

# OAKVILLE

# PURCHASER REQUEST FOR EXTRAS FORM

MODEL: OAK 533

SUITE: 711

# WORK / PURCHASE ORDER

**STANDARD PACKAGE - LIGHT (1) \* All item below are applicable as per plan**

| *Cabinets                 |  |
|---------------------------|--|
| Kitchen                   | Sierra White PVC                               |
| Island *as per plan       | N/A  |
| Master Ensuite            | N/A  |
| Main                      | Sierra White PVC                               |
| *Countertops              |  |
| Kitchen                   | Emerstone Quartz Carrara White                 |
| Master Ensuite            | N/A  |
| Main                      | Emerstone Quartz Carrara White                 |
| *Tile/Hardwood            |  |
| Laminate Flooring         | Highland Willowbrook Oak 8 Inch                |
| Kitchen Bk.Splash         | Colours & Dimensions Silver Grey Matte 4 x 16  |
| Laundry                   | Lily White Tile 12 x 12                        |
| Master Glass Shower       | N/A  |
| Mastr Ensuite Floor       | N/A  |
| Mstr Ens. Shower Wall     | N/A  |
| Master Shower Flr         | N/A  |
| Main Bath Floor           | Genesis Light Grey 12 x 24                     |
| Main Bath Wall            | Genesis Light Grey 12 x 24                     |
| *Trim, Kitchen, Bathrooms |  |
| Trim                      | Flat MDF 2-3/4" Casing X 5-1/4" Baseboard      |
| Cabinet Handles           | Standard                                       |
| Kitchen Sink              | Cantrio KSS2018 Undermount                     |
| Kitchen Faucet            | Peerless P7919LF CHROME, Pulldown Faucet       |
| Master Ensuite Sink       | N/A  |
| Master Ensuite Faucet     | N/A  |
| Master Ensuite Tub        | N/A  |
| Master Shower Faucet      | N/A  |
| Master Ensuite Toilet     | N/A  |
| Main Bath Sink            | PS161C Undermount, rectangle                   |
| Main Bath Faucet          | Peerless P1519LF CHROME                        |
| Main Bath Tub             | ADORA Skirted Tub                              |
| Main Tub Faucet           | Peerless PT14419 CHROME                        |
| Main Toilet               | WC-382 WHITE, Elongated, Soft-Close, One Piece |
| Fridge                    | SEE SPEC                                       |
| Stove                     | SEE SPEC                                       |
| Dishwasher                | SEE SPEC                                       |
| Microwave                 | SEE SPEC                                       |
| Washer/Dryer              | SEE SPEC                                       |

[illegible]

**DISCLAIMER & CONDITIONS**

\*\*\*FOR TRADE USE\*\*\*

***Any upgrades in the colour chart must be accompanied with a PES. It is the responsibility of all Trades to inform the builder of any discrepancies on sketches, PES and/or colour charts PRIOR to installation.***

**To Agreement of Purchase and Sale  
The Branch Condominiums  
Oakville, ON**

## RESIDENTIAL SUITE

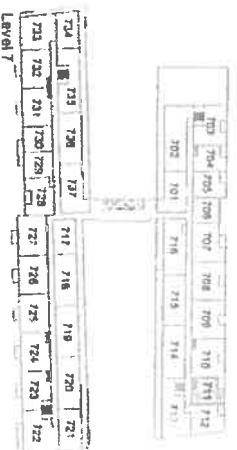

Vendor's Initial: \_\_\_\_\_ Purchaser's Initial: AM CM Date: Aug 11 22

[illegible]

OAKVILLE

INTERIOR FINISHES ACKNOWLEDGEMENT

ZANCOR  
HOMES  
T-15  
B R A N C H

The BRANCH - Oakville

SUITE: 711

DATE:

INTERIOR FINISHES ACKNOWLEDGEMENT

Purchaser accepts and acknowledges that the Builder reserves the right to substitute materials with those of equal or better quality where the manufacture, scheduling or delivery of materials may directly impact the Builder's ability to meet its contractual obligations under the Agreement of Purchase and Sale. The purchaser acknowledges and agrees to proceed forthwith with res selections in the event the original selections cannot be incorporated into the interior finishing of the home upon notice by the Builder.

CM1 (M)

Every effort will be made to ensure the materials selected are as close as possible to the samples provided, however due to variances in manufacturing and properties of natural materials we do not guarantee identical colour matching.

CM1 (M)

PORCELAIN & NATURAL STONES: Due to the properties of natural stones including but not limited to marble, granite, quartz, no two pieces are exactly the same. Variations in colour, tone, granularity (pitting, fissures) and patterns are to be expected, including various lighting may affect the overall finished look. Stone should never be cleaned with lemon oil or vinegar. The purchaser acknowledges colour and product variations as well as natural imperfections that may exist with the selection of natural stone materials and shall not hold the Vendor liable for provision of same.

CM1 (M)

STONE COUNTERTOP JOINTS: Purchaser is aware that one joint may be at each corner and on either side of slide-in-range (if applicable). It will also be where the length of the counter top exceeds the length of a stone slab. Slabs are usually approximately 5' x 8'.

CM1 (M)

TILES: Due to manufacturing, shade (dye lots), product variations may exist that can affect the overall look of the finished product. Although every effort will be made to ensure the colours and materials selected are as close as possible to the samples, the purchaser acknowledges that the sample tiles supplied in the Design Centre may not be identical to the materials installed in the home.

CM1 (M)

LAMINATE / HARDWOOD FLOORING: Due to the natural properties of wood & laminate, many variables can affect the overall look of the finished product. Variations include but not limited to wood type or laminate finish, colour/stain and wood grain are significant factors that make exact colour matching impossible. The purchaser acknowledges that the hardwood flooring and laminate is a pre-finished product in a controlled environment. Expansion, compression and cupping are characteristics of hardwood flooring once installed in the home. The purchaser acknowledges these may become apparent over time and despite the Builders' efforts to install the hardwood flooring materials in keeping with good workmanship, the Builder shall not be responsible nor held liable for minor variances of fluctuation in hardwood flooring materials.

CM1 (M)

CABINETRY: Due to the natural properties of wood, slight variations apparent with cabinetry are to be expected. This includes but not limited to wood species, wood grain, colour, finish, product variations, and natural imperfections are all factors that may affect the overall look of the finished product. Such factors make exact colour matching impossible. The type and intensity of lighting in the areas of designated cabinetry placement may also highlight characteristics of cabinetry finish. All cabinets shall be finished with a white melamine interior box unless a finished interior is upgraded. Due to building specifications and/or on-site conditions, certain cabinetry upgrades may not be possible. The purchaser acknowledges that the Builder cannot guarantee the cabinetry finish or provision of certain upgrades and shall not hold the Builder liable for provision of same.

CM1 (M)

UPGRADES/EXTRAS: All upgrades and additional selections indicated on the colour chart must be accompanied by an upgrade/extras sheet (PES) and full payment otherwise the selection will be invalid. All colour charts and upgrades/extras will not proceed until verified and signed by an authorized signing officer at the Vendor's head office. CHANGES WILL NOT BE PERMITTED UPON COMPLETION AND SUBMISSION OF THE COLOUR CHART.

CM1 (M)

Suite 711

## APPLIANCE PACKAGE

1 Bedroom Suite  
1 Bedroom + Den Suite, Loft

THE  
BRANCH

PURCHASER NAME C. MOSSA

PURCHASER NAME MOSSA

DATE Aug 11 2022



24" Fridge  
(Panel Ready)  
GE - M2E9FPMKII



24" Range, Smooth top  
GE - JCAS640RMSS



24" Over The Range  
Microwave  
Haier HMV1472BHS



(Panel Ready)  
UDT518SAHP



24" Washer  
WM7200WW



24" Dryer  
DV7600WW

Products photos may not be exact and are subject to change without notice with equal or better value. E & O.E.