

CONSTRUCTION SUMMARY OF EXTRAS
Printed 2022-12-19 / 3:57 PM / Page 1 of 2

Site: CALEDON
Lot: 144A
Model: MAGNA(38-01) ELEV B
Purchaser: NIRMAL K NIJJAR
Purchaser: 0
Phone: 647.283.1655
Email: JK@LESCAPE.COM



DESCRIPTION		DATE SELECTED
BONUS PACKAGE: 3 PIECE STAINLESS STEEL APPLIANCES WITH WHITE WASHER & DRYER	INCLUDED IN APS	
BONUS PACKAGE: STAINLESS STEEL HOOD FAN	INCLUDED IN APS	
STRUCTURALS		
1 NA		18-Oct-21
2 NA		18-Oct-21
3 QTY 1- LARGER BASEMENT WINDOW- 30" X 24" - SEE SKETCH		18-Oct-21
4 NA		18-Oct-21
5 SIDE ENTRY- (FROM EXTERIOR TO STAIRS) AS PER PLAN. GRADE PERMITTING & PENDING CITY APPROVAL- SEE SKETCH		18-Oct-21
6 SHOWER NICHE IN MASTER ENSUITE- 18 INCHES X 14 INCHES HIGH BUILT INTO THE WALL, IMNCLUDE MARBLE SURROUND AND TILED BACK- SEE SKETCH		18-Oct-21
7 SHOWER NICHE IN ENSUITE 2- 18 INCHES X 14 INCHES HIGH BUILT INTO THE WALL, IMNCLUDE MARBLE SURROUND AND TILED BACK- SEE SKETCH		18-Oct-21
8 ENSUITE 2-CONVERT 5' TUB TO FRAMELESS GLASS SHOWER ENCLOSURE WITH STANDARD 2 X 2 TILES ON THE FLOOR, STANDARD WALL TILES, STANDARD MARBLE JAMB & LED SHOWER POTLIGHT IN LIEU OF TUB- SEE SKETCH		18-Oct-21
COLOURS		
1 BANK OF DRAWERS IN MASTER AND SHARED BATH		18-Oct-21
2 KITCHEN- OVER THE RANGE MICROWAVE, INCLUDES 15 AMP- SEE SPEC AND SKETCH- OCT 25		18-Oct-21
3 KITCHEN- UPPER PIE CUT- SEE SKETCH		18-Oct-21
4 KITCHEN- FRIDGE ENCLOSURE- DEEP UPPER AND GABLES- SEE SKETCH		18-Oct-21
5 KITCHEN- BANK OF DRAWERS- SEE SPEC AND SKETCH		18-Oct-21
6 KITCHEN- DOUBLE RISER, INSTALLED AT CEILING- SEE SKETCH		18-Oct-21
7 KITCHEN- PANTRY 60CM BY APPROX 3 FEET - UP 1,		18-Oct-21
8 PLUMBING- WATERLINE FOR FRIDGE		18-Oct-21
9 PLUMBING- KITCHEN SINK- 515 BLANCO QUARTUS- 401518		18-Oct-21
10 ELECTRICAL- 2 CAPPED LIGHTS OVER KITCHEN ISLAND, SPACED EVENLY ON SEPARATE SWITCH STD LIGHT TO REMAIN- SEE SKECTH		18-Oct-21
11 ELECTRICAL- PLUG OVER FIREPLACE FOR FUTURE TV, BESIDE CABLE. INSTALL 65 AFF- SEE SKETCH		18-Oct-21
12 ELECTRICAL- ROUGH IN FOR UNDER VALANCE LIGHTING		18-Oct-21
13 POWDER ROOM COUNTERTOP- UP 2- OCT 25		18-Oct-21
14 NA		18-Oct-21
15 NA		18-Oct-21
16 GAS FIREPLACE (LINEAR) NAPOLEAN BL46- 46 INCH (INCLUDES STANDARD MANTLE) ** TOWNSHIP PERMITTING- MANTEL- NF15		18-Oct-21
17 KITCHEN CABINET- UP 1		18-Oct-21
18 KITCHEN- COUNTERTOP- UP 3	SEE RESELECTION	18-Oct-21
19 KITCHEN BACKSPLASH- SLAB- UP 3		18-Oct-21
20 HARDWOOD- UP 2- GREAT ROOM, PARLOUR, MAIN HALL/ LANDINGS, UPPER HALL- UP 2		18-Oct-21
21 HARDWOOD- UP 2- BEDROOMS- MASTER, BEDROOM 2, 3, 4		18-Oct-21
22 MASTER SHOWER FLOOR- UP 2		18-Oct-21
23 ENSUITE 2 SHOWER FLOOR- UP 2		18-Oct-21
24 HARDWARE FOR CABINETS		18-Oct-21
25 RAILING- UP 2		18-Oct-21
26 COMFORT HEIGHT- QTY 4- MASTER, ENSUITE 2, POWDER, SHARED		18-Oct-21
27 INTERIOR DOOR HARDWARE- WINILY 3820 STRAIGHT LEVER, MATTE BLACK WITH MATTE BLACK HINGES		18-Oct-21

CONSTRUCTION SUMMARY OF EXTRAS

Printed 2022-12-19 / 3:57 PM / Page 2 of 2

Site: CALEDON
Lot: 144A
Model: MAGNA(38-01) ELEV B
Purchaser: NIRMAL K NIJJAR
Purchaser: 0
Phone: 647.283.1655
Email: JK@LESCAPE.COM



DESCRIPTION		DATE SELECTED
RESELECTION OF COUNTERTOP		
1	RESELECTION OF COUNTERTOP IN KITCHEN **required as original is not available	30-Nov-22
2	INSTALL EMERSTONE BORGHINI D'ORO **INCLUDES BACKSPASH TO MATCH (Upgrade 4)	30-Nov-22
ELECTRICAL REQUIREMENT		
1	ELECTRICAL - ADD (2) PLUGS IN LOCATIONS AS PER ARTISTIC SMART HOMES	30-Nov-22

Already Done

ENTRANCES				
Main Foyer - FLOORING		NEW BYZANTINE PENTELIC GREY 12 X 24- BRICKED		
Mudroom - FLOORING		NEW BYZANTINE PENTELIC GREY 12 X 24- BRICKED		
Side Hall - FLOORING		NA		
Basement Foyer - FLOORING		NA		
KITCHEN				
Kitchen - FLOORING		NEW BYZANTINE PENTELIC GREY 12 X 24- BRICKED		
Breakfast - FLOORING		NEW BYZANTINE PENTELIC GREY 12 X 24- BRICKED		
Kitchen - CABINETS		MATRIX CHIOSTRO- UP 1		
Island - CABINETS		MATRIX CHIOSTRO- UP 1		
Servery - CABINETS		NA		
Kitchen - HANDLES/KNOBS		H800MB		
Kitchen - COUNTERTOP		CALCATTÀ GOLD-UP 3-		
Island - COUNTERTOP		CALCATTÀ GOLD-UP 3-		
Kitchen - BACKSPLASH		CALCATTÀ GOLD SLAB-UP 3		
Kitchen - SINK		BLANCO QUARTUS R15- 401518		
Kitchen - FAUCET		STD		
GREAT ROOM / DINING / LIVING / DEN / OFFICE / BASEMENT				
Family / Great Room - FLOORING		KENTWOOD BRUSHED OAK STONNECROP 5 X 3/4"- UP 2		
Main Hall - FLOORING		KENTWOOD BRUSHED OAK STONNECROP 5 X 3/4"- UP 2		
PARLOUR - FLOORING		KENTWOOD BRUSHED OAK STONNECROP 5 X 3/4"- UP 2		
Library / Den - FLOORING		NA		
Basement Rec Room - FLOORING		NA		
STAIRS				
Railing Details - PICKETS		1 3/4" SQUARE OAK W/ BEVEL CORNERS- UP 2		
Railing Details - POSTS		3 1/4" SQUARE OAK POST W/ BEVEL CORNERS- UP 2		
Railing Details - HANDRAIL		2 3/4" OAK HANDRAIL- UP 2		
Stair Stain - MAIN STAIRS		STAIN STAIRS TO MATCH HARDWOOD AS CLOSE AS POSSIBLE		
Stair Stain - BASEMENT STAIRS (if applicable)		NA		
Stair Stain - SERVICE STAIRS (if applicable)		NA		
POWDER ROOM				
Powder Room - FLOORING		NEW BYZANTINE PENTELIC GREY 12 X 24- BRICKED		
Powder Room - CABINETS		EURO OLMO CARISMA- COMFORT HEIGHT- OCT 25		
Powder Room - COUNTERTOP		BLANCO PURE- UP 2- OCT 25		
Powder Room - SINK		STD		
Powder Room - FAUCET		STD		
2ND FLOOR				
Upper Hall - FLOORING		KENTWOOD BRUSHED OAK STONNECROP 5 X 3/4"- UP 2		
Master Bedroom - FLOORING		KENTWOOD BRUSHED OAK STONNECROP 5 X 3/4"- UP 2		
Bedroom 2 - FLOORING		KENTWOOD BRUSHED OAK STONNECROP 5 X 3/4"- UP 2		
Bedroom 3 - FLOORING		KENTWOOD BRUSHED OAK STONNECROP 5 X 3/4"- UP 2		
Bedroom 4 - FLOORING		KENTWOOD BRUSHED OAK STONNECROP 5 X 3/4"- UP 2		
Bedroom 5 - FLOORING		NA		
Master Ensuite - FLOORING		GENESIS LIGHT GREY 12 X 24- BRICKED- OCT 25		
Master Ensuite - SHOWER WALL		GENESIS LIGHT GREY 12 X 24- STACKED VERTICAL- OCT 25		
Master Ensuite - SHOWER FLOOR		MARBLE ICEBURG 2 X 2- UP 2		
Master Ensuite - SHOWER JAMB		BIANCO CARRARA- OCT 25		
Master Ensuite - CABINETS		SIERRA WHITE PVC- COMFORT HEIGHT- OCT 25		
Master Ensuite - HANDLES/KNOBS		H800MB		
Master Ensuite - COUNTERTOP		BIANCO CARRARA- OCT 25		
Master Ensuite - SINK(s)	STD	Master Ensuite - FAUCET(s)	STD	
FOR TRADE USE				
Any upgrades in the colour chart must be accompanied with a PES. It is the responsibility of all Trades to inform the builder of any discrepancies on sketches, PES and/or colour charts PRIOR to installation.		CALEDON 144A	X N.N	
PAGE 1 OF 2		PURCHASER INITIALS	VENDOR APPROVAL	

ANCOR HOMES COLOUR CHART

2ND FLOOR CONTINUED ...

Main Bath - FLOORING		NA
Main Bath - TUB / SHOWER WALL		NA
Main Bath - SHOWER FLOOR		NA
Main Bath - SHOWER JAMB		NA
Main Bath - CABINETS		NA
Main Bath - HANDLES/KNOBS		NA
Main Bath - COUNTERTOP		NA
Main Bath - SINK(s)	NA	Main Bath - FAUCET(s) NA
Shared Bath - FLOORING	GENESIS LIGHT GREY 12 X 24- BRICKED- OCT 25	
Shared Bath- TUB / SHOWER WALL	GENESIS LIGHT GREY 12 X 24- STACKED VERTICAL- OCT 25	
Shared Bath- SHOWER FLOOR	NA	
Shared Bath- SHOWER JAMB	NA	
Shared Bath- CABINETS	SIERRA WHITE PVC- COMFORT HEIGHT- OCT 25	
Shared Bath- HANDLES/KNOBS	H800MB	
Shared Bath- COUNTERTOP	5003-38- WHITE CASCADE	
Shared Bath- SINK(s)	STD	Shared Bath - FAUCET(s) STD
Ensuite 2 Bath - FLOORING	GENESIS LIGHT GREY 12 X 24- BRICKED- OCT 25	
Ensuite 2 Bath - TUB / SHOWER WALL	GENESIS LIGHT GREY 12 X 24- STACKED VERTICAL- OCT 25	
Ensuite 2 Bath - SHOWER FLOOR	MARBLE ICEBURG 2 X 2- UP 2	
Ensuite 2 Bath - SHOWER JAMB	BIANCO CARRARA- OCT 25	
Ensuite 2 Bath - CABINETS	CONT SLAB OAK TIMBER GREY- COMFORT HEIGHT	
Ensuite 2 Bath - HANDLES/KNOBS	H800MB	
Ensuite 2 Bath - COUNTERTOP	5003-38- WHITE CASCADE	
Ensuite 2 Bath - SINK(s)	STD	Ensuite Bath - FAUCET(s) STD

LAUNDRY

Laundry - FLOORING	NEW BYZANTINE PENTELIC GREY 12 X 24- BRICKED	Laundry - HANDLES/KNOBS	H800MB
Laundry - CABINETS	CONT SLAB OAK TIMBER GREY	Laundry - SINK	STD
Laundry - COUNTERTOP	5003-38	Laundry - FAUCET	STD
Laundry - BACKSPLASH	NA		

TRIM / PAINT

Casing/Baseboards		STD
Interior Doors		STD
Interior Door Hardware	WINLY 3820- MATTE BLACK W/ BLACK HINGES	
PAINT - Throughout	COOL WHITE	

FIREPLACE

Location / Insert / Mantle	GAS NAPOLEAN BL46-46 LINEAR WITH NF15 MANTLE	
----------------------------	--	--

ACCESSORIES

Mirrors	YES	BATH ACCESSORIES	DO NOT INSTALL
---------	-----	------------------	----------------

APPLIANCE REQUIREMENTS

GAS LINE TO BBQ	STD	ELECTRICAL for Built-in Oven	DECLINED
GAS LINE & ELECTRICAL TO STOVE	DECLINED	ELECTRICAL for Built in	YES
GAS LINE & ELECTRICAL TO DRYER	DECLINED	ELECTRICAL for Cooktop	DECLINED
HOOD FAN VENT SIZE	6" STD	ELECTRICAL for Bar Fridge	DECLINED
WATERLINE to Fridge	YES		

DISCLAIMER

INITIALS

Any changes to the colour chart after signing are subject to a \$5000 administration fee plus costs			
Purchaser has checked and acknowledged accuracy of colour and selections before signing.			

Colours of all materials are as close as possible to Builders selection but not necessarily identical due to dye lot variances in manufacturing/manufacturers. Due to construction progress some items may have been pre-selected or installed. In this event the Vendor's selection must be accepted by the purchaser

SITE / LOT:	CALEDON	144A
PURCHASER(S):	NIRMAL K NIJAR	
PURCHASER(S):	0	
CONTACT:	647.283.1655	JK@LESCAPE.COM

FOR TRADE USE

Any upgrades in the colour chart must be accompanied with a PES. It is the responsibility of all Trades to inform the builder of any discrepancies on sketches, PES and/or colour charts PRIOR to installation.	PURCHASER SIGNATURE	INITIALS	SIGN HERE
	PURCHASER SIGNATURE		
	DÉCOR CONSULTANT		



ASCENT™ LINEAR SERIES DIRECT VENT GAS FIREPLACE



Specifications

Model	BTU	Width		Height		Depth		Glass
		Actual	Framing	Actual	Framing	Actual	Framing	
BL36-1	17,500	35 15/16	36 1/2	39 1/16	39 3/8	15 3/4	16	16 3/4 X 30 3/4
BL46	24,000	46 7/8	47 3/8	39 1/16	39 3/8	18 5/16	18 9/16	16 3/4 X 41 11/16

Front Options

BL36-1: Classic/Premium

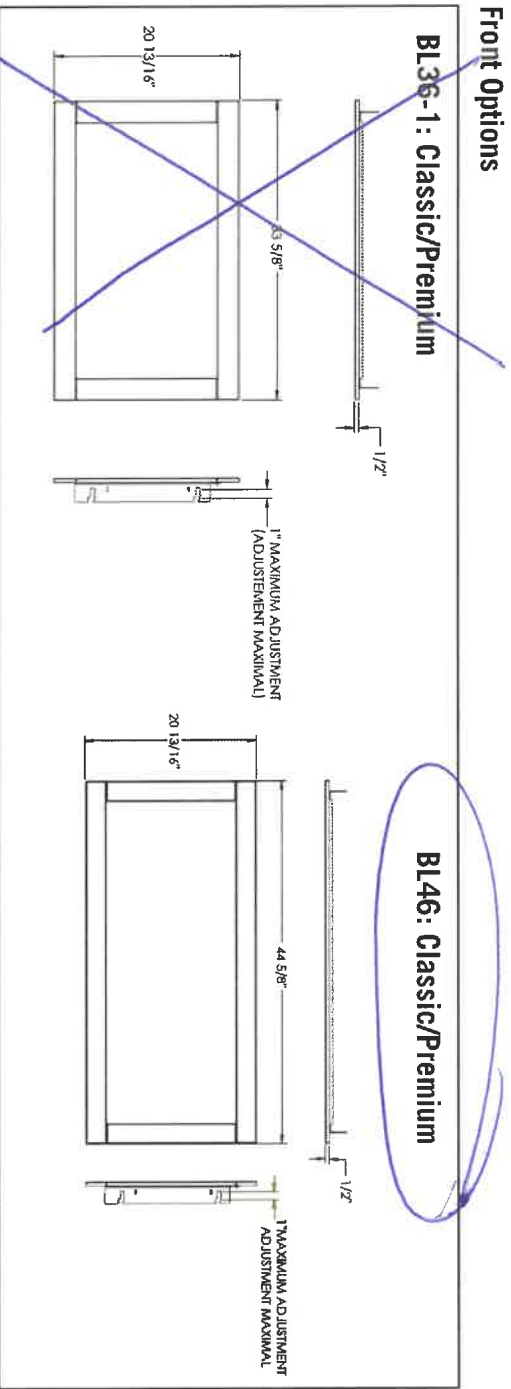

BL46: Classic/Premium

Flush Framing Clearances

Recessed Framing Clearances

WARNING

- Do not build into the area - it must be left clear to provide adequate clearance for the vent in the 14" (35.6cm) wide area centered along the front of the appliance. The appliance should be in its final location before framing.

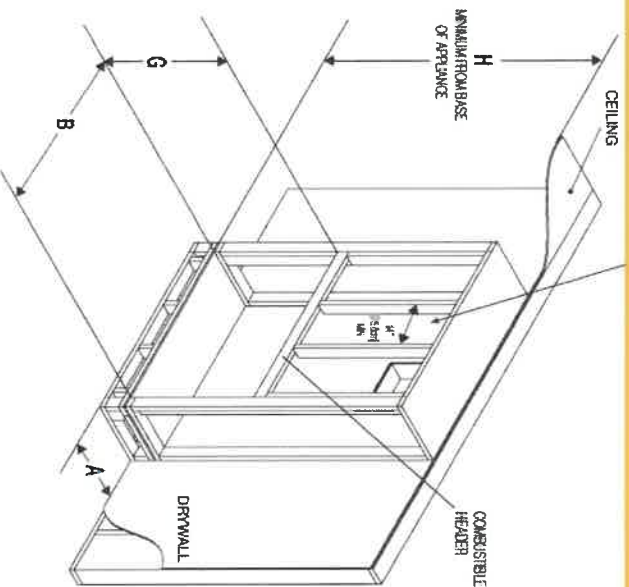

BL36-1		BL46	
B	36 1/2 (92.7cm)		47 3/8 (120.3cm)
G	39 3/8 (100cm)		39 3/8 (100cm)
A	16 (40.6cm)		18 9/16 (47.1cm)
H	56 (1.42.2cm)		56 (1.42.2cm)

WARNING

- Do not build into the area - it must be left clear to provide adequate clearance for the vent in the 14" (35.6cm) wide area centered along the front of the appliance. The appliance should be in its final location before framing.

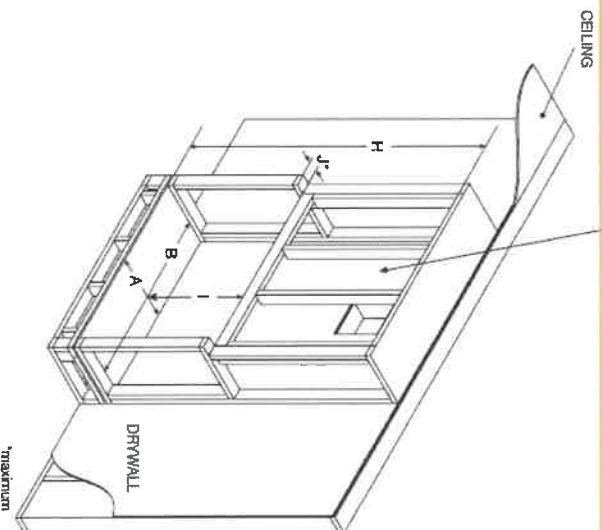

BL36-1		BL46	
I	41 1/2 (105.4cm)		41 1/2 (105.4cm)
A	16 (40.6cm)		18 9/16 (47.1cm)
B	36 1/2 (92.7cm)		47 3/8 (120.3cm)
H	56 (1.42.2cm)		56 (1.42.2cm)
J	4 (10.2cm)		4 (10.2cm)

1444A

ASCENT™ LINEAR SERIES DIRECT VENT GAS FIREPLACE



Product information provided is not complete and is subject to change without notice. Please consult the installation manual for the most up to date installation information.

Dimensions

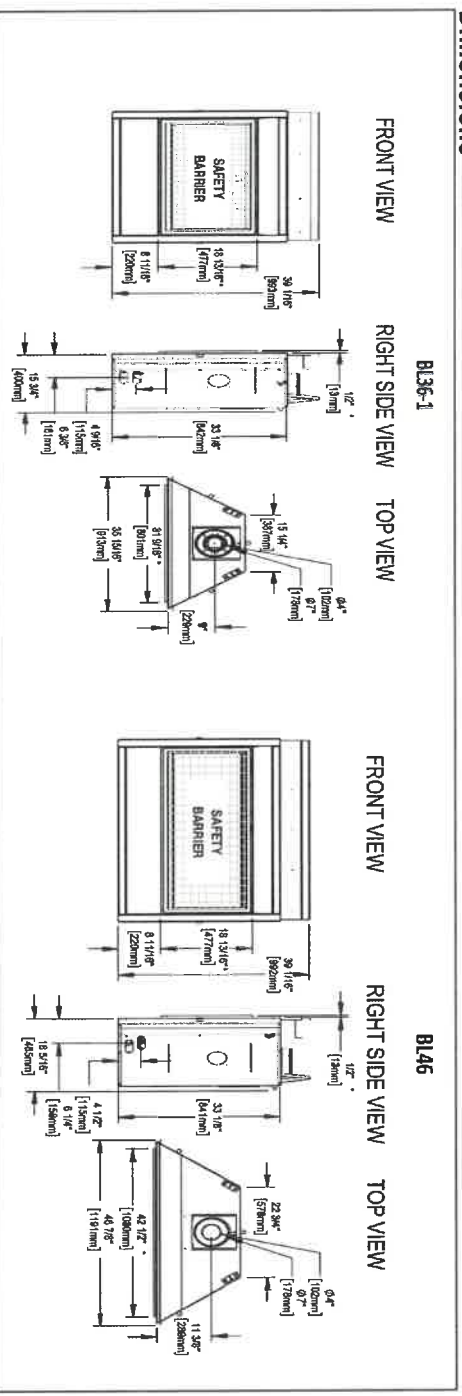

Wall Penetration

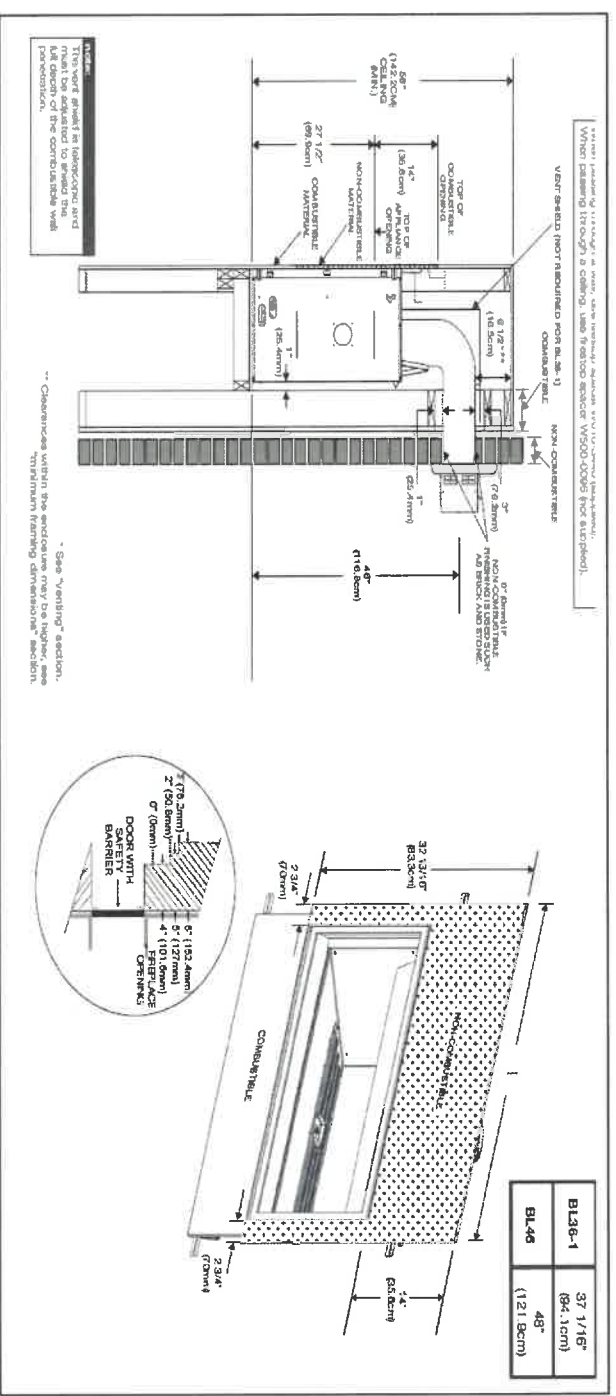

Combustible Mantel Clearances

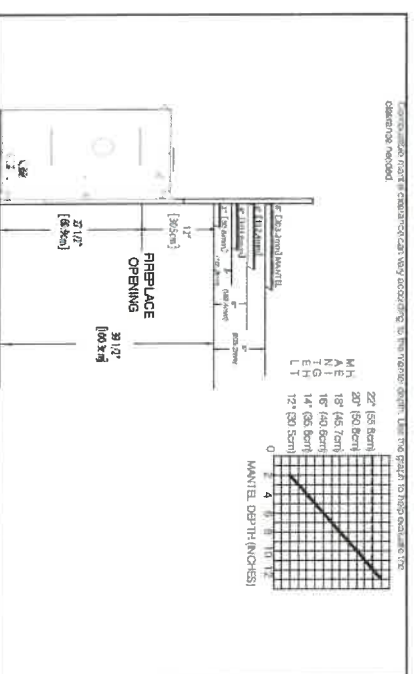

Appliance Location

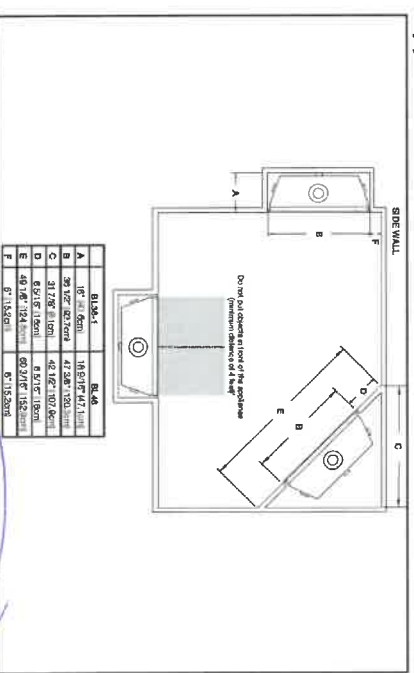

144

Product Specification Sheet
QUATRUS R15 U SUPER SINGLE

Satin brushed finish



PRODUCT DIMENSIONS

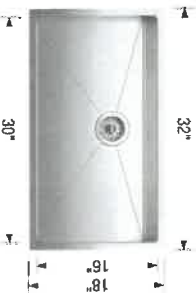

1 of 144A
Oct 19/21

QUATRUS R15 U SUPER SINGLE	Colour Finish	Model No.	FEATURES / SPECIFICATIONS
-------------------------------	---------------	-----------	---------------------------



Satin brushed
finish

401518

- German engineered with 304 series, 18-gauge stainless steel
- Practical 15 mm radius corners for easy cleaning
- X-pattern drain grooves quickly remove water from the sink
- Extra-large bowl size is ideal for busy families
- 18/10 chrome-nickel content for exceptional lustre and strength
- Rear-positioned drain holes maximize cabinet storage space

DESIGN AND PLANNING TIPS

Cabinet Size: 36" (915 mm)
Bowl depth: 9" (230 mm)
Depending on cabinet construction, a different cabinet size may be required.
Consult the cabinet manufacturer.

WARRANTY

Limited Lifetime warranty

Code/Standards Compliance

BLANCO sinks and faucets are third-party tested and certified to CSA, cUPC, ANSI/ASME and NSF standards and listed by applicable certification bodies. For more information on individual product listings, contact our office or listing organization.

BLANCO CANADA 100 Corporation Drive Brampton, ON L6S 6B5	Tel: 905 494 2400 Fax: 905 494 2425 www.blancocanada.com	Toll Free: 1 877 425 2626 Toll Free: 1 877 825 2626	© 2016 BLANCO CANADA
--	--	--	----------------------

Kleber Int.

N.N



1.1 cu. ft. Low Profile Microwave Hood Combination
WML55011H



Stainless Steel
WML55011HS

Also available in:

- ☐ White WML55011HW
- ☒ Black WML55011HB

Key Features & Benefits

Low Profile Design

Maximize space by moving your microwave off the countertop with a Low Profile design that fits in the same space as your undercabinet hood.*

Purposeful Capacity

Fit tall glasses, wide plates and big bowls in this low profile microwave that still has enough room for all the essentials with 1.1 cu. ft. of purposeful capacity.

400 CFM Motor Class High

Performance Venting
Keep your kitchen smelling like home with 400 CFM motor class high performance venting that quickly gets rid of smoke, odor and moisture.

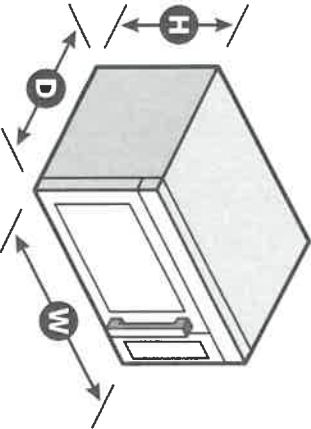

Capacity	
Total	1.1 cu. ft.
General Features & Properties	
Tap-To-Open Door	
Concealed Touch Controls	
90° Hinge Door	
Popcorn Preset	
1,000-Watt Cooking Power	
Turntable On/Off Option	
Dishwasher-Safe Turntable Plate	
Microwave Presets	
Add 30 Seconds Option	
Electrical Details	
Amps	15
Volts	120

Technical Details	
Microwave Type	Over-the-Range
CFMs	400
Lighting Type	Halogen
Number of Speeds	3
Venting Type	Updraft
Dimensions	
Product Dimensions (H x W x D)	10-5/16" x 29-7/8" x 18"
Depth with Door Open 90°	42-1/8"
Cutout Dimensions (W x D)	30" x 12" minimum
Reference Material	
Install Guide	
Use & Care Guide	
Warranty	

Lot 144A
Oct 28/21

*Based on 24" minimum install for undercabinet hoods and Low Profile Microwave Hood. **Performance varies based on installation. NOTE: Dimensions are for planning purposes only. For complete details, see Installation Instructions packed with product. Specifications subject to change without notice. ®/™ © 2020. All rights reserved. Printed in the U.S.A. D200104XXE. WML55011HSpecSheetV01.

- Rotate microwave oven up toward upper cabinet.

NOTE: If venting through the wall, make sure the damper assembly fits easily into the vent in the wall cutout.

- Push microwave oven against mounting plate and hold in place.

NOTE: If microwave oven does not need to be adjusted, skip steps 7 through 9.

- If adjustment is required, rotate microwave oven downward. Using 2 or more people, lift microwave oven off of mounting plate and set aside on a covered surface.

- Loosen mounting plate screws. Adjust mounting plate and retighten screws.

- Repeat steps 3 through 6.

- With the microwave oven centered, and with at least one person holding it in place, insert bolts through upper cabinet into microwave oven. Tighten bolts until there is no gap between upper cabinet and microwave oven.

NOTE:

- Some upper cabinets may require bolts longer or shorter than 3" (7.6 cm). Longer or shorter bolts are available at most hardware stores.
- Overtightening bolts may warp the top of the microwave oven. To avoid warping, wood filler blocks (installer to provide) may be added. The blocks must be the same thickness as the space between the upper cabinet bottom and the microwave oven.

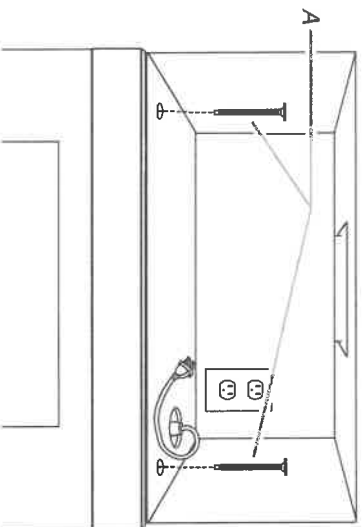

A. Bolts

- Connect vent to damper assembly.

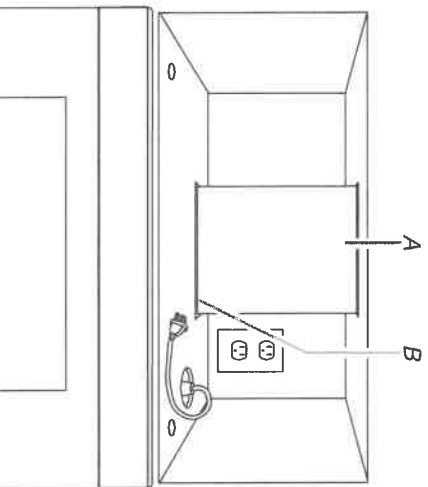

A. Vent

B. Damper assembly (under vent) Compact

Complete Installation

- Install filters. Refer to the User Instructions for filter placement.

⚠ WARNING



Electrical Shock Hazard

Plug into a grounded 3 prong outlet.

Do not remove ground prong.

Do not use an adapter.

Do not use an extension cord.

Failure to follow these instructions can result in death, fire, or electrical shock.

- Plug microwave oven into grounded 3 prong outlet.
 - Reconnect power.
 - Check the operation of microwave oven by placing 1 cup (250 ml) of water in the turntable and programming a cook time of 1 minute at 100% power. Test vent fan and exhaust by operating the vent fan.
 - If the microwave oven does not operate:
 - Check that a household fuse has not blown, or that a circuit breaker has not tripped. Replace the fuse or reset the circuit breaker. If the problem continues, call an electrician.
 - Check that the power supply cord is plugged into a grounded 3 prong outlet.
 - See the User Instructions for troubleshooting information. Installation is now complete.
- Save Installation Instructions for future use.

lot 1444
06/28/21

Installation Dimensions

NOTE: The grounded 3 prong outlet must be inside the upper cabinet. See the "Electrical Requirements" section.

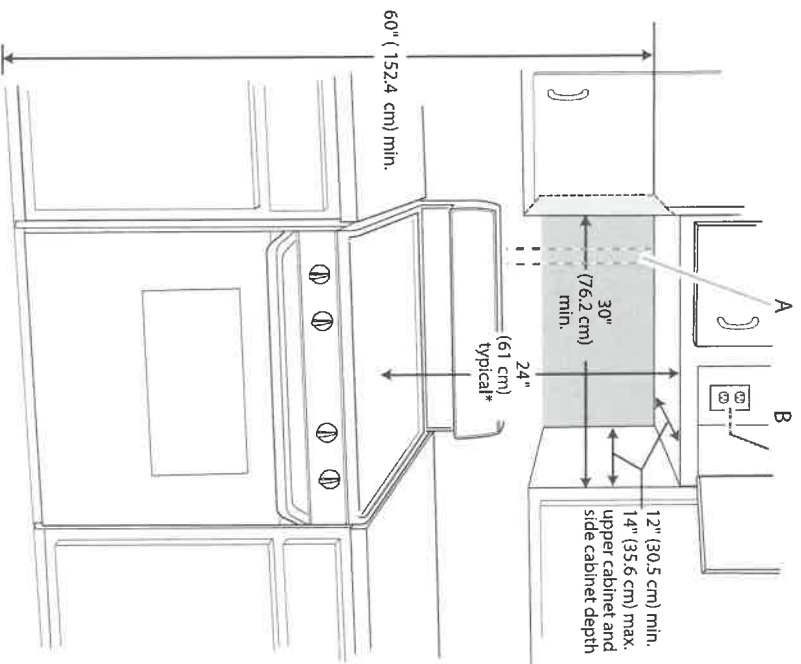

A. 2" x 4" wall stud
B. Grounded 3 prong outlet

*24" (61 cm) is typical for 60" (152.4 cm) installation height. Exact dimensions may vary depending on type of range/cooktop below.

Product Dimensions

*Overall depth of product will vary slightly depending on door design.

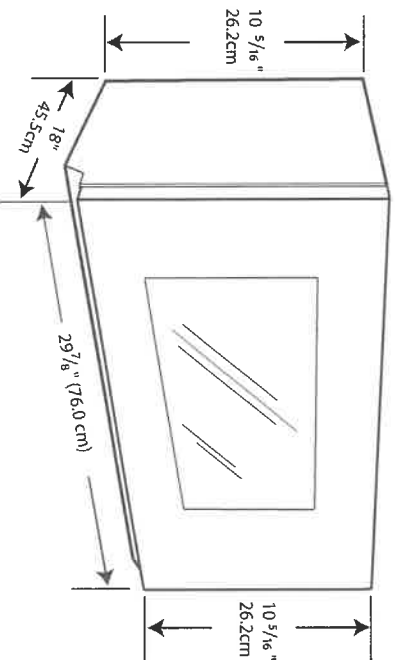

Electrical Requirements

⚠WARNING



Electrical Shock Hazard

- Plug into a grounded 3 prong outlet.
- Do not remove ground prong.
- Do not use an adapter.
- Do not use an extension cord.
- Failure to follow these instructions can result in death, fire, or electrical shock.

Observe all governing codes and ordinances.

Required:

- A 120-volt, 60 Hz, AC-only, 15- or 20-amp electrical supply with a fuse or circuit breaker

Recommended:

- A time-delay fuse or time-delay circuit breaker
- A separate circuit serving only this microwave oven

GROUNDING INSTRUCTIONS

■ For all cord connected appliances:

The microwave oven must be grounded. In the event of an electrical short circuit, grounding reduces the risk of electric shock by providing an escape wire for the electric current. The microwave oven is equipped with a cord having a grounding wire with a grounding plug. The plug must be plugged into an outlet that is properly installed and grounded.

WARNING: Improper use of the grounding plug can result in a risk of electric shock. Consult a qualified electrician or serviceman if the grounding instructions are not completely understood, or if doubt exists as to whether the microwave oven is properly grounded.

Do not use an extension cord. If the power supply cord is too short, have a qualified electrician or serviceman install an outlet near the microwave oven.

SAVE THESE INSTRUCTIONS

lot 144A
Oct 28/21

VENTING DESIGN SPECIFICATIONS

This section is intended for architectural designer and builder/contractor reference only.

NOTES:

- Vent materials needed for installation are not provided with microwave hood combination.
- We do not recommend using a flexible metal vent.
- To avoid possible product damage, be sure to vent air outside, unless using recirculation installation. Do not vent exhaust air into concealed spaces, such as spaces within walls or ceilings, attics, crawl spaces, or garages.

For optimal venting installation, we recommend:

- Using roof or wall caps that have back draft dampers
- Using a rigid metal vent
- Using the most direct route by minimizing the length of the vent and number of elbows to provide efficient performance
- Using uniformly sized vents
- Using duct tape to seal all joints in the vent system
- Using caulking compound to seal exterior wall or roof opening around cap
- Not installing 2 elbows together for optimal hood performance

If venting through the wall, be sure that there is proper clearance within the wall for the damper to open fully.

If venting through the roof, and rectangular-to-round transition is used, be sure there are at least 3" (7.6 cm) of clearance between the top of the microwave oven and the transition piece. See "Rectangular-to-Round Transition" illustration.

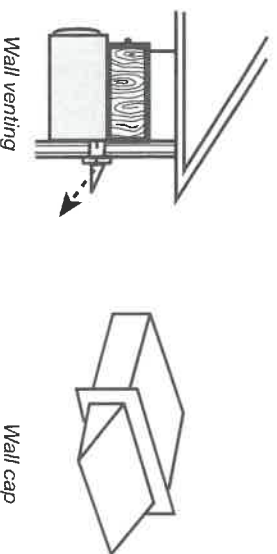
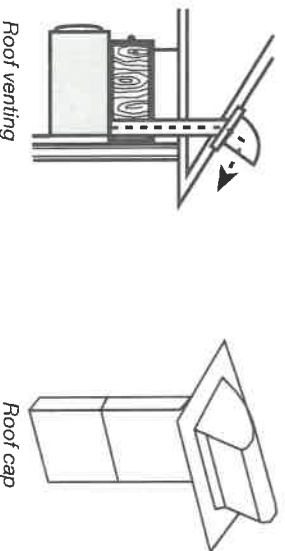

Rectangular-to-Round Transition

NOTE: The minimum 3" (7.6 cm) clearance must exist between the top of the microwave oven and the rectangular to round transition piece so that the damper can open freely and fully.

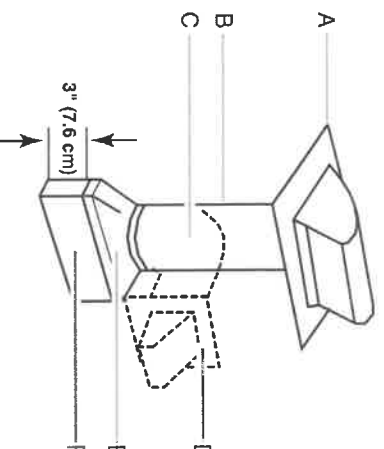

- A. Roof cap
- B. 6" (15.2 cm) min. diameter round vent
- C. Elbow (for wall venting only)
- D. Wall cap
- E. 3 1/4" x 10" (8.3 x 25.4 cm to 15.2 cm) rectangular to round transition piece
- F. Vent extension piece, at least 3" (7.6 cm) high

Recommended Vent Length

A 3 1/4" x 10" (8.3 x 25.4 cm) rectangular or 6" (15.2 cm) round vent should be used.

The total length of the vent system including straight vent, elbow(s), transitions, and wall or roof caps must not exceed the equivalent of 140 ft (42.7 m) for either type of vent. See the "Recommended Standard Fittings" section for equivalent lengths.

For best performance, use no more than three 90° elbows. To calculate the length of the system you need, add the equivalent lengths of each vent piece used in the system. See the following examples.

3 1/4" x 10" (8.3 x 25.4 cm) vent system = 73 ft (22.2 m) total.

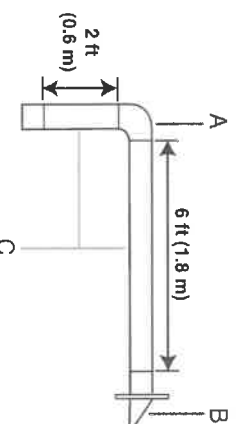

- A. One 3 1/4" x 10" (8.3 x 25.4 cm) 90° elbow = 25 ft (7.6 m)
- B. 1 wall cap = 40 ft (12.2 m)
- C. 2 ft (0.6 m) + 6 ft (1.8 m) straight = 8 ft (2.4 m)

Lot 144A
Oct 28/21

CALEDON CLUB

38-01 Magna

1 of 144A
0 of 18/21

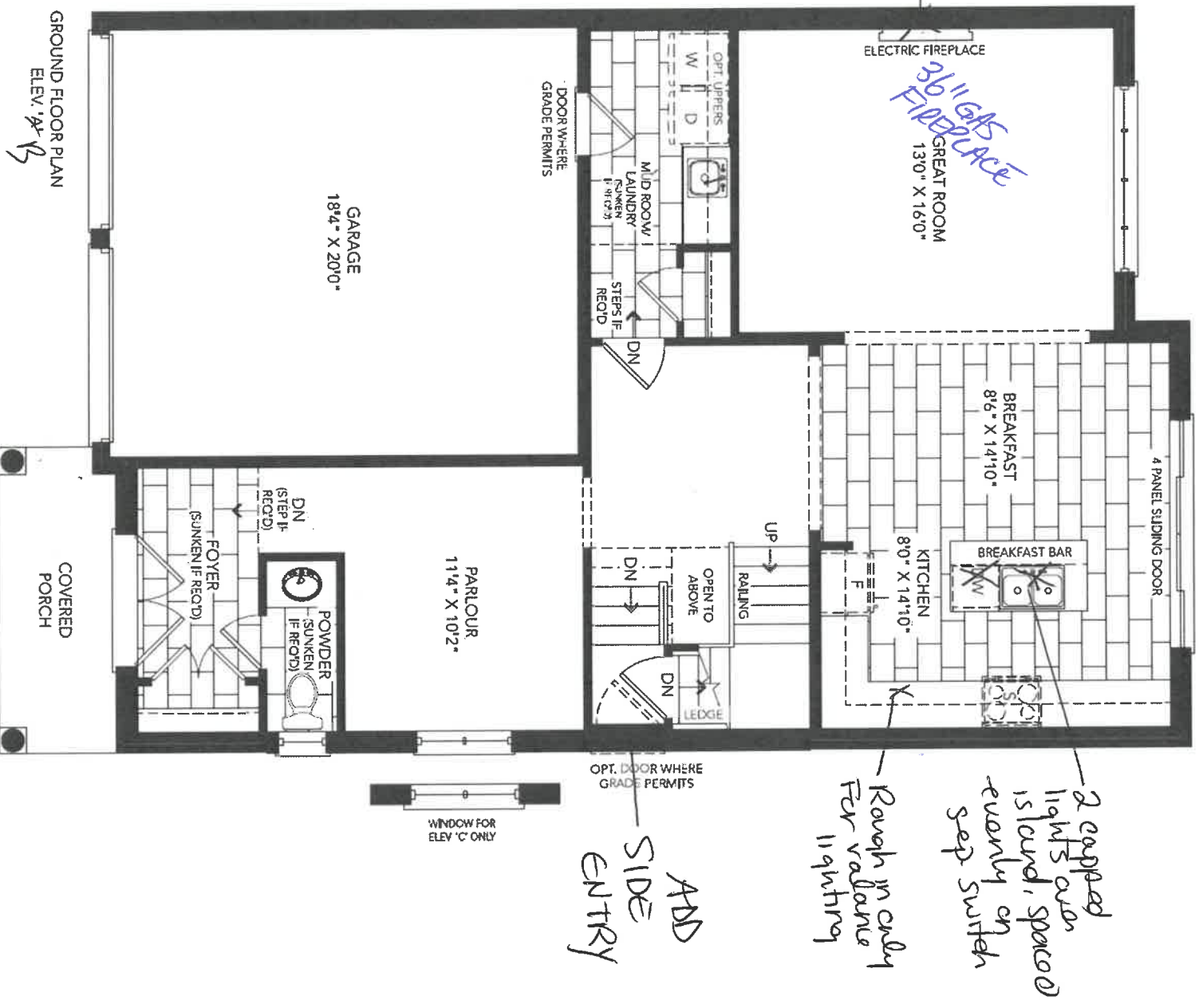

N-N

CALEDON CLUB

38-01 Magna

1 of 144A
06/18/21

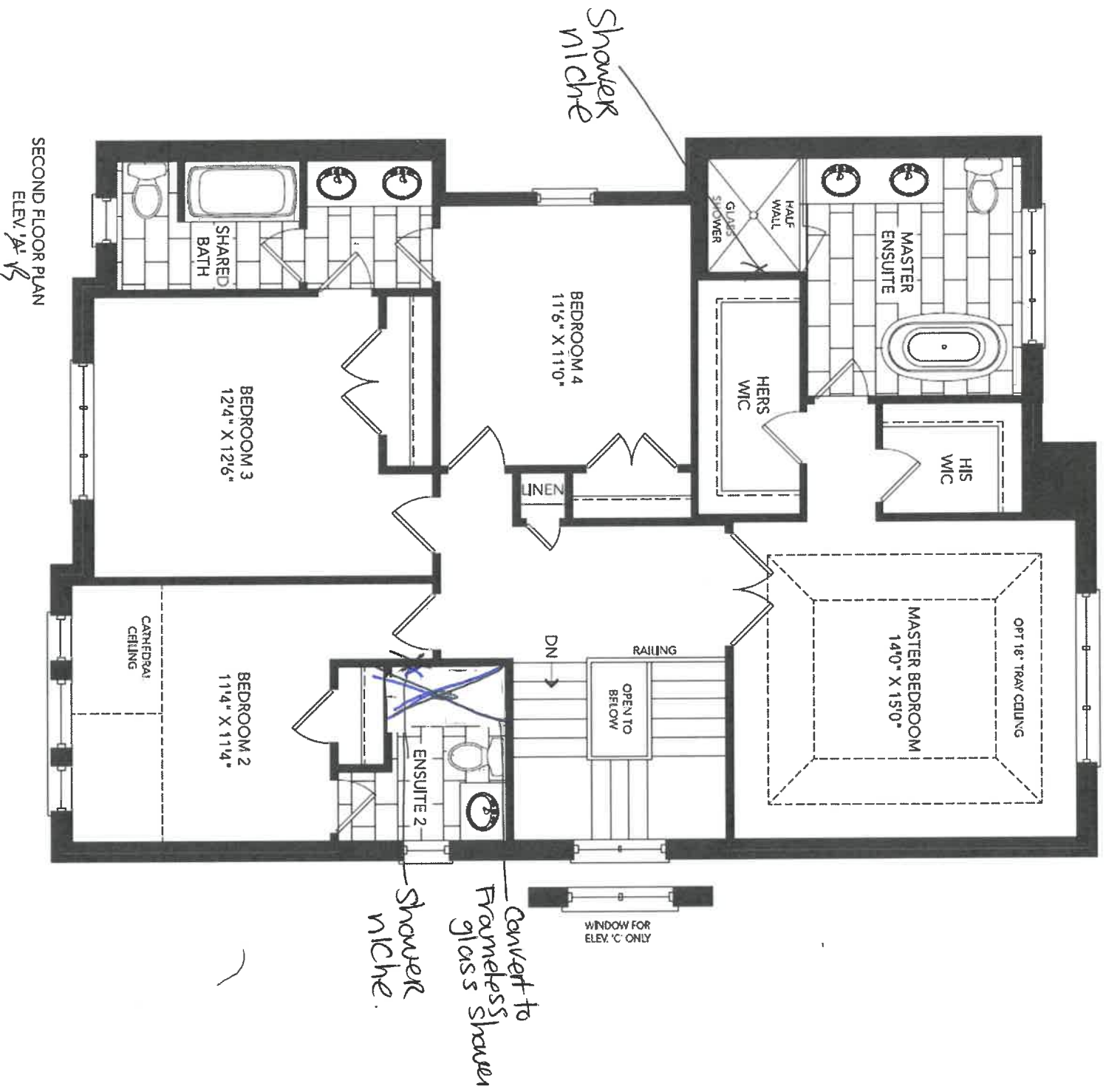

N.N

CALEDON CLUB

38-01 Magna

lot 144A
Oct 18/21

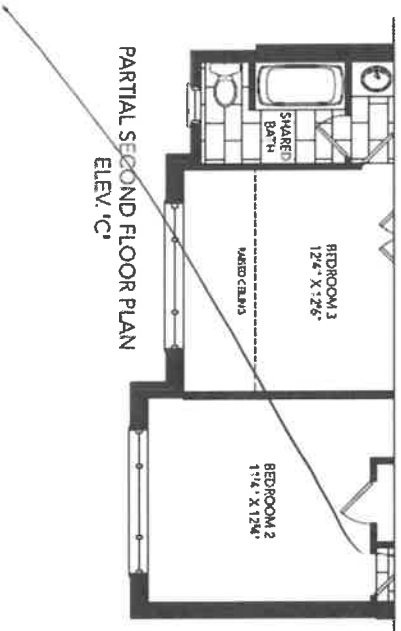
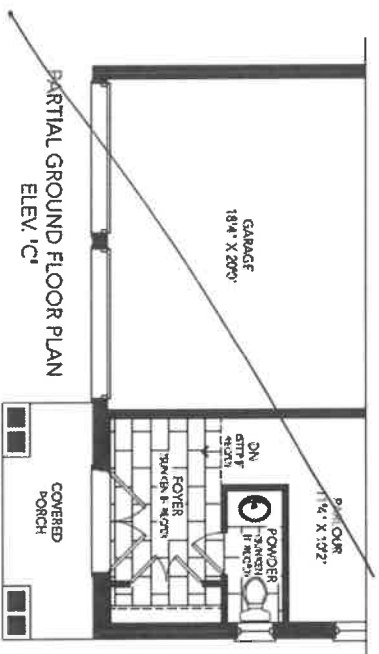
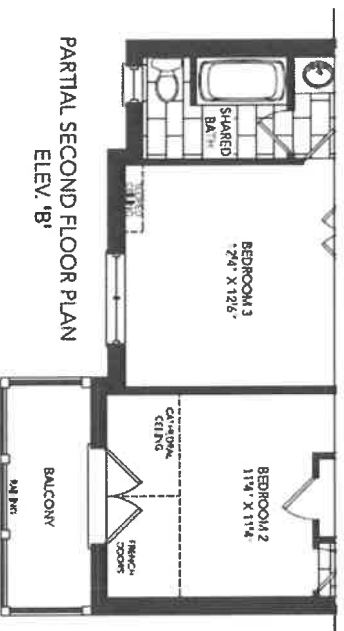
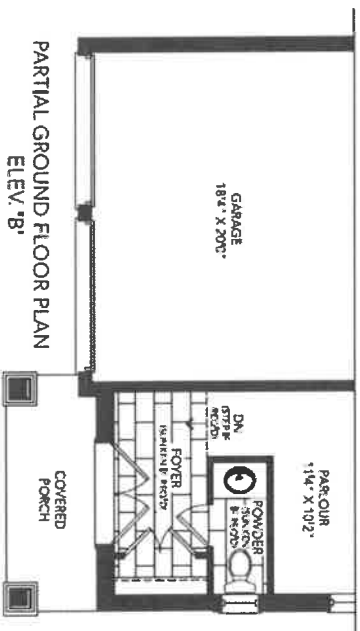

N.N

CALEDON CLUB

38-01 Magna

lot 144A
Oct 18/21

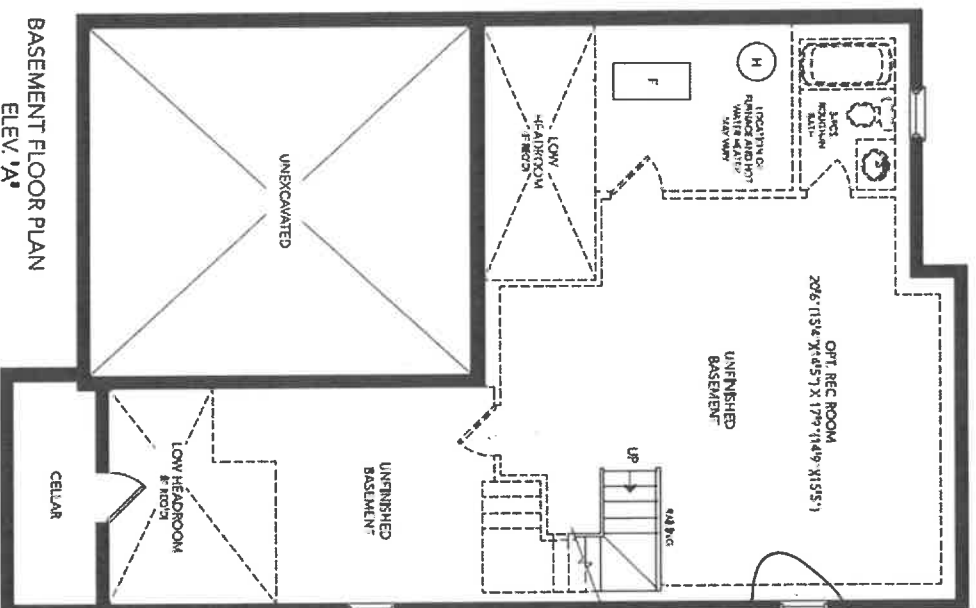

9th 1 larger
window
36" x 24"
approx if
possible

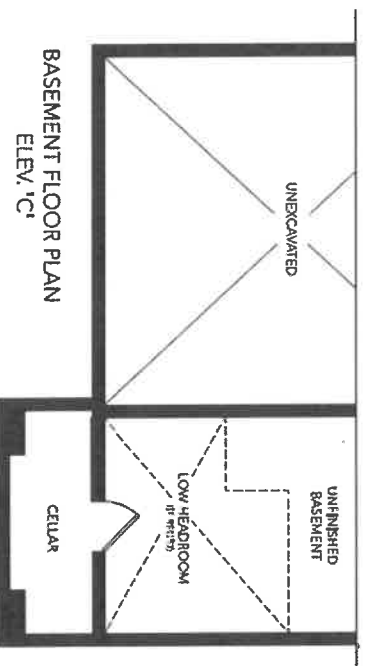
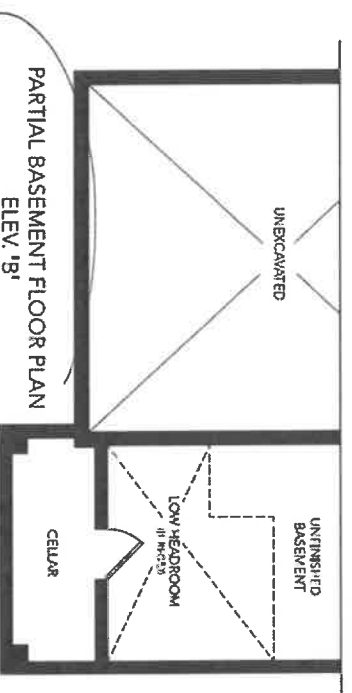

N.N

38-1-ELEV A,B,C
KITCHEN

- Soft Close Doors
- and Drawers
- Cutlery Divider

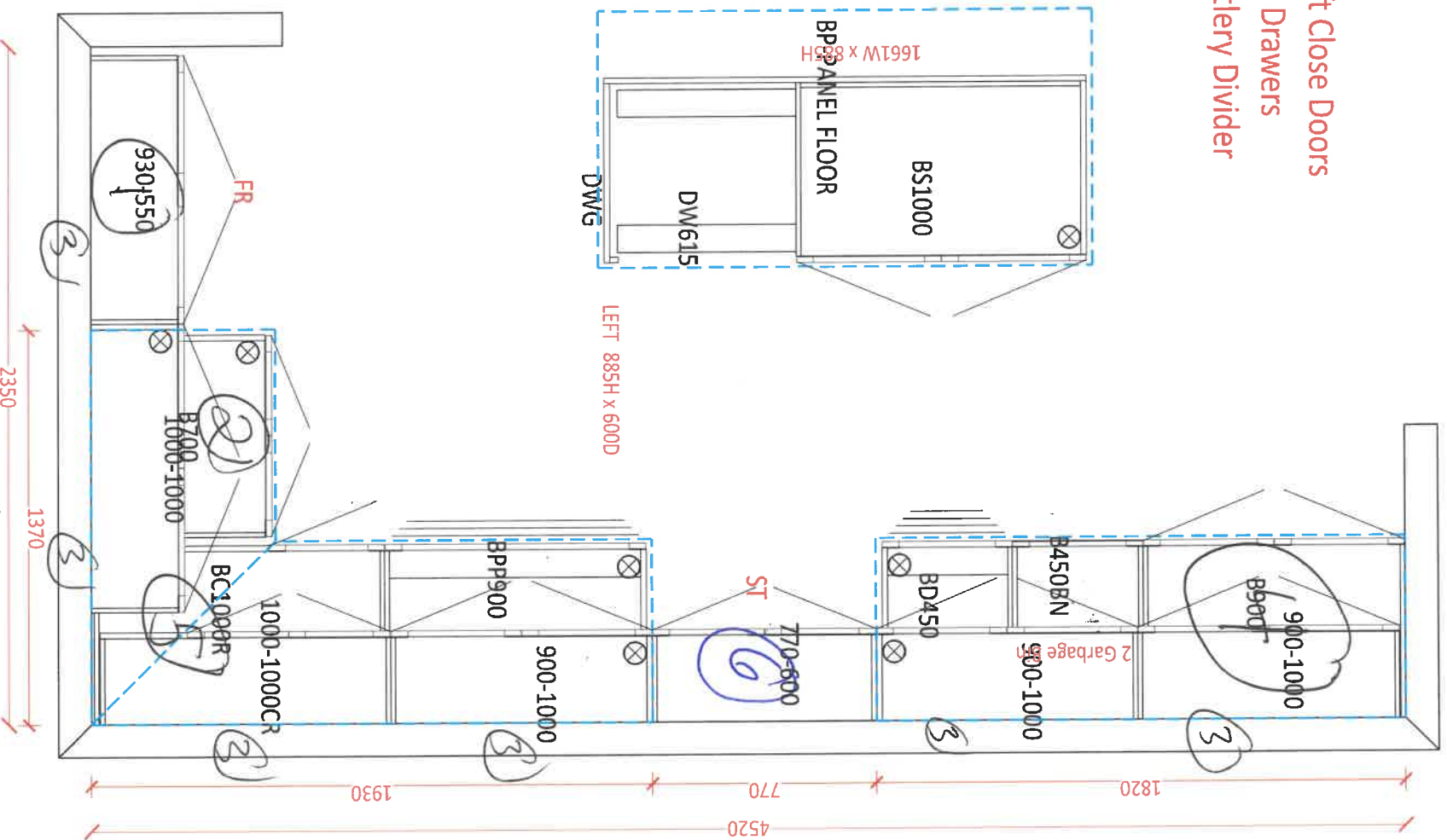

- ① Fridge enclosure - deep upper + gables
- ② Bank of drawers
- ③ Double Riser panel, installed over cabinets, at ceiling
- ④ Pantry - 60cm x approx 3' wide
- ⑤ upper pre cut
- ⑥ over the Range

N. N.

DATE SUBMITTED
12 Jul 2021

38-1-ELEV A,B,C
STD. VANITIES

POWDER - Comfort Height

ENSUITE 2 - Comfort Height

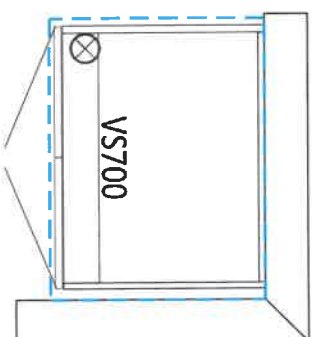
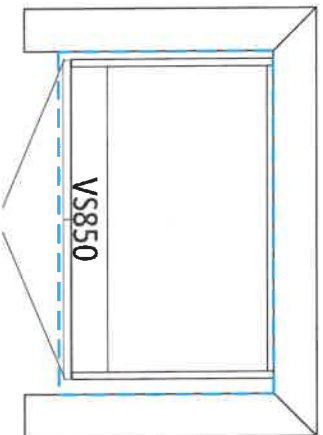

SHARED - Comfort Height

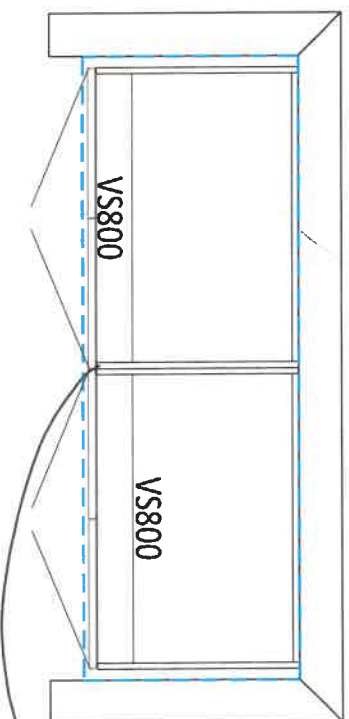

Back of
Drawers

MASTER ENSUITE - Comfort Height

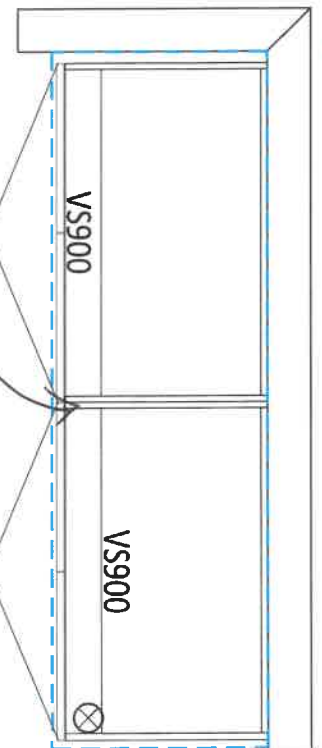

OPT. BASEMENT BATH

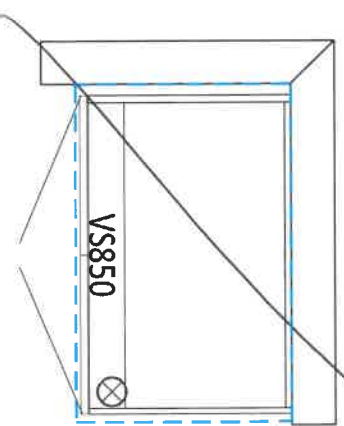

Back of
drawers
LAUNDRY ROOM

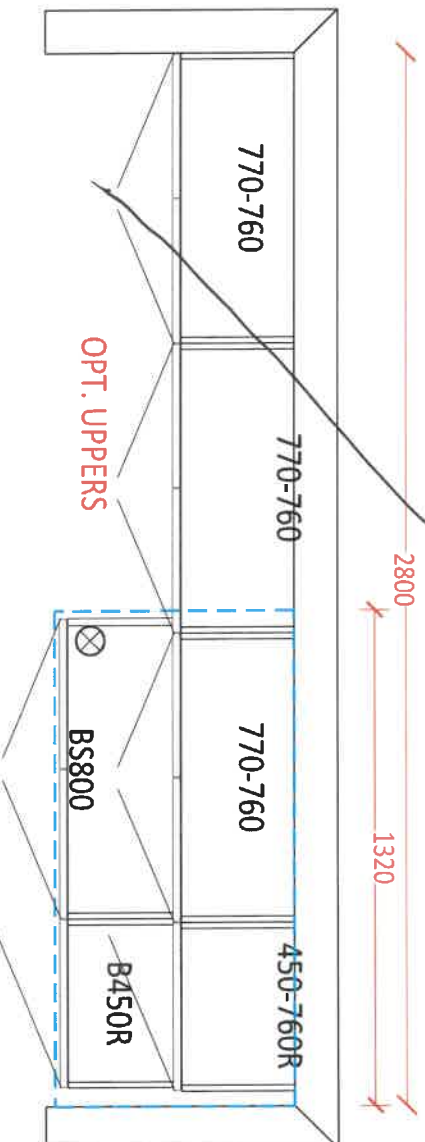

N.N



DATE SUBMITTED

12 Jul 2021

CLIENT N/ ZANCOR HOMES
SHIP TO : CALEDON CLUB

PH:
CELL :

DRAFTED BY: FERNANDA
COMMENT

P/O #

JOB NUMBER

INSTALL DATE:

PAGE

2 of 22

38-1-ELEV A,B,C
KITCHEN

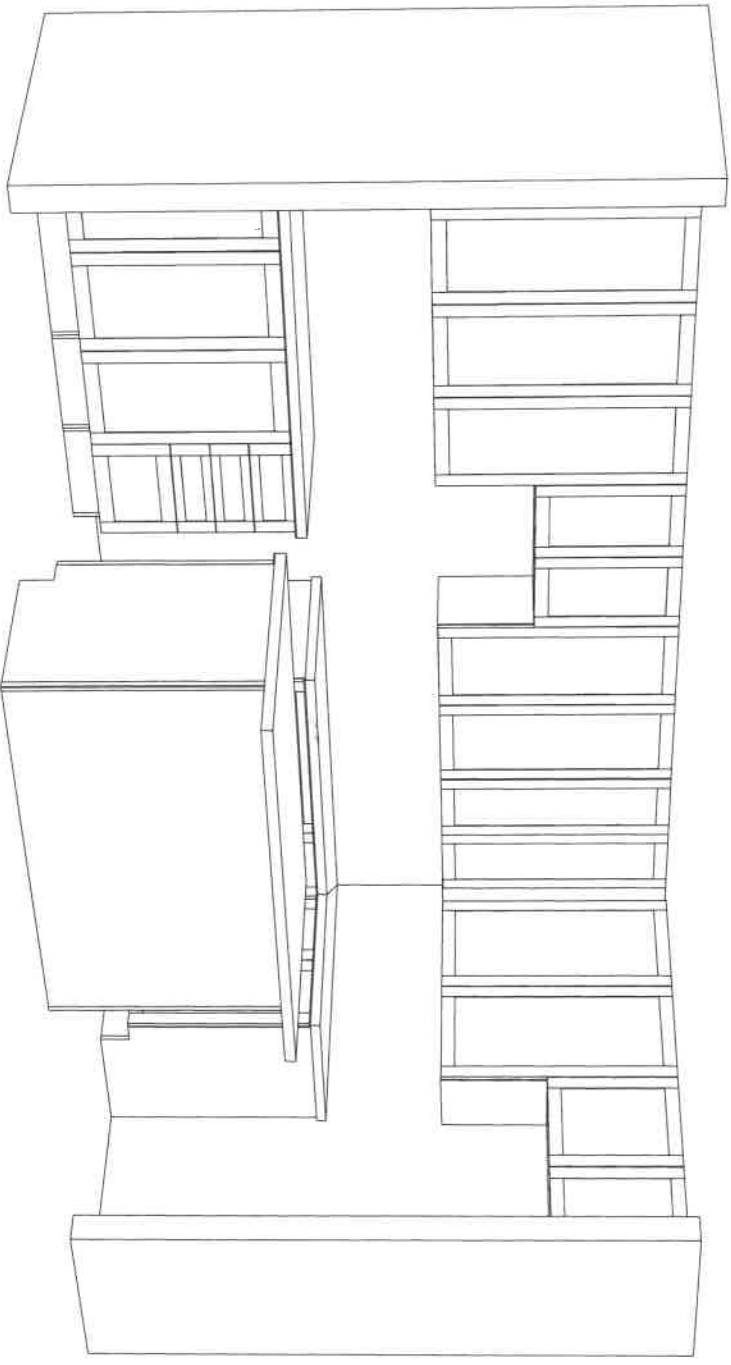

1 of 144 A
Oct 18/21

N.N

APPLIANCE ACKNOWLEDGEMENT

CONTACT: Steve Miller - Appliance Canada (905) 660-2424 / smiller@appliancecanada.com

- It is the Purchaser's responsibility to coordinate delivery, installation and hook up of appliances and to ensure they are installed as per Manufacturers specifications after closing.

STANDARD APPLIANCE OPENINGS provided by Zancor:

*Standard appliance openings are approximate and the minimum required. Sizes may vary due to onsite condition and/or when modifications have been made to the cabinetry.

- Fridge Opening 36" x 74"
- Stove Opening 30"
- Hood Fan Opening 30"
- Hood Fan & Vent 6" with Under Cabinet Hood
- Dishwasher Opening 24"

Accepts Standard
Openings **Initial

S.M.

OPTIONAL UPGRADED APPLIANCES to be provided by Homeowner:

- ****Specs/information sheets are required and it is the responsibility of the homeowner to provide this to Zancor Homes by the due date that has been provided. If appliance specs are not submitted, Zancor Homes will not be responsible for any necessary requirements and the standard opening will be built.**

S.M.

- Upgraded Appliance Specs are DUE 2 WEEKS FROM SIGNED DATE OF COLOUR CHART (if not received during appointment)

INITIAL

- ***Specs that require changes/modifications after this date will not be accepted***

- NOTE: Any upgraded appliances are to be paid by the Purchaser, directly to the appliances company.

- Additional charges to the Purchaser may apply for cabinetry, electrical and plumbing in order to accommodate the specs given by the homeowner.

FRIDGE UPGRADE

- ☐ Built-in
- ☐ Paneled **Panel to match required
- ☐ Integrated / Flush Inset
- ☒ Waterline

RANGE UPGRADE

*Larger hood fan CFM might be required, which need a larger vent

- ☐ 36" **Hood fan opening must be the same size or larger (8" vent might be required)
- ☐ 48" **Hood Fan opening must be the same size or larger (8" or 10" vent required)
- ☐ Gas Range **gas line and electrical required & sold separately
- ☐ Induction **electrical required & sold separately
- ☐ Cooktop (Apron Front) **Countertop Cut-out required & sold separately
- ☐ Cooktop (Drop-in) **countertop Cut-out required & sold separately

HOOD FAN & VENT
UPGRADE

- ☐ 8 Inch **Required for 600 CFM
- ☐ 10 Inch
- ☐ Chimney Hood Fan **Vent must be centred
- ☐ Insert / Liner

WALL OVEN/MICRO
UPGRADE

- ☐ Single Wall Oven **electrical required & sold separately
- ☐ Double Wall Oven **electrical required & sold separately
- ☐ Steam Oven **electrical required & sold separately
- ☒ Warming Drawer **electrical required & sold separately
- ☐ Over Then Range Microwave (OTR)
- ☐ Built-In Microwave **Trim Kit required **electrical required & sold separately

**Electrical required

DATE Oct 18/21

SITE CALEDON

LOT 144A

** Any upgrades checked in this appliance form must be accompanied with specs provided by the Purchaser.
**It is the responsibility of the trade to inform the Builder of any discrepancies with specs, sketches, extras and/or colour chart PRIOR to production/installation.

ZANCOR

221 North Rivermede Road, Concord, Ontario L4K 3N7 * T: (905) 738.7010 F: (905) 738.5948

221 North Rivermede Road, Concord, Ontario L4K 3N7 * T: (905) 738.7010 F: (905) 738.5948

Purchaser accepts and acknowledges that the Builder reserves the right to substitute materials with those of equal or better quality where the manufacture, scheduling or delivery of materials may directly impact the Builder's ability to meet its' contractual obligations under the Agreement of Purchase and Sale.

N.N

UPGRADES/EXTRAS: All upgrades and additional selections indicated on the colour chart must be accompanied by an upgrades/extras sheet (PES) and full payment otherwise the selection will be invalid. All colour charts and upgrades/extras will not proceed until verified and signed by an authorized signing officer at the Vendor's head office. **CHANGES WILL NOT BE PERMITTED UPON COMPLETION AND SUBMISSION OF THE COLOUR CHART.**

N.N

PORCELAIN & NATURAL STONES: Due to the properties of natural stones including but not limited to **marble, granite, quartz**, no two pieces are exactly the same. Variations in colour, tone, granularity (pitting, fissures) and pattern are to be expected, including various lighting may affect the overall finished look. Stone tops are sealed at time of installation and should never be cleaned with lemon oil or vinegar. Stones are porous materials, therefore any spilled substance require immediate attention. Stone countertops require regular seal re-application as part of home maintenance. Purchaser acknowledges colour and product variations as well as natural imperfections may exist with the selection of natural stone materials and shall not hold the Vendor liable for provision of same.

N.N

STONE COUNTERTOP JOINTS: Purchaser is aware that one joint will be at each corner and on either side of slide-in-range (if applicable). It will also be where the length of the counter top exceeds the length of a stone slab. Slabs are usually approximately 5'x 8'.

N.N

CERAMIC TILES: Due to manufacturing, shade (dye lots), product variations may exist that can affect the overall look of the finished product. Although every effort will be made to ensure the colours and materials selected are as close as possible to the samples, the purchaser acknowledges that the sample tiles supplied in the Design Centre may not be identical to the materials installed in the home.

N.N

STAIR STAINS: Due to the natural properties of wood, many variables can affect the overall look of the finished product. Factors including but not limited to wood type, knotting, graining, density, age, humidity, and air temperature can result in substantial variations in stain intensity. The purchaser accepts that although the Vendor will do their best to match stain the unfinished stairs as close as possible to the pre-finished floors, it is not possible to have an identical match and that there MAY be shade differences between the two products.

N.N

CABINETRY: Due to the natural properties of wood, slight variations apparent with cabinetry are to be expected. This includes but not limited to wood species, wood grain, colour, finish, product variations, and natural imperfections are all factors that may affect the overall look of the finished product. Such factors make exact colour matching impossible. The type and intensity of lighting in the areas of designated cabinetry placement may also highlight characteristics of cabinetry finish. All cabinets shall be finished with a white melamine interior box unless a finished interior is upgraded. Due to building specifications and/or on-site conditions, certain cabinetry upgrades may not be possible. The purchaser acknowledges that the Builder cannot guarantee the cabinetry finish or provision of certain upgrades and shall not hold the Builder liable for provision of same.

N.N

UPGRADES/EXTRAS: All upgrades and additional selections indicated on the colour chart must be accompanied by an upgrades/extras sheet (PES) and full payment otherwise the selection will be invalid. All colour charts and upgrades/extras will not proceed until verified and signed by an authorized signing officer at the Vendor's head office. **CHANGES WILL NOT BE PERMITTED UPON COMPLETION AND SUBMISSION OF THE COLOUR CHART.**

N.N

HARDWOOD / LAMINATE FLOORING: Due to the properties of wood and laminate, many variables can affect the overall look of the finished product. Variations include but not limited to wood type or laminate finish, colour/stain and wood grain are significant factors that make exact colour matching impossible. The purchaser acknowledges that the hardwood flooring is a pre-finished product in a controlled environment. Expansion, compression and cupping are characteristics of hardwood flooring once installed in the home. The purchaser acknowledges these may become apparent over time and despite the Builders' efforts to install the hardwood flooring materials in keeping with good workmanship, the Builder shall not be responsible nor held liable for minor variances of fluctuation in hardwood flooring materials.

N.N

HARDWOOD / LAMINATE WAIVER:

I/We understand hardwood flooring is classified as a porous material and as such not recommended by the Builder in certain areas. I/We understand there is a concern due to possible water and other substances being frequently splashed or spilled onto the floor and in contravention of Ontario Building Code Section 9.30.1.2(1).

"Finished flooring bathrooms, kitchens, public entrance halls, laundry & general storage areas shall consist of resilient flooring, felted-synthetic-fibre floor coverings, concrete, terrazzo, ceramic tile, mastic or other types of flooring providing similar degrees of water resistance.

I/We are prepared to assume full responsibility for any damage caused to the hardwood floor or subfloor due to moisture absorbency in the mentioned areas, and agree to waive any claims against the Township of residence, TARIION and/or the Builder in relation to the matter. ****SEE COLOUR CHART FOR LOCATIONS****

N.N

DATE 03/18/21

SITE CALEDON

LOT 144A

221 North Rivermede Road, Concord, Ontario L4K 3N7 * T: (905) 738.7010 F: (905) 738.5948

N.N

HOME AUTOMATION (Cable, CAT5/6, Telephone)

INCLUDED IN SCHEDULE "A" IN AGREEMENT OF PURCHASE AND SALE:

- Rough-in for Central Vacuum system piped to garage
- Rough-in for Telephone (2) locations
- Rough-in for Cable TV (2) locations
- Rough-in for Cat-6 Network (3) locations

OPTION 1:

I/we the Homeowner(s) have chosen to contact the Home Automation Company to select the locations of the rough-ins for Cable, CAT5, Telephone as included in our Agreement of Purchase Sale.

I/we the Homeowner(s) will contact the trade within 4 weeks of the date of this release to select locations of the standard rough-ins review other optional products for purchase.

Trade: Artistic Smart Homes
Phone: (905) 850-9386
Location: 8601 Jane Street
 Concord, Ont L4K 5N9

Should the homeowner not make these selections within the sufficient time provided, the rough-ins as mentioned above will be installed in locations at the Vendor's discretion.

N.S.
 Homeowner(s) Initial

OPTION 2:

I/we the Homeowner(s) acknowledge that if we do not contact the home automation company, I/we the Homeowner(s) have agreed to the Vendor locations for the standard rough-ins for Cable, CAT6, Telephone that are included in the Agreement of Purchase and Sale.

Homeowner(s) Initial

Oct 18/21
 DATE

CALEDON
 SITE

144A
 LOT

BRICK/JOINT PATTERN INSTALLATION
RELEASE FORM

FLOOR TILES *Brick installation is standard*

WALL TILES *Brick installation requires an additional charge and must be included on the extras if selected*

(Large tiles installation for floor and wall) – ½ Brick

Please be advised it has come to our attention, that due to production, many of the over-sized and odd shaped, man-made tiles (i.e. porcelain & ceramic), have been found to have a slight bow in the tile. It is a standard occurrence with all suppliers and manufacturers.

It is therefore recommended, that if and when a purchaser requests to install one of these tiles in a brick-joint pattern, that it be installed on a ½ brick pattern, to try to avoidlippage. Attached with this letter, you will find a layout of the ½ brick installation that has been recommended.

LOCATIONS:

page, laundry, Pande, Kitchen, Backlot, Master, Shaver
twi, Medium

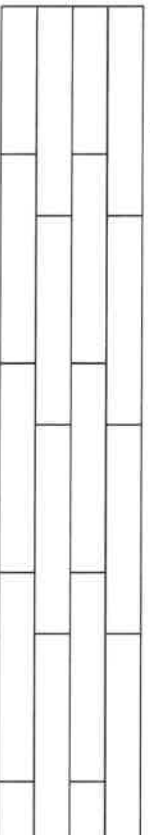

Please understand, even in using this ½ brick installation, there may still be minimal lippage which cannot fully be eliminated.

Hence, when there is a request for brick-joint installation, Zancor Homes and their contractor, cannot be held responsible for this matter.

N. N

Homeowner(s) Initial

(Small tile installation for walls) – ½ Brick

Purchaser requests to install small wall tiles on a backsplash or shower wall in a brick-joint pattern, that it be installed on a ½ brick pattern.

LOCATIONS:

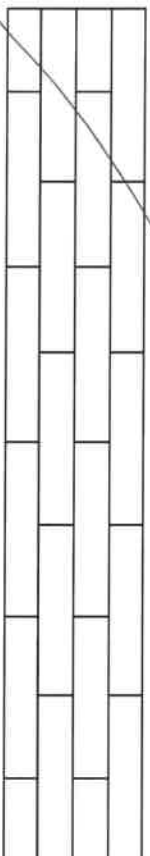

Homeowner(s) Initial

DATE

SITE

LOT

CALEDON

144A

Stone Countertop Edge Profiles

Where applicable as per site specifications

STANDARD EDGE FOR KITCHEN & VANITIES

Standard Countertop Edge in
Kitchen

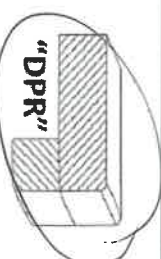

Standard Countertop Edge in
Vanity

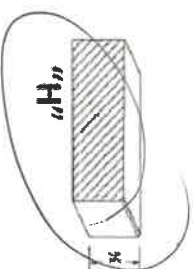

Homeowner(s) Initial N-N

OPTION (1) EDGE FOR KITCHEN & VANITIES \$250

Optional Edge in Kitchen

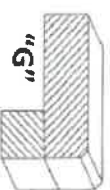
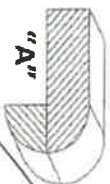
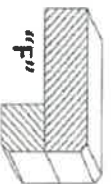
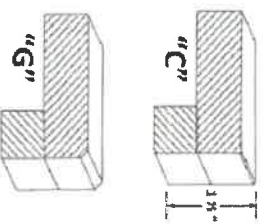

Optional Edge in Bathroom

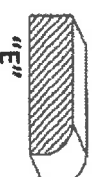
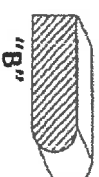
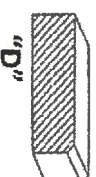

Homeowner(s) Initial _____

OPTION (2) EDGE FOR KITCHEN & VANITIES CUSTOM PRICING

Optional Edge for Kitchen

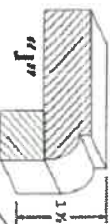
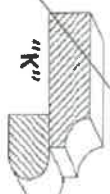
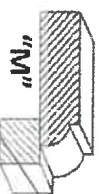
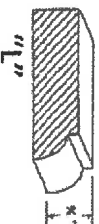

Optional Edge in Vanity

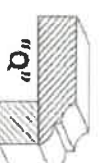
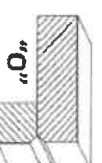
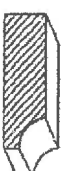

Homeowner(s) Initial _____

DATE

Oct 18/21

SITE

CALEDON

LOT

144A