

CONSTRUCTION SUMMARY OF EXTRAS
Printed 2022-08-04 / 3:44 PM / Page 1 of 2

Site: CALEDON (B)
Lot: 80B
Model: GRANDVIEW/ (38-04) A
Purchaser: KAMALJEET SINGH SANGHERA
Purchaser: MANPREET KAUR POONI
Phone: 514-298-4702 514 808-5704
Email: MANPREETPOONI1@HOTMAIL.COM
kamalsanghera@hotmail.com



DESCRIPTION		DATE SELECTED
BONUS PACKAGE: 3 PIECE STAINLESS STEEL APPLIANCES WITH WHITE WASHER & DRYER	INCLUDED IN APS	
BONUS PACKAGE: STAINLESS STEEL HOOD FAN	INCLUDED IN APS	
BONUS PACKAGE: AIR CONDITIONER	AS PER SCH E	
STRUCTURALS		
1 SIDE DOOR FROM EXTERIOR TO STAIR LANDING, GRADE PERMITTING IF POSSIBLE		08-Jan-22
ADDITIONAL STRUCTURALS		
1 N/A		
2 CONVERT 5 FT BATHTUB INTO FRAMELESS GLASS SHOWER ENCLOSURE WITH STANDARD 2 X 2 TILES ON THE FLOOR STANDARD WALL TILES, STANDARD MARBLE JAMB & LED SHOWER POTLIGHT IN LIEU OF TUB IN SHARED BATH AND ENSUITE BATH		28-Jun-22
COLOURS		
1 (4) LED POTLIGHTS IN FAMILY ROOM ON SEPARATE DIMMER SWITCH STANDARD LIGHT TO REMAIN		04-Aug-22
2 (3) LED POTLIGHTS IN KITCHEN ON SEPARATE DIMMER SWITCH		04-Aug-22
3 SHIFT STANDARD LIGHT IN KITCHEN TO BE INSTALLED ABOVE KITCHEN ISLAND		04-Aug-22
4 (1) CARPED LIGHT ON SEPARATE SWITCH IN LIVING ROOM		04-Aug-22
5 PLUG ABOVE FIREPLACE INSTALL APPROX 65" FROM FLOOR		04-Aug-22
6 HARDWOOD UP # 1 FAMILY ROOM, MAIN HALL, DINING/LIVING ROOM UPPER HALLWAY		04-Aug-22
7 KITCHEN BREAKFAST FLOOR TILES UP # 6		04-Aug-22
8 UPGRADE CABINET HARDWARE		04-Aug-22
9 KITCHEN FRIDGE ENCLOSURE		04-Aug-22
10 30" WIDE PANTRY 24 " DEEP WITH ADJUSTABLE SHELVES IN LIEU OF UPPER AND LOWER CABINETS		04-Aug-22
11 MICROWAVE SHELF		04-Aug-22
12 ELECTRICAL 15 AMP ON SEPARATE CIRCUIT FOR MICROWAVE (SEE SPECS)		04-Aug-22
13 KITCHEN /ISLAND CABINETS UP # 1		04-Aug-22
14 KITCHEN/ISLAND COUNTER TOP UP # 4 QUARTZ		04-Aug-22
15 KITCHEN BACKSPLASH UP # 2 INCLUDES BEHIND CHIMNEY HOOD		04-Aug-22
16 MASTER ENSUITE UP # 1 VANITY		04-Aug-22
17 MASTER ENSUITE UP # 2 SHOWER FLOOR TILE		04-Aug-22
18 N/A		04-Aug-22
19 ENSUITE # 2 SHOWER FLOOR TILES UP # 2		04-Aug-22
20 SHARED BATH SHOWER FLOOR TILES UP # 1		04-Aug-22
21 COMFORT HEIGHT VANITIES POWDER ROOM , MASTER ENSUITE, ENSUITE # 2, SHARED		04-Aug-22
22		04-Aug-22
23 KITCHEN DELETE UPPER ABOVE STOVE AND ALLOW FOR FREE STANDING CHIMNEY HOOD(SEE SPECS)		04-Aug-22
24 KITCHEN SINK PRECIS U 1 3/4 LOW DIVIDE IN COLOR TRUFFLE #402069		04-Aug-22
25 KITCHEN FAUCET MOEN,SLEEK SINGLE HANDLE PULLDOWN FAUCET WITH HANDLE ON DECK IN MATT BLACK		04-Aug-22
26 KITCHEN TRANSITIONAL SOAP DISPENSER MODE # 3942 IN MATT BLACK INSTALL TO THE RIGHT OF THE KITCHEN FAUCET		04-Aug-22
27 BATHROOM ACCESSORIES POWDER ROOM (1) 9" TOWEL BAR MODEL YB2486 AND PAPER HOLDER YB2408		04-Aug-22
28 BATHROOM ACCESSORIES (3) 24" TOWEL BAR MODEL YB2424 AND (3) PAPER HOLDER YB2408 MASTER ENSUITE, SHARED BATH, ENSUITE # 2		04-Aug-22

CONSTRUCTION SUMMARY OF EXTRAS

Printed 2022-08-04 / 3:44 PM / Page 2 of 2

Site: CALEDON (B)

Lot: 80B

Model: GRANDVIEW (38-04) A

Purchaser: KAMALLEET SINGH SANGHERA

Purchaser: MANPREET KAUR POONI

Phone: 514-298-4702 514 808-5704

Email: MANPREETPOONI1@HOTMAIL.COM

kamalsanghera@hotmail.com



	DESCRIPTION	DATE SELECTED
29	N/A	04-Aug-22
30	N/A	04-Aug-22
31	N/A	04-Aug-22
32	N/A	04-Aug-22
33	N/A	04-Aug-22
34	N/A	04-Aug-22
35	N/A	04-Aug-22
36	N/A	04-Aug-22
37	HARDWOOD UP # 1 MASTER BEDROOM, BED 2,3,4 IN LIEU OF STANDARD CARPET	04-Aug-22
38	WATERLINE TO FRIDGE	04-Aug-22
39	N/A	04-Aug-22
40	SHAKER CROWN MOULDING ABOVE UPPER CABINETS IN KITCHEN AND ACROSS CHIMNEY HOOD FAN, INCLUDES HORIZONTAL PANEL ABOVE CHIMNEY HOOD,	04-Aug-22
41	N/A	

ZANCOR HOMES COLOUR CHART

PRINTED 2022-05-13, 2:17 PM

ENTRANCES		KITCHEN	
Main Foyer - FLOORING	LOFT IVORY 12 X 24 INSTALL STACKED		
Mudroom - FLOORING	LOFT ASH 12 X 24 INSTALL STACKED		
Side Hall - FLOORING	NA		
Basement Foyer - FLOORING	NA		
Kitchen - FLOORING	ROMA STATUARIO RECTIFIED 24 X 24 UP # 6		
Breakfast - FLOORING	ROMA STATUARIO RECTIFIED 24 X 24 UP # 6		
Kitchen - CABINETS	SIERRA MAPLE GREEN TEA UP # 1		
Island - CABINETS	SIERRA MAPLE GREEN TEA UP # 1		
Servery - CABINETS	NA		
Kitchen - HANDLES/KNOBS	H 800MB		
Kitchen - COUNTERTOP	BORGHINI DORO QUARTZ UP # 4		
Island - COUNTERTOP	BORGHINI DORO QUARTZ UP # 4		
Kitchen - BACKSPLASH	C & D DIAMOND DECRO TENDER GREY BRIGHT 4 X 16 INSTALL STACKED UP # 2		
Kitchen - SINK	PRECIS SILGRANITE U 1 3/4 LOW DIVIDE TRUFFLE		
Kitchen - FAUCET	SLEEK SINGLE HANDLE PULL FAUCET 7871 BLACK MATT		
GREAT ROOM / DINING / LIVING / DEN / OFFICE / BASEMENT			
Family / Great Room - FLOORING	MIRAGE RIO RED OAK ADMIRATION CASHMERE 3 5/16" UP # 1		
Main Hall - FLOORING	MIRAGE RIO RED OAK ADMIRATION CASHMERE 3 5/16" UP # 1		
Dining / Living Room - FLOORING	MIRAGE RIO RED OAK ADMIRATION CASHMERE 3 5/16" UP # 1		
Library / Den - FLOORING	MIRAGE RIO RED OAK ADMIRATION CASHMERE 3 5/16" UP # 1		
Basement Rec Room - FLOORING	NA		
STAIRS			
Railing Details - PICKETS	METAL BLACK SINGLE COLLAR WITH ALT PLAIN		
Railing Details - POSTS	2 3/4" TURNED OAK POSTS		
Railing Details - HANDRAIL	2 1/2" OVAL OAK HANDRAIL		
Stair Stain - MAIN STAIRS	STAIN OAK STAIR TO MATCH HARDWOOD AS CLOSE AS POSSIBLE		
Stair Stain - BASEMENT STAIRS (If applicable)	NA		
Stair Stain - SERVICE STAIRS (If applicable)	NA		
POWDER ROOM			
Powder Room - FLOORING	LOFT ASH 12 X 24 INSTALL STACKED		
Powder Room - CABINETS	SIERRA PVC WHITE COMFORT HEIGHT H 800-MB		
Powder Room - COUNTERTOP	BIANCA CARRERA		
Powder Room - SINK	STANDARD		
Powder Room - FAUCET	STANDARD		
2ND FLOOR			
Upper Hall - FLOORING	MIRAGE RIO RED OAK ADMIRATION CASHMERE 3 5/16" UP # 1		
Master Bedroom - FLOORING	MIRAGE RIO RED OAK ADMIRATION CASHMERE 3 5/16" UP # 1		
Bedroom 2	MIRAGE RIO RED OAK ADMIRATION CASHMERE 3 5/16" UP # 1		
Bedroom 3 - FLOORING	MIRAGE RIO RED OAK ADMIRATION CASHMERE 3 5/16" UP # 1		
Bedroom 4 - FLOORING	MIRAGE RIO RED OAK ADMIRATION CASHMERE 3 5/16" UP # 1		
Bedroom 5 - FLOORING	MIRAGE RIO RED OAK ADMIRATION CASHMERE 3 5/16" UP # 1		
NA			
Master Ensuite - FLOORING			
Master Ensuite - SHOWER WALL			
Master Ensuite - SHOWER FLOOR			
Master Ensuite - SHOWER JAMB			
Master Ensuite - CABINETS			
Master Ensuite - HANDLES/KNOBS			
Master Ensuite - COUNTERTOP			
Master Ensuite - SINK(s)			
STANDARD OVAL		BIANCA CARRERA	
Master Ensuite - FAUCET(s)		STANDARD	
SIGNATURES			
CALEDON 80B		MP	
1CJ			
PURCHASER INITIALS		VENDOR APPROVAL	

Any upgrades in the colour chart must be accompanied with a PES. It is the responsibility of all Trades to inform the builder of any discrepancies on sketches, PES and/or colour charts PRIOR to installation.

PAGE 1 OF 2

June 28/22

ZANCOR HOMES COLOUR CHART

PRINTED 2022-05-13, 2:17 PM

2ND FLOOR CONTINUED...

Main Bath - FLOORING			
Main Bath - TUB / SHOWER WALL		NA	
Main Bath - SHOWER FLOOR		NA	
Main Bath - SHOWER JAMB		NA	
Main Bath - CABINETS		NA	
Main Bath - HANDLES/KNOBS		NA	
Main Bath - COUNTERTOP		NA	
Main Bath - SINK(s)		NA	
		Main Bath - FAUCET(s)	
Shared Bath- FLOORING			
Shared Bath- TUB / SHOWER WALL		LOFT ASH 12 X 24 INSTALL STACKED	
Shared Bath- SHOWER FLOOR		LOFT ASH 12 X 24 INSTALL HORIZONTAL STACKED	
Shared Bath- SHOWER JAMB		ONTARIO SERIES DARK GREY GLOSSY 2 X 2 UP # 1	
Shared Bath- CABINETS		BIANCA CARRERA	
Shared Bath- HANDLES/KNOBS		SIERRA PVC WHITE COMFORT HEIGHT	
Shared Bath- COUNTERTOP		H 500-P	
Shared Bath- SINK(s)		COTE D AZUR 1886K-07	
		Shared Bath - FAUCET(s)	STANDARD
Ensuite Bath - FLOORING			
Ensuite Bath - TUB / SHOWER WALL		GENESSIS DARK GREY 12 X 24 INSTALL STACKED	
Ensuite Bath - SHOWER FLOOR		GENESSIS DARK GREY 12 X 24 INSTALL STACKED	
Ensuite Bath - SHOWER JAMB		MARBLE ICEBERG 2 X 2 MARBLE UP # 2	Noticed A/
Ensuite Bath - CABINETS		BIANCA CARRERA	
Ensuite Bath - HANDLES/KNOBS		SHAKER V PVC TUXEDO COMFORT HEIGHT	
Ensuite Bath - COUNTERTOP		H 500-P	
Ensuite Bath - SINK(s)		PORTICO MARBLE 7735-58	
		STANDARD	Ensuite Bath - FAUCET(s)
		LAUNDRY	STANDARD

Laundry - FLOORING			
Laundry - CABINETS		LOFT DOVE 12 X 24 INSTALL STACKED	
Laundry - COUNTERTOP		EURO OLMO CARISMA	
Laundry - BACKSPLASH		BASALT SLATE 3690-58	
		NA	
		TRIM / PAINT	

Casing/Baseboards			
Interior Doors		STANDARD	
Interior Door Hardware		STANDARD	
PAINT - Throughout		STANDARD	
		WARM GREY	

Location / Insert / Mantle			
		FIREPLACE	
		STANDARD ELECTRIC	
Mirrors			
		ACCESSORIES	
		STANDARD	
		BATH ACCESSORIES	
		UPGRADE	

GAS LINE TO BBQ		STANDARD	
GAS LINE & ELECTRICAL TO STOVE		DECLINED	ELECTRICAL for Built-in Oven
GAS LINE & ELECTRICAL TO DRYER		DECLINED	ELECTRICAL for Built-in Micro
HOOD FAN VENT SIZE		6" STANDARD	ELECTRICAL for Cooktop
WATERLINE to Fridge		UPGRADE	ELECTRICAL for Bar Fridge

DISCLAIMER

Any changes to the colour chart after signing are subject to a \$5000 administration fee plus costs			INITIALS
Purchaser has checked and acknowledged accuracy of colour and selections before signing.			ES NP
			ES NP
			ES NP

Colours of all materials are as close as possible to Builders selection but not necessarily identical due to dye lot variances in manufacturing/manufacturers. Due to construction progress some items may have been pre-selected or installed. In this event the Vendor's selection must be accepted by the purchaser

SITE / LOT:	CALEDON (B)	80B
PURCHASER(S):	KAMALLEET SINGH SANGHERA	
PURCHASER(S):	MANPREET KAUR POONI	
CONTACT:	514-298-4702 514 508 5704	MANPREETPOONI@HOTMAIL.COM

FOR TRADE USE

Any upgrades in the colour chart must be accompanied with a PES. It is the responsibility of all Trades to inform the builder of any discrepancies on sketches, PES and/or colour charts PRIOR to installation.

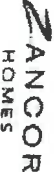

PURCHASER SIGNATURE	PURCHASER SIGNATURE	PURCHASER SIGNATURE
DÉCOR CONSULTANT	DÉCOR CONSULTANT	DÉCOR CONSULTANT
Vendor APPROVAL	Vendor APPROVAL	Vendor APPROVAL

Lot 803

June 8/22

CALEDON CLUB

38-04 Grandview

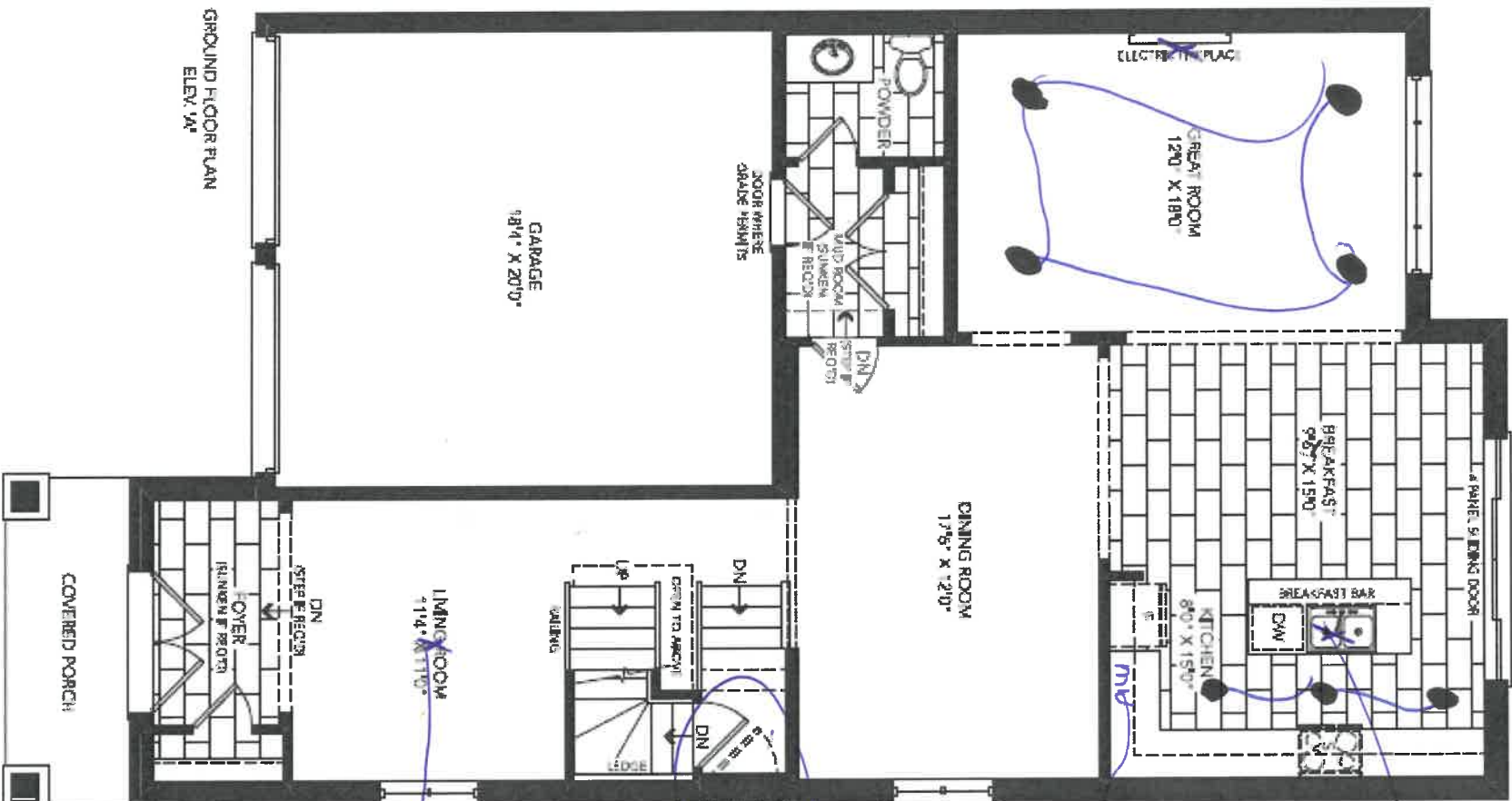

GROUND FLOOR PLAN
ELEV. 1A'

CLAR

803

CALEDON CLUB

38-04 Grandview

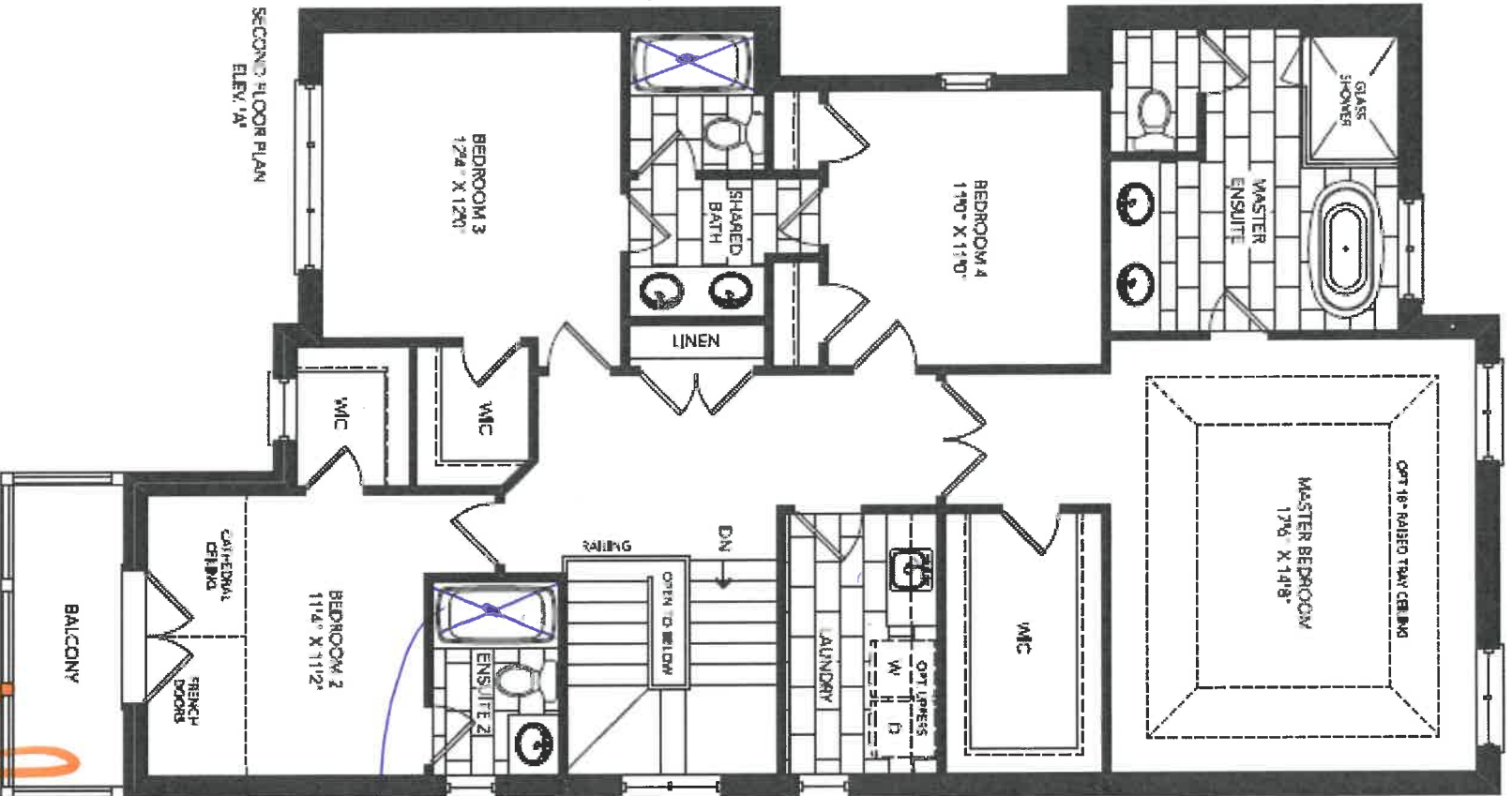

Franchise
Snow
no →
143

Frameless
Shower
No Tub



20

CLIENT NAME: ZANCOR HOMES
SHIP TO: CALEDON CLUB

PH:
CELL:

DRAFTED BY: FERNANDA
COMMENT

12 Jul 2021

P/O#	
------	--

JOB NUMBER

INSTALL DATE:

PAGE

10 of 22

38-4-ELEV A,B,C
KITCHEN

- Soft Close Doors
- and Drawers
- Cutlery Divider

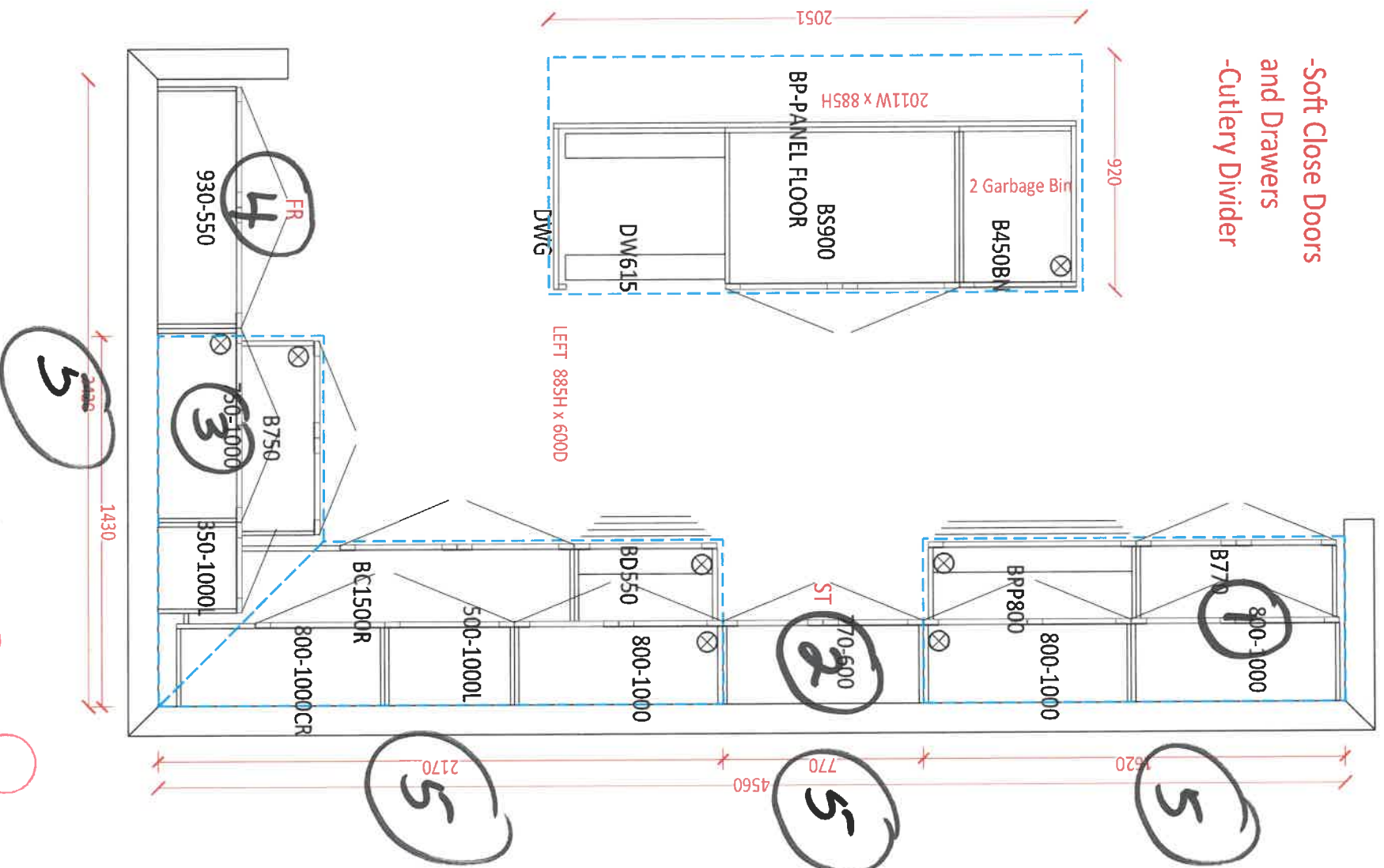

June 8/22

Chlor

CLIENT NAME: ZANCOR HOMES
SHIP TO : CALEDON CLUB

PH:
CELL:

DATE SUBMITTED
12 Jul 2021

DRAFTED BY: FERNANDA
COMMENT

P/O #

JOB NUMBER

INSTALL DATE:

PAGE

11 of 22

38-4-ELEV A,B,C
KITCHEN

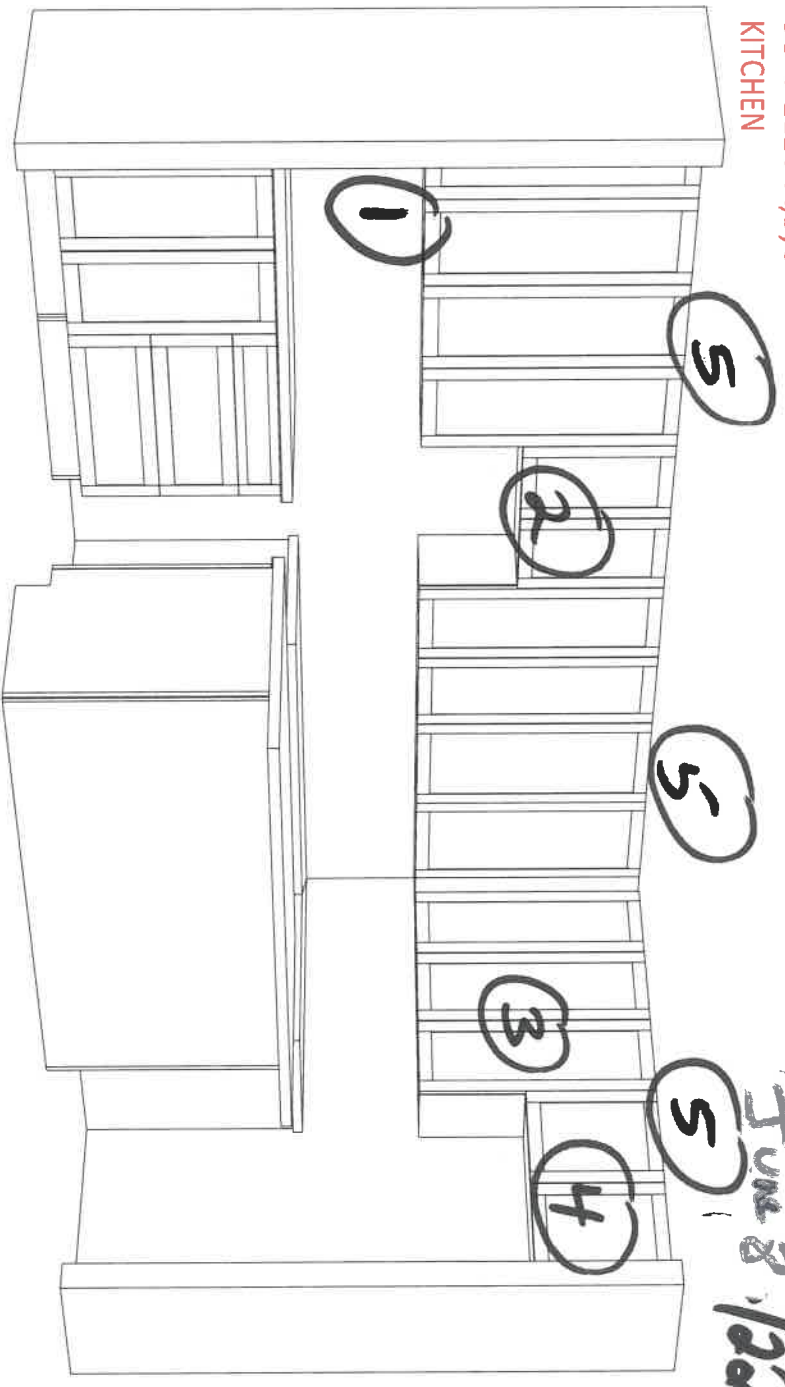

- ① 30" wide 24" deep Pantry with 10 shelves
- ② leave space chimney hood
- ③ microwave shelf
- ④ fridge enclosure
- ⑤ sharp crown moulding above all uppers
Includes across chimney hood
+ horizontal panel above chimney hood



CEHL

8013

5kook

Single Handle Pulldown
Bar/Prep Faucet
7664
Chrome \$797.36
Other \$986.29
Black Stainless \$1,069.58
Single hole installation only



Single Handle Kitchen
Faucet with Side Spray
7870
Chrome \$579.89
Other \$749.99
Deckplate included
Not available in BLS & ORB



Single Handle Pulldown
Kitchen Faucet
7864
Chrome \$678.98
Other \$877.43
Black Stainless \$965.12
Deckplate included



Single Handle Pulldown Kitchen
Faucet with Handle in Deck
7871
Chrome \$666.90
Other \$862.45
Not available in BLS & ORB
Single hole installation only



Single Handle Pulldown
Pre-Rinse Kitchen Faucet
5925
Chrome \$794.41
Other \$1,026.54
Black Stainless \$1,129.21
Not available in ORB
Deckplate included



FINISH OPTIONS

Chrome (C), Matte Black (BLS), Spot Resist™ Stainless (SRSL), Black Stainless (BLS), Oil Rubbed Bronze (ORB)

To order, combine the model number with one of these finish letters: Matte Black (BL), Spot Resist™ Stainless (SRSL), Black Stainless (BLS) & Oil Rubbed Bronze (ORB).
To order Chrome (C) models, use model number only.
For Chrome MotionSense, order 7864EWC

Lot 808
JUN 8/23

Soap Dispensers



SOAP DISPENSER

Must be Black.

**Transitional Soap or
Lotion Dispenser**

3942

Chrome	\$243.59
Other	\$278.55

Not available in BLS, BG, NL & ORB
Use model number only for C

**Transitional Soap or
Lotion Dispenser**

3944

Chrome	\$243.59
Other	\$278.55

Not available in BLS, BG & NL
Use model number only for C

*Install to Right of
Faucet*



**Traditional Soap or
Lotion Dispenser**

S3945	
Chrome	\$325.87
Other	\$392.36

Not available in BLS



**Paterson Soap or
Lotion Dispenser**

S3955	
Chrome	\$325.87
Other	\$392.36

Not available in BLS, BG, NL & ORB



**Transitional Soap or
Lotion Dispenser**

S3948	
Chrome	\$325.87
Other	\$392.36

Not available in BLS, BG & NL

2018013

June 8/22

Lot 808

June 8/22 **Method™**

Traditional | Transitional | Modern

\$125 per bathroom for (2) items

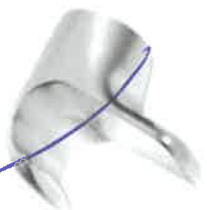

Double Robe Hook
Model YB2403

Chrome
Other



Pivoting Paper Holder
Model YB2408

Chrome
Other



18" Towel Bar
Model YB2418

Chrome
Other



24" Towel Bar
Model YB2424

Chrome
Other



9" Towel Bar
Model YB2486

Chrome
Other



FINISH OPTIONS:

To order, combine the model number with one of these finish letter(s):
Chrome [CH], LifeShine® Brushed Nickel [BN].

PROOFIT™
INSTALLATION SYSTEM

method
SNARED
ENSURE 2

method
SNARED
ENSURE 2

method
SNARED
ENSURE 2

CLB12

L0180B

une 8/22

PRECIS
SILGRANIT



- Made in Canada and Germany
- Valued at \$100 million; medical grade of up to 80% quartz sand
- Heat, scratch and impact resistant
- Non porous, impervious, stain resistant - does not absorb fluids or gases
- Easy to clean – pour and wipe down frequently
- Hygienic as its surface prohibits bacteria infiltration
- Also positioned and certified from holding pharmaceutical culture storage
- Includes 3X 791 mm stainless steel slantives, clon™ reservoir

[illegible]

Reversible -

**PRECIS
SILGRANIT**



- More in 2001 and 2002
 • Developed quite a conceptual understanding of it to this day
 • Initial article not signed (didn't know who to ask)
 • Wasn't published (didn't know who to ask)
 • They're really a very open and nice group
 • Horvath's idea surface pretty much the same
 • More involved and creative than before
 • Articles for the 2001 and 2002 papers were written
 • Didn't know how to write them
 • Didn't know how to write them
 • Didn't know how to write them

Sink Specification		Sink Dimensions		Sink Mounting		Sink Installation	
Model	40165T	Model	40165T	Model	40165T	Model	40165T
Color	White	Color	White	Color	White	Color	White
Material	Stainless Steel	Material	Stainless Steel	Material	Stainless Steel	Material	Stainless Steel
Finish	Brushed	Finish	Brushed	Finish	Brushed	Finish	Brushed
Weight	15.0 lbs	Weight	15.0 lbs	Weight	15.0 lbs	Weight	15.0 lbs
Width	20 1/2"	Width	20 1/2"	Width	20 1/2"	Width	20 1/2"
Depth	10 1/2"	Depth	10 1/2"	Depth	10 1/2"	Depth	10 1/2"
Height	10 1/2"	Height	10 1/2"	Height	10 1/2"	Height	10 1/2"
Mounting	Undermount	Mounting	Undermount	Mounting	Undermount	Mounting	Undermount
Installation	Professional	Installation	Professional	Installation	Professional	Installation	Professional
Warranty	5 Year	Warranty	5 Year	Warranty	5 Year	Warranty	5 Year

The model should be

Build your BLANCO UNIT with Faucets and Accessories



Journal of Health Politics, Policy and Law

Build your BLANCO UNIT with Faucets and Accessories



Journal of Interpersonal Violence 26(12) 2011, pp. 2411-2426
DOI: 10.1177/0886260511418511
© The Author(s) 2011. Reprints and permissions: sagepub.com/journalsPermissions.nav

Kitchen
Sink

Precis U 13/4 how Divine

CLASH



CLIENT NAME: ZANCOR HOMES
SHIP TO : CALEDON CLUB

DRAFTED BY: FERNANDA

PH:
CELL :

DATE SUBMITTED
12 Jul 2021

COMMENT

P/O #

JOB NUMBER

INSTALL DATE:

PAGE
12 of 22

38-4-ELEV A,B,C
STD. VANITIES

POWDER

SHARED

June 8. 122

Lot 803

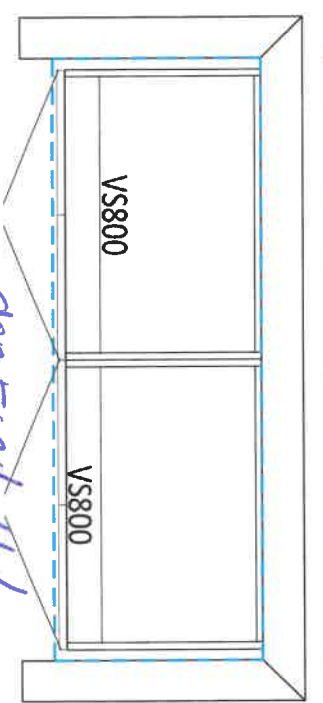
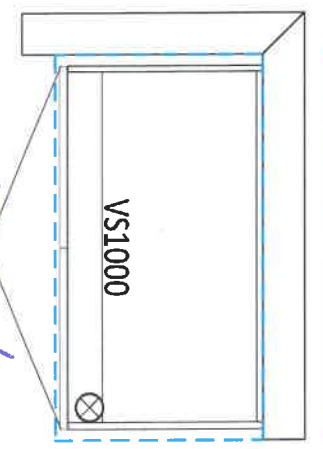

ENSUITE 2

MASTER ENSUITE

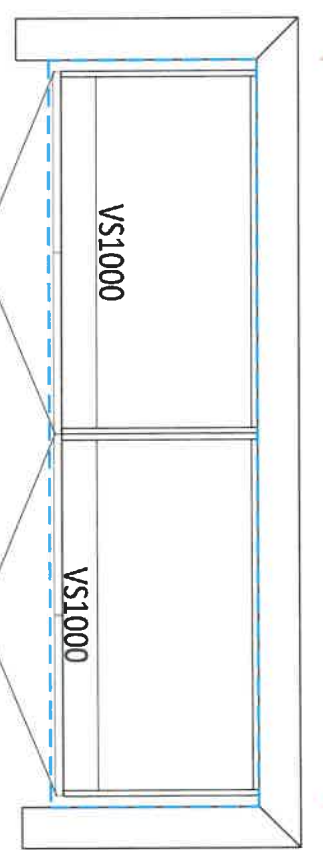
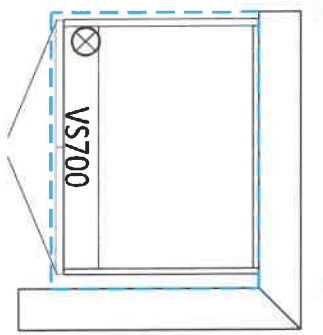

comfort HT

comfort HT.

LAUNDRY ROOM

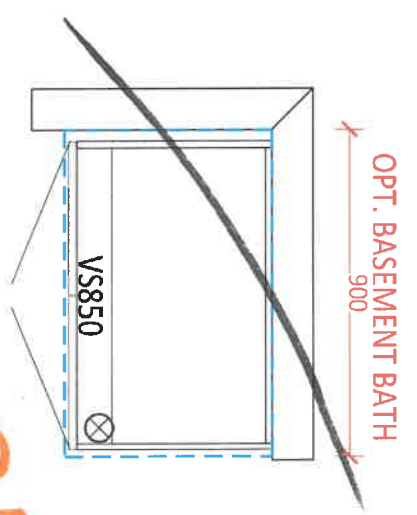
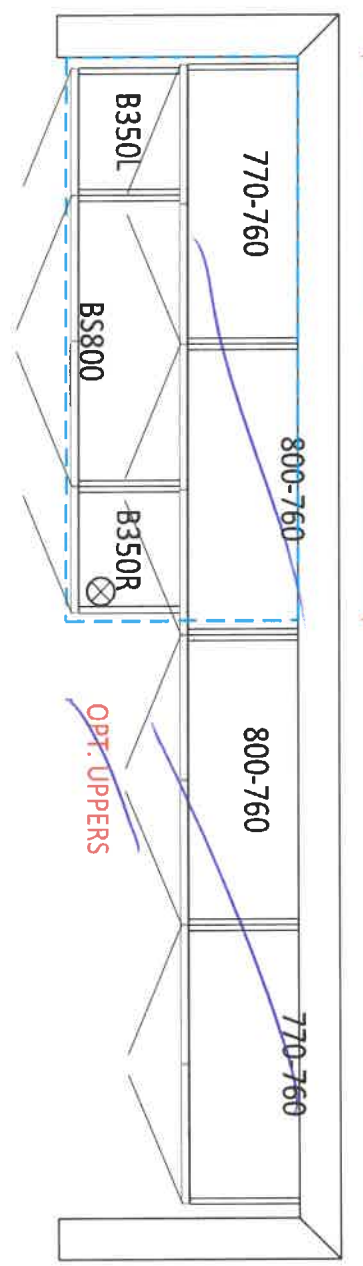

Clear 803

THE GALLERY

BY ZANCOR

ZANCOR

221 North Rivermede Road, Concord, Ontario L4K 3N7 * T: (905) 738.7010 F: (905) 738.5948

Boyle
J. W. 1/10/16

Purchaser accepts and acknowledges that the Builder reserves the right to substitute materials with those of equal or better quality where the manufacture, scheduling or delivery of materials may directly impact the Builder's ability to meet its contractual obligations under the Agreement of Purchase and Sale.

UPGRADES/EXTRAS: All upgrades and additional selections indicated on the colour chart must be accompanied by an upgrades/extras sheet (PES) and full payment otherwise the selection will be invalid. All colour charts and upgrades/extras will not proceed until verified and signed by an authorized signing officer at the Vendor's head office. **CHANGES WILL NOT BE PERMITTED UPON COMPLETION AND SUBMISSION OF THE COLOUR CHART.**

PORCELAIN & NATURAL STONES: Due to the properties of natural stones including but not limited to **marble, granite, quartz**, no two pieces are exactly the same. Variations in colour, tone, granularity (pitting, fissures) and pattern are to be expected, including various lighting may affect the overall finished look. Stone tops are sealed at time of installation and should never be cleaned with lemon oil or vinegar. Stones are porous materials, therefore any spilled substance require immediate attention. Stone countertops require regular seal re-application as part of home maintenance. Purchaser acknowledges colour and product variations as well as natural imperfections may exist with the selection of natural stone materials and shall not hold the Vendor liable for provision of same.

STONE COUNTERTOP JOINTS: Purchaser is aware that one joint will be at each corner and on either side of slide-in-range (if applicable). It will also be where the length of the counter top exceeds the length of a stone slab. Slabs are usually approximately 5' x 8'.

CERAMIC TILES: Due to manufacturing, shade (dye lots), product variations may exist that can affect the overall look of the finished product. Although every effort will be made to ensure the colours and materials selected are as close as possible to the samples, the purchaser acknowledges that the sample tiles supplied in the Design Centre may not be identical to the materials installed in the home.

STAIR STAINS: Due to the natural properties of wood, many variables can affect the overall look of the finished product. Factors including but not limited to wood type, knotting, graining, density, age, humidity, and air temperature can result in substantial variations in stain intensity. The purchaser accepts that although the Vendor will do their best to match stain the unfinished stairs as close as possible to the pre-finished floors, it is not possible to have an identical match and that there MAY be shade differences between the two products.

CABINETRY: Due to the natural properties of wood, slight variations apparent with cabinetry are to be expected. This includes but not limited to wood species, wood grain, colour, finish, product variations, and natural imperfections are all factors that may affect the overall look of the finished product. Such factors make exact colour matching impossible. The type and intensity of lighting in the areas of designated cabinetry placement may also highlight characteristics of cabinetry finish. All cabinets shall be finished with a white melamine interior box unless a finished interior is upgraded. Due to building specifications and/or on-site conditions, certain cabinetry upgrades may not be possible. The purchaser acknowledges that the Builder cannot guarantee the cabinetry finish or provision of certain upgrades and shall not hold the Builder liable for provision of same.

UPGRADES/EXTRAS: All upgrades and additional selections indicated on the colour chart must be accompanied by an upgrades/extras sheet (PES) and full payment otherwise the selection will be invalid. All colour charts and upgrades/extras will not proceed until verified and signed by an authorized signing officer at the Vendor's head office. **CHANGES WILL NOT BE PERMITTED UPON COMPLETION AND SUBMISSION OF THE COLOUR CHART.**

HARDWOOD / LAMINATE FLOORING: Due to the properties of wood and laminate, many variables can affect the overall look of the finished product. Variations include but not limited to wood type or laminate finish, colour/stain and wood grain are significant factors that make exact colour matching impossible. The purchaser acknowledges that the hardwood flooring is a pre-finished product in a controlled environment. Expansion, compression and cupping are characteristics of hardwood flooring once installed in the home. The purchaser acknowledges these may become apparent over time and despite the Builder's efforts to install the hardwood flooring materials in keeping with good workmanship, the Builder shall not be responsible nor held liable for minor variances of fluctuation in hardwood flooring materials.

HARDWOOD / LAMINATE WAIVER:

I/We understand hardwood flooring is classified as a porous material and as such not recommended by the Builder in certain areas. I/We understand there is a concern due to possible water and other substances being frequently splashed or spilled onto the floor and in contravention of Ontario Building Code Section 9.30.1.2(1).

"Finished flooring bathrooms, kitchens, public entrance halls, laundry & general storage areas shall consist of resilient flooring, felted-synthetic-fibre floor coverings, concrete, terrazzo, ceramic tile, mastic or other types of flooring providing similar degrees of water resistance.

I/We are prepared to assume full responsibility for any damage caused to the hardwood floor or subfloor due to moisture absorbcency in the mentioned areas, and agree to waive any claims against the Township of residence, TARIION and/or the Builder in relation to the matter. ****SEE COLOUR CHART FOR LOCATIONS****

DATE

SITE

LOT

CALEDON

805

221 North Rivermede Road, Concord, Ontario L4K 3N7 * T: (905) 738.7010 F: (905) 738.5948

HOME AUTOMATION (Cable, CAT5/6, Telephone)

INCLUDED IN SCHEDULE "A" IN AGREEMENT OF PURCHASE AND SALE:

- Rough-in for Central Vacuum system piped to garage
- Rough-in for Telephone (2) locations
- Rough-in for Cable TV (2) locations
- Rough-in for Cat-6 Network (3) locations

OPTION 1:

I/we the Homeowner(s) have chosen to contact the Home Automation Company to select the locations of the rough-ins for Cable, CAT5, Telephone as included in our Agreement of Purchase Sale.

I/we the Homeowner(s) will contact the trade within 4 weeks of the date of this release to select locations of the standard rough-ins review other optional products for purchase.

Trade: Artistic Smart Homes
Phone: (905) 850-9386
Location: 8601 Jane Street
 Concord, Ont L4K 5N9

Should the homeowner not make these selections within the sufficient time provided, the rough-ins as mentioned above will be installed in locations at the Vendor's discretion.

X
Homeowner(s) Initial

OPTION 2:

I/we the Homeowner(s) acknowledge that if we do not contact the home automation company, I/we the Homeowner(s) have agreed to the Vendor locations for the standard rough-ins for Cable, CAT6, Telephone that are included in the Agreement of Purchase and Sale.

Homeowner(s) Initial

CEA

CALEDON

DATE Dec 8/22

SITE

LOT

803

Stone Countertop Edge Profiles

Where applicable as per site specifications

STANDARD EDGE FOR KITCHEN & VANITIES

Standard Countertop Edge in Kitchen

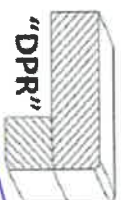

Standard Countertop Edge in Vanity

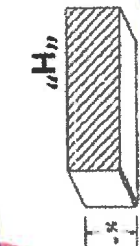

master

Homeowner(s) Initial

OPTION (1) EDGE FOR KITCHEN & VANITIES \$250

Optional Edge in Kitchen

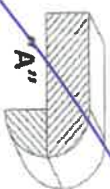
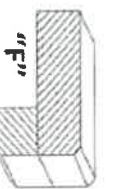
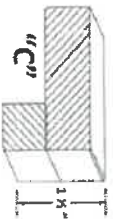

Optional Edge in Bathroom

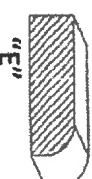
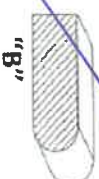

Homeowner(s) Initial

OPTION (2) EDGE FOR KITCHEN & VANITIES CUSTOM PRICING

Optional Edge for Kitchen

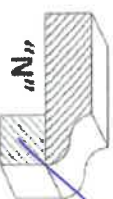
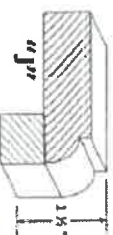
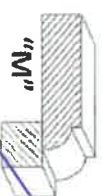
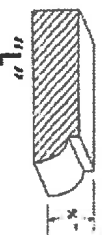

Optional Edge in Vanity

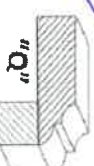
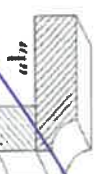
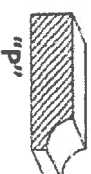

Homeowner(s) Initial

DATE

SITE

LOT

CALEDON

June 8/22

203

CEVA

APPLIANCE ACKNOWLEDGEMENT

CONTACT: Steve Miller - Appliance Canada (905) 660-2424 / smiller@appliancecanada.com

- It is the Purchaser's responsibility to coordinate delivery, installation and hook up of appliances and to ensure they are installed as per Manufacturers specifications after closing.

STANDARD APPLIANCE OPENINGS provided by Zancor:

*Standard appliance openings are approximate and the minimum required. Sizes may vary due to onsite condition and/or when modifications have been made to the cabinetry.

- Fridge Opening 36" x 74"
- Stove Opening 30"
- Hood Fan Opening 30"
- Hood Fan & Vent 6" with Under Cabinet Hood
- Dishwasher Opening 24"

Accepts Standard
Openings **Initial**OPTIONAL UPGRADED APPLIANCES to be provided by Homeowner:**

- ****Specs/information sheets are required and it is the responsibility of the homeowner to provide this to Zancor Homes by the due date that has been provided. If appliance specs are not submitted, Zancor Homes will not be responsible for any necessary requirements and the standard opening will be built.**

- **Upgraded Appliance Specs are DUE 2 WEEKS FROM SIGNED DATE OF COLOUR CHART (if not received during appointment)**

- ****Specs that require changes/modifications after this date will not be accepted*****

- **NOTE: Any upgraded appliances are to be paid by the Purchaser, directly to the appliances company.**

- **Additional charges to the Purchaser may apply for cabinetry, electrical and plumbing in order to accommodate the specs given by the homeowner.**

FRIDGE UPGRADE

- ☐ Built-in
- ☐ Paneled **Panel to match required
- ☐ Integrated / Flush Inset
- ☒ Waterline

RANGE UPGRADE

*Larger hood fan CFM might be required, which need a larger vent

- ☐ 36" **Hood fan opening must be the same size or larger (8" vent might be required)
- ☐ 48" **Hood Fan opening must be the same size or larger (8" or 10" vent required)
- ☐ Gas Range **gas line and electrical required & sold separately
- ☐ Induction **electrical required & sold separately
- ☐ Cooktop (Apron Front) **Countertop Cut-out required & sold separately
- ☐ Cooktop (Drop-in) **countertop Cut-out required & sold separately

HOOD FAN & VENT UPGRADE

- ☐ 8 Inch **Required for 600 CFM
- ☐ 10 Inch
- ☒ Chimney Hood Fan **Vent must be centred
- ☐ Insert / Liner

WALL OVEN/MICRO UPGRADE

- ☐ Single Wall Oven **electrical required & sold separately
- ☐ Double Wall Oven **electrical required & sold separately
- ☐ Steam Oven **electrical required & sold separately
- ☐ Warming Drawer **electrical required & sold separately
- ☐ Over The Range Microwave (OTR)
- ☐ Built-In Microwave **Trim Kit required **electrical required & sold separately

****Electrical required**

mw shelf.

DATE Dec 8, 2020

SITE CALEDON

LOT 80B

** Any upgrades checked in this appliance form must be accompanied with specs provided by the Purchaser.
**It is the responsibility of the trade to inform the Builder of any discrepancies with specs, sketches, extras and/or colour chart PRIOR to production/installation.

221 North Rivermede Road, Concord, Ontario L4K 3N7 * T: (905) 738.7010 F: (905) 738.5948

ZANCOR