

CONSTRUCTION SUMMARY OF EXTRAS

Printed 2022-06-29 / 10:02 AM / Page 1 of 1

Site:
Lot:
Model:
Purchaser:
Purchaser:
Phone:
Email:

RIVER'S EDGE WASAGA
297
HUMBER (50-05) ELEV B
DANIEL ULITSKY
0
647.786.7047
ALONAESTATES@GMAIL.COM



DESCRIPTION		DATE SELECTED
BONUS PACKAGE: STAINLESS STEEL HOOD FAN	INCLUDED IN APS	
STRUCTURALS		
1 SMOOTH CEILING ON MAIN FLOOR IN LIEU OF STRIPPLE		15-Feb-22
2 SMOOTH CEILING ON SECOND FLOOR IN LIEU OF STRIPPLE		15-Feb-22
3 ELECTRICAL- 50" DIMPLEX FIREPLACE- BLF5051 IN LIEU OF STANDARD. WALL TO BE BUILT INTO ROOM BY APPROX 8 INCHES TO ACCOMMODATE. WALL FROM FLOOR TO CEILING- SEE SKETCH		15-Feb-22
COLOURS		
1 ELECTRICAL- PLUG FOR TV INSTALLED OVER FIREPLACE- INSTALL 65 AFF		19-May-22
2 NA		19-May-22
3 NA		19-May-22
4 NA		19-May-22
5 HARDWOOD- UP 2- FAMILY ROOM, MAIN HALL, LANDINGS, DINING ROOM, UPPER HALL		19-May-22
6 STAIN FOR STAIRS TO MATCH HARDWOOD AS CLOSE AS POSSIBLE		19-May-22
7 HARDWARE CABINETS		19-May-22
8 RAILING- UP 2		19-May-22
9 KITCHEN BACKSPLASH- UP 2- STACKED		19-May-22

ENTRANCES				
Main Foyer - FLOORING	NEW BYZNANTINE ASSURO BLUE 12 X 24- STACKED			
Mudroom - FLOORING	NEW BYZNANTINE ASSURO BLUE 12 X 24- STACKED			
Side Hall - FLOORING	NA			
Basement Foyer - FLOORING	NA			
KITCHEN				
Kitchen - FLOORING	NEW BYZNANTINE ASSURO BLUE 12 X 24- STACKED			
Breakfast - FLOORING	NEW BYZNANTINE ASSURO BLUE 12 X 24- STACKED			
Kitchen - CABINETS	EURO HIGH GLOSS WHITE			
Island - CABINETS	EURO HIGH GLOSS WHITE			
Servery - CABINETS	EURO HIGH GLOSS WHITE			
Kitchen - HANDLES/KNOBS	H800MB			
Kitchen - COUNTERTOP	BIANCO SARDO			
Island - COUNTERTOP	BIANCO SARDO			
Kitchen - BACKSPLASH	COLOUR AND DIMENSION ARTIC WHITE BRIGHT 4 X 16- STACKED - UP 2			
Kitchen - SINK	STD			
Kitchen - FAUCET	STD			
GREAT ROOM / DINING / LIVING / DEN / OFFICE / BASEMENT				
Family / Great Room - FLOORING	KENTWOOD OAK STONECROP 5" X 3/4" - UP 2			
Main Hall - FLOORING	KENTWOOD OAK STONECROP 5" X 3/4" - UP 2			
Dining / Living Room - FLOORING	KENTWOOD OAK STONECROP 5" X 3/4" - UP 2			
Library / Den - FLOORING	NA			
Basement Rec Room - FLOORING	NA			
STAIRS				
Railing Details - PICKETS	1 3/4" SQUARE OAK W/ BEVEL CORNER- UP 2			
Railing Details - POSTS	3 1/4" SQUARE OAK W/ BEVEL CORNERS- UP 2			
Railing Details - HANDRAIL	2 3/4" SQUARE OAK- UP 2			
Stair Stain - MAIN STAIRS	STAIN STAIRS TO MATCH HARDWOOD AS CLOSE AS POSSIBLE			
Stair Stain - BASEMENT STAIRS (if applicable)	NA			
BEDROOMS / BATHROOMS / LAUNDRY				
Powder Room - FLOORING	NEW BYZNANTINE ASSURO BLUE 12 X 24- STACKED			
Powder Room - CABINETS	NA			
Powder Room - HARDWARE	NA			
Powder Room - COUNTERTOP	NA			
Powder Room - SINK	STD			
Powder Room - FAUCET	STD			
Laundry - FLOORING	NEW BYZNANTINE ASSURO BLUE 12 X 24- STACKED			
Laundry - CABINETS	NA	laundry - HANDLES/KNOBS	NA	
Laundry - COUNTERTOP	NA	laundry - SINK	STD	
Laundry - BACKSPLASH	NA	laundry - FAUCET	STD	
Upper Hall - FLOORING	KENTWOOD OAK STONECROP 5" X 3/4" - UP 2			
Master Bedroom - FLOORING	T20 OPENING NIGHT			
Bedroom 2 - FLOORING	T20 OPENING NIGHT			
Bedroom 3 - FLOORING	T20 OPENING NIGHT			
Bedroom 4 - FLOORING	T20 OPENING NIGHT			
Bedroom 5 - FLOORING	NA			
Master Ensuite - FLOORING	NEW BYZNANTINE ASSURO BLUE 12 X 24- STACKED			
Master Ensuite - SHOWER WALL	NEW BYZNANTINE ASSURO BLUE 12 X 24- STACKED VERTICAL			
Master Ensuite - SHOWER FLOOR	WHITE 2 X 2			
Master Ensuite - SHOWER JAMB	BIANCO CARRARA			
Master Ensuite - CABINETS	EURO HIGH GLOSS WHITE			
Master Ensuite - HANDLES/KNOBS	H800MB			
Master Ensuite - COUNTERTOP	4595-38			
Master Ensuite - SINK(s)	STD	Master Ensuite - FAUCET(s)	STD	
FOR TRADE USE				
Any upgrades in the colour chart must be accompanied with a PES. It is the responsibility of all Trades to inform the builder of any discrepancies on sketches, PES and/or colour charts <u>PRIOR</u> to installation.		RIVERS EDGE WASAGA 297 D.H PURCHASER INITIALS VENDOR APPROVAL		

JUN 2 8 2022

2ND FLOOR CONTINUED...					
Main Bath - FLOORING			NA		
Main Bath - TUB / SHOWER WALL			NA		
Main Bath - SHOWER FLOOR			NA		
Main Bath - SHOWER JAMB			NA		
Main Bath - CABINETS			NA		
Main Bath - HANDLES/KNOBS			NA		
Main Bath - COUNTERTOP			NA		
Main Bath - SINK(s)	NA		Main Bath - FAUCET(s)		NA
NEW BYZNATINE ASSURO BLUE 12 X 24- STACKED					
Shared Bath- FLOORING					
Shared Bath- TUB / SHOWER WALL			NEW BYZNATINE ASSURO BLUE 12 X 24- STACKED VERTICAL		
Shared Bath- SHOWER FLOOR			NA		
Shared Bath- SHOWER JAMB			NA		
Shared Bath- CABINETS			EURO HIGH GLOSS WHITE		
Shared Bath- HANDLES/KNOBS			H800MB		
Shared Bath- COUNTERTOP			4595-38		
Shared Bath- SINK(s)	STD		Shared Bath - FAUCET(s)		STD
NEW BYZNATINE ASSURO BLUE 12 X 24- STACKED					
Ensuite Bath - FLOORING					
Ensuite Bath - TUB / SHOWER WALL			NEW BYZNATINE ASSURO BLUE 12 X 24- STACKED VERTICAL		
Ensuite Bath - SHOWER FLOOR			NA		
Ensuite Bath - SHOWER JAMB			NA		
Ensuite Bath - CABINETS			EURO HIGH GLOSS WHITE		
Ensuite Bath - HANDLES/KNOBS			H800MB		
Ensuite Bath - COUNTERTOP			4595-38		
Ensuite Bath - SINK(s)	STD		Ensuite Bath - FAUCET(s)		STD
TRIM / PAINT					
Casing/Baseboards			STD		
Interior Door STYLE			STD		
Interior Door HEIGHT			STD		
Interior Door Hardware			STD		
PAINT - Throughout			COOL WHITE		
FIREPLACE					
Location / Insert / Mantle			50" DIMPLEX		
ACCESSORIES					
Mirrors	YES		BATH ACCESSORIES		DO NOT INSTALL
APPLIANCE REQUIREMENTS					
GAS LINE TO BBQ	STD		ELECTRICAL for Built-in Oven		DECLINED
GAS LINE & ELECTRICAL TO STOVE	DECLINED		ELECTRICAL for Built-in Micro		DECLINED
GAS LINE & ELECTRICAL TO DRYER	DECLINED		ELECTRICAL for Cooktop		DECLINED
HOOD FAN VENT SIZE	6" STD		ELECTRICAL for Bar Fridge		DECLINED
WATERLINE to Fridge	DECLINED				
DISCLAIMER					
Any changes to the colour chart after signing are subject to a \$5000 administration fee plus costs					
Purchaser has checked and acknowledged accuracy of colour and selections before signing.					
Colours of all materials are as close as possible to Builders selection but not necessarily identical due to dye lot variances in manufacturing/manufacturers. Due to construction progress some items may have been pre-selected or installed. In this event the Vendor's selection must be accepted by the purchaser					
SITE / LOT:		RIVER'S EDGE WASAGA		297	
PURCHASER(S):		DANIEL ULITSKY			
PURCHASER(S):		0			
PHONE #:		647.786.7047			
EMAIL:		ALONAESTATES@GMAIL.COM			
*** FOR TRADE USE ***					
Any upgrades in the colour chart must be accompanied with a PES. It is the responsibility of all Trades to inform the builder of any discrepancies on sketches, PES and/or colour charts PRIOR to installation.			SIGNATURES / DATE		
<div>ZANCOR HOMES</div>			PURCHASER SIGNATURE		
			PURCHASER SIGNATURE		
			DÉCOR CONSULTANT		
Vendor APPROVAL			JUN 28 2022		

lot 293
May 20/12

50-05 Hummer

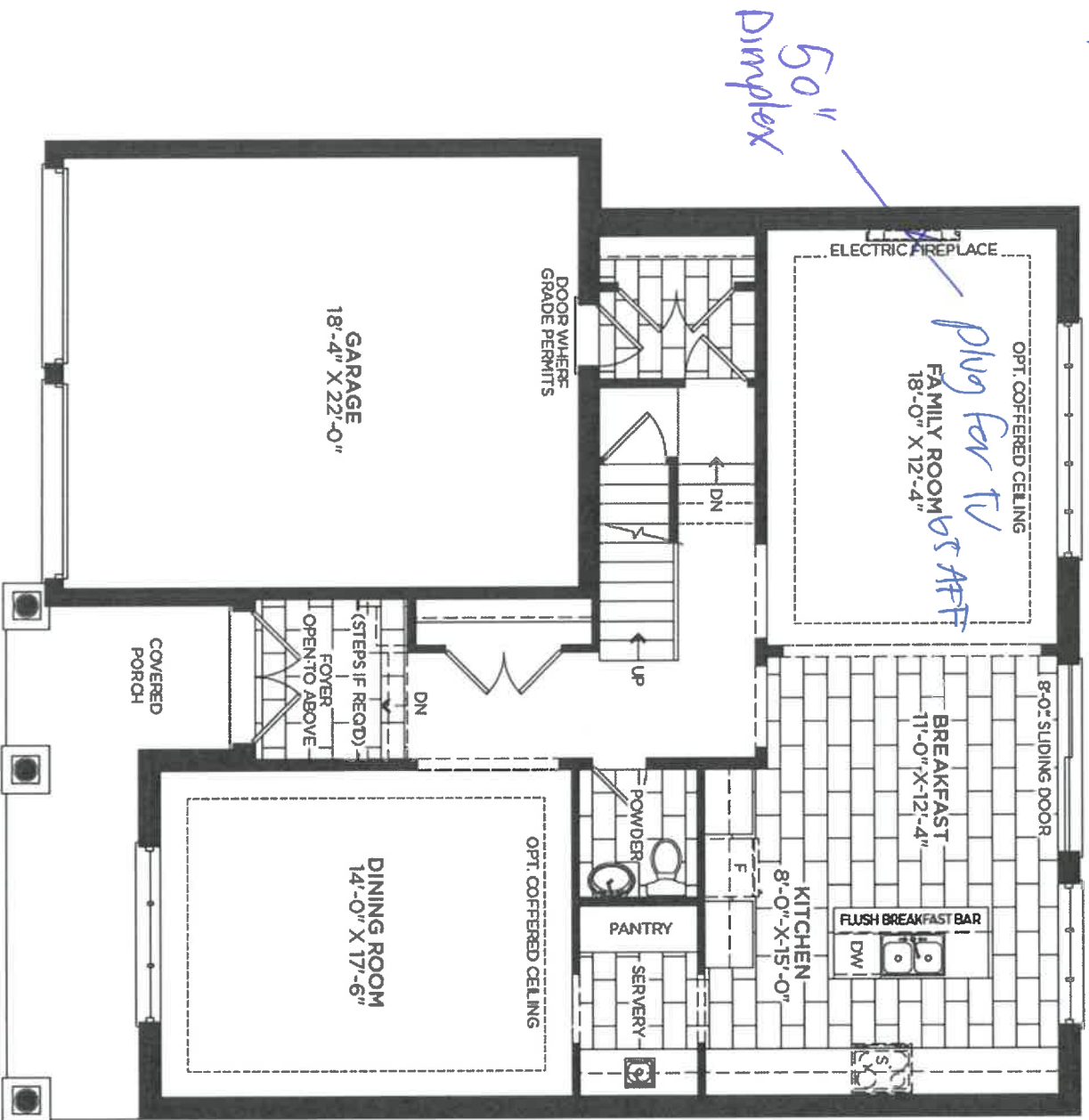

MAIN FLOOR ELEVATION A B

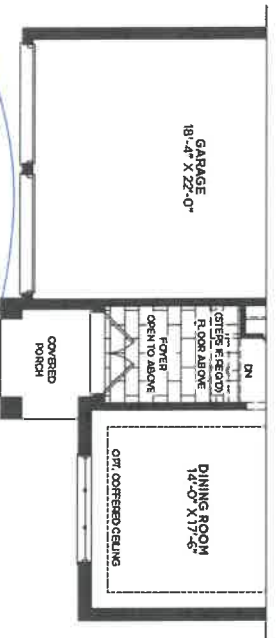

MAIN FLOOR ELEVATION B

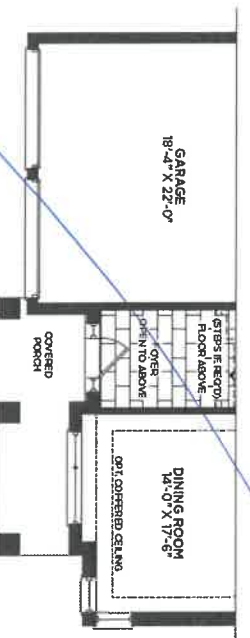

MAIN FLOOR ELEVATION C

Smooth
ceiling

D.N

Lot 297
Apr 24/12

50-05 Humber

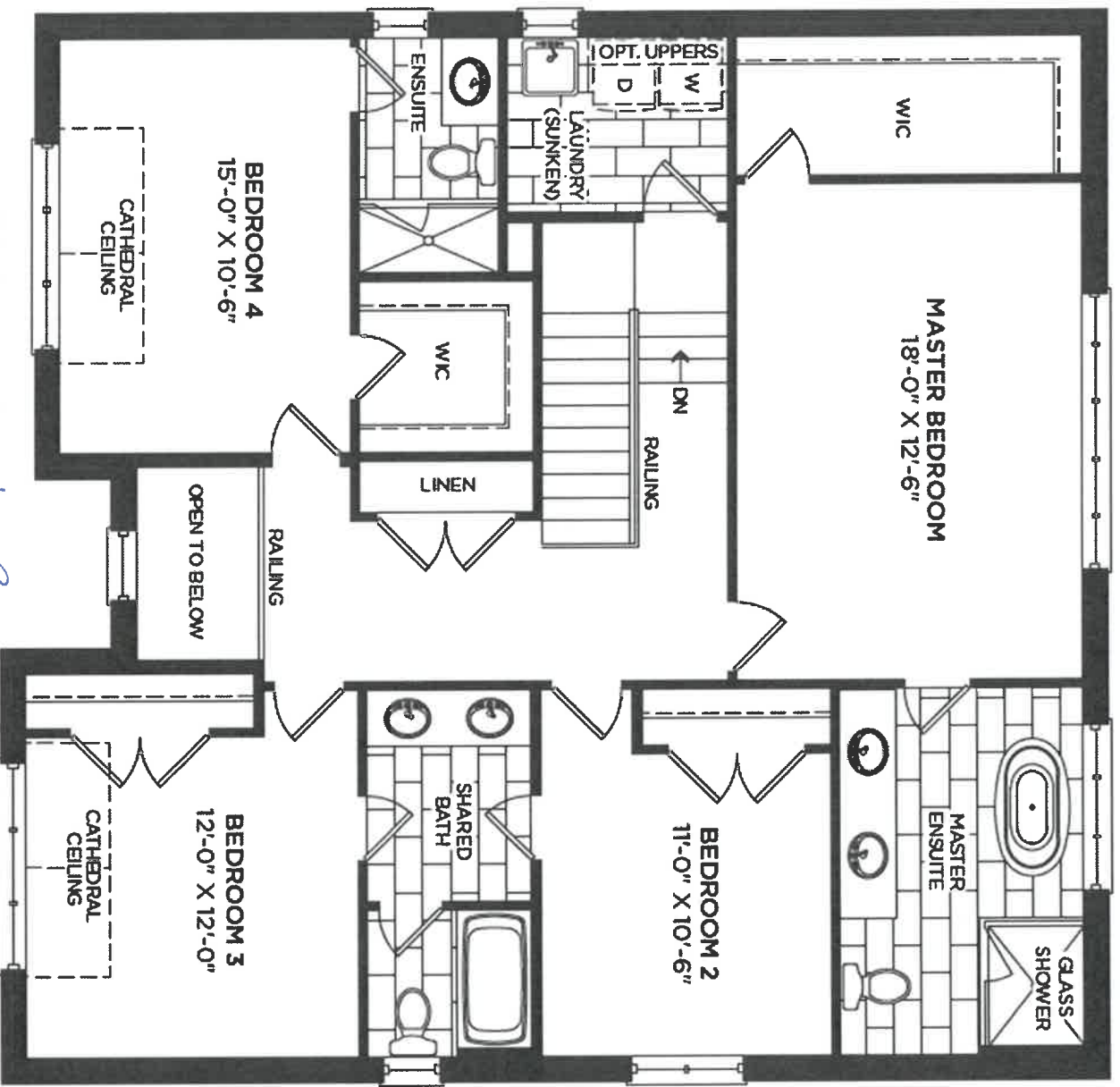

SECOND FLOOR ELEVATION A *B*

D.A.

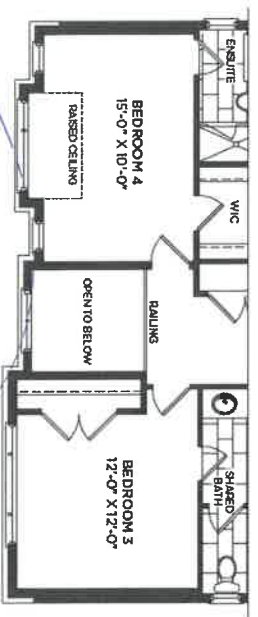

SECOND FLOOR ELEVATION B

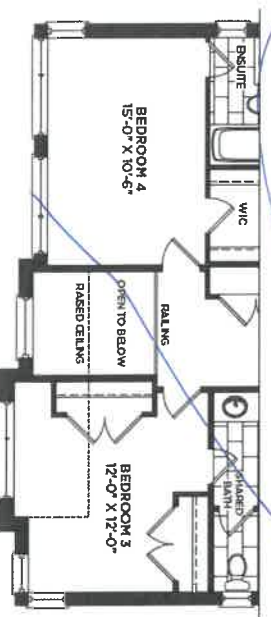

SECOND FLOOR ELEVATION C

Smooth Ceiling

Lot 297
May 20/22

50-05 Humber

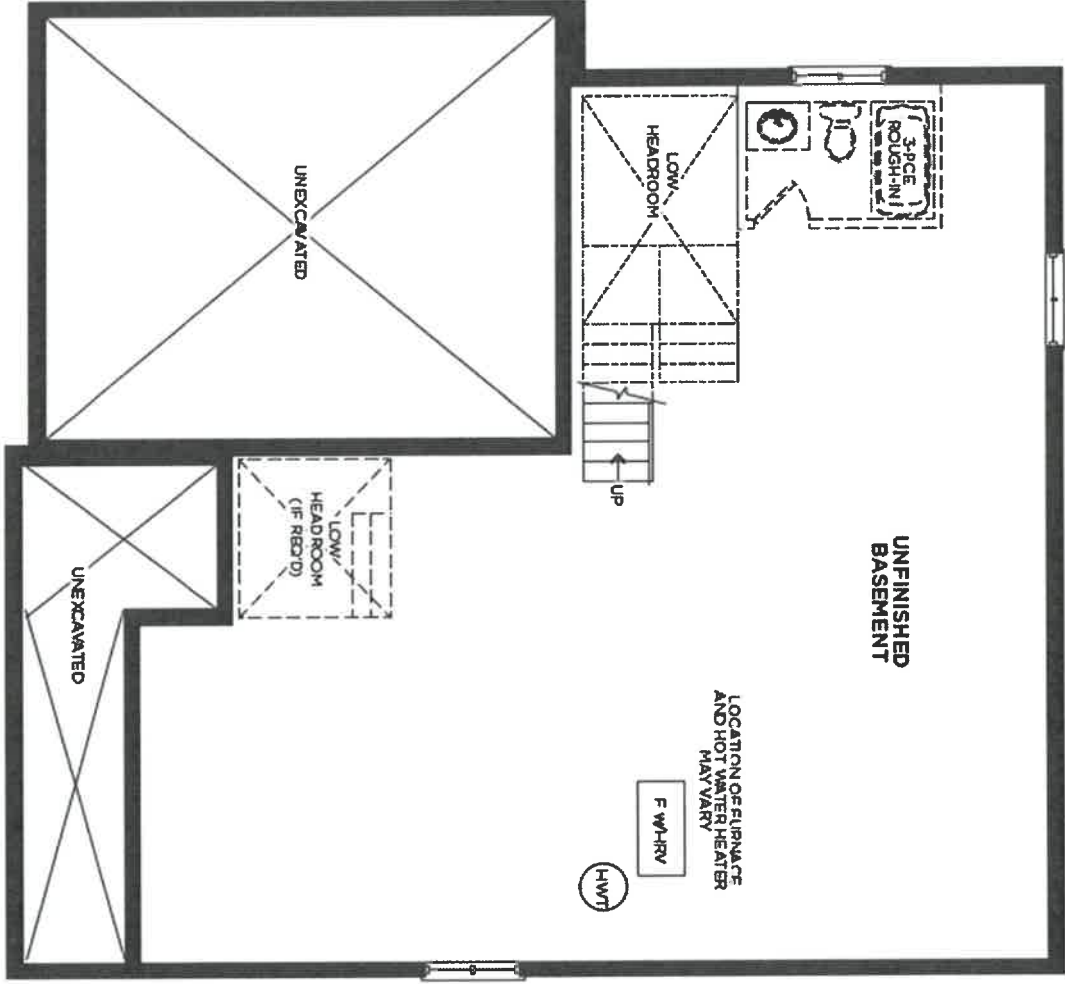

BASEMENT ELEVATION A

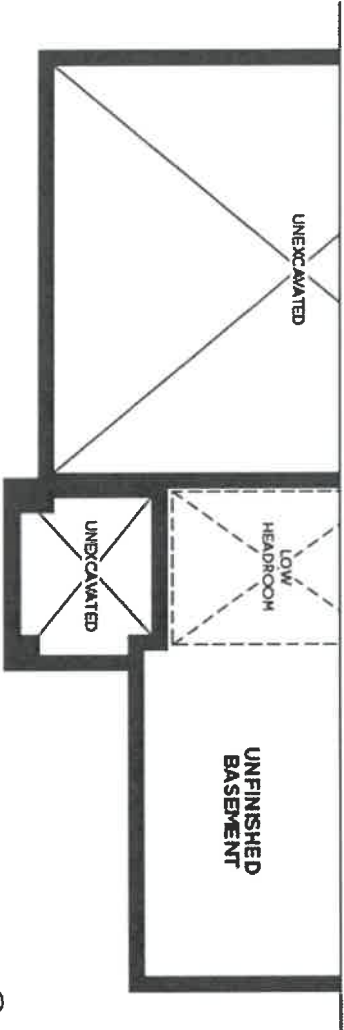

BASEMENT ELEVATION B

P.N

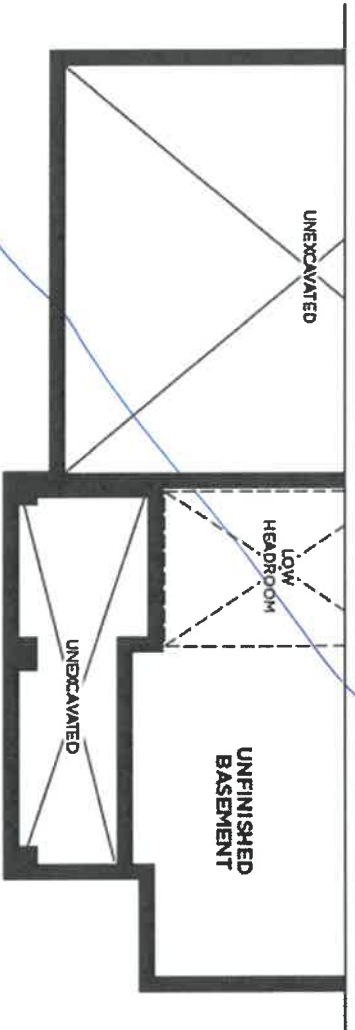

BASEMENT ELEVATION C



CLIENT NAME: ZANCOR HOMES
SHIP TO : Rivers Edge Sunnisdale Trails
#50-05

PH:
CELL:

JOB NUMBER

INSTALL DATE:

PAGE
2 of 2

DATE SUBMITTED

01 Mar 2022

DRAFTED BY: Binita

P/O #

lot 297
149/19/22

2500

b.u

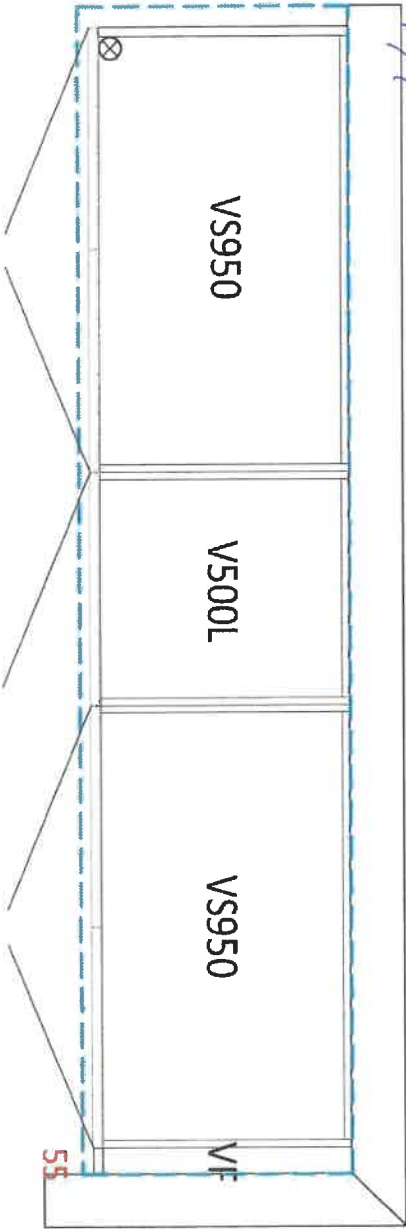

Master Ensuite

1800

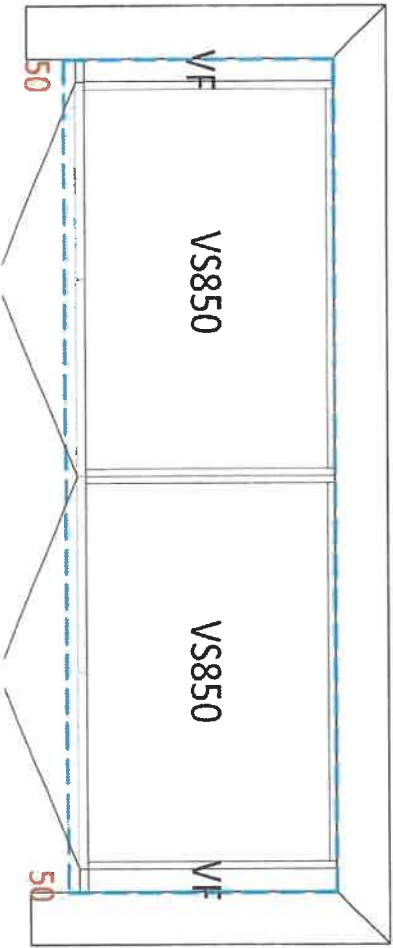

Shared Bath

975

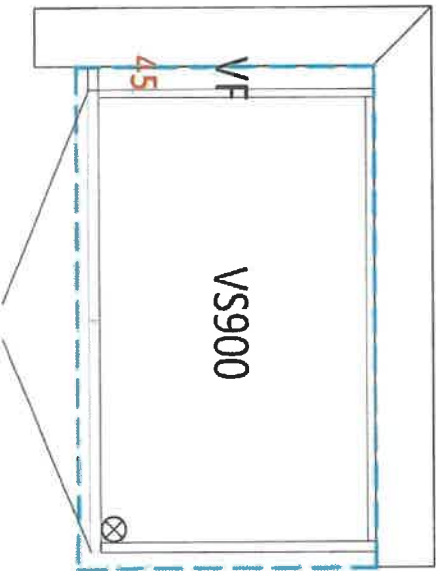

Ensuite

2235

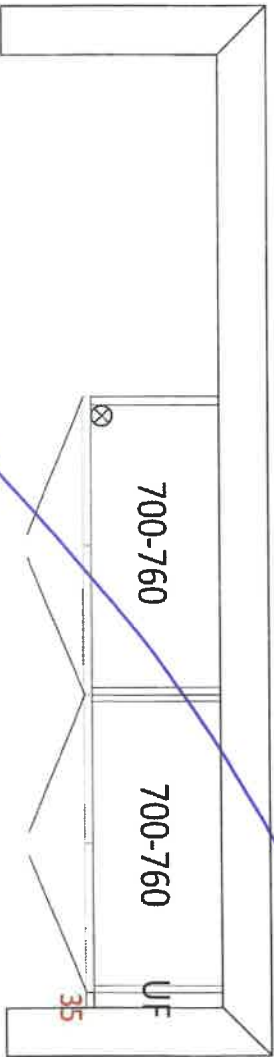

opt. Laundry uppers



CLIENT NAME: ZANCOR HOMES
SHIP TO : Rivers Edge Sunnidle Trails
#50-05

PH:
CELL :

DATE SUBMITTED
01 Mar 2022

DRAFTED BY: Binita
COMMENT

P/O #

JOB NUMBER

INSTALL DATE:

PAGE
1 of 2

1 of 297
Kitchen May 19/22

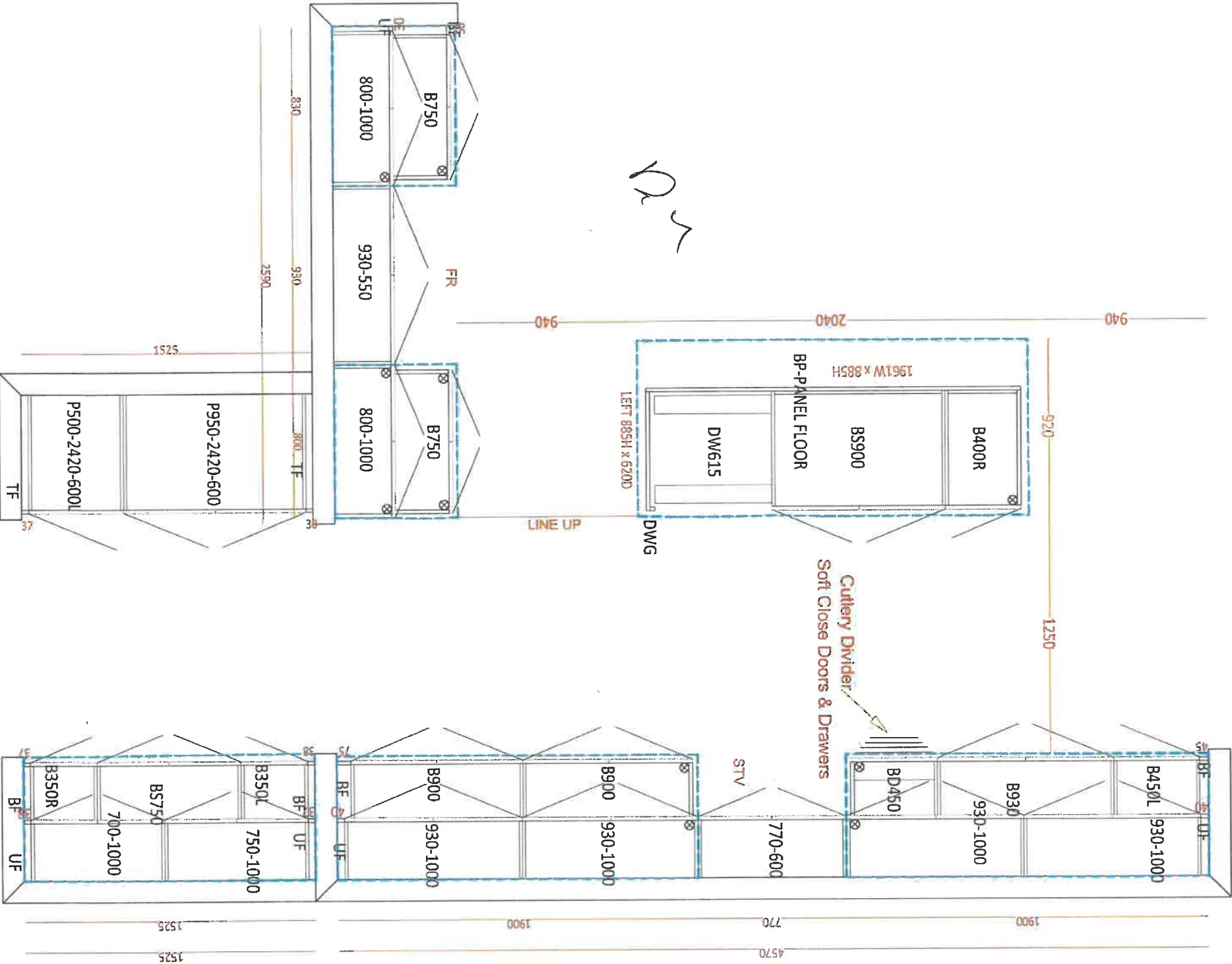



Prism Series
50" Linear Electric Fireplace

BLF5051

The best-selling linear fireplace
is now even better.



The best-selling electric linear fireplace just got better with the all new Prism Series. Sparkling with intensity in a full spectrum of colors, the Prism effect illuminates the diamond-like acrylic ice ember bed in a show-stopping effect. Plug-in or hard-wire, hung on the wall or built-in, the Prism Series is beautifully versatile.

 **PRISM**
series

297

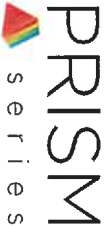

Prism Series

50" Linear Electric Fireplace

BLF5051

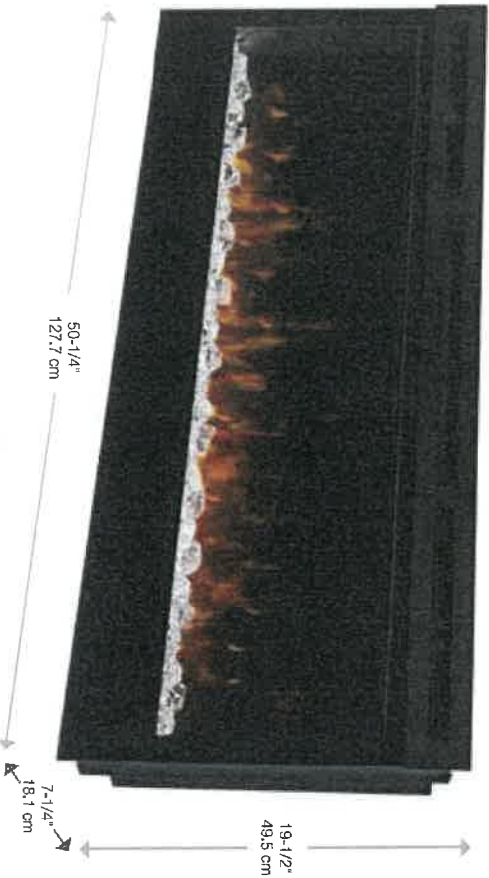

Accessories



120 Volts | 1,230 Watts | 4,197 BTU

Model #	Description	Lbs / Kg	UPC	Wt ¹	Carton Dimensions (WxHxD)		Cube	
					inches	cm	ft ³	m ³
BLF5051	50" Linear Electric Fireplace	75 / 34.1	781052 098787	2 yr.	55 x 23-1/4 x 12-7/8	139.7 x 58.9 x 32.7	9.5	0.26
DT1267BLK	Cohesion Trim - Black	51 / 23.1	781052 080355	1 yr	64-7/8 x 26-1/4 x 8-3/4	164.8 x 66.8 x 22.1	8.6	0.24
LF50DWS-KIT	50" Driftwood and River Rock Accessory Kit	7 / 3.17	781052 102842		34-1/4 x 5-7/8 x 8-1/8	87.2 x 14.98 x 20.6		

Specifications, finishes and dimensions are subject to change. *Limited warranty. ©2020 Glen Dimplex Americas
Glen Dimplex Americas | 1-800-668-6663 | www.dimplex.com

Features

- The Original Dimplex Flame Effect™**
A blend of technology, artistry and craftsmanship that sets the standard for realism.
- Acrylic Ice Media Bed**
Light plays through different size pieces and sparkle in a spectrum of colors.
- Media Accent Colors**
Choose from a variety of brilliant color themes or cycle through a range of colors using the custom mode. Freezing on the hue of your choice.
- Flexible Installation**
Simply surface mount and plug-in or fully-recess and direct wire for a seamless installation
- Hanging Glass Design**
Detachable glass trim easily finishes rough openings and provides access to media.
- Remote Thermostat Control**
Temperature control at your fingertips for convenient comfort.
- Multi-function Remote**
Control the flame, heat and thermostat from the comfort of your chair.
- LED Lighting**
Flame and lights use brilliant, low-energy LED's that require zero maintenance.
- All-season Flames**
Enjoy the unique charm of a fireplace 365 days a year using the flames without the heat.
- Cool-Touch Glass**
Glass remains cool making it safe for any location and any user.
- Low Carbon Footprint**
The most sustainable fireplace option: no emissions and 100% efficient.

894

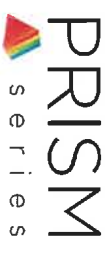

Prism Series

50" Linear Electric Fireplace

BLF5051

Product Dimensions:

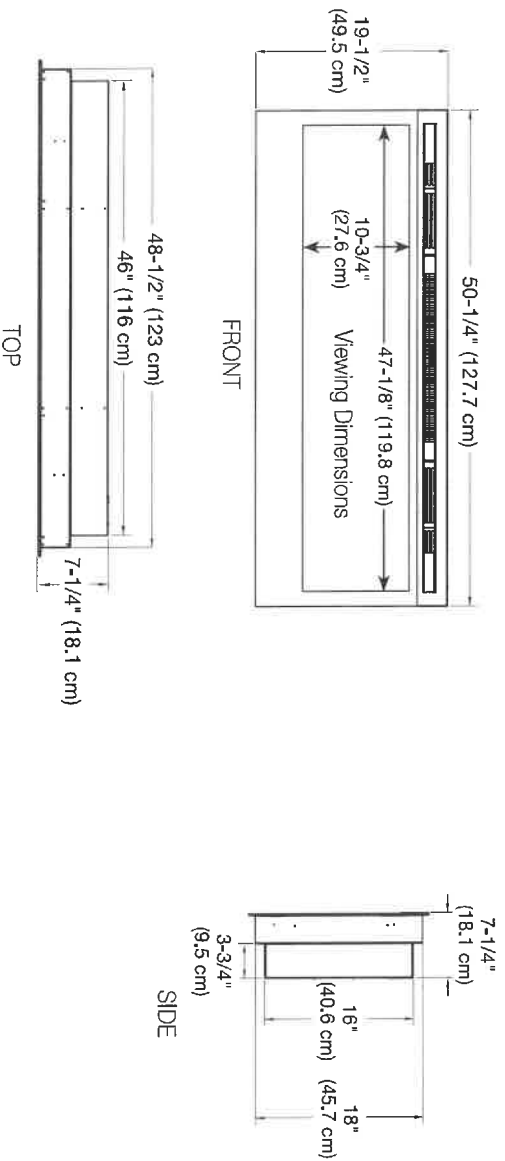

Installation Options and Framing Dimensions

3 Mounting Options

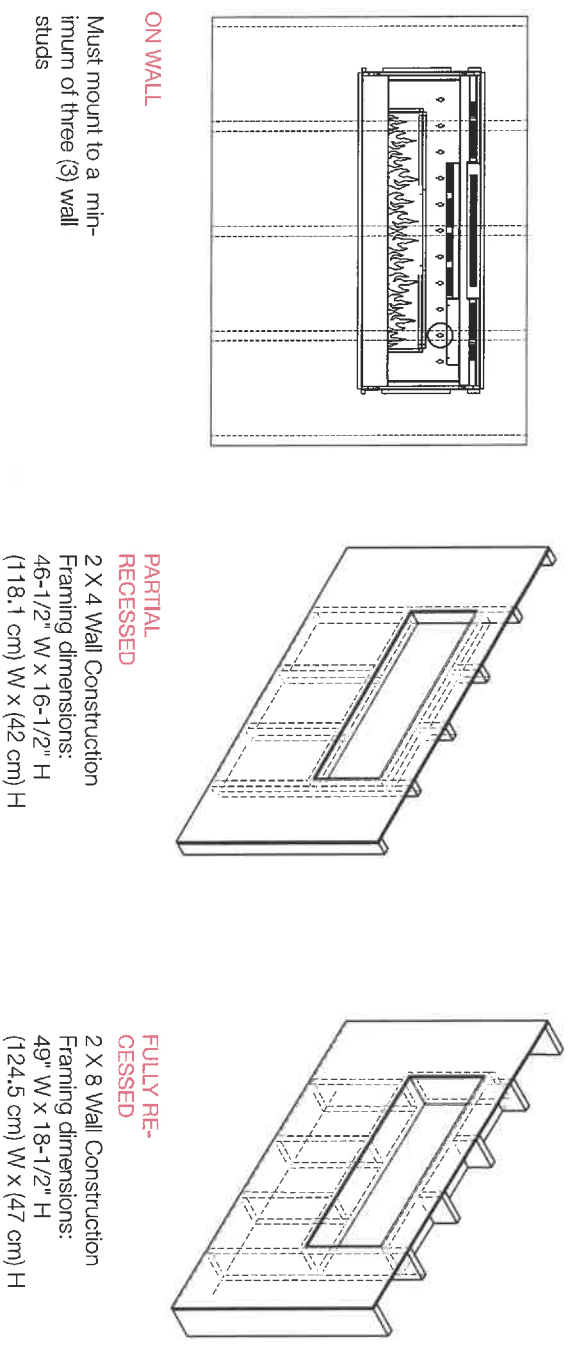

297

APPLIANCE ACKNOWLEDGEMENT

CONTACT: Steve Miller - Appliance Canada (905) 660-2424 / smiller@appliancecanada.com

- It is the Purchasers responsibility to coordinate delivery, installation and hook up of appliances and to ensure they are installed as per Manufacturers specifications after closing.

STANDARD APPLIANCE OPENINGS provided by Zancor:

- *Standard appliance openings are approximate and the minimum required. Sizes may vary due to onsite condition and/or when modifications have been made to the cabinetry.
- Fridge Opening 36" x 74"
 - Stove Opening 30"
 - Hood Fan Opening 30"
 - Hood Fan & Vent 6" with Under Cabinet Hood
 - Dishwasher Opening 24"

Accepts Standard
Openings ** Initial

☒ Initial

OPTIONAL UPGRADED APPLIANCES to be provided by Homeowner:

- ****Specs/Information sheets are required and it is the responsibility of the homeowner to provide this to Zancor Homes by the due date that has been provided. If appliance specs are not submitted, Zancor Homes will not be responsible for any necessary requirements and the standard opening will be built.**

☒ Initial

- **Upgraded Appliance Specs are DUE 2 WEEKS FROM SIGNED DATE OF COLOUR CHART (if not received during appointment)**

INITIAL

- ****Specs that require changes/modifications after this date will not be accepted*****

- **NOTE: Any upgraded appliances are to be paid by the Purchaser, directly to the appliances company.**

- **Additional charges to the Purchaser may apply for cabinetry, electrical and plumbing in order to accommodate the specs given by the homeowner.**

FRIDGE UPGRADE

- ☐ Built-in
- ☐ Paneled **Panel to match required
- ☐ Integrated / Flush Inset
- ☐ Waterline

RANGE UPGRADE

*Larger hood fan CFM might be required, which need a larger vent

- ☒ 36" **Hood fan opening must be the same size or larger (8" vent might be required)
- ☒ 48" **Hood Fan opening must be the same size or larger (8" or 10" vent required)
- ☒ Gas Range **gas line and electrical required & sold separately
- ☒ Induction **electrical required & sold separately
- ☐ Cooktop (Apron Front) **Countertop Cut-out required & sold separately
- ☐ Cooktop (Drop-in) **countertop Cut-out required & sold separately

gasline ✓

HOOD FAN & VENT UPGRADE

- ☒ 8 Inch **Required for 600 CFM
- ☒ 10 Inch
- ☒ Chimney Hood Fan **Vent must be centred
- ☐ Insert / Liner

WALL OVEN/MICRO UPGRADE

- ☐ Single Wall Oven **electrical required & sold separately
- ☐ Double Wall Oven **electrical required & sold separately
- ☐ Steam Oven **electrical required & sold separately
- ☐ Warming Drawer **electrical required & sold separately
- ☐ Over Then Range Microwave (OTR)

**Electrical required

- ☒ Built-In Microwave **Trim Kit required **electrical required & sold separately

DATE May 18/22

WASAGA RIVERS EDGE

SITE

297

LOT

** Any upgrades checked in this appliance form must be accompanied with specs provided by the Purchaser.

**It is the responsibility of the trade to inform the Builder of any discrepancies with specs, sketches, extras and/or colour chart PRIOR to production/installation.

ZANCOR

221 North Rivermede Road, Concord, Ontario L4K 3N7 * T: (905) 738.7010 F: (905) 738.5948

INTERIOR FINISHES ACKNOWLEDGEMENT / WAIVER

Purchaser accepts and acknowledges that the Builder reserves the right to substitute materials with those of equal or better quality where the manufacture, scheduling or delivery of materials may directly impact the Builder's ability to meet its' contractual obligations under the Agreement of Purchase and Sale.

D.4

UPGRADES/EXTRAS: All upgrades and additional selections indicated on the colour chart must be accompanied by an upgrades/extras sheet (PES) and full payment otherwise the selection will be invalid. All colour charts and upgrades/extras will not proceed until verified and signed by an authorized signing officer at the Vendor's head office. **CHANGES WILL NOT BE PERMITTED UPON COMPLETION AND SUBMISSION OF THE COLOUR CHART.**

D.4

PORCELAIN & NATURAL STONES: Due to the properties of natural stones including but not limited to marble, granite, quartz, no two pieces are exactly the same. Variations in colour, tone, granularity (pitting, fissures) and pattern are to be expected, including various lighting may affect the overall finished look. Stone tops are sealed at time of installation and should never be cleaned with lemon oil or vinegar. Stones are porous materials, therefore any spilled substance require immediate attention. Stone countertops require regular seal re-application as part of home maintenance. Purchaser acknowledges colour and product variations as well as natural imperfections may exist with the selection of natural stone materials and shall not hold the Vendor liable for provision of same.

D.4

STONE COUNTERTOP JOINTS: Purchaser is aware there may be joints in stone counter tops, in kitchens and vanities if applicable as per plan. Joints will also be applicable where the length of the counter top exceeds the length of a stone slab.

D.4

CERAMIC TILES: Due to manufacturing, shade (dye lots), product variations may exist that can affect the overall look of the finished product. Although every effort will be made to ensure the colours and materials selected are as close as possible to the samples, the purchaser acknowledges that the sample tiles supplied in the Design Centre may not be identical to the materials installed in the home.

D.4

STAIR STAINS: Due to the natural properties of wood, many variables can affect the overall look of the finished product. Factors including but not limited to wood type, knotting, graining, density, age, humidity, and air temperature can result in substantial variations in stain intensity. The purchaser accepts that although the Vendor will do their best to match stain the unfinished stairs as close as possible to the pre-finished floors, it is not possible to have an identical match and that there MAY be shade differences between the two products.

D.4

CABINETRY: Due to the natural properties of wood, slight variations apparent with cabinetry are to be expected. This includes but not limited to wood species, wood grain, colour, finish, product variations, and natural imperfections are all factors that may affect the overall look of the finished product. Such factors make exact colour matching impossible. The type and intensity of lighting in the areas of designated cabinetry placement may also highlight characteristics of cabinetry finish. All cabinets shall be finished with a white melamine interior box unless a finished interior is upgraded. Due to building specifications and/or on-site conditions, certain cabinetry upgrades may not be possible. The purchaser acknowledges that the Builder cannot guarantee the cabinetry finish or provision of certain upgrades and shall not hold the Builder liable for provision of same.

D.4

UPGRADES/EXTRAS: All upgrades and additional selections indicated on the colour chart must be accompanied by an upgrades/extras sheet (PES) and full payment otherwise the selection will be invalid. All colour charts and upgrades/extras will not proceed until verified and signed by an authorized signing officer at the Vendor's head office. **CHANGES WILL NOT BE PERMITTED UPON COMPLETION AND SUBMISSION OF THE COLOUR CHART.**

D.4

FLOOR TRANSITIONS: Transition strips will be used between

D.4

HARDWOOD / LAMINATE FLOORING: Due to the properties of wood and laminate, many variables can affect the overall look of the finished product. Variations include but not limited to wood type or laminate finish, colour/stain and wood grain are significant factors that make exact colour matching impossible. The purchaser acknowledges that the hardwood flooring is a pre-finished product in a controlled environment. Expansion, compression and cupping are characteristics of hardwood flooring once installed in the home. The purchaser acknowledges these may become apparent over time and despite the Builders' efforts to install the hardwood flooring materials in keeping with good workmanship, the Builder shall not be responsible nor held liable for minor variances of fluctuation in hardwood flooring materials.

D.4

HARDWOOD / LAMINATE WAIVER:

I/We understand hardwood flooring is classified as a porous material and as such not recommended by the Builder in certain areas. I/We understand there is a concern due to possible water and other substances being frequently splashed or spilled onto the floor and in contravention of Ontario Building Code Section 9.30.1.2(1).

"Finished flooring bathrooms, kitchens, public entrance halls, laundry & general storage areas shall consist of resilient flooring, felted-synthetic-fibre floor coverings, concrete, terrazzo, ceramic tile, mastic or other types of flooring providing similar degrees of water resistance."

D.4

I/We are prepared to assume full responsibility for any damage caused to the hardwood floor or subfloor due to moisture absorbency in the mentioned areas, and agree to waive any claims against the Township of residence, TARIION and/or the Builder in relation to the matter. ****SEE COLOUR CHART FOR LOCATIONS****

D.4

DATE

May 18/22

SITE

WASAGA RIVERS EDGE

LOT

293

HOME AUTOMATION (Cable, CAT5/6, Telephone)

INCLUDED IN SCHEDULE "A" IN AGREEMENT OF PURCHASE AND SALE:

- Rough-in for Central Vacuum system piped to garage
- Rough-in for Telephone (2) locations
- Rough-in for Cable TV (2) locations
- Rough-in for Cat-6 Network (3) locations

CONTACT:

I/we the Homeowner(s) have chosen to contact the Home Automation Company to select the locations of the rough-ins for Cable, CAT6, Telephone as included in our Agreement of Purchase Sale.

I/we the Homeowner(s) will contact the trade within 4 weeks of the date of this release to select locations of the standard rough-ins review other optional products for purchase.

Trade: Zyigma Lighting & Automation
Phone: (705) 715-1102

Email: info@zygmainc.ca

Location: 11 King Street, Unit 3
Barrie, Ontario L4N 6B5

ACKNOWLEDGEMENT:

I/We the homeowner(s) acknowledge that if I/We the homeowners decide to not contact Zyigma Lighting & Automation, locations of the standard rough-ins will be installed as per Vendors discretion.

DS
Homeowner(s) Initial

Homeowner(s) Initial

WASAGA RIVERS EDGE

DATE

SITE

LOT

Stone Countertop Edge Profiles

Where applicable as per site specifications

STANDARD EDGE FOR KITCHEN & VANITIES

Standard Countertop Edge in Kitchen

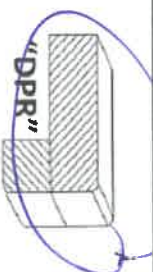

Standard Countertop Edge in Vanity

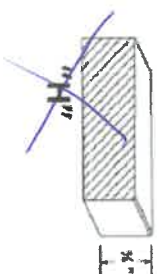

Homeowner(s) Initial *D.H.*

OPTION (1) EDGE FOR KITCHEN & VANITIES \$250

Optional Edge in Kitchen

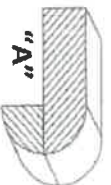
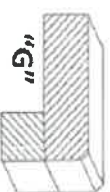
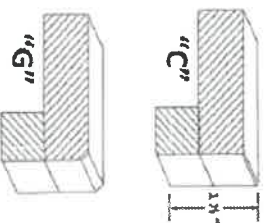

Optional Edge in Bathroom

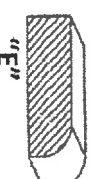
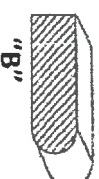
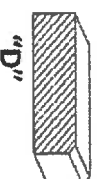

Homeowner(s) Initial *D*

OPTION (2) EDGE FOR KITCHEN & VANITIES CUSTOM PRICING

Optional Edge for Kitchen

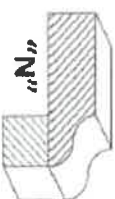
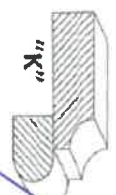
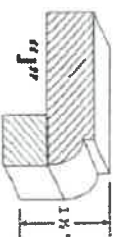
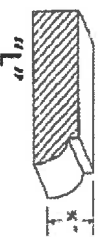

Optional Edge in Vanity

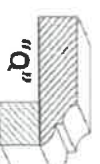
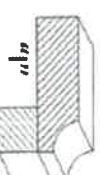
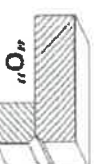
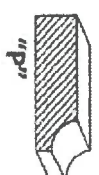

Homeowner(s) Initial

DATE

May 18 / 22

SITE

WASAGA RIVERS EDGE

LOT

297