

CONSTRUCTION SUMMARY OF EXTRAS

Printed 2022-06-29 / 1:32 PM / Page 1 of 1

Site:  
Lot:  
Model:  
Purchaser:  
Purchaser:  
Phone:  
Email:

RIVER'S EDGE WASAGA  
239  
WILLOW (43-07) ELEV C  
HONG MING DONG  
0  
289-396-6996  
TONYDONG888@HOTMAIL.COM



DESCRIPTION		DATE SELECTED
BONUS PACKAGE: STAINLESS STEEL HOOD FAN		INCLUDED IN APS
STRUCTURALS		
1	FRENCH DOORS AT REAR, 8 FEET HIGHT, (BOTH DOORS OPEN, MULTI POINT LOCK) IN LIEU OF SLIDING DOOR AS PER PLAN	08-Feb-22
2	QTY 2 SIDELITE INSTALLED - QTY 1- LEFT SIDE OF FRENCH DOOR, QTY 1- RIGHT SIDE OF FRENCH DOOR (12 INCHES WIDE)- SEE SKETCH	08-Feb-22
3	SMOOTH CEILING MAIN FLOOR	08-Feb-22
4	SMOOTH CEILING ON SECOND FLOOR	08-Feb-22
5	FIREPLACE- ELECTRIC 50" DIMPLEX BLF5051, WALL TO BE BUILT INTO THE ROOM APPROX 8" TO ACCOMMODATE.	08-Feb-22
6	GASLINE FOR STOVE, INCLUDES 15 AMP . 40 AMP TO REMAIN	08-Feb-22
7	QTY 2- 8 FOOT HIGH INTERIOR DOORS, IN LIEU OF STANDARD (6'8"), CLEARANCES PERMITTED- SEE SKETCH	08-Feb-22
8	AIR CONDITIONING UNIT	08-Feb-22
COLOURS		
1	ELECTRICAL- 2 CAPPED LIGHTS OVER KITCHEN ISLAND, SPACED EVENLY ON SEPARATE SWITCH.	21-Jun-22
2	1 POTLIGHT IN KITCHEN ON SAME SWITCH. DELETE STD LIGHT	21-Jun-22
3	ELECTRICAL-PLUG FOR FUTURE TV OVER FIREPLACE, INSTALL 65 A/F BESIDE CABLE- SEE SKETCH	21-Jun-22
4	CHIMNEY HOOD- DELETE UPPER CABINET AND CENTER VENTING- SEE SPEC	21-Jun-22
5	WATERLINE FOR FRIDGE	21-Jun-22
6	RISE AND CROWN INSTALLED OVER CABINETS. INSTALL CROWN AT CEILING, INCLUDES HORIZONTAL PANEL FOR ACROSS CHIMNEY HOOD- SEE SKETCH	21-Jun-22
7	FRIDGE ENCLOSURE- DEEP UPPER AND GABLES	21-Jun-22
8	BANK OF DRAWERS IN MASTER BATH AND SHARED	21-Jun-22
9	KITCHEN CABINET- UP 1	21-Jun-22
10	KITCHEN COUNTERTOP- UP 3	21-Jun-22
11	NA	21-Jun-22
12	NA	21-Jun-22
13	NA	21-Jun-22
14	NA	21-Jun-22
15	NA	21-Jun-22
16	HARDWOOD- FAMILY ROOM, LANDINGS, DEN, LIVING/DINING, UPPER HALL- UP 2	21-Jun-22
17	STAIN FOR STAIRS TO MATCH HARDWOOD AS CLOSE AS POSSIBLE- 1 FLIGHT	21-Jun-22
18	MASTER BATH CABINET- UP 1	21-Jun-22
19	MASTER BATH COUNTERTOP- UP 2, INCLUDES UNDERMOUNT SINKS	21-Jun-22
20	MASTER BATH SHOWER FLOOR- UP 2	21-Jun-22
21	ENSUITE BATH SHOWER FLOOR- UP 2	21-Jun-22
22	ENSUITE BATH CAB- UP 1	21-Jun-22
23	SHARED BATH CAB- UP 1	21-Jun-22
24	COMFORT HEIGHT- MASTER	21-Jun-22
25	ENSUITE 2 BATH COUNTERTOP- UP 2, INCLUDES UNDERMOUNT SINK	21-Jun-22
26	SHARED BATH COUNTERTOP- UP 2, INCLUDES UNDERMOUNT SINKS	21-Jun-22
27	HARDWARE FOR CABINETS	21-Jun-22
28	RAILING- UP 2	21-Jun-22
29	TRIM- TEMPORARY W/ BEVEL	21-Jun-22
30	PLUMBING- KITCHEN SINK- BLANCO 401518	21-Jun-22
31	PLUMBING- QTY 4- TOILET PAPER- MASTER, POWDER, ENSUITE, SHARED. QTY 3- 24" TOWEL BAR- MASTER, SHARED, ENSUITE	21-Jun-22
32	LAUNDRY ROOM BASE CABINET- UP 1	21-Jun-22
33	PLUMBING- UNDERMOUNT SINKS- RECTANGLE- QTY 2 MASTER, QTY 2 SHARED, QTY 1 ENSUITE	21-Jun-22

ZANCOR HOMES COLOUR CHART

PRINTED 2022-06-21, 3:04 PM

ENTRANCES					
Main Foyer - FLOORING		NEW BYZNATTINE ASSURO BLUE 12 X 24- STACKED			
Mudroom - FLOORING		NEW BYZNATTINE ASSURO BLUE 12 X 24- STACKED			
Side Hall - FLOORING		NA			
Basement Foyer - FLOORING		NA			
KITCHEN					
Kitchen - FLOORING		NEW BYZNATTINE ASSURO BLUE 12 X 24- STACKED			
Breakfast - FLOORING		NEW BYZNATTINE ASSURO BLUE 12 X 24- STACKED			
Kitchen - CABINETS		MOSAIC MDF GLACIER WHITE- UP 1			
Island - CABINETS		MOSAIC MDF GLACIER WHITE- UP 1			
Severy - CABINETS		NA			
Kitchen - HANDLES/KNOBS		H800MB			
Kitchen - COUNTERTOP		BORGHINI CLASSIC- UP 3			
Island - COUNTERTOP		BORGHINI CLASSIC- UP 3			
Kitchen - BACKSPLASH		DECLINED			
Kitchen - SINK		BLANCO 401518- SUPER SINGLE			
Kitchen - FAUCET		STD			
GREAT ROOM / DINING / LIVING / DEN / OFFICE / BASEMENT					
Family / Great Room - FLOORING		KENTWOOD BRUSHED OAK STONECROP 5" X 3/4"- UP 2			
Main Hall - FLOORING		KENTWOOD BRUSHED OAK STONECROP 5" X 3/4"- UP 2			
Dining / Living Room - FLOORING		KENTWOOD BRUSHED OAK STONECROP 5" X 3/4"- UP 2			
Library / Den - FLOORING		KENTWOOD BRUSHED OAK STONECROP 5" X 3/4"- UP 2			
Basement Rec Room - FLOORING		NA			
STAIRS					
Railing Details - PICKETS		BLACK METAL PLAIN- UP 2			
Railing Details - POSTS		3 1/4" SQUARE OAK POST W/ REVEAL- UP 2			
Railing Details - HANDRAIL		2 3/4" SQUARE OAK HANDRAIL- UP 2			
Stair Stain - MAIN STAIRS		STAIN STAIRS TO MATCH HARDWOOD AS CLOSE AS POSSIBLE			
Stair Stain - BASEMENT STAIRS (if applicable)		NA			
BEDROOMS / BATHROOMS / LAUNDRY					
Powder Room - FLOORING		NEW BYZNATTINE ASSURO BLUE 12 X 24- STACKED			
Powder Room - CABINETS		NA			
Powder Room - HARDWARE		NA			
Powder Room - COUNTERTOP		NA			
Powder Room - SINK		STD			
Powder Room - FAUCET		STD			
Laundry - FLOORING		NEW BYZNATTINE ASSURO BLUE 12 X 24- STACKED			
Laundry - CABINETS	(BASE)	MOSAIC MDF GLACIER WHITE- UP 1	Laundry - HANDLES/KNOBS		H800MB
Laundry - COUNTERTOP		5001K-07	Laundry - SINK		STD
Laundry - BACKSPLASH		NA	Laundry - FAUCET		STD
Upper Hall - FLOORING		KENTWOOD BRUSHED OAK STONECROP 5" X 3/4"- UP 2			
Master Bedroom - FLOORING		T03 OPENING NIGHT			
Bedroom 2 - FLOORING		T03 OPENING NIGHT			
Bedroom 3 - FLOORING		T03 OPENING NIGHT			
Bedroom 4 - FLOORING		T03 OPENING NIGHT			
Bedroom 5 - FLOORING		NA			
Master Ensuite - FLOORING		NEW BYZNATTINE ASSURO BLUE 12 X 24- STACKED			
Master Ensuite - SHOWER WALL		NEW BYZNATTINE ASSURO BLUE 12 X 24- STACKED VERTICAL			
Master Ensuite - SHOWER FLOOR		ONTARIO SREIES DARK GREY GLOSSY- UP 2			
Master Ensuite - SHOWER JAMB		BIANCO CARRARA			
Master Ensuite - CABINETS		MOSAIC MDF GLACIER WHITE- UP 1- COMFORT HEIGHT			
Master Ensuite - HANDLES/KNOBS		H800MB			
Master Ensuite - COUNTERTOP		CARRARA WHITE- UP 2			
Master Ensuite - SINK(s)	Rectable	Rectable 4220-CIV X 2	Master Ensuite - FAUCET(s)		STD
***FOR TRADE USE***					
Any upgrades in the colour chart must be accompanied with a PES. It is the responsibility of all Trades to inform the builder of any discrepancies on sketches, PES and/or colour charts PRIOR to installation.		RIVERS EDGE WASAGA 239			
				PURCHASER INITIALS	VENDOR APPROVAL

JUN 28 2022



2ND FLOOR CONTINUED...

Main Bath - FLOORING		NA	
Main Bath - TUB / SHOWER WALL		NA	
Main Bath - SHOWER FLOOR		NA	
Main Bath - SHOWER JAMB		NA	
Main Bath - CABINETS		NA	
Main Bath - HANDLES/KNOBS		NA	
Main Bath - COUNTERTOP		NA	
Main Bath - SINK(S)	NA	Main Bath - FAUCET(S)	NA
Shared Bath - FLOORING	NEW BYZANTINE ASSURO BLUE 12 X 24- STACKED		
Shared Bath- TUB / SHOWER WALL	NEW BYZANTINE ASSURO BLUE 12 X 24- STACKED VERRTICAL		
Shared Bath- SHOWER FLOOR	NA		
Shared Bath- SHOWER JAMB	NA		
Shared Bath- CABINETS	MOSAIC MDF GLACIER WHITE- UP 1-		
Shared Bath- HANDLES/KNOBS	H800MB		
Shared Bath- COUNTERTOP	CARRARA WHITE- UP 2		
Shared Bath- SINK(S)	Rectangular 4220-CIV	Shared Bath - FAUCET(S)	STD
Ensuite Bath - FLOORING	NEW BYZANTINE ASSURO BLUE 12 X 24- STACKED		
Ensuite Bath - TUB / SHOWER WALL	NEW BYZANTINE ASSURO BLUE 12 X 24- STACKED VERRTICAL		
Ensuite Bath - SHOWER FLOOR	ONTARIO SREIJS DARK GREY GLOSSY- UP 2		
Ensuite Bath - SHOWER JAMB	BIANCO CARRARA		
Ensuite Bath - CABINETS	MOSAIC MDF GLACIER WHITE- UP 1-		
Ensuite Bath - HANDLES/KNOBS	H800MB		
Ensuite Bath - COUNTERTOP	CARRARA WHITE- UP 2		
Ensuite Bath - SINK(S)	Rectangular 4220-CIV	Ensuite Bath - FAUCET(S)	STD
TRIM / PAINT			
Casing/Baseboards	CONTEMPORARY 2 W/ BEVEL		
Interior Door STYLE	STD		
Interior Door HEIGHT	8 FOOT DOORS- QTY 2- SEE SKETCH		
Interior Door Hardware	STD		
PAINT - Throughout	COOL WHITE		
FIREPLACE			
Location / Inset / Mantle	50" DIMPLEX		
ACCESSORIES			
Mirrors	YES	BATH ACCESSORIES	UPGRADE
APPLIANCE REQUIREMENTS			
GAS LINE TO BBQ	STD	ELECTRICAL for Built-in Oven	DECLINED
GAS LINE & ELECTRICAL TO STOVE	YES	ELECTRICAL for Built-in Micro	DECLINED
GAS LINE & ELECTRICAL TO DRYER	DECLINED	ELECTRICAL for Cooktop	DECLINED
HOOD FAN VENT SIZE	6" STD	ELECTRICAL for Bar Fridge	DECLINED
WATERLINE to Fridge	YES		
DISCLAIMER			
Any changes to the colour chart after signing are subject to a <b>\$5000</b> administration fee plus costs			
Purchaser has checked and acknowledged accuracy of colour and selections before signing.			
Colours of all materials are as close as possible to Builders selection but not necessarily identical due to dye lot variances in manufacturing/manufacturers. Due to construction progress some items may have been pre-selected or installed. In this event the Vendor's selection must be accepted by the purchaser			
SITE / LOT:	RIVER'S EDGE WASAGA		239 ✓
PURCHASER(S):	HONG MING DONG		
PURCHASER(S):	0		
PHONE #:	289-396-6996		
EMAIL:	TONYDONG888@HOTMAIL.COM		
***FOR TRADE USE***			
Any upgrades in the colour chart must be accompanied with a PES. It is the responsibility of all Trades to inform the builder of any discrepancies on sketches, PES and/or colour charts <u>PRIOR</u> to installation.			
ZANCOR HOMES		PURCHASER SIGNATURE	JILLIAN
		PURCHASER SIGNATURE	
		DÉCOR CONSULTANT	
***PAGE 2 OF 2**		Vendor APPROVAL	JUN 22 2022

Lot 239  
June 21/22

# 43-07 WILLOW (Elev. C)

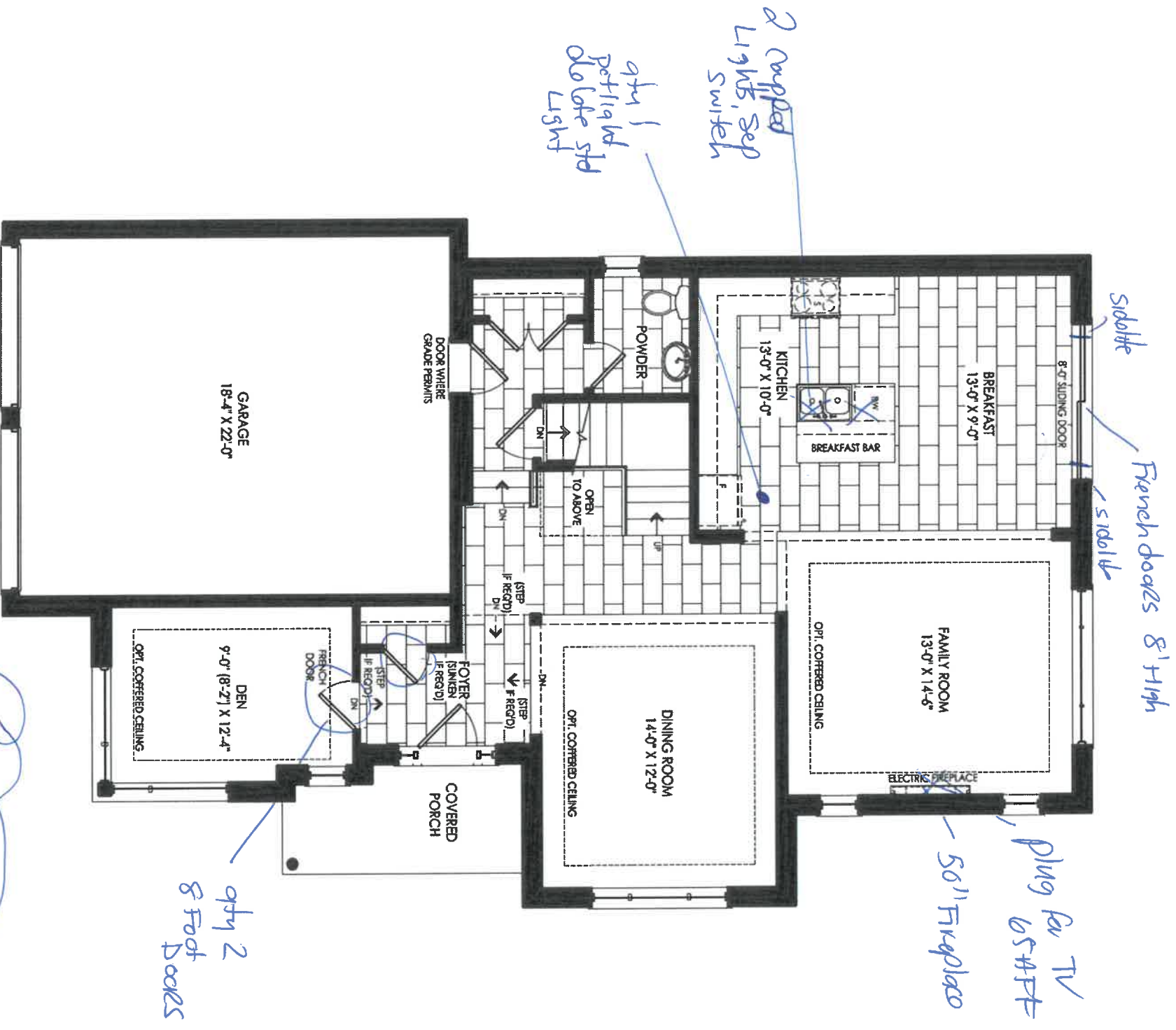

MAIN FLOOR ELEVATION C

76

Lot 239  
June 21/22

# 43-07 WILLOW (Elev. C)

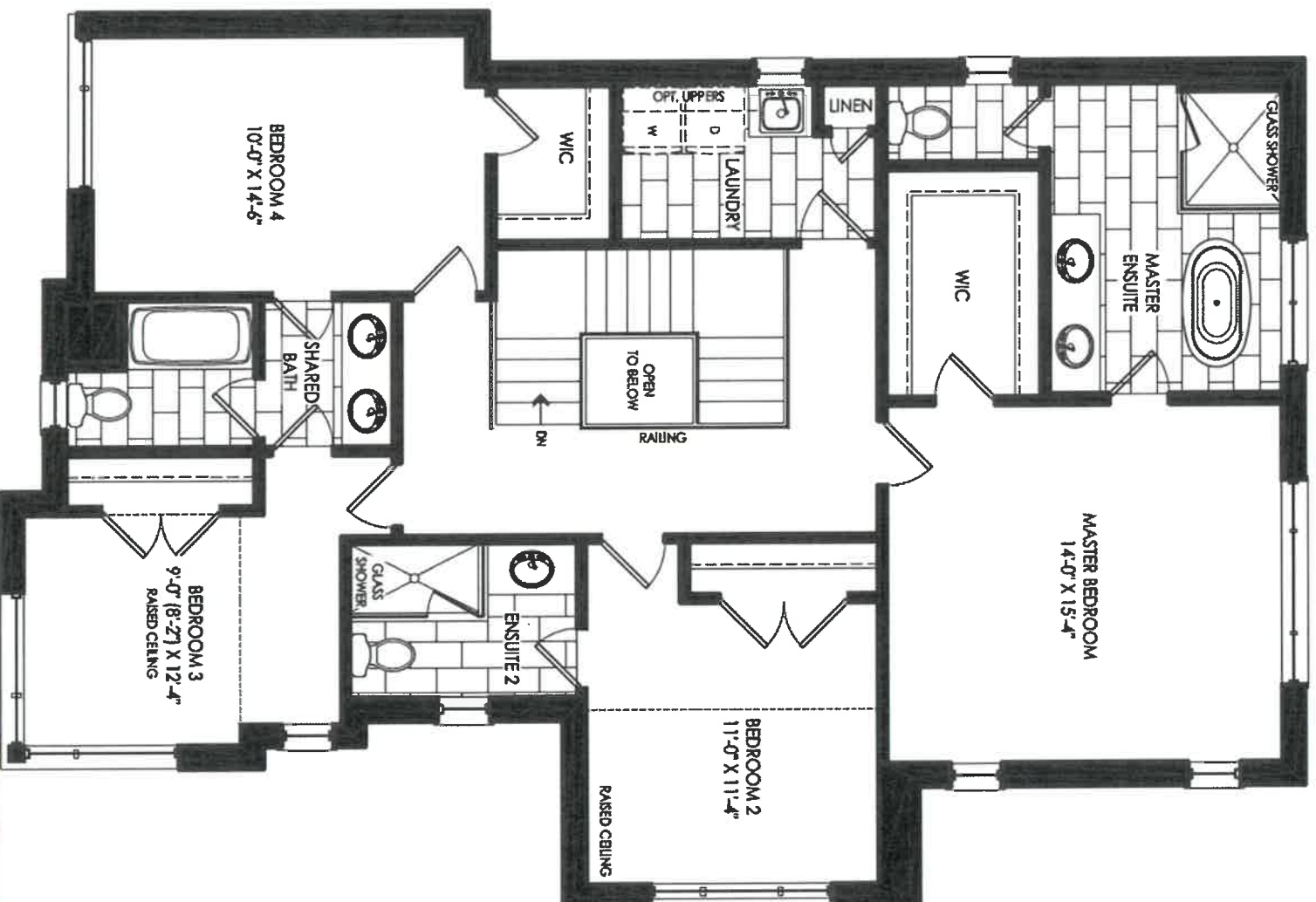

SECOND FLOOR ELEVATION C

Smooth  
ceilings

2

lot 239

June 21/22

# 43-07 WILLOW (Elev. C)

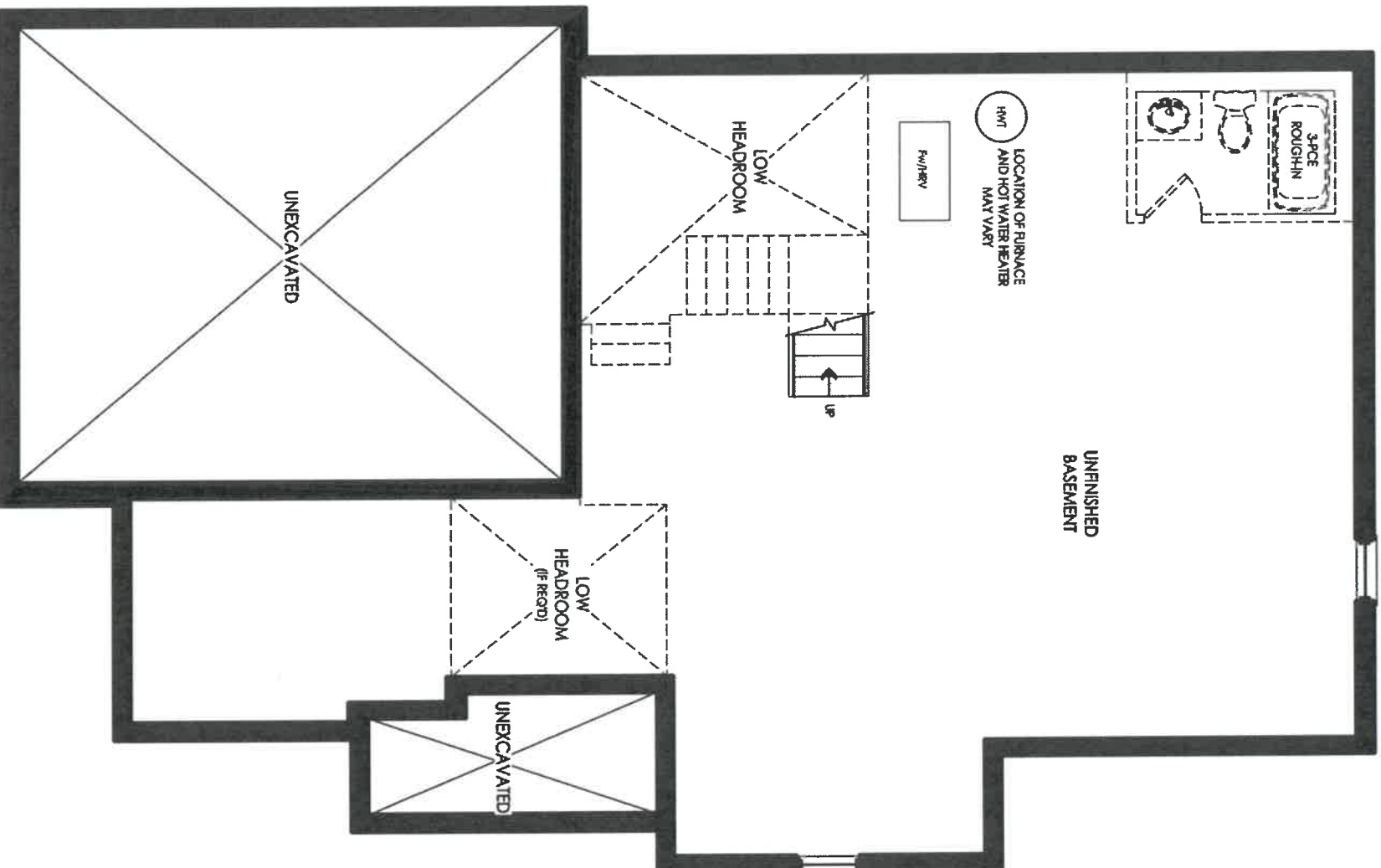

BASEMENT ELEVATION C

th





1 of 239  
June 21/22

Product Specification Sheet

QUATRUS R15 U SUPER SINGLE

Satin brushed finish



PRODUCT DIMENSIONS



QUATRUS R15 U SUPER SINGLE	Colour Finish	Model No.	FEATURES / SPECIFICATIONS
-------------------------------	---------------	-----------	---------------------------



Satin brushed  
finish

401518

- German engineered with 304 series, 18-gauge stainless steel
- Practical 15 mm radius corners for easy cleaning
- X-pattern drain grooves quickly remove water from the sink
- Extra-large bowl size is ideal for busy families
- 18/10 chrome-nickel content for exceptional lustre and strength
- Rear-positioned drain holes maximize cabinet storage space

DESIGN AND PLANNING TIPS

Cabinet Size: 36" (915 mm)  
Bowl depth: 9" (230 mm)  
Depending on cabinet construction, a different cabinet size may be required.  
Consult the cabinet manufacturer.

WARRANTY

Limited Lifetime warranty

Code/Standards Compliance

BLANCO sinks and faucets are third-party tested and certified to CSA, cUPC, ANSI/ASME and NSF standards and listed by applicable certification bodies. For more information on individual product listings, contact our office or listing organization.

BLANCO CANADA 100 Corporation Drive Brampton, ON L6S 6B5	Tel: 905 494 2400 Fax: 905 494 2425 www.blancocanada.com	Toll Free: 1 877 425 2626 Toll Free: 1 877 825 2626	© 2016 BLANCO CANADA
--	--	--	----------------------

Kitchen  
Sink

Top



1 of 239  
Juno 21/22

# Method™

Traditional | Transitional | Modern



**Double Robe Hook**  
Model YB2403

Chrome  
Other



**Pivoting Paper Holder**  
Model YB2408

Chrome  
Other



**18" Towel Bar**  
Model YB2418

Chrome  
Other



**24" Towel Bar**  
Model YB2424

Chrome  
Other



**9" Towel Bar**  
Model YB2406

Chrome  
Other

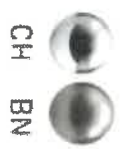

**FINISH OPTIONS:**  
To order, combine the model number with one of these finish letter(s):  
Chrome (CH), LifeShine® Brushed Nickel (BN).

For



## **Prism Series** 50" Linear Electric Fireplace

BLF5051

The best-selling linear fireplace is now even better.



The best-selling electric linear fireplace just got better with the all new Prism Series. Sparkling with intensity in a full spectrum of colors, the Prism effect illuminates the diamond-like acrylic ice ember bed in a show-stopping effect. Plug-in or hard-wire, hung on the wall or built-in; the Prism Series is beautifully versatile.

**PRISM**  
series

239

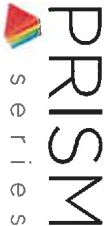

Prism Series  
50" Linear Electric Fireplace

BLF5051

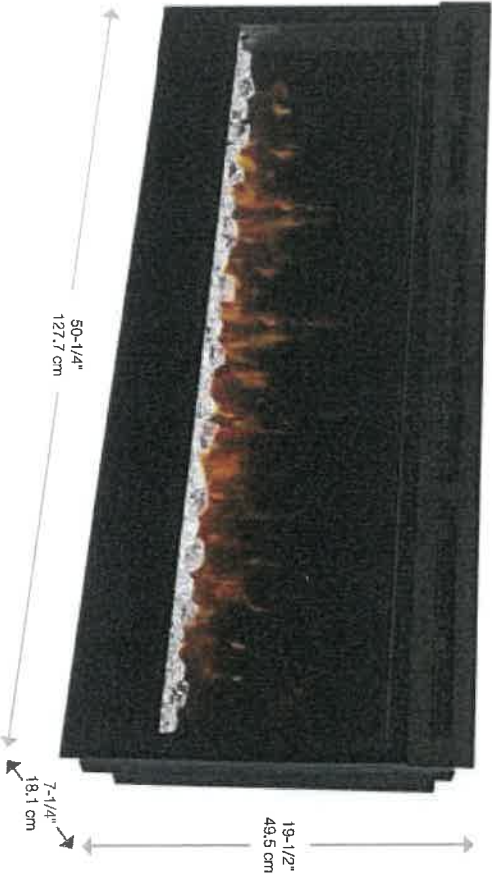

Accessories

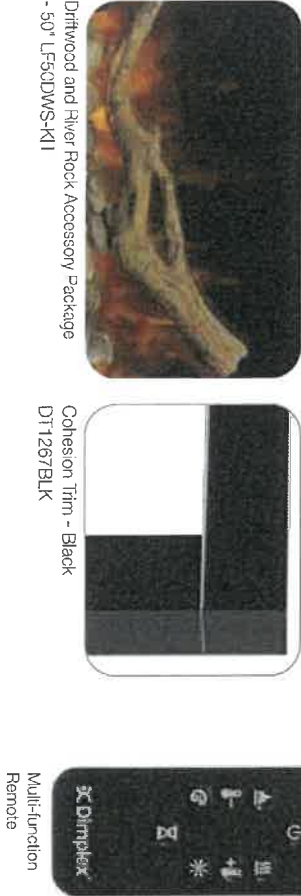

Model #	Description	Lbs / Kg	UPC	Warranty	Carton Dimensions (WxHxD)		Cube	
					Inches	cm	ft <sup>3</sup>	m <sup>3</sup>
BLF5051	50" Linear Electric Fireplace	75 / 34.1	781052 098787	2 yr.	55 x 23-1/4 x 12-7/8	139.7 x 58.9 x 32.7	9.5	0.26
DT1267BLK	Cohesion Trim - Black	51 / 23.1	781052 080355	1 yr	64-7/8 x 26-1/4 x 8-3/4	164.8 x 66.8 x 22.1	8.6	0.24
LF50DWS-KIT	50" Driftwood and River Rock Accessory Kit	7 / 3.17	781052 102842		34-1/4 x 5-7/8 x 8-1/8	87.2 x 14.98 x 20.6		

Specifications, finishes and dimensions are subject to change. \*Limited warranty. ©2020 Glen Dimplex Americas  
Glen Dimplex Americas | 1-800-668-6663 | [www.dimplex.com](http://www.dimplex.com)

Features

- The Original Dimplex Flame Effect™**  
A blend of technology, artistry and craftsmanship that sets the standard for realism.
- Acrylic Ice Media Bed**  
Light plays through different size pieces and sparkle in a spectrum of colors.
- Media Accent Colors**  
Choose from a variety of brilliant color themes or cycle through a range of colors using the custom mode, freezing on the hue of your choice.
- Flexible Installation**  
Simply surface mount and plug-in or fully-recess and direct wire for a seamless installation
- Hanging Glass Design**  
Detachable glass trim easily finishes rough openings and provides access to media.
- Remote Thermostat Control**  
Temperature control at your fingertips for convenient comfort.
- Multi-function Remote**  
Control the flame, heat and thermostat from the comfort of your chair.
- LED Lighting**  
Flame and lights use brilliant, low-energy LED's that require zero maintenance.
- All-season Flames**  
Enjoy the unique charm of a fireplace 365 days a year using the flames without the heat.
- Cool-touch Glass**  
Glass remains cool making it safe for any location and any user.
- Low Carbon Footprint**  
The most sustainable fireplace option; no emissions and 100% efficient.

SE-022-R06-041520

239

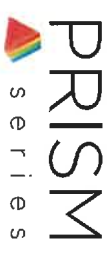

# Prism Series

## 50" Linear Electric Fireplace

BLF5051

### Product Dimensions:

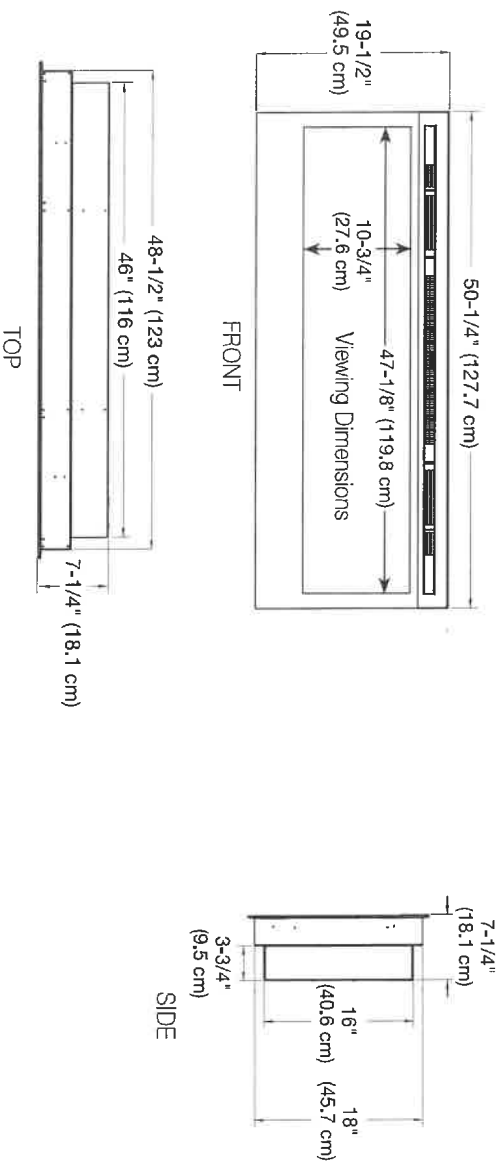

### Installation Options and Framing Dimensions

#### 3 Mounting Options

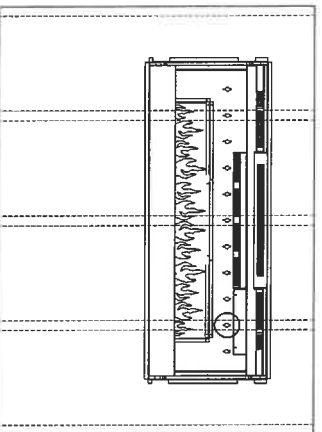

**ON WALL**

Must mount to a minimum of three (3) wall studs

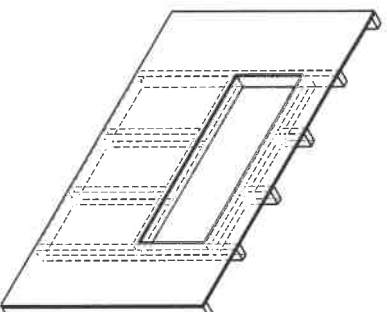

**PARTIAL RECESSED**

2 X 4 Wall Construction  
Framing dimensions:  
46-1/2" W x 16-1/2" H  
(118.1 cm) W x (42 cm) H

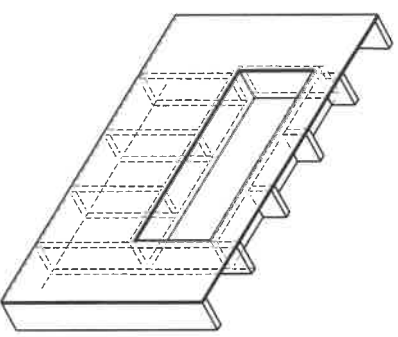

**FULLY RECESSED**

2 X 8 Wall Construction  
Framing dimensions:  
49" W x 18-1/2" H  
(124.5 cm) W x (47 cm) H

239



CLIENT NAME: ZANCOR HOMES  
SHIP TO: Rivers Edge Sunnisdale Trails  
#43-07

PH:  
CELL:

OB NUMBER  
INSTALL DATE:  
PAGE  
1 of 2

DATE SUBMITTED  
01 Mar 2022

**DRAFTED BY:** Binita  
**COMMENT**

P/O #

1 of 2

Oct 239  
June 21/22

- ① chimney Hood
- ② Tndgr enclosure
- ③ Riser + Crown installed ceiling

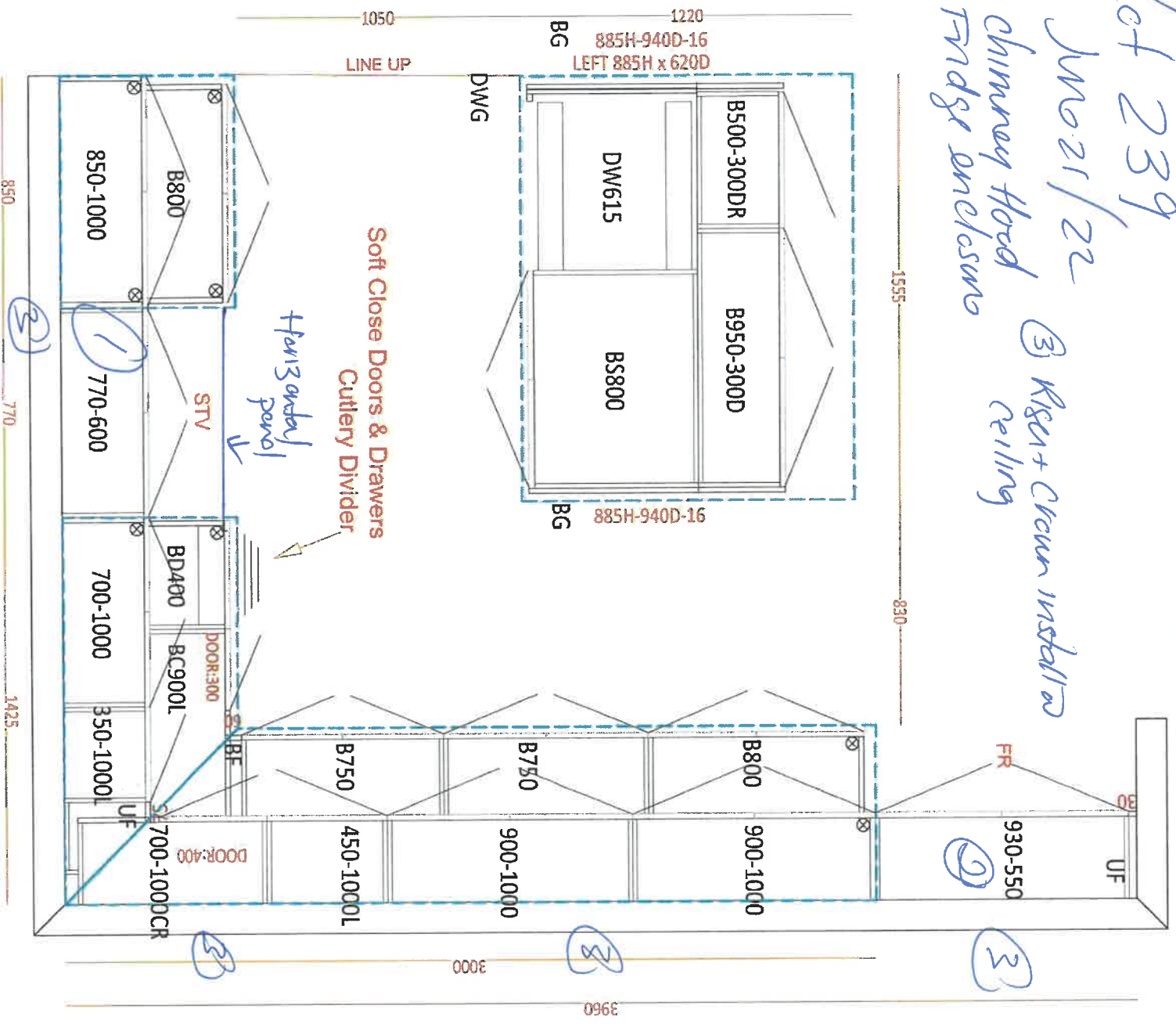

## Kitchen

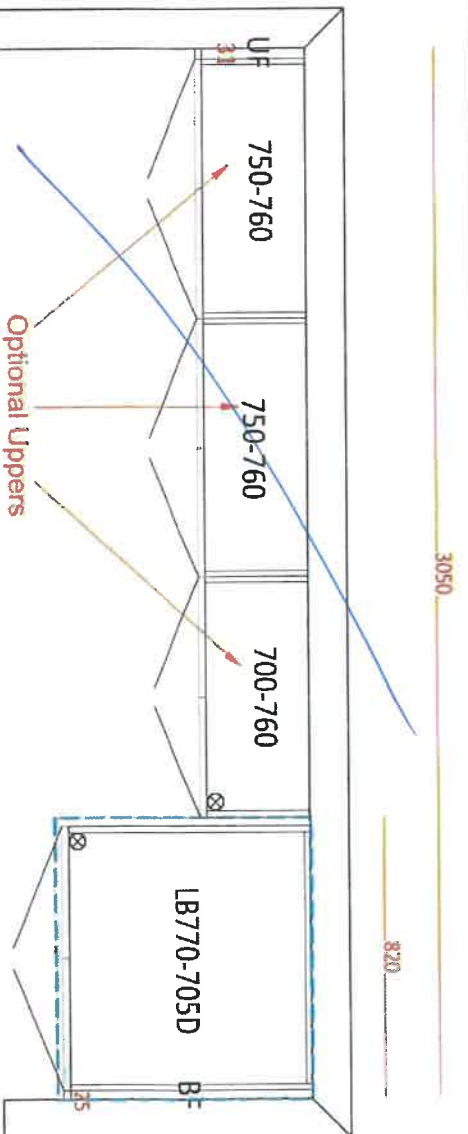

## Laundry



CLIENT NAME: ZANCOR HOMES  
SHIP TO : Rivers Edge Sunnisdale Trails  
#A3-07

PH:  
CELL:

JOB NUMBER

INSTALL DATE:

PAGE  
2 of 2

DATE SUBMITTED

01 Mar 2022

DRAFTED BY: Binita

COMMENT

P/O #

lot 239  
June 21/22

1160  
1160

Ensuite 2

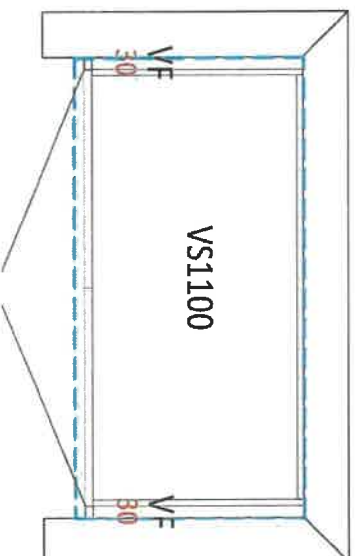

1720  
1720

Twin Bath

Back of drawers

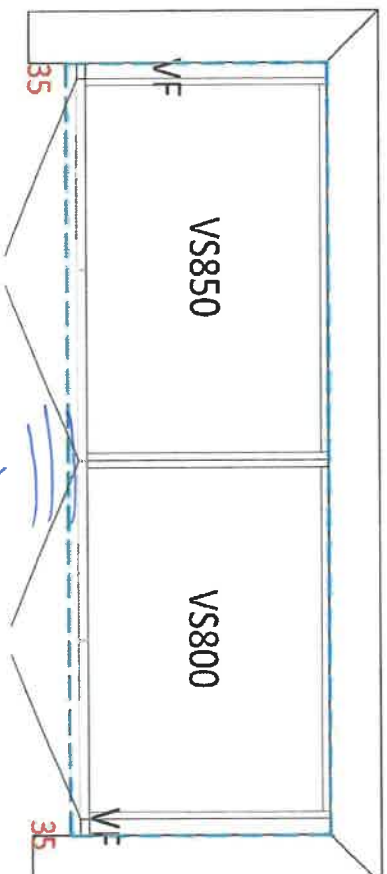

2150  
2150

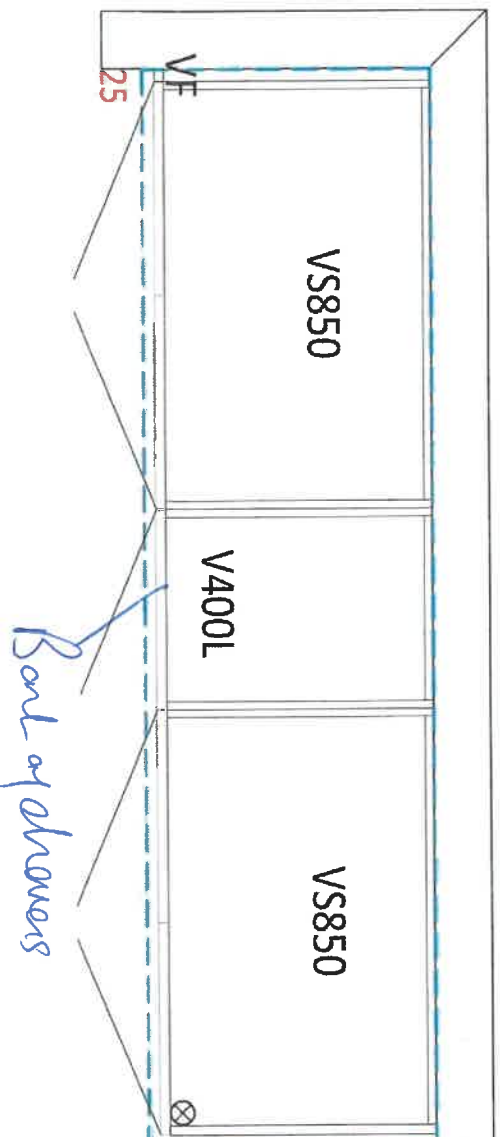

Back of drawers

Master Ensuite - corner height

116

## APPLIANCE ACKNOWLEDGEMENT

**CONTACT: Steve Miller - Appliance Canada (905) 660-2424 / smiller@appliancecanada.com**

- **It is the Purchaser's responsibility to coordinate delivery, installation and hook up of appliances and to ensure they are installed as per Manufacturers specifications after closing.**

**STANDARD APPLIANCE OPENINGS provided by Zancor:**

\*Standard appliance openings are approximate and the minimum required. Sizes may vary due to on-site condition and/or when modifications have been made to the cabinetry.

- Fridge Opening 36" x 74"
- Stove Opening 30"
- Hood Fan Opening 30"
- Hood Fan & Vent 6" with Under Cabinet Hood
- Dishwasher Opening 24"

Accepts Standard  
Openings \*\*Initial

Tcy

**OPTIONAL UPGRADED APPLIANCES to be provided by Homeowner:**

- **\*\*Specs/information sheets are required and it is the responsibility of the homeowner to provide this to Zancor Homes by the due date that has been provided. If appliance specs are not submitted, Zancor Homes will not be responsible for any necessary requirements and the standard opening will be built.**

Tcy

- **Upgraded Appliance Specs are DUE 2 WEEKS FROM SIGNED DATE OF COLOUR CHART (if not received during appointment)**

INITIAL

- **\*\*Specs that require changes/modifications after this date will not be accepted\*\*\***

- **NOTE: Any upgraded appliances are to be paid by the Purchaser, directly to the appliances company.**

- **Additional charges to the Purchaser may apply for cabinetry, electrical and plumbing in order to accommodate the specs given by the homeowner.**

**FRIDGE UPGRADE**

- ☐ Built-in
- ☐ Paneled \*\*Panel to match required
- ☐ Integrated / Flush Inset
- ☒ Waterline

**RANGE UPGRADE**

\*Larger hood fan CFM might be required, which need a larger vent

- ☐ 36" \*\*Hood fan opening must be the same size or larger (8" vent might be required)
- ☐ 48" \*\*Hood Fan opening must be the same size or larger (8" or 10" vent required)
- ☒ Gas Range \*\*gas line and electrical required & sold separately
- ☐ Induction \*\*electrical required & sold separately
- ☐ Cooktop (Apron Front) \*\*Countertop Cut-out required & sold separately
- ☐ Cooktop (Drop-in) \*\*countertop Cut-out required & sold separately

**HOOD FAN & VENT****UPGRADE**

- ☐ 8 Inch \*\*Required for 600 CFM
- ☐ 10 Inch
- ☒ Chimney Hood Fan \*\*Vent must be centred
- ☐ Insert / Liner

**WALL OVEN/MICRO****UPGRADE**

\*\*Electrical required

- ☐ Single Wall Oven \*\*electrical required & sold separately
- ☐ Double Wall Oven \*\*electrical required & sold separately
- ☐ Steam Oven \*\*electrical required & sold separately
- ☐ Warming Drawer \*\*electrical required & sold separately
- ☐ Over Then Range Microwave (OTR)
- ☐ Built-In Microwave \*\*Trim Kit required \*\*electrical required & sold separately

DATE

June 21/22

WASAGA RIVERS EDGE

SITE

LOT

239

\*\* Any upgrades checked in this appliance form must be accompanied with specs provided by the Purchaser.

\*\*It is the responsibility of the trade to inform the Builder of any discrepancies with specs, sketches, extras and/or colour chart PRIOR to production/installation.

ZANCOR

221 North Rivermede Road, Concord, Ontario L4K 3N7 \* T: (905) 738.7010 F: (905) 738.5948



## INTERIOR FINISHES ACKNOWLEDGEMENT / WAIVER

Purchaser accepts and acknowledges that the Builder reserves the right to substitute materials with those of equal or better quality where the manufacture, scheduling or delivery of materials may directly impact the Builder's ability to meet its' contractual obligations under the Agreement of Purchase and Sale.

**UPGRADES/EXTRAS:** All upgrades and additional selections indicated on the colour chart must be accompanied by an upgrades/extras sheet (PES) and full payment otherwise the selection will be invalid. All colour charts and upgrades/extras will not proceed until verified and signed by an authorized signing officer at the Vendor's head office. **CHANGES WILL NOT BE PERMITTED UPON COMPLETION AND SUBMISSION OF THE COLOUR CHART.**

**PORCELAIN & NATURAL STONES:** Due to the properties of natural stones including but not limited to **marble, granite, quartz**, no two pieces are exactly the same. Variations in colour, tone, granularity (pitting, fissures) and pattern are to be expected, including various lighting may affect the overall finished look. Stone tops are sealed at time of installation and should never be cleaned with lemon oil or vinegar. Stones are porous materials, therefore any spilled substance require immediate attention. Stone countertops require regular seal re-application as part of home maintenance. Purchaser acknowledges colour and product variations as well as natural imperfections may exist with the selection of natural stone materials and shall not hold the Vendor liable for provision of same.

**STONE COUNTERTOP JOINTS:** Purchaser is aware there may be joints in stone counter tops, in kitchens and vanities if applicable as per plan. Joints will also be applicable where the length of the counter top exceeds the length of a stone slab.

**CERAMIC TILES:** Due to manufacturing, shade (dye lots), product variations may exist that can affect the overall look of the finished product. Although every effort will be made to ensure the colours and materials selected are as close as possible to the samples, the purchaser acknowledges that the sample tiles supplied in the Design Centre may not be identical to the materials installed in the home.

**STAIR STAINS:** Due to the natural properties of wood, many variables can affect the overall look of the finished product. Factors including but not limited to wood type, knotting, graining, density, age, humidity, and air temperature can result in substantial variations in stain intensity. The purchaser accepts that although the Vendor will do their best to match stain the unfinished stairs as close as possible to the pre-finished floors, it is not possible to have an identical match and that there MAY be shade differences between the two products.

**CABINETRY:** Due to the natural properties of wood, slight variations apparent with cabinetry are to be expected. This includes but not limited to wood species, wood grain, colour, finish, product variations, and natural imperfections are all factors that may affect the overall look of the finished product. Such factors make exact colour matching impossible. The type and intensity of lighting in the areas of designated cabinetry placement may also highlight characteristics of cabinetry finish. All cabinets shall be finished with a white melamine interior box unless a finished interior is upgraded. Due to building specifications and/or on-site conditions, certain cabinetry upgrades may not be possible. The purchaser acknowledges that the Builder cannot guarantee the cabinetry finish or provision of certain upgrades and shall not hold the Builder liable for provision of same.

**UPGRADES/EXTRAS:** All upgrades and additional selections indicated on the colour chart must be accompanied by an upgrades/extras sheet (PES) and full payment otherwise the selection will be invalid. All colour charts and upgrades/extras will not proceed until verified and signed by an authorized signing officer at the Vendor's head office. **CHANGES WILL NOT BE PERMITTED UPON COMPLETION AND SUBMISSION OF THE COLOUR CHART.**

**FLOOR TRANSITIONS:** Transition strips will be used between all different floor surfaces

**HARDWOOD / LAMINATE FLOORING:** Due to the properties of wood and laminate, many variables can affect the overall look of the finished product. Variations include but not limited to wood type or laminate finish, colour/stain and wood grain are significant factors that make exact colour matching impossible. The purchaser acknowledges that the hardwood flooring is a pre-finished product in a controlled environment. Expansion, compression and cupping are characteristics of hardwood flooring once installed in the home. The purchaser acknowledges these may become apparent over time and despite the Builders' efforts to install the hardwood flooring materials in keeping with good workmanship, the Builder shall not be responsible nor held liable for minor variances of fluctuation in hardwood flooring materials.

### HARDWOOD / LAMINATE WAIVER:

I/We understand hardwood flooring is classified as a porous material and as such not recommended by the Builder in certain areas. I/We understand there is a concern due to possible water and other substances being frequently splashed or spilled onto the floor and in contravention of Ontario Building Code Section 9.30.1.2(1).

*"Finished flooring bathrooms, kitchens, public entrance halls, laundry & general storage areas shall consist of resilient flooring, felted-synthetic-fibre floor coverings, concrete, terrazzo, ceramic tile, mastic or other types of flooring providing similar degrees of water resistance."*

I/We are prepared to assume full responsibility for any damage caused to the hardwood floor or subfloor due to moisture absorbency in the mentioned areas, and agree to waive any claims against the Township of residence, TARIION and/or the Builder in relation to the matter. **\*\*SEE COLOUR CHART FOR LOCATIONS\*\***

DATE	Mo 21/22	SITE	WASAGA RIVERS EDGE	LOT	Q39
------	----------	------	--------------------	-----	-----



## HOME AUTOMATION (Cable, CAT5/6, Telephone)

**INCLUDED IN SCHEDULE "A" IN AGREEMENT OF PURCHASE AND SALE:**

- Rough-in for Central Vacuum system piped to garage
- Rough-in for Telephone (2) locations
- Rough-in for Cable TV (2) locations
- Rough-in for Cat-6 Network (3) locations

**CONTACT:**

I/we the Homeowner(s) have chosen to contact the Home Automation Company to select the locations of the rough-ins for Cable, CAT6, Telephone as included in our Agreement of Purchase Sale.

I/we the Homeowner(s) will contact the trade within 4 weeks of the date of this release to select locations of the standard rough-ins review other optional products for purchase.

**Trade:** Zygya Lighting & Automation  
**Phone:** (705) 715-1102  
**Email:** [info@zygmainc.ca](mailto:info@zygmainc.ca)  
**Location:** 11 King Street, Unit 3  
Barrie, Ontario L4N 6B5

**ACKNOWLEDGEMENT:**

I/We the homeowner(s) acknowledge that if I/We the homeowners decide to not contact Zygya Lighting & Automation, locations of the standard rough-ins will be installed as per Vendors discretion.

TL

Homeowner(s) Initial

Homeowner(s) Initial

WASAGA RIVERS EDGE

1 Dec 1/22

SITE

LOT

239

## FLOOR TILES

(Large tiles installation for floor and wall) – ¼ Brick

**BRICK installation is included as a standard on the FLOOR for 12 x 24 tiles and must be noted on the colour chart and acknowledged on this form \***

Please be advised it has come to our attention, that due to production, many of the over-sized and odd shaped, man-made tiles (i.e. porcelain & ceramic), have been found to have a slight bow in the tile. It is a standard occurrence with all suppliers and manufacturers.

It is therefore recommended, that if and when a purchaser requests to install one of these tiles in a brick-joint pattern, that it be installed in a ¼ brick pattern, to try to avoidlippage. Attached with this letter, you will find a layout of the ¼ brick installation that has been recommended.

### BRICK install - floor locations:

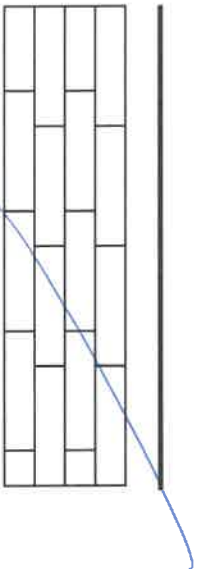

### STACKED install - floor locations:



Please understand, even in using this ¼ brick installation, there may still be minimal lippage which cannot fully be eliminated. Hence, when there is a request for brick-joint installation, Zancor Homes and their contractor, cannot be held responsible for this matter.

*TL*

Homeowner(s) Initial

## WALL TILES

(Tile installation for walls) – ½ Brick

**\*\*\*BRICK installation on WALLS are NOT INCLUDED. This optional extra must be added to the extras form along with a note on the colour chart**

Purchaser requests to install small wall tiles on a backsplash or shower wall in a brick-joint pattern, that it be installed on a ½ brick pattern.

### STACKED install (horizontal) - wall locations:

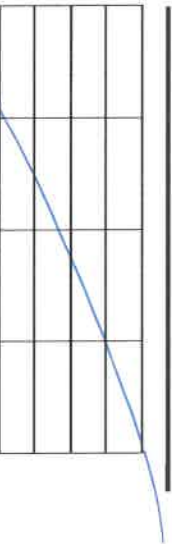

### \*\*\*BRICK install (horizontal)- wall locations:

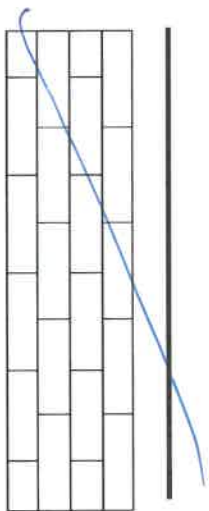

### STACKED install (vertical) - wall locations:



Homeowner(s) Initial

*TL*

DATE

*June 21/22*

SITE

**RIVERS EDGE**

LOT

*239*

Stone Countertop Edge Profiles

\*\*Where applicable as per site specifications\*\*

STANDARD EDGE FOR KITCHEN & VANITIES

Standard Countertop Edge in  
Kitchen



Standard Countertop Edge in  
Vanity

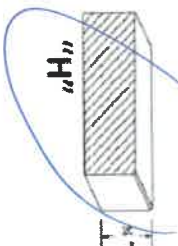

X 24

Homeowner(s) Initial

OPTION (1) EDGE FOR KITCHEN & VANITIES \$250

Optional Edge in Kitchen

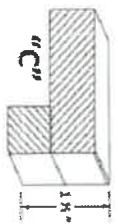

Optional Edge in Bathroom

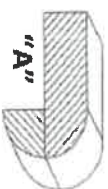
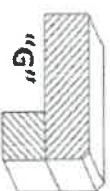
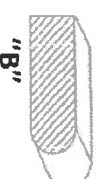

Homeowner(s) Initial

OPTION (2) EDGE FOR KITCHEN & VANITIES CUSTOM PRICING

Optional Edge for Kitchen

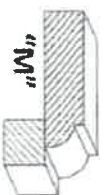
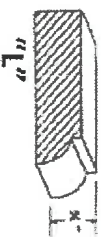

Optional Edge in Vanity

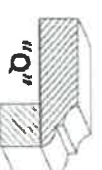
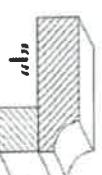
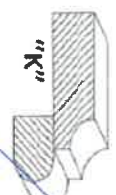
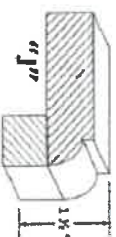
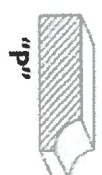

Homeowner(s) Initial

DATE

June 21/22

SITE

WASAGA RIVERS EDGE

LOT

Q39