

CONSTRUCTION SUMMARY OF EXTRAS

Printed 2022-06-02 / 4:13 PM / Page 1 of 1

Site: RIVER'S EDGE WASAGA  
Lot: 305  
Model: NIPPISSING (50-06) ELEV C  
Purchaser: ANEES, AHMED ATTHAWAL  
Purchaser: 0  
Phone: 416.450.8022  
Email: ANESATTHWAL690@GMAIL.COM



| DESCRIPTION |  | DATE SELECTED   |
|-------------|--|-----------------|
|             | BONUS PACKAGE: STAINLESS STEEL HOOD FAN  | INCLUDED IN APS |
|             |  |                 |
|             |  |                 |
|             | STRUCTURALS  |                 |
| 1           | NO STRUCTURAL CHANGES  | 01-Mar-22       |
|             | COLOURS  |                 |
| 1           | ELECTRICAL- 2 CAPPED LIGHTS OVER KITCHEN ISLAND, SPACED EVENLY ON SEPARATE SWITCH. STD LIGHT TO REMAIN | 26-May-22       |
| 2           | ELECTRICAL- PLUG OVER FIREPLACE FOR FUTURE TV, INSTALLED 65 AFF  | 26-May-22       |
| 3           | NA   | 26-May-22       |
| 4           | NA   | 26-May-22       |
| 5           | NA   | 26-May-22       |
| 6           | BANK OF DRAWERS IN MASTER AND SHARED   | 26-May-22       |
| 7           | KITCHEN COUNTERTOP- UP 2   | 26-May-22       |
| 8           | NA   | 26-May-22       |
| 9           | HARDWOOD- UP 3- FAMILY ROOM, LANDINNGS, MAIN HALL, LIVING/DINING, DEN, UPPER HALL                      | 26-May-22       |
| 10          | STAIN FOR STAIRS TO MATCH HARDWOOD AS CLOSE AS POSSIBLE- 1 FLIGHT                                      | 26-May-22       |
| 11          | RAILING - UP 2   | 26-May-22       |

ZANCOR HOMES COLOUR CHART

| ENTRANCES  |   |                              |     |  |
|--|---|------------------------------|-----|--|
| Main Foyer - FLOORING  | NEW BYZANTINE ASSURO BLUE 12 X 24- STACKED          |                              |     |  |
| Mudroom - FLOORING   | NEW BYZANTINE ASSURO BLUE 12 X 24- STACKED          |                              |     |  |
| Side Hall - FLOORING   | NA  |                              |     |  |
| Basement Foyer - FLOORING  | NA  |                              |     |  |
| KITCHEN  |   |                              |     |  |
| Kitchen - FLOORING   | NEW BYZANTINE ASSURO BLUE 12 X 24- STACKED          |                              |     |  |
| Breakfast - FLOORING   | NEW BYZANTINE ASSURO BLUE 12 X 24- STACKED          |                              |     |  |
| Kitchen - CABINETS   | SIERRA WHITE PVC                                    |                              |     |  |
| Island - CABINETS  | SIERRA WHITE PVC                                    |                              |     |  |
| Servery - CABINETS   | SIERRA WHITE PVC                                    |                              |     |  |
| Kitchen - HANDLES/KNOBS  | H500BC  |                              |     |  |
| Kitchen - COUNTERTOP   | CARRARA WHITE- UP 2                                 |                              |     |  |
| Island - COUNTERTOP  | CARRARA WHITE- UP 2                                 |                              |     |  |
| Kitchen - BACKSPLASH   | DECLINED  |                              |     |  |
| Kitchen - SINK   | STD   |                              |     |  |
| Kitchen - FAUCET   | STD   |                              |     |  |
| GREAT ROOM / DINING / LIVING / DEN / OFFICE / BASEMENT   |   |                              |     |  |
| Family / Great Room - FLOORING   | NORTHERN SOLID SAWN SCULPTED UVF ANGORA- UP 3       |                              |     |  |
| Main Hall - FLOORING   | NORTHERN SOLID SAWN SCULPTED UVF ANGORA- UP 3       |                              |     |  |
| Dining / Living Room - FLOORING  | NORTHERN SOLID SAWN SCULPTED UVF ANGORA- UP 3       |                              |     |  |
| Library / Den - FLOORING   | NORTHERN SOLID SAWN SCULPTED UVF ANGORA- UP 3       |                              |     |  |
| Basement Rec Room - FLOORING   | NA  |                              |     |  |
| STAIRS   |   |                              |     |  |
| Railing Details - PICKETS  | ALL PLAIN BLACK METAL- UP 2                         |                              |     |  |
| Railing Details - POSTS  | 3 1/4" SQUARE OAK POST W/ REVEAL- UP 2              |                              |     |  |
| Railing Details - HANDRAIL   | 2 3/4" SQUARE OAK HANDRAIL- UP 2                    |                              |     |  |
| Stair Stain - MAIN STAIRS  | STAIN STAIRS TO MATCH HARDWOOD AS CLOSE AS POSSIBLE |                              |     |  |
| Stair Stain - BASEMENT STAIRS (if applicable)  | NA  |                              |     |  |
| BEDROOMS / BATHROOMS / LAUNDRY   |   |                              |     |  |
| Powder Room - FLOORING   | NEW BYZANTINE ASSURO BLUE 12 X 24- STACKED          |                              |     |  |
| Powder Room - CABINETS   | NA  |                              |     |  |
| Powder Room - HARDWARE   | NA  |                              |     |  |
| Powder Room - COUNTERTOP   | NA  |                              |     |  |
| Powder Room - SINK   | STD   |                              |     |  |
| Powder Room - FAUCET   | STD   |                              |     |  |
| LOFT WHITE 12 X 24- STACKED  |   |                              |     |  |
| Laundry - FLOORING   | NA  |                              |     |  |
| Laundry - CABINETS   | NA  | Laundry - HANDLES/KNOBS      | NA  |  |
| Laundry - COUNTERTOP   | NA  | Laundry - SINK               | STD |  |
| Laundry - BACKSPLASH   | NA  | Laundry - FAUCET             | STD |  |
|  |   |                              |     |  |
| Upper Hall - FLOORING  | NORTHERN SOLID SAWN SCULPTED UVF ANGORA- UP 3       |                              |     |  |
| Master Bedroom - FLOORING  | T20 OPENING NIGHT                                   |                              |     |  |
| Bedroom 2 - FLOORING   | T20 OPENING NIGHT                                   |                              |     |  |
| Bedroom 3 - FLOORING   | T20 OPENING NIGHT                                   |                              |     |  |
| Bedroom 4 - FLOORING   | T20 OPENING NIGHT                                   |                              |     |  |
| Bedroom 5 - FLOORING   | NA  |                              |     |  |
|  |   |                              |     |  |
| Master Ensuite - FLOORING  | NEW BYZNATINE ASSURO BLUE 12 X 24- STACKED          |                              |     |  |
| Master Ensuite - SHOWER WALL   | NEW BYZNATINE ASSURO BLUE 12 X 24- STACKED VERTICAL |                              |     |  |
| Master Ensuite - SHOWER FLOOR  | WHITE 2 X 2   |                              |     |  |
| Master Ensuite - SHOWER JAMB   | BIANCO CARRARA                                      |                              |     |  |
| Master Ensuite - CABINETS  | EURO STORM  |                              |     |  |
| Master Ensuite - HANDLES/KNOBS   | H500BC  |                              |     |  |
| Master Ensuite - COUNTERTOP  | 1886K-07  |                              |     |  |
| Master Ensuite - SINK(s)   | STD   | Master Ensuite - FAUCET(s)   | STD |  |
| ***FOR TRADE USE***  |   |                              |     |  |
| Any upgrades in the colour chart must be accompanied with a PES. It is the responsibility of all Trades to inform the builder of any discrepancies on sketches, PES and/or colour charts <u>PRIOR</u> to installation. |   | RIVERS EDGE<br>WASAGA<br>305 |     |  |
|  |   | A.A                          |     |  |
|  |   | PURCHASER INITIALS           |     |  |
|  |   | VENDOR APPROVAL              |     |  |

2ND FLOOR CONTINUED...

|                                |   |                         |     |
|--------------------------------|---|-------------------------|-----|
| Main Bath - FLOORING           | NA  |                         |     |
| Main Bath - TUB / SHOWER WALL  | NA  |                         |     |
| Main Bath - SHOWER FLOOR       | NA  |                         |     |
| Main Bath - SHOWER JAMB        | NA  |                         |     |
| Main Bath - CABINETS           | NA  |                         |     |
| Main Bath - HANDLES/KNOBS      | NA  |                         |     |
| Main Bath - COUNTERTOP         | NA  |                         |     |
| Main Bath - SINK(s)            | NA  | Main Bath - FAUCET(s)   | NA  |
|                                |   |                         |     |
| Shared Bath- FLOORING          | NEW BYZANTINE ASSURO BLUE 12 X 24- STACKED          |                         |     |
| Shared Bath- TUB / SHOWER WALL | NEW BYZANTINE ASSURO BLUE 12 X 24- STACKED VERTICAL |                         |     |
| Shared Bath- SHOWER FLOOR      | NA  |                         |     |
| Shared Bath- SHOWER JAMB       | NA  |                         |     |
| Shared Bath- CABINETS          | CONT SLAB OAK TIMBER GREY                           |                         |     |
| Shared Bath- HANDLES/KNOBS     | H500BC  |                         |     |
| Shared Bath- COUNTERTOP        | 5003-38   |                         |     |
| Shared Bath- SINK(s)           | STD   | Shared Bath - FAUCET(s) | STD |

|                                  |   |                          |     |
|----------------------------------|---|--------------------------|-----|
| Ensuite Bath - FLOORING          | NEW BYZANTINE ASSURO BLUE 12 X 24- STACKED          |                          |     |
| Ensuite Bath - TUB / SHOWER WALL | NEW BYZANTINE ASSURO BLUE 12 X 24- STACKED VERTICAL |                          |     |
| Ensuite Bath - SHOWER FLOOR      | WHITE 2 X 2   |                          |     |
| Ensuite Bath - SHOWER JAMB       | BIANCO CARRARA                                      |                          |     |
| Ensuite Bath - CABINETS          | CONT SLAB OAK TIMBER GREY                           |                          |     |
| Ensuite Bath - HANDLES/KNOBS     | H500BC  |                          |     |
| Ensuite Bath - COUNTERTOP        | 5003-38   |                          |     |
| Ensuite Bath - SINK(s)           | STD   | Ensuite Bath - FAUCET(s) | STD |

|                        |            |  |  |
|------------------------|------------|--|--|
| TRIM / PAINT           |            |  |  |
| Casing/Baseboards      | STD        |  |  |
| Interior Door STYLE    | STD        |  |  |
| Interior Door HEIGHT   | STD        |  |  |
| Interior Door Hardware | STD        |  |  |
| PAINT - Throughout     | COOL WHITE |  |  |

|                            |     |  |  |
|----------------------------|-----|--|--|
| FIREPLACE                  |     |  |  |
| Location / Insert / Mantle | STD |  |  |

|             |     |                  |                  |
|-------------|-----|------------------|------------------|
| ACCESSORIES |     |                  |                  |
| Mirrors     | YES | BATH ACCESSORIES | DO NOT INSTALL ✓ |

|                                |          |                               |          |
|--------------------------------|----------|-------------------------------|----------|
| APPLIANCE REQUIREMENTS         |          |                               |          |
| GAS LINE TO BBQ                | STD      | ELECTRICAL for Built-in Oven  | DECLINED |
| GAS LINE & ELECTRICAL TO STOVE | DECLINED | ELECTRICAL for Built-in Micro | DECLINED |
| GAS LINE & ELECTRICAL TO DRYER | DECLINED | ELECTRICAL for Cooktop        | DECLINED |
| HOOD FAN VENT SIZE             | 6" STD   | ELECTRICAL for Bar Fridge     | DECLINED |
| WATERLINE to Fridge            | DECLINED |                               |          |

|  |  |  |  |
|--|--|--|--|
| DISCLAIMER   |  |  |  |
| Any changes to the colour chart after signing are subject to a <b>\$5000</b> administration fee plus costs   |  |  |  |
| Purchaser has checked and acknowledged accuracy of colour and selections before signing.   |  |  |  |
| Colours of all materials are as close as possible to Builders selection but not necessarily identical due to dye lot variances in manufacturing/manufacturers. Due to construction progress some items may have been pre-selected or installed. In this event the Vendor's selection must be accepted by the purchaser |  |  |  |

|               |                          |       |
|---------------|--------------------------|-------|
| SITE / LOT:   | RIVER'S EDGE WASAGA      | 305 ✓ |
| PURCHASER(S): | ANEES, AHMED ATTHAWAL    |       |
| PURCHASER(S): | 0                        |       |
| PHONE #:      | 416.450.8022             |       |
| EMAIL:        | ANESATTHWAL690@GMAIL.COM |       |

|  |                     |   |         |
|--|---------------------|---|---------|
| ***FOR TRADE USE***  |                     |   |         |
| Any upgrades in the colour chart must be accompanied with a PES. It is the responsibility of all Trades to inform the builder of any discrepancies on sketches, PES and/or colour charts <u>PRIOR</u> to installation. |                     |   |         |
|   | PURCHASER SIGNATURE |  |         |
|  | PURCHASER SIGNATURE |   | JILLIAN |
|  | DÉCOR CONSULTANT    |   |         |

|                 |                 |   |             |
|-----------------|-----------------|---|-------------|
| **PAGE 2 OF 2** | Vendor APPROVAL |  | JUN 02 2022 |
|-----------------|-----------------|---|-------------|



lot 305  
May 26/22

# 50-06 Nipissing

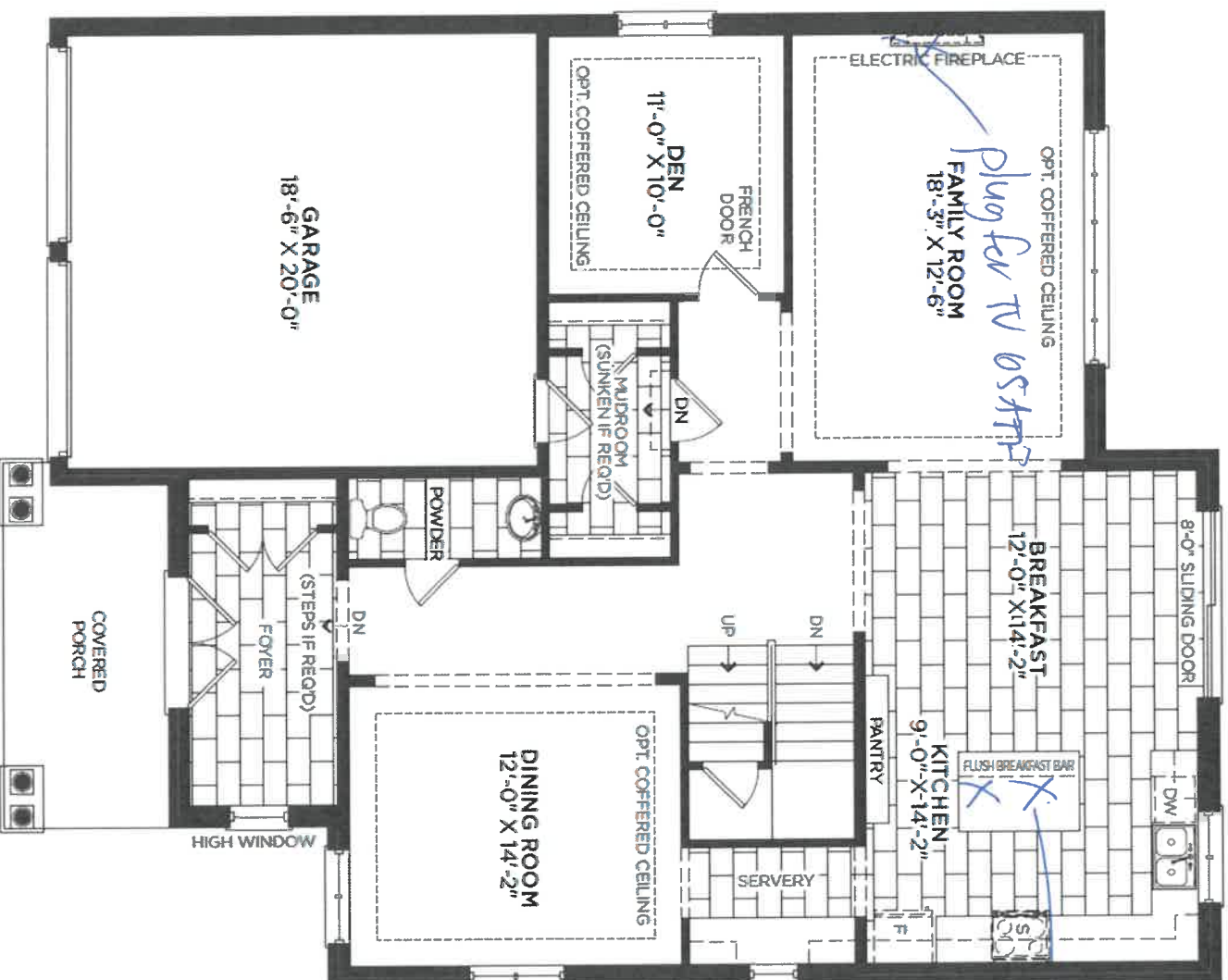

MAIN FLOOR ELEVATION A

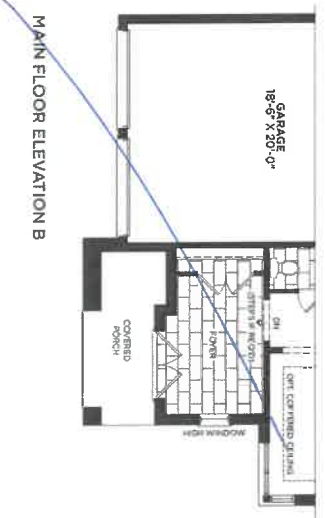

MAIN FLOOR ELEVATION B

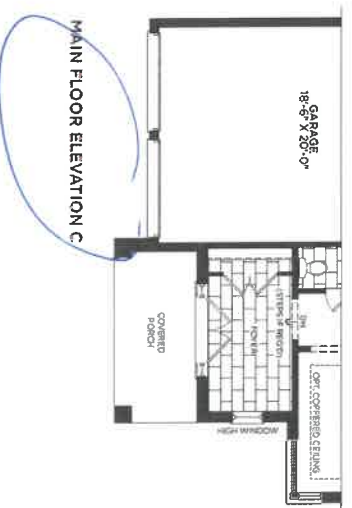

MAIN FLOOR ELEVATION C

lot 305  
May 20/22

# 50-06 Nipissing

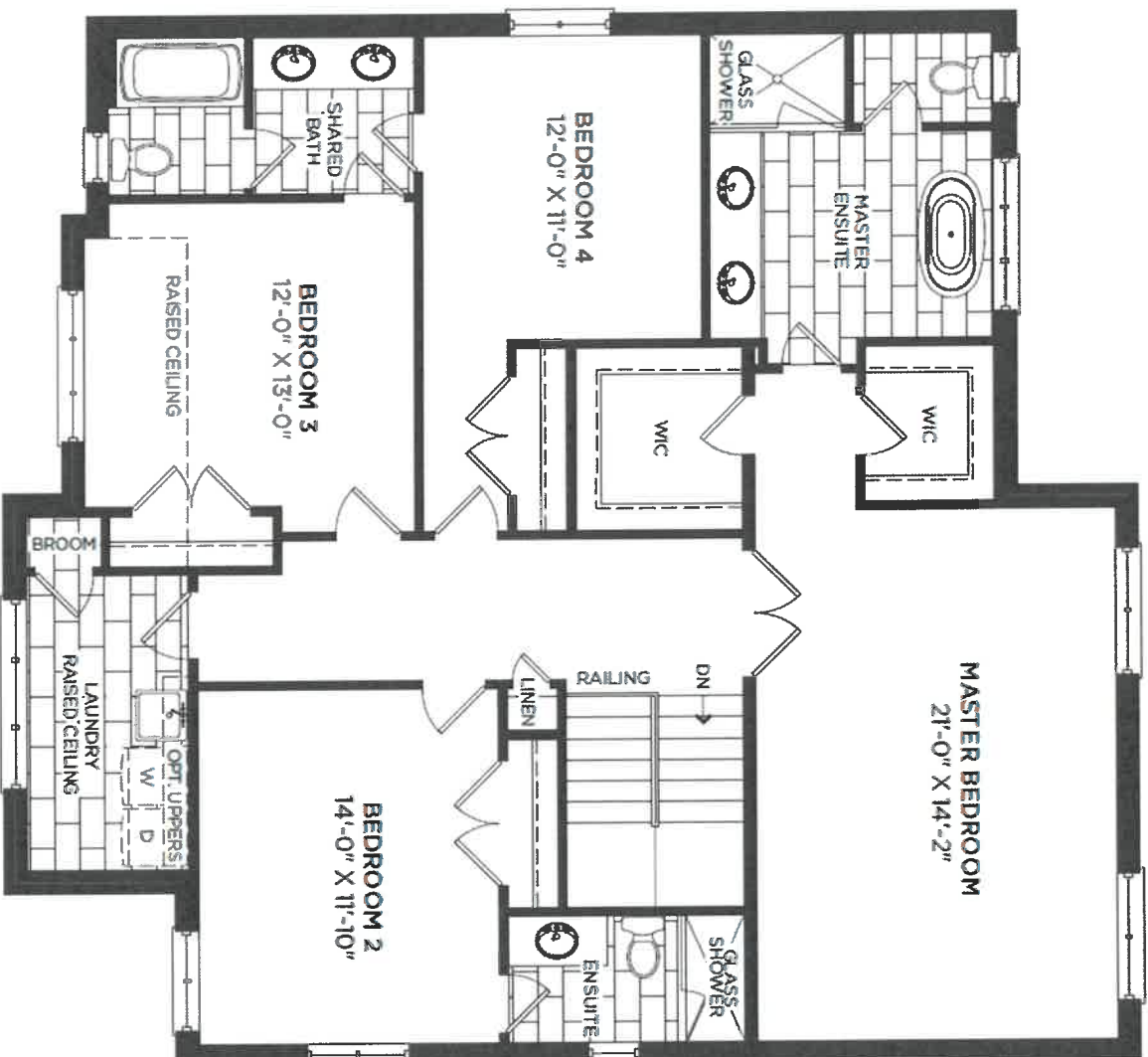

SECOND FLOOR ELEVATION A/C

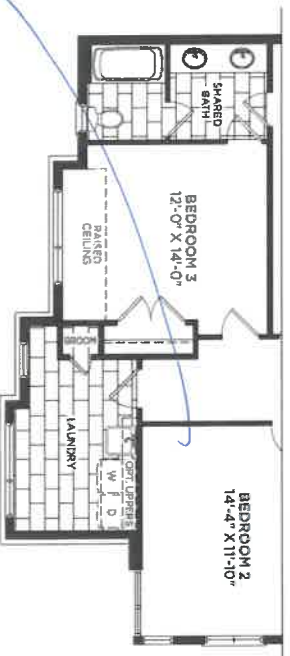

SECOND FLOOR ELEVATION B

B.A

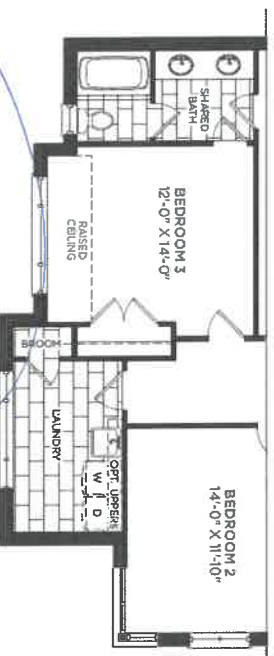

SECOND FLOOR ELEVATION C

161 305  
May 26/22

# 50-06 Nipissing

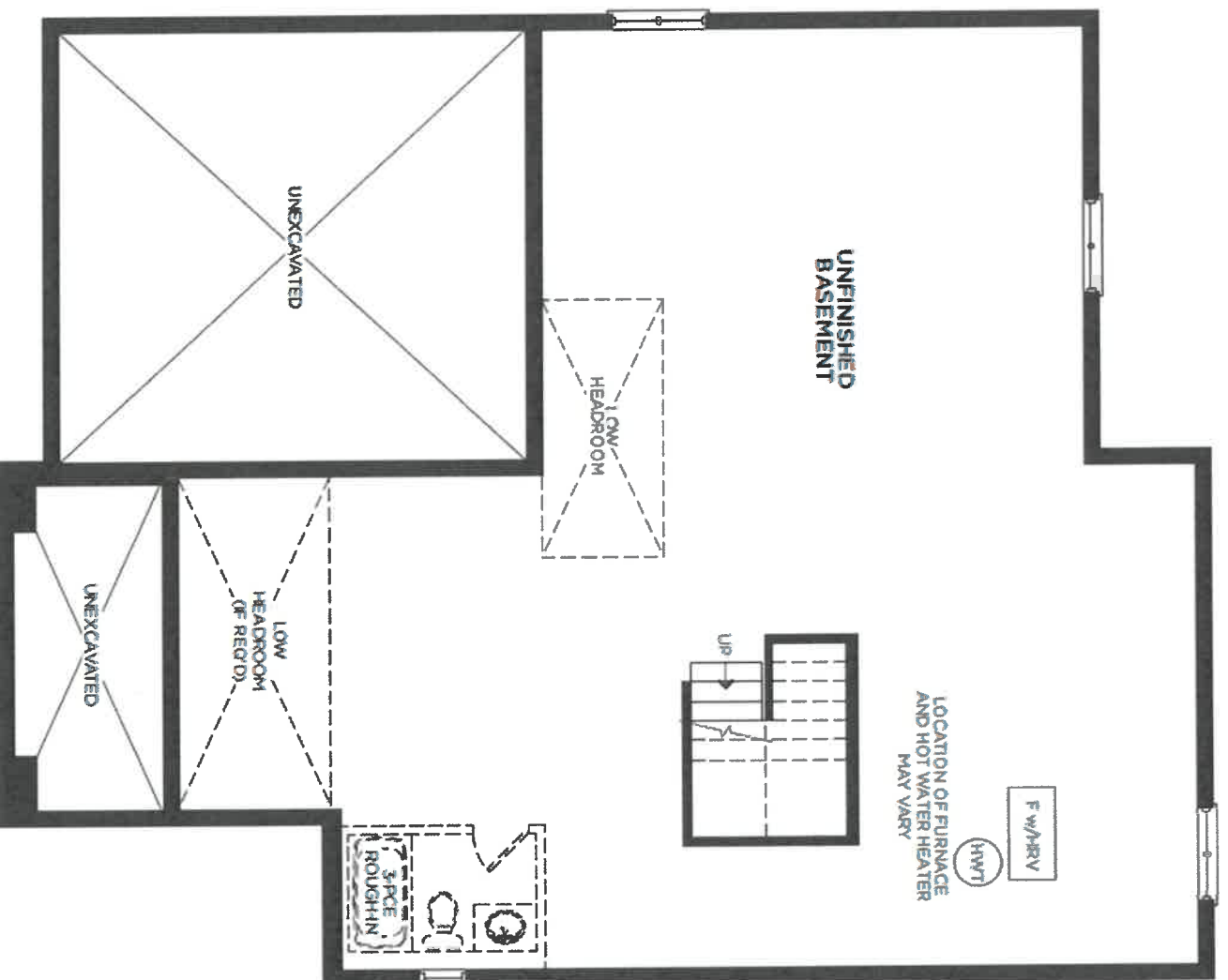

**BASEMENT ELEVATION A**

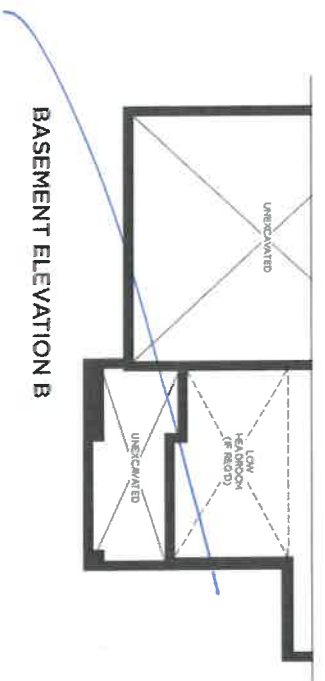

**BASEMENT ELEVATION B**

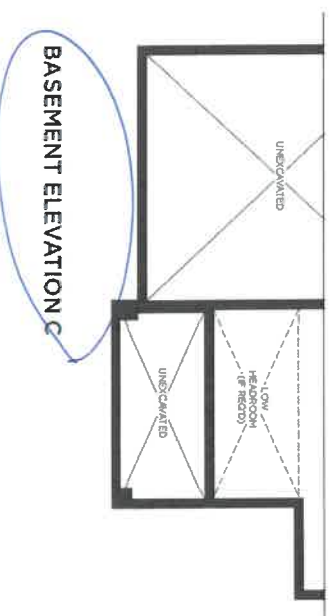

**BASEMENT ELEVATION C**

1



CLIENT NAME: ZANCOR HOMES  
SHIP TO : Rivers Edge Sunnidle Trails  
#50-06

DRAFTED BY: Binita

PH:  
CELL:

JOB NUMBER  
INSTALL DATE:

PAGE  
2 of 2

DATE SUBMITTED  
01 Mar 2022

COMMENT

P/O #

1 of 305  
May 26/22

Master Ensuite

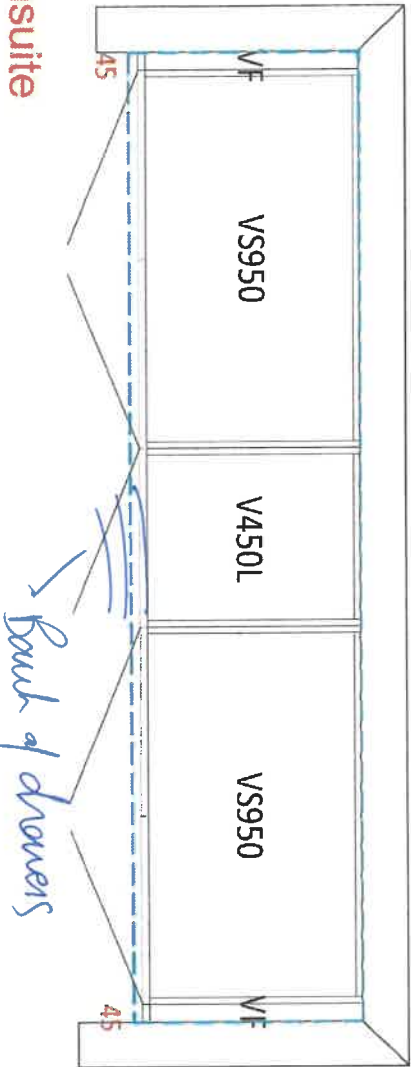

1930  
1930

Shared Bath

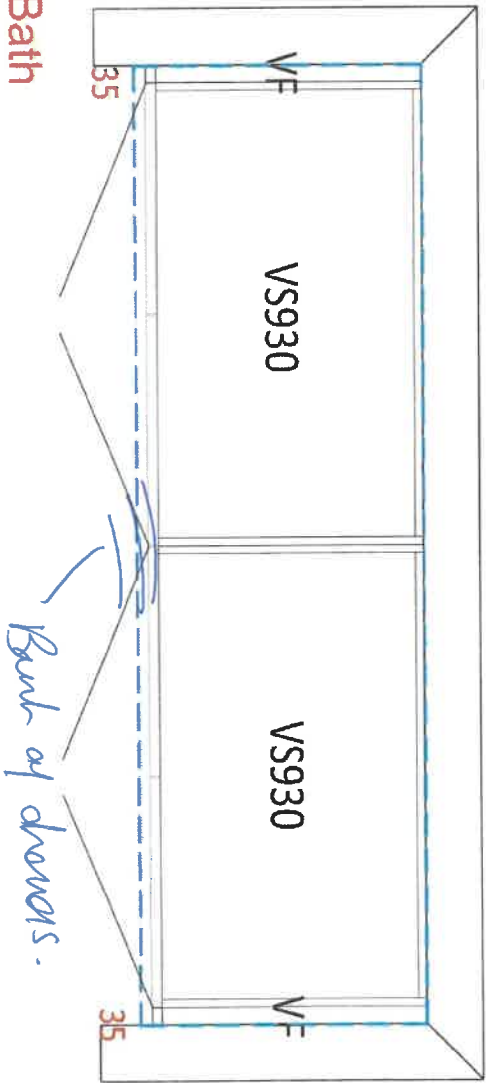

1170  
1170

Ensuite

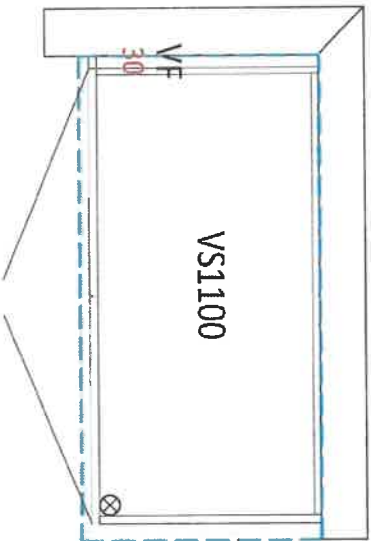

2440

opt laundry uppers

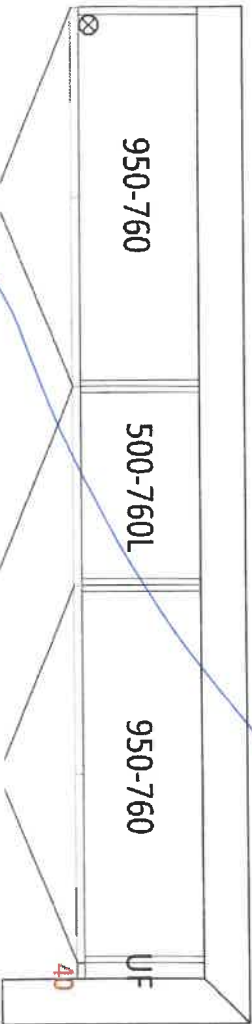



DATE SUBMITTED

01 Mar 2022

CLIENT NAME: ZANCOR HOMES  
SHIP TO : Rivers Edge Sunnidle Trails  
#50-06

PH:  
CELL:

**DRAFTED BY:** Binita

P/O #

|               |        |
|---------------|--------|
| JOB NUMBER    |        |
| INSTALL DATE: |        |
| PAGE          | 1 of 2 |

## Kitchen

Oct 305  
May 20/22

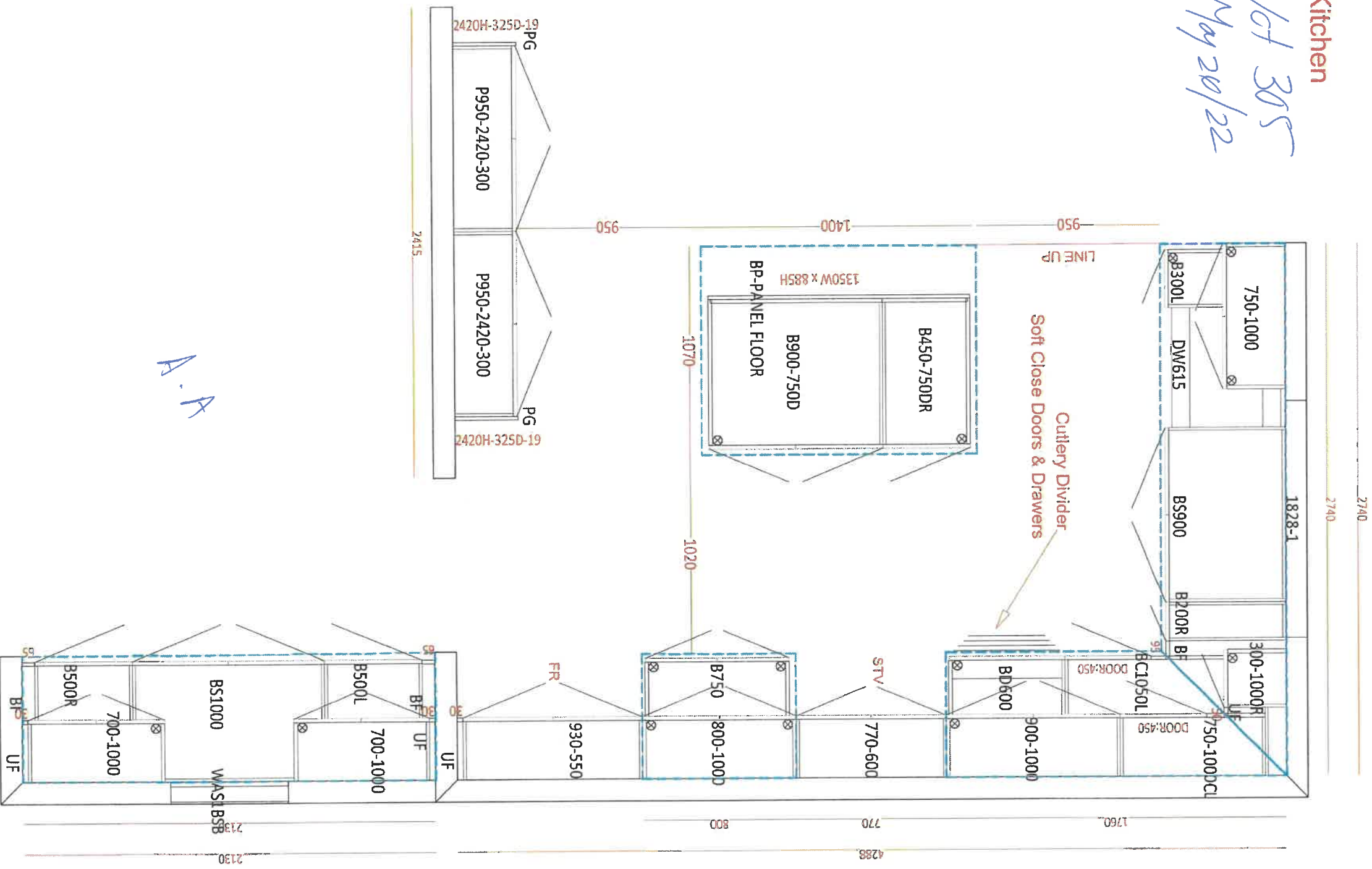



APPLIANCE ACKNOWLEDGEMENT

CONTACT: Steve Miller - Appliance Canada (905) 660-2424 / smiller@appliancecanada.com

- It is the Purchasers responsibility to coordinate delivery, installation and hook up of appliances and to ensure they are installed as per Manufacturers specifications after closing.

STANDARD APPLIANCE OPENINGS provided by Zancor:

\*Standard appliance openings are approximate and the minimum required. Sizes may vary due to onsite condition and/or when modifications have been made to the cabinetry.

- Fridge Opening 36" x 74"  
► Stove Opening 30"  
► Hood Fan Opening 30"  
► Hood Fan & Vent 6" with Under Cabinet Hood  
► Dishwasher Opening 24"

Accepts Standard  
Openings \*\*Initial

SM

OPTIONAL UPGRADED APPLIANCES to be provided by Homeowner:

- **\*\*Specs/Information sheets are required and it is the responsibility of the homeowner to provide this to Zancor Homes by the due date that has been provided. If appliance specs are not submitted, Zancor Homes will not be responsible for any necessary requirements and the standard opening will be built.**

TH

- Upgraded Appliance Specs are DUE 2 WEEKS FROM SIGNED DATE OF COLOUR CHART (if not received during appointment)

INITIAL

- \*\*\*Specs that require changes/modifications after this date will not be accepted\*\*\*

- NOTE: Any upgraded appliances are to be paid by the Purchaser, directly to the appliances company.

- Additional charges to the Purchaser may apply for cabinetry, electrical and plumbing in order to accommodate the specs given by the homeowner.

FRIDGE UPGRADE

- ☒ Built-in  
☒ Paneled \*\*Panel to match required  
☒ Integrated / Flush Inset  
☐ Waterline

RANGE UPGRADE

\*Larger hood fan CFM might be required, which need a larger vent

- ☐ 36" \*\*Hood fan opening must be the same size or larger (8" vent might be required)  
☐ 48" \*\*Hood Fan opening must be the same size or larger (8" or 10" vent required)  
☐ Gas Range \*\*gas line and electrical required & sold separately  
☐ Induction \*\*electrical required & sold separately  
☐ Cooktop (Apron Front) \*\*Countertop Cut-out required & sold separately  
☐ Cooktop (Drop-in) \*\*countertop Cut-out required & sold separately

HOOD FAN & VENT

UPGRADE

- ☐ 8 Inch \*\*Required for 600 CFM  
☐ 10 Inch  
☐ Chimney Hood Fan \*\*Vent must be centred  
☒ Insert / Liner

WALL OVEN/MICRO

UPGRADE

\*\*Electrical required

- ☒ Single Wall Oven \*\*electrical required & sold separately  
☐ Double Wall Oven \*\*electrical required & sold separately  
☐ Steam Oven \*\*electrical required & sold separately  
☐ Warming Drawer \*\*electrical required & sold separately  
☐ Over Then Range Microwave (OTR)  
☒ Built-In Microwave \*\*Trim Kit required \*\*electrical required & sold separately

DATE May 20/22

WASAGA RIVERS EDGE

LOT 305

\*\* Any upgrades checked in this appliance form must be accompanied with specs provided by the Purchaser.

\*\*It is the responsibility of the trade to inform the Builder of any discrepancies with specs, sketches, extras and/or colour chart PRIOR to production/installation.

ZANCOR

221 North Rivermede Road, Concord, Ontario L4K 3N7 \* T: (905) 738.7010 F: (905) 738.5948

## INTERIOR FINISHES ACKNOWLEDGEMENT / WAIVER

Purchaser accepts and acknowledges that the Builder reserves the right to substitute materials with those of equal or better quality where the manufacture, scheduling or delivery of materials may directly impact the Builder's ability to meet its' contractual obligations under the Agreement of Purchase and Sale.

**UPGRADES/EXTRAS:** All upgrades and additional selections indicated on the colour chart must be accompanied by an upgrades/extras sheet (PES) and full payment otherwise the selection will be invalid. All colour charts and upgrades/extras will not proceed until verified and signed by an authorized signing officer at the Vendor's head office. **CHANGES WILL NOT BE PERMITTED UPON COMPLETION AND SUBMISSION OF THE COLOUR CHART.**

**PORCELAIN & NATURAL STONES:** Due to the properties of natural stones including but not limited to **marble, granite, quartz,** no two pieces are exactly the same. Variations in colour, tone, granularity (pitting, fissures) and pattern are to be expected, including various lighting may affect the overall finished look. Stone tops are sealed at time of installation and should never be cleaned with lemon oil or vinegar. Stones are porous materials, therefore any spilled substance require immediate attention. Stone countertops require regular seal re-application as part of home maintenance. Purchaser acknowledges colour and product variations as well as natural imperfections may exist with the selection of natural stone materials and shall not hold the Vendor liable for provision of same.

**STONE COUNTERTOP JOINTS:** Purchaser is aware there may be joints in stone counter tops, in kitchens and vanities if applicable as per plan. Joints will also be applicable where the length of the counter top exceeds the length of a stone slab.

**CERAMIC TILES:** Due to manufacturing, shade (dye lots), product variations may exist that can affect the overall look of the finished product. Although every effort will be made to ensure the colours and materials selected are as close as possible to the samples, the purchaser acknowledges that the sample tiles supplied in the Design Centre may not be identical to the materials installed in the home.

**STAIR STAINS:** Due to the natural properties of wood, many variables can affect the overall look of the finished product. Factors including but not limited to wood type, knotting, graining, density, age, humidity, and air temperature can result in substantial variations in stain intensity. The purchaser accepts that although the Vendor will do their best to match stain the unfinished stairs as close as possible to the pre-finished floors, it is not possible to have an identical match and that there MAY be shade differences between the two products.

**CABINETRY:** Due to the natural properties of wood, slight variations apparent with cabinetry are to be expected. This includes but not limited to wood species, wood grain, colour, finish, product variations, and natural imperfections are all factors that may affect the overall look of the finished product. Such factors make exact colour matching impossible. The type and intensity of lighting in the areas of designated cabinetry placement may also highlight characteristics of cabinetry finish. All cabinets shall be finished with a white melamine interior box unless a finished interior is upgraded. Due to building specifications and/or on-site conditions, certain cabinetry upgrades may not be possible. The purchaser acknowledges that the Builder cannot guarantee the cabinetry finish or provision of certain upgrades and shall not hold the Builder liable for provision of same.

**UPGRADES/EXTRAS:** All upgrades and additional selections indicated on the colour chart must be accompanied by an upgrades/extras sheet (PES) and full payment otherwise the selection will be invalid. All colour charts and upgrades/extras will not proceed until verified and signed by an authorized signing officer at the Vendor's head office. **CHANGES WILL NOT BE PERMITTED UPON COMPLETION AND SUBMISSION OF THE COLOUR CHART.**

**FLOOR TRANSITIONS:** Transition strips will be used between

**HARDWOOD / LAMINATE FLOORING:** Due to the properties of wood and laminate, many variables can affect the overall look of the finished product. Variations include but not limited to wood type or laminate finish, colour/stain and wood grain are significant factors that make exact colour matching impossible. The purchaser acknowledges that the hardwood flooring is a pre-finished product in a controlled environment. Expansion, compression and cupping are characteristics of hardwood flooring once installed in the home. The purchaser acknowledges these may become apparent over time and despite the Builders' efforts to install the hardwood flooring materials in keeping with good workmanship, the Builder shall not be responsible nor held liable for minor variances of fluctuation in hardwood flooring materials.

### HARDWOOD / LAMINATE WAIVER:

I/We understand hardwood flooring is classified as a porous material and as such not recommended by the Builder in certain areas. I/We understand there is a concern due to possible water and other substances being frequently splashed or spilled onto the floor and in contravention of Ontario Building Code Section 9.30.1.2(1).

*"Finished flooring bathrooms, kitchens, public entrance halls, laundry & general storage areas shall consist of resilient flooring, felted-synthetic-fibre floor coverings, concrete, terrazzo, ceramic tile, mastic or other types of flooring providing similar degrees of water resistance."*

I/We are prepared to assume full responsibility for any damage caused to the hardwood floor or subfloor due to moisture absorbency in the mentioned areas, and agree to waive any claims against the Township of residence, TARIION and/or the Builder in relation to the matter. **\*\*SEE COLOUR CHART FOR LOCATIONS\*\***

|      |          |      |                    |     |     |
|------|----------|------|--------------------|-----|-----|
| DATE | 19/26/22 | SITE | WASAGA RIVERS EDGE | LOT | 305 |
|------|----------|------|--------------------|-----|-----|

## HOME AUTOMATION (Cable, CAT5/6, Telephone)

### INCLUDED IN SCHEDULE "A" IN AGREEMENT OF PURCHASE AND SALE:

- Rough-in for Central Vacuum system piped to garage
- Rough-in for Telephone (2) locations
- Rough-in for Cable TV (2) locations
- Rough-in for Cat-6 Network (3) locations

### CONTACT:

I/we the Homeowner(s) have chosen to contact the Home Automation Company to select the locations of the rough-ins for Cable, CAT6, Telephone as included in our Agreement of Purchase Sale.

I/we the Homeowner(s) will contact the trade within 4 weeks of the date of this release to select locations of the standard rough-ins review other optional products for purchase.

Trade: Zygya Lighting &Automation  
 Phone: (705) 715-1102  
 Email: [info@zygmainc.ca](mailto:info@zygmainc.ca)  
 Location: 11 King Street, Unit 3  
 Barrie, Ontario L4N 6B5

### ACKNOWLEDGEMENT:

I/We the homeowner(s) acknowledge that if I/We the homeowners decide to not contact Zygya Lighting & Automation, locations of the standard rough-ins will be installed as per Vendors discretion.

X D.A

Homeowner(s) Initial

Homeowner(s) Initial

WASAGA RIVERS EDGE

DATE

SITE

LOT



## Stone Countertop Edge Profiles

\*\*Where applicable as per site specifications\*\*

### STANDARD EDGE FOR KITCHEN & VANITIES

Standard Countertop Edge in  
Kitchen

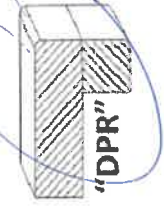

Standard Countertop Edge in  
Vanity

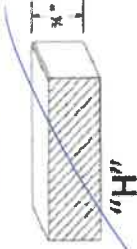

*J.A.A.*

Homeowner(s) Initial

### OPTION (1) EDGE FOR KITCHEN & VANITIES \$250

Optional Edge in Kitchen

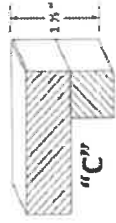

Optional Edge in Bathroom

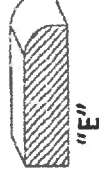
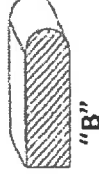
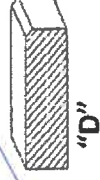

Homeowner(s) Initial

### OPTION (2) EDGE FOR KITCHEN & VANITIES CUSTOM PRICING

Optional Edge for Kitchen

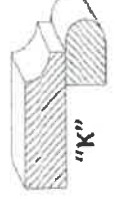
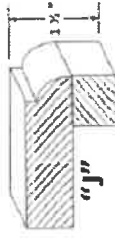
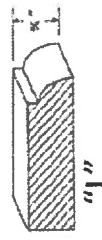

Optional Edge in Vanity

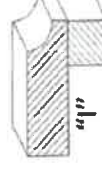
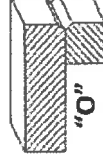
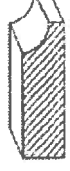

Homeowner(s) Initial

*May 26/22*

DATE

WASAGA RIVERS EDGE

*305*

SITE

LOT