

CONSTRUCTION SUMMARY OF EXTRAS

Printed 2022-04-20 / 2:33 PM / Page 1 of 1

Site: RIVER'S EDGE WASAGA
Lot: 37
Model: HOLLAND (43-01) ELEV B
Purchaser: KYLE, A BAKER
Purchaser: 0
Phone: 705.441.5865
Email: BAKERPERFORMANCEPARTS@HOTMAIL.COM



DESCRIPTION		DATE SELECTED
BONUS PACKAGE: STAINLESS STEEL HOOD FAN	INCLUDED IN APS	
	STRUCTURALS	
1 NO STRUCTURAL CHANGES		24-Jan-22
	COLOURS	
1 ELECTRICAL- 2 CAPPED LIGHTS OVER KITCHEN ISLAND, SPACED EVENLY ON SEPARATE SWITCH. STD LIGHT TO REMAIN- SEE SKETCH		11-Apr-22
2 HARDWARE FOR CABINETS		11-Apr-22
3 STAIN FOR STAIRS TO MATCH HARDWOOD AS CLOSE AS POSSIBLE= 2 FLIGHT		11-Apr-22
4 HARDWOOD- FAMILY ROOM, LANDINGS, MAIN HALL- UP 1		11-Apr-22

ZANCOR HOMES COLOUR CHART

PRINTED 2022-04-11, 10:28 AM

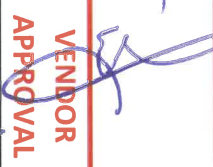
ENTRANCES				
Main Foyer - FLOORING	NEW BYZANTINE ASSURO BLUE 12 X 24- BRICKED			
Mudroom - FLOORING	NA			
Side Hall - FLOORING	NA			
Basement Foyer - FLOORING	NEW BYZANTINE ASSURO BLUE 12 X 24- BRICKED			
KITCHEN				
Kitchen - FLOORING	NEW BYZANTINE ASSURO BLUE 12 X 24- BRICKED			
Breakfast - FLOORING	NEW BYZANTINE ASSURO BLUE 12 X 24- BRICKED			
Kitchen - CABINETS	SIERRA TIMBER GREY STAINED OAK			
Island - CABINETS	SIERRA TIMBER GREY STAINED OAK			
Servery - CABINETS	NA			
Kitchen - HANDLES/KNOBS	H800MB			
Kitchen - COUNTERTOP	BIANCO SARDO			
Island - COUNTERTOP	BIANCO SARDO			
Kitchen - BACKSPLASH	DECLINED			
Kitchen - SINK	STD			
Kitchen - FAUCET	STD			
GREAT ROOM / DINING / LIVING / DEN / OFFICE / BASEMENT				
Family / Great Room - FLOORING	NORTHERN SOLID SAWN SELECT V PEARL WHITE OAK 3 1/4" BUCKINGHAM- UP 1			
Main Hall - FLOORING	NORTHERN SOLID SAWN SELECT V PEARL WHITE OAK 3 1/4" BUCKINGHAM- UP 1			
Dining / Living Room - FLOORING	NA			
Library / Den - FLOORING	NA			
Basement Rec Room - FLOORING	NA			
STAIRS				
Railing Details - PICKETS	BLACK METAL SINGLE COLLAR W/ ALT PLAIN			
Railing Details - POSTS	2 3/4" TURNED OAK POST			
Railing Details - HANDRAIL	2 1/2" OVAL OAK HANDRAIL			
Stair Stain - MAIN STAIRS	STAIN STAIRS TO MATCH HARDWOOD AS CLOSE AS POSSIBLE			
Stair Stain - BASEMENT STAIRS (if applicable)	STAIN STAIRS TO MATCH HARDWOOD AS CLOSE AS POSSIBLE			
BEDROOMS / BATHROOMS / LAUNDRY				
Powder Room - FLOORING	NA			
Powder Room - CABINETS	NA			
Powder Room - HARDWARE	NA			
Powder Room - COUNTERTOP	NA			
Powder Room - SINK	NA			
Powder Room - FAUCET	NA			
NEW BYZANTINE ASSURO BLUE 12 X 24- BRICKED				
Laundry - FLOORING			laundry - HANDLES/KNOBS	NA
Laundry - CABINETS	NA		laundry - SINK	STD
Laundry - COUNTERTOP	NA		laundry - FAUCET	STD
Laundry - BACKSPLASH				
Upper Hall - FLOORING	NA			
Master Bedroom - FLOORING	T03 OPENING NIGHT			
Bedroom 2 - FLOORING	T03 OPENING NIGHT			
Bedroom 3 - FLOORING	T03 OPENING NIGHT			
Bedroom 4 - FLOORING	NA			
Bedroom 5 - FLOORING	NA			
GENESIS LIGHT GREY 12 X 24- BRICKED				
Master Ensuite - FLOORING	GENESIS LIGHT GREY 12 X 24- STACKED HORIZONTAL			
Master Ensuite - SHOWER WALL	NA			
Master Ensuite - SHOWER FLOOR	NA			
Master Ensuite - SHOWER JAMB	NA			
Master Ensuite - CABINETS	EURO LARICE BIANCO			
Master Ensuite - HANDLES/KNOBS	H800MB			
Master Ensuite - COUNTERTOP	4945-38			
Master Ensuite - SINK(S)	STD	Master Ensuite - FAUCET(S)	STD	
FOR TRADE USE				
Any upgrades in the colour chart must be accompanied with a PES. It is the responsibility of all trades to inform the builder of any discrepancies on sketches, PES and/or colour charts PRIOR to installation.		RIVERS EDGE WASAGA 37 ✓		
		PURCHASER INITIALS	VENDOR APPROVAL	

2ND FLOOR CONTINUED...					
Main Bath - FLOORING	NEW BYZANTINE ASSURO BLUE 12 X 24- BRICKED				
Main Bath - TUB / SHOWER WALL	NEW BYZANTINE ASSURO BLUE 12 X 24- STACKED HORIZONTAL				
Main Bath - SHOWER FLOOR	NA				
Main Bath - SHOWER JAMB	NA				
Main Bath - CABINETS	CONT SLAB OAK TIMBER GREY				
Main Bath - HANDLES/KNOBS	H800MB				
Main Bath - COUNTERTOP	4945-38				
Main Bath - SINK(s)	STD	Main Bath - FAUCET(s)	STD		
BASEMENT Bath- FLOORING					
NEW BYZANTINE ASSURO BLUE 12 X 24- BRICKED					
BASEMENT Bath- TUB / SHOWER WALL					
NEW BYZANTINE ASSURO BLUE 12 X 24- STACKED HORIZONTAL					
BASEMENT Bath- SHOWER FLOOR					
NA					
BASEMENT Bath- SHOWER JAMB					
NA					
BASEMENT Bath- CABINETS					
CONT SLAB OAK TIMBER GREY					
BASEMENT Bath- HANDLES/KNOBS					
H800MB					
BASEMENT Bath- COUNTERTOP					
4945-38					
BASEMENT Bath- SINK(s)					
STD					
Shared Bath - FAUCET(s)					
STD					
Ensuite Bath - FLOORING					
NA					
Ensuite Bath - TUB / SHOWER WALL					
NA					
Ensuite Bath - SHOWER FLOOR					
NA					
Ensuite Bath - SHOWER JAMB					
NA					
Ensuite Bath - CABINETS					
NA					
Ensuite Bath - HANDLES/KNOBS					
NA					
Ensuite Bath - COUNTERTOP					
NA					
Ensuite Bath - SINK(s)					
NA					
Ensuite Bath - FAUCET(s)					
NA					
TRIM / PAINT					
Casing/Baseboards					
STD					
Interior Door STYLE					
STD					
Interior Door HEIGHT					
STD					
Interior Door Hardware					
STD					
PAINT - Throughout					
WARM GREY					
FIREPLACE					
Location / Insert / Mantle					
STD					
ACCESSORIES					
Mirrors	YES	BATH ACCESSORIES	DELETE		
APPLIANCE REQUIREMENTS					
GAS LINE TO BBQ	STD	ELECTRICAL for Built-in Oven	DECLINED		
GAS LINE & ELECTRICAL TO STOVE	DECLINED	ELECTRICAL for Built-in Micro	DECLINED		
GAS LINE & ELECTRICAL TO DRYER	DECLINED	ELECTRICAL for Cooktop	DECLINED		
HOOD FAN VENT SIZE	6" STD	ELECTRICAL for Bar Fridge	DECLINED		
WATERLINE to Fridge	DECLINED				
DISCLAIMER					
Any changes to the colour chart after signing are subject to a \$5000 administration fee plus costs					
Purchaser has checked and acknowledged accuracy of colour and selections before signing.					
Colours of all materials are as close as possible to Builders selection but not necessarily identical due to dye lot variances in manufacturing/manufacturers. Due to construction progress some items may have been pre-selected or installed. In this event the Vendor's selection must be accepted by the purchaser					
INITIALS					
SITE / LOT:					
RIVER'S EDGE WASAGA					
37					
PURCHASER(S):					
KYLE, A BAKER					
PURCHASER(S):					
0					
PHONE #:					
705.441.5865					
EMAIL:					
BAKERPERFORMANCEPARTS@HOTMAIL.COM					
SIGNATURES / DATE					
Any upgrades in the colour chart must be accompanied with a PES.					
It is the responsibility of all Trades to inform the builder of any discrepancies on sketches, PES and/or colour charts PRIOR to installation.					
ZANCOR HOMES					
PURCHASER SIGNATURE					
PURCHASER SIGNATURE					
DÉCOR CONSULTANT					
JILLIAN					
Vendor APPROVAL					
APR 20/22					

43-01 Holland

lot 37
Jan 21/22
April 11/22

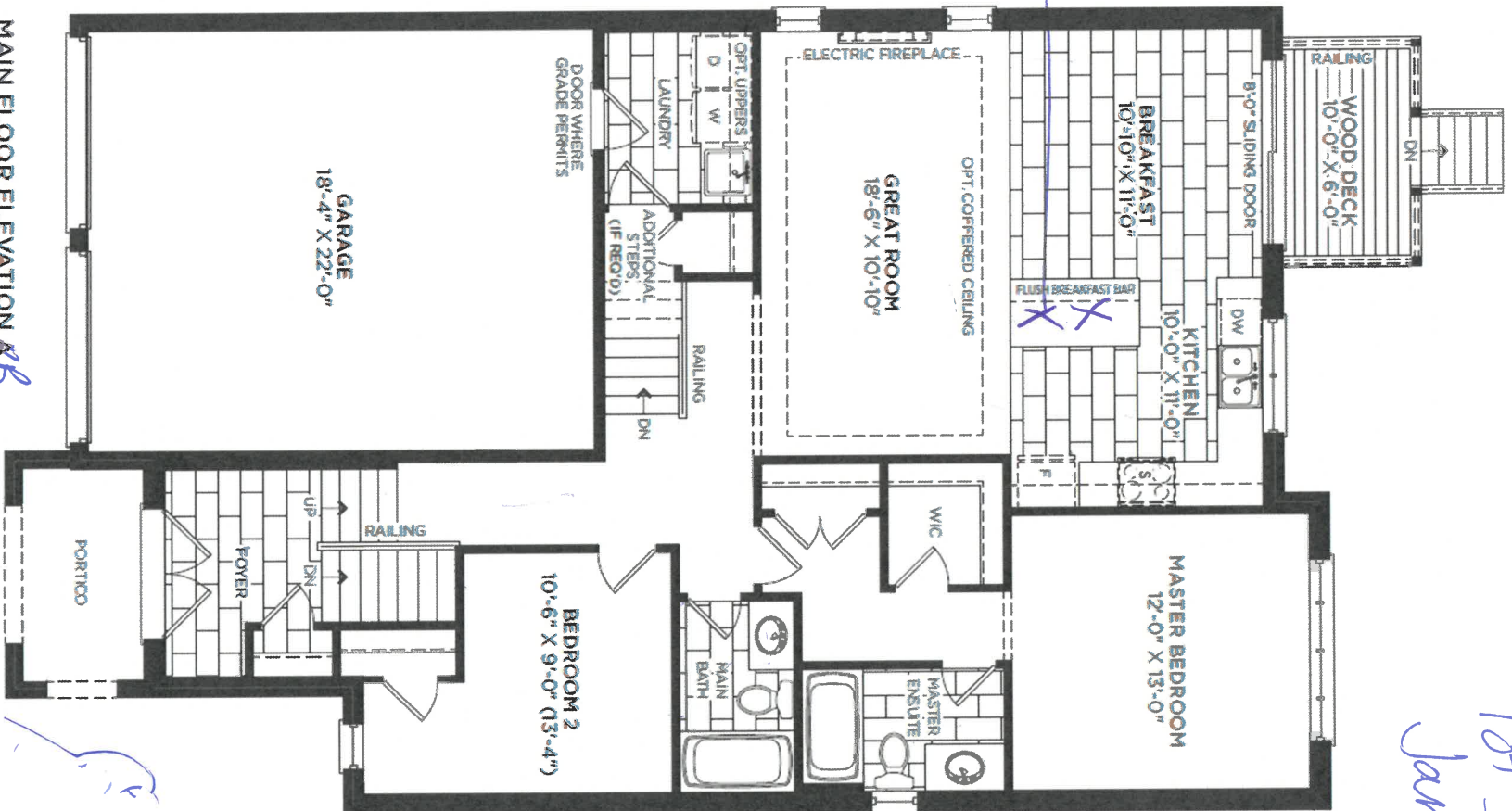

MAIN FLOOR ELEVATION AB

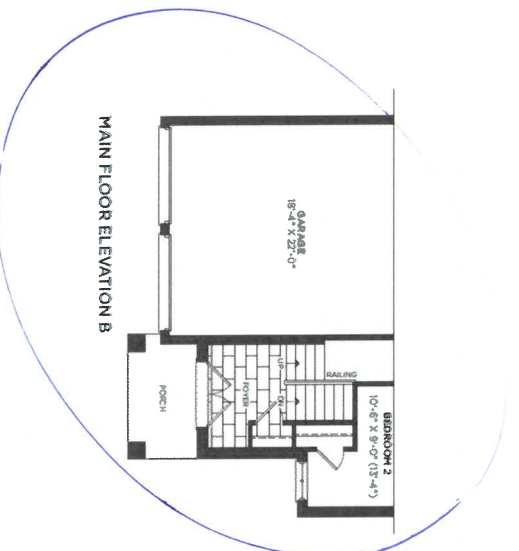

MAIN FLOOR ELEVATION B



MAIN FLOOR ELEVATION C



WASAGAT
NATURE-INSPIRED
COMMUNITY

**WASAGA'S
NATURE-INSPIRED
COMMUNITY**





DATE SUBMITTED

01 Mar 2022

CLIENT NAME: ZANCOR HOMES

SHIP TO : Rivers Edge Sunnidle Trails

#43-01

PH:

CELL:

DRAFTED BY: Binita

COMMENT

P/O #

JOB NUMBER

INSTALL DATE:

PAGE

1 of 2

3300

3300

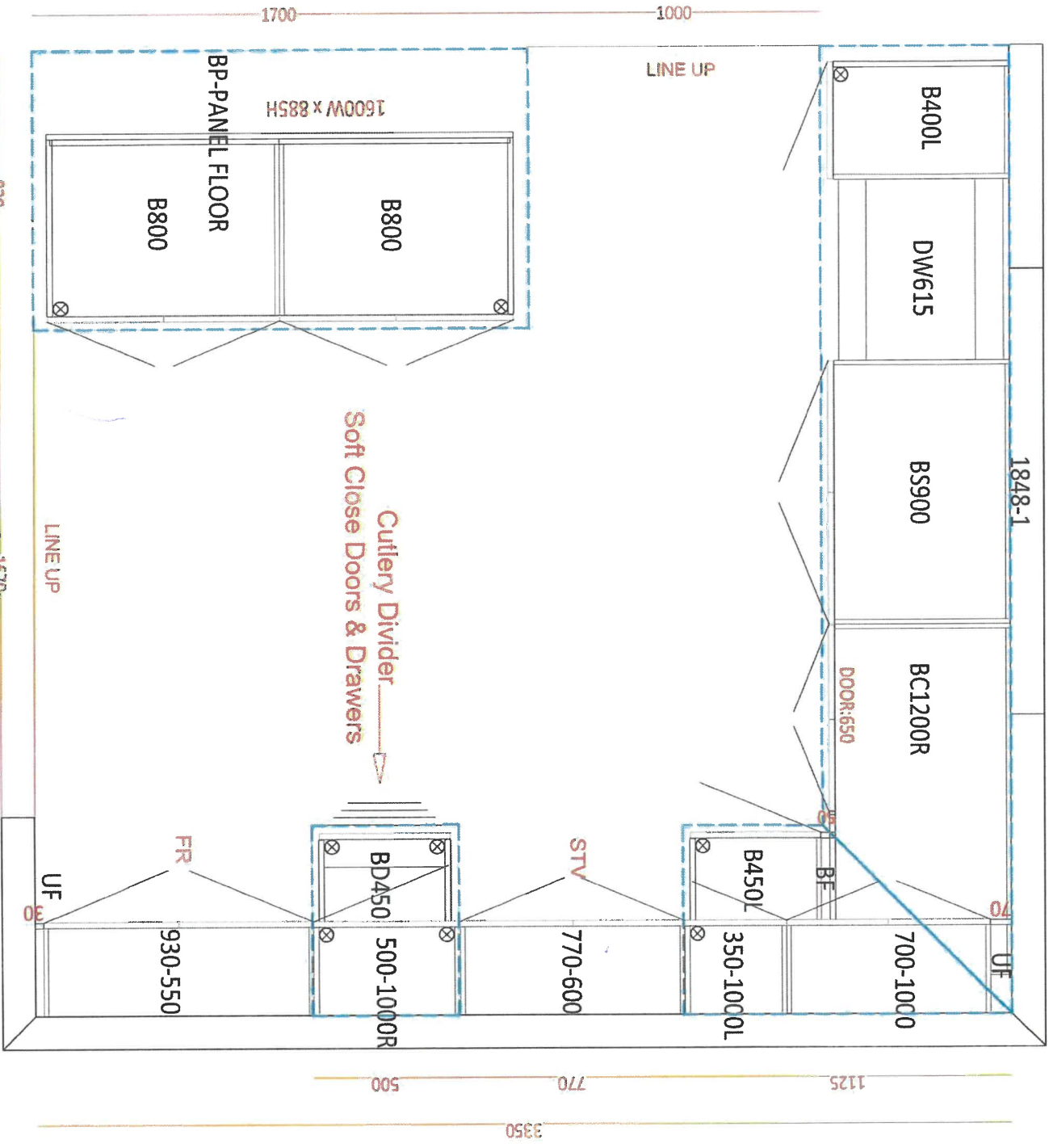

Kitchen

opt Laundry uppers



CLIENT NAME: ZANCOR HOMES
SHIP TO : Rivers Edge Sunnidle Trails
#43-01

PH:
CELL:

DRAFTED BY: Binita
COMMENT

P/O #

JOB NUMBER

INSTALL DATE:

PAGE
2 of 2

DATE SUBMITTED

01 Mar 2022

990

990

1st 37
Apr 11/22

Main Bath
Basement Fl.

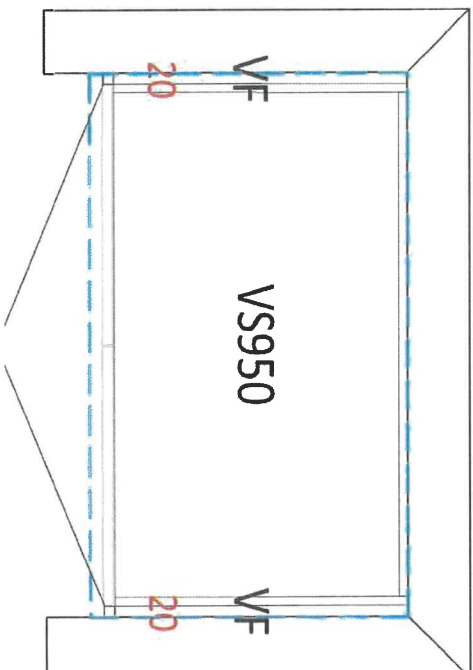

1100

1100

Master Ensuite

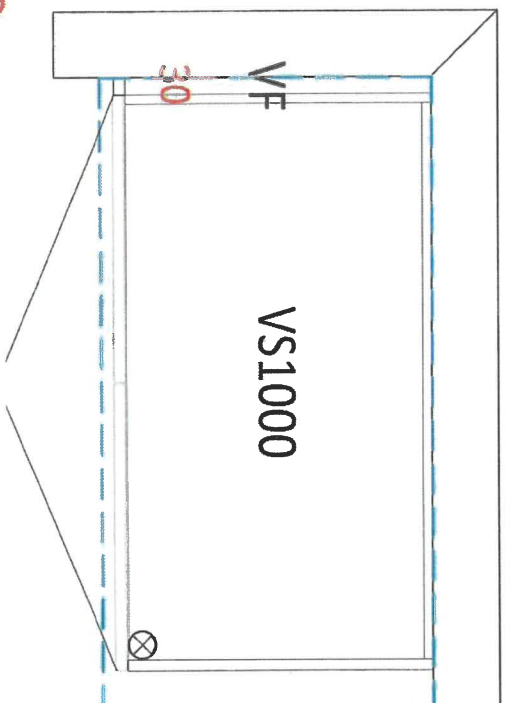

945

945

Main Bath

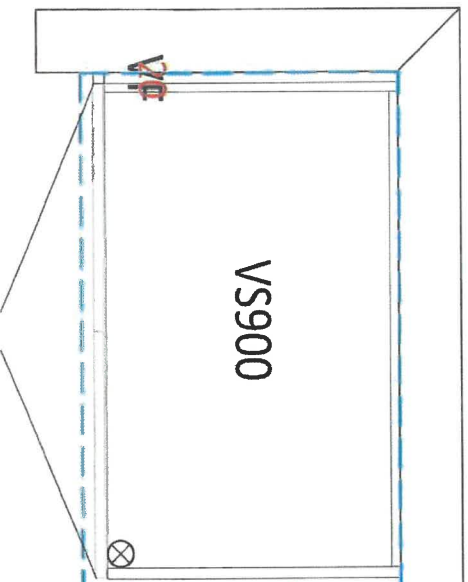

[Handwritten signature]

APPLIANCE ACKNOWLEDGEMENT

CONTACT: Steve Miller - Appliance Canada (905) 660-2424 / smiller@appliancecanada.com

- It is the Purchaser's responsibility to coordinate delivery, installation and hook up of appliances and to ensure they are installed as per Manufacturers specifications after closing.

STANDARD APPLIANCE OPENINGS provided by Zancor:

*Standard appliance openings are approximate and the minimum required. Sizes may vary due to onsite condition and/or when modifications have been made to the cabinetry.

- Fridge Opening 36" x 74"
- Stove Opening 30"
- Hood Fan Opening 30"
- Hood Fan & Vent 6" with Under Cabinet Hood
- Dishwasher Opening 24"

Accepts Standard
Openings **Initial**OPTIONAL UPGRADED APPLIANCES to be provided by Homeowner:**

- ****Specs/information sheets are required and it is the responsibility of the homeowner to provide this to Zancor Homes by the due date that has been provided. If appliance specs are not submitted, Zancor Homes will not be responsible for any necessary requirements and the standard opening will be built.**



- **Upgraded Appliance Specs are DUE 2 WEEKS FROM SIGNED DATE OF COLOUR CHART (if not received during appointment)**

INITIAL

- ****Specs that require changes/modifications after this date will not be accepted****

- **NOTE: Any upgraded appliances are to be paid by the Purchaser, directly to the appliances company.**

- **Additional charges to the Purchaser may apply for cabinetry, electrical and plumbing in order to accommodate the specs given by the homeowner.**

FRIDGE UPGRADE

- ☐ Built-in
- ☒ Paneled **Panel to match required
- ☐ Integrated / Flush Inset
- ☒ Waterline

RANGE UPGRADE

*Larger hood fan CFM might be required, which need a larger vent

- ☐ 36" **Hood fan opening must be the same size or larger (8" vent might be required)
- ☐ 48" **Hood Fan opening must be the same size or larger (8" or 10" vent required)
- ☐ Gas Range **gas line and electrical required & sold separately
- ☐ Induction **electrical required & sold separately
- ☐ Cooktop (Apron Front) **Countertop Cut-out required & sold separately
- ☐ Cooktop (Drop-in) **countertop Cut-out required & sold separately

HOOD FAN & VENT**UPGRADE**

- ☒ 8 Inch **Required for 600 CFM
- ☐ 10 inch
- ☐ Chimney Hood Fan **Vent must be centred
- ☐ Insert / Liner

WALL OVEN/MICRO**UPGRADE**

**Electrical required

- ☒ Single Wall Oven **electrical required & sold separately
- ☐ Double Wall Oven **electrical required & sold separately
- ☐ Steam Oven **electrical required & sold separately
- ☐ Warming Drawer **electrical required & sold separately
- ☐ Over Then Range Microwave (OTR)
- ☐ Built-In Microwave **Trim Kit required **electrical required & sold separately

DATE April 11/22

WASAGA RIVERS EDGE

37

SITE

LOT

** Any upgrades checked in this appliance form must be accompanied with specs provided by the Purchaser.

**It is the responsibility of the trade to inform the Builder of any discrepancies with specs, sketches, extras and/or colour chart PRIOR to production/installation.

ZANCOR

221 North Rivermede Road, Concord, Ontario L4K 3N7 * T: (905) 738.7010 F: (905) 738.5948

INTERIOR FINISHES ACKNOWLEDGEMENT / WAIVER

Purchaser accepts and acknowledges that the Builder reserves the right to substitute materials with those of equal or better quality where the manufacture, scheduling or delivery of materials may directly impact the Builder's ability to meet its' contractual obligations under the Agreement of Purchase and Sale.

UPGRADES/EXTRAS: All upgrades and additional selections indicated on the colour chart must be accompanied by an upgrades/extras sheet (PES) and full payment otherwise the selection will be invalid. All colour charts and upgrades/extras will not proceed until verified and signed by an authorized signing officer at the Vendor's head office. **CHANGES WILL NOT BE PERMITTED UPON COMPLETION AND SUBMISSION OF THE COLOUR CHART.**

PORCELAIN & NATURAL STONES: Due to the properties of natural stones including but not limited to **marble, granite, quartz**, no two pieces are exactly the same. Variations in colour, tone, granularity (pitting, fissures) and pattern are to be expected, including various lighting may affect the overall finished look. Stone tops are sealed at time of installation and should never be cleaned with lemon oil or vinegar. Stones are porous materials, therefore any spilled substance require immediate attention. Stone countertops require regular seal re-application as part of home maintenance. Purchaser acknowledges colour and product variations as well as natural imperfections may exist with the selection of natural stone materials and shall not hold the Vendor liable for provision of same.

STONE COUNTERTOP JOINTS: Purchaser is aware there may be joints in stone counter tops, in kitchens and vanities if applicable as per plan. Joints will also be applicable where the length of the counter top exceeds the length of a stone slab.

CERAMIC TILES: Due to manufacturing, shade (dye lots), product variations may exist that can affect the overall look of the finished product. Although every effort will be made to ensure the colours and materials selected are as close as possible to the samples, the purchaser acknowledges that the sample tiles supplied in the Design Centre may not be identical to the materials installed in the home.

STAIR STAINS: Due to the natural properties of wood, many variables can affect the overall look of the finished product. Factors including but not limited to wood type, knotting, graining, density, age, humidity, and air temperature can result in substantial variations in stain intensity. The purchaser accepts that although the Vendor will do their best to match stain the unfinished stairs as close as possible to the pre-finished floors, it is not possible to have an identical match and that there MAY be shade differences between the two products.

CABINETRY: Due to the natural properties of wood, slight variations apparent with cabinetry are to be expected. This includes but not limited to wood species, wood grain, colour, finish, product variations, and natural imperfections are all factors that may affect the overall look of the finished product. Such factors make exact colour matching impossible. The type and intensity of lighting in the areas of designated cabinetry placement may also highlight characteristics of cabinetry finish. All cabinets shall be finished with a white melamine interior box unless a finished interior is upgraded. Due to building specifications and/or on-site conditions, certain cabinetry upgrades may not be possible. The purchaser acknowledges that the Builder cannot guarantee the cabinetry finish or provision of certain upgrades and shall not hold the Builder liable for provision of same.

UPGRADES/EXTRAS: All upgrades and additional selections indicated on the colour chart must be accompanied by an upgrades/extras sheet (PES) and full payment otherwise the selection will be invalid. All colour charts and upgrades/extras will not proceed until verified and signed by an authorized signing officer at the Vendor's head office. **CHANGES WILL NOT BE PERMITTED UPON COMPLETION AND SUBMISSION OF THE COLOUR CHART.**

HARDWOOD / LAMINATE FLOORING: Due to the properties of wood and laminate, many variables can affect the overall look of the finished product. Variations include but not limited to wood type or laminate finish, colour/stain and wood grain are significant factors that make exact colour matching impossible. The purchaser acknowledges that the hardwood flooring is a pre-finished product in a controlled environment. Expansion, compression and cupping are characteristics of hardwood flooring once installed in the home. The purchaser acknowledges these may become apparent over time and despite the Builders' efforts to install the hardwood flooring materials in keeping with good workmanship, the Builder shall not be responsible nor held liable for minor variances of fluctuation in hardwood flooring materials.

HARDWOOD / LAMINATE WAIVER:

I/We understand hardwood flooring is classified as a porous material and as such not recommended by the Builder in certain areas. I/We understand there is a concern due to possible water and other substances being frequently splashed or spilled onto the floor and in contravention of Ontario Building Code Section 9.30.1.2(1).

"Finished flooring bathrooms, kitchens, public entrance halls, laundry & general storage areas shall consist of resilient flooring, felted-synthetic-fibre floor coverings, concrete, terrazzo, ceramic tile, mastic or other types of flooring providing similar degrees of water resistance."

I/We are prepared to assume full responsibility for any damage caused to the hardwood floor or subfloor due to moisture absorbency in the mentioned areas, and agree to waive any claims against the Township of residence, TARIION and/or the Builder in relation to the matter. ****SEE COLOUR CHART FOR LOCATIONS****

DATE Apr 11/22

SITE WASAGA RIVERS EDGE

LOT

37

BRICK/JOINT PATTERN INSTALLATION RELEASE FORM

***BRICK installation is included as a standard on the floor for 12 x 24 tiles and must be noted on the colour chart and acknowledged on this form ***

(Large tiles installation for floor and wall) – ¼ Brick

Please be advised it has come to our attention, that due to production, many of the over-sized and odd shaped, man-made tiles (i.e. porcelain & ceramic), have been found to have a slight bow in the tile. It is a standard occurrence with all suppliers and manufacturers.

It is therefore recommended, that if and when a purchaser requests to install one of these tiles in a brick-joint pattern, that it be installed 0-1" in a ¼ brick pattern, to try to avoidlippage. Attached with this letter, you will find a layout of the ¼ brick installation that has been recommended.

LOCATIONS: all floors
LOCATIONS: _____
LOCATIONS: _____
LOCATIONS: _____



Please understand, even in using this ¼ brick installation, there may still be minimal lippage which cannot fully be eliminated.

Hence, when there is a request for brick-joint installation, Zancor Homes and their contractor, cannot be held responsible for this matter.

[Signature]
Homeowner(s) Initial

(Small tile installation for walls) – ½ Brick

Purchaser requests to install small wall tiles on a backsplash or shower wall in a brick-joint pattern, that it be installed on a ½ brick pattern.

LOCATIONS: _____
LOCATIONS: _____
LOCATIONS: _____
LOCATIONS: _____



Homeowner(s) Initial

DATE Apr 11/22

SITE WASAGA RIVERS EDGE

LOT 37

Stone Countertop Edge Profiles

Where applicable as per site specifications

STANDARD EDGE FOR KITCHEN & VANITIES

Standard Countertop Edge in Kitchen

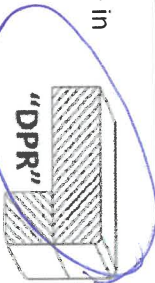

Standard Countertop Edge in Vanity

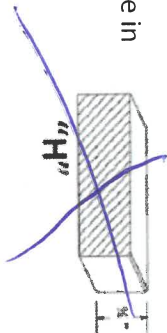

Homeowner(s) Initial

OPTION (1) EDGE FOR KITCHEN & VANITIES \$250

Optional Edge in Kitchen

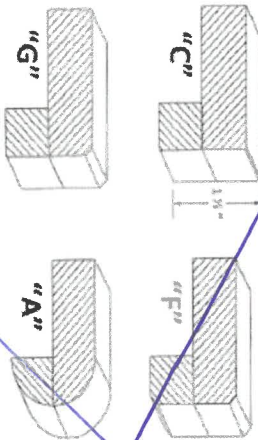

Optional Edge in Bathroom

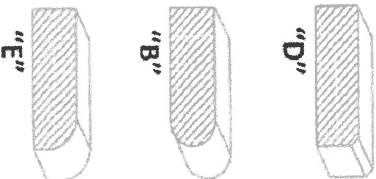

Homeowner(s) Initial

OPTION (2) EDGE FOR KITCHEN & VANITIES CUSTOM PRICING

Optional Edge for Kitchen

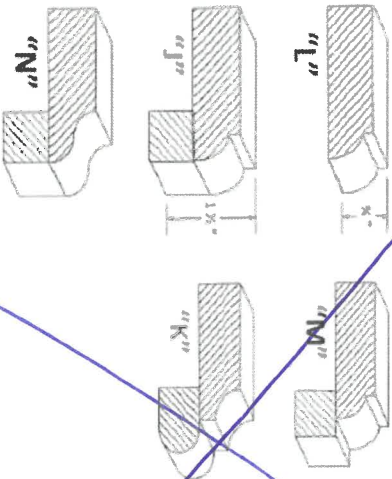

Optional Edge in Vanity

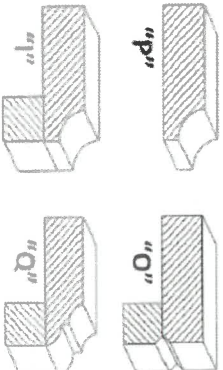

Homeowner(s) Initial

DATE

SITE

LOT

WASAGA RIVERS EDGE

Apr 11/22

ST