

CONSTRUCTION SUMMARY OF EXTRAS  
Printed 2022-05-09 / 11:17 AM / Page 1 of 1

Site:  
Lot:  
Model:  
Purchaser:  
Purchaser:  
Phone:  
Email:

RIVER'S EDGE WASAGA  
241  
SEVERN (40-03) ELEV. B  
ANDREI CARACHEORGHIU  
XIAOTING SUN  
647-705-3427 / 647-678-1130  
ANDREI.CARAGHEORGHIU2@GMAIL.COM /  
EVIESUN@HOTMAIL.COM







DESCRIPTION		DATE SELECTED
	BONUS PACKAGE: 3 PIECE STAINLESS STEEL APPLIANCES WITH WHITE WASHER & DRYER	INCLUDED IN APS
	BONUS PACKAGE: STAINLESS STEEL HOOD FAN	INCLUDED IN APS
	STRUCTURALS	
1	NO STRUCTURAL CHANGES	
	COLOURS	
1	ELECTRICAL- 2 CAPPED LIGHTS OVER KITCHEN ISLAND, SPACED EVENLY ON SEPARATE SWITCH- STD LIGHT TO REMAIN- SEE SECTCH	03-May-22
2	BANK OF DRAWERS IN MASTER	03-May-22
3	CHIMNEY HOOD, DELETE UPPER CABINET AND CENTER VENTING	03-May-22
4	FRIDGE ENCLOSURE- DEEP UPPER AND GABLE	03-May-22
5	RISER AND SHAKER CROWN INSTALLED OVER CABINETS. INSTALL CROWN AT CEILING. HORIZONTAL PANEL ACROSS CHIMNEY HOOD. NO BULKHEAD	03-May-22
6	KITCHEN CABINET- UP 1	03-May-22
7	2 TONE KITCHEN CABINETS- ISLAND TO BE DIFFERENT COLOUR THAN REST OF KITCHEN	03-May-22
8	KITCHEN COUNTEROP- UP 2	03-May-22
9	HARDWOOD-FAMILY ROOM, LANDINGS, LIVING/ DINING/ UPPER HALL	03-May-22
10	STAIN FOR STAIRS TO MATCH HARDWOOD AS CLOSE AS POSSIBLE- 1.5 FLIGHT	03-May-22
11	KITCHEN BACKSPLASH- UP 2- STACKED	03-May-22
12	KITCHEN TILE- UP 4- 12 X 24- STACKED	03-May-22
13	NA	03-May-22
14	POWDER ROOM TILE- 12 X 24- STACKED	03-May-22
15	MASTER COUNTERTOP- UP 3- INCLUDES OVAL UNDERMOUNT SINKS	03-May-22
16	MASTER BATH SHOWER FLOOR- UP 2	03-May-22
17	KITCHEN CABINET HARDWARE	03-May-22
18	COMFORT HEIGHT- MASTER	03-May-22

ZANCOR HOMES COLOUR CHART

PRINTED 2022-05-03, 3:26 PM

ENTRANCES				
Main Foyer - FLOORING	LOFT WHITE 12 X 24- STACKED			
Mudroom - FLOORING	NA			
Side Hall - FLOORING	NA			
Basement Foyer - FLOORING	NA			
KITCHEN				
Kitchen - FLOORING	ETERNA VOLKAS CALCATTA GREY- 12 X 24- STACKED - UP 4			
Breakfast - FLOORING	ETERNA VOLKAS CALCATTA GREY- 12 X 24- STACKED - UP 4			
Kitchen - CABINETS	MOSAIC MDF GLACIER WHITE- UP 1			
Island - CABINETS	MOSAIC MDF FOG GREY- UP 1			
Servery - CABINETS- PANTRY	MOSAIC GLACIER WHITE- UP 1			
Kitchen - HANDLES/KNOBS	H800BC128			
Kitchen - COUNTERTOP	CARRARA WHITE- UP 2			
Island - COUNTERTOP	CARRARA WHITE- UP 2			
Kitchen - BACKSPLASH	COLOUR AND DIMENSION ARCTIC WHITE BRIGHT- 4 X 16- STACKED- UP 2			
Kitchen - SINK	STD			
Kitchen - FAUCET	STD			
GREAT ROOM / DINING / LIVING / DEN / OFFICE / BASEMENT				
Family / Great Room - FLOORING	NORTHERN SOLID SAW SCULPTED UVF RED OAK 5" HARBOR- UP 3			
Main Hall - FLOORING	NORTHERN SOLID SAW SCULPTED UVF RED OAK 5" HARBOR- UP 3			
Dining / Living Room - FLOORING	NORTHERN SOLID SAW SCULPTED UVF RED OAK 5" HARBOR- UP 3			
Library / Den - FLOORING	NA			
Basement Rec Room - FLOORING	NA			
STAIRS				
Railing Details - PICKETS	1 3/4" TURNED OAK			
Railing Details - POSTS	2 3/4" TURNED OAK POST			
Railing Details - HANDRAIL	2 1/2" OVAL OAK			
Stair Stain - MAIN STAIRS	STAIN STAIRS TO MATCH HARDWOOD AS CLOSE AS POSSIBLE			
Stair Stain - BASEMENT STAIRS (if applicable)	NA			
BEDROOMS / BATHROOMS / LAUNDRY				
Powder Room - FLOORING	ETERNA VOLKAS CALCATTA GREY- 12 X 24- STACKED			
Powder Room - CABINETS	NA			
Powder Room - HARDWARE	NA			
Powder Room - COUNTERTOP	NA			
Powder Room - SINK	STD			
Powder Room - FAUCET	STD			
Laundry - FLOORING	LOFT ANTHRACITE 12 X 24- STACKED			
Laundry - CABINETS	SIERRA WHITE PVC	Laundry - HANDLES/KNOBS	H500P	
Laundry - COUNTERTOP	4945-38	Laundry - SINK	STD	
Laundry - BACKSPLASH	NA	Laundry - FAUCET	STD	
Upper Hall - FLOORING	NORTHERN SOLID SAW SCULPTED UVF RED OAK 5" HARBOR- UP 3			
Master Bedroom - FLOORING	T03 OPENING NIGHT			
Bedroom 2 - FLOORING	T03 OPENING NIGHT			
Bedroom 3 - FLOORING	T03 OPENING NIGHT			
Bedroom 4 - FLOORING	T03 OPENING NIGHT			
Bedroom 5 - FLOORING	NA			
Master Ensuite - FLOORING	GENESIS DARK GREY 12 X 24- STACKED			
Master Ensuite - SHOWER WALL	NEW BYZANTINE ASSURO BLUE 12 X 24- STACKED VERTICAL			
Master Ensuite - SHOWER FLOOR	ONTARIO HEX SERIES DARK GREY MATTE- UP 2			
Master Ensuite - SHOWER JAMB	BIANCO CARRARA			
Master Ensuite - CABINETS	SIERRA WHITE PVC- COMFORT HEIGHT			
Master Ensuite - HANDLES/KNOBS	H500P			
Master Ensuite - COUNTERTOP				
Master Ensuite - SINK(s)	4220-CFY	BORGHINI CLASSIC- UP 3	Master Ensuite - FAUCET(s)	STD
***FOR TRADE USE***				
Any upgrades in the colour chart must be accompanied with a PES. It is the responsibility of all Trades to inform the builder of any discrepancies on sketches, PES and/or colour charts PRIOR to installation.		RIVERS EDGE WASAGA 241	XB	VENDOR APPROVAL
		**PAGE 1 OF 2**	PURCHASER INITIALS	

2ND FLOOR CONTINUED...				
Main Bath - FLOORING	NEW BYZANTINE ASSURO BLUE 12 X 24- STACKED			
Main Bath - TUB / SHOWER WALL	NEW BYZANTINE ASSURO BLUE 12 X 24- STACKED VERTICAL			
Main Bath - SHOWER FLOOR	NA			
Main Bath - SHOWER JAMB	NA			
Main Bath - CABINETS	SIERRA WHITE PVC			
Main Bath - HANDLES/KNOBS	H500P			
Main Bath - COUNTERTOP	P-345-CA			
Main Bath - SINK(s)	STD		Main Bath - FAUCET(s)	STD
Shared Bath- FLOORING	NA			
Shared Bath- TUB / SHOWER WALL	NA			
Shared Bath- SHOWER FLOOR	NA			
Shared Bath- SHOWER JAMB	NA			
Shared Bath- CABINETS	NA			
Shared Bath- HANDLES/KNOBS	NA			
Shared Bath- COUNTERTOP	NA			
Shared Bath- SINK(s)	NA		Shared Bath - FAUCET(s)	NA
Ensuite Bath - FLOORING	NA			
Ensuite Bath - TUB / SHOWER WALL	NA			
Ensuite Bath - SHOWER FLOOR	NA			
Ensuite Bath - SHOWER JAMB	NA			
Ensuite Bath - CABINETS	NA			
Ensuite Bath - HANDLES/KNOBS	NA			
Ensuite Bath - COUNTERTOP	NA			
Ensuite Bath - SINK(s)	NA		Ensuite Bath - FAUCET(s)	NA
TRIM / PAINT				
Casing/Baseboards	STD			
Interior Door STYLE	STD			
Interior Door HEIGHT	STD			
Interior Door Hardware	STD			
PAINT - Throughout	COOL WHITE			
FIREPLACE				
Location / Insert / Mantle	STD			
ACCESSORIES				
Mirrors	YES		BATH ACCESSORIES	UPGRADE
APPLIANCE REQUIREMENTS				
GAS LINE TO BBQ	STD		ELECTRICAL for Built-in Oven	DECLINED
GAS LINE & ELECTRICAL TO STOVE	DECLINED		ELECTRICAL for Built-in Micro	DECLINED
GAS LINE & ELECTRICAL TO DRYER	DECLINED		ELECTRICAL for Cooktop	DECLINED
HOOD FAN VENT SIZE	6" STD		ELECTRICAL for Bar Fridge	DECLINED
WATERLINE to Fridge	DECLINED			
DISCLAIMER				INITIALS
Any changes to the colour chart after signing are subject to a \$5000 administration fee plus costs				X XS
Purchaser has checked and acknowledged accuracy of colour and selections before signing.				X XS
Colours of all materials are as close as possible to Builders selection but not necessarily identical due to dye lot variances in manufacturing/manufacturers. Due to construction progress some items may have been pre-selected or installed. In this event the Vendor's selection must be accepted by the purchaser				
SITE / LOT:	RIVER'S EDGE WASAGA			241 ✓
PURCHASER(S):	ANDREI CARACHEORGHII			
PURCHASER(S):	XIAOTING SUN			
PHONE #:	647-705-3427 / 647-678-1130			
EMAIL:	ANDREI.CARACHEORGHII2@GMAIL.COM / EVIESUN@HOTMAIL.COM			
***FOR TRADE USE***				
Any upgrades in the colour chart must be accompanied with a PES. It is the responsibility of all Trades to inform the builder of any discrepancies on sketches, PES and/or colour charts PRIOR to installation.			PURCHASER SIGNATURE	
			PURCHASER SIGNATURE	
			DÉCOR CONSULTANT	
			Vendor APPROVAL	



10 + 241  
May 3/22

# 40-03 Severn

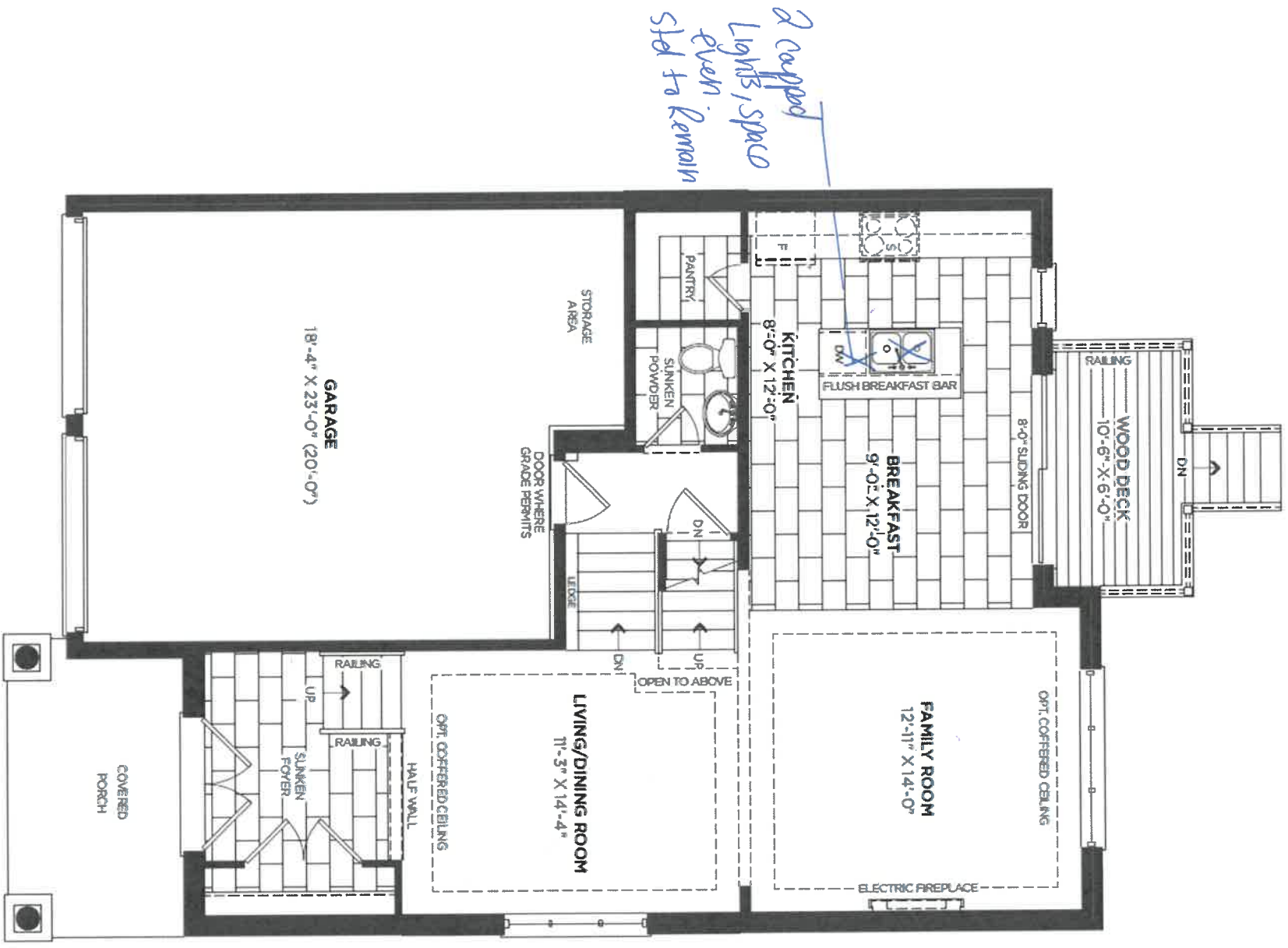

MAIN FLOOR ELEVATION A *AB*

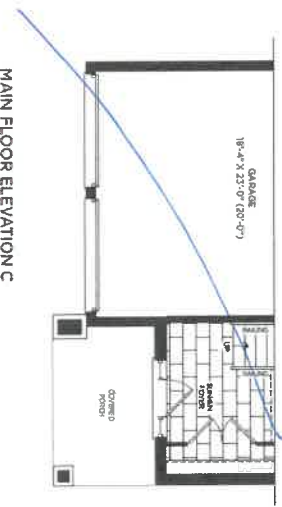
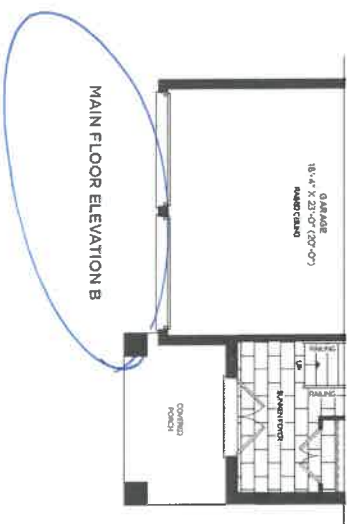

*AS*

1 of 24 /  
May 3/21

# 40-03 Severn

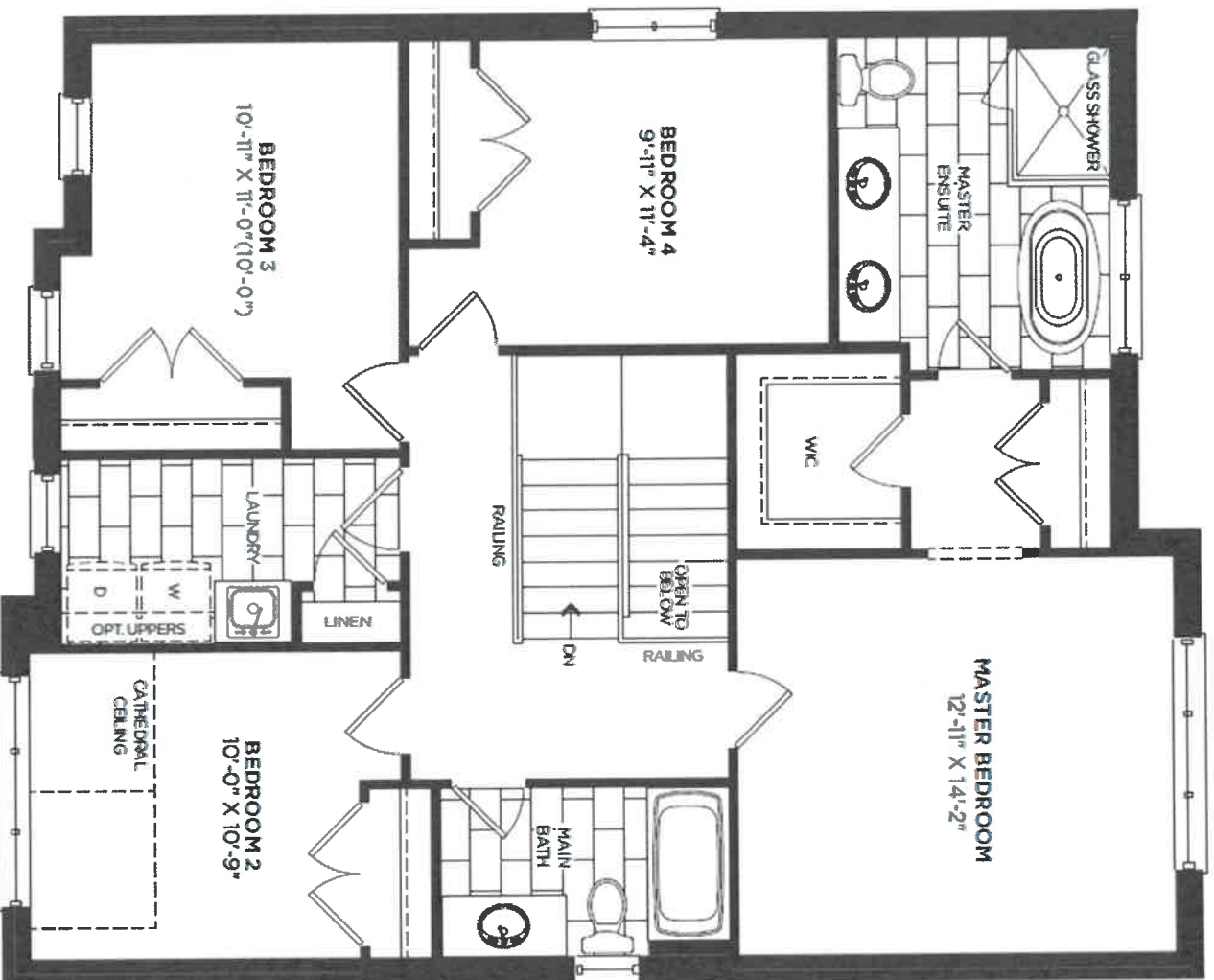

SECOND FLOOR ELEVATION A *B*

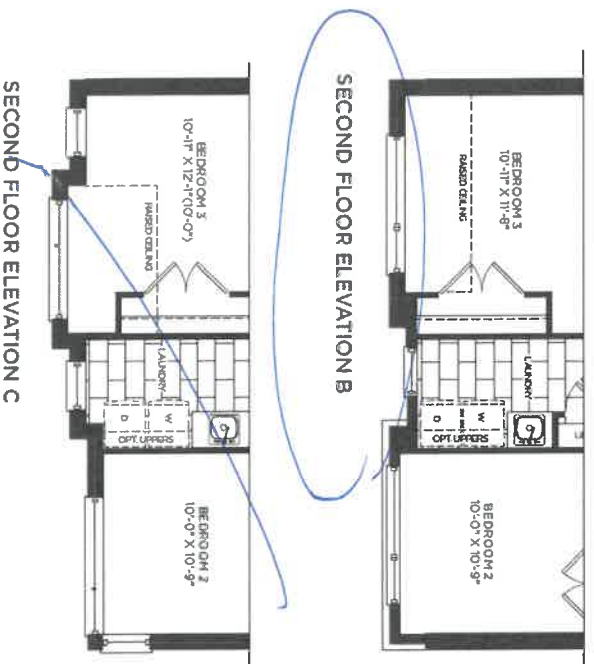

SECOND FLOOR ELEVATION C

X 5

lot 24/  
May 3/22

## 40-03 Severn

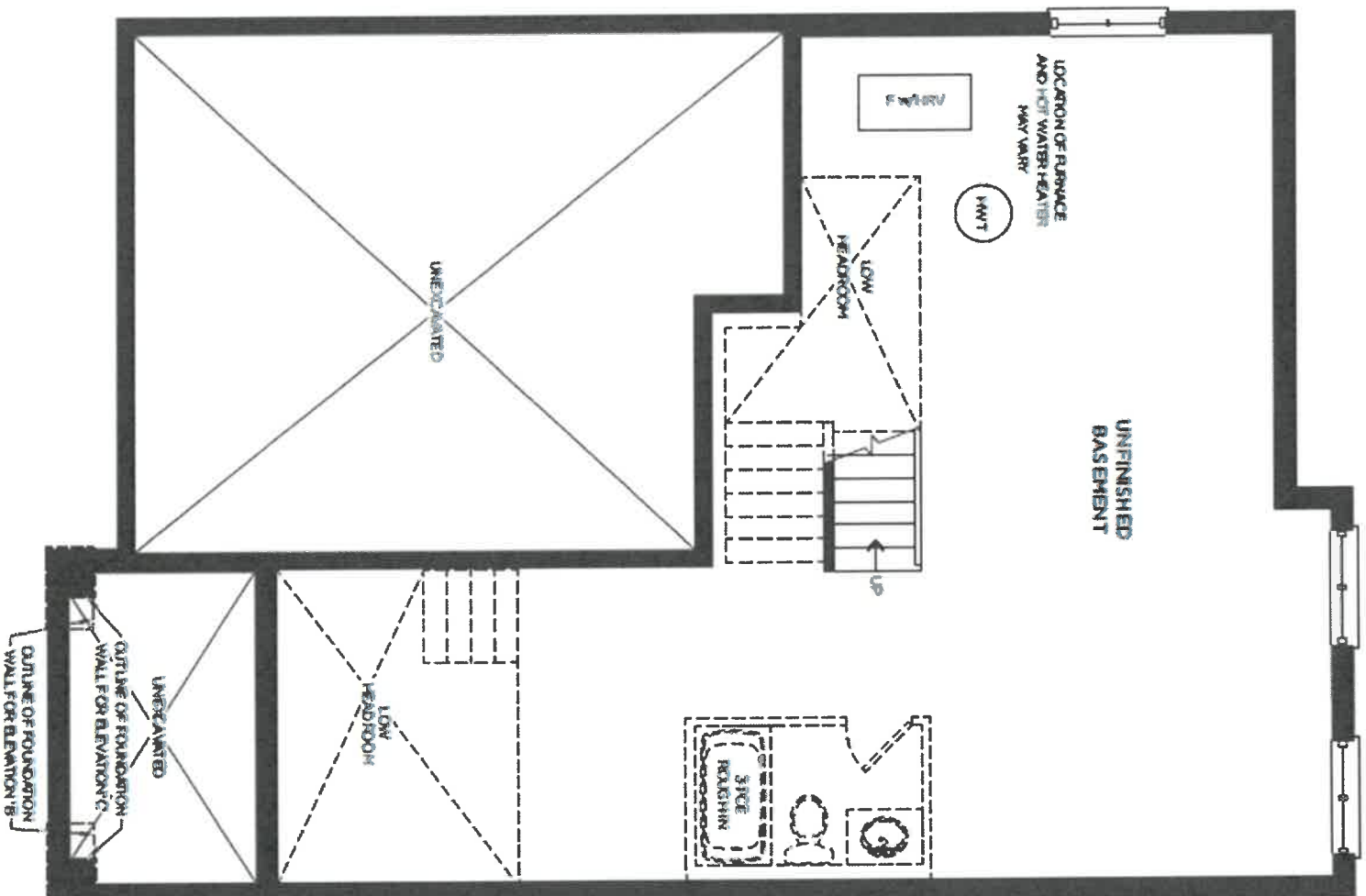

BASEMENT ELEVATION A, B & C

X5

CLIENT NAME: ZANCOR HOMES  
SHIP TO : Rivers Edge Sunnisdale Trails  
#40-03

JOB NUMBER

INSTALL DATE:

PH:

CELL:

DRAFTED BY: Binta

COMMENT

P/O #

PAGE

2 of 2

DATE SUBMITTED

01 Mar 2022

1180  
1180

Oct 24/  
May 3/22

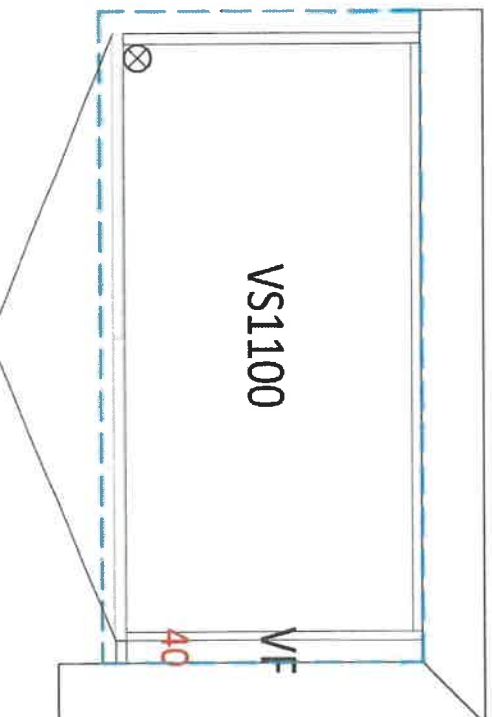

Main Bath

2130  
2130

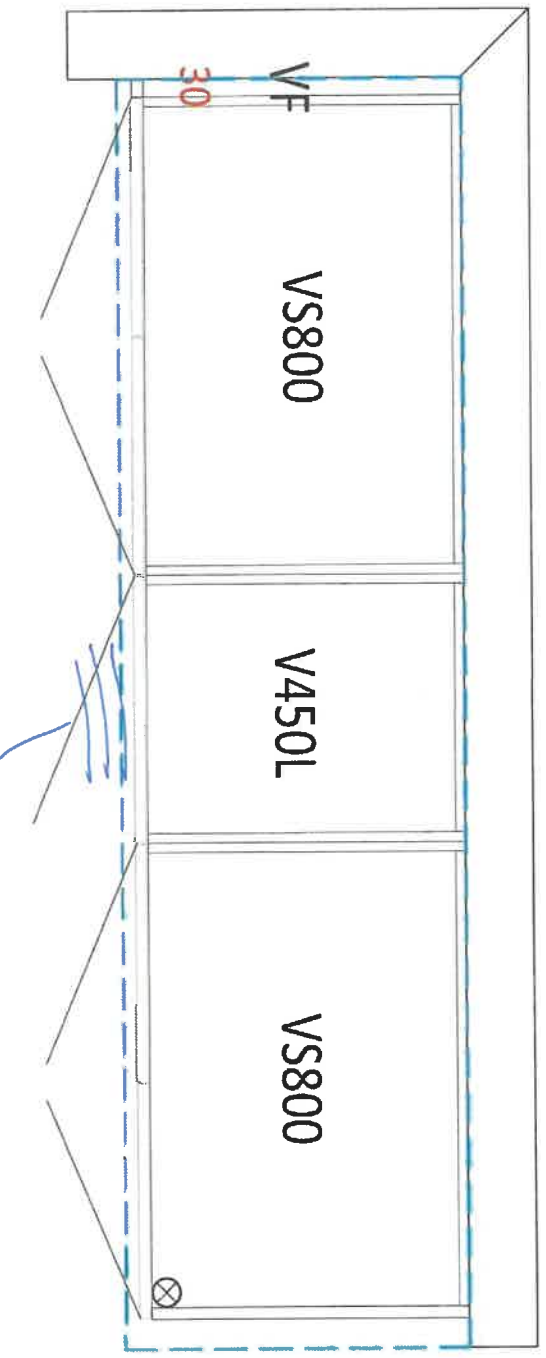

Master Ensuite

Conrad  
Hofmeyer

Bank of chevers

X 5



DATE SUBMITTED  
01 Mar 2022

CLIENT NAME: ZANCOR HOMES  
SHIP TO : Rivers Edge Sunnisdale Trails  
#40-03

PH:  
CELL :

DRAFTED BY: Binta  
COMMENT

P/O #

JOB NUMBER

INSTALL DATE:

PAGE

1 of 2

lot 241  
11/04/22

3650

500

770

1420

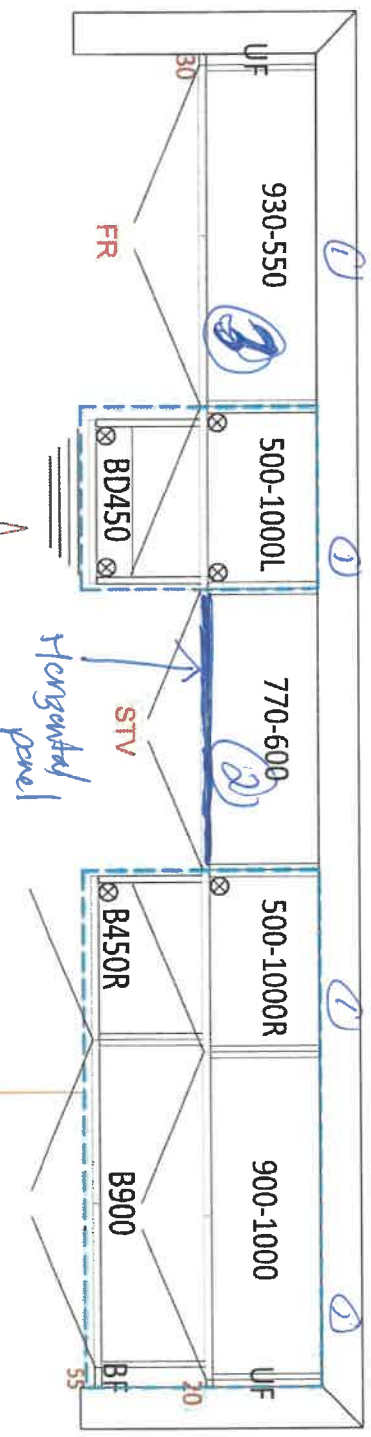

Cutlery Divider  
Soft Close Doors & Drawers

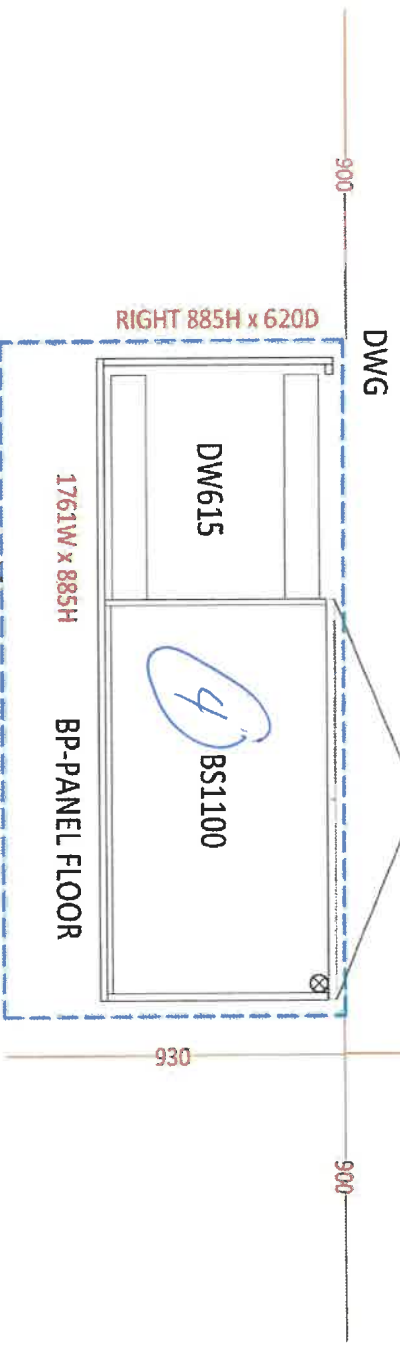

Kitchen

- ① Riser + Shaker crown, installed over cabinets. crown installed @ ceiling
- ② Chimney Hood
- ③ Fridge enclosure
- ④ Island different colour than kitchen

2280

750

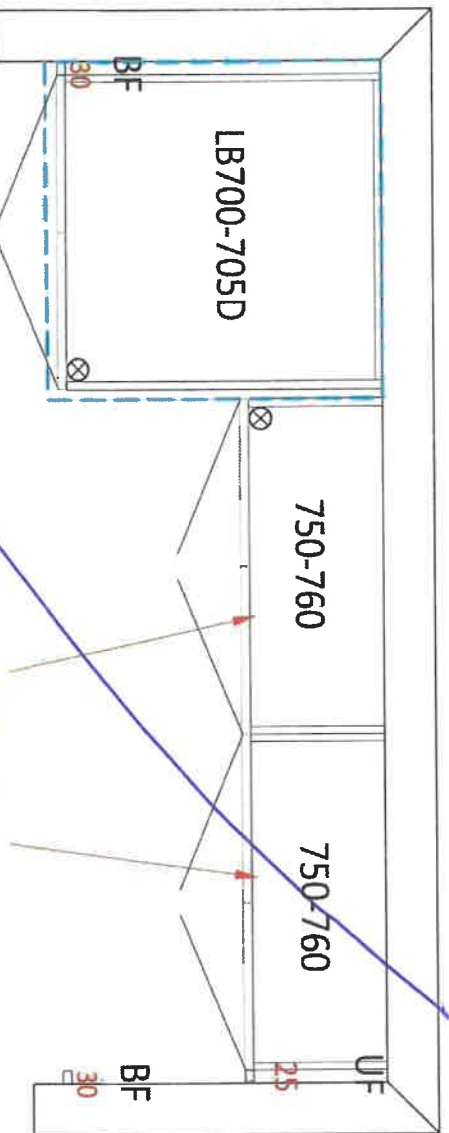

Optional Uppers

Laundry

AS



## APPLIANCE ACKNOWLEDGEMENT

**CONTACT: Steve Miller - Appliance Canada (905) 660-2424 / smiller@appliancecanada.com**

- It is the Purchaser's responsibility to coordinate delivery, installation and hook up of appliances and to ensure they are installed as per Manufacturers specifications after closing.

### STANDARD APPLIANCE OPENINGS provided by Zancor:

\*Standard appliance openings are approximate and the minimum required. Sizes may vary due to onsite condition and/or when modifications have been made to the cabinetry.

- Fridge Opening 36" x 74"
- Stove Opening 30"
- Hood Fan Opening 30"
- Hood Fan & Vent 6" with Under Cabinet Hood
- Dishwasher Opening 24"

Accepts Standard  
Openings \*\*Initial

✓XS

### OPTIONAL UPGRADED APPLIANCES to be provided by Homeowner:

- **\*\*Specs/information sheets are required and it is the responsibility of the homeowner to provide this to Zancor Homes by the due date that has been provided. If appliance specs are not submitted, Zancor Homes will not be responsible for any necessary requirements and the standard opening will be built.**

✓XS

- **Upgraded Appliance Specs are DUE 2 WEEKS FROM SIGNED DATE OF COLOUR CHART (if not received during appointment)**

INITIAL

- \*\*\*Specs that require changes/modifications after this date will not be accepted\*\*\*

- NOTE: Any upgraded appliances are to be paid by the Purchaser, directly to the appliances company.

- Additional charges to the Purchaser may apply for cabinetry, electrical and plumbing in order to accommodate the specs given by the homeowner.

### FRIDGE UPGRADE

- ☐ Built-in
- ☐ Paneled \*\*Panel to match required
- ☐ Integrated / Flush Inset
- ☐ Waterline

### RANGE UPGRADE

\*Larger hood fan CFM might be required, which need a larger vent

- ☐ 36" \*\*Hood fan opening must be the same size or larger (8" vent might be required)
- ☐ 48" \*\*Hood Fan opening must be the same size or larger (8" or 10" vent required)
- ☐ Gas Range \*\*gas line and electrical required & sold separately
- ☐ Induction \*\*electrical required & sold separately
- ☐ Cooktop (Apron Front) \*\*Countertop Cut-out required & sold separately
- ☐ Cooktop (Drop-in) \*\*countertop Cut-out required & sold separately

### HOOD FAN & VENT UPGRADE

- ☐ 8 Inch \*\*Required for 600 CFM
- ☐ 10 Inch
- ☒ Chimney Hood Fan \*\*Vent must be centred
- ☐ Insert / Liner

### WALL OVEN/MICRO UPGRADE

- ☐ Single Wall Oven \*\*electrical required & sold separately
- ☐ Double Wall Oven \*\*electrical required & sold separately
- ☐ Steam Oven \*\*electrical required & sold separately
- ☐ Warming Drawer \*\*electrical required & sold separately
- ☐ Over Then Range Microwave (OTR)
- ☐ Built-In Microwave \*\*Trim Kit required \*\*electrical required & sold separately

DATE May 3/22

WASAGA RIVERS EDGE

241

SITE

LOT

\*\* Any upgrades checked in this appliance form must be accompanied with specs provided by the Purchaser.

\*\*It is the responsibility of the trade to inform the Builder of any discrepancies with specs, sketches, extras and/or colour chart PRIOR to production/installation.

ZANCOR

221 North Rivermede Road, Concord, Ontario L4K 3N7 \* T: (905) 738.7010 F: (905) 738.5948

## INTERIOR FINISHES ACKNOWLEDGEMENT / WAIVER

Purchaser accepts and acknowledges that the Builder reserves the right to substitute materials with those of equal or better quality where the manufacture, scheduling or delivery of materials may directly impact the Builder's ability to meet its' contractual obligations under the Agreement of Purchase and Sale.

**UPGRADES/EXTRAS:** All upgrades and additional selections indicated on the colour chart must be accompanied by an upgrades/extras sheet (PES) and full payment otherwise the selection will be invalid. All colour charts and upgrades/extras will not proceed until verified and signed by an authorized signing officer at the Vendor's head office. **CHANGES WILL NOT BE PERMITTED UPON COMPLETION AND SUBMISSION OF THE COLOUR CHART.**

**PORCELAIN & NATURAL STONES:** Due to the properties of natural stones including but not limited to **marble, granite, quartz,** no two pieces are exactly the same. Variations in colour, tone, granularity (pitting, fissures) and pattern are to be expected, including various lighting may affect the overall finished look. Stone tops are sealed at time of installation and should never be cleaned with lemon oil or vinegar. Stones are porous materials, therefore any spilled substance require immediate attention. Stone countertops require regular seal re-application as part of home maintenance. Purchaser acknowledges colour and product variations as well as natural imperfections may exist with the selection of natural stone materials and shall not hold the Vendor liable for provision of same.

**STONE COUNTERTOP JOINTS:** Purchaser is aware there may be joints in stone counter tops, in kitchens and vanities if applicable as per plan. Joints will also be applicable where the length of the counter top exceeds the length of a stone slab.

**CERAMIC TILES:** Due to manufacturing, shade (dye lots), product variations may exist that can affect the overall look of the finished product. Although every effort will be made to ensure the colours and materials selected are as close as possible to the samples, the purchaser acknowledges that the sample tiles supplied in the Design Centre may not be identical to the materials installed in the home.

**STAIR STAINS:** Due to the natural properties of wood, many variables can affect the overall look of the finished product. Factors including but not limited to wood type, knotting, graining, density, age, humidity, and air temperature can result in substantial variations in stain intensity. The purchaser accepts that although the Vendor will do their best to match stain the unfinished stairs as close as possible to the pre-finished floors, it is not possible to have an identical match and that there MAY be shade differences between the two products.

**CABINETRY:** Due to the natural properties of wood, slight variations apparent with cabinetry are to be expected. This includes but not limited to wood species, wood grain, colour, finish, product variations, and natural imperfections are all factors that may affect the overall look of the finished product. Such factors make exact colour matching impossible. The type and intensity of lighting in the areas of designated cabinetry placement may also highlight characteristics of cabinetry finish. All cabinets shall be finished with a white melamine interior box unless a finished interior is upgraded. Due to building specifications and/or on-site conditions, certain cabinetry upgrades may not be possible. The purchaser acknowledges that the Builder cannot guarantee the cabinetry finish or provision of certain upgrades and shall not hold the Builder liable for provision of same.

**UPGRADES/EXTRAS:** All upgrades and additional selections indicated on the colour chart must be accompanied by an upgrades/extras sheet (PES) and full payment otherwise the selection will be invalid. All colour charts and upgrades/extras will not proceed until verified and signed by an authorized signing officer at the Vendor's head office. **CHANGES WILL NOT BE PERMITTED UPON COMPLETION AND SUBMISSION OF THE COLOUR CHART.**

**FLOOR TRANSITIONS:** Transition strips will be used between

**HARDWOOD / LAMINATE FLOORING:** Due to the properties of wood and laminate, many variables can affect the overall look of the finished product. Variations include but not limited to wood type or laminate finish, colour/stain and wood grain are significant factors that make exact colour matching impossible. The purchaser acknowledges that the hardwood flooring is a pre-finished product in a controlled environment. Expansion, compression and cupping are characteristics of hardwood flooring once installed in the home. The purchaser acknowledges these may become apparent over time and despite the Builders' efforts to install the hardwood flooring materials in keeping with good workmanship, the Builder shall not be responsible nor held liable for minor variances of fluctuation in hardwood flooring materials.

### HARDWOOD / LAMINATE WAIVER:

I/We understand hardwood flooring is classified as a porous material and as such not recommended by the Builder in certain areas. I/We understand there is a concern due to possible water and other substances being frequently splashed or spilled onto the floor and in contravention of Ontario Building Code Section 9.30.1.2(1).

*"Finished flooring bathrooms, kitchens, public entrance halls, laundry & general storage areas shall consist of resilient flooring, felted-synthetic-fibre floor coverings, concrete, terrazzo, ceramic tile, mastic or other types of flooring providing similar degrees of water resistance."*

I/We are prepared to assume full responsibility for any damage caused to the hardwood floor or subfloor due to moisture absorbency in the mentioned areas, and agree to waive any claims against the Township of residence, TARIION and/or the Builder in relation to the matter. **\*\*SEE COLOUR CHART FOR LOCATIONS\*\***

DATE	MAY 31/22	SITE	WASAGA RIVERS EDGE	LOT	241
------	-----------	------	--------------------	-----	-----

## HOME AUTOMATION (Cable, CAT5/6, Telephone)

### INCLUDED IN SCHEDULE "A" IN AGREEMENT OF PURCHASE AND SALE:

- Rough-in for Central Vacuum system piped to garage
- Rough-in for Telephone (2) locations
- Rough-in for Cable TV (2) locations
- Rough-in for Cat-6 Network (3) locations

### CONTACT:

I/we the Homeowner(s) have chosen to contact the Home Automation Company to select the locations of the rough-ins for Cable, CAT6, Telephone as included in our Agreement of Purchase Sale.

I/we the Homeowner(s) will contact the trade within 4 weeks of the date of this release to select locations of the standard rough-ins review other optional products for purchase.

Trade:  
Phone:  
Email:  
Location:

Zygm Lighting &Automation  
(705) 715-1102  
[info@zygmainc.ca](mailto:info@zygmainc.ca)  
11 King Street, Unit 3  
Barrie, Ontario L4N 6B5

### ACKNOWLEDGEMENT:

I/We the homeowner(s) acknowledge that if I/We the homeowners decide to not contact Zygm Lighting & Automation, locations of the standard rough-ins will be installed as per Vendors discretion.

Homeowner(s) Initial

Homeowner(s) Initial

DATE

SITE

LOT

WASAGA RIVERS EDGE



Stone Countertop Edge Profiles

\*\*Where applicable as per site specifications\*\*

STANDARD EDGE FOR KITCHEN & VANITIES

Standard Countertop Edge in Kitchen

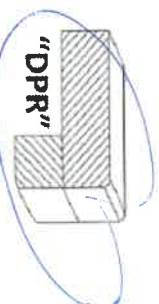

Standard Countertop Edge in Vanity

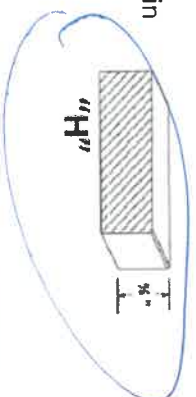

XS

Homeowner(s) Initial

OPTION (1) EDGE FOR KITCHEN & VANITIES \$250

Optional Edge in Kitchen

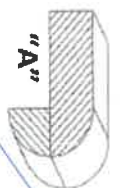
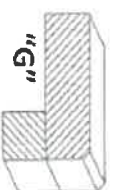
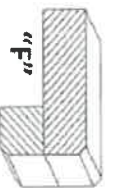
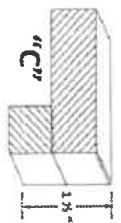

Optional Edge in Bathroom

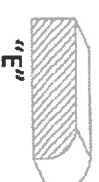
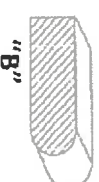
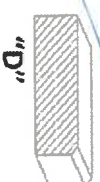

Homeowner(s) Initial

OPTION (2) EDGE FOR KITCHEN & VANITIES CUSTOM PRICING

Optional Edge for Kitchen

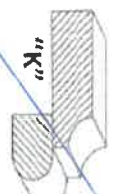
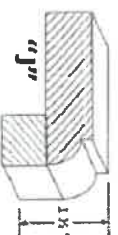
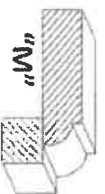
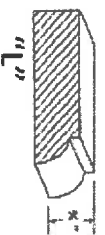

Optional Edge in Vanity

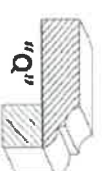
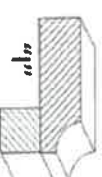
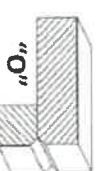
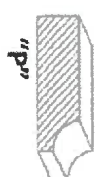

Homeowner(s) Initial

DATE

May 3/22

SITE

WASAGA RIVERS EDGE

LOT

241



lot 241  
May 3/21

## Method™

Traditional | Transitional | Modern

\$125 per bathroom for (2) items



**Double Robe Hook**  
Model YB2403

Chrome  
Other

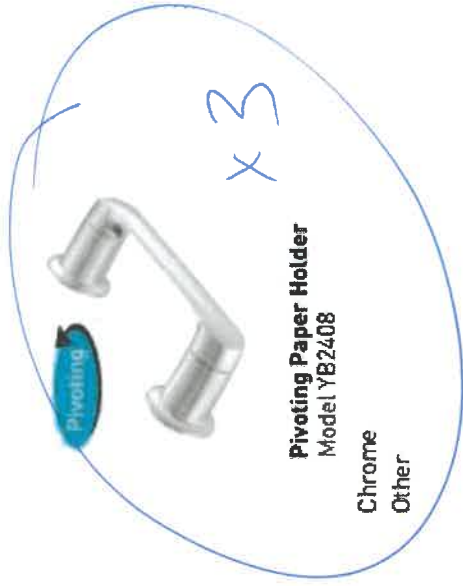

**Pivoting Paper Holder**  
Model YB2408

Chrome  
Other



**18" Towel Bar**  
Model YB2418

Chrome  
Other

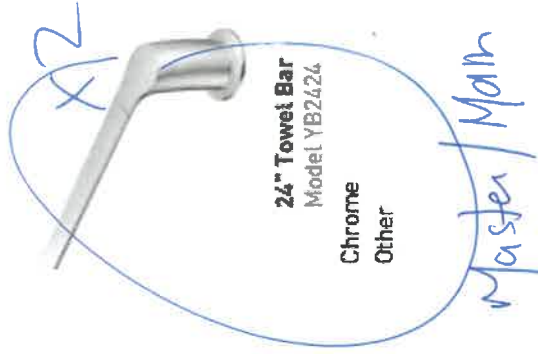

**24" Towel Bar**  
Model YB2424

Chrome  
Other

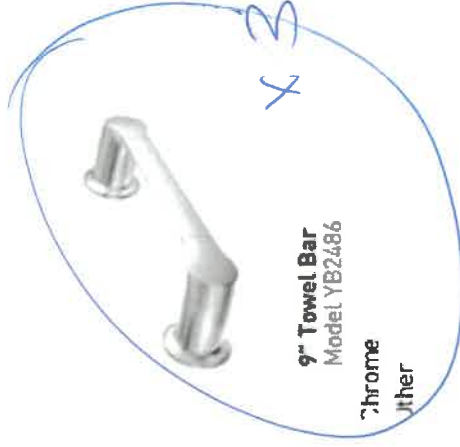

**9" Towel Bar**  
Model YB2486

Chrome  
Other

**PROOFIT™**  
INSTALLATION SYSTEM



### FINISH OPTIONS:

To order, combine the model number with one of these finish letter(s):  
Chrome (CH), LifeShine® Brushed Nickel (BN).

x3