

CONSTRUCTION SUMMARY OF EXTRAS
Printed 2022-04-22 / 3:19 PM / Page 1 of 2

Site: WASAGA
Lot: 132
Model: PIER (40-07) ELEV
Purchaser: HELEN YU
Purchaser: 0
Phone: 416.886.2802
Email: HELEN.YU1991@GMAIL.COM



DESCRIPTION		DATE SELECTED
BONUS PACKAGE: 3 PIECE STAINLESS STEEL APPLIANCES WITH WHITE TOP LOAD WASHER & DRYER		INCLUDED IN APS
BONUS PACKAGE: STAINLESS STEEL HOOD FAN		INCLUDED IN APS
1	ELECTRICAL- 50" DIMPLEX- BLF5051- IN LIEU OF STANDARD. WALL WILL BE BUILT INTO ROOM APPROX 8 " TO ACCOMMODATE- SEE SKETCH	28-Sep-21
2	ELECTRICAL- PLUG FOR FUTURE TV OVER FIREPLACE. INSTALL 65 AFF, BESIDE CABLE- SEE SKETCH	28-Sep-21
3	ELECTRICAL- 2 CARPED LIGHTS OVER KITCHEN ISLAND, SPACED EVENLY ON SEPARATE SWITCH.	28-Sep-21
4	ELECTRICAL- QTY 6 POTLIGHTS IN KITCHEN ON SAME SWITCH. DELETE STANDARD LIGHT- SEE SKETCH	28-Sep-21
5	ELETRICAL- QTY 4 EXTERIOR POTLIGHT ON SEPARATE SWITCH- SEE SKETCH	28-Sep-21
6	ELECTRICAL- KITCHEN- HIDDEN LIGHT VALANCE- QTY 4 PUCK LIGHTS ON SEPARATE SWITCH- SEE SKETCH	28-Sep-21
7	SMOOTH CEILINGS- MAIN FLOOR	28-Sep-21
8	SMOOTH CEILINGS- SECOND FLOOR	28-Sep-21
9	BANK OF DRAWERS IN MASTER	28-Sep-21
10	CABINETS- LAUNDRY UPPER CABINETS	28-Sep-21
11	HARDWOOD- FAMILY ROOM, INCLUDES LANDING, DINING ROOM, MAIN HALL, UPPER HALL- UP 3	28-Sep-21
12	STAIN FOR STAIRS TO MATCH HARDWOOD AS CLOSE AS POSSIBLE	28-Sep-21
13	HARDWOOD IN BEDROOMS- MASTER BEDROOM, BEDROOM 2, 3, 4- HARDWOOD- UP 3	28-Sep-21
14	RAILING- UP 2	28-Sep-21
15	PLUMBING- QTY 2 RECTANGLE SINK- 4220CIV IN MASTER BATH	28-Sep-21
16	PLUMBING- CONTRA CAL ONE PIECE 4710BOV- MASTER BATH- SEE SPEC	28-Sep-21
17	KITCHEN- DELETE UPPER CABINET FOR FUTURE CHIMNEY HOOD AND CENTER VENTING- SEE SPEC/SKETCH	28-Sep-21
18	KITCHEN CABINET- UP 1	28-Sep-21
19	NA	28-Sep-21
20	KITCHEN/ BREAKFAST- TILE- 12 X 24- BRICKED- UP 2	28-Sep-21
21	KITCHEN COUNTER- UP 3, INCLUDES UNDERMOUNT SINK <i>BLANCO</i>	28-Sep-21
22	FOYER- TILE- 12 X 24 BRICKED- UP 2	28-Sep-21
23	POWDER ROOM TILE- 12 X 24 BRICKED- UP 2	28-Sep-21
24	MUD ROOM TILE 12 X 24 BRICKED- UP 2	28-Sep-21
25	MASTER BATH FLOOR TILE- 12 X 24- BRICKED- UP 5	28-Sep-21
26	MASTER BATH WALL TILE- 12 X 24- STACKED- UP 5	28-Sep-21
27	MASTER BATH SHOWER FLOOR- UP 2	28-Sep-21
28	MASTER BATH CABINET- UP 1	28-Sep-21
29	MASTER BATH COUNTER- UP 2- INCLUDES QTY 2 oval UNDERMOUNT SINK <i>RECTANGLE SEE#15</i>	28-Sep-21
30	MAIN BATH COUNTER- UP 2- INCLUDES OVAL UNDERMOUNT SINK	28-Sep-21
31	MAIN BATH- FLOOR TILE-12 X 24- BRICKED-UP 2	28-Sep-21
32	COMFORT HEIGHT- QTY 3- MASTER, MAIN AND BASEMENT BATH	28-Sep-21
33	GASLINE FOR STOVE- INCLUDES 15 AMP, 40 AMP TO REMAIN	28-Sep-21
34	WATERLINE FOR FRIDGE	28-Sep-21
35	COMPLETE LENNOX AIR CONDITIONER (13 ACX) INSTALLED. **SIZED ACCORDING TO HVAC CALCULATIONS**	28-Sep-21
36	FINISHED 3 PCE BATHROOM W/ VANITY, TOILET & TUB IN BASEMENT- SEE SKETCH	28-Sep-21
37	8 FOOT INTERIOR DOORS ON MAIN FLOOR IN LIEU OF STANDARD, CLERANCES PERMITTED QTY 7- SEE SKETCH	28-Sep-21
38	7 FOOT INTERIOR DOORS ON SECOND FLOOR IN LIEU OF STANDARD, CLEARANCES PERMITTED- QTY 10- SEE SKETCH	28-Sep-21
39	PIVOTING PAPER HOLDER - YB2408- METHOD- QTY 4- POWDER, MAIN, ENSUITE	28-Sep-21
40	24 TOWEL BAR- YB2424- MOEN- QTY 3- MASTER AND MAIN, BASEMENT BATH	28-Sep-21
41	9" TOWEL BAR- YB2486- MOEN- INSTALL NEAR SINK FOR HAND TOWEL QTY 4- POWDER, MAIN, ENSUITE, BASEMENT BATH	28-Sep-21

CONSTRUCTION SUMMARY OF EXTRAS

Printed 2022-04-22 / 3:19 PM / Page 2 of 2

Site:
Lot:
Model:
Purchaser:
Purchaser:
Phone:
Email:

WASAGA
132
PIER (40-07) ELEV
HELEN YU
0
416.886.2802
HELEN.YU1991@GMAIL.COM



DESCRIPTION		DATE SELECTED
ADDITIONAL		
1	ELEVATION CHANGE - NOW ELEVATION "C" (NOT A)	29-Oct-21
2	ELECTRICAL - REQUESTING 3200K LIGHT BULBS FOR THE POTLIGHTS	29-Oct-21
3	APPLIANCE SPECS	
ADDITIONAL IN KITCHEN		
1	BACKSPLASH IN KITCHEN - FULL SLAB TO MATCH KITCHEN COUNTERTOP	19-Apr

ENTRANCES				
Main Foyer - FLOORING		FLOW GREIGE POLISHED 12 X 24-BRICKED- UP 2		
Mudroom - FLOORING		FLOW GREIGE POLISHED 12 X 24-BRICKED- UP 2		
Side Hall - FLOORING		NA		
Basement Foyer - FLOORING		NA		
KITCHEN				
Kitchen - FLOORING		FLOW GREIGE POLISHED 12 X 24-BRICKED- UP 2		
Breakfast - FLOORING		FLOW GREIGE POLISHED 12 X 24-BRICKED- UP 2		
Kitchen - CABINETS		MOSAIC GLACIER WHITE MDF- UP 1		
Island - CABINETS		MOSAIC GLACIER WHITE MDF- UP 1		
Servery - CABINETS		NA		
Kitchen - HANDLES/KNOBS		H800BC		
Kitchen - COUNTERTOP		CALCATTI GOLD- UP 3		
Island - COUNTERTOP		CALCATTI GOLD- UP 3		
Kitchen - BACKSPLASH	APR 19/22	SLAB TO MATCH	DECLINED	COUNTERTOP
Kitchen - SINK		INCLUDES BETHUD	STD	CHINESE
Kitchen - FAUCET			STD	
GREAT ROOM / DINING / LIVING / DEN / OFFICE / BASEMENT				
Family / Great Room - FLOORING		NORTHERN SOLID SAW SCULPTED CHARACTER UV RED OAK 5" ANGORA- UP 3		
Main Hall - FLOORING		NORTHERN SOLID SAW SCULPTED CHARACTER UV RED OAK 5" ANGORA- UP 3		
Dining / Living Room - FLOORING		NORTHERN SOLID SAW SCULPTED CHARACTER UV RED OAK 5" ANGORA- UP 3		
Library / Den - FLOORING		NA		
Basement Rec Room - FLOORING		NA		
STAIRS				
Railing Details - PICKETS		ALL PLAIN BLACK METAL- UP 2		
Railing Details - POSTS		3 1/3" SQUARE OAK POST W/ REVEAL- UP 2		
Railing Details - HANDRAIL		2 3/4" OAK H ANDRAIL- UP 2		
Stair Stain - MAIN STAIRS		STAIN TO MATCH HARDWOOD AS CLOSE AS POSSIBLE		
Stair Stain - BASEMENT STAIRS (if applicable)		NA		
Stair Stain - SERVICE STAIRS (if applicable)		NA		
POWDER ROOM				
Powder Room - FLOORING		FLOW GREIGE POLISHED 12 X 24-BRICKED- UP 2		
Powder Room - CABINETS		NA		
Powder Room - COUNTERTOP		NA		
Powder Room - SINK		STD		
Powder Room - FAUCET		STD		
2ND FLOOR				
Upper Hall - FLOORING		NORTHERN SOLID SAW SCULPTED CHARACTER UV RED OAK 5" ANGORA- UP 3		
Master Bedroom - FLOORING		NORTHERN SOLID SAW SCULPTED CHARACTER UV RED OAK 5" ANGORA- UP 3		
Bedroom 2 - FLOORING		NORTHERN SOLID SAW SCULPTED CHARACTER UV RED OAK 5" ANGORA- UP 3		
Bedroom 3 - FLOORING		NORTHERN SOLID SAW SCULPTED CHARACTER UV RED OAK 5" ANGORA- UP 3		
Bedroom 4 - FLOORING		NORTHERN SOLID SAW SCULPTED CHARACTER UV RED OAK 5" ANGORA- UP 3		
Bedroom 5 - FLOORING		NA		
Master Ensuite - FLOORING		B&W BREACH POLISHED 12 X 24- BRICKED- UP 5		
Master Ensuite - SHOWER WALL		B&W BREACH POLISHED 12 X 24- STACKED VERTICAL- UP 5		
Master Ensuite - SHOWER FLOOR		NERO MARQUINA HEXAGON POLISHED- UP 2		
Master Ensuite - SHOWER JAMB		BIANCO CARRARA		
Master Ensuite - CABINETS		SIERRA MDF BLACK- COMFORT HEIGHT- UP 1		
Master Ensuite - HANDLES/KNOBS		H800BC		
Master Ensuite - COUNTERTOP		BLANCO PURE- UP 2		
Master Ensuite - SINK(s)	4220CIV- QTY 2	Master Ensuite- FAUCET(s)		STD
*** FOR TRADE USE ***				
Any upgrades in the colour chart must be accompanied with a PES. It is the responsibility of all Trades to inform the builder of any discrepancies on sketches, PES and/or colour charts <u>PRIOR</u> to installation.		WASAGA SHORELINE	132	X HY
*** PAGE 1 OF 2 ***		PURCHASER INITIALS	VENDOR APPROVAL	

2ND FLOOR CONTINUED...

Main Bath - FLOORING	FLOW WHITE POLISHED 12 X 24- BRICKED- UP 2		
Main Bath - TUB / SHOWER WALL	LOFT WHITE 12 X 24- STACKED HORIZONTAL		
Main Bath - SHOWER FLOOR	NA		
Main Bath - SHOWER JAMB	NA		
Main Bath - CABINETS	EURO BLACKWOOD- COMFORT HEIGHT		
Main Bath - HANDLES/KNOBS	H800BC		
Main Bath - COUNTERTOP	BLANCO PURE- UP 2		
Main Bath - SINK(s)	OVAL UNDERMOUNT	Main Bath - FAUCET(s)	STD
BASEMENT Bath- FLOORING	LOFT WHITE 12 X 24- BRICKED		
BASEMENT - TUB / SHOWER WALL	LOFT WHITE 12 X 24- STACKED HORIZONTAL		
BASEMENT Bath- SHOWER FLOOR	NA		
BASEMENT Bath- SHOWER JAMB	NA		
BASEMENT Bath- CABINETS	EURO BLACKWOOD- COMFORT HEIGHT		
BASEMENT Bath- HANDLES/KNOBS	H800BC		
BASEMENT Bath- COUNTERTOP	5003-38		
BASEMENT Bath- SINK(s)	STD	Shared Bath - FAUCET(s)	STD
Ensuite Bath - FLOORING	NA		
Ensuite Bath - TUB / SHOWER WALL	NA		
Ensuite Bath - SHOWER FLOOR	NA		
Ensuite Bath - SHOWER JAMB	NA		
Ensuite Bath - CABINETS	NA		
Ensuite Bath - HANDLES/KNOBS	NA		
Ensuite Bath - COUNTERTOP	NA		
Ensuite Bath - SINK(s)	NA	Ensuite Bath - FAUCET(s)	NA
LAUNDRY			
Laundry - FLOORING	LOFT WHITE 12 X 24- BRICKED	Laundry - HANDLES/KNOBS	H800BC
Laundry - CABINETS AND UPERS	EURO BLACKWOOD	Laundry - SINK	STD
Laundry - COUNTERTOP	5003-38	Laundry - FAUCET	STD
Laundry - BACKSPLASH	NA		
TRIM / PAINT			
Casing/Baseboards	STD		
Interior Doors	STD		
Interior Door Hardware	STD		
PAINT - Throughout	WARM GREY		
FIREPLACE			
Location / Insert / Mantle	50" DIMPLEX		
ACCESSORIES			
Mirrors	YES	BATH ACCESSORIES	UPGRADE
APPLIANCE REQUIREMENTS			
GAS LINE TO BBQ	STD	ELECTRICAL for Built-in Oven	DECLINED
GAS LINE & ELECTRICAL TO STOVE	YES	ELECTRICAL for Built-in Micro	DECLINED
GAS LINE & ELECTRICAL TO DRYER	DECLINED	ELECTRICAL for Cooktop	DECLINED
HOOD FAN VENT SIZE	6" STD	ELECTRICAL for Bar Fridge	DECLINED
WATERLINE to Fridge	YES		
DISCLAIMER			
Any changes to the colour chart after signing are subject to a \$5000 administration fee plus costs			
Purchaser has checked and acknowledged accuracy of colour and selections before signing.			
Colours of all materials are as close as possible to Builders selection but not necessarily identical due to dye lot variances in manufacturing/manufacturers. Due to construction progress some items may have been pre-selected or installed. In this event the Vendor's selection must be accepted by the purchaser			
SITE / LOT:	WASAGA		132
PURCHASER(S):	HELEN YU		
PURCHASER(S):	0		
CONTACT:	416.886.2802	HELEN.YU1991@GMAIL.COM	
FOR TRADE USE			
Any upgrades in the colour chart must be accompanied with a PES. It is the responsibility of all Trades to inform the builder of any discrepancies on sketches, PES and/or colour charts PRIOR to installation.			
ZANCOR HOMES		PURCHASER SIGNATURE Helen Yu	
		PURCHASER SIGNATURE	
		DÉCOR CONSULTANT	
		Vendor APPROVAL	

PIER 40-07

lot 132
Sept 28/21

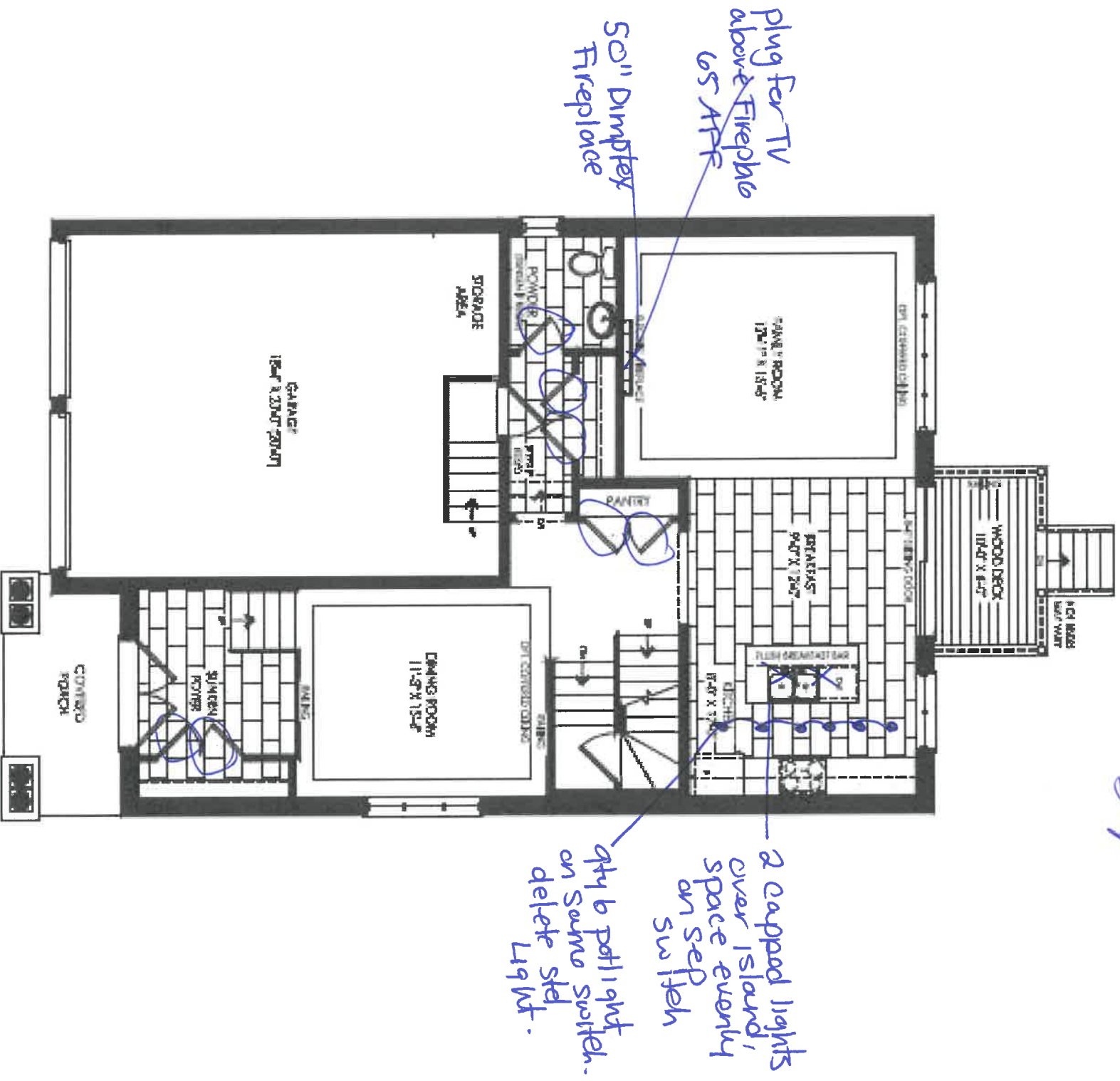

Elevation A
Ground Floor

Qty 7-8 Foot
interior Doors

Smooth ceilings

PIER 40-07

lot 132
Sept 24/21

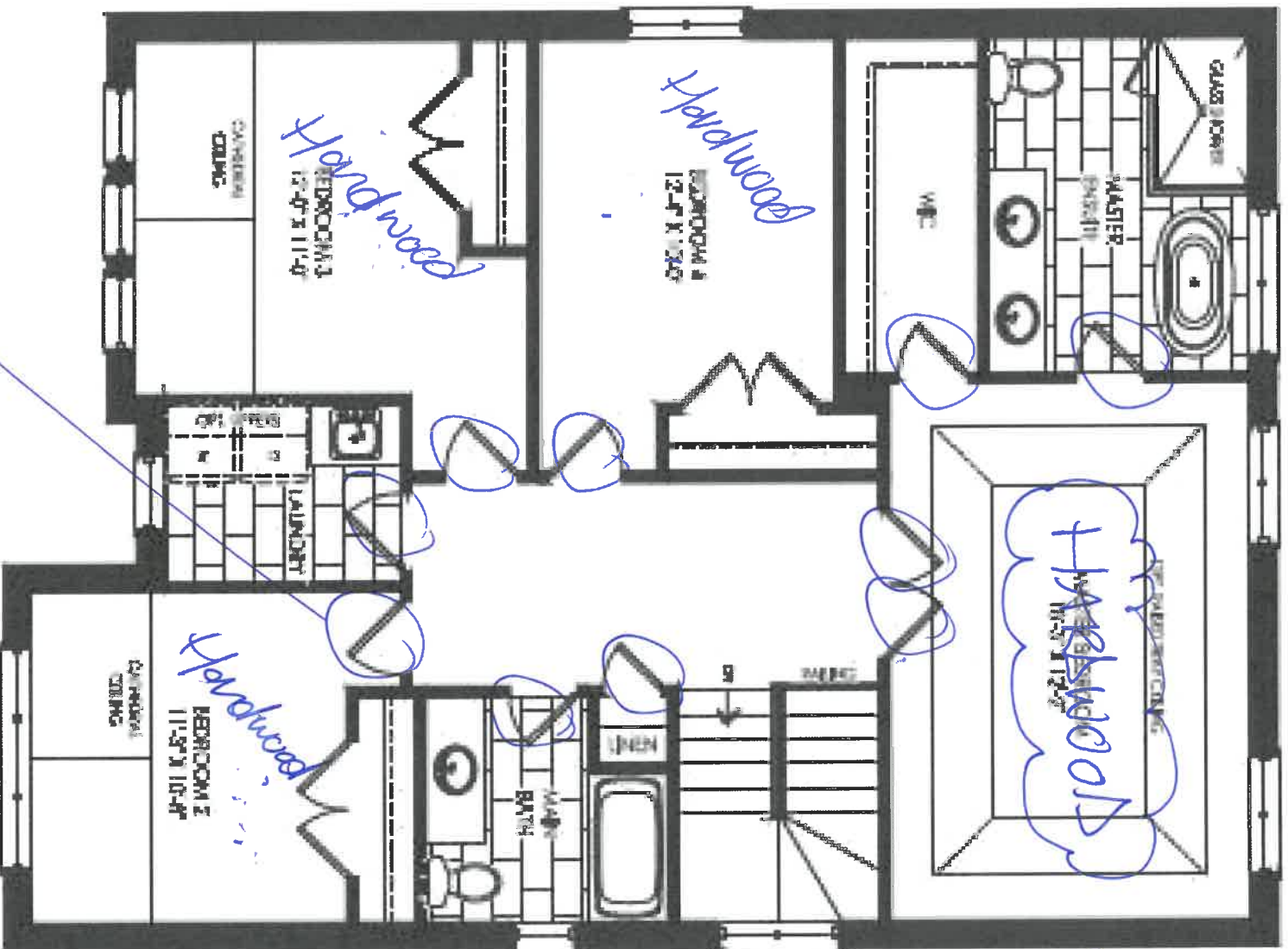

Elevation A
Second Floor

9th 10 - 7 Foot
interior doors.

Smooth
Ceilings

(HV)

PIER 40-07

Lot 132
Sept 28/21

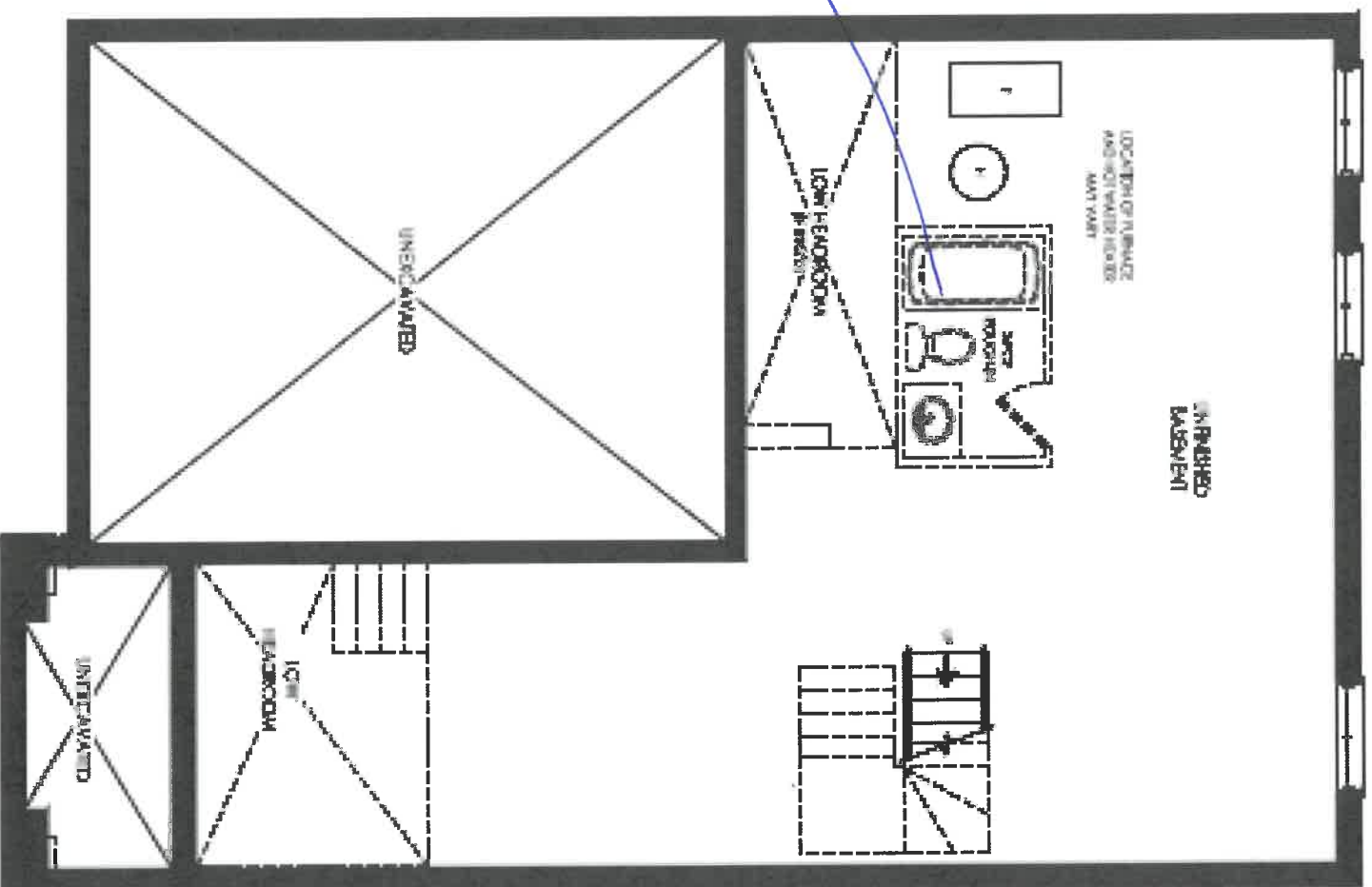

Elevation A, B & C
Basement

TH

FRIGIDAIRE

PROFESSIONAL

FRENCH DOOR COUNTER-DEPTH REFRIGERATOR

21.6 CU. FT.

FPBC2278UF

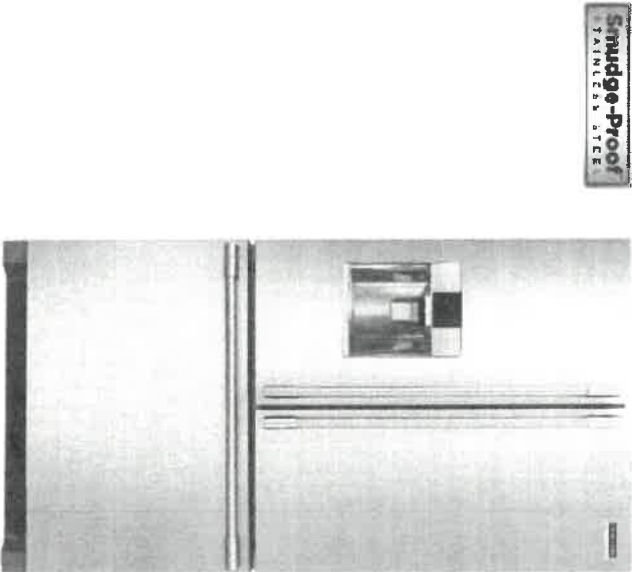

Smudge-Proof
STAINLESS STEEL

AVAILABLE
COLORS



PRODUCT DIMENSIONS

Height (Cabinet including hinge)	69-7/8"
Width	36"
Depth (including Door)	27-1/8"

MORE EASY-TO-USE FEATURES

Smudge-Proof™ Stainless Steel
Resists fingerprints and cleans easily.

Full-Width Deli Drawer
Easily store anything from meats and cheeses to sliced cakes and large platters in our fully-extendable, large capacity deli drawer.

Multi-level LED Lighting
Find fresh foods quickly with bright multi-level LED lighting.

EvenTemp™ Cooling System
Our EvenTemp™ cooling system keeps food cool without breaking a sweat, distributing air effectively so groceries stay at the right temperature.

SpaceWise® Freezer Organization System
Our SpaceWise® Freezer Organization System keeps frozen foods organized and accessible with deep freezer storage and an adjustable divider.

PureSource Ultra® II Ice & Water Filtration
Easily regulate both fresh food and freezer sections with LCD temperature controls on the ice and water dispenser that offer temperature adjustments with the touch of a button.

Dual Ice
Be ready for any occasion with two ice makers.

PureAir Ultra® II Air Filter
Fresh air offers great taste. Our PureAir Ultra® II air filters effortlessly keep the food in your refrigerator tasting fresh by removing over 99% of particles with lasting, highly absorbent carbon technology.

SIGNATURE FEATURES



SpaceWise® Organization System

Our SpaceWise® Organization System makes it easy to keep food organized and accessible with a flip-in shelf to fit taller items with ease, plus adjustable door bins and shelves that offer storage capacity and flexibility.



CrispSeal™ Crispers

Humidity-controlled CrispSeal™ crispers keep produce fresher longer so you can waste less and save money.

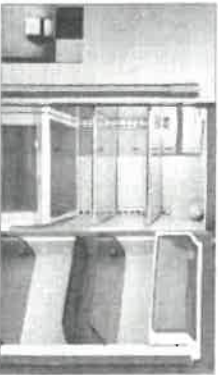

Professional-Grade Design

Durable hardware and professional-grade design features including smoky door bins, counter-top-to-top glass shelving with etched bars, and a distinctive handle for a high-quality look to your kitchen.



Get a built-in look with counter-depth design

Our counter-depth refrigerator gives you the built-in look without the protruding front panel. You get 4 inches of kitchen floor space back compared to standard Frigidaire refrigerators.

192

FPBC2278UF
FRENCH DOOR COUNTER-DEPTH REFRIGERATOR
21.6 CU. FT.

FRIGIDAIRE
PROFESSIONAL

FEATURES

Door Design	Single Doors
Door Handle Design	Seamless Steel
Callout Panel	Grid
Door Bypass Door Design	No Yes
Door Hinge Covers	Hidden
Keypad - Front Key	Optional Yes
Energy Star Plus Technology	
Water Filter Location	Top Right Inside Door Section
Sound Package	Quiet Design

DISPENSER

Crush Ice	Yes/No/No
Dispenser Design	Flush Side-Panel Ice Dispenser / 1.5 Gallons per Day
Crush Ice Cube Size / Hole Ice Output - per Hour	Yes/No/Yes
Model / On - Off Design	No - Sensor Plus - Yes
Lock Light	No - Yes
Door / Door Edge / Sensor Failure Alarm	Yes / Yes / Yes
Water Filter Change Indicator Light	Yes
Air Filter Door or Lockless Entry	Yes

REFRIGERATOR FEATURES

Lighting	Multitouch LED
Water Filter Type	First Service Filter II or Second Filter II
Air Filter Type	
Full-Size Shelves	1
Half-Size Shelves/Drawers	3
Internally Storing Drawers	
Condenser - Self Clean	Yes
Full-Width Soft Lenses	
Water Rate - per Dispenser	Yes/Yes
Classical - 11 Spots with Humidity Control	1
Daily Compartment	1 Single (Right Door)
Crush Ice Dispenser	2 Single / per Door
Left Hand Door Bins	1 Bin / 1
Golden Ageable Eggs Bins	2 Bin only
24" or 30" wide - per Bin	
Drawer set B	
Reversible - per Bottle Dispenser	1 Gray No

FREEZER FEATURES

Exterior - Single Freezer Drawer	Yes
Single Ultra-Thin Freezer Bin	
Basket Drawers	Yes (Upper & Lower Basket)
Lighting	LED
Adjustable Ice Water (20 to 60 Days)	Yes

CERTIFICATIONS

Energy Star Most Efficient (2015)	Yes
-----------------------------------	-----

SPECIFICATIONS

Net Capacity (cu. ft.)	21.6
Refrigerator Capacity (cu. ft.)	18.6
Freezer Capacity (cu. ft.)	6.6
Energy Star - coefficient of performance	Right Bottom 304
Water Filter Location (Left or Right)	Left Bottom - Grid
Water Filter Rating	200 / GCH / 154
Compressor Location (Left or Right)	Left
Amperage (amps)	8.5
Refrigerant Type & Amount (pounds)	R600a 5
Shipping Weight (pounds)	347 Lbs.

PRODUCT DIMENSIONS

A - Height (w/ Hinges & Rollers)	69 3/8"
B - Cabinet Width / Door Width	35 7/8" / 35"
C - Depth (incl. Door)	23 1/4"
Depth (incl. Door open 90°)	42 1/2"
Depth with Drawer Fully Extended (incl. Handle)	46 1/2"

BUILT-IN LOOK CUTOUT DIMENSIONS

Height (incl. Hinges & Rollers)	65 1/4"
Width	36"
Depth	23"

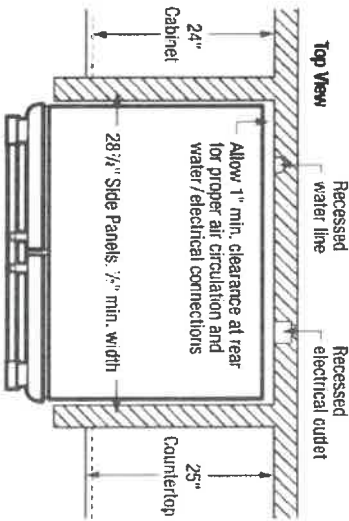
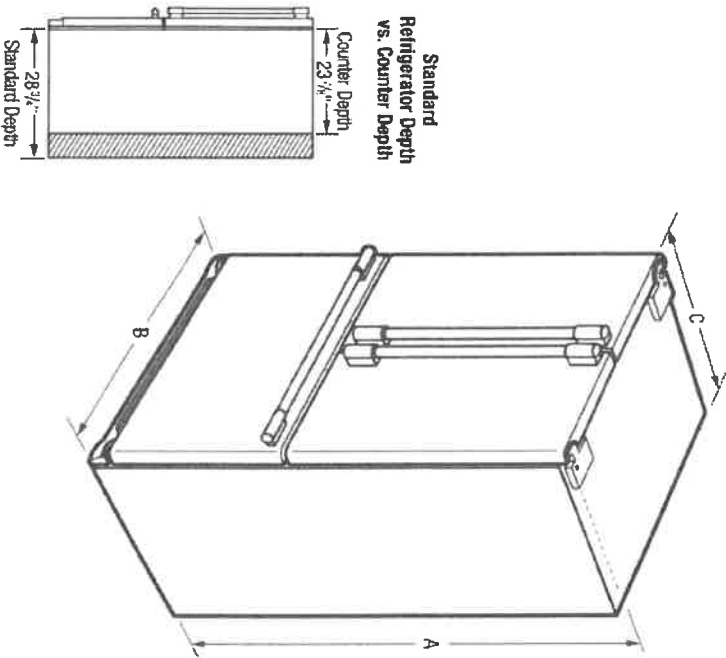

FRIGIDAIRE

USA • 10200 David Taylor Drive • Charlotte, NC 28262 • 1-800-FRIGIDAIRE • frigidaire.com
CANADA • 5685 Terry Fox Way • Mississauga, ON L5V 3E4 • 1-800-265-8352 • frigidaire.ca

Note: For planning purposes only. Always consult local and national electric, gas and plumbing codes. Refer to Product Installation Guide for detailed installation instructions on the web at frigidaire.com / frigidaire.ca. Specifications subject to change. Always refer information available on the web at frigidaire.com / frigidaire.ca.



FPBC2278UF 9/16
© 2016 Electrolux Home Products, Inc.

FPBC2278UF
FRENCH DOOR COUNTER-DEPTH REFRIGERATOR
21.6 CU. FT.

FRIGIDAIRE
P R O F E S S I O N A L

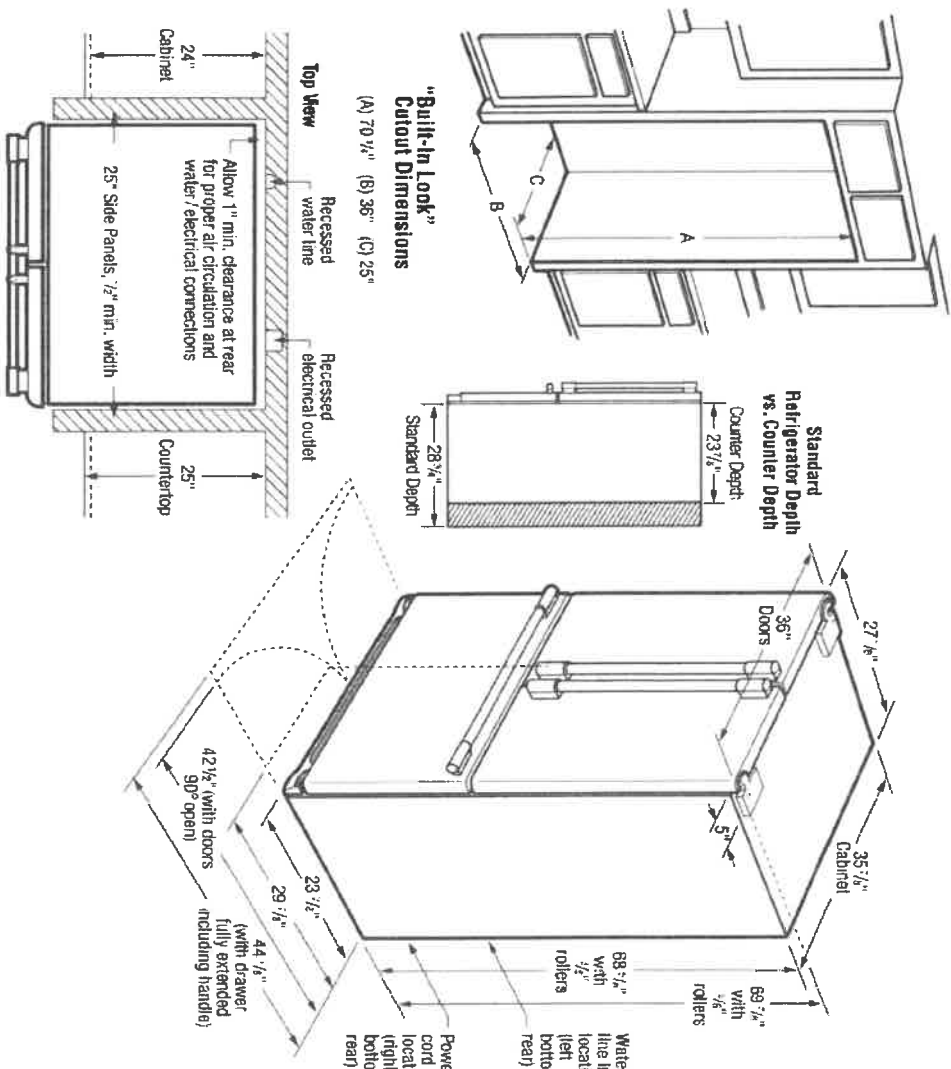

INSTALLATION SPECIFICATIONS

1258

- Product Shipping Weight (approx.) = 247 Lbs.
- An electrical supply with grounded three-prong receptacle is required. The power supply circuit must be installed in accordance with current edition of National Electrical Code (NFPA 70) and local codes & ordinances.
- Voltage Range = 120V / 60 Hz / 15 Amps
- Connected Load (Amps) at 120 Volts = 10.2 Amps
- Amps at 240 Volts = 2.5 Amps
- Always consult local code national electric & plumbing codes.
- Floor should be level surface of hard material capable of supporting full load by refrigerator.
- Minimum 3/8" clearance required for sides and top of refrigerator or freezer compartment at rear to allow for ease of installation, proper air circulation and delivery of electrical connections.
- When installing refrigerator adjacent to wall, cabinet or other structure that extends beyond front edge of unit, 20" minimum clearance is recommended for allow for minimum 12" to back of unit for easy moving correctly placed / to space access and removal. *Refrigerator 4 1/2" minimum clearance with 20" allow for 90° door swing which will provide drawer / crisper access with restricted removal.*

- To be sure optimum performance, make certain that you follow the recommended steps below 55°F or rises above 100°F and avoid installing in direct sunlight or close proximity to range, a dishwasher or other heat source.
 - For proper installation, front grille should be removed and stored.
 - Recess electrical outlet when possible.
 - Water Access on rear wall recommended to prevent water line damage.
 - Water Pressure = Cold water line must be within 30 and 100 psi at the user adjustable unit.
 - Copper or stainless steel tubing with 1/2" O.D. recommended for water supply line with left side equal to distance from rear of unit to household water supply line with 7" diameter of back. Copper or Water Supply Installation Kits available.
 - Adjustable front rollers to assist with alignment.
- "BUILT-IN LOOK" SPECIFICATIONS**
- Minimum opening of 70 1/4" H x 35 1/4" D required to allow for ease of installation. Proper installation and plumbing / electrical installation is required to remove all wall / floor including prior to installation.

Note: For planning purposes only. Always consult local and national electric, gas and plumbing codes. Refer to Product Installation Guide for detailed installation instructions on the web at frigidaire.com/frigidaire.ca or [frigidaire.ca](http://frigidaire.com/frigidaire.ca). Dimensions may vary without notice. © 2015 Frigidaire Corporation.



FRIGIDAIRE

USA • 9200 Laredo Taylor Lane • Charlotte NC 28262 • 1-800-FRIGIDAIRE • frigidaire.com
CANADA • 5855 Terry Fox Way • Mississauga, ON L5V 3E4 • 1-800-265-8352 • frigidaire.ca

FPBC2278UF 9/15
© 2015 Electrolux Home Products, Inc.

FRIGIDAIRE

PROFESSIONAL

Freestanding Range

FPGH3077RF

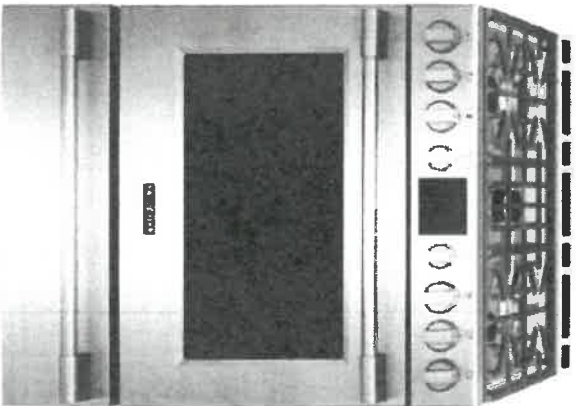

30" Gas

Product Dimensions

Height (Min. / Max.)	36-1/8" / 36-5/8"
Width	29-7/8"
Depth (Including Handle)	28-3/4"

More Easy-To-Use Features

Smudge-Proof™
Resists fingerprints and cleans easily.

Professional-Grade Design, Without the Remodel
Upgrade your kitchen and get the look of a built-in range, without the remodel. The range slides into 30" cutouts.

PowerPlus™ Burner
Quickly boil, sauté, and sear foods at high heat with the PowerPlus™ 18,000 BTU burner.

PrecisionPro Controls™
Prepare a range of dishes with precision, whether you're simmering, sautéing, searing or boiling.

Convection Conversion
Automatically converts the convection oven to the ideal cooking time for evenly cooked dishes.

Sabbath Mode (Sabbath Certified)

Available In:



Burners	BTU
Right Front	18,000
Right Rear	5,000
Left Front	7,500
Left Rear	7,000
Center Griddle	3,000 - 12,000
Center Burner	1,125 - 3,500

Fits the width of a 30" freestanding range



PowerPlus™ 2-in-1 Burner & Griddle
Ultimate cooking flexibility for endless meal options. Use the burner burner to sear steaks and chops or the griddle burner for pancakes or flapjacks.



PowerPlus™ Temperature Probe
Inserts meat easily, no fussing and no waiting for doneness. The probe alerts you when the meat is perfectly cooked.

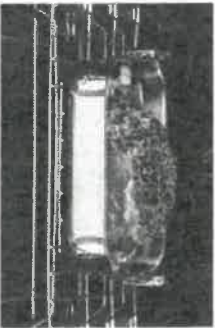

PowerPlus™ Convection
Powerful performance. Convection circulates hot air to evenly cook a roast, turkey, or large batch of cookies. Bake and broil.



PowerPlus™ Preheat
At the PowerPlus Preheat, your oven automatically heats the large powerful burner to even delicious, quick.

138

FRIGIDAIRE
P R O F E S S I O N A L

Freestanding Range

FPGH3077RF 30" Gas

Features

Oven Control / Timing System	PrecisionPro Controls™
Surface Type	Deep Sump Stainless Steel
Sealed Gas Burners	Yes
Grates	Continuous Cast Iron w/ Black Matte Finish
Window	Extruded angle with Black-Tint Finish Smudge-Proof™ Stainless Steel
Exterior Door Finish	Stainless Steel
Handle Design	Black
Exterior Finish (Slide Panels) Conversion System	PowerPlus® Single-Fan Convection
Oven Clearing System	Self Clean Storage
Drawer Functionality	
Oven Controls	
Bake / Broil	Yes / Yes
Errorless™ Convection Conversion (convert on Bake/Broil/Roast)	Yes
PowerPlus® Convection	Yes / No / Yes
PowerPlus® Preheat	Yes
PowerPlus® Temperature Probe	Yes
Keep Warm	Yes
Self Clean	2, 3, 4 Hours
Rapid Clean Option	21 hours
Kitchen Timer / Timed Cook Option	Yes (2) / No
Auto Oven Shut-Off	Yes
Cooktop Features	
Right Front Burner (BTU)	18,000
Right Rear Burner (BTU)	5,000
Left Front Burner (BTU)	7,500
Left Rear Burner (BTU)	12,000
Center Griddle Burner (BTU)	3,000-12,000
Center Simmer Burner (BTU)	1125-3,500 B
Oven Features	
Capacity (Cu.Ft.)	5.1
Oven Light	2
Reck Configuration	1 PowerGlide™ 1 Handle, 1 Offset
Baking System	Even Baking Technology
Bake Burner / Broil Burner (BTU)	18,000 / 11,500
Optional Accessories	
Griddle / Grill (2-inches)	Included
Certifications	
A.D.A. Compliant	Yes
Sabbath Mode (Star-K® Cert.)	Yes
Specifications	
Oven Interior (H x W x D)	18-5/8" x 24-1/8" x 19-1/2"
Power Supply Connection Location	Left Bottom Rear
Gas Supply Connection Location	Right Bottom Rear
LP Gas Conversion Kit	Included
Voltage Rating	120V/60Hz/15A
Amps @ 120 Volts	15
Shut-off Weight (Approx.)	250 lbs

Always properly install the model A.D.A. stainless based on the correct space access required for A.D.A. Access Requirements and the Department of Justice's 2010 A.D.A. Standards for Accessible Design

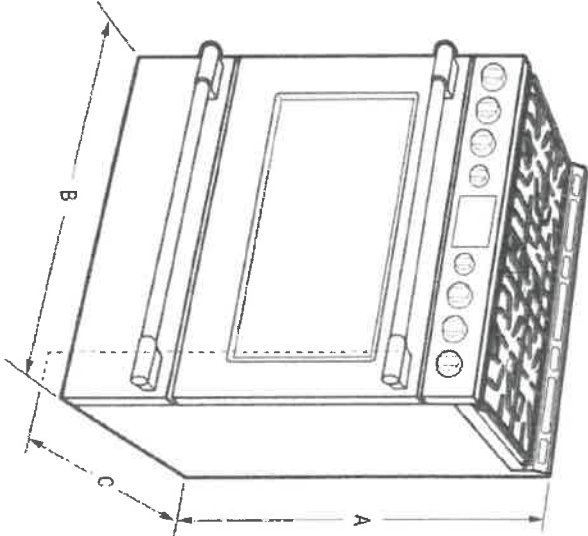

NOTE: For planning purposes only. Always consult local and national electric and gas codes. Refer to Product Installation Guide for detailed installation instructions on the web at frigidaire.com.



Product Dimensions		Cabinet Cutout Dimensions	
A - Height (Min./Max.)	36-1/8" / 36-5/8"	Height (Standard)	36"
B - Width	29-7/8"	Width (Min.)	30-1/8"
C - Depth (Including Handle)	28-3/4"	Depth (Min.)	24"
Depth with Door Open 90°	46"		

FRIGIDAIRE

USA • 10200 Duane Taylor Drive • Charlotte, NC 28262 • 1-800-FRIGIDAIRE • frigidaire.com
CANADA • 5825 King Pike Way • Mississauga, ON L5V 3E4 • 1-800-265-8152 • frigidaire.ca
Model: FPGH3077RF © 2016

Always refer to the website frigidaire.com for the most up-to-date information.
2016-2017
Frigidaire Professional

Freestanding Range

30" Gas

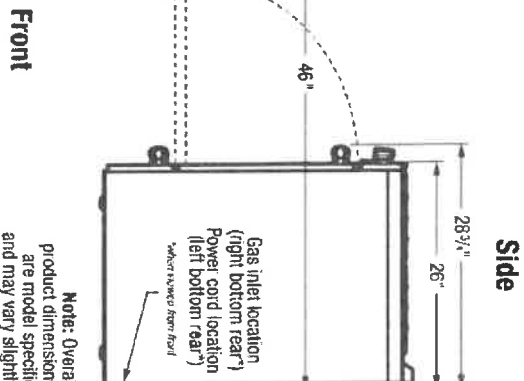

* Minimum distance from cooking surface to underside of overhead cabinetry

- [illegible]

For planning purposes only. Refer to product instructions on the web at frigidaire.com for detailed instructions.

5

2005 and 2006. The results are shown in Table 1.

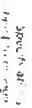

24" Pocket Handle Dishwasher

500 Series – Stainless Steel SHPM65Z55N

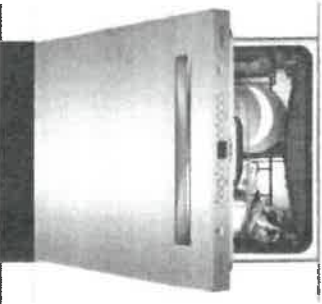

SHPM65Z55N
Stainless Steel

Also available in:
White SHPM65Z52N
Black SHPM65Z56N

The AutoAir™ drying option automatically releases the door at the end of the cycle to let moisture escape and fresh air in for drier dishes.

Features & Benefits

44 dBA: dishwasher runs quietly so your kitchen conversations aren't interrupted.

The Flexible 3rd Rack with fold down sides adds 30% more¹ loading area, perfect for utensils and ramekins.

The AquaStop® leak protection system contains leaks through a precisely engineered system. If a leak occurs, the system contains it by shutting down operation and pumping out water. So you have the ultimate peace of mind whether you are away or at home.

General Properties

Number of wash cycles	5
Number of options	5
dBA	44
Drying system	AutoAir™
Third rack	Flexible 3rd Rack
Rack adjustability	Rackmatic®
Tub material	Stainless Steel
Control type	Buttons
Concealed water heating element	Yes
Leak protection system	24/7 AquaStop®
NSF®-certified ² sanitize option	Yes
Water softener	No
Five-level wash	Yes
ChildLock	No
Special features	Infolight®, AutoAir™ Option

Efficiency

Water usage per cycle	3.5
Energy efficiency class	Tier 1
ENERGY STAR® qualified	Yes
Total annual energy consumption (kWh)	269
Total annual water consumption (g)	623.5
Capacity	
Number of place settings	16

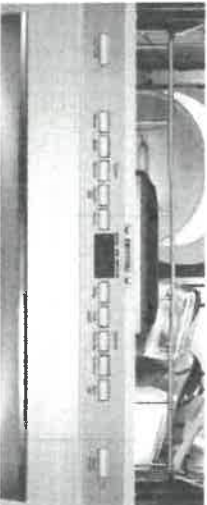

Technical Details

Watts (W)	1440 W
Current (A)	12 Amps
Volts (V)	120 V
Frequency (Hz)	60 Hz
Power cord full length	67"
Power cord install length from edge of unit when facing the door (in) ³	Left – 45" Right – 56"
Minimum water pressure (lb/sin)	14
Length outlet hose (in)	79"

Dimensions & Weight

Overall appliance dimensions (HxWxD) (in)	33 7/8" x 23 9/16" x 23 3/4"
Required cutout size (HxWxD) (in)	33 7/8" x 23 5/8" x 24"
Adjustable feet	Yes
Net weight (lbs)	91 lbs

Accessories—Optional

Junction Box	SMZPCJB1UC
Bosch Dishwasher Water Supply Hose	SMZSH002UC
Drain Hose Extension Kit	SGZ1010UC
Dishwasher Accessory Kit	SMZ5000
Anti-Tarnish Silverware Cassette	SMZ5002UC
Edge Protector + Power Cord Clip Install Kit	SMZEPCC1UC

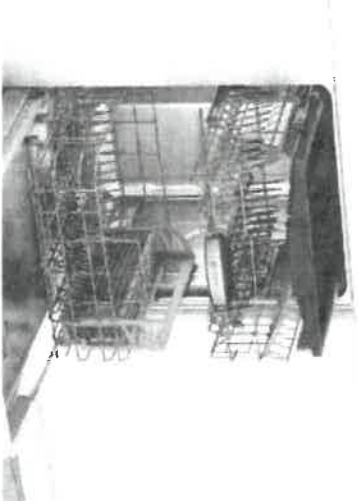

¹ Compared to a Bosch dishwasher with 2 racks.
Certification to NSF/ANSI Standard 184 for residential dishwashers.
² September 2020 running production change to remove adhesive routing clips for power cord. These clips and the edge protector are now included in the dishwasher accessory kit # SMZEPCC1UC.
Accessories: To purchase Bosch accessories, cleaners & parts please visit www.bosch-home.com/us/store or call 1-800-944-2304 (Mon to Fri 9 am to 6 pm PST, Sat 9 am to 3 pm PST).
Notes: All height, width and depth dimensions are shown in inches. BSH reserves the absolute and unrestricted right to change product materials and specifications at any time without notice. Consult the product's installation instructions for final dimensional data and other details prior to making cutout.
Warranties: Please see Use & Care manual or Bosch website for statement of limited warranty.
For more information on our entire line of products, go to www.bosch-home.com/us or call 1-800-944-2304
³ BSH Home Appliances Corporation. All rights reserved. Bosch is a registered trademark of Robert Bosch GmbH.

24" Pocket Handle Dishwasher

500 Series – Stainless Steel SHPM65Z55N



Installation Details

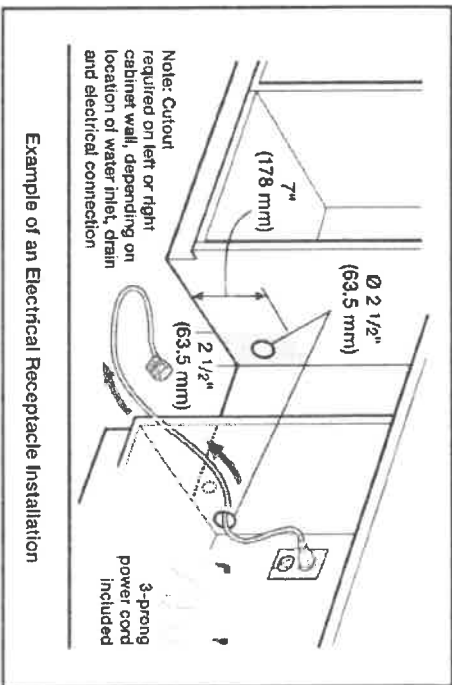
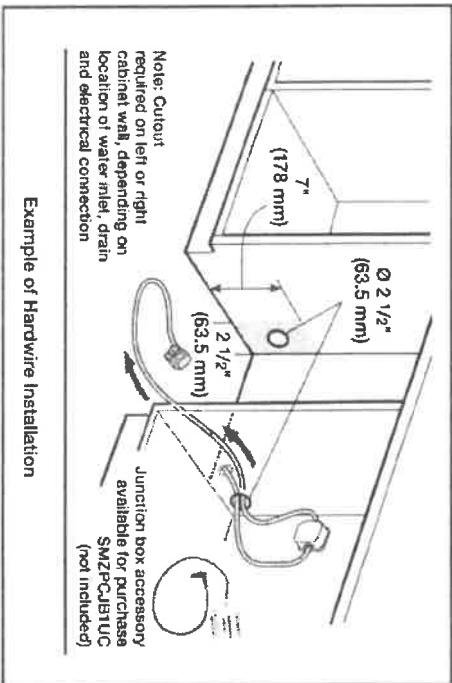
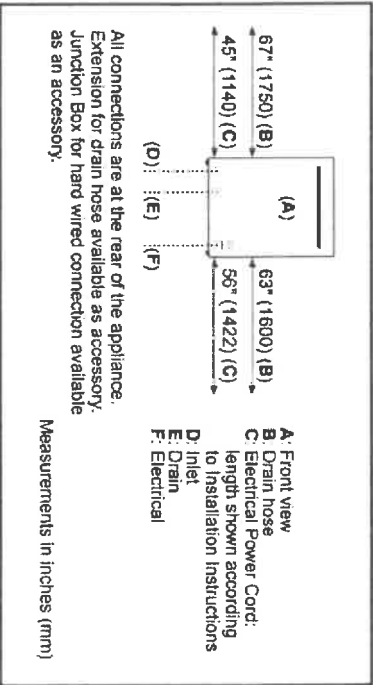
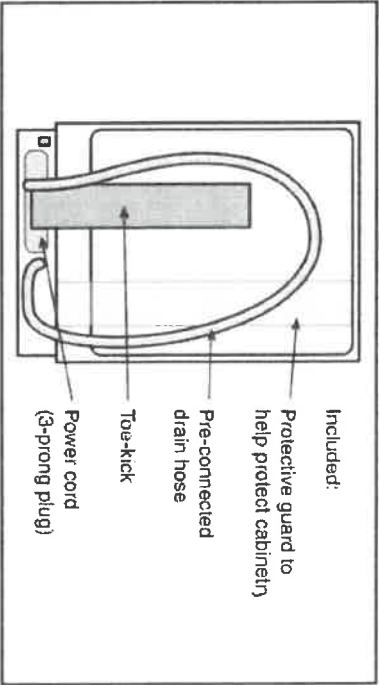
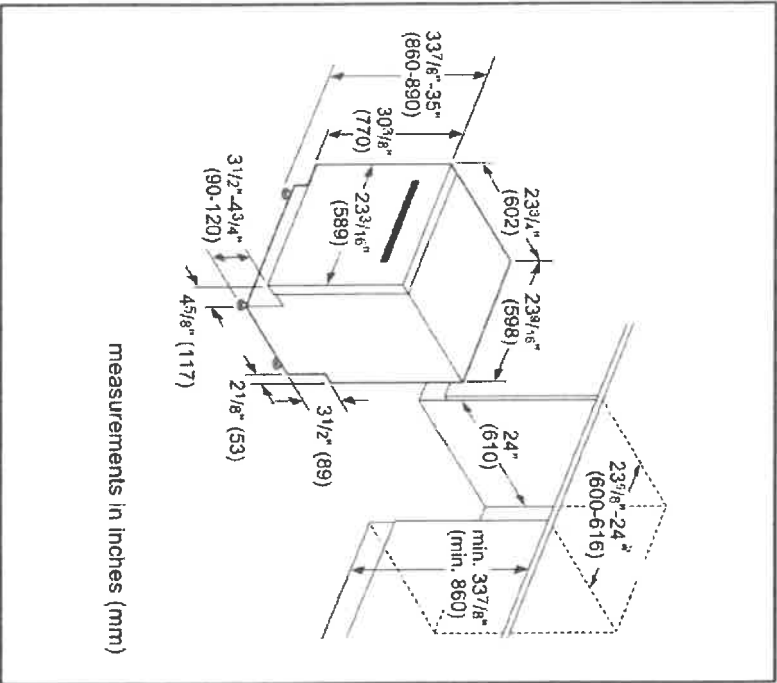

Accessories: To purchase Bosch accessories, cleaners & parts please visit www.bosch-home.com/us/store or call 1-800-944-2904 (Mon to Fri 9 am to 6 pm PST, Sat 9 am to 3 pm PST).
Notes: All height, width and depth dimensions are shown in inches. BSH reserves the absolute and unrestricted right to change product materials and specifications, at any time, without notice. Consult the product's installation instructions for final dimensional data and other details prior to making cutout.
Warranties: Please see Use & Care manual or Bosch website for statement of limited warranty.
For more information on our entire line of products, go to www.bosch-home.com/us or call 1-800-944-2904
© BSH Home Appliances Corporation. All rights reserved. Bosch is a registered trademark of Robert Bosch GmbH.

AVG

AVH-308CS
30" Wall mounted hood - MSRP: \$929.00

Selected Model	
Model number	AVH-308CS
Exterior Appearance	
Stainless steel grade	201
Dimensions	29 1/2" (W) x 19 3/4" (D) x 3 1/4" (H)
Features	
Control	Soft touch with LED display
Lighting	2 bulbs, 3W LED (bulbs included)
Blower type	860 CFM, 6-Speed
Blower performance	Speed 1, 2, 4 sones Speed 6, 6.2 sones
Filter type	2 aluminium micro hole filters (included) 2 Stainless steel baffle filters (included) 6" Round (Top)
Ducting	Ducted
Duct transition	For ceiling heights up to 9'0"
Chimney (ducted out)	
Electrical Requirements	
Electrical requirements	120V / 60Hz / 2.7 Amps
Accessories (optional)	
Optional duct covers	AD-884S (884mm, AVN-AVH compatible)
Warranty	
1-year Warranty	Parts and labour, in-home service

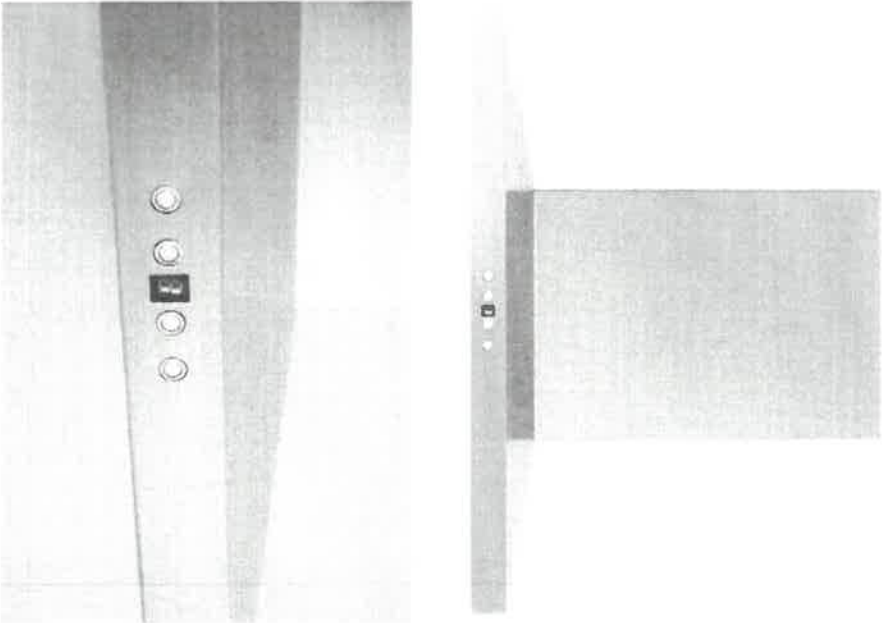

The information contained herein is based on sources that we believe to be reliable, but is not guaranteed by us, may be incomplete or may change without notice

132

AVH-308CS/368CS

Dimensions

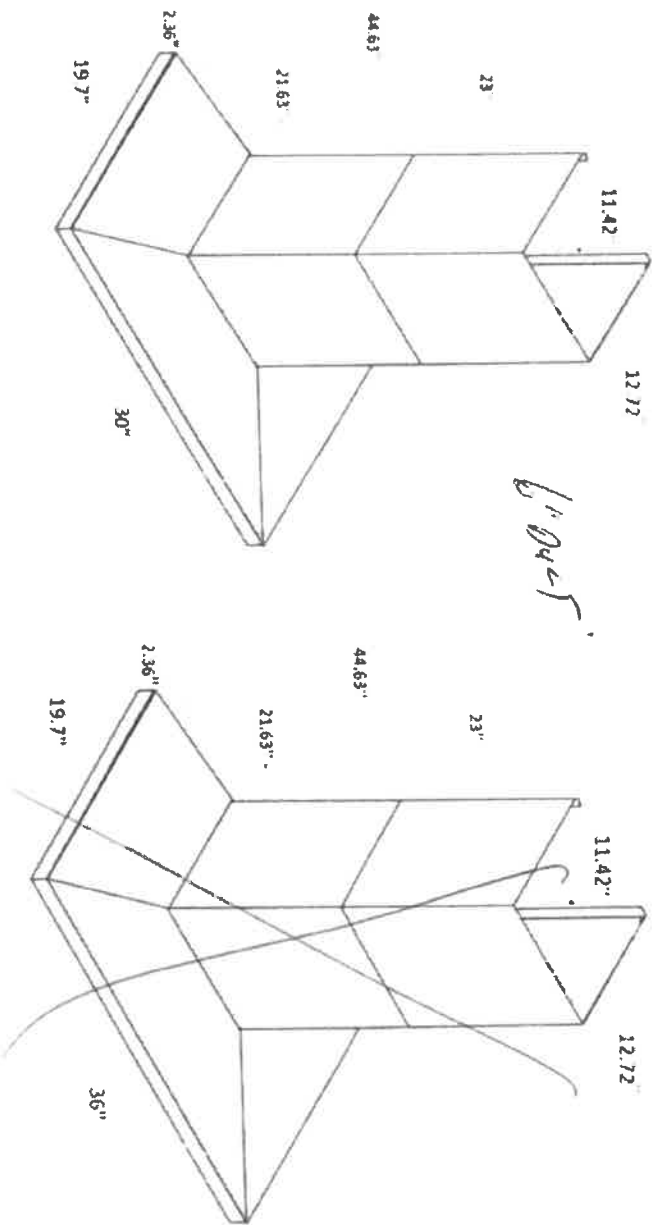

Installation

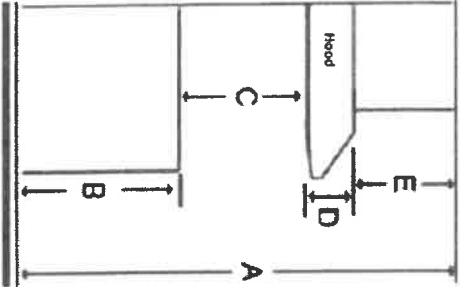

A	Floor to ceiling height	variable
B	Floor to counter top height (standard)	36"
C	Recommended height between cooking surface and bottom of the hood	28" to 30"
D	Hood height	2.36"
E	Chimney height	Max 44.63"

Duct transition

6" round top



The information contained herein is based on sources that we believe to be reliable, but is not guaranteed by us, may be incomplete and/or may change without notice.

CALVIN
19 1/4" OVAL UNDERMOUNT SINK

☐ 4220CFY Undermount Sink

Product Specs:

- Vitreous china
- Front overflow hole
- Template and mounting hardware supplied

Overall Dimensions (W x D x H):

(OD): 490mm(19 1/4") x 410mm(16 1/8") x 195mm(7 7/8")
(ID): 430mm(17") x 350mm(13 3/4") x 145mm(5 7/8")

Compliance Certifications:

- Meets or exceeds the following:
- IAPMO cUPC
 - ASME A112.19.2 / CSA B45.1-2013

Shipping:

Cube 1.53
GW 19 lbs



Notes:
Dimensions of fixtures are nominal and may vary within the range of tolerances established by ASME standard A112.19.2. These measurements are subject to change or cancellation. No responsibility is assumed for use of superseded or voided pages.

*Bone and Biscuit available through Direct Import (CIF) only.

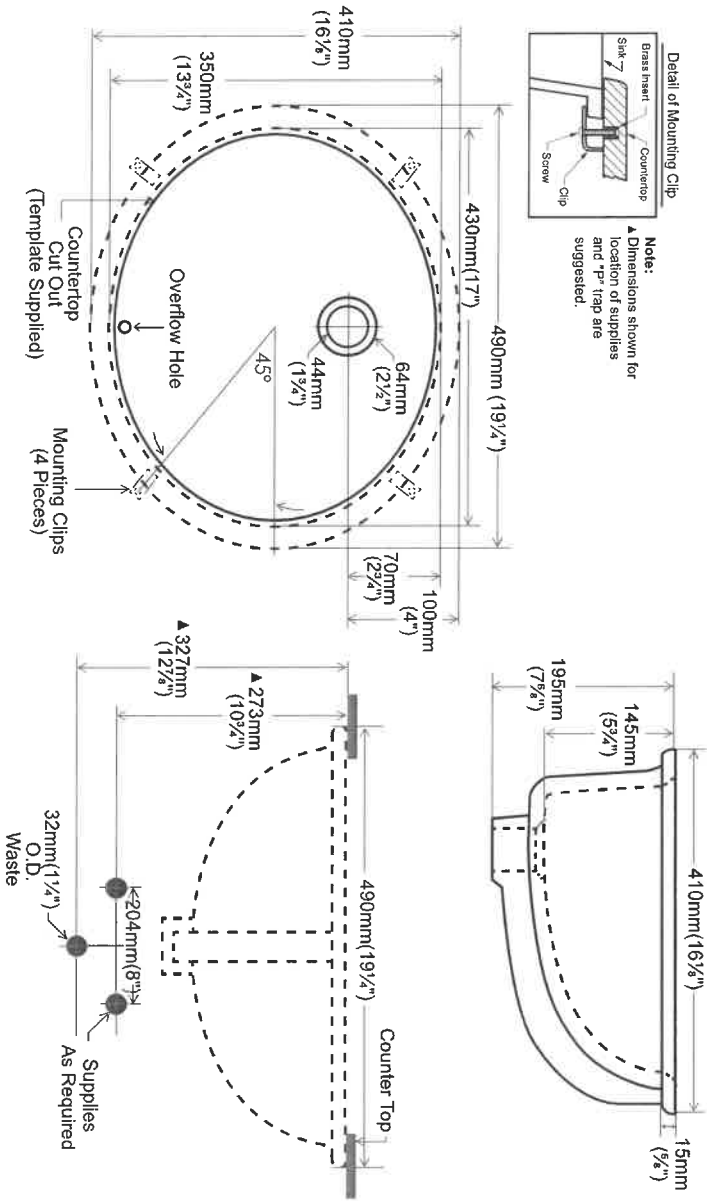

Contrac®

5970 Chedworth Way, Unit A, Mississauga, ON, Canada L5R 3V5
www.contrac.ca

Revised: January 2016

132 Main Bath

COLLETTE
21½" RECTANGULAR UNDERMOUNT SINK

☐ 4220CIV Undermount Sink

Product Specs:

- Vitreous china
- Front overflow hole
- Template and mounting hardware supplied

Overall Dimensions (W x D x H):

(OD): 545mm(21½") x 355mm(14") x 190mm(7½")
(ID): 485mm(19") x 295mm(11½") x 140mm(5½")

Compliance Certifications:

Meets or exceeds the following:

- IAPMO cUPC
- ASME A112.19.2 / CSA B45.1-2013

Shipping:

Cube 1.64
GW 25 lbs



Colours To Be Specified:
Colour: ☐ Soft White
☐ Bone (055)*
☐ Biscuit (066)*

Notes:
Dimensions of fixtures are nominal and may vary within the range of tolerances established by ASME standard A112.19.2. These measurements are subject to change or cancellation. No responsibility is assumed for use of superseded or voided pages.

*Bone and Biscuit available through Direct Import (CIF) only.

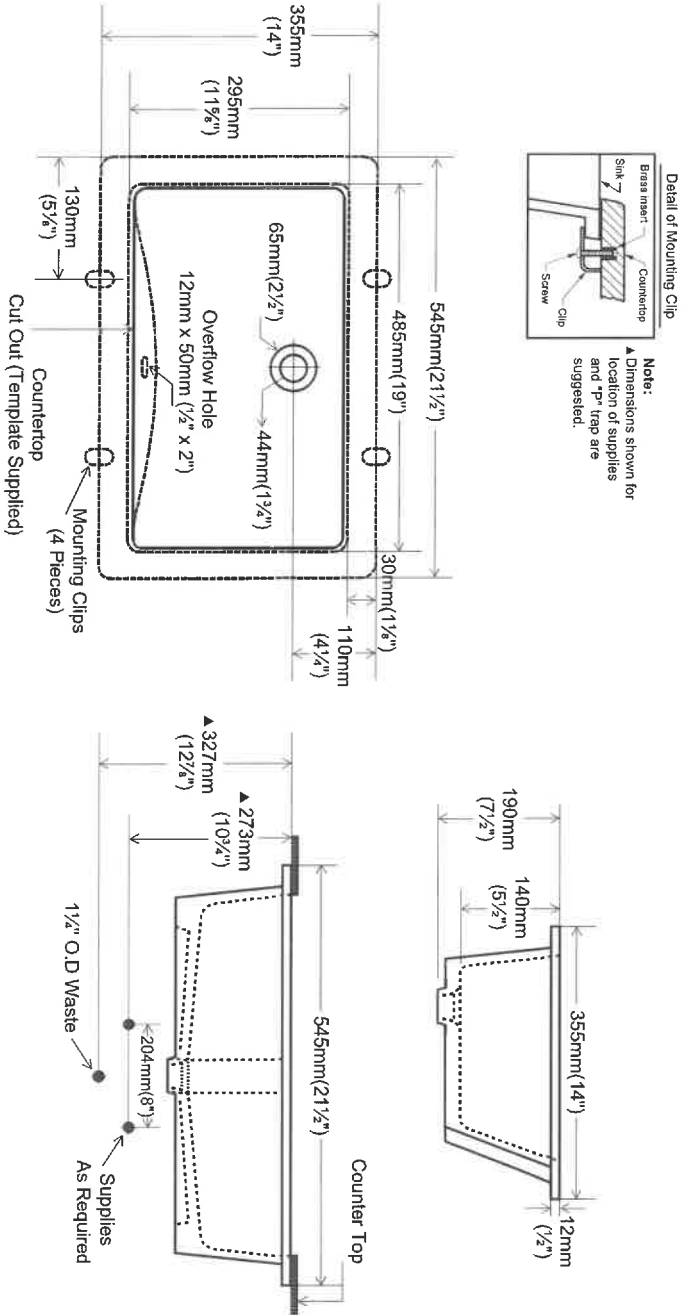

Contrac®

5970 Chedworth Way, Unit A, Mississauga, ON, Canada L5R 3V5

www.contrac.ca

Revised: January 2016

132
Master

CALI ONE PIECE TOILET

4.8LPF / 1.28GPF

- ☐ 4710BOV Lined Tank
- ☐ 4710BOVU Unlined Tank

PRODUCT SPECS:

- High efficiency toilet
- 4.8Lpf / 1.28Gpf
- Elongated bowl with concealed skirted trapway
- Vitreous china
- 17" Plus Height for greater comfort
- Soft white tank lever
- 12" (305mm) Rough-in
- 2" Fully glazed ball pass trapway
- 3" Flapper
- Siphon jet flush action
- Water surface: 7⁹/₁₆" x 5⁵/₁₆" (198mm x 143mm)
- Decorative soft white side caps included
- Smooth close toilet seat included

DIMENSIONS:

390mm W x 725mm D x 765mm H
15³/₈" W x 28¹/₂" D x 30¹/₈" H

COMPLIANCE CERTIFICATIONS

Meets or exceeds the following:

- IAPMO cUPC
- ASME A 112.19.2 / CSA B45.1
- ADA Guidelines & ANSI A117.1
- LEED Compliant
- CSA B651 barrier-free standard
- US EPA WaterSense
- Map Tested 1000g

SHIPPING

Cube 9.39
GW 92.5 lbs



TO BE SPECIFIED
Colour:
☐ Soft White

NOTES: This toilet is designed to rough-in at a minimum dimension of 305mm (12") from finished wall to C/L of outlet. Supply line not included with fixture and must be ordered separately.

Important: Dimensions of fixtures are nominal and may vary within the range of tolerances established by ASME standard A112.19.2. These measurements are subject to change or cancellation. No responsibility is assumed for use of superceded or voided pages.

Product is designed to comply with ADA / ANSI A117.1 and CSA B651 Barrier-Free Standard requirements, if installed according to the standard and local building codes. It is the responsibility of the installer to comply with this standard and local building codes prior to installation.

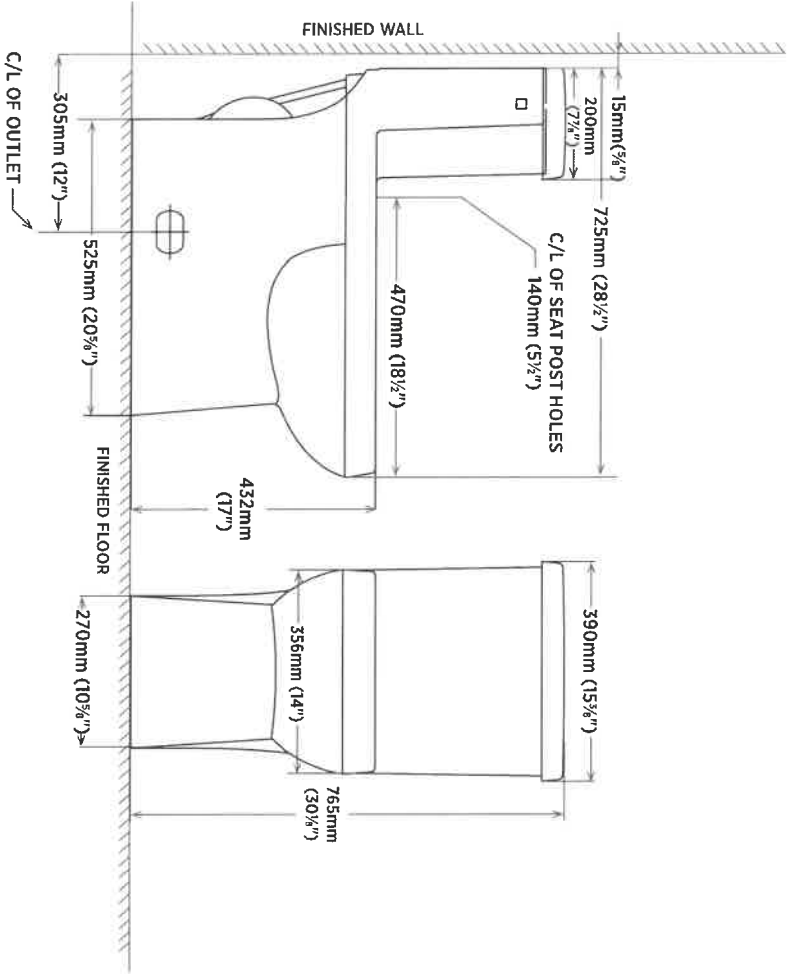

contrac

5970 CHEDWORTH WAY, UNIT B, MISSISSAUGA, ONTARIO, CANADA L5R 4G5 | CONTRAC.CA

REVISED MAY 2021

132 m/sf



Prism Series
50" Linear Electric Fireplace

BLF5051

The best-selling linear fireplace is now even better.

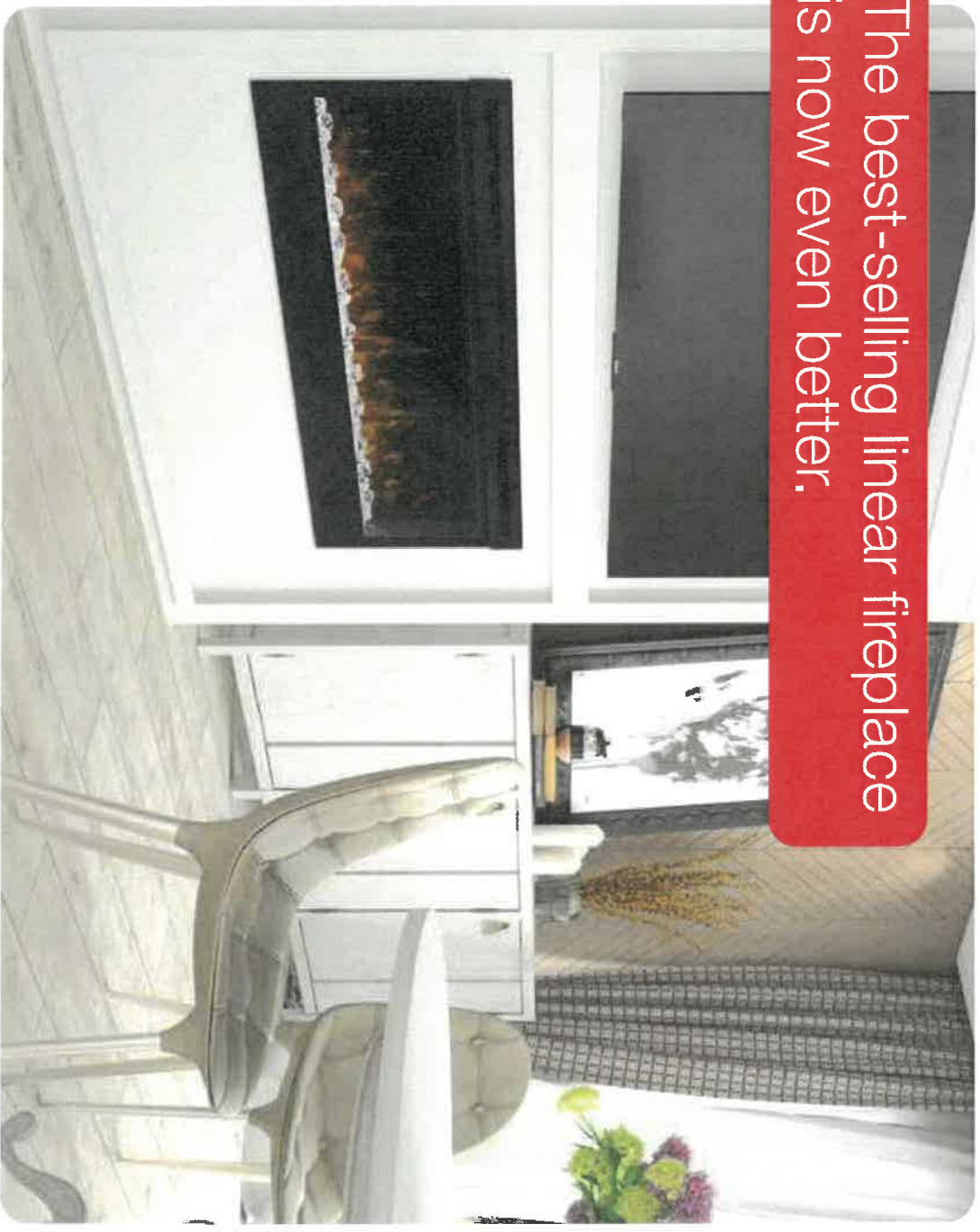

The best-selling electric linear fireplace just got better with the all new Prism Series. Sparkling with intensity in a full spectrum of colors, the Prism effect illuminates the diamond-like acrylic ice ember bed in a show-stopping effect. Plug-in or hard-wire, hung on the wall or built-in; the Prism Series is beautifully versatile.

132

PRISM
series

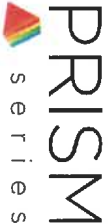

Prism Series

50" Linear Electric Fireplace

BLF5051

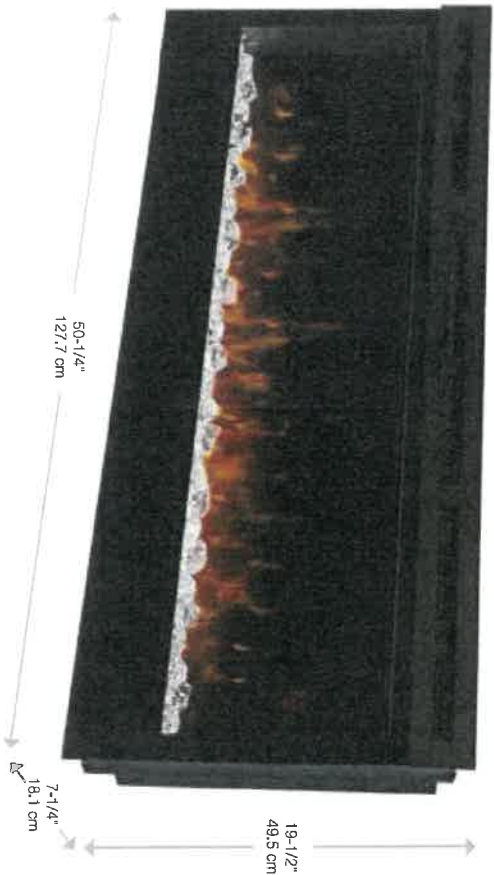

Color Themes



Accessories

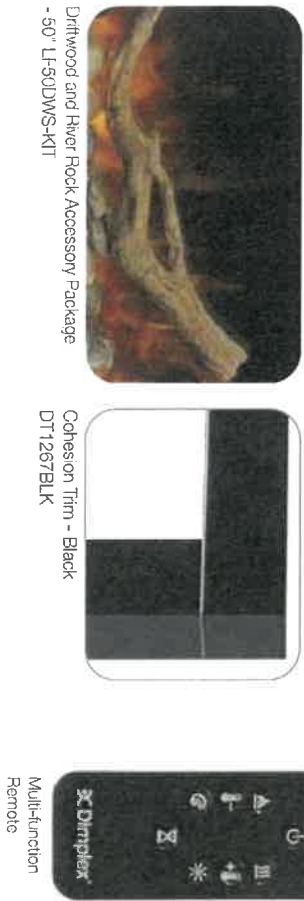

120 Volts | 1,230 Watts | 4,197 BTU

Model #	Description	Lbs / Kg	UPC	Why?	Carton Dimensions (WxHxD)		Cube
					Inches	cm	ft ³ / m ³
BLF5051	50" Linear Electric Fireplace	75 / 34.1	781052 098787	2 yr.	55 x 23-1/4 x 12-7/8	139.7 x 58.9 x 32.7	9.5 0.26
DT1267BLK	Cohesion Trim - Black	51 / 23.1	781052 080355	1 yr.	64-7/8 x 26-1/4 x 8-3/4	164.8 x 66.8 x 22.1	8.6 0.24
LF50DWS-KIT	50" Driftwood and River Rock Accessory Kit	7 / 3.17	781052 102842		34-1/4 x 5-7/8 x 8-1/8	87.2 x 14.98 x 20.6	

Specifications, finish and dimensions are subject to change. *Limited warranty. ©2020 Glen Dimplex Americas

Glen Dimplex Americas | 1-800-668-6663 | www.dimplex.com

Features

- The Original Dimplex Flame Effect**
A blend of technology, artistry and craftsmanship that sets the standard for realism.
- Acrylic Ice Media Bed**
Light plays through different size pieces and sparkle in a spectrum of colors.
- Media Accent Colors**
Choose from a variety of brilliant color themes or cycle through a range of colors using the custom mode, freezing on the hue of your choice.
- Flexible Installation**
Simply surface mount and plug-in or fully-recess and direct wire for a seamless installation
- Hanging Glass Design**
Detachable glass trim easily finishes rough openings and provides access to media.
- Remote Thermostat Control**
Temperature control at your fingertips for convenient comfort.
- Multi-function Remote**
Control the flame, heat and thermostat from the comfort of your chair.
- LED Lighting**
Flame and lights use brilliant, low-energy LED's that require zero maintenance.
- All-season Flames**
Enjoy the unique charm of a fireplace 365 days a year using the flames without the heat.
- Cool-touch Glass**
Glass remains cool making it safe for any location and any user.
- Low Carbon Footprint**
The most sustainable fireplace option; no emissions and 100% efficient.

132

SE-022-FR06-04 E20



Prism Series

50" Linear Electric Fireplace

BLF5051

Product Dimensions:

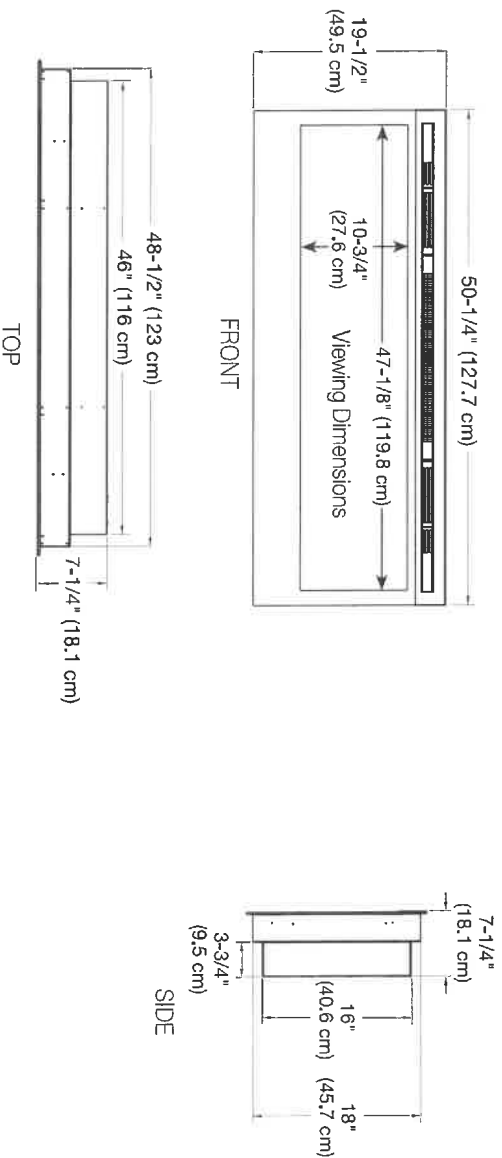

Installation Options and Framing Dimensions

3 Mounting Options

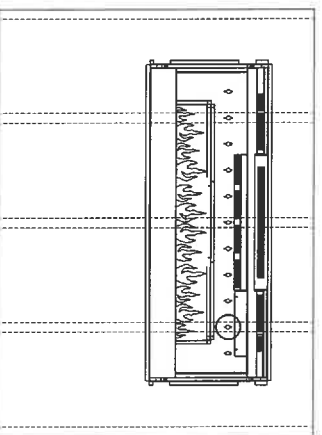

ON WALL

Must mount to a minimum of three (3) wall studs

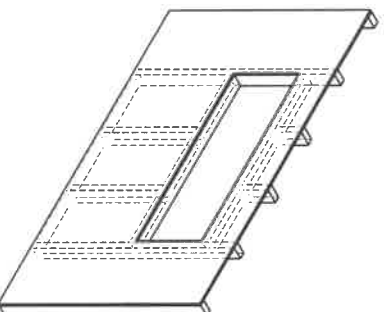

PARTIAL RECESSED

2 X 4 Wall Construction
Framing dimensions:
46-1/2" W x 16-1/2" H
(118.1 cm W x 42 cm) H

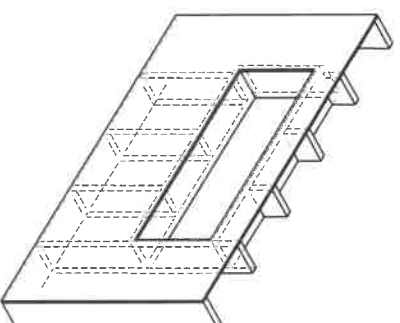

FULLY RECESSED

2 X 8 Wall Construction
Framing dimensions:
49" W x 18-1/2" H
(124.5 cm W x 47 cm) H



DATE SUBMITTED
16 Jun 2021

CLIENT: ME: ZANCOR HOMES
SHIP TO: SHORELINE POINT

DRAFTED BY: FERNANDA
COMMENT

PH:
CELL:

P/O #

JOB NUMBER

INSTALL DATE:

PAGE

9 of 22

40-07

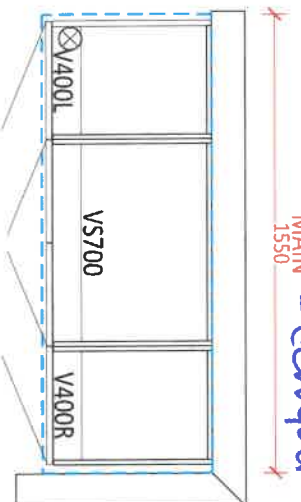

MAIN - countertop Height
1550

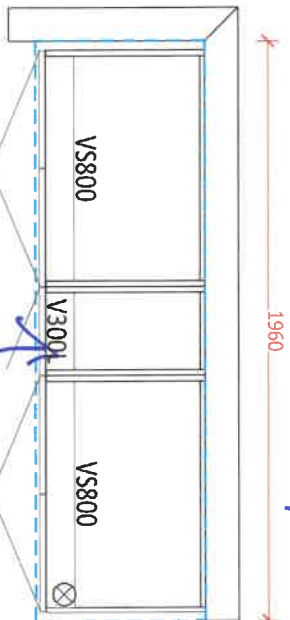

MASTER ENSUITE - countertop Height
1960

Back of Drawers

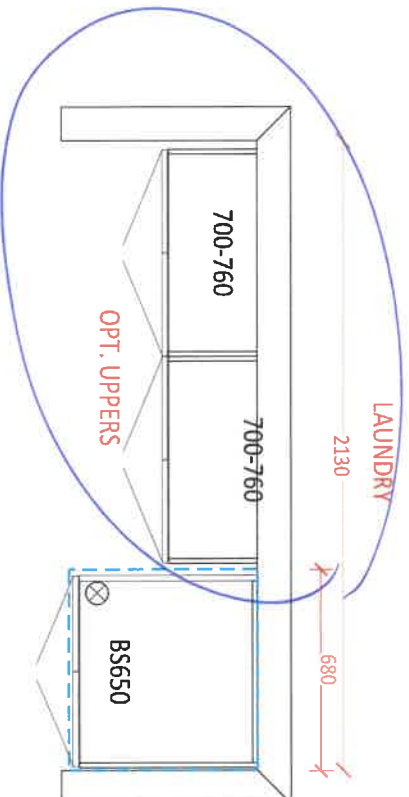

LAUNDRY

44



NAME: ZANCOR HOMES
SH: SHORELINE POINT

PH:
CELL:

DRAFTED BY: FERNANDA
COMMENT

DATE SUBMITTED
16 Jun 2021

CB NUMBER

INSTALL DATE:

PAGE

8 of 22

P/O#

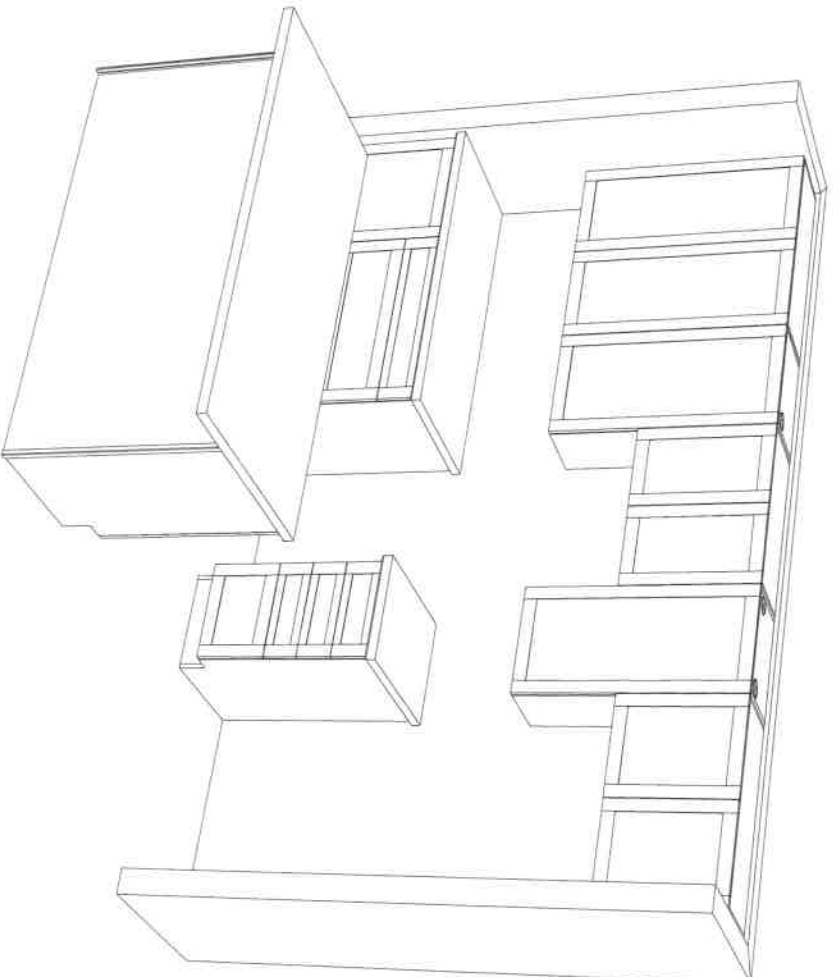

144



DATE SUBMITTED
16 Jun 2021

CLIENT: ME: ZANCOR HOMES
PROJECT: SHORELINE POINT

DRAFTED BY: FERNANDA
COMMENT:

PH:
CELL:

DWG NUMBER

INSTALL DATE:

PAGE
7 of 22

40-07
KITCHEN

Lot 132
Sp622/21

-Soft Close Doors
and Drawers
-Cutlery Divider



RIGHT 885H x 600D

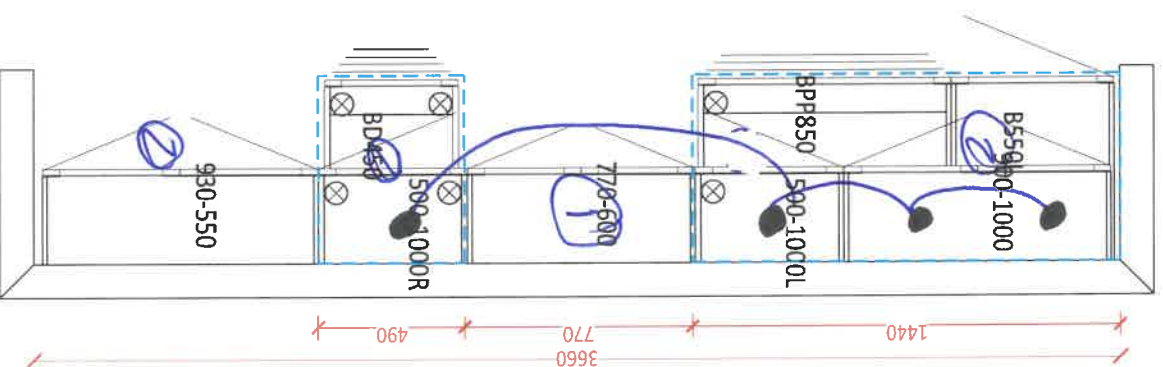

- ① delete upper cabinet for future Chimney Hood
- ② hidden light valance with puck lights x 4

(4).
Puck,
Lights

THU

COLLETTE
21½" RECTANGULAR UNDERMOUNT SINK

Lot 132
S0628/21

☐ 4220C1Y Undermount Sink

Product Specs:

- Vitreous china
- Front overflow hole
- Template and mounting hardware supplied

Overall Dimensions (W x D x H):

(OD): 545mm(21½") x 355mm(14") x 190mm(7½")
(ID): 485mm(19") x 295mm(11½") x 140mm(5½")

Compliance Certifications:

Meets or exceeds the following:

- IAPMO cUPC
- ASME A112.19.2 / CSA B45.1-2013

Shipping:

Cube 1.64
GW 25 lbs



Notes:

Dimensions of fixtures are nominal and may vary within the range of tolerances established by ASME standard A112.19.2. These measurements are subject to change or cancellation. No responsibility is assumed for use of superseded or voided pages.

*Bone and Biscuit available through Direct Import (CIFI) only.

Material Fasco 16

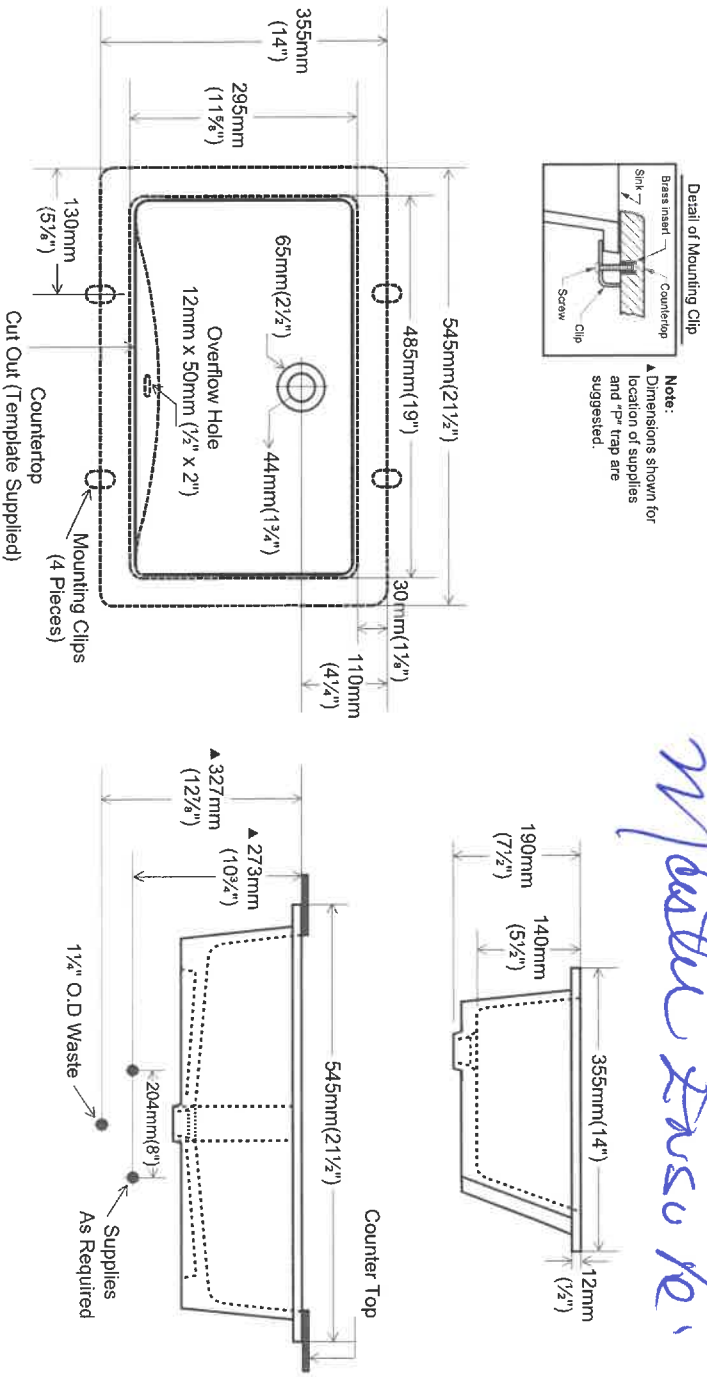

contrac®

5970 Chedworth Way, Unit A, Mississauga, ON, Canada L5R 3V5
www.contrac.ca

Revised: January 2016

CALI ONE PIECE TOILET
4.8LPF / 1.28GPF

- ☐ 4710BOV Lined Tank
- ☐ 4710BOVU Unlined Tank

PRODUCT SPECS:

- High efficiency toilet
- 4.8LPF / 1.28GPF
- Elongated bowl with concealed skirted trapway
- Vitreous china
- 17" Plus Height for greater comfort
- Soft white tank lever
- 12" (305mm) Rough-in
- 2" Fully glazed ball pass trapway
- 3" Flapper
- Siphon jet flush action
- Water surface: 7 $\frac{5}{8}$ " x 5 $\frac{3}{8}$ " (198mm x 143mm)
- Decorative soft white side caps included
- Smooth close toilet seat included

DIMENSIONS:

390mm W x 725mm D x 765mm H
15 $\frac{3}{8}$ " W x 28 $\frac{1}{2}$ " D x 30 $\frac{3}{8}$ " H

COMPLIANCE CERTIFICATIONS

Meets or exceeds the following:

- IAPMO cUPC
- ASME A 112.19.2 / CSA B45.1
- ADA Guidelines & ANSI A117.1
- LEED Compliant
- CSA B651 barrier-free standard
- US EPA WaterSense
- Map Tested 1000g

SHIPPING

Cube 9.39
GW 92.5 lbs



TO BE SPECIFIED
Colour: ☐ Soft White

NOTES: This toilet is designed to rough-in at a minimum dimension of 305mm (12") from finished wall to C/L of outlet. Supply line not included with fixture and must be ordered separately.
Important: Dimensions of fixtures are nominal and may vary within the range of tolerances established by ASME standard A112.19.2. These measurements are subject to change or cancellation. No responsibility is assumed for use of superseded or voided pages.
Product is designed to comply with ADA / ANSI A117.1 and CSA B651 Barrier-Free Standard requirements, if installed according to the standard and local building codes. It is the responsibility of the installer to comply with this standard and local building codes prior to installation.

Lot 132
SPB028/21

Matt Exsude

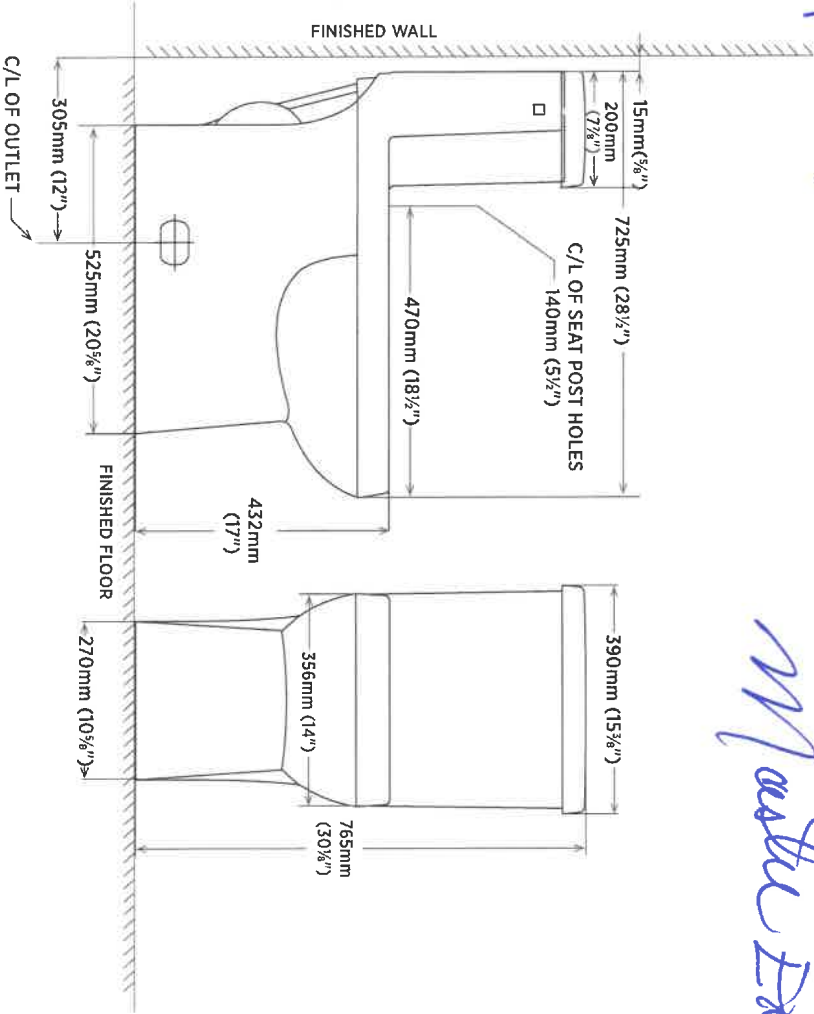

444

C

PIER 40-07 ELEVATION "C"
LOT 132 WASAGA SHORELINE

****Exterior colours will be as per approved exterior selection****

Separate switch
4 Exterior potlights



[Signature]

Oct 30, 2021

HOMEOWNER SIGNATURE & DATE

THE
GALLERY

SHORELINE POINT

BY ZANCOR

WASAGA BEACH

ZANCOR

APPLIANCE ACKNOWLEDGEMENT

CONTACT: Steve Miller - Appliance Canada (905) 660-2424 / smiller@appliancecanada.com

- It is the Purchaser's responsibility to coordinate delivery, installation and hook up of appliances and to ensure they are installed as per Manufacturers specifications after closing.

STANDARD APPLIANCE OPENINGS provided by Zancor:

*Standard appliance openings are approximate and the minimum required. Sizes may vary due to onsite condition and/or when modifications have been made to the cabinetry.

- Fridge Opening 36" x 74"
- Stove Opening 30"
- Hood Fan Opening 30"
- Hood Fan & Vent 6" with Under Cabinet Hood
- Dishwasher Opening 24"

Accepts Standard
Openings **Initial

OPTIONAL UPGRADED APPLIANCES to be provided by Homeowner:

- ****Specs/information sheets are required and it is the responsibility of the homeowner to provide this to Zancor**
- **Homes by the due date that has been provided. If appliance specs are not submitted, Zancor Homes will not be responsible for any necessary requirements and the standard opening will be built.**

Initial

- Upgraded Appliance Specs are DUE 2 WEEKS FROM SIGNED DATE OF COLOUR CHART (if not received during appointment)

- ***Specs that require changes/modifications after this date will not be accepted***

- NOTE: Any upgraded appliances are to be paid by the Purchaser, directly to the appliances company.

- Additional charges to the Purchaser may apply for cabinetry, electrical and plumbing in order to accommodate the specs given by the homeowner.

FRIDGE UPGRADE

- ☐ Built-in
- ☐ Paneled **Panel to match required
- ☐ Integrated / Flush Inset
- ☒ Waterline

RANGE UPGRADE

*Larger hood fan CFM might be required, which need a larger vent

- ☐ 36" **Hood fan opening must be the same size or larger (8" vent might be required)
- ☐ 48" **Hood Fan opening must be the same size or larger (8" or 10" vent required)
- ☒ Gas Range **gas line and electrical required & sold separately
- ☐ Induction **electrical required & sold separately
- ☐ Cooktop (Apron Front) **Countertop Cut-out required & sold separately
- ☐ Cooktop (Drop-in) **countertop Cut-out required & sold separately

HOOD FAN & VENT UPGRADE

- ☐ 8 Inch **Required for 600 CFM
- ☐ 10 Inch
- ☒ Chimney Hood Fan **Vent must be centred
- ☐ Insert / Liner

WALL OVEN/MICRO UPGRADE

- ☐ Single Wall Oven **electrical required & sold separately
- ☐ Double Wall Oven **electrical required & sold separately
- ☐ Steam Oven **electrical required & sold separately
- ☐ Warming Drawer **electrical required & sold separately
- ☐ Over The Range Microwave (OTR)
- ☐ Built-In Microwave **Trim Kit required **electrical required & sold separately

**Electrical required

DATE Sent 28/21

WASAGA SHORLINE

SITE

LOT

132

** Any upgrades checked in this appliance form must be accompanied with specs provided by the Purchaser.

**It is the responsibility of the trade to inform the Builder of any discrepancies with specs, sketches, extras and/or colour chart PRIOR to production/installation.

ZANCOR

221 North Rivermede Road, Concord, Ontario L4K 3N7 * T: (905) 738.7010 F: (905) 738.5948

INTERIOR FINISHES ACKNOWLEDGEMENT / WAIVER

Purchaser accepts and acknowledges that the Builder reserves the right to substitute materials with those of equal or better quality where the manufacture, scheduling or delivery of materials may directly impact the Builder's ability to meet its' contractual obligations under the Agreement of Purchase and Sale.

UPGRADES/EXTRAS: All upgrades and additional selections indicated on the colour chart must be accompanied by an upgrades/extras sheet (PES) and full payment otherwise the selection will be invalid. All colour charts and upgrades/extras will not proceed until verified and signed by an authorized signing officer at the Vendor's head office. **CHANGES WILL NOT BE PERMITTED UPON COMPLETION AND SUBMISSION OF THE COLOUR CHART.**

PORCELAIN & NATURAL STONES: Due to the properties of natural stones including but not limited to **marble, granite, quartz**, no two pieces are exactly the same. Variations in colour, tone, granularity (pitting, fissures) and pattern are to be expected, including various lighting may affect the overall finished look. Stone tops are sealed at time of installation and should never be cleaned with lemon oil or vinegar. Stones are porous materials, therefore any spilled substance require immediate attention. Stone countertops require regular seal re-application as part of home maintenance. Purchaser acknowledges colour and product variations as well as natural imperfections may exist with the selection of natural stone materials and shall not hold the Vendor liable for provision of same.

STONE COUNTERTOP JOINTS: Purchaser is aware that one joint will be at each corner and on either side of slide-in-range (if applicable). It will also be where the length of the counter top exceeds the length of a stone slab. Slabs are usually approximately 5' x 8'.

CERAMIC TILES: Due to manufacturing, shade (dye lots), product variations may exist that can affect the overall look of the finished product. Although every effort will be made to ensure the colours and materials selected are as close as possible to the samples, the purchaser acknowledges that the sample tiles supplied in the Design Centre may not be identical to the materials installed in the home.

STAR STAINS: Due to the natural properties of wood, many variables can affect the overall look of the finished product. Factors including but not limited to wood type, knotting, graining, density, age, humidity, and air temperature can result in substantial variations in stain intensity. The purchaser accepts that although the Vendor will do their best to match stain the unfinished stairs as close as possible to the pre-finished floors, it is not possible to have an identical match and that there MAY be shade differences between the two products.

CABINETRY: Due to the natural properties of wood, slight variations apparent with cabinetry are to be expected. This includes but not limited to wood species, wood grain, colour, finish, product variations, and natural imperfections are all factors that may affect the overall look of the finished product. Such factors make exact colour matching impossible. The type and intensity of lighting in the areas of designated cabinetry placement may also highlight characteristics of cabinetry finish. All cabinets shall be finished with a white melamine interior box unless a finished interior is upgraded. Due to building specifications and/or on-site conditions, certain cabinetry upgrades may not be possible. The purchaser acknowledges that the Builder cannot guarantee the cabinetry finish or provision of certain upgrades and shall not hold the Builder liable for provision of same.

UPGRADES/EXTRAS: All upgrades and additional selections indicated on the colour chart must be accompanied by an upgrades/extras sheet (PES) and full payment otherwise the selection will be invalid. All colour charts and upgrades/extras will not proceed until verified and signed by an authorized signing officer at the Vendor's head office. **CHANGES WILL NOT BE PERMITTED UPON COMPLETION AND SUBMISSION OF THE COLOUR CHART.**

HARDWOOD / LAMINATE FLOORING: Due to the properties of wood and laminate, many variables can affect the overall look of the finished product. Variations include but not limited to wood type or laminate finish, colour/stain and wood grain are significant factors that make exact colour matching impossible. The purchaser acknowledges that the hardwood flooring is a pre-finished product in a controlled environment. Expansion, compression and cupping are characteristics of hardwood flooring once installed in the home. The purchaser acknowledges these may become apparent over time and despite the Builders' efforts to install the hardwood flooring materials in keeping with good workmanship, the Builder shall not be responsible nor held liable for minor variances of fluctuation in hardwood flooring materials.

HARDWOOD / LAMINATE WAIVER:

I/We understand hardwood flooring is classified as a porous material and as such not recommended by the Builder in certain areas. I/We understand there is a concern due to possible water and other substances being frequently splashed or spilled onto the floor and in contravention of Ontario Building Code Section 9.30.1.2(1).

"Finished flooring bathrooms, kitchens, public entrance halls, laundry & general storage areas shall consist of resilient flooring, felted-synthetic-fibre floor coverings, concrete, terrazzo, ceramic tile, mastic or other types of flooring providing similar degrees of water resistance."

I/We are prepared to assume full responsibility for any damage caused to the hardwood floor or subfloor due to moisture absorbcency in the mentioned areas, and agree to waive any claims against the Township of residence, TARIION and/or the Builder in relation to the matter. ****SEE COLOUR CHART FOR LOCATIONS****

DATE	SITE	LOT
Sept 28/21	WASAGA SHORELINE	132

221 North Rivermede Road, Concord, Ontario L4K 3N7 * T: (905) 738.7010 F: (905) 738.5948

HOME AUTOMATION (Cable, CAT5/6, Telephone)

INCLUDED IN SCHEDULE "A" IN AGREEMENT OF PURCHASE AND SALE:

- Rough-in for Central Vacuum system piped to garage
- Rough-in for Telephone (2) locations
- Rough-in for Cable TV (2) locations
- Rough-in for Cat-6 Network (3) locations

CONTACT:

I/we the Homeowner(s) have chosen to contact the Home Automation Company to select the locations of the rough-ins for Cable, CAT5, Telephone as included in our Agreement of Purchase Sale.

I/we the Homeowner(s) will contact the trade within 4 weeks of the date of this release to select locations of the standard rough-ins review other optional products for purchase.

Trade: Smart-Tech Home Automation
Phone: (905) 761-6469
Email: kris@smart-tech.ca
Rep: Kris
Location: 200 Millway Avenue, Unit 8
Concord, Ont L4K 5K8

ACKNOWLEDGEMENT:

I/We the homeowner(s) acknowledge that if I/We the homeowners decide to not contact Smart-Tech, locations of the standard rough-ins will be installed as per Vendors discretion.

KH
Homeowner(s) Initial

DATE Sept 28/21

WASAGA SHORELINE

132
LOT

BRICK/JOINT PATTERN INSTALLATION RELEASE FORM

BRICK installation is included as a standard on the floor for 12 x 24 tiles and must be noted on the colour chart and acknowledged on this form

(Large tiles installation for floor and wall) – ¼ Brick

Please be advised it has come to our attention, that due to production, many of the over-sized and odd shaped, man-made tiles (i.e. porcelain & ceramic), have been found to have a slight bow in the tile. It is a standard occurrence with all suppliers and manufacturers.

It is therefore recommended, that if and when a purchaser requests to install one of these tiles in a brick-joint pattern, that it be installed on a ¼ brick pattern, to try to avoidlippage. Attached with this letter, you will find a layout of the ¼ brick installation that has been recommended.

LOCATIONS: Entry, Mud, Powder, Main, Halls
LOCATIONS: Kitchen, Basement, 8th
LOCATIONS: Laundry
LOCATIONS: _____

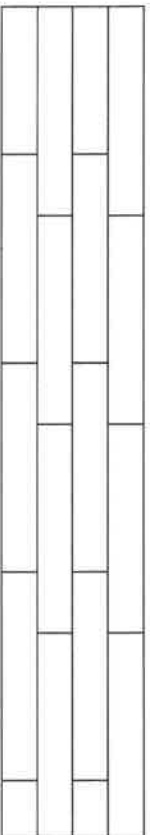

Please understand, even in using this ¼ brick installation, there may still be minimallippage which cannot fully be eliminated.

Hence, when there is a request for brick-joint installation, Zancor Homes and their contractor, cannot be held responsible for this matter.

HEP
Homeowner(s) Initial

(Small tile installation for walls) – ½ Brick

Purchaser requests to install small wall tiles on a backsplash or shower wall in a brick-joint pattern, that it be installed on a ½ brick pattern.

LOCATIONS: _____
LOCATIONS: _____
LOCATIONS: _____
LOCATIONS: _____

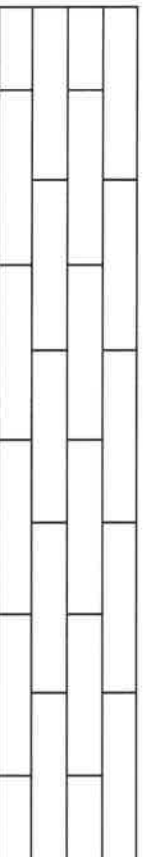

Homeowner(s) Initial

DATE Sept 23/21

SITE WASAGA SHORELINE

LOT 132

Stone Countertop Edge Profiles

Where applicable as per site specifications

STANDARD EDGE FOR KITCHEN & VANITIES

Standard Countertop Edge in
Kitchen

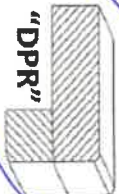

Standard Countertop Edge in
Vanity

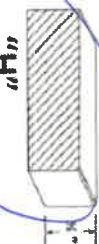

Homeowner(s) Initial HA

OPTION (1) EDGE FOR KITCHEN & VANITIES \$250

Optional Edge in Kitchen

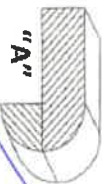
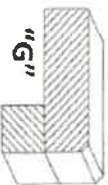
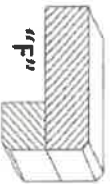
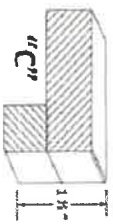

Optional Edge in Bathroom

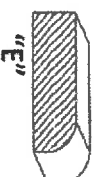
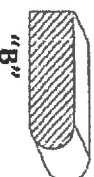

Homeowner(s) Initial _____

OPTION (2) EDGE FOR KITCHEN & VANITIES CUSTOM PRICING

Optional Edge for Kitchen

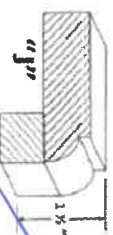
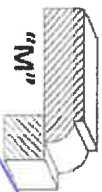
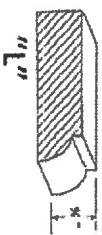

Optional Edge in Vanity

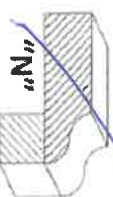
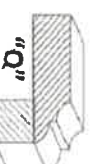
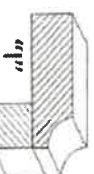
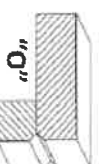

Homeowner(s) Initial HA

DATE

Sept 28/21

SITE

WASAGA SHORELINE

LOT

132