

Site: CALEDON

Lot: 197-1

Model: ESSEX (RLTH-04) ELEV A, CORNER

Purchaser: VINAYKUMAR P. PANCHAL

Purchaser: AMITKUMAR P. PANCHAL

Phone: 416.451.5571 / 416.710.4200

Email: PANCHAL_VINAY@YAHOO.COM



DESCRIPTION		DATE SELECTED
	BONUS PACKAGE: 3 PIECE STAINLESS STEEL APPLIANCES WITH WHITE WASHER & DRYER	INCLUDED IN APS
	BONUS PACKAGE: STAINLESS STEEL HOOD FAN	INCLUDED IN APS
	STRUCTURALS & COLOURS	
1	FIREPLACE- ELECTRICAL DIMPLEX BLF5051. WALL BUILT INTO ROOM BY APPROX 8" TO ACCOMMODATE- SEE SKETCH AND SPEC	10-Mar-22
2	ELECTRICAL- 2 CAPPED LIGHTS OVER KITCHEN ISLAND, SPACED EVENLY ON SEPARATE SWITCH. STD LIGHT TO REMAIN- SEE SKETCH	10-Mar-22
3	KITCHEN CABINET- UP 1	10-Mar-22
4	KITCHEN COUNTERTOP- UP 2	10-Mar-22
5	SF POWDER ROOM CABINET- UP 1	10-Mar-22
6	SF POWDER ROOM COUNTERTOP- UP 2	10-Mar-22
7	GF POWDER ROOM CABINET- UP 1	10-Mar-22
8	MASTER CABINET- UP 1	10-Mar-22
9	MASTER BATH COUNTERTOP- UP 2	10-Mar-22
10	MASTER BATH SHOWER FLOOR- UP 2	10-Mar-22
11	MAIN BATH CABINET- UP 1	10-Mar-22
12	HARDWOOD- UP 1- HOBBY ROOM, LIVING, DINING, RED ROOM, UPPER HALL/ LANDINGS	10-Mar-22
13	HARDWARE FOR CABINETS	10-Mar-22
14	TRIM- UP 1	10-Mar-22
15	COMFORT HEIGHT X 4- MASTER, MAIN, SF POWDER	10-Mar-22
16	24" TOWEL BAR- YB2424- QTY 2- MASTER AND MAIN	10-Mar-22
17	PIVOTING PAPER HOLDER- YB2408- QTY 4- MASTER, MAIN, X 2 POWDER	10-Mar-22
18	9" TOWEL BAR- YB2486- TO BE INSTALLED NEAR SINK FOR HAND TOWEL- QTY 4- MASTER, MAIN, X 2 POWDER	10-Mar-22
19	NA	10-Mar-22
20	NA	10-Mar-22
21	NA	10-Mar-22
22	BANK OF DRAWERS IN MASTER AND MAIN	10-Mar-22
23	WATERLINE FOR FRIDGE	10-Mar-22
24	GASLINE TO STOVE, INCLUDES 15 AMP. 40 AMP TO REMAIN	10-Mar-22
25	ELECTRICAL- PLUG OVER FIREPLACE FOR FUTURE TV, INSTALL 65 AFF, BESIDE CABLE	10-Mar-22

ZANCOR HOMES COLOUR CHART

ENTRANCES				
Main Foyer - FLOORING		NEW BYZANTINE ASSURO BLUE 12 X 24- STACKED		
Mudroom - FLOORING		NEW BYZANTINE ASSURO BLUE 12 X 24- STACKED		
Side Hall - FLOORING		NA		
Basement Foyer - FLOORING		NA		
KITCHEN				
Kitchen - FLOORING		NEW BYZANTINE ASSURO BLUE 12 X 24- STACKED		
Breakfast - FLOORING		NEW BYZANTINE ASSURO BLUE 12 X 24- STACKED		
Kitchen - CABINETS		EURO ANTHRACITE- UP 1		
Island - CABINETS		EURO ANTHRACITE- UP 1		
Servery - CABINETS		NA		
Kitchen - HANDLES/KNOBS		H800MB		
Kitchen - COUNTERTOP		CARRARA WHITE- UP 2		
Island - COUNTERTOP		CARRARA WHITE- UP 2		
Kitchen - BACKSPLASH		DECLINED		
Kitchen - SINK		STD		
Kitchen - FAUCET		STD		
GREAT ROOM / DINING / LIVING / DEN / OFFICE / BASEMENT				
Family / Great Room - FLOORING		KENTWOOD OAK BEARSKIN 3 1/2" X 3/4" - UP 1		
Main Hall - FLOORING		KENTWOOD OAK BEARSKIN 3 1/2" X 3/4" - UP 1		
Dining / Living Room - FLOORING		KENTWOOD OAK BEARSKIN 3 1/2" X 3/4" - UP 1		
Library / Den - FLOORING- HOBBY		KENTWOOD OAK BEARSKIN 3 1/2" X 3/4" - UP 1		
Basement Rec Room - FLOORING		KENTWOOD OAK BEARSKIN 3 1/2" X 3/4" - UP 1		
STAIRS				
Railing Details - PICKETS		BLACK METAL SINGLE COLLAR W/ ALT PLAIN		
Railing Details - POSTS		2 3/4" TURNED OAK		
Railing Details - HANDRAIL		2 1/2" OVAL OAK		
Stair Stain - MAIN STAIRS		STAIN STAIRS TO MATCH HARDWOOD AS CLOSE AS POSSIBLE		
Stair Stain - BASEMENT STAIRS (if applicable)		NA		
Stair Stain - SERVICE STAIRS (if applicable)		NA		
POWDER ROOM				
Powder Room - FLOORING		NEW BYZANTINE ASSURO BLUE 12 X 24- STACKED		
Powder Room - CABINETS		EURO ANTHRACITE- UP 1		
Powder Room - COUNTERTOP		GF- BIANCO CARRARA SF- CARRARA WHITE- C		
Powder Room - SINK		STD		
Powder Room - FAUCET		STD		
2ND FLOOR				
Upper Hall - FLOORING		KENTWOOD OAK BEARSKIN 3 1/2" X 3/4" - UP 1		
Master Bedroom - FLOORING		T03 OPENING NIGHT		
Bedroom 2 - FLOORING		T03 OPENING NIGHT		
Bedroom 3 - FLOORING		T03 OPENING NIGHT		
Bedroom 4 - FLOORING		NA		
Bedroom 5 - FLOORING		NA		
Master Ensuite - FLOORING		NEW BYZANTINE ASSURO BLUE 12 X 24- STACKED		
Master Ensuite - SHOWER WALL		NEW BYZANTINE ASSURO BLUE 12 X 24- STACKED VERTICAL		
Master Ensuite - SHOWER FLOOR		ONTARIO HEX DARK GREY GLOSSY- UP 2		
Master Ensuite - SHOWER JAMB		BIANCO CARRARA		
Master Ensuite - CABINETS		ROVERE TESSO- UP 1- COMFORT HEIGHT		
Master Ensuite - HANDLES/KNOBS		H800MB		
Master Ensuite - COUNTERTOP		BIANCO PURE- UP 2		
Master Ensuite - SINK(s)	STD		Master Ensuite - FAUCET(s)	STD
FOR TRADE USE				
Any upgrades in the colour chart must be accompanied with a PES. It is the responsibility of all Trades to inform the builder of any discrepancies on sketches, PES and/or colour charts <u>PRIOR</u> to installation.		CALEDON 197-1	NP	VENDOR APPROVAL
PAGE 1 OF 2				

Mar 29/22

ZANCOR HOMES COLOUR CHART

2ND FLOOR CONTINUED...									
Main Bath - FLOORING		NEW BYZANTINE ASSURO BLUE 12 X 24- STACKED							
Main Bath - TUB / SHOWER WALL		NEW BYZANTINE ASSURO BLUE 12 X 24- STACKED VERTICAL							
Main Bath - SHOWER FLOOR		NA							
Main Bath - SHOWER JAMB		NA							
Main Bath - CABINETS		EURO ANTHRACITE- UP 1- COMFORT HEIGHT							
Main Bath - HANDLES/KNOBS		H800MB							
Main Bath - COUNTERTOP		49454-38							
Main Bath - SINK(s)		STD		Main Bath - FAUCET(s)		STD			
Shared Bath- FLOORING		NA							
Shared Bath- TUB / SHOWER WALL		NA							
Shared Bath- SHOWER FLOOR		NA							
Shared Bath- SHOWER JAMB		NA							
Shared Bath- CABINETS		NA							
Shared Bath- HANDLES/KNOBS		NA							
Shared Bath- COUNTERTOP		NA							
Shared Bath- SINK(s)		NA		Shared Bath - FAUCET(s)		NA			
GF Bath - FLOORING		NA							
GF Bath - TUB / SHOWER WALL		NA							
GF Bath - SHOWER FLOOR		NA							
GF Bath - SHOWER JAMB		NA							
GF Bath - CABINETS		NA							
GF Bath - HANDLES/KNOBS		NA							
GF Bath - COUNTERTOP		NA							
GF Bath - SINK(s)		NA		Ensuite Bath - FAUCET(s)		NA			
LAUNDRY									
Laundry - FLOORING		NEW BYZANTINE ASSURO BLUE 12 X 24- STACKED							
Laundry - CABINETS		HIGH GLOSS EURO WHITE		Laundry - HANDLES/KNOBS		H800MB			
Laundry - COUNTERTOP		P-345-CA		Laundry - SINK		STD			
Laundry - BACKSPLASH		NA		Laundry - FAUCET		STD			
TRIM / PAINT									
Casing/Baseboards		COLONIAL- UP 1							
Interior Doors		STD							
Interior Door Hardware		STD							
PAINT - Throughout		COOL WHITE							
FIREPLACE									
Location / Insert / Mantle		50" DIMPLEX							
ACCESSORIES									
Mirrors		YES		BATH ACCESSORIES		UPGRADE			
APPLIANCE REQUIREMENTS									
GAS LINE TO BBQ		STD		ELECTRICAL for Built-in Oven		DECLINED			
GAS LINE & ELECTRICAL TO STOVE		YES		ELECTRICAL for Built-in Micro		DECLINED			
GAS LINE & ELECTRICAL TO DRYER		DECLINED		ELECTRICAL for Cooktop		DECLINED			
HOOD FAN VENT SIZE		6" STD		ELECTRICAL for Bar Fridge		DECLINED			
WATERLINE to Fridge		YES							
DISCLAIMER									
Any changes to the colour chart after signing are subject to a \$5000 administration fee plus costs									
Purchaser has checked and acknowledged accuracy of colour and selections before signing.									
Colours of all materials are as close as possible to Builders selection but not necessarily identical due to dye lot variances in manufacturing/manufacturers. Due to construction progress some items may have been pre-selected or installed. In this event the Vendor's selection must be accepted by the purchaser									
SITE / LOT:		CALEDON							
PURCHASER(S):		VINAYKUMAR P. PANCHAL							
PURCHASER(S):		AMITKUMAR P. PANCHAL							
CONTACT:		416.451.5571 / 416.710.4200							
FOR TRADE USE									
Any upgrades in the colour chart must be accompanied with a PES. It is the responsibility of all Trades to inform the builder of any discrepancies on sketches, PES and/or colour charts PRIOR to installation.									
<div>ZANCOR HOMES</div>		PURCHASER SIGNATURE		<div>JILLIAN</div>					
		PURCHASER SIGNATURE							
		DÉCOR CONSULTANT							
PAGE 2 OF 2		Vendor APPROVAL		SIGNATURES / DATE					

ESSEX RLTH-04 (Corner)

lot 197-1
Apr 10/22

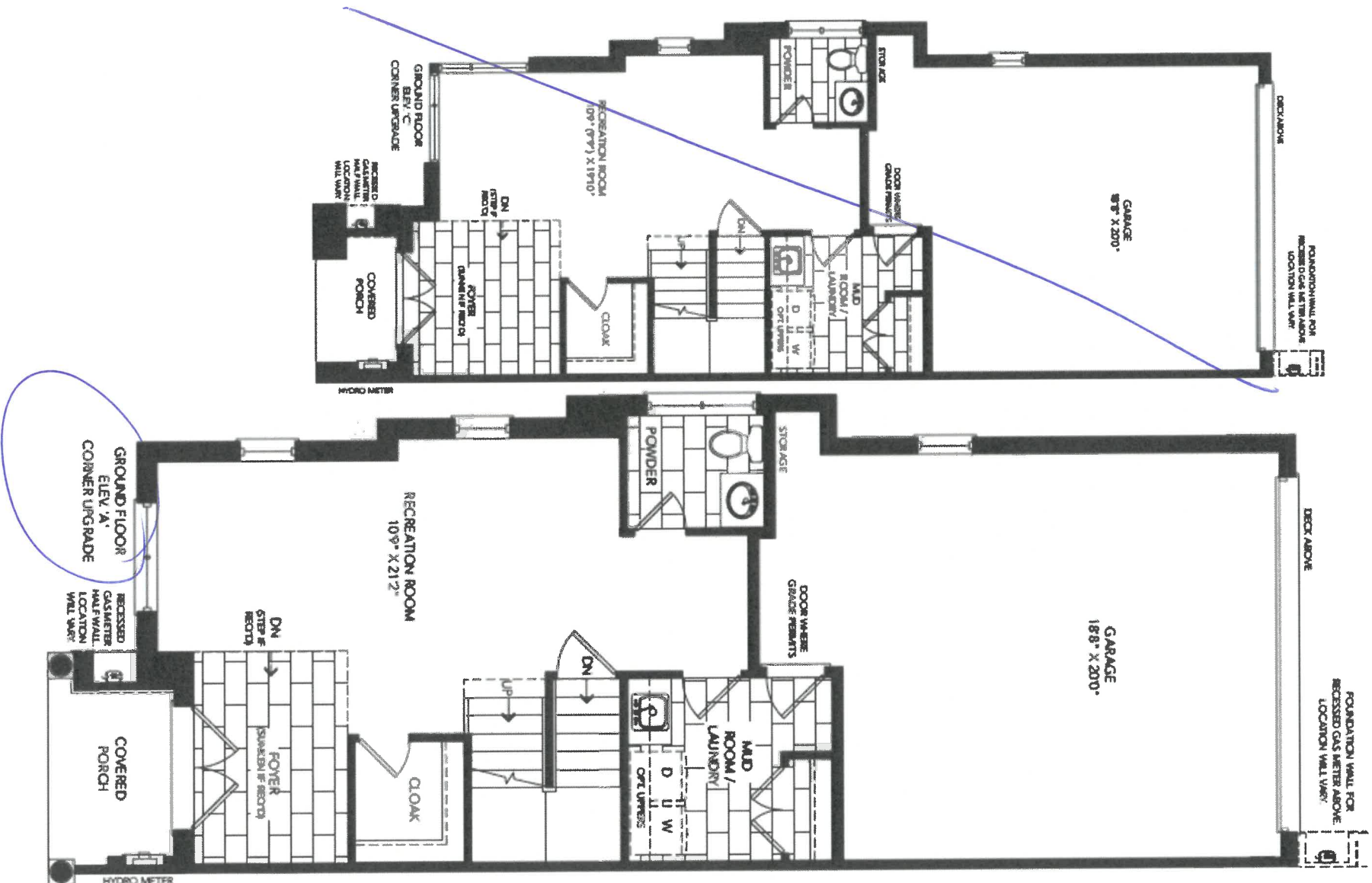

AR

lot 197-1
4/10/22

ESSEX RLTH-04 (Corner)

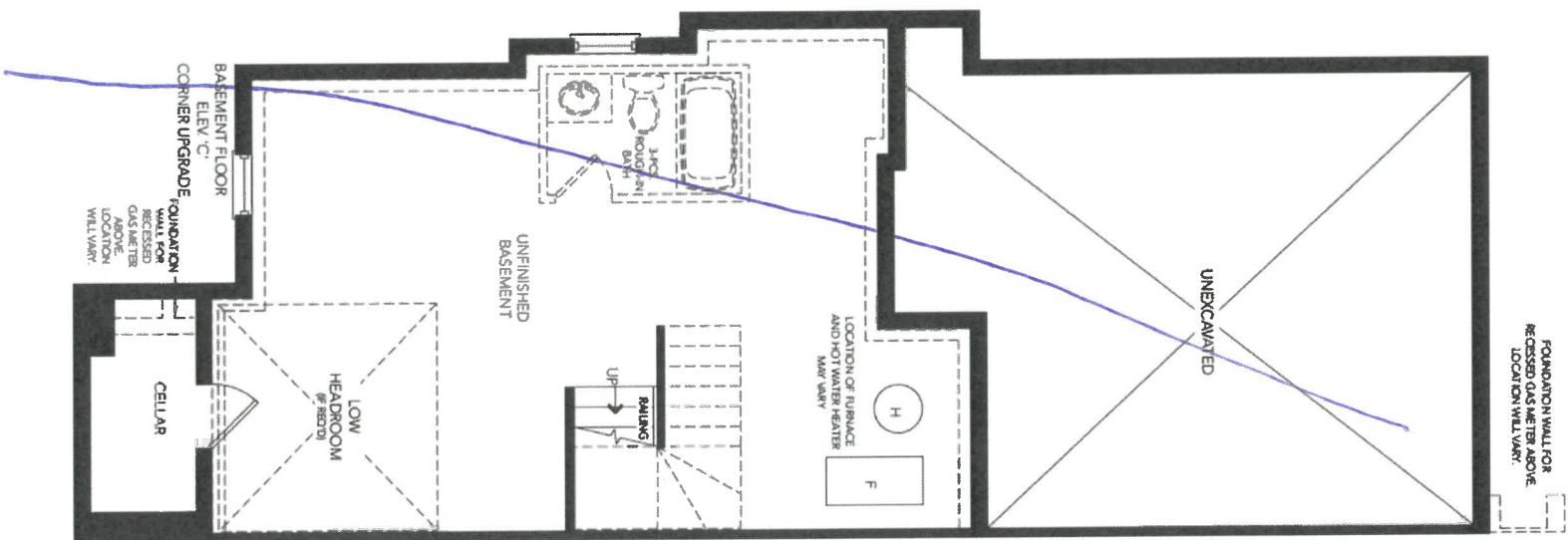
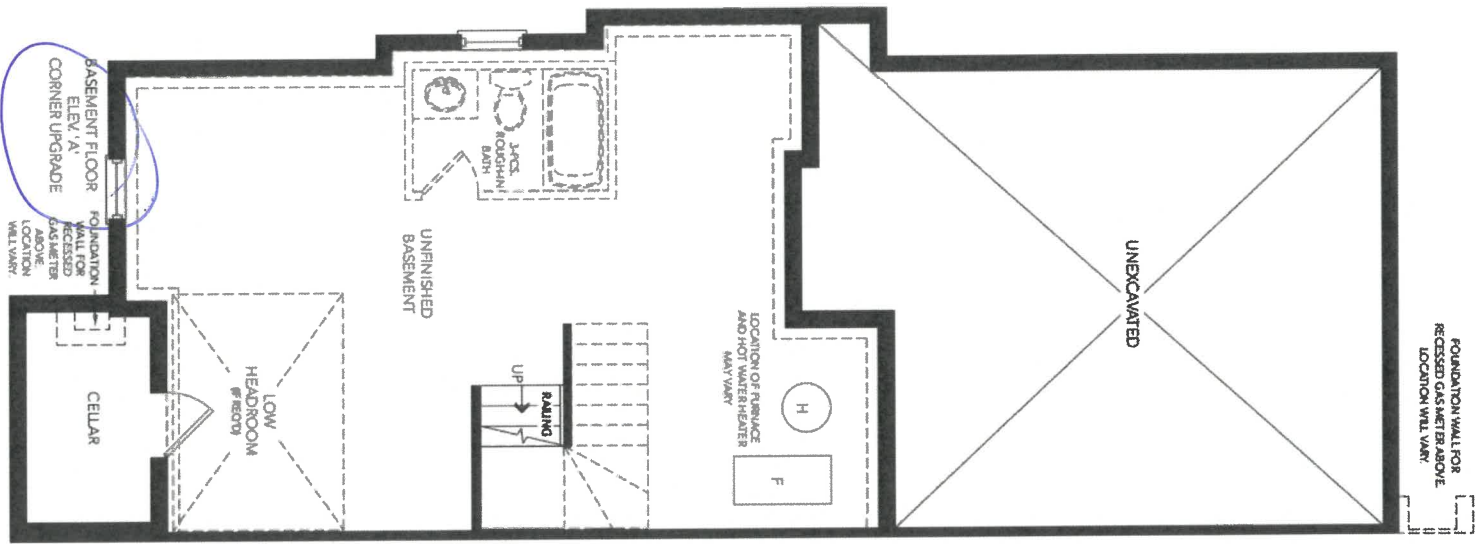

UP

ESSEX RLTH-04 (Corner)

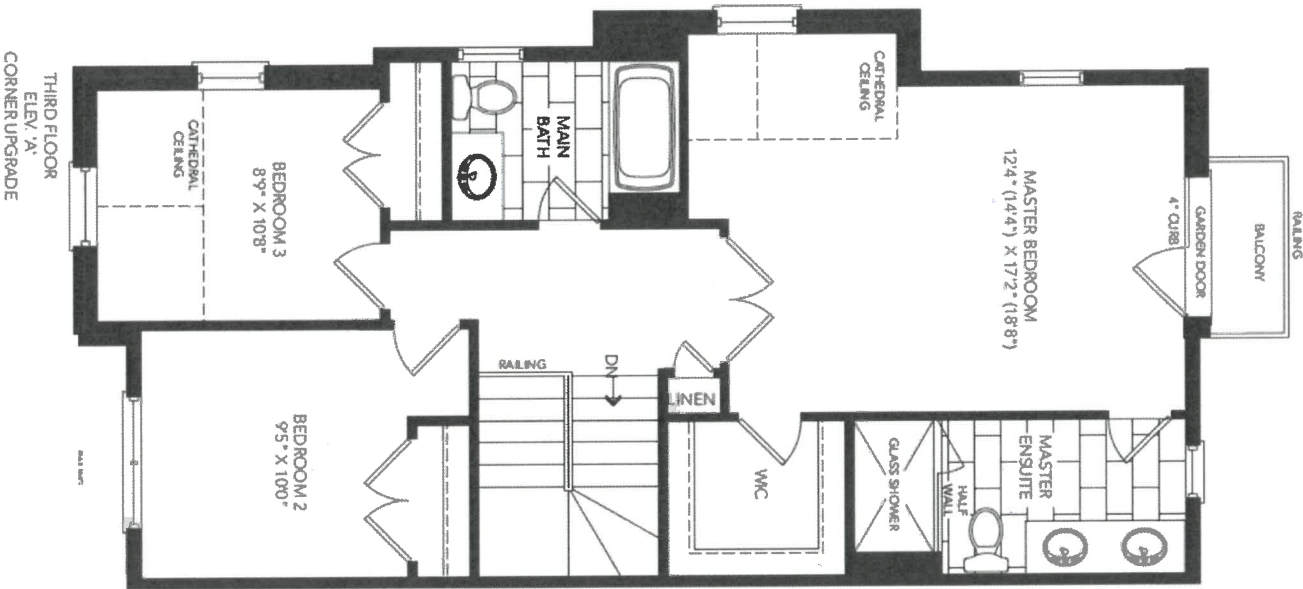

lot 197-1
Mar 10/22

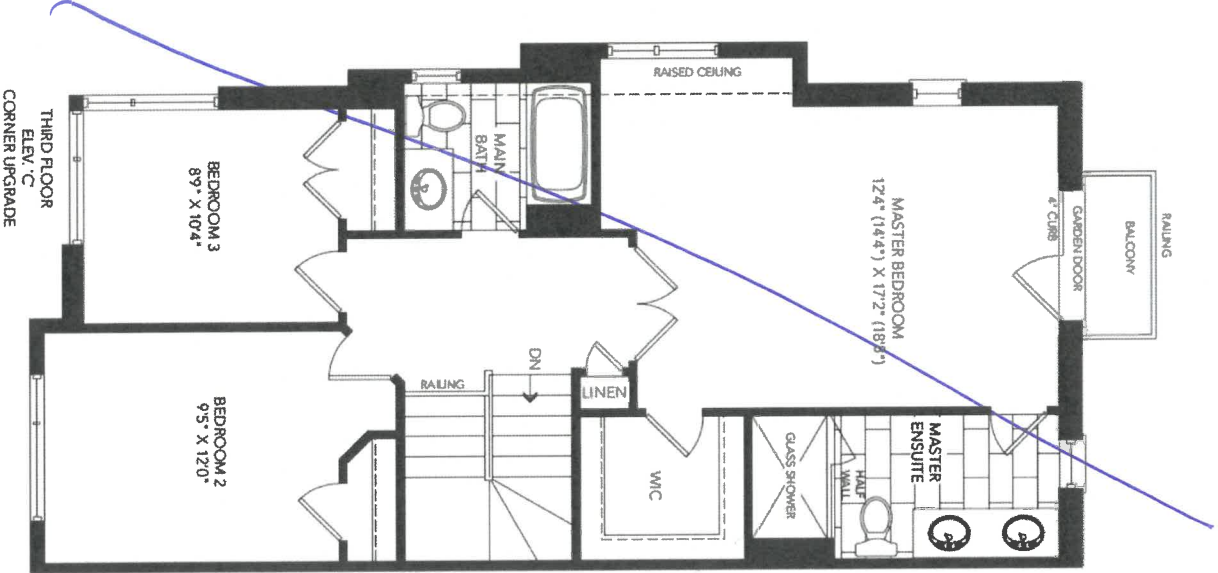

ESSEX RLTH-04 (Corner)





DATE SUBMITTED
01 Mar 2022

CLIENT NAME: ZANCOR HOMES
SHIP TO : CALEDON CLUB
 RLTH-04-ELEV. A, B, C
DRAFTED BY: KATLYN
COMMENT
PH:
CELL:

JOB NUMBER
P/O #

INSTALL DATE:
PAGE
3 of 8

STD VANITIES

POWDER GROUND FLOOR

760
750

lot 192-1
Apr 10/22

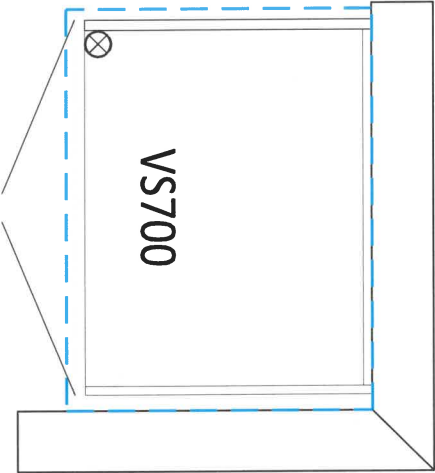

099

LAUNDRY ROOM

2540
950

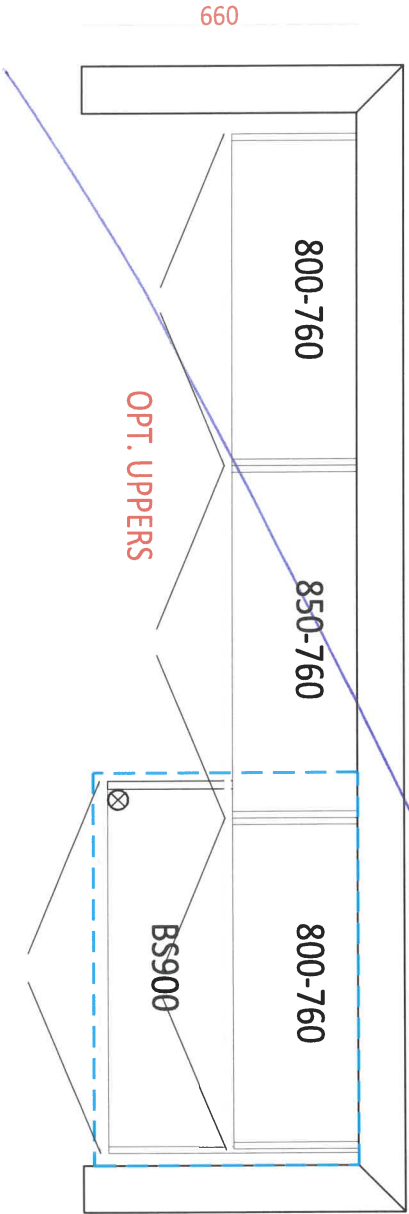

660

099

MAIN

MASTER ENSUITE

1310
1310

1860
1850

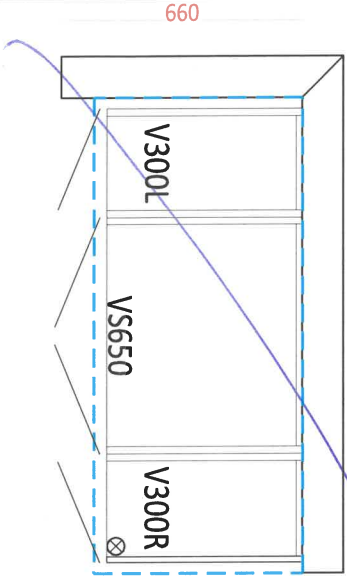

660

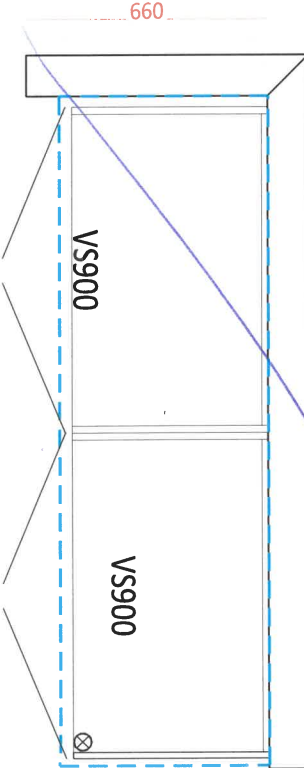

660

VP



DATE SUBMITTED
01 Mar 2022

CLIENT NAME: ZANCOR HOMES
SHIP TO : CALEDON CLUB
 RLTH-04-ELEV. A, B, C
DRAFTED BY: KATLYN
PH:
CELL:

JOB NUMBER
INSTALL DATE:
PAGE
7 of 8
P/O #

THIRD FLOOR VANITIES

POWDER ROOM

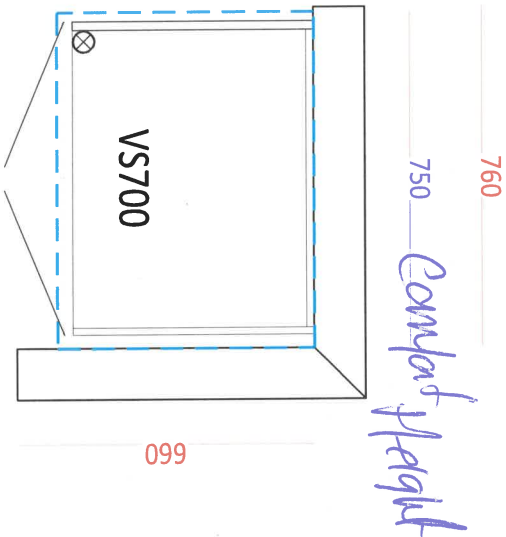

1 of 192-1
March/27

MUDROOM

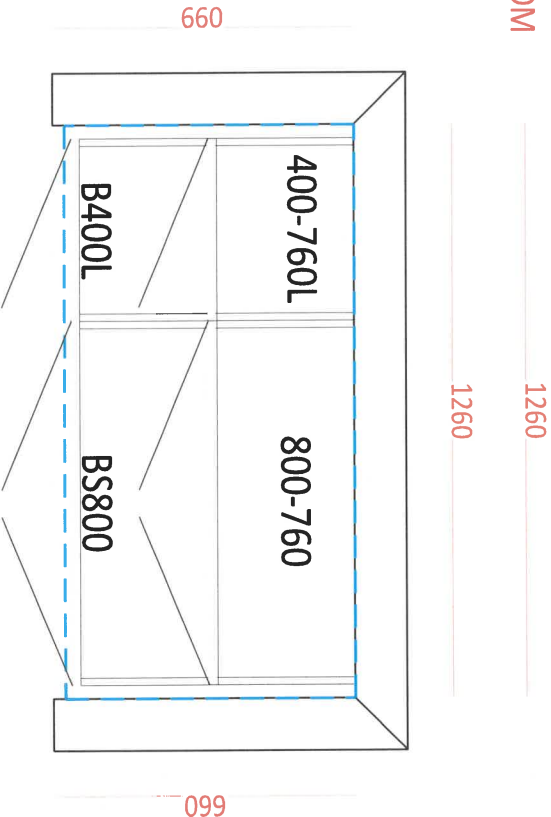

MAIN - comfort Height

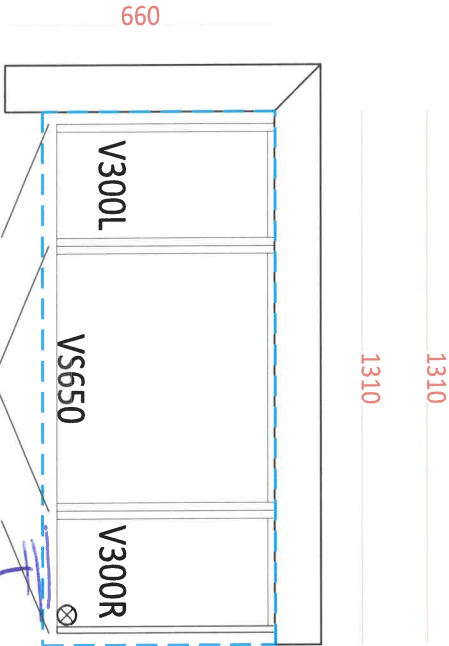

MASTER ENSUITE - comfort Height

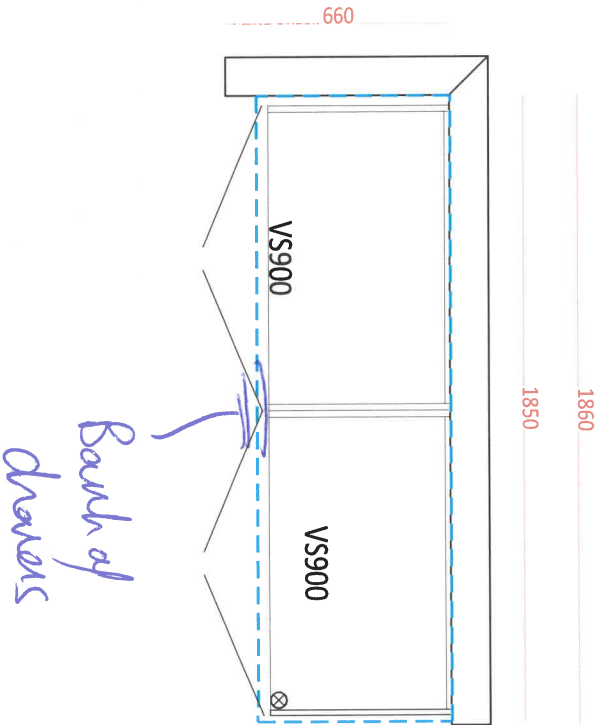

VP



DATE SUBMITTED
01 Mar 2022

CLIENT NAME: ZANCOR HOMES
SHIP TO : CALEDON CLUB
RLTH-04-ELEV. A, B, C
PH:
CELL :

DRAFTED BY: KATLYN
COMMENT

P/O #

JOB NUMBER
INSTALL DATE:
PAGE
1 of 8

KITCHEN

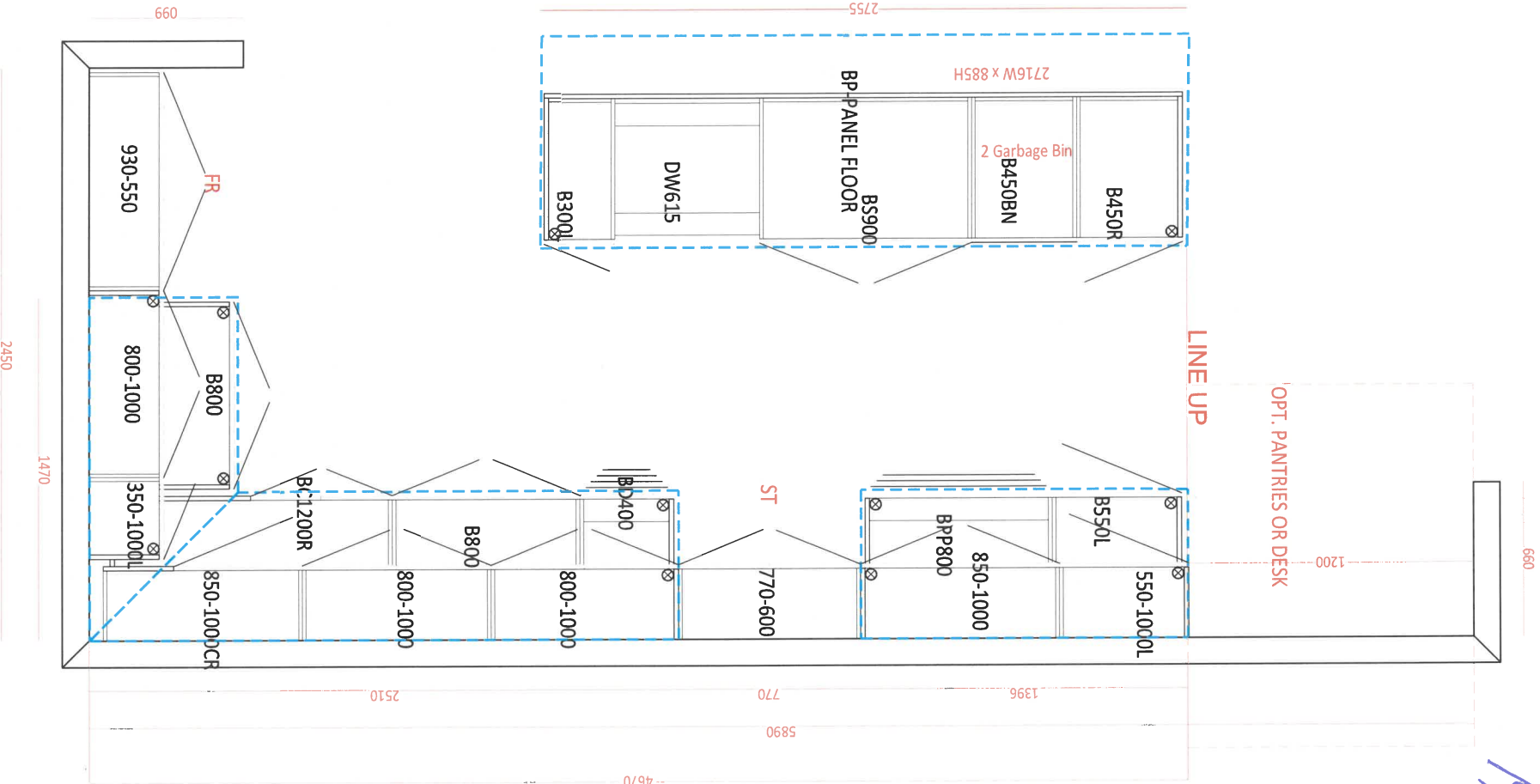

VR

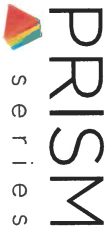

lot 1921
Jan 10/22

Prism Series

50" Linear Electric Fireplace

BLF5051

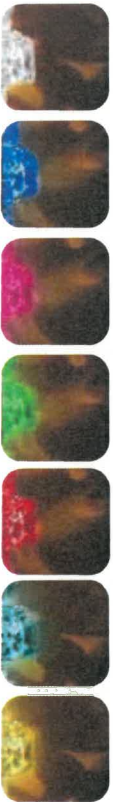
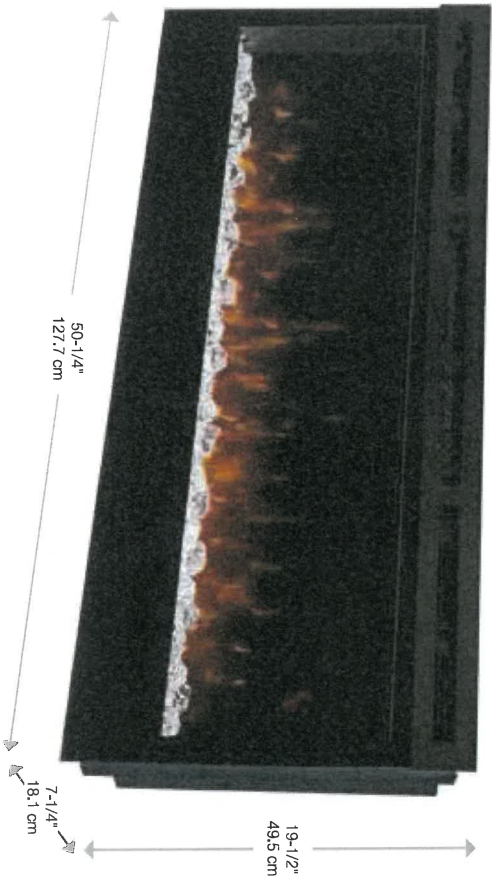

Color Themes

Accessories



Driftwood and River Rock Accessory Package
- 50" LF50DWS-KIT

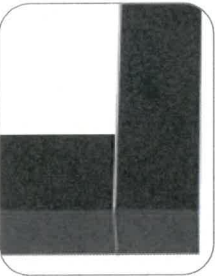

Cohesion Trim - Black
DT1267BLK



Multi-function
Remote

120 Volts | 1,230 Watts | 4,197 BTU

Model #	Description	Lbs / Kg	UPC	Wty ¹	Carton Dimensions (WxHxD)		Cube	
					Inches	cm	ft ³	m ³
BLF5051	50" Linear Electric Fireplace	75 / 34.1	781052 098787	2 yr.	55 x 23-1/4 x 12-7/8	139.7 x 58.9 x 32.7	9.5	0.26
DT1267BLK	Cohesion Trim - Black	51 / 23.1	781052 080355	1 yr	64-7/8 x 26-1/4 x 8-3/4	164.8 x 66.8 x 22.1	8.6	0.24
LF50DWS-KIT	50" Driftwood and River Rock Accessory Kit	7 / 3.17	781052 102842		34-1/4 x 5-7/8 x 8-1/8	87.2 x 14.98 x 20.6		

Specifications, finishes and dimensions are subject to change. ¹Limited warranty. ©2020 Glen Dimplex Americas

Glen Dimplex Americas | 1-800-668-6663 | www.dimplex.com

Features

- The Original Dimplex Flame Effect™**
A blend of technology, artistry and craftsmanship that sets the standard for realism.
- Acrylic Ice Media Bed**
Light plays through different size pieces and sparkle in a spectrum of colors.
- Media Accent Colors**
Choose from a variety of brilliant color themes or cycle through a range of colors using the custom mode, freezing on the hue of your choice.
- Flexible Installation**
Simply surface mount and plug-in or tully-recess and direct wire for a seamless installation
- Hanging Glass Design**
Detachable glass trim easily finishes rough openings and provides access to media.
- Remote Thermostat Control**
Temperature control at your fingertips for convenient comfort.
- Multi-function Remote**
Control the flame, heat and thermostat from the comfort of your chair.
- LED Lighting**
Flame and lights use brilliant, low-energy LED's that require zero maintenance.
- All-season Flames**
Enjoy the unique charm of a fireplace 365 days a year using the flames without the heat.
- Cool-touch Glass**
Glass remains cool making it safe for any location and any user.
- Low Carbon Footprint**
The most sustainable fireplace option: no emissions and 100% efficient.

SF-022-FR06-04-520



let 197-1
Mar 18/21

Prism Series 50" Linear Electric Fireplace

BLF5051

Product Dimensions:

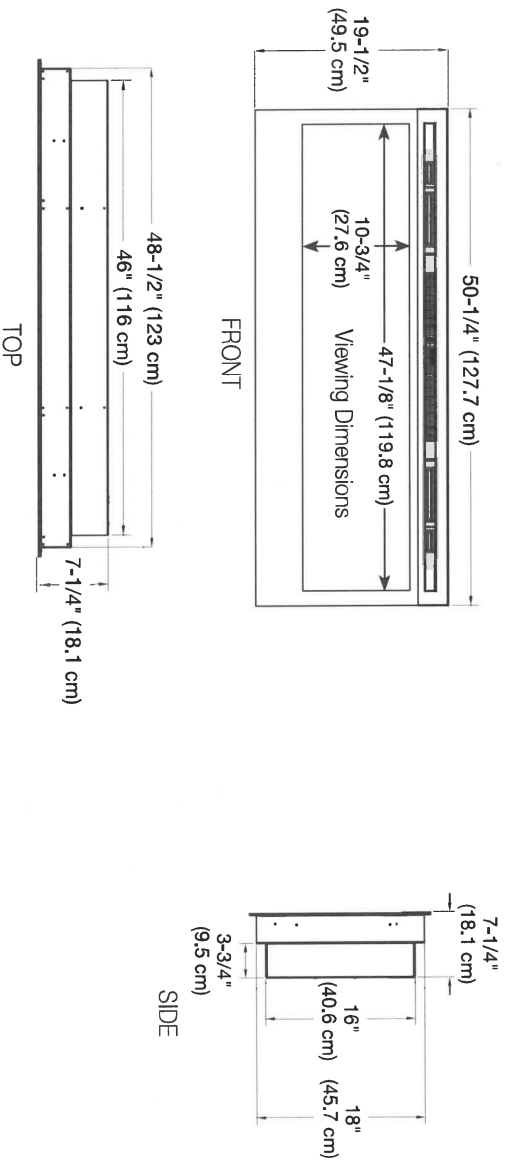

Installation Options and Framing Dimensions

3 Mounting Options

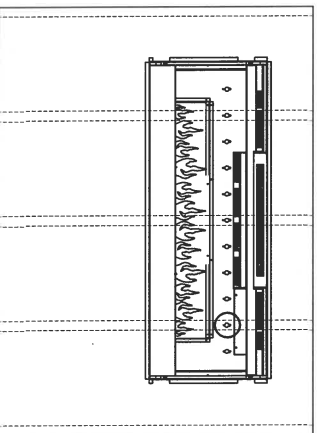

ON WALL

Must mount to a minimum of three (3) wall studs

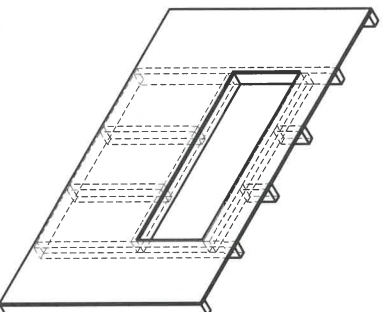

PARTIAL RECESSED

2 X 4 Wall Construction
Framing dimensions:
46-1/2" W x 16-1/2" H
(118.1 cm) W x (42 cm) H

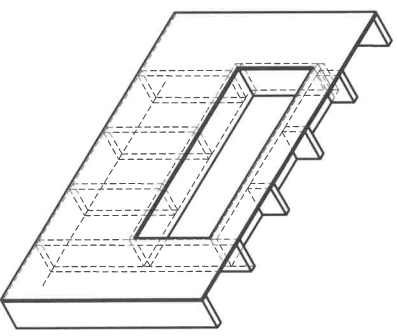

FULLY RECESSED

2 X 8 Wall Construction
Framing dimensions:
49" W x 18-1/2" H
(124.5 cm) W x (47 cm) H

✓

APPLIANCE ACKNOWLEDGEMENT

CONTACT: Steve Miller - Appliance Canada (905) 660-2424 / smiller@appliancecanada.com

- It is the Purchasers responsibility to coordinate delivery, installation and hook up of appliances and to ensure they are installed as per Manufacturers specifications after closing.

STANDARD APPLIANCE OPENINGS provided by Zancor:

*Standard appliance openings are approximate and the minimum required. Sizes may vary due to onsite condition and/or when modifications have been made to the cabinetry.

- ▶ Fridge Opening 36" x 74"
- ▶ Stove Opening 30"
- ▶ Hood Fan Opening 30"
- ▶ Hood Fan & Vent 6" with Under Cabinet Hood
- ▶ Dishwasher Opening 24"

Accepts Standard
Openings **Initial

SM

OPTIONAL UPGRADED APPLIANCES to be provided by Homeowner:

- **Specs/Information sheets are required and it is the responsibility of the homeowner to provide this to Zancor Homes by the due date that has been provided. If appliance specs are not submitted, Zancor Homes will not be responsible for any necessary requirements and the standard opening will be built.**

SM

- ▶ Upgraded Appliance Specs are DUE 2 WEEKS FROM SIGNED DATE OF COLOUR CHART (if not received during appointment) INITIAL
- ▶ ***Specs that require changes/modifications after this date will not be accepted***
- ▶ NOTE: Any upgraded appliances are to be paid by the Purchaser, directly to the appliances company.
- ▶ Additional charges to the Purchaser may apply for cabinetry, electrical and plumbing in order to accommodate the specs given by the homeowner.

FRIDGE UPGRADE

- ☐ Built-in
- ☐ Paneled **Panel to match required
- ☒ Integrated / Flush Inset
- ☒ Waterline

RANGE UPGRADE

*Larger hood fan CFM might be required, which need a larger vent

- ☐ 36" **Hood fan opening must be the same size or larger (8" vent might be required)
- ☒ 48" **Hood Fan opening must be the same size or larger (8" or 10" vent required)
- ☒ Gas Range **gas line and electrical required & sold separately
- ☐ Induction **electrical required & sold separately
- ☐ Cooktop (Apron Front) **Countertop Cut-out required & sold separately
- ☐ Cooktop (Drop-in) **countertop Cut-out required & sold separately

HOOD FAN & VENT
UPGRADE

- ☐ 8 Inch **Required for 600 CFM
- ☐ 10 Inch
- ☐ Chimney Hood Fan **Vent must be centred
- ☐ Insert / Liner

WALL OVEN/MICRO
UPGRADE

- ☐ Single Wall Oven **electrical required & sold separately
- ☐ Double Wall Oven **electrical required & sold separately
- ☐ Steam Oven **electrical required & sold separately
- ☐ Warming Drawer **electrical required & sold separately
- ☐ Over Then Range Microwave (OTR)
- ☐ Built-In Microwave **Trim Kit required **electrical required & sold separately

DATE Mar 10 / 22

SITE CALEDON

LOT 197-1

** Any upgrades checked in this appliance form must be accompanied with specs provided by the Purchaser.
**It is the responsibility of the trade to inform the Builder of any discrepancies with specs, sketches, extras and/or colour chart PRIOR to production/installation.

ZANCOR

221 North Rivermede Road, Concord, Ontario L4K 3N7 * T: (905) 738.7010 F: (905) 738.5948

221 North Rivermede Road, Concord, Ontario L4K 3N7 * T: (905) 738.7010 F: (905) 738.5948

Purchaser accepts and acknowledges that the Builder reserves the right to substitute materials with those of equal or better quality where the manufacture, scheduling or delivery of materials may directly impact the Builder's ability to meet its' contractual obligations under the Agreement of Purchase and Sale.

UPGRADES/EXTRAS: All upgrades and additional selections indicated on the colour chart must be accompanied by an upgrades/extras sheet (PES) and full payment otherwise the selection will be invalid. All colour charts and upgrades/extras will not proceed until verified and signed by an authorized signing officer at the Vendor's head office. **CHANGES WILL NOT BE PERMITTED UPON COMPLETION AND SUBMISSION OF THE COLOUR CHART.**

PORCELAIN & NATURAL STONES: Due to the properties of natural stones including but not limited to **marble, granite, quartz**, no two pieces are exactly the same. Variations in colour, tone, granularity (pitting, fissures) and pattern are to be expected, including various lighting may affect the overall finished look. Stone tops are sealed at time of installation and should never be cleaned with lemon oil or vinegar. Stones are porous materials, therefore any spilled substance require immediate attention. Stone countertops require regular seal re-application as part of home maintenance. Purchaser acknowledges colour and product variations as well as natural imperfections may exist with the selection of natural stone materials and shall not hold the Vendor liable for provision of same.

STONE COUNTERTOP JOINTS: Purchaser is aware there may be joints in stone counter tops, in kitchens and vanities if applicable as per plan. Joints will also be applicable where the length of the counter top exceeds the length of a stone slab.

CERAMIC TILES: Due to manufacturing, shade (dye lots), product variations may exist that can affect the overall look of the finished product. Although every effort will be made to ensure the colours and materials selected are as close as possible to the samples, the purchaser acknowledges that the sample tiles supplied in the Design Centre may not be identical to the materials installed in the home.

STAIR STAINS: Due to the natural properties of wood, many variables can affect the overall look of the finished product. Factors including but not limited to wood type, knotting, graining, density, age, humidity, and air temperature can result in substantial variations in stain intensity. The purchaser accepts that although the Vendor will do their best to match stain the unfinished stairs as close as possible to the pre-finished floors, it is not possible to have an identical match and that there MAY be shade differences between the two products.

CABINETRY: Due to the natural properties of wood, slight variations apparent with cabinetry are to be expected. This includes but not limited to wood species, wood grain, colour, finish, product variations, and natural imperfections are all factors that may affect the overall look of the finished product. Such factors make exact colour matching impossible. The type and intensity of lighting in the areas of designated cabinetry placement may also highlight characteristics of cabinetry finish. All cabinets shall be finished with a white melamine interior box unless a finished interior is upgraded. Due to building specifications and/or on-site conditions, certain cabinetry upgrades may not be possible. The purchaser acknowledges that the Builder cannot guarantee the cabinetry finish or provision of certain upgrades and shall not hold the Builder liable for provision of same.

UPGRADES/EXTRAS: All upgrades and additional selections indicated on the colour chart must be accompanied by an upgrades/extras sheet (PES) and full payment otherwise the selection will be invalid. All colour charts and upgrades/extras will not proceed until verified and signed by an authorized signing officer at the Vendor's head office. **CHANGES WILL NOT BE PERMITTED UPON COMPLETION AND SUBMISSION OF THE COLOUR CHART.**

HARDWOOD / LAMINATE FLOORING: Due to the properties of wood and laminate, many variables can affect the overall look of the finished product. Variations include but not limited to wood type or laminate finish, colour/stain and wood grain are significant factors that make exact colour matching impossible. The purchaser acknowledges that the hardwood flooring is a pre-finished product in a controlled environment. Expansion, compression and cupping are characteristics of hardwood flooring once installed in the home. The purchaser acknowledges these may become apparent over time and despite the Builders' efforts to install the hardwood flooring materials in keeping with good workmanship, the Builder shall not be responsible nor held liable for minor variances of fluctuation in hardwood flooring materials.

HARDWOOD / LAMINATE WAIVER:

I/We understand hardwood flooring is classified as a porous material and as such not recommended by the Builder in certain areas. I/We understand there is a concern due to possible water and other substances being frequently splashed or spilled onto the floor and in contravention of Ontario Building Code Section 9.30.1.2(1).

"Finished flooring bathrooms, kitchens, public entrance halls, laundry & general storage areas shall consist of resilient flooring, felted-synthetic-fibre floor coverings, concrete, terrazzo, ceramic tile, mastic or other types of flooring providing similar degrees of water resistance.

I/We are prepared to assume full responsibility for any damage caused to the hardwood floor or subfloor due to moisture absorbency in the mentioned areas, and agree to waive any claims against the Township of residence, TARIION and/or the Builder in relation to the matter. ****SEE COLOUR CHART FOR LOCATIONS****

DATE	19/10/22	SITE	CALEDON	LOT	197-1
221 North Rivermede Road, Concord, Ontario L4K 3N7 * T: (905) 738.7010 F: (905) 738.5948					

HOME AUTOMATION (Cable, CAT5/6, Telephone)

INCLUDED IN SCHEDULE "A" IN AGREEMENT OF PURCHASE AND SALE:

- Rough-in for Central Vacuum system piped to garage
- Rough-in for Telephone (2) locations
- Rough-in for Cable TV (2) locations
- Rough-in for Cat-6 Network (3) locations

OPTION 1:

I/we the Homeowner(s) have chosen to contact the Home Automation Company to select the locations of the rough-ins for Cable, CAT5, Telephone as included in our Agreement of Purchase Sale.

I/we the Homeowner(s) will contact the trade within 4 weeks of the date of this release to select locations of the standard rough-ins review other optional products for purchase.

Trade:

Artistic Smart Homes

Phone:

(905) 850-9386

Location:

8601 Jane Street

Concord, Ont L4K 5N9

Should the homeowner not make these selections within the sufficient time provided, the rough-ins as mentioned above will be installed in locations at the Vendor's discretion.

I/we the Homeowner(s) acknowledge that if we do not contact the home automation company, I/we the Homeowner(s) have agreed to the Vendor locations for the standard rough-ins for Cable, CAT6, Telephone that are included in the Agreement of Purchase and Sale.

Homeowner(s) Initial

X J R

Homeowner(s) Initial

DATE

Mar 10 / 22

SITE

CALEDON

LOT

199-1

221 North Rivermede Road, Concord, Ontario L4K 3N7 * T: (905) 738.7010 F: (905) 738.5948

Stone Countertop Edge Profiles

Where applicable as per site specifications

STANDARD EDGE FOR KITCHEN & VANITIES

Standard Countertop Edge in
Kitchen



Standard Countertop Edge in
Vanity

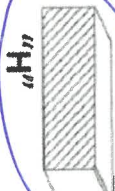

Homeowner(s) Initial JP

OPTION (1) EDGE FOR KITCHEN & VANITIES \$250

Optional Edge in Kitchen

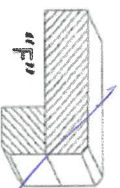
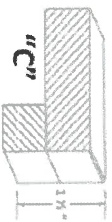

Optional Edge in Bathroom

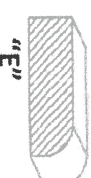
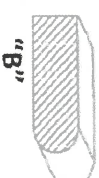
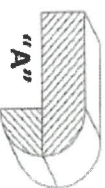
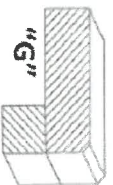

Homeowner(s) Initial _____

OPTION (2) EDGE FOR KITCHEN & VANITIES CUSTOM PRICING

Optional Edge for Kitchen

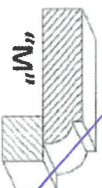
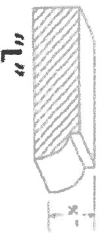

Optional Edge in Vanity

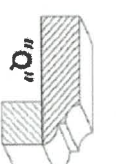
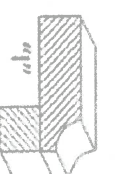
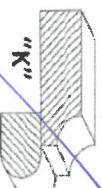
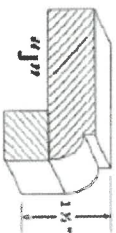
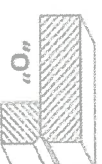
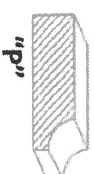

Homeowner(s) Initial _____

DATE

May 10 / 22

SITE

CALEDON

LOT

199-1