

Site:
Lot:
Model:
Purchaser:
Purchaser:
Phone:
Email:

CALEDON (B)
65B
WYNDANCE 38-02 (A) (4 BEDROOM)
LAKHVINDERJIT S. HUNDAL
PARMEET KAUR HUNDAL
647-972-5992
LAKHUNDAL@HOTMAIL.COM



DESCRIPTION		DATE SELECTED
BONUS PACKAGE: 3 PIECE STAINLESS STEEL APPLIANCES WITH WHITE WASHER & DRYER		INCLUDED IN APS
BONUS PACKAGE: STAINLESS STEEL HOOD FAN		INCLUDED IN APS
BONUS PACKAGE: AIR CONDITIONER		AS PER SCH E
STRUCTURALS		
1 FINISHED 3 PCE BATHROOM IN BASEMENT **INCLUDES TOILET, VANITY, TUB, FLOOR TILES, WALL TILES, ELECTRICAL AND DRYWALL FROM BUILDERS STANDARD SAMPLES		DEC 13 2021
COLOURS		
1 KITCHEN - COUNTERTOP - UPGRADE 2		24-Jan-22
2 KITCHEN BACKSPLASH - STONE SLAB		24-Jan-22
3 N/A		24-Jan-22
4 N/A		24-Jan-22
5 KITCHEN - ADD PANTRY (2 DOOR) 24 INCHES WIDE BY 18 INCHES DEEP **SEE DRAWING		24-Jan-22
6 KITCHEN - ADD MATCHING VALANCE		24-Jan-22
7 KITCHEN - ADD CROWN MOULDING		24-Jan-22
8 NOTE - THERE WILL BE A BULKHEAD ACROSS ALL THE KITCHEN UPPER CABINETS INCLUDING PANTRY		24-Jan-22
9 KITCHEN - FRIDGE ENCLOSURE **SEE FRIDGE LOCATION		24-Jan-22
10 POWDER ROOM - CABINETS - UPGRADE 1		24-Jan-22
11 POWDER ROOM SINK - RECTANGLE UNDERMOUNT		24-Jan-22
12 LAUNDRY ROOM - ADD UPPER CABINETS		24-Jan-22
13 LAUNDRY ROOM - ADD COUNTERTOP ACROSS WASHER & DRYER		24-Jan-22
14 MASTER ENSUITE - CABINETS - UPGRADE 1		24-Jan-22
15 MASTER ENSUITE - COUNTERTOP - UPGRADE 1		24-Jan-22
16 MASTER ENSUITE - ADD DRAWERS IN BETWEEN SINKS (2 SMALL, 1 BIG)		24-Jan-22
17 MASTER ENSUITE - VANITY COMFORT HEIGHT		24-Jan-22
18 MOEN ACCESSORIES - TOILET PAPER HOLDER IN ALL BATHROOMS (X5)		24-Jan-22
19 MOEN ACCESSORIES - 18 INCH TOWEL BAR IN ALL BATHROOMS (EXCEPT MASTER) (X4)		24-Jan-22
20 MOEN ACCESSORIES - 24 INCH TOWEL BAR IN MASTER ENSUITE		24-Jan-22
21 ELECTRICAL - ADD (2) CAPPED LIGHTS IN KITCHEN ABOVE ISLAND ON SEPARATE SWITCH		24-Jan-22
22 ELECTRICAL - ADD PLUG ABOVE FIREPLACE FOR FUTURE TV **CABLE BESIDE IT		24-Jan-22
23 PLUMBING - SEE NEW LOCATION OF HOSE BIB IN GARAGE		24-Jan-22
24 WATERLINE TO FRIDGE		24-Jan-22
25 KITCHEN - UPGRADE KITCHEN HANDLES		24-Jan-22
26 MASTER ENSUITE SINKS - RECTANGLE UNDERMOUNT		24-Jan-22
27 KITCHEN SINK - BLANCO 401247		24-Jan-22
28 KITCHEN CANOPY - TRANSITIONAL STYLE **INCLUDES HOOD FAN (SEE SPEC)		24-Jan-22
ADDITIONAL		
1 KITCHEN - BUILT IN MCROWAVE WITH TRIM KIT WITH DRAWER BELOW		26-Jan-22
2 ELECTRICAL FOR MICROWAVE		26-Jan-22
3 KITCHE - SOAP DISPENSER CHROME		26-Jan-22

ANCOR HOMES COLOUR CHART

ENTRANCES				
Main Foyer - FLOORING		NEW BYZANTINE ASSURO 12 X 24 *BRICK		
Mudroom - FLOORING		NEW BYZANTINE ASSURO 12 X 24 *BRICK		
Side Hall - FLOORING		N/A		
Basement Foyer - FLOORING		N/A		
KITCHEN				
Kitchen - FLOORING		NEW BYZANTINE ASSURO 12 X 24 *BRICK		
Breakfast - FLOORING		NEW BYZANTINE ASSURO 12 X 24 *BRICK		
Kitchen - CABINETS		SIERRA PVC - WHITE		
Island - CABINETS		SIERRA PVC - WHITE		
Servery - CABINETS		N/A		
Kitchen - HANDLES/KNOBS		UPGRADE - H800BC128		
Kitchen - COUNTERTOP		EMERSTONE CARRARA WHITE (2)		
Island - COUNTERTOP		EMERSTONE CARRARA-WHITE (2)	PURE GREY	
Kitchen - BACKSPLASH		SLAB - EMERSTONE CARRARA WHITE (2)		
Kitchen - SINK		UPGRADE - BLANCO 401247		
Kitchen - FAUCET		STANDARD		
GREAT ROOM / DINING / LIVING / DEN / OFFICE / BASEMENT				
Family / Great Room - FLOORING		HARDWOOD - VINTAGE RED OAK NSS SMOOTH 3-1/4" PEARL - JAVA (1)		
Main Hall - FLOORING		HARDWOOD - VINTAGE RED OAK NSS SMOOTH 3-1/4" PEARL - JAVA (1)		
Dining / Living Room - FLOORING		HARDWOOD - VINTAGE RED OAK NSS SMOOTH 3-1/4" PEARL - JAVA (1)		
Library / Den - FLOORING		N/A		
Basement Rec Room - FLOORING		N/A		
STAIRS				
Railing Details - PICKETS		STANDARD - METAL PICKETS - SINGLE COLLAR WITH ALT PLAIN		
Railing Details - POSTS		STANDARD - TURNED OAK 3-1/4"		
Railing Details - HANDRAIL		STANDARD - OVAL OAK 2-3/4"		
Stair Stain - MAIN STAIRS		STAIN STAIRS TO MATCH HARDWOOD AS CLOSE AS POSSIBLE		
Stair Stain - BASEMENT STAIRS (if applicable)		N/A		
Stair Stain - SERVICE STAIRS (if applicable)		N/A		
POWDER ROOM				
Powder Room - FLOORING		NEW BYZANTINE ASSURO 12 X 24 *BRICK		
Powder Room - CABINETS		MOSAIK MDF - STONE GREY (1)		
Powder Room - COUNTERTOP		BIANCO CARRARA		
Powder Room - SINK		UPGRADE - RECTANGLE UNDERMOUNT		
Powder Room - FAUCET		STANDARD		
2ND FLOOR				
Upper Hall - FLOORING		HARDWOOD - VINTAGE RED OAK NSS SMOOTH 3-1/4" PEARL - JAVA (1)		
Master Bedroom - FLOORING		CARPET - OPENING NIGHT - COLOUR T21 w/STANDARD UNDERPAD		
Bedroom 2 - FLOORING		CARPET - OPENING NIGHT - COLOUR T21 w/STANDARD UNDERPAD		
Bedroom 3 - FLOORING		CARPET - OPENING NIGHT - COLOUR T21 w/STANDARD UNDERPAD		
Bedroom 4 - FLOORING		CARPET - OPENING NIGHT - COLOUR T21 w/STANDARD UNDERPAD		
Bedroom 5 - FLOORING		N/A		
Master Ensuite - FLOORING		GENESIS LIGHT GREY 12 X 24 *BRICK		
Master Ensuite - SHOWER WALL		GENESIS LIGHT GREY 12 X 24 *STACKED VERTICAL		
Master Ensuite - SHOWER FLOOR		WHITE 2 X 2		
Master Ensuite - SHOWER JAMB		BIANCO CARRARA		
Master Ensuite - CABINETS		MOSAIK MDF - STONE GREY (1) **COMFORT HEIGHT		
Master Ensuite - HANDLES/KNOBS		H800BC		
Master Ensuite - COUNTERTOP		EMERSTONE WHITE GALAXY (1)		
Master Ensuite - SINK(s)	STANDARD UNDERMOUNT	Master Ensuite - FAUCET(s)	STANDARD	
FOR TRADE USE				
Any upgrades in the colour chart must be accompanied with a PES. It is the responsibility of all Trades to inform the builder of any discrepancies on sketches, PES and/or colour charts <u>PRIOR</u> to installation.		CALEDON 65B	CH	SIGNATURES
PAGE 1 OF 2		PURCHASER INITIALS	VENDOR APPROVAL	

ZANCOR HOMES COLOUR CHART

2ND FLOOR CONTINUED...

Ensuite 2 Bath - FLOORING	LOFT WHITE 12 X 24 *BRICK	
Ensuite 2 Bath - TUB / SHOWER WALL	LOFT WHITE 12 X 24 *HORIZONTAL STACKED	
Ensuite 2 Bath - SHOWER FLOOR	N/A	
Ensuite 2 Bath - SHOWER JAMB	N/A	
Ensuite 2 Bath - CABINETS	SHAKER TUXEDO	
Ensuite 2 Bath - HANDLES/KNOBS	H800BC	
Ensuite 2 Bath - COUNTERTOP	LAMINATE - 5009-60	
Ensuite 2 Bath - SINK(S)	STANDARD	Main Bath - FAUCET(s) STANDARD
Shared Bath- FLOORING	LOFT WHITE 12 X 24 *BRICK	
Shared Bath- TUB / SHOWER WALL	LOFT WHITE 12 X 24 *HORIZONTAL STACKED	
Shared Bath- SHOWER FLOOR	N/A	
Shared Bath- SHOWER JAMB	N/A	
Shared Bath- CABINETS	SIERRA PVC WHITE	
Shared Bath- HANDLES/KNOBS	H800BC	
Shared Bath- COUNTERTOP	LAMINATE -4925K-07 1886K-07 LH	
Shared Bath- SINK(S)	STANDARD	Shared Bath - FAUCET(s) STANDARD
Basement Bath - FLOORING	LOFT WHITE 12 X 24 *BRICK	
Basement Bath - TUB / SHOWER WALL	LOFT WHITE 12 X 24 *HORIZONTAL STACKED	
Basement Bath - SHOWER FLOOR	N/A	
Basement Bath - SHOWER JAMB	N/A	
Basement Bath - CABINETS	SHAKER TUXEDO	
Basement Bath - HANDLES/KNOBS	H800BC	
Basement Bath - COUNTERTOP	LAMINATE - 5009-60	
Basement Bath - SINK(S)	STANDARD	Ensuite Bath - FAUCET(s) STANDARD
LAUNDRY		
Laundry - FLOORING	NEW BYZANTINE ASSURO 12 X 24 *BRICK	
Laundry - CABINETS & UPPERS/LOWER	SIERRA PVC WHITE	Laundry - HANDLES/KNOBS H800BC
Laundry - COUNTERTOP	LAMINATE - 1886K-07	Laundry - SINK STANDARD
Laundry - BACKSPLASH	N/A	Laundry - FAUCET STANDARD
TRIM / PAINT		
Casing/Baseboards	STANDARD	
Interior Doors	STANDARD	
Interior Door Hardware	STANDARD	
PAINT - Throughout	COOL WHITE	
FIREPLACE		
Location / Insert / Mantle	STANDARD	
ACCESSORIES		
Mirrors	YES	BATH ACCESSORIES UPGRADE
APPLIANCE REQUIREMENTS		
GAS LINE TO BBQ	STANDARD	ELECTRICAL for Built-in Oven N/A
GAS LINE & ELECTRICAL TO STOVE	DECLINED	ELECTRICAL for Built-in Micro N/A
GAS LINE & ELECTRICAL TO DRYER	N/A	ELECTRICAL for Cooktop N/A
HOOD FAN VENT SIZE	6 INCH	ELECTRICAL for Bar Fridge N/A
WATERLINE to Fridge	YES	
DISCLAIMER		
Any changes to the colour chart after signing are subject to a \$5000 administration fee plus costs		
Purchaser has checked and acknowledged accuracy of colour and selections before signing.		
Colours of all materials are as close as possible to Builders selection but not necessarily identical due to dye lot variances in manufacturing/manufacturers. Due to construction progress some items may have been pre-selected or installed. In this event the Vendor's selection must be accepted by the purchaser		
SITE / LOT:	CALEDON (B)	65B
PURCHASER(S):	LAKHVINDERJIT S. HUNDAL	
PURCHASER(S):	PARMEET KAUR HUNDAL	
CONTACT:	647-972-5992	LAKHUNDAL@HOTMAIL.COM
FOR TRADE USE		
Any upgrades in the colour chart must be accompanied with a PES. It is the responsibility of all Trades to inform the builder of any discrepancies on sketches, PES and/or colour charts PRIOR to installation.		
ZANCOR HOMES	PURCHASER SIGNATURE	SIMONE
	PURCHASER SIGNATURE	
	DÉCOR CONSULTANT	
Vendor APPROVAL		

COLLETTE

21½" RECTANGULAR UNDERMOUNT SINK

☐ 4220C1Y Undermount Sink

Product Specs:

- Vitreous china
- Front overflow hole
- Template and mounting hardware supplied

Overall Dimensions (W x D x H):

(OD): 545mm(21½") x 355mm(14") x 190mm(7½")
(ID): 485mm(19") x 295mm(11½") x 140mm(5½")

Compliance Certifications:

- Meets or exceeds the following:
- IAPMO cUPC
 - ASME A112.19.2 / CSA B45.1-2013

Shipping:

Cube 1.64
GW 25 lbs

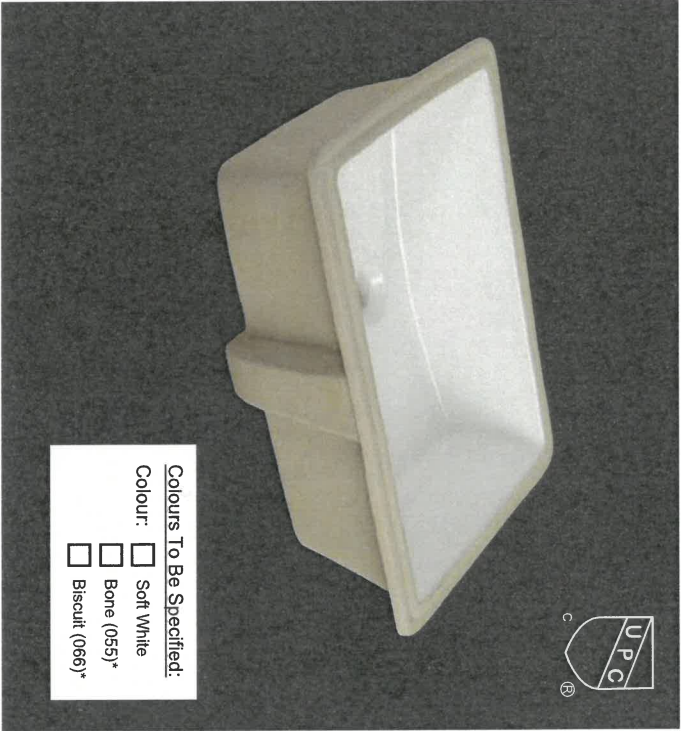

Notes:
Dimensions of fixtures are nominal and may vary within the range of tolerances established by ASME standard A112.19.2. These measurements are subject to change or cancellation. No responsibility is assumed for use of superseded or voided pages.

*Bone and Biscuit available through Direct Import (CIF) only.

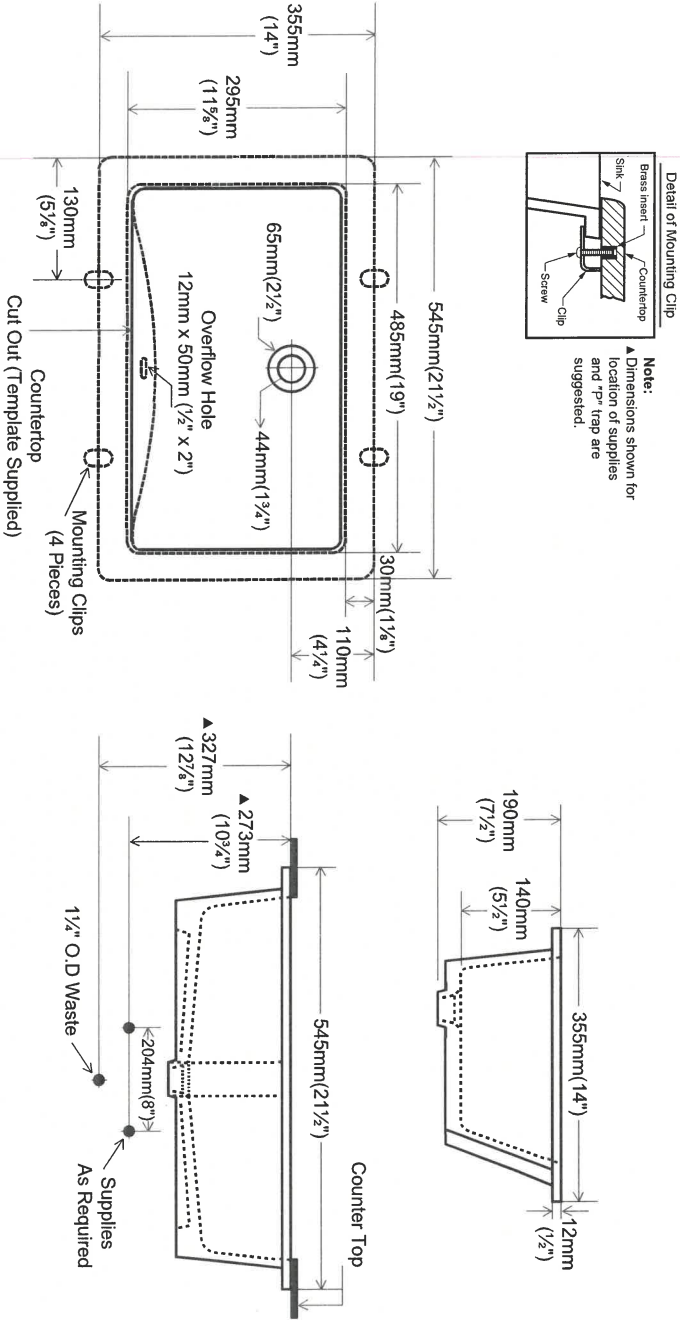

38-02 Wyndance



38-02 Wyndance



CALEDON CLUB

38-02 Wyndance

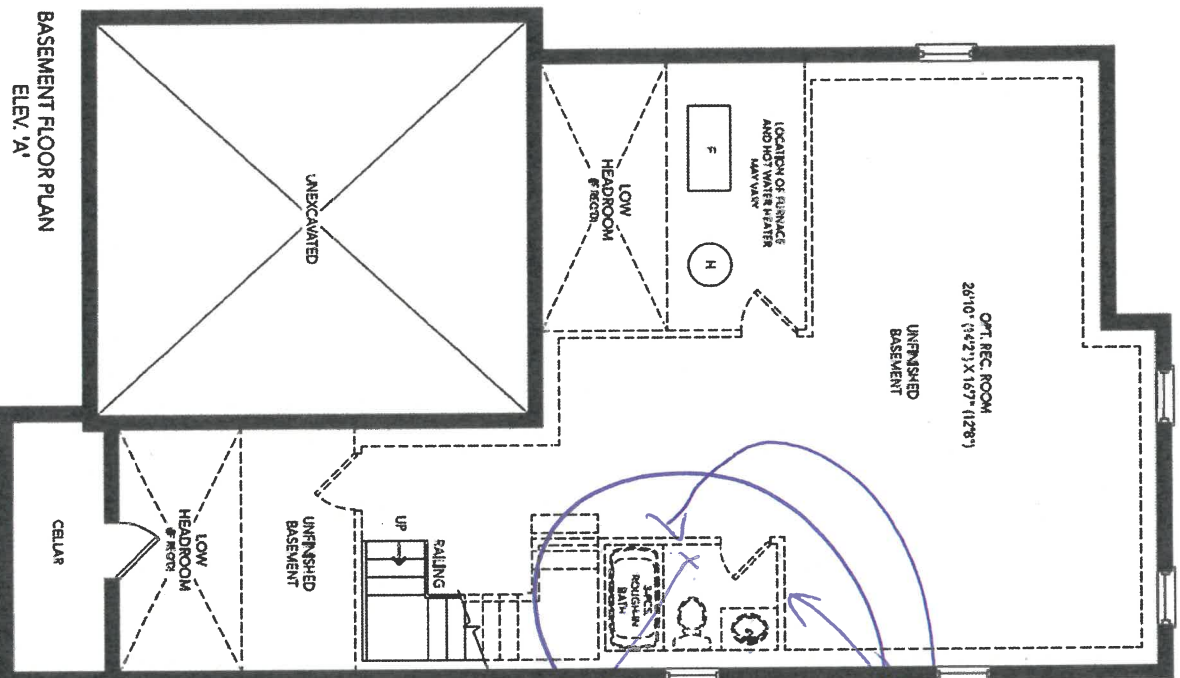

FINISHED
PARTIAL CON.
TOWEL BAR.

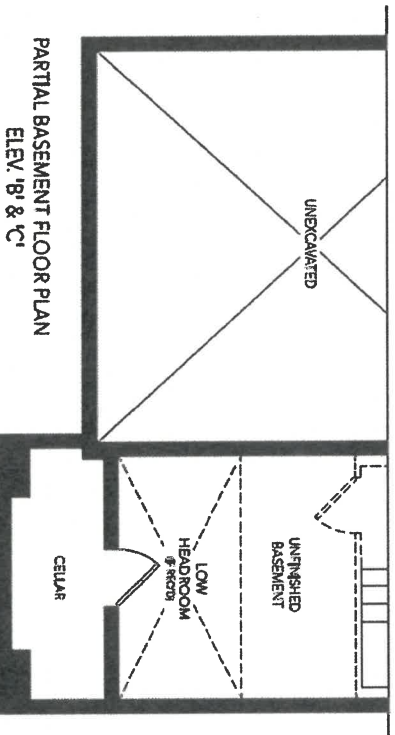

L.H.

L.H. USB

~~SALE PRICE~~
MASAGA BACH

Kitchen CANOPY "TRANSITIONAL STYLE"

Includes access to venting, can add mirror (like in décor) – ADDITIONAL \$950

See price book for details

TRANSITIONAL

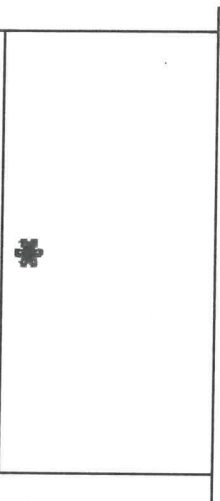

TransitionalHOOD3-900W-750h-550d

*Optional
FAN Insert
Available *

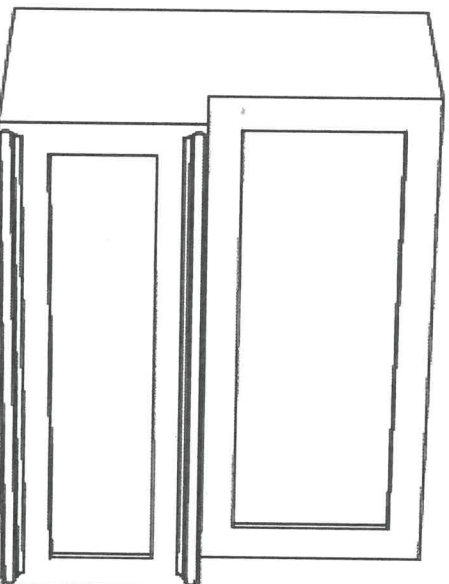
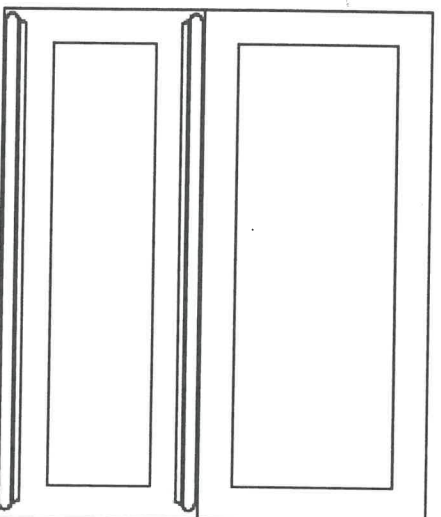

Caledon

65B

Supplied through New Image



Kitchen FAN INSERT AVG-276PS for optional Canopy

6 inch vent as per spec

*See price book for details *

AVG

AVC-276PS

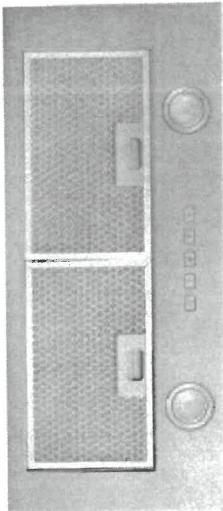

AVC-276PS
30" Insert hood - MSRP: \$469.00

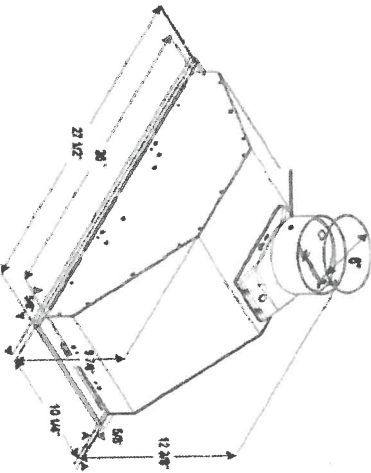

Selected Model	AVC-276PS
Model number	
Dimensions	22 1/2" (W) x 10 1/4" (D) x 12 3/8" (H)
Exterior Appearance	304
Stainless steel grade	
Features	Electronic push buttons 2 bulbs, 2W LED (bulbs included) 600 CFM, 3-speed Blower type Speed 1, 298 CFM Blower performance Speed 2, 457 CFM Speed 3, 600 CFM 2 aluminum micro hole filters (included) 6" Round (Top) Ducted
Filter type	
Duct transition	
Ducting	
Electrical Requirements	120V / 60Hz / 2.7 Amps
Warranty	Parts and labor, in-home service
1-year Warranty	

Installation

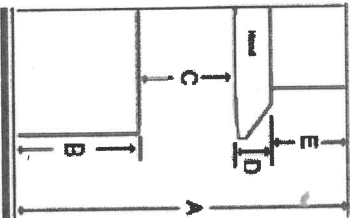

A	floor to ceiling height	variable
B	Floor to counter top height (standard)	36"
C	Recommended height between cooking surface and bottom of the hood	28" to 30"
D	hood height	12 3/8"
E	Cabinet height	N/A

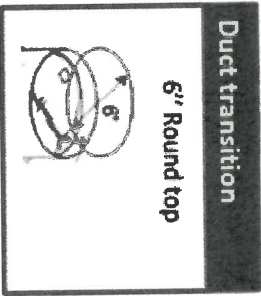

Supplied through New Image.

653



CLIENT NAME: ZANCOR HOMES
SHIP TO : CALEDON CLUB

JOB NUMBER

INSTALL DATE:

PH:
CELL :

PAGE
4 of 22

DATE SUBMITTED

12 Jul 2021

DRAFTED BY: FERNANDA

COMMENT

P/O #

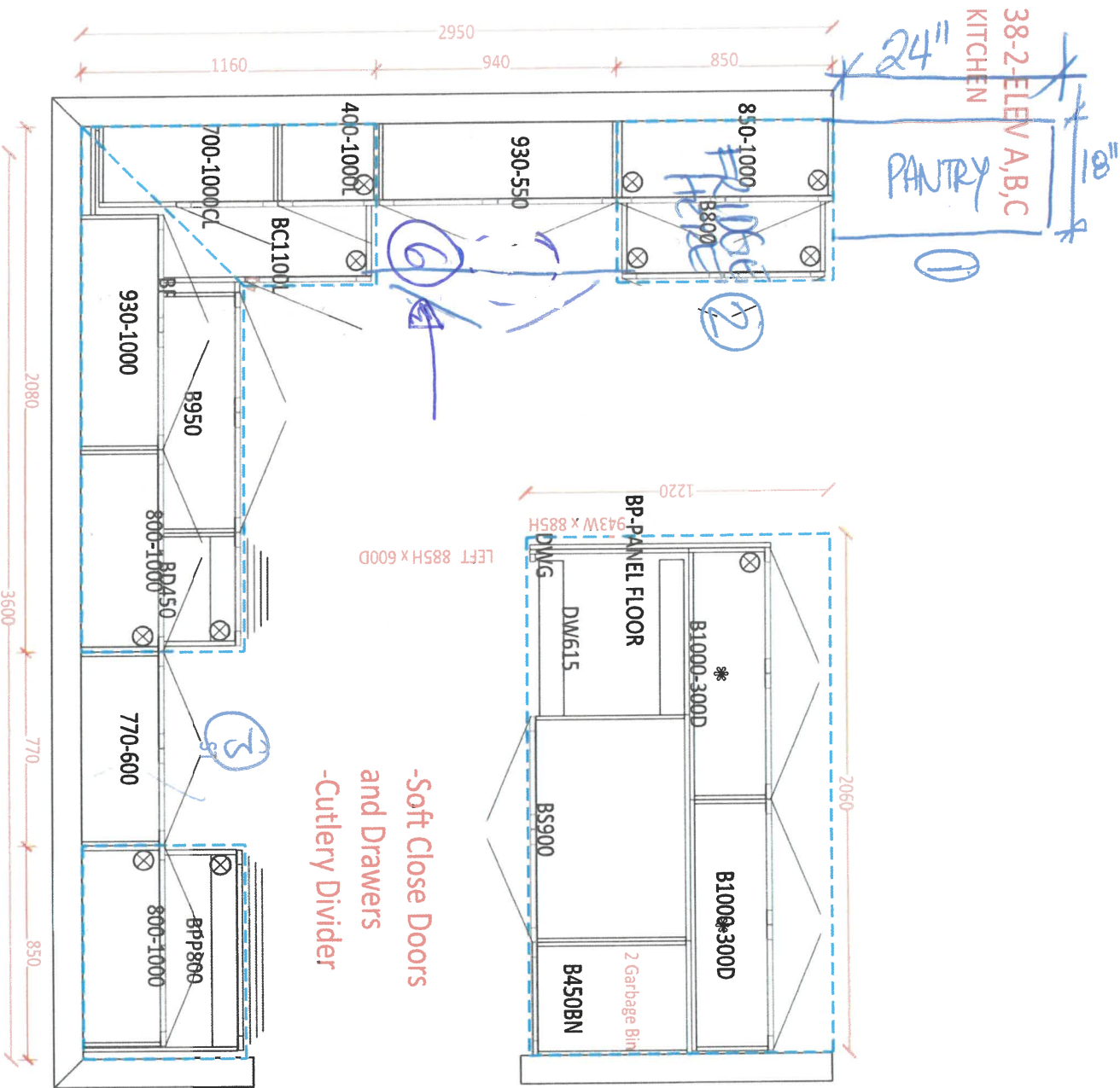

- 1 Pantry 18" D x 24" W
- 2 Fridge Enclosure *New location
- 3 ~~Island unit~~ Stone & feature chimney
- 4 Valance
- 5 Crown.

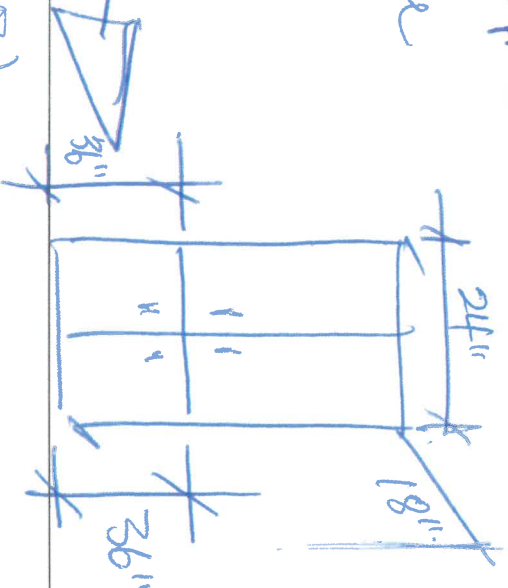

6 built in microwave with drawer below

2/10/2022

NN-ST663SC Countertop - Panasonic

Our website uses cookies and similar tools to improve its performance and enhance your user experience. By continuing to use this website without changing your settings you consent to their use. To find out more about the cookies we use or how to change your settings, please see our cookies policy. [Learn more.](#)

Panasonic	FRANCAIS						
	Overview	Features	Specs	Accessories	Where to Buy	Support	Search
		Consumer	Business	eStore	Support	About Us	Q

Countertop NN-ST663SC

Price † \$ 289.99

SHOP NOW

Microwave Ovens

Countertop

NNST663SC

NN-ST663SC
Mid-Size Genius®
Inverter® Stainless
Steel Microwave



† Price shown is the suggested retail price applicable to ALL PROVINCES EXCEPT FOR QUEBEC. Quebec consumers should refer to prices advertised by their local retailer or to prices advertised on the Panasonic eStore.

Inverter® Technology

Panasonic Inverter® Technology perfects the art of cooking with microwave ovens, delivering delicious flavor, excellent colour, and superb shape and texture in the foods you cook. The consistent delivery of microwave energy means delicate foods can simmer without the edges and surfaces overcooking. Foods have the look and taste of conventional-oven cooking without the wait!

Does not destroy food cells



< Inverter® Turbo Defrost



Linear Output Power for Even Cooking



L.H

65B

H.7

NNTK621S.

MWO TRIM KIT SPECIFICATION

Updated Mar. 21 '13

Trim kit #	Applied Model	Outside frame			Inside frame DIM		Inside flange to flange		Cabinet cut out DIM		Gap	Gap
		W	H	Thickness D	W	H	W	H	W	H	x	y
NNTK903S/WC/BC	NNC994, CD989	27"	19 9/16"	1"	25	14 3/8"	24 1/4"	14 5/16"	24 7/8"	18 1/16"	5/8"	1/4"
NNTK913S/WC/BC	NNC994, CD989	30"	19 9/16"	1"	25	14 3/8"	24 1/4"	14 5/16"	24 7/8"	18 1/16"	5/8"	1/4"
NNTK922S	900 series non-convex	27"	18 5/8"	3/4"	24 5/8"	13 5/8"	24 5/8"	13 5/8"	25 1/2"	17 3/8"	1/2"	1/4"
NNTK932S	900 series non-convex	30"	18 5/8"	3/4"	24 5/8"	13 5/8"	24 5/8"	13 5/8"	28 1/2"	17 3/8"	1/2"	1/4"
NNTK722S	700 series non-convex	27"	16 1/2"	3/4"	22 5/8"	11 3/8"	22 5/8"	11 3/8"	25 1/2"	15 5/16"	1/2"	1/4"
NNTK732S	700 series non-convex	30"	16 1/2"	3/4"	22 5/8"	11 3/8"	22 5/8"	11 3/8"	28 1/2"	15 5/16"	1/2"	1/4"
NNTK929	NNS9xx	27"	18 5/8"	1"	25 1/8"	13 7/16"	24 1/8"	13 3/8"	24 7/8"	17 3/8"	5/8"	1/4"
NNTK939	NNS9xx	30"	18 5/8"	1"	25 1/8"	13 7/16"	24 1/8"	13 3/8"	24 7/8"	17 3/8"	5/8"	1/4"
NNTK729	NNS7xx	27"	16 1/2"	3/16"	23 5/16"	11 5/16"	22 1/8"	11 1/4"	24 7/8"	15 5/16"	5/8"	1/4"
NNTK739	NNS7xx	30"	16 1/2"	3/16"	23 5/16"	11 5/16"	22 1/8"	11 1/4"	24 7/8"	15 5/16"	5/8"	1/4"
NNTK529SSA/W	NNS615, SA616, SN67	27"	16 1/2"	3/16"	21 1/2"	11 1/4"	20 3/8"	11 1/4"	22 11/16"	15 5/16"	5/8"	1/4"
NNTK623GSAP	NNGD693S	27"	16 1/2"	3/4"	21"	12 1/4"	21"	12 1/4"	25 1/2"	15 5/16"	5/16"	7/16"
NNTK621SSAP	NNST6x1; SD6x1	27"	16 1/2"	3/4"	21"	12 1/4"	21"	12 1/4"	25 1/2"	15 5/16"	7/16"	1/4"
NNTK510CS	NNCF770M, 781S	23 1/2"	16"	13/16"	20 13/16"	11 5/8"	20 13/16"	11 5/8"	22 1/4 +/- 1/8"	15 1/2 +/- 1/16"	7/32"	7/32"

Note: Trim kit NNTK909 / 909W for NNC980B / W
2012 models
2013 models

Note: NNTK903/913xC glossy finish w/o C is flat NNTK939BA (glossy) NNTK939BR (flat)

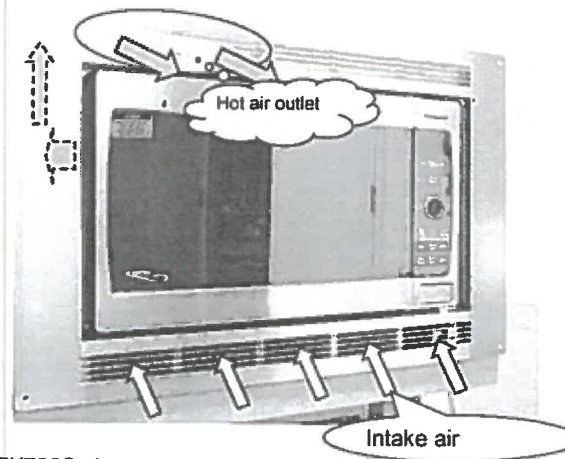
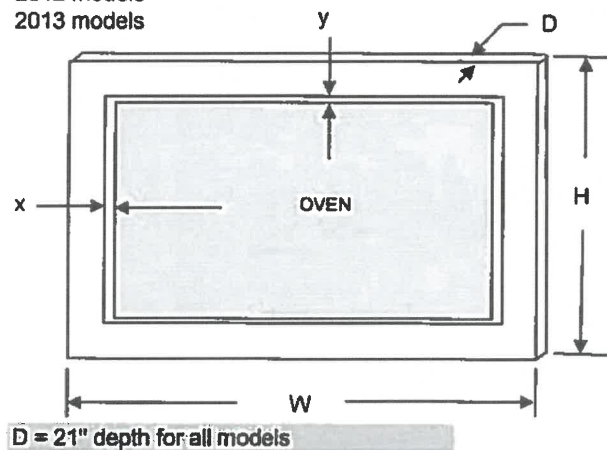

NNTK739S shown

658



CLIENT NAME: ZANCOR HOMES
SHIP TO : CALEDON CLUB

JOB NUMBER

INSTALL DATE:

PH:
CELL :

PAGE

6 of 22

DRAFTED BY: FERNANDA

COMMENT

P/O #

DATE SUBMITTED

12 Jul 2021

38-2-ELEV A,B,C
STD. VANITIES

POWDER

910

SHARED

1660

VS850

VS800

VS800

ENSUITE 2

910

MASTER ENSUITE

2600

VS850

VS1000

VS50L

VS1000

drawers

LAUNDRY ROOM

2420

840

770-760

800-760

770-760

OPT. UPPERS

BS800

OPT. BASEMENT BATH

900

VS850

caminate
pacifier
to wash

L.H

APPLIANCE ACKNOWLEDGEMENT

***CONTACT: Steve Miller - Appliance Canada (905) 660-2424 / smiller@appliancecanada.com**

- It is the Purchaser's responsibility to coordinate delivery, installation and hook up of appliances and to ensure they are installed as per Manufacturers specifications after closing.

STANDARD APPLIANCE OPENINGS provided by Zancor:

*Standard appliance openings are approximate and the minimum required. Sizes may vary due to onsite condition and/or when modifications have been made to the cabinetry.

- Fridge Opening 36" x 74"
- Stove Opening 30"
- Hood Fan Opening 30"
- Hood Fan & Vent 6" with Under Cabinet Hood
- Dishwasher Opening 24"

Accepts Standard
Openings **Initial

L.H

OPTIONAL UPGRADED APPLIANCES to be provided by Homeowner:

- ****Specs/information sheets are required and it is the responsibility of the homeowner to provide this to Zancor Homes by the due date that has been provided. If appliance specs are not submitted, Zancor Homes will not be responsible for any necessary requirements and the standard opening will be built.**

L.H

- **Upgraded Appliance Specs are DUE 2 WEEKS FROM SIGNED DATE OF COLOUR CHART (if not received during appointment)**

INITIAL

- ****Specs that require changes/modifications after this date will not be accepted****

- **NOTE: Any upgraded appliances are to be paid by the Purchaser, directly to the appliances company.**

- Additional charges to the Purchaser may apply for cabinetry, electrical and plumbing in order to accommodate the specs given by the homeowner.

FRIDGE UPGRADE

- ☐ Built-in
- ☐ Paneled **Panel to match required
- ☐ Integrated / Flush Inset
- ☒ Waterline

RANGE UPGRADE

*Larger hood fan CFM might be required, which need a larger vent

- ☐ 36" **Hood fan opening must be the same size or larger (8" vent might be required)
- ☐ 48" **Hood Fan opening must be the same size or larger (8" or 10" vent required)
- ☐ Gas Range **gas line and electrical required & sold separately
- ☐ Induction **electrical required & sold separately
- ☐ Cooktop (Apron Front) **Countertop Cut-out required & sold separately
- ☐ Cooktop (Drop-in) **countertop Cut-out required & sold separately

HOOD FAN & VENT UPGRADE

- ☐ 8 Inch **Required for 600 CFM
- ☐ 10 Inch
- ☒ Chimney Hood Fan **Vent must be centred
- ☐ Insert / Liner

WALL OVEN/MICRO UPGRADE

- ☐ Single Wall Oven **electrical required & sold separately
- ☐ Double Wall Oven **electrical required & sold separately
- ☐ Steam Oven **electrical required & sold separately
- ☐ Warming Drawer **electrical required & sold separately
- ☐ Over Then Range Microwave (OTR)
- ☐ Built-In Microwave **Trim Kit required **electrical required & sold separately

**Electrical required

DATE Jan 24/22

Caledon

65B

SITE

LOT

** Any upgrades checked in this appliance form must be accompanied with specs provided by the Purchaser.
**It is the responsibility of the trade to inform the Builder of any discrepancies with specs, sketches, extras and/or colour chart PRIOR to production/installation.

ZANCOR

221 North Rivermede Road, Concord, Ontario L4K 3N7 * T: (905) 738.7010 F: (905) 738.5948

221 North Rivermede Road, Concord, Ontario L4K 3N7 * T: (905) 738.7010 F: (905) 738.5948

Purchaser accepts and acknowledges that the Builder reserves the right to substitute materials with those of equal or better quality where the manufacture, scheduling or delivery of materials may directly impact the Builder's ability to meet its' contractual obligations under the Agreement of Purchase and Sale.

UPGRADES/EXTRAS: All upgrades and additional selections indicated on the colour chart must be accompanied by an upgrades/extras sheet (PES) and full payment otherwise the selection will be invalid. All colour charts and upgrades/extras will not proceed until verified and signed by an authorized signing officer at the Vendor's head office. **CHANGES WILL NOT BE PERMITTED UPON COMPLETION AND SUBMISSION OF THE COLOUR CHART.**

PORCELAIN & NATURAL STONES: Due to the properties of natural stones including but not limited to **marble, granite, quartz**, no two pieces are exactly the same. Variations in colour, tone, granularity (pitting, fissures) and pattern are to be expected, including various lighting may affect the overall finished look. Stone tops are sealed at time of installation and should never be cleaned with lemon oil or vinegar. Stones are porous materials, therefore any spilled substance require immediate attention. Stone countertops require regular seal re-application as part of home maintenance. Purchaser acknowledges colour and product variations as well as natural imperfections may exist with the selection of natural stone materials and shall not hold the Vendor liable for provision of same.

STONE COUNTERTOP JOINTS: Purchaser is aware that one joint will be at each corner and on either side of slide-in-range (if applicable). It will also be where the length of the counter top exceeds the length of a stone slab. Slabs are usually approximately 5'x 8'.

CERAMIC TILES: Due to manufacturing, shade (dye lots), product variations may exist that can affect the overall look of the finished product. Although every effort will be made to ensure the colours and materials selected are as close as possible to the samples, the purchaser acknowledges that the sample tiles supplied in the Design Centre may not be identical to the materials installed in the home.

STAIR STAINS: Due to the natural properties of wood, many variables can affect the overall look of the finished product. Factors including but not limited to wood type, knotting, graining, density, age, humidity, and air temperature can result in substantial variations in stain intensity. The purchaser accepts that although the Vendor will do their best to match stain the unfinished stairs as close as possible to the pre-finished floors, it is not possible to have an identical match and that there MAY be shade differences between the two products.

CABINETRY: Due to the natural properties of wood, slight variations apparent with cabinetry are to be expected. This includes but not limited to wood species, wood grain, colour, finish, product variations, and natural imperfections are all factors that may affect the overall look of the finished product. Such factors make exact colour matching impossible. The type and intensity of lighting in the areas of designated cabinetry placement may also highlight characteristics of cabinetry finish. All cabinets shall be finished with a white melamine interior box unless a finished interior is upgraded. Due to building specifications and/or on-site conditions, certain cabinetry upgrades may not be possible. The purchaser acknowledges that the Builder cannot guarantee the cabinetry finish or provision of certain upgrades and shall not hold the Builder liable for provision of same.

UPGRADES/EXTRAS: All upgrades and additional selections indicated on the colour chart must be accompanied by an upgrades/extras sheet (PES) and full payment otherwise the selection will be invalid. All colour charts and upgrades/extras will not proceed until verified and signed by an authorized signing officer at the Vendor's head office. **CHANGES WILL NOT BE PERMITTED UPON COMPLETION AND SUBMISSION OF THE COLOUR CHART.**

HARDWOOD / LAMINATE FLOORING: Due to the properties of wood and laminate, many variables can affect the overall look of the finished product. Variations include but not limited to wood type or laminate finish, colour/stain and wood grain are significant factors that make exact colour matching impossible. The purchaser acknowledges that the hardwood flooring is a pre-finished product in a controlled environment. Expansion, compression and cupping are characteristics of hardwood flooring once installed in the home. The purchaser acknowledges these may become apparent over time and despite the Builders' efforts to install the hardwood flooring materials in keeping with good workmanship, the Builder shall not be responsible nor held liable for minor variances of fluctuation in hardwood flooring materials.

HARDWOOD / LAMINATE WAIVER:

I/We understand hardwood flooring is classified as a porous material and as such not recommended by the Builder in certain areas. I/We understand there is a concern due to possible water and other substances being frequently splashed or spilled onto the floor and in contravention of Ontario Building Code Section 9.30.1.2(1).

"Finished flooring bathrooms, kitchens, public entrance halls, laundry & general storage areas shall consist of resilient flooring, felted-synthetic-fibre floor coverings, concrete, terrazzo, ceramic tile, mastic or other types of flooring providing similar degrees of water resistance.

I/We are prepared to assume full responsibility for any damage caused to the hardwood floor or subfloor due to moisture absorbercy in the mentioned areas, and agree to waive any claims against the Township of residence, TARIION and/or the Builder in relation to the matter. ****SEE COLOUR CHART FOR LOCATIONS****

DATE

SITE

LOT

CALEDON

221 North Rivermede Road, Concord, Ontario L4K 3N7 * T: (905) 738.7010 F: (905) 738.5948

HOME AUTOMATION (Cable, CAT5/6, Telephone)

INCLUDED IN SCHEDULE "A" IN AGREEMENT OF PURCHASE AND SALE:

- Rough-in for Central Vacuum system piped to garage
- Rough-in for Telephone (2) locations
- Rough-in for Cable TV (2) locations
- Rough-in for Cat-6 Network (3) locations

OPTION 1:

I/we the Homeowner(s) have chosen to contact the Home Automation Company to select the locations of the rough-ins for Cable, CAT5, Telephone as included in our Agreement of Purchase Sale.

I/we the Homeowner(s) will contact the trade within 4 weeks of the date of this release to select locations of the standard rough-ins review other optional products for purchase.

Trade: Artistic Smart Homes

Phone: (905) 850-9386

Location: 8601 Jane Street
Concord, Ont L4K 5N9

Should the homeowner not make these selections within the sufficient time provided, the rough-ins as mentioned above will be installed in locations at the Vendor's discretion.

L.H
Homeowner(s) Initial

OPTION 2:

I/we the Homeowner(s) acknowledge that if we do not contact the home automation company, I/we the Homeowner(s) have agreed to the Vendor locations for the standard rough-ins for Cable, CAT6, Telephone that are included in the Agreement of Purchase and Sale.

L.H
Homeowner(s) Initial

Jen 24/22
DATE

CALEDON

SITE

65B
LOT

BRICK/JOINT PATTERN INSTALLATION RELEASE FORM

FLOOR TILES *Brick installation is standard*

WALL TILES *Brick installation requires an additional charge and must be included on the extras if selected*

(Large tiles installation for floor and wall) – ¼ Brick

Please be advised it has come to our attention, that due to production, many of the over-sized and odd shaped, man-made tiles (i.e. porcelain & ceramic), have been found to have a slight bow in the tile. It is a standard occurrence with all suppliers and manufacturers.

It is therefore recommended, that if and when a purchaser requests to install one of these tiles in a brick-joint pattern, that it be installed on a ¼ brick pattern, to try to avoid lippage. Attached with this letter, you will find a layout of the ¼ brick installation that has been recommended.

LOCATIONS:

Floors

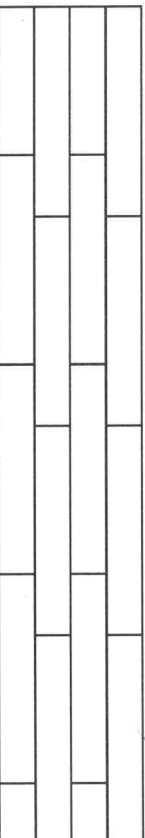

Please understand, even in using this ¼ brick installation, there may still be minimal lippage which cannot fully be eliminated.

Hence, when there is a request for brick-joint installation, Zancor Homes and their contractor, cannot be held responsible for this matter.

L.H.

Homeowner(s) Initial

(Small tile installation for walls) – ½ Brick

Purchaser requests to install small wall tiles on a backsplash or shower wall in a brick-joint pattern, that it be installed on a ½ brick pattern.

LOCATIONS:

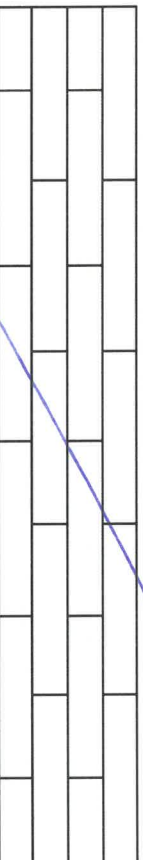

Homeowner(s) Initial

CALEDON

DATE

June 24/22

SITE

LOT

65B

Stone Countertop Edge Profiles

Where applicable as per site specifications

STANDARD EDGE FOR KITCHEN & VANITIES

Standard Countertop Edge in
Kitchen



Standard Countertop Edge in
Vanity

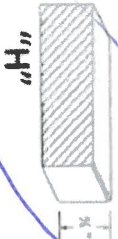

L.H.

Homeowner(s) Initial

OPTION (1) EDGE FOR KITCHEN & VANITIES \$250

Optional Edge in Kitchen

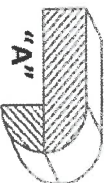
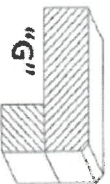
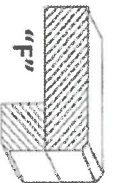
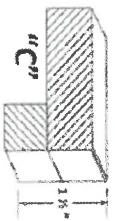

Optional Edge in Bathroom

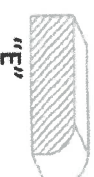
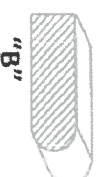
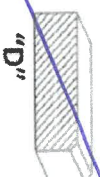

Homeowner(s) Initial

OPTION (2) EDGE FOR KITCHEN & VANITIES CUSTOM PRICING

Optional Edge for Kitchen

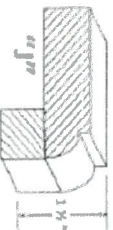
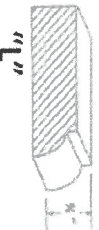

Optional Edge in Vanity

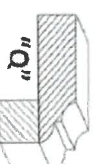
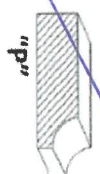

Homeowner(s) Initial

bSB

DATE

Jan 24/22

SITE

CALEDON

LOT