

CONSTRUCTION SUMMARY OF EXTRAS

Printed 2022-02-01 / 3:12 PM / Page 1 of 1

Site:
Lot:
Model:
Purchaser:
Phone:
Email:

CALEDON (B)
65B
WYNDANCE 38-02 (A) (4 BEDROOM)
LAKHVINDERJIT S. HUNDAL
PARMEET KAUR HUNDAL
647-972-5992
LAKHUNDAL@HOTMAIL.COM



DESCRIPTION		DATE SELECTED
BONUS PACKAGE: 3 PIECE STAINLESS STEEL APPLIANCES WITH WHITE WASHER & DRYER		INCLUDED IN APS
BONUS PACKAGE: STAINLESS STEEL HOOD FAN		INCLUDED IN APS
BONUS PACKAGE: AIR CONDITIONER		AS PER SCH E
	STRUCTURALS	
1	FINISHED 3 PCE BATHROOM IN BASEMENT **INCLUDES TOILET, VANITY, TUB, FLOOR TILES, WALL TILES, ELECTRICAL AND DRYWALL FROM BUILDERS STANDARD SAMPLES	DEC 13 2021
	COLOURS	
1	KITCHEN - CONTERTOP - UPGRADE 2	24-Jan-22
2	KITCHEN BACKSPLASH - STONE SLAB	24-Jan-22
3	N/A	24-Jan-22
4	N/A	24-Jan-22
5	KITCHEN - ADD PANTRY (2 DOOR) 24 INCHES WIDE BY 18 INCHES DEEP **SEE DRAWING	24-Jan-22
6	KITCHEN - ADD MATCHING VALANCE	24-Jan-22
7	KITCHEN - ADD CROWN MOULDING	24-Jan-22
8	NOTE - THERE WILL BE A BULKHEAD ACROSS ALL THE KITCHEN UPPER CABINETS INCLUDING PANTRY	24-Jan-22
9	KITCHEN - FRIDGE ENCLOSURE **SEE FRIDGE LOCATION	24-Jan-22
10	POWDER ROOM - CABINETS - UPGRADE 1	24-Jan-22
11	POWDER ROOM SINK - RECTANGLE UNDERMOUNT	24-Jan-22
12	LAUNDRY ROOM - ADD UPPER CABINETS	24-Jan-22
13	LAUNDRY ROOM - ADD COUNTERTOP ACROSS WASHER & DRYER	24-Jan-22
14	MASTER ENSUITE - CABINETS - UPGRADE 1	24-Jan-22
15	MASTER ENSUITE - COUNTERTOP - UPGRADE 1	24-Jan-22
16	MASTER ENSUITE - ADD DRAWERS IN BETWEEN SINKS (2 SMALL, 1 BIG)	24-Jan-22
17	MASTER ENSUITE - VANITY COMFORT HEIGHT	24-Jan-22
18	MOEN ACCESSORIES - TOILET PAPER HOLDER IN ALL BATHROOMS (X5)	24-Jan-22
19	MOEN ACCESSORIES - 18 INCH TOWEL BAR IN ALL BATHROOMS (EXCEPT MASTER) (X4)	24-Jan-22
20	MOEN ACCESSORIES - 24 INCH TOWEL BAR IN MASTER ENSUITE	24-Jan-22
21	ELECTRICAL - ADD (2) CAPPED LIGHTS IN KITCHEN ABOVE ISLAND ON SEPARATE SWITCH	24-Jan-22
22	ELECTRICAL - ADD PLUG ABOVE FIREPLACE FOR FUTURE TV **CABLE BESIDE IT	24-Jan-22
23	PLUMBING - SEE NEW LOCATION OF HOSE BIB IN GARAGE	24-Jan-22
24	WATERLINE TO FRIDGE	24-Jan-22
25	KITCHEN - UPGRADE KITCHEN HANDLES	24-Jan-22
26	MASTER ENSUITE SINKS - RECTANGLE UNDERMOUNT	24-Jan-22
27	KITCHEN SINK - BLANCO 401247	24-Jan-22
28	KITCHEN CANOPY - TRANSITIONAL STYLE **INCLUDES HOOD FAN (SEE SPEC)	24-Jan-22

ZANCOR HOMES COLOUR CHART

ENTRANCES				
Main Foyer - FLOORING		NEW BYZANTINE ASSURO 12 X 24 *BRICK		
Mudroom - FLOORING		NEW BYZANTINE ASSURO 12 X 24 *BRICK		
Side Hall - FLOORING		N/A		
Basement Foyer - FLOORING		N/A		
KITCHEN				
Kitchen - FLOORING		NEW BYZANTINE ASSURO 12 X 24 *BRICK		
Breakfast - FLOORING		NEW BYZANTINE ASSURO 12 X 24 *BRICK		
Kitchen - CABINETS		SIERRA PVC - WHITE		
Island - CABINETS		SIERRA PVC - WHITE		
Servery - CABINETS		N/A		
Kitchen - HANDLES/KNOBS		UPGRADE - H800BC128		
Kitchen - COUNTERTOP		EMERSTONE CARRARA WHITE (2)		
Island - COUNTERTOP		EMERSTONE CARRARA-WHITE (2) <i>PURE GREY CH</i>		
Kitchen - BACKSPLASH		SLAB - EMERSTONE CARRARA WHITE (2)		
Kitchen - SINK		UPGRADE - BIANCO 401247		
Kitchen - FAUCET		STANDARD		
GREAT ROOM / DINING / LIVING / DEN / OFFICE / BASEMENT				
Family / Great Room - FLOORING		HARDWOOD - VINTAGE RED OAK NSS SMOOTH 3-1/4" PEARL - JAVA (1)		
Main Hall - FLOORING		HARDWOOD - VINTAGE RED OAK NSS SMOOTH 3-1/4" PEARL - JAVA (1)		
Dining / Living Room - FLOORING		HARDWOOD - VINTAGE RED OAK NSS SMOOTH 3-1/4" PEARL - JAVA (1)		
Library / Den - FLOORING		N/A		
Basement Rec Room - FLOORING		N/A		
STAIRS				
Railing Details - PICKETS		STANDARD - METAL PICKETS - SINGLE COLLAR WITH ALT PLAIN		
Railing Details - POSTS		STANDARD - TURNED OAK 3-1/4"		
Railing Details - HANDRAIL		STANDARD - OVAL OAK 2-3/4"		
Stair Stain - MAIN STAIRS		STAIN STAIRS TO MATCH HARDWOOD AS CLOSE AS POSSIBLE		
Stair Stain - BASEMENT STAIRS (if applicable)		N/A		
Stair Stain - SERVICE STAIRS (if applicable)		N/A		
POWDER ROOM				
Powder Room - FLOORING		NEW BYZANTINE ASSURO 12 X 24 *BRICK		
Powder Room - CABINETS		MOSAIK MDF - STONE GREY (1)		
Powder Room - COUNTERTOP		BIANCO CARRARA		
Powder Room - SINK		UPGRADE - RECTANGLE UNDERMOUNT		
Powder Room - FAUCET		STANDARD		
2ND FLOOR				
Upper Hall - FLOORING		HARDWOOD - VINTAGE RED OAK NSS SMOOTH 3-1/4" PEARL - JAVA (1)		
Master Bedroom - FLOORING		CARPET - OPENING NIGHT - COLOUR T21 w/STANDARD UNDERPAD		
Bedroom 2 - FLOORING		CARPET - OPENING NIGHT - COLOUR T21 w/STANDARD UNDERPAD		
Bedroom 3 - FLOORING		CARPET - OPENING NIGHT - COLOUR T21 w/STANDARD UNDERPAD		
Bedroom 4 - FLOORING		CARPET - OPENING NIGHT - COLOUR T21 w/STANDARD UNDERPAD		
Bedroom 5 - FLOORING		N/A		
Master Ensuite - FLOORING		GENESIS LIGHT GREY 12 X 24 *BRICK		
Master Ensuite - SHOWER WALL		GENESIS LIGHT GREY 12 X 24 *STACKED VERTICAL		
Master Ensuite - SHOWER FLOOR		WHITE 2 X 2		
Master Ensuite - SHOWER JAMB		BIANCO CARRARA		
Master Ensuite - CABINETS		MOSAIK MDF - STONE GREY (1) **COMFORT HEIGHT		
Master Ensuite - HANDLES/KNOBS		H800BC		
Master Ensuite - COUNTERTOP		EMERSTONE WHITE GALAXY (1)		
Master Ensuite - SINK(s) <i>(X2) Rectangle</i>		STANDARD UNDERMOUNT	Master Ensuite - FAUCET(s)	STANDARD
FOR TRADE USE				
<i>Any upgrades in the colour chart must be accompanied with a PES. It is the responsibility of all Trades to inform the builder of any discrepancies on sketches, PES and/or colour charts <u>PRIOR</u> to installation.</i>		CALEDON 65B	<i>CH</i>	<i>CH</i>
		PAGE 1 OF 2	PURCHASER INITIALS	VENDOR APPROVAL

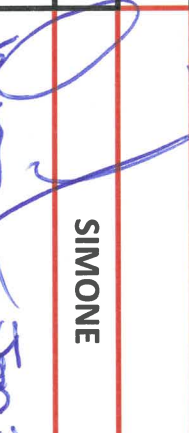
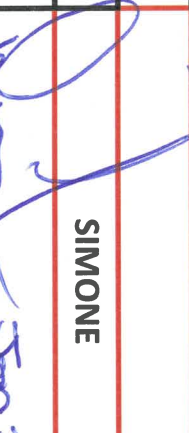
2ND FLOOR CONTINUED...									
Ensuite 2 Bath - FLOORING	LOFT WHITE 12 X 24 *BRICK								
Ensuite 2 Bath - TUB / SHOWER WALL	LOFT WHITE 12 X 24 *HORIZONTAL STACKED								
Ensuite 2 Bath - SHOWER FLOOR	N/A								
Ensuite 2 Bath - SHOWER JAMB	N/A								
Ensuite 2 Bath - CABINETS	SHAKER TUXEDO								
Ensuite 2 Bath - HANDLES/KNOB	H800BC								
Ensuite 2 Bath - COUNTERTOP	LAMINATE - 5009-60								
Ensuite 2 Bath - SINK(s)	STANDARD		Main Bath - FAUCET(s)		STANDARD				
Shared Bath- FLOORING	LOFT WHITE 12 X 24 *BRICK								
Shared Bath- TUB / SHOWER WALL	LOFT WHITE 12 X 24 *HORIZONTAL STACKED								
Shared Bath- SHOWER FLOOR	N/A								
Shared Bath- SHOWER JAMB	N/A								
Shared Bath- CABINETS	SIERRA PVC WHITE								
Shared Bath- HANDLES/KNOB	H800BC								
Shared Bath- COUNTERTOP	LAMINATE -4925K-07 1886K-07 LH								
Shared Bath- SINK(s)	STANDARD		Shared Bath - FAUCET(s)		STANDARD				
Basement Bath - FLOORING	LOFT WHITE 12 X 24 *BRICK								
Basement Bath - TUB / SHOWER WALL	LOFT WHITE 12 X 24 *HORIZONTAL STACKED								
Basement Bath - SHOWER FLOOR	N/A								
Basement Bath - SHOWER JAMB	N/A								
Basement Bath - CABINETS	SHAKER TUXEDO								
Basement Bath - HANDLES/KNOB	H800BC								
Basement Bath - COUNTERTOP	LAMINATE - 5009-60								
Basement Bath - SINK(s)	STANDARD		Ensuite Bath - FAUCET(s)		STANDARD				
LAUNDRY									
Laundry - FLOORING	NEW BYZANTINE ASSURO 12 X 24 *BRICK								
Laundry - CABINETS & UPPERS/LOWER	SIERRA PVC WHITE		Laundry - HANDLES/KNOB		H800BC				
Laundry - COUNTERTOP	LAMINATE - 1886K-07		Laundry - SINK		STANDARD				
Laundry - BACKSPLASH	N/A		Laundry - FAUCET		STANDARD				
TRIM / PAINT									
Casing/Baseboards			STANDARD						
Interior Doors			STANDARD						
Interior Door Hardware			STANDARD						
PAINT - Throughout			COOL WHITE						
FIREPLACE									
Location / Insert / Mantle			STANDARD						
ACCESSORIES									
Mirrors	YES		BATH ACCESSORIES		UPGRADE				
APPLIANCE REQUIREMENTS									
GAS LINE TO BBQ	STANDARD		ELECTRICAL for Built-in Oven		N/A				
GAS LINE & ELECTRICAL TO STOVE	DECLINED		ELECTRICAL for Built-in Micro		N/A				
GAS LINE & ELECTRICAL TO DRYER	N/A		ELECTRICAL for Cooktop		N/A				
HOOD FAN VENT SIZE	6 INCH		ELECTRICAL for Bar Fridge		N/A				
WATERLINE to Fridge	YES								
DISCLAIMER									
Any changes to the colour chart after signing are subject to a \$5000 administration fee plus costs						LH			
Purchaser has checked and acknowledged accuracy of colour and selections before signing.						LH			
Colours of all materials are as close as possible to Builders selection but not necessarily identical due to dye lot variances in manufacturing/manufacturers. Due to construction progress some items may have been pre-selected or installed. In this event the Vendor's selection must be accepted by the purchaser									
SITE / LOT:	CALEDON (B)				65B				
PURCHASER(S):	LAKHVINDERJIT S. HUNDAL								
PURCHASER(S):	PARMEET KAUR HUNDAL								
CONTACT:	647-972-5992				LAKHUNDAL@HOTMAIL.COM				
****FOR TRADE USE****									
Any upgrades in the colour chart must be accompanied with a PES. It is the responsibility of all Trades to inform the builder of any discrepancies on sketches, PES and/or colour charts PRIOR to installation.									
ZANCOR HOMES			PURCHASER SIGNATURE						
			PURCHASER SIGNATURE						
			DÉCOR CONSULTANT		SIMONE				
			Vendor APPROVAL						

COLLETTE

21½" RECTANGULAR UNDERMOUNT SINK

☐ 4220CIV

Undermount Sink

Product Specs:

- Vitreous china
- Front overflow hole
- Template and mounting hardware supplied

Overall Dimensions (W x D x H):

(OD): 545mm(21½") x 355mm(14") x 190mm(7½")
(ID): 485mm(19") x 295mm(11⅝") x 140mm(5½")

Compliance Certifications:

Meets or exceeds the following:

- IAPMO cUPC
- ASME A112.19.2 / CSA B45.1-2013

Shipping:

Cube	1.64
GW	25 lbs



Colours To Be Specified:	
Colour:	<input type="checkbox"/> Soft White
	<input type="checkbox"/> Bone (055)*
	<input type="checkbox"/> Biscuit (066)*

Notes:
Dimensions of fixtures are nominal and may vary within the range of tolerances established by ASME standard A112.19.2. These measurements are subject to change or cancellation. No responsibility is assumed for use of superseded or voided pages.

* Bone and Biscuit available through Direct Import (CIR) only.

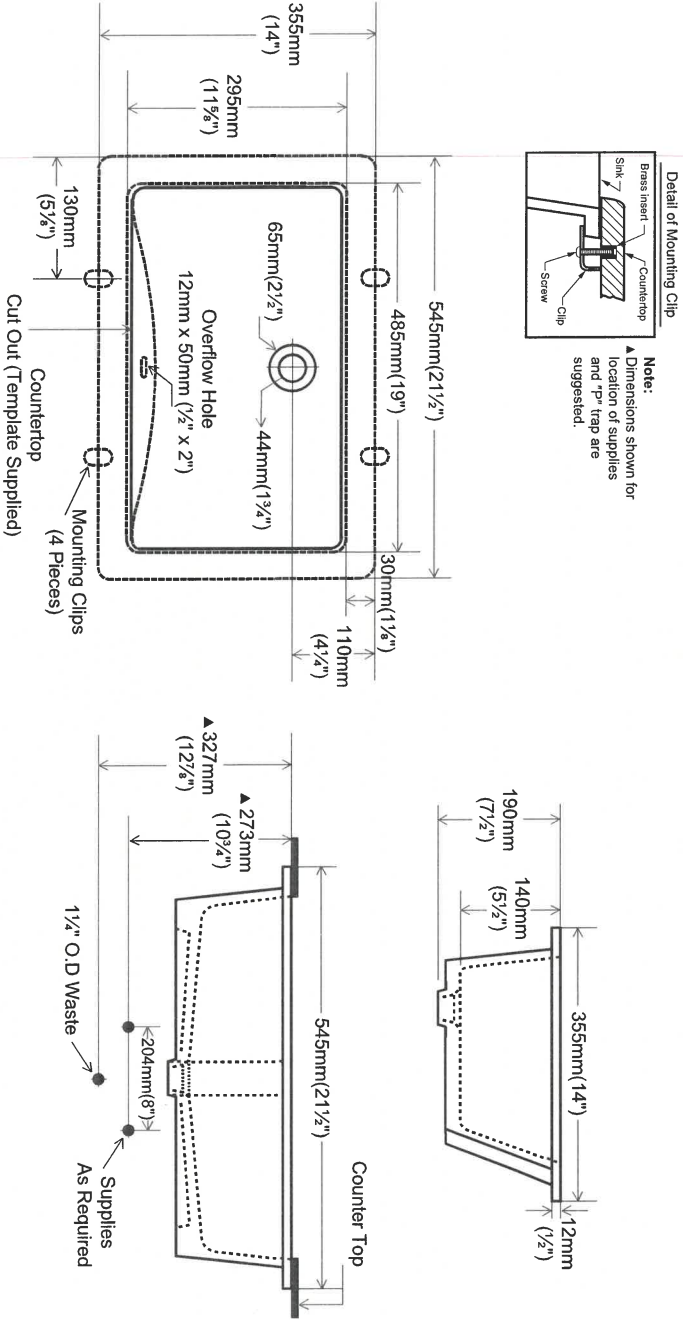

Contrac®

5970 Chedworth Way, Unit A, Mississauga, ON, Canada L5R 3V5

www.contrac.ca

Revised: January 2016

Master Ensuite

65B

CALEDON CLUB

38-02 Wyndance

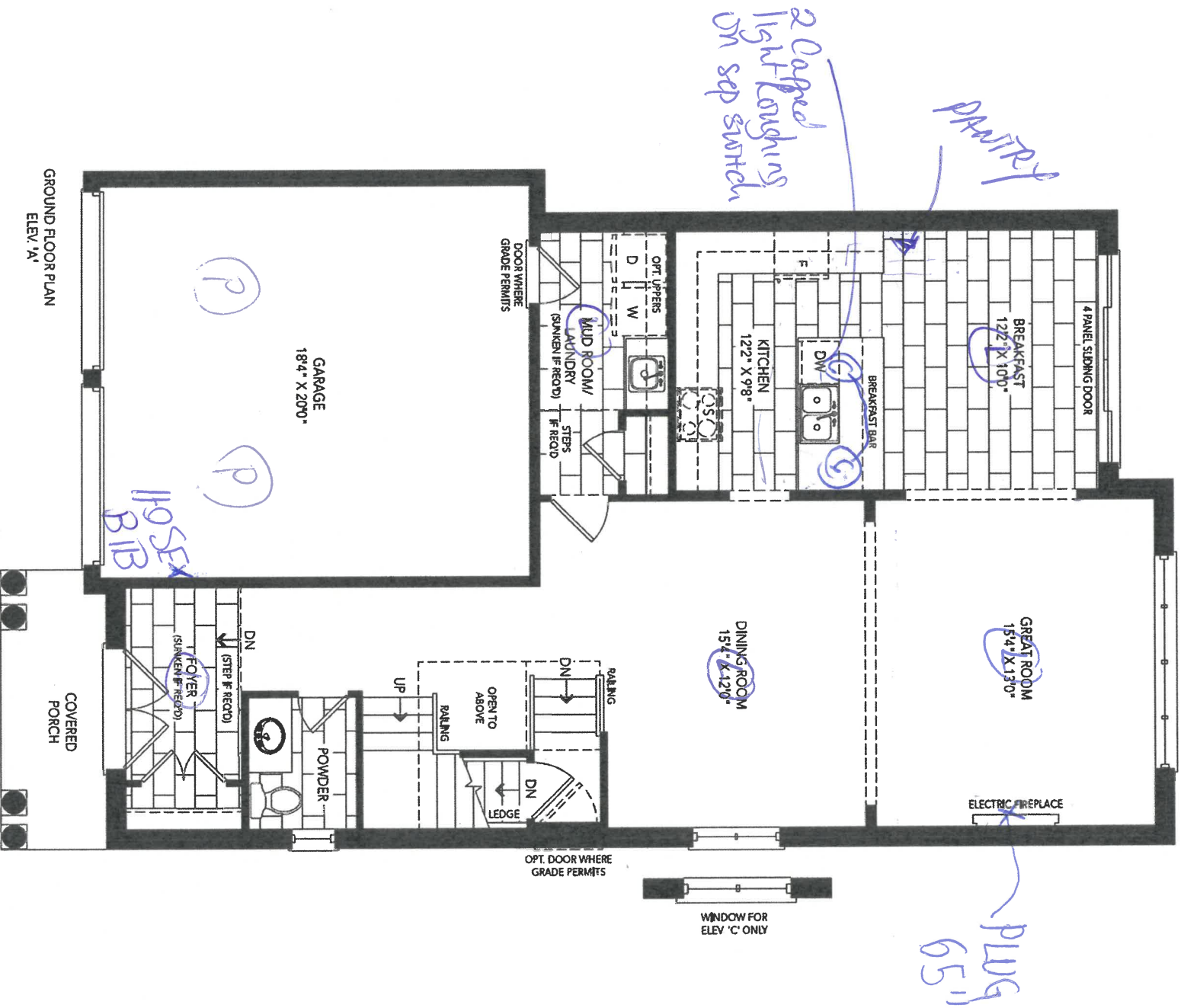

CALEDON CLUB

38-02 Wyndance

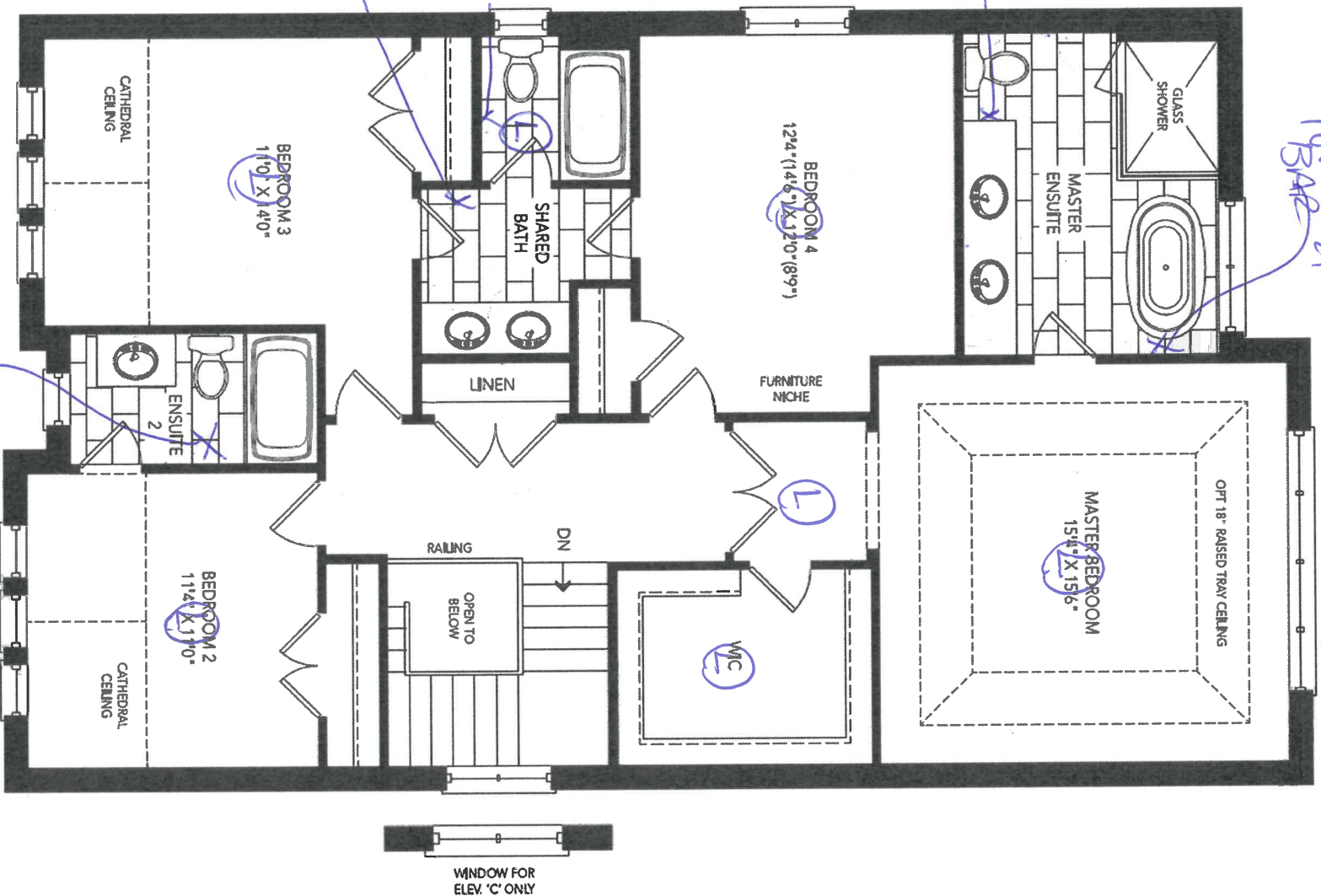

L.H

L.H

USB

CALEDON CLUB

38-02 Wyndance

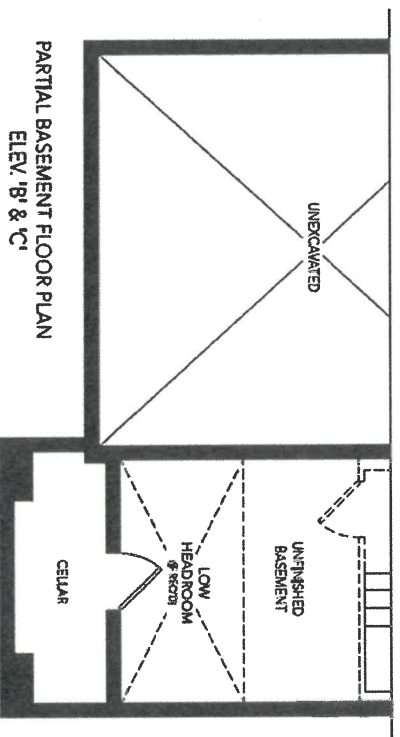
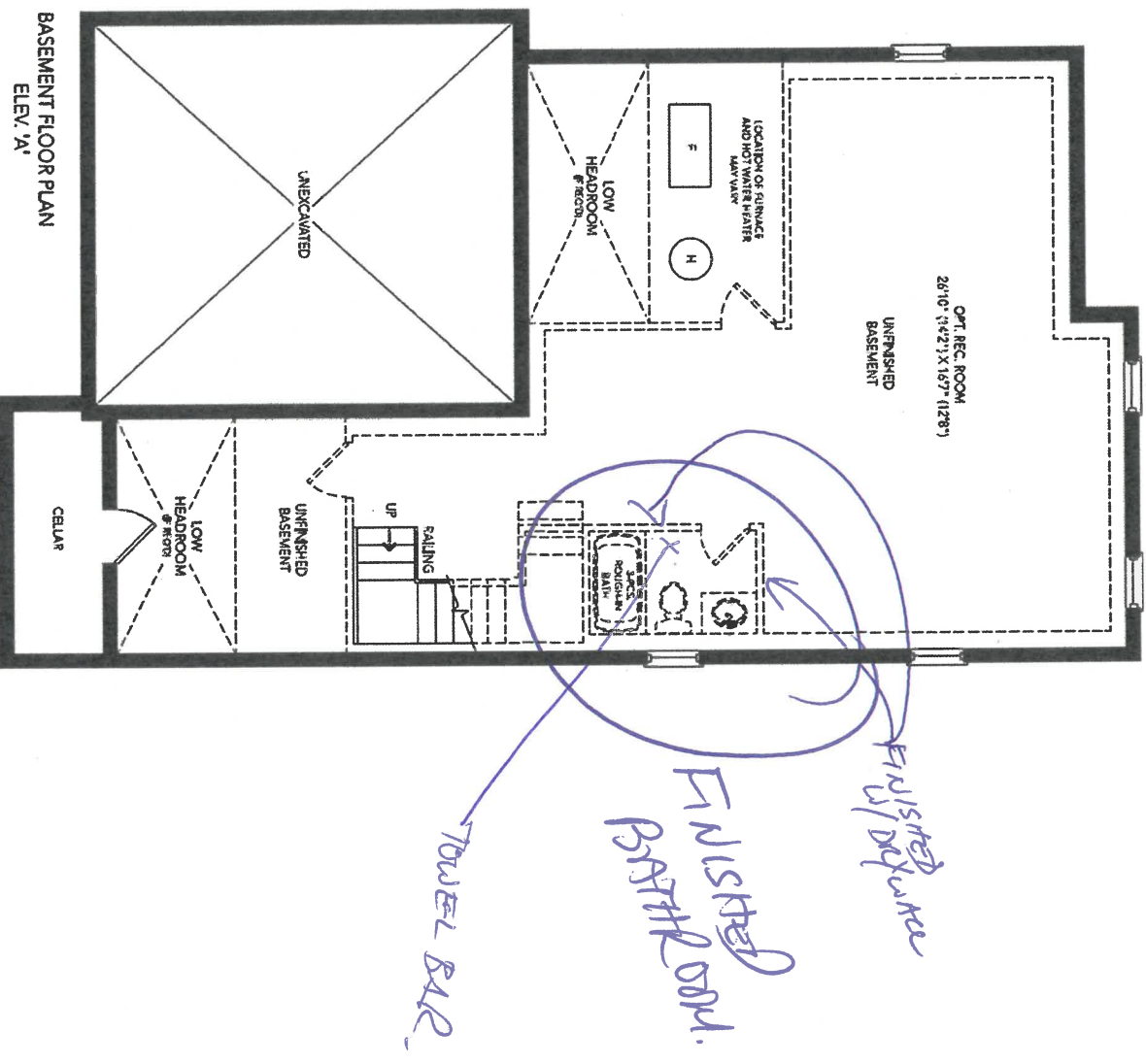

L.H.

L.H. USB

~~SHERRILL~~
WASAGA BACH

Kitchen CANOPY "TRANSITIONAL STYLE"

Includes access to venting, can add mirror (like in décor) – ADDITIONAL \$950

*See price book for details *

TRANSITIONAL

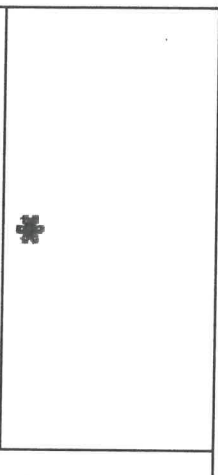

TransitionalHOOD3-900w-750h-550d

*Optional
FAN Insert
Available*

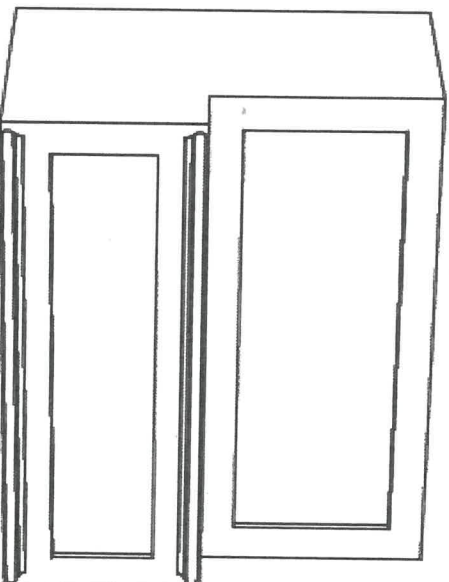
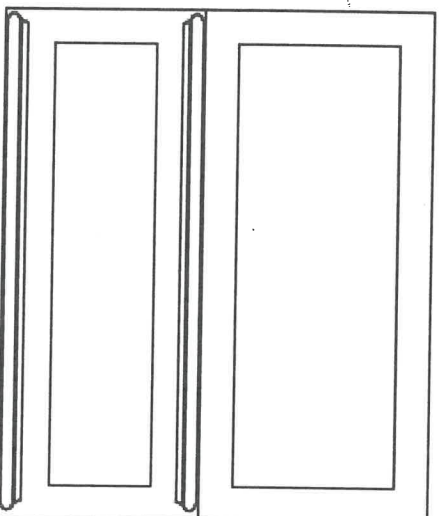

Caledon

65B

Supplied through New Image



WASAGA BEACH

Kitchen FAN INSERT AVG-276PS for optional Canopy
6 inch vent as per spec
*See price book for details *

AVG

AVC-276PS

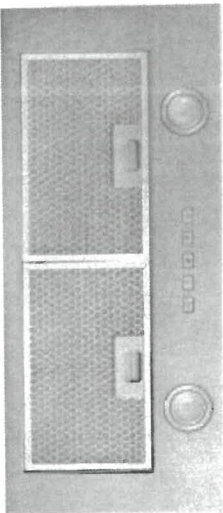

AVC-276PS
30" Insert hood - MSRP: \$469.00

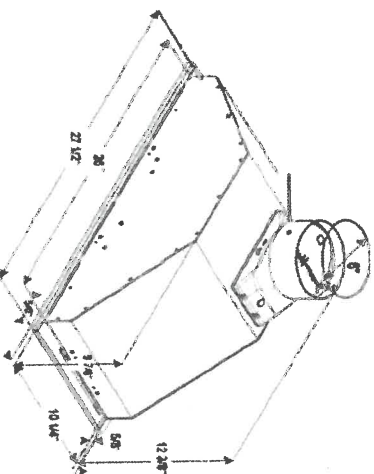

Selected Model	AVC-276PS
Model number	AVC-276PS
Dimensions	27 1/2" (W) x 10 1/4" (D) x 12 3/8" (H)
Exterior Appearance	304
Stainless steel grade	304
Control	Electronic push buttons
Lighting	2 bulbs, 20W LED (bulbs included)
Blower type	600 CFM, 3-speed
Blower performance	Speed 1, 296 CFM Speed 2, 457 CFM Speed 3, 600 CFM
Filter type	2 stainless micro mesh (included)
Duct transition	6" Round (Top)
Ducting	Ducted
Electrical Requirements	120V / 60HZ / 2.7 Amps
Warranty	1-year
1-year Warranty	Parts and labour, in-home service

Installation

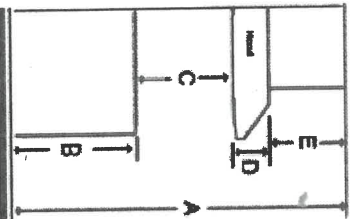

A	Floor to ceiling height	Variable
B	Floor to counter top height (standard)	36"
C	Recommended height between cooking surface and bottom of the hood	28" to 30"
D	Hood height	12 3/8"
E	Cabinet height	N/A

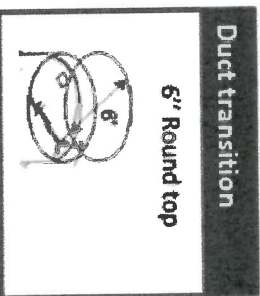

Supplied through New Image.

653B



CLIENT NAME: ZANCOR HOMES
SHIP TO: CALEDON CLUB

JOB NUMBER

INSTALL DATE:

PH:

CELL:

DRAFTED BY: FERNANDA

COMMENT

12 Jul 2021

PAGE
4 of 22

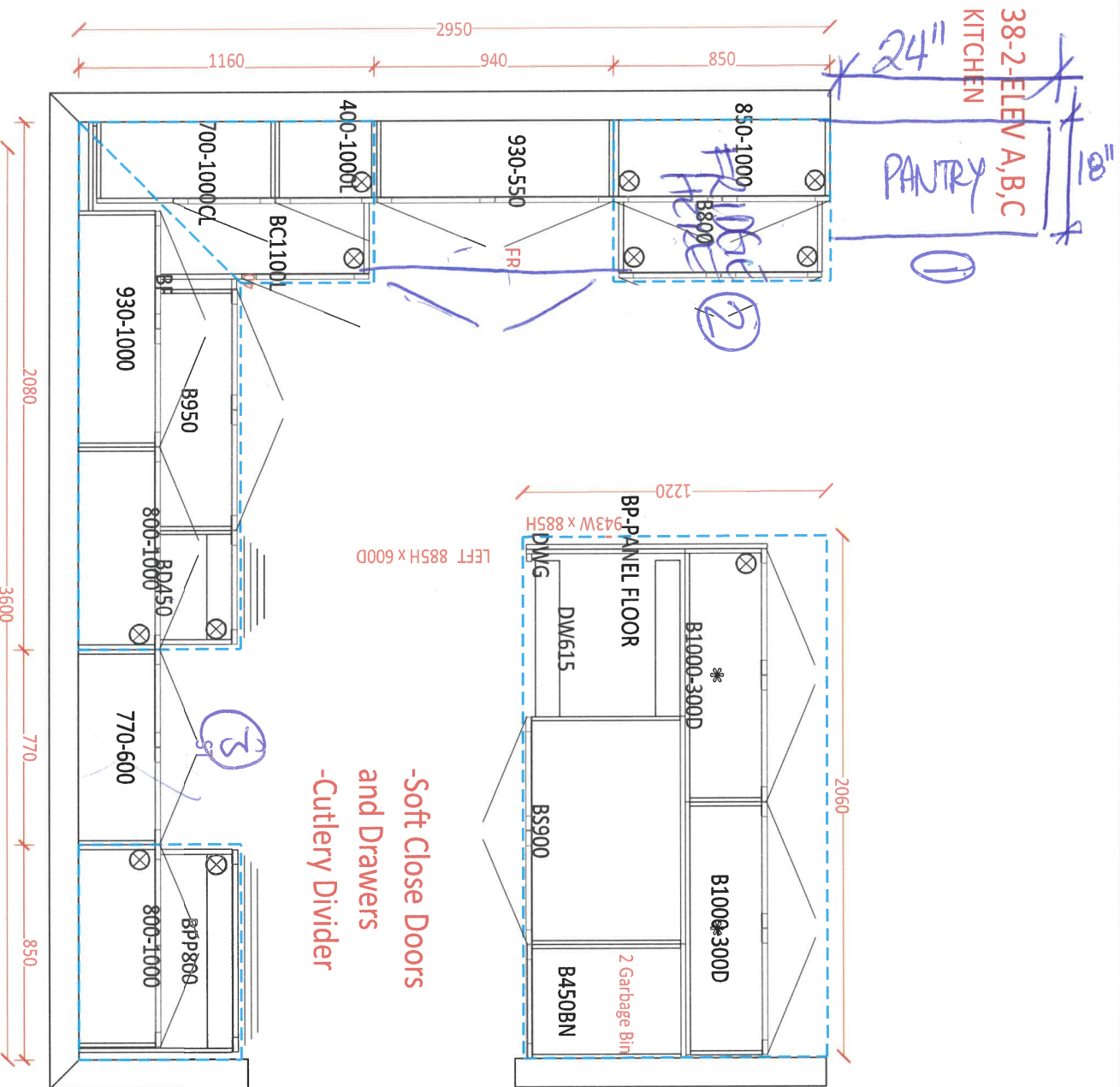

- ① Pantry 18" D x 24" W
 - ② Fridge Enclosure ~~new~~ location
 - ③ ~~Delete space above stove for future clearance~~
 - ④ Valance
 - ⑤ Crown.
-

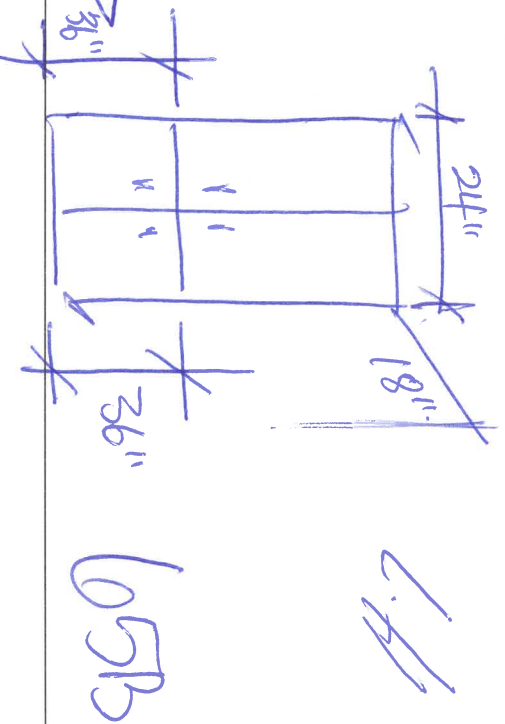



CLIENT NAME: ZANCOR HOMES
SHIP TO : CALEDON CLUB

JOB NUMBER

INSTALL DATE:

PH:
CELL :

DRAFTED BY: FERNANDA

COMMENT

PAGE
6 of 22

DATE SUBMITTED
12 Jul 2021

P/O #

38-2-ELEV A,B,C
STD. VANITIES

POWDER

910

SHARED

1660

VS850

VS800

VS800

ENSUITE 2

910

MASTER ENSUITE

2600

VS850

VS1000

VS50L

VS1000

Drawers

LAUNDRY ROOM

2420

840

770-760

800-760

770-760

OPT. UPPERS

BS800

OPT. BASEMENT BATH

900

VS850

convert
to a single
basement bath

L.H.

APPLIANCE ACKNOWLEDGEMENT

CONTACT: Steve Miller - Appliance Canada (905) 660-2424 / smiller@appliancecanada.com

It is the Purchaser's responsibility to coordinate delivery, installation and hook up of appliances and to ensure they are installed as per Manufacturers specifications after closing.

STANDARD APPLIANCE OPENINGS provided by Zancor:

*Standard appliance openings are approximate and the minimum required. Sizes may vary due to onsite condition and/or when modifications have been made to the cabinetry.

▶ Fridge Opening	36" x 74"	Accepts Standard Openings **Initial
▶ Stove Opening	30"	
▶ Hood Fan Opening	30"	
▶ Hood Fan & Vent	6" with Under Cabinet Hood	
▶ Dishwasher Opening	24"	

OPTIONAL UPGRADED APPLIANCES to be provided by Homeowner:

****Specs/Information sheets are required and it is the responsibility of the homeowner to provide this to Zancor Homes by the due date that has been provided. If appliance specs are not submitted, Zancor Homes will not be responsible for any necessary requirements and the standard opening will be built.**

L.H

▶ Upgraded Appliance Specs are DUE 2 WEEKS FROM SIGNED DATE OF COLOUR CHART (if not received during appointment)

INITIAL

▶ **Specs that require changes/modifications after this date will not be accepted***

▶ NOTE: Any upgraded appliances are to be paid by the Purchaser, directly to the appliances company.

▶ Additional charges to the Purchaser may apply for cabinetry, electrical and plumbing in order to accommodate the specs given by the homeowner.

FRIDGE UPGRADE

- ☐ Built-in
- ☐ Panelled **Panel to match required
- ☐ Integrated / Flush Inset
- ☒ Waterline

RANGE UPGRADE

*Larger hood fan CFM might be required, which need a larger vent

☐ 36" **Hood fan opening must be the same size or larger (8" vent might be required)

☐ 48" **Hood Fan opening must be the same size or larger (8" or 10" vent required)

- ☐ Gas Range **gas line and electrical required & sold separately
- ☐ Induction **electrical required & sold separately
- ☐ Cooktop (Apron Front) **Countertop Cut-out required & sold separately
- ☐ Cooktop (Drop-in) **countertop Cut-out required & sold separately

HOOD FAN & VENT UPGRADE

- ☐ 8 Inch **Required for 600 CFM
- ☐ 10 Inch

☒ Chimney Hood Fan **Vent must be centred

☐ Insert / Liner

WALL OVEN/MICRO UPGRADE

- ☐ Single Wall Oven **electrical required & sold separately
- ☐ Double Wall Oven **electrical required & sold separately
- ☐ Steam Oven **electrical required & sold separately
- ☐ Warming Drawer **electrical required & sold separately
- ☐ Over Then Range Microwave (OTR)
- ☐ Built-In Microwave **Trim Kit required **electrical required & sold separately

**Electrical required

DATE Jan 24/22

CALEDON

SITE

65B

LOT

** Any upgrades checked in this appliance form must be accompanied with specs provided by the Purchaser.
**It is the responsibility of the trade to inform the Builder of any discrepancies with specs, sketches, extras and/or colour chart PRIOR to production/installation.

ZANCOR

221 North Rivermede Road, Concord, Ontario L4K 3N7 * T: (905) 738.7010 F: (905) 738.5948

221 North Rivermede Road, Concord, Ontario L4K 3N7 * T: (905) 738.7010 F: (905) 738.5948

Purchaser accepts and acknowledges that the Builder reserves the right to substitute materials with those of equal or better quality where the manufacture, scheduling or delivery of materials may directly impact the Builder's ability to meet its' contractual obligations under the Agreement of Purchase and Sale.

UPGRADES/EXTRAS: All upgrades and additional selections indicated on the colour chart must be accompanied by an upgrades/extras sheet (PES) and full payment otherwise the selection will be invalid. All colour charts and upgrades/extras will not proceed until verified and signed by an authorized signing officer at the Vendor's head office. **CHANGES WILL NOT BE PERMITTED UPON COMPLETION AND SUBMISSION OF THE COLOUR CHART.**

PORCELAIN & NATURAL STONES: Due to the properties of natural stones including but not limited to **marble, granite, quartz**, no two pieces are exactly the same. Variations in colour, tone, granularity (pitting, fissures) and pattern are to be expected, including various lighting may affect the overall finished look. Stone tops are sealed at time of installation and should never be cleaned with lemon oil or vinegar. Stones are porous materials, therefore any spilled substance require immediate attention. Stone countertops require regular seal re-application as part of home maintenance. Purchaser acknowledges colour and product variations as well as natural imperfections may exist with the selection of natural stone materials and shall not hold the Vendor liable for provision of same.

STONE COUNTERTOP JOINTS: Purchaser is aware that one joint will be at each corner and on either side of slide-in-range (if applicable). It will also be where the length of the counter top exceeds the length of a stone slab. Slabs are usually approximately 5'x 8'.

CERAMIC TILES: Due to manufacturing, shade (dye lots) product variations may exist that can affect the overall look of the finished product. Although every effort will be made to ensure the colours and materials selected are as close as possible to the samples, the purchaser acknowledges that the sample tiles supplied in the Design Centre may not be identical to the materials installed in the home.

STAIR STAINS: Due to the natural properties of wood, many variables can affect the overall look of the finished product. Factors including but not limited to wood type, knotting, graining, density, age, humidity, and air temperature can result in substantial variations in stain intensity. The purchaser accepts that although the Vendor will do their best to match stain the unfinished stairs as close as possible to the pre-finished floors, it is not possible to have an identical match and that there MAY be shade differences between the two products.

CABINETRY: Due to the natural properties of wood, slight variations apparent with cabinetry are to be expected. This includes but not limited to wood species, wood grain, colour, finish, product variations, and natural imperfections are all factors that may affect the overall look of the finished product. Such factors make exact colour matching impossible. The type and intensity of lighting in the areas of designated cabinetry placement may also highlight characteristics of cabinetry finish. All cabinets shall be finished with a white melamine interior box unless a finished interior is upgraded. Due to building specifications and/or on-site conditions, certain cabinetry upgrades may not be possible. The purchaser acknowledges that the Builder cannot guarantee the cabinetry finish or provision of certain upgrades and shall not hold the Builder liable for provision of same.

UPGRADES/EXTRAS: All upgrades and additional selections indicated on the colour chart must be accompanied by an upgrades/extras sheet (PES) and full payment otherwise the selection will be invalid. All colour charts and upgrades/extras will not proceed until verified and signed by an authorized signing officer at the Vendor's head office. **CHANGES WILL NOT BE PERMITTED UPON COMPLETION AND SUBMISSION OF THE COLOUR CHART.**

HARDWOOD / LAMINATE FLOORING: Due to the properties of wood and laminate, many variables can affect the overall look of the finished product. Variations include but not limited to wood type or laminate finish, colour/stain and wood grain are significant factors that make exact colour matching impossible. The purchaser acknowledges that the hardwood flooring is a pre-finished product in a controlled environment. Expansion, compression and cupping are characteristics of hardwood flooring once installed in the home. The purchaser acknowledges these may become apparent over time and despite the Builders' efforts to install the hardwood flooring materials in keeping with good workmanship, the Builder shall not be responsible nor held liable for minor variances of fluctuation in hardwood flooring materials.

HARDWOOD / LAMINATE WAIVER:

I/We understand hardwood flooring is classified as a porous material and as such not recommended by the Builder in certain areas. I/We understand there is a concern due to possible water and other substances being frequently splashed or spilled onto the floor and in contravention of Ontario Building Code Section 9.30.1.2(1).

"Finished flooring bathrooms, kitchens, public entrance halls, laundry & general storage areas shall consist of resilient flooring, felted-synthetic-fibre floor coverings, concrete, terrazzo, ceramic tile, mastic or other types of flooring providing similar degrees of water resistance.

I/We are prepared to assume full responsibility for any damage caused to the hardwood floor or subfloor due to moisture absorbency in the mentioned areas, and agree to waive any claims against the Township of residence, TARIION and/or the Builder in relation to the matter. ****SEE COLOUR CHART FOR LOCATIONS****

DATE Jan 24/12 SITE CALEDON LOT 65B

221 North Rivermede Road, Concord, Ontario L4K 3N7 * T: (905) 738.7010 F: (905) 738.5948

HOME AUTOMATION (Cable, CAT5/6, Telephone)

INCLUDED IN SCHEDULE "A" IN AGREEMENT OF PURCHASE AND SALE:

- Rough-in for Central Vacuum system piped to garage
- Rough-in for Telephone (2) locations
- Rough-in for Cable TV (2) locations
- Rough-in for Cat-6 Network (3) locations

OPTION 1:

I/we the Homeowner(s) have chosen to contact the Home Automation Company to select the locations of the rough-ins for Cable, CAT5, Telephone as included in our Agreement of Purchase Sale.

I/we the Homeowner(s) will contact the trade within 4 weeks of the date of this release to select locations of the standard rough-ins review other optional products for purchase.

Trade: Artistic Smart Homes

Phone: (905) 850-9386

Location: 8601 Jane Street
Concord, Ont L4K 5N9

Should the homeowner not make these selections within the sufficient time provided, the rough-ins as mentioned above will be installed in locations at the Vendor's discretion.

L.H
Homeowner(s) Initial

OPTION 2:

I/we the Homeowner(s) acknowledge that if we do not contact the home automation company, I/we the Homeowner(s) have agreed to the Vendor locations for the standard rough-ins for Cable, CAT6, Telephone that are included in the Agreement of Purchase and Sale.

L.H
Homeowner(s) Initial

Jan 24/22
DATE

CALEDON

SITE

65B
LOT

BRICK/JOINT PATTERN INSTALLATION RELEASE FORM

FLOOR TILES *Brick installation is standard*

WALL TILES *Brick installation requires an additional charge and must be included on the extras if selected*

(Large tiles installation for floor and wall) – ¼ Brick

Please be advised it has come to our attention, that due to production, many of the over-sized and odd shaped, man-made tiles (i.e. porcelain & ceramic), have been found to have a slight bow in the tile. It is a standard occurrence with all suppliers and manufacturers.

It is therefore recommended, that if and when a purchaser requests to install one of these tiles in a brick-joint pattern, that it be installed so as to avoid lippage. Attached with this letter, you will find a layout of the ¼ brick installation that has been recommended.

LOCATIONS:

FLOOR

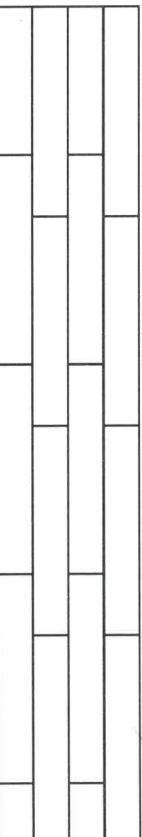

Please understand, even in using this ¼ brick installation, there may still be minimal lippage which cannot fully be eliminated.

Hence, when there is a request for brick-joint installation, Zancor Homes and their contractor, cannot be held responsible for this matter.

L.H.

Homeowner(s) Initial

(Small tile installation for walls) – ½ Brick

Purchaser requests to install small wall tiles on a backsplash or shower wall in a brick-joint pattern, that it be installed on a ½ brick pattern.

LOCATIONS:

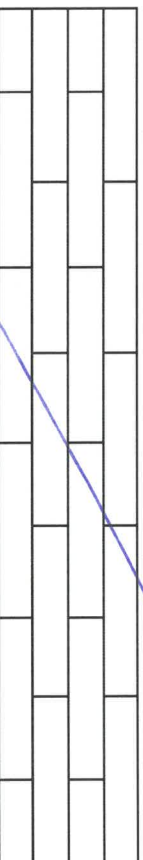

Homeowner(s) Initial

CALEDON

DATE

SITE

LOT

Stone Countertop Edge Profiles

** Where applicable as per site specifications **

STANDARD EDGE FOR KITCHEN & VANITIES

Standard Countertop Edge in
Kitchen

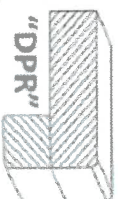

Standard Countertop Edge in
Vanity



L.H.

Homeowner(s) Initial

OPTION (1) EDGE FOR KITCHEN & VANITIES \$250

Optional Edge in Kitchen

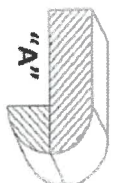
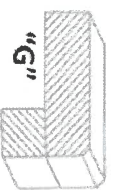
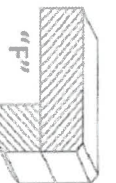
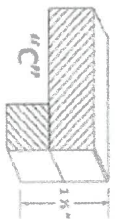

Optional Edge in Bathroom

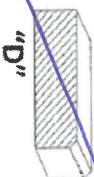

Homeowner(s) Initial

OPTION (2) EDGE FOR KITCHEN & VANITIES CUSTOM PRICING

Optional Edge for Kitchen

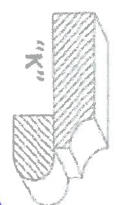
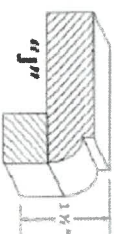
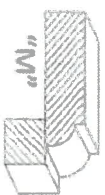
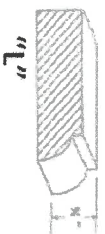

Optional Edge in Vanity

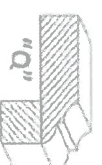
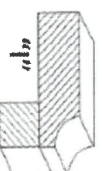
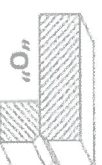
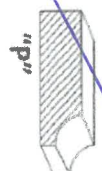

Homeowner(s) Initial

DATE

Jan 24/22

SITE

CALEDON

LOT

65B