

Simone Walker

From: Steve Miller <smiller@appliancescanada.com>
Sent: August 31, 2021 9:35 AM
To: Amar Wadhawan; Simone Walker
Subject: Re: Lot--14 Brampton Country Trails - Interior Selections
Attachments: Xerox_Scan_005.pdf

Hi Simone,

Specs are attached (In case you don't already have them)

Thanks,

Steve.

From: Amar Wadhawan <amar_wadhawan@hotmail.com>
Sent: Sunday, August 29, 2021 10:41 AM
To: Zancor Homes <simone@zancorhomes.com>; Steve Miller <smiller@appliancescanada.com>
Subject: Re: Lot--14 Brampton Country Trails - Interior Selections

Caution! This message was sent from outside your organization.

Good Morning Simone,

Just checking, were you able to get the measurements from Steve for the fridge. As I didn't see any email from him regarding the same.

Steve please send me also the same if you have done or haven't done. Please advise.

Thank you
Amar Wadhawan
647-205-9999

Good Morning Steve,

Can you please provide measurements to Simone for the Jennair Appliances-

Fridge With Dispenser (Stainless Steel Outside Doors) **JS48PPDUDE 48"**

Stove-36"

Range Hood 36" and Dishwasher are having standard measurements I believe.

Thank you
Amar Wadhawan

14 Brampton
Specs

647-205-9999

Sent from my iPhone

On Jul 12, 2021, at 8:34 AM, Simone Walker <simone@zancorhomes.com> wrote:

Hi Amar,

Please send me your specs once you have finalized with Steve Miller.

Thank you,
Simone

From: Amar Wadhawan <amar_wadhawan@hotmail.com>
Sent: July 10, 2021 12:21 PM
To: Simone Walker <simone@zancorhomes.com>
Cc: Info <info@zancorhomes.com>
Subject: Re: Lot--14 Brampton Country Trails - Interior Selections

Hi Simone,

Can we go for stove also with the 48" width or??

Sorry at that time we never go appointment due to COVID and now there are lot of options to select...

Thank you
Amar Wadhawan

Sent from my iPhone

On Jul 6, 2021, at 7:32 PM, Amar Wadhawan
<amar_wadhawan@hotmail.com> wrote:

Thanks for your quick reply...We have an appointment on 10th July with Steve@ Appliance Canada. We are considering 48" fridge but if you allow me I can give you exact dimensions required for the same.

Best Regards
Amar Wadhawan
Ph: 647-205-9999

From: Simone Walker
Sent: July 6, 2021 7:09 PM
To: Amar Wadhawan

Cc: [Info](#)

Subject: RE: Lot--14 Brampton Country Trails - Interior Selections

Hi Amar,

It seems that there is most likely going to be a delay. If this is the case, you will receive notice in writing from the office.

Also, if you change the fridge, please let me know right away.

Thank you,
Simone

JENN-AIR® DETAILED PLANNING DIMENSIONS

48" SIDE-BY-SIDE REFRIGERATORS WITH ICE & WATER DISPENSER

JS48PPDUDE – 48^{3⁄8}" x 83^{3⁄8}" x 27^{3⁄4}" (with handles)
JS48SSDUDE – 48^{3⁄8}" x 83^{3⁄8}" x 27^{1⁄8}" (with handles)

PRODUCT DIMENSIONS

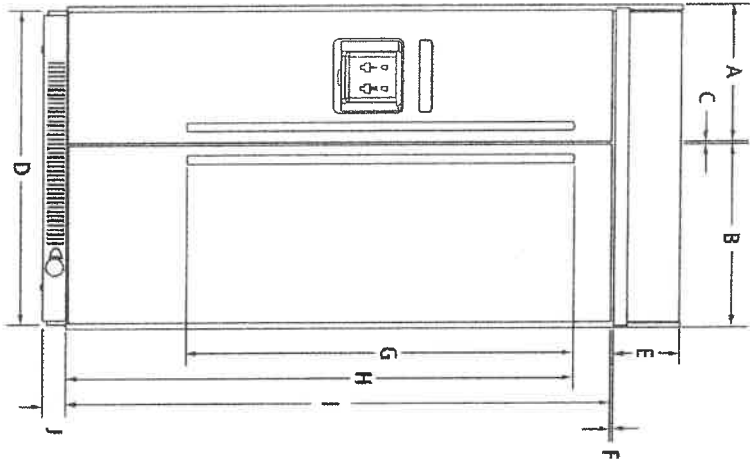

FRONT VIEW

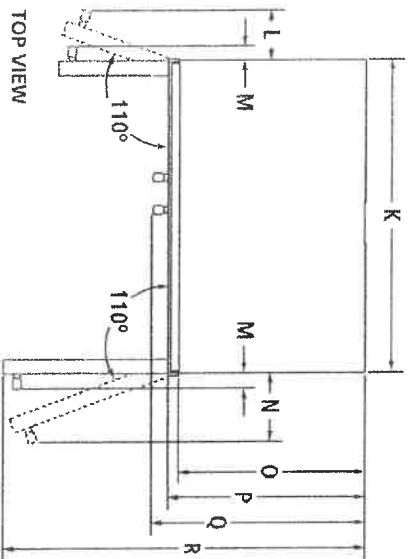

TOP VIEW

MODEL #	JS48PPDUDE	JS48SSDUDE
A	Width of freezer door (including hinge side offset)	20 in 50.8 cm
B	Width of refrigerator door (including hinge side offset)	27 in 68.6 cm
C	Space between doors	3⁄8 in 1.0 cm
D	Overall width (including side trim)	48 ^{3⁄8} in 122.9 cm
E	Height of top grille	8 ^{5⁄8} in 21.7 cm
F	Space between doors and top grille	3⁄8 in 1.0 cm
G	Height of handles Pro-Style® Stainless	45 ^{1⁄16} in 115.7 cm
H	Height to top of handles Pro-Style® Stainless	50 in 127.1 cm
I	Euro Style Stainless	63 ^{11⁄16} in 163.5 cm
J	Height of bottom grille	65 ^{3⁄4} in 167.0 cm
K	Height of doors	71 in 180.2 cm
L	Width of recessed refrigerator to freezer handle – door fully open 110° Pro-Style® Stainless	3 in 7.6 cm
M	Width of refrigerator to handle – door fully open 110° Pro-Style® Stainless	47 in 119.4 cm
N	Width from side of refrigerator to refrigerator handle – door fully open 110° Pro-Style® Stainless	8 in 20.3 cm
O	Euro Style Stainless	2 ^{3⁄8} in 6.7 cm
P	Width from side of refrigerator to handle – door open 90° Pro-Style® Stainless	2 in 5.1 cm
Q	Euro Style Stainless	10 ^{7⁄8} in 27.6 cm
R	Depth without doors	10 ^{1⁄4} in 26.1 cm
	Depth with doors	22 ^{1⁄8} in 56.2 cm
	Depth with handles Pro-Style® Stainless	25 ^{1⁄8} in 63.8 cm
	Euro Style Stainless	27 ^{3⁄4} in 70.5 cm
	Depth with refrigerator door open 90°	27 ^{1⁄8} in 68.8 cm
		50 ^{3⁄16} in 129.0 cm

IMPORTANT: Dimensional specifications are provided for planning purposes only.
Do not make any cutouts based on this information. Refer to the Installation or Use & Care Guide before selecting cabinetry, verifying electrical/gas connections, making cutouts or beginning installation. All Jenn-Air® appliances are appropriately UL, CUL or CSA approved.



8116ADZW915

48" SIDE-BY-SIDE REFRIGERATORS WITH ICE & WATER DISPENSER

JS48PPDUDE – 48³/₈" x 83³/₈" x 27³/₄" (with handles)
JS48SSDUDE – 48³/₈" x 83³/₈" x 27¹/₆" (with handles)

DIMENSIONS AS INSTALLED

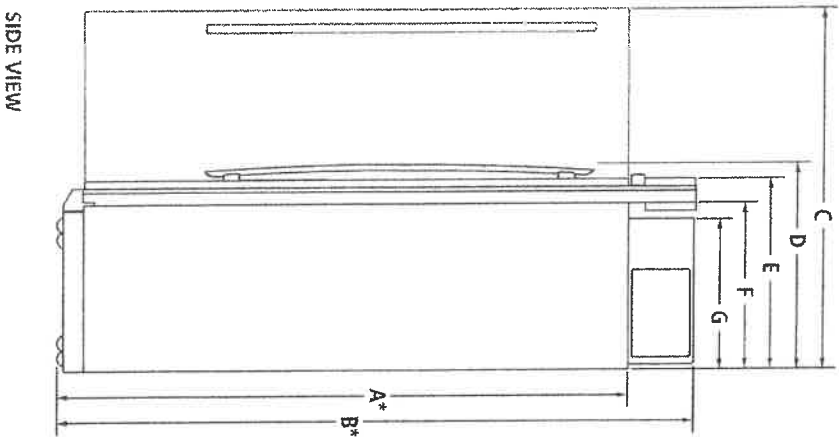

MODEL #	JS48PPDUDE JS48SSDUDE	
	in	cm
A*	Height without compressor (min.)	74 ³ / ₈ 188.9
B*	Height of recessed refrigerator (min.)	83 ³ / ₈ 211.8
C	Depth with refrigerator door open 90° (min.)	51 ¹ / ₆ 129.7
D	Depth with handles (min.)	27 ³ / ₄ 70.5
	Pro-Style* Stainless	
E	Euro Style Stainless	27 ¹ / ₆ 68.8
	Depth with doors (min.)	25 ¹ / ₆ 63.8
F	Depth without doors (min.)	22 ¹ / ₆ 56.2
G	Depth of compressor (min.)	19 ⁵ / ₈ 49.8

*Add 1¹/₄" (3.2 cm) to the height dimension when leveling legs are fully extended.

IMPORTANT: Dimensional specifications are provided for planning purposes only.
Do not make any cutouts based on this information. Refer to the Installation or Use & Care Guide before selecting cabinetry, verifying electrical/gas connections, making cutouts or beginning installation.
All Jenn-Air® appliances are appropriately UL, CUL or CSA approved.

JENN-AIR® DETAILED PLANNING DIMENSIONS

48" SIDE-BY-SIDE REFRIGERATORS WITH ICE & WATER DISPENSER

JS48PPDUD – 48^{3⁄8}" x 83^{3⁄8}" x 27^{3⁄4}" (with handles)
JS48SSDUD – 48^{3⁄8}" x 83^{3⁄8}" x 27^{1⁄8}" (with handles)

OPENING/CLEARANCE DIMENSIONS

MODEL #		JS48PPDUD JS48SSDUD	
A	Width (min.)	in	cm
B	Width of recommended electrical location	47 ^{1⁄2}	120.7
C	Distance from side of cabinet to recommended water connection location	13 ^{3⁄4}	34.3
D	Height (min.)	84	213.4
E	Height to recommended electrical location	77	195.6
F	Depth of recommended water connection location (max.)	1	2.5
e	Recommended electrical connection location		
w	Recommended water connection location		

ELECTRICAL REQUIREMENTS

115 volt, 60 Hz, AC only, 15- or 20-amp fused grounded circuit is required. A dedicated circuit is recommended. Use an outlet that cannot be turned off by a switch.
Minimum length of power cord is 84" (213.4 cm). Do not use an extension cord.

WATER PRESSURE REQUIREMENTS

A cold water supply with water pressure between 30 and 120 psi (207 and 827 kPa) is required to operate the water dispenser and ice maker. Call a licensed, qualified plumber with any questions about the water pressure.

Reverse Osmosis Water Supply

IMPORTANT: The pressure of the water coming out of a reverse osmosis system going to the water inlet valve of the refrigerator needs to be between 30 and 120 psi (207 and 827 kPa).
If a reverse osmosis water filtration system is connected to the cold water supply, the water pressure to the reverse osmosis system needs to be a minimum of 40 to 60 psi (276 to 414 kPa).

LOCATION REQUIREMENTS

Floor must be able to support refrigerator (more than 600 lb [272 kg]) and contents of the refrigerator and must be at the same level as flooring in the room.

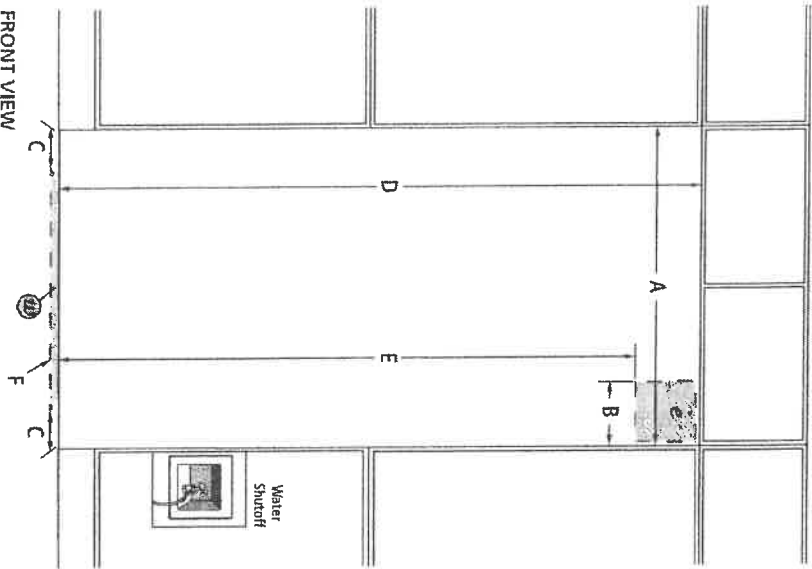

FRONT VIEW

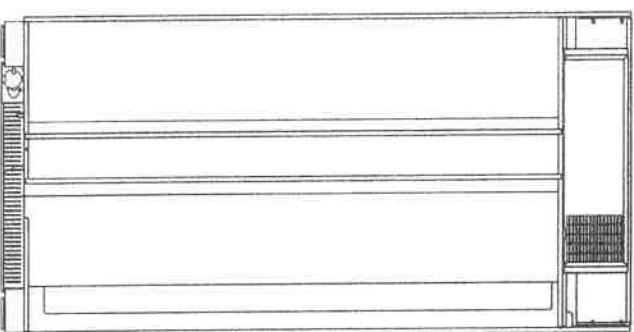

BACK VIEW

IMPORTANT: Dimensional specifications are provided for planning purposes only.
Do not make any cutouts based on this information. Refer to the Installation or Use & Care Guide before selecting cabinetry, verifying electrical/gas connections, making cutouts or beginning installation.
All Jenn-Air® appliances are appropriately UL, CUL or CSA approved.

Location Requirements

IMPORTANT: Observe all governing codes and ordinances. Do not obstruct flow of combustion and ventilation air.

It is the installer's responsibility to comply with installation clearances specified on the model/serial/rating plate. The model/serial/rating plate is located under the console on the right-hand side.

- It is recommended that a 585 CFM (993.9 m³/hr) or larger range hood be installed above the range.
- Follow the range hood or microwave hood combination installation instructions for dimensional clearances above the cooktop surface.
- Recessed installations must provide complete enclosure of the sides and rear of the range.
- All openings in the wall or floor where range is to be installed must be sealed.
- Do not seal the range to the side cabinets.
- Cabinet opening dimensions that are shown must be used. Given dimensions are minimum clearances.
- The anti-tip bracket must be installed. To install the anti-tip bracket shipped with the range, see the "Install Anti-Tip Bracket" section.
- Grounded electrical supply is required. See the "Electrical Requirements" section.
- Proper gas supply connection must be available. See the "Gas Supply Requirements" section.
- Contact a qualified floor covering installer to check that the floor covering can withstand at least 200°F (93°C). Use an insulated pad or 1/4" (6.4 mm) plywood over carpet and under range if installing range over carpeting.

IMPORTANT: To avoid damage to your cabinets, check with your builder or cabinet supplier to make sure that the materials used will not discolor, delaminate, or sustain other damage. This oven has been designed in accordance with the requirements of UL and CSA International and complies with the maximum allowable wood cabinet temperatures of 194°F (90°C).

Mobile Home - Additional Installation Requirements

The installation of this range must conform to the Manufactured Home Construction and Safety Standard, Title 24 CFR, Part 3280 (formerly the Federal Standard for Mobile Home Construction and Safety, Title 24, HUD Part 280). When such standard is not applicable, use the Standard for Manufactured Home Installations, ANSI A225.1/NFPA 501A or local codes. In Canada, the installation of this range must conform with the current standards CAN/CSA-A240-latest edition or with local codes.

Mobile Home Installations Require:

- When this range is installed in a mobile home, it must be secured to the floor during transit. Any method of securing the range is adequate as long as it conforms to the standards listed above.

Product Dimensions

NOTE: Cooktop features may differ.
30" (76.2 cm) models

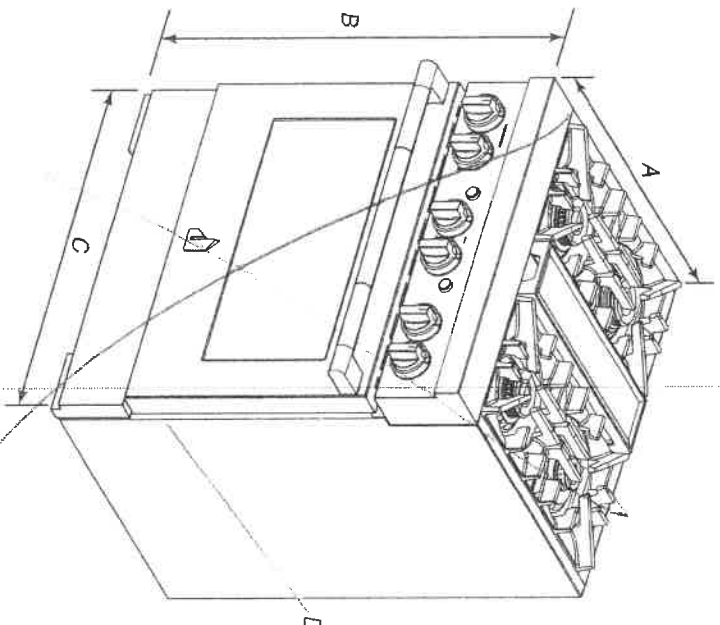

- A. 27¹/₂" (70.5 cm) depth with control panel (See NOTE.)
- B. 35³/₄" (90.8 cm) range height when sitting on the wheels
- C. 29⁷/₈" (75.7 cm) width
- D. Model/serial/rating plate location/SAID label (located on front side panel)

36" (91.4 cm) models

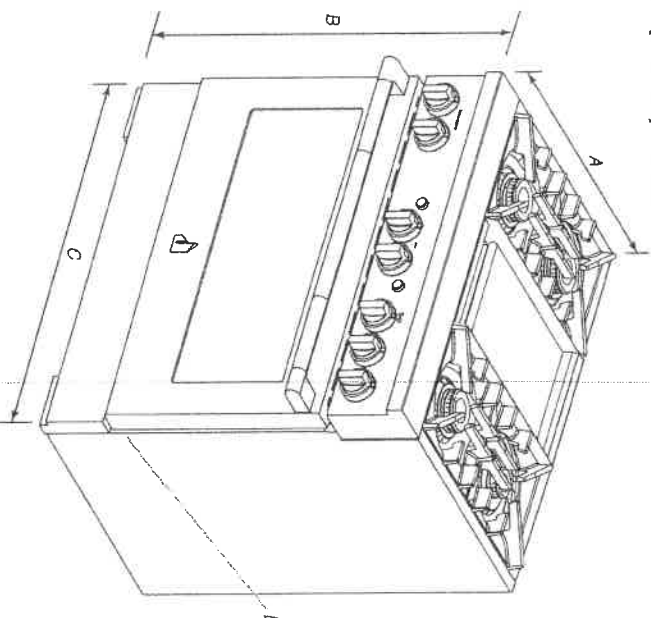

- A. 27¹/₂" (68.9 cm) depth with control panel (See NOTE.)
- B. 35³/₄" (90.8 cm) range height when sitting on the wheels
- C. 36" (91.4 cm) width
- D. Model/serial/rating plate location/SAID label (located on front side panel)

48" (121.9 cm) models

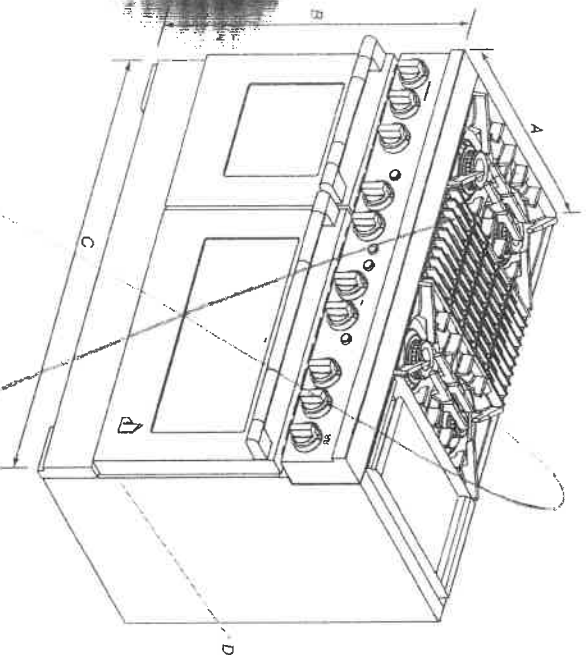

- A. 27 $\frac{1}{8}$ " (68.9 cm) depth with control panel (See NOTE.)
- B. 35 $\frac{3}{4}$ " (90.8 cm) range height when sitting on the wheels
- C. 48" (121.9 cm) width
- D. Model/serial/rating plate location (SAID label located on front side panel)

NOTE: When installed in a 24" (61.0 cm) base cabinet with 25" (63.5 cm) countertop, front of oven door protrudes 1 $\frac{7}{8}$ " (4.8 cm) beyond 24" (61.0 cm) base cabinet.

Cabinet Requirements

Cabinet opening dimensions shown are for 25" (64.0 cm) countertop depth, 24" (61.0 cm) base cabinet depth, and 36" (91.4 cm) countertop height. Dimensions must be met in order to ensure a flush fit to back wall.

IMPORTANT: If installing a range hood, hood liner, or microwave hood combination above the cooking surface, follow the range hood or microwave hood combination installation instructions for dimensional clearances above the cooking surface.

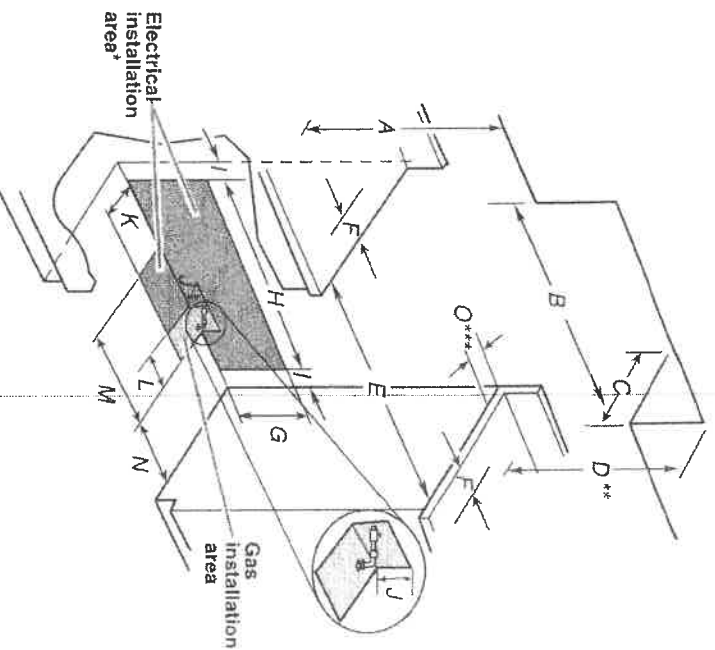

- A. 18" (45.7 cm) upper cabinet to countertop
- B. 30" (76.2 cm) model: 30" (76.2 cm) min. upper cabinet width
- B. 36" (91.4 cm) model: 36" (91.4 cm) min. upper cabinet width
- C. 48" (121.9 cm) model: 48" (121.9 cm) min. upper cabinet width
- C. 13" (33 cm) max. upper cabinet depth
- D. For minimum clearance to top of range.**
- E. 30" (76.2 cm) on 30" (76.2 cm) models
- E. 36" (91.4 cm) on 36" (91.4 cm) models
- F. 12" (30.4 cm) min. clearance from both sides of range to side wall or other combustible material
- G. 15" (38.1 cm)
- H. 28" (71.1 cm) on 36" (91.4 cm) models
- I. 4" (10.1 cm)
- J. 3" (7.5 cm)
- K. 5" (12.7 cm)
- L. 12" (30.5 cm) on 36" (91.4 cm) models
- M. 10 $\frac{1}{2}$ " (26.7 cm)
- N. 9" (22.9 cm)
- O. 6" (15.2 cm)***

** If not using ventilation, Minimum Clearances

- 30" (76.2 cm) models: 42" (106.7 cm) minimum clearance between the top of the cooking platform and the bottom of a combustible surface
- 36" (91.4 cm) models: 58" (147.3 cm) minimum clearance between the top of the cooking platform and the bottom of a combustible surface
- 48" (121.9 cm) models: 58" (147.3 cm) minimum clearance between the top of the cooking platform and the bottom of a combustible surface

***If the surface of the back wall is constructed of a combustible material and a backguard is not installed, a 6" (15.2 cm) minimum clearance is required for all models.

JENN-AIR® DETAILED PLANNING DIMENSIONS

DISHWASHERS

JDTS5246G, JDTS5244G – 23⁷/₈" x 33¹/₂" x 28⁹/₃₂" (including handle)
JDTS5245G, JDTS5243G – 23⁷/₈" x 33¹/₂" x 24¹/₂" (not including handle)

OPENING/CLEARANCE DIMENSIONS

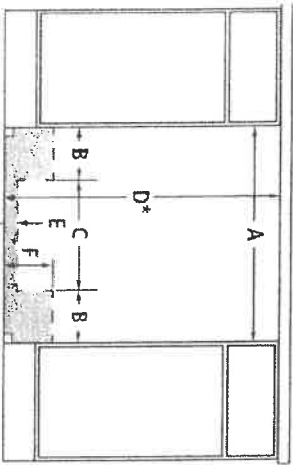

FRONT VIEW

MODEL #	JDTS5246G	JDTS5245G	JDTS5244G	JDTS5243G
A	Width (min.)	24	61.0	
B	Width of possible utility installation area (back wall)	6 ³ / ₄	17.2	
C	Width of clear area (back wall)	10 ¹ / ₂	26.7	
D*	Height with wheels removed (min.)	34	86.4	
E	Height of possible utility installation area (back wall)	2 ¹ / ₄	6.4	
F	Height of possible utility installation area (back/side wall)	6 ¹ / ₄	15.9	
G	Height of clear area (side wall)	3	7.6	
H	Depth (min.)	24	61.0	
I	Depth of utility location (side wall)	4	10.2	

Electrical, water and drain connections may be installed in shaded areas

Recommended drain connection location – closest to sink	1 ¹ / ₂ dia. 3.8 dia.
Recommended electrical connection location – right-hand side or back wall	1 ¹ / ₂ dia. 3.8 dia.
Recommended water connection location – left-hand side or back wall	½ dia. 1.3 dia.

*Measured from the lowest point on the underside of countertop.

ELECTRICAL REQUIREMENTS

20-volt, 60 Hz, AC-only, 15- or 20-amp, fused electrical supply. Copper wire only.
A time delay fuse or circuit breaker and separate circuit is recommended.

WATER SUPPLY REQUIREMENTS

120°F (49°C) hot water supply with water pressure between 20 and 120 psi (138 and 862 kPa) is required. If you have questions about your water pressure, call a licensed, qualified plumber.

DRAIN REQUIREMENTS

Connect drain hose to waste tee or disposer inlet above drain trap.
Maximum drain hose length 12' (3.7 m).

LOCATION REQUIREMENTS

Corner locations require a 2" (5.1 cm) minimum clearance between the side of the dishwasher door and the wall or cabinet.

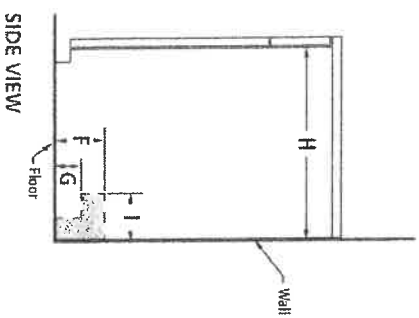

SIDE VIEW

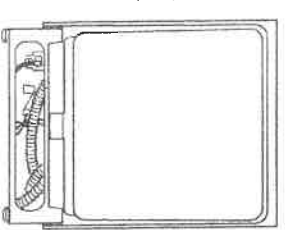

BACK VIEW

IMPORTANT: Dimensional specifications are provided for planning purposes only.
Do not make any cutouts based on this information. Refer to the installation or Use & Care Guide before selecting cabinetry, verifying electrical/gas connections, making cutouts or beginning installation.
All Jenn-Air® appliances are appropriately UL, CUL or CSA approved.

ELICA PRO SERIES
LEONE

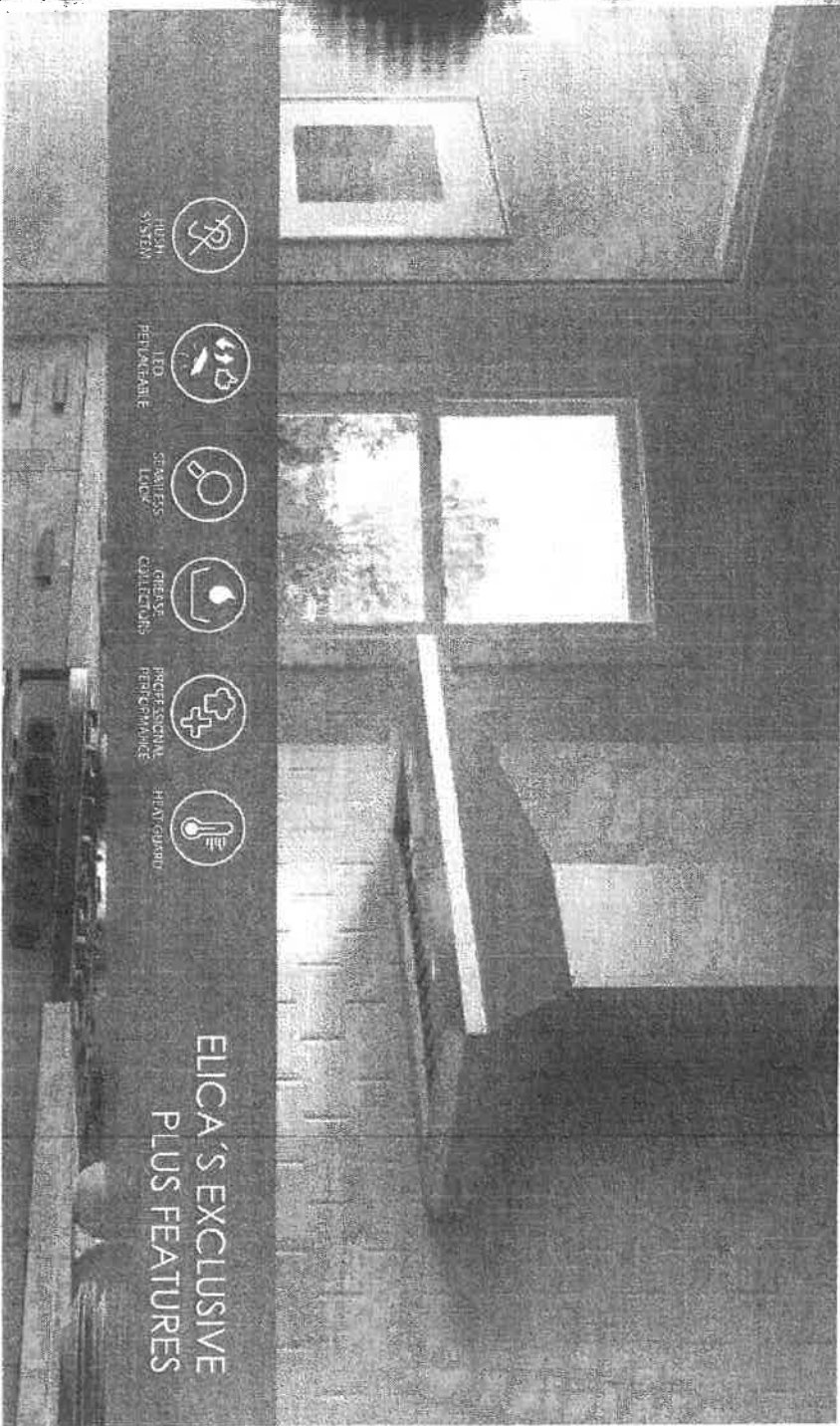

- HUSH SYSTEM
- LED PERIMETER LIGHTING
- STAINLESS LATCHES
- GREASE COLLECTORS
- PROFESSIONAL PERFORMANCE
- HEAT EXCHANGER

ELICA'S EXCLUSIVE PLUS FEATURES

Give a splash of Italian design to your professional kitchen with Leone's crisp lines, seamless welded corner craftsmanship, beveled rim and gleaming stainless steel.

Leone has the extra depth (24") and power (1200 CFM on 36", 42" & 48" widths) needed to support professional ranges and cooktops. No ear plugs required with Leone's HUSH sound suppression system, which enables you to comfortably talk and entertain, even when cooking up a storm. Available in 30", 36" and 42" widths, Leone features backlit hidden knob controls, which operate the 4-speed blower and LED lighting. Designed for standard ducted ventilation only.

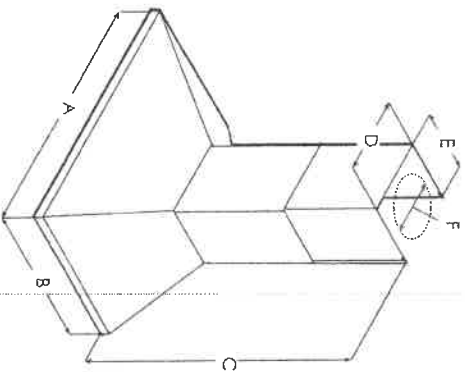

A	ELN636S1	ELN136S1	ELN142S1	ELN148S
	ELN630S2	ELN136S2	ELN142S2	
B	24" (61 cm)			
C	Max: 47 5/8" (120.9 cm)			
	Min: 30" (76.2 cm)			
D	13 2/16" (33.2 cm)			
E	10 5/8" (27 cm)			
F	8" (20.3 cm)			

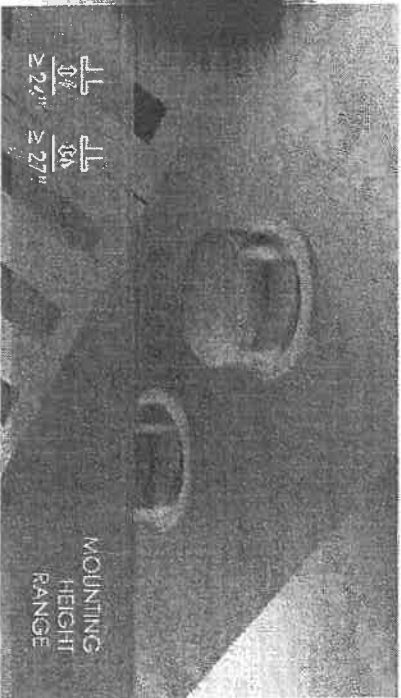

MOUNTING HEIGHT RANGE
≥ 24" ≥ 27"

ELICA PRO SERIES
LEONE

8" Duct

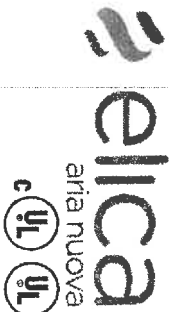

SPECIFICATIONS

	30" Unit	36" Unit	42" Unit	48" Unit
Model:	ELN630S1 ELN630S2	ELN136S1 ELN136S2	ELN142S1 ELN142S2	ELN148SS
Dimensions:	30"W x 24"D x 12 1/8"H	36"W x 24"D x 12 1/8"H	42"W x 24"D x 12 1/8"H	48"W x 24"D x 12 1/8"H
Blower Type (internal):	600 CFM (4-speed)	1200 CFM (4-speed)	1200 CFM (4-speed)	1200 CFM (4-speed)
Blower Performance:				
Speed 1	205 CFM	375 CFM	375 CFM	375 CFM
Speed 2	350 CFM	640 CFM	640 CFM	640 CFM
Speed 3	510 CFM	940 CFM	940 CFM	940 CFM
Speed 4	600 CFM	1200 CFM	1200 CFM	1200 CFM
Noise (sones):	Min: 2.01, Max: 6	Min: 3.21, Max: 7.7	Min: 3.21, Max: 7.7	Min: 3.21, Max: 7.7
Working Speed				
Finish:		Stainless Steel		
Controls:		Fully retractable rotating knobs with blue backlighting		
Illumination:		2 LED, 7.5 Watts LED light		
(replaceable lamps 1 intensity)				
Filter Type:		Dishwasher-Safe, Professional Stainless Steel, Angled baffled filters		
Angled Baffle Filters:	1	2	2	3
Duct Transition:	8" Round with Backdraft Damper (top only)			
Installation Type:	Ducted Installation Only			
Electrical:		120V - 60 Hz		
KITS:				
Long Chimney		KIT02765		
Extension Kit:				
CONSUMABLE PARTS				
Replacement Grease Filter (1):	GF09FA	GF09EA		GF09FA
Replacement Light Bulb (1):		LMP0131098		
		*Consumable parts are sold in units of one (1). Order accordingly		
INSTALL HEIGHTS:				
Ranger Hood:		Min: 8", Max 10"		
Ranger Hood with extension duct covers:		Min: 9.9", Max 13"		

PLUS FEATURES

- HUSH SYSTEM** - An exclusive sound deadening technology that effectively reduces sound levels by over 35%
- LED CONSUMER REPLACEABLE BULB** - High quality LED lighting usually requires a skilled technician to replace lamps. Avoid this expense with Elica's new LED lamps that enable homeowners to replace in seconds
- SEAMLESS CRAFTSMANSHIP** - Heavy gauge stainless steel "Seamless" construction that delivers refined elegance.
- STAINLESS STEEL BAFFLE FILTERS WITH GREASE COLLECTORS** - Designed for high airflow cooking, the "S" shape design traps high volumes of grease
- PROFESSIONAL PERFORMANCE** - Special features and high performances for models with aspiration capacity between 600 and 1200 CFM's
- HEAT GUARD** - Senses extreme temperatures (>158 degrees) and automatically adjusts the blower speed to HIGH