

CONSTRUCTION SUMMARY OF EXTRAS
Printed 2021-09-24 / 3:10 PM / Page 1 of 1

Site: WASAGA
Lot: 90
Model: WAVE (60-02) ELEV C
Purchaser: SHARON ROBINSON
Purchaser: STEVE BORZUSH
Phone: 705.790.2408
Email: CARABRIGHTSTAR599@GMAIL.COM



DESCRIPTION		DATE SELECTED
BONUS PACKAGE: 3 PIECE STAINLESS STEEL APPLIANCES WITH WHITE TOP LOAD WASHER & DRYER	INCLUDED IN APS	
BONUS PACKAGE: STAINLESS STEEL HOOD FAN	INCLUDED IN APS	
	STRUCTURALS	
1 OPERABLE WINDOW- QTY 3- (1) MASTER BEDROO M, (1) GREAT ROOM (1) BEDROOM 2	3-Sep-21	
	COLOURS	
1 FROSTED FRONT DOOR- SEE SKETCH	03-Sep-21	
2 NA	03-Sep-21	
3 50" DIMPELX FIREPLACE IN LIEU OF STANDARD- BLF5051- WALL BUILT INTO ROOM APPROX 8" TO ACCOMIDATE- SEE SKETCH	03-Sep-21	
4 PLUG ABOVE FIREPLACE FOR FUTURE TV, INSTALL 65 AFB BESIDE CABLE- SEE SKETCH	03-Sep-21	
5 ELECTRICAL- 2 CAPPED LIGHTS OVER KITCHEN ISLAND, SPACED EVENLY UN SEPARATE SWITCH. STD LIGHT TO REMAIN- SEE SKETCH	03-Sep-21	
6 KITCHEN-UNDER VALANCE	03-Sep-21	
7 ELECTRICAL- LIGHTING FOR VALANCE- LED STRIP LIGHTING (UNDERSIDE OF UPPER CABINETS)	03-Sep-21	
8 KITCHEN- OVER THE RANGE MICROWAVE, 15 AMP INCLUDED	03-Sep-21	
9 KITCHEN- BACKSPASH- UP 2 STACKED	03-Sep-21	
10 KITCHEN- RISER PANEL AND SHAKER CROWN MOLDING OVER CABINETS. INSTALL CROWN AT CEILING- SEE SKETCH	03-Sep-21	
11 KITCHEN-UPPER ANGLE CABINET WITH CLEAR PLAIN GLASS DOOR- SEE SKETCH	03-Sep-21	
12 KITCHEN- 2 TONE CABINETS- ISLAND TO BE DIFFERENT COLOUR THAN REST OF KITCHEN	03-Sep-21	
13 KITCHEN COUNTERTOP- UP 2- INCLUDES BLANCO UNDERMOUNT SINK	03-Sep-21	
14 HARDWOOD- FAMILY ROOM, DINING ROOM, MAIN HALL	03-Sep-21	
15 STAIN FOR STAIRS TO MATCH HARDWOOD AS CLOSE AS POSSIBLE	03-Sep-21	
16 BANK OF DRAWERS IN MASTER- SEE SKETCH	03-Sep-21	
17 UPPER CABINETS - LAUNDRY-	03-Sep-21	
18 MASTER- SHOWER FLOOR- UP 1	03-Sep-21	
19 MASTER COUNTER TOP INCLUDES (2) UNDERMOUNT OVAL SINK- UP 1	03-Sep-21	
20 NA	03-Sep-21	
21 RAILING- UP 3	03-Sep-21	
22 COMFORT HEIGHT- MASTER AND ENSUITE	03-Sep-21	
23 CONTRAC CALL ONE PIECE TOILET- 4710BOV- SEE SPEC- FOR MASTER ENSUITE	03-Sep-21	
24 24" TOWEL BAR- MOEN YB2424- MASTER AND ENSUITE	03-Sep-21	
25 9" TOWEL BAR- YB2486- MASTER, ENSUITE AND POWDER- INSTALL NEAR SINK AS HAND TOWEL BAR	03-Sep-21	
26 PIVOTING PAPER HOLDER- YB2408- MASTER, POWDER AND ENSUITE	03-Sep-21	
	ADDITIONAL	
1 PLUMBING- KITCHEN SINK- BLANCO QUARTUS R15- SUPER SINGLE- 401518- SEE SPEC	09-Sep-21	

ZANCOR HOMES COLOUR CHART

PRINTED 2021-09-03, 11:46 AM

ENTRANCES				
Main Foyer - FLOORING		NEW BYZANTINE ASSURO BLUE 12 X 24- BRICKED		
Mudroom - FLOORING		NEW BYZANTINE ASSURO BLUE 12 X 24- BRICKED		
Side Hall - FLOORING		NA		
Basement Foyer - FLOORING		NEW BYZANTINE ASSURO BLUE 12 X 24- BRICKED		
KITCHEN				
Kitchen - FLOORING		NEW BYZANTINE ASSURO BLUE 12 X 24- BRICKED		
Breakfast - FLOORING		NEW BYZANTINE ASSURO BLUE 12 X 24- BRICKED		
Kitchen - CABINETS		EURO HIGH GLOSS WHITE		
Island - CABINETS		CONT SLAB OAK TIMBER GREY STAINED		
Servery - CABINETS		NA		
Kitchen - HANDLES/KNOBS		H800BC		
Kitchen - COUNTERTOP		CARRARA WHITE- UP 2		
Island - COUNTERTOP		CARRARA WHITE- UP 2		
Kitchen - BACKSPLASH		C+D STERLING GREY BRIGHT 4 X 16- UP 2 STACKED		
Kitchen - SINK		BLANCO UNDERMOUNT		
Kitchen - FAUCET		STD		
GREAT ROOM / DINING / LIVING / DEN / OFFICE / BASEMENT				
Family / Great Room - FLOORING		NORTHERN SOLID SAWN CHARACTER PEARL WHITE OAK 5" ORACALE- UP 2		
Main Hall - FLOORING		NORTHERN SOLID SAWN CHARACTER PEARL WHITE OAK 5" ORACALE- UP 2		
Dining / Living Room - FLOORING		NORTHERN SOLID SAWN CHARACTER PEARL WHITE OAK 5" ORACALE- UP 2		
Library / Den - FLOORING		NA		
Basement Rec Room - FLOORING		NA		
STAIRS				
Railing Details - PICKETS		ALL BLACK SINGLE COLLAR W/ ALT PLAIN- UP 3		
Railing Details - POSTS		3 1/4 SQUARE OAK POST W/ BEVEL CORNERS- UP 3		
Railing Details - HANDRAIL		2 3/4" GROOVED OAK HANDRAIL- UP 3		
Stair Stain - MAIN STAIRS		STAIN TO MATCH HARDWOOD AS CLOSE AS POSSIBLE		
Stair Stain - BASEMENT STAIRS (if applicable)		STAIN TO MATCH HARDWOOD AS CLOSE AS POSSIBLE		
Stair Stain - SERVICE STAIRS (if applicable)		NA		
POWDER ROOM				
Powder Room - FLOORING		NEW BYZANTINE ASSURO BLUE 12 X 24- BRICKED		
Powder Room - CABINETS		NA		
Powder Room - COUNTERTOP		NA		
Powder Room - SINK		STD		
Powder Room - FAUCET		STD		
2ND FLOOR				
Upper Hall - FLOORING		NA		
Master Bedroom - FLOORING		T03 OPENING NIGHT		
Bedroom 2 - FLOORING		T03 OPENING NIGHT		
Bedroom 3 - FLOORING		NA		
Bedroom 4 - FLOORING		NA		
Bedroom 5 - FLOORING		NA		
Master Ensuite - FLOORING		NEW BYZANTINE ASSURO BLUE 12 X 24- BRICKED		
Master Ensuite - SHOWER WALL		NEW BYZANTINE ASSURO BLUE 12 X 24- STACKED VERTICLE		
Master Ensuite - SHOWER FLOOR		ONTARIO SERIES HEX TAUPE MATTE- UP 1		
Master Ensuite - SHOWER JAMB		BIANCO CARRARA		
Master Ensuite - CABINETS		CONT SLAB OAK TIMBER GREY STAINED- COMFORT HEIGHT		
Master Ensuite - HANDLES/KNOBS		H800BC		
Master Ensuite - COUNTERTOP		WHITE GALAXY- UP 1		
Master Ensuite - SINK(S)	4220 CFY (2)	Master Ensuite - FAUCET(S)	STD	
***FOR TRADE USE ***				
Any upgrades in the colour chart must be accompanied with a PES. It is the responsibility of all Trades to inform the builder of any discrepancies on sketches, PES and/or colour charts PRIOR to installation.		WASAGA SHORELINE	90	SIGNATURES
		PAGE 1 OF 2	PURCHASER INITIALS	VENDOR APPROVAL

2ND FLOOR CONTINUED...									
Main Bath - FLOORING				NA					
Main Bath - TUB / SHOWER WALL				NA					
Main Bath - SHOWER FLOOR				NA					
Main Bath - SHOWER JAMB				NA					
Main Bath - CABINETS				NA					
Main Bath - HANDLES/KNOBS				NA					
Main Bath - COUNTERTOP				NA					
Main Bath - SINK(s)		NA		Main Bath - FAUCET(s)		NA			
Shared Bath- FLOORING				NA					
Shared Bath- TUB / SHOWER WALL				NA					
Shared Bath- SHOWER FLOOR				NA					
Shared Bath- SHOWER JAMB				NA					
Shared Bath- CABINETS				NA					
Shared Bath- HANDLES/KNOBS				NA					
Shared Bath- COUNTERTOP				NA					
Shared Bath- SINK(s)		NA		Shared Bath - FAUCET(s)		NA			
Ensuite Bath - FLOORING				NEW BYZANTINE ASSURO BLUE 12 X 24- BRICKED					
Ensuite Bath - TUB / SHOWER WALL				NEW BYZANTINE ASSURO BLUE 12 X 24- STACKED HORIZONATL					
Ensuite Bath - SHOWER FLOOR				NA					
Ensuite Bath - SHOWER JAMB				NA					
Ensuite Bath - CABINETS				EURO HIGH GLOSS WHITE- COMFORT HEIGHT		GIDCAR			
Ensuite Bath - HANDLES/KNOBS				H800BC					
Ensuite Bath - COUNTERTOP				8830-58					
Ensuite Bath - SINK(s)		STD		Ensuite Bath - FAUCET(s)		STD			
LAUNDRY									
Laundry - FLOORING		NEW BYZANTINE ASSURO BLUE 12 X 24- BRICKED		Laundry - HANDLES/KNOBS		H800BC			
Laundry - CABINETS AND UPPERS		HIGH GLOSS EURO WHITE		Laundry - SINK		STD			
Laundry - COUNTERTOP		8830-58		Laundry - FAUCET		STD			
Laundry - BACKSPLASH		NA							
TRIM / PAINT									
Casing/Baseboards				STD					
Interior Doors				STD					
Interior Door Hardware				STD					
PAINT - Throughout				COOL WHITE					
FIREPLACE									
Location / Insert / Mantle				50" DIMPLEX					
ACCESSORIES									
Mirrors		YES		BATH ACCESSORIES		UPGRADE			
APPLIANCE REQUIREMENTS									
GAS LINE TO BBQ		STD		ELECTRICAL for Built-in Oven		DECLINED			
GAS LINE & ELECTRICAL TO STOVE		DECLINED		ELECTRICAL for Built-in Micro		YES			
GAS LINE & ELECTRICAL TO DRYER		DECLINED		ELECTRICAL for Cooktop		DECLINED			
HOOD FAN VENT SIZE		6" STD		ELECTRICAL for Bar Fridge		DECLINED			
WATERLINE to Fridge		DECLINED							
DISCLAIMER									
Any changes to the colour chart after signing are subject to a \$5000 administration fee plus costs									
Purchaser has checked and acknowledged accuracy of colour and selections before signing.									
Colours of all materials are as close as possible to Builders selection but not necessarily identical due to dye lot variances in manufacturing/manufacturers. Due to construction progress some items may have been pre-selected or installed. In this event the Vendor's selection must be accepted by the purchaser									
SITE / LOT:		WASAGA		90					
PURCHASER(S):		SHARON ROBINSON							
PURCHASER(S):		STEVE BORZUSH							
CONTACT:		705.790.2408		CARABRIGHTSTAR599@GMAIL.COM					
FOR TRADE USE									
Any upgrades in the colour chart must be accompanied with a PES. It is the responsibility of all Trades to inform the builder of any discrepancies on sketches, PES and/or colour charts PRIOR to installation.									
ZANCOR HOMES		PURCHASER SIGNATURE		PURCHASER SIGNATURE					
		DÉCOR CONSULTANT							
Vendor APPROVAL									

Product Specification Sheet
QUATRUS R15 U SUPER SINGLE

Satin brushed finish



QUATRUS R15 U
SUPER SINGLE

Colour Finish

Model No.

FEATURES / SPECIFICATIONS



Satin brushed
finish

401518

- German engineered with 304 series, 18-gauge stainless steel
- Practical 15 mm radius corners for easy cleaning
- X-pattern drain grooves quickly remove water from the sink
- Extra-large bowl size is ideal for busy families
- 18/10 chrome-nickel content for exceptional lustre and strength
- Rear-positioned drain holes maximize cabinet storage space

DESIGN AND PLANNING TIPS

Cabinet Size: 36" (915 mm)
Bowl depth: 9" (230 mm)
Depending on cabinet construction, a different cabinet size may be required.
Consult the cabinet manufacturer.

WARRANTY

Limited Lifetime warranty

Code/Standards Compliance

BLANCO sinks and faucets are third-party tested and certified to CSA, cUPC, ANSI/ASME and NSF standards and listed by applicable certification bodies. For more information on individual product listings, contact our office or listing organization.

BLANCO CANADA
100 Corporation Drive
Brampton, ON L6S 6B5

Tel: 905 494 2400
Fax: 905 494 2425
www.blancocanada.com

Toll Free: 1 877 425 2626
Toll Free: 1 877 825 2626

© 2016 BLANCO CANADA

X

Clear Copy

10th 90
Sep 19/21

CALI ONE PIECE TOILET
4.8L/PF / 1.28GPF

- ☐ 4710B0V Lined Tank
- ☐ 4710B0VU Unlined Tank

PRODUCT SPECS:

- High efficiency toilet

- 4.8L/pf / 1.28Gpf

- Elongated bowl with concealed skirted trapway

- Vitreous china

- 17" Plus Height for greater comfort

- Soft white tank lever

- 12" (305mm) Rough-in

- 2" Fully glazed ball pass trapway

- 3" Flapper

- Siphon jet flush action

- Water surface: 7¾" x 5⅝" (198mm x 143mm)

- Decorative soft white side caps included

- Smooth close toilet seat included
- DIMENSIONS:

390mm W x 725mm D x 765mm H

15⅝" W x 28½" D x 30⅝" H
- COMPLIANCE CERTIFICATIONS

Meets or exceeds the following:

- IAPMO cUPC

- ASME A 112.19.2 / CSA B45.1

- ADA Guidelines & ANSI A117.1

- LEED Compliant

- CSA B651 barrier-free standard

- US EPA WaterSense

- Map Tested 1000g

SHIPPING

Cube	9.39
GW	92.5 lbs

TO BE SPECIFIED

Colour: ☐ Soft White

NOTES: This toilet is designed to rough-in at a minimum dimension of 305mm (12") from finished wall to C/L of outlet. Supply line not included with fixture and must be ordered separately.

Important: Dimensions of fixtures are nominal and may vary within the range of tolerances established by ASME standard A112.19.2. These measurements are subject to change or cancellation. No responsibility is assumed for use of superseded or voided pages.

Product is designed to comply with ADA / ANSI A117.1 and CSA B651 Barrier-free Standard requirements, if installed according to the standard and local building codes. It is the responsibility of the installer to comply with this standard and local building codes prior to installation.

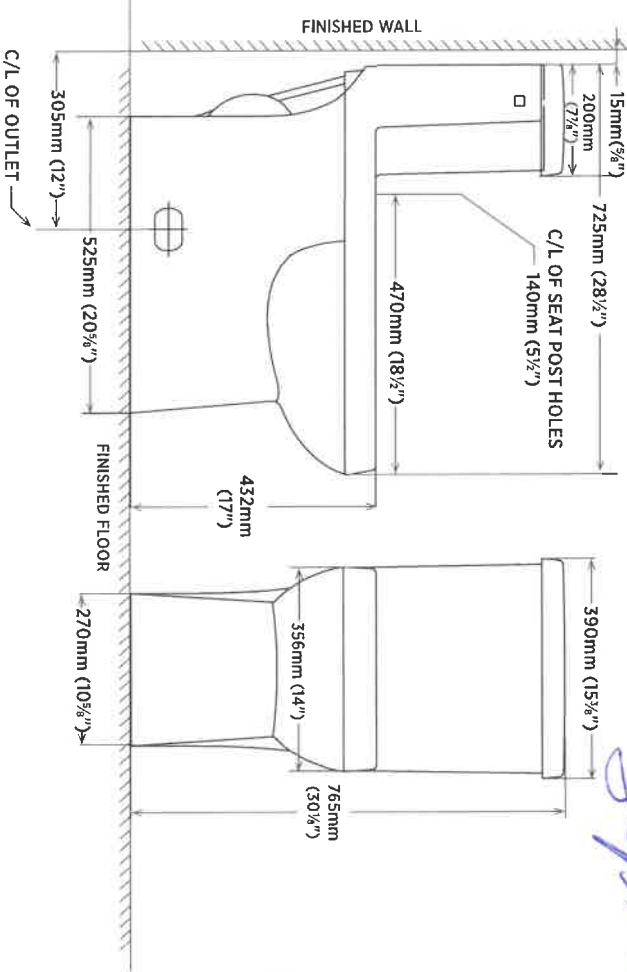

WASAGA BEACH

1st 96
Sept 3/21



— 2 capped
light over
island.
space
evening,
Sep with

SHORELINE POINT
WASAGA BEACH

WAVE 60-02

lot 90
Sept 3/21

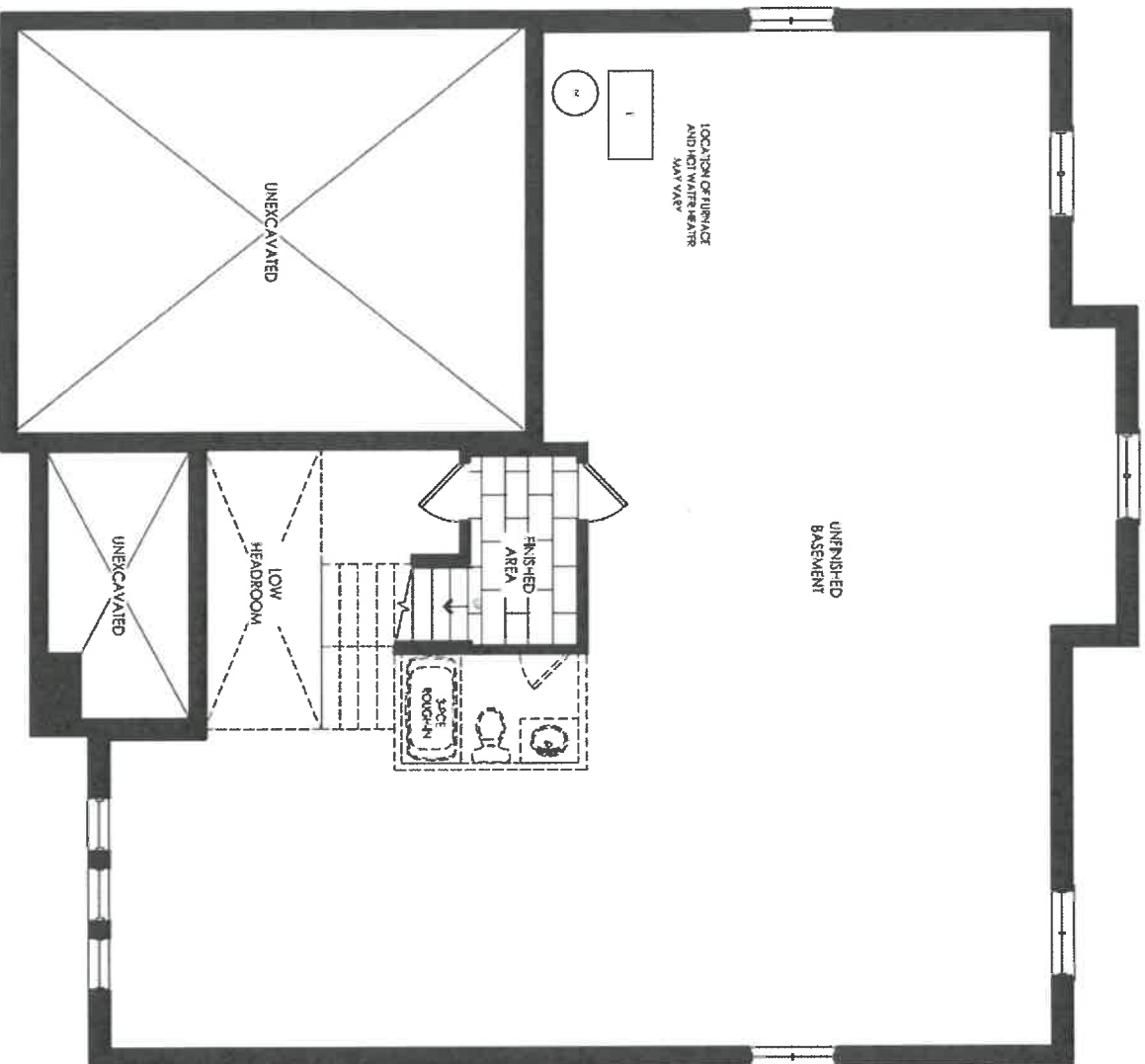

Elevation A
Basement

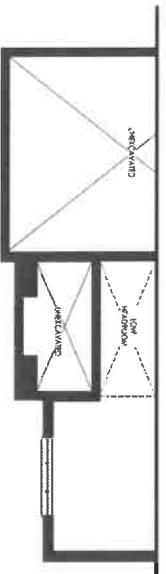

Elevation B
Basement

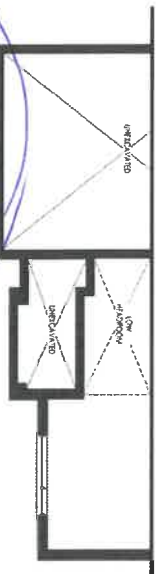

Elevation C
Basement

Handwritten signature or initials.

Handwritten signature or initials.

 <small>new image systems inc.</small>		<small>OS NUMBER</small> 	
<small>CLIENT NAME:</small> ZANCOR HOMES <small>SHIP TO :</small> SHORELINE POINT		<small>INSTALL DATE:</small> 	
<small>DRAFTED BY:</small> FERNANDA <small>COMMENT</small>		<small>PH:</small> <small>CELL:</small>	
<small>DATE SUBMITTED</small> 16 Jun 2021		<small>PAGE</small> 15 of 22	

60-02

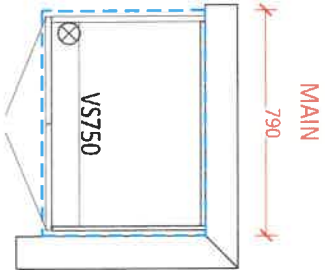

Lot 90
Sept 3/21
Confirmed Height

Back of drawers.

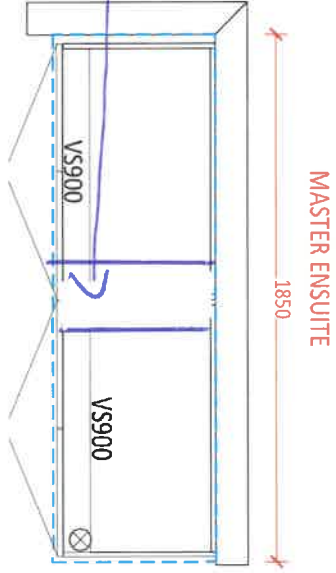

Confirmed Height

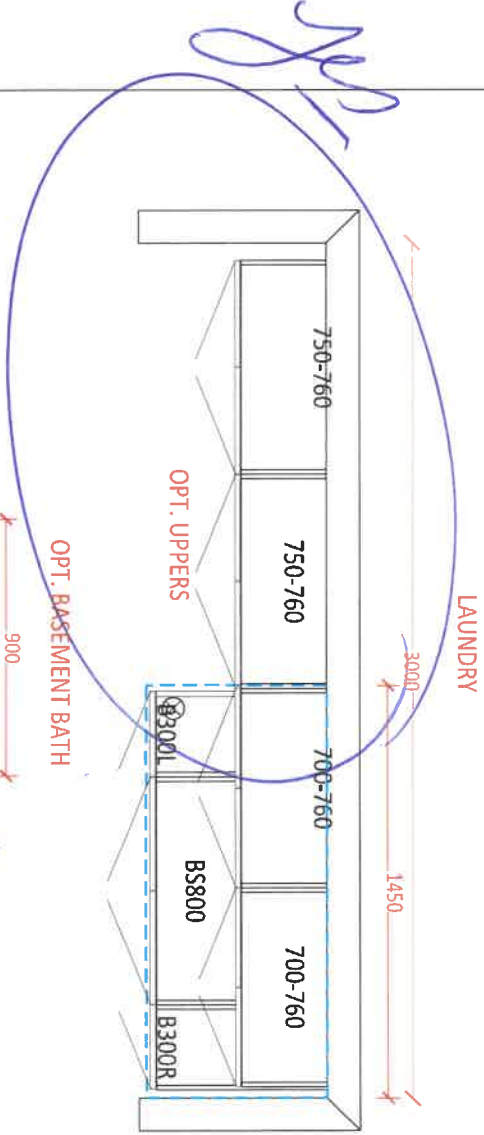

Handwritten initials/signature

CLIENT NAME: ZANCOR HOMES
SHIP TO: SHORELINE POINT

PH:
CELL:

13 of 22

16 Jun 2021

DRAFTED BY: FERNANDA

P/OH

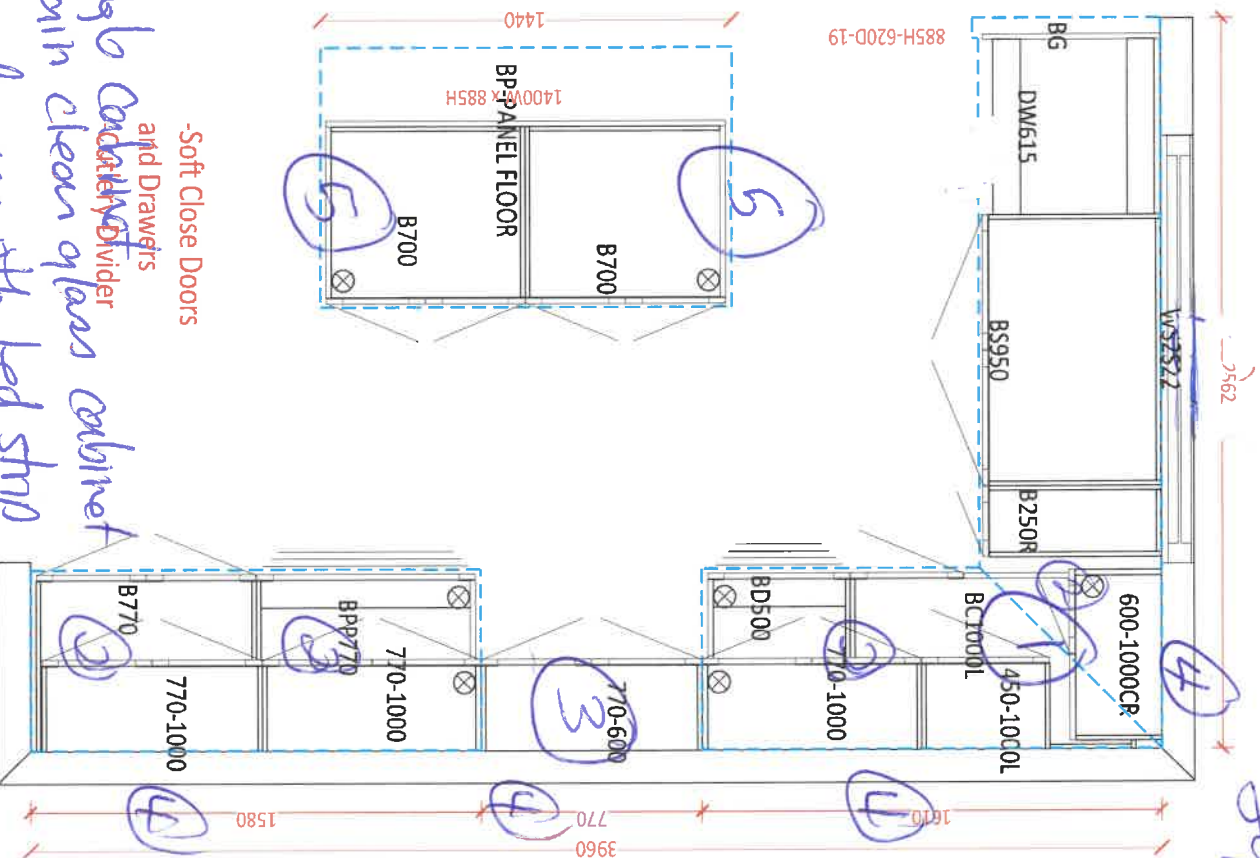
60-02
KITCHEN

1st 96
Sept 3/21

- ① upper angle cabinet with plain clean glass cabinet
- ② under valance with led strip lighting
- ③ over the Range Microwave
- ④ Riser + (grooves) even cabinet, install even at ceiling
- ⑤ 2 tier kitchen - island different than Rest of kitchen.

		CLIENT NAME: ZANCOR HOMES SHIP TO: SHORELINE POINT		OS NUMBER INSTALL DATE: PAGE: 14 of 22	
DATE SUBMITTED 16 Jun 2021		DRAFTED BY: FERNANDA COMMENT:		PH: CELL:	
		P104			

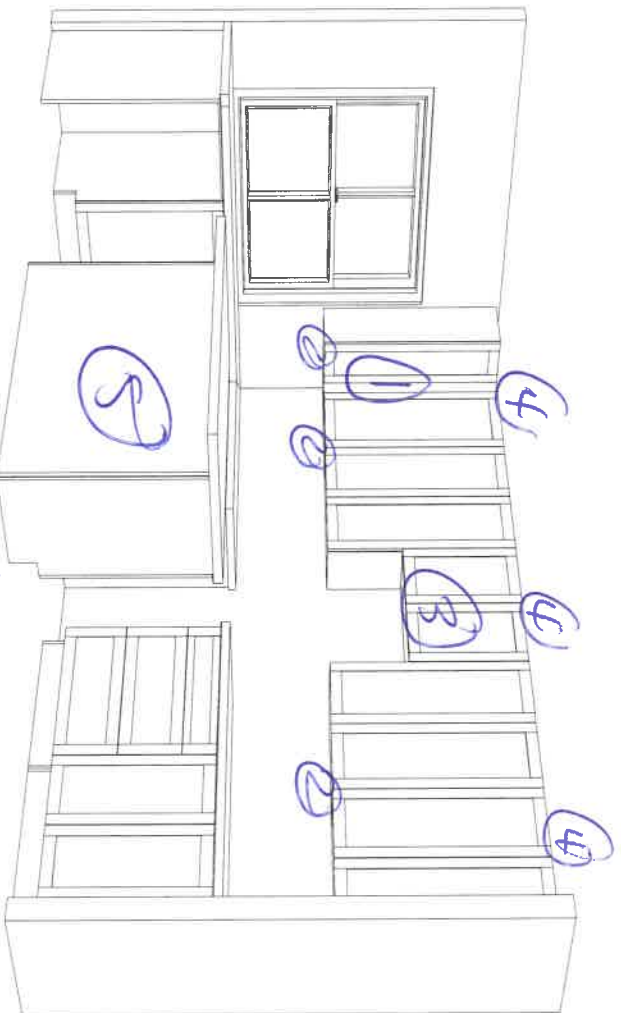

- ① upper angle cabinet with plain clear glass cabinet
- ② under valene with led strip light
- ③ over the Range Microwave
- ④ Riser + Crown over cabinet, install crown & ceiling.
- ⑤ 2 new kitchen island different from existing kitchen

Ed 90
Sept 3/21

Ed

Ed

THE
GALLERY

SHORELINE POINT

BY ZANCOR

WASAGA BEACH

ZANCOR

APPLIANCE ACKNOWLEDGEMENT

CONTACT: Steve Miller - Appliance Canada (905) 660-2424 / smiller@appliancecanada.com

- It is the Purchaser's responsibility to coordinate delivery, installation and hook up of appliances and to ensure they are installed as per Manufacturers specifications after closing.

STANDARD APPLIANCE OPENINGS provided by Zancor:

*Standard appliance openings are approximate and the minimum required. Sizes may vary due to onsite condition and/or when modifications have been made to the cabinetry.

- ▶ Fridge Opening 36" x 74"
- ▶ Stove Opening 30"
- ▶ Hood Fan Opening 30"
- ▶ Hood Fan & Vent 6" with Under Cabinet Hood
- ▶ Dishwasher Opening 24"

Accepts Standard
Openings **Initial



OPTIONAL UPGRADED APPLIANCES to be provided by Homeowner:

- **Specs/information sheets are required and it is the responsibility of the homeowner to provide this to Zancor Homes by the due date that has been provided. If appliance specs are not submitted, Zancor Homes will not be responsible for any necessary requirements and the standard opening will be built.**



INITIAL

- ▶ Upgraded Appliance Specs are DUE 2 WEEKS FROM SIGNED DATE OF COLOUR CHART (if not received during appointment)
- ▶ ***Specs that require changes/modifications after this date will not be accepted***
- ▶ NOTE: Any upgraded appliances are to be paid by the Purchaser, directly to the appliances company.
- ▶ Additional charges to the Purchaser may apply for cabinetry, electrical and plumbing in order to accommodate the specs given by the homeowner.

FRIDGE UPGRADE

- ☐ Built-in
- ☐ Paneled **Panel to match required
- ☒ Integrated / Flush Inset
- ☐ Waterline

RANGE UPGRADE

*Larger hood fan CFM might be required, which need a larger vent

- ☐ 36" **Hood fan opening must be the same size or larger (8" vent might be required)
- ☐ 48" **Hood Fan opening must be the same size or larger (8" or 10" vent required)
- ☐ Gas Range **gas line and electrical required & sold separately
- ☐ Induction **electrical required & sold separately
- ☐ Cooktop (Apron Front) **Countertop Cut-out required & sold separately
- ☒ Cooktop (Drop-in) **countertop Cut-out required & sold separately

HOOD FAN & VENT UPGRADE

- ☐ 8 Inch **Required for 600 CFM
- ☐ 10 Inch
- ☐ Chimney Hood Fan **Vent must be centred
- ☒ Insert / Liner

WALL OVEN/MICRO UPGRADE

- ☐ Single Wall Oven **electrical required & sold separately
- ☐ Double Wall Oven **electrical required & sold separately
- ☐ Steam Oven **electrical required & sold separately
- ☐ Warming Drawer **electrical required & sold separately
- ☒ Over Then Range Microwave (OTR)
- ☐ Built-in Microwave **Trim Kit required **electrical required & sold separately

**Electrical required

DATE Sat 3/21

WASAGA SHORLINE

SITE

LOT

90

** Any upgrades checked in this appliance form must be accompanied with specs provided by the Purchaser.

**It is the responsibility of the trade to inform the Builder of any discrepancies with specs, sketches, extras and/or colour chart PRIOR to production/installation.

ZANCOR

221 North Rivermede Road, Concord, Ontario L4K 3N7 * T: (905) 738.7010 F: (905) 738.5948

THE
GALLERY

SHORELINE POINT
WASAGA BEACH

ZANCOR

INTERIOR FINISHES ACKNOWLEDGEMENT / WAIVER

Purchaser accepts and acknowledges that the Builder reserves the right to substitute materials with those of equal or better quality where the manufacture, scheduling or delivery of materials may directly impact the Builder's ability to meet its' contractual obligations under the Agreement of Purchase and Sale.

UPGRADES/EXTRAS: All upgrades and additional selections indicated on the colour chart must be accompanied by an upgrades/extras sheet (PES) and full payment otherwise the selection will be invalid. All colour charts and upgrades/extras will not proceed until verified and signed by an authorized signing officer at the Vendor's head office. **CHANGES WILL NOT BE PERMITTED UPON COMPLETION AND SUBMISSION OF THE COLOUR CHART.**

PORCELAIN & NATURAL STONES: Due to the properties of natural stones including but not limited to marble, granite, quartz, no two pieces are exactly the same. Variations in colour, tone, granularity (pitting, fissures) and pattern are to be expected, including various lighting may affect the overall finished look. Stone tops are sealed at time of installation and should never be cleaned with lemon oil or vinegar. Stones are porous materials, therefore any spilled substance require immediate attention. Stone countertops require regular seal re-application as part of home maintenance. Purchaser acknowledges colour and product variations as well as natural imperfections may exist with the selection of natural stone materials and shall not hold the Vendor liable for provision of same.

STONE COUNTERTOP JOINTS: Purchaser is aware that one joint will be at each corner and on either side of slide-in-range (if applicable). It will also be where the length of the counter top exceeds the length of a stone slab. Slabs are usually approximately 5'x 8'.

CERAMIC TILES: Due to manufacturing, shade (dye lots), product variations may exist that can affect the overall look of the finished product. Although every effort will be made to ensure the colours and materials selected are as close as possible to the samples, the purchaser acknowledges that the sample tiles supplied in the Design Centre may not be identical to the materials installed in the home.

STAR STAINS: Due to the natural properties of wood, many variables can affect the overall look of the finished product. Factors including but not limited to wood type, knotting, graining, density, age, humidity, and air temperature can result in substantial variations in stain intensity. The purchaser accepts that although the Vendor will do their best to match stain the unfinished stairs as close as possible to the pre-finished floors, it is not possible to have an identical match and that there MAY be shade differences between the two products.

CABINETRY: Due to the natural properties of wood, slight variations apparent with cabinetry are to be expected. This includes but not limited to wood species, wood grain, colour, finish, product variations, and natural imperfections are all factors that may affect the overall look of the finished product. Such factors make exact colour matching impossible. The type and intensity of lighting in the areas of designated cabinetry placement may also highlight characteristics of cabinetry finish. All cabinets shall be finished with a white melamine interior box unless a finished interior is upgraded. Due to building specifications and/or on-site conditions, certain cabinetry upgrades may not be possible. The purchaser acknowledges that the Builder cannot guarantee the cabinetry finish or provision of certain upgrades and shall not hold the Builder liable for provision of same.

UPGRADES/EXTRAS: All upgrades and additional selections indicated on the colour chart must be accompanied by an upgrades/extras sheet (PES) and full payment otherwise the selection will be invalid. All colour charts and upgrades/extras will not proceed until verified and signed by an authorized signing officer at the Vendor's head office. **CHANGES WILL NOT BE PERMITTED UPON COMPLETION AND SUBMISSION OF THE COLOUR CHART.**

HARDWOOD / LAMINATE FLOORING: Due to the properties of wood and laminate, many variables can affect the overall look of the finished product. Variations include but not limited to wood type or laminate finish, colour/stain and wood grain are significant factors that make exact colour matching impossible. The purchaser acknowledges that the hardwood flooring is a pre-finished product in a controlled environment. Expansion, compression and cupping are characteristics of hardwood flooring once installed in the home. The purchaser acknowledges these may become apparent over time and despite the Builders' efforts to install the hardwood flooring materials in keeping with good workmanship, the Builder shall not be responsible nor held liable for minor variances of fluctuation in hardwood flooring materials.

HARDWOOD / LAMINATE WAIVER:

I/We understand hardwood flooring is classified as a porous material and as such not recommended by the Builder in certain areas. I/We understand there is a concern due to possible water and other substances being frequently splashed or spilled onto the floor and in contravention of Ontario Building Code Section 9.30.1.2(1).

"Finished flooring bathrooms, kitchens, public entrance halls, laundry & general storage areas shall consist of resilient flooring, felted-synthetic-fibre floor coverings, concrete, terrazzo, ceramic tile, mastic or other types of flooring providing similar degrees of water resistance."

I/We are prepared to assume full responsibility for any damage caused to the hardwood floor or subfloor due to moisture absorbency in the mentioned areas, and agree to waive any claims against the Township of residence, TARIION and/or the Builder in relation to the matter. ****SEE COLOUR CHART FOR LOCATIONS****

DATE	Sept 3/21	SITE	WASAGA SHORELINE	LOT	90
------	-----------	------	------------------	-----	----

221 North Rivermede Road, Concord, Ontario L4K 3N7 * T: (905) 738-7010 F: (905) 738-5948

THE
GALLER Y
BY ZANCOR

SHORELINE POINT
WASAGA BEACH

ZANCOR

HOME AUTOMATION (Cable, CAT5/6, Telephone)

INCLUDED IN SCHEDULE "A" IN AGREEMENT OF PURCHASE AND SALE:

- Rough-in for Central Vacuum system piped to garage
- Rough-in for Telephone (2) locations
- Rough-in for Cable TV (2) locations
- Rough-in for Cat-6 Network (3) locations

CONTACT:

I/we the Homeowner(s) have chosen to contact the Home Automation Company to select the locations of the rough-ins for Cable, CAT5, Telephone as included in our Agreement of Purchase Sale.

I/we the Homeowner(s) will contact the trade within 4 weeks of the date of this release to select locations of the standard rough-ins review other optional products for purchase.

Trade: Smart-Tech Home Automation
Phone: (905) 761-6469
Email: kris@smart-tech.ca
Rep: Kris
Location: 200 Millway Avenue, Unit 8
Concord, Ont L4K 5K8

ACKNOWLEDGEMENT:

I/We the homeowner(s) acknowledge that if I/We the homeowners decide to not contact Smart-Tech, locations of the standard rough-ins will be installed as per Vendors discretion.

Homeowner(s) Initial

SC AB

WASAGA SHORELINE

DATE Sept 3/20

SITE

LOT

90

BRICK/JOINT PATTERN INSTALLATION RELEASE FORM

BRICK installation is included as a standard on the floor for 12 x 24 tiles and must be noted on the colour chart and acknowledged on this form

(Large tiles installation for floor and wall) – ¼ Brick

Please be advised it has come to our attention, that due to production, many of the over-sized and odd shaped, man-made tiles (i.e. porcelain & ceramic), have been found to have a slight bow in the tile. It is a standard occurrence with all suppliers and manufacturers.

It is therefore recommended, that if and when a purchaser requests to install one of these tiles in a brick-joint pattern, that it be installed on a ¼ brick pattern, to try to avoid lippage. Attached with this letter, you will find a layout of the ¼ brick installation that has been recommended.

LOCATIONS: loges, laundry, Master Ensuite, kitchen, breakfast, powder
LOCATIONS: _____
LOCATIONS: Guestroom - loges

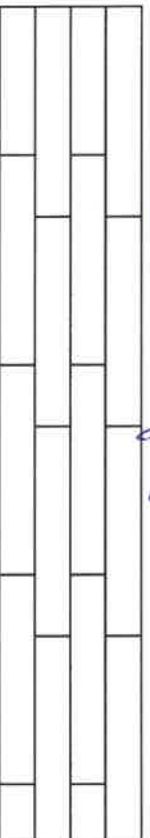

Please understand, even in using this ¼ brick installation, there may still be minimal lippage which cannot fully be eliminated.

Hence, when there is a request for brick-joint installation, Zancor Homes and their contractor, cannot be held responsible for this matter.

Homeowner(s) Initial

LM

(Small tile installation for walls) – ½ Brick

Purchaser requests to install small wall tiles on a backsplash or shower wall in a brick-joint pattern, that it be installed on a ½ brick pattern.

LOCATIONS: _____
LOCATIONS: _____
LOCATIONS: _____
LOCATIONS: _____

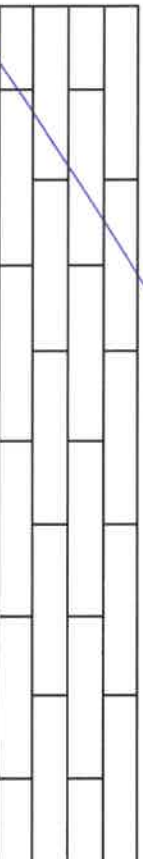

Homeowner(s) Initial

DATE Sept 3/21

SITE WASAGA SHORELINE

LOT 90

Stone Countertop Edge Profiles

Where applicable as per site specifications

STANDARD EDGE FOR KITCHEN & VANITIES

Standard Countertop Edge in
Kitchen

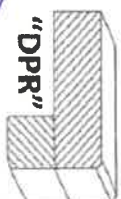

Standard Countertop Edge in
Vanity

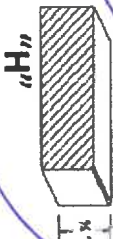

Handwritten initials/signature

Homeowner(s) Initial

OPTION (1) EDGE FOR KITCHEN & VANITIES \$250

Optional Edge in Kitchen

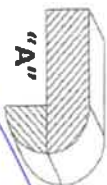
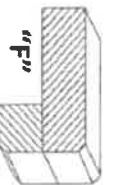
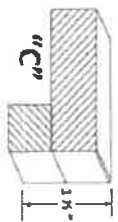

Optional Edge in Bathroom

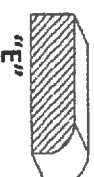
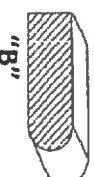
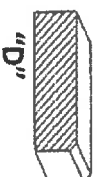

Homeowner(s) Initial

OPTION (2) EDGE FOR KITCHEN & VANITIES CUSTOM PRICING

Optional Edge for Kitchen

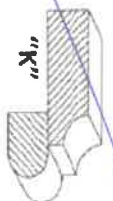
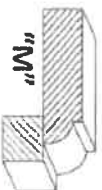
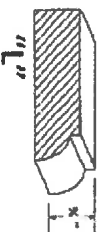

Optional Edge in Vanity

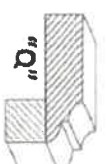
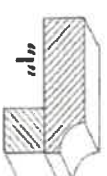
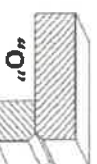
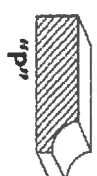

Homeowner(s) Initial

DATE Sept 3/21

SITE WASAGA SHORELINE

LOT

90