

CONSTRUCTION SUMMARY OF EXTRAS
Printed 2021-08-26 / 2:51 PM / Page 1 of 1

Site:
Lot:
Model:
Purchaser:
Purchaser:
Phone:

WASAGA SHORELINE
4
CORAL (60-04) C
ANDY LU
CATHY LEE
0
LEECATHY123@GMAIL.COM /
LUANDY2020@GMAIL.COM

Email:



	DESCRIPTION	DATE SELECTED
	BONUS PACKAGE: 3 PIECE STAINLESS STEEL APPLIANCES WITH WHITE TOP LOAD WASHER & DRYER	INCLUDED IN APS
	BONUS PACKAGE: STAINLESS STEEL HOOD FAN	INCLUDED IN APS
1	MAIN BATH - FRAMELESS GLASS SHOWER IN LIEU OF TUB *INCLUDES SHOWER POTLIGHT	AUG 11 2021
2	KITCHEN - BUILT-IN WALL OVEN COMBO WITH DRAWER BELOW	AUG 11 2021
3	ELECTRICAL - 40 AMP FOR WALL OVEN	AUG 11 2021
4	KITCHEN - COOKTOP WITH POT DRAWERS BEDLOW (SOFT CLOSE) **STANDARD 40 AMP CAN BE USED FOR THIS AS PER SPEC	AUG 11 2021
5	COOKTOP CUT OUT IN COUNTERTOP	AUG 11 2021
6	KITCHEN - DELETE UPPERS ABOVE ABOVE FRIDGE FOR FUTURE CHIMNEY HOOD FAN *CENTRE VENT	AUG 11 2021
7	KITCHEN - FRIDGE ENCLOSURE	AUG 11 2021
8	KITCHEN - CONVERT STANDARD POT DRAWERS INTO STANDARD BANK OF DRAWERS (WITH STANDARD SOFT CLOSE) ****BOTH SETS OF BANK OF DRAWERS TO BE APPROXIMATELY 18 INCHES WIDE****	AUG 11 2021
9	KITCHEN - BASE CORNER CABINET	AUG 11 2021
10	KITCHEN - ADD TOP DRAWER IN ISLAND	AUG 11 2021
11	ELECTRICAL - SEE LOCATION FOR STANDARD PLUG IN ISLAND	AUG 11 2021
12	ELECTRICAL - (4) POTLIGHTS IN LIBRARY, NOTE ****INSTALL THE LIGHTS 40 INCHES IN FROM EACH WALL	AUG 11 2021
13	KITCHEN -MATCHING LIGHT VALANCE	AUG 11 2021
14	ELECTRICAL - ADD UNDER CABINET LED LIGHTING	AUG 11 2021
15	ELECTRICAL - INSTALL STANDARD KITCHEN LIGHT TO BE CENTRED OVER THE ISLAND	AUG 11 2021
16	ELECTRICAL - ADD (1) CAPPED WALL LIGHT ABOVE SINK IN MASTER ENSUITE & SHIFT OVER THE STANDARD TO BE CENTRED ON THE WALL ABOVE THE OTHER SINK	AUG 11 2021
17	CABINETS - LAUNDRY UPPERS	AUG 11 2021
18	CABINETS - MASTER ENSUITE - ADD BANK OF DRAWERS BETWEEN SINKS *SOFT CLOSE	AUG 11 2021
19	ELECTRICAL - ADD PLUG ABOVE THE FIREPLACE APPROX 65 INCHES ABOVE FLOOR **CABLE ROUGHIN BESIDE	AUG 11 2021
20	BASEMENT - ADD SECOND DOOR TO BASEMENT FOYER	AUG 11 2021
21	SHOWER FLOOR IN MASTER ENSUITE AND MAIN BATH	AUG 11 2021
22	HARDWOOD - UPGRADE COLOUR	AUG 11 2021
23	STAIN STAIRS TO MATCH HARDWOOD AS CLOSE AS POSSIBLE	AUG 11 2021
24	CABINETS - COMFORT HEIGHT IN MASTER ENSUITE	AUG 11 2021
25	CABINETS - COMFORT HEIGHT IN MAIN BATH	AUG 11 2021
26	INTERIOR DOOR - 1 LITE MIRROR DOOR FOR POWDER ROOM	AUG 11 2021
27	KITCHEN BACKSPLASH - 12 X 24 FLOOR TILES **HORIZONTAL WITH THE FULL TILE AGAINST THE COUNTERTOP **INCLUDES BEHIND CHIMNEY	AUG 11 2021
28	WATERLINE TO FRIDGE	AUG 11 2021

ZANCOR HOMES COLOUR CHART

PRINTED 2021-08-11, 11:49 AM

ENTRANCES				
Main Foyer - FLOORING		LOFT DOVE 12 X 24 *BRICK	✓	
Mudroom - FLOORING		LOFT DOVE 12 X 24 *BRICK	✓	
Side Hall - FLOORING		N/A		
Basement Foyer - FLOORING		NEW BYZANTINE ASSURO 12 X 24 *BRICK		
KITCHEN				
Kitchen - FLOORING		NEW BYZANTINE ASSURO 12 X 24 *BRICK	✓	
Breakfast - FLOORING		NEW BYZANTINE ASSURO 12 X 24 *BRICK	✓	
Kitchen - CABINETS		EURO HIGH GLOSS WHITE	✓	
Island - CABINETS		EURO HIGH GLOSS WHITE	✓	
Servery - CABINETS		N/A		
Kitchen - HANDLES/KNOBS		DOORS K200BC / DRAWERS H500BC	✓	
Kitchen - COUNTERTOP		LAMINATE 5006K-07	✓	
Island - COUNTERTOP		LAMINATE 5006K-07	✓	
Kitchen - BACKSPLASH **INCL BEHIND CHIMNEY		NEW BYZANTINE12 X 24 **HORIZONTAL **FULL TILE TO BE AGAINST COUNTERTOP**	✓	
Kitchen - SINK		STANDARD		
Kitchen - FAUCET		STANDARD		
GREAT ROOM / DINING / LIVING / DEN / OFFICE / BASEMENT				
Family / Great Room - FLOORING		HARDWOOD - MIRAGE OAK CASHMERE - RIO 3-5/16"		✓
Main Hall - FLOORING		HARDWOOD - MIRAGE OAK CASHMERE - RIO 3-5/16"		✓
Dining / Living Room - FLOORING		HARDWOOD - MIRAGE OAK CASHMERE - RIO 3-5/16"		✓
Library / Den - FLOORING		HARDWOOD - MIRAGE OAK CASHMERE - RIO 3-5/16"		✓
Basement Rec Room - FLOORING		NEW BYZANTINE ASSURO 12 X 24 *BRICK		✓
STAIRS				
Railing Details - PICKETS		STANDARD METAL - SINGLE COLLAR WITH ALT PLAIN		✓
Railing Details - POSTS		STANDARD TURNED OAK		
Railing Details - HANDRAIL		STANDARD OVAL OAK		
Stair Stain - MAIN STAIRS		STAIN TO MATCH HARDWOOD AS CLOSE AS POSSIBLE		
Stair Stain - BASEMENT STAIRS (if applicable)		STAIN TO MATCH HARDWOOD AS CLOSE AS POSSIBLE		✓
Stair Stain - SERVICE STAIRS (if applicable)		N/A		
POWDER ROOM				
Powder Room - FLOORING		NEW BYZANTINE GREY 12 X 24 *BRICK		✓
Powder Room - CABINETS		PEDESTAL SINK		
Powder Room -		N/A		
Powder Room - SINK		PEDESTAL SINK		
Powder Room - FAUCET		STANDARD		
2ND FLOOR				
Upper Hall - FLOORING		N/A		
Master Bedroom - FLOORING		CARPET - OPENING NIGHT COLOUR T15 w/STANDARD UNDERPAD		✓
Bedroom 2 - FLOORING		CARPET - OPENING NIGHT COLOUR T15 w/STANDARD UNDERPAD		✓
Bedroom 3 - FLOORING		CARPET - OPENING NIGHT COLOUR T15 w/STANDARD UNDERPAD		✓
Bedroom 4 - FLOORING		N/A		
Bedroom 5 - FLOORING		N/A		
Master Ensuite - FLOORING		GENESIS TAUPE 12 X 24 *BRICK	✓	
Master Ensuite - SHOWER WALL		NEW BYZANTINE GREY 12 X 24 *VERTICAL STACKED		✓
Master Ensuite - SHOWER FLOOR		ONTARIO HEX TAUPE MATTE		✓
Master Ensuite - SHOWER JAMB		BIANCO CARRARA	✓	
Master Ensuite - CABINETS		EURO BLACKWOOD	✓	
Master Ensuite - HANDLES/KNOBS		DOORS K200BC / DRAWERS H500BC	✓	
Master Ensuite - COUNTERTOP		LAMINATE - 6697-58	✓	
Master Ensuite - SINK(S)	STANDARD	Master Ensuite - FAUCET(s)		STANDARD
FOR TRADE USE				
Any upgrades in the colour chart must be accompanied with a PES. It is the responsibility of all trades to inform the builder of any discrepancies on sketches, PES and/or colour charts <u>PRIOR</u> to installation.		WASAGA SHORELINE 4		SIGNATURES
			PURCHASER INITIALS	VENDOR APPROVAL

2ND FLOOR CONTINUED ...						
Main Bath - FLOORING	GENSIS LIGHT GREY 12 X 24 *BRICK		✓			
Main Bath - TUB / SHOWER WALL	NEW BYZANTINE ASSURO 12 X 24 *VERTICAL STACKED			✓		
Main Bath - SHOWER FLOOR	ONTARIO HEX DARK GREY MATTE		✓			
Main Bath - SHOWER JAMB	BIANCO CARRARA		✓			
Main Bath - CABINETS	SHAKER TUXEDO		✓			
Main Bath - HANDLES/KNOBS	DOORS K200BC		✓			
Main Bath - COUNTERTOP	LAMINATE - 4925K-07		✓			
Main Bath - SINK(s)	STANDARD	Main Bath - FAUCET(s)	STANDARD			
Shared Bath- FLOORING	N/A					
Shared Bath- TUB / SHOWER WALL	N/A					
Shared Bath- SHOWER FLOOR	N/A					
Shared Bath- SHOWER JAMB	N/A					
Shared Bath- CABINETS	N/A					
Shared Bath- HANDLES/KNOBS	N/A					
Shared Bath- COUNTERTOP	N/A					
Shared Bath- SINK(s)		Shared Bath - FAUCET(s)				
Ensuite Bath - FLOORING	N/A					
Ensuite Bath - TUB / SHOWER WALL	N/A					
Ensuite Bath - SHOWER FLOOR	N/A					
Ensuite Bath - SHOWER JAMB	N/A					
Ensuite Bath - CABINETS	N/A					
Ensuite Bath - HANDLES/KNOBS	N/A					
Ensuite Bath - COUNTERTOP	N/A					
Ensuite Bath - SINK(s)		Ensuite Bath - FAUCET(s)				
LAUNDRY						
Laundry - FLOORING	LOFT DOVE 12 X 24 *BRICK	✓	Laundry - HANDLES/KNOBS	K200BC		
Laundry - CABINETS (LOWERS / UPPERS)	HIGH GLOSS WHITE		Laundry - SINK	STANDARD		
Laundry - COUNTERTOP	LAMINATE 1887K-22		Laundry - FAUCET	STANDARD		
Laundry - BACKSPLASH	N/A					
TRIM / PAINT						
Casing/Baseboards	STANDARD					
Interior Doors	STANDARD					
Interior Door Hardware	STANDARD					
PAINT - Throughout	COOL WHITE					
FIREPLACE						
STANDARD ELECTRIC						
ACCESSORIES						
Mirrors	YES	BATH ACCESSORIES	YES			
APPLIANCE REQUIREMENTS						
GAS LINE TO BBQ	YES	ELECTRICAL for Built-in Oven	YES			
GAS LINE & ELECTRICAL TO STOVE	DECLINED	ELECTRICAL for Built-in Micro	N/A			
GAS LINE & ELECTRICAL TO DRYER	N/A	ELECTRICAL for Cooktop	YES			
HOOD FAN VENT SIZE	6 INCH	ELECTRICAL for Bar Fridge	N/A			
WATERLINE to Fridge	YES					
DISCLAIMER						
Any changes to the colour chart after signing are subject to a \$5000 administration fee plus costs						
Purchaser has checked and acknowledged accuracy of colour and selections before signing.						
Colours of all materials are as close as possible to Builders selection but not necessarily identical due to dye lot variances in manufacturing/manufacturers. Due to construction progress some items may have been pre-selected or installed. In this event the Vendor's selection must be accepted by the purchaser						
SITE / LOT: WASAGA SHORELINE 4						
PURCHASER(S):		ANDY LU				
PURCHASER(S):		CATHY LEE				
CONTACT:		0		LEECATHY123@GMAIL.COM / LUANDY2020@GMAIL.COM		
FOR TRADE USE						
Any upgrades in the colour chart must be accompanied with a PES. It is the responsibility of all Trades to inform the builder of any discrepancies on sketches, PES and/or colour charts PRIOR to installation.			SIGNATURES / DATE			
PURCHASER SIGNATURE						
PURCHASER SIGNATURE						
DÉCOR CONSULTANT			SIMONE			
Vendor APPROVAL						
PAGE 2 OF 2						

HOME APPLIANCES

LG REFRIGERATION

LMXS28626
28 cu.ft. 4-Door French Door Refrigerator



- 27.8 cu.ft.
- Slim SpacePlus® Ice System
- Spill Protector™ Tempered Glass Shelf / 1 Folding Shelf
- 2 Humidity Crispers
- 6 Door Bins (2 Adjustable Gallon Sized)
- Smart Cooling Plus System
- 10 Year Limited Manufacturer's Warranty on Linear Compressor
- Fresh Air Filter, Evaporator, Multi-Air Flow
- SmartDiagnosis™ System
- ENERGY STAR® Qualified

SmartThinQ™

Enjoy new ways to control your home with LG smart appliances

- Get an alert when kids forget to close the door
- Make more ice while you're at work
- Works with LG SmartThinQ™ app, the Google Assistant and Amazon Alexa

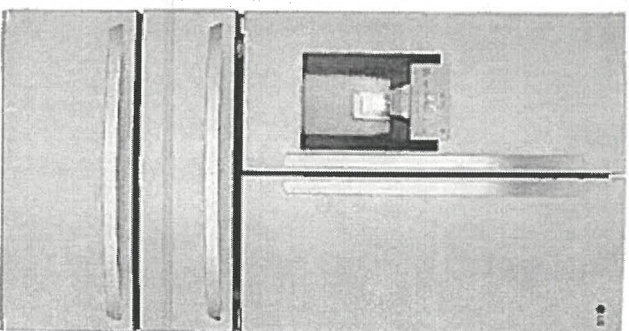

PRODUCT FEATURES

CAPACITY	
Refrigerator (cu.ft.)	18.6
Freezer (cu.ft.)	9.2
Total (cu.ft.)	27.8
FEATURES	
Energy Consumption (kWh/Year)	72.4
ENERGY STAR® Qualified	Yes
SmartThinQ™	
SmartDiagnosis™	Yes
WATER & ICE SYSTEM	
Ice & Water Dispenser	Yes
Dispenser Type	Integ. dtd
Daily Ice Production (lbs)	3.5
IcePlus™ Production (lbs)	3.8
Ice Storage Capacity (lb)	2.5 • 4.0
Ice System	Slim SpacePlus™
Dispenser Light	Yes
Water Filter	LT1000P
COOLING	
Linear Compressor	Yes
Smart Cooling® System	Yes
Multi-Air Flow Cooling	Yes
Temperature Sensors	6
Fresh Air Filter	Yes
Evaporator	Yes
CONVENIENCE	
Display Type	Membrane / White LED
Temperature Control	Electronic/Digital
Child Lock	Yes
Auto Closing Door Hinge	Yes
LockProbe™ Quiet Operation	Yes
REFRIGERATOR	
No. of Shelves	4 Sp. (1.3 Fixed • 1 Folding)
Folding Shelf	1
Carriervered Shelves	Hybrid Carriervered
Shelf Construction	Spill Protector™ Tempered Glass
Crisper Bins	2 Humidity Crispers
Guide-In Service Drawer	Yes
Refrigerator Light	Ceiling LED

REFRIGERATOR DOOR	
No. of Bins	6 Total (2 Adjustable Gallon Sized)
Door Bin Construction	1 Piece (Clear)
FREEZER	
Door Type	Full Drawer
Drawers	2-Tier Organization
Drawers	Yes
Drawer Divider	Yes
Freezer Light	LED Lighting
Freezer Handle	Visa
MATERIALS AND FINISHES	
Contour Door	Yes
Hidden Hinges	Yes
Surface	Smooth
Back	Flush & Metal Cover Over Mechanical Parts
Handles	Matching Contoured Handles
At-A-Glance Cover	PrintProof™ Stainless Steel Black Stainless Steel
DIMENSIONS/CLEARANCES/WEIGHTS	
Depth w/ Handles	36.114"
Depth w/ Door Open	33.314"
Depth w/ Door Closed	29.718"
Depth (Total w/ Door Open)	48.114"
Height to Top of Case	68.318"
Height to Top of Door Hinge	69.314"
Width	35.314"
Width (Door Open 90° w/ Handle)	44.114"
Width (Door Open 90° w/ Handle)	39.114"
Installation Clearance	Top 1" Back 2"
Weight (Net/Total)	322 lbs. / 347 lbs.
Carton Dimensions (WxHxD)	36" x 73" x 39"
LIMITED WARRANTY	
Parts & Labor	1 Year
Sealed System	7 Years
Linear Compressor	10 Years
UPC CODES	
LMXS28626S PrintProof™ Stainless Steel	010231794707
LMXS28626D Black Stainless Steel	010231794770

© 2017 LG Electronics, Inc. All rights reserved. "Life's Good" is a registered trademark of LG. All other product and brand names are trademarks or registered trademarks of their respective owners. Design features and specifications are subject to change without notice. Non-metric weights and measurements are approximate. Measurements may vary by product and are subject to change without notice. (201707)

4 Vasaga

APPL CANADA

APPLIANCE CANADA VAUGHAN, 8701 JANE ST. UNIT 1, VAUGHAN, ON, L4K 2M6

Page 1 of 1

CUSTOMER

SALES ORDER INFORMATION

DOCUMENT NUMBER

LU ANDY

TYPE: SALES ORDER/INVOICE

07171AJBNAL

LOT 4

DEL/Pu: D

WASAGA BEACH, ON

ZONE: A/C

SALESPERSON(S)

L9Z1V1

DAY: TBA

STEVE M

Hm: 416-806-2155

DATE: TBA

Wk: 416-806-2155

A

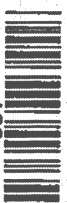

ACC

Order Sort: R

DELIVERY/PICKUP DATE WILL BE CONFIRMED AND SCHEDULED UPON ARRIVAL OF PRODUCT FROM SUPPLIERS.

QTY	ITEM CODE	W	VEND	DESCRIPTION	EXTD PRICE
1	B015555S		004C	WCESLUSOHS ✓	\$ 646.00 ✓
1	02L3515T		0860	LWC3063ST ✓	\$ 2761.32 ✓
1	02L3426S	LG	0860	LMXS28626S ✓	\$ 1805.86 ✓
1	26A0597S		013C	AVH-308CS ✓	\$ 690.00 ✓
1	B015630M		004C	WDF560SAFM ?	\$ 200.00 ✓
				w/tpool	

For Your Home,
For Your Life.

07171AJBNAL

SPECIAL NOTES

INSTALLATION NOT INCLUDED

*Taxes and Surcharges are subject to change	MERCH SUBT. \$ DELIVERY \$ TAXABLE TOTAL \$ GST/HST \$ PST/OST \$ TOTAL \$ DEPOSIT \$ BALANCE DUE \$	6103.18 .00 6103.18 793.41 .00 6896.59 500.00 6396.59
--	---	--

TRAN TYPE	AMOUNT	ACCT.	ACCOUNT NUMBER	MERCHANT #	FIN CODE	APPROVAL	DATE/TIME
TEL+MAIL/TEL+POS	500.00	CDN AMEX	*****1004	44148802	M	138738	19-JUL-2021 07:38:21
				NO B12	BATCH 004		00001 APPROVED TRANACTOR 181

FOR CUSTOMER SERVICE INQUIRIES
Please call your store : 905-660-2424
or email: concierge@appliancecanada.com

AC0007472

4

OK

PAYMENT OPTIONS

- ☐ STANDARD REVOLVING
☐ EQUAL MONTHLY PAYMENTS PROMOTIONAL OFFER
☐ MONTHS NO INTEREST NO PAYMENT PROMOTIONAL OFFER

DATE: 17-JUL-2021 23:22:37
CUSTOMER SIGNATURE(S):

IMPORTANT: Retain this copy for your records.

AVG

AVH-308CS
30" Wall mounted hood - MSRP: \$819.00

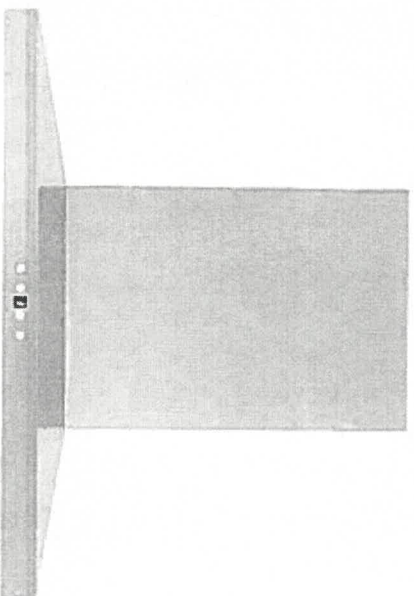

Model	AVH-308CS	
Features		
Control	Soft touch with LED display	
Lighting	2 bulbs, 3W LED (bulbs included)	
Blower type	860 CFM, 6-Speed	
Blower performance	Speed 1, 2.4 sones	
Filter type	Speed 6, 6.2 sones	
Duct transition	2 aluminum micro hole filters (included)	
Ducting	2 Stainless steel baffle filters (included)	
Chimney (ducted out)	6" Round (Top)	
Ducted		
For ceiling heights up to 9'0"		
Exterior Appearance		
Stainless steel grade	201	
Electrical Requirements		
Electrical requirements	120V / 60Hz / 2.7 Amps	
Dimensions		
Dimensions	29 1/2" (W) x 19 3/4" (D) x 3 1/4" (H)	
Warranty		
1-year Warranty	Parts and labour, in-home service	

The information contained herein is based on sources that we believe to be reliable, but is not guaranteed by us, may be incomplete or may change without notice

4 Weeks

- Use the countertop opening dimensions that are given with these installation instructions. Given dimensions are minimum clearances and provide 0" (0 cm) clearance.
 - Grounded electrical supply is required. See "Electrical Requirements" section.
- IMPORTANT:** To avoid damage to your cabinets, check with your builder or cabinet supplier to make sure that the materials used will not discolor, delaminate, or sustain other damage.

Product Dimensions

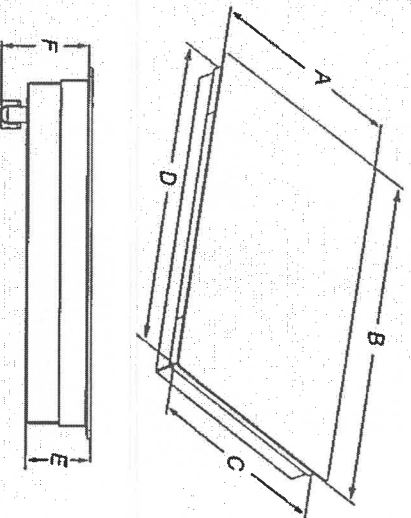

- A. Glass depth - black and white models - 21^{3/4}" (55.2 cm)
Glass depth - Whirlpool and Maytag stainless steel models - 22^{1/4}" (58.0 cm)
- B. Glass width - 24" (60.9 cm) models - 23^{1/4}" (54.9 cm)
Glass width - 30" black and white (76.2 cm) models - 30^{3/4}" (78.4 cm)
Glass width - Whirlpool and Maytag 30" stainless steel (76.2 cm) models - 30^{3/4}" (78.4 cm)
Glass width - KitchenAid 30" stainless steel (76.2 cm) models - 30^{1/2}" (77.1 cm)
Glass width - 36" black and white (91.4 cm) models - 36^{1/4}" (92.3 cm)
Glass width - Whirlpool 36" stainless steel (91.4 cm) models - 36^{1/4}" (92.3 cm)
Glass width - Maytag 36" stainless steel (91.4 cm) models - 36^{1/4}" (91.5 cm)
Glass width - KitchenAid 36" stainless steel (91.4 cm) models - 35^{1/2}" (91.0 cm)
- C. Frame depth - 20^{1/4}" (51.6 cm)
- D. Frame width - 24" (60.9 cm) models - 21^{3/4}" (55.7 cm)
Frame width - 30" (76.2 cm) models - 29" (73.7 cm)
Frame width - 36" (91.4 cm) models - 34^{1/4}" (87.5 cm)
- E. Cooktop height with bottom heat shield - 3^{1/2}" (9.8 cm)
- F. Cooktop height including knobs (located at rear of cooktop, right side) - 5" (12.7 cm)
- G. Cooktop height including knobs, including conduit (located at rear of cooktop, right side) - 6^{1/4}" (15.4 cm)

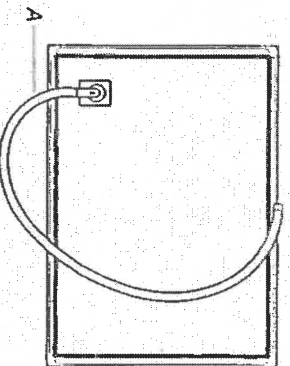

A. Location of Power Cord (length of power cord is 48" (121.9 cm), including the conduit)

Cabinet Dimensions

IMPORTANT: If installing a range hood or microwave hood combination above cooking surface, follow the range hood or microwave hood combination installation instructions for dimensional clearances above the cooktop surface.

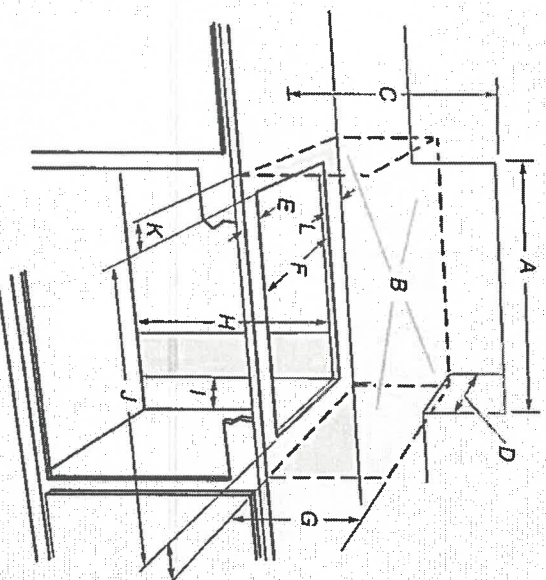

- A. 24" (60.9 cm) on 24" models; 30" (76.2 cm) on 30" models; 36" (91.4 cm) on 36" models
- B. Combustible area above countertop (shown by dashed box above)
- C. 30" (76.2 cm) minimum clearance between top of cooktop platform and bottom of uncovered wood or metal cabinet (24" (61 cm) minimum clearance if bottom of wood or metal cabinet is covered by not less than 1/4" (0.6 cm) flame retardant millicord covered with not less than No. 28 MSG sheet steel, 0.015" (0.04 cm) stainless steel, or 0.024" (0.06 cm) aluminum or 0.020" (0.05 cm) copper)
- D. 13" (33 cm) recommended upper cabinet depth
- E. 2" (5.1 cm)
- F. 20^{1/2}" (52.0 cm) recommended cutout.
- G. 18" (45.7 cm) minimum clearance from upper cabinet to countertop within minimum horizontal clearances to cooktop
- H. Junction box or outlet: 7" (17.8 cm) minimum from top of countertop
- I. Junction box or outlet: 9" (23.0 cm) maximum from right side of cabinet
- J. 29^{1/2}" (74.9 cm) recommended cutout on 30" (76.2 cm) models. Will fit in cutout from 29^{1/4}"-29^{3/4}" (73.8-75.1 cm) on 30" (76.2 cm) models.
- K. 35^{1/2}" (90.2 cm) recommended cutout on 36" (91.4 cm) models. Will fit in cutout from 34^{1/4}"-35^{1/4}" (87.8-90.3 cm) on 36" (91.4 cm) models.
- L. 22^{1/4}" (56.67 cm) recommended cutout on 24" (61.0 cm) models. Will fit in cutout from 22^{1/4}"-22^{3/4}" (56.4-57.0 cm) on 24" (61.0 cm) models.
- M. 2^{1/2}" (6.35 cm) minimum distance to nearest left and right side combustible surface above cooktop
- N. 1^{1/2}" (3.81 cm) minimum clearance between back wall and countertop

NOTES: After making the countertop cutout, some installations may require notching down the base cabinet side walls to clear the cooktop base. To avoid this modification, use a base cabinet with sidewalls wider than the cutout.

If cabinet has a drawer, a 5^{1/2}" (14.0 cm) depth clearance from the top of the countertop to the top of the drawer (or other obstruction) in base cabinet is required.

40AMP

4000



HOME APPLIANCES
LG COOKING
LWMC3063_
Combi Wall Oven

1.7 cu.ft. Microwave (Speed Oven)
Infrared Heating™
4.7 cu.ft. Oven
True Convection
Steam Cooking
Self+EasyClean
SmartThinQ® Technology



Enjoy new ways to control your home with LG smart appliances

- Start or stop your Oven remotely
- Set your Monitor Status from your smartphone
- Works with the LG SmartThinQ® app

Available on the Google Assistant Alexa™ innit™ voiceTRIF

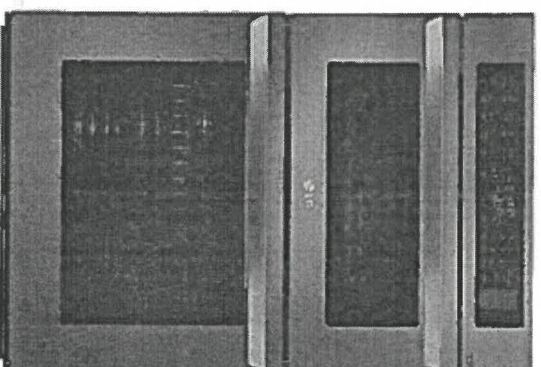

SMART APPLIANCE

SUMMARY	
Total Oven Capacity (cu. ft.)	6.4 (Upper & Lower)
Colors	Stainless Steel / Black Stainless Steel
UPPER OVEN FEATURES	
Capacity (cu.ft.)	1.7
Interior (Cavity) - Upper/AMO / Lower Oven	Stainless / Enamel Coating
Microwave Power output	950W
Microwave made power consumption	1550W
Convection Bake made power consumption	1600W
Bread make power consumption	1300W
Convection Element (W)	1500W (Shallow heater)
Bread Upper Element (W)	1200W (ISOOW + 700W)
Bread Lower Element (W)	375W
Microwave	Yes
Convection Bake	Yes
Bake	Yes
Speed cook	Yes
- # of Defrost (4 Menu)	Meat / Poultry / Fish / Bread
- # of Sensor cook (9 Menu)	Beverage / Casserole / Chicken / Pasta / Pizza / Plate of food / Rice / Soup / Vegetable
- # of Auto cook (28 Menu)	Baked (regular steam) / Bagel (frozen) / Baked potatoes (2-9 cu.ft.) / Baguette / Cold filled (1 lb) / Corn dog (frozen) / Fresh vegetable / Frozen chicken wings / Frozen fish / Frozen skinless hoglets / Frozen pizza (regular crust) / Frozen soft pretzels / Frozen vegetable / Garlic bread (frozen) / Hamburger (1/2 lb) / Lamb chops (1/2" thick, 6-8 oz) / Pork chops (1/2" thick, 6-8 oz) / Pork steak (1" thick, 14-15oz) / Rice / Salmon steak (1" thick) / Sausage / Sirloin steak (1" thick, 18-21oz) / Tenderloin Vegetable carving
- # of Soften (Menu)	Butter / Cream Cheese / Frosting / Ice Cream
- # of Heat (Steam)	Butter / Cheese / Cheese / Chocolate / Marshmallow
LOWER OVEN FEATURES	
Capacity (cu.ft.)	4.7
EasyClean®	Yes
Self Clean	Yes (3-4.5 hours)
Variable heating time	Yes (3-4.5 hours)
Variable broil	Yes (Full Center / High/Low)
Broil element	2,500 watts (over / 1,500 watts (under
Bake element	2,500 watts
# of rack position	Hidden (8 pass)
1/2 hrs. shut-off	5
- # of light	Yes
Convection conversion	2 (Halogen Lamp)
- Convection element	Yes
Convection System/Mode/Cooking System	True Convection
Convection Fan	Single Speed
Oven Cooling mode	Con/Bake / Con/Bake / Bake / Bake / Steam Bake / Steam Roast / Probe / more mode (variable/Manual/Probe)
Oven Control Features	Gas Touch (SmoothTouch™)
Door Lock	Yes

CONTROL	
Oven Control Type	Glass Touch (SmoothTouch™)
Display	White TFT
Language	English / Spanish / French
Smart Function	Wi-Fi / Smart Butler
Clock	12 hr or 24 hr (option)
Kitchen Timer	Yes
Temp Cook	Yes
Temperature Unit of Measure	Fahrenheit / Celsius
Cooking Completion Reminder Volume	Beeper (1 Loud, 2 Low, 3 Mute)
Submitt Mode	Yes
Appearance	Stainless Steel / Black Stainless Steel
Available Colors	Stainless Steel Finish (Aluminum)
Handle/Knob	Black Stainless Steel Finish (Aluminum)
Oven Door Feature	WideView™ Window
Scratch Resistant	Yes
PratProof™ Finish	Yes (Black Stainless Steel Only)
SmartThinQ® SMART FEATURES	
SmartThinQ®	Yes
Wi-Fi Connectivity	Yes
Works with	Google Assistant and Amazon Alexa
SmartThinQ® with built-in and SmartChef	Yes
DIMENSIONS/CLEARANCES/WEIGHT	
Shipping Weight (lbs)	244 lbs
Product Weight (lbs)	194 lbs
Product (W x H x D)	29 3/4" x 33 9/11" x 24 1/2"
Cut-out (W x H x D)	28 1/2" x 33 7/16" x 23 1/2"
Over all Depth (in) - including handle	26 7/8"
Over all Depth (in) - including handle	20 8/11" x 8 9/25" x 17 5/13"
Oven Interior Dimensions (Upper) (in) (W x H x D)	24 1/2" x 17 5/16" x 18 7/8"
Oven Interior Dimensions (Lower) (in) (W x H x D)	33" x 30" x 50"
POWER/RATINGS	
Max Amp Load	40A
Rating	7.6kW
Requirements	120V / 240 VAC, 120 / 208 VAC
ACCESSORIES	
Glass Tray (Upper)	Yes
Metal Tray (Upper)	Yes
Rack (Upper)	Yes
Broiler pan & Grid	Yes
Gliding Rack	1
Heavy Duty Rack	2
Meat probe	Yes
S. cooking Pad	Yes
WARRANTY	
Parts & Labor	1 Year
UPC CODES	
LWMC3063ST (Stainless Steel)	048231319810
LW-3063B3 (Black Stainless Steel)	048231339827

4 years

CORAL 60-04

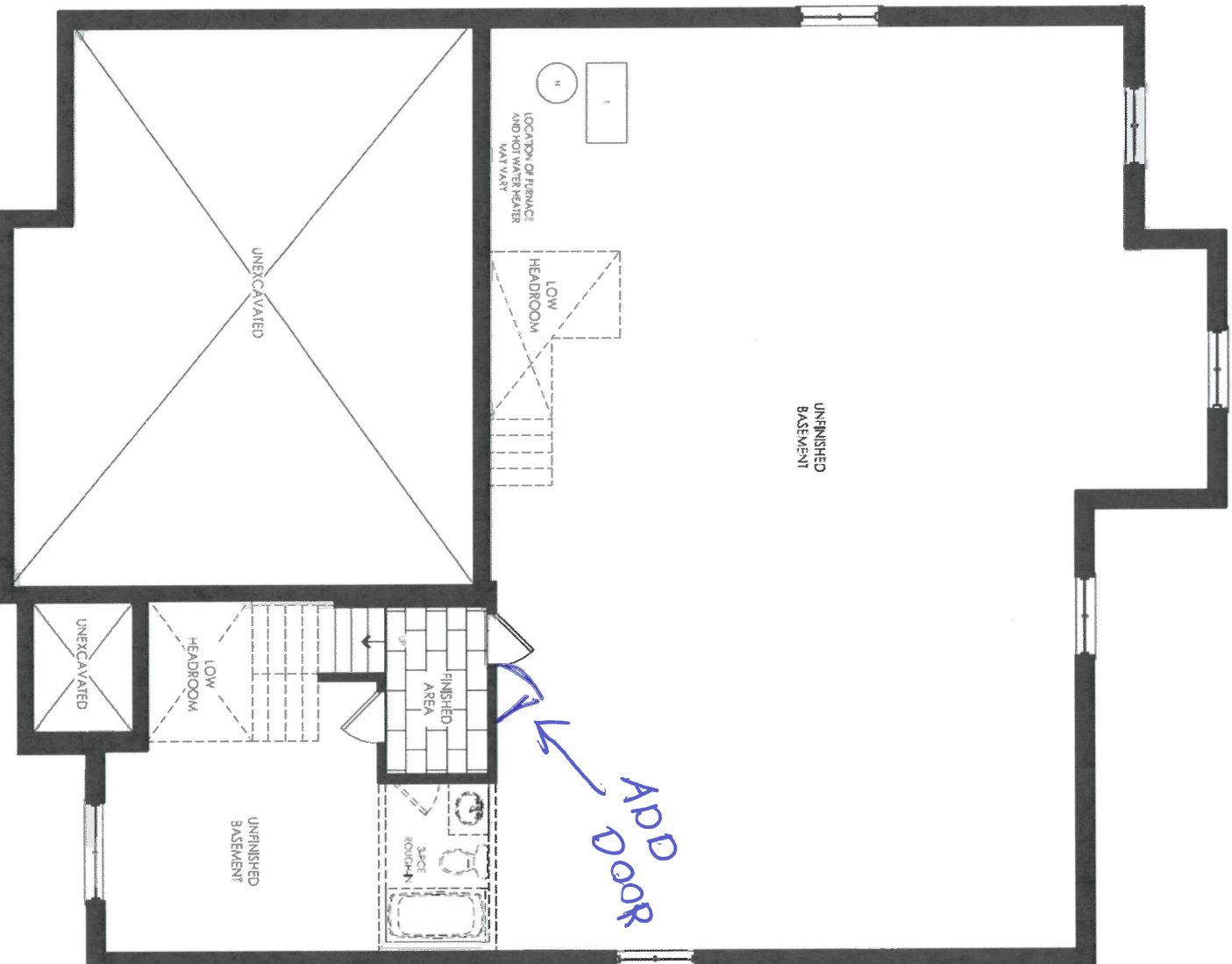

Elevation A
Basement

✓

Q

CORAL 60-04

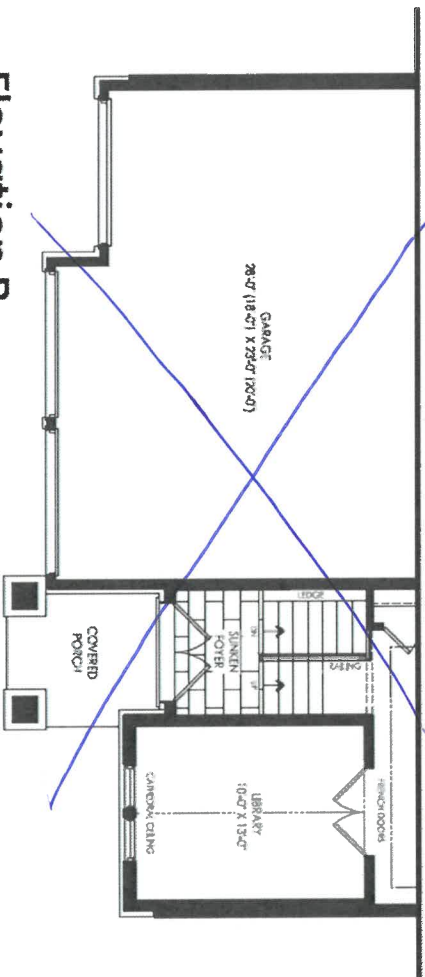

Elevation B
Ground Floor

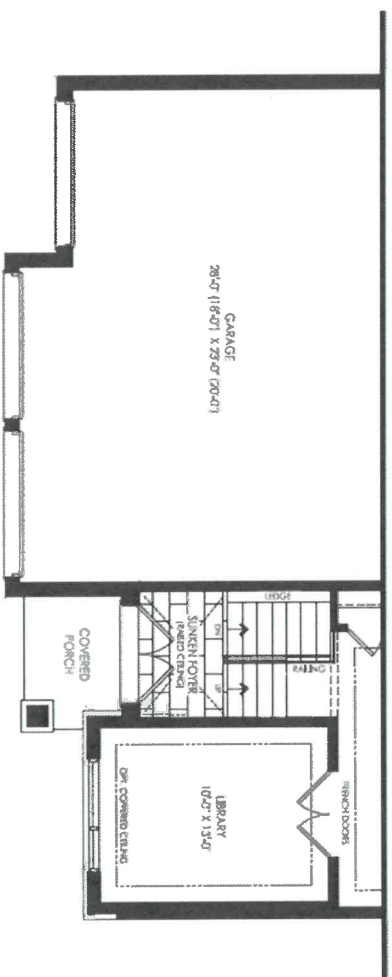

Elevation C
Ground Floor

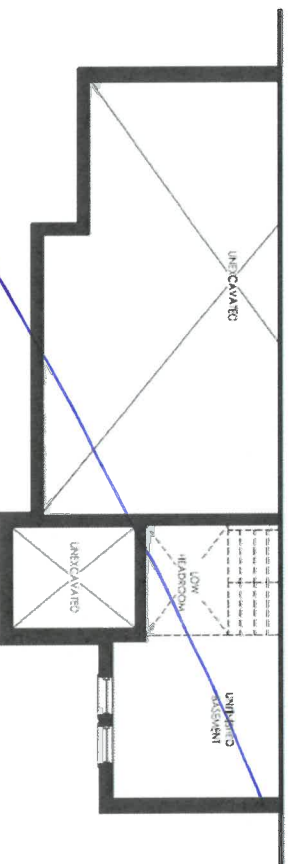

Elevation B
Basement

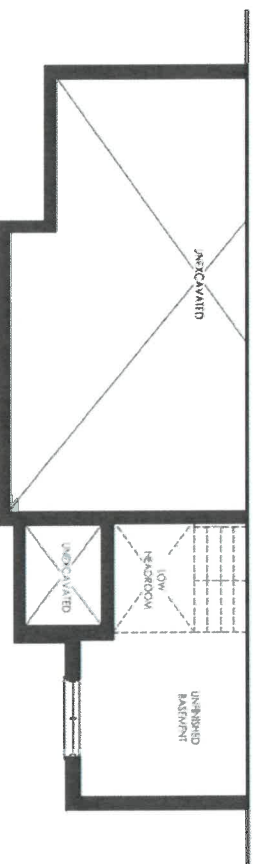

Elevation C
Basement

SHORELINE POINT
WASAGA BEACH

CORAL 60-04

The Coral



ALL ELEVATIONS INCLUDE 55 SQ.FT OF FINISHED BASEMENT



Handwritten signature in blue ink.



DATE SUBMITTED
16 Jun 2021

CLIENT NAME: ZANCOR HOMES
SHIP TO : SHORELINE POINT

DRAFTED BY: FERNANDA
COMMENT

JOB NUMBER
INSTALL DATE:
PAGE
20 of 22

60-04
KITCHEN

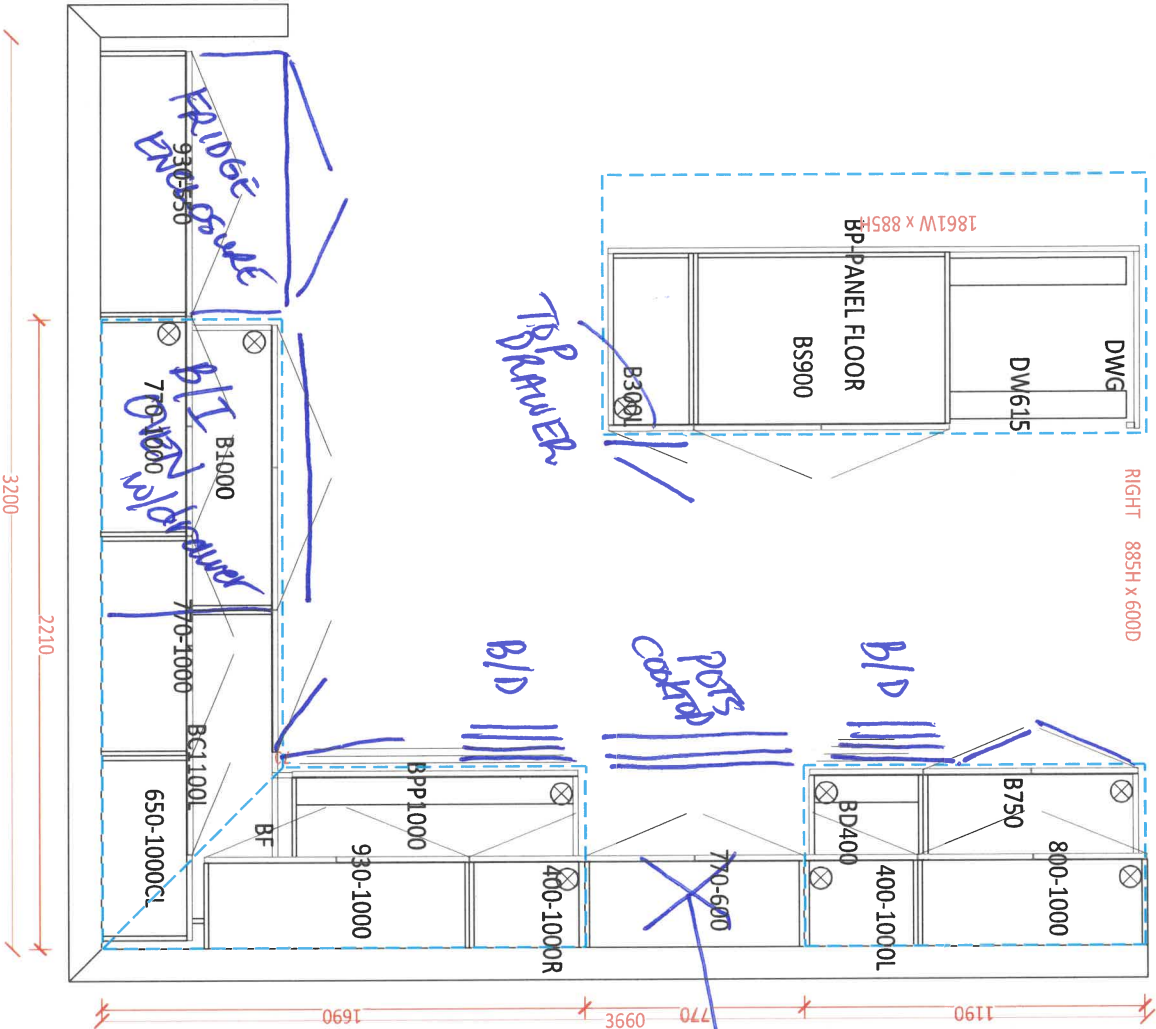

* ALL SOFT CLOSE *

[Handwritten signature]



DATE SUBMITTED

16 Jun 2021

CLIENT NAME: ZANCOR HOMES
SHIP TO : SHORELINE POINT

JOB NUMBER

INSTALL DATE:

PAGE

21 of 22

DRAFTED BY: FERNANDA

PH:
CELL :

COMMENT

P/O #

60-04

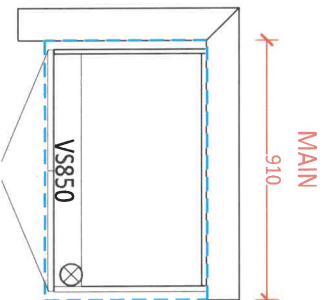

Comfort height

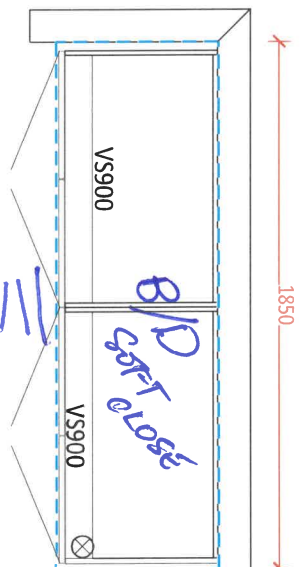

*81D cat 10 1/2
Comfort height*

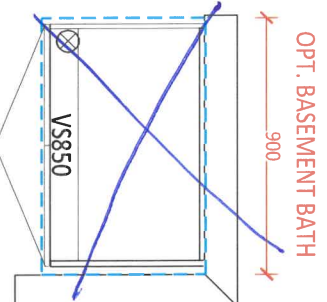
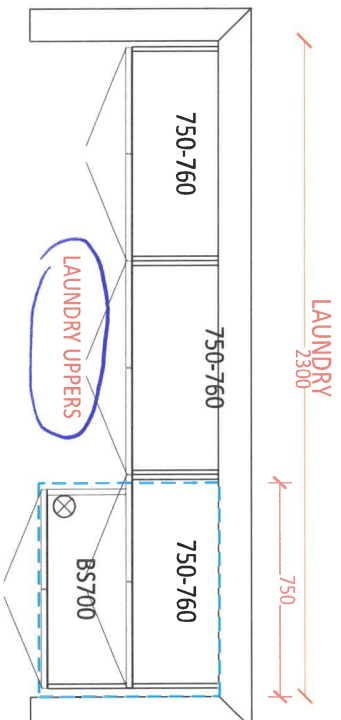

Handwritten signature

APPLIANCE ACKNOWLEDGEMENT

CONTACT: Steve Miller - Appliance Canada (905) 660-2424 / smiller@appliancecanada.com

- It is the Purchaser's responsibility to coordinate delivery, installation and hook up of appliances and to ensure they are installed as per Manufacturers specifications after closing.

STANDARD APPLIANCE OPENINGS provided by Zancor:

*Standard appliance openings are approximate and the minimum required. Sizes may vary due to onsite condition and/or when modifications have been made to the cabinetry.

- Fridge Opening 36" x 74"
- Stove Opening 30"
- Hood Fan Opening 30"
- Hood Fan & Vent 6" with Under Cabinet Hood
- Dishwasher Opening 24"

Accepts Standard
Openings **Initial



OPTIONAL UPGRADED APPLIANCES to be provided by Homeowner:

- ****Specs/information sheets are required and it is the responsibility of the homeowner to provide this to Zancor Homes by the due date that has been provided. If appliance specs are not submitted, Zancor Homes will not be responsible for any necessary requirements and the standard opening will be built.**



- Upgraded Appliance Specs are DUE 2 WEEKS FROM SIGNED DATE OF COLOUR CHART (if not received during appointment)

INITIAL

- ****Specs that require changes/modifications after this date will not be accepted*****

- NOTE: Any upgraded appliances are to be paid by the Purchaser, directly to the appliances company.

- Additional charges to the Purchaser may apply for cabinetry, electrical and plumbing in order to accommodate the specs given by the homeowner.

FRIDGE UPGRADE

- ☐ Built-in
- ☐ Panelled **Panel to match required
- ☐ Integrated / Flush Inset
- ☐ Waterline

RANGE UPGRADE

*Larger hood fan CFM might be required, which need a larger vent

- ☐ 36" **Hood fan opening must be the same size or larger (8" vent might be required)
- ☐ 48" **Hood Fan opening must be the same size or larger (8" or 10" vent required)
- ☐ Gas Range **gas line and electrical required & sold separately
- ☐ Induction **electrical required & sold separately
- ☐ Cooktop (Apron Front) **Countertop Cut-out required & sold separately
- ☐ Cooktop (Drop-in) **countertop Cut-out required & sold separately

HOOD FAN & VENT

UPGRADE

- ☐ 8 Inch **Required for 600 CFM
- ☐ 10 Inch
- ☐ Chimney Hood Fan **Vent must be centred
- ☐ Insert / Liner

WALL OVEN/MICRO

UPGRADE

**Electrical required

- ☐ Single Wall Oven **electrical required & sold separately
- ☐ Double Wall Oven **electrical required & sold separately
- ☐ Steam Oven **electrical required & sold separately
- ☐ Warming Drawer **electrical required & sold separately
- ☐ Over Then Range Microwave (OTR)
- ☐ Built-In Microwave **Trim Kit required **electrical required & sold separately

Aug 11/25

WASAGA SHORLINE

4

DATE

SITE

LOT

** Any upgrades checked in this appliance form must be accompanied with specs provided by the Purchaser.

**It is the responsibility of the trade to inform the Builder of any discrepancies with specs, sketches, extras and/or colour chart PRIOR to production/installation.

ZANCOR

221 North Rivermede Road, Concord, Ontario L4K 3N7 * T: (905) 738.7010 F: (905) 738.5948

INTERIOR FINISHES ACKNOWLEDGEMENT / WAIVER

Purchaser accepts and acknowledges that the Builder reserves the right to substitute materials with those of equal or better quality where the manufacture, scheduling or delivery of materials may directly impact the Builder's ability to meet its' contractual obligations under the Agreement of Purchase and Sale.

UPGRADES/EXTRAS: All upgrades and additional selections indicated on the colour chart must be accompanied by an upgrades/extras sheet (PES) and full payment otherwise the selection will be invalid. All colour charts and upgrades/extras will not proceed until verified and signed by an authorized signing officer at the Vendor's head office. **CHANGES WILL NOT BE PERMITTED UPON COMPLETION AND SUBMISSION OF THE COLOUR CHART.**

PORCELAIN & NATURAL STONES: Due to the properties of natural stones including but not limited to **marble, granite, quartz**, no two pieces are exactly the same. Variations in colour, tone, granularity (pitting, fissures) and pattern are to be expected, including various lighting may affect the overall finished look. Stone tops are sealed at time of installation and should never be cleaned with lemon oil or vinegar. Stones are porous materials, therefore any spilled substance require immediate attention. Stone countertops require regular seal re-application as part of home maintenance. Purchaser acknowledges colour and product variations as well as natural imperfections may exist with the selection of natural stone materials and shall not hold the Vendor liable for provision of same.

STONE COUNTERTOP JOINTS: Purchaser is aware that one joint will be at each corner and on either side of slide-in-range (if applicable). It will also be where the length of the counter top exceeds the length of a stone slab. Slabs are usually approximately 5' x 8'.

CERAMIC TILES: Due to manufacturing, shade (dye lots), product variations may exist that can affect the overall look of the finished product. Although every effort will be made to ensure the colours and materials selected are as close as possible to the samples, the purchaser acknowledges that the sample tiles supplied in the Design Centre may not be identical to the materials installed in the home.

STAIR STAINS: Due to the natural properties of wood, many variables can affect the overall look of the finished product. Factors including but not limited to wood type, knotting, graining, density, age, humidity, and air temperature can result in substantial variations in stain intensity. The purchaser accepts that although the Vendor will do their best to match stain the unfinished stairs as close as possible to the pre-finished floors, it is not possible to have an identical match and that there MAY be shade differences between the two products.

CABINETRY: Due to the natural properties of wood, slight variations apparent with cabinetry are to be expected. This includes but not limited to wood species, wood grain, colour, finish, product variations, and natural imperfections are all factors that may affect the overall look of the finished product. Such factors make exact colour matching impossible. The type and intensity of lighting in the areas of designated cabinetry placement may also highlight characteristics of cabinetry finish. All cabinets shall be finished with a white melamine interior box unless a finished interior is upgraded. Due to building specifications and/or on-site conditions, certain cabinetry upgrades may not be possible. The purchaser acknowledges that the Builder cannot guarantee the cabinetry finish or provision of certain upgrades and shall not hold the Builder liable for provision of same.

UPGRADES/EXTRAS: All upgrades and additional selections indicated on the colour chart must be accompanied by an upgrades/extras sheet (PES) and full payment otherwise the selection will be invalid. All colour charts and upgrades/extras will not proceed until verified and signed by an authorized signing officer at the Vendor's head office. **CHANGES WILL NOT BE PERMITTED UPON COMPLETION AND SUBMISSION OF THE COLOUR CHART.**

HARDWOOD / LAMINATE FLOORING: Due to the properties of wood and laminate, many variables can affect the overall look of the finished product. Variations include but not limited to wood type or laminate finish, colour/stain and wood grain are significant factors that make exact colour matching impossible. The purchaser acknowledges that the hardwood flooring is a pre-finished product in a controlled environment. Expansion, compression and cupping are characteristics of hardwood flooring once installed in the home. The purchaser acknowledges these may become apparent over time and despite the Builders' efforts to install the hardwood flooring materials in keeping with good workmanship, the Builder shall not be responsible nor held liable for minor variances of fluctuation in hardwood flooring materials.

HARDWOOD / LAMINATE WAIVER:

I/We understand hardwood flooring is classified as a porous material and as such not recommended by the Builder in certain areas. I/We understand there is a concern due to possible water and other substances being frequently splashed or spilled onto the floor and in contravention of Ontario Building Code Section 9.30.1.2(1).

"Finished flooring bathrooms, kitchens, public entrance halls, laundry & general storage areas shall consist of resilient flooring, felted-synthetic-fibre floor coverings, concrete, terrazzo, ceramic tile, mastic or other types of flooring providing similar degrees of water resistance.

I/We are prepared to assume full responsibility for any damage caused to the hardwood floor or subfloor due to moisture absorbency in the mentioned areas, and agree to waive any claims against the Township of residence, TARIION and/or the Builder in relation to the matter. ****SEE COLOUR CHART FOR LOCATIONS****

DATE	Aug 11/21	SITE	WASAGA SHORELINE	LOT	4
------	-----------	------	------------------	-----	---

221 North Rivermade Road, Concord, Ontario L4K 3N7 * T: (905) 738-7010 F: (905) 738-5948

HOME AUTOMATION
(Cable, CAT5/6, Telephone)

INCLUDED IN SCHEDULE "A" IN AGREEMENT OF PURCHASE AND SALE:

- Rough-in for Central Vacuum system piped to garage
- Rough-in for Telephone (2) locations
- Rough-in for Cable TV (2) locations
- Rough-in for Cat-6 Network (3) locations

CONTACT:

I/we the Homeowner(s) have chosen to contact the Home Automation Company to select the locations of the rough-ins for Cable, CAT5, Telephone as included in our Agreement of Purchase Sale.

I/we the Homeowner(s) will contact the trade within 4 weeks of the date of this release to select locations of the standard rough-ins review other optional products for purchase.

Trade: Smart-Tech Home Automation
Phone: (905) 761-6469
Email: kris@smart-tech.ca
Rep: Kris
Location: 200 Millway Avenue, Unit 8
Concord, Ont L4K 5K8

ACKNOWLEDGEMENT:

I/We the homeowner(s) acknowledge that if I/We the homeowners decide to not contact Smart-Tech, locations of the standard rough-ins will be installed as per Vendors discretion.

Homeowner(s) Initial

DATE Aug 11/21

WASAGA SHORELINE

LOT 4

BRICK/Joint PATTERN INSTALLATION RELEASE FORM

BRICK installation is included as a standard on the floor for 12 x 24 tiles and must be noted on the colour chart and acknowledged on this form

(Large tiles installation for floor and wall) – ¼ Brick

Please be advised it has come to our attention, that due to production, many of the over-sized and odd shaped, man-made tiles (i.e. porcelain & ceramic), have been found to have a slight bow in the tile. It is a standard occurrence with all suppliers and manufacturers.

It is therefore recommended, that if and when a purchaser requests to install one of these tiles in a brick-joint pattern, that it be installed on a ¼ brick pattern, to try to avoidlippage. Attached with this letter, you will find a layout of the ¼ brick installation that has been recommended.

LOCATIONS: All Floors
LOCATIONS: _____
LOCATIONS: _____
LOCATIONS: _____

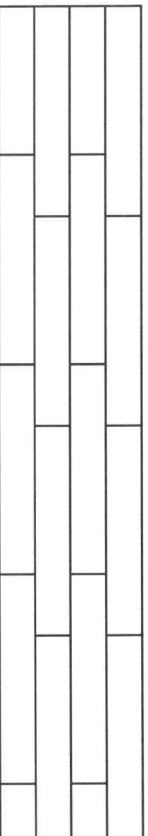

Please understand, even in using this ¼ brick installation, there may still be minimal lippage which cannot fully be eliminated.

Hence, when there is a request for brick-joint installation, Zancor Homes and their contractor, cannot be held responsible for this matter.

Homeowner(s) Initial

(Small tile installation for walls) – ½ Brick

Purchaser requests to install small wall tiles on a backsplash or shower wall in a brick-joint pattern, that it be installed on a ½ brick pattern.

LOCATIONS: _____
LOCATIONS: _____
LOCATIONS: _____
LOCATIONS: _____



Homeowner(s) Initial

DATE

Aug 11/21

SITE

WASAGA SHORELINE

LOT

4