

CONSTRUCTION SUMMARY OF EXTRAS

Printed 2021-08-26 / 2:51 PM / Page 1 of 1

Site: WASAGA SHORELINE

Lot: 4

Model: CORAL (60-04) C

Purchaser: ANDY LU

Purchaser: CATHY LEE

Phone: 0

Email: LEECATHY123@GMAIL.COM / LUANDY2020@GMAIL.COM



DESCRIPTION		DATE SELECTED
	BONUS PACKAGE: 3 PIECE STAINLESS STEEL APPLIANCES WITH WHITE TOP LOAD WASHER & DRYER	INCLUDED IN APS
	BONUS PACKAGE: STAINLESS STEEL HOOD FAN	INCLUDED IN APS
1	MAIN BATH - FRAMELESS GLASS SHOWER IN LIEU OF TUB *INCLUDES SHOWER POTLIGHT	AUG 11 2021
2	KITCHEN - BUILT-IN WALL OVEN COMBO WITH DRAWER BELOW	AUG 11 2021
3	ELECTRICAL - 40 AMP FOR WALL OVEN	AUG 11 2021
4	KITCHEN - COOKTOP WITH POT DRAWERS BEDLOW (SOFT CLOSE) **STANDARD 40 AMP CAN BE USED FOR THIS AS PER SPEC	AUG 11 2021
5	COOKTOP CUT OUT IN COUNTERTOP	AUG 11 2021
6	KITCHEN - DELETE UPPEERS ABOVE ABOVE FRIDGE FOR FUTURE CHIMNEY HOOD FAN *CENTRE VENT	AUG 11 2021
7	KITCHEN - FRIDGE ENCLOSURE	AUG 11 2021
8	KITCHEN - CONVERT STANDARD POT DRAWERS INTO STANDARD BANK OF DRAWERS (WITH STANDARD SOFT CLOSE) ***BOTH SETS OF BANK OF DRAWERS TO BE APPROXIMATELY 18 INCHES WIDE****	AUG 11 2021
9	KITCHEN - BASE CORNER CABINET	AUG 11 2021
10	KITCHEN - ADD TOP DRAWER IN ISLAND	AUG 11 2021
11	ELECTRICAL - SEE LOCATION FOR STANDARD PLUG IN ISLAND	AUG 11 2021
12	ELECTRICAL - (4) POTLIGHTS IN LIBRARY, NOTE ****INSTALL THE LIGHTS 40 INCHES IN FROM EACH WALL	AUG 11 2021
13	KITCHEN -MATCHING LIGHT VALANCE	AUG 11 2021
14	ELECTRICAL - ADD UNDER CABINET LED LIGHTING	AUG 11 2021
15	ELECTRICAL - INSTALL STANDARD KITCHEN LIGHT TO BE CENTRED OVER THE ISLAND	AUG 11 2021
16	ELECTRICAL - ADD (1) CAPPED WALL LIGHT ABOVE SINK IN MASTER ENSUITE & SHIFT OVER THE STANDARD TO BE CENTRED ON THE WALL ABOVE THE OTHER SINK	AUG 11 2021
17	CABINETS - LAUNDRY UPPEERS	AUG 11 2021
18	CABINETS - MASTER ENSUITE - ADD BANK OF DRAWERS BETWEEN SINKS *SOFT CLOSE	AUG 11 2021
19	ELECTRICAL - ADD PLUG ABOVE THE FIREPLACE APPROX 65 INCHES ABOVE FLOOR **CABLE ROUGHIN BESIDE	AUG 11 2021
20	BASEMENT - ADD SECOND DOOR TO BASEMENT FOYER	AUG 11 2021
21	SHOWER FLOOR IN MASTER ENSUITE AND MAIN BATH	AUG 11 2021
22	HARDWOOD - UPGRADE COLOUR	AUG 11 2021
23	STAIN STAIRS TO MATCH HARDWOOD AS CLOSE AS POSSIBLE	AUG 11 2021
24	CABINETS - COMFORT HEIGHT IN MASTER ENSUITE	AUG 11 2021
25	CABINETS - COMFORT HEIGHT IN MAIN BATH	AUG 11 2021
26	INTERIOR DOOR - 1 LITE MIRROR DOOR FOR POWDER ROOM	AUG 11 2021
27	KITCHEN BACKSPASH - 12 X 24 FLOOR TILES **HORIZONTAL WITH THE FULL TILE AGAINST THE COUNTERTOP **INCLUDES BEHIND CHIMNEY	AUG 11 2021
28	WATERLINE TO FRIDGE	AUG 11 2021

ZANCOR HOMES COLOUR CHART

PRINTED 2021-08-11, 11:49 AM

ENTRANCES				
Main Foyer - FLOORING	LOFT DOVE 12 X 24 *BRICK	✓		
Mudroom - FLOORING	LOFT DOVE 12 X 24 *BRICK	✓		
Side Hall - FLOORING	N/A			
Basement Foyer - FLOORING	NEW BYZANTINE ASSURO 12 X 24 *BRICK			
KITCHEN				
Kitchen - FLOORING	NEW BYZANTINE ASSURO 12 X 24 *BRICK	✓		
Breakfast - FLOORING	NEW BYZANTINE ASSURO 12 X 24 *BRICK	✓		
Kitchen - CABINETS	EURO HIGH GLOSS WHITE	✓		
Island - CABINETS	EURO HIGH GLOSS WHITE	✓		
Servery - CABINETS	N/A			
Kitchen - HANDLES/KNOBS	DOORS K200BC / DRAWERS H500BC	✓		
Kitchen - COUNTERTOP	LAMINATE 5006K-07	✓		
Island - COUNTERTOP	LAMINATE 5006K-07	✓		
Kitchen - BACKSPLASH **INCL BEHIND CHIMNEY	NEW BYZANTINE12 X 24 **HORIZONTAL **FULL TILE TO BE AGAINST COUNTERTOP**			✓
Kitchen - SINK	STANDARD			
Kitchen - FAUCET	STANDARD			
GREAT ROOM / DINING / LIVING / DEN / OFFICE / BASEMENT				
Family / Great Room - FLOORING	HARDWOOD - MIRAGE OAK CASHMERE - RIO 3-5/16"			✓
Main Hall - FLOORING	HARDWOOD - MIRAGE OAK CASHMERE - RIO 3-5/16"			✓
Dining / Living Room - FLOORING	HARDWOOD - MIRAGE OAK CASHMERE - RIO 3-5/16"			✓
Library / Den - FLOORING	HARDWOOD - MIRAGE OAK CASHMERE - RIO 3-5/16"			✓
Basement Rec Room - FLOORING	NEW BYZANTINE ASSURO 12 X 24 *BRICK			✓
STAIRS				
Railing Details - PICKETS	STANDARD METAL - SINGLE COLLAR WITH ALT PLAIN			✓
Railing Details - POSTS	STANDARD TURNED OAK			
Railing Details - HANDRAIL	STANDARD OVAL OAK			
Stair Stain - MAIN STAIRS	STAIN TO MATCH HARDWOOD AS CLOSE AS POSSIBLE			
Stair Stain - BASEMENT STAIRS (if applicable)	STAIN TO MATCH HARDWOOD AS CLOSE AS POSSIBLE			✓
Stair Stain - SERVICE STAIRS (if applicable)	N/A			
POWDER ROOM				
Powder Room - FLOORING	NEW BYZANTINE GREY 12 X 24 *BRICK			✓
Powder Room - CABINETS	PEDESTAL SINK			
Powder Room -	N/A			
Powder Room - SINK	PEDESTAL SINK			
Powder Room - FAUCET	STANDARD			
2ND FLOOR				
Upper Hall - FLOORING	N/A			
Master Bedroom - FLOORING	CARPET - OPENING NIGHT COLOUR T15 w/STANDARD UNDERPAD			✓
Bedroom 2 - FLOORING	CARPET - OPENING NIGHT COLOUR T15 w/STANDARD UNDERPAD			✓
Bedroom 3 - FLOORING	CARPET - OPENING NIGHT COLOUR T15 w/STANDARD UNDERPAD			✓
Bedroom 4 - FLOORING	N/A			
Bedroom 5 - FLOORING	N/A			
Master Ensuite - FLOORING	GENESIS TAUPE 12 X 24 *BRICK	✓		
Master Ensuite - SHOWER WALL	NEW BYZANTINE GREY 12 X 24 *VERTICAL STACKED			✓
Master Ensuite - SHOWER FLOOR	ONTARIO HEX TAUPE MATTE			✓
Master Ensuite - SHOWER JAMB	BIANCO CARRARA	✓		
Master Ensuite - CABINETS	EURO BLACKWOOD	✓		
Master Ensuite - HANDLES/KNOBS	DOORS K200BC / DRAWERS H500BC	✓		
Master Ensuite - COUNTERTOP	LAMINATE - 6697-58	✓		
Master Ensuite - SINK(s)	STANDARD	Master Ensuite - FAUCET(s)	STANDARD	
***FOR TRADE USE***				
Any upgrades in the colour chart must be accompanied with a PES. It is the responsibility of all Trades to inform the builder of any discrepancies on sketches, PES and/or colour charts PRIOR to installation.		WASAGA SHORELINE 4	SIGNATURES	
			PURCHASER INITIALS	VENDOR APPROVAL



2ND FLOOR CONTINUED...										
Main Bath - FLOORING		GENSIS LIGHT GREY 12 X 24 * BRICK				✓				
Main Bath - TUB / SHOWER WALL		NEW BYZANTINE ASSURO 12 X 24 *VERTICAL STACKED								✓
Main Bath - SHOWER FLOOR		ONTARIO HEX DARK GREY MATTE								✓
Main Bath - SHOWER JAMB		BIANCO CARRARA				✓				
Main Bath - CABINETS		SHAKER TUXEDO				✓				
Main Bath - HANDLES/KNOBS		DOORS K200BC				✓				
Main Bath - COUNTERTOP		LAMINATE - 4925K-07				✓				
Main Bath - SINK(s)		STANDARD		Main Bath - FAUCET(s)		STANDARD				
Shared Bath- FLOORING		N/A								
Shared Bath- TUB / SHOWER WALL		N/A								
Shared Bath- SHOWER FLOOR		N/A								
Shared Bath- SHOWER JAMB		N/A								
Shared Bath- CABINETS		N/A								
Shared Bath- HANDLES/KNOBS		N/A								
Shared Bath- COUNTERTOP		N/A				Shared Bath - FAUCET(s)				
Shared Bath- SINK(s)										
Ensuite Bath - FLOORING		N/A								
Ensuite Bath - TUB / SHOWER WALL		N/A								
Ensuite Bath - SHOWER FLOOR		N/A								
Ensuite Bath - SHOWER JAMB		N/A								
Ensuite Bath - CABINETS		N/A								
Ensuite Bath - HANDLES/KNOBS		N/A								
Ensuite Bath - COUNTERTOP		N/A				N/A				
Ensuite Bath - SINK(s)				Ensuite Bath - FAUCET(s)						
LAUNDRY										
Laundry - FLOORING		LOFT DOVE 12 X 24 * BRICK		✓		Laundry - HANDLES/KNOBS		K200BC		
Laundry - CABINETS (LOWERS / UPPERS)		HIGH GLOSS WHITE				Laundry - SINK		STANDARD		
Laundry - COUNTERTOP		LAMINATE 1887K-22				Laundry - FAUCET		STANDARD		
Laundry - BACKSPLASH		N/A								
TRIM / PAINT										
Casing/Baseboards		STANDARD								
Interior Doors		STANDARD								
Interior Door Hardware		STANDARD								
PAINT - Throughout		COOL WHITE								
FIREPLACE										
Location / Insert / Mantle		STANDARD ELECTRIC								
ACCESSORIES										
Mirrors		YES		BATH ACCESSORIES		YES				
APPLIANCE REQUIREMENTS										
GAS LINE TO BBQ		YES		ELECTRICAL for Built-in Oven		YES				
GAS LINE & ELECTRICAL TO STOVE		DECLINED		ELECTRICAL for Built-in Micro		N/A				
GAS LINE & ELECTRICAL TO DRYER		N/A		ELECTRICAL for Cooktop		YES				
HOOD FAN VENT SIZE		6 INCH		ELECTRICAL for Bar Fridge		N/A				
WATERLINE to Fridge		YES								
DISCLAIMER										
Any changes to the colour chart after signing are subject to a <b>\$5000</b> administration fee plus costs										
Purchaser has checked and acknowledged accuracy of colour and selections before signing.										
Colours of all materials are as close as possible to Builders selection but not necessarily identical due to dye lot variances in manufacturing/manufacturers. Due to construction progress some items may have been pre-selected or installed. In this event the Vendor's selection must be accepted by the purchaser										
SITE / LOT:		WASAGA SHORELINE				4				
PURCHASER(S):		ANDY LU								
PURCHASER(S):		CATHY LEE								
CONTACT:		0		LEECATHY123@GMAIL.COM / LUANDY2020@GMAIL.COM		SIGNATURES / DATE				
Any upgrades in the colour chart must be accompanied with a PES. It is the responsibility of all Trades to inform the builder of any discrepancies on sketches, PES and/or colour charts PRIOR to installation.		PURCHASER SIGNATURE		PURCHASER SIGNATURE		SIMONE				
		PURCHASER SIGNATURE		PURCHASER SIGNATURE						
		DÉCOR CONSULTANT		DÉCOR CONSULTANT						
Vendor APPROVAL		Vendor APPROVAL								



HOME APPLIANCES

LG REFRIGERATION

**LMXS28626\_**  
28 cu.ft. 4-Door French Door Refrigerator

- 27.8 cu.ft.
- Slim SpacePlus® Ice System
- Spill Protector™ Tempered Glass Shelf / 1 Folding Shelf
- 2 Humidity Crispers
- 6 Door Bins (2 Adjustable Gallon Sized)
- Smart Cooling Plus System
- 10 Year Limited Manufacturer's Warranty on Linear Compressor
- Fresh Air Filter, Evaporator, Multi-Air Flow
- SmartDiagnosis™ System
- ENERGY STAR® Qualified



Enjoy new ways to control your home with LG smart appliances

- Get an alert when kids forget to close the door
- Make more ice while you're at work
- Works with LG SmartThinQ™ app, the Google Assistant and Amazon Alexa

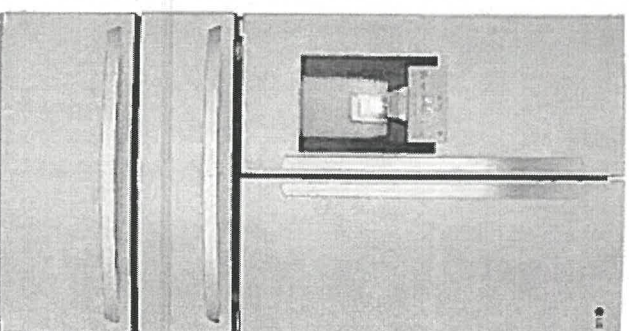

PRODUCT FEATURES

<b>CAPACITY</b>	
Refrigerator (cu.ft.)	18.6
Freezer (cu.ft.)	9.2
Total (cu.ft.)	27.8
<b>FEATURES</b>	
Energy Consumption (kWh/Year)	72.4
ENERGY STAR® Qualified	Yes
<b>SmartThinQ™</b>	
SmartDiagnosis™	Yes
<b>WATER &amp; ICE SYSTEM</b>	
Ice & Water Dispenser	Yes
Dispenser Type	Integrated
Daily Ice Production (lbs)	3.5
IcePlus™ Production (lbs)	3.8
Ice Storage Capacity (lb)	2.5 * 4.0
Ice System	Slim SpacePlus®
Dispenser Light	Yes
Water Filter	LT1000P
<b>COOLING</b>	
Linear Compressor	Yes
Smart Cooling® System	Yes
Multi-Air Flow Cooling	Yes
Temperature Sensors	6
Fresh Air Filter	Yes
Evaporator	Yes
<b>CONVENIENCE</b>	
Display Type	Monochrome / White LED
Temperature Control	Electronic Digital
Child Lock	Yes
Auto Closing Door Hinge	Yes
LockRelease™ Quiet Operation	Yes
<b>REFRIGERATOR</b>	
No. of Shelves	4 Spl. (3 Fixed+1Fold-ig)
Folding Shelf	1
Cantilevered Shelves	Hybrid Cantilevered
Shelf Construction	Spl. Protector™ Tempered Glass
Crisper Bins	2 Humidity Crisper
Guide N Serve™ Drawer	Yes
Refrigerator Light	Ceiling LED

REFRIGERATOR DOOR

No. of Bins	6 Total (2 Adjustable Gallon Sized)
Door Bin Construction	1 Piece (Steel)
<b>FREEZER</b>	
Door Type	Pull Drawer
Drawers	2-Tier Organization
Drawers™ Solid Drawer Base	Yes
Drawer Divider	Yes
Freezer Light	LED Lighting
Freezer Handle	Wire
<b>MATERIALS AND FINISHES</b>	
Interior Door	Yes
Hidden Hinges	Yes
Surface	Smooth
Back	Flush & Match Cover Over Mechanical Parts
Handle	Matching Commercial Handles
At-A-Glance Colors	PrintProof™ Stainless Steel, Black Stainless Steel
<b>DIMENSIONS/CLEARANCES/WEIGHTS</b>	
Depth with Handles	35 1/4"
Depth without Handles	33 3/4"
Depth without Door	29 7/8"
Depth (Total with Door Open)	48 1/4"
Height to Top of Case	68 3/8"
Height to Top of Door Hinge	69 3/4"
Width	35 3/4"
Width (Door Open 90° with Handle)	44 1/4"
Width (Door Open 90° without Handle)	39 1/4"
Installation Clearance	Top 1" Back 2"
Weight (Net/Carton)	322 lbs./ 347 lbs.
Carton Dimensions (WxHxD)	35" x 73" x 39"
<b>LIMITED WARRANTY</b>	
Parts & Labor	1 Year
Sealed System	7 Years
Linear Compressor	10 Years
<b>UPC CODES</b>	
LMXS28626S PrintProof™ Stainless Steel	048231794707
LMXS28626D Black Stainless Steel	048231794770

© 2017 LG Electronics, Inc. All rights reserved. "Life's Good" is a registered trademark of LG Electronics, Inc. All other product and brand names are trademarks or registered trademarks of their respective owners. Design, features and specifications are subject to change without notice. LG0117

4 packages





APPLIANCE CANADA VAUGHAN, 8701 JANE ST. UNIT 1, VAUGHAN, ON, L4K 2M6

Page 1 of 1

CUSTOMER

SALES ORDER INFORMATION

DOCUMENT NUMBER

LU ANDY

TYPE: SALES ORDER/INVOICE

07171AJBNAL

LOT 4

DE/PU: D

WASAGA BEACH, ON

ZONE: A/C

SALESPERSON(S)

L9Z1V1

DAY: TBA

STEVE M

Hm: 416-806-2155

DATE: TBA

WK: 416-806-2155

A



ACC

Order Sort: R

DELIVERY/PICKUP DATE WILL BE CONFIRMED AND SCHEDULED UPON ARRIVAL OF PRODUCT FROM SUPPLIERS.

QTY	ITEM CODE	W	VEND	DESCRIPTION	EXTD PRICE
1	B015555S		004C	WCESSUSQHS ✓	\$ 646.00 ✓
1	02L3515T		0860	LWC3063ST ✓	\$ 2761.32 ✓
1	02L3425S		0860	LMXS28626S ✓	\$ 1805.86 ✓
1	26A0597S		013C	AVH-308CS ✓	\$ 690.00 ✓
1	B015630M		004C	WDF560SAFM ?	\$ 200.00 ✓
with p001					

Outstanding Service. Fridge  
Premium Brands. Hood  
Market Leading Prices. Dishwasher  
For Your Home,  
For Your Life.

07171AJBNAL

SPECIAL NOTES

\*\*\*INSTALLATION NOT INCLUDED\*\*\*

\*Taxes and Merch Subt. \$ 6103.18  
Surcharges DELIVERY \$ .00  
are subject TAXABLE TOTAL \$ 6103.18  
to change GST/HST \$ 793.41  
TOTAL \$ 6896.59  
DEPOSIT \$ 500.00  
BALANCE DUE \$ 6396.59

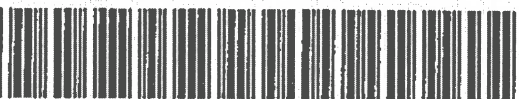

TRAN TYPE	AMOUNT	ACCT.	ACCOUNT NUMBER	MERCHANT #	FIN CODE	APPROVAL	DATE/TIME
TEL-MAIL/TEL-PO	500.00	CDN AMEX	*****1008	44148902	M	138738	19-JUL-2021 07:30:21
Card Type: AMEX				MO: 312	BATCH: 164	450.00	00001 APPROVED THANK YOU

FOR CUSTOMER SERVICE INQUIRIES  
Please call your store : 905-660-2424  
or email: concierge@appliancecanada.com

AC0007472



4

OK

PAYMENT OPTIONS  
☐ STANDARD REVOLVING  
☐ EQUAL MONTHLY PAYMENTS PROMOTIONAL OFFER  
☐ MONTHS NO INTEREST NO PAYMENT PROMOTIONAL OFFER

DATE 17-JUL-2021 23:22:37

CUSTOMER SIGNATURE(S)

WASAGA

\* I.D. REQUIRED ON PICKUP OF MERCHANDISE / NO CODs ON DELIVERY \*

IMPORTANT: Retain this copy for your records.

# AVG

AVH-308CS  
30" Wall mounted hood - MSRP: \$819.00

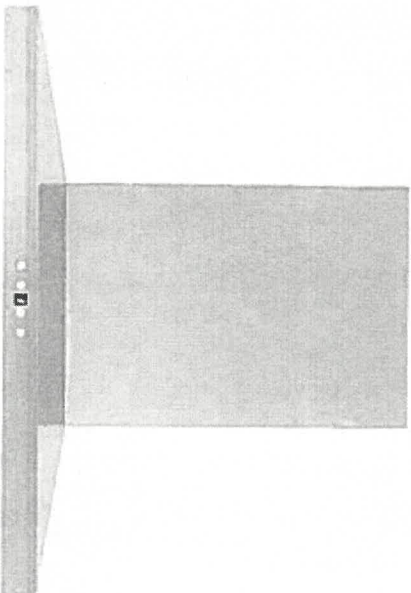

Model	AVH-308CS	
Control	Features	
Lighting	Soft touch with LED display	
Blower type	2 bulbs, 3W LED (bulbs included)	
Blower performance	860 CFM, 6-Speed	
	Speed 1, 2, 4, 6	
	Speed 6, 6.2, 8	
Filter type	2 aluminum micro hole filters (included)	
	2 Stainless steel baffle filters (included)	
Duct transition	6" Round (Top)	
Ducting	Ducted	
Chimney (ducted out)	For ceiling heights up to 9'0"	
Stainless steel grade	Exterior Appearance	201
Electrical requirements	Electrical Requirements	120V / 60Hz / 2.7 Amps
Dimensions	Dimensions	29 1/2" (W) x 19 3/4" (D) x 3 1/4" (H)
1-year Warranty	Warranty	Parts and labour, in-home service

4 Weeks

The information contained herein is based on sources that we believe to be reliable, but is not guaranteed by us, may be incomplete or may change without notice



- Use the countertop opening dimensions that are given with these installation instructions. Given dimensions are minimum clearances and provide 0" (0 cm) clearance.
  - Grounded electrical supply is required. See "Electrical Requirements" section.
- IMPORTANT:** To avoid damage to your cabinets, check with your builder or cabinet supplier to make sure that the materials used will not discolor, delaminate, or sustain other damage.

## Product Dimensions

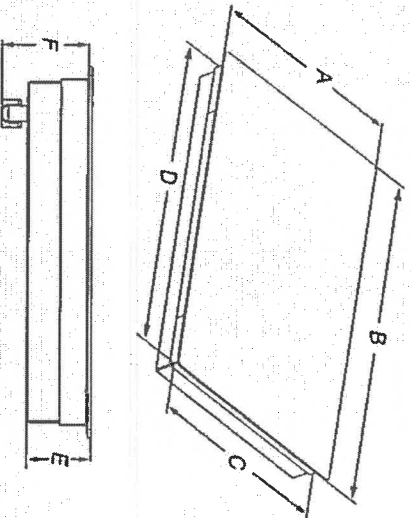

- A. Glass depth - black and white models - 21<sup>3</sup>/<sub>16</sub>" (55.2 cm)  
Glass depth - Whirlpool and Maytag stainless steel models - 22<sup>7</sup>/<sub>16</sub>" (58.0 cm)
- B. Glass depth - KitchenAid stainless steel models - 21<sup>3</sup>/<sub>16</sub>" (54.9 cm)  
Glass width - 24" (60.9 cm) models - 23<sup>1</sup>/<sub>16</sub>" (60.5 cm)  
Glass width - 30" black and white (76.2 cm) models - 30<sup>1</sup>/<sub>16</sub>" (78.4 cm)  
Glass width - Whirlpool and Maytag 30" stainless steel (76.2 cm) models - 30<sup>9</sup>/<sub>16</sub>" (78.4 cm)  
Glass width - KitchenAid 30" stainless steel (76.2 cm) models - 30<sup>1</sup>/<sub>16</sub>" (77.1 cm)  
Glass width - 36" black and white (91.4 cm) models - 36<sup>7</sup>/<sub>16</sub>" (92.3 cm)  
Glass width - Whirlpool 36" stainless steel (91.4 cm) models - 36<sup>1</sup>/<sub>16</sub>" (92.3 cm)  
Glass width - Maytag 36" stainless steel (91.4 cm) models - 36<sup>7</sup>/<sub>16</sub>" (91.5 cm)  
Glass width - KitchenAid 36" stainless steel (91.4 cm) models - 35<sup>1</sup>/<sub>16</sub>" (91.0 cm)
- C. Frame depth - 20<sup>3</sup>/<sub>16</sub>" (51.6 cm)
- D. Frame width - 30" (76.2 cm) models - 29<sup>7</sup>/<sub>16</sub>" (55.7 cm)  
Frame width - 36" (91.4 cm) models - 34<sup>1</sup>/<sub>16</sub>" (87.5 cm)
- E. Cooktop height with bottom heat shield - 3<sup>5</sup>/<sub>8</sub>" (9.8 cm)
- F. Cooktop height including knobs (located at rear of cooktop, right side) - 5" (12.7 cm)  
Cooktop height including conduit (located at rear of cooktop, right side) - 5<sup>1</sup>/<sub>16</sub>" (13.4 cm)

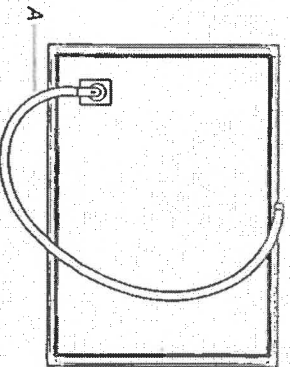

A. Location of Power Cord (length of power cord is 48" (121.9 cm), including the conduit)

## Cabinet Dimensions

**IMPORTANT:** If installing a range hood or microwave hood combination above cooking surface, follow the range hood or microwave hood combination installation instructions for dimensional clearances above the cooktop surface.

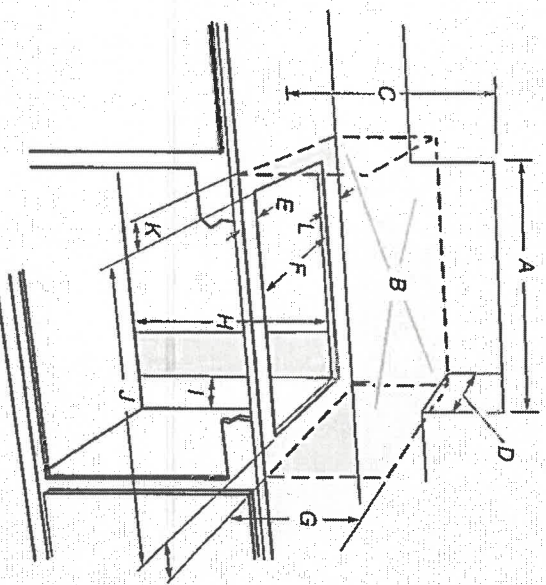

- A. 24" (60.9 cm) on 24" models; 30" (76.2 cm) on 30" models; 36" (91.4 cm) on 36" models
- B. Combustible area above countertop (shown by dashed box above)
- C. 30" (76.2 cm) minimum clearance between top of cooktop platform and bottom of unconverted wood or metal cabinet (24" (61 cm) minimum clearance if bottom of wood or metal cabinet is covered by not less than 1/4" (0.6 cm) flame retardant millboard covered with not less than No. 28 MSG steel sheet, 0.015" (0.04 cm) stainless steel, or 0.024" (0.06 cm) aluminum or 0.020" (0.05 cm) copper)
- D. 13" (33 cm) recommended upper cabinet depth
- E. 2" (5.1 cm)
- F. 20<sup>1</sup>/<sub>2</sub>" (52.0 cm) recommended cutout.  
Will fit in cutout from 20<sup>3</sup>/<sub>4</sub>"-20<sup>7</sup>/<sub>8</sub>" (51.8-52.2 cm).
- G. 18" (45.7 cm) minimum clearance from upper cabinet to countertop within minimum horizontal clearances to
- H. Junction box or outlet: 7" (17.8 cm) minimum from top of countertop
- I. Junction box or outlet: 9" (23.0 cm) maximum from right side of cabinet
- J. 29<sup>1</sup>/<sub>2</sub>" (74.9 cm) recommended cutout on 30" (76.2 cm) models.  
Will fit in cutout from 29<sup>1</sup>/<sub>4</sub>"-29<sup>7</sup>/<sub>8</sub>" (73.8-75.1 cm) on 30" (76.2 cm) models.  
35<sup>1</sup>/<sub>2</sub>" (90.2 cm) recommended cutout on 36" (91.4 cm) models.  
Will fit in cutout from 34<sup>1</sup>/<sub>2</sub>"-35<sup>7</sup>/<sub>8</sub>" (87.8-90.3 cm) on 36" (91.4 cm) models.  
22<sup>1</sup>/<sub>2</sub>" (56.67 cm) recommended cutout on 24" (61.0 cm) models.  
Will fit in cutout from 22<sup>1</sup>/<sub>4</sub>"-22<sup>7</sup>/<sub>8</sub>" (56.4-57.0 cm) on 24" (61.0 cm) models.
- K. 2<sup>1</sup>/<sub>2</sub>" (6.35 cm) minimum distance to nearest left and right side combustible surface above cooktop
- L. 1<sup>1</sup>/<sub>2</sub>" (3.81 cm) minimum clearance between back wall and countertop

**NOTES:** After making the countertop cutout, some installations may require notching down the base cabinet side walls to clear the cooktop base. To avoid this modification, use a base cabinet with sidewalls wider than the cutout.

If cabinet has a drawer, a 5<sup>1</sup>/<sub>2</sub>" (14.0 cm) depth clearance from the top of the countertop to the top of the drawer (or other obstruction) in base cabinet is required.

40AMP

40AMP







# Prism Series

## 50" Linear Electric Fireplace

BLF5051

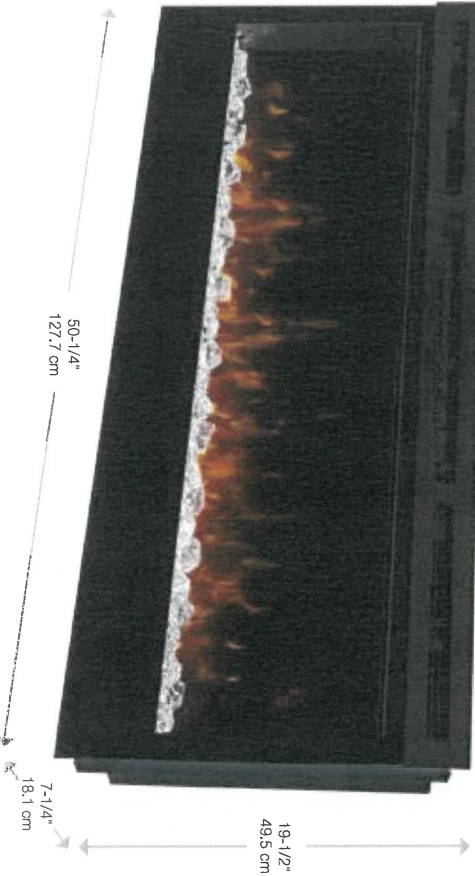

### Accessories



120 Volts   1,230 Watts   4,197 BTU									
Model #	Description	Lbs / Kg	UPC	Wtr <sup>1</sup>	Carton Dimensions (WxHxD)		Cube		
					Inches	cm	ft <sup>3</sup>	m <sup>3</sup>	
BLF5051	50" Linear Electric Fireplace	75 / 34.1	781052 098787	2 yr.	55 x 23-1/4 x 12-7/8	139.7 x 59.9 x 32.7	9.5	0.26	
DT1267BLK	Cohesion Trim - Black	51 / 23.1	781052 080355	1 yr	64-7/8 x 26-1/4 x 8-3/4	164.8 x 66.8 x 22.1	8.6	0.24	
LF50DWS-KIT	50" Driftwood and River Rock Accessory Kit	7 / 3.17	781052 102842		34-1/4 x 5-7/8 x 8-1/8	87.2 x 14.98 x 20.6			

Specifications, finishes and dimensions are subject to change. \*Limited warranty. ©2020 Glen Dimplex Americas

Glen Dimplex Americas | 1-800-668-6663 | www.dimplex.com

### Features

- The Original Dimplex Flame Effect™**  
A blend of technology, artistry and craftsmanship that sets the standard for realism.
- Acrylic Ice Media Bed**  
Light plays through different size pieces and sparkle in a spectrum of colors.
- Media Accent Colors**  
Choose from a variety of brilliant color themes or cycle through a range of colors using the custom mode, freezing on the hue of your choice.
- Flexible Installation**  
Simply surface mount and plug-in or fully-recess and direct wire for a seamless installation
- Hanging Glass Design**  
Detachable glass trim easily finishes rough openings and provides access to media.
- Remote Thermostat Control**  
Temperature control at your fingertips for convenient comfort.
- Multi-function Remote**  
Control the flame, heat and thermostat from the comfort of your chair.
- LED Lighting**  
Flame and lights use brilliant, low-energy LED's that require zero maintenance.
- All-season Flames**  
Enjoy the unique charm of a fireplace 365 days a year using the flames without the heat.
- Cool-touch Glass**  
Glass remains cool making it safe for any location and any user.
- Low Carbon Footprint**  
The most sustainable fireplace option; no emissions and 100% efficient.

SE-022-R06-041520

133 pages



## **Prism Series** 50" Linear Electric Fireplace

BLF5051

The best-selling linear fireplace is now even better.



The best-selling electric linear fireplace just got better with the all new Prism Series. Sparkling with intensity in a full spectrum of colors, the Prism effect illuminates the diamond-like acrylic ice ember bed in a show-stopping effect. Plug-in or hard-wire, hung on the wall or built-in; the Prism Series is beautifully versatile.

 **PRISM**  
series

*133 Wang*





# Prism Series

## 50" Linear Electric Fireplace

BLF5051

### Product Dimensions:

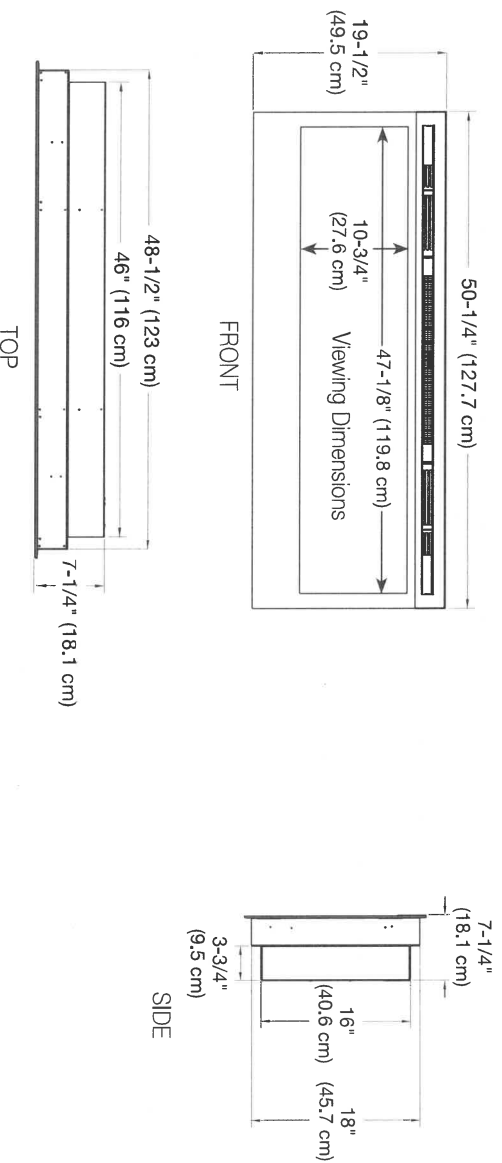

### Installation Options and Framing Dimensions

#### 3 Mounting Options

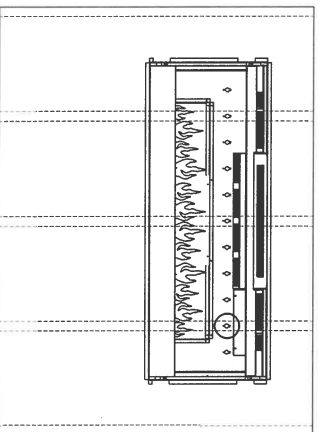

##### ON WALL

Must mount to a minimum of three (3) wall studs

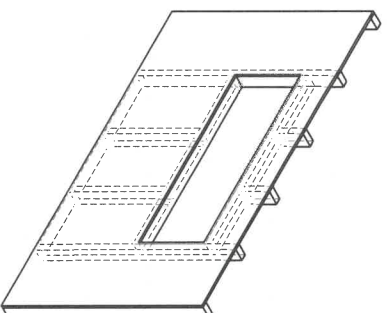

##### PARTIAL RECESSED

2 X 4 Wall Construction  
Framing dimensions:  
46-1/2" W x 16-1/2" H  
(118.1 cm) W x (42 cm) H

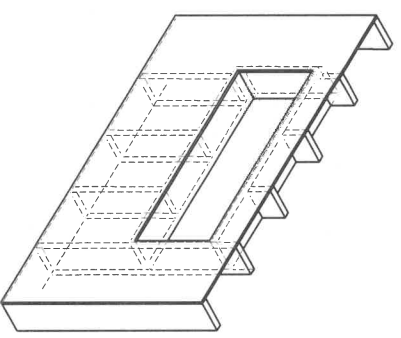

##### FULLY RECESSED

2 X 8 Wall Construction  
Framing dimensions:  
49" W x 18-1/2" H  
(124.5 cm) W x (47 cm) H

133/10/20/28

SHORELINE POINT  
WASAGA BEACH

CORAL 60-04

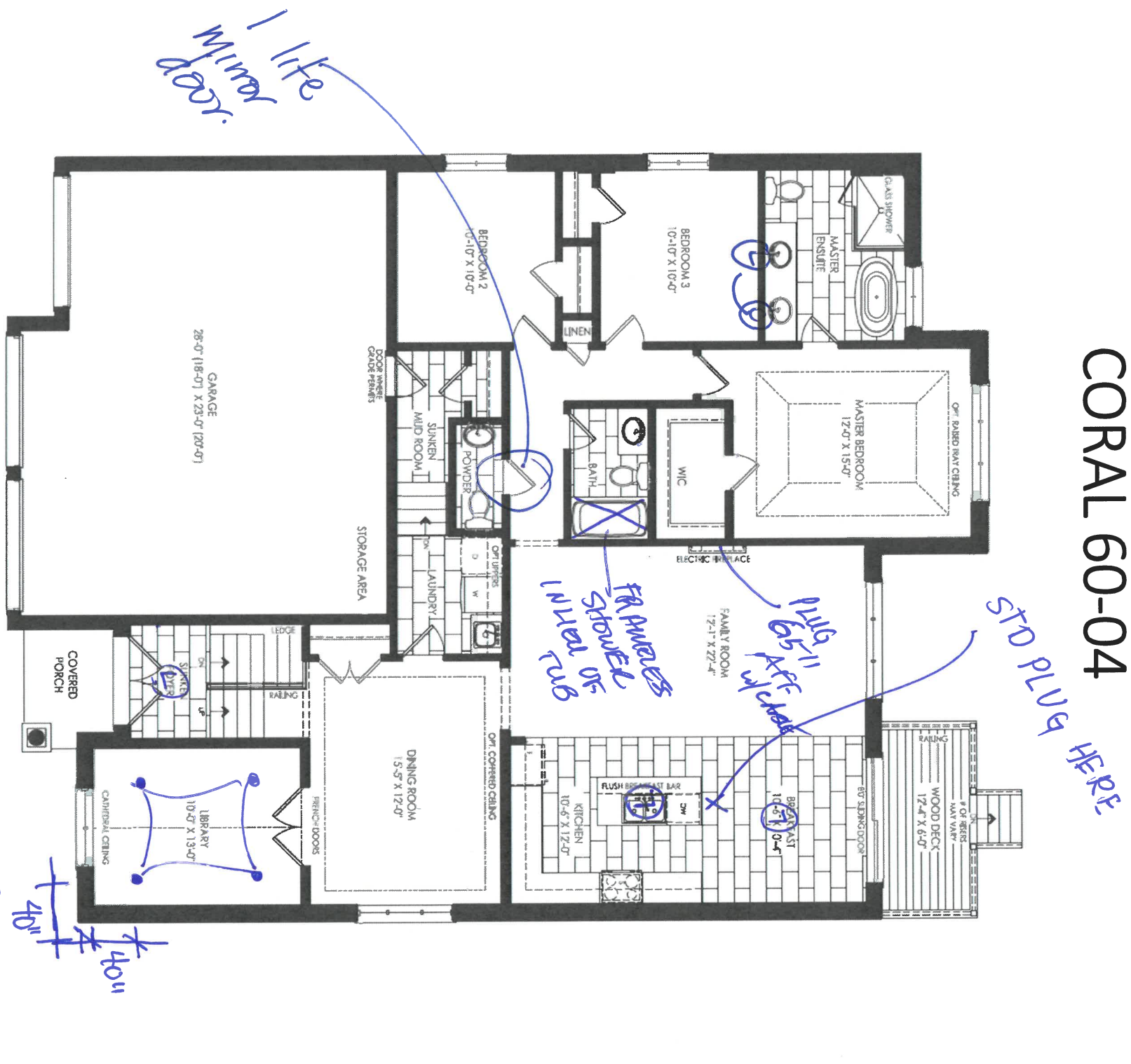

Elevation A  
Ground Floor

✓



CORAL 60-04

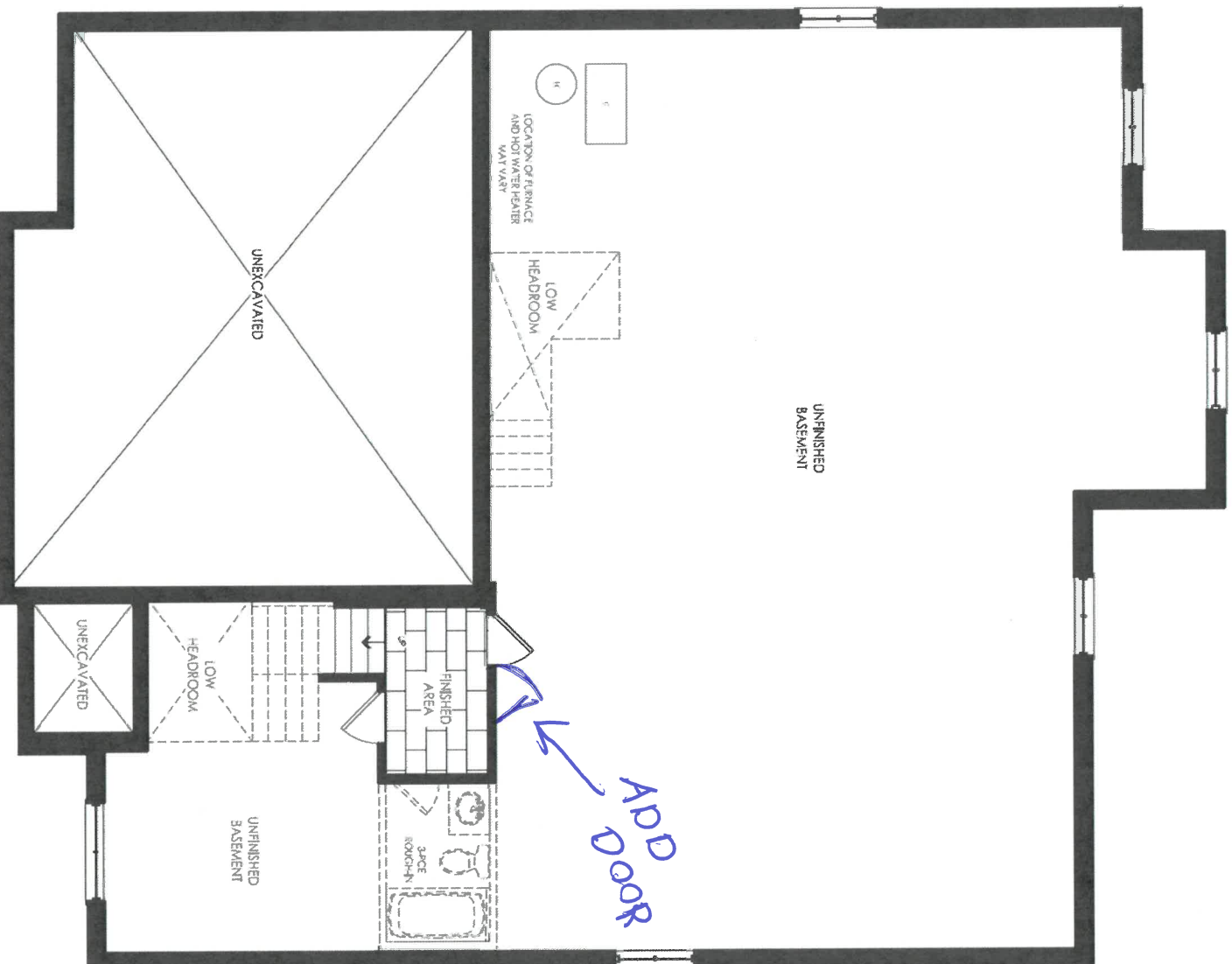

Elevation A  
Basement

Handwritten blue signatures.

SHORELINE POINT  
WASAGA BEACH

CORAL 60-04

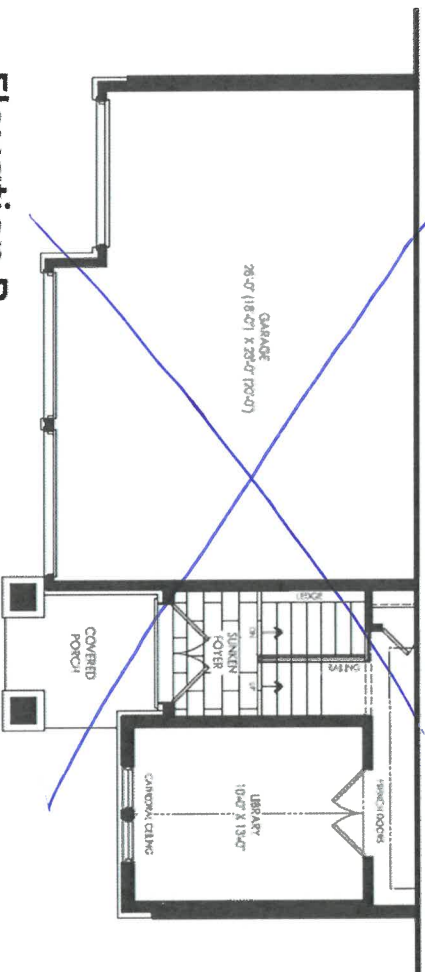

Elevation B  
Ground Floor

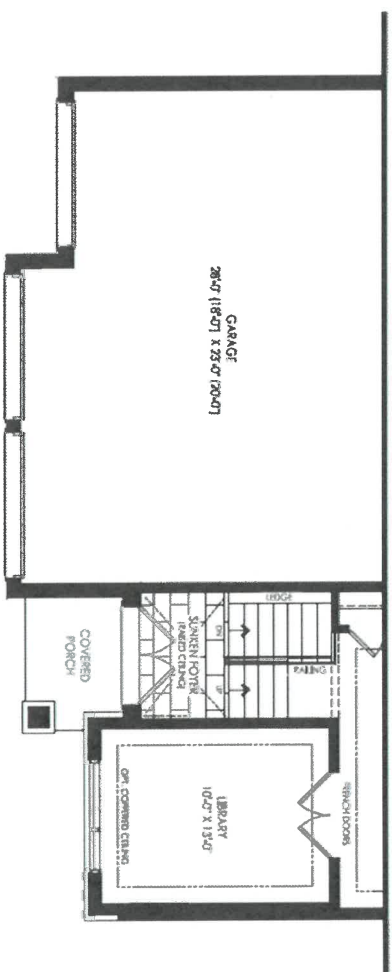

Elevation C  
Ground Floor

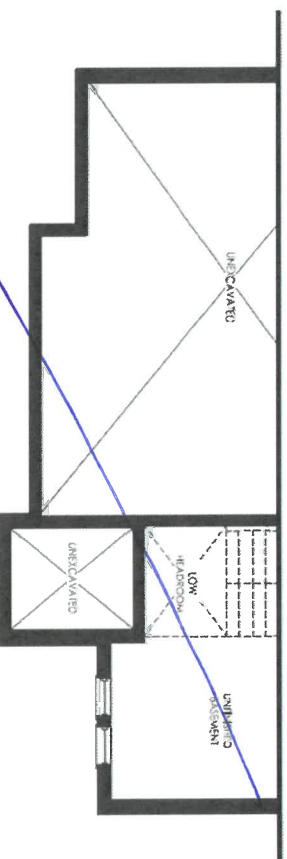

Elevation B  
Basement

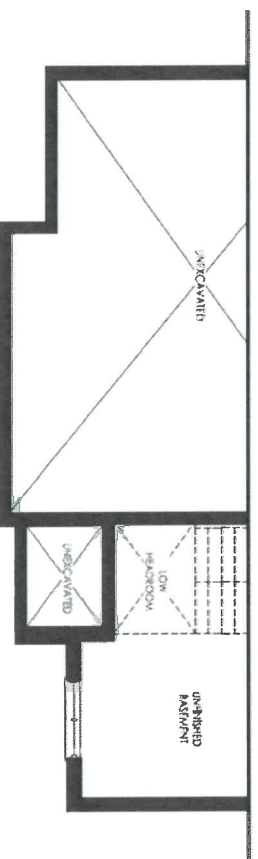

Elevation C  
Basement

4



# SHORELINE POINT

WASAGA BEACH

## CORAL 60-04

### The Coral



ALL ELEVATIONS INCLUDE 55 SQ FT OF FINISHED BASEMENT



*Handwritten signature in blue ink.*



NEW INTERIOR KITCHENS INC.

DATE SUBMITTED

16 Jun 2021

CLIENT NAME: ZANCOR HOMES  
SHIP TO: SHORELINE POINT

DRAFTED BY: FERNANDA  
COMMENT

DWG NUMBER

INSTALL DATE:

PAGE

20 of 22

P/O #

60-04  
KITCHEN

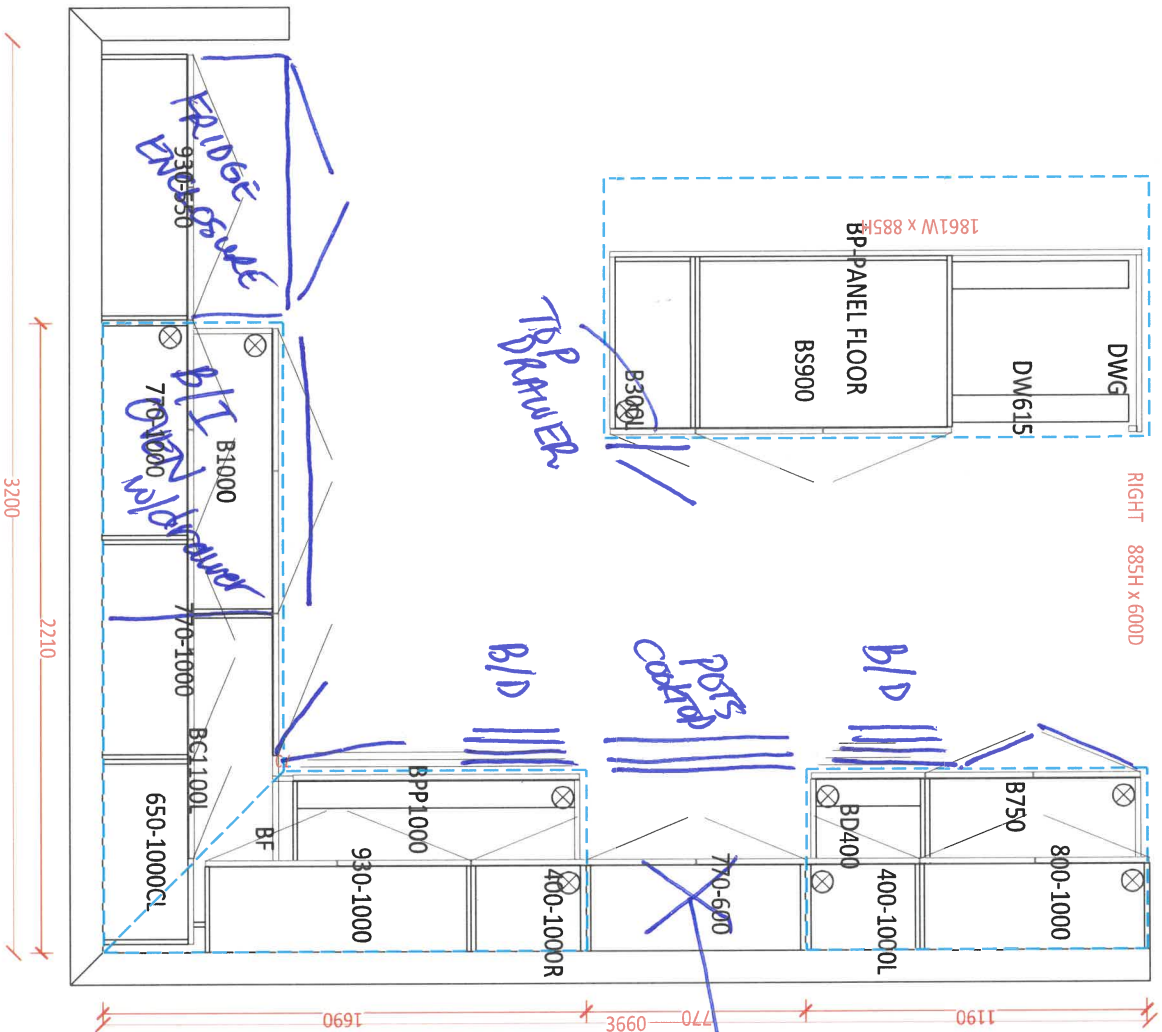

\* ALL SOFT CLOSE \*

Handwritten signature/initials.





DATE SUBMITTED

16 Jun 2021

CLIENT NAME: ZANCOR HOMES  
SHIP TO : SHORELINE POINT

DRAFTED BY: FERNANDA  
COMMENT

PH:  
CELL:

P/O #

CS NUMBER

INSTALL DATE:

PAGE

21 of 22

60-04

MAIN

910

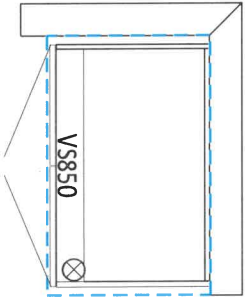

Comfort budget

MASTER ENSUITE

1850

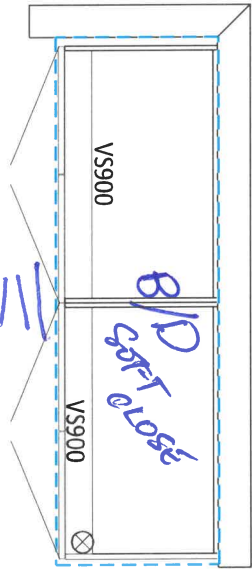

Comfort budget

LAUNDRY

2300

750

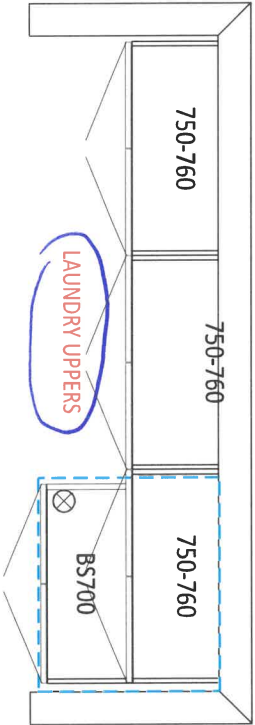

OPT. BASEMENT BATH

900

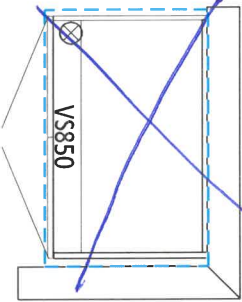

Handwritten signature

APPLIANCE ACKNOWLEDGEMENT

CONTACT: Steve Miller - Appliance Canada (905) 660-2424 / smiller@appliancecanada.com

- It is the Purchaser's responsibility to coordinate delivery, installation and hook up of appliances and to ensure they are installed as per Manufacturers specifications after closing.

STANDARD APPLIANCE OPENINGS provided by Zancor:

\*Standard appliance openings are approximate and the minimum required. Sizes may vary due to onsite condition and/or when modifications have been made to the cabinetry.

- Fridge Opening 36" x 74"  
► Stove Opening 30"  
► Hood Fan Opening 30"  
► Hood Fan & Vent 6" with Under Cabinet Hood  
► Dishwasher Opening 24"

Accepts Standard  
Openings \*\*Initial



OPTIONAL UPGRADED APPLIANCES to be provided by Homeowner:

**\*\*Specs/information sheets are required and it is the responsibility of the homeowner to provide this to Zancor Homes by the due date that has been provided. If appliance specs are not submitted, Zancor Homes will not be responsible for any necessary requirements and the standard opening will be built.**



INITIAL

- **Upgraded Appliance Specs are DUE 2 WEEKS FROM SIGNED DATE OF COLOUR CHART (if not received during appointment)**
- \*\*Specs that require changes/modifications after this date will not be accepted\*\*\*
- NOTE: Any upgraded appliances are to be paid by the Purchaser, directly to the appliances company.
- Additional charges to the Purchaser may apply for cabinetry, electrical and plumbing in order to accommodate the specs given by the homeowner.

FRIDGE UPGRADE

- ☐ Built-in
- ☐ Paneled \*\*Panel to match required
- ☐ Integrated / Flush Inset
- ☐ Waterline

RANGE UPGRADE

\*Larger hood fan CFM might be required, which need a larger vent

☐ 36" \*\*Hood fan opening must be the same size or larger (8" vent might be required)

☐ 48" \*\*Hood Fan opening must be the same size or larger (8" or 10" vent required)

- ☐ Gas Range \*\*gas line and electrical required & sold separately
- ☐ Induction \*\*electrical required & sold separately
- ☐ Cooktop (Apron Front) \*\*Countertop Cut-out required & sold separately
- ☐ Cooktop (Drop-in) \*\*countertop Cut-out required & sold separately

HOOD FAN & VENT

UPGRADE

- ☐ 8 Inch \*\*Required for 600 CFM
- ☐ 10 Inch
- ☐ Chimney Hood Fan \*\*Vent must be centred
- ☐ Insert / Liner

WALL OVEN/MICRO

UPGRADE

\*\*Electrical required

- ☐ Single Wall Oven \*\*electrical required & sold separately
- ☐ Double Wall Oven \*\*electrical required & sold separately
- ☐ Steam Oven \*\*electrical required & sold separately
- ☐ Warning Drawer \*\*electrical required & sold separately
- ☐ Over Then Range Microwave (OTR)
- ☐ Built-In Microwave \*\*Trim Kit required \*\*electrical required & sold separately

Aug 11/25

WASAGA SHORLINE

4

DATE

SITE

LOT

\*\* Any upgrades checked in this appliance form must be accompanied with specs provided by the Purchaser.

\*\*It is the responsibility of the trade to inform the Builder of any discrepancies with specs, sketches, extras and/or colour chart PRIOR to production/installation.

ZANCOR

221 North Rivermede Road, Concord, Ontario L4K 3N7 \* T: (905) 738.7010 F: (905) 738.5948



THE  
GALLERY

SHORELINE POINT  
WASAGA BEACH

ZANCOR

INTERIOR FINISHES ACKNOWLEDGEMENT / WAIVER

Purchaser accepts and acknowledges that the Builder reserves the right to substitute materials with those of equal or better quality where the manufacture, scheduling or delivery of materials may directly impact the Builder's ability to meet its' contractual obligations under the Agreement of Purchase and Sale.

**UPGRADES/EXTRAS:** All upgrades and additional selections indicated on the colour chart must be accompanied by an upgrades/extras sheet (PES) and full payment otherwise the selection will be invalid. All colour charts and upgrades/extras will not proceed until verified and signed by an authorized signing officer at the Vendor's head office. **CHANGES WILL NOT BE PERMITTED UPON COMPLETION AND SUBMISSION OF THE COLOUR CHART.**

**PORCELAIN & NATURAL STONES:** Due to the properties of natural stones including but not limited to **marble, granite, quartz**, no two pieces are exactly the same. Variations in colour, tone, granularity (pitting, fissures) and pattern are to be expected, including various lighting may affect the overall finished look. Stone tops are sealed at time of installation and should never be cleaned with lemon oil or vinegar. Stones are porous materials, therefore any spilled substance require immediate attention. Stone countertops require regular seal re-application as part of home maintenance. Purchaser acknowledges colour and product variations as well as natural imperfections may exist with the selection of natural stone materials and shall not hold the Vendor liable for provision of same.

**STONE COUNTERTOP JOINTS:** Purchaser is aware that one joint will be at each corner and on either side of slide-in-range (if applicable). It will also be where the length of the counter top exceeds the length of a stone slab. Slabs are usually approximately 5'x 8'.

**CERAMIC TILES:** Due to manufacturing, shade (dye lots), product variations may exist that can affect the overall look of the finished product. Although every effort will be made to ensure the colours and materials selected are as close as possible to the samples, the purchaser acknowledges that the sample tiles supplied in the Design Centre may not be identical to the materials installed in the home.

**STAIR STAINS:** Due to the natural properties of wood, many variables can affect the overall look of the finished product. Factors including but not limited to wood type, knotting, graining, density, age, humidity, and air temperature can result in substantial variations in stain intensity. The purchaser accepts that although the Vendor will do their best to match stain the unfinished stairs as close as possible to the pre-finished floors, it is not possible to have an identical match and that there **MAY** be shade differences between the two products.

**CABINETRY:** Due to the natural properties of wood, slight variations apparent with cabinetry are to be expected. This includes but not limited to wood species, wood grain, colour, finish, product variations, and natural imperfections are all factors that may affect the overall look of the finished product. Such factors make exact colour matching impossible. The type and intensity of lighting in the areas of designated cabinetry placement may also highlight characteristics of cabinetry finish. All cabinets shall be finished with a white melamine interior box unless a finished interior is upgraded. Due to building specifications and/or on-site conditions, certain cabinetry upgrades may not be possible. The purchaser acknowledges that the Builder cannot guarantee the cabinetry finish or provision of certain upgrades and shall not hold the Builder liable for provision of same.

**UPGRADES/EXTRAS:** All upgrades and additional selections indicated on the colour chart must be accompanied by an upgrades/extras sheet (PES) and full payment otherwise the selection will be invalid. All colour charts and upgrades/extras will not proceed until verified and signed by an authorized signing officer at the Vendor's head office. **CHANGES WILL NOT BE PERMITTED UPON COMPLETION AND SUBMISSION OF THE COLOUR CHART.**

**HARDWOOD / LAMINATE FLOORING:** Due to the properties of wood and laminate, many variables can affect the overall look of the finished product. Variations include but not limited to wood type or laminate finish, colour/stain and wood grain are significant factors that make exact colour matching impossible. The purchaser acknowledges that the hardwood flooring is a pre-finished product in a controlled environment. Expansion, compression and cupping are characteristics of hardwood flooring once installed in the home. The purchaser acknowledges these may become apparent over time and despite the Builders' efforts to install the hardwood flooring materials in keeping with good workmanship, the Builder shall not be responsible nor held liable for minor variances of fluctuation in hardwood flooring materials.

HARDWOOD / LAMINATE WAIVER:

I/We understand hardwood flooring is classified as a porous material and as such not recommended by the Builder in certain areas. I/We understand there is a concern due to possible water and other substances being frequently splashed or spilled onto the floor and in contravention of Ontario Building Code Section 9.30.1.2(1).

*"Finished flooring bathrooms, kitchens, public entrance halls, laundry & general storage areas shall consist of resilient flooring, felted-synthetic-fibre floor coverings, concrete, terrazzo, ceramic tile, mastic or other types of flooring providing similar degrees of water resistance.*

I/We are prepared to assume full responsibility for any damage caused to the hardwood floor or subfloor due to moisture absorbency in the mentioned areas, and agree to waive any claims against the Township of residence, TARION and/or the Builder in relation to the matter. **\*\*SEE COLOUR CHART FOR LOCATIONS\*\***

DATE Aug 11/21

SITE WASAGA SHORELINE

LOT 4

221 North Rivermede Road, Concord, Ontario L4K 3N7 \* T: (905) 738-7010 F: (905) 738-5948

HOME AUTOMATION  
(Cable, CAT5/6, Telephone)

**INCLUDED IN SCHEDULE "A" IN AGREEMENT OF PURCHASE AND SALE:**

- Rough-in for Central Vacuum system piped to garage
- Rough-in for Telephone (2) locations
- Rough-in for Cable TV (2) locations
- Rough-in for Cat-6 Network (3) locations

**CONTACT:**

I/we the Homeowner(s) have chosen to contact the Home Automation Company to select the locations of the rough-ins for Cable, CAT5, Telephone as included in our Agreement of Purchase Sale.

I/we the Homeowner(s) will contact the trade within 4 weeks of the date of this release to select locations of the standard rough-ins review other optional products for purchase.

Trade: Smart-Tech Home Automation  
Phone: (905) 761-6469  
Email: [kris@smart-tech.ca](mailto:kris@smart-tech.ca)  
Rep: Kris  
Location: 200 Millway Avenue, Unit 8  
Concord, Ont L4K 5K8

**ACKNOWLEDGEMENT:**

I/We the homeowner(s) acknowledge that if I/We the homeowners decide to not contact Smart-Tech, locations of the standard rough-ins will be installed as per Vendors discretion.

Homeowner(s) Initial

DATE Aug 11/21

WASAGA SHORELINE

LOT 4



BRICK/JOINT PATTERN INSTALLATION  
RELEASE FORM

**\*BRICK installation is included as a standard on the floor for 12 x 24 tiles and must be noted on the colour chart and acknowledged on this form\***

(Large tiles installation for floor and wall) – ¼ Brick

Please be advised it has come to our attention, that due to production, many of the over-sized and odd shaped, man-made tiles (i.e. porcelain & ceramic), have been found to have a slight bow in the tile. It is a standard occurrence with all suppliers and manufacturers.

It is therefore recommended, that if and when a purchaser requests to install one of these tiles in a brick-joint pattern, that it be installed on a ¼ brick pattern, to try to avoidlippage. Attached with this letter, you will find a layout of the ¼ brick installation that has been recommended.

LOCATIONS: All Floors  
LOCATIONS: \_\_\_\_\_  
LOCATIONS: \_\_\_\_\_  
LOCATIONS: \_\_\_\_\_

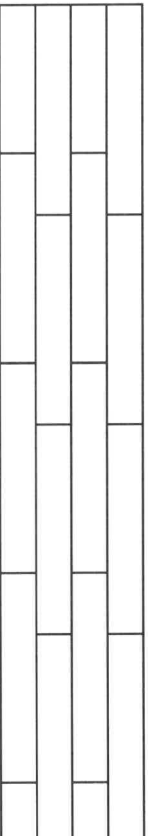

Please understand, even in using this ¼ brick installation, there may still be minimal lippage which cannot fully be eliminated.

Hence, when there is a request for brick-joint installation, Zancor Homes and their contractor, cannot be held responsible for this matter.

Homeowner(s) Initial

(Small tile installation for walls) – ½ Brick

Purchaser requests to install small wall tiles on a backsplash or shower wall in a brick-joint pattern, that it be installed on a ½ brick pattern.

LOCATIONS: \_\_\_\_\_  
LOCATIONS: \_\_\_\_\_  
LOCATIONS: \_\_\_\_\_  
LOCATIONS: \_\_\_\_\_  
LOCATIONS: \_\_\_\_\_



Homeowner(s) Initial

DATE Aug 11/21

SITE WASAGA SHORELINE

LOT 4