

Site: BROOKLIN NOW TOWNS

Lot: 9-52

Model: RLT-03 DISCOVER

Purchaser: HASHIR SALMAN

Purchaser: ZEB SALMAN KHAWAJA

Phone: 647-860-7041

Email: [zebsalman\\_69@hotmail.com](mailto:zebsalman_69@hotmail.com)



DESCRIPTION		DATE SELECTED
	BONUS PACKAGE: 3 PIECE STAINLESS STEEL APPLIANCES WITH WHITE FRONT LOAD WASHER & DRYER	INCLUDED IN APS
	BONUS PACKAGE: STAINLESS STEEL HOOD FAN	INCLUDED IN APS
	BONUS PACKAGE: AIR CONDITIONING UNIT	INCLUDED IN APS
#1	HARDWOOD UP 1 GREAT ROOM, LIVING/ DINING/ KITCHEN BREAKFAST/ UPPERHALL/ LANDINGS	23-Apr-21
#2	STAIN STAIRS 2 FLIGHTS	23-Apr-21
#3	FINISHED BAR SINK IN SERVERY WITH FAUCET ( BLANCO 400781/ CHATEAU 4903)	23-Apr-21
#4	PLUMBING METHOD IN CHROME (4) PIVOTING PAPER HOLDER YB2408 (2) 24" TOWEL BAR YB2424/ (2) 18" TOWEL BAR FOR POWDER ROOMS YB2418	23-Apr-21
#5	STANDARD BANK OF VANITY DRAWERS IN THE MIDDLE OF THE 2 SINKS IN THE MASTER ENSUITE- 2 SMALL 1 LARGE	23-Apr-21

ENTRANCES				
Main Foyer - FLOORING		ESPARATA CREMA 18 X 18		
Mudroom - FLOORING		ESPARATA CREMA 18 X 18		
Side Hall - FLOORING		NA		
Goundv Foyer - FLOORING		ESPARATA CREMA 18 X 18		
KITCHEN				
Kitchen - FLOORING		SOLID SAWN PEARL 3 1/4" ECLIPSE UP # 1		
Breakfast - FLOORING		SOLID SAWN PEARL 3 1/4" ECLIPSE UP # 1		
Kitchen - CABINETS		EURO BLACKWOOD		
Island - CABINETS		EURO BLACKWOOD		
Servery - CABINETS		EURO BLACKWOOD		
Kitchen - HANDLES/KNOBS		H-500-P		
Kitchen - COUNTERTOP		BIANCO SARDO GRANITE		
Island -/SERVERY COUNTERTOP		BIANCO SARDO GRANITE		
Kitchen - BACKSPLASH		NA		
Kitchen - SINK		STANDARD		
Kitchen - FAUCET		STANDARD		
GREAT ROOM / DINING / LIVING / DEN / OFFICE / BASEMENT				
Dining Room - FLOORING		N35 SOLID SAWN PEARL 3 1/4" ECLIPSE UP # 1		
Living Room - FLOORING		SOLID SAWN PEARL 3 1/4" ECLIPSE UP # 1		
Great Room - FLOORING		SOLID SAWN PEARL 3 1/4" ECLIPSE UP # 1		
Library / Den - FLOORING		NA		
Basement Rec Room - FLOORING		N35 SOLID SAWN PEARL 3 1/4" ECLIPSE UP # 1		
STAIRS				
Railing Details - PICKETS		METAL BLACK Single COLLAR WITH ALT PLAIN		
Railing Details - POSTS		1 3/4" TURNED OAK		
Railing Details - HANDRAIL		2 1/2" OAK OVAL		
Stair Stain - MAIN STAIRS (2 FLIGHTS)		STAIN TO MATCH HARDWOOD AS CLOSE AS POSSIBLE		
Stair Stain - BASEMENT STAIRS (if applicable)		NA		
Stair Stain - SERVICE STAIRS (if applicable)		NA		
POWDER ROOM				
Powder Room - FLOORING Ground Floor		ESPARATA CREMA 18 X 18		
Powder Room FLOORING 2nd Floor		ESPARATA CREMA 18 X 18		
Powder Room - COUNTERTOP		NA		
Powder Room - SINK		STANDARD		
Powder Room - FAUCET		STANDARD		
2ND FLOOR				
Upper Hall - FLOORING		N35 SOLID SAWN PEARL 3 1/4" ECLIPSE UP # 1		
Master Bedroom - FLOORING		OPENING NIGHT T-15		
Bedroom 2 - FLOORING		OPENING NIGHT T-15		
Bedroom 3 - FLOORING		OPENING NIGHT T-15		
Bedroom 4 - FLOORING		NA		
Bedroom 5 - FLOORING		NA		
Master Ensuite - FLOORING		NEW BYZANTINE PENTELLIC GREY 12 X 24		
Master Ensuite - SHOWER WALL		NEW BYZANTINE PENTELLIC GREY 12 X 24		
Master Ensuite - SHOWER FLOOR		2 X 2 WHITE		
Master Ensuite - SHOWER JAMB		PERLATO ROYALE		
Master Ensuite - CABINETS		SHAKER V PVC TUXEDO		
Master Ensuite - HANDLES/KNOBS		H-900AC		
Master Ensuite - COUNTERTOP		SIERRA CASCADE 5005-38		
Master Ensuite - SINK(S)		STANDARD	Master Ensuite - FAUCET(S)	STANDARD
***FOR TRADE USE***				
Any upgrades in the colour chart must be accompanied with a PES. It is the responsibility of all Trades to inform the builder of any discrepancies on sketches, PES and/or colour charts PRIOR to installation.		9-52- BROOKLIN		
		**PAGE 1 OF 2**		
		PURCHASER INITIALS	VENDOR APPROVAL	



2ND FLOOR CONTINUED ...				
Main Bath - FLOORING	NEW BYZANTINE PENTELLIC GREY 12 X 24			✓
Main Bath - TUB / SHOWER WALL	NEW BYZANTINE PENTELLIC GREY 12 X 24			✓
Main Bath - SHOWER FLOOR	NA			
Main Bath - SHOWER JAMB	NA			
Main Bath - CABINETS	SHAKER V PVC TUXEDO			✓
Main Bath - HANDLES/KNOBS	H-900-AC			✓
Main Bath - COUNTERTOP	SIERRA CASCADE 5005-38			✓
Main Bath - SINK(s)	STANDARD	Main Bath - FAUCET(s)	STANDRD	
Shared Bath - FLOORING	NA			
Shared Bath - TUB / SHOWER WALL	NA			
Shared Bath - SHOWER FLOOR	NA			
Shared Bath - SHOWER JAMB	NA			
Shared Bath - CABINETS	NA			
Shared Bath - HANDLES/KNOBS	NA			
Shared Bath - COUNTERTOP	NA			
Shared Bath - SINK(s)	NA	Shared Bath - FAUCET(s)	N	
Ensuite Bath - FLOORING	NA			
Ensuite Bath - TUB / SHOWER WALL	NA			
Ensuite Bath - SHOWER FLOOR	NA			
Ensuite Bath - SHOWER JAMB	NA			
Ensuite Bath - CABINETS	NA			
Ensuite Bath - HANDLES/KNOBS	NA			
Ensuite Bath - COUNTERTOP	NA			
Ensuite Bath - SINK(s)	NA	Ensuite Bath - FAUCET(s)	NA	
LAUNDRY				
Laundry - FLOORING	NEW BYZANTINE PENTELLIC GREY 12 X 24	Laundry - HANDLES/KNOBS	NA	
Laundry - CABINETS	NA	Laundry - SINK	STANDARD	
Laundry - COUNTERTOP	NA	Laundry - FAUCET	STANDARD	
Laundry - BACKSPLASH	NA			
TRIM / PAINT				
Casing/Baseboards	STANDARD			
Interior Doors	STANDARD			
Interior Door Hardware	STANDARD			
PAINT - Throughout	CAMEO WHITE		✓	
FIREPLACE				
Location / Insert / Mantle	NA			
ACCESSORIES				
Mirrors	STANDARD	BATH ACCESSORIES	UPGRADE	
APPLIANCE REQUIREMENTS				
GAS LINE TO BBQ	STANDARD	ELECTRICAL for Built-in Oven	NA	
GAS LINE & ELECTRICAL TO STOVE	NA	ELECTRICAL for Built-in Micro	NA	
GAS LINE & ELECTRICAL TO DRYER	NA	ELECTRICAL for Cooktop	NA	
HOOD FAN VENT SIZE	STANDARD 6"	ELECTRICAL for Bar Fridge	NA	
WATERLINE to Fridge	NA			
DISCLAIMER		INITIALS		
Any changes to the colour chart after signing are subject to a \$5000 administration fee plus costs				
Purchaser has checked and acknowledged accuracy of colour and selections before signing.				
Colours of all materials are as close as possible to Builders selection but not necessarily identical due to dye lot variances in manufacturing/manufacturers. Due to construction progress some items may have been pre-selected or installed. In this event the Vendors's selection must be accepted by the purchaser				
SITE / LOT: 9-52 BROOKLIN ✓				
PURCHASER(S): HASHIR SALMAN				
HOME #/CELL # 647.860.7041				
EMAIL: ZESALMAN 69@HOTMAIL.COM				
***FOR TRADE USE***				
Any upgrades in the colour chart must be accompanied with a PES. It is the responsibility of all Trades to inform the builder of any discrepancies on sketches, PES and/or colour charts PRIOR to installation.				
ZANCOR HOMES		PURCHASER SIGNATURE		
PURCHASER SIGNATURE		PURCHASER SIGNATURE		
DÉCOR CONSULTANT		DÉCOR CONSULTANT		
Vendor APPROVAL		Vendor APPROVAL		
SIGNATURES / DATE				

Lot 9-52  
ADDL  
23/21

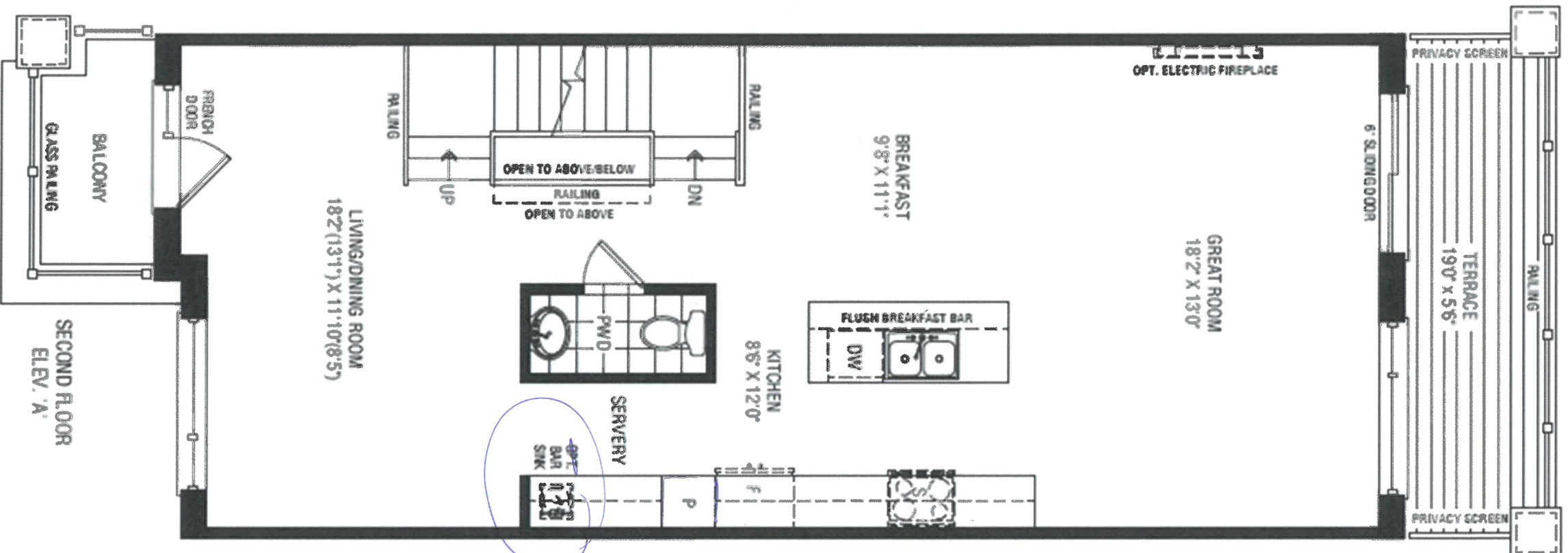

ADD BAR SINK

6x7

DISCOVER

1919-52

APR 12

23/2

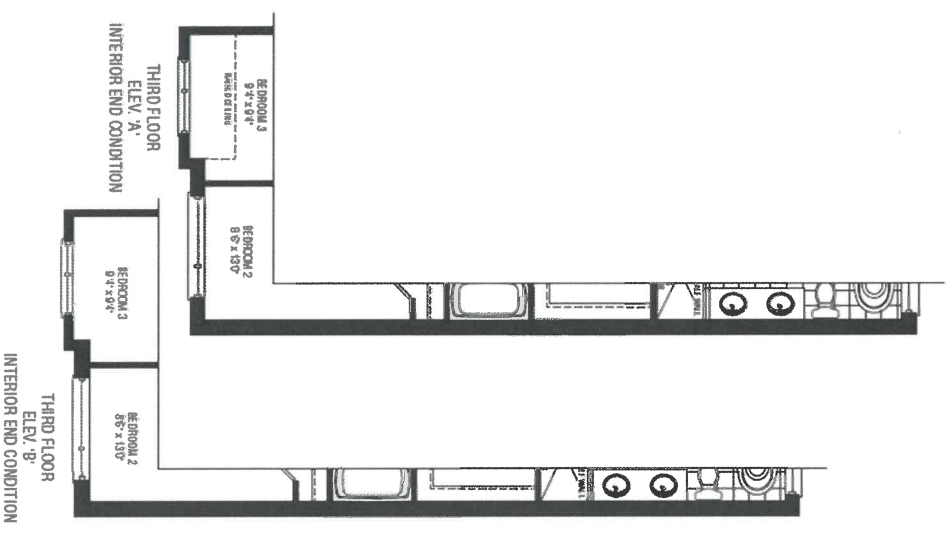
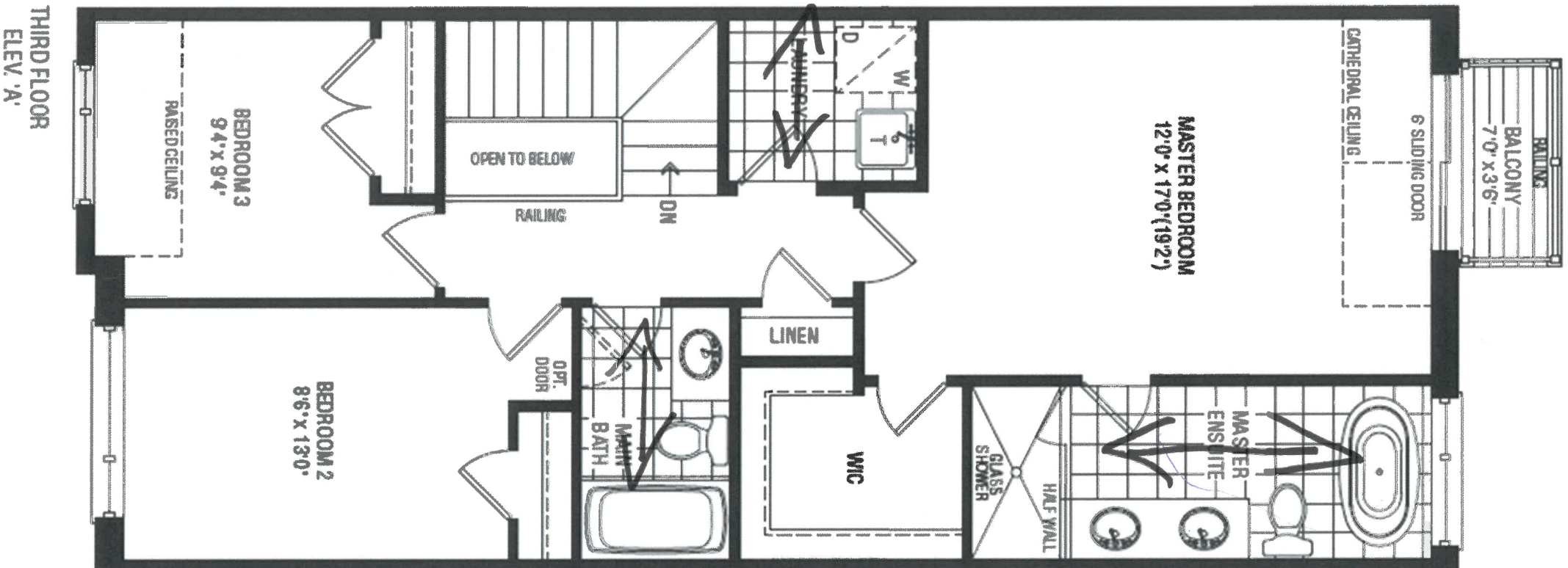

Floor Tile  
Dikanda



# DISCOVER



1019-52  
APR 16 23/21

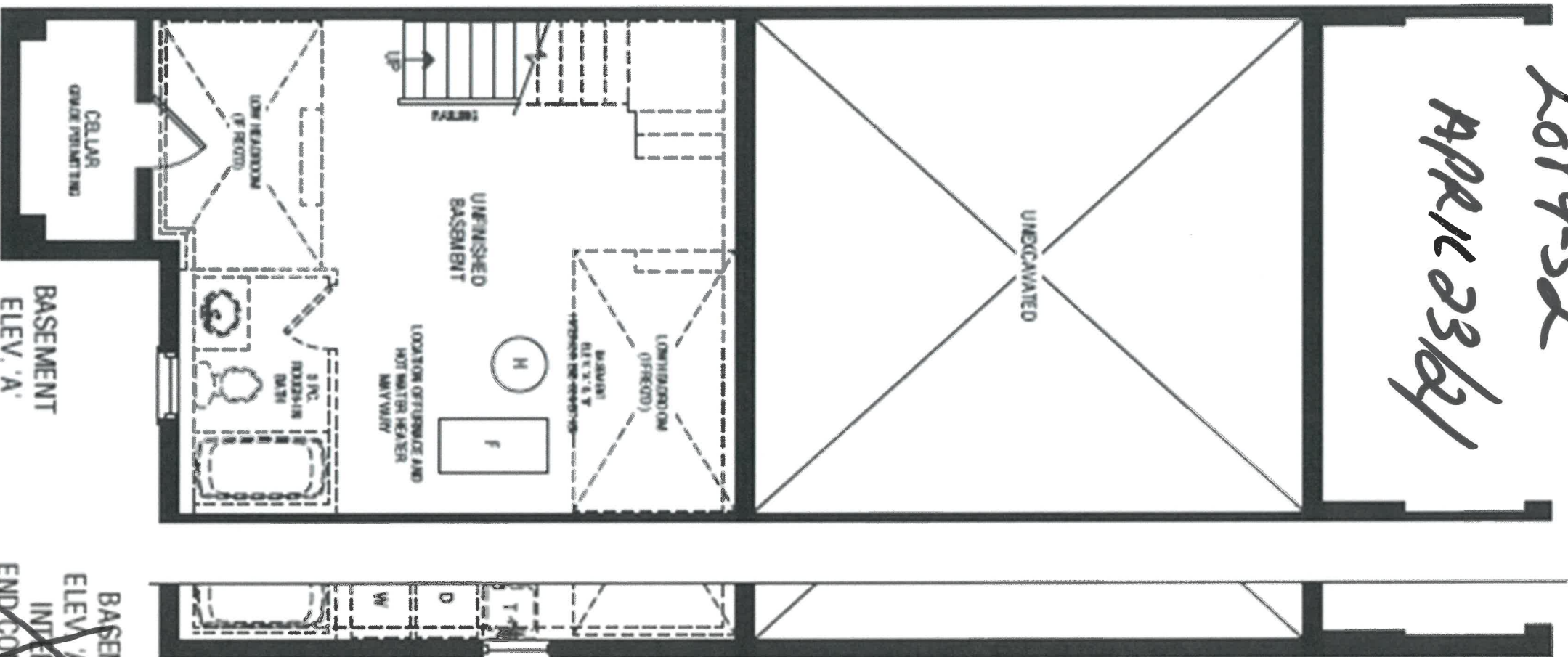

BASEMENT  
ELEV. 'A' & 'B'  
INTERIOR  
END CONDITION

F-1

DISCOVER

1019-52

APR 12 23/21

000A WHITE  
GRADE PERRY'S

**PVD -  
SINKEN  
F REOD**

ON  
STEPS & READ

FOYER  
(SUNSHINE READY)



5

GROUND FLOOR  
ELEV. '8'  
INTERIOR  
END CONDITION

# DISCOVER



DATE SUBMITTED  
30 Mar 2021

CLIENT NAME: ZANCOR HOMES  
SHIP TO : BROOKVALLEY TOWNS

DRAFTED BY: FERNANDA  
COMMENT  
PH:  
CELL:

JOB NUMBER  
INSTALL DATE:  
PAGE  
18 of 19

RLT-03  
STANDARD VANITIES ELEV A & B  
END

Let 9-52  
A/R/L  
23/2

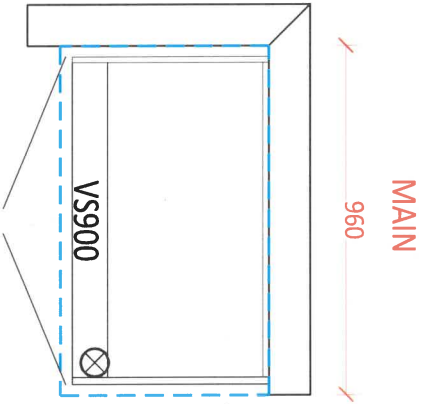

MASTER ENSUITE

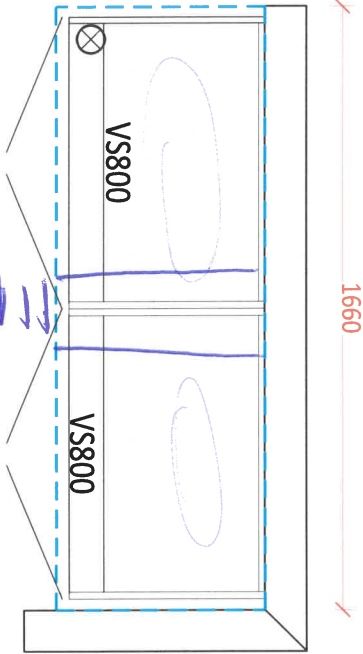

4-5'

ADD Bank

of  
Drawers

OPT. BASEMENT BATH

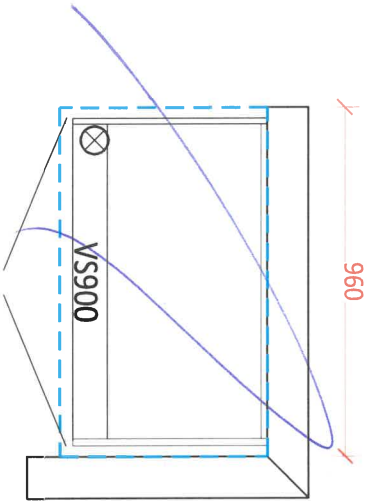





DATE SUBMITTED  
30 Mar 2021

CLIENT NAME: ZANCOR HOMES  
SHIP TO : BROOKVALLEY TOWNS

DRAFTED BY: FERNANDA  
COMMENT

PH:  
CELL:

P/O #

JOB NUMBER

INSTALL DATE:

PAGE  
17 of 19

RLT-03  
KITCHEN 3D DRAWING

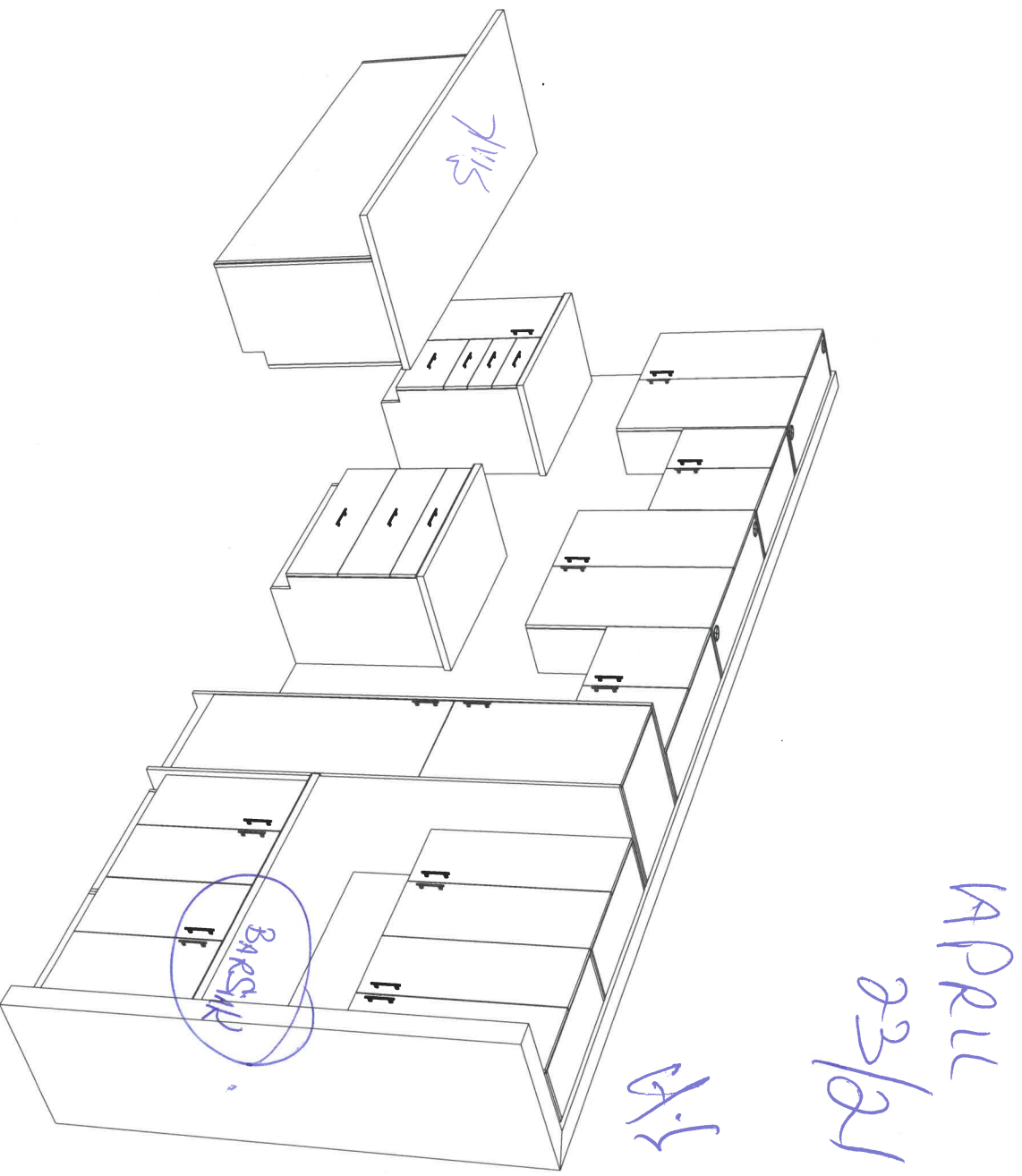

Stone Countertop Edge Profiles

\*\*Where applicable as per site specifications\*\*

LOT / SITE:

BROOKLIN TOWNS -

9-57

DATE:

APRIL 23/21

STANDARD EDGE FOR KITCHEN & VANITIES

Standard Countertop Edge  
in Kitchen

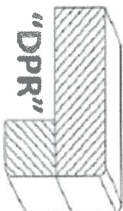

Standard Countertop Edge  
in Vanity

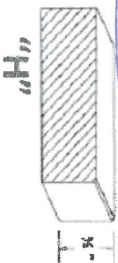

Handwritten initials: A.S.

Homeowner(s) Initial

OPTION (1) EDGE FOR KITCHEN & VANITIES \$250

Optional Edge in Kitchen

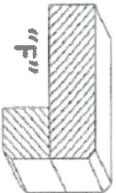
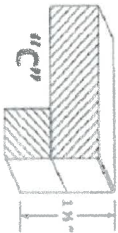

Optional Edge in Bathroom

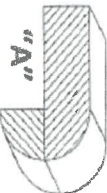
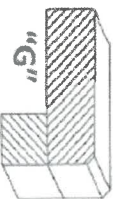
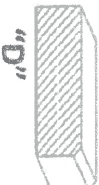

Homeowner(s) Initial

OPTION (2) EDGE FOR KITCHEN & VANITIES CUSTOM PRICING

Optional Edge for Kitchen

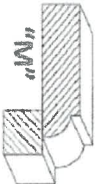
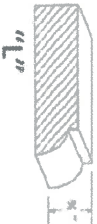

Optional Edge in Vanity

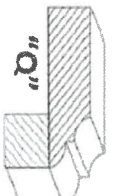
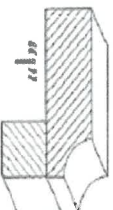
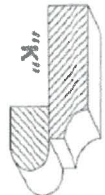
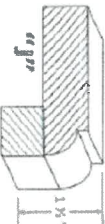
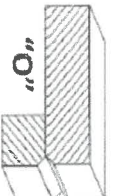
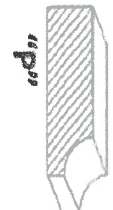

Homeowner(s) Initial

HOME AUTOMATION  
(Cable, CAT5, Telephone)

LOT / SITE:

BROOKLIN TOWNS -

9-52

DATE:

APRIL 23/21

STANDARD ITEMS AS PER SCHEDULE A:

STANDARD CABLE ROUGHIN in (1) Master Bedroom, (1) Family / Great Room  
STANDARD TELEPHONE ROUGHIN in (1) Master Bedroom, (1) Family / Great Room  
STANDARD CAT5 ROUGHIN - (3) In location of Purchasers choice.

OPTION 1:

I/we the Homeowner(s) have chosen to contact the Home Automation Company to select the locations of the rough-ins for Cable, CAT5, Telephone as included in our Agreement of Purchase Sale.

I/we the Homeowner(s) will contact the trade within 4 weeks of the date of this release to select locations of the standard rough-ins review other optional products for purchase.

Trade:

Artistic Smart Homes

Phone:

(905) 850-9386

Rep:

Jessica

Location:

8601 Jane Street Unit #8 Vaughan ON L4K 5N9

Should the homeowner not make these selections within the sufficient time provided, the rough-ins as mentioned above will be installed in locations as indicated above.

X  
Homeowner(s) Initial

OPTION 2:

I/we the Homeowner(s) have chosen to not contact the home automation company. I/we the Homeowner(s) have selected the locations for the standard rough-ins for Cable, CAT5, Telephone that are included in the Agreement of Purchase and Sale directly with a décor rep .

Homeowner(s) Initial



APPLIANCE ACKNOWLEDGEMENT

CONTACT: Steve Miller @ Appliance Canada (905) 660-2424 / 8701 Jane Street, Vaughan

► Appliance Specs are DUE 2 WEEKS FROM SIGNED DATE OF COLOUR CHART (if not received during appointment)

\*\*\*Specs that require changes/modifications after this date will not be accepted\*\*\*

► NOTE: Any upgraded appliances are to be paid by the Purchaser, directly to the appliances company.

► Additional charges to the Purchaser may apply for cabinetry, electrical and plumbing in order to accommodate the specs given by the homeowner.

► It is the Purchaser's responsibility to coordinate delivery, installation and hook up of appliances and to ensure they are installed as per Manufacturers specifications after closing.

► Standard appliance openings are approximate and the minimum required. Sizes may vary due to onsite condition and/or when modifications have been made to the cabinetry.

STANDARD OPENINGS ACKNOWLEDGED BY PURCHASER:

- Fridge Opening ► 36" x 74" \*\*Size is (+/-) & space above the fridge is required due to proper air flow
- Stove Opening ► 30"
- Hood Fan Opening ► 30"
- Hood Fan Vent ► 6"
- Dishwasher Opening ► 24"

INITIAL

UPGRADED APPLIANCES BELOW (Check applicable)

it is the Purchaser's responsibility to provide Zancor Homes with the correct specification for each appliance that has been upgraded. Zancor Homes will not be responsible for appliance requirements based on upgrades if specs have not been provided to the builder.

INITIAL

FRIDGE

- ☐ Built-In ☐ Flush Inset
- (Spec's Required) ☐ Paneled / Integrated ☐ Water Line

RANGE

- ☐ 36" ☐ Cooktop (Apron front)
- (Spec's Required) ☐ 48" ☐ be the same as the stove ☐ Cooktop (Drop-in)

\*\*Larger CFM may be required with these appliances\*\*

\*\*Countertop Cut-out charge required for cooktop

- ☐ Induction

HOOD FAN &

- ☐ Under Cabinet (Standard) ☐ 6 Inch (Standard)

VENT

- ☐ Chimney (centre vent) ☐ 8 Inch

- (Spec's Required) ☐ Insert / Liner ☐ 10 Inch

WALL OVEN &

- ☐ Single Oven ☐ Warming Drawer

MICRO

- ☐ Double Oven ☐ Over the Range Microwave

- (Spec's Required) ☐ Steam Oven ☐ Built-in Microwave (\*trim kit required)

DATE

BROOKLIN TOWNS

LOT

\*\* Any upgrades checked in this appliance form must be accompanied with specs provided by the Purchaser.

\*\*It is the responsibility of the trade to inform the Builder of any discrepancies with specs, sketches, extras and/or colour chart PRIOR to production/installation.

INTERIOR FINISHES ACKNOWLEDGEMENT / WAIVER

Purchaser accepts and acknowledges that the Builder reserves the right to substitute materials with those of equal or better quality where the manufacture, scheduling or delivery of materials may directly impact the Builder's ability to meet its' contractual obligations under the Agreement of Purchase and Sale.

H-S

**UPGRADES/EXTRAS:** All upgrades and additional selections indicated on the colour chart must be accompanied by an upgrades/extras sheet (PES) and full payment otherwise the selection will be invalid. All colour charts and upgrades/extras will not proceed until verified and signed by an authorized signing officer at the Vendor's head office. **CHANGES WILL NOT BE PERMITTED UPON COMPLETION AND SUBMISSION OF THE COLOUR CHART.**

H-S

**PORCELAIN & NATURAL STONES:** Due to the properties of natural stones including but not limited to **marble, granite, quartz**, no two pieces are exactly the same. Variations in colour, tone, granularity (pitting, fissures) and pattern are to be expected, including various lighting may affect the overall finished look. Stone tops are sealed at time of installation and should never be cleaned with lemon oil or vinegar. Stones are porous materials, therefore any spilled substance require immediate attention. Stone countertops require regular seal re-application as part of home maintenance. Purchaser acknowledges colour and product variations as well as natural imperfections may exist with the selection of natural stone materials and shall not hold the Vendor liable for provision of same.

H-S

**STONE COUNTERTOP JOINTS:** Purchaser is aware that one joint will be at each corner and on either side of slide-in-range (if applicable). It will also be where the length of the counter top exceeds the length of a stone slab. Slabs are usually approximately 5'x 8'.

H-S

**CERAMIC TILES:** Due to manufacturing, shade (dye lots), product variations may exist that can affect the overall look of the finished product. Although every effort will be made to ensure the colours and materials selected are as close as possible to the samples, the purchaser acknowledges that the sample tiles supplied in the Design Centre may not be identical to the materials installed in the home.

H-S

**STAIR STAINS:** Due to the natural properties of wood, many variables can affect the overall look of the finished product. Factors including but not limited to wood type, knotting, graining, density, age, humidity, and air temperature can result in substantial variations in stain intensity. The purchaser accepts that although the Vendor will do their best to match stain the unfinished stairs as close as possible to the pre-finished floors, it is not possible to have an identical match and that there MAY be shade differences between the two products.

H-S

**CABINETRY:** Due to the natural properties of wood, slight variations apparent with cabinetry are to be expected. This includes but not limited to wood species, wood grain, colour, finish, product variations, and natural imperfections are all factors that may affect the overall look of the finished product. Such factors make exact colour matching impossible. The type and intensity of lighting in the areas of designated cabinetry placement may also highlight characteristics of cabinetry finish. All cabinets shall be finished with a white melamine interior box unless a finished interior is upgraded. Due to building specifications and/or on-site conditions, certain cabinetry upgrades may not be possible. The purchaser acknowledges that the Builder cannot guarantee the cabinetry finish or provision of certain upgrades and shall not hold the Builder liable for provision of same.

H-S

**UPGRADES/EXTRAS:** All upgrades and additional selections indicated on the colour chart must be accompanied by an upgrades/extras sheet (PES) and full payment otherwise the selection will be invalid. All colour charts and upgrades/extras will not proceed until verified and signed by an authorized signing officer at the Vendor's head office. **CHANGES WILL NOT BE PERMITTED UPON COMPLETION AND SUBMISSION OF THE COLOUR CHART.**

H-S

**HARDWOOD / LAMINATE FLOORING:** Due to the properties of wood and laminate, many variables can affect the overall look of the finished product. Variations include but not limited to wood type or laminate finish, colour/stain and wood grain are significant factors that make exact colour matching impossible. The purchaser acknowledges that the hardwood flooring is a pre-finished product in a controlled environment. Expansion, compression and cupping are characteristics of hardwood flooring once installed in the home. The purchaser acknowledges these may become apparent over time and despite the Builders' efforts to install the hardwood flooring materials in keeping with good workmanship, the Builder shall not be responsible nor held liable for minor variances of fluctuation in hardwood flooring materials.

H-S

HARDWOOD / LAMINATE WAIVER:

I/We understand hardwood flooring is classified as a porous material and as such not recommended by the Builder in certain areas. I/We understand there is a concern due to possible water and other substances being frequently splashed or spilled onto the floor and in contravention of Ontario Building Code Section 9.30.1.2(1).

*"Finished flooring bathrooms, kitchens, public entrance halls, laundry & general storage areas shall consist of resilient flooring, felted-synthetic-fibre floor coverings, concrete, terrazzo, ceramic tile, mastic or other types of flooring providing similar degrees of water resistance.*

I/We are prepared to assume full responsibility for any damage caused to the hardwood floor or subfloor due to moisture absorbency in the mentioned areas, and agree to waive any claims against the Township of residence, TARIION and/or the Builder in relation to the matter. **\*\*SEE COLOUR CHART FOR LOCATIONS\*\***

H-S

DATE 10/8/23

BROOKLIN TOWNS  
SITE

9-52  
LOT