

CONSTRUCTION SUMMARY OF EXTRAS

Printed 2021-06-03 / 3:05 PM / Page 1 of 1

Site: BROOKLIN NOW TOWNS
 Lot: 8-46
 Model: IMAGINE (TH-01)
 Purchaser: VINOTHAN KUMARAVEL
 Purchaser: 0
 Phone: 647.991.8376
 Email: VINOTHAN68@GMAIL.COM



DESCRIPTION		DATE SELECTED
BONUS PACKAGE: 3 PIECE STAINLESS STEEL APPLIANCES WITH WHITE FRONT LOAD WASHER & DRYER	INCLUDED IN APS	
BONUS PACKAGE: STAINLESS STEEL HOOD FAN	INCLUDED IN APS	
BONUS PACKAGE: AIR CONDITIONING UNIT	INCLUDED IN APS	
#1 STAIN FOR STAIRS (2 FLIGHTS)	20-May-21	
#2 HARDWOOD - UP1- GF REC ROOM, MAIN FLOOR, BREAKFAST AREA,GREAT ROOM, UPPER HALL ***SEE FLOOR PLAN ***	20-May-21	
#3 KITCHEN AND SERVERY FLOOR TILE IN THIS AREA, NOT HARDWOOD- *****SEE FLOOR PLAN***	20-May-21	
#4 KITCHEN COUNTERTOP- UP 4	20-May-21	
#5 BEDROOM CARPET- MASTER, BED 1 AND 2, 3- UP 1	20-May-21	
#6 MASTER BATH SHOWER TILE- UP 1	20-May-21	
#7 KITCHEN CABINETS- UP 1	20-May-21	
#8 PIVOTING PAPER HOLDER- YB2408- QTY 4- MASTER BATH, MAIN BATH, GF POWDER, SF POWDER	20-May-21	
#9 24" TOWEL BAR- YB2424- QTY 2- MASTER AND MAIN BATH	20-May-21	
#10 9" TOWEL BAR- QTY 2- GF, SF POWDER	20-May-21	
#11 KITCHEN BACKSPASH- UP 2	20-May-21	
#12 RELOCATE LAUNDRY ROOM TO UNFINISHED BASEMENT IF POSSIBLE (SEE SKETCH), BASEMENT TO REMAIN UNFINISHED. GF LAUNDRY TO REMAIN FINISHED WITH ROUGH IN IF POSSIBLE	20-May-21	
#13 RELOCATE POSITION OF SINK AND TOILET ON GROUND FLOOR POWDER AS PER SKETCH, IF POSSIBLE	20-May-21	
#14 COMFORT HEIGHT IN MASTER AND MAIN BATH	20-May-21	
#15 50" ELECTRIC FIREPLACE- DIMPLEX PRISM BLF5051	20-May-21	
#16 PLUG FOR FUTURE TV ABOVE FIREPLACE- INSTALL 65" A/F	20-May-21	

ZANCOR HOMES COLOUR CHART

PRINTED 2021-05-20, 4:01 PM

ENTRANCES				
Main Foyer - FLOORING		NEW BYZANTINE PENTELLIC GREY 12 X 24		
Mudroom - FLOORING		NEW BYZANTINE PENTELLIC GREY 12 X 24		
Side Hall - FLOORING		NA		
Basement Foyer - FLOORING		NA		
KITCHEN				
Kitchen AND SERVERY - FLOORING		NEW BYZANTINE PENTELLIC GREY 12 X 24 - SEE SKETCH ON FLOOR PLAN		
Breakfast - FLOORING		NORTHERN SOLID SAWN COLLECTION PEARL WHITE OAK - BAROQUE- UP 1		
Kitchen - CABINETS		CAMBRIDGE MAPLE BRICK DUST- UP 1		
Island - CABINETS		CAMBRIDGE MAPLE BRICK DUST- UP 1		
Servery - CABINETS		CAMBRIDGE MAPLE BRICK DUST- UP 1		
Kitchen - HANDLES/KNOBS		H800BC		
Kitchen - COUNTERTOP		CALCATTIA PIAZO QUARTZ- UP 4		
Island - COUNTERTOP		CALCATTIA PIAZO QUARTZ- UP 4		
Kitchen - BACKSPLASH		BRIGHT BISCUIT 4 X 16- UP 2- STACKED		
Kitchen - SINK		STD		
Kitchen - FAUCET		STD		
GREAT ROOM / DINING / LIVING / DEN / OFFICE / BASEMENT				
Dining Room - FLOORING		NA		
Living Room - FLOORING		NA		
Great Room - FLOORING		NORTHERN SOLID SAWN COLLECTION PEARL WHITE OAK - BAROQUE- UP 1		
Library / Den - FLOORING		NA		
Basement Rec Room - FLOORING		NORTHERN SOLID SAWN COLLECTION PEARL WHITE OAK - BAROQUE- UP 1		
STAIRS				
Railing Details - PICKETS		1- 3/4" TURNED OAK		
Railing Details - POSTS		2- 3/4" TURNED OAK POST		
Railing Details - HANDRAIL		2- 1/2" OVAL OAK HANDRAIL		
Stair Stain - MAIN STAIRS		STAIN TO MATCH HARDWOOD AS CLOSE AS POSSIBLE		
Stair Stain - BASEMENT STAIRS (if applicable)		NA		
Stair Stain - SERVICE STAIRS (if applicable)		NA		
POWDER ROOM				
GF- Powder Room - FLOORING		NEW BYZANTINE PENTELLIC GREY 12 X 24		
Powder Room - CABINETS		NA		
SF- Powder Room - FLOORING		NEW BYZANTINE PENTELLIC GREY 12 X 24		
Powder Room - SINK		STD		
Powder Room - FAUCET		STD		
2ND FLOOR				
Upper Hall - FLOORING		NORTHERN SOLID SAWN COLLECTION PEARL WHITE OAK - BAROQUE- UP 1		
Master Bedroom - FLOORING		REMARKABLE QUALITY- 965 GYPSY- UP 1		
Bedroom 2 - FLOORING		REMARKABLE QUALITY- 965 GYPSY- UP 1		
Bedroom 3 - FLOORING		REMARKABLE QUALITY- 965 GYPSY- UP 1		
Bedroom 4 - FLOORING		NA		
Bedroom 5 - FLOORING		NA		
Master Ensuite - FLOORING		LOFT GREY 12 X 24		
Master Ensuite - SHOWER WALL		LOFT GREY 12 X 24- VERTICLE STACKED		
Master Ensuite - SHOWER FLOOR		ONTARIO SERIES HEX TENDER GREY GLOSSY- UP 1		
Master Ensuite - SHOWER JAMB		BIANCO CARRARA		
Master Ensuite - CABINETS		SHAKER V PVC TUEXEDO- COMFORT HEIGHT		
Master Ensuite - HANDLES/KNOBS		H500C		
Master Ensuite - COUNTERTOP		WHITE CASCADE 5003- 38		
Master Ensuite - SINK(s)	STD	Master Ensuite - FAUCET(s)		STD
FOR TRADE USE				
Any upgrades in the colour chart must be accompanied with a PES. It is the responsibility of all Trades to inform the builder of any discrepancies on sketches, PES and/or colour charts PRIOR to installation.		BROOKLIN 8-46	L.V	
PAGE 1 OF 2		PURCHASER INITIALS	VENDOR APPROVAL	

ZANCOR HOMES COLOUR CHART

PRINTED 2021-05-20, 4:01 PM

2ND FLOOR CONTINUED...

Main Bath - FLOORING	LOFT GREY 12 X 24	
Main Bath - TUB / SHOWER WALL	LOFT GREY 12 X 24- VERTICLE STACKED	
Main Bath - SHOWER FLOOR	NA	
Main Bath - SHOWER JAMB	NA	
Main Bath - CABINETS	MOSAIK OAK TIMBER GREY- COMFORT HEIGHT	
Main Bath - HANDLES/KNOBS	H500C	
Main Bath - COUNTERTOP	8830-58 ELEMENTAL CONCRETE	
Main Bath - SINK(s)	STD	Main Bath - FAUCET(s) STD
Shared Bath- FLOORING	NA	
Shared Bath- TUB / SHOWER WALL	NA	
Shared Bath- SHOWER FLOOR	NA	
Shared Bath- SHOWER JAMB	NA	
Shared Bath- CABINETS	NA	
Shared Bath- HANDLES/KNOBS	NA	
Shared Bath- COUNTERTOP	NA	
Shared Bath- SINK(s)	NA	Shared Bath - FAUCET(s) NA
Ensuite Bath - FLOORING	NA	
Ensuite Bath - TUB / SHOWER WALL	NA	
Ensuite Bath - SHOWER FLOOR	NA	
Ensuite Bath - SHOWER JAMB	NA	
Ensuite Bath - CABINETS	NA	
Ensuite Bath - HANDLES/KNOBS	NA	
Ensuite Bath - COUNTERTOP	NA	
Ensuite Bath - SINK(s)	NA	Ensuite Bath - FAUCET(s) NA
LAUNDRY		
Laundry - FLOORING	NEW BYZANTINE PENTELLIC GRY 12X24	Laundry - HANDLES/KNOBS NA
Laundry - CABINETS	NA	Laundry - SINK STD
Laundry - COUNTERTOP	NA	Laundry - FAUCET STD
Laundry - BACKSPLASH	NA	
TRIM / PAINT		
Casing/Baseboards	STD	
Interior Doors	STD	
Interior Door Hardware	STD	
PAINT - Throughout	BIRCH WHITE	
FIREPLACE		
Location / Insert / Mantle	BLF5051, 50" ELECTRIC	
ACCESSORIES		
Mirrors	YES	BATH ACCESSORIES
APPLIANCE REQUIREMENTS		
GAS LINE TO BBQ	STD	ELECTRICAL for Built-in Oven DECLINED
GAS LINE & ELECTRICAL TO STOVE	DECLINED	ELECTRICAL for Built-in Micro DECLINED
GAS LINE & ELECTRICAL TO DRYER	DECLINED	ELECTRICAL for Cooktop DECLINED
HOOD FAN VENT SIZE	6" STD	ELECTRICAL for Bar Fridge DECLINED
WATERLINE to Fridge	DECLINED	
DISCLAIMER		
Any changes to the colour chart after signing are subject to a \$5000 administration fee plus costs		
Purchaser has checked and acknowledged accuracy of colour and selections before signing.		
Colours of all materials are as close as possible to Builders selection but not necessarily identical due to dye lot variances in manufacturing/manufacturers. Due to construction progress some items may have been pre-selected or installed. In this event the Vendor's selection must be accepted by the purchaser		
SITE / LOT:	BROOKLIN LOT 8-46	INITIALS
PURCHASER(S):	VINOTHAN KUMARAVEL	
PURCHASER(S):	0	
CONTACT:	647.991.8376	VINOTHAN68@GMAIL.COM
FOR TRADE USE		
Any upgrades in the colour chart must be accompanied with a PES. It is the responsibility of all Trades to inform the builder of any discrepancies on sketches, PES and/or colour charts PRIOR to Installation.		
ZANCOR HOMES	PURCHASER SIGNATURE	
	PURCHASER SIGNATURE	
	DÉCOR CONSULTANT	0
PAGE 2 OF 2	Vendor APPROVAL	0
SIGNATURES / DATE		

BROOKLIN NOW TOWNS

Imagine TH-1

Lot 8-46

may 2012

Servery +
Kitchen flooring to be
tile, Breakfast to
Remain hardwood

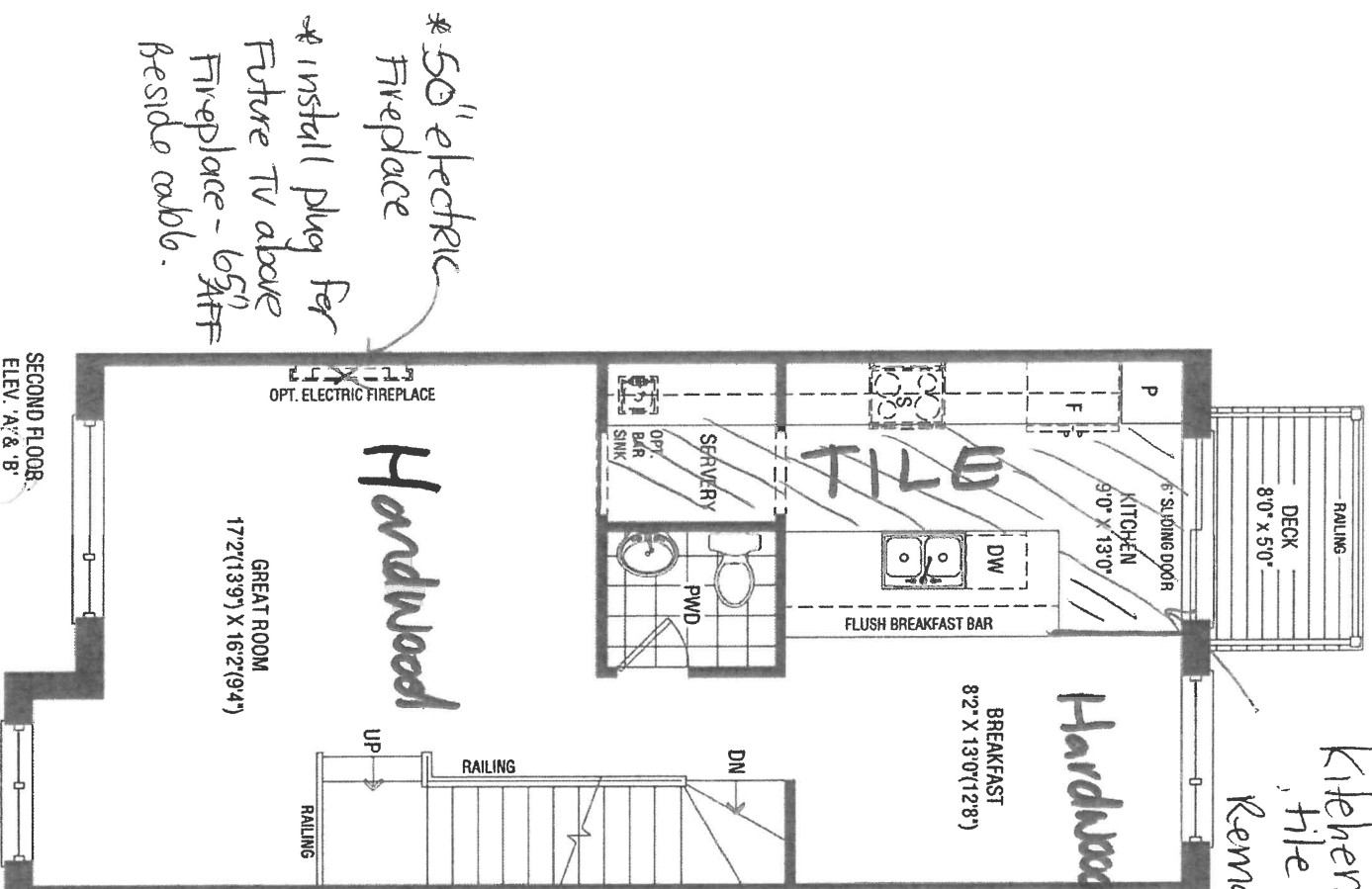

14.7

BROOKLIN NOW TOWNS Imagine TH-1

Lo 18-46
MAY 20/21

* Laundry
Relocated,
to basement,
plumbing
Rough in
GF laundry
to remain
if possible

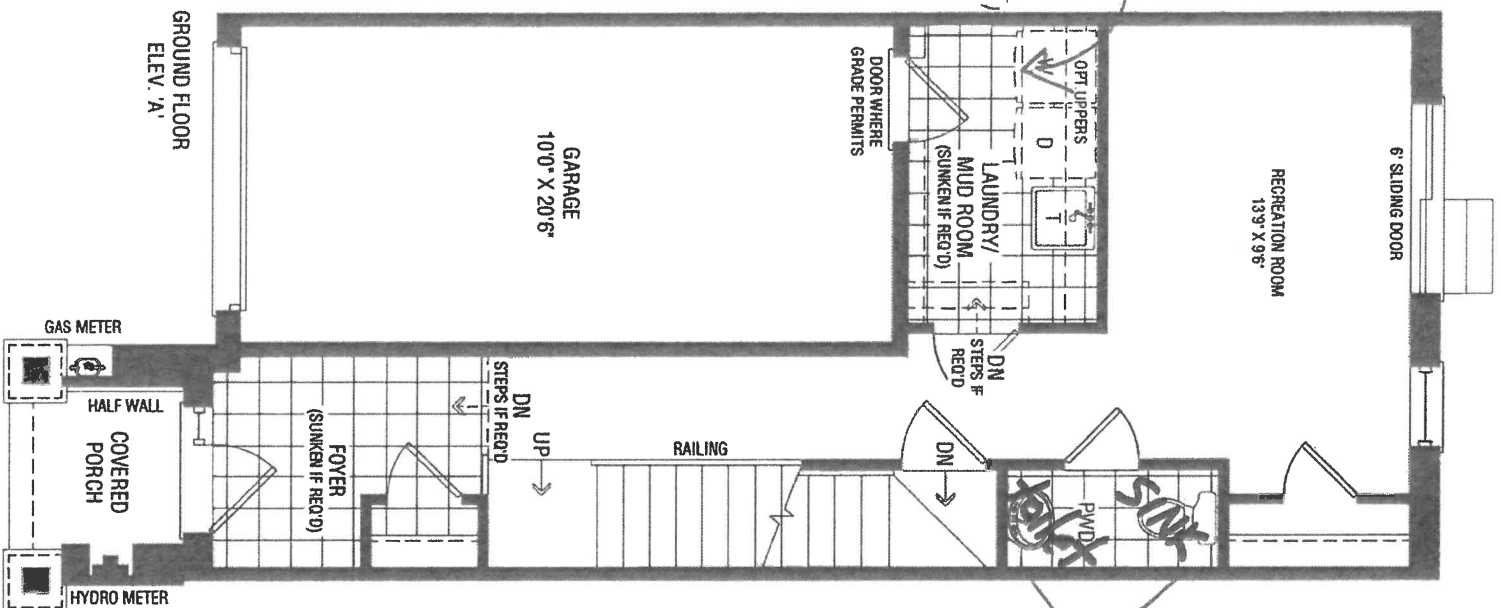

Relocate position of
Sink + toilet
as Marked.
if possible

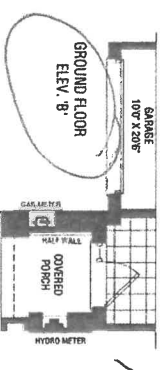

K.V.

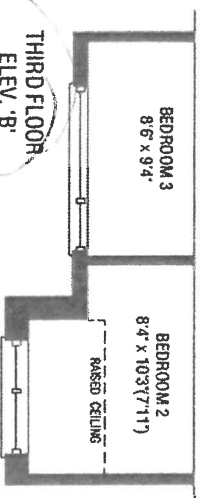
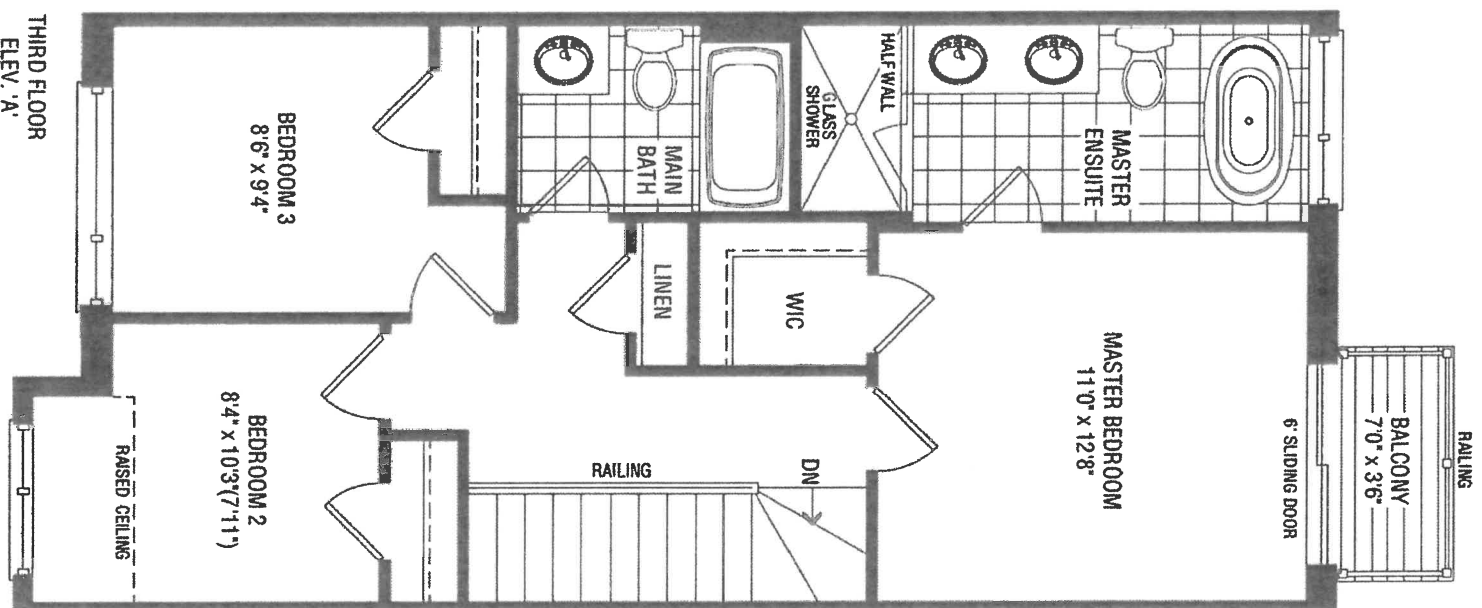

2018-46
 M920/21

IMAGINE

BROOKLIN NOW TOWNS

Imagine TH-1

Lo 68-46.

Lo 6

m8/20/22

Laundry location,
Basement to remain
unfinished.
if possible

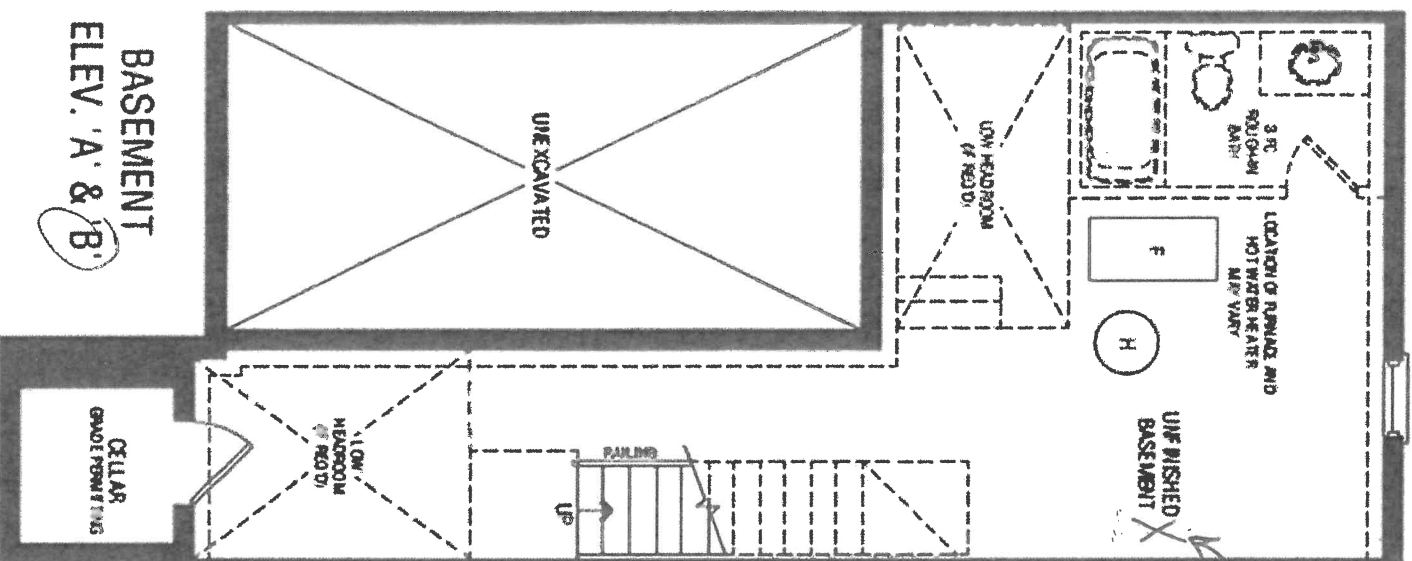

BASEMENT
ELEV. 'A' & 'B'

1-2



DATE SUBMITTED
30 Mar 2021

CLIENT NAME: ZANCOR HOMES
SHIP TO : BROOKVALEY TOWNS

PH:
CELL:

DRAFTED BY: FERNANDA
COMMENT

JOB NUMBER
INSTALL DATE:

PAGE
3 of 19

TH-01
STANDARD VANITIES ELEV A & B

MAIN

760

Comfort Height

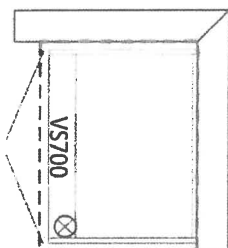

*1st 8-46
May 20/21*

MASTER ENSUITE
1660

Comfort Height

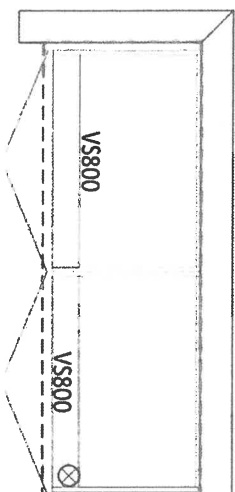

OPT. LAUNDRY UPPERS

2800

900-760

930-760

900-760

OPT. BASEMENT BATH

960

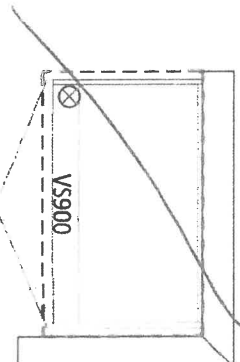

Y-V



New Image Kitchens Inc.

CLIENT NAME: ZANCOR HOMES
SHIP TO: BROOKVALLEY TOWNS

PH:
CELL:

DATE SUBMITTED
30 Mar 2021

DRAFTED BY: FERNANDA
COMMENT

P/O #

JOB NUMBER
INSTALL DATE
PAGE
1 of 19

TH-01
KITCHEN ELEV. A & B

lot 8-46
May 20/21

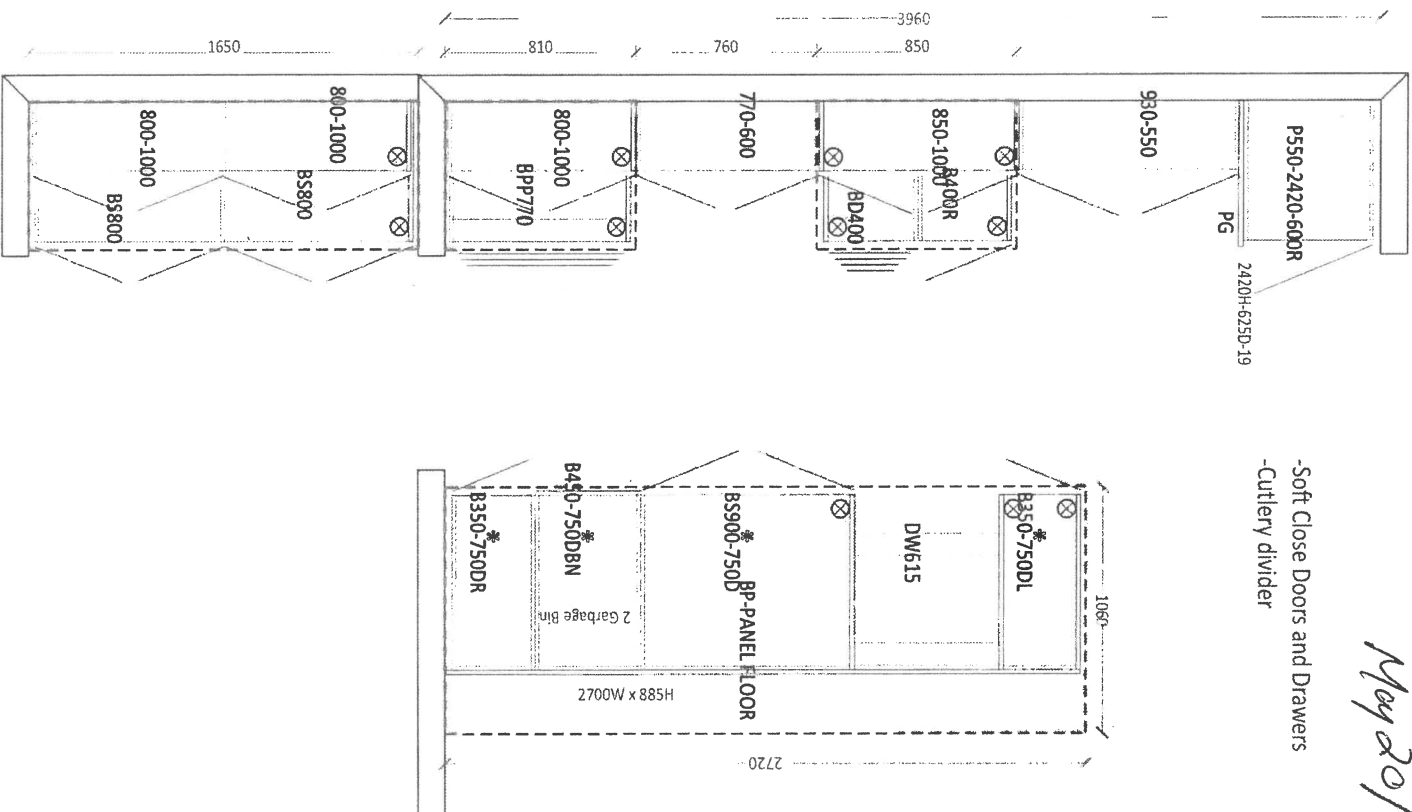

-Soft Close Doors and Drawers
-Cutlery divider

✓



new image kitchens inc.

DATE SUBMITTED
30 Mar 2021

CLIENT NAME: ZANCOR HOMES
SHIP TO: BROOKVALEY TOWNS

PH:
CELL:

DRAFTED BY: FERNANDA
COMMENT

PG #

JOB NUMBER

INSTALL DATE:

PAGE

2 of 19

TH-01
KITCHEN 3D DRAWING

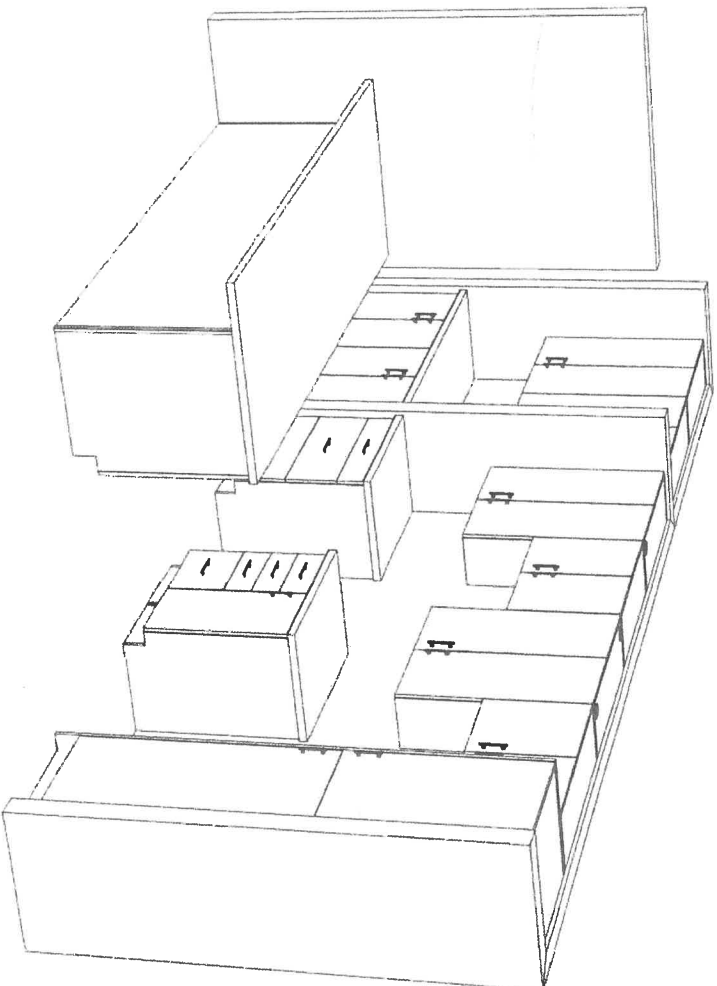

*Standard
Kitchen*

*1 of 8-46
May 20/21*

K.V.

THE
GALLERY
BY ZANCOR

ZANCOR

now
TOWNS IN BROOKLIN

APPLIANCE ACKNOWLEDGEMENT

CONTACT: Steve Miller @ Appliance Canada (905) 660-2424 / 8701 Jane Street, Vaughan

▶ Appliance Specs are DUE 2 WEEKS FROM SIGNED DATE OF COLOUR CHART (if not received during appointment)

*****Specs that require changes/modifications after this date will not be accepted*****

▶ NOTE: Any upgraded appliances are to be paid by the Purchaser, directly to the appliances company.

▶ Additional charges to the Purchaser may apply for cabinetry, electrical and plumbing in order to accommodate the specs given by the homeowner.

▶ It is the Purchaser's responsibility to coordinate delivery, installation and hook up of appliances and to ensure they are installed as per Manufacturers specifications after closing.

▶ Standard appliance openings are approximate and the minimum required. Sizes may vary due to onsite condition and/or when modifications have been made to the cabinetry.

STANDARD OPENINGS ACKNOWLEDGED BY PURCHASER:

Y.V.

INITIAL

- Fridge Opening ▶ 36" x 74" **Size is (+/-) & space above the fridge is required due to proper air flow
- Stove Opening ▶ 30"
- Hood Fan Opening ▶ 30"
- Hood Fan Vent ▶ 6"
- Dishwasher Opening ▶ 24"

UPGRADED APPLIANCES BELOW (Check applicable)

It is the Purchaser's responsibility to provide Zancor Homes with the correct specification for each appliance that has been upgraded. Zancor Homes will not be responsible for appliance requirements based on upgrades if specs have not been provided to the builder.

Y.V.

INITIAL

FRIDGE

- ☐ Built-In ☐ Flush Inset
- (Spec's Required) ☒ Paneled / Integrated ☐ Water Line

RANGE

- ☐ 36" ☐ 48" *hood fan opening to be the same as the stove
- (Spec's Required) ☐ Gas ☐ Cooktop (Apron front)

Larger CFM may be required with these appliances

**Countertop Cut-out charge required for cooktop

☐ Induction

HOOD FAN &

- ☐ Under Cabinet (Standard) ☒ 6 Inch (Standard)

VENT

- ☐ Chimney (centre vent) ☐ 8 Inch
- (Spec's Required) ☐ Insert / Liner ☐ 10 Inch

WALL OVEN &

- ☐ Single Oven ☐ Warming Drawer

MICRO

- ☐ Double Oven ☐ Over the Range Microwave
- (Spec's Required) ☐ Steam Oven ☐ Built-in Microwave (*trim kit required)

DATE

SITE

LOT

BROOKLIN TOWNS

** Any upgrades checked in this appliance form must be accompanied with specs provided by the Purchaser.

**It is the responsibility of the trade to inform the Builder of any discrepancies with specs, sketches, extras and/or colour chart PRIOR to production/installation.

221 North Rivermede Road, Concord, Ontario L4K 3N7 * T: (905) 738.7010 F: (905) 738.5948

Stone Countertop Edge Profiles

Where applicable as per site specifications

LOT / SITE:

BROOKLIN TOWNS -

8-46.

DATE:

May 26/21

STANDARD EDGE FOR KITCHEN & VANITIES

Standard Countertop Edge
in Kitchen



Standard Countertop Edge
in Vanity



Homeowner(s) Initial *LV*

OPTION (1) EDGE FOR KITCHEN & VANITIES \$250

Optional Edge in Kitchen

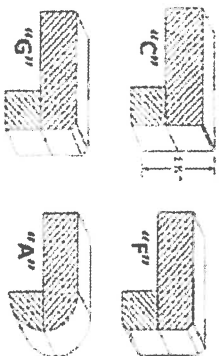

Optional Edge in Bathroom

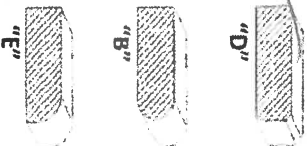

Homeowner(s) Initial

OPTION (2) EDGE FOR KITCHEN & VANITIES CUSTOM PRICING

Optional Edge for Kitchen

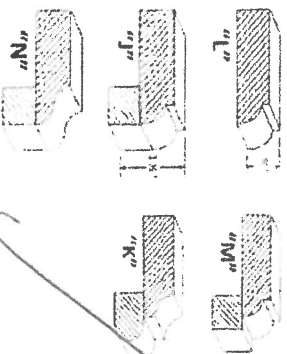

Optional Edge in Vanity

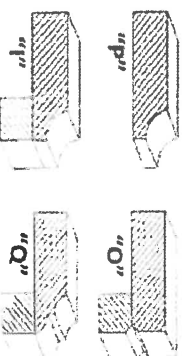

Homeowner(s) Initial

GALLERY
BY ZANCOR

ZANCOR

now
TOWNS IN BROOKLIN

HOME AUTOMATION
(Cable, CAT5, Telephone)

LOT / SITE: BROOKLIN TOWNS -

DATE: May 20/21

STANDARD ITEMS AS PER SCHEDULE A:

STANDARD CABLE ROUGHIN in (1) Master Bedroom, (1) Family / Great Room
STANDARD TELEPHONE ROUGHIN in (1) Master Bedroom, (1) Family / Great Room
STANDARD CAT5 ROUGHIN - (3) In location of Purchasers choice.

OPTION 1:

I/we the Homeowner(s) have chosen to contact the Home Automation Company to select the locations of the rough-ins for Cable, CAT5, Telephone as included in our Agreement of Purchase Sale.

I/we the Homeowner(s) will contact the trade within 4 weeks of the date of this release to select locations of the standard rough-ins review other optional products for purchase.

Trade: Artistic Smart Homes
Phone: (905) 850-9386
Rep: Jessica
Location: 8601 Jane Street Unit #8 Vaughan ON L4K 5N9

Should the homeowner not make these selections within the sufficient time provided, the rough-ins as mentioned above will be installed in locations as indicated above.

J K-V

Homeowner(s) Initial

OPTION 2:

I/we the Homeowner(s) have chosen to not contact the home automation company. I/we the Homeowner(s) have selected the locations for the standard rough-ins for Cable, CAT5, Telephone that are included in the Agreement of Purchase and Sale directly with a décor rep .

Homeowner(s) Initial

GALLERY
BY ZANCOR

ZANCOR

now
TRADING IN BARRINGTON

INTERIOR FINISHES ACKNOWLEDGEMENT / WAIVER

Purchaser accepts and acknowledges that the Builder reserves the right to substitute materials with those of equal or better quality where the manufacture, scheduling or delivery of materials may directly impact the Builder's ability to meet its' contractual obligations under the Agreement of Purchase and Sale.

K.V

UPGRADES/EXTRAS: All upgrades and additional selections indicated on the colour chart must be accompanied by an upgrades/extras sheet (PES) and full payment otherwise the selection will be invalid. All colour charts and upgrades/extras will not proceed until verified and signed by an authorized signing officer at the Vendor's head office. **CHANGES WILL NOT BE PERMITTED UPON COMPLETION AND SUBMISSION OF THE COLOUR CHART.**

K.V

PORCELAIN & NATURAL STONES: Due to the properties of natural stones including but not limited to marble, granite, quartz, no two pieces are exactly the same. Variations in colour, tone, granularity (pitting, fissures) and pattern are to be expected, including various lighting may affect the overall finished look. Stone tops are sealed at time of installation and should never be cleaned with lemon oil or vinegar. Stones are porous materials, therefore any spilled substance require immediate attention. Stone countertops require regular seal re-application as part of home maintenance. Purchaser acknowledges colour and product variations as well as natural imperfections may exist with the selection of natural stone materials and shall not hold the Vendor liable for provision of same.

K.V

STONE COUNTERTOP JOINTS: Purchaser is aware that one joint will be at each corner and on either side of slide-in-range (if applicable). It will also be where the length of the counter top exceeds the length of a stone slab. Slabs are usually approximately 5'x 8'.

K.V

CERAMIC TILES: Due to manufacturing, shade (dye lots), product variations may exist that can affect the overall look of the finished product. Although every effort will be made to ensure the colours and materials selected are as close as possible to the samples, the purchaser acknowledges that the sample tiles supplied in the Design Centre may not be identical to the materials installed in the home.

K.V

STAIR STAINS: Due to the natural properties of wood, many variables can affect the overall look of the finished product. Factors including but not limited to wood type, knotting, graining, density, age, humidity, and air temperature can result in substantial variations in stain intensity. The purchaser accepts that although the Vendor will do their best to match stain the unfinished stairs as close as possible to the pre-finished floors, it is not possible to have an identical match and that there MAY be shade differences between the two products.

K.V

CABINETRY: Due to the natural properties of wood, slight variations apparent with cabinetry are to be expected. This includes but not limited to wood species, wood grain, colour, finish, product variations, and natural imperfections are all factors that may affect the overall look of the finished product. Such factors make exact colour matching impossible. The type and intensity of lighting in the areas of designated cabinetry placement may also highlight characteristics of cabinetry finish. All cabinets shall be finished with a white melamine interior box unless a finished interior is upgraded. Due to building specifications and/or on-site conditions, certain cabinetry upgrades may not be possible. The purchaser acknowledges that the Builder cannot guarantee the cabinetry finish or provision of certain upgrades and shall not hold the Builder liable for provision of same.

K.V

UPGRADES/EXTRAS: All upgrades and additional selections indicated on the colour chart must be accompanied by an upgrades/extras sheet (PES) and full payment otherwise the selection will be invalid. All colour charts and upgrades/extras will not proceed until verified and signed by an authorized signing officer at the Vendor's head office. **CHANGES WILL NOT BE PERMITTED UPON COMPLETION AND SUBMISSION OF THE COLOUR CHART.**

K.V

HARDWOOD / LAMINATE FLOORING: Due to the properties of wood and laminate, many variables can affect the overall look of the finished product. Variations include but not limited to wood type or laminate finish, colour/stain and wood grain are significant factors that make exact colour matching impossible. The purchaser acknowledges that the hardwood flooring is a pre-finished product in a controlled environment. Expansion, compression and cupping are characteristics of hardwood flooring once installed in the home. The purchaser acknowledges these may become apparent over time and despite the Builders' efforts to install the hardwood flooring materials in keeping with good workmanship, the Builder shall not be responsible nor held liable for minor variances of fluctuation in hardwood flooring materials.

K.V

HARDWOOD / LAMINATE WAIVER:

I/We understand hardwood flooring is classified as a porous material and as such not recommended by the Builder in certain areas. I/We understand there is a concern due to possible water and other substances being frequently splashed or spilled onto the floor and in contravention of Ontario Building Code Section 9.30.1.2(1).

"Finished flooring bathrooms, kitchens, public entrance halls, laundry & general storage areas shall consist of resilient flooring, felted-synthetic-fibre floor coverings, concrete, terrazzo, ceramic tile, mastic or other types of flooring providing similar degrees of water resistance.

I/We are prepared to assume full responsibility for any damage caused to the hardwood floor or subfloor due to moisture absorbency in the mentioned areas, and agree to waive any claims against the Township of residence, TARIION and/or the Builder in relation to the matter. ****SEE COLOUR CHART FOR LOCATIONS****

K.V

BROOKLIN TOWNS

DATE

SITE

LOT

