

CONSTRUCTION SUMMARY OF EXTRAS

Printed 2021-05-28 / 3:57 PM / Page 1 of 1

Site:
Lot:
Model:
Purchaser:
Purchaser:
Phone:
Email:

BROOKLIN NOW TOWNS
2-9
RLT-03
UDAY VEER SINGH PATIAL
JESSICA ARUL
647.473.9324
JESSICARUL06@GMAIL.COM



DESCRIPTION		DATE SELECTED
	BONUS PACKAGE: 3 PIECE STAINLESS STEEL APPLANCES WITH WHITE LOAD WASHER & DRYER	INCLUDED IN APS
	BONUS PACKAGE: STAINLESS STEEL HOOD FAN	INCLUDED IN APS
	BONUS PACKAGE: AIR CONDITIONING UNIT	INCLUDED IN APS
#1	COMFORT HEIGHT CABINET INCREASE TO 36" - MASTER ENSUITE AND MAIN BATH	28-Apr-21
#2	N/A	28-Apr-21
#3	CLEAR PLAIN GLASS DOOR FOR KITCHEN CABINET (SEE SKETCH) QTY 2	28-Apr-21
#4	CABINET- KITCHEN UPPER- VANILLA MILKSHAKE-- UP 1 / BASE CABINETS + ISLAND CABINETS- STONE GREY - UP 1	28-Apr-21
#5	KITCHEN ISLAND 2 TONE- ISLAND CABINET: TO BE STONE GREY- UP 1	28-Apr-21
#6	COUNTERTOP- KITCHEN QUARTZ - UP 1	28-Apr-21
#7	TILE- KITCHEN BACKSPLASH- UP 3- INSTALL STACKED	28-Apr-21
#8	COUNTER TOP- MASTER ENSUITE- QUARTZ - UP 2 (COMES WITH QTY 2 OVAL SINK QTY 4220CFY)	28-Apr-21
#9	CABINET- MASTER ENSUITE UP 1	28-Apr-21
#10	TILE-MASTER ENSUITE SHOWER FLOOR- UP 1	28-Apr-21
#11	N/A	28-Apr-21
#12	HARDWARE- KITCHEN CABINETS- BERENSON- HALIBURTON- MATTE BLACK- 96MM- QTY 30	28-Apr-21
#13	HARDWARE- MASTER ENSUITE CABINETS- BERENSON- HALIBURTON MATTE BLACK- 96 MM QTY 4	28-Apr-21
#14	HARDWARE- MAIN BATH CABINETS- BERENSON- HALIBURTON MATTE BLACK-96MM QTY 2	28-Apr-21
#15	N/A	28-Apr-21
#16	KITCHEN SINK- BLANCO PRECIS 401705- COLOUR- ANTHRACITE- 409590	28-Apr-21
#17	SOAP DISPENSER- TRANSITIONAL SOAP- MODEL-3942 IN MATTE BLACK- QTY 2- INSTALL (1) LEFT OF SINK FAUCET, AND INSTALL (1) TO RIGHT OF SINK FAUCT)- INSTALL 10" FRON SINK FAUCET ON BOTH SIDES (IF POSSIBLE)	28-Apr-21
#18	KITCHEN SINK FAUCET- SINGLE PULLDOWN KITCHEN FAUCET- ALIGN- MODEL 7565 IN MATTE BLACK	28-Apr-21
#19	N/A	28-Apr-21
#20	N/A	28-Apr-21
#21	N/A	28-Apr-21
#22	N/A	28-Apr-21
#23	N/A	28-Apr-21
#24	CAPPED INTERIOR LIGHT ROUGH IN ON SEPERATE SWITCH- TO BE CENTERD IN THE KITCHEN ISLAND. STANDARD LIGHT TO REMAIN	28-Apr-21
#25	QTY 4 INTERIOR POT LIGHTS IN GREAT ROOM (SEE SKETCH) ON SEPERATE SWITCH, STD LIGHT TO REMAIN	28-Apr-21
#26	N/A	28-Apr-21
#27	QTY 4 INTERIOR POT LIGHTS IN LIVING ROOM (SEE SKETCH), ON SEPERATE SWITCH, EXISTING LIGHT TO REMAIN	
#28	PLUG FOR FUTURE TV ABOVE FIREPLACE BESIDE CABLE- INSTALL 65 AFF	
#29	ELECTRIC FIREPLACE - DIMPLEX PRISM BLF5051 50" LINEAR- WALL TO BE 72" WIDE FINISHED	

ZANCOR HOMES COLOUR CHART

ENTRANCES				
Main Foyer - FLOORING		LOFT ANTHRACITE 12 X 24	✓	
Mudroom - FLOORING		LOFT ANTHRACITE 12 X 24	✓	
Side Hall - FLOORING		NA		
Basement Foyer - FLOORING		NA		
KITCHEN				
Kitchen - FLOORING		NORTHERN SOLID SAWN COLLECTION RED OAK 3 1/4" NATURAL	✓	
Breakfast - FLOORING		NORTHERN SOLID SAWN COLLECTION RED OAK 3 1/4" NATURAL	✓	
Kitchen - CABINETS		UPPER CABINETS- SIERRA MDF VANILLA MILKSHAKE- BASE CABINET- SIERRA MDF STONE GREY- UP 1	✓	
Island - CABINETS <i>And Pantry</i>		SIERRA MDF STONE GREY- UP 1	✓	
Servery - CABINETS		UPPER: SIERRA MDF VANILLA MILKSHAKE- UP 1- BASE CABINET- SIERRA MDF STONE GREY- UP 1	✓	
Kitchen - HANDLES/KNOBS		BERENSON HALBURTON- MATTE BLACK- QTY 96MM	✓	
Kitchen - COUNTERTOP		WHITE GALAXY QUARTZ- UP 1	✓	
Island - COUNTERTOP		WHITE GALAXY QUARTZ- UP 1	✓	
Kitchen - BACKSPLASH		TRAVELLA SATIN GRAFITE 3 X 6- UP 3 STACKED	✓	
Kitchen - SINK		UPGRADE - BLANCO PRECIS (401705)IN ANTHRACITE- 409590	✓	
Kitchen - FAUCET		ALIGN 7565- MATTE BLACK	✓	
GREAT ROOM / DINING / LIVING / DEN / OFFICE / BASEMENT				
Dining Room - FLOORING		NORTHERN SOLID SAWN COLLECTION RED OAK 3 1/4" NATURAL	✓	
Living Room - FLOORING		NORTHERN SOLID SAWN COLLECTION RED OAK 3 1/4" NATURAL	✓	
Great Room - FLOORING		NORTHERN SOLID SAWN COLLECTION RED OAK 3 1/4" NATURAL	✓	
Library / Den - FLOORING		NA		
Basement Rec Room - FLOORING		NORTHERN SOLID SAWN COLLECTION RED OAK 3 1/4" NATURAL	✓	
STAIRS				
Railing Details - PICKETS		METAL BLACK SINGLE COLLAR W/ALT PLAIN	✓	
Railing Details - POSTS		2 3/4" TURNED OAK POST	✓	
Railing Details - HANDRAIL		2 1/2" OVAL OAK HANDRAIL	✓	
Stair Stain - MAIN STAIRS		STANDARD NATURAL FINISH	✓	
Stair Stain - BASEMENT STAIRS (if applicable)		NA		
Stair Stain - SERVICE STAIRS (if applicable)		NA		
POWDER ROOM				
GF- Powder Room - FLOORING		LOFT ANTHRACITE 12 X 24	✓	
Powder Room - CABINETS		NA		
SF-Powder Room - FLOORING		LOFT ANTHRACITE 12 X 24	✓	
Powder Room - SINK		STD		
Powder Room - FAUCET		STD		
2ND FLOOR				
Upper Hall - FLOORING		NORTHERN SOLID SAWN COLLECTION RED OAK 3 1/4" NATURAL	✓	
Master Bedroom - FLOORING		T17 OPENING NIGHT	✓	
Bedroom 2 - FLOORING		T17 OPENING NIGHT	✓	
Bedroom 3 - FLOORING		T17 OPENING NIGHT	✓	
Bedroom 4 - FLOORING		NA		
Bedroom 5 - FLOORING		NA		
Master Ensuite - FLOORING		LOFT ANTHRACITE 12 X 24	✓	
Master Ensuite - SHOWER WALL		LOFT ANTHRACITE 12 X 24	✓	
Master Ensuite - SHOWER FLOOR		ONTARIO SERIES HEX BLACK GLOSSY- UP 1	✓	
Master Ensuite - SHOWER JAMB		BIANCO CARRARA	✓	
Master Ensuite - CABINETS		EURO NIKI 1 ANTHRACITE - UP 1	✓	
Master Ensuite - HANDLES/KNOBS		BERENSON HALBURTON- MATTE BLACK- QTY 4- 96MM	✓	
Master Ensuite - COUNTERTOP		EMERALD STONE BLACK - 3100 JET BLACK QUARTZ- UP 2	✓	
Master Ensuite - SINK(s)		4220CFY / Master Ensuite - FAUCET(s)	STD	
FOR TRADE USE				
Any upgrades in the colour chart must be accompanied with a PES. It is the responsibility of all Trades to inform the builder of any discrepancies on sketches, PES and/or colour charts PRIOR to installation.		BROOKLIN 2-9	U.P. 5A	Vendor Approval
PAGE 1 OF 2			PURCHASER INITIALS	VENDOR APPROVAL

ZANCOR HOMES COLOUR CHART

PRINTED 2021-05-05, 2:20 PM

2ND FLOOR CONTINUED...

Main Bath - FLOORING	LOFT ANTHRACITE 12 X 24		
Main Bath - TUB / SHOWER WALL	LOFT ANTHRACITE 12 X 24		
Main Bath - SHOWER FLOOR	NA		
Main Bath - SHOWER JAMB	NA		
Main Bath - CABINETS	EURO STORM		
Main Bath - HANDLES/KNOBS	BERENSON HALIBURTON - MATTE BLACK - QTY 2 - 96MM		
Main Bath - COUNTERTOP	COTE D'AZUR NOIR 5006K-07		
Main Bath - SINK(s)	STD	Main Bath - FAUCET(s)	STD
Shared Bath - FLOORING	NA		
Shared Bath- TUB / SHOWER WALL	NA		
Shared Bath- SHOWER FLOOR	NA		
Shared Bath- SHOWER JAMB	NA		
Shared Bath- CABINETS	NA		
Shared Bath- HANDLES/KNOBS	NA		
Shared Bath- COUNTERTOP	NA		
Shared Bath- SINK(s)	NA	Shared Bath - FAUCET(s)	NA
Ensuite Bath - FLOORING	NA		
Ensuite Bath - TUB / SHOWER WALL	NA		
Ensuite Bath - SHOWER FLOOR	NA		
Ensuite Bath - SHOWER JAMB	NA		
Ensuite Bath - CABINETS	NA		
Ensuite Bath - HANDLES/KNOBS	NA		
Ensuite Bath - COUNTERTOP	NA		
Ensuite Bath - SINK(s)	NA	Ensuite Bath - FAUCET(s)	NA

LAUNDRY

Laundry - FLOORING	LOFT ANTHRACITE 12 X 24	Laundry - HANDLES/KNOBS	NA
Laundry - CABINETS	NA	Laundry - SINK	STD
Laundry - COUNTERTOP	NA	Laundry - FAUCET	STD
Laundry - BACKSPLASH	NA		

TRIM / PAINT

Casing/Baseboards	STD		
Interior Doors	STD		
Interior Door Hardware	STD		
PAINT - Throughout	WARM GREY		

FIREPLACE

Location / Insert / Mantle	50" ELECTRICAL LINEAR BLT50S1 ✓		
----------------------------	---------------------------------	--	--

ACCESSORIES

Mirrors	YES	BATH ACCESSORIES	NO INSTALL
---------	-----	------------------	------------

APPLIANCE REQUIREMENTS

GAS LINE TO BBQ	STANDARD	ELECTRICAL for Built-in Oven	DECLINED
GAS LINE & ELECTRICAL TO STOVE	DECLINED	ELECTRICAL for Built-in Micro	DECLINED
GAS LINE & ELECTRICAL TO DRYER	DECLINED	ELECTRICAL for Cooktop	DECLINED
HOOD FAN VENT SIZE	STANDARD	ELECTRICAL for Bar Fridge	DECLINED
WATERLINE to Fridge	DECLINED		

DISCLAIMER

Any changes to the colour chart after signing are subject to a \$5000 administration fee plus costs	X	U.P.	X	JA
Purchaser has checked and acknowledged accuracy of colour and selections before signing.	X	U.P.	X	JA
Colours of all materials are as close as possible to Builders selection but not necessarily identical due to dye lot variances in manufacturing/manufacturers. Due to construction progress some items may have been pre-selected or installed. In this event the Vendor's selection must be accepted by the purchaser	X	U.P.	X	JA

SITE / LOT:	BROOKLIN LOT 2-9 ✓			
PURCHASER(S):	UDAY VEER SINGH PATIAL			
PURCHASER(S):	JESSICA ARUL			
CONTACT:	647.473.9324	JESSICARUL06@GMAIL.COM		

FOR TRADE USE

Any upgrades in the colour chart must be accompanied with a PES. It is the responsibility of all Trades to inform the builder of any discrepancies on sketches, PES and/or colour charts PRIOR to installation.	PURCHASER SIGNATURE	
	PURCHASER SIGNATURE	Amir Singh
	DÉCOR CONSULTANT	JILLIAN

SIGNATURES / DATE

1 of 2-9
Apr. 28/21

qty 4 pot lights
on separate switch
Standard light to
Remain

Coupled light, on
Separate switch,
Center in Island.
Standard light to
Remain.

qty 4 pot lights,
on separate switch,
Standard living
Room light to
Remain

10/10/2021

10/10/2021

plug above
Fire place
65" AFF
50"
electric
Fireplace,
wall to be
6' wide
when finished

#hook.
Tile
direct-

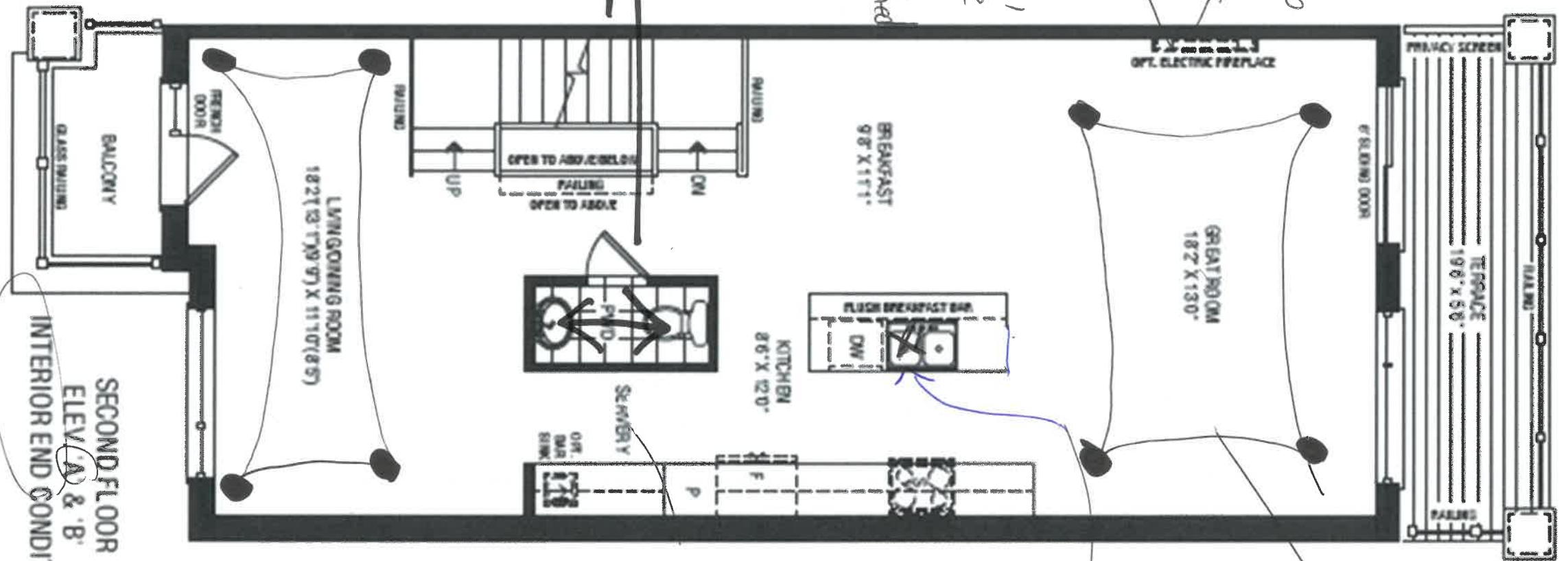

SECOND FLOOR
ELEV. A & B
INTERIOR END CONDITION

DISCOVER

10/10/2021

10/10/2021

1st 2-9
Apr. 28/21

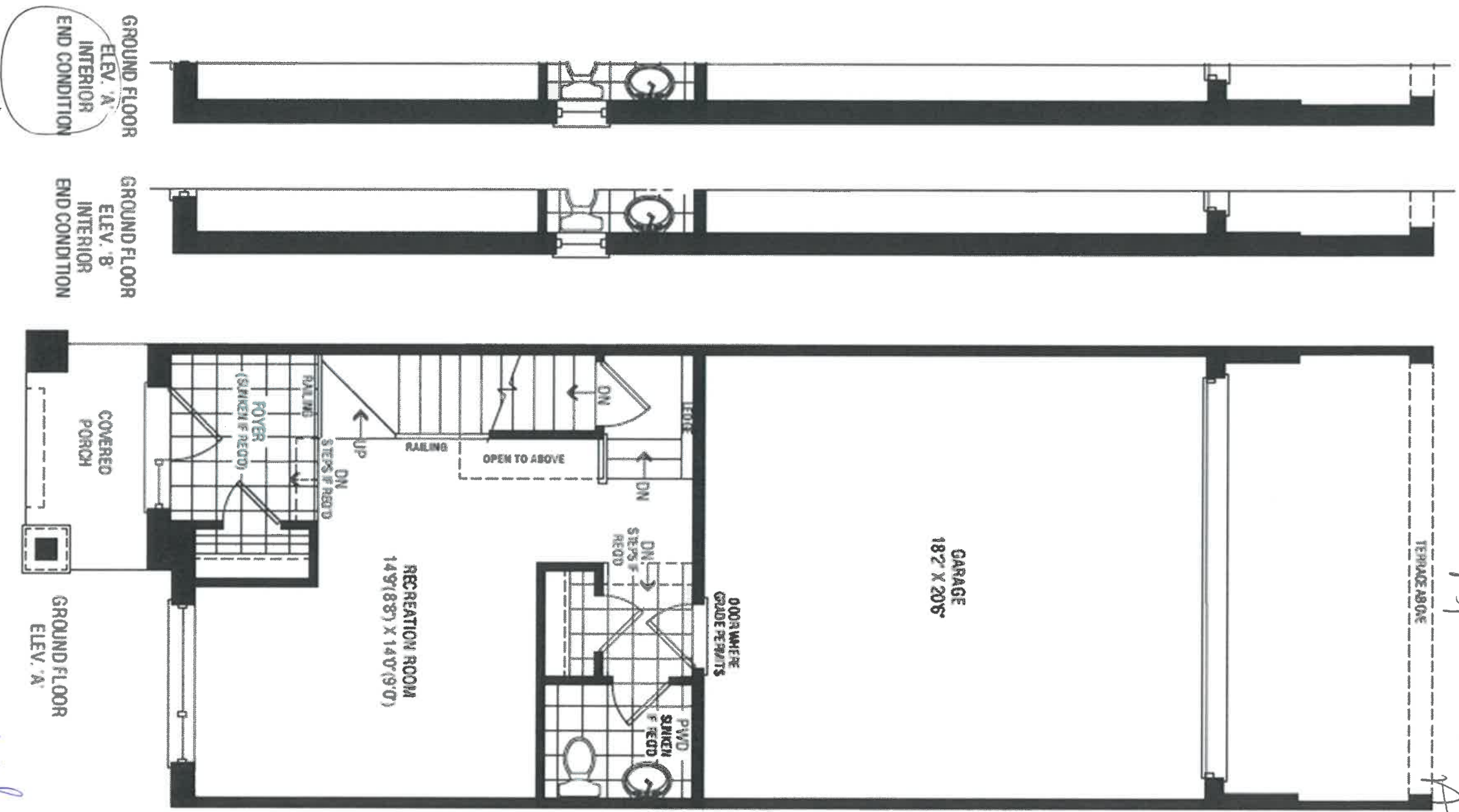

Discover

1 of 2-9
Apr. 28/21

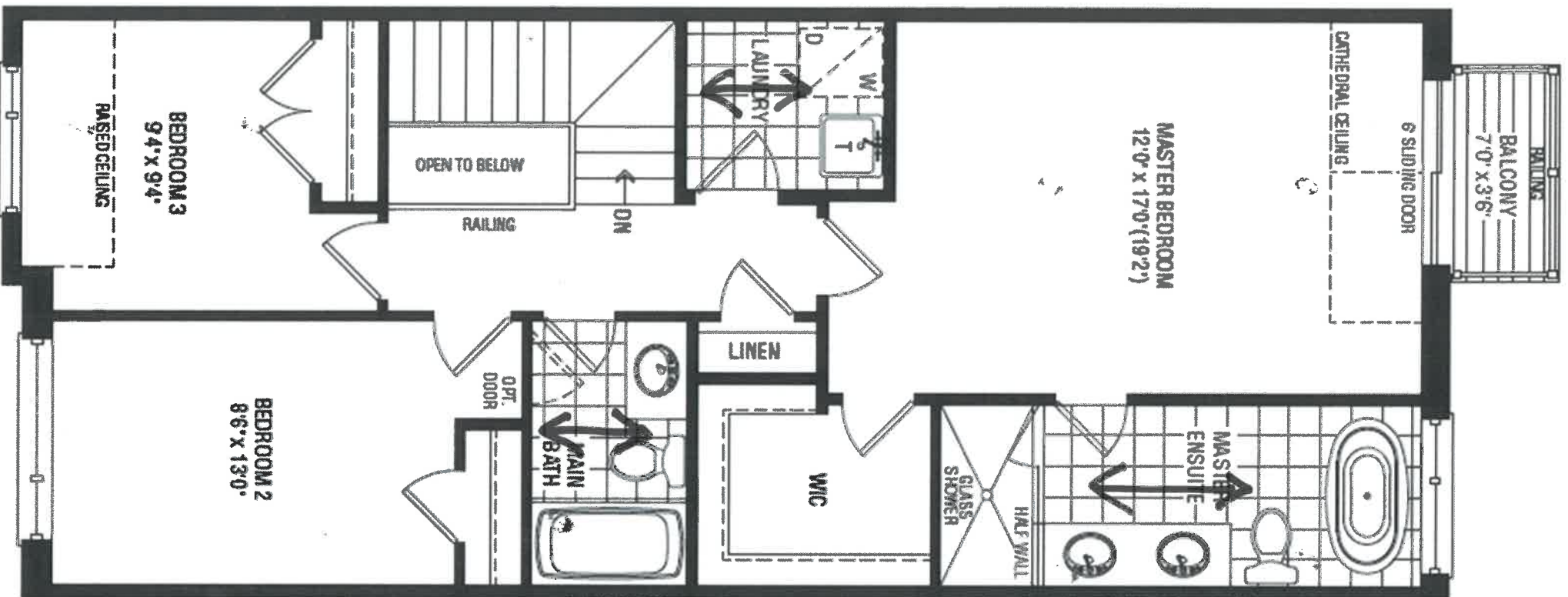

THIRD FLOOR
ELEV. 'A'

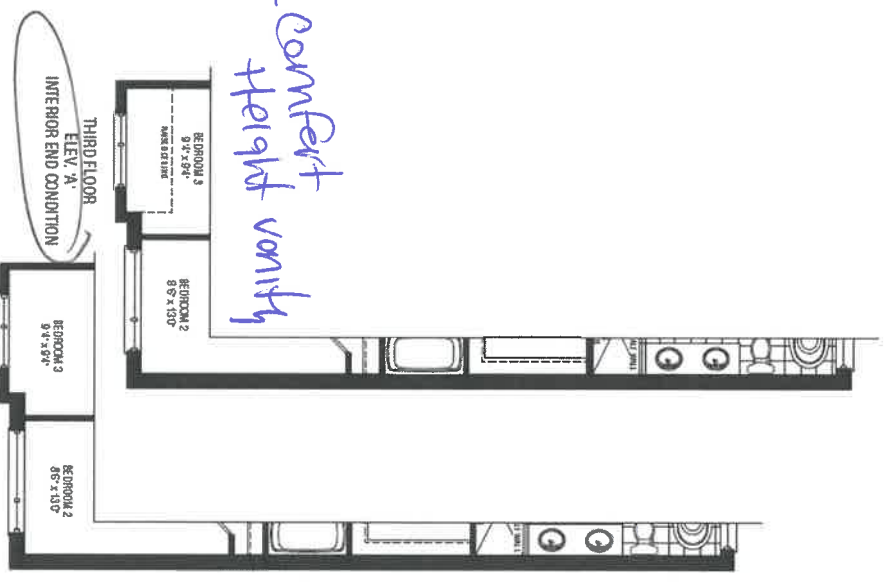

100%
Tile direct

THIRD FLOOR
ELEV. 'B'
INTERIOR END CONDITION

DISCOVER

Handwritten notes:

- Master
- comfort height vanity
- comfort height vanity

1st 2-9
Apr. 28/21

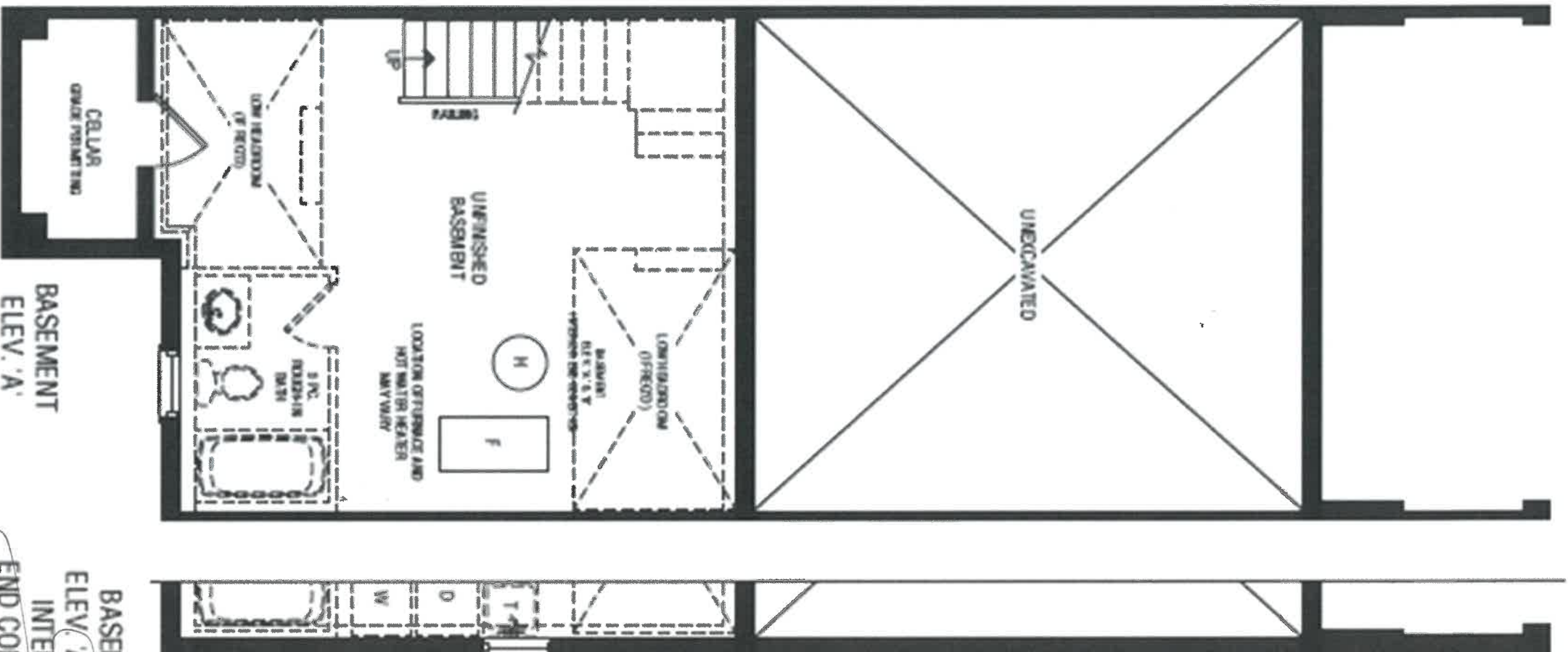

Amir

DISCOVER

Marked

CALVIN
19 1/4" OVAL UNDERMOUNT SINK

❑ 4220CFY Undermount Sink

Product Specs:

- Vitreous china
- Front overflow hole
- Template and mounting hardware supplied

Overall Dimensions (W x D x H):

(OD): 490mm(19 1/2") x 410mm(16 1/8") x 195mm(7 7/8")
(ID): 430mm(17") x 350mm(13 3/4") x 145mm(5 7/2")

Compliance Certifications:

Meets or exceeds the following:

- IAPMO cUPC
- ASME A112.19.2 / CSA B45.1-2013

Shipping:

Cube 1.53
GW 19 lbs

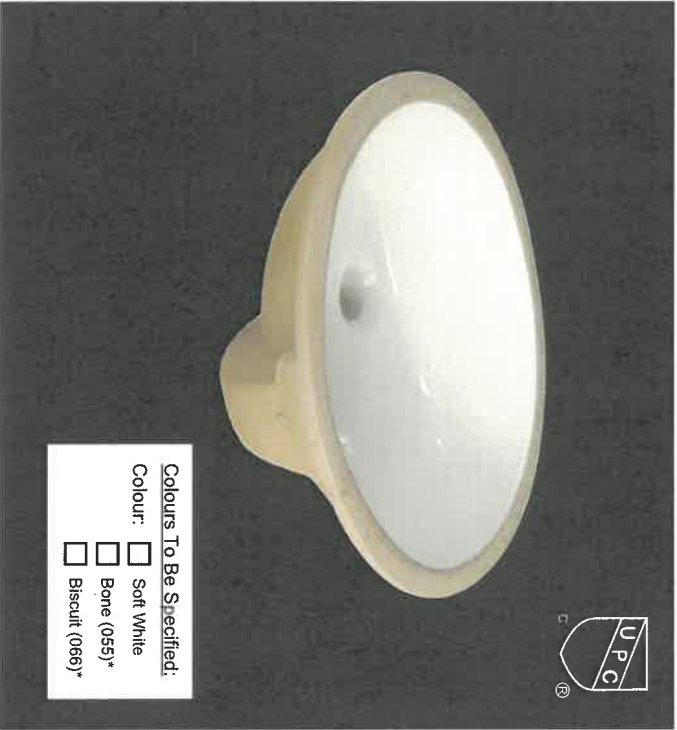

Colours To Be Specified:

Colour: ☐ Soft White
☐ Bone (055)*
☐ Biscuit (066)*

Notes:
Dimensions of fixtures are nominal and may vary within the range of tolerances established by ASME standard A112.19.2. These measurements are subject to change or cancellation. No responsibility is assumed for use of superseded or voided pages.

*Bone and Biscuit available through Direct Import (DIF) only.

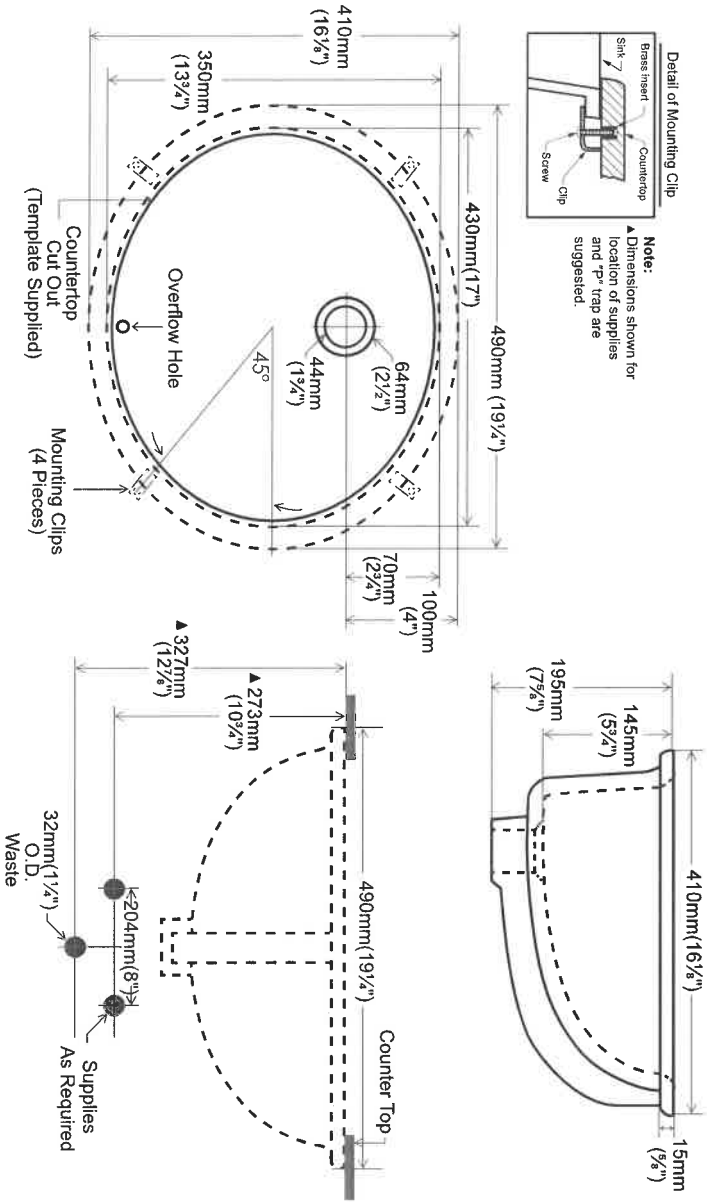

contrac®

5970 Chedworth Way, Unit A, Mississauga, ON, Canada L5R 3V5
www.contrac.ca

Revised: January 2016

2-9 Master

Align®

Traditional | Transitional | Modern

From intimate galley kitchens to large gourmet workstations,
Align faucets bring a refreshed modern look to your home.

KITCHEN

1 of 2-9
Apr. 28/21



**MotionSense™ Hands-Free Single
Handle Pull-down Kitchen Faucet ***
Not Available in BLS, BL or BG
Model 7565E

Chrome
Other

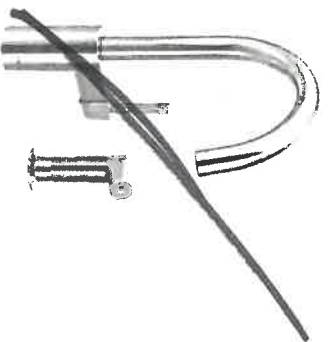

**Single Handle Kitchen Faucet
with Side Spray ***
Not Available in BG or BLS

Model 7165
Chrome
Other

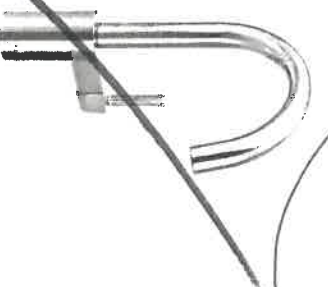

**Single Handle
Kitchen Faucet ***
Not Available in BG or BLS

Model 7365
Chrome
Other



**Single Handle Pull-down
Kitchen Faucet ***
Model 7565
Chrome
Other
Black Stainless

Matte Black

Kitchen
Faucet

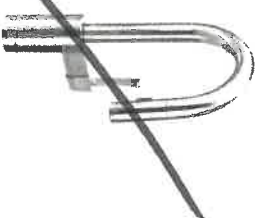

**Single Handle Pull-down
Bar/Prep Faucet ***
Model 5965

Chrome
Other
Black Stainless



C SRS BL BG BLS

FINISH OPTIONS:

To order, combine the model number with one of these finish letter(s):
Spot Resist™ Stainless (SRS), Matte Black [BL] & Brushed Gold [BG]

To order Chrome (C) model, use model number only.
For Chrome MotionSense, order 7565EC.

* Deckplate sold separately - 141002 series

Jim

Michael

Soap or Lotion Dispensers

Traditional Transitional Modern

However you define your faucet's style, you can assure a coordinated look with Moen soap dispensers.

KITCHEN

1 of 2-9
Apr. 28/21

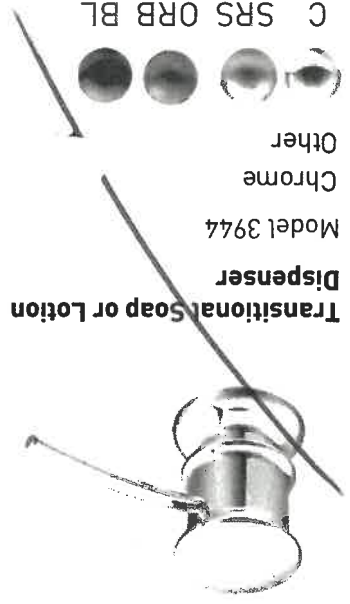

qth 2
Kitchen
Black.

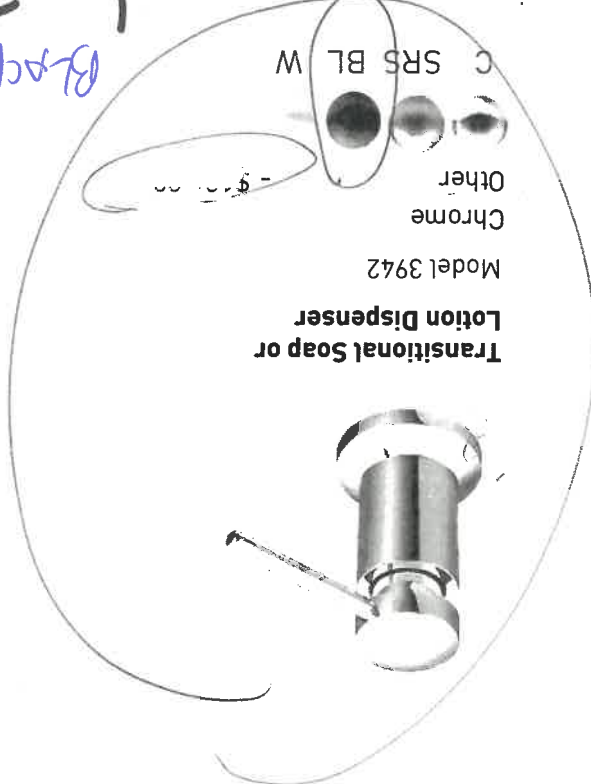

Lotion







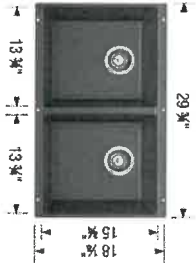

28/21

Product Specification Sheet

PRECIS U 2
SILGRANIT®

PRODUCT DIMENSIONS



PRECIS U 2	Colour Finish	Model No.	<div>FEATURES / SPECIFICATIONS</div> <ul style="list-style-type: none">• Preciis Kitchen sinks are made in Canada and Germany• Double bowl configuration allows for easy multi-tasking in busy kitchens• Made of SILGRANIT, a high-quality granite composite• Heat, scratch and stain resistant• Non-porous surface is anti-bacterial and easy to clean <div>DESIGN AND PLANNING TIPS</div> <p>Cabinet Size: 33" (840 mm) Bowl depth: 8" (205 mm) / 8" (205 mm) Depending on cabinet construction, a different cabinet size may be required. Consult the cabinet manufacturer.</p> <div>2-9 Kitchen</div>
	White	401705	
	Truffle	401779	
	Metallic Gray	401881	
	Concrete Gray	402265	
	Cinder	401415	
	Café	400581	
	Biscuit	401818	
	Anthracite	400580	
WARRANTY			

Limited Lifetime warranty

Code/Standards Compliance

BLANCO sinks and faucets are third-party tested and certified to CSA, cUPC, ANSI/ASME and NSF standards and listed by applicable certification bodies. For more information on individual product listings, contact our office or listing organization.

BLANCO CANADA 100 Corporation Drive Brampton, ON L6S 6B5	Tel: 905 494 2400 Fax: 905 494 2425 www.blancocanada.com	Toll Free: 1 877 425 2626 Toll Free: 1 877 825 2626	© 2016 BLANCO CANADA
--	--	--	----------------------

GALLERY ^{THE} **ZANCOR**
BY ZANCOA HOMES

UPGRADED HARDWARE -
New Image Kitchens

* ALL PRICES ARE PER PIECE *

BERENSON - HALIBURTON

CHROME



Knob	
96mm	\$
128mm	\$
160mm	\$
256mm	\$
320mm	\$
448mm	\$

BRUSHED NICKEL



Knob	
96mm	\$
128mm	\$
160mm	\$
256mm	\$
320mm	\$
448mm	\$

BRUSHED BRASS



Knob	
96mm	\$
128mm	\$
160mm	\$
256mm	\$
320mm	\$
448mm	\$

GRAPHITE



Knob	
96mm	\$
128mm	\$
160mm	\$
256mm	\$
320mm	\$
448mm	\$

MATTE BLACK

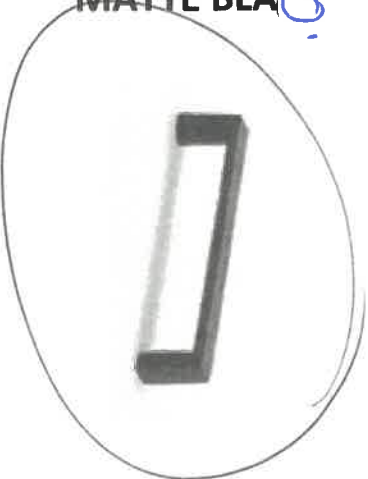

Knob	
96mm	\$
128mm	\$
160mm	\$
256mm	\$
320mm	\$
448mm	\$

Kitchen x 30
Master x 4
Main x 2

10-2-9
Apr. 28/21



CLIENT NAME: ZANCOR HOMES
SHIP TO: BROOKVALEY TOWNS

JOB NUMBER

INSTALL DATE:

PH:
CELL:

DRAFTED BY: FERNANDA
COMMENT

PAGE
17 of 19

DATE SUBMITTED
30 Mar 2021

P/O #

RLT-03
KITCHEN 3D DRAWING

Lot 2-9
April 28/21

ALL
- upper cabinets
Vanilla Milkshake

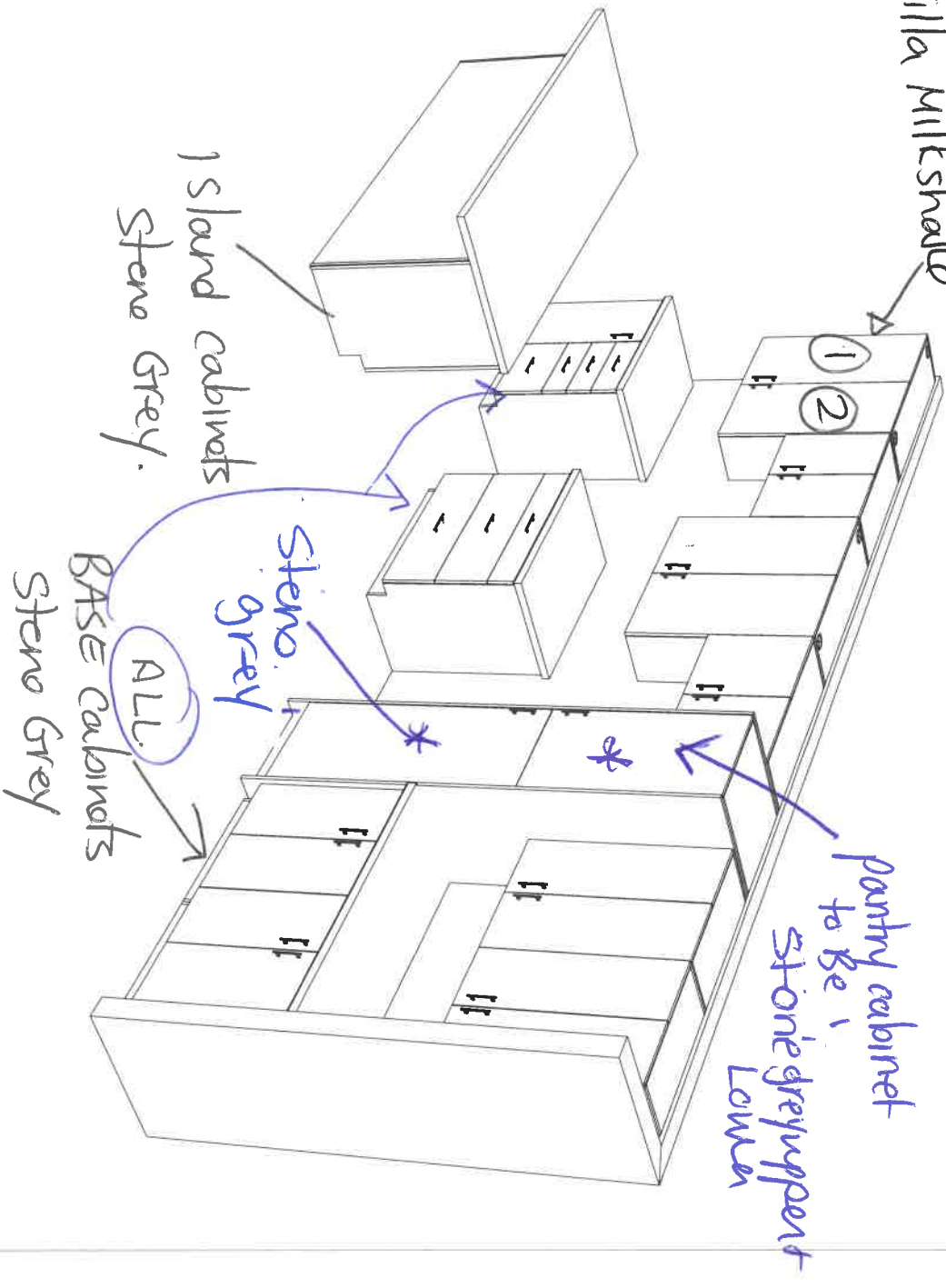

1 qty 1 - clear glass door
@ qty 1 - clear glass door

Modified V.P
Jordan



DATE SUBMITTED
30 Mar 2021

CLIENT NAME: ZANCOR HOMES
SHIP TO : BROOKVALLEY TOWNS

PH:
CELL :

DRAFTED BY: FERNANDA
COMMENT

P/O #

OB NUMBER

INSTALL DATE:

PAGE

16 of 19

RLT-03
KITCHEN ELEV. A & B
END

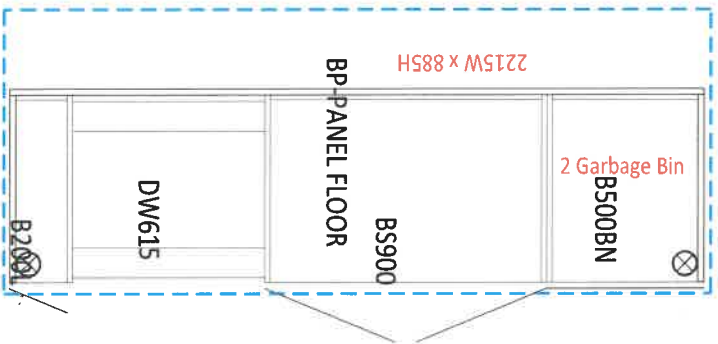

-Soft Close Doors and Drawers
-Cutlery divider

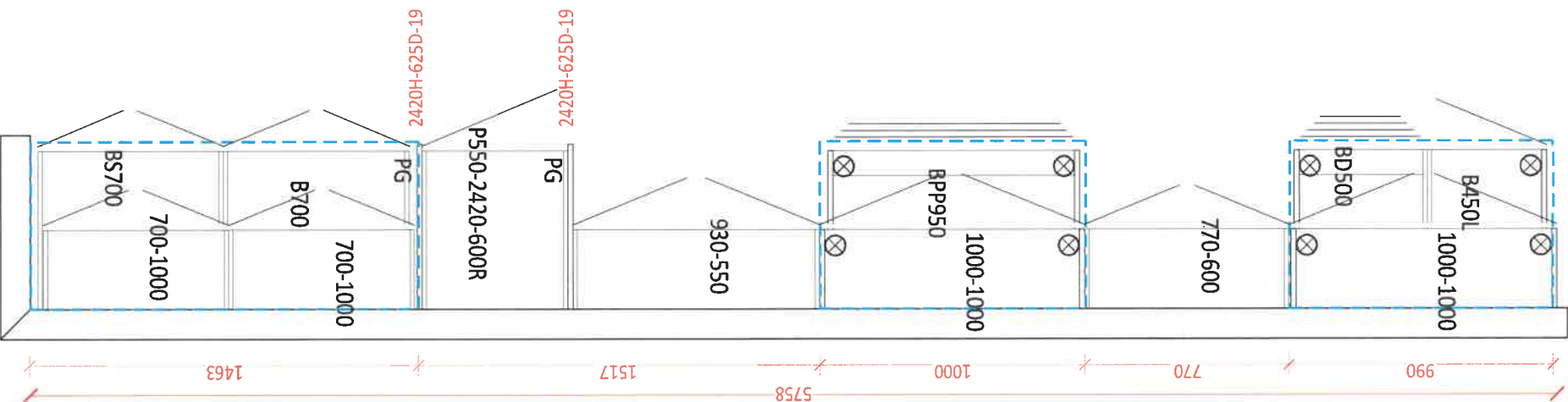

Lot 2-9
Apr 1 28/21

1000mm
1000mm



DATE SUBMITTED
30 Mar 2021

CLIENT NAME: ZANCOR HOMES
SHIP TO: BROOKVALEY TOWNS

PH:
CELL:
DRAFTED BY: FERNANDA
COMMENT

JOB NUMBER

INSTALL DATE:

PAGE

18 of 19

P/O #

RLT-03
STANDARD VANITIES ELEV A & B
END

MAIN
960

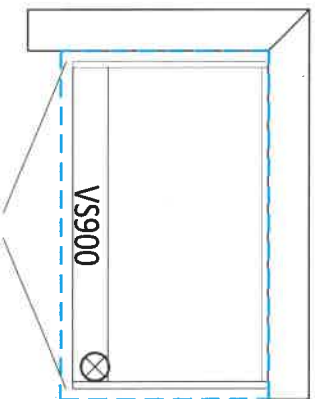

*Comfort
Height -*

*1 of 2-9
April 28/21*

MASTER ENSUITE
1660

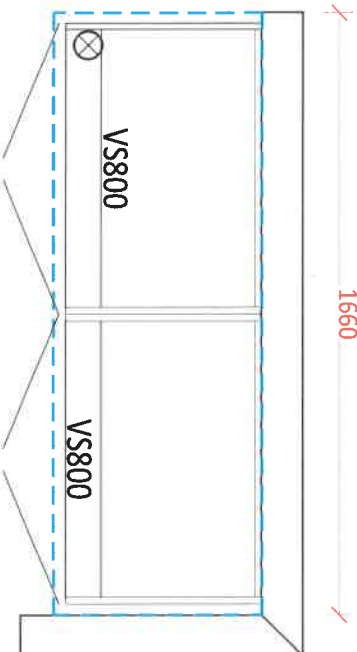

*Comfort
Height*

OPT. BASEMENT BATH
960

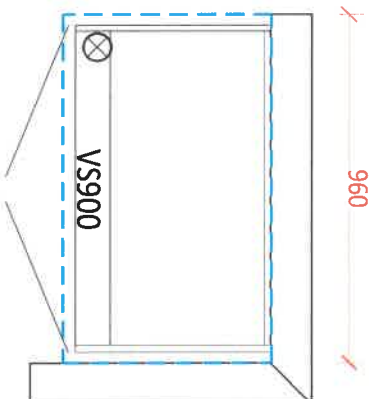

floor score

Marked

APPLIANCE ACKNOWLEDGEMENT

CONTACT: Steve Miller @ Appliance Canada (905) 660-2424 / 8701 Jane Street, Vaughan

► Appliance Specs are DUE 2 WEEKS FROM SIGNED DATE OF COLOUR CHART (if not received during appointment)

Specs that require changes/modifications after this date will not be accepted

► NOTE: Any upgraded appliances are to be paid by the Purchaser, directly to the appliances company.

► Additional charges to the Purchaser may apply for cabinetry, electrical and plumbing in order to accommodate the specs given by the homeowner.

► It is the Purchaser's responsibility to coordinate delivery, installation and hook up of appliances and to ensure they are installed as per Manufacturers specifications after closing.

► Standard appliance openings are approximate and the minimum required. Sizes may vary due to onsite condition and/or when modifications have been made to the cabinetry.

STANDARD OPENINGS ACKNOWLEDGED BY PURCHASER:

Fridge Opening	► 36" x 74"	**Size is (+/-) & space above the fridge is required due to proper air flow
Stove Opening	► 30"	
Hood Fan Opening	► 30"	
Hood Fan Vent	► 6"	
Dishwasher Opening	► 24"	

UPGRADED APPLIANCES BELOW (Check applicable)

It is the Purchaser's responsibility to provide Zancor Homes with the correct specification for each appliance that has been upgraded. Zancor Homes will not be responsible for appliance requirements based on upgrades if specs have not been provided to the builder.

FRIDGE

☐ Built-In ☐ Flush Inset

(Spec's Required) ☐ Paneled / Integrated ☐ Water Line

U.P.
INITIAL

RANGE

☐ 36" ☐ Cooktop (Apron front)

(Spec's Required) ☐ 48" ☐ Cooktop (Drop-in)

*hood fan opening to be the same as the stove

Larger CFM may be required with these appliances

**Countertop Cut-out charge required for cooktop

☐ Induction

HOOD FAN &

☐ Under Cabinet (Standard) ☒ 6 Inch (Standard)

VENT

☐ Chimney (centre vent) ☐ 8 Inch

(Spec's Required) ☐ Insert / Liner ☐ 10 Inch

WALL OVEN &

☐ Single Oven ☐ Warming Drawer

MICRO

☐ Double Oven ☐ Over the Range Microwave

(Spec's Required) ☐ Steam Oven ☐ Built-in Microwave (*trim kit required)

DATE

SITE

LOT

BROOKLIN TOWNS

** Any upgrades checked in this appliance form must be accompanied with specs provided by the Purchaser.

**It is the responsibility of the trade to inform the Builder of any discrepancies with specs, sketches, extras and/or colour chart PRIOR to production/installation.

221 North Rivermede Road, Concord, Ontario L4K 3N7 * T: (905) 738.7010 F: (905) 738.5948

Approved

U.P.

HOME AUTOMATION
(Cable, CAT5, Telephone)

LOT / SITE: BROOKLIN TOWNS - 2-9

DATE: Apr. 28 / 21

STANDARD ITEMS AS PER SCHEDULE A:

STANDARD CABLE ROUGHIN in (1) Master Bedroom, (1) Family / Great Room
STANDARD TELEPHONE ROUGHIN in (1) Master Bedroom, (1) Family / Great Room
STANDARD CAT5 ROUGHIN - (3) In location of Purchasers choice.

OPTION 1:

I/we the Homeowner(s) have chosen to contact the Home Automation Company to select the locations of the rough-ins for Cable, CAT5, Telephone as included in our Agreement of Purchase Sale.

I/we the Homeowner(s) will contact the trade within 4 weeks of the date of this release to select locations of the standard rough-ins review other optional products for purchase.

Trade: Artistic Smart Homes
Phone: (905) 850-9386
Rep: Jessica
Location: 8601 Jane Street Unit #8 Vaughan ON L4K 5N9

Should the homeowner not make these selections within the sufficient time provided, the rough-ins as mentioned above will be installed in locations as indicated above.

OPTION 2:

V.P. JH
Homeowner(s) Initial

I/we the Homeowner(s) have chosen to not contact the home automation company. I/we the Homeowner(s) have selected the locations for the standard rough-ins for Cable, CAT5, Telephone that are included in the Agreement of Purchase and Sale directly with a décor rep.

V.P. JH
Homeowner(s) Initial

Stone Countertop Edge Profiles

Where applicable as per site specifications

LOT / SITE:

BROOKLIN TOWNS -

2-9

DATE:

Apr. 28/21

STANDARD EDGE FOR KITCHEN & VANITIES

Standard Countertop Edge
in Kitchen

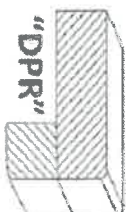

Standard Countertop Edge
in Vanity

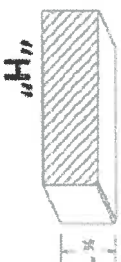

Homeowner(s) Initial

V.P. JA

OPTION (1) EDGE FOR KITCHEN & VANITIES \$250

Optional Edge in Kitchen

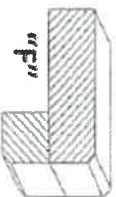
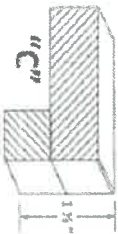

Optional Edge in Bathroom

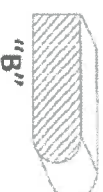
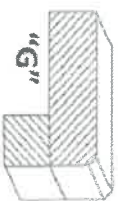
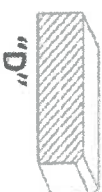

Homeowner(s) Initial

V.P. JA

OPTION (2) EDGE FOR KITCHEN & VANITIES CUSTOM PRICING

Optional Edge for Kitchen

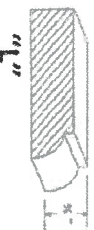

Optional Edge in Vanity

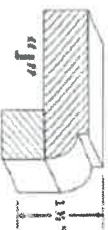
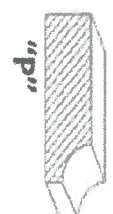

Homeowner(s) Initial

V.P. JA

gwa
V.P. JA



Undercounter Dishwasher

16-2-9
10-28/21
APR 11

PRODUCT MODEL NUMBERS

WDF110PAB	WDF320PAD	WDT710PAH
WDF111PAB	WDF330PAH	WDT720PAD
WDF120PAF	WDF331PAH	WDT730PAH
WDF121PAF	WDF520PAD	WDT735PAG
WDF130PAH	WDF540PAD	WDT735PAH
WDF131PAH	WDF545PAF	

DRAIN REQUIREMENTS

- A new drain hose is supplied with your dishwasher. If drain hose is not long enough, use a new drain hose with a maximum length of 12 ft (3.7 m) that meets all current AHAM/IAPMO test standards, is resistant to heat and detergent, and fits the 1" (25 mm) drain connector of the dishwasher. See the "Tools and Parts" section at the front of the guide for part details and orders.
- Make sure to connect drain hose to waste tee or disposer inlet above drain trap in house plumbing and 20" (508 mm) minimum above the floor. It is recommended that the drain hose either be looped up and securely fastened to the underside of the counter or be connected to an air gap.
- Make sure to use an air gap if the drain hose is connected to house plumbing lower than 20" (508 mm) above subfloor or floor.

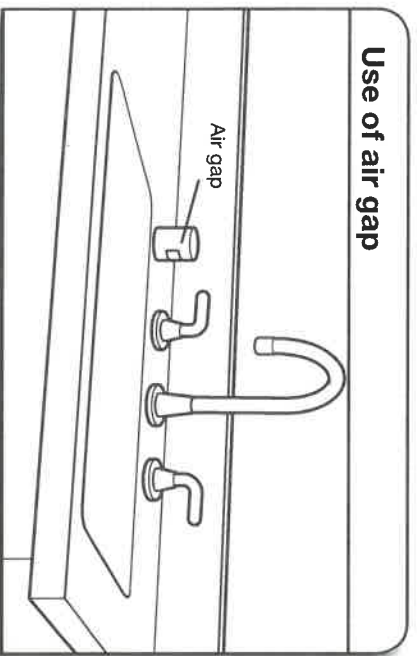

- If required, the air gap should be installed in accordance with the air gap installation instructions. When you are connecting the air gap, a rubber hose (not provided) will be needed to connect to the waste tee or disposer inlet.
- Use 1/2" minimum I.D. drain line fittings.

WATER SUPPLY REQUIREMENTS

- This dishwasher has a water heating feature and also requires a connection to a hot water supply line.
- A hot water line with 20 to 120 psi (138 to 862 kPa) water pressure can be verified by a licensed plumber.
- 120°F (49°C) water at dishwasher
- 3/8" O.D. copper tubing with compression fitting or flexible braided water supply line. See the "Tools and Parts" section at the front of the guide for part details and orders.

NOTE: 1/2" minimum plastic tubing is not recommended.

- A 90° elbow with 3/4" hose connection with rubber washer. See the "Tools and Parts" section at the front of the guide for part details and orders.
- Do not solder within 6" (152 mm) of the water inlet valve.
- If installed in new construction, make sure the house water supply lines have been flushed prior to connecting the dishwasher to remove any debris that may exist in the supply line.

NOTE: If replacing an existing dishwasher, it is recommended to install a new water line (See the "Tools and Parts" section at the front of the guide for part details) and drain hose (supplied) with the new dishwasher.

ELECTRICAL REQUIREMENTS

You Must Have:

- 120-volt, 60 Hz, AC-only, 15- or 20-amp, fused electrical supply
 - Copper wire only
 - A maximum of 2 field wiring supply conductors (12 AWG largest size) plus 1 grounding conductor are permitted in the terminal box.
- We Recommend:
- A time-delay fuse or circuit breaker
 - A separate circuit

If Connecting Dishwasher with a Power Cord:

- Use a UL Listed power cord kit marked for use with dishwasher. See the "Tools and Parts" section at the front of the guide for part details and orders.
- Plug into a grounded 3 prong outlet. Outlet must meet all local codes and ordinances.

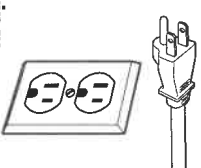

If Connecting Dishwasher with Direct Wiring:

- Use flexible, armored, or nonmetallic sheathed copper wire with grounding wire that meets the wiring requirements for your home and local codes and ordinances.
- Use a UL Listed/CSA Approved metallic strain relief.



Because Whirlpool Corporation policy includes a continuous commitment to improve our products, we reserve the right to change materials and specifications without notice.

Dimensions are for planning purposes only. For complete details, see Installation Instructions packed with product. Specifications subject to change without notice.

182-6
Apr. 28/21

PRODUCT AND CABINET OPENING DIMENSIONS

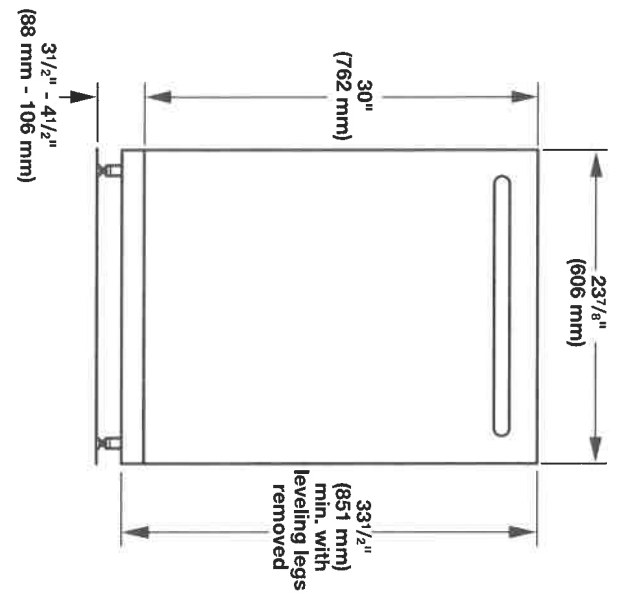

For 4" (100 mm) toe kick, height of cabinet opening is 34 1/2" (863 mm).

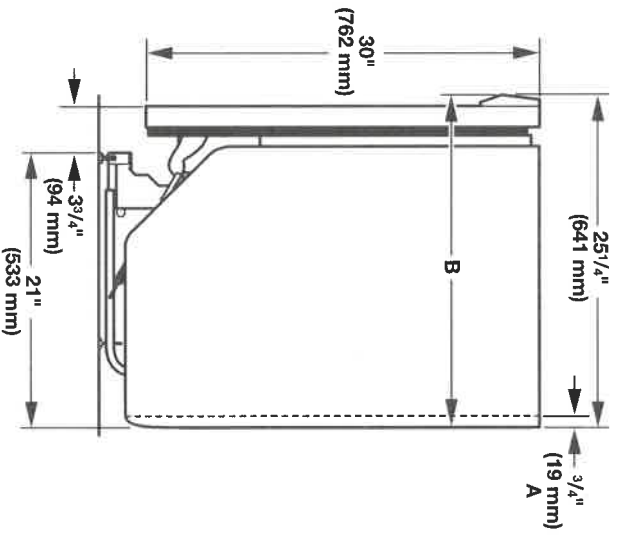

A. Insulation may be compressed (not used on all models).
B. Door handles may protrude forward of the face of the dishwasher, (varies by model).

Check that all surfaces have no protrusions that would prohibit dishwasher installation.

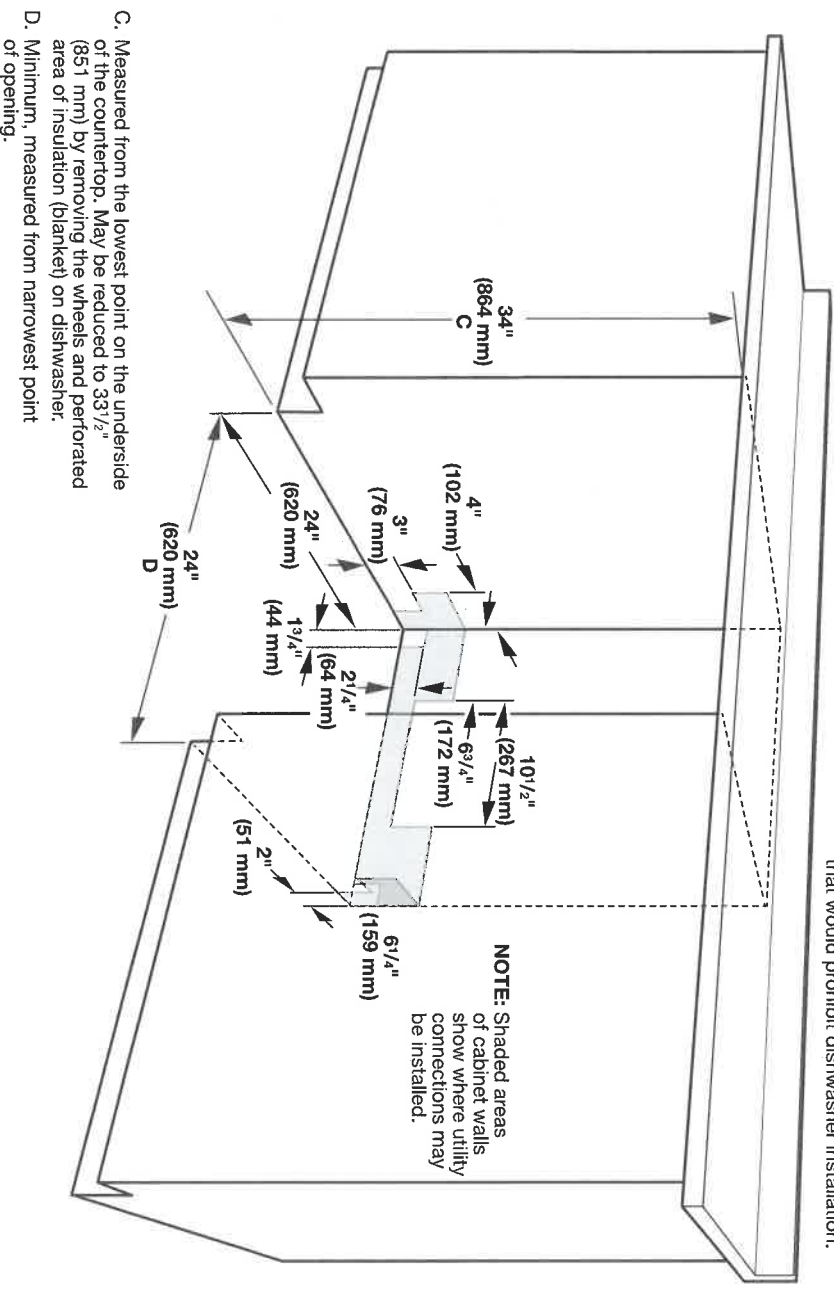

C. Measured from the lowest point on the underside of the countertop. May be reduced to 33 1/2" (851 mm) by removing the wheels and perforated area of insulation (blanket) on dishwasher.
D. Minimum, measured from narrowest point of opening.

W10806908-D-WH

182-9
Apr. 28/21

WRF535SWH
FRENCH DOOR REFRIGERATOR

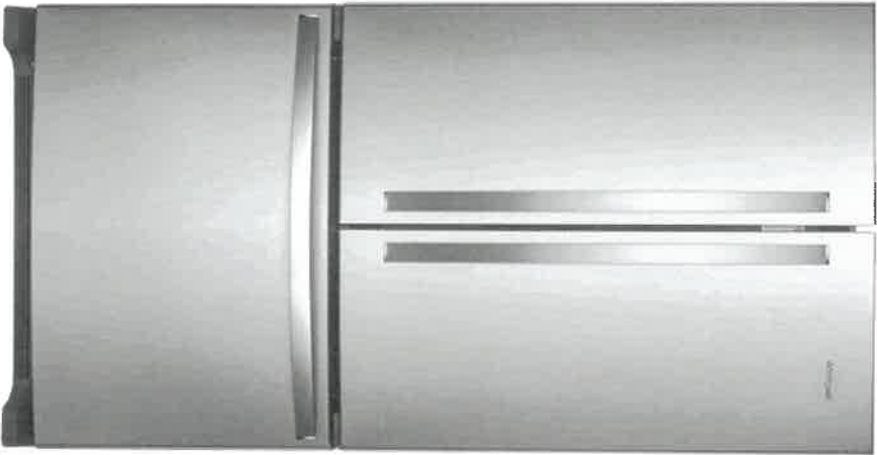

FINGERPRINT RESISTANT



Hide fingerprints and smudges with steel that easily wipes clean. Available in Black Stainless and Stainless Steel colors.

FULL-WIDTH, TEMPERATURE-CONTROLLED DRAWER



Store wide items like party platters and sheet cakes or preserve large amounts of meat and cheese at just the right temperature.

FRAMELESS GLASS SHELVES



Store more items on each shelf with wall-to-wall frameless glass shelves, which offer greater storage flexibility.

OTHER FEATURES

- Gallon door bins
- Humidity Controlled Crispers
- Accu-Chill™ temperature management system
- Adaptive defrost
- Interior water dispenser with EveryDrop™ water filtration
- FreshFlow™ produce preserver
- LED interior lighting

MODEL	WRF535SWHB	WRF535SWHW	WRF535SWHZ	WRF535SWHV
Max height (in)	70-1/8"	70-1/8"	70-1/8"	70-1/8"
Width (in)	35-5/8"	35-5/8"	35-5/8"	35-5/8"
Depth (in)	35-1/2"	35-1/2"	35-1/2"	35-1/2"

Black
(B)

White
(W)

Fingerprint Resistant
Stainless Steel (Z)

Fingerprint Resistant Black
Stainless Steel (V)



@/™ ©2017 Whirlpool. All rights reserved. 10/17, Form No. WRT170102A

Whirlpool®

Mr. Mokid

2-9 28/21
16
18/21

NE63T871SS

SAMSUNG

6.3 cu. ft. Slide-In Electric Range

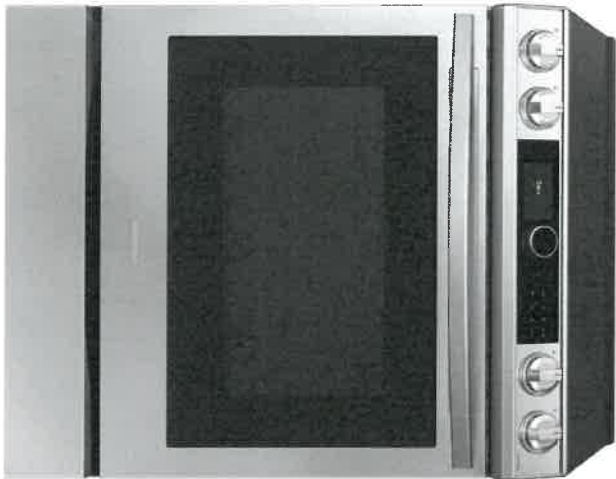

Signature Features

Intelligent User Experience

- Simplified control panel remembers your cooking habits while offering intuitive messaging on an LCD with one knob and minimum buttons.

Air Fry

- The ideal way to cook healthier fried food as it eliminates excess fat, but everything is still crispy and brown outside and juicy inside.

True Convection

- A heated fan distributes heat all around the oven and keeps the temperature constant so dishes are cooked quickly and thoroughly.

Wi-Fi Connectivity

- Monitor and control the oven using the SmartThings App¹. And control the oven with your voice using a voice assistant², such as Samsung Bixby³, Amazon Alexa or Google Assistant.

Fingerprint Resistant Finish

- Prevents surfaces from being covered in unsightly fingerprints or marks and smudges.

Available Colours

Fingerprint Resistant
Stainless Steel (shown)

Fingerprint Resistant
Black Stainless Steel



Air Fry



True Convection

Features

- Intelligent User Experience
- Air Fry with included Air Fry Rack
- True Convection
- Wi-Fi Connectivity
- Voice Control
- Fingerprint Resistant Finish

Convenience

- Slide-In Design
- Flexible Cooktop – 5 Electric Elements
- Large Oven Capacity: 6.3 cu. ft.
- Storage Drawer
- Hidden Bake Element
- Self & Steam Clean
- Illuminated Knobs
- Auto Oven Light
- Proofing
- Kitchen Timer
- Delay Start
- Auto Shut-Off Option
- Child Safety Lock
- Easy Preset Cook Options
- Sabbath Mode
- Temperature Probe

¹Available on Android and iOS devices. A Wi-Fi connection and a Samsung account are required.

²A Wi-Fi connection is required.

³Bixby is Samsung's brand of artificial intelligence (AI) / Internet of Things (IoT) voice assistant. A Samsung account is required.

Mr. Motilal

NE63T871SS

SAMSUNG

6.3 cu. ft. Slide-In Electric Range

Installation Specifications

IMPORTANT: To eliminate the risk of burns or fire caused by reaching over heated surface units, avoid having cabinet storage space located above the surface units. If you have cabinet storage space over the heating elements, you can reduce the risk by installing a range hood that projects horizontally a minimum of 5 inches beyond the bottom of the cabinets.

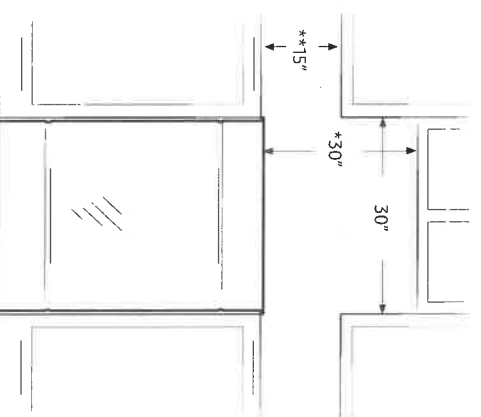

* A minimum of 30" is required between the top of the cooking surface and the bottom of an unprotected wood or metal cabinet; a minimum of 24" is required if the bottom of the wood or metal cabinet is protected by not less than 1/4" of flame retardant millboard covered with not less than no.28 MSG of sheet steel, 0.015" of stainless steel, 0.024" of aluminum, or 0.020" of copper.

**** A minimum of 15" is required between the countertop and the adjacent cabinet bottom.**

Dimensions

CAUTION: This range has been designed to comply with the maximum allowable wood cabinet temperatures of 194 °F. Make sure the wall covering, countertops, and cabinets around the range can withstand the heat (up to 194 °F) generated by the range. If not, discolouration, delamination, or melting may occur.

SLIDE-IN CUTOUT

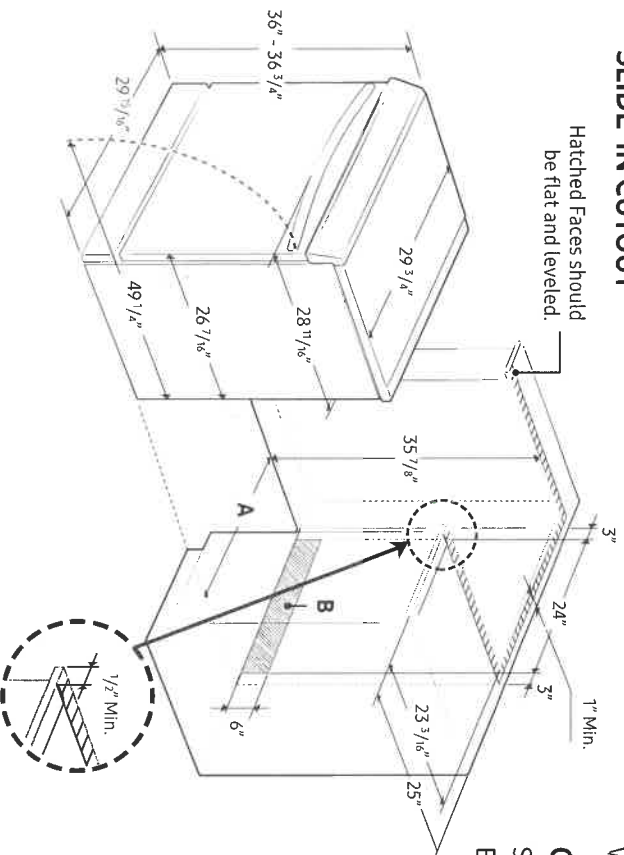

Power Source

240V/60HZ/40A

Electric Ceramic Cooktop

- Right Front: 6"/9"/12", 3000W
- Left Front: 6"/9", 3600W
- Right Rear: 6", 1200W
- Left Rear: 6", 1200W
- Warm Center: 7", 100W

Oven

- Hidden Bake Element: 3000W
- Bake: 175°F - 550°F
- Convection Bake: 175°F - 550°F
- Convection Roast: 175°F - 550°F
- Broil: (Low – High)
- Convection Element/Heater: 1250W
- Proofing
- Sabbath Mode

Storage Drawer

- Capacity: 1.0 cu. ft.

Warranty

One (1) Year Parts and Labour

Product Dimensions & Weight (WxHxD)

Outside Dimensions:

29¹⁵/₁₆" X 36"-36³/₄" X 28¹¹/₁₆"

Weight: 174.8 lbs (79.3 kg)

Shipping Dimensions & Weight (WxHxD)

Dimensions: 33¹/₁₆" x 41³/₄" x 30⁵/₁₆"

Weight: 201.3 lbs (91.3 kg)

Colour	Model #	UPC Code
Stainless Steel	NE63T8711SS	887276414997
Black Stainless Steel	NE63T8711SG	887276414980



Actual colour may vary. Design, specifications and colour availability are subject to change without notice. Non-metric weights and measurements are approximate.

© 2020 Samsung Electronics Canada Inc. All rights reserved. Samsung is a registered trademark of Samsung Electronics Co., Ltd. used with permission.

Noted

10/28/21

Purchaser accepts and acknowledges that the Builder reserves the right to substitute materials with those of equal or better quality where the manufacture, scheduling or delivery of materials may directly impact the Builder's ability to meet its contractual obligations under the Agreement of Purchase and Sale.

UPGRADES/EXTRAS: All upgrades and additional selections indicated on the colour chart must be accompanied by an upgrades/extras sheet (PES) and full payment otherwise the selection will be invalid. All colour charts and upgrades/extras will not proceed until verified and signed by an authorized signing officer at the Vendor's head office. **CHANGES WILL NOT BE PERMITTED UPON COMPLETION AND SUBMISSION OF THE COLOUR CHART.**

PORCELAIN & NATURAL STONES: Due to the properties of natural stones including but not limited to **marble, granite, quartz**, no two pieces are exactly the same. Variations in colour, tone, granularity (pitting, fissures) and pattern are to be expected, including various lighting may affect the overall finished look. Stone tops are sealed at time of installation and should never be cleaned with lemon oil or vinegar. Stones are porous materials, therefore any spilled substance require immediate attention. Stone countertops require regular seal re-application as part of home maintenance. Purchaser acknowledges colour and product variations as well as natural imperfections may exist with the selection of natural stone materials and shall not hold the Vendor liable for provision of same.

STONE COUNTERTOP JOINTS: Purchaser is aware that one joint will be at each corner and on either side of slide-in-range (if applicable). It will also be where the length of the counter top exceeds the length of a stone slab. Slabs are usually approximately 5' x 8'.

CERAMIC TILES: Due to manufacturing, shade (dye lots), product variations may exist that can affect the overall look of the finished product. Although every effort will be made to ensure the colours and materials selected are as close as possible to the samples, the purchaser acknowledges that the sample tiles supplied in the Design Centre may not be identical to the materials installed in the home.

STAIR STAINS: Due to the natural properties of wood, many variables can affect the overall look of the finished product. Factors including but not limited to wood type, knotting, graining, density, age, humidity, and air temperature can result in substantial variations in stain intensity. The purchaser accepts that although the Vendor will do their best to match stain the unfinished stairs as close as possible to the pre-finished floors, it is not possible to have an identical match and that there MAY be shade differences between the two products.

CABINETRY: Due to the natural properties of wood, slight variations apparent with cabinetry are to be expected. This includes but not limited to wood species, wood grain, colour, finish, product variations, and natural imperfections are all factors that may affect the overall look of the finished product. Such factors make exact colour matching impossible. The type and intensity of lighting in the areas of designated cabinetry placement may also highlight characteristics of cabinetry finish. All cabinets shall be finished with a white melamine interior box unless a finished interior is upgraded. Due to building specifications and/or on-site conditions, certain cabinetry upgrades may not be possible. The purchaser acknowledges that the Builder cannot guarantee the cabinetry finish or provision of certain upgrades and shall not hold the Builder liable for provision of same.

UPGRADES/EXTRAS: All upgrades and additional selections indicated on the colour chart must be accompanied by an upgrades/extras sheet (PES) and full payment otherwise the selection will be invalid. All colour charts and upgrades/extras will not proceed until verified and signed by an authorized signing officer at the Vendor's head office. **CHANGES WILL NOT BE PERMITTED UPON COMPLETION AND SUBMISSION OF THE COLOUR CHART.**

HARDWOOD / LAMINATE FLOORING: Due to the properties of wood and laminate, many variables can affect the overall look of the finished product. Variations include but not limited to wood type or laminate finish, colour/stain and wood grain are significant factors that make exact colour matching impossible. The purchaser acknowledges that the hardwood flooring is a pre-finished product in a controlled environment. Expansion, compression and cupping are characteristics of hardwood flooring once installed in the home. The purchaser acknowledges these may become apparent over time and despite the Builders' efforts to install the hardwood flooring materials in keeping with good workmanship, the Builder shall not be responsible nor held liable for minor variances of fluctuation in hardwood flooring materials.

I/We understand hardwood flooring is classified as a porous material and as such not recommended by the Builder in certain areas. I/We understand there is a concern due to possible water and other substances being frequently splashed or spilled onto the floor and in contravention of Ontario Building Code Section 9.30.1.2(1).

"Finished flooring bathrooms, kitchens, public entrance halls, laundry & general storage areas shall consist of resilient flooring, felted-synthetic-fibre floor coverings, concrete, terrazzo, ceramic tile, mastic or other types of flooring providing similar degrees of water resistance."

I/We are prepared to assume full responsibility for any damage caused to the hardwood floor or subfloor due to moisture absorbency in the mentioned areas, and agree to waive any claims against the Township of residence, TARIION and/or the Builder in relation to the matter. ****SEE COLOUR CHART FOR LOCATIONS****

LOT