

CONSTRUCTION SUMMARY OF EXTRAS

Printed 2021-04-28 / 9:37 AM / Page 1 of 1

Site: BROOKLIN NOW TOWNS

Lot: 9-53

Model: AMAZE RLT-01

Purchaser: VALENTINA AZARM D DIAHEDI

Purchaser: 0

Phone: 289.387.4001

Email: VMAHZOUNI@YAHOO.COM



DESCRIPTION		DATE SELECTED
	BONUS PACKAGE: 3 PIECE STAINLESS STEEL APPLIANCES WITH WHITE FRONT LOAD WASHER & DRYER	INCLUDED IN APS
	BONUS PACKAGE: STAINLESS STEEL HOOD FAN	INCLUDED IN APS
	BONUS PACKAGE: AIR CONDITIONING UNIT	INCLUDED IN APS
#1	STAIN FOR STAIRS	27-Apr-21
#2	HARDWOOD- UP 1	27-Apr-21
#3	COUNTERTOP KITCHEN- UP 2	27-Apr-21
#4	BACKSPLASH- KITCHEN- UP 2	27-Apr-21
#5	COUNTERTOP- MASTER ENSUITE- UP 1 MARBLE (INCLUDES OVAL UNDERMOUNT SINK- 4220CFY)	27-Apr-21
#6	COUNTERTOP- MAIN BATH- UP 1 MARBLE (INCLUDES OVAL UNDERMOUNT SINK- 4220 CFY)	27-Apr-21
#7	ELECTRICAL FIREPLACE- DIMPLEX PRISM BLF5051 LINEAR- 50"	27-Apr-21
#8	ELECTRICAL- 2 CAPPED LIGHTS TO BE SPACED EVENLY OVER KITCHEN ISLAND ON SEPARATE SWITCH, STANDARD LIGHT TO REMAIN	27-Apr-21

ZANCOR HOMES COLOUR CHART

PRINTED 2021-04-27, 11:10 AM

ENTRANCES				
Main Foyer - FLOORING		LIVORNO 18 X 18	✓	
Mudroom - FLOORING		LIVORNO 18 X 18	✓	
Side Hall - FLOORING		NA		
Basement Foyer - FLOORING		NA		
KITCHEN				
Kitchen - FLOORING		KENTWOOD OAK WOLFHOUND 3 1/2" X 3/4- UP 1	✓	
Breakfast - FLOORING		KENTWOOD OAK WOLFHOUND 3 1/2" X 3/4- UP 1	✓	
Kitchen - CABINETS		SIERRA PVC WHITE	✓	
Island - CABINETS		SIERRA PVC WHITE	✓	
Servery - CABINETS		NA		
Kitchen - HANDLES/KNOB		H800BC		
Kitchen - COUNTERTOP		CARRARA WHITE QUARTZ UP 2	✓	
Island - COUNTERTOP		CARRARA WHITE QUARTZ UP 2	✓	
Kitchen - BACKSPLASH		ARCTIC WHITE BRIGHT 4 X 16 UP 2	✓	
Kitchen - SINK		STD		
Kitchen - FAUCET		STD		
GREAT ROOM / DINING / LIVING / DEN / OFFICE / BASEMENT				
Dining Room - FLOORING		KENTWOOD OAK WOLFHOUND 3 1/2" X 3/4- UP 1	✓	
Living Room - FLOORING		KENTWOOD OAK WOLFHOUND 3 1/2" X 3/4- UP 1	✓	
Great Room - FLOORING		KENTWOOD OAK WOLFHOUND 3 1/2" X 3/4- UP 1	✓	
Library / Den - FLOORING		NA		
Basement Rec Room - FLOORING		KENTWOOD OAK WOLFHOUND 3 1/2" X 3/4- UP 1	✓	
STAIRS				
Railing Details - PICKETS		METAL BLACK SINGLE COLLAR W/ ALT PLAIN	✓	
Railing Details - POSTS		2 3/4" TURNED OAK POST	✓	
Railing Details - HANDRAIL		2-1/2" OVAL OAK HANDRAIL	✓	
Stair Stain - MAIN STAIRS		TO MATCH AS CLOSE AS POSSIBLE TO HARDWOOD	✓	
Stair Stain - BASEMENT STAIRS (if applicable)		NA		
Stair Stain - SERVICE STAIRS (if applicable)		NA		
POWDER ROOM				
GF- Powder Room - FLOORING		LIVORNO 18 X 18	✓	
Powder Room - CABINETS		NA		
SF-Powder Room -FLOORING		LIVORNO 18 X 18	✓	
Powder Room - SINK		STD		
Powder Room - FAUCET		STD		
2ND FLOOR				
Upper Hall - FLOORING		KENTWOOD OAK WOLFHOUND 3 1/2" X 3/4- UP 1	✓	
Master Bedroom - FLOORING		T03 OPENING NIGHT	✓	
Bedroom 2 - FLOORING		T03 OPENING NIGHT	✓	
Bedroom 3 - FLOORING		T03 OPENING NIGHT	✓	
Bedroom 4 - FLOORING		NA		
Bedroom 5 - FLOORING		NA		
Master Ensuite - FLOORING		LIVORNO 18 X 18	✓	
Master Ensuite - SHOWER WALL		LIVORNO 18 X 18	✓	
Master Ensuite - SHOWER FLOOR		WHITE 2 X 2	✓	
Master Ensuite - SHOWER JAMB		BIANCO CARRARA	✓	
Master Ensuite - CABINETS		EURO BLACKWOOD	✓	
Master Ensuite - HANDLES/KNOB		H800BC	✓	
Master Ensuite - COUNTERTOP		BIANCO CARRARA MARBLE- UP 1	✓	
Master Ensuite - SINK(s)	✓	Master Ensuite - FAUCET(s)	✓	STD
FOR TRADE USE				
Any upgrades in the colour chart must be accompanied with a PES. It is the responsibility of all Trades to inform the builder of any discrepancies on sketches, PES and/or colour charts PRIOR to installation.		BROOKLIN 9-53	✓	SIGNATURES
PAGE 1 OF 2		PURCHASER INITIALS	✓	VENDOR APPROVAL

2ND FLOOR CONTINUED...									
Main Bath - FLOORING		LIVORNO 18 X 18							
Main Bath - TUB / SHOWER WALL		LIVORNO 18 X 18							
Main Bath - SHOWER FLOOR		NA							
Main Bath - SHOWER JAMB		NA							
Main Bath - CABINETS		SIERRA PVC WHITE							
Main Bath - HANDLES/KNOBS		H800BC							
Main Bath - COUNTERTOP		BIANCO CARRARA MARBLE- UP 1 ✓							
Main Bath - SINK(s)		OVAL 4220CFY ✓		Main Bath - FAUCET(s)		STD			
Shared Bath- FLOORING		NA							
Shared Bath- TUB / SHOWER WALL		NA							
Shared Bath- SHOWER FLOOR		NA							
Shared Bath- SHOWER JAMB		NA							
Shared Bath- CABINETS		NA							
Shared Bath- HANDLES/KNOBS		NA							
Shared Bath- COUNTERTOP		NA							
Shared Bath- SINK(s)		(NA		Shared Bath - FAUCET(s)		NA			
Ensuite Bath - FLOORING		NA							
Ensuite Bath - TUB / SHOWER WALL		NA							
Ensuite Bath - SHOWER FLOOR		NA							
Ensuite Bath - SHOWER JAMB		NA							
Ensuite Bath - CABINETS		NA							
Ensuite Bath - HANDLES/KNOBS		NA							
Ensuite Bath - COUNTERTOP		NA							
Ensuite Bath - SINK(s)		(NA		Ensuite Bath - FAUCET(s)		NA			
LAUNDRY									
Laundry - FLOORING		LIVORNO 18 X 18		Laundry - HANDLES/KNOBS		NA			
Laundry - CABINETS		NA		Laundry - SINK		NA			
Laundry - COUNTERTOP		NA		Laundry - FAUCET		NA			
Laundry - BACKSPLASH		NA							
TRIM / PAINT									
Casing/Baseboards		STD							
Interior Doors		STD							
Interior Door Hardware		STD							
PAINT - Throughout		WARM GREY ✓							
FIREPLACE									
Location / Insert / Mantle		BLFFS051- 50 " ELECTRIC ✓							
ACCESSORIES									
Mirrors		YES		BATH ACCESSORIES		YES			
APPLIANCE REQUIREMENTS									
GAS LINE TO BBQ		STANDARD ✓		ELECTRICAL for Built-in Oven		DECLINED			
GAS LINE & ELECTRICAL TO STOVE		DECLINED		ELECTRICAL for Built-in Micro		DECLINED			
GAS LINE & ELECTRICAL TO DRYER		DECLINED		ELECTRICAL for Cooktop		DECLINED			
HOOD FAN VENT SIZE		STANDARD ✓		ELECTRICAL for Bar Fridge		DECLINED			
WATERLINE to Fridge		DECLINED							
DISCLAIMER									
Any changes to the colour chart after signing are subject to a \$5000 administration fee plus costs						VJD			
Purchaser has checked and acknowledged accuracy of colour and selections before signing.						VJD			
Colours of all materials are as close as possible to Builders selection but not necessarily identical due to dye lot variances in manufacturing/manufacturers. Due to construction progress some items may have been pre-selected or installed. In this event the Vendors's selection must be accepted by the purchaser									
SITE / LOT:		BROOKLIN		LOT		9-53			
PURCHASER(S):		VALENTINA AZARM D DIAHEDI							
PURCHASER(S):		0							
CONTACT:		289.387.4001		VMAHZOUNI@YAHOO.COM		SIGNATURES / DATE			
FOR TRADE USE									
Any upgrades in the colour chart must be accompanied with a PES. It is the responsibility of all Trades to inform the builder of any discrepancies on sketches, PES and/or colour charts PRIOR to installation.				PURCHASER SIGNATURE					
ZANCOR HOMES				PURCHASER SIGNATURE		V. Diahed			
				DÉCOR CONSULTANT		4114. 9			
				Vendor APPROVAL		[Signature] April 28/21			

Lot 9-53
Apr. 27/21

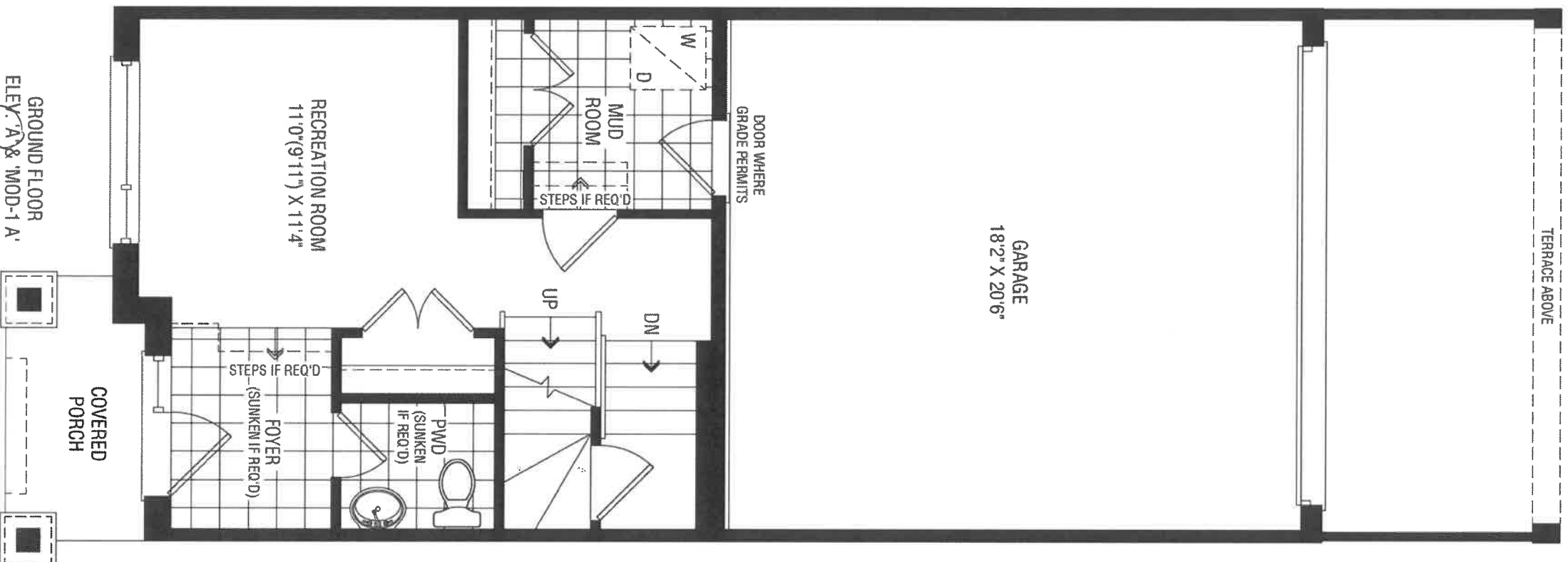

AMAZE

7.0

CALVIN
19 1/4" OVAL UNDERMOUNT SINK

☐ 4220CFY Undermount Sink

Product Specs:

- Vitreous china
- Front overflow hole
- Template and mounting hardware supplied

Overall Dimensions (W x D x H):

(OD): 490mm(19 1/2") x 410mm(16 1/2") x 195mm(7 7/8")
(ID): 430mm(17") x 350mm(13 3/4") x 145mm(5 3/4")

Compliance Certifications:

Meets or exceeds the following:

- IAPMO cUPC
- ASME A112.19.2 / CSA B45.1-2013

Shipping:

Cube 1.53
GW 19 lbs

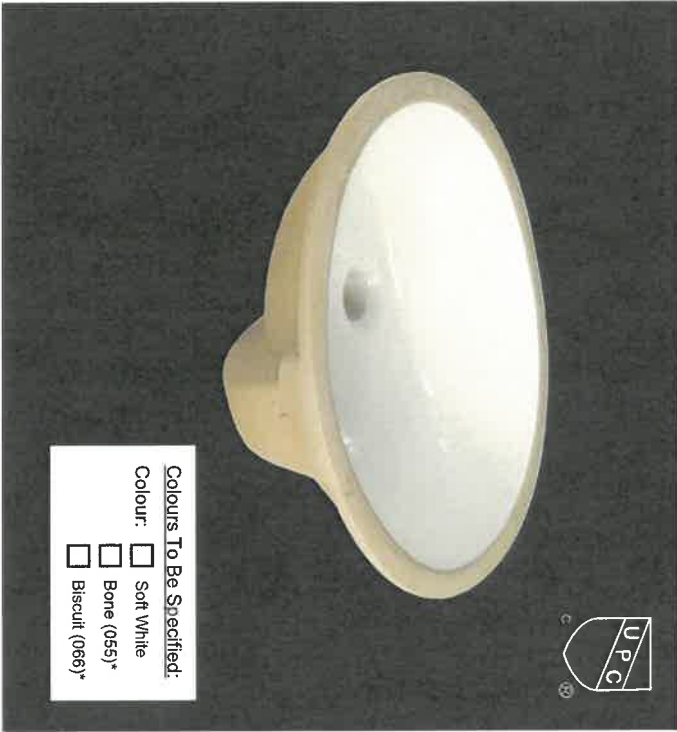

Notes:
Dimensions of fixtures are nominal and may vary within the range of tolerances established by ASME standard A112.19.2. These measurements are subject to change or cancellation. No responsibility is assumed for use of superseded or voided pages.
*Bone and Biscuit available through Direct Import (CIF) only.

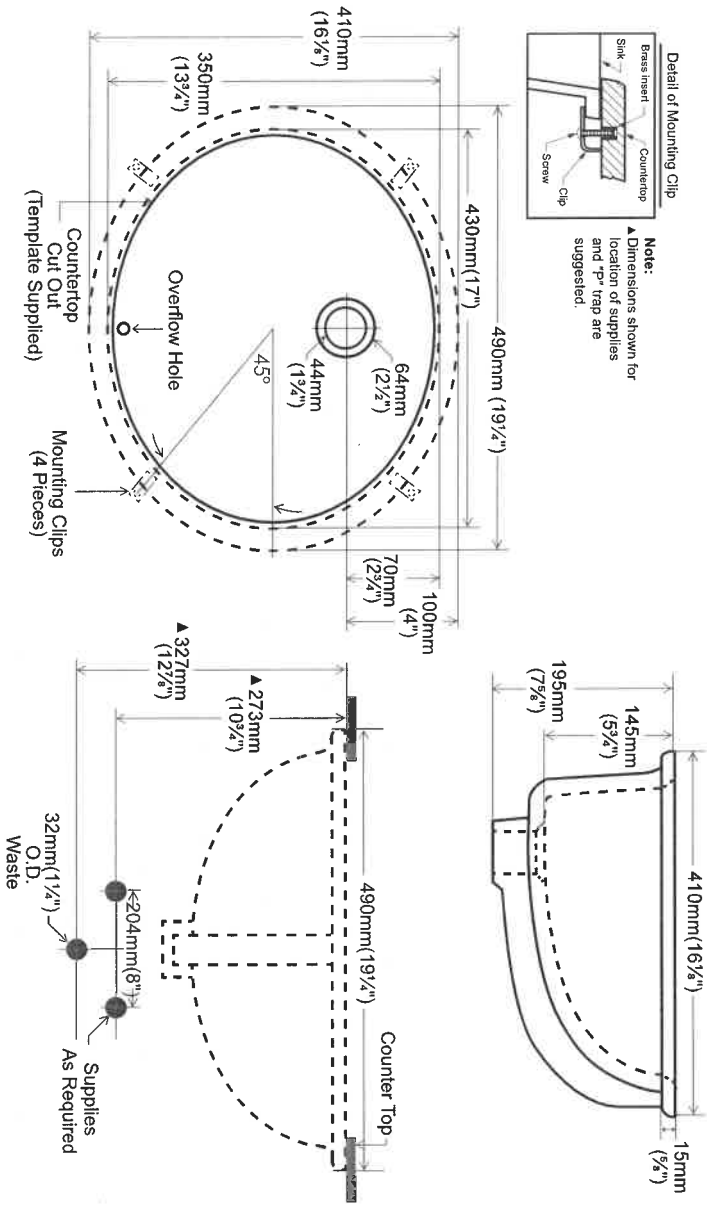

contrac®

5970 Chedworth Way, Unit A, Mississauga, ON, Canada L5R 3V5
www.contrac.ca

Revised: January 2016

Q-53 Master + Main

Let
9-53
Apr. 27/21

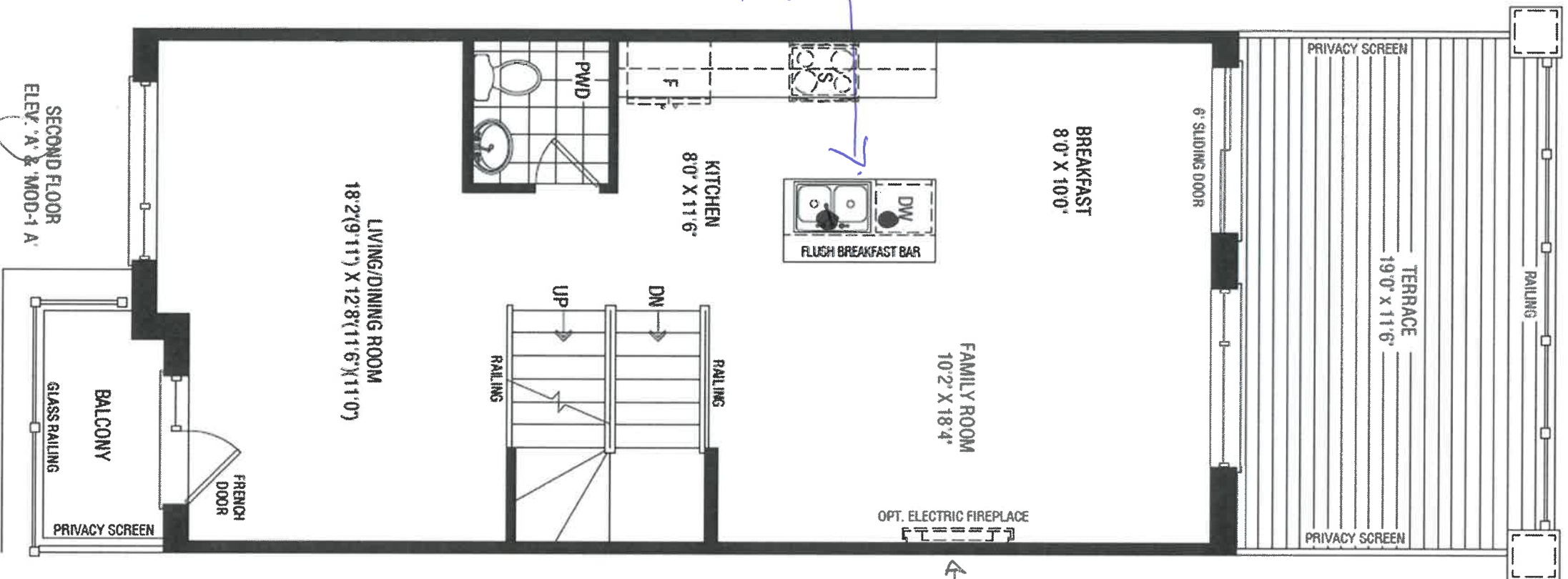

7.0

AMAZE

RAILING

RAISED CEILING FOR
ELEV. MOD-1 ONLY

MASTER BEDROOM
12'0" x 13'2"

12'0" x 13'2"

**GLASS
SHOWER**

Dye

LINEN

WIC

BEDROOM 2
8'6" x 9'4"

THIRD FLOOR
ELEV. 'A' & 'MOD-1A'



70

9-53

Apr. 27/21

AMAZE

Lot
9-53
~~Lot~~
Apr. 27/21

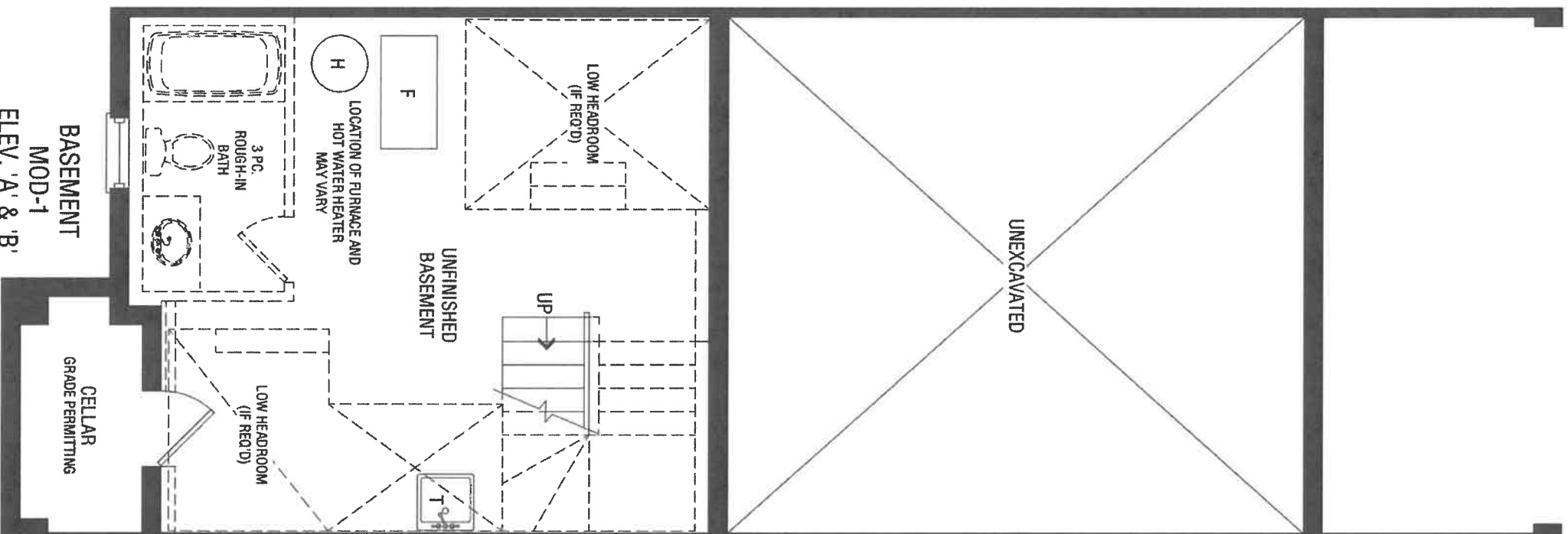

23

AMAZE



DATE SUBMITTED
30 Mar 2021

CLIENT NAME: ZANCOR HOMES
SHIP TO : BROOKVALEY TOWNS

PH:
CELL :
DRAFTED BY: FERNANDA
COMMENT

JOB NUMBER
INSTALL DATE:
PAGE
11 of 19
P/O #

RLT-01
KITCHEN 3D DRAWING

L869-S3

APR 27/21

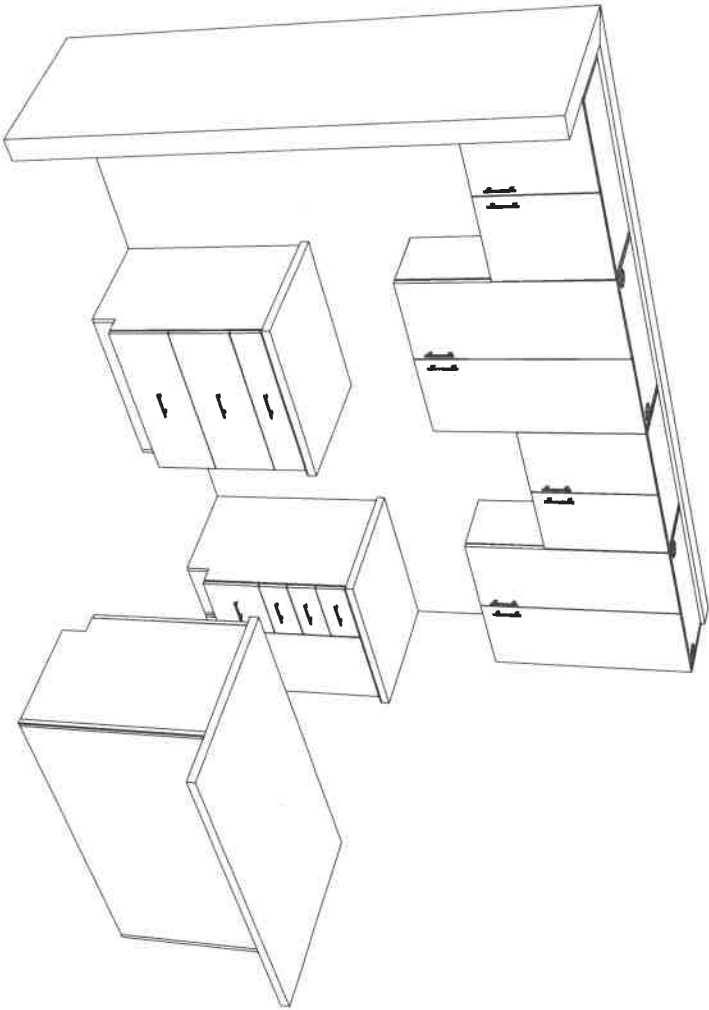

STANDARD

✓



DATE SUBMITTED
30 Mar 2021

CLIENT NAME: ZANCOR HOMES
SHIP TO: BROOKVALEY TOWNS

DRAFTED BY: FERNANDA
COMMENT

PH:
CELL:

P/O #

JOB NUMBER

INSTALL DATE:

PAGE
10 of 19

RLT-01
KITCHEN ELEV. A & B

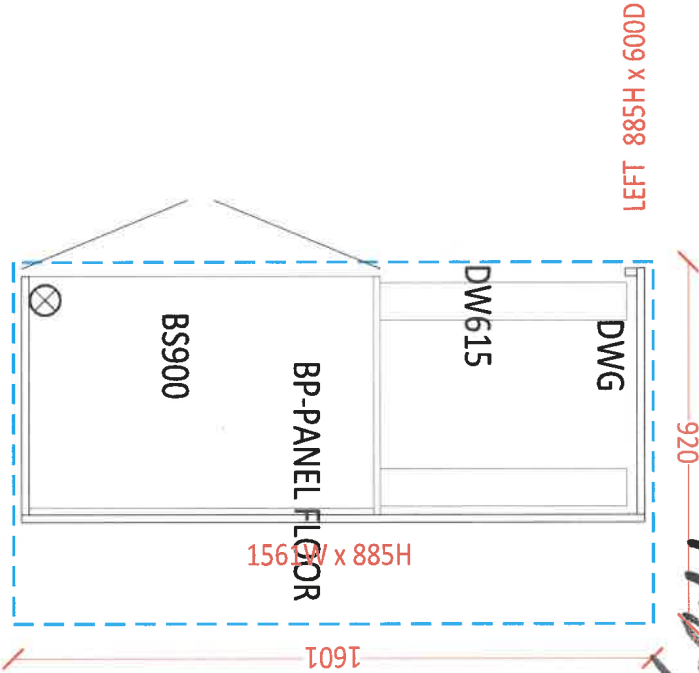
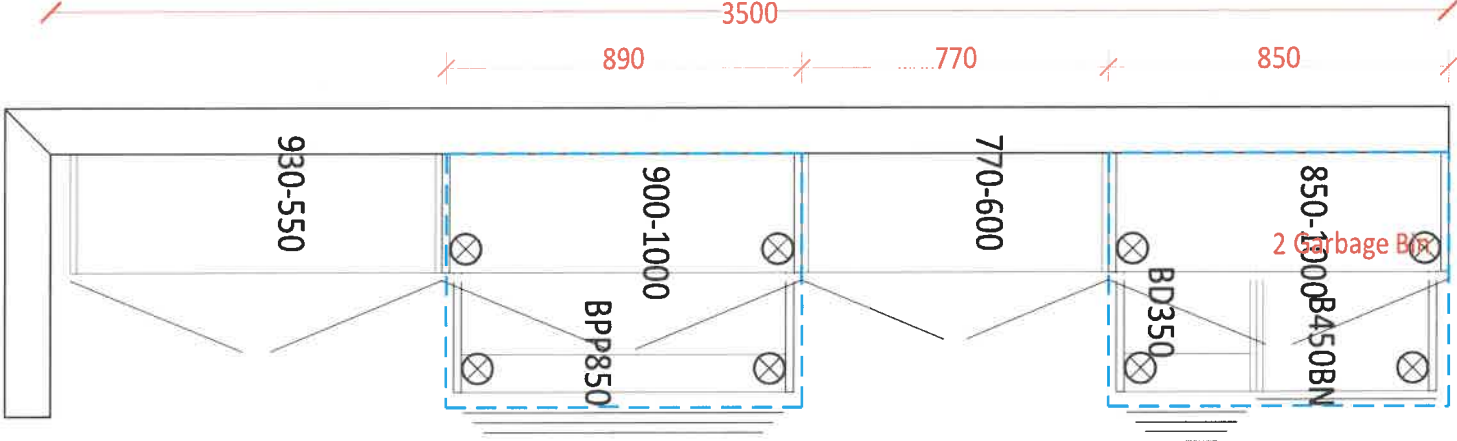

-Soft Close Doors and Drawers
-Cutlery divider

Lot 9-53
APR 27/21



DATE SUBMITTED
30 Mar 2021

CLIENT NAME: ZANCOR HOMES
SHIP TO : BROOKVALLEY TOWNS

DRAFTED BY: FERNANDA
COMMENT

PH:
CELL :

P/O #

JOB NUMBER

INSTALL DATE:

PAGE

12 of 19

RLT-01
STANDARD VANITIES ELEV A & B

Lot 9-53

APR

27/21

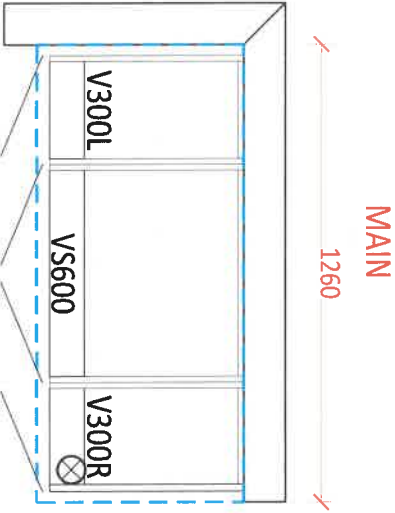

MASTER ENSUITE

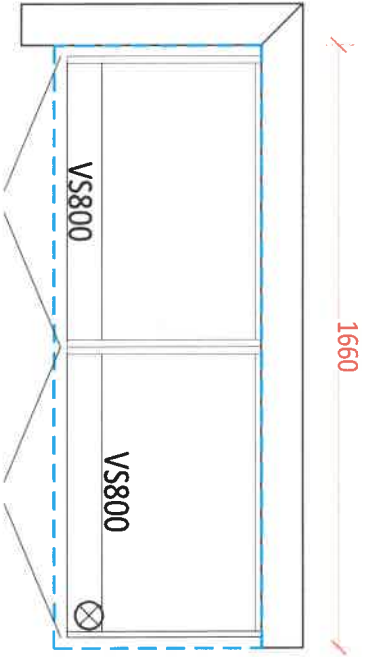

OPT. BASEMENT BATH

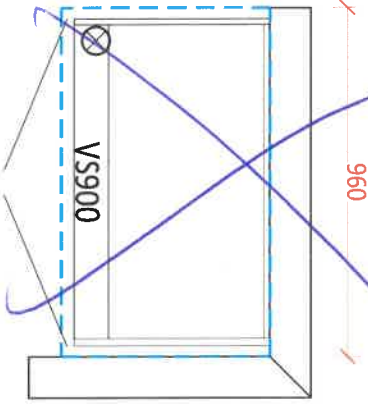

Handwritten signature or mark.

Stone Countertop Edge Profiles

Where applicable as per site specifications

LOT / SITE:

BROOKLIN TOWNS - 9-53

DATE:

April 27/21

STANDARD EDGE FOR KITCHEN & VANITIES

Standard Countertop Edge
in Kitchen

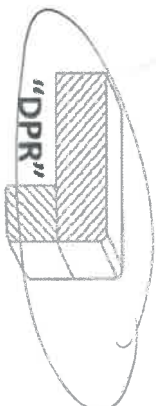

Standard Countertop Edge
in Vanity

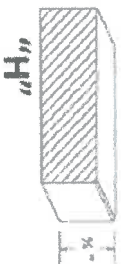

ND

Homeowner(s) Initial

OPTION (1) EDGE FOR KITCHEN & VANITIES \$250

Optional Edge in Kitchen

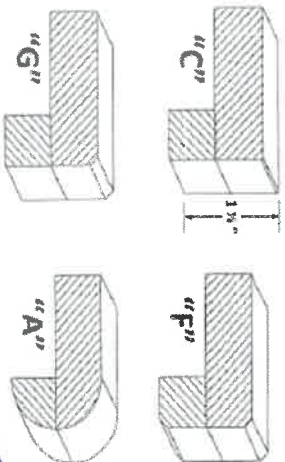

Optional Edge in Bathroom

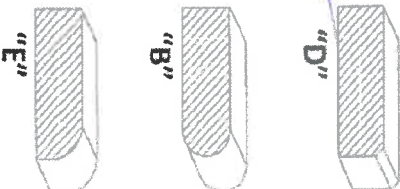

Homeowner(s) Initial

OPTION (2) EDGE FOR KITCHEN & VANITIES CUSTOM PRICING

Optional Edge for Kitchen

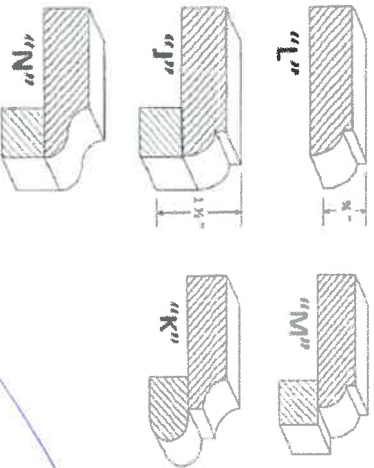

Optional Edge in Vanity

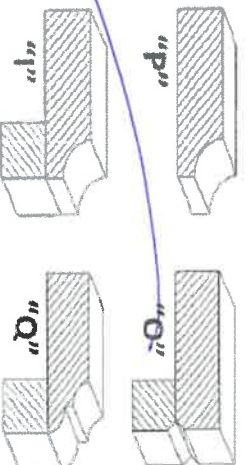

Homeowner(s) Initial

HOME AUTOMATION (Cable, CAT5, Telephone)

LOT / SITE: BROOKLIN TOWNS - 9-53

DATE: APR 27 / 21

STANDARD ITEMS AS PER SCHEDULE A:

STANDARD CABLE ROUGHIN in (1) Master Bedroom, (1) Family / Great Room
STANDARD TELEPHONE ROUGHIN in (1) Master Bedroom, (1) Family / Great Room
STANDARD CAT5 ROUGHIN - (3) In location of Purchasers choice.

OPTION 1:

I/we the Homeowner(s) have chosen to contact the Home Automation Company to select the locations of the rough-ins for Cable, CAT5, Telephone as included in our Agreement of Purchase Sale.

I/we the Homeowner(s) will contact the trade within 4 weeks of the date of this release to select locations of the standard rough-ins review other optional products for purchase.

Trade: **Artistic Smart Homes**
Phone: **(905) 850-9386**
Rep: **Jessica**
Location: **8601 Jane Street Unit #8 Vaughan ON L4K 5N9**

*Cable and
internet
Cable*

Should the homeowner not make these selections within the sufficient time provided, the rough-ins as mentioned above will be installed in locations as indicated above.

VD

Homeowner(s) Initial

OPTION 2:

I/we the Homeowner(s) have chosen to not contact the home automation company. I/we the Homeowner(s) have selected the locations for the standard rough-ins for Cable, CAT5, Telephone that are included in the Agreement of Purchase and Sale directly with a décor rep.

Homeowner(s) Initial

APPLIANCE ACKNOWLEDGEMENT

CONTACT: Steve Miller @ Appliance Canada (905) 660-2424 / 8701 Jane Street, Vaughan

► **Appliance Specs are DUE 2 WEEKS FROM SIGNED DATE OF COLOUR CHART (if not received during appointment)**

*****Specs that require changes/modifications after this date will not be accepted*****

► NOTE: Any upgraded appliances are to be paid by the Purchaser, directly to the appliances company.

► Additional charges to the Purchaser may apply for cabinetry, electrical and plumbing in order to accommodate the specs given by the homeowner.

► It is the Purchasers responsibility to coordinate delivery, installation and hook up of appliances and to ensure they are installed as per Manufacturers specifications after closing.

► Standard appliance openings are approximate and the minimum required. Sizes may vary due to on-site condition and/or when modifications have been made to the cabinetry.

STANDARD OPENINGS ACKNOWLEDGED BY PURCHASER:

- Standard Appliance Company*
- Fridge Opening 36" x 74" **Size is (+/-) & space above the fridge is required due to proper air flow
 - Stove Opening 30"
 - Hood Fan Opening 30"
 - Hood Fan Vent 6"
 - Dishwasher Opening 24"

INITIAL *VS*

UPGRADED APPLIANCES BELOW (Check applicable)

It is the Purchaser's responsibility to provide Zancor Homes with the correct specification for each appliance that has been upgraded. Zancor Homes will not be responsible for appliance requirements based on upgrades if specs have not been provided to the builder.

INITIAL *VS*

FRIDGE

- ☐ Built-In ☐ Flush Inset
- (Spec's Required) ☒ Paneled / Integrated ☐ Water Line

RANGE

- ☐ 36" ☐ 48" ☐ 60" ☐ 72" ☐ 84" ☐ 96" ☐ 108" ☐ 120"
- (Spec's Required) ☐ 48" ☐ 60" ☐ 72" ☐ 84" ☐ 96" ☐ 108" ☐ 120"
- *hood fan opening to be the same as the stove
- ☐ Gas ☐ Electric ☐ Induction
- **Larger CFM may be required with these appliances**
- **Countertop Cut-out charge required for cooktop

**Countertop Cut-out charge required for cooktop

HOOD FAN &

- ☐ Under Cabinet (Standard) ☐ 6 Inch (Standard)

VENT

- ☐ Chimney (centre vent) ☐ 8 Inch ☐ 10 Inch
- (Spec's Required) ☐ Insert / Liner

WALL OVEN &

- ☐ Single Oven ☐ Warming Drawer

MICRO

- ☐ Double Oven ☐ Over the Range Microwave
- (Spec's Required) ☐ Steam Oven ☐ Built-in Microwave (*trim kit required)

DATE *Apr. 27/21*

SITE **BROOKLIN TOWNS**

LOT *9-53*

** Any upgrades checked in this appliance form must be accompanied with specs provided by the Purchaser.

**It is the responsibility of the trade to inform the Builder of any discrepancies with specs, sketches, extras and/or colour chart PRIOR to production/installation.

221 North Rivermede Road, Concord, Ontario L4K 3N7 * T: (905) 738.7010 F: (905) 738.5948

INTERIOR FINISHES ACKNOWLEDGEMENT / WAIVER

Purchaser accepts and acknowledges that the Builder reserves the right to substitute materials with those of equal or better quality where the manufacture, scheduling or delivery of materials may directly impact the Builder's ability to meet its' contractual obligations under the Agreement of Purchase and Sale.

✓

UPGRADES/EXTRAS: All upgrades and additional selections indicated on the colour chart must be accompanied by an upgrades/extras sheet (PES) and full payment otherwise the selection will be invalid. All colour charts and upgrades/extras will not proceed until verified and signed by an authorized signing officer at the Vendor's head office. **CHANGES WILL NOT BE PERMITTED UPON COMPLETION AND SUBMISSION OF THE COLOUR CHART.**

✓

PORCELAIN & NATURAL STONES: Due to the properties of natural stones including but not limited to **marble, granite, quartz**, no two pieces are exactly the same. Variations in colour, tone, granularity (pitting, fissures) and pattern are to be expected, including various lighting may affect the overall finished look. Stone tops are sealed at time of installation and should never be cleaned with lemon oil or vinegar. Stones are porous materials, therefore any spilled substance require immediate attention. Stone countertops require regular seal re-application as part of home maintenance. Purchaser acknowledges colour and product variations as well as natural imperfections may exist with the selection of natural stone materials and shall not hold the Vendor liable for provision of same.

✓

STONE COUNTERTOP JOINTS: Purchaser is aware that one joint will be at each corner and on either side of slide-in-range (if applicable). It will also be where the length of the counter top exceeds the length of a stone slab. Slabs are usually approximately 5'x 8'.

✓

CERAMIC TILES: Due to manufacturing, shade (dye lots), product variations may exist that can affect the overall look of the finished product. Although every effort will be made to ensure the colours and materials selected are as close as possible to the samples, the purchaser acknowledges that the sample tiles supplied in the Design Centre may not be identical to the materials installed in the home.

✓

STAIR STAINS: Due to the natural properties of wood, many variables can affect the overall look of the finished product. Factors including but not limited to wood type, knotting, graining, density, age, humidity, and air temperature can result in substantial variations in stain intensity. The purchaser accepts that although the Vendor will do their best to match stain the unfinished stairs as close as possible to the pre-finished floors, it is not possible to have an identical match and that there MAY be shade differences between the two products.

✓

CABINETRY: Due to the natural properties of wood, slight variations apparent with cabinetry are to be expected. This includes but not limited to wood species, wood grain, colour, finish, product variations, and natural imperfections are all factors that may affect the overall look of the finished product. Such factors make exact colour matching impossible. The type and intensity of lighting in the areas of designated cabinetry placement may also highlight characteristics of cabinetry finish. All cabinets shall be finished with a white melamine interior box unless a finished interior is upgraded. Due to building specifications and/or on-site conditions, certain cabinetry upgrades may not be possible. The purchaser acknowledges that the Builder cannot guarantee the cabinetry finish or provision of certain upgrades and shall not hold the Builder liable for provision of same.

✓

UPGRADES/EXTRAS: All upgrades and additional selections indicated on the colour chart must be accompanied by an upgrades/extras sheet (PES) and full payment otherwise the selection will be invalid. All colour charts and upgrades/extras will not proceed until verified and signed by an authorized signing officer at the Vendor's head office. **CHANGES WILL NOT BE PERMITTED UPON COMPLETION AND SUBMISSION OF THE COLOUR CHART.**

✓

HARDWOOD / LAMINATE FLOORING: Due to the properties of wood and laminate, many variables can affect the overall look of the finished product. Variations include but not limited to wood type or laminate finish, colour/stain and wood grain are significant factors that make exact colour matching impossible. The purchaser acknowledges that the hardwood flooring is a pre-finished product in a controlled environment. Expansion, compression and cupping are characteristics of hardwood flooring once installed in the home. The purchaser acknowledges these may become apparent over time and despite the Builders' efforts to install the hardwood flooring materials in keeping with good workmanship, the Builder shall not be responsible nor held liable for minor variances of fluctuation in hardwood flooring materials.

✓

HARDWOOD / LAMINATE WAIVER:

I/We understand hardwood flooring is classified as a porous material and as such not recommended by the Builder in certain areas. I/We understand there is a concern due to possible water and other substances being frequently splashed or spilled onto the floor and in contravention of Ontario Building Code Section 9.30.1.2(1).

"Finished flooring bathrooms, kitchens, public entrance halls, laundry & general storage areas shall consist of resilient flooring, felted-synthetic-fibre floor coverings, concrete, terrazzo, ceramic tile, mastic or other types of flooring providing similar degrees of water resistance."

I/We are prepared to assume full responsibility for any damage caused to the hardwood floor or subfloor due to moisture absorbency in the mentioned areas, and agree to waive any claims against the Township of residence, TARIION and/or the Builder in relation to the matter. ****SEE COLOUR CHART FOR LOCATIONS****

✓

40/2272

BROOKLIN TOWNS

9-53

DATE

SITE

LOT