

CONSTRUCTION SUMMARY OF EXTRAS

Printed 2021-04-19 / 11:37 AM / Page 1 of 1

Site: BROOKLIN NOW TOWNS

Lot: 1-6- BROOKLIN

Model: AMAZE (RLT-01)

Purchaser: MUTHURAJALINGAM SUBRAMANIAM

Purchaser: Charanya Muthurajalingam

Phone: 416.200.0792

Email: MUTHU64@HOTMAIL.COM



DESCRIPTION		DATE SELECTED
BONUS PACKAGE: 3 PIECE STAINLESS STEEL APPLIANCES WITH WHITE FRONT LOAD WASHER & DRYER		INCLUDED IN APS
BONUS PACKAGE: STAINLESS STEEL HOOD FAN		INCLUDED IN APS
BONUS PACKAGE: AIR CONDITIONING UNIT		INCLUDED IN APS
#1	18" MOEN IN CHROME TOWEL BAR MODEL YB2418 -SF AND GF POWDER ROOM	16-Apr-21
#2	24" YB2424 IN CHROME TOWEL BAR - MASTER ENSUITE AND MAIN BATH	16-Apr-21
#3	MOEN TOILET PAPER HOLDER- YB2408- MASTE ENSUITE, MAIN BATH, SF AND GF POWDER	16-Apr-21
#4	WATER LINE TO FRIDGE	16-Apr-21
#5	TILE BACKSPLASH IN KITCHEN UP # 2	16-Apr-21
#6	GAS LINE TO STOVE	16-Apr-21
		**INCLUDES 15 AMP PLUG

ENTRANCES				
Main Foyer - FLOORING		GENESIS LIGHT GREY 12 X 24		
Mudroom - FLOORING		GENESIS LIGHT GREY 12 X 24	✓	
Side Hall - FLOORING		NORTHERN SOLID SAWN RED OAK 3 1/4" NATURAL STANDARD	✓	
Ground Floor Foyer - FLOORING		GENESIS LIGHT GREY 12 X 24	✓	
KITCHEN				
Kitchen - FLOORING		NORTHERN SOLID SAWN RED OAK 3 1/4" NATURAL STANDARD	✓	
Breakfast - FLOORING		NORTHERN SOLID SAWN RED OAK 3 1/4" NATURAL STANDARD	✓	
Kitchen - CABINETS		SIERRA PVC WHITE	✓	
Island - CABINETS		SIERRA PVC WHITE	✓	
Servery - CABINETS		NA		
Kitchen - HANDLES/KNOB		H-800-BC	✓	
Kitchen - COUNTERTOP		BIANCO SARDO GRANITE	✓	
Island - COUNTERTOP		BIANCO SARDO GRANITE	✓	
Kitchen Backsplash		ARCTIC WHITE BRIGHT 4 X 16 UP# 2 INSTAL STACKED		
Kitchen - SINK		STANDARD	✓	
Kitchen - FAUCET		STANDARD	✓	
GREAT ROOM / DINING / LIVING / DEN / OFFICE / BASEMENT				
Dining Room - FLOORING		NORTHERN SOLID SAWN RED OAK 3 1/4" NATURAL STANDARD	✓	
Living Room - FLOORING		NORTHERN SOLID SAWN RED OAK 3 1/4" NATURAL STANDARD	✓	
Family Room - FLOORING		NORTHERN SOLID SAWN RED OAK 3 1/4" NATURAL STANDARD	✓	
Library / Den - FLOORING		NA		
Basement Rec Room - FLOORING		NORTHERN SOLID SAWN RED OAK 3 1/4" NATURAL STANDARD	✓	
STAIRS				
Railing Details - PICKETS		1 3/4" TURNED OAK	✓	
Railing Details - POSTS		TURNED OAK	✓	
Railing Details - HANDRAIL		OVAL OAK	✓	
Stair Stain - MAIN STAIRS		STANDARD NATURAL	✓	
Stair Stain - BASEMENT STAIRS (if applicable)		NA		
Stair Stain - SERVICE STAIRS (if applicable)		NA		
POWDER ROOM				
GF- Powder Room - FLOORING		GENESIS LIGHT GREY 12 X 24	✓	
Powder Room - CABINETS		NA		
SF- Powder Room - FLOORING		LIVORNO 18 X 18	✓	
Powder Room - SINK		STANDARD	✓	
Powder Room - FAUCET		STANDARD	✓	
2ND FLOOR				
Upper Hall - FLOORING		NORTHERN SOLID SAWN RED OAK 3 1/4" NATURAL STANDARD	✓	
Master Bedroom - FLOORING		OPENING NIGHT T-03	✓	
Bedroom 2 - FLOORING		OPENING NIGHT T-03	✓	
Bedroom 3 - FLOORING		OPENING NIGHT T-03	✓	
Bedroom 4 - FLOORING		NA		
Bedroom 5 - FLOORING		NA		
Master Ensuite - FLOORING		LIVORNO 18 X 18	✓	
Master Ensuite - SHOWER WALL		LIVORNO 18 X 18	✓	
Master Ensuite - SHOWER FLOOR		2 X 2 WHITE	✓	
Master Ensuite - SHOWER JAMB		BIANCA CARRERA	✓	
Master Ensuite - CABINETS		SIERRA PVC WHITE	✓	
Master Ensuite - HANDLES/KNOB		H-800-BC	✓	
Master Ensuite - COUNTERTOP		WHITE CASCADE 5003-38	✓	
Master Ensuite - SINK(s)		STANDARD	Master Ensuite - FAUCET(s)	STANDARD
FOR TRADE USE				
Any upgrades in the colour chart must be accompanied with a PES. It is the responsibility of all Trades to inform the builder of any discrepancies on sketches, PES and/or colour charts PRIOR to installation.		LOT 1-6- BROOKLIN	C.M	
PAGE 1 OF 2		PURCHASER INITIALS	VENDOR APPROVAL	

2ND FLOOR CONTINUED...				
Main Bath - FLOORING		LIVORNO 18 X 18	✓	
Main Bath - TUB / SHOWER WALL		LIVORNO 18 X 18	✓	
Main Bath - SHOWER FLOOR		NA		
Main Bath - SHOWER JAMB		NA		
Main Bath - CABINETS		SIERRA PVC WHITE	✓	
Main Bath - HANDLES/KNOBS		H-800-BC	✓	
Main Bath - COUNTERTOP		WHITE CASCADE 5003-38	✓	
Main Bath - SINK(s)	STANDARD	✓	Main Bath - FAUCET(s)	STANDARD ✓
Shared Bath- FLOORING		NA		
Shared Bath- TUB / SHOWER WALL		NA		
Shared Bath- SHOWER FLOOR		NA		
Shared Bath- SHOWER JAMB		NA		
Shared Bath- CABINETS		NA		
Shared Bath- HANDLES/KNOBS		NA		
Shared Bath- COUNTERTOP		NA		
Shared Bath- SINK(s)	NA		Shared Bath - FAUCET(s)	N
Ensuite Bath - FLOORING		NA		
Ensuite Bath - TUB / SHOWER WALL		NA		
Ensuite Bath - SHOWER FLOOR		NA		
Ensuite Bath - SHOWER JAMB		NA		
Ensuite Bath - CABINETS		NA		
Ensuite Bath - HANDLES/KNOBS		NA		
Ensuite Bath - COUNTERTOP		NA		
Ensuite Bath - SINK(s)	NA		Ensuite Bath - FAUCET(s)	N
LAUNDRY				
Laundry - FLOORING	NA		Laundry - HANDLES/KNOBS	NA
Laundry - CABINETS	NA		Laundry - SINK	NA
Laundry - COUNTERTOP	NA		Laundry - FAUCET	NA
Laundry - BACKSPLASH	NA			
TRIM / PAINT				
Casing/Baseboards		STANDARD	✓	
Interior Doors		STANDARD	✓	
Interior Door Hardware		STANDARD	✓	
PAINT - Throughout		WARM GREY	✓	
FIREPLACE				
Location / Insert / Mantle		NA		
ACCESSORIES				
Mirrors	STANDARD	✓	BATH ACCESSORIES	UPGRADE
APPLIANCE REQUIREMENTS				
GAS LINE TO BBQ	STANDARD		ELECTRICAL for Built-in Oven	DECLINED
GAS LINE & ELECTRICAL TO STOVE	YES		ELECTRICAL for Built-in Micro	DECLINED
GAS LINE & ELECTRICAL TO DRYER	DECLINED		ELECTRICAL for Cooktop	DECLINED
HOOD FAN VENT SIZE	STANDARD		ELECTRICAL for Bar Fridge	DECLINED
WATERLINE to Fridge	YES			
DISCLAIMER				
Any changes to the colour chart after signing are subject to a \$5000 administration fee plus costs				C.M
Purchaser has checked and acknowledged accuracy of colour and selections before signing.				C.M
Colours of all materials are as close as possible to Builders selection but not necessarily identical due to dye lot variances in manufacturing/manufacturers. Due to construction progress some items may have been pre-selected or installed. In this event the Vendor's selection must be accepted by the purchaser				C-M
SITE / LOT: LOT 1-6 BROOKLIN				
PURCHASER(S): MUTHURAJALINGAM SUBRAMANIAM				
HOME #/CELL # 416.200.0792				
EMAIL: MUTHU64@HOTMAIL.COM				
FOR TRADE USE				
Any upgrades in the colour chart must be accompanied with a PES. It is the responsibility of all Trades to inform the builder of any discrepancies on sketches, PES and/or colour charts PRIOR to installation.				
PURCHASER SIGNATURE			SIGNATURES / DATE	
PURCHASER SIGNATURE			d11L	
DÉCOR CONSULTANT			April 19/21	
Vendor APPROVAL				

BROOKLIN NOW TOWNS
AMAZE RLT-1

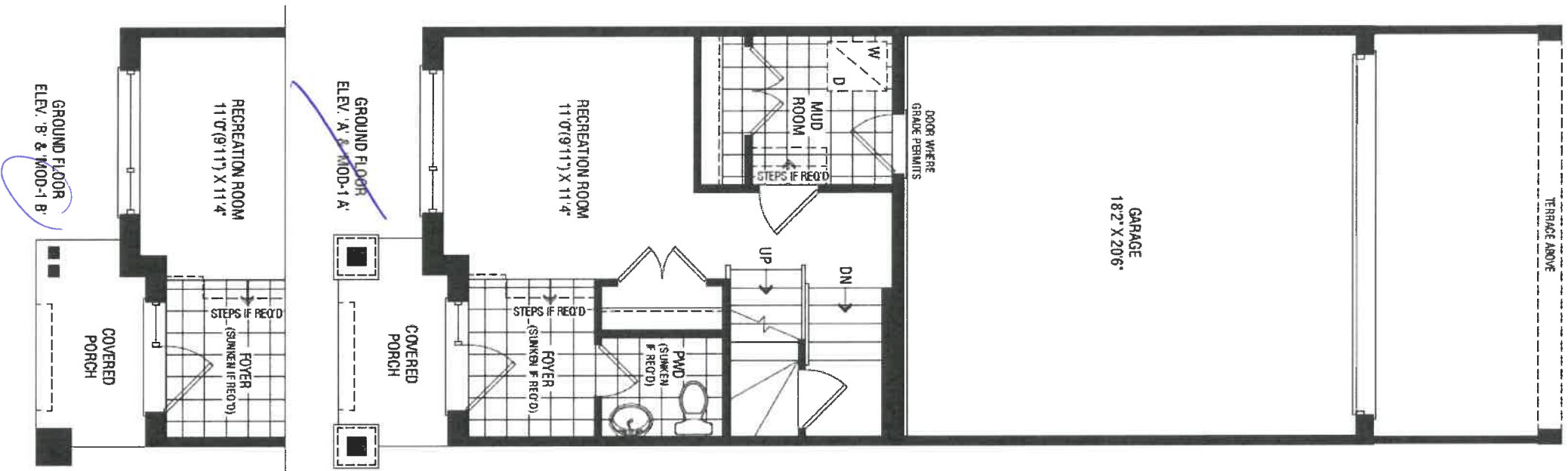

APR 12-16/21

LOT 1-6

C.M

BROOKLIN NOW TOWNS
AMAZE RLT-1

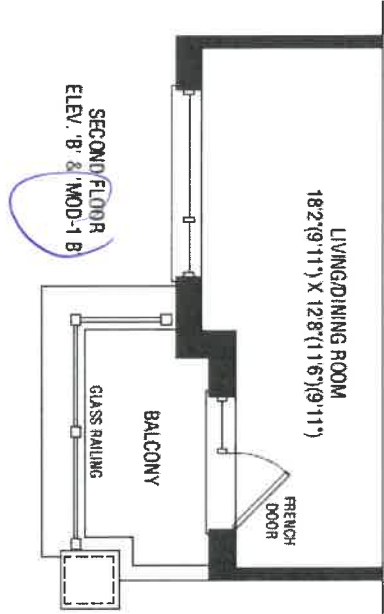
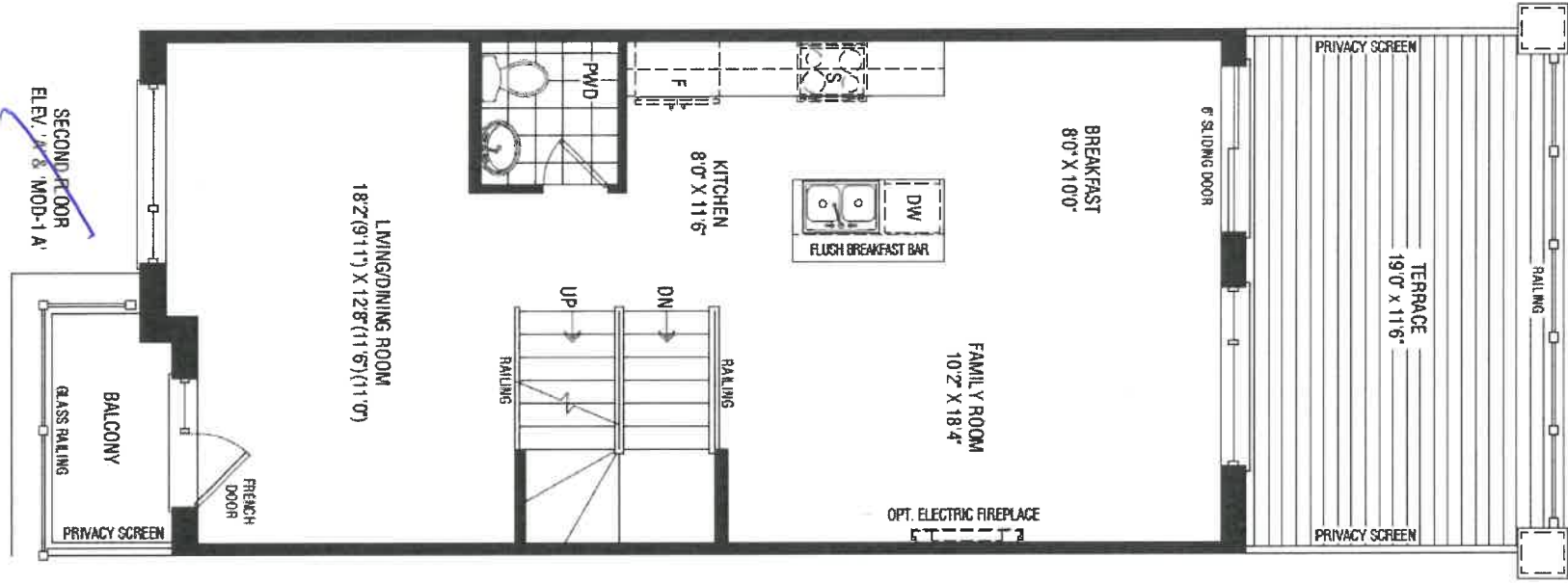

APR 14
16/21

1-6

C.N

BROOKLIN NOW TOWNS
AMAZE RLT-1

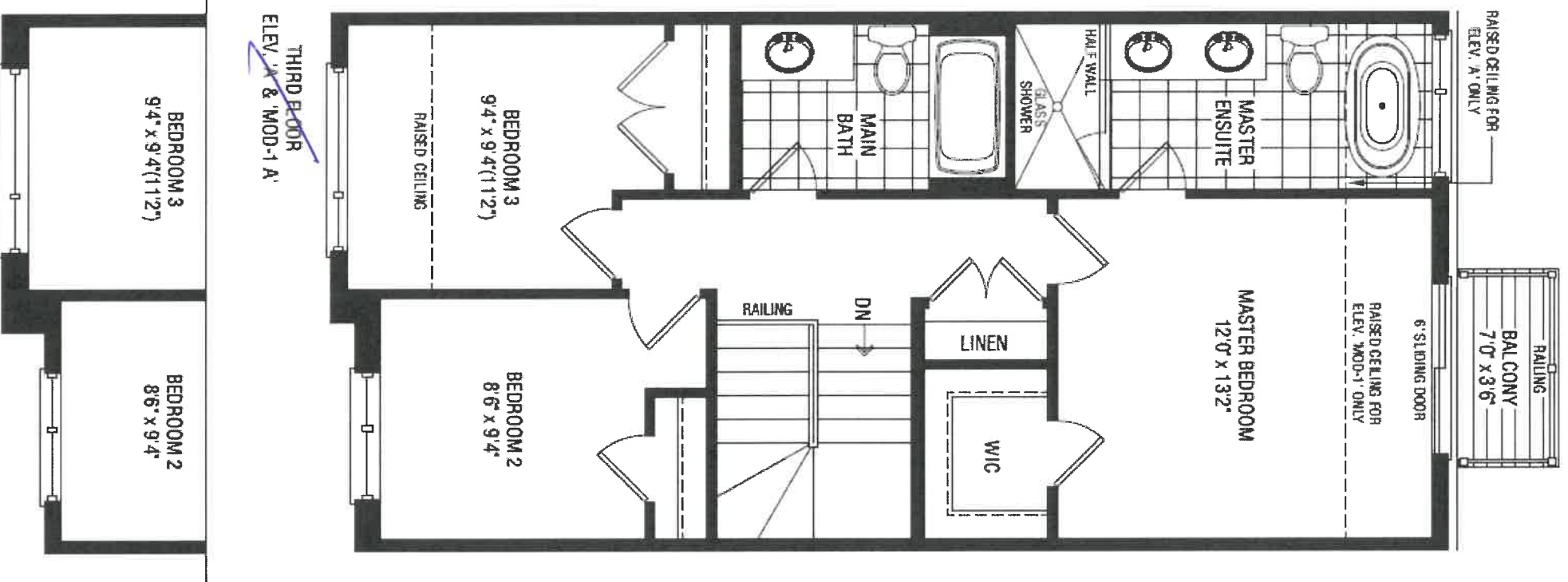

APRIL
16/21.

16/1-6

C.M

**BROOKLIN NOW TOWNS
AMAZE RLT-1**

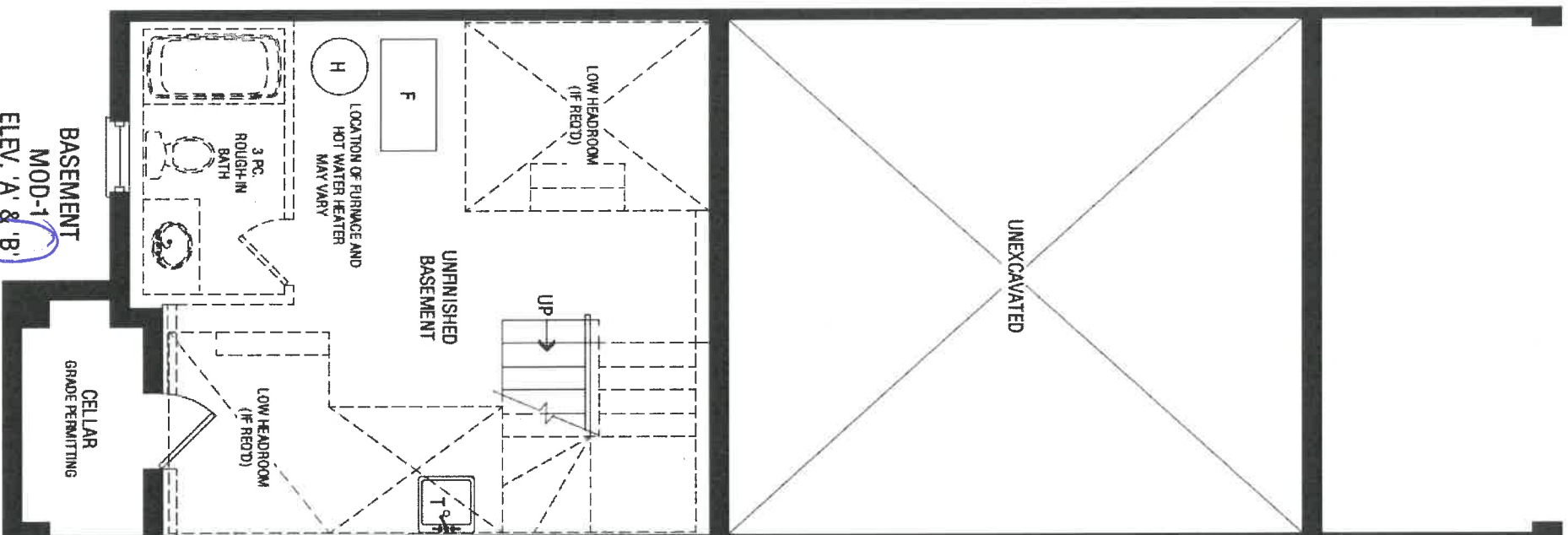

Lot 1-6

APR 12
16/21
C.M.



DATE SUBMITTED
30 Mar 2021

CLIENT NAME: ZANCOR HOMES
SHIP TO : BROOKVALEY TOWNS

DRAFTED BY: FERNANDA
COMMENT
PH:
CELL:

P/O #

JOB NUMBER

INSTALL DATE:

PAGE

11 of 19

RLT-01
KITCHEN 3D DRAWING

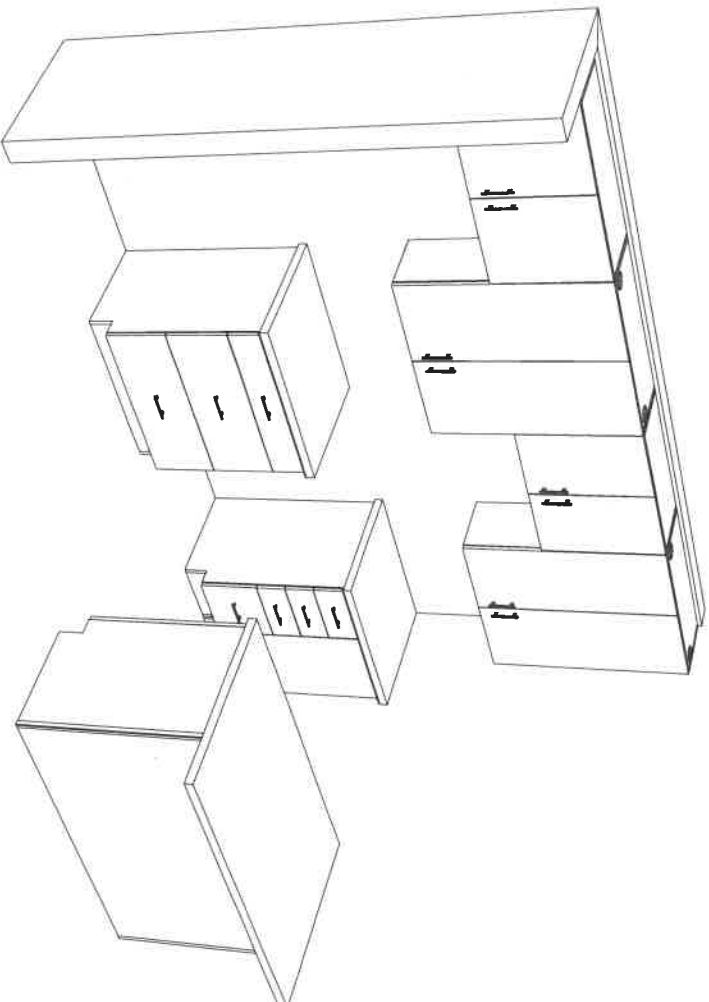

STANDARD

APRIL

16/21

lot 1-b

C.M



DATE SUBMITTED
30 Mar 2021

CLIENT NAME: ZANCOR HOMES
SHIP TO: BROOKVALEY TOWNS

DRAFTED BY: FERNANDA

PH:
CELL:

COMMENT

P/O #

JOB NUMBER

INSTALL DATE:

PAGE

12 of 19

RLT-01
STANDARD VANITIES ELEV A & B

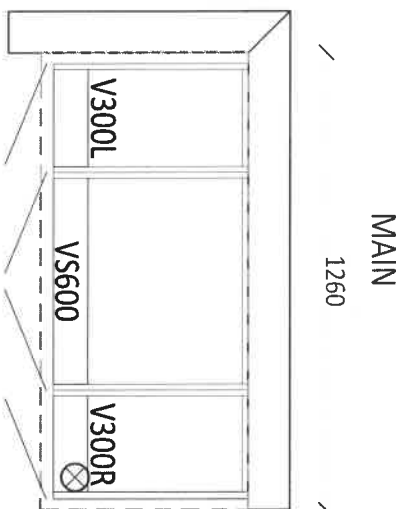

MASTER ENSUITE

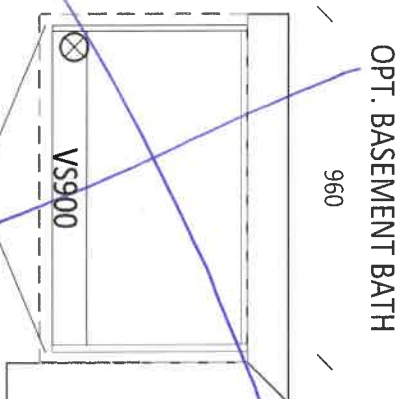
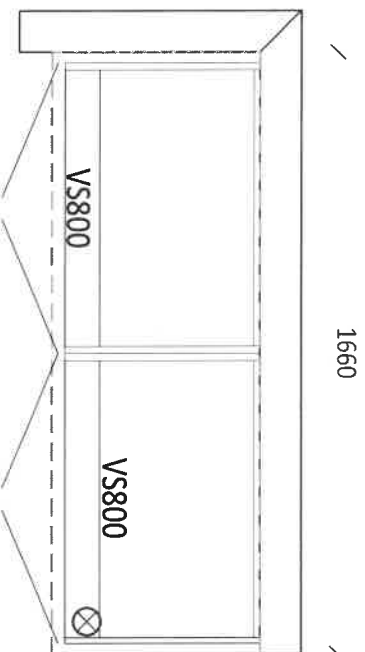

1-b

C.M

Lo6 1-b
APR 16/21
Standard APD



CLIENT NAME: ZANCOR HOMES
SHIP TO : BROOKVALLEY TOWNS

PH:
CELL:

RLT-01
KITCHEN ELEV. A & B

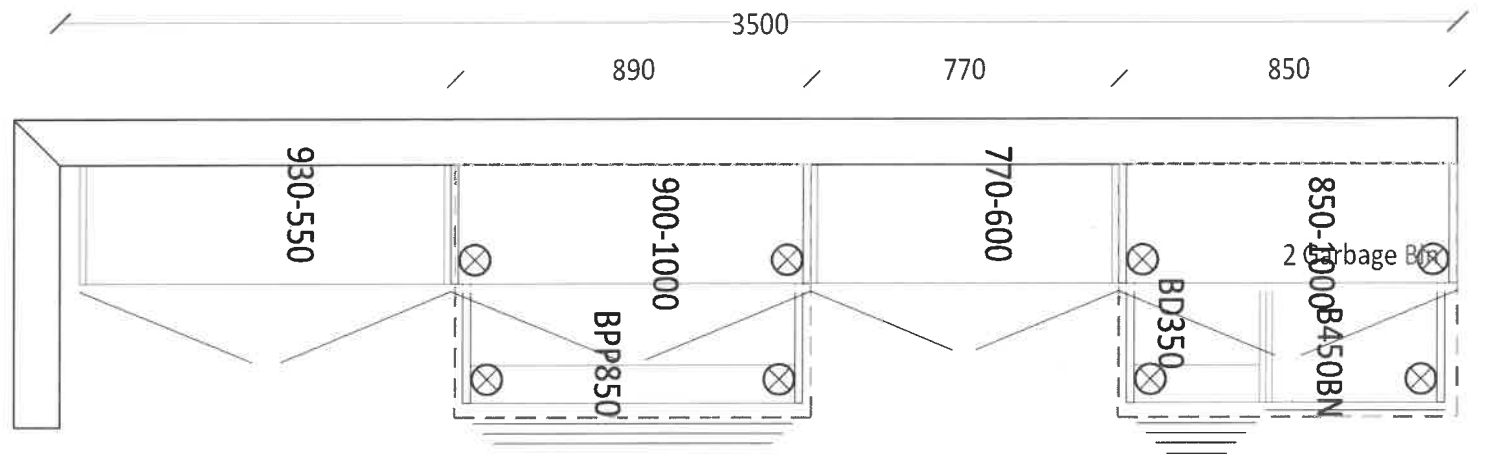

D009 x H588 L1371

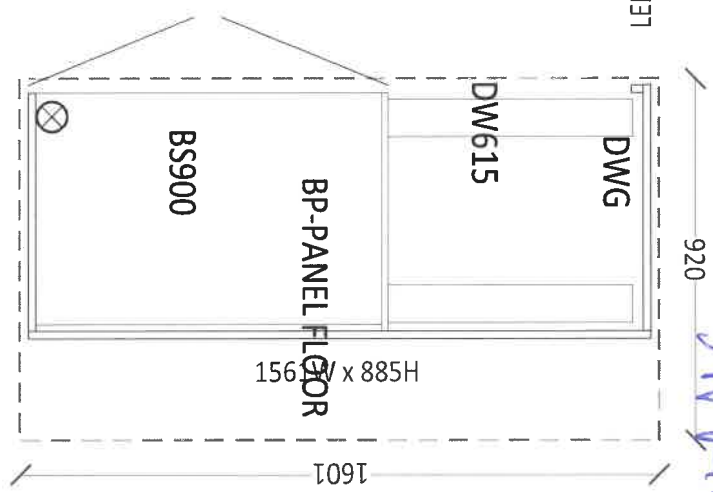

- Soft Close Doors and Drawers
- Cutlery divider

1-6

C.M

1061-6
APR 11/2021

Stone Countertop Edge Profiles

Where applicable as per site specifications

LOT / SITE:

BROOKLIN TOWNS -

1-6.

DATE:

APR 12 16/21

STANDARD EDGE FOR KITCHEN & VANITIES

Standard Countertop Edge
in Kitchen

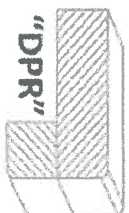

Standard Countertop Edge
in Vanity

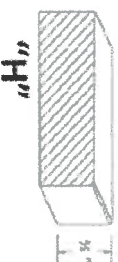

C.M

Homeowner(s) Initial

OPTION (1) EDGE FOR KITCHEN & VANITIES \$250

Optional Edge in Kitchen

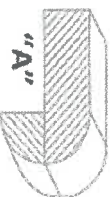
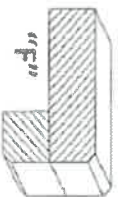
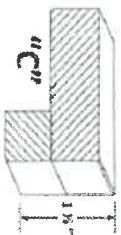

Optional Edge in Bathroom

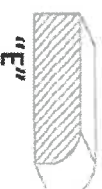
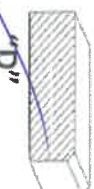

Homeowner(s) Initial

OPTION (2) EDGE FOR KITCHEN & VANITIES CUSTOM PRICING

Optional Edge for Kitchen

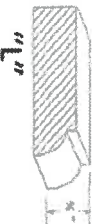

Optional Edge in Vanity

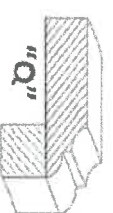
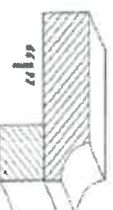
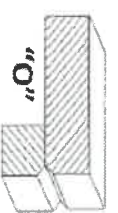

Homeowner(s) Initial

HOME AUTOMATION
(Cable, CAT5, Telephone)

LOT / SITE: BROOKLIN TOWNS -

DATE:

1-6.
APRIL 16/21

STANDARD ITEMS AS PER SCHEDULE A:

STANDARD CABLE ROUGHIN in (1) Master Bedroom, (1) Family / Great Room
STANDARD TELEPHONE ROUGHIN in (1) Master Bedroom, (1) Family / Great Room
STANDARD CAT5 ROUGHIN - (3) In location of Purchasers choice.

OPTION 1:

I/we the Homeowner(s) have chosen to contact the Home Automation Company to select the locations of the rough-ins for Cable, CAT5, Telephone as included in our Agreement of Purchase Sale.

I/we the Homeowner(s) will contact the trade within 4 weeks of the date of this release to select locations of the standard rough-ins review other optional products for purchase.

Trade: Artistic Smart Homes
Phone: (905) 850-9386
Rep: Jessica
Location: 8601 Jane Street Unit #8 Vaughan ON L4K 5N9

Should the homeowner not make these selections within the sufficient time provided, the rough-ins as mentioned above will be installed in locations as indicated above.

Homeowner(s) Initial

OPTION 2:

I/we the Homeowner(s) have chosen to not contact the home automation company. I/we the Homeowner(s) have selected the locations for the standard rough-ins for Cable, CAT5, Telephone that are included in the Agreement of Purchase and Sale directly with a décor rep.

Homeowner(s) Initial

INTERIOR FINISHES ACKNOWLEDGEMENT / WAIVER

Purchaser accepts and acknowledges that the Builder reserves the right to substitute materials with those of equal or better quality where the manufacture, scheduling or delivery of materials may directly impact the Builder's ability to meet its' contractual obligations under the Agreement of Purchase and Sale.

C.M

UPGRADES/EXTRAS: All upgrades and additional selections indicated on the colour chart must be accompanied by an upgrades/extras sheet (PES) and full payment otherwise the selection will be invalid. All colour charts and upgrades/extras will not proceed until verified and signed by an authorized signing officer at the Vendor's head office. **CHANGES WILL NOT BE PERMITTED UPON COMPLETION AND SUBMISSION OF THE COLOUR CHART.**

C.M

PORCELAIN & NATURAL STONES: Due to the properties of natural stones including but not limited to **marble, granite, quartz**, no two pieces are exactly the same. Variations in colour, tone, granularity (pitting, fissures) and pattern are to be expected, including various lighting may affect the overall finished look. Stone tops are sealed at time of installation and should never be cleaned with lemon oil or vinegar. Stones are porous materials, therefore any spilled substance require immediate attention. Stone countertops require regular seal re-application as part of home maintenance. Purchaser acknowledges colour and product variations as well as natural imperfections may exist with the selection of natural stone materials and shall not hold the Vendor liable for provision of same.

C.M

STONE COUNTERTOP JOINTS: Purchaser is aware that one joint will be at each corner and on either side of slide-in-range (if applicable). It will also be where the length of the counter top exceeds the length of a stone slab. Slabs are usually approximately 5'x 8'.

C.M

CERAMIC TILES: Due to manufacturing, shade (dye lots), product variations may exist that can affect the overall look of the finished product. Although every effort will be made to ensure the colours and materials selected are as close as possible to the samples, the purchaser acknowledges that the sample tiles supplied in the Design Centre may not be identical to the materials installed in the home.

C.M

STAIR STAINS: Due to the natural properties of wood, many variables can affect the overall look of the finished product. Factors including but not limited to wood type, knotting, graining, density, age, humidity, and air temperature can result in substantial variations in stain intensity. The purchaser accepts that although the Vendor will do their best to match stain the unfinished stairs as close as possible to the pre-finished floors, it is not possible to have an identical match and that there **MAY** be shade differences between the two products.

C.M

CABINETRY: Due to the natural properties of wood, slight variations apparent with cabinetry are to be expected. This includes but not limited to wood species, wood grain, colour, finish, product variations, and natural imperfections are all factors that may affect the overall look of the finished product. Such factors make exact colour matching impossible. The type and intensity of lighting in the areas of designated cabinetry placement may also highlight characteristics of cabinetry finish. All cabinets shall be finished with a white melamine interior box unless a finished interior is upgraded. Due to building specifications and/or on-site conditions, certain cabinetry upgrades may not be possible. The purchaser acknowledges that the Builder cannot guarantee the cabinetry finish or provision of certain upgrades and shall not hold the Builder liable for provision of same.

C.M

UPGRADES/EXTRAS: All upgrades and additional selections indicated on the colour chart must be accompanied by an upgrades/extras sheet (PES) and full payment otherwise the selection will be invalid. All colour charts and upgrades/extras will not proceed until verified and signed by an authorized signing officer at the Vendor's head office. **CHANGES WILL NOT BE PERMITTED UPON COMPLETION AND SUBMISSION OF THE COLOUR CHART.**

C.M

HARDWOOD / LAMINATE FLOORING: Due to the properties of wood and laminate, many variables can affect the overall look of the finished product. Variations include but not limited to wood type or laminate finish, colour/stain and wood grain are significant factors that make exact colour matching impossible. The purchaser acknowledges that the hardwood flooring is a pre-finished product in a controlled environment. Expansion, compression and cupping are characteristics of hardwood flooring once installed in the home. The purchaser acknowledges these may become apparent over time and despite the Builders' efforts to install the hardwood flooring materials in keeping with good workmanship, the Builder shall not be responsible nor held liable for minor variances of fluctuation in hardwood flooring materials.

C.M

HARDWOOD / LAMINATE WAIVER:

I/We understand hardwood flooring is classified as a porous material and as such not recommended by the Builder in certain areas. I/We understand there is a concern due to possible water and other substances being frequently splashed or spilled onto the floor and in contravention of Ontario Building Code Section 9.30.1.2(1).

"Finished flooring bathrooms, kitchens, public entrance halls, laundry & general storage areas shall consist of resilient flooring, felted-synthetic-fibre floor coverings, concrete, terrazzo, ceramic tile, mastic or other types of flooring providing similar degrees of water resistance.

I/We are prepared to assume full responsibility for any damage caused to the hardwood floor or subfloor due to moisture absorbency in the mentioned areas, and agree to waive any claims against the Township of residence, TARION and/or the Builder in relation to the matter. ****SEE COLOUR CHART FOR LOCATIONS****

C.M

DATE APR 16/21

SITE BROOKLIN TOWNS

LOT 1-6

APPLIANCE ACKNOWLEDGEMENT

CONTACT: Steve Miller @ Appliance Canada (905) 660-2424 / 8701 Jane Street, Vaughan

▶ Appliance Specs are DUE 2 WEEKS FROM SIGNED DATE OF COLOUR CHART (if not received during appointment)

Specs that require changes/modifications after this date will not be accepted

▶ NOTE: Any upgraded appliances are to be paid by the Purchaser, directly to the appliances company.

▶ Additional charges to the Purchaser may apply for cabinetry, electrical and plumbing in order to accommodate the specs given by the homeowner.

▶ It is the Purchaser's responsibility to coordinate delivery, installation and hook up of appliances and to ensure they are installed as per Manufacturers specifications after closing.

▶ Standard appliance openings are approximate and the minimum required. Sizes may vary due to onsite condition and/or when modifications have been made to the cabinetry.

STANDARD OPENINGS ACKNOWLEDGED BY PURCHASER:

Fridge Opening	▶ 36" x 74"	**Size is (+/-) & space above the fridge is required due to proper air flow
Stove Opening	▶ 30"	
Hood Fan Opening	▶ 30"	
Hood Fan Vent	▶ 6"	
Dishwasher Opening	▶ 24"	

UPGRADED APPLIANCES BELOW (Check applicable)

It is the Purchaser's responsibility to provide Zancor Homes with the correct specification for each appliance that has been upgraded. Zancor Homes will not be responsible for appliance requirements based on upgrades if specs have not been provided to the builder.

C.M
INITIAL

FRIDGE

<input type="checkbox"/> Built-In	<input type="checkbox"/> Flush Inset
(Spec's Required) <input type="checkbox"/> Paneled / Integrated	<input checked="" type="checkbox"/> Water Line

RANGE

<input type="checkbox"/> 36"	<input type="checkbox"/> Cooktop (Apron front)
(Spec's Required) <input type="checkbox"/> 48"	<input type="checkbox"/> Cooktop (Drop-in)

Larger CFM may be required with these appliances

☐ Induction

standard stove opening.

**Countertop Cut-out charge required for cooktop

HOOD FAN &

☒ Under Cabinet (Standard) ☒ 6 Inch (Standard)

VENT

<input type="checkbox"/> Chimney (centre vent)	<input type="checkbox"/> 8 Inch
(Spec's Required) <input type="checkbox"/> Insert / Liner	<input type="checkbox"/> 10 Inch

WALL OVEN &

☐ Single Oven ☐ Warming Drawer

MICRO

<input type="checkbox"/> Double Oven	<input type="checkbox"/> Over the Range Microwave
(Spec's Required) <input type="checkbox"/> Steam Oven	<input type="checkbox"/> Built-in Microwave (*trim kit required)

APR 16/21

BROOKLIN TOWNS

1-6.

DATE

SITE

LOT

** Any upgrades checked in this appliance form must be accompanied with specs provided by the Purchaser.

**It is the responsibility of the trade to inform the Builder of any discrepancies with specs, sketches, extras and/ or colour chart PRIOR to production/installation.