

CONSTRUCTION SUMMARY OF EXTRAS

Printed 2021-04-20 / 3:23 PM / Page 1 of 1

Site: BROOKLIN NOW TOWNS

Lot: 1-2

Model: AMAZE RLT-01 (B-MOD-1)

Purchaser: CARLA DALEY

Purchaser: 0

Phone: 647-303-7360





Email: STACEY0703@OUTLOOK.COM



DESCRIPTION		DATE SELECTED
	BONUS PACKAGE: 3 PIECE STAINLESS STEEL APPLIANCES WITH WHITE FRONT LOAD WASHER & DRYER	INCLUDED IN APS
	BONUS PACKAGE: STAINLESS STEEL HOOD FAN	INCLUDED IN APS
	BONUS PACKAGE: AIR CONDITIONING UNIT	INCLUDED IN APS
#1	NO STRUCTURAL CHANGES	FEB 8 2021
	COLOURS	
#1	HARDWOOD MAIN LEVEL AND UPPER HALL- ALL NON TILED AREAS- UP 1	08-Apr-21
#2	STAIN STAIRS TO MATCH HARDWOOD	08-Apr-21
#3	KITCHEN CABINETS- UP 2	08-Apr-21
#4	2 TONE COLOUR FOR KITCHEN CABINET	08-Apr-21
#5	COMFORT HEIGHT- MASTER ENSUITE	08-Apr-21

ZANCOR HOMES COLOUR CHART

PRINTED 2021-04-08, 11:53 AM

ENTRANCES				
Main Foyer - FLOORING		LIVORNO GRIS 18 X 18		
Mudroom - FLOORING		LIVORNO GRIS 18 X 18		
Side Hall - FLOORING		NA		
Basement Foyer - FLOORING		NA		
KITCHEN				
Kitchen - FLOORING		VINTAGE NORTHERN SOLID SAWN COLLECTION RED OAK 3 1/4" ECLIPSE		
Breakfast - FLOORING		VINTAGE NORTHERN SOLID SAWN COLLECTION RED OAK 3 1/4" ECLIPSE		
Kitchen UPPER- CABINETS		ALGONQUIN VANILLA MILKSHAKE UP 2		
Island - CABINETS		ALGONQUIN STONE GREY UP2		
Kitchen LOWER - CABINETS		ALGONQUIN STONE GREY UP2		
Kitchen - HANDLES/KNOB		H500P		
Kitchen - COUNTERTOP		BIANCO SARDO GRANITE		
Island - COUNTERTOP		BIANCO SARDO GRANITE		
Kitchen - BACKSPLASH		DECLINED		
Kitchen - SINK		STD		
Kitchen - FAUCET		STD		
DINING / LIVING / DEN / OFFICE / BASEMENT				
Dining Room - FLOORING		VINTAGE NORTHERN SOLID SAWN COLLECTION RED OAK 3 1/4" ECLIPSE		
Living Room/FAMILY - FLOORING		VINTAGE NORTHERN SOLID SAWN COLLECTION RED OAK 3 1/4" ECLIPSE		
Den - FLOORING		NA		
Library - FLOORING		NA		
Office - FLOORING		NA		
Basement Rec Room - FLOORING		VINTAGE NORTHERN SOLID SAWN COLLECTION RED OAK 3 1/4" ECLIPSE		
STAIRS				
Railing Details - PICKETS		METAL BLACK SINGLE COLLAR		
Railing Details - POSTS		TURNED OAK POST		
Railing Details - HANDRAIL		2-1/2" OVAL OAK HANDRAIL		
Stair Stain - MAIN STAIRS		TO MATCH HARDWOOD COLOUR AS CLOSE AS POSSIBLE		
Stair Stain - BASEMENT STAIRS (if applicable)		NA		
Stair Stain - SERVICE STAIRS (if applicable)		NA		
POWDER ROOM				
Powder Room - FLOORING	(BOTH)	LIVORNO GRIS 18 X 18		
Powder Room - CABINETS		NA		
Powder Room - COUNTERTOP		NA		
Powder Room - SINK		STD		
Powder Room - FAUCET		STD		
2ND FLOOR				
Upper Hall - FLOORING		VINTAGE NORTHERN SOLID SAWN COLLECTION RED OAK 3 1/4" ECLIPSE		
Master Bedroom - FLOORING		OPENING NIGHT- T03		
Bedroom 2 - FLOORING		OPENING NIGHT- T03		
Bedroom 3 - FLOORING		OPENING NIGHT- T03		
Bedroom 4 - FLOORING		NA		
Bedroom 5 - FLOORING		NA		
Master Ensuite - FLOORING		LIVORNO GRIS 18 X 18		
Master Ensuite - SHOWER WALL		LIVORNO GRIS 18 X 18		
Master Ensuite - SHOWER FLOOR		WHITE 2 X 2		
Master Ensuite - SHOWER JAMB		BIANCO CARRARA		
Master Ensuite - CABINETS		HIGH GLOSS EURO WHITE		
Master Ensuite - HANDLES/KNOB		K300P		
Master Ensuite - COUNTERTOP		1887K-22 ANTIQUE FINISH BENJAMIN GREY		
Master Ensuite - SINK(s)		STD	Master Ensuite - FAUCET(s)	STD
***FOR TRADE USE***				
Any upgrades in the colour chart must be accompanied with a PES. It is the responsibility of all Trades to inform the builder of any discrepancies on sketches, PES and/or colour charts PRIOR to installation.		1-2 BROOKLIN		
**PAGE 1 OF 2**		PURCHASER INITIALS	VENDOR APPROVAL	

2ND FLOOR CONTINUED...									
Main Bath - FLOORING		VERSAI GRIS 18 X 18							
Main Bath - TUB / SHOWER WALL		VERSAI GRIS 18 X 18							
Main Bath - SHOWER FLOOR		NA							
Main Bath - SHOWER JAMB		NA							
Main Bath - CABINETS		EURO LARICE BIANCO							
Main Bath - HANDLES/KNOBS		K300P							
Main Bath - COUNTERTOP		6697-58 ARGENTO ROMANO MATTE FINISH							
Main Bath - SINK(s)		STP		Main Bath - FAUCET(s)				STD	
Shared Bath - FLOORING		NA							
Shared Bath- TUB / SHOWER WALL		NA							
Shared Bath- SHOWER FLOOR		NA							
Shared Bath- SHOWER JAMB		NA							
Shared Bath- CABINETS		NA							
Shared Bath- HANDLES/KNOBS		NA							
Shared Bath- COUNTERTOP		NA							
Shared Bath- SINK(s)		NA		Shared Bath - FAUCET(s)				NA	
Ensuite Bath - FLOORING		NA							
Ensuite Bath - TUB / SHOWER WALL		NA							
Ensuite Bath - SHOWER FLOOR		NA							
Ensuite Bath - SHOWER JAMB		NA							
Ensuite Bath - CABINETS		NA							
Ensuite Bath - HANDLES/KNOBS		NA							
Ensuite Bath - COUNTERTOP		NA							
Ensuite Bath - SINK(s)		NA		Ensuite Bath - FAUCET(s)				NA	
LAUNDRY									
Laundry - FLOORING		NA		Laundry - HANDLES/KNOBS				NA	
Laundry - CABINETS		NA		Laundry - SINK				NA	
Laundry - COUNTERTOP		NA		Laundry - FAUCET				NA	
Laundry - BACKSPLASH		NA							
TRIM / PAINT									
Casing/Baseboards		STD							
Interior Doors		STD							
Interior Door Hardware		STD							
PAINT - Throughout		WARM GREY							
FIREPLACE									
Location / Insert / Mantle		NA							
ACCESSORIES									
Mirrors		YES		BATH ACCESSORIES				YES	
APPLIANCE REQUIREMENTS									
GAS LINE TO BBQ		STANDARD		ELECTRICAL for Built-in Oven				DECLINED	
GAS LINE & ELECTRICAL TO STOVE		DECLINED		ELECTRICAL for Built-in Micro				DECLINED	
GAS LINE & ELECTRICAL TO DRYER		DECLINED		ELECTRICAL for Cooktop				DECLINED	
HOOD FAN VENT SIZE		611		DECLINED- STP				DECLINED	
WATERLINE to Fridge		DECLINED							
DISCLAIMER									
Any changes to the colour chart after signing are subject to a \$5000 administration fee plus costs		CP							
Purchaser has checked and acknowledged accuracy of colour and selections before signing.		CP							
Colours of all materials are as close as possible to Builders selection but not necessarily identical due to dye lot variances in manufacturing/manufacturers. Due to construction progress some items may have been pre-selected or installed. In this event the Vendor's selection must be accepted by the purchaser									
SITE / LOT:		1-2- BROOKLIN							
PURCHASER(S):		CARLA DALEY							
HOME #/CELL #		647.303.7360							
EMAIL:		STACEY0703@OUTLOOK.COM							
***FOR TRADE USE***									
Any upgrades in the colour chart must be accompanied with a PES. It is the responsibility of all Trades to inform the builder of any discrepancies on sketches, PES and/or colour charts PRIOR to installation.		PURCHASER SIGNATURE		COOPER				SIGNATURES / DATE	
		PURCHASER SIGNATURE		Jillman					
		DÉCOR CONSULTANT							
		Vendor APPROVAL		A. 14/21					



APPLIANCE ACKNOWLEDGEMENT

CONTACT: Steve Miller @ Appliance Canada (905) 660-2424 / 8701 Jane Street, Vaughan

- ▶ **Appliance Specs are DUE 2 WEEKS FROM SIGNED DATE OF COLOUR CHART (if not received during appointment)**  
**\*\*\*Specs that require changes/modifications after this date will not be accepted\*\*\***
- ▶ NOTE: Any upgraded appliances are to be paid by the Purchaser, directly to the appliances company.
- ▶ Additional charges to the Purchaser may apply for cabinetry, electrical and plumbing in order to accommodate the specs given by the homeowner.
- ▶ It is the Purchasers responsibility to coordinate delivery, installation and hook up of appliances and to ensure they are installed as per Manufacturers specifications after closing.
- ▶ Standard appliance openings are approximate and the minimum required. Sizes may vary due to onsite condition and/or when modifications have been made to the cabinetry.

STANDARD OPENINGS ACKNOWLEDGED BY PURCHASER:

- ▶ Fridge Opening ▶ 36" x 74" \*\*Size is (+/-) & space above the fridge is required due to proper air flow
- ▶ Stove Opening ▶ 30"
- ▶ Hood Fan Opening ▶ 30"
- ▶ Hood Fan Vent ▶ 6"
- ▶ Dishwasher Opening ▶ 24"

INITIAL

CD

UPGRADED APPLIANCES BELOW (Check applicable)

**It is the Purchaser's responsibility to provide Zancor Homes with the correct specification for each appliance that has been upgraded. Zancor Homes will not be responsible for appliance requirements based on upgrades if specs have not been provided to the builder.**

INITIAL

CD

FRIDGE

- ☐ Built-In ☐ Flush Inset
- (Spec's Required) ☐ Paneled / Integrated ☐ Water Line

RANGE

- ☐ 36" ☐ Cooktop (Apron front)
- (Spec's Required) ☐ 48" \*hood fan opening to be the same as the stove ☐ Cooktop (Drop-in)

\*\*Larger CFM may be required with these appliances\*\*

- ☐ Gas
- ☐ Induction

\*\*Countertop Cut-out charge required for cooktop

HOOD FAN &

- ☒ Under Cabinet (Standard) ☒ 6 Inch (Standard)

VENT

- ☐ Chimney (centre vent) ☐ 8 Inch
- (Spec's Required) ☐ Insert / Liner ☐ 10 Inch

WALL OVEN &

- ☐ Single Oven ☐ Warming Drawer

MICRO

- ☐ Double Oven ☐ Over the Range Microwave
- (Spec's Required) ☐ Steam Oven ☐ Built-in Microwave (\*trim kit required)

DATE

Apr. 8, 2021

SITE

BROOKLIN TOWNS

LOT

1-2

\*\* Any upgrades checked in this appliance form must be accompanied with specs provided by the Purchaser.

\*\*It is the responsibility of the trade to inform the Builder of any discrepancies with specs, sketches, extras and/ or colour chart PRIOR to production/installation.

221 North Rivermede Road, Concord, Ontario L4K 3N7 \* T: (905) 738.7010 F: (905) 738.5948

## INTERIOR FINISHES ACKNOWLEDGEMENT / WAIVER

Purchaser accepts and acknowledges that the Builder reserves the right to substitute materials with those of equal or better quality where the manufacture, scheduling or delivery of materials may directly impact the Builder's ability to meet its' contractual obligations under the Agreement of Purchase and Sale.

**UPGRADES/EXTRAS:** All upgrades and additional selections indicated on the colour chart must be accompanied by an upgrades/extras sheet (PES) and full payment otherwise the selection will be invalid. All colour charts and upgrades/extras will not proceed until verified and signed by an authorized signing officer at the Vendor's head office. **CHANGES WILL NOT BE PERMITTED UPON COMPLETION AND SUBMISSION OF THE COLOUR CHART.**

**PORCELAIN & NATURAL STONES:** Due to the properties of natural stones including but not limited to **marble, granite, quartz**, no two pieces are exactly the same. Variations in colour, tone, granularity (pitting, fissures) and pattern are to be expected, including various lighting may affect the overall finished look. Stone tops are sealed at time of installation and should never be cleaned with lemon oil or vinegar. Stones are porous materials, therefore any spilled substance require immediate attention. Stone countertops require regular seal re-application as part of home maintenance. Purchaser acknowledges colour and product variations as well as natural imperfections may exist with the selection of natural stone materials and shall not hold the Vendor liable for provision of same.

**STONE COUNTERTOP JOINTS:** Purchaser is aware that one joint will be at each corner and on either side of slide-in-range (if applicable). It will also be where the length of the counter top exceeds the length of a stone slab. Slabs are usually approximately 5'x 8'.

**CERAMIC TILES:** Due to manufacturing, shade (dye lots), product variations may exist that can affect the overall look of the finished product. Although every effort will be made to ensure the colours and materials selected are as close as possible to the samples, the purchaser acknowledges that the sample tiles supplied in the Design Centre may not be identical to the materials installed in the home.

**STAIR STAINS:** Due to the natural properties of wood, many variables can affect the overall look of the finished product. Factors including but not limited to wood type, knotting, graining, density, age, humidity, and air temperature can result in substantial variations in stain intensity. The purchaser accepts that although the Vendor will do their best to match stain the unfinished stairs as close as possible to the pre-finished floors, it is not possible to have an identical match and that there MAY be shade differences between the two products.

**CABINETRY:** Due to the natural properties of wood, slight variations apparent with cabinetry are to be expected. This includes but not limited to wood species, wood grain, colour, finish, product variations, and natural imperfections are all factors that may affect the overall look of the finished product. Such factors make exact colour matching impossible. The type and intensity of lighting in the areas of designated cabinetry placement may also highlight characteristics of cabinetry finish. All cabinets shall be finished with a white melamine interior box unless a finished interior is upgraded. Due to building specifications and/or on-site conditions, certain cabinetry upgrades may not be possible. The purchaser acknowledges that the Builder cannot guarantee the cabinetry finish or provision of certain upgrades and shall not hold the Builder liable for provision of same.

**UPGRADES/EXTRAS:** All upgrades and additional selections indicated on the colour chart must be accompanied by an upgrades/extras sheet (PES) and full payment otherwise the selection will be invalid. All colour charts and upgrades/extras will not proceed until verified and signed by an authorized signing officer at the Vendor's head office. **CHANGES WILL NOT BE PERMITTED UPON COMPLETION AND SUBMISSION OF THE COLOUR CHART.**

**HARDWOOD / LAMINATE FLOORING:** Due to the properties of wood and laminate, many variables can affect the overall look of the finished product. Variations include but not limited to wood type or laminate finish, colour/stain and wood grain are significant factors that make exact colour matching impossible. The purchaser acknowledges that the hardwood flooring is a pre-finished product in a controlled environment. Expansion, compression and cupping are characteristics of hardwood flooring once installed in the home. The purchaser acknowledges these may become apparent over time and despite the Builders' efforts to install the hardwood flooring materials in keeping with good workmanship, the Builder shall not be responsible nor held liable for minor variances of fluctuation in hardwood flooring materials.

### HARDWOOD / LAMINATE WAIVER:

I/We understand hardwood flooring is classified as a porous material and as such not recommended by the Builder in certain areas. I/We understand there is a concern due to possible water and other substances being frequently splashed or spilled onto the floor and in contravention of Ontario Building Code Section 9.30.1.2(1).

*"Finished flooring bathrooms, kitchens, public entrance halls, laundry & general storage areas shall consist of resilient flooring, felted-synthetic-fibre floor coverings, concrete, terrazzo, ceramic tile, mastic or other types of flooring providing similar degrees of water resistance.*

I/We are prepared to assume full responsibility for any damage caused to the hardwood floor or subfloor due to moisture absorbency in the mentioned areas, and agree to waive any claims against the Township of residence, TARIION and/or the Builder in relation to the matter. **\*\*SEE COLOUR CHART FOR LOCATIONS\*\***

DATE April 8, 2021

SITE BROOKLIN TOWNS

LOT 1-2

## HOME AUTOMATION (Cable, CAT5, Telephone)

LOT / SITE: BROOKLIN TOWNS - 1-2  
DATE: April 8, 2021

### STANDARD ITEMS AS PER SCHEDULE A:

STANDARD CABLE ROUGHIN in (1) Master Bedroom, (1) Family / Great Room  
STANDARD TELEPHONE ROUGHIN in (1) Master Bedroom, (1) Family / Great Room  
STANDARD CAT5 ROUGHIN - (3) In location of Purchasers choice.

### OPTION 1:

I/we the Homeowner(s) have chosen to contact the Home Automation Company to select the locations of the rough-ins for Cable, CAT5, Telephone as included in our Agreement of Purchase Sale.

I/we the Homeowner(s) will contact the trade within 4 weeks of the date of this release to select locations of the standard rough-ins review other optional products for purchase.

Trade: **Artistic Smart Homes**  
Phone: **(905) 850-9386**  
Rep: **Jessica**  
Location: **8601 Jane Street Unit #8 Vaughan ON L4K 5N9**

Should the homeowner not make these selections within the sufficient time provided, the rough-ins as mentioned above will be installed in locations as indicated above.

### OPTION 2:

CO  
Homeowner(s) Initial

I/we the Homeowner(s) have chosen to not contact the home automation company. I/we the Homeowner(s) have selected the locations for the standard rough-ins for Cable, CAT5, Telephone that are included in the Agreement of Purchase and Sale directly with a décor rep.

\_\_\_\_\_  
Homeowner(s) Initial



Stone Countertop Edge Profiles

\*\*Where applicable as per site specifications\*\*

LOT / SITE:

BROOKLIN TOWNS -

1-2

DATE:

April 8, 2021

STANDARD EDGE FOR KITCHEN & VANITIES

Standard Countertop Edge  
in Kitchen

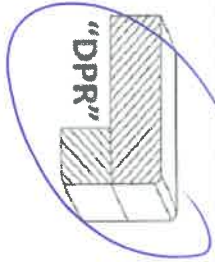

Standard Countertop Edge  
in Vanity

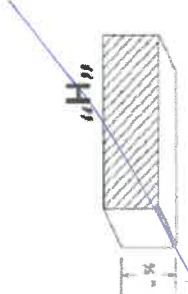

Homeowner(s) Initial

CD

OPTION (1) EDGE FOR KITCHEN & VANITIES \$250

Optional Edge in Kitchen

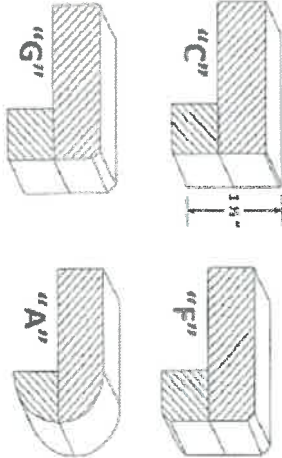

Optional Edge in Bathroom

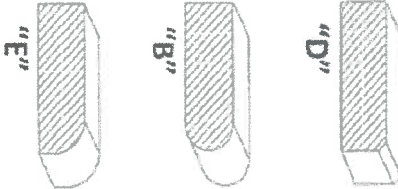

Homeowner(s) Initial

OPTION (2) EDGE FOR KITCHEN & VANITIES CUSTOM PRICING

Optional Edge for Kitchen

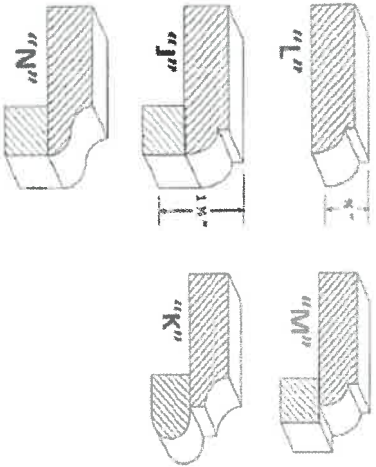

Optional Edge in Vanity

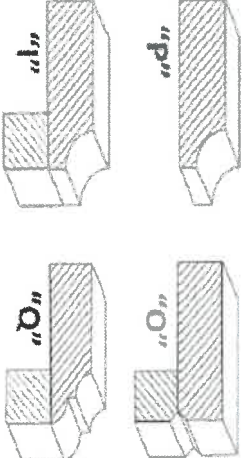

Homeowner(s) Initial

**BROOKLIN NOW TOWNS**  
**AMAZE RLT-1**

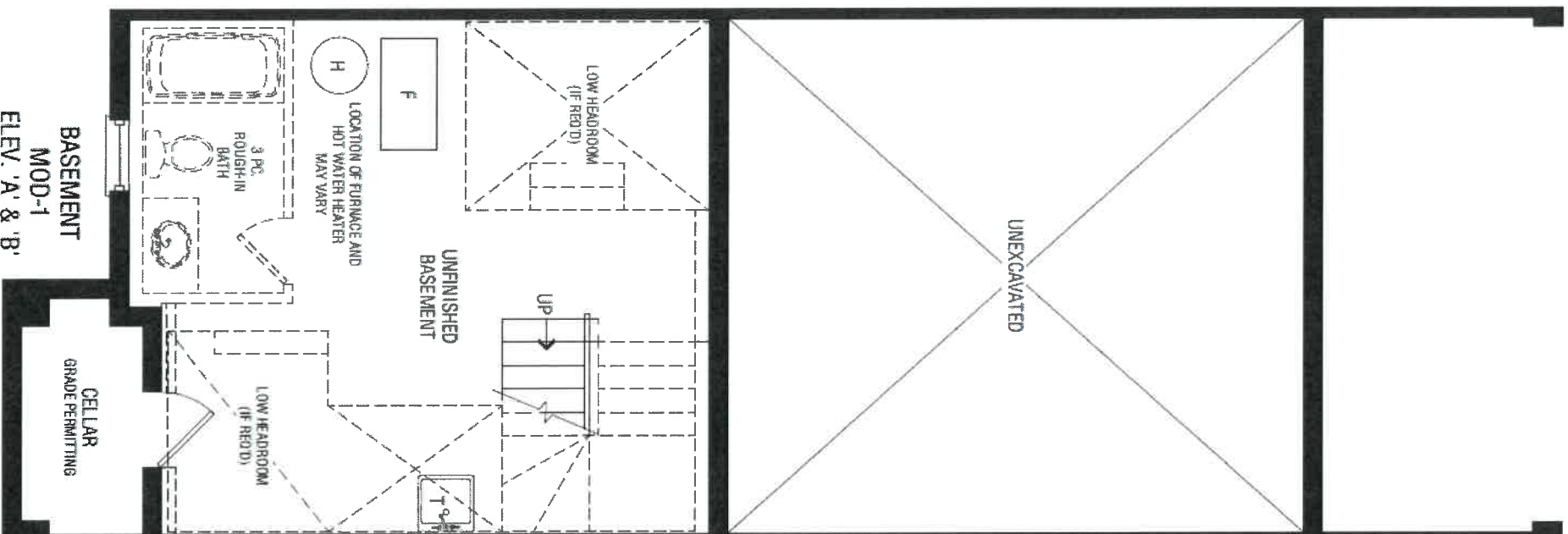



**BROOKLIN NOW TOWNS**  
**AMAZE RLT-1**

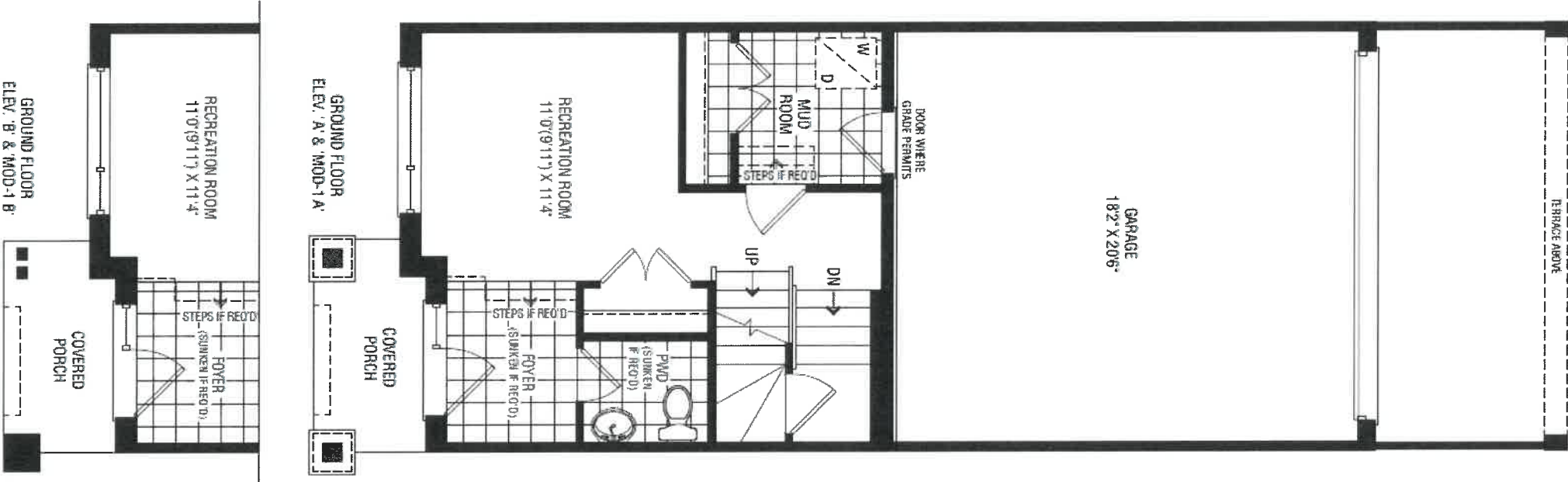

# BROOKLIN NOW TOWNS

## AMAZE RLT-1

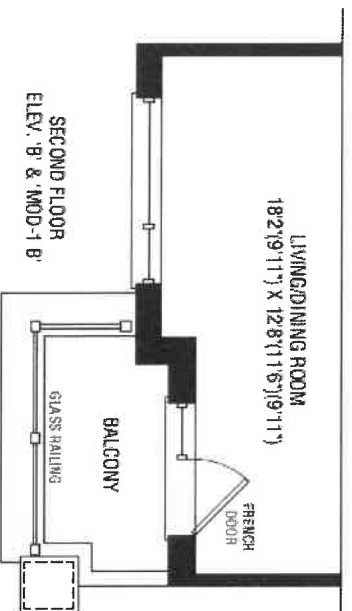
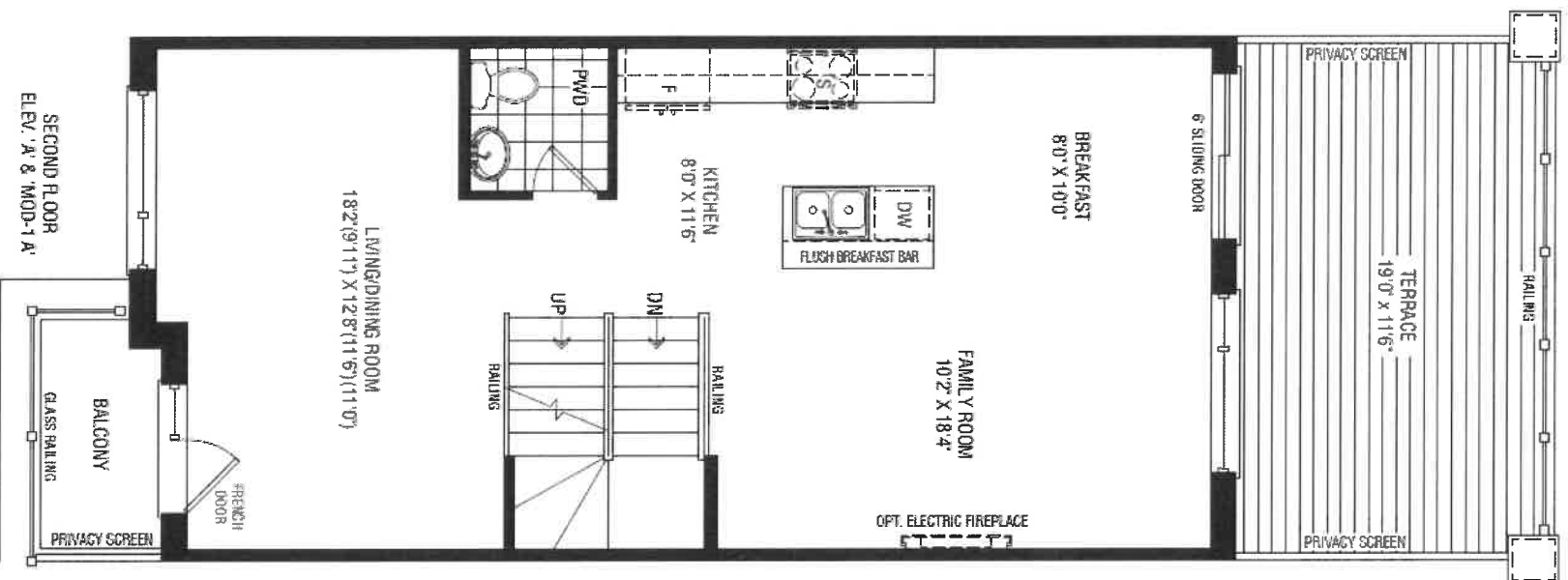

**BROOKLIN NOW TOWNS**  
**AMAZE RLT-1**

