

CONSTRUCTION SUMMARY OF EXTRAS  
Printed 2020-12-14 / 3:19 PM / Page 1 of 1

Site: WASAGA  
Lot: 141-2  
Model: AQUA TH-03 (B)  
Purchaser: BERNARD PAUL & VERONICA R HEBERT  
Phone/Email: 226-348-0738



DESCRIPTION		DATE SELECTED
BONUS PACKAGE: 3 PIECE STAINLESS STEEL APPLANCES WITH WHITE WASHER & DRYER	INCLUDED IN APS	
BONUS PACKAGE: STAINLESS STEEL HOOD FAN	INCLUDED IN APS	
#1 COMPLETE AIR CONDITIONING UNIT	OCTOBER 1 2020	
#2 GAS LINE TO STOVE **INCLUDES 15 AMP	OCTOBER 1 2020	
#3 CHIMNEY HOOD FAN ABOVE STOVE **CENTRE VENT	OCTOBER 1 2020	
#4 FIREPLACE - ELECTRIC FIREPLACE 34 INCH - DIMPLEX BLF3451 PRISM **APPROX 20 INCHES FROM THE BOTTOM OFF THE FLOOR, WALL TO BE 60 INCHES WIDE, FLOOR TO CEILING	OCTOBER 1 2020	
#5 ELECTRICAL - ADD PLUG ABOVE FIREPLACE **LOCATE STANDASRD CABLE ROUGH-IN APPROX 65 INCHES AFF	OCTOBER 1 2020	
#6 ELECTRICAL - ADD PLUG IN GREAT ROOM - SEE SKETCH	OCTOBER 1 2020	
#7 ELECTRICAL - ADD PLUG IN ISLAND **CLOSEST TO <del>SINK</del> <b>STOVE *SEE KITCHEN LAYOUT</b>	OCTOBER 1 2020	
#8 ELECTRICAL - PLUG FOR MICROWAVE <b>(BUILT-IN MICRO IN PANTRY - SEE #22)</b>	OCTOBER 1 2020	
#9 WATERLINE TO FRIDGE	OCTOBER 1 2020	
#10 ELECTRICAL - ADD ONE CAPPED LIGHT BOX ABOVE ISLAND **RELOCATE THE STANDARD TO BE ABOVE	OCTOBER 1 2020	
#11 ELECTRICAL - ADD 4 POTLIGHTS IN KITCHEN ON SEP SWITCH	OCTOBER 1 2020	
#12 ELECTRICAL - ADD 2 PUCKLIGHTS IN GREAT ROOM ON SEP SWITCH	OCTOBER 1 2020	
#13 ELECTRICAL - ADD EXTERIOR POTLIGHT ON PORCH	OCTOBER 1 2020	
#14 ELECTRICAL - ADD SWITCHED RECEPTACLE IN MASTER BEDROOM **SEE SEKTCH **NOTE: TOP PLUGS TO BE ON A SWITCH, BOTTOM PLUG TO BE LIVE ALL THE TIME	OCTOBER 1 2020	
#15 SOUND INSULATION ON ONE WALL OF POWDER ROOM	OCTOBER 1 2020	
#16 KITCHEN - CABINETS - UPGRADE 1	OCTOBER 1 2020	
#17 KITCHEN - TWO TONE	OCTOBER 1 2020	
#18 KITCHEN - CABINETS - EXTENDED UPPERS TO BE 39-1/2"	OCTOBER 1 2020	
#19 KITCHEN - COUNTERTOP - UPGRADE TO GRANITE **INCLUDE UNDERMOUNT SINK	OCTOBER 1 2020	
#20 KITCHEN - CABINETS - CROWN MOULDING TO MATCH	OCTOBER 1 2020	
#21 KITCHEN - ADD 36 INCH PANTRY	OCTOBER 1 2020	
#22 KITCHEN - ADD BUILT-IN MICROWAVE	OCTOBER 1 2020	
#23 KITCHEN - ROTATOE ISLAND **BREAKFAST BAR OVER HANG IS TO BE ON FRIDGE SIDE	OCTOBER 1 2020	
#24 ELECTRICAL - KITCHEN - ADD GFI PLUG UNDER SINK ON A SEPARATE SWITCH **SWITCH TO BE LOCATED ON THE WALL TO THE RIGHT OF THE SINK	OCTOBER 1 2020	
#25 KITCHEN - PULL-OUT SPICE RACK	OCTOBER 1 2020	
#26 KITCHEN - FRIDGE ENCLOSURE (DEEP UPPERS)	OCTOBER 1 2020	
#27 KITCHEN - BASE PIE CORNER CABINET	OCTOBER 1 2020	
#28 MASTER ENSUITE - ADD BANK OF DRAWERS (CLOSEST TO TOILET)	OCTOBER 1 2020	
#29 MASTER ENSUITE - SHOWER FLOOR TILES	OCTOBER 1 2020	
#30 KITCHEN BACKSPLASH - UPGRADE 1 **INCLUDES BEHIND CHIMNEY	OCTOBER 1 2020	
#31 LAUNDRY ROOM - UPPER CABINETS	OCTOBER 1 2020	
#32 VINYL FLOORING IN LIEU OF LAMINATE ON MAIN FLOOR	OCTOBER 1 2020	
#33 STAIN STAIRS TO MATCH AS CLOSE AS POSSIBLE	OCTOBER 1 2020	
#34 CARPET - UPGRADE 1 UNDERPAD	OCTOBER 1 2020	
#35 SMART-TECH LOCATIONS - SEE FLOOR PLAN	OCTOBER 1 2020	
#37 KITCHEN - SEE LOCATION OF BANK OF DRAWERS		
#38 DELETE UPPERS ABOVE STOVE FOR FUTURE CHIMNEY HOOD FAN		
#39 APPLIANCE SPECS INCLUDED		
#40 COUNTERTOP KITCHEN - DRILL HOLE FOR FUTURE SOAP DISPENSER TO THE RIGHT CORNER OF SINK		

\* HOLE SIZE = BETWEEN 1.25" - 1.50" \*

INCOR HOMES COLOUR CHART

CABINETRY / COUNTERTOPS				
	DOOR STYLE	HARDWARE	COUNTERTOP	EDGE
Kitchen UPPERS (Including Fridge & Pantry)	SHAKER MDF - WHITE (1)	H800BC	GIALLO ORNAMENTAL LIGHT	
Kitchen LOWERS (Including Island)	SHAKER MDF - FOG GREY (BLUE) (1)	H800BC	GIALLO ORNAMENTAL LIGHT	
Powder Room	PEDESTAL SINK			
Master Ensuite	EURO BLACKWOOD	H500BC	P344-CA	
Main Bath	EURO BLACKWOOD	H500BC	P344-CA	
Laundry	EURO BLACKWOOD	H500BC		
TILES				
Main Foyer	GENESIS DARK GREY 12 X 24 *BRICK			
Powder Room	GENESIS DARK GREY 12 X 24 *BRICK			
Kitchen	NEW BYZANTINE GREY 12 X 24 *BRICK			
Breakfast	NEW BYZANTINE GREY 12 X 24 *BRICK			
Kitchen Bk.Splash	ONTARIO SERIES HEX - TENDER GREY GLOSSY (1) **INCLUDES BEHIND CHIMNEY			
Laundry	NEW BYZANTINE ASSURO 12 X 24 *BRICK			
Mstr Ensuite Floor	NEW BYZANTINE ASSURO 12 X 24 *BRICK			
Mstr Ensuite Shower WALL	CINQ GREY 8 X 10			
Master Shower Floor	VOLKAS WHITE MATTE 2 X 2			
Master Shower JAMB	BIANCO CARRARA			
Main Bath Floor	NEW BYZANTINE ASSURO 12 X 24 *BRICK			
Main Bath Wall	CINQ GREY 8 X 10			
HARDWOOD / CARPET				
Kitchen	TILE			
Breakfast	TILE			
Family Room	VINYL - TORLYS EVERWOOD PREMIER 4-7/8" - SANDY RIDGE			
Main hall	VINYL - TORLYS EVERWOOD PREMIER 4-7/8" - SANDY RIDGE			
Upper Hall	CARPET - OPENING NIGHT - COLOUR T03 w/UPGRADE 1 UNDERPAD			
Master Bedroom	CARPET - OPENING NIGHT - COLOUR T03 w/UPGRADE 1 UNDERPAD			
Bedroom 2	CARPET - OPENING NIGHT - COLOUR T03 w/UPGRADE 1 UNDERPAD			
Bedroom 3	CARPET - OPENING NIGHT - COLOUR T03 w/UPGRADE 1 UNDERPAD			
BASEMENT	N/A			
FIREPLACES				
LOCATION	ELECTRICAL FIREPLACE - DIMPLEX BLF3451	MANTLE	N/A	
MIRRORS & ACCESSORIES		PLASTER MOULDING		
Mirrors	YES	Opt. Crown Moulding	NO	
Bathroom Accessories	DELETE	Location	NO	
Purchaser has reviewed the colour chart			SITE & LOT	
***FOR TRADE USE***			WASAGA	141-2
Any upgrades in the colour chart must be accompanied with a PES. It is the responsibility of all Trades to inform the builder of any discrepancies on sketches, PES and/or colour charts <u>PRIOR</u> to installation.				
** PAGE 1 OF 2 **			Purchaser Initial	Vendor

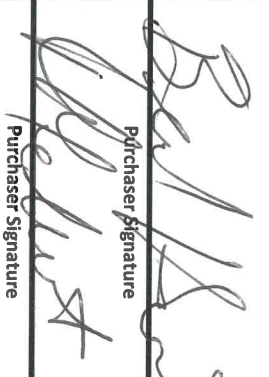
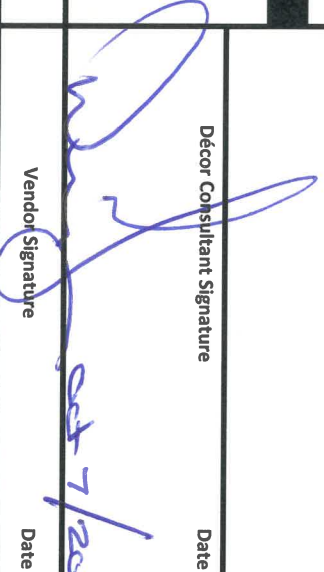

# INCOR HOMES COLOUR CHART

STAIRS, RAILING & PICKETS & STAIR STAIN			
Stair Stain / Species:	STAIN TO MATCH FLOORING AS CLOSE AS POSSIBLE		
Main to Basement Railing Details:	STANDARD METAL -SINGLE COLLAR WITH ALT. PLAIN w/STANDARD TURNED OAK POST & STANDARD OVAL HANDRAIL		
TRIM			
Casing/Baseboards	STANDARD		
Interior Doors	STANDARD		
Interior Door Hardware	STANDARD		
Exterior Door Hardware	STANDARD		
PAINT			
THROUGHOUT	WARM GREY		
PLUMBING- UPGRADES TO BE DETAILED ON PES			
	FIXTURES	FAUCETS	NOTES
Kitchen	UNDERMOUNT SINK	STANDARD	
Powder room	STANDARD	STANDARD	
Master Ensuite	STANDARD	STANDARD	
Main Bath	STANDARD	STANDARD	
Laundry	STANDARD	STANDARD	
ZANCOR APPLIANCE REQUIREMENTS-UPGRADES TO BE DETAILED ON PES			
Appliance Package received in 'Schedule E'		YES / NO Package Name:	
GAS LINE TO STOVE	UPG (SEE PES)	DECLINED	NOTES
	YES		
WATERLINE to Fridge	YES		
Hood Fan Venting SIZE	6 INCH		
ELECTRICAL for Built-in Oven	NO		
ELECTRICAL for Built-in Micro / OTR	YES		
ELECTRICAL for Gas Stove / Cooktop	NO		
ELECTRICAL for Bar Fridge	NO		
DISCLAIMER			INITIALS
Colours of all materials are as close as possible to Builder's selection but not necessarily identical due to dye lot variances in manufacturing/manufacturers. Due to construction progress some items may have been pre-selected or installed. In this event the Vendor's selection must be accepted by the purchaser			
Any changes to the colour chart after signing are subject to a \$5000 administration fee plus costs			
Purchaser has checked and acknowledged accuracy of colour and selections before signing.			
SITE:	WASAGA	LOT: 141-2	
PURCHASER(S):	BERNARD PAUL & VERONICA R HEBERT		
HOME #/CELL #	226-348-0738		
EMAIL:			
DÉCOR NOTES			
***FOR TRADE USE***			
Any upgrades in the colour chart must be accompanied with a PES. It is the responsibility of <u>all trades</u> to inform the builder of any discrepancies on sketches, PES and/or colour charts <u>PRIOR</u> to installation.			
ZANCOR HOMES		Purchaser Signature	Date
			OCT 1 2020
		Décor Consultant Signature	Date
			OCT 7/2020
		Vendor Signature	Date



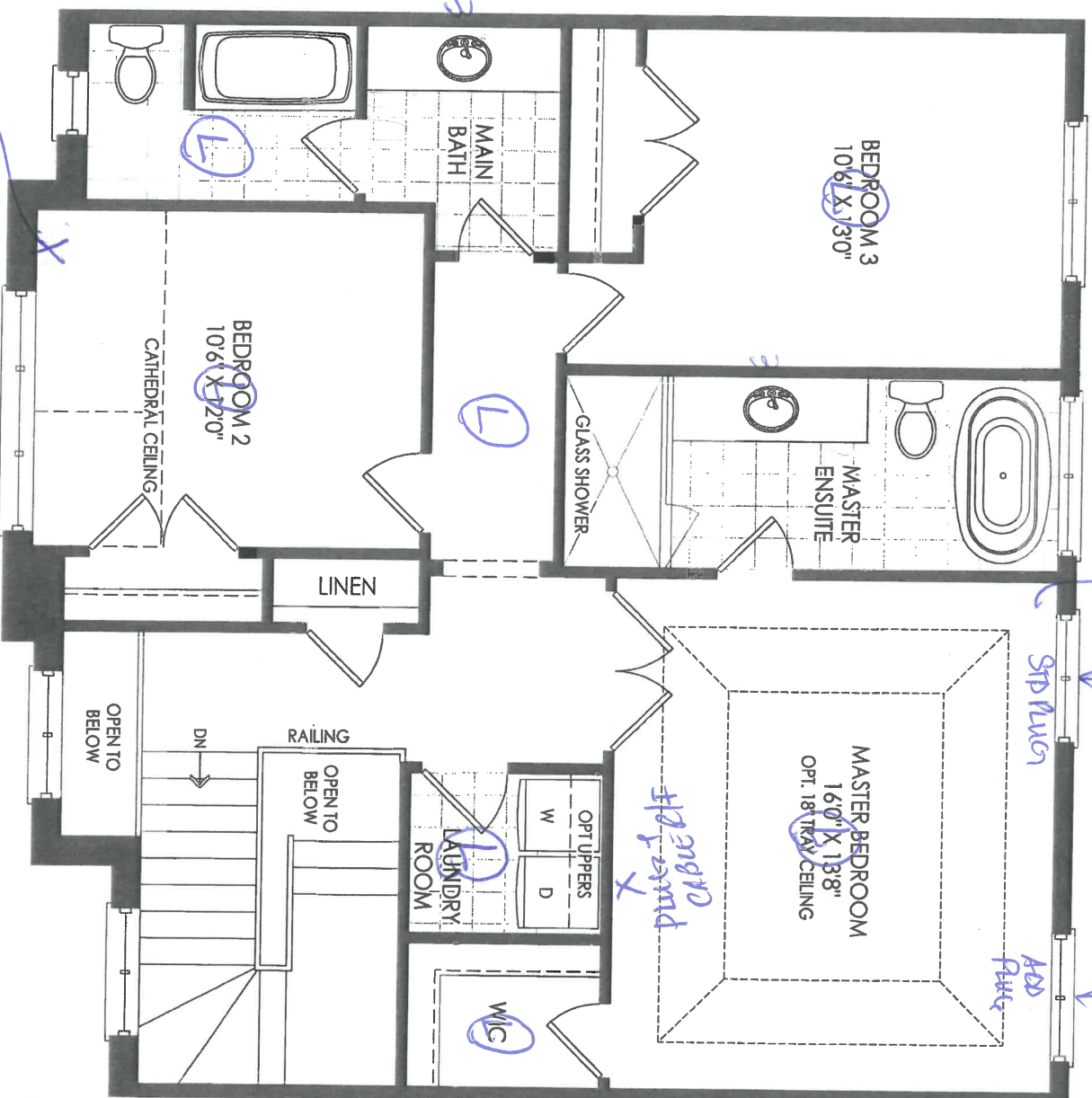

SECOND FLOOR EL. A

(B)

upgrade underpad.

THE AQUA TH-03



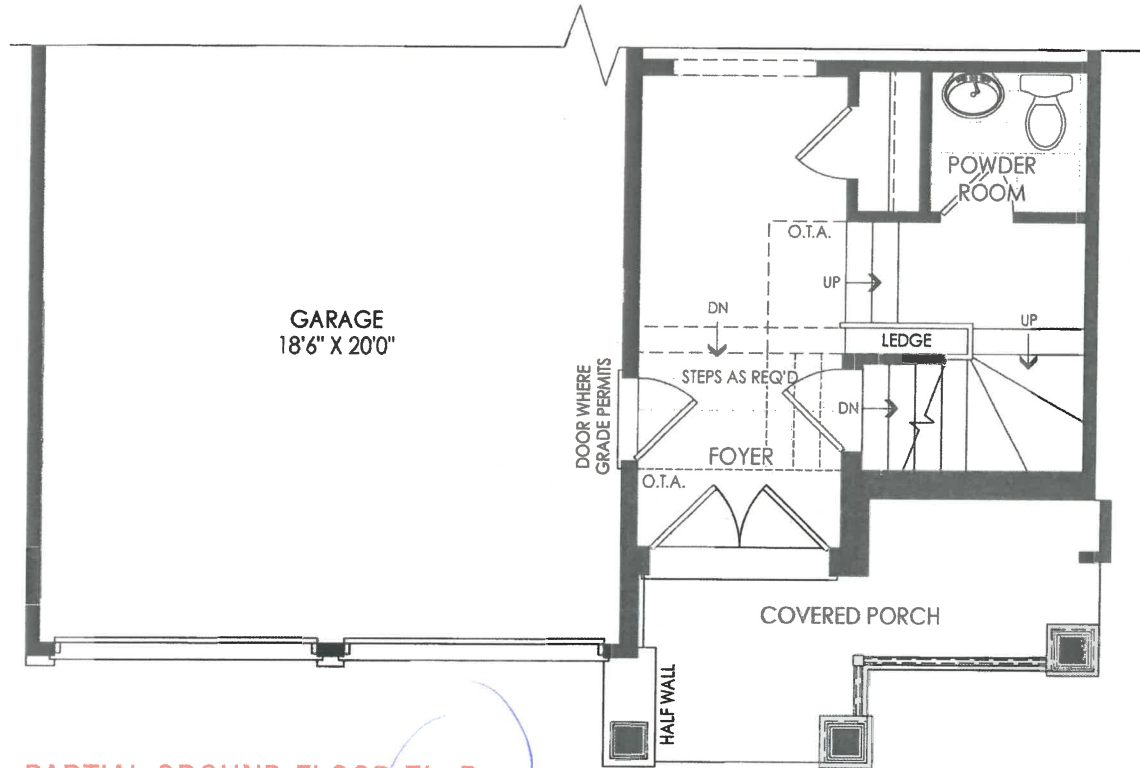

PARTIAL GROUND FLOOR EL. B

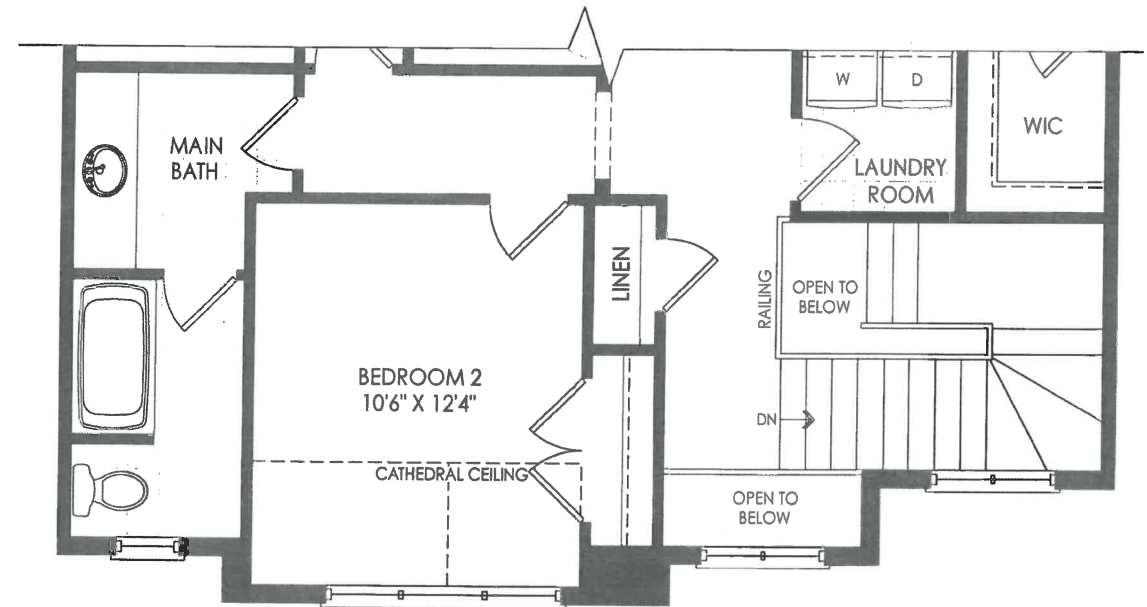

PARTIAL SECOND FLOOR EL. B

2-141  
21

THE AQUA TH-03



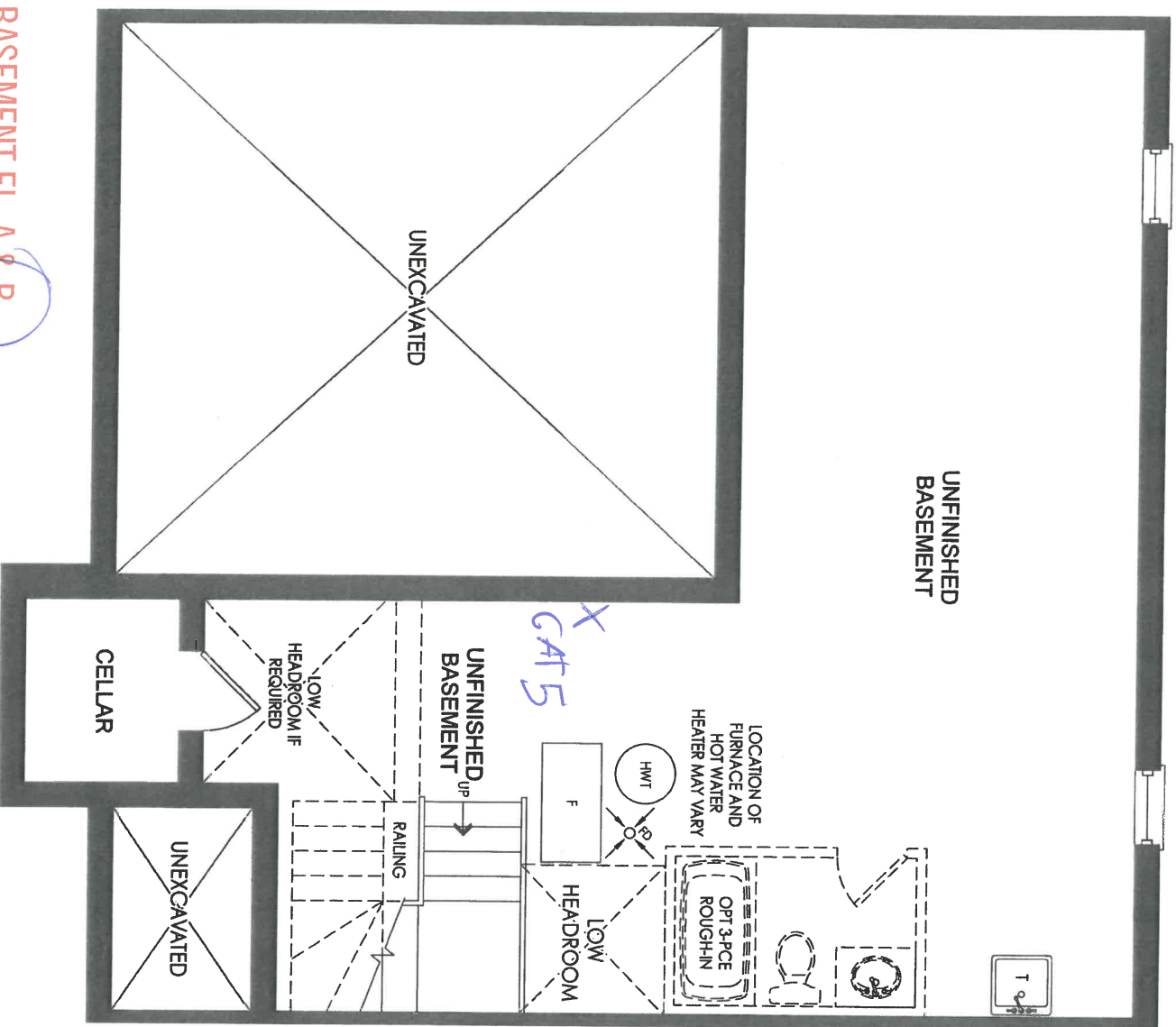

BASEMENT EL. A & B

THE AQUA TH-03

141-2

B

NEW IMAGE KITCHENS INC			
Scale:	Approved by:	Drawn by:	WANCE
Date: 3/27/11		Revised:	
ZANCOR HOMES		Drawing number:	
TH-3 WASAGA		THE AQUA	

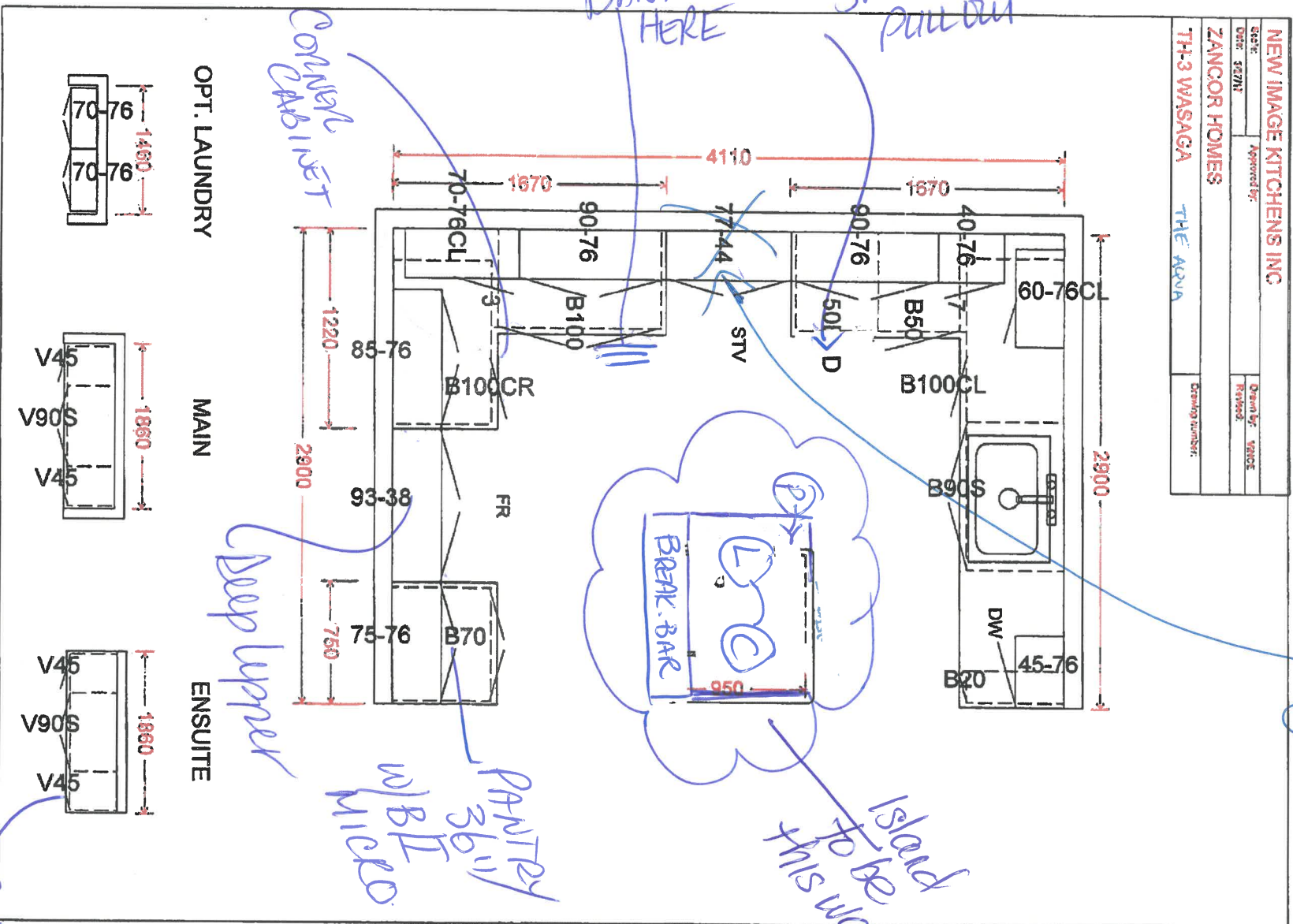

*Double Island Hood*

- UPPERS (1) (WHITE)
- LOWERS (1) (Fog Grey) | 41-2B
- Cloud moulding.
- TWO TONE



**Simone Walker**

---

**From:** Ruth Hebert <ruthhebert2@gmail.com>  
**Sent:** October 21, 2020 9:40 AM  
**To:** Simone Walker  
**Subject:** Soap dispenser-Hebert

**Follow Up Flag:** Follow up  
**Flag Status:** Flagged

Hi Simone,

As per our conversation, the hole for the soap dispenser needs to be 1.25 inches to 1.50 inches. It would need to be placed on the right hand side of the faucet.

Thanks,

Ruth

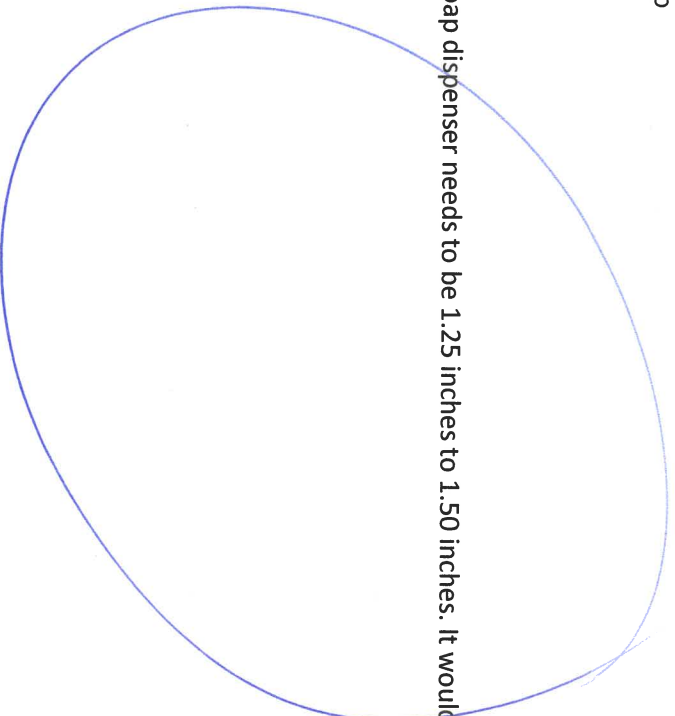

Soap Dispenser Hole Size  
+ location

THE  
GALLERY  
BY ZANCOR

Stone Countertop Edge Profiles (Aurivia)

\*\*Where applicable as per site specifications\*\*

Standard Countertop  
Edge in Kitchen

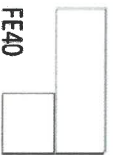

Standard Countertop  
Edge in Vanity



FE40

FE20

Upgrade 1 – Countertop Edges

Optional Edge in  
Kitchen – See book for  
model specific pricing

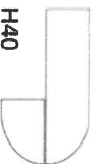

H40

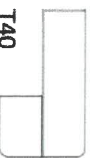

T40

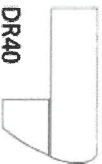

DR40

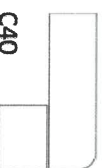

C40

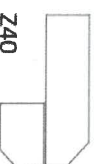

Z40

Optional Edge in  
Vanity – See book for  
model specific pricing



C20



H20

Upgrade 2 – Countertop Edges

Option 2 Edge in  
Kitchen – Custom \$\$



FV40

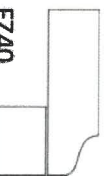

FZ40

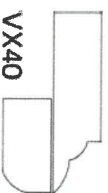

VX40

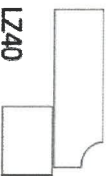

LZ40



FFZ40

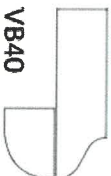

VB40

Optional 2 Edge in  
Vanity – Custom \$\$



L20



F20

DATE 08/1/2020

SITE Wasaga

LOT 141-2

Homeowner(s) Initials

ZANCOR

THE  
GALLERY  
BY ZANCOR  
APPLIANCE ACKNOWLEDGEMENT

CONTACT: Wayne @ Coast Appliances (905) 303-6909 / 1748 Credit Stone Circle, Vaughan

- ▶ NOTE: Any upgraded appliances are to be paid by the Purchaser, directly to the appliances company.
- ▶ Additional charges to the Purchaser may apply for cabinetry, electrical and plumbing in order to accommodate the specs given by the homeowner.
- ▶ It is the Purchaser's responsibility to provide Zancor Homes with the correct specification for each appliance where it exceeds the standard openings. Zancor Homes will not be responsible for appliances not fitting due to late changes.
- ▶ It is the Purchasers responsibility to coordinate delivery, installation and hook up of appliances and to ensure they are installed as per Manufacturers specifications after closing.
- ▶ Standard appliance openings are approximate and the minimum required. Sizes may vary due to onsite condition and/or when modifications have been made to the cabinetry.

STANDARD OPENINGS ACCEPTED BY PURCHASER:

HOMEOWNER INITIALS

Fridge Opening	▶ 36" (+/-) x 74" (+/-)	**Space above the fridge is required due to proper air flow
Stove Opening	▶ 30"	Hood Fan Opening ▶ 30"
Dishwasher Opening	▶ 24"	Hood Fan Vent ▶ 6"

Appliance Specs are DUE 2 WEEKS FROM SIGNED DATE (if not received during appointment)

\*\*\*Specs that require changes/modifications after this date will not be accepted\*\*\*

UPGRADE APPLIANCE OPENING REQUIREMENTS:

HOMEOWNER INITIALS

FRIDGE	<input type="checkbox"/> Built-In	<input type="checkbox"/> Flush Inset
	<input type="checkbox"/> Paneled / Integrated	<input checked="" type="checkbox"/> Water Line Required

RANGE	<input type="checkbox"/> 36"	<input type="checkbox"/> Cooktop (Apron front)
	<input type="checkbox"/> 48"	<input type="checkbox"/> Cooktop (Dropin)
	<input checked="" type="checkbox"/> Gas	**Countertop Cut-out charge required for cooktop
	<input type="checkbox"/> Induction	

HOOD FAN & VENT	<input type="checkbox"/> Under Cabinet (Standard)	<input checked="" type="checkbox"/> 6 Inch (Standard)
	<input checked="" type="checkbox"/> Chimney (centre vent)	<input type="checkbox"/> 8 Inch
	<input type="checkbox"/> Insert / Liner	<input type="checkbox"/> 10 Inch

WALL OVEN & MICRO	<input type="checkbox"/> Single Oven	<input type="checkbox"/> Warming Drawer
	<input type="checkbox"/> Double Oven	<input type="checkbox"/> Over the Range Microwave
	<input type="checkbox"/> Steam Oven	<input checked="" type="checkbox"/> Built-in Microwave (*trim kit required)

DATE	Oct 1/2020	SITE	W8888888	LOT	141-2
------	------------	------	----------	-----	-------

\*\* Any upgrades checked in this appliance form must be accompanied with specs provided by the Purchaser.

\*\*It is the responsibility of the trade to inform the Builder of any discrepancies with specs, sketches, extras and/or colour chart PRIOR to production/installation.

ZANCOR

221 North Rivermede Road, Concord, Ontario L4K 3N7 \* T: (905) 738.7010 F: (905) 738.5948



THE  
GALLERY  
BY ZANCOR

RELEASE FORM  
BRICK/JOINT PATTERN INSTALLATION

LOT / SITE:

HOMEOWNERS:

DATE:

141-2 Wassa  
Hebert  
Oct 1 / 2020

\*Brick installation requires an additional charge and will be included on the extras if selected\*

Large tiles installation for floor and wall – ½ Brick

Please be advised it has come to our attention, that due to production, many of the over-sized and odd shaped, man-made tiles (i.e. porcelain & ceramic), have been found to have a slight bow in the tile. It is a standard occurrence with all suppliers and manufacturers.

It is therefore recommended, that if and when a purchaser requests to install one of these tiles in a brick-joint pattern, that it be installed on a ½ brick pattern, to try to avoidlippage. Attached with this letter, you will find a layout of the ½ brick installation that has been recommended.

Locations: All floors

Please understand, even in using this ½ brick installation, there may still be minimal lippage which cannot fully be eliminated.

Hence, when there is a request for brick-joint installation, Zancor Homes and their contractor cannot be held responsible for this matter.

X  
Homeowner(s) Initial

(Small tile installation for walls) – ½ Brick

Purchaser requests to install small wall tiles on a backsplash or shower wall in a brick-joint pattern, that it be installed on a ½ brick pattern.

Locations:

Homeowner(s) Initial



THE  
GALLERY  
BY ZANCOR

HOME AUTOMATION  
(Cable, CAT5, Telephone)

LOT / SITE: 141-2 Masaya  
HOMEOWNERS: Hebert  
DATE: Oct

OPTION 1

I/we the Homeowner(s) have chosen to contact the Home Automation Company to select the locations of the rough-ins for Cable, CAT5, Telephone as included in our Agreement of Purchase Sale.

I/we the Homeowner(s) will contact the trade within 4 weeks of the date of this release to select locations of the standard rough-ins review other optional products for purchase.

Trade: Smart -Tech Systems Ltd.  
Phone: (905) 761-6469  
Rep: KRIS  
Location: 200 Millway Avenue, Unit #8  
Concord, Ont L4K 5K8

Should the homeowner not make these selections within the sufficient time provided, the rough-ins as mentioned above will be installed in locations at the Vendor's discretion.

Homeowner(s) Initial

OPTION 2

I/we the Homeowner(s) have chosen to not contact the home automation company. I/we the Homeowner(s) have selected the locations for the standard rough-ins for Cable, CAT5, Telephone that are included in the Agreement of Purchase and Sale directly with a décor rep.

Homeowner(s) Initial

ZANCOR

2/21/2020

30" Front Control Gas Range

FRIGIDAIRE

FGGH3047VD

30" Front Control Gas Range

SIGNATURE FEATURES



Make healthier and delicious meals with Air Fry

Deliver all of the flavor and none of the guilt. Air Fry allows you to make healthier and delicious meals for the entire family - right in your oven. The first range on the market to include Air Fry.



Flexible Five Burner Cooktop

Get the ultimate cooking flexibility. Cooktop features an 18,000-BTU power burner for faster boiling, a 5,000-BTU simmer burner for delicate foods and sauces and a 10,000-BTU oval burner, perfect for your griddle.

AVAILABLE COLORS



Stainless Steel

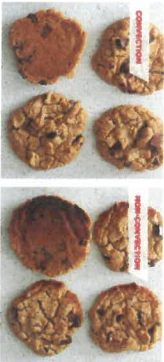

Faster, more even baking results with True Convection

Get faster, more even multi-track baking with a powerful convection fan and third heating element that evenly circulates hot air throughout the oven.



Quick Boil Burner

Get meals on the table faster with our powerful 18,000 BTU burner.

PRODUCT DIMENSIONS

Height	36-5/8"
Width	29-7/8"
Depth	26-6/8"

MORE EASY-TO-USE FEATURES

Fast Steam Cleaning Option  
A 30-minute light oven cleaning that's chemical-free, odor-free, and fast.

Keep your cooktop looking beautiful

Our gas burners are now easier to remove and clean.

Griddle Pan Included

Immediately begin making your family's favorite meals, like pancakes or quesadillas, on the center oval burner because the griddle pan comes included with the range.

Upgrade your Kitchen with a Built-in Look

Get the look of a built-in range, without the remodel. This Front Control Range easily fits the space of your existing 30" range.

Rear Filler Kit Included

Our Rear Filler Kit will help fill any gap between the back of the range and your backsplash.

Frigidaire Fit Promise

We promise that your new 30" Frigidaire Gallery® front control range will fit your existing range cutout, or we will reimburse up to one hundred dollars for professionally modifying the countertop.¹

Continuous Corner-to-Corner Grates

Continuous Grates make it easy to move burner pots and more.

CERTIFICATIONS

ADA Compliant



Star-K® Certified (Sabbath Mode)

Barry

141-2



FGGH3047VD  
30" Front Control Gas Range

FRIGIDAIRE

General Specifications

Leveling Legs	4 Adjustable
Frigidaire Fit Promise	Yes
Power Type	Gas
Size	30"
Installation Type	Free-Standing
Collection	
Cooktop	
Center Rear	10000 BTU (Oval)
Cooking Surface	Color- Coordinated Porcelain
Electronic Ignition	Yes
Grate Color	Black Matte
Grate Material	Cast Iron
Grates	3 Edge-to-Edge
Knob Type	Cast Iron
Left Front	14000 BTU
Left Rear	9500 BTU
Right Front	18000 BTU
Right Rear	5000 BTU
Control Panel Finish	
Control Panel Finish	Aluminum with Stainless Steel Finish
Electrical Specifications	
Amps @ 120 Volts	5
Min Circuit Required	15A
Voltage Rating	120V 60Hz
Certifications & Approvals	
ADA Compliant - All Brands	Yes
Agency Approval(All Brands)	CSA Blue Star / CSA Blue Flame
Sabbath Mode	Yes
Cooktop Specifications	
Knob Color	Black Stainless Steel
Exterior Specifications	
Cooktop Finish	Black Porcelain
Drawer Finish	Black Stainless Steel
Exterior Finish	Smudge-Proof™ Black Stainless Steel
Manifold Finish	Black Stainless Steel
Manifold Panel	Black Stainless Steel

Cooking Controls

Bake	Yes
Broil	Yes
Cancel Button	Yes
Set Clock	Yes
Door Lock	Yes
Lockout	Yes
Main Oven	Self Clean
Quick Bake Convection	Yes
Self-Clean	2 3 Hours
Start Button	Yes
Temperature Probe	No
Timer Function	Yes
Dimensions: Exterior	
Height	36-5/8"
Width	29-7/8"
Depth	26-6/8"
Door Finish	
Door Finish	Black Stainless Steel
Capacities	
Total Capacity - Cu. Ft.	5.6
Oven	
Bake	18000 BTU
Baking System	Even Baking Technology
Broil	13500 BTU
Broiling System	Var-1-Broil™ High/Low
Cleaning System	Self-Clean
Convection System	True Convection
Hidden Bake Element	Yes
Oven 1 Interior Color	Slate Blue
Oven 1 Interior Depth	19-1/8"
Oven 1 Interior Height	20-5/8"
Interior Lighting	1 Incandescent
Oven 1 Interior Width	24-3/8"
Rack Configuration	3 Standard
Rack Positions	6 positions
Type	Main
Window	Large Visualite®
Air Fry	Yes
Drawer	
Drawer Functionality	Storage
Drawer Handle	Black Stainless Steel
Handle Color	
Handle Color	Black Stainless Steel

14-2

# FRIGIDAIRE GALLERY

FGHG2368TF

FRENCH DOOR  
REFRIGERATOR  
22.4 CU. FT. COUNTER-DEPTH

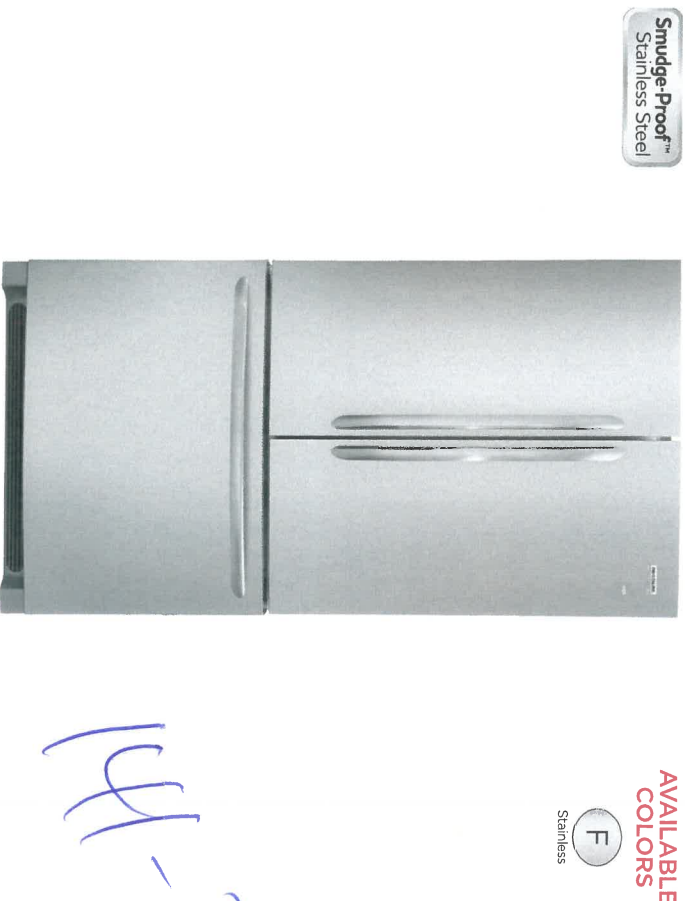

Smudge-Proof™  
Stainless Steel

AVAILABLE  
COLORS  
F  
Stainless

PRODUCT DIMENSIONS	
Height (Including Hinges & Rollers)	69-7/8"
Width (Doors)	36"
Depth (Including Door)	28-1/2"

**MORE EASY-TO-USE FEATURES**

**PureAir Ultra® II Filters**  
Our PureAir Ultra® II air filters effortlessly keep the air in your refrigerator fresh.

**Even Temp™**  
Even temperature throughout the refrigerator.

**Adjustable Interior Storage**  
Over 100 ways to organize and customize your refrigerator.

**Store-More™ Flip-Up Shelves**  
Easily make room for tall or large items.

**Multi-Level LED Lighting**  
Corner-to-corner LED lighting throughout the refrigerator for better visibility.

**Store-More™ Shelves**  
More space to store your food with edge-to-edge shelves.

**Full-Width Cool-Zone™ Drawer**  
A large capacity Cool Zone™ drawer extends completely and provides space to easily store anything from sheet cakes and large platters to snacks and juice boxes.

**Express-Select® Controls**  
Easily select options with the touch of a button.

**Freezer Basket with Divider**  
Deep freezer storage with adjustable divider keeps food organized and accessible.

**Effortless™ Glide Freezer Drawers**  
Drawers glide out smoothly and fully extend, giving you easy access to what's inside.

**Quick Freeze**  
Quickly freeze foods so they stay at their freshest.

**CERTIFICATIONS**

ENERGY STAR®



Star-K® Certified (Sabbath Mode)

**SIGNATURE FEATURES**



**Crisp Seal™**  
Sealed humidity-controlled crispers maintain moisture for market-fresh produce.



**Counter-Depth Design**  
Maximize your kitchen space with our counter-depth design that gives you over 4 inches of kitchen floor space back while still offering over 100 ways to organize.



**Effortless™ Glide Crisper Drawers**  
Our humidity-controlled crisper drawers can be configured any number of ways, either side-by-side or stacked on top of each other so you can organize your refrigerator the way you want.

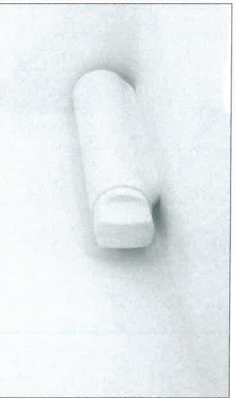

**PureSource Ultra® II  
Ice & Water Filtration**  
Discover how our genuine filtration works to keep your water cleaner. PureSource Ultra® II Water Filters remove 99.3% of lead and 99.9% of cysts from your household water.

FGHG2368TF

FRENCH DOOR REFFERATOR

22.4 CU. FT. COUNTER-DEPTH

FRIGIDAIRE

GALLERY

FEATURES

Door Design	Tall Soft-Arc
Door Handle Design	Stainless Steel
Cabinet Finish	Grey
Door Stops/Door Closers	Yes/Yes
Door Hinge Covers	Hidden
Rollers - Front/Rear	Adjustable/Yes
Water Filter Location	Top-Right Fresh Food Section
Sound Package	

CONTROL FEATURES

Controls	Express-Select®
Control Panel Location	Left Door, Inside Edge
Number of Control Buttons	11
Ice Option/Freeze Option	Quick Ice/Quick Freeze
Display On/Off Option	

Lock

Temp./Door Ajar/Power Failure Alerts	Yes/Yes/Yes
Water Filter Change Indicator Light	Yes
Air Filter Change Indicator Light	Yes

REFRIGERATOR FEATURES

Lighting	Multi-Level Designer LED
Water Filter Type	PureSource Ultra® II
Air Filter Type	PureAir Ultra® II
Quarter-Width Fixed Shelves	
Half-Width Fixed Shelves	4 Store-More™
Quarter-Width Sliding Shelves	
Half-Width Sliding Shelves	
Canilever Shelves	Yes
Store-More™ Full-Width Drawer	1 Cool Zone™
Hanging Wine Rack	
Hanging Can Dispenser	
Crisper Drawer/Humidity Controls	2 Clear/2
Dairy Compartment	
Store-More™ Fixed Door Bins	2 Clear
2-Liter Fixed Door Bins	
Gallon Adjustable Door Bins	4 Clear
2-Liter Adjustable Door Bins	2 Clear
Dispenser Bin	
Non-Slip Bin Liner/Bottle Retainers	Yes/No

FREEZER FEATURES

Self-Closing Pull-Out Drawer	Yes
Sliding Full-Width Freezer Baskets	2 Effortless™ Glide
Basket Dividers	1 (Bottom Basket)
Lighting	LED
Ice Maker	Yes

CERTIFICATIONS

ENERGY STAR®	Yes
Star-K® Certified (Sabbath Mode)	Yes

SPECIFICATIONS

Total Capacity (Cu. Ft.)	22.4
Refrigerator Capacity (Cu. Ft.)	15.6
Freezer Capacity (Cu. Ft.)	6.8
Power Cord Connection Location	Right Bottom Rear
Water Inlet Connection Location	Left Bottom Rear
Voltage Rating	120V/60Hz
Connected Load (kW rating) @ 120 Volts¹	102
Amps @ 120 Volts	8.5
Minimum Circuit Required (Amps)	15
Shipping Weight (Approx.)	347 Lbs.

For use on adequately wired 120V, dedicated circuit having 2-wire service with a separate ground wire. Appliance must be grounded for safe operation.

PRODUCT DIMENSIONS

A-Height (Including Hinges & Rollers)	69-7/8"
B-Cabinet Width/Door Width	35-7/8" / 36"
C-Depth (Including Door)	28-1/2"
Depth with Door Open 90°	42-1/2"
Depth with Drawer Fully Extended (Including Handle)	45-1/2"
"BUILT-IN LOOK" CUTOUT DIMENSIONS	
Height (Including Hinges and Rollers)	70-1/4"
Width	36"
Depth	25"

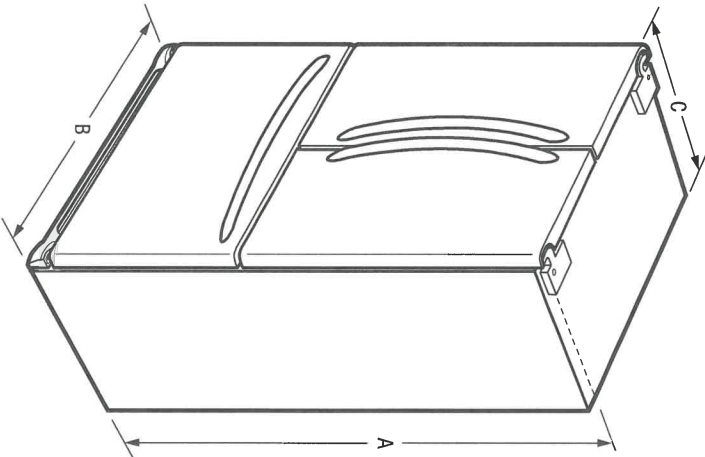

141-2



FGHG2368TF  
FRENCH DOOR REFFERATOR  
22.4 CU. FT. COUNTER-DEPTH

FRIGIDAIRE  
GALLERY

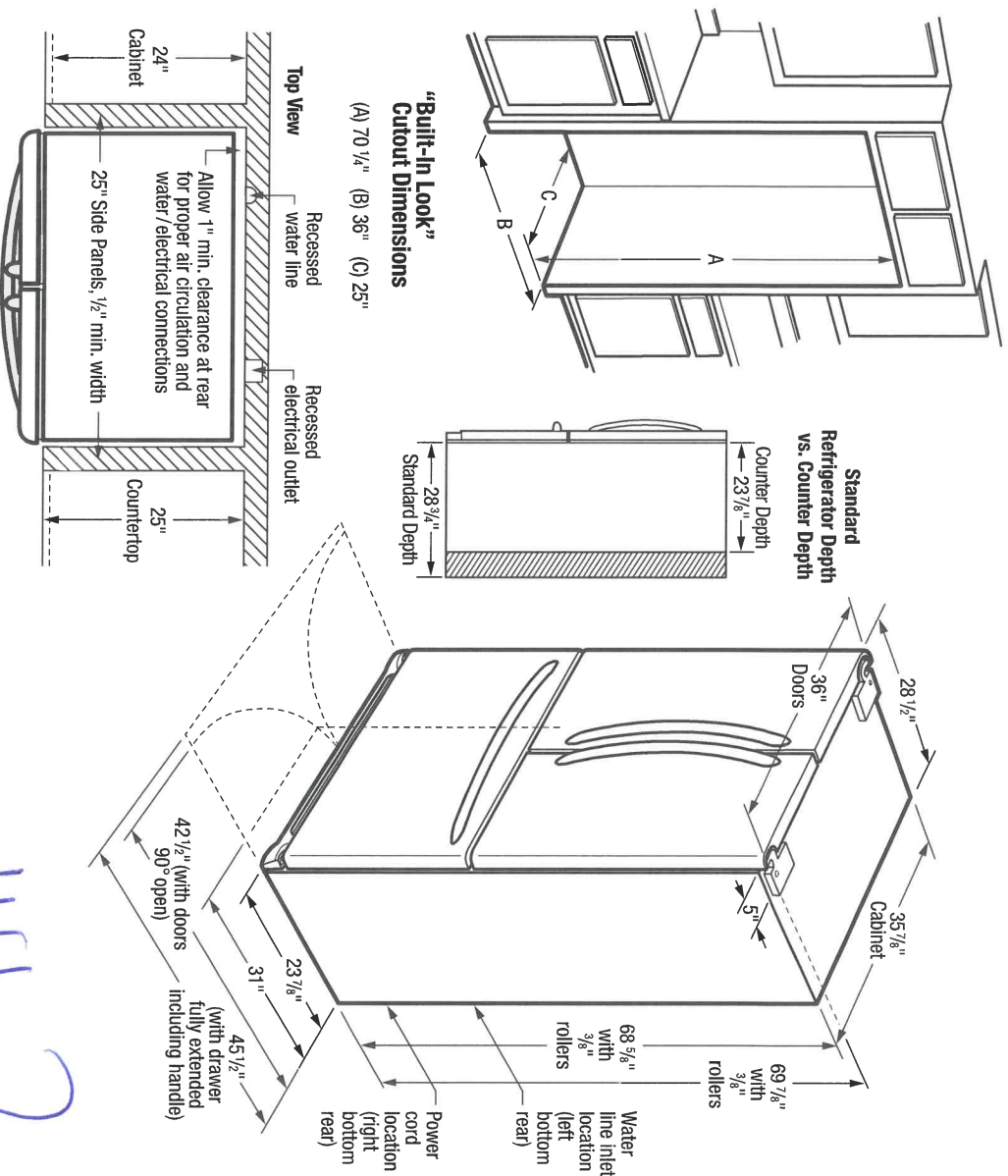

INSTALLATION SPECIFICATIONS

- Product Shipping Weight (approx.) - 347 Lbs.
- An electrical supply with grounded three-prong receptacle is required. The power supply circuit must be installed in accordance with current edition of National Electrical Code (NFPA 70) and local codes & ordinances.
- Voltage Rating - 120V/60 Hz
- Connected Load (kW Rating) @120 Volts = 102kW
- Amps @ 120 Volts = 8.5 Amps
- Always consult local and national electric & plumbing codes.
- Floor should be level surface of hard material, capable of supporting fully loaded refrigerator.
- When installing refrigerator adjacent to wall, cabinet or other appliance that extends beyond front edge of unit, 20" minimum clearance recommended to allow for optimum 120° to 180° door swing, providing complete drawer/cripper access and removal. *(Absolute 4-1/2" minimum clearance will ONLY allow for 90° door swing which will provide drawer/cripper access with restricted removal)*
- To ensure optimum performance, avoid installing in direct sunlight or close proximity to range, dishwasher or other heat source.

- For proper ventilation, front grille MUST remain unobstructed.
  - Recess electrical outlet when possible.
  - Water recess on rear wall recommended to prevent water line damage.
  - Water Pressure - Cold water line must provide between 30 and 100 pounds per square inch (psi).
  - Copper tubing with 1/4" O.D. recommended for water supply line with length equal to distance from rear of unit to household water supply line plus 7 additional feet. Optional Water Supply Installation Kits available.
  - Adjustable front rollers to assist with door alignment.
- "BUILT-IN LOOK" SPECIFICATIONS**
- Minimum opening of 70-1/4"H x 36"W x 25"D required to allow for ease of installation, proper air circulation, and plumbing/electrical connections.
  - Remove all wall/floor molding prior to installation.



FRIGIDAIRE  
USA • 10200 David Taylor Drive • Charlotte, NC 28262 • 1-800-FRIGIDAIRE • [frigidaire.com](http://frigidaire.com)  
CANADA • 5855 Terry Fox Way • Mississauga, ON L5V 3E4 • 1-800-265-8352 • [frigidaire.ca](http://frigidaire.ca)

*Note: For planning purposes only. Always consult local and national electric, gas and plumbing codes. Refer to Product Installation Guide for detailed installation instructions on the web at [frigidaire.com](http://frigidaire.com) / [frigidaire.ca](http://frigidaire.ca). Specifications subject to change. Accessories information available on the web at [frigidaire.com](http://frigidaire.com) / [frigidaire.ca](http://frigidaire.ca)*

# FRIGIDAIRE GALLERY

## Dishwashers

FGID2476S F/W/B

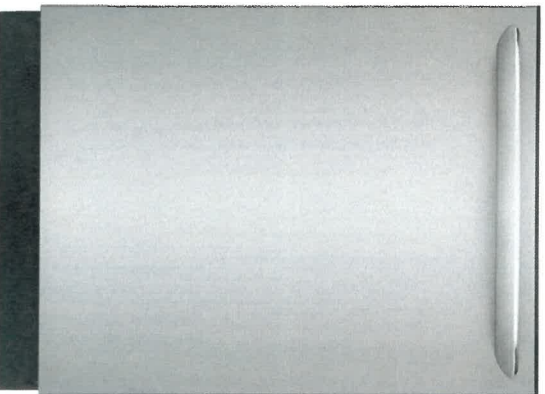

14-2

### 24" Built-In

#### Product Dimensions

Height (Adjustable)	33-3/4" - 35-3/4"
Width	24"
Depth (Including Door)	24-1/4"

#### More Easy-To-Use Features

**Smudge-Proof™ Stainless Steel<sup>14</sup>**  
Resists fingerprints and cleans easily.

**Clean Dishes of All Sizes**  
Loading your dishwasher is no longer a puzzle with our SpaceWise® Adjustable Rack, which adjusts to fit oversized dishes and kitchen tools of all shapes and sizes.

**Ready-to-Use Dish Alert**  
Know when your dishes are clean with LED Floor Beam Indicator, which beams a green light alerting you that your dishes are mealtime-ready.

**Stay-In-Place Door**  
The door stays put at whatever angle you open it for easy loading and unloading.

**24-Hour Delay Start**  
Set your dishwasher in advance to run on your schedule. It can be set to run 1-24 hours in advance.

**Cleans 14 Place Settings**  
Clean up to 14 place settings in one cycle.

**Efficient Water Usage**  
Cleans a full load of dishes using 15% less water<sup>15</sup>.

**Stainless Steel Interior and Filtration**  
Durable, stainless steel interior with removable, stainless steel filter, which prevents re-depositing of food particles.

ENERGY STAR®  
NSF® International  
Certification



#### Available in:



<sup>14</sup> Than a traditional spray arm.  
<sup>15</sup> When used with rinse aid.  
<sup>16</sup> Tested against competing models with comparable quick cycle times according to ANSI/AHAM DW-1-2010 with only 6 place settings.  
<sup>17</sup> Select model only.  
<sup>18</sup> Over a year when using normal cycle in our stainless tub compared to our plastic tub.

#### Signature Features

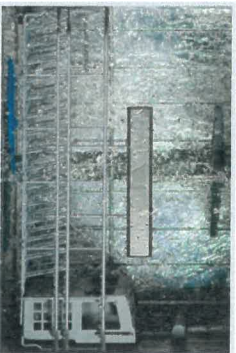

**A Complete Clean**  
Clean dishes in one cycle with OrbitClean® Wash System, which uses four times more water coverage<sup>1</sup> for a complete clean.



**Best 30-Minute Clean**  
Don't wait when dishes can be cleaned with the best 30-Minute Quick Clean<sup>2</sup>.



**Automatically Adjusts Cycles**  
DishSense™ Technology automatically adjusts the cycle time based on the level of clean that your dishes need for an efficient clean.



Features	
Control Design	Fully-Integrated Express-Select <sup>†</sup>
Digital Display	Yes
Door Latch/ Stay-Put Door Hinge Design	Yes/ Yes
Low Rinse-Aid Indicator Light	
Interior Colour/ Interior Design	Stainless Steel/ Tail Tub
Wash System	Direct Feed
Wash Arm	OrbitClean <sup>®</sup>
Wash Levels/ Wash Speeds	5/ 5
DisiSense™ Technology	Yes
AquaSurge™ Technology	Yes
Sound Package	SilentDesign™
Filter/ Filter Trap	S-Steel/ Removable
Soft Food Disposer	
dB Level	51
Drying System	EvenDry™
Cycles	
Number of Cycles	8
PowerPlus™ (Heavy)	Yes
Normal	Yes
Light	
Quick Wash (30-Min.)	Yes
Favourite	Yes
China Crystal	Yes
Rinse Only	Yes
Energy Saver Plus	Yes
Upper Rack Wash Only	Yes
Cycle Indicator Light/ Control Lock	No/ Yes
Cycle Complete Floor Beam Indicator	LED
Options	
Heat/ No Heat Dry	Yes/ Yes
Hi-Temp Wash	Yes
NSF <sup>®</sup> Certified Sanitize Rinse	Yes
Delay Start	1-24 Hour
Rack System	
Rack Design	Deluxe
Rack Coating	Nylon TufRacks™
Upper Rack -	
Rack Handles	
Stemware/ Champagne Glass Holders	Yes
Fold-Down Tines	Yes
Cup Shelves/ Stemware Grips	2/ No
Versa-Tray™	
Adjustable Rack	Yes
Lower Rack -	
SpaceWise <sup>®</sup> Silverware Basket	3-Piece Split
Fold-Down Tines	2 Full Rows
Small Items Cover	2
Third-Level Rack (Single Tray)	
Certifications	
ENERGY STAR <sup>®</sup>	Yes
NSF <sup>®</sup> International Certification	Yes
Specifications	
Water Inlet Location	Left Bottom Front
Water Usage (Gallons)	4.0 – 8.0
Water Pressure (PSI)	20 – 120
Integral Air Gap on Supply	Yes
Leveling Legs	Yes
Power Supply Connection Location	Right Bottom Front
Voltage Rating	120V / 60 Hz / 15A
Connected Load (kW Rating) @ 120 Volts <sup>†</sup>	1.44
Amps @ 120 Volts	15.0
Shipping Weight (Approx.)	91 Lbs.

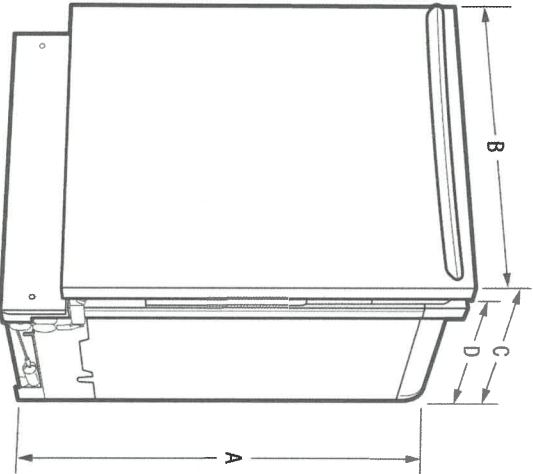

141-2

NOTE: For planning purposes only. Always consult local and national electric and plumbing codes. Refer to Product Installation Guide for detailed installation instructions on the web at [frigidaire.ca](http://frigidaire.ca).



Product Dimensions	
A - Height (Adjustable)	33-3/4" – 35-3/4"
B - Width	23-3/4"
C - Depth (Including Door)	24-1/4"
D - Depth (To Tub Flange)	22-1/2"
Depth with Door Open 90°	50-1/4"

Cutout Dimensions	
Height (Min.)	34"
Height (Max.)	35-3/4"
Width (Min.)	24"
Depth (Min.)	24"

<sup>†</sup>For use on adequately wired 120V, dedicated circuit having 2-wire service with a separate ground wire. Appliance must be grounded for safe operation.

Accessories information available on the web at [frigidaire.ca](http://frigidaire.ca)

FRIGIDAIRE

CANADA • 5855 Terry Fox Way • Mississauga, ON L5V 3E4 • 1-800-265-5352 • [frigidaire.ca](http://frigidaire.ca)  
FGID2476S 03/17

© 2017 Electrolux Major Appliances, NA

Specifications subject to change.  
Printed in Canada





# FHWC3055LS

Frigidaire 30" Stainless  
Canopy Wall-Mounted  
Hood

AVAILABLE  
COLORS

PRODUCT DIMENSIONS

Height	31-11/16"
Width	29-7/8"
Depth	19-11/16"

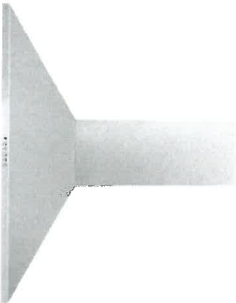

SIGNATURE FEATURES

- Dual-Centrifugal Fans**

Move air quietly and efficiently — up to 400 cu. ft. of air per minute.
- Halogen Lighting**

For bright illumination of the cooktop surface.
- Washable Filters**

Dishwasher safe for easy cleaning. The aluminum filter provides strength and durability not found in foam filters.

141-2

FHWC3055LS  
Frigidaire 30" Stainless Canopy  
Wall-Mounted Hood

General Specifications

Filter Type	Dishwasher-Safe
Power Type	Electric
Size	30"
Installation Type	Wall Mounted
Collection	Frigidaire

Electrical Specifications

Amps @ 120 Volts	4
Circuit Amps	15
Connected Load (KW Rating) @ 120V	0.516
Voltage Rating	120V 60Hz
Watts @ 120 Volts	520

Certifications & Approvals

Agency Approval	UL/cUL
UL/cUL Approval	Yes - cULus
Vent & Light System	

Blower Type	Centrifugal
Duct Diameter	6"
Ducted / Ductless Vent Installation	Yes
Exhaust Duct	Convertible
Exhaust Fan Capacity (CFM)	400
Exhaust Fan Speeds	3
Filters	2
Lights	2
Sones Rating	3.63 to 7.94 (1 to 3 speeds)
Sound Level (dBA)	58.5 to 69.9 (1 to 3 speeds)
Work-Area Light	Halogen Lighting

Controls

Control Buttons	5
Electronic Controls with LCD Display	No

Accessories

Recirculation Kit for Wall-Mount Hoods	Stainless - Optional order item no. FHWRKT55LS
--	--

Wall-Mount Extended Kit	Stainless - Optional order item no. FHWOX55LS
-------------------------	---

Exterior Dimensions

Depth	19-11/16"
Height	31-11/16"
Height (Min.)	31-11/16"
Height (with Flue Extension)	45"
Width	29-7/8"

141-2



*Note:* For planning purposes only. Always consult local and national electric, gas and plumbing codes. Refer to Product Installation Guide for detailed installation instructions on the web at [frigidaire.com / frigidaire.ca](http://frigidaire.com/frigidaire.ca).

**Specifications subject to change.** Accessories information available on the web at [frigidaire.com](http://frigidaire.com) / [frigidaire.ca](http://frigidaire.ca)

**FRIGIDAIRE**  
USA • 10200 David Taylor Drive • Charlotte, NC 28262 • 1-800-FRIGIDAIRE • [frigidaire.com](http://frigidaire.com)  
CANADA • 5855 Terry Fox Way • Mississauga, ON L5V 3E4 • 1-800-265-8352 • [frigidaire.ca](http://frigidaire.ca)

FHWC3055LS  
©2017 Electrolux Home Products, Inc.

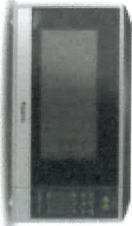

Microwave Ovens    Cyclonic Inverter™

Countertop NN-ST765S

MODEL & SIZE	Model Number	NN-ST765S
	Type	Family-size
	Installation	Countertop or built-in
	Oven Capacity	1.6 cu. ft.
	Cooking Power	1200W
	Turntable Diameter	380mm
	Panasonic Inverter	Cyclonic Inverter
PANASONIC TECHNOLOGY	Genius Sensor	Genius®
	Color	Stainless Steel
DESIGN	Control Panel	Touch pad
	Display Panel	New 4 Digit + Icon LCD / Green
	Door Window	Clear Black
STYLE	Door Release	Push Open
	Oven Interior	Paint White
PERFORMANCE	Multi-stage Cooking	3 stage
PROGRAMMABLE FEATURES	Sensor Cook	Yes
	Sensor Reheat	Yes
	Auto Cook/Reheat	Yes
	More / Less Control	Yes
	Inverter Turbo Defrost	Yes
	Keep Warm Button	Yes
	Popcorn Button	Yes

141-2

		Quick Minute	es
SPECIFICATIONS	Cavity Dimensions (W x D x H)		Approx. 418 x 470 x 228 mm 15.7 x 18.5 x 8.3 inch
	Unit Dimensions (W x D x H)		555 x 493 x 304 mm 21.9 x 19.4 x 12 inch
	Carton Dimensions (W x D x H)		627 x 540 x 360 mm
	ACCESSORIES		
TRIM KITS	27" Model Number	NN-TK722S	
	30" Model Number	NN-TK732S	
Accessory	Glass Tray		

Copyright ©Panasonic Canada Inc.

141-2



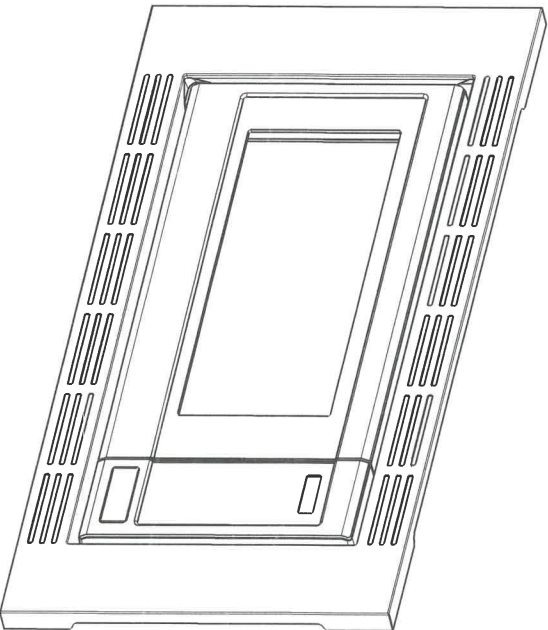

# Installation Instructions

## Notice d'installation

### Instrucciones para la instalación

Cabinet Armoire Gabinete	Trim kit Nécessaire d'encastrement Juego de acabados
30" (762 mm) 30 po (762 mm) 30" (762 mm)	NN-TK932S NN-TK732S
27" (686 mm) 27 po (686 mm) 27" (686 mm)	NN-TK922S NN-TK722S

Read carefully and keep these installation instructions.  
Lisez attentivement et conservez cette notice d'installation.  
Lea cuidadosamente y guarde este instructivo de  
instalación para su referencia.

2. Installation Diagram  
2. Schéma d'installation  
2. Diagrama de instalación

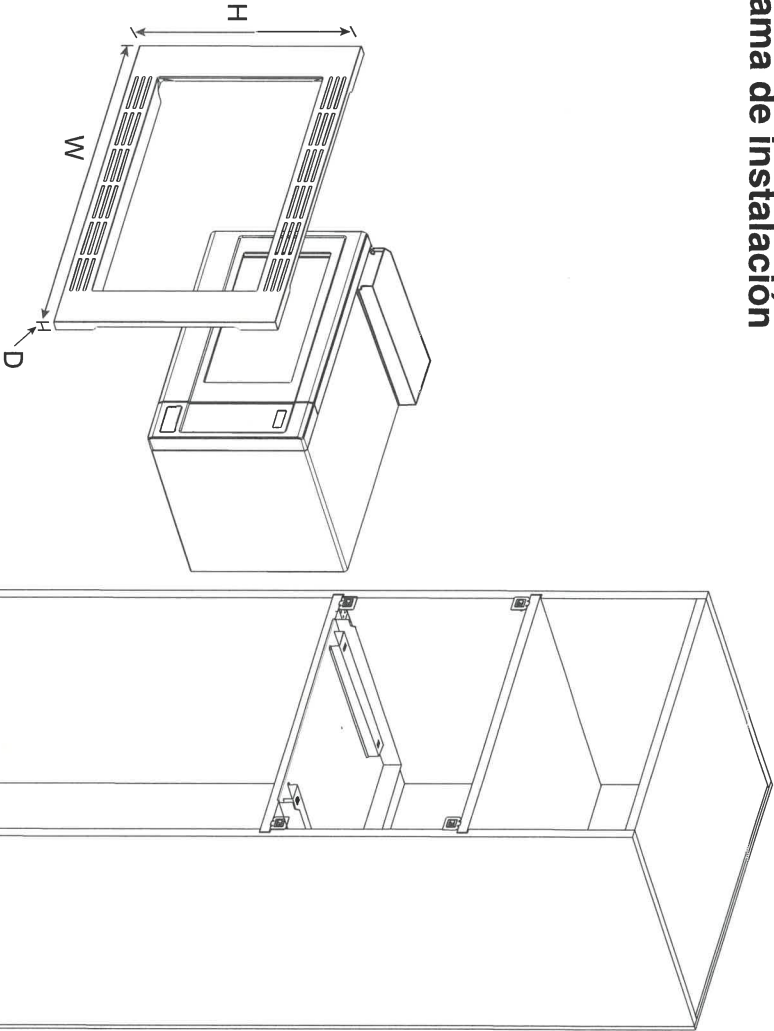

141-2

Trim Kit Dimensions				
	TK932S	TK922S	TK732S	TK722S
Width	30" (760 mm)	27" (684 mm)	30" (760 mm)	27" (684 mm)
Height	18 7/16" (472 mm)	18 9/16" (472 mm)	16 1/2" (419 mm)	16 1/2" (419 mm)
Depth (Thickness)	3/4" (20 mm)	3/4" (20 mm)	3/4" (20 mm)	3/4" (20 mm)

Dimensions du nécessaire d'encastrement				
	TK932S	TK922S	TK732S	TK722S
Largeur	760 mm (30 po)	684 mm (27 po)	760 mm (30 po)	684 mm (27 po)
Hauteur	472 mm (18 7/16 po)	472 mm (18 9/16 po)	419 mm (16 1/2 po)	419 mm (16 1/2 po)
Profondeur (épaisseur)	20 mm (3/4 po)	20 mm (3/4 po)	20 mm (3/4 po)	20 mm (3/4 po)

Dimensiones del juego de acabados				
	TK932S	TK922S	TK732S	TK722S
Ancho	30" (760 mm)	27" (684 mm)	30" (760 mm)	27" (684 mm)
Altura	18 7/16" (472 mm)	18 9/16" (472 mm)	16 1/2" (419 mm)	16 1/2" (419 mm)
Profundidad (grosor)	3/4" (20 mm)	3/4" (20 mm)	3/4" (20 mm)	3/4" (20 mm)



3-3. Cabinet Diagram and Dimensions (For TK732S)  
3-3. Schéma de l'armoire et dimensions (Pour TK732S)  
3-3. Dimensiones y diagrama del gabinete (Para TK732S)

fig 1.

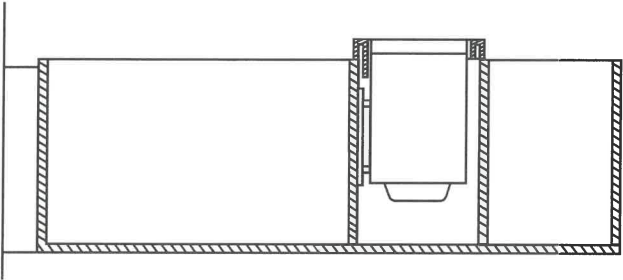
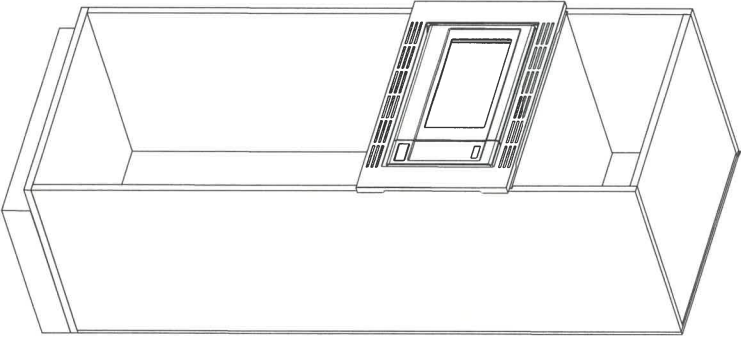
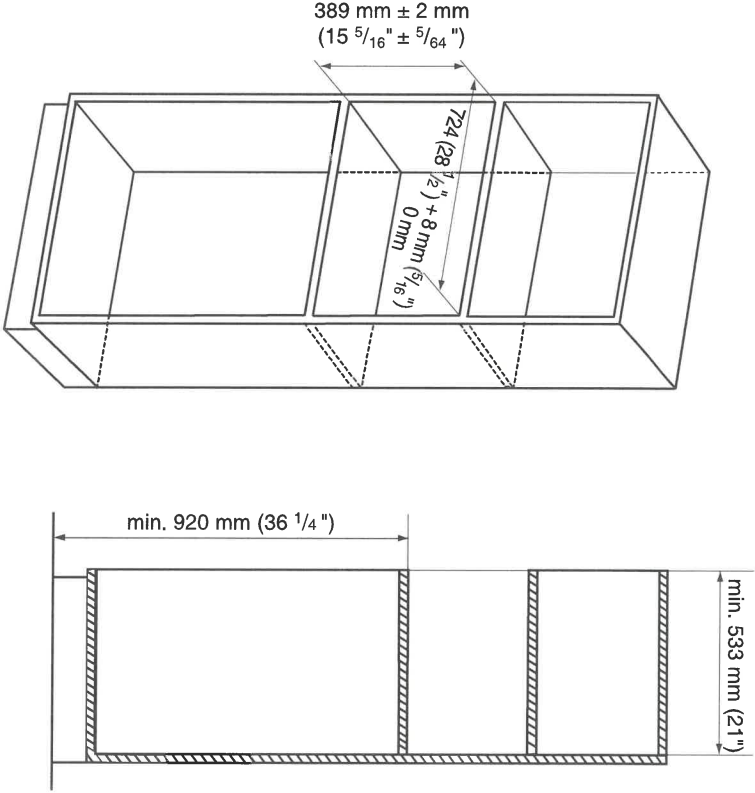

141-2