

CONSTRUCTION SUMMARY OF EXTRAS
Printed 2019-04-10 / 10:09 AM / Page 1 of 1

Site:
Lot:
Model:
Purchaser:
Phone/Email:
Appointment:

INNISFIL PHASE 2
40N
BREAKER 50-05 (B)
INVENTORY
SIMONE 416-843-7270 / SIMONE@ZANORHOMES.COM
STRUCUTRALS & COLOURS



	DESCRIPTION	DATE SELECTED
#1	SMOOTH CEILINGS ON MAIN FLOOR	APRIL 4 2019
#2	FRAMELESS GLASS SHOWER IN MASTER ENSUITE	APRIL 4 2019
#3	KITCHEN - DEEP UPPERS WITH GABLES	APRIL 4 2019
#4	KITCHEN - SERVERY - UPPERS TO BE CLEAR BEVELED GLASS DOORS	APRIL 4 2019
#5	KITCHEN - UPPER UPPER CABINETS BESIDE FRIDGE TO BE CLEAR BEVEL GLASS DOORS	APRIL 4 2019
#6	KITCHEN - CROWN MOULDING & LOWER LIGHT VALANCE	APRIL 4 2019
#7	KITCHEN - ANGLED CANOPY ABOVE STOVE *HOOD FAN FROM APPLIANCE COMPANY	APRIL 4 2019
#8	KITCHEN - EITHER SIDE OF CANOPY - UPPERS TO BE CLEAR BEVELED GLASS DOORS	APRIL 4 2019
#9	KITCHEN - UPGRADE 1 CABINETS	APRIL 4 2019
#10	APPLIANCE PACKAGE	APRIL 4 2019
#11	ELECTRICAL - MOVE STANDARD LIGHT IN KITCHEN TO BE OVER ISLAND: ADD (1) CAPPED LIGHT ABOVE ISLAND **BOTH ON SAME SWITCH	APRIL 4 2019
#12	ELECTRICAL - VALANCE LIGHTING IN KITCHEN / SERVERY ON SEP SWITCH	APRIL 4 2019
#13	ELECTRICAL - 7 LED POTLIGHTS IN FAMILY ROOM ON SEP SWITCHES **DELETE STD	APRIL 4 2019
#14	ELECTRICAL - 5 LED POTLIGHTS IN DINING ROOM ON SEP SWITCHES **STD REMAINS	APRIL 4 2019
#15	ELECTRICAL - 4 LED POTLIGHTS IN MAIN HALL ON EXISTING SWITCH *DELETE STD	APRIL 4 2019
#16	ELECTRICAL - CAPPED LIGHT ON SEP SWITCH OVER TUB IN MASTER	APRIL 4 2019
#17	HARDWOOD - MAIN FLOOR UPGRADE: COLOUR IN LIEU OF STANDARD	APRIL 4 2019
#18	HARDWOOD - UPPER HALL IN LIEU OF CARPET	APRIL 4 2019
#19	STAIN STAIRS TO MATCH HARDWOOD AS CLOSE AS POSSIBLE	APRIL 4 2019
#20	KITCHEN BACKSPLASH - UPGRADE 1 **BRICK	APRIL 4 2019

ZANCOR HOMES COLOUR CHART

CABINETRY / COUNTERTOPS					
	DOOR STYLE	HARDWARE	COUNTERTOP	EDGE	
Kitchen	SIERRA MDF - WHITE (1)	HP500P	NEW CALEDONIA (STD)		
Canopy	ANGLED - MDF BLACK	HP500P	N/A		
Island & Servery	SIERRA MDF - BLACK (1)	HP500P	NEW CALEDONIA (STD)		
Master Ensuite	SIERRA MEL - WHITE	HP500P	CARRARA 6696-58		
Twin 2/3	SIERRA MEL - WHITE	HP500P	CARRARA 6696-58		
Ensuite 4	SIERRA MEL - WHITE	HP500P	CARRARA 6696-58		
Laundry	N/A		N/A		
TILES					
Main Foyer	CINQ BLACK 13 X 13				
Basement Foyer	N/A				
Powder Room	LILY WHITE 13 X 13				
Mud Room	LILY WHITE 13 X 13				
Kitchen / Breakfast	CINQ BLACK 13 X 13				
Kitchen Bk.Splash	COLOURS & DIMENSIONS 3 X 6 WHITE (1) **BRICK				
Laundry	LILY WHITE 13 X 13				
Mstr Ensuite Floor	CINQ GREY 13 X 13				
Mstr Ensuite Shower WALL	CINQ GREY 8 X 10				
Master Shower Floor	WHITE 2 X 2				
Master Shower	BIANCO				
Twin 2/3 Floor	MALINA ICE 13 X 13				
Twin 2/3 Tub Wall	UNIWALL WHITE 8 X 10				
Ensuite 4 Floor	MALINA ICE 13 X 13				
Ensuite 4 Tub Wall	UNIWALL WHITE 8 X 10				
HARDWOOD / CARPET					
Kitchen/ Breakfast	N/A				
Servery/Pantry	N/A				
Family Room	KENTWOOD OAK 3-1/2" STURGEON				
Living / Dining Room	KENTWOOD OAK 3-1/2" STURGEON				
Main hall	KENTWOOD OAK 3-1/2" STURGEON				
Library	N/A				
Upper Hall	KENTWOOD OAK 3-1/2" STURGEON				
Master Bedroom	OPNEING NIGHT - T20 (STANDARD UNDERPAD)				
Bedroom 2	OPNEING NIGHT - T20 (STANDARD UNDERPAD)				
Bedroom 3	OPNEING NIGHT - T20 (STANDARD UNDERPAD)				
Bedroom 4	OPNEING NIGHT - T20 (STANDARD UNDERPAD)				
FIREPLACES					
LOCATION	FAMILY ROOM	MANTLE	NF8		
MIRRORS & ACCESSORIES					
Mirrors	YES	Opt. Crown Moulding	N/A		
Bathroom Accessories	DELETE	Location	N/A		
Purchaser has reviewed the colour chart			SITE & LOT		
FOR TRADE USE			INNISFIL PH2 40N		
Any upgrades in the colour chart must be accompanied with a PES. It is the responsibility of all Trades to inform the builder of any discrepancies on sketches, PES and/or colour charts PRIOR to installation.					
** PAGE 1 OF 2 **			Purchaser Initial	Vendor	

ZANCOR HOMES COLOUR CHART

STAIRS, RAILING & PICKETS & STAIR STAIN				
Stair Stain / Species:	OAK STAIRS - STAIN TO MATCH HARDWOOD AS CLOSE AS POSSIBLE			
Main to 2nd Railing Details:	STANDARD TURNED OAK			
Main to Basement Railing Details:	N/A			
TRIM				
Casing/Baseboards	STANDARD			
Interior Doors	STANDARD			
Interior Door Hardware	STANDARD			
Exterior Door Hardware	STANDARD			
PAINT				
THROUGHOUT	WARM GREY			
PLUMBING- UPGRADES TO BE DETAILED ON PES				
	FIXTURES	FAUCETS	NOTES	
Kitchen	STANDARD	STANDARD	UNDERMOUNT	
Servery	STANDARD	STANDARD		
Powder room	STANDARD	STANDARD		
Master Ensuite	STANDARD	STANDARD		
Twin 2/3	STANDARD	STANDARD		
Ensuite 4	STANDARD	STANDARD		
ZANCOR APPLIANCE REQUIREMENTS-UPGRADES TO BE DETAILED ON PES				
Appliance Package received in 'Schedule E'				
		YES / NO Package Name:		
	UPG (SEE PES)	DECLINED	NOTES	
GAS LINE	NO			
WATERLINE to Fridge	NO			
Hood Fan Venting SIZE	6 INCH			
ELECTRICAL for Built-in Oven	NO			
ELECTRICAL for Built-in Micro / OTR	NO			
ELECTRICAL for Gas Stove / Cooktop	NO			
ELECTRICAL for Bar Fridge	NO			
DISCLAIMER			INITIALS	
Colours of all materials are as close as possible to Builders selection but not necessarily identical due to dye lot variances in manufacturing/manufacturers. Due to construction progress some items may have been pre-selected or installed. In this event the Vendor's selection must be accepted by the purchaser				
Any changes to the colour chart after signing are subject to a \$5000 administration fee plus costs				
Purchaser has checked and acknowledged accuracy of colour and selections before signing.				
SITE:	INNISFIL PH2	LOT: 40N		
PURCHASER(S):	INVENTORY			
HOME #/CELL #	SIMONE 416-843-7270		Purchaser Signature	
EMAIL:	SIMONE@ZANCORHOMES.COM		Date	
DÉCOR NOTES			Purchaser Signature	
			Date	
FOR TRADE USE			D décor Consultant Signature	
Any upgrades in the colour chart must be accompanied with a PES.			Date	
It is the responsibility of all Trades to inform the builder of any discrepancies on sketches, PES and/or colour charts PRIOR to installation.			April 19/19.	
*** PAGE 2 OF 2 ***			Vendor Signature	
			Date	

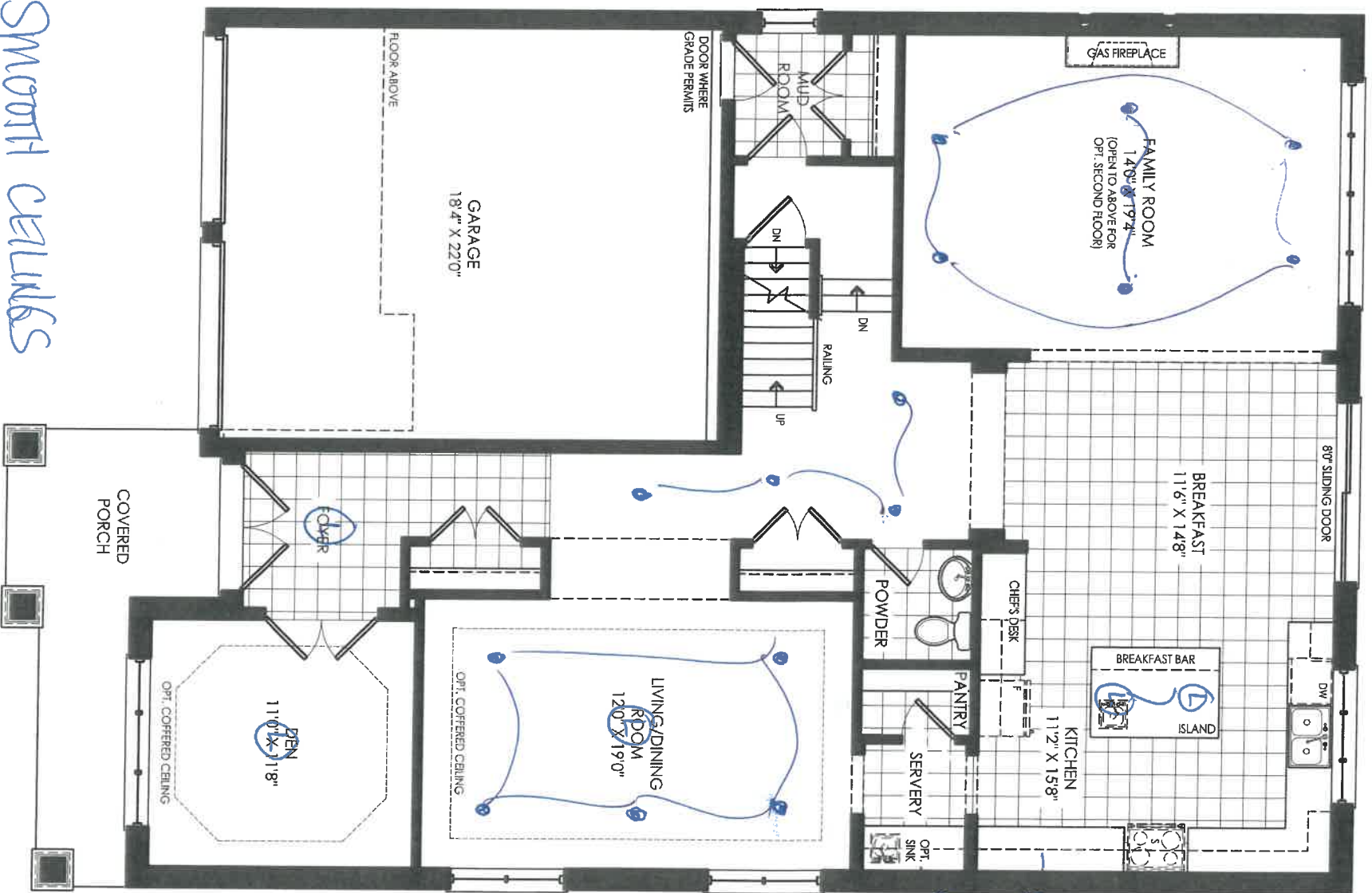

** SMOOTH CEILINGS*

GROUND FLOOR ELEV. 'B'

50-05

LOT 404

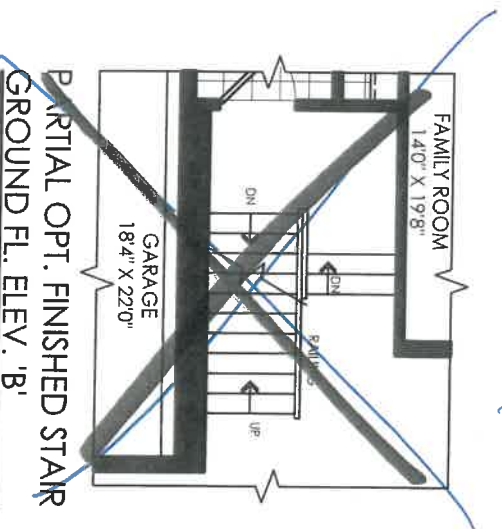
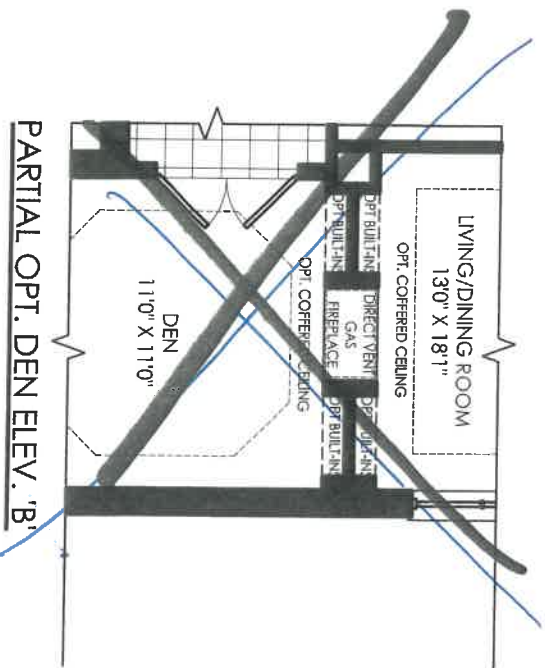

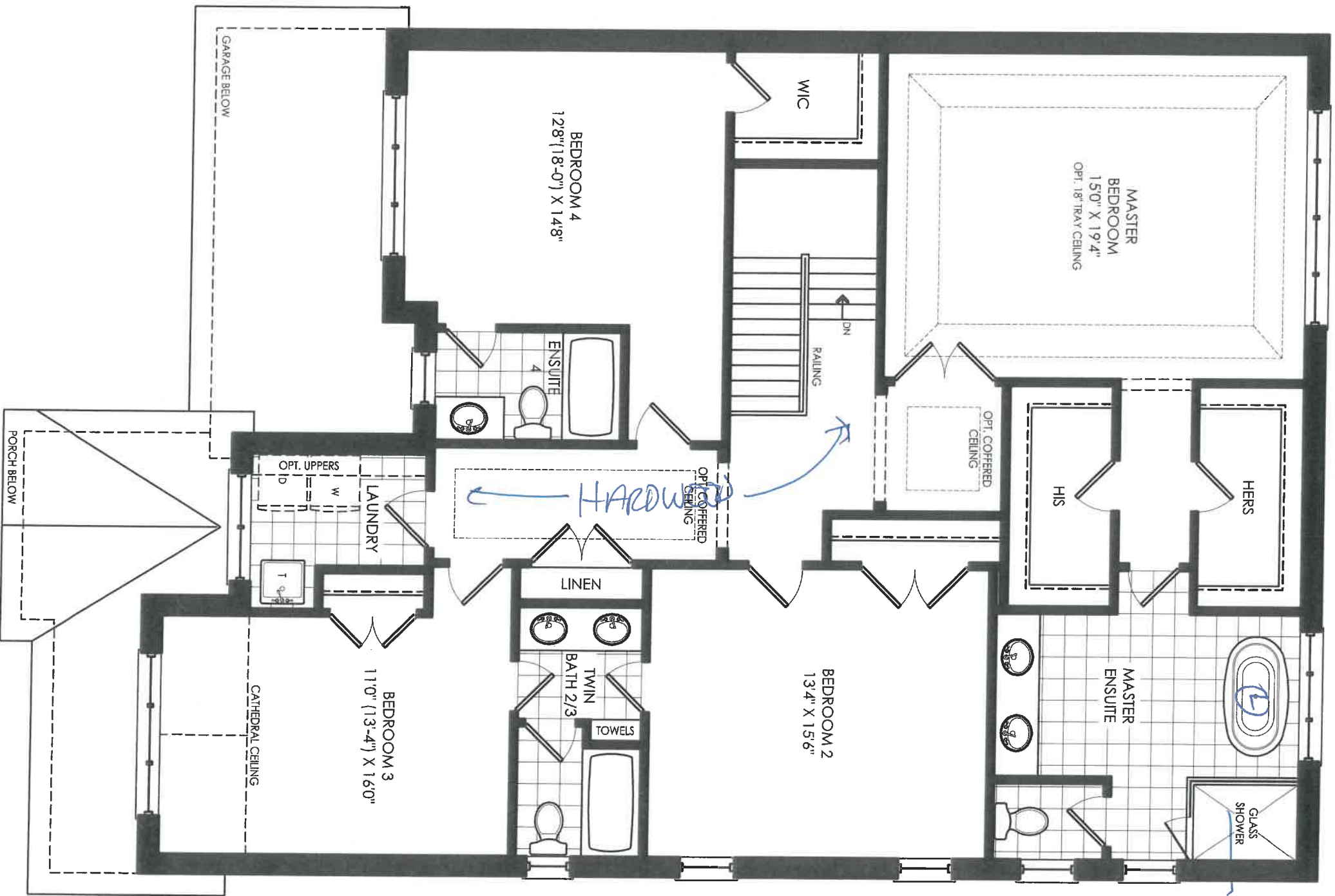

SECOND FLOOR ELEV. 'B'

50-05

LOT 40N

ZANCOR HOMES
EDGE PROFILES (INTERSTONE / REDSTONE)

STANDARD
KITCHENS

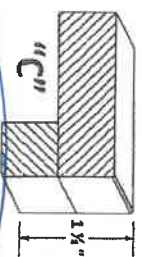

1/2" thick

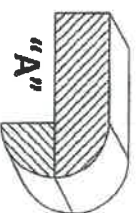
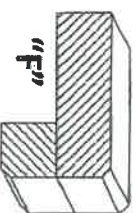
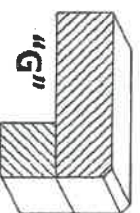
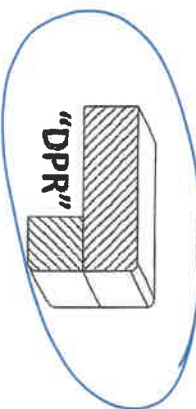

STANDARD
VANITIES

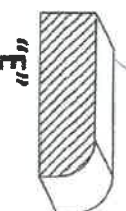
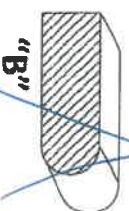
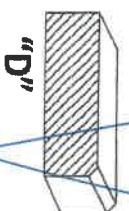
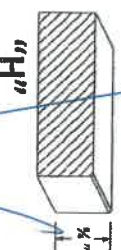

40x

UPGRADE
KITCHENS

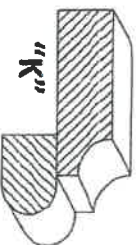
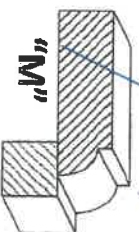
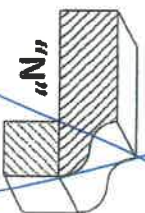
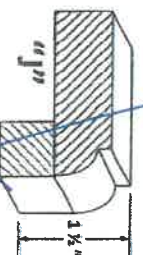
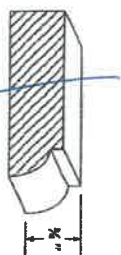

UPGRADE
VANITIES

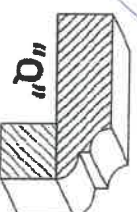
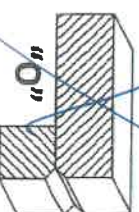
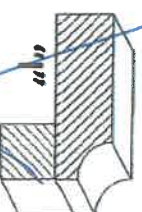
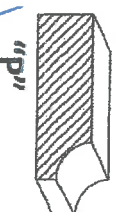

IN/ISFIL 40x

LOT / SITE

PURCHASER SIGNATURE

STANDARD CABINET HARDWARE

(New Image Kitchens)

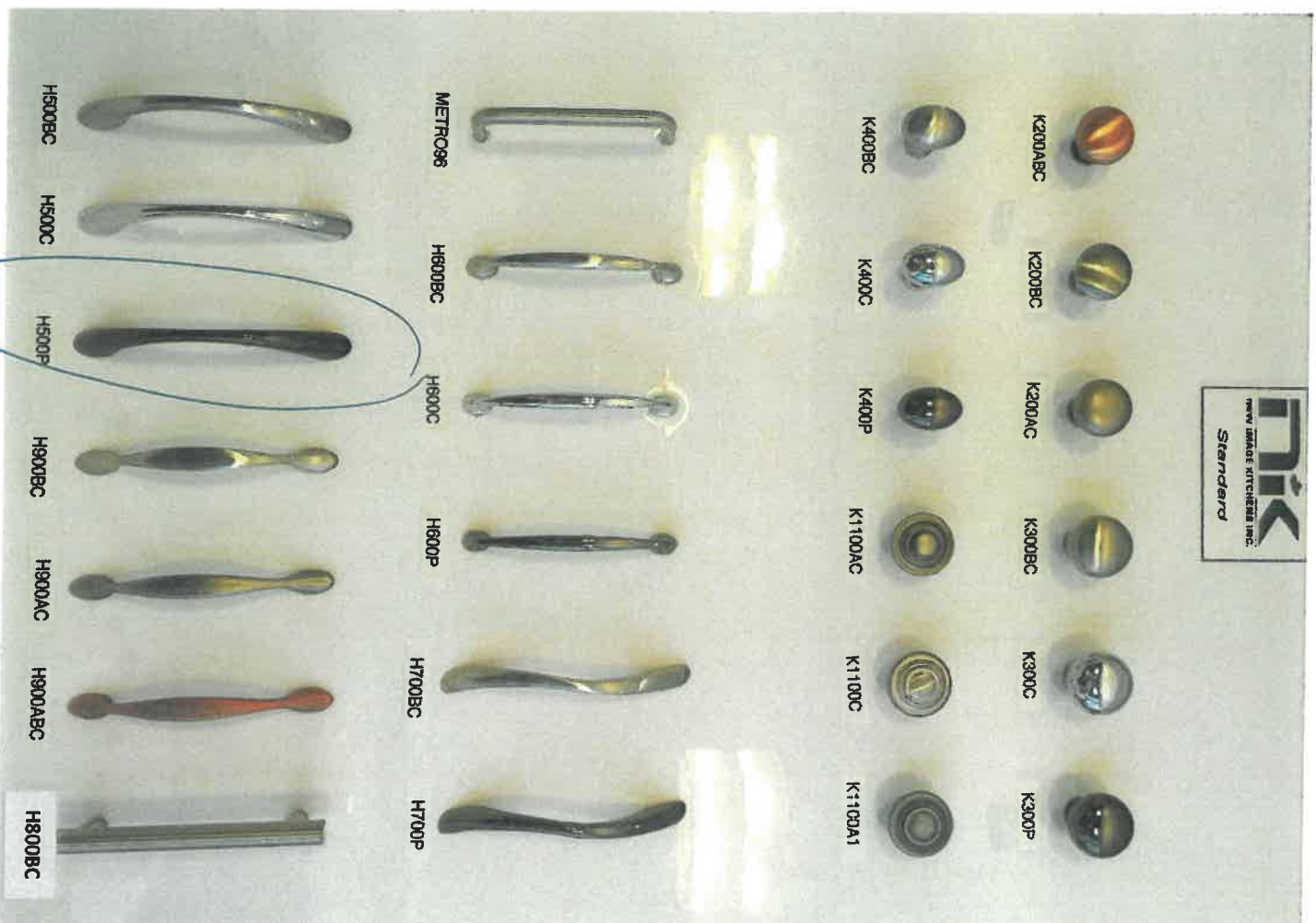

KITCHEN - H500P
BATHS - H500P

New Image Kitchens Inc.	
Scale:	Approved by:
Date: 24/02/17	Drawn by: MGER
	Revised:
BELLE AIR SHORES, INNISFIL	Drawing number:

MODEL: 50-05



40N

Scale:	Approved by:	Drawn by: MGER
Date: 14/10/15		

Approved by:

Drawn by: **MGER**
Revised:

Drawing number:

MODEL: 50-05

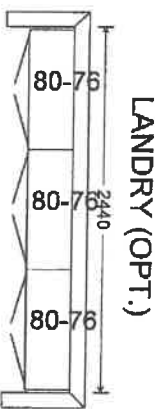

- ② Broken glass wraps in severely

- ③ Revealed Glass W/Presid Module

- if growth moulding

- 116th VAVANCE

6. ANALYST CATEGORY

- 7) BEVELLED GLASS TONS

NOTES



APPLIANCE ACKNOWLEDGEMENT

- ▶ NOTE: Any upgraded appliances are to be paid by the Purchaser, directly to the appliances company.
- ▶ Additional charges to the Purchaser may apply for cabinetry, electrical and plumbing in order to accommodate the specs given by the homeowner.
- ▶ It is the Purchaser's responsibility to provide Zancor Homes with the correct specification for each appliance where it exceeds the standard openings. Zancor Homes will not be responsible for appliances not fitting due to late changes.
- ▶ It is the Purchasers responsibility to coordinate delivery, installation and hook up of appliances and to ensure they are installed as per Manufacturers specifications after closing.
- ▶ Standard appliance openings are approximate and the minimum required. Sizes may vary due to onsite condition and/or when modifications have been made to the cabinetry.

STANDARD OPENINGS ACCEPTED BY PURCHASER:

HOMEOWNER SIGNATURE

- Fridge** ▶ 36" (+/-) x 74" (+/-)
**Space above the fridge is required due to proper air flow
- Stove** ▶ 30"
- Dishwasher** ▶ 24"
- Hood Fan Opening** ▶ 30"
- Hood fan Vent** ▶ 6"

Appliance Specs are DUE (if not received during appointment)
2 WEEKS FROM SIGNED DATE ABOVE
Specs that require changes/modifications after this date will not be accepted

UPGRADE APPLIANCE OPENING REQUIREMENTS:

HOMEOWNER SIGNATURE

- FRIDGE**
- ☐ Built-In
 - ☐ Paneled / Integrated
 - ☐ Flush Inset
 - ☐ Water Line Required

- RANGE**
- ☐ 36"
 - ☐ 48"
 - ☒ Gas
 - ☐ Induction
 - ☐ Cooktop (Apron front)
 - ☐ Cooktop (Dropin)
- **Cut-out charge required for cooktop

- HOOD FAN & VENT**
- ☐ Under Cabinet
 - ☐ Chimney (centre vent)
 - ☒ Insert / Liner
 - ☒ 6 Inch
 - ☐ 8 Inch
 - ☐ 10 Inch

- WALL OVEN & MICRO**
- ☐ Single Oven
 - ☐ Double Oven
 - ☐ Steam Oven
 - ☐ Warming Drawer
 - ☒ Over the Range Microwave
 - ☐ Built-in Microwave (*trim kit required)

DATE April 19 SITE 11119th LOT 401

** Any upgrades checked in this appliance form must be accompanied with specs provided by the Purchaser.
It is the responsibility of the trades to inform the Builder of any discrepancies with specs, sketches, extras and/or colour chart PRIOR to production/installation. **

INTERIOR FINISHES ACKNOWLEDGEMENT / WAIVER

Purchaser accepts and acknowledges that the Builder reserves the right to substitute materials with those of equal or better quality where the manufacture, scheduling or delivery of materials may directly impact the Builder's ability to meet its' contractual obligations under the Agreement of Purchase and Sale.

UPGRADES/EXTRAS: All upgrades and additional selections indicated on the colour chart must be accompanied by an upgrades/extras sheet (PES) and full payment otherwise the selection will be invalid. All colour charts and upgrades/extras will not proceed until verified and signed by an authorized signing officer at the Vendor's head office. **CHANGES WILL NOT BE PERMITTED UPON COMPLETION AND SUBMISSION OF THE COLOUR CHART.**

PORCELAIN & NATURAL STONES: Due to the properties of natural stones including but not limited to **marble, granite, quartz**, no two pieces are exactly the same. Variations in colour, tone, granularity (pitting, fissures) and pattern are to be expected, including various lighting may affect the overall finished look. Stone tops are sealed at time of installation and should never be cleaned with lemon oil or vinegar. Stones are porous materials, therefore any spilled substance require immediate attention. Stone countertops require regular seal re-application as part of home maintenance. Purchaser acknowledges colour and product variations as well as natural imperfections may exist with the selection of natural stone materials and shall not hold the Vendor liable for provision of same.

STONE COUNTERTOP JOINTS: Purchaser is aware that one joint will be at each corner and on either side of slide-in-range (if applicable). It will also be where the length of the counter top exceeds the length of a stone slab. Slabs are usually approximately 5'x 8'.

CERAMIC TILES: Due to manufacturing, shade (dye lots), product variations may exist that can affect the overall look of the finished product. Although every effort will be made to ensure the colours and materials selected are as close as possible to the samples, the purchaser acknowledges that the sample tiles supplied in the Design Centre may not be identical to the materials installed in the home.

STAIR STAINS: Due to the natural properties of wood, many variables can affect the overall look of the finished product. Factors including but not limited to wood type, knotting, graining, density, age, humidity, and air temperature can result in substantial variations in stain intensity. The purchaser accepts that although the Vendor will do their best to match stain the unfinished stairs as close as possible to the pre-finished floors, it is not possible to have an identical match and that there MAY be shade differences between the two products.

CABINETRY: Due to the natural properties of wood, slight variations apparent with cabinetry are to be expected. This includes but not limited to wood species, wood grain, colour, finish, product variations, and natural imperfections are all factors that may affect the overall look of the finished product. Such factors make exact colour matching impossible. The type and intensity of lighting in the areas of designated cabinetry placement may also highlight characteristics of cabinetry finish. All cabinets shall be finished with a white melamine interior box unless a finished interior is upgraded. Due to building specifications and/or on-site conditions, certain cabinetry upgrades may not be possible. The purchaser acknowledges that the Builder cannot guarantee the cabinetry finish or provision of certain upgrades and shall not hold the Builder liable for provision of same.

UPGRADES/EXTRAS: All upgrades and additional selections indicated on the colour chart must be accompanied by an upgrades/extras sheet (PES) and full payment otherwise the selection will be invalid. All colour charts and upgrades/extras will not proceed until verified and signed by an authorized signing officer at the Vendor's head office. **CHANGES WILL NOT BE PERMITTED UPON COMPLETION AND SUBMISSION OF THE COLOUR CHART.**

HARDWOOD / LAMINATE FLOORING: Due to the properties of wood and laminate, many variables can affect the overall look of the finished product. Variations include but not limited to wood type or laminate finish, colour/stain and wood grain are significant factors that make exact colour matching impossible. The purchaser acknowledges that the hardwood flooring is a pre-finished product in a controlled environment. Expansion, compression and cupping are characteristics of hardwood flooring once installed in the home. The purchaser acknowledges these may become apparent over time and despite the Builders' efforts to install the hardwood flooring materials in keeping with good workmanship, the Builder shall not be responsible nor held liable for minor variances of fluctuation in hardwood flooring materials.

HARDWOOD / LAMINATE WAIVER:

I/We understand hardwood flooring is classified as a porous material and as such not recommended by the Builder in certain areas. I/We understand there is a concern due to possible water and other substances being frequently splashed or spilled onto the floor and in contravention of Ontario Building Code Section 9.30.1.2(1).

"Finished flooring bathrooms, kitchens, public entrance halls, laundry & general storage areas shall consist of resilient flooring, felted-synthetic-fibre floor coverings, concrete, terrazzo, ceramic tile, mastic or other types of flooring providing similar degrees of water resistance."

I/We are prepared to assume full responsibility for any damage caused to the hardwood floor or subfloor due to moisture absorberency in the mentioned areas, and agree to waive any claims against the Township of residence, TARIOR and/or the Builder in relation to the matter.

****SEE COLOUR CHART FOR LOCATIONS****

SITE 1NN6FL

LOT 40N

DATE APR 4/19

COMFORT SERIES
ASTI

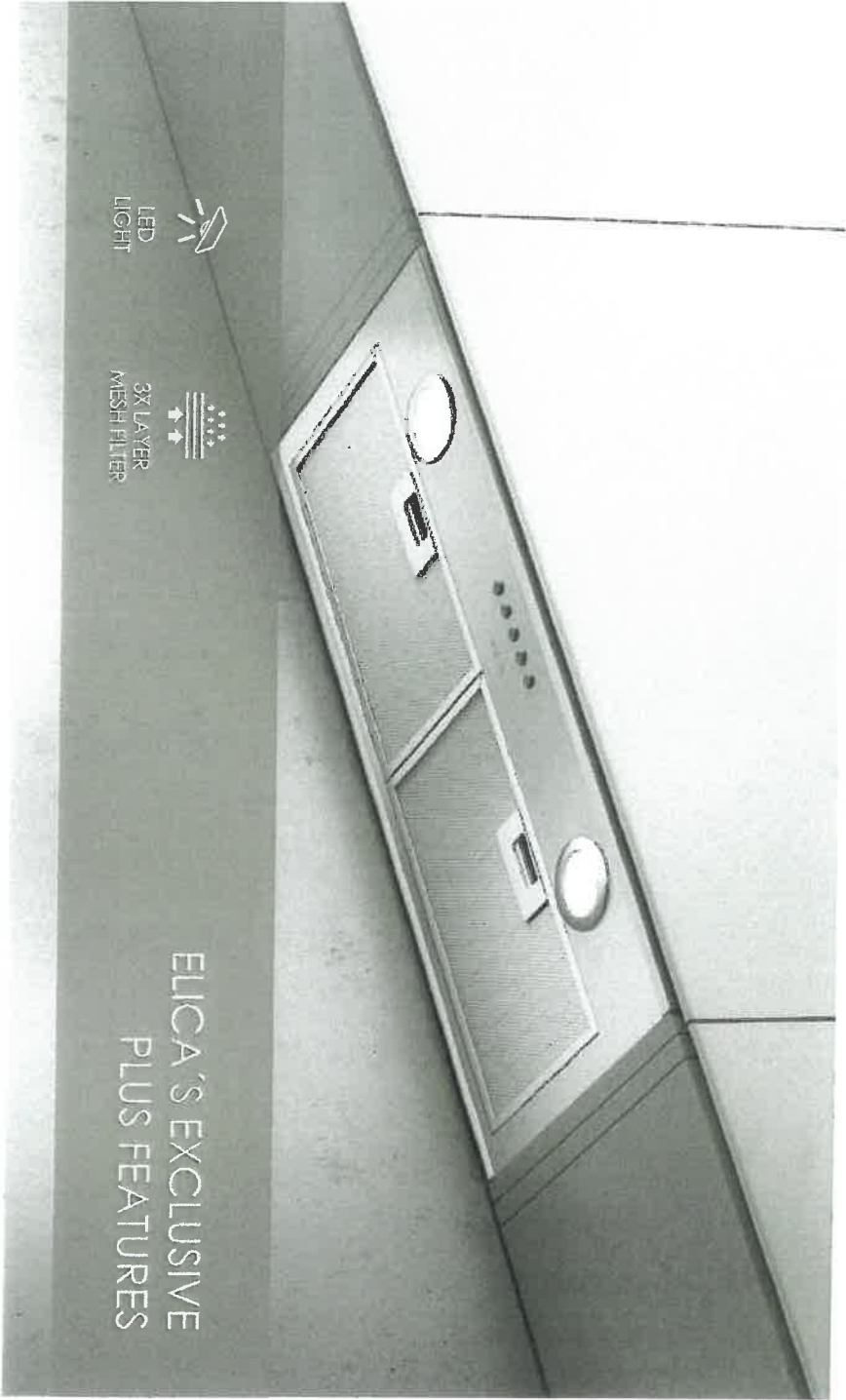

Asiti is designed for discreet mounting inside cabinetry, fits perfectly into 12" deep cabinetry and is ideal for kitchens where space is limited or the range hood needs to be out of sight.
Asiti comes equipped with a powerful 400 CFM blower that can handle most cooking needs.
Convenient Backlit Electronic Push Button Controls operate the 3 speed blower and LED lighting, while dishwasher safe anodized aluminum mesh filters offer easy maintenance.
Asiti is designed for standard ducted or recirculating installation.

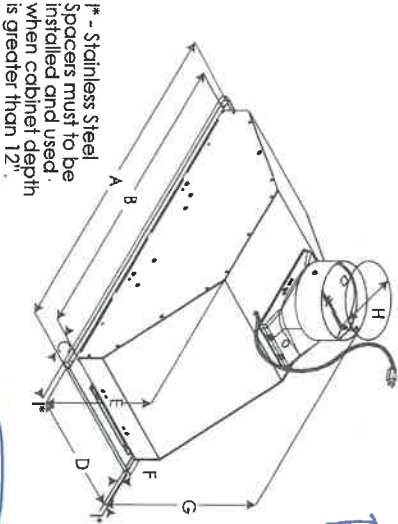
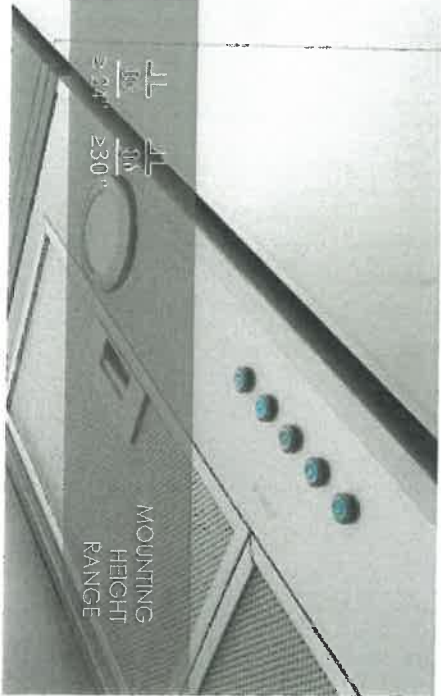

	<u>EAS4228S</u>	<u>EAS428S1</u>
A	22 1/4" (57.1 cm)	28 1/4" (71.8 cm)
B	19 1/8" (50 cm)	26" (66 cm)
C	1 3/4" (2.9 cm)	
D	10 3/4" (27.3 cm)	
E	9 1/32" (24.2 cm)	
F	5 1/8" (1.85 cm)	
G	14 3/8" (37 cm)	
H	6" (15.2 cm)	
I*	1/2" (1.27 cm)	

400

EAS428S

SPECIFICATIONS

	24" Unit EAS42SS	28" Unit EAS428S1
Model:		
Dimensions:	22 1/4 "W x 10 3/4"D x 9 1/2" H	28 1/4 "W x 10 3/4 "D x 9 1/2" H
Blower Type(internal):		
Blower Performance:	400 CFM (3-speed)	
Speed 1	160 CFM	
Speed 2	280 CFM	
Speed 3	400 CFM	
Noise (sones):	Min: 1.5, Max: 5.9	
Working Speed		
Finish:	Stainless Steel	
Controls:	Backlit Push Button 3-Speed	
Illumination:	2 LED, 2.1 Watts	
Filter Type:	Dishwasher-Safe, Aluminum Mesh Filter 1	
Aluminum Mesh Filters:	6" Round with Back Draft Damper (top only) 2	
Duct Transition:	Ducted (Recirculating Kit sold separately)	
Installation Type:	120V - 60 Hz 289 Watts at 2.43 Amps	
Electrical:		
KITS:		
Recirculating Kit with 2 carbon filters:	KIT02770	
30" Hood Liner (29"Wx17 1/2"-20 1/2"D):	KIT02773	
36" Hood Liner (35"Wx17 1/2"-20 1/2"D):	KIT02774	
	*Liner accessories are only available for the EAS428S1 model	
CONSUMABLE PARTS:		
Grease Filter (1):	GF08PA	GF08P
Carbon Filter(1):	FB016A	FB016A
Light Bulb (1):	LMP0117673	
	*Consumable parts are sold in units of one (1). Order accordingly	

PLUS FEATURES



LED LIGHT - LED lighting is undoubtedly the smartest solution in terms of energy saving.
Expected life time of over 20,000 hours.



3X LAYER MESH FILTER - Elica aluminum mesh filters are a step above competition, featuring triple layered, anodized aluminum that is woven into highly dense mesh. The thick mesh captures more grease, anodization helps resist staining and provides durability to repeated cleanings in the dishwasher.

40W



Undercounter Dishwasher

PRODUCT MODEL NUMBERS

WDF110PAB	WDF320PAD	WDT710PAH
WDF111PAB	WDF330PAH	WDT720PAD
WDF120PAF	WDF331PAH	WDT730PAH
WDF121PAF	WDF520PAD	WDT735PAG
WDF130PAH	WDF540PAD	WDT735PAH
WDF131PAH	WDF545PAF	

DRAIN REQUIREMENTS

- A new drain hose is supplied with your dishwasher. If drain hose is not long enough, use a new drain hose with a maximum length of 12 ft (3.7 m) that meets all current AHAM/IAPMO test standards, is resistant to heat and detergent, and fits the 1" (25 mm) drain connector of the dishwasher. See the "Tools and Parts" section at the front of the guide for part details and orders.
- Make sure to connect drain hose to waste tee or disposer inlet above drain trap in house plumbing and 20" (508 mm) minimum above the floor. It is recommended that the drain hose either be looped up and securely fastened to the underside of the counter or be connected to an air gap.
- Make sure to use an air gap if the drain hose is connected to house plumbing lower than 20" (508 mm) above subfloor or floor.

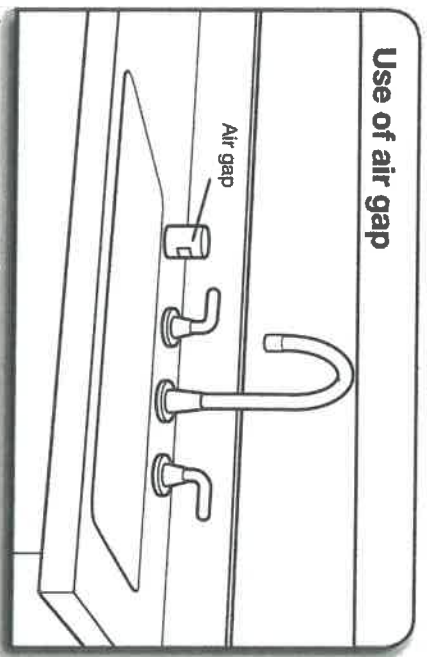

- If required, the air gap should be installed in accordance with the air gap installation instructions. When you are connecting the air gap, a rubber hose (not provided) will be needed to connect to the waste tee or disposer inlet.
- Use 1/2" minimum I.D. drain line fittings.

WATER SUPPLY REQUIREMENTS

- This dishwasher has a water heating feature and also requires a connection to a hot water supply line.
- A hot water line with 20 to 120 psi (136 to 862 kPa) water pressure can be verified by a licensed plumber.
- 120°F (49°C) water at dishwasher
- 3/8" O.D. copper tubing with compression fitting or flexible braided water supply line. See the "Tools and Parts" section at the front of the guide for part details and orders.

NOTE: 1/2" minimum plastic tubing is not recommended.

- A 90° elbow with 3/4" hose connection with rubber washer. See the "Tools and Parts" section at the front of the guide for part details and orders.
- Do not solder within 6" (152 mm) of the water inlet valve.
- If installed in new construction, make sure the house water supply lines have been flushed prior to connecting the dishwasher to remove any debris that may exist in the supply line.

NOTE: If replacing an existing dishwasher, it is recommended to install a new water line (see the "Tools and Parts" section at the front of the guide for part details) and drain hose (supplied) with the new dishwasher.

ELECTRICAL REQUIREMENTS

You Must Have:

- 120-volt, 60 Hz, AC-only, 15- or 20-amp, fused electrical supply
 - Copper wire only
 - A maximum of 2 field wiring supply conductors (12 AWG largest size) plus 1 grounding conductor are permitted in the terminal box.
- We Recommend:
- A time-delay fuse or circuit breaker
 - A separate circuit

If Connecting Dishwasher with a Power Cord:

- Use a UL Listed power cord kit marked for use with dishwasher. See the "Tools and Parts" section at the front of the guide for part details and orders.

- Plug into a grounded 3 prong outlet. Outlet must meet all local codes and ordinances.

If Connecting Dishwasher with Direct Wiring:

- Use flexible, armored, or nonmetallic sheathed copper wire with grounding wire that meets the wiring requirements for your home and local codes and ordinances.
- Use a UL Listed/CSA Approved metallic strain relief.



Because Whirlpool Corporation policy includes a continuous commitment to improve our products, we reserve the right to change materials and specifications without notice.

Dimensions are for planning purposes only. For complete details, see installation instructions packed with product. Specifications subject to change without notice.

40N

PRODUCT AND CABINET OPENING DIMENSIONS

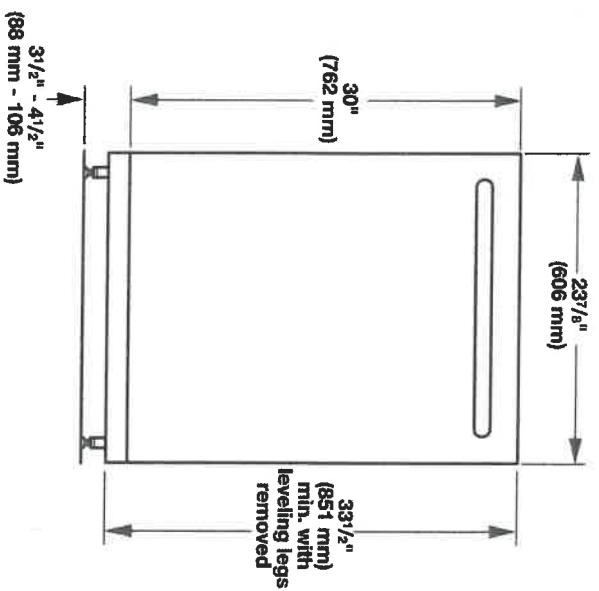

For 4" (100 mm) toe kick, height of cabinet opening is 34½" (863 mm).

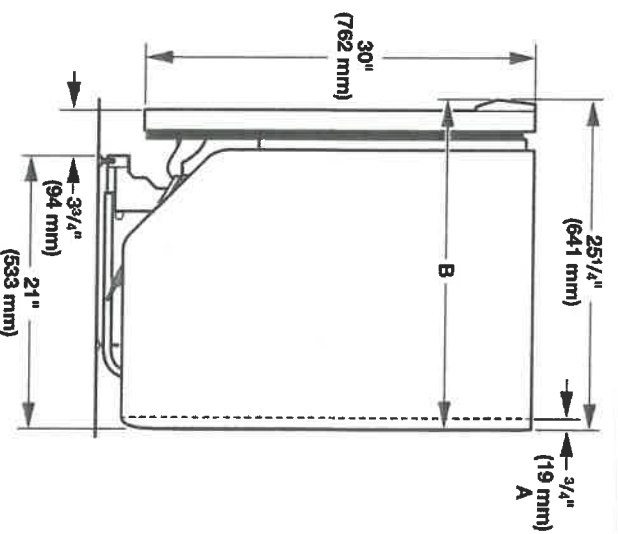

A. Insulation may be compressed (not used on all models).

B. Door handles may protrude forward of the face of the dishwasher, (varies by model).

Check that all surfaces have no protrusions that would prohibit dishwasher installation.

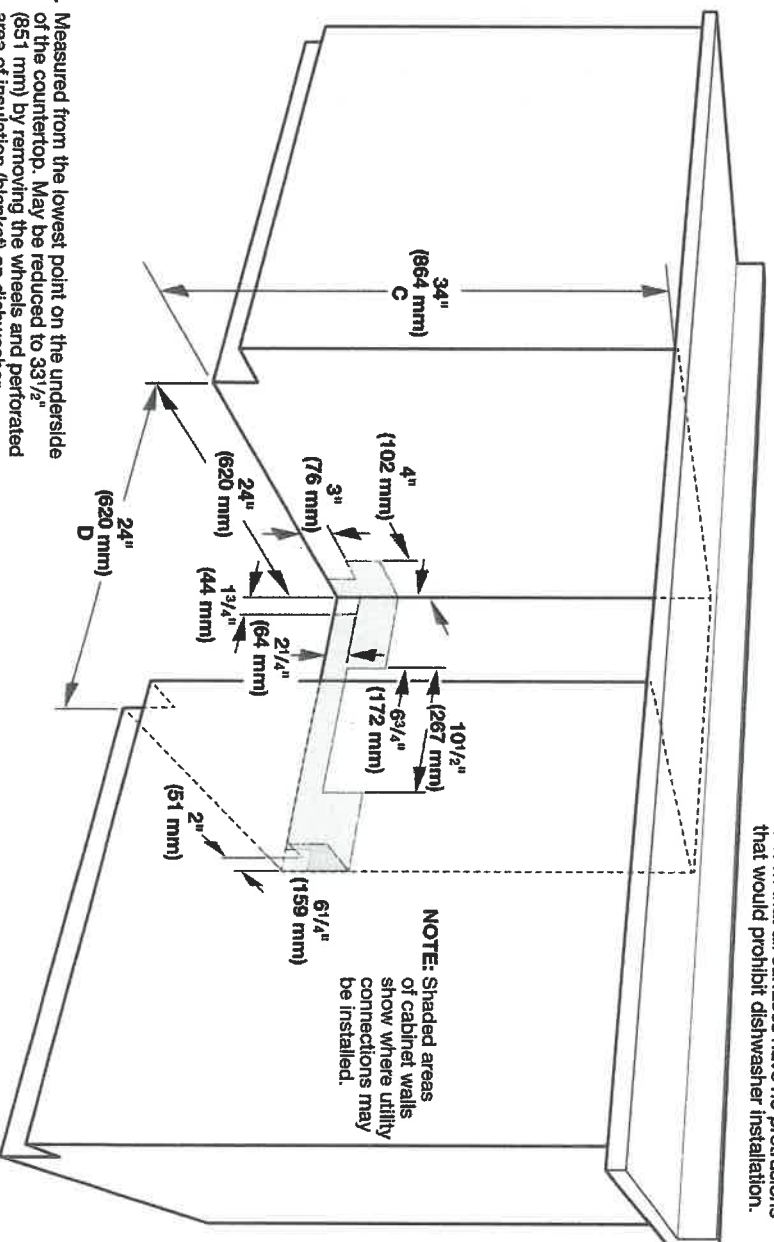

C. Measured from the lowest point on the underside of the countertop. May be reduced to 33 1/2 (851 mm) by removing the wheels and perforated area of insulation (blanket) on dishwasher.

D. Minimum, measured from narrowest point of opening.

Because Whirlpool Corporation policy includes a continuous commitment to improve our products, we reserve the right to change materials and specifications without notice.

Dimensions are for planning purposes only. For complete details, see installation instructions packed with product. Specifications subject to change without notice.

Page 2 of 2
W10806908-D-WH
12/16

$$\frac{5}{2}$$



French Door Bottom Mount Refrigerator

PRODUCT MODEL NUMBERS

WRF532SMH WRF536SMH
WRF540CWH

Electrical: A 115 V, 60 Hz, AC only 15 or 20 A fused, grounded electrical supply is required. It is recommended that a separate circuit serving only your refrigerator be provided. Use an outlet that cannot be turned off by a switch. Do not use an extension cord.

NOTE: Before performing any type of installation, cleaning, or removing a light bulb, turn the control (Thermostat, Refrigerator or Freezer Control depending on the model) to OFF and then disconnect the refrigerator from the electrical source. When you are finished, reconnect the refrigerator to the electrical source and reset the control (Thermostat, Refrigerator or Freezer Control depending on the model) to the desired setting. See "Using the Controls."

Water: A cold water supply with water pressure between 35 and 120 psi (241 and 827 kPa) is required to operate the water dispenser and ice maker. If you have questions about your water pressure, call a licensed, qualified plumber.

IMPORTANT: The pressure of the water coming out of a reverse osmosis system going to the water inlet valve of the refrigerator needs to be between 35 and 120 psi (241 and 827 kPa).

Reverse Osmosis Water Supply:

If a reverse osmosis water filtration system is connected to your cold water supply, the water pressure to the reverse osmosis system needs to be a minimum of 40 to 60 psi (276 to 414 kPa).

PRODUCT DIMENSIONS

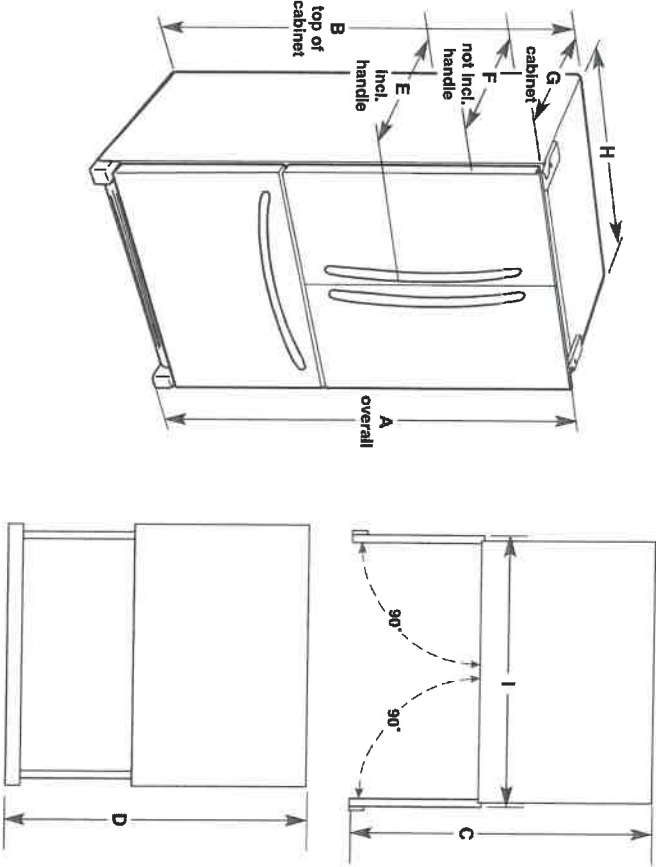

Model Number	Model Size	Height - Overall "A"	Height - Top of Cabinet "B"	Depth - Doors Open 90° "C"	Depth - Drawer Open "D"	Depth - With Handles "E"	Depth - Without Handles "F"	Depth - Cabinet Only "G"	Width - Cabinet "H"
WRF532SMH	22 1/8" cu. ft.	70 5/8" (178.1 cm)	68 5/8" (174.9 cm)	47 1/8" (119.7 cm)	52 1/8" (132.4 cm)	34 1/2" (87.4 cm)	33" (83.8 cm)	29 1/8" (73.9 cm)	35 3/8" (90.5 cm)
WRF536SMH	25 1/5" cu. ft.	70 5/8" (178.1 cm)	68 5/8" (174.9 cm)	48 5/8" (122.2 cm)	52 1/8" (132.4 cm)	35 1/2" (89.9 cm)	33" (83.8 cm)	29 1/8" (73.9 cm)	35 3/8" (90.5 cm)
WRF540CWH	20" cu. ft.	70 5/8" (178.1 cm)	68 5/8" (174.9 cm)	43" (109.2 cm)	45 3/8" (115.3 cm)	30 1/2" (77.5 cm)	26 7/8" (68.3 cm)	24 1/8" (61.2 cm)	35 3/8" (90.5 cm)

LOCATION REQUIREMENTS

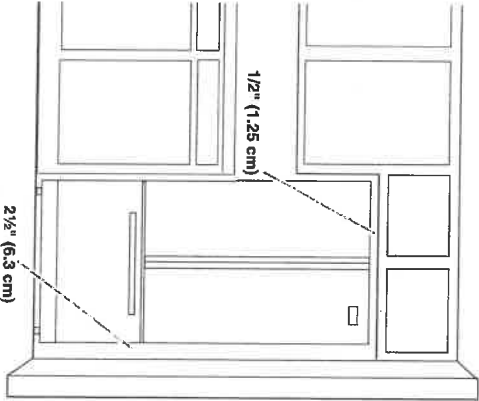

IMPORTANT: This refrigerator is designed only for indoor, household use only.

To ensure proper ventilation for your refrigerator, allow for a 1/2" (1.25 cm) space on each side and at the top. Allow for 1" (2.54 cm) of space behind the refrigerator. If your refrigerator has an ice maker, make sure you leave some extra space at the back for the water line connections. If you are installing your refrigerator next to a fixed wall, leave 2 1/2" (6.3 cm) minimum on the hinge side (some models require more) to allow for the door to swing open.

NOTE: This refrigerator is intended for use in a location where the temperature ranges from a minimum of 55°F (13°C) to a maximum of 110°F (43°C). The preferred room temperature range for optimum performance, which reduces electricity usage and provides superior cooling, is between 60°F (15°C) and 90°F (32°C). It is recommended that you do not install the refrigerator near a heat source, such as an oven or radiator.

Because Whirlpool Corporation policy includes a continuous commitment to improve our products, we reserve the right to change materials and specifications without notice.

Dimensions are for planning purposes only. For complete details, see installation instructions packed with product. Specifications subject to change without notice.

Ref. W0597594E
07/18

400

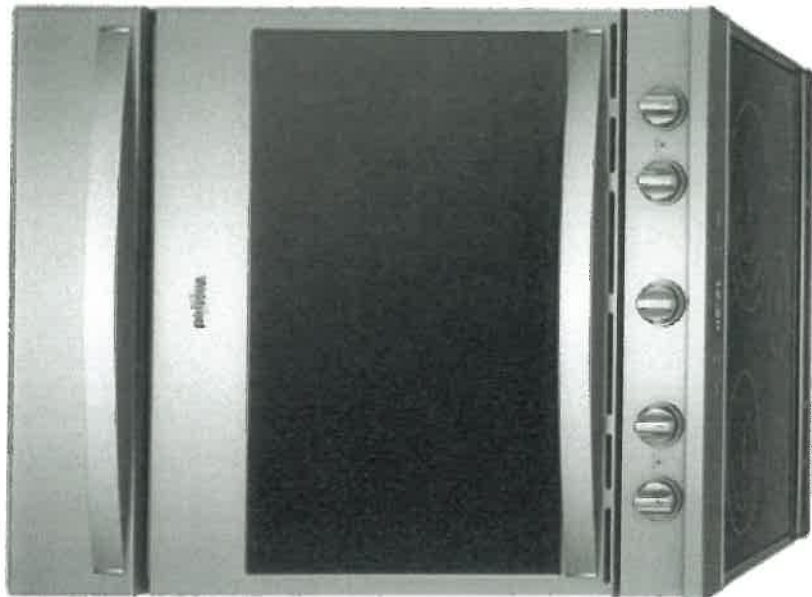

6.4 Cu. Ft. Smart Slide-in Electric Range with Frozen Bake™

Technology

6.4 Cu. Ft. Smart Slide-in
Electric Range with Frozen
Bake™ Technology is rated
3.9 out of 5 by 27.

Model #: YWEE750H0HZ



4017

Specifications

Dimensions

Depth	72.71 cm, 28-5/8 in
Depth Closed Excluding Handles	68.58 cm, 27.0 in
Depth Closed Including Handles	72.71 cm, 28-5/8 in
Depth With Door Open 90 Degree	124.14 cm, 48-7/8 in
Height	91.44 cm, 36.0 in
Width	75.88 cm, 29-7/8 in

Configuration and Overview

Fuel Type	Electric
Range Type	Slide-in
Size	76.20 cm, 30 in

Oven Details

Automatic Convection Conversion Temperature Adjust	Yes
Automatic Shut-Off	No
Bake Element Power	3600W
Broiler Location	Top of Oven
Convection Element Type	True
Convection Functions	Bake, Broil, Roast
Door Removable	Yes
Drawer Type	Storage Drawer
Hidden Bake Element	Yes
Interior Color	Grey

Store

4D N