



PURCHASER'S ESTIMATE (PE) REQUEST & REQUEST TO AMEND THE
AGREEMENT OF PURCHASE AND SALE

PURCHASER: **MODEL HOME**

TEL: RES.:

LOT NUMBER		PHASE	HOUSE TYPE		PRINT DATE
19		1	Beaumont (50-05) Elev B		24-Jan-18
Item	Ref#	Quantity	Description		Addition to Purchase Price
1	4631		FINISHED BASEMENT - SEE PLAN - INCLUDES: 1. GYM with GLASS WALL AND DOOR **Trimmed flat arch if possible 2. FURNACE ROOM - Drywall walls & ceiling, floor unfinished 3. BEDROOM - Closet w/frameless mirror bi-fold doors, EGRESS WINDOW 4. REC ROOM		
2	4632		FINISHED BASEMENT BATHROOM - 1. To be same length as furnace room 2. Shorten Vanity to accomdate open shelves 3. FRAMELESS GLASS SHOWER in lieu of tub 4. TOILET, UNDERMOUNT SINK 5. Floor and wall tiles		
3	4633		STAIRS - 1. REMOVE 2 base landing/stairs on main floor and install standard treads with square edge 2. OPEN TO BELOW OAK STAIRS FROM MAIN FLOOR TO FINISHED BASEMENT *includes 2 hockey sticks and finished foyer **Railings where applicable		
4	4634		BASEMENT WET BAR - 1. UNDER COUNTER WINE/BAR FRIDGE 2. SINK & FAUCET ***To be finalized with kitchen company		
5	4635		BASEMENT WINDOWS - 1. ENLARGE ALL BASEMENT WINDOWS TO BE 30 X 24 2. ADD 2 WINDOWS AT REAR - 30 X 24 3. RIGHT SIDE WINDOW IN REC ROOM - SHIFT TO BE CENTRED WITH FIREPLACE BUMP OUT ***EGRESS REQUIRED AT BEDROOM		
6	4636		CELLINGS - 1. COFFERED in main hall 2. WAFPLE in library 3. RAISED 18 INCH COFFERED in upper hall at stairs		
7	4637		CELLINGS - 1. COFFERED ceiling in master ensuite where vanity is 2. COFFERED ceiling in master ensuite where tub area is **NOTE Drop ceiling to 8 feet above shower area only ***REVISED MASTER ENSUITE		
8	4638		LAUNDRY ROOM - 1. INSULATE ALL WALLS OF LAUNDRY ROOM ON SECOND FLOOR 2. CHANGE LOCATION OF LAUNDRY ROOM DOOR		
9	4639		MASTER ENSUITE - 1. OPENING from bedroom to bathroom to be 36 INCHES by extending the nib walls approx 1 foot from the closet side of openings 2. Delete double doors to closet. ADD single door in new location		
10	4640		MASTER ENSUITE - INFINITY DRAIN		
11	4667		FRAMELESS GLASS SHOWER in ensuite 2/3 & 4		



PURCHASER'S ESTIMATE (PE) REQUEST & REQUEST TO AMEND THE
AGREEMENT OF PURCHASE AND SALE

PURCHASER: *Model Home*

TEL: RES.

LOT NUMBER		PHASE	HOUSE TYPE		PRINT DATE
19		1	Beaumont (50-05) Elev B		24-Jan-18
Item	Ref#	Quantity	Description		Addition to Purchase Price
12	4668		PLUMBING - MASTER ENSUITE **BRUSHED NICKEL TUB - Maax Ariosaa 6636 Model #106267 *COLOUR 019 THUNDER GREY TUB FAUCET - VOSS 4 PCE SHOWER - 4 JETS, 8.5" RAINHEAD & SLIDEBAR TOILET - CONTRAC KIERRA SINKS - TOTO LT533 FAUCETS - VOSS WIDESPREAD		
13	4669		PLUMBING - ADD SLIDE BAR to all standards and larger shower head in Ensuite 2/3, Ensuite 4, Basement bath		
14	4670		PLUMBING - ENSUITE 5 Moen Align Annex Shower Rail **with toe tester in lieu of standard		
15	4671		PLUMBING - MOEN BATHROOM ACCESSORIES 1. GENTA BH3808 paper holder, BH3824 24 inch towel bar in Ensuite 2/3, 4, 5 & basement bath 2. VOSS in paper holder, 24 inch towel bar master ensuite		
16	4672		ELECTRICAL - LED POTLIGHTS (4) foyer, delete std (4) in library, delete std (4) in hall at stairs, separate from standard (1) in furniture niche, sep switch (3) hall in front of dining room, delete std (2) powder HALL		
17	4673		ELECTRICAL - LED POTLIGHTS (6) dining room between two coffered ceilings on sep switch, std remains (10) great room, delete std (4) breakfast on sep switch, std remains (6) kitchen sep switch (1) powder room on same switch as wall sconces Std kitchen light to be over island along with additional capped		
18	4674		ELECTRICAL - LED POTLIGHTS (6) Master bed on sep switch, std remains (4) bedroom 2 on sep switch, std remains (5) bedroom 3 on sep switch, std remains (4) bedroom 4 on sep switch, std remains (4) bedroom 5 on sep switch, std remains		
19	4675		ELECTRICAL - LED POTLIGHTS (9) upper hall, delete std (3) laundry, delete std (3) ensuite 5, same switch as standard (1) ensuite 5 SHOWER POT (2) ensuite 2/3 on same switch as standard - standard on wall above each sink (2) ensuite 2/3 water closet		
20	4676		ELECTRICAL - LED POTLIGHTS (3) ensuite 4 on same switch as standard (1) master ensuite inside coffer, sep switch (3) master tub area on sep switch, see location of std (6) master walk in closet (2) in EACH closet, B2, 3, 4, 5 **POTS IN B2, 3, 4, 5 WALK IN CLOSETS TO BE ON DOOR JAMB SWITCHES		



PURCHASER'S ESTIMATE (PE) REQUEST & REQUEST TO AMEND THE
AGREEMENT OF PURCHASE AND SALE

PURCHASER: *MODEL HOME*

TEL: RES.

LOT NUMBER		PHASE	HOUSE TYPE		PRINT DATE
19		1	Beaumont (50-05) Elev B		24-Jan-18
Item	Ref#	Quantity	Description		Addition to Purchase Price
21	4677		ELECTRICAL - LED POTTLIGHTS (3) master ensuite same switch as shower (2) master ensuite toilet area, delete std		
22	4678		ELECTRICAL - LED POTTLIGHTS (4) basement foyer, delete std (8) gym, delete std (4) basement area in front of gym, delete std (7) basement hall, delete std (8), (6), (9), basement rec room, delete std (4) basement bath with std		
23	4679		10 FOOT MAIN FLOOR CEILING HEIGHT - INCLUDES taller windows, 8 foot high interior doors 9 FOOT SECOND FLOOR CEILING HEIGHT - INCLUDES transoms above windows where applicable, 8 foot high interior doors		
24	4680		ELECTRICAL - WALL SCONCES (2) dining 18" in each end, sep switch 66"H (2) library 18" in each end, sep switch 66"H (2) powder, either side of sink, same switch as pot 66"H (2) master ensuite above each sink 72"H (2) master ensuite make up desk 72"H sconces on wall across from master vanity to match locations		
25	4803		PLUMBING - UNDERMOUNT SINK TOTO LT641 ENSUITE 2/3 (x2) ENSUITE 4 ENSUITE 5 BASEMENT BATH		
26	4804		PLUMBING - POWDER ROOM TOILET - CONTRACT KIERA		
27	4806		FRAMING - MASTER WALK IN CLOSET - 1. CLOSE OFF WALL FROM CLOSET TO VANITY AREA 2. RELOCATE SINGLE DOOR FROM BEDROOM TO WALK IN CLOSET **DOOR TO BE APPROX 24" AWAY FROM WALL TO ALLOW FOR FUTURE BUILT-INS		
28	4807		ELECTRICAL - RECTANGULAR STEP LIGHTS **EVERY OTHER STEP & 3 IN LANDING AREA		
29	4808		FIREPLACE IN LIBRARY **INCLUDES BUMP OUT FOUNDATION		
30	4809		FIREPLACE - L42 MONTIGO LINEAR FIREPLACE GREAT ROOM		
31	4992		ELECTRICAL - EXTERIOR POTS (1) LEFT SIDE (1) RIGHT SIDE (2) 2ND FLOOR ABOVE PORTICO (EITHER SIDE OF WINDOW) (2) 2ND FLOOR ABOVE GARAGE (EITHER SIDE OF WINDOW) (2) CORNERS OF GARAGE		
32	5443		PLUMBING - POWDER ROOM SINK - KOHLER K-2373 FAUCET - DELTA TESLA ***WALL MOUNT*** T3552L5-WL (POLISHED NICKEL)		

PURCHASER'S ESTIMATE (PE) REQUEST & REQUEST TO AMEND THE
AGREEMENT OF PURCHASE AND SALE



PURCHASER: MODEL HOME

TEL. RES.:

LOT NUMBER		PHASE	HOUSE TYPE	PRINT DATE
19		1	Beaumont (50-05) Elev B	24-Jan-18
Item	Ref#	Quantity	Description	Addition to Purchase Price
33	5465		ELECTRICAL - PLUGS 1. ADD PLUG IN FOYER AS PER LOCATION ON SKETCH 2. SEE LOCATION OF STANDARD PLUGS IN MASTER ENSUITE VANITY **ONE ON EACH END/SIDE, NOT ON REAR EXTERIOR 3. ADD ONE PLUG TO MAKE UP DESK IN MASTER ENSUITE	



It is hereby understood and agreed between the undersigned parties hereto that the following changes shall be made to the above mentioned Agreement of Purchase and Sale dated , and except for such changes noted above and below all other terms and conditions in the Agreement of Purchase and Sale remain as stated therein and time is to be of the essence:

The undersigned Purchaser hereby agrees with the undersigned Vendor to Increase the Purchase Price and Add a Further Deposit in connection with Extras/Upgrades ordered contemporaneously herewith:

Increase Purchase Price by **\$239,982.62** in reference to this PE #498.

Acknowledgement - Purchaser Initials

This is a request to price the above extras/upgrades in accordance with the following terms and conditions:

1. The above referenced parties agree to the installation of the following extras at the prices shown above in accordance with the terms and conditions set out in the purchasers extra agreement.
2. The prices quoted on this request for extras sheet are contingent upon the extras being ordered within 14 days of acceptance on the offer. Should the purchaser wish to add any of this items at a later date, then the new prices will be quoted.
3. All extras must be paid in full.
4. If the sale of the above extras are not completed (due to the purchaser not completing the contract) any amount paid for these extras shall be kept in full by the builder, given that any work on the above extras has begun or if materials have been ordered.
5. The Builder does not have to accept any additional extras, upgrades or changes from the Purchaser once this form has been approved by the Builder.
6. Any additional extras or upgrades will only be accepted if they are in writing and approved by the Builder. Verbal extras or upgrades will not be acknowledged as part of the agreement.
7. All selections are final. Changes to the above are subject to a 20% administration fee. Minimum of \$5000.

PURCHASER:

MODEL HOME

24-Jan-18

DATE

VENDOR:

PER: Zancor Homes (Cookstown) Ltd.



Lot 19 Cookstown

EXTERIOR LIGHTS (x8)

- (1) ONE @ SIDE WFT
- (2) 2ND FROM ABOVE BALCO
- (2) 2ND FROM ABOVE GARAGE
- (2) CORNERS OF GARAGE
- (1) 2ND FROM RIGHT SIDE

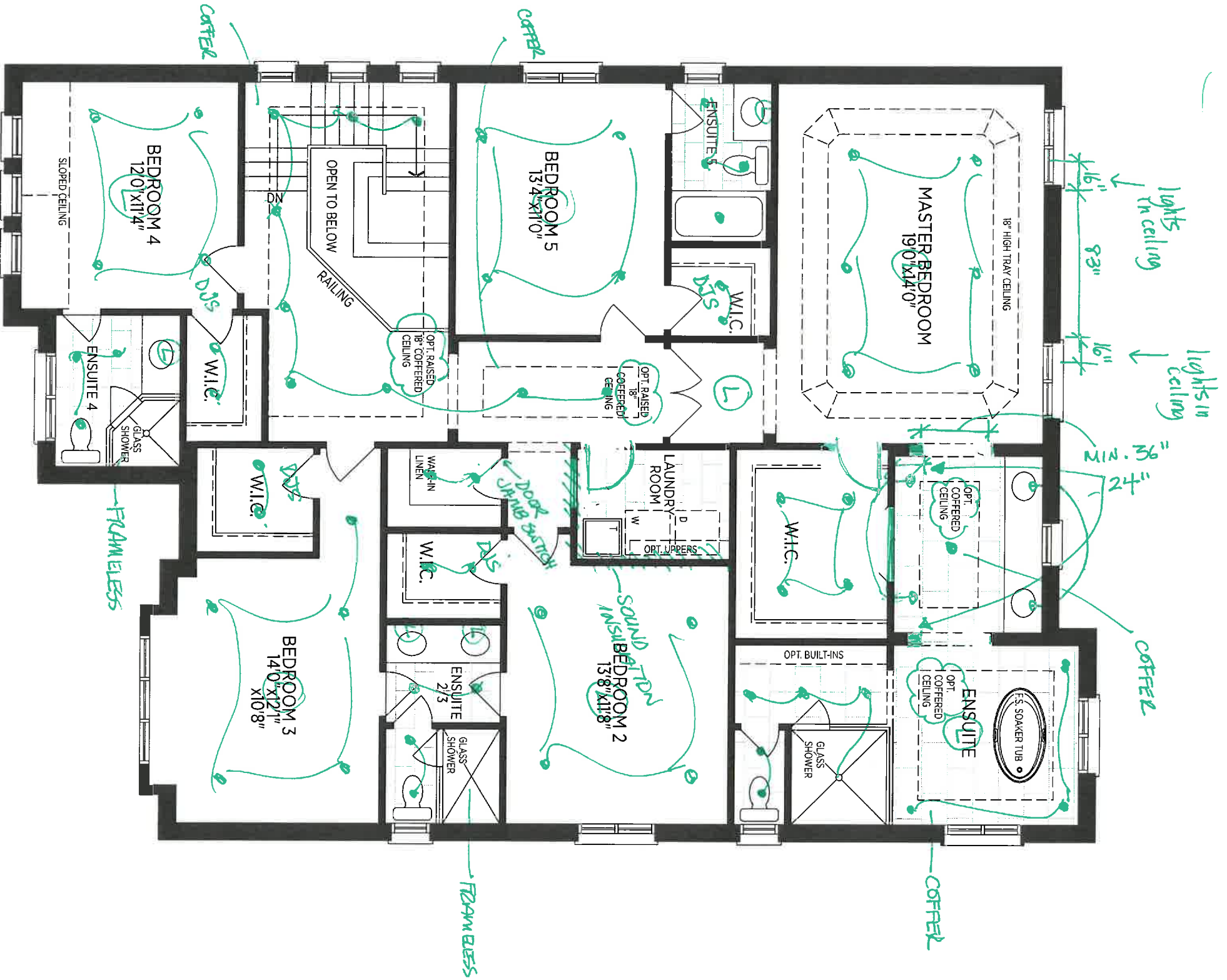

OPT. SECOND FLOOR W/ 5 BEDROOM EL. A

TOTO®

LT533

Promenade® Undercounter Lavatory

FEATURES

- 18-1/2" x 14-1/2" Undercounter lavatory
- Front or rear overflow
- Mounting assembly complete with installation template and mounting screw set for wood countertops
- THU410 is required for marble/granite type counter top installation and must be purchased separately

MODELS

- LT533
(#01, #03, #11, #12, #51)

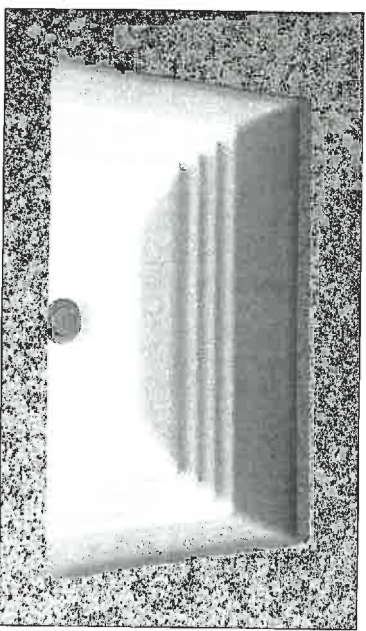

COLORS/FINISHES

- #01 Cotton
- #03 Bone
- #11 Colonial White
- #12 Sedona Beige
- #51 Ebony

CODES/STANDARDS

- Meets and exceeds ASME A112.19.2/CSA B45.1
- Certifications: IAPMO(cUPC), State of Massachusetts , City of Los Angeles, and others
- Meets ADA guidelines and ANSI A117.1 requirements when countertop is installed 864mm (34 ") from finished floor and lavatory is installed 205mm (8-1/8 ") minimum from front edge.



PRODUCT SPECIFICATION

The undercounter lavatory shall be made of vitreous china. Lavatory shall be 18-1/2" in length and 14-1/2" in width. Product shall be with overflow and lavatory shall include mounting assembly. Lavatory shall be TOTO Model LT533_____.

Lot 19 Colston

Master Insuite
(X2)

1 of 2

AUG 22 2017

LT533

Promenade® Undercounter Lavatory

SPECIFICATIONS

- Waste
 - Size
 - Basin
 - Warranty
 - Material
 - Shipping Weight
 - Shipping Dimensions
- 1-1/4" O.D.
20-1/2"W x 16-1/2"D
18-1/2"W x 14-1/2"D
One Year Limited Warranty
Vitreous china
25 lbs.
22-1/4"W X 18-3/4"D X
9-3/4"H"

INSTALLATION NOTES

Mounting Hardware

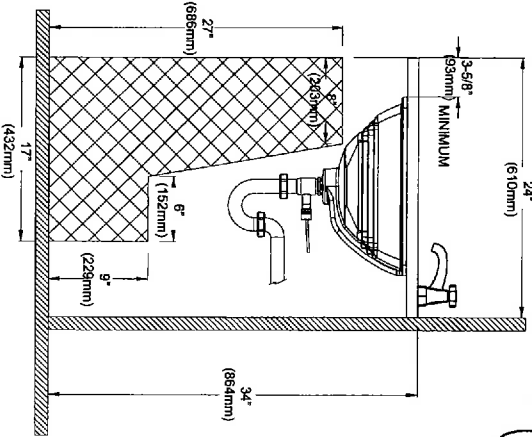
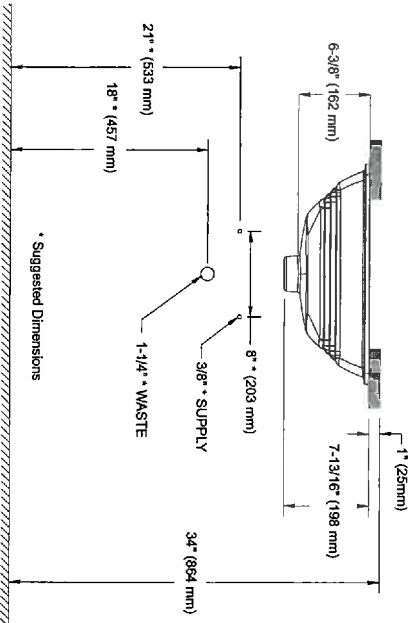
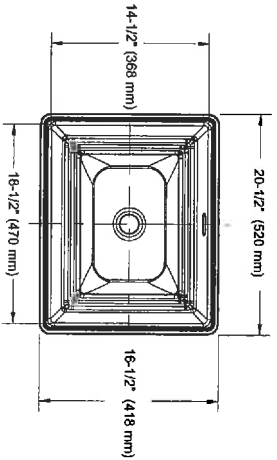
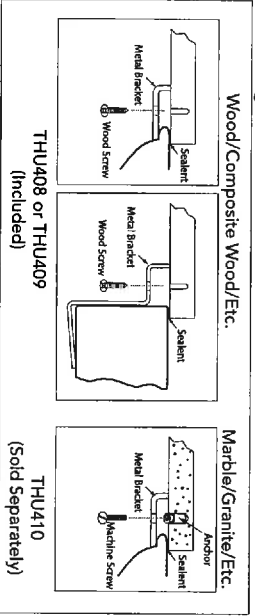

ADA Compliance Check
Note: Overflow must be at rear

lot 19
lookston.

Master
Ensuite

282

TOTO®

Ph: (888) 295-8134 | Fax: (800) 699-4889 | www.totousa.com | © TOTO USA

These dimensions and specifications are subject to change without notice

#SS-00449 v.04
AUG 22 2017

TOTO®

LT641

Dartmouth® Undercounter Lavatory

FEATURES

- 18-3/4" x 13-3/4"
- ADA compliant
- Front or rear overflow
- Mounting assembly complete with installation template and mounting screw set for wood countertops
- THU410 is required for marble/granite type counter top installation and must be purchased separately

MODELS

- LT641
(#01, #03, #11, #12, #51)

COLORS/FINISHES

- #01 Cotton
- #03 Bone
- #11 Colonial White
- #12 Sedona Beige
- #51 Ebony

CODES/STANDARDS

- Meets and exceeds ASME A112.19.2/CSA B45.1
- Certifications: IAPMO(cUPC), State of Massachusetts, City of Los Angeles, and others
- Meets ADA guidelines and ANSI A117.1 requirements when countertop is installed 864mm (34") from finished floor and lavatory is installed 205mm (8-1/8") minimum from front edge.



PRODUCT SPECIFICATION

The undercounter lavatory shall be made of vitreous china. Lavatory shall be 18-3/4" in length and 13-3/4" in width. Product shall be with overflow and lavatory shall include mounting assembly. Lavatory shall be TOTO Model LT641_____.



LOT 19 Cookstown

Ensuite 2/3 (x2)

Ensuite 4

Ensuite 5

Basement

1 of 2

AUG 22 2017

LT641

Dartmouth® Undercounter Lavatory

SPECIFICATIONS

- Waste 1-1/4" O.D.
- Size 21-1/4"W x 16-1/4"D
- Basin 18-3/4"W x 13-3/4"D
- Warranty One Year Limited Warranty
- Material Vitreous china
- Shipping Weight 21 lbs.
- Shipping Dimensions 22-1/4"W x 18-3/4"D x 9-3/4"H

INSTALLATION NOTES

Mounting Hardware

--	--

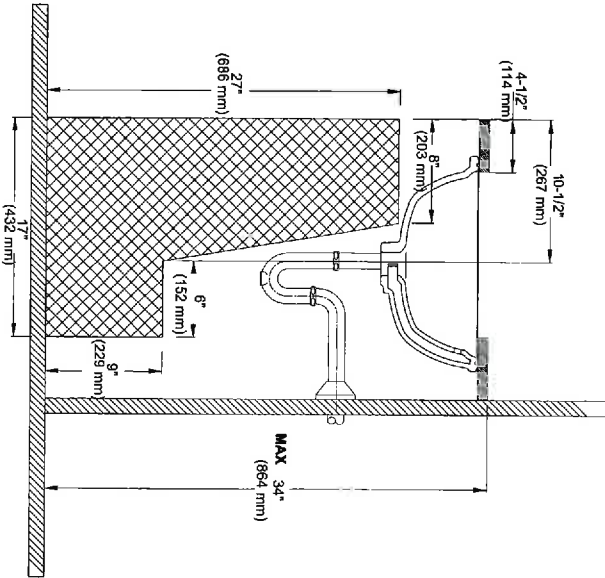
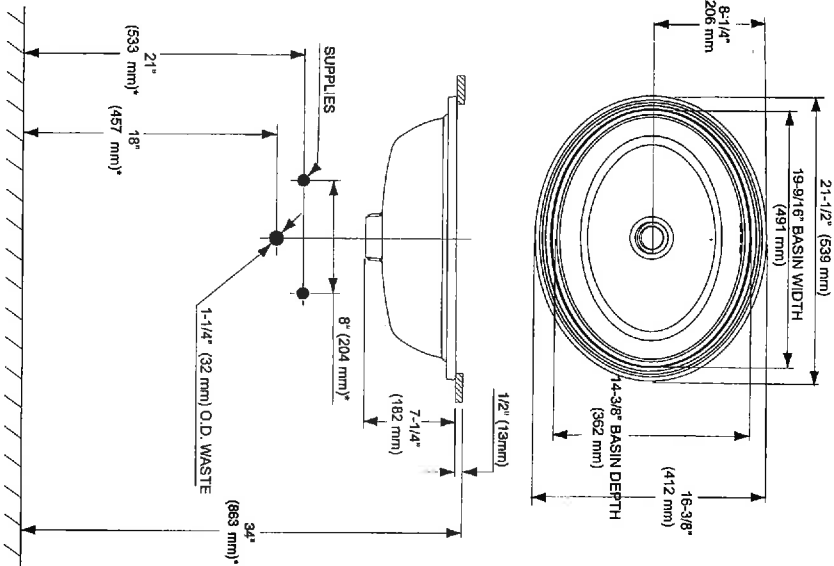

ADA Compliance Check

Lot 19 Corston.
Ensuite 2/3 (x2)
Ensuite 4
Ensuite 5
Bathroom

TOTO®

Ph: (888) 295-8134 | Fax: (800) 699-4889 | www.totousa.com | © TOTO USA

These dimensions and specifications are subject to change without notice

282

AUG 22 2017

#SS-00400 v.04

KIERA
4.8Lpf / 1.28Gpf or 3Lpf / 0.8Gpf 1PC DUAL FLUSH
1 67/8" HIGH ELONGATED

- ☐ 4710BNW Lined Tank
- ☐ 4710BNWU Unlined Tank

Product Specs:

- High efficiency dual flush toilet
- 4.8Lpf / 1.28Gpf or 3.0Lpf / 0.8Gpf
- Elongated bowl with concealed skirted trapway
- Vitreous china
- 167/8" Bowl height
- White top Push Button
- 12" (305mm) Rough-in
- 2" Fully glazed ball pass trapway
- 3" Dual flush valve
- Siphon jet flush action
- Water surface (240mm x 170mm) 77/8" x 51/2"
- Smooth close toilet seat included

Overall Dimensions:

- 392mm (W) x 725mm (D) x 765mm (H)
- 151/2" (W) x 283/4" (D) x 303/8" (H)

Compliance Certifications:

Meets or exceeds the following:

- IAPMO cUPC
- US EPA WaterSense
- ASME A 12.19.2 / CSA B45.1-2013
- Map tested 1000g
- LEED Compliant

Shipping:

- Cube 9.39
- GW 92.50lbs



Notes:

This toilet is designed to rough-in at a minimum dimension of 305mm (12") from finished wall to C/L of outlet. Supply line not included with fixture and must be ordered separately.
Important: Dimensions of fixtures are nominal and may vary within the range of tolerances established by ASME standard A112.19.2. These measurements are subject to change or cancellation. No responsibility is assumed for use of superseded or voided pages.

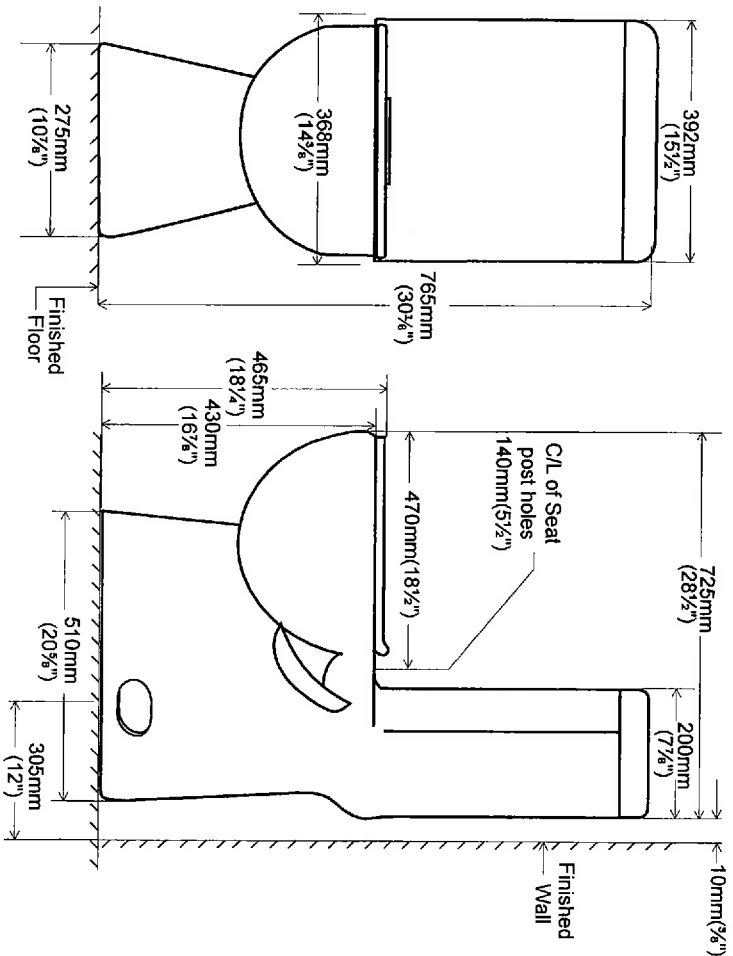

Lot 19
consignment

Master Ensuite
+ Powder

Contrac®

CANADA | 5970 Chedworth Way, Unit A, Mississauga, ON, Canada L5R 3V5 | www.contrac.ca
USA | 6241 Northwind Parkway, Hobart, Indiana, USA 46342 | www.contrac.us

Revised: July 2016

AUG 22 2017

MAAX SUBMITTAL SPECIFICATIONS

Ariosà 6636

MODEL NUMBER 106267

DIMENSIONS: 66" x 36" x 28" Acrylic

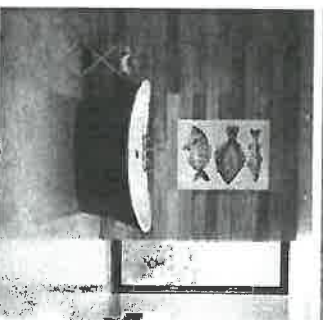
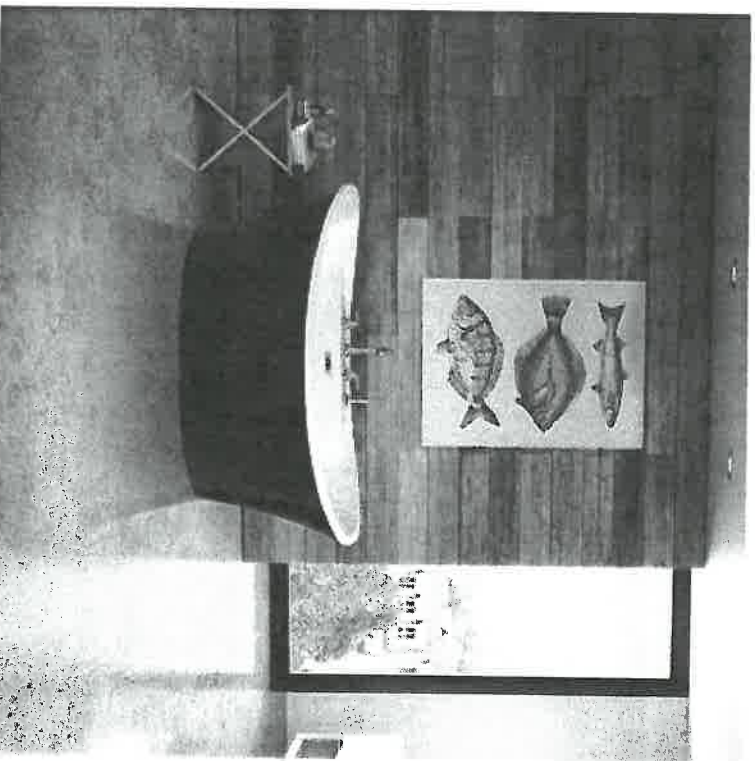

Master ENSUITE
*COLOUR 019
Thunder Grey

Project :

Contractor :

MAAX Representative :

Date :

Tel :

www.maax.com

Vivez l'expérience

MAAX®

Enjoy the experience

STANDARD FEATURES

- 2-piece bathtub with transitional symmetrical look and concealed seam
- Recessed deck with ample space for faucet installation
- Maximized bathing well with center drain
- Above-the-Floor Rough (AFR) and F² Drain compatible
- MAAX innovative leveling legs
- Apron available in white and 5 designer colors
- No systems available

OPTIONS

- Cable-operated waste and overflow
- Waste and overflow
- Waste and overflow
- Brass waste and overflow for high-rise construction
- Brass waste and overflow for high-rise construction
- Linear waste and overflow

UNIQUE FEATURES

- Above-the-Floor Rough (AFR)
- 1 Tub - 2 Pieces
- Compatible with F² Drain

SYSTEMS

- None

CERTIFICATIONS

Maax products adhere to one or more of the following certifications:



2017-08-22

LOT 19

COOKSTOWN

AUG 22 2017

MAAX SUBMITTAL SPECIFICATIONS

Vivez l'expérience
MAAX
Enjoy the experience

Ariosà 6636

MODEL NUMBER 106267

TECHNICAL DRAWINGS

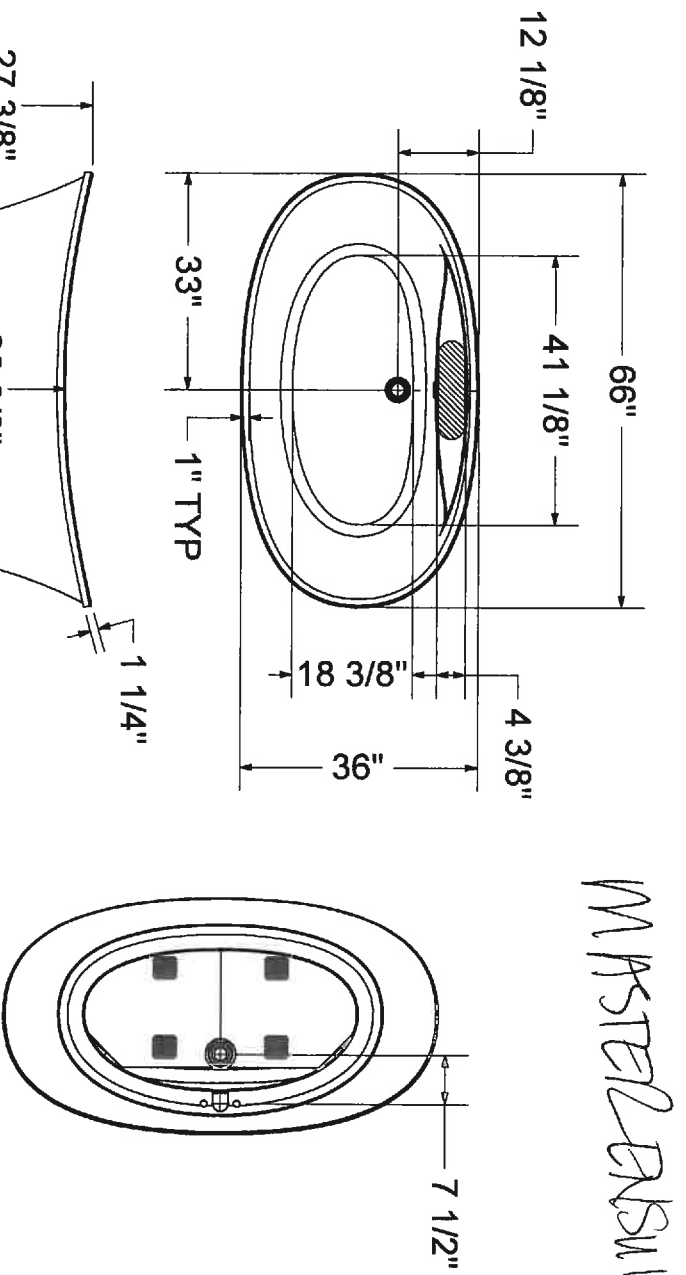

MASTERBATH

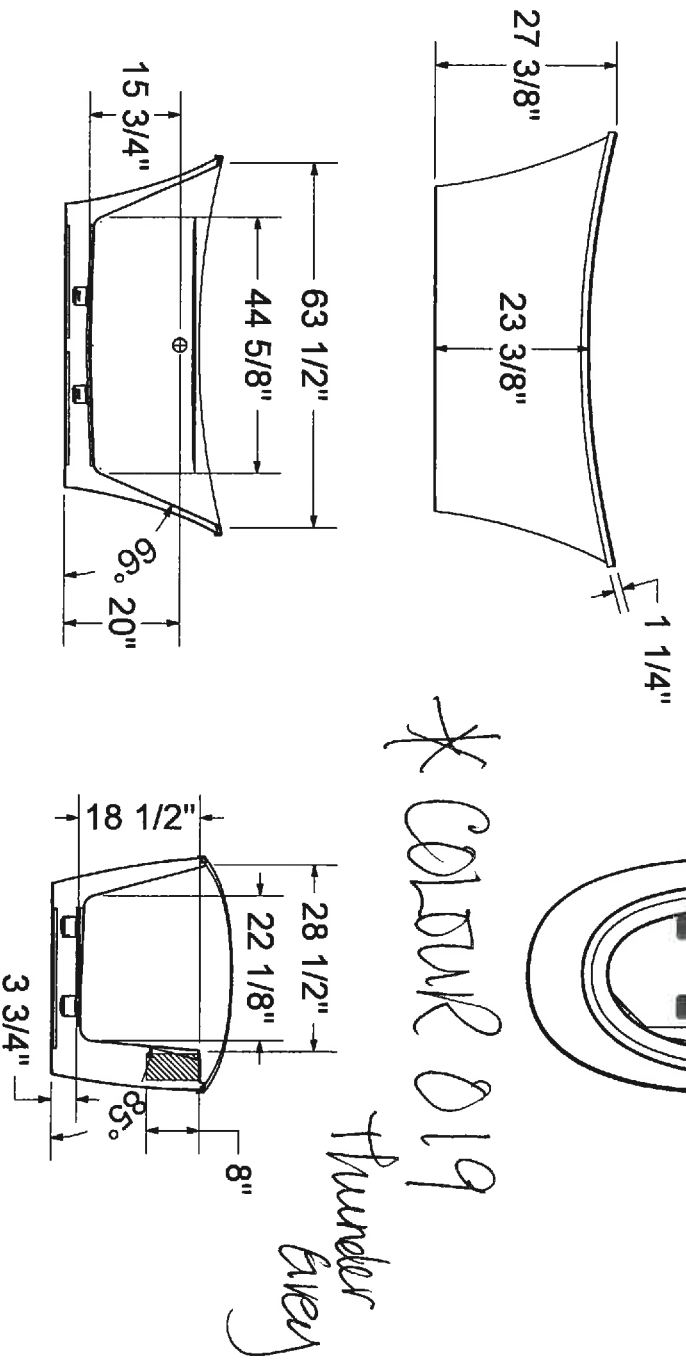

* COLOUR 019

thunder
every

(M) : Recommended faucet area of 15" (L) x 4" (W).
Depth recommended for straight pipes 8".
All dimensions are approximate. Structure measurements
must be verified against the unit to ensure proper fit.

LOT 19
COOKSTOWN

AUG 22 2017

2017-08-22

Lot 19 cookstown (MODEL HOME)

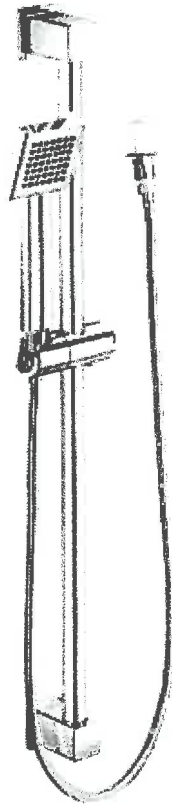

Master Ensuite

Model S3371 / S3600 (x3) / TS7115/
TS3100 (x3) / S3879EP / A721 / 116651/
164745 / S6345

X 1

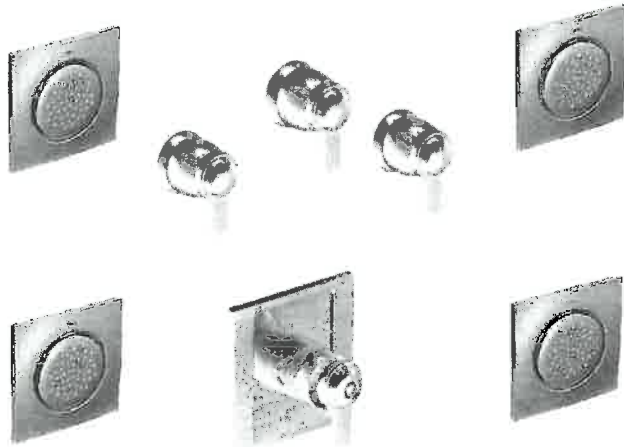
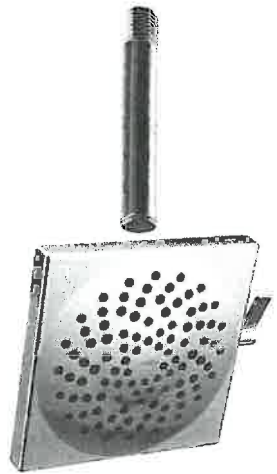

x 1 Unit



x 5 Unit

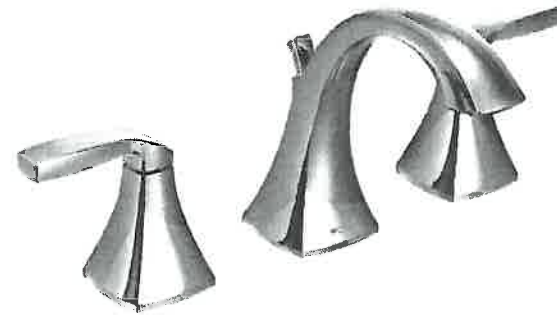

Master Ensuite Voss

T6905/69000 x 1



Master Ensuite Voss

T694/9797 x 1

MOEN
Buy it for looks. Buy it for life.*

LOT 19 COOKSTOWN (MODEL HOME)



Bath 2/3 4 5 basement
Vichy 6710
Chrome
x 5 Units

512

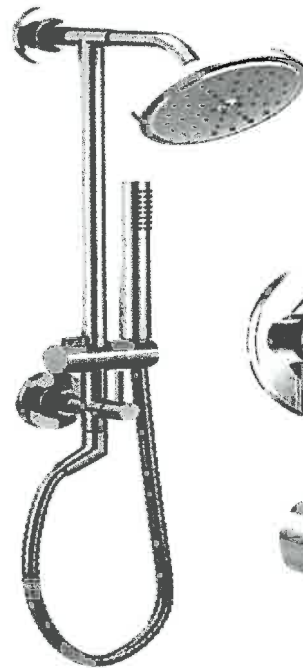

Model: Annex (Ensuite 5)
TS3661NH/3839/T2661/62380/
173809
x 1 Units



x 5 Units

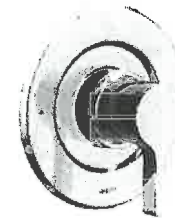
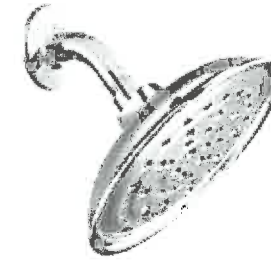
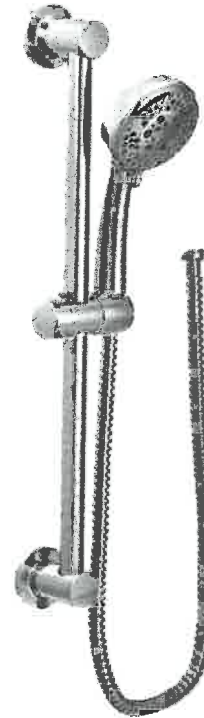

Model: Shower Only
3669EP/A721/T4171/33
72/62380/T2661/S122/1
73809
x 4 Units



x 5 Units

MOEN
Buy it for looks. Buy it for life.®