

STANDARD APPLIANCE OPENINGS

The purchaser acknowledges the following standard spaces for kitchen appliances:

Range Conventional – 30" Width

Hood Fan – 30" Width (must be the same or larger as range opening as per Ontario Building & Fire Code)

Refrigerator – 36" W x 72" H (Approximate - height may change due to bulkheads)

Dishwasher – 24" Width

6" Exhaust Vent above stove

OTHER _____

See Specs.

UPGRADED APPLIANCE OPENINGS

*Check all that apply - NON-STANDARD APPLIANCE OPTIONS

Standard

Refrige/Std.

NOTE: When upgrading appliances, there may be an additional charge to modify cabinetry and/or electrical and plumbing to accommodate the appropriate size from the manufacturer specifications of each appliance.

MANUFACTURERS SPECIFICATIONS MUST BE ATTACHED

36" / 42" Stove (Hood fan width will be the same as per Ontario Building Code)

Gas Stove

Slide-In Stove

Cooktop

*(Gas/Electric – Cut-out Charge & Plug Required)

Built-In Wall Oven

Hood Fan (may require larger vent, charges will apply – 6" is standard)

8" Vent / 10" Vent

Chimney hoods **CENTRE VENT ABOVE STOVE (clearance space will be left with this appliance will not butt up against cabinetry)

Built-In Microwave with Trim Kit

Built-In Microwave Drawer with Trim Kit

Warming Drawer

OTR – Over The Range Microwave *Plug required

SP Built-in Refrigerator/Sub Zero – If purchasing a side by side or French Door, the wall beside the door may be an issue if it is deeper than 24"

* Applicable charges may apply if required to due to space accommodations

* Note: Refrigerator Door Swing

Wine / Bar Fridge (electrical required)

Steam Oven / Built-In Coffee makers

Cargo Waste Bin systems

Front Load Washer & Dryer *(Specs required if installing counter above)

Stackable Washer & Dryer

JB/SA **NOTE:** It is the Purchaser's responsibility to coordinate delivery, installation and hook up of appliances and to ensure they are installed as per Manufacturers specifications after closing.

JB/SA Purchaser acknowledges responsibility for providing correct specification for such appliances. The purchaser agrees to deliver forthwith to the Builder the manufacturer's appliance specifications where the size exceeds the standard openings.

JB/SA If specs not received, the standard openings as determined by Zancor Homes will be provided. If rework/repair is required due to late specs received, additional costs will be applied.

Appliance Specifications are to be sent to the Zancor Décor Centre no later than _____

Appliance Specifications received _____

Purchaser Signature *Deborah*

Date *Aug 10/16*

Purchaser Signature *Chris Abboud*

Date _____

PROJECT *King-Sault*

LOT *E-S*

1065-5

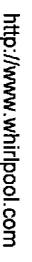

Aug 16 / 16
Key Feature

- Advanced Moisture Sensing System
- Quad Baffles
- Tap Touch Controls with Memory
- EcoBoost™ Option
- Wrinkle Shield™ Plus Option
- Undercounter Installation
- 7.4 Cu. Ft. Capacity
- ENERGY STAR® Qualified

Height: 39
Width: 27
Depth: 31

[Use And Care Guide](#)
[Dimension Guide](#)
[Installation Guide](#)
[Warranty Certificate](#)

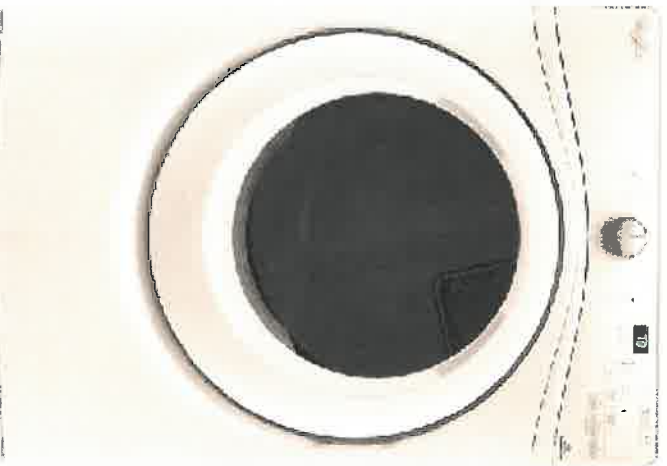

®Registered trademark/™ Trademark of Winipool, U.S.A. © 2013 Winipool Corporation. All Rights Reserved.
All other trademarks are owned by their respective companies.
Because Winipool Corporation policy includes a continuous commitment to improve our products, we reserve the right to change materials and specifications without notice. We also reserve the right to discontinue or transition products without notice.
Manufacturer's Suggested Retail Price (MSRP) and Minimum Advertised Price (MAP) provided for reference purposes only. Dealer alone determines advertised and retail prices.
Created On: Wednesday, March 23, 2016 11:52:37

WFW75HEFW

4.5 cu. ft. Front Load Washer with Precision
Dispense



<http://www.whirlpool.com>

Lot 5-5
Aug 18/16

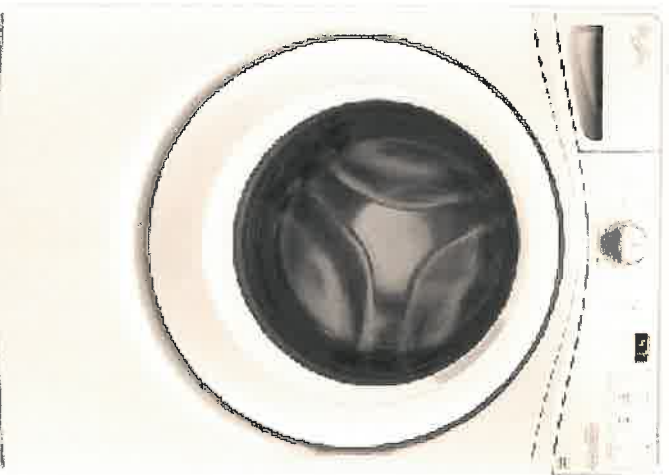

Key Features:

- Precision Dispense
- Adaptive Wash Technology
- Smooth Wave Stainless Steel Wash Basket
- 4.5 cu. ft. Capacity
- ENERGY STAR® Qualified

Product Dimensions:

Height: 39 3/4
Width: 27
Depth: 33 5/16

Electrical Requirements:

15 or 20. 120 V.

Additional Information:

[Use And Care Guide](#)
[Dimension Guide](#)
[Installation Guide](#)
[Energy Guide](#)
[Warranty Certificate](#)



56
56
Jas. Abner

30" GAS RANGE



PRODUCT SPECIFICATIONS

Model	GR304
Dimensions	29 7/8"W x 37"H x 28 3/8"D
Oven 1 Interior Dimensions	24"W x 18 5/8"H x 17"D
Oven 1 Usable Capacity	2.9 cu ft
Oven 1 Overall Capacity	4.4 cu ft
Door Clearance	19 1/2"
Weight	32.5 lb
Electrical Supply	110/120 VAC, 50/60 Hz
Electrical Service	15 amp dedicated circuit
Gas Supply	3/4" rigid pipe
Gas Inlet	1/2" NPT female

DIMENSIONS

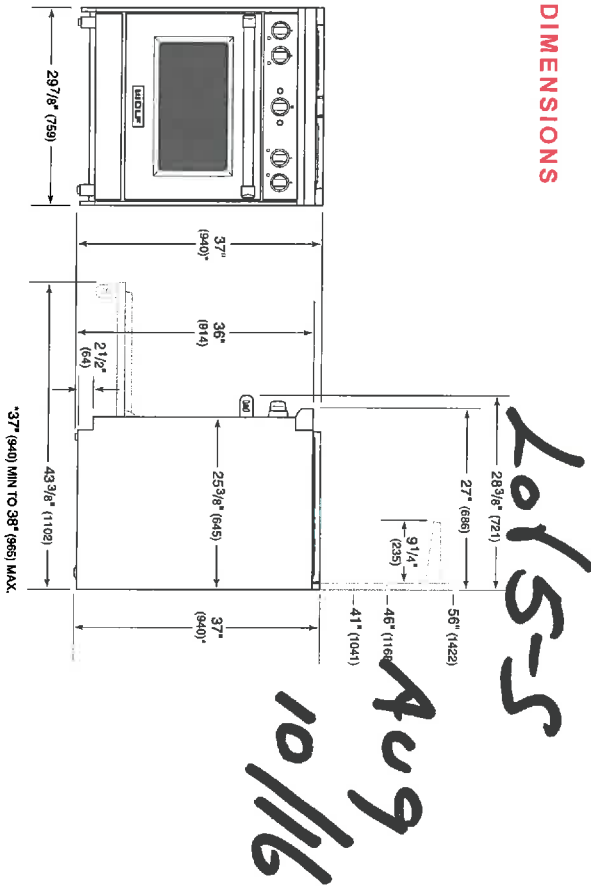

ELECTRICAL

GAS

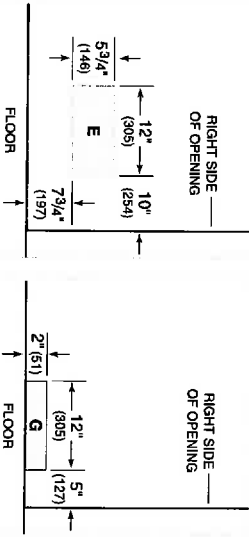

STANDARD INSTALLATION

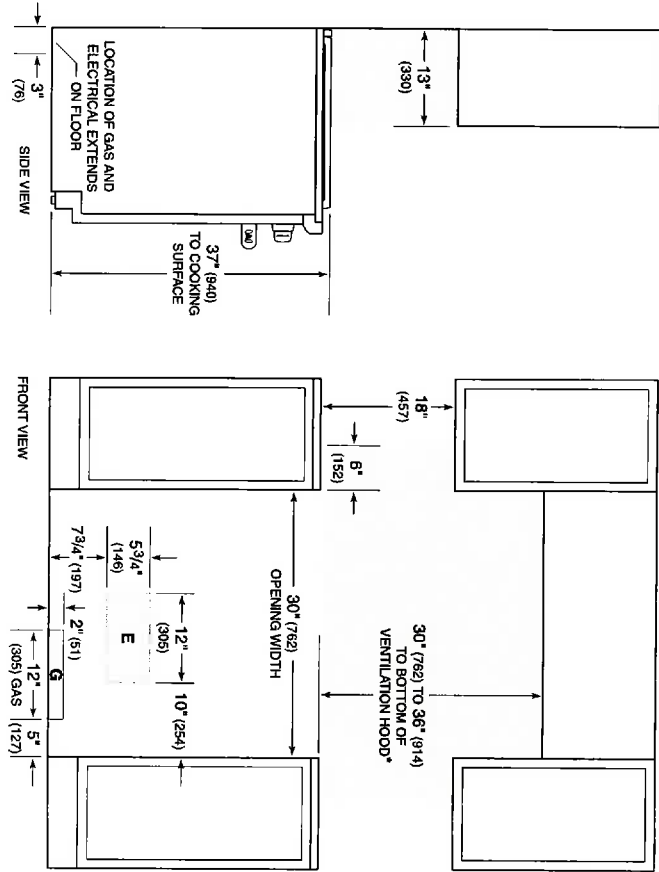

*Without ventilation hood, 42" (1067) minimum clearance countertop to combustible materials.
NOTE: Shaded area above countertop indicates minimum clearance to combustible surfaces, combustible materials cannot be located within this area.
For island installation, 12" (305) minimum clearance back of range to combustible rear wall above countertop.

IT

JA

Jos Abbas

30" GAS RANGE



G R 304

665-S
Aug 10/16

FEATURES

- Convection oven for faster, more consistent cooking
- Dual-stacked, sealed burners for higher highs, lower lows
- Continuous cast-iron grates for easy movement of pots and pans
- Infrared broiler inside oven sears quickly and evenly
- Heavy-gauge stainless steel
- Rigorously tested in our U.S. manufacturing facilities for decades of use
- Exceptional 24/7 support from our Customer Care team in Madison
- Signature red infinite control knobs
- Individual spark ignition system
- Adjustable legs for stability, plus rear casters

ACCESSORIES

- Bake stone kit (stone, rack and peel)
- Stainless steel, brass or chrome bezels
- High altitude conversion kit
- Full-extension easy glide oven rack
- Cast iron S-grates and wok grate
- Stainless steel kickplate
- Signature red, black or stainless steel control knobs
- Front leg covers
- 5" and 10" stainless steel risers, and 20" riser with shelf

Accessories available through an authorized Sub-Zero dealer. For local dealer information, visit subzero-wolf.com/localor

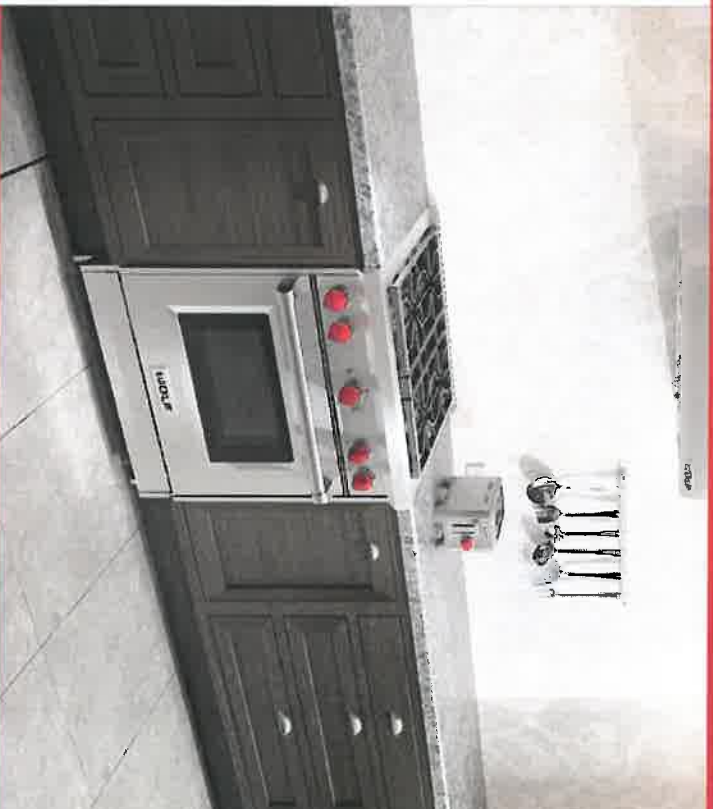

KNOB OPTIONS



TOP CONFIGURATION

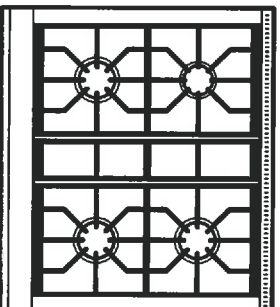

RANGETOP SPECIFICATIONS

- 1 - 9,200 Btu Burner
- 3 - 15,000 Btu Burners

JA

56

D5436XLS

Turbo Drying
Top tray for bowls and cutlery
Upper basket type: Premium
Lower basket type: Premium
Separate removable basket
Number of place settings: 16

Top tray functions
InstantLift™ - smart height adjustment of the top tray
Divisible and removable trays
Rack for knives and utensils
Rack for bowls and cups
Telescopic rails

Upper basket functions
Tight mesh base
Multi position wine shelf left
Multi position wine shelf right
Fixed pin rows
Fixed glass support
Wide knife stand

Lower basket functions
Foldable/divisible pin rows rear
Separate removable basket

Programs
Sanitation wash
Normal wash
Heavy wash
Quick wash
ECO wash

Options
Delayed start

Cleaning systems
Number of spray zones: 9
Number of spray arms: 3
WideClean™ - extra washing power for pots and pans
SCS - Super Cleaning System™
Aqua Level™ Sensor
Stainless steel spray arms

Drying system
Turbo Drying™
Features
8 stainless steel parts
Time remaining indicator
Voice signal for the end of washing cycle
Hidden heater
Kidsafe - lockable controls

Water safety
Few sealing points outside the container
Long lasting seam welded tank
Waterproof external base
Exterior float
Aqua Detect™ Sensor
Aqua Level™ Sensor
Stand-by water protection
Yes
Max time water intake
Sound alarm
Anti-block drain pump



Installation
Adjustable feet
Multi fit outlet hose
Fixed high loop outlet hose
Trim kit

EAN code: 3838942042188
code: 492231

General
Product: Dishwasher
Mode of installation: Built-in
Size: XL (ADA height compliant)
Touch Screen Display
Number of programs: 7
Noise level: 46 dB(A)
Number of baskets: 3
EAN code: 3838942042188

Dimensions and installation
Height: 32 5/16 (820 mm)
Width: 23 15/16 (608 mm)
Depth: 22 7/8 (581 mm)
Packaging height: 35 1/16 (890 mm)
Packaging width: 25 3/16 (640 mm)
Packaging depth: 26 3/4 (680 mm)
Length electrical cord: 46 7/16 (1180 mm)
Length inlet hose: 66 1/8 (1680 mm)
Length outlet hose: 41 3/4 (1060 mm)
Weight net: 101 lbs
Weight gross: 109 lbs

Technical information
Voltage: 120 V
Current: 15 A

Consumption
Energy consumption/cycle: 0,87 kWh

Lot 5-5
Aug 16/16

56

5A

SUB•ZERO

DIMENSIONS

DIMENSIONS

Technical drawing of a two-door refrigerator. The top view shows a width of 36" (914) and a depth of 23 3/8" (595). The side view shows a height of 68 1/2" (1741) and a depth of 23 3/8" (595). The front view shows a total height of 68 1/2" (1741) and a total width of 36" (914). The door widths are 18 1/4" (465) each. The bottom view shows a total width of 36" (914) and a total depth of 23 3/8" (595). The bottom view also shows a depth of 23 3/8" (595) for the main body and a depth of 4" (102) for the base. The bottom view also shows a depth of 23 3/8" (595) for the main body and a depth of 4" (102) for the base.

36" (914)

23 3/8" (595)

68 1/2" (1741)

18 1/4" (465)

4" (102)

23 3/8" (595)

HEIGHT DIMENSIONS ± 1/2" (13)

Lot 5-5

Aug 10/16

PLUMBING

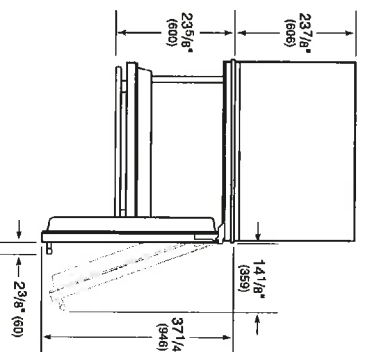

STANDARD INSTALLATION

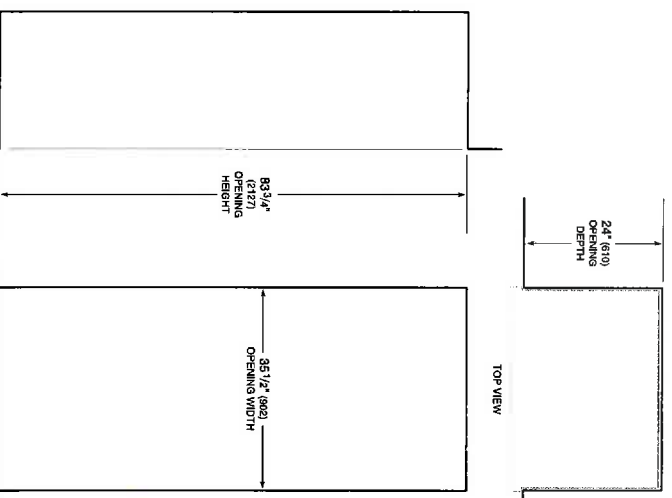

NOTE: Shaded line represents profile of unit.

36" BUILT-IN OVER-AND-UNDER REFRIGERATOR/FREEZER

SUB•ZERO

BI-36U/S

FEATURES

Dual refrigeration keeps food fresher longer

Air purification system fights spoilage, odors

Crispers and deli drawers in low-temp, high-humidity zones for optimum freshness

Microprocessor control assures peak performance

Water-filtration system for ice reduces contaminants, chlorine taste and odor

Freshness cards for maximum food preservation

Clear-view, triple-pane and UV-resistant glass door

Rigorously tested in our U.S. manufacturing facilities to ensure at least 20 years of heavy use

Exceptional 24/7 support from our Customer Care team based in Madison, Wisconsin and just footsteps from our factory

"Soft bright" interior lighting

Over-and-under refrigerator/freezer storage

Magnetic door seal system locks in cold air

Automatic ice maker with "max ice" feature

Adjustable shelves for maximum convenience

ACCESSORIES

Stainless steel kickplate

Grilles for 83" or 88" finished height (84" is standard)

Side panel mounting kit

Dual installation kit with or without dual wide grille—84" finished height

Accessories are available through an authorized Sub-Zero dealer. For local dealer information, visit subzero-wolf.com/locator.



Lot 5-5
Aug 10/16



HANDLE OPTIONS

PRO



TUBULAR



PRODUCT DETAILS

REFRIGERATOR

- 3 Adjustable glass shelves
- 1 Stationary glass shelf
- 1 High-humidity drawer with dividers
- 1 Storage drawer with dividers
- 2 Adjustable door shelves
- 1 Stationary door shelf
- Adjustable dairy compartment

FREEZER

- Full-extension roll-out freezer drawer
- Two-tier wire storage baskets
- Automatic ice maker



SU908

Lot 5-5

Aug 10/16

SU908 2 motors

- Motor: 900 CFM



56

- Lighting: 2x20W Dichroic lamps



5A



- Control panel: 4 speed push-button + timer + light switch

- Grease filter: 295X239X25mm commercial style baffle filter
- Stainless steel: AISI 430
- Duct size 7"

8" Duct

