



CONSTRUCTION SUMMARY

Belle Aire Shores - Zancor Homes (Innisfil) Ltd.

PURCHASERS: Igor Tsinovoy and Irina Tsinovoy

TEL: RES: 416-419-0057

LOT / PHASE	HOUSE TYPE	PRINT DATE
137N / 2	MAINSTAY (42-01) ELEV A	5-Jul-17

Re#	Quantity - Description	Approved	Notes
3616	NO STRUCTURAL CHANGES	05Jul17	
3617	NO UPGRADES	05Jul17	
4224	BONUS: Granite kitchen countertops with undermount sink 3 Piece stainless steel appliances with white top loading washer and dryer Stainless steel under cabinet hood fan Extended uppers in kitchen (39-1/2") BBQ Gas line	05Jul17	
4225	BONUS: Air Conditioning (42ft and 50ft lots ONLY) 9ft main floor ceilings, 8ft ceilings on second floor 3-1/4 inch by 3/4 inch natural prefinished engineered hardwood on main floor in non-tiled areas, excludes bedrooms Natural finished oak stairs	05Jul17	

This Document is Extremely Time Sensitive - Printed 5 Jul 17 at 9:40

ZANCOR HOMES COLOUR CHART

CABINETRY / COUNTERTOPS						
	DOOR STYLE	HARDWARE	COUNTERTOP	EDGE		
Kitchen	STD MOSAIC OAK -TIMBER GREY	H800BC	GIALLO ORNAMENTAL LIGHT	C		
Island	STD MOSAIC OAK -TIMBER GREY	H800BC	GIALLO ORNAMENTAL LIGHT	C		
Master Ensuite	STD CONT SLAB PVC CHOCOLATE BROWN	H700BC	CALCUTTA MARBLE - 4825K-07	STD		
Main	STD CONT SLAB PVC RED APPLE	H500BC	IVORY KASHERE-76226-46	STD		
Powder Room	N/A					
Laundry	N/A					
TILES				INSERTS	THRESHOLDS	
Main Foyer	GRECO BEIGE 13 X 13					
Powder Room	GRECO BEIGE 13 X 13					
Mud Room	GRECO BEIGE 13 X 13					
Main Hall	N/A					
Kitchen Floor	GRECO BEIGE 13 X 13					
Breakfast Floor	GRECO BEIGE 13 X 13					
Laundry (2nd Floor)	MALENA IVORY 13 X 13					
Mstr Ensuite Floor	MALENA CARBON 13 X 13					
Mstr Ensuite Shower	MELENA CARBON 8 X 10					
Mstr Shower Floor	WHITE 2 X 2					
Master Shower Jamb	BIANCO CARRARA			BIANCO CARRARA		
Main Bath Floor	MALENA IVORY 13 X 13					
Main Bath Tub Wall	MALENA IVORY 8 X 10			BIANCO CARRARA		
HARDWOOD / CARPET						
Great Room	3"-1/4"STANDARD NATURAL OAK HARDWOOD					
Den	3"-1/4" STANDARD NATURAL OAK HARDWOOD					
Kitchen * (Waiver)	N/A					
Main Foyer * (Waiver)	N/A					
Main Hall	3"-1/4" STANDARD NATURAL OAK HARDWOOD					
Upper Hall	STANDARD OPENING NIGHT CARPET - T03					
Master Bedroom	STANDARD OPENING NIGHT CARPET - T03					
Bedroom 2	STANDARD OPENING NIGHT CARPET - T03					
Bedroom 3	STANDARD OPENING NIGHT CARPET - T03					
Carpet Underpad	STANDARD					
FIREPLACES						
LOCATION	N/A	Opt. Surround	N/A	MANTLE		N/A
LOCATION		Opt. Surround		MANTLE		
	MIRRORS & ACCESSORIES			PLASTER MOULDING		
Mirrors	YES		Opt. Crown Moulding		N/A	
Bathroom Accessories	DELETE ALL WHITE ACCESSORIES	Location				
Purchaser has reviewed the colour chart				SITE & LOT		
***FOR TRADE USE***				INNISFIL		137N
Any upgrades in the colour chart must be accompanied with a PES. It is the responsibility of all Trades to inform the builder of any discrepancies on sketches, PES and/or colour charts PRIOR to installation.						
** PAGE 1 OF 2 **				Purchaser Initial		Vendor

# ZANCOR HOMES COLOUR CHART

STAIRS, RAILING & PICKETS & STAIR STAIN			
Stair Stain / Species:	VARISH ONLY		
White Paint Req'd	N/A		
Main to 2nd Railing Details:	STANDARD		
Main to Basement Railing Details:	STANDARD		
TRIM			
Casing/Baseboards	STANDARD		
Interior Doors	STANDARD		
Interior Door Hardware	STANDARD		
Exterior Door Hardware	STANDARD		
PAINT			
Kitchen/Breakfast	OYSTER WHITE	Master Beds	OYSTER WHITE
		Bedroom 2	OYSTER WHITE
		Bedroom 3	OYSTER WHITE
Great room	OYSTER WHITE		
Den	OYSTER WHITE	Master Ens.	OYSTER WHITE
Main/Upper Hall	OYSTER WHITE	Main	OYSTER WHITE
Laundry	OYSTER WHITE		
Powder Room	OYSTER WHITE		
PLUMBING- UPGRADES TO BE DETAILED ON PES			
FIXTURES	FAUCETS	NOTES	
Kitchen	STANDARD		
Powder Room	STANDARD		
Master Ensuite	STANDARD		
Main Bath	STANDARD		
ZANCOR APPLIANCE REQUIREMENTS-UPGRADES TO BE DETAILED ON PES			
Appliance Package received in 'Schedule E'		YES / NO Package Name:	
	UPG (SEE PES)	DECLINED	NOTES
GAS LINE	NO	NO	
WATERLINE to Fridge	NO	NO	
Hood Fan Venting SIZE	YES 6"	NO	BUILDERS STANDARD
ELECTRICAL for Built-in Oven	NO	NO	
ELECTRICAL for Built-in Micro / OTR	NO	NO	
ELECTRICAL for Gas Stove / Cooktop	NO	NO	
ELECTRICAL for Bar Fridge	NO	NO	
DISCLAIMER			
Colours of all materials are as close as possible to Builders selection but not necessarily identical due to dye lot variances in manufacturing/manufacturers. Due to construction progress some items may have been pre-selected or installed. In this event the Vendor's selection must be accepted by the purchaser			
Any changes to the colour chart after signing are subject to a <b>\$5000</b> administration fee plus costs			
Purchaser has checked and acknowledged accuracy of colour and selections before signing.			
SITE:	INNISFIL	LOT: 137N	
PURCHASER(S):	IGOR TSINOVY IRINA TSINOVY		
HOME #/CELL #	416-419-0057		
EMAIL:	tsinovoy@gmail.com		
DÉCOR NOTES	<div> <div>Purchaser Signature</div> <div>Date</div> </div> <div> <div>Purchaser Signature</div> <div>Date</div> </div>		
<div> <div> <div>***FOR TRADE USE***</div> <div>Any upgrades in the colour chart must be accompanied with a PES.</div> <div>It is the responsibility of all Trades to inform the builder of any discrepancies on sketches, PES and/or colour charts PRIOR to installation.</div> </div> <div>  <div> <div>Décor Consultant Signature</div> <div>Date</div> </div> </div> </div>			
*** PAGE 2 OF 2 ***		<div> <div>Vendor Signature</div> <div>Date</div> </div>	

Elevation A 2225 sq.ft.

Elevation B 2281 sq.ft.



Ground Floor  
Elevation A

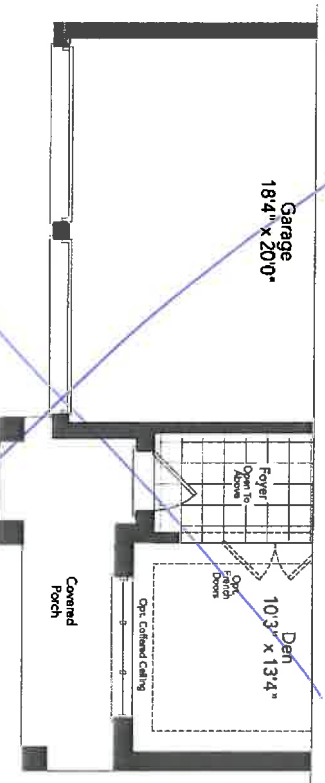

Partial Ground Floor  
Elevation B

LOT 1374  
MAINSTAY 42-01

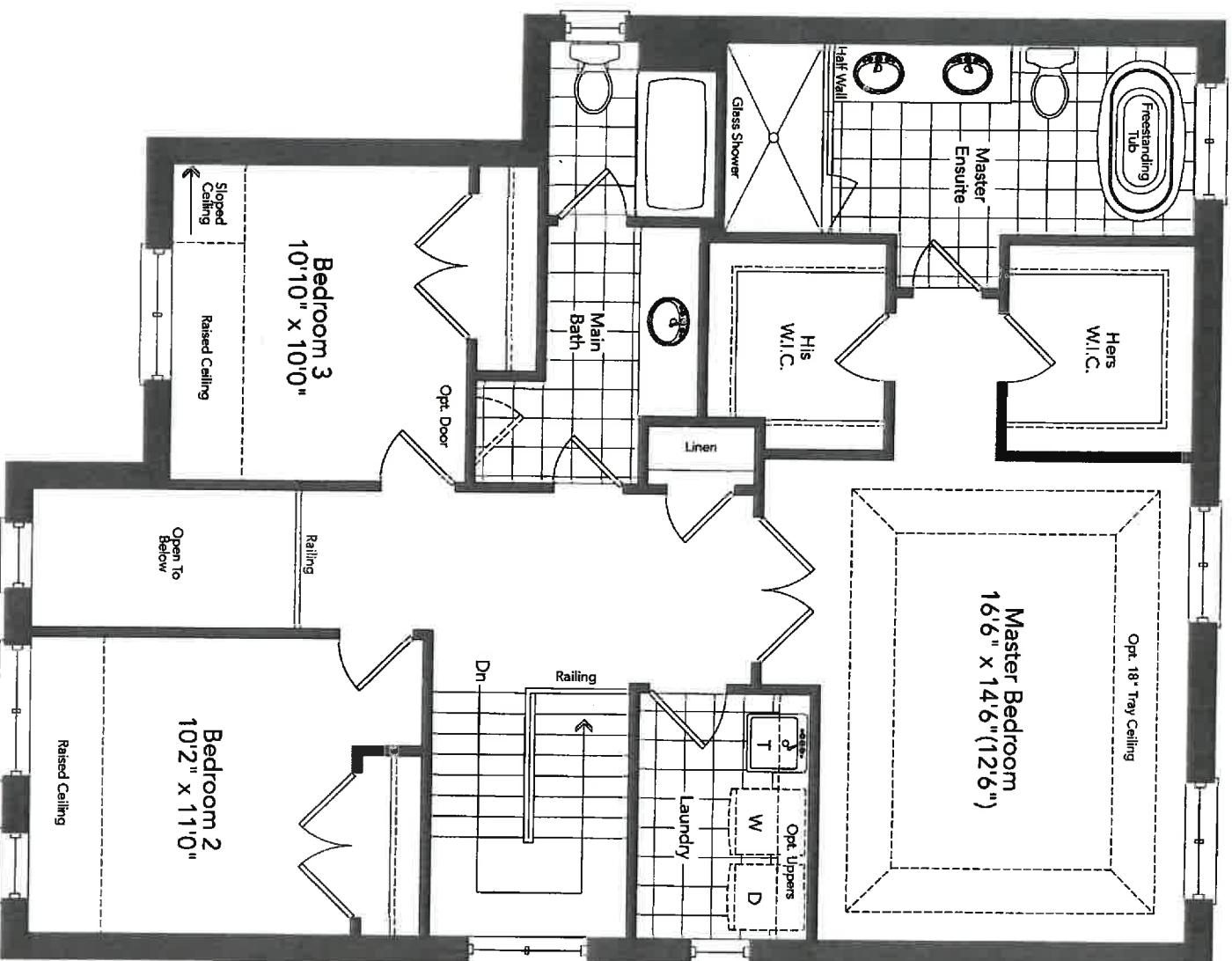

Second Floor  
Elevation A

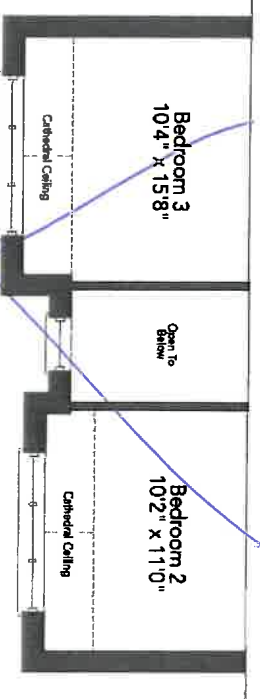

Partial Second Floor  
Elevation B

LOT 137XJ  
1441541L



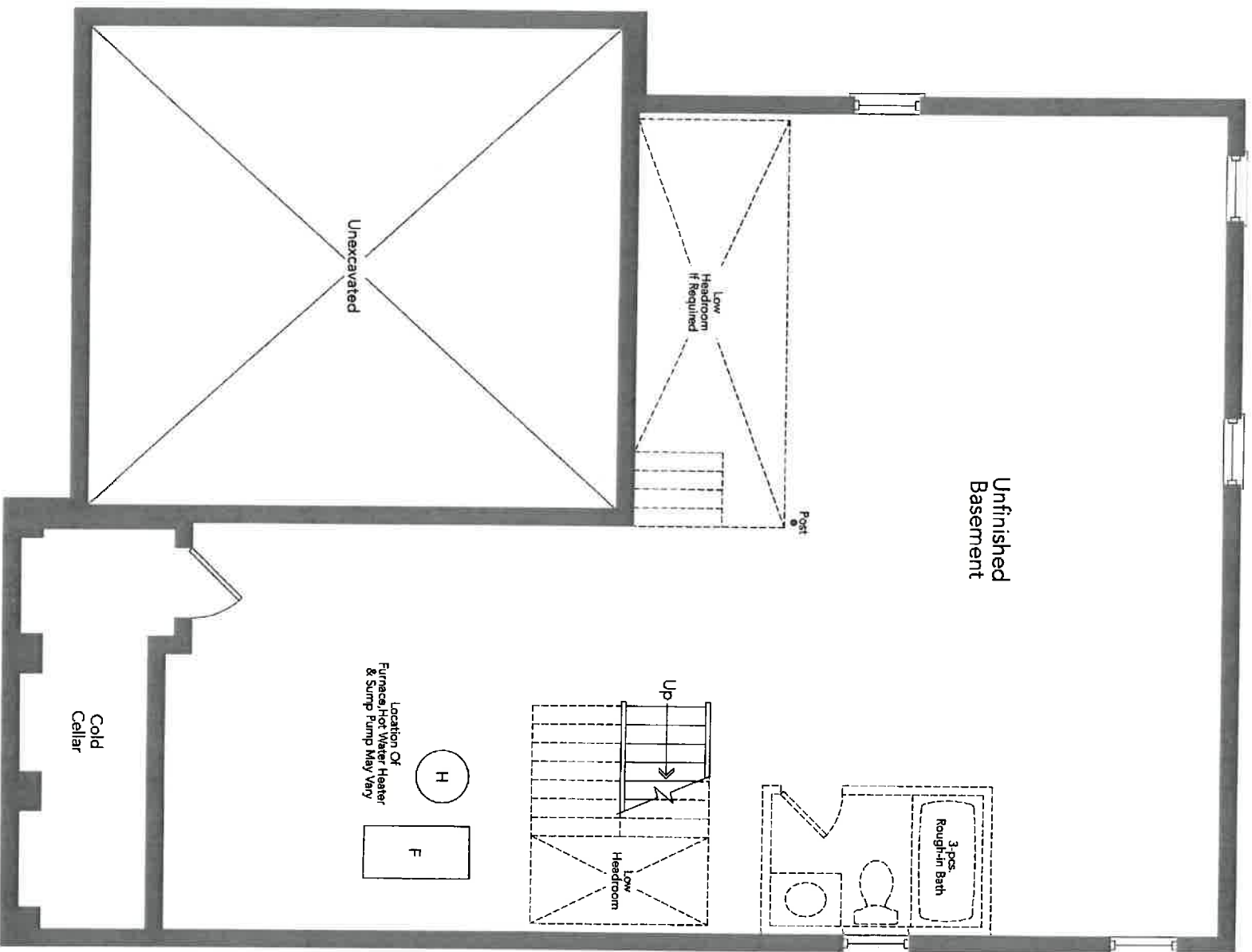

Basement  
Elevation A

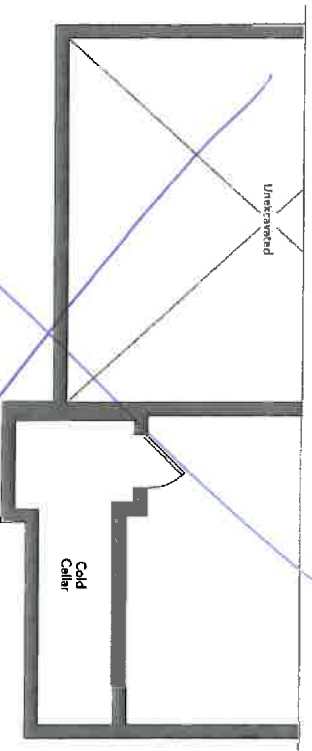

Partial Basement  
Elevation B

11

LOT 137N  
14415FL

MAINSTAY 42-01

New Image Kitchens Inc.	
Scale:	Approved by:
Date: 24/02/17	Drawn by: MSER
	Revised:
BELLE AIR SHORES, INNISFIL	Drawing number:

MODEL: 42-01

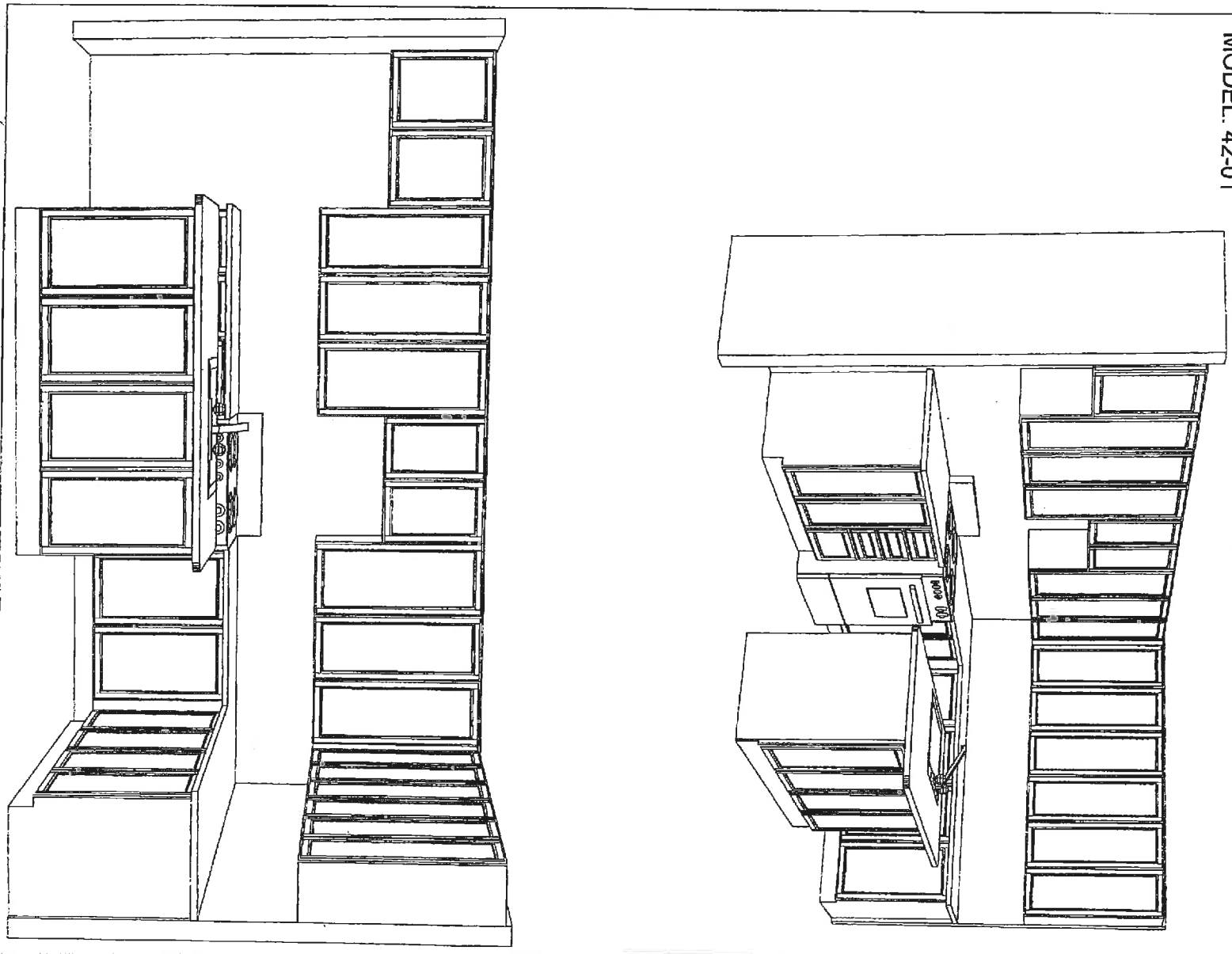

LOT 1374  
INNISFIL

New Image Kitchens Inc.

Scale: 10/10/15 Approved by: MGER

Date: 10/10/15 Drawn by: MGER

Revised:

BELLE AIR SHORES, INNISFIL

Drawing number:

MODEL: 42-01

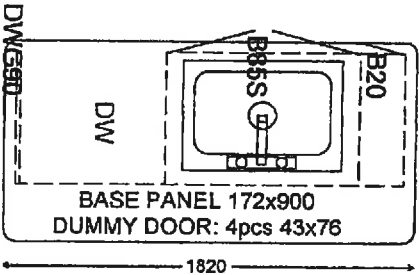
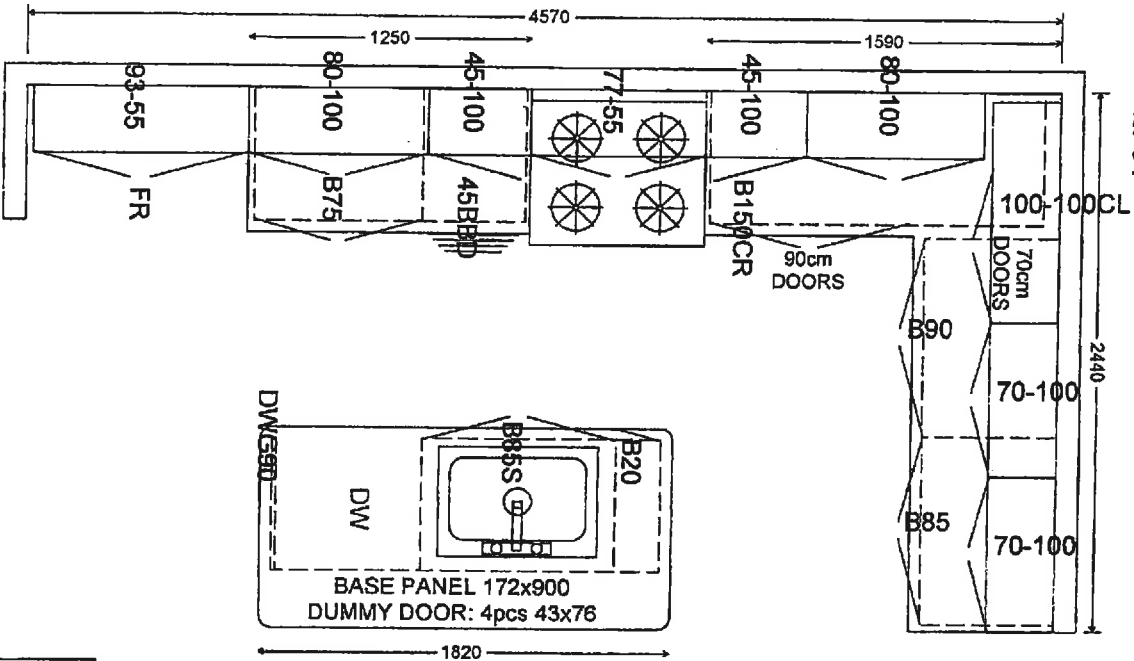

~~LAUNDRY (OPTIONAL)~~



MAIN

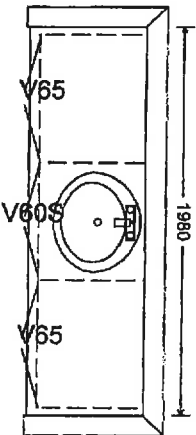

MASTER ENSUITE

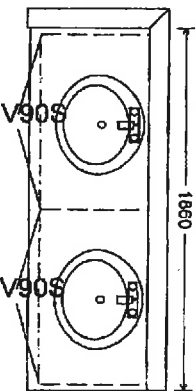

LOT 137 N  
INNISFIL



# STANDARD CABINET HARDWARE

(New Image Kitchens)



- |         |        |        |         |        |         |
|---------|--------|--------|---------|--------|---------|
| K200ABC | K200BC | K200AC | K300BC  | K300C  | K300P   |
| K400BC  | K400C  | K400P  | K1100AC | K1100C | K1100A1 |

- |         |        |       |       |        |       |
|---------|--------|-------|-------|--------|-------|
| METRO98 | H800BC | H600C | H600P | H700BC | H700P |
|---------|--------|-------|-------|--------|-------|

- |        |       |       |        |        |         |        |
|--------|-------|-------|--------|--------|---------|--------|
| H500BC | H500C | H500P | H900BC | H900AC | H900ABC | H800BC |
|--------|-------|-------|--------|--------|---------|--------|

METAL  
CABINETS

METAL  
CABINETS

KITCHEN  
ISLAND

210713714  
13714

11

ZANCOR HOMES  
EDGE PROFILES (INTERSTONE / REDSTONE)

STANDARD

KITCHEN /  
BATH

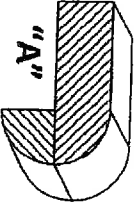
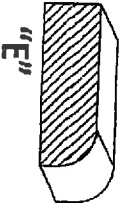
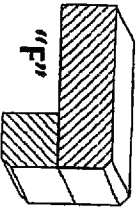
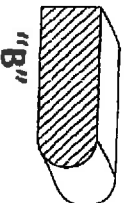
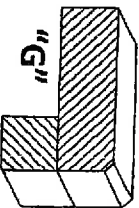
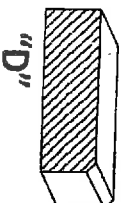
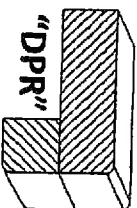
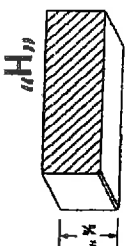
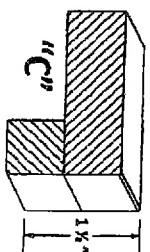

UPGRADES

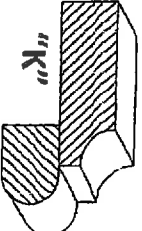
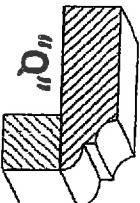
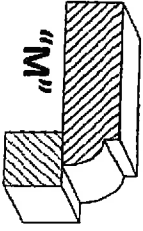
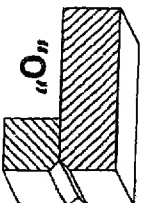
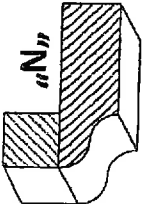
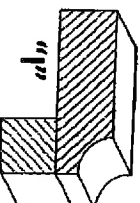
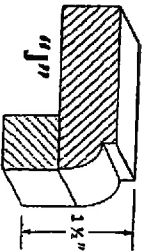
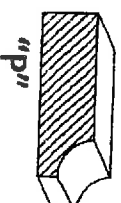
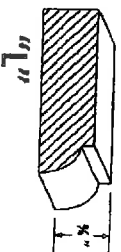

LOT / SITE

137M-1KMSFL

PURCHASER SIGNATURE

(T)

**INTERIOR FINISHES ACKNOWLEDGEMENT / WAIVER**

Purchaser accepts and acknowledges that the Builder reserves the right to substitute materials with those of equal or better quality where the manufacture, scheduling or delivery of materials may directly impact the Builder's ability to meet its contractual obligations under the Agreement of Purchase and Sale.

**UPGRADES/EXTRAS:** All upgrades and additional selections indicated on the colour chart must be accompanied by an upgrades/extras sheet (PES) and full payment otherwise the selection will be invalid. All colour charts and upgrades/extras will not proceed until verified and signed by an authorized signing officer at the Vendor's head office. **CHANGES WILL NOT BE PERMITTED UPON COMPLETION AND SUBMISSION OF THE COLOUR CHART.**

**PORCELAIN & NATURAL STONES:** Due to the properties of natural stones including but not limited to marble, granite, quartz, no two pieces are exactly the same. Variations in colour, tone, granularity (pitting, fissures) and pattern are to be expected, including various lighting may affect the overall finished look. Stone tops are sealed at time of installation and should never be cleaned with lemon oil or vinegar. Stones are porous materials, therefore any spilled substance require immediate attention. Stone countertops require regular seal re-application as part of home maintenance. Purchaser acknowledges colour and product variations as well as natural imperfections may exist with the selection of natural stone materials and shall not hold the Vendor liable for provision of same.

**STONE COUNTERTOP JOINTS:** Purchaser is aware that one joint will be at each corner and on either side of slide-in-range (if applicable). It will also be where the length of the counter top exceeds the length of a stone slab. Slabs are usually approximately 5'x 8'.

**CERAMIC TILES:** Due to manufacturing, shade (dye lots), product variations may exist that can affect the overall look of the finished product. Although every effort will be made to ensure the colours and materials selected are as close as possible to the samples, the purchaser acknowledges that the sample tiles supplied in the Design Centre may not be identical to the materials installed in the home.

**STAIR STAINS:** Due to the natural properties of wood, many variables can affect the overall look of the finished product. Factors including but not limited to wood type, knotting, graining, density, age, humidity, and air temperature can result in substantial variations in stain intensity. The purchaser accepts that although the Vendor will do their best to match stain the unfinished stairs as close as possible to the pre-finished floors, it is not possible to have an identical match and that there MAY be shade differences between the two products.

**CABINETRY:** Due to the natural properties of wood, slight variations apparent with cabinetry are to be expected. This includes but not limited to wood species, wood grain, colour, finish, product variations, and natural imperfections are all factors that may affect the overall look of the finished product. Such factors make exact colour matching impossible. The type and intensity of lighting in the areas of designated cabinetry placement may also highlight characteristics of cabinetry finish. All cabinets shall be finished with a white melamine interior box unless a highlight interior is upgraded. Due to building specifications and/or on-site conditions, certain cabinetry upgrades may not be possible. The purchaser acknowledges that the Builder cannot guarantee the cabinetry finish or provision of certain upgrades and shall not hold the Builder liable for provision of same.

**UPGRADES/EXTRAS:** All upgrades and additional selections indicated on the colour chart must be accompanied by an upgrades/extras sheet (PES) and full payment otherwise the selection will be invalid. All colour charts and upgrades/extras will not proceed until verified and signed by an authorized signing officer at the Vendor's head office. **CHANGES WILL NOT BE PERMITTED UPON COMPLETION AND SUBMISSION OF THE COLOUR CHART.**

**HARDWOOD / LAMINATE FLOORING:** Due to the properties of wood and laminate, many variables can affect the overall look of the finished product. Variations include but not limited to wood type or laminate finish, colour/stain and wood grain are significant factors that make exact colour matching impossible. The purchaser acknowledges that the hardwood flooring is a pre-finished product in a controlled environment. Expansion, compression and cupping are characteristics of hardwood flooring once installed in the home. The purchaser acknowledges these may become apparent over time and despite the Builder's efforts to install the hardwood flooring materials in keeping with good workmanship, the Builder shall not be responsible nor held liable for minor variances of fluctuation in hardwood flooring materials.

**HARDWOOD / LAMINATE WAIVER:**

I/We understand hardwood flooring is classified as a porous material and as such not recommended by the Builder in certain areas. I/We understand there is a concern due to possible water and other substances being frequently splashed or spilled onto the floor and in contravention of Ontario Building Code Section 9.30.1.2(1).

*"Finished flooring bathrooms, kitchens, public entrance halls, laundry & general storage areas shall consist of resilient flooring, felted-synthetic-fibre floor coverings, concrete, terrazzo, ceramic tile, mastic or other types of flooring providing similar degrees of water resistance."*

I/We are prepared to assume full responsibility for any damage caused to the hardwood floor or subfloor due to moisture absorbency in the mentioned areas, and agree to waive any claims against the Township of residence, TARION and/or the Builder in relation to the matter.

**\*\*SEE COLOUR CHART FOR LOCATIONS\*\***

SITE

LOT

DATE

Jan 15/17

137A

MAY 31 2017



# APPLIANCE SPEC INFORMATION SHEET

STE & LOT:

LOT 1374-1A157L

DATE:

MAY 31 2017

SITING:

☒ Standard

☐ Reverse

## RANGE

☒ 30" (STD)

☐ 36"

☐ 48"

☐ GAS

☐ COOKTOP (APRON)

☐ COOKTOP (DROPIN)

☐ AMPS

☐ AMPS

☐ AMPS

## REFRIGERATOR

☒ STANDARD OPENING 36" X 72"

☐ BUILT IN FRIDGE

☐ WATERLINE REQUIRED

☐ PANELLED/INTEGRATED

☐ FLUSH INSET

## WALL OVENS

☐ 30"

☐ SINGLE

☐ DOUBLE

☐ STEAM OVEN

☐ WARMING DRAWER

☐ AMPS

☐ AMPS

☐ AMPS

☐ AMPS

## MICROWAVES

☐ BUILT IN MICRO

☐ MICRO TRIM KIT

☐ OVER THE RANGE

☐ AMPS

☐ MODEL

☐ AMPS

## HOOD FANS

☐ CHIMNEY (CENTRE VENT)

☒ UNDER CABINET

☐ FLUSH INSET

☒ 6 INCH (STD)

☐ 8 INCH

☐ 10 INCH

## DISHWASHER

☒ 24" (STD SIZE)

## LAUNDRY

☐ FRONT LOADING SIDE BY SIDE

☐ STACKABLE

☒ TOP LOAD

Additional charges may apply for cabinetry, electrical and plumbing in order to accommodate the specs given by the homeowner.

**NOTE:** It is the Purchaser's responsibility to coordinate delivery, installation and hook up of appliances and to ensure they are installed as per Manufacturers specifications after closing.

Purchaser acknowledges responsibility for providing correct specification for such appliances. The purchaser agrees to deliver forthwith to the Builder the manufacturer's appliance specifications where the size exceeds the standard openings.

If specs not received, the standard openings as determined by Zancor Homes will be provided. If rework/repair is required due to late specs received, additional costs will be applied.

Appliance Specs are DUE (if not received during appointment):

2 WEEKS FROM SIGNED DATE ABOVE – Specs received after this date and changes are required to accommodate the appliances, an administration fee of minimum \$250 will apply.

\*Changes must be approved by head office.

Purchaser Signature

Date

Purchaser Signature

Date