



## ANGUS SOUTH

Item #	<b>Construction Details ANGUS SOUTH: LOT 20</b>  <b>Model Type &amp; Elevation : MAGNOLIA 40-07 ELEV. A</b> <b>Purchasers Names : IAN RAMPADARAT &amp; JAYANI FATIMA CYNTHIA BIYANWILA</b>		
		Date	Note
Included	<i>Rough-in for 3 Piece in basement</i>		Bonus Package
Included	<i>3 piece stainless steel kitchen appliances with white top loading washer and dryer</i>		Bonus Package
Included	<i>Chimney Hood Fan</i>		Bonus Package
Included	<i>Natural finish laminate flooring on main floor in non tiles areas as per plan</i>		Bonus Package
Included	<i>9' main floor ceilings, 8 ft ceilings on second and basement</i>		Bonus Package
Included	<i>Carpet Grade Stairs with Oak pickets</i>		Bonus Package
Included	<i>Glass shower in Master Ensuite as per plan</i>		Bonus Package
1/	CEILINGS - SMOOTH CEILINGS TO MAIN AND 2ND FLOOR		
2/	CABINETS - KITCEHN - TALL CABINET WITH POT DRAWER BELOW FOR BUILT IN WALL OVEN AND MICROWAVE		
3/	CABINETS - KITCHEN - COOK TOP WITH POT DRAWERS BELOW		
4/	CABINETS - KITCHEN - CUT OUT FOR COOKTOP **NO BACK LIP		
5/	CABINETS - KITCHEN - UPGRADE CABINET HARDWARE - ALL DOORS K1600BC / ALL DRAWERS H-CUP 76C **NOTE - INSTALL 2 ON EACH OF THE POT DRAWERS		
6/	CABINETS - KITCHEN - DO NOT INSTALL HARDWARE ON THE BACK OF THE KITCHEN ISLAND		
7/	CABINETS - KITCHEN - ADD VALANCE		
8/	CABINETS - KITCHEN - 24 INCH DEEP UPPER OVER FRIDGE WITH 2 SIDE PANELS		
9/	CABINETS - KITCHEN - TALL PLAIN POST 29 INCHES DEEP, APPROX 7 CM WIDE; INSTALL BESIDE THE WINDE FRIDGE; MAKE SPACE FOR WINE FRIDGE **PURCHASER IS AWARE IT WILL EXTEND PAST COUNTERTOP		
10/	CABINETS - KITCHEN - 2 DOOR CLEAR GLASS CABINET ABOVE WINE FRIDGE		
11/	CABINETS - KITCHEN - LEAVE 60 INCHES OF EMPTY SPACE ABOVE COOKTOP **PURCHASER WILL DO THEIR OWN HOOD AFTER CLOSING		
12/	CABINETS - KITCHEN - (4) CLEAR GLASS CABINETS (NO GLASS SHELVES)		
13/	CABINETS - KITCHEN, MASTER, MAIN & TWIN - UPGRADE 1 CABINETS		
14/	CABINETS - KITCHEN - INCREASE SIZE OF ISLAND BY 5 FEET, INCLUDES COUNTERTOP **NOTE - NO HARDWARE ON BACK OF ISLAND **TOTAL LENGTH 12 FEET PLUS STD COUNTERTOP EDGE OVERHANG ON SHORT ENDS PLUS BREAKFAST BAR ON LONG SIDE		

## STRUCTURALS AND COLOURS

2/7/2017

ANGUS SOUTH

Item #	Construction Details ANGUS SOUTH: LOT 20  Model Type & Elevation : MAGNOLIA 40-07 ELEV. A Purchasers Names : IAN RAMPADARAT & JAYANI FATIMA CYNTHIA BIYANWILA	 Date   Note	
15/	CABINETS - KITCHEN - EXTRA BANK OF DRAWER IN ISLAND		
16/	CABINETS - KITCHEN - 1 TOP DRAWER BY FRIDGE AREA		
17/	CABINTES - KITCHEN - DELETE BACK LIP ON COUNTERTOP		
18/	DELETE ALL CERAMIC ACCESSORIES		
19/	DELETE ALL BATHROOM MIRRORS		
20/	DELETE LINEN CLOSET ON 2ND FLOOR AND <b>INCREASE</b> SIZE OF LAUNDRY ROOM		
21/	DEN - UPGRADE TO DOUBLE FRENCH DOORS		
22/	ELECTRICAL - ADD (1) EXTERIOR CAPPED LIGHTIN THE CEILING OF THE PORTICO ON SEP SWITCH		
23/	ELECTRICAL - ADD CAPPED LIGHTS:		
	(1) ABOVE TUB IN MASTER ENSUITE ON SEPARATE SWITCH		
	(1) IN THE CEILING OF POWDER ROOM ON EXISTIN SWITCH, DELETE STANDARD		
	(1) IN THE CEILING OF THE MAIN BATHROOM ON EXISTING SWITCH, DELETE STANDARD		
	(1) IN CEILING OF TWIN BATH ON EXISTING SWITCH, DELETE STANDARD		
24/	ELECTRICAL - TOTAL 3 LIGHTS ABOVE ISLAND **(1) STANDARD RELOCATED TO BE ABOVE ISLAND, (2) ADD CAPPED **NOTE, ISLAND WILL BE 12 FEET LONG, SPACE ELECTRICAL EVENLY		
25/	ELECTRICAL - MASTER ENSUITE - TOTAL (4) ROUGH IN WALL SCONCES; 2 ON EACH VANITY ON EITHER SIDE OF SINK, APPROX 67 INCHES FROM FLOOR, 5 INCHES FROM EACH SIDE, DELETE STANDARD LIGHT		
26/	ELECTRICAL - KITCHEN - UNDER CABINET LED STRIP LIGHTING IN KITCHEN ON SEP SWITCH		
27/	ELECTRICAL - 15 AMP PLUG FOR FUTURE WINE FRIDGE **SEE KITCHEN LAYOUT		
28/	ELECTRICAL - 15 AMP PLUG FOR MICROWAVE **SEE KITCHEN LAYOUT		
29/	ELECTRICAL - 240V FOR BUILT IN WALL OVEN **SEE KITCHEN LAYOUT		
30/	ELECTRICAL - MASTER ENSUITE - ADD GFI PLUG TO OPPOSITE OF STANDARD PLUG (BOTH VANITIES WILL HAVE A PLUG)		

STRUCTURALS AND COLOURS

2/7/2017

## ANGUS SOUTH

Item #	Construction Details ANGUS SOUTH: LOT 20  Model Type & Elevation : MAGNOLIA 40-07 ELEV. A Purchasers Names : IAN RAMPADARAT & JAYANI FATIMA CYNTHIA BIYANWILA		
		Date	Note
31/	ELECTRICAL - STNDARD PLUGS		
	(1) ABOVE COUNTERTOP DESK IN KITCHEN		
	(1) GREAT ROOM AT THE STANDARD HEIGHT FROM THE FLOOR		
	(1) 2ND FLOOR HALLWAY INSTALL ??? FROM THE FLOOR		
	(1) MASTER BEDROOM STANDARD HEIGHT FROM FLOOR		
32/	ELECTRICAL - KITCHEN - (1) CAPPED LIGHT ON SAME SWITCH AS ISLAND LIGHTS		
33/	ELECTRICAL - KITCHEN - (6) PUCK LIGHTS IN UPPER CABINETS IN KITCHEN, ON SAME SWITCH AS VALANCE LIGHTING		
34/	ELECTRICAL - KITCHEN - INSTALL STANDARD CHIMNEY HOOD FAN IN KITCHEN (HOMEONWERS WILL BE CHANGING AFTER CLOSING)		
35/	FRONT DOORS - DOUBLE FRONT DOORS IN LIEU OF SINGLE		
36/	FIREPLACE - GREAT ROOM - 30" B30NTR) GAS FIREPLACE INCLUDES STANDARD PAINT GRADE MANTLE & 4 INCH MARBLE SURROUND **NOTE - FIREPLACE WILL COME INTO THE ROOM (NO FOUNDATION JOG)		
37/	FRAMING - NO BULKHEADS IN KITCHEN, IF POSSIBLE		
38/	FRAMING / MIRRORS - DELETE FRONT HALL CLOSET ***NO NIB WALLS, OPEN SPACE		
39/	GLASS - MASTER ENSUITE - FRAMELESS GLASS SHOWER IN LIEU OF STANDARD		
40/	GARAGE - GARAGE MAN DOOR, IF GRADE PERMITS		
41/	HVAC / ELECTRICAL - GAS LINE TO STOVE **INCLUDES 15 AMP PLUG, 40 AMP TO REMAIN		
42/	HVAC - KITCHEN - VENT SIZE TO FOLLOW WITH SPECS		
43/	LAMINATE - MAIN FLOOR STANDARD AREAS TO STAINED LAMINATE ***NOTE - INCLUDES STAINING OF STAIRS		
44/	LAMINATE - KITCHEN, BREAKFAST, FOYER - UPGRADE TO LAMINATE IN LIEU OF TILE		
45/	PLUMBING - MASTER ENSUITE - STANDARD SHOWER HEAD TO REMAIN		
46/	PLUMBING - KITCHEN - MOEN POTFILLER IN BRUSHED NICKEL, TRADITIONAL MODEL #S664 (INSTALL BEHIND COOKTOP) SEE SKETCH FOR LOCATION		
47/	PLUMBING - WATERLINE TO FRIDGE		
48/	PLUMBING - TWIN BATH - DOUBLE SINKS		

**STRUCTURALS AND COLOURS**

**2/7/2017**

ANGUS SOUTH

Item #	Construction Details ANGUS SOUTH: LOT 20  Model Type & Elevation : MAGNOLIA 40-07 ELEV. A Purchasers Names : IAN RAMPADARAT & JAYANI FATIMA CYNTHIA BIYANWILA		
		Date	Note
49/	PLUMBING - MASTER ENSUITE - ADD RAIN HEAD SHOWER AND INSTALL ON CENTRE OF CEILING, MOEN CHROME #S112 w/6 INCH SHOWER ARM #S112 AND 3/4 INCH VOLUME CONTROL ***STANDARD SHOWER HEAD TO REMAIN		
50/	STAIRS - OAK STAIRS IN LIEU OF CARPET		
51/	TILE - MASTER ENSUITE - SHOWER JAMB WHITE QUARTZ; MARBLE SHOWER FLOOR TILES		
52/	TILES - LAUNDRY - UPGRADE 5 FLOOR TILES, INSTALL 1/4 BRICK		
53/	TILES - MAIN BATH - UPGRADE 5 FLOOR TILES, INSTALL 1/4 BRICK; UPGRADE 3 WALL TILES, INSTALL HOIZONTAL BRICK		
54/	TILES - MASTER ENSUITE - UPGRADE 5 FLOOR TILE, INSTALL 1/4 BRICK; UPGRADE 3 WALL TILE, INSTALL HORIZONTAL BRICK		
55/	TILES - MUD ROOM - UPGRADE 4 FLOOR TILES, INTALL 1/4 BRICK		
56/	TILES - POWDER ROOM - UPGRADE 5 FLOOR TILES, INSTALL 1/4 BRICK		
57/	TILES - TWIN BATH - UPGRADE 5 FLOOR TILES, INSTALL 1/4 BRICK; UPGRADE 3 WALL TILES, INSTALL HOIZONTAL BRICK		
58/	TRIM - LAUNDRY ROOM - DOOR TO SWING INSIDE THE ROOM		
59/	TRIM - DELETE MAIN FLOOR MUDROOM DOOR		

STRUCTURALS AND COLOURS

2/7/2017

# ZANCOR HOMES COLOUR CHART

CABINETRY / COUNTERTOPS						
	DOOR STYLE	HARDWARE	COUNTERTOP	EDGE		
Kitchen	CAMBRIDGE <del>mdf</del> -WHITE	<input checked="" type="checkbox"/>	Black 1600 BC CALCATTA 4925K-07	<input checked="" type="checkbox"/>		
Island	CAMBRIDGE <del>mdf</del> -WHITE	<input checked="" type="checkbox"/>	DR. Heup 3460 CALCATTA 4925K-07	<input checked="" type="checkbox"/>		
Servery	NA					
Master Ensuite	CAMBRIDGE <del>mdf</del> -WHITE	<input checked="" type="checkbox"/>	H 800 BC CALCATTA 4925K-07	<input checked="" type="checkbox"/>		
Main	CAMBRIDGE <del>mdf</del> -WHITE	<input checked="" type="checkbox"/>	H 800 BC CALCATTA 4925K-07	<input checked="" type="checkbox"/>		
Twin	CAMBRIDGE <del>mdf</del> -WHITE	<input checked="" type="checkbox"/>	H 800 BC CALCATTA 4925K-07	<input checked="" type="checkbox"/>		
Ensuite ###	NA					
Powder Room	NA					
Laundry	NA					
Basement Bath	NA					
TILES						
Main Foyer	NA	LAMINATE				
Basement Foyer	NA					
Powder Room	ROMA STATUARIO 12 X 24 INSTALL 1/4 BRICK UP# 5	<input checked="" type="checkbox"/>				
Mud Room	WOOD SMOKE 12 X 24 1/4 BRICK UP# 4	<input checked="" type="checkbox"/>				
Main Hall	NA					
Kitchen Floor	NA					
Breakfast Floor	NA					
Kitchen Bk.Splash	NA					
Laundry	ROMA STATUARIO 12 X 24 INSTALL 1/4 BRICK UP# 5	<input checked="" type="checkbox"/>				
Mstr Ensuite Floor	ROMA STATUARIO 12 X 24 INSTALL 1/4 BRICK UP# 5	<input checked="" type="checkbox"/>				
Mstr Ensuite Shower	CARRARRA SERIES WHITE/GREY UP # 3 1/4 BRICK /HORIZONTAL	<input checked="" type="checkbox"/>				
Mstr Ens Tub Wall/Deck	NA					
Master Shower Floor	2 X 2 MARBLE ORIENTAL WHITE	<input checked="" type="checkbox"/>				
Master Shower Jamb	WHITE QUARTZ	<input checked="" type="checkbox"/>				
Main Bath Floor	ROMA STATUARIO 12 X 24 INSTALL 1/4 BRICK UP# 5	<input checked="" type="checkbox"/>				
Main Bath Tub Wall	CARRARRA SERIES WHITE/GREY UP # 3 1/4 BRICK /HORIZONTAL	<input checked="" type="checkbox"/>				
Twin Bath Floor	ROMA STATUARIO 12 X 24 INSTALL 1/4 BRICK UP# 5	<input checked="" type="checkbox"/>				
Twin Ensuite Tub Wall	CARRARRA SERIES WHITE/GREY UP # 3 1/4 BRICK /HORIZONTAL	<input checked="" type="checkbox"/>				
Ensuite ### Bath Floor	NA					
Ensuite ### Bath Wall	NA					
Basement Ensuite Floor	NA					
Basement Ensuite Wall	NA					
HARDWOOD / CARPET/LAMINATE						
Living Room	NA					
Dining Room	LEXINGTON MIDNIGHT OAK TL 210006					
Family/Great Room	LEXINGTON MIDNIGHT OAK TL 210006					
Den/Study/parlour/Library	LEXINGTON MIDNIGHT OAK TL 210006					
Kitchen *(Waiver)	LEXINGTON MIDNIGHT OAK TL 210006					
Main Foyer *(Waiver)	LEXINGTON MIDNIGHT OAK TL 210006					
Main Hall	LEXINGTON MIDNIGHT OAK TL 210006					
Upper Hall	LEXINGTON MIDNIGHT OAK TL 210006					
Master Bedroom	CARPET PERFORMA 11 CANVAS # 6304					
Bedroom 2	CARPET PERFORMA 11 CANVAS # 6304					
Bedroom 3	CARPET PERFORMA 11 CANVAS # 6304					
Bedroom 4	CARPET PERFORMA 11 CANVAS # 6304					
Carpet Underpad	STANDARD					
FIREPLACES						
LOCATION	GREAT ROOM	Opt. Surround	BIANCA CARR	MANTLE	NF 8	
LOCATION		Opt. Surround		MANTLE		
MIRRORS & ACCESSORIES						
Mirrors	DELETE ALL	<input checked="" type="checkbox"/>	Opt. Crown Moulding		NA	
Bathroom Accessories	DELETE ALL	<input checked="" type="checkbox"/>	location		NA	
Purchaser has reviewed the colour chart						
***FOR TRADE USE***						
					ANGUS SOUTH	20
Any upgrades in the colour chart must be accompanied with a PES. It is the responsibility of all Trades to inform the builder of any discrepancies on sketches, PES and/or colour charts PRIOR to installation.					Purchaser Initial	Vendor



# ZANCOR HOMES COLOUR CHART

STAIRS, RAILING & PICKETS & STAIR STAIN			
Stair Stain / Species:		STAIN MIDNIGHT OAK ✓	
White Paint Req'd		NA	
Main to 2nd Railing Details:		STANDARD OAK	
Main to top of Basement stairs		STANDARD OAK	
TRIM			
Casing/Baseboards		STANDARD ✓	
Interior Doors		STANDARD ✓	
Interior Door Hardware		STANDARD ✓	
Exterior Door Hardware		STANDARD ✓	
PAINT			
Kitchen/Breakfast	WARM GREY ✓	Master Beds	WARM GREY
Living Room	NA ✓	Bedroom 2	WARM GREY
Dining Room	WARM GREY ✓	Bedroom 3	WARM GREY
Family/Great room	WARM GREY ✓	Bedroom 4	WARM GREY
Den/Study	WARM GREY ✓	Master Ens.	WARM GREY
Main/Upper Hall	WARM GREY ✓	Main	WARM GREY
Laundry	WARM GREY ✓	Twin	WARM GREY
Powder Room	WARM GREY ✓	Basement	NA
PLUMBING- UPGRADES TO BE DETAILED ON PES			
FIXTURES	FAUCETS	NOTES	
Kitchen	STANDARD	W6 STANDARD ✓	UPGRADE POT FILLER SEE PES ✓ #
Powder Room	STANDARD	STANDARD ✓	
Master Ensuite	STANDARD	STANDARD ✓	
Twin bath	STANDARD	STANDARD ✓	
MAIN Bath	STANDARD	STANDARD ✓	
BASEMENT	NA	NA	
Other	NA	NA	
ZANCOR APPLIANCE REQUIREMENTS-UPGRADES TO BE DETAILED ON PES			
Appliance Package received in 'Schedule E'		YES / NO Package Name:	
GAS LINE BBQ	UPG (SEE PES)	DECLINED	NOTES
WATERLINE to Fridge	STANDARD ✓		
Hood Fan Venting SIZE	NA		
ELECTRICAL for Built-in Oven	6" STANDARD ✓		
ELECTRICAL for Built-in Micro	UPGRADE ✓		
ELECTRICAL for Gas Stove / Cooktop	UPGRADE ✓		
ELECTRICAL for Bar Fridge	UPGRADE ✓		
DISCLAIMER		INITIALS	
Colours of all materials are as close as possible to Builders selection but not necessarily identical due to dye lot variances in manufacturing/manufacturers. Due to construction progress some items may have been pre-selected or installed. In this event the Vendor's selection must be accepted by the purchaser			
Any changes to the colour chart after signing are subject to a \$5000 administration fee plus costs			
Purchaser has checked and acknowledged accuracy of colour and selections before signing.			
SITE: ANGUS SOUTH	40-7 MAGNOLIA	LOT: 20	
PURCHASER(S):	Ian Rampadarat		
HOME #/CELL #	Jayani Fatima Cynthia Biyanwila		
EMAIL:	647-961-3524		
DÉCOR NOTES			
***FOR TRADE USE***			
Any upgrades in the colour chart must be accompanied with a PES.			
It is the responsibility of all Trades to inform the builder of any discrepancies on sketches, PES and/or colour charts PRIOR to installation.			
*** PAGE 2 OF 2 ***			
ZANCOR HOMES			
Purchaser Signature		Date	
Purchaser Signature		Date	
D décor Consultant Signature		Date	
Vendor Signature		Date	

Lot 20

40-7- Ekou A

Nov 12/16

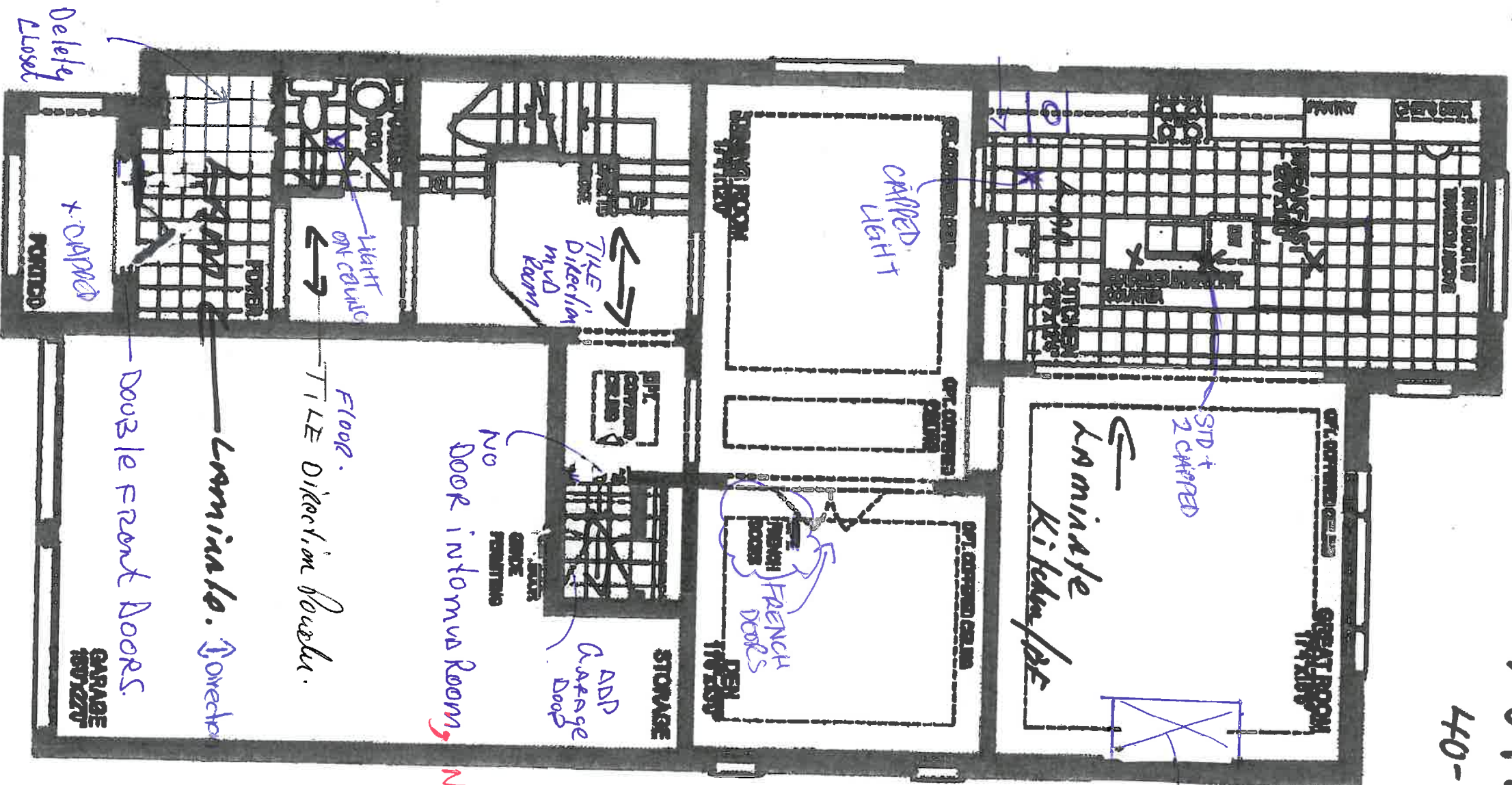

GROUND FLOOR PLAN, E.L. 'A'

FEB 02 2017



10120

40-7-  
Elev A

2 SCONES  
CAPPED  
ON 5/8" SW.  
2 SCONES  
CAPPED  
FLOOR TILE  
DIRECTION  
FRAMES 20013/16

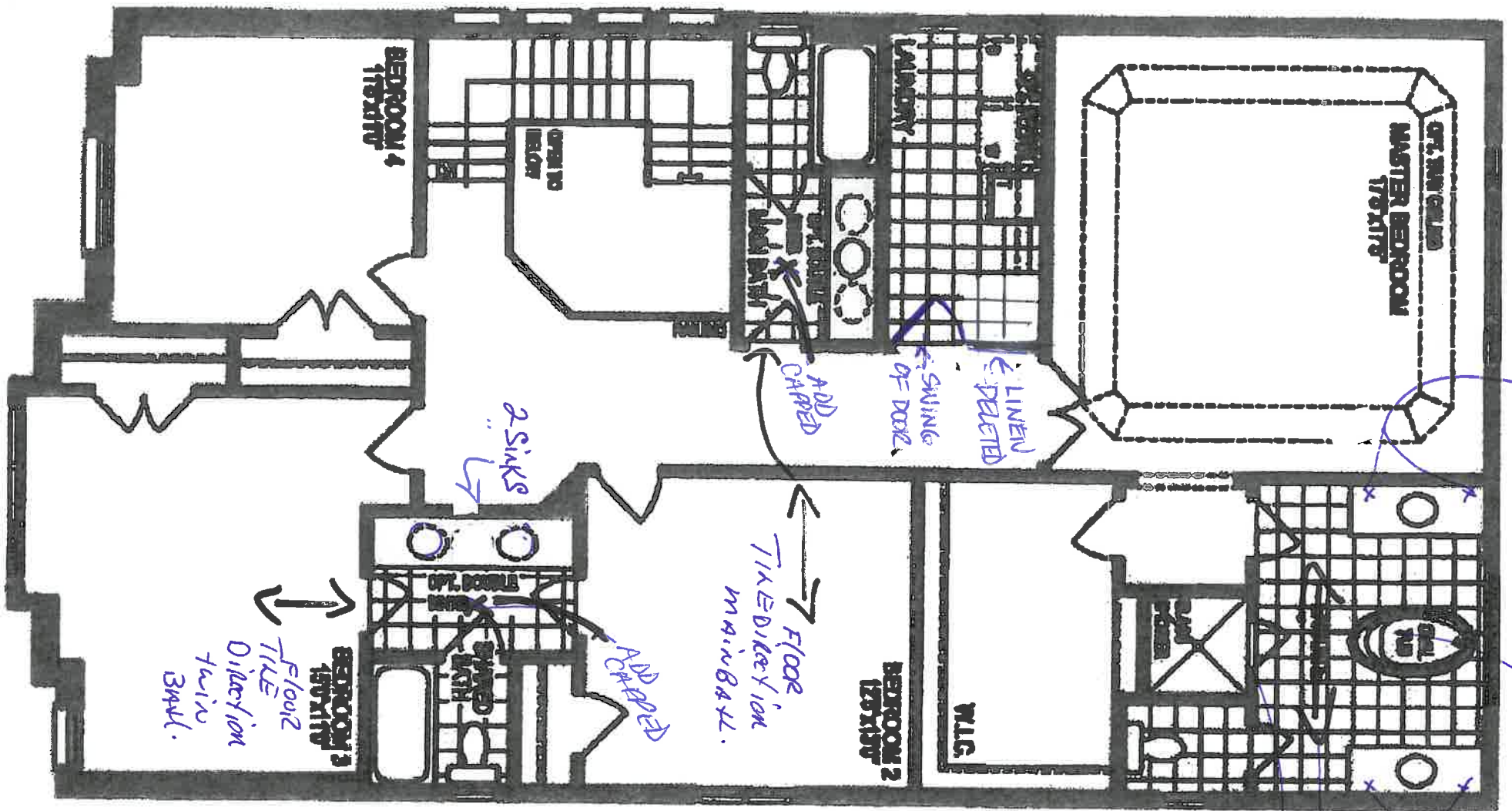

Elev. A.

X  
X  
X



Page 2 of 2

NEW IMAGE KITCHENS INC			
Scale:	Approved by:	Drawn by:	Y.M.E.
Date: 11/09/16	Rev: 01	Rev: 01	
ZANCOR HOMES		LOT 20 ANGUS SOUTH	
		Drawing number:	

66620

Angus South

Jan 16/17

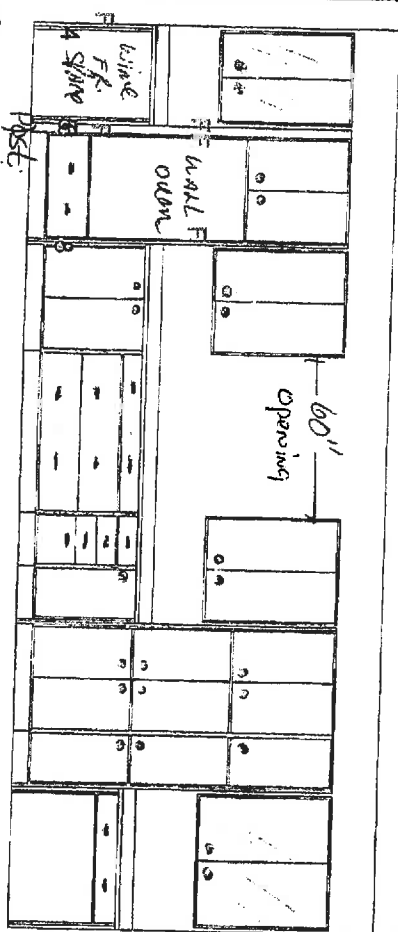

- 1 Deep up floor over Frige 2 side Panels
- 2 Space for wine Frige
- 3 (6) clear glass inserts
- 4 cook top cabinet with pot drawers
- 5 7cm wide Tall Plain Post. 29" Deep (To be in line with dining room. must not be larger than dining open
- 6 extend island cabinet's to be 12' in length Plus
- 7 Built in wall oven/mw with pot dr. below
- 8 Koolha Bank of drawers on island = 24" wide
- 9 1 - top drawer

X *[Signature]*  
X *[Signature]*

NEW IMAGE KITCHENS INC			
Scale	Drawn by	Checked by	VP'S
Date 1/16/18	Approved by	Reviewed	
ZANCOR HOMES			
LOT 20 ANGUS SOUTH		Drawing number	

Page 1 of 2  
elevation

Lot 20  
Jan 16/17

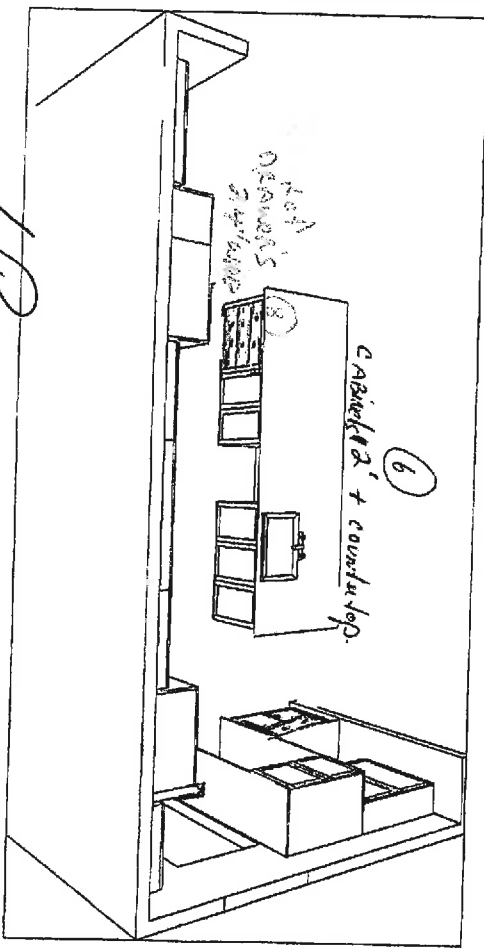
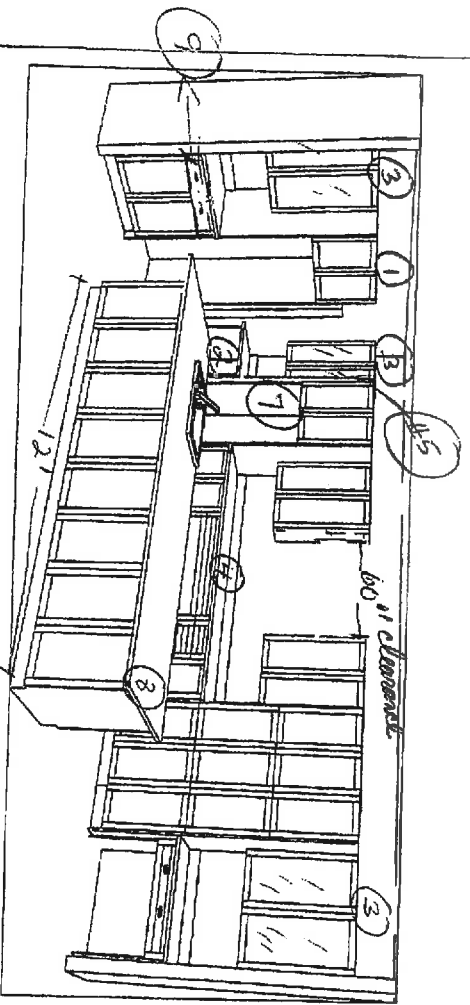

X *[Signature]*  
X *[Signature]*  
X *[Signature]*



Lo620

Nov 18/16

**UPGRADE CABINET HARDWARE**  
**\$500 (Kitchen) / \$150 per Bathroom**  
(New Image Kitchens)



ALL  
DRAWERS  
2 on  
Pot Drawers  
AS  
JR



20 Angus Smith

## STANDARD CABINET HARDWARE

(New Image Kitchens)

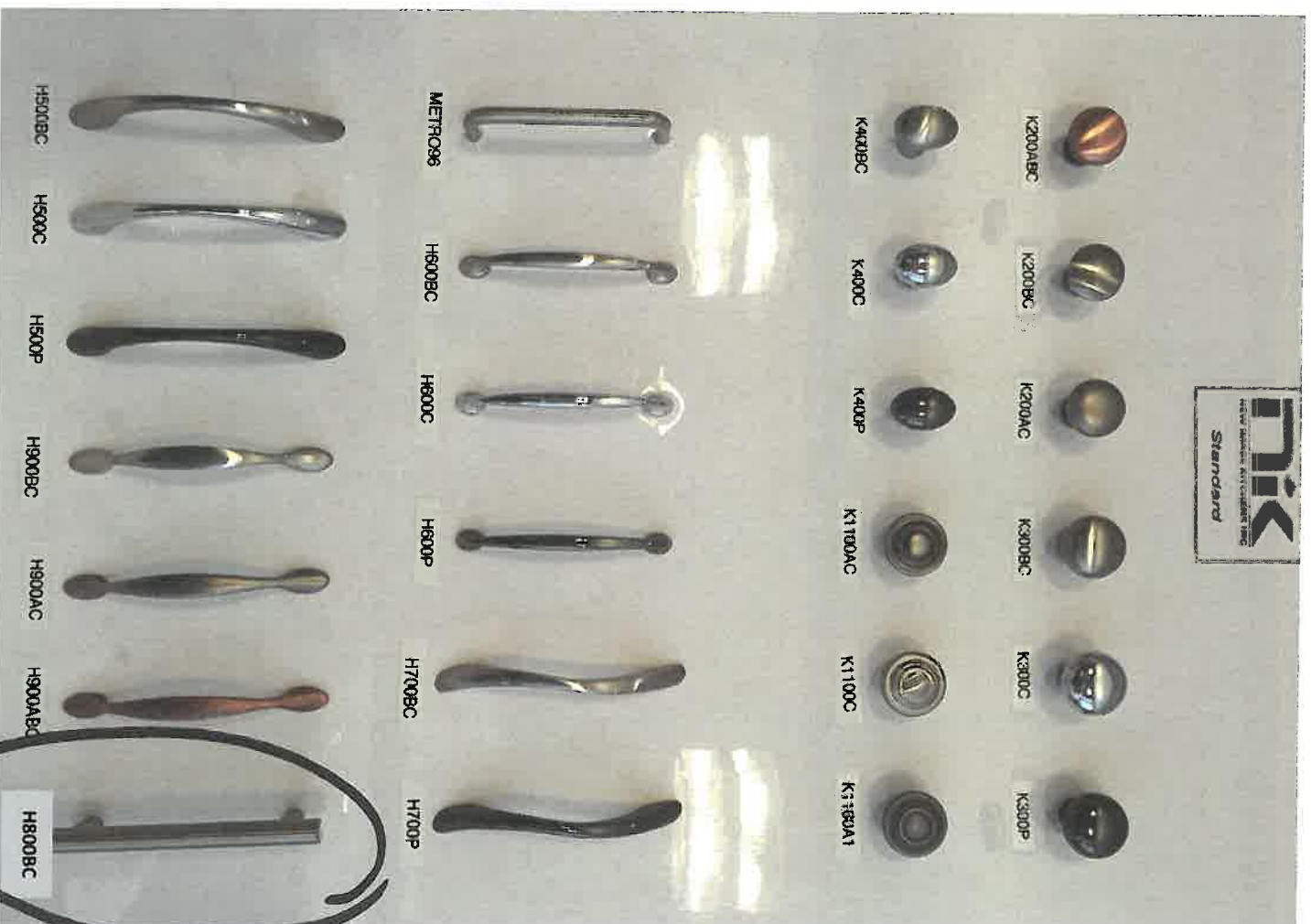

H800BC

Bathrooms

# Thermostatic Showers

Traditional | Transitional | Modern

*ExactTemp® 3/4" valve allows for multiple shower configurations due to its high volume water delivery system.*

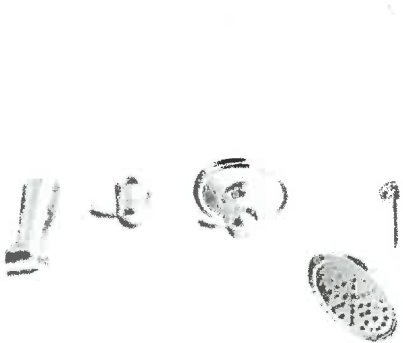

**ExactTemp® Tub/Shower Faucet  
with 3/4" Volume Control \***

Model TS3600 / S3371 / 128284 / S122 /  
S6310 / TS3411 / TS3600 / 3853

Chrome  
Other



**ExactTemp® Shower Only  
with 3/4" Volume Control \***

Model TS3400 / S3371 / S3600

Chrome  
Other



**3/4" Chrome Volume Control**

Model TS3600 / S3600

Chrome  
Other



**FINISH OPTIONS:**

C BN ORB

To order, combine the model number with one of these finish letter(s):  
LifeShine® Brushed Nickel (BN) & Oil Rubbed Bronze (ORB).

To order Chrome (C) model, use model number only.

\* Please see vertical spa guide for installation #700106

*mpack  
Exact  
Due 20/16  
L6120*

*IF*

Add to shower head price if coming from ceiling

# Rainshowers with Immersion™

Traditional | Transitional | Modern

Waterhill™ Single Function  
10" Rainshower with Immersion™ \*

Model S112

S112EP is not available in WR  
Longer Shower Arm Required

Chrome  
Other

Isabel™ Two Function  
9" Rainshower with Immersion™ \*

Model S131

Not available in WR

Chrome - \$149  
Other - \$176

Velocity™ Two Function  
8" Rainshower with Immersion™ \*

Model S6320

Not available in NL or WR

Chrome - \$128  
Other - \$148

Single Function  
8" Rainshower with Immersion™ \*

Model S6360

Available in C, BN and NL

Chrome - \$149  
Other - \$176

## FINISH OPTIONS:



C BN NL ORB

WR

To order, combine the model number with one of these finish letter(s):  
LifeShine® Brushed Nickel (BN), Oil Rubbed Bronze (ORB), LifeShine®  
Polished Nickel (NL) & Wrought Iron (WR).  
To order Chrome (C) model, use model number only.  
\* To order the Eco-Performance (EP) version, use EP suffix in  
addition to finish

# Showering Accessories

Traditional | Transitional | Modern

## 16" Overhead Shower Arm

Model 151380  
Not available in W/R  
Chrome - \$89.84  
Other - \$152.89

## 12" Straight Shower Arm

Model 223651  
Chrome - \$60.48  
Other - \$108.74

## Round Shower Flange

Model 412199  
Chrome - \$13.55  
Other - \$35.60

## Round Shower Flange

Model 147572  
Available in C and BN  
Chrome - \$21.67  
Other - \$42.97

## FINISH OPTIONS:

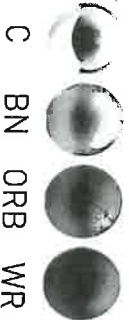

## 8" Curved Shower Arm

Model 123815  
Not available in W/R  
Chrome - \$33.71  
Other - \$73.96

## 6" Straight Shower Arm

Model 116651  
Chrome - \$16.55  
Other - \$27.22

## Round S

Model 116651  
Available in C and BN  
Chrome - \$16.55  
Other - \$27.22

To order, combine the model number with one of these finish letter(s):  
LifeShine® Brushed Nickel (BN), Oil Rubbed Bronze (ORB) & Wrought Iron (WR).  
To order Chrome (C) model, use model number only.  
\*\* To order the Eco-Performance (EP) version, add "EP" after the model number



# Pot Fillers

Traditional | Transitional | Modern

Convenient flow control over a cooktop.

Dual joints allow for maximum reach and dual shut-off valves mean never reaching over a hot surface to turn it off.

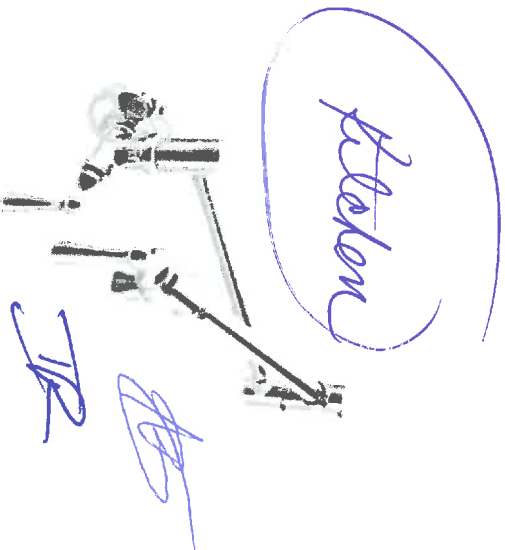

**Traditional Two Handle Pot Filler  
Faucet with Dual Shut-Offs ±**

Model S664

Chrome  
Other

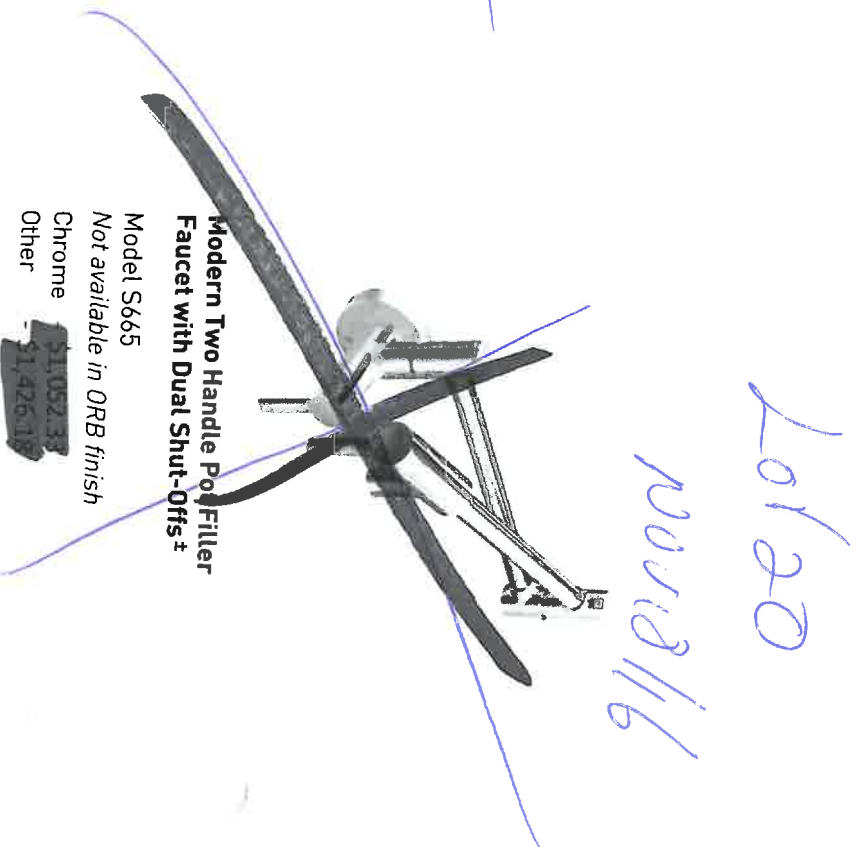
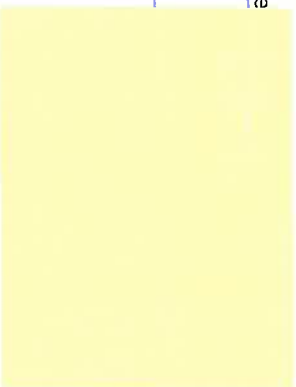

**Modern Two Handle Pot Filler  
Faucet with Dual Shut-Offs ±**

Model S665

Not available in ORB finish

Chrome  
Other



## FINISH OPTIONS:



C SRS ORB

To order, combine the model number with one of these finish letter(s):  
Spot Resistant™ Stainless (SRS) & Oil Rubbed Bronze (ORB).

To order Chrome (C) models, use model number only.  
± Single hole installation only

**INTERIOR FINISHES ACKNOWLEDGEMENT / WAIVER**

Purchaser accepts and acknowledges that the Builder reserves the right to substitute materials with those of equal or better quality where the manufacture, scheduling or delivery of materials may directly impact the Builder's ability to meet its' contractual obligations under the Agreement of Purchase and Sale.

**PORCELAIN & NATURAL STONES:** Due to the properties of natural stones including but not limited to **marble, granite, quartz**, no two pieces are exactly the same. Variations in colour, tone, granularity (pitting, fissures) and pattern are to be expected, including various lighting may affect the overall finished look. Stone should never be cleaned with lemon oil or vinegar. The purchaser acknowledges colour and product variations as well as natural imperfections that may exist with the selection of natural stone materials and shall not hold the Vendor liable for provision of same.

**STONE COUNTERTOP JOINTS:** Purchaser is aware that one joint will be at each corner and on either side of slide-in-range (if applicable). It will also be where the length of the counter top exceeds the length of a stone slab. Slabs are usually approximately 5'x 8'.

**CERAMIC TILES:** Due to manufacturing, shade (dye lots), product variations may exist that can affect the overall look of the finished product. Although every effort will be made to ensure the colours and materials selected are as close as possible to the samples, the purchaser acknowledges that the sample tiles supplied in the Design Centre may not be identical to the materials installed in the home.

**STAIR STAINS:** Due to the natural properties of wood, many variables can affect the overall look of the finished product. Factors including but not limited to wood type, knotting, graining, density, age, humidity, and air temperature can result in substantial variations in stain intensity. The purchaser accepts that although the Vendor will do their best to match stain the unfinished stairs as close as possible to the pre-finished floors, it is not possible to have an identical match and that there MAY be shade differences between the two products.

**CABINETRY:** Due to the natural properties of wood, slight variations apparent with cabinetry are to be expected. This includes but not limited to wood species, wood grain, colour, finish, product variations, and natural imperfections are all factors that may affect the overall look of the finished product. Such factors make exact colour matching impossible. The type and intensity of lighting in the areas of designated cabinetry placement may also highlight characteristics of cabinetry finish. All cabinets shall be finished with a white melamine interior box unless a finished interior is upgraded. Due to building specifications and/or on-site conditions, certain cabinetry upgrades may not be possible. The purchaser acknowledges that the Builder cannot guarantee the cabinetry finish or provision of certain upgrades and shall not hold the Builder liable for provision of same.

**UPGRADES/EXTRAS:** All upgrades and additional selections indicated on the colour chart must be accompanied by an upgrades/extras sheet (PES) and full payment otherwise the selection will be invalid. All colour charts and upgrades/extras will not proceed until verified and signed by an authorized signing officer at the Vendor's head office. **CHANGES WILL NOT BE PERMITTED UPON COMPLETION AND SUBMISSION OF THE COLOUR CHART.**

**HARDWOOD / LAMINATE FLOORING:** Due to the properties of wood and laminate, many variables can affect the overall look of the finished product. Variations include but not limited to wood type or laminate finish, colour/stain and wood grain are significant factors that make exact colour matching impossible. The purchaser acknowledges that the hardwood flooring is a pre-finished product in a controlled environment. Expansion, compression and cupping are characteristics of hardwood flooring once installed in the home. The purchaser acknowledges these may become apparent over time and despite the Builders' efforts to install the hardwood flooring materials in keeping with good workmanship, the Builder shall not be responsible nor held liable for minor variances of fluctuation in hardwood flooring materials.

**UPGRADES/EXTRAS:** All upgrades and additional selections indicated on the colour chart must be accompanied by an upgrades/extras sheet (PES) and full payment otherwise the selection will be invalid. All colour charts and upgrades/extras will not proceed until verified and signed by an authorized signing officer at the Vendor's head office. **CHANGES WILL NOT BE PERMITTED UPON COMPLETION AND SUBMISSION OF THE COLOUR CHART.**

**HARDWOOD / LAMINATE WAIVER:**

I/We understand hardwood flooring is classified as a porous material and as such not recommended by the Builder in certain areas. I/We understand there is a concern due to possible water and other substances being frequently splashed or spilled onto the floor and in contravention of Ontario Building Code Section 9.30.1.2(1).

*"Finished flooring bathrooms, kitchens, public entrance halls, laundry & general storage areas shall consist of resilient flooring, felted-synthetic-fibre floor coverings, concrete, terrazzo, ceramic tile, mastic or other types of flooring providing similar degrees of water resistance."*

I/We are prepared to assume full responsibility for any damage caused to the hardwood floor or subfloor due to moisture absorbency in the mentioned areas, and agree to waive any claims against the Township of residence, TARIION and/or the Builder in relation to the matter.

**\*\*SEE COLOUR CHART FOR LOCATIONS\*\***

SITE

LOT

DATE

# APPLIANCE SPEC INFORMATION SHEET

STE & LOT:

20 Angus

DATE:

Nov 18/16

SITING:

☐ Standard

☐ Reverse

## RANGE

☐ 30" (STD)

☐ 36"

☐ 48"

☐ GAS

☐ COOKTOP (APRON)

☒ COOKTOP (DROPI)

☐ AMPS

☐ AMPS

☐ AMPS

☒ STANDARD OPENING 36" X 72"

☐ BUILT IN FRIDGE

☐ WATERLINE REQUIRED

☐ PANELLED/INTEGRATED

☐ FLUSH INSET

## WALL OVENS

☐ 30"

☒ SINGLE *Need spec*

☐ DOUBLE

☐ STEAM OVEN

☐ WARMING DRAWER

☐ AMPS

☒ AMPS

☐ AMPS

☐ AMPS

## MICROWAVES

☐ BUILT IN MICRO

☒ MICRO TRIM KIT *spec*

☐ OVER THE RANGE

☐ AMPS

☐ MODEL

☐ AMPS

## HOOD FANS

☒ CHIMNEY (CENTRE VENT)

☐ UNDER CABINET

☐ FLUSH INSET

*Need spec. For unit size.*

☐ 6 INCH (STD)

☐ 8 INCH

☐ 10 INCH

## DISHWASHER

☒ 24" (STD SIZE)

## LAUNDRY

☐ FRONT LOADING SIDE BY SIDE

☐ STACKABLE

*TR* Additional charges may apply for cabinetry, electrical and plumbing in order to accommodate the specs given by the homeowner.

*TR* **NOTE:** It is the Purchaser's responsibility to coordinate delivery, installation and hook up of appliances and to ensure they are installed as per Manufacturers specifications after closing.

*TR* Purchaser acknowledges responsibility for providing correct specification for such appliances. The purchaser agrees to deliver forthwith to the Builder the manufacturer's appliance specifications where the size exceeds the standard openings.

*TR* If specs not received, the standard openings as determined by Zancor Homes will be provided. If rework/repair is required due to late specs received, additional costs will be applied.

Appliance Specs not received, DUE BY:

Dec 15/16

Appliance Specs RECEIVED

Purchaser Signature

*[Signature]*

Date

Nov 18/16

Purchaser Signature

*[Signature]*

Date

Nov 18/16

30" (76.2 CM) AND 36" (91.4 CM) GAS BUILT-IN COOKTOP

PRODUCT MODEL NUMBERS

KCGS3350E	KCGS950E	MGC9630D	WCG75US0D
KCGS3356E	KCGS956E	MGC9636D	WCG97US0D
KCGS550E	MGC7430D	WCG51US0D	WCG97US6D
KCGS556E	MGC7536D	WCG51US6D	

GAS SUPPLY REQUIREMENTS

Type of Gas

Natural Gas:

- This cooktop is factory set for use with Natural gas. If converting to LP gas, see the "LP Gas Conversion" instructions provided in the package containing literature. The model/serial rating plate located on the underside of the cooktop base has information on the types of gas that can be used. If the types of gas listed do not include the type of gas available, check with the local gas supplier.

LP Gas Conversion:

Conversion must be done by a qualified service technician.

No attempt shall be made to convert the cooktop from the gas specified on the model/serial rating plate for use with a different gas without consulting the serving gas supplier. See the Gas Conversion instructions provided in the package containing literature.

Gas Supply Line

- Provide a gas supply line of ¾" (1.9 cm) rigid pipe to the cooktop location. A smaller size pipe on longer runs may result in insufficient gas supply. Pipe-joint compounds that resist the action of LP gas must be used. Do not use TEFLO<sup>®</sup> tape. With LP gas, piping or tubing size should be ½" minimum. Usually, LP gas suppliers determine the size and materials used in the system.

Flexible metal appliance connector:

- If local codes permit, use a ½" or ¾" I.D. flexible stainless steel tubing gas connector, designed by CSA to connect the cooktop to the rigid gas supply line.



- A ½" male pipe thread is needed for connection to the female pipe threads of the inlet to the cooktop pressure regulator.
- Do not kink or damage the flexible metal tubing when moving the cooktop.

20120  
Angus Scott

- Must include a shutoff valve:

The supply line must be equipped with a manual shutoff valve. This valve should be located in the same room but external to the cooktop opening, such as an adjacent cabinet. It must be accessible without removing the cooktop, and it should be in a location that allows ease of opening and closing. Do not block access to shutoff valve. The valve is for turning on or shutting off gas to the cooktop.

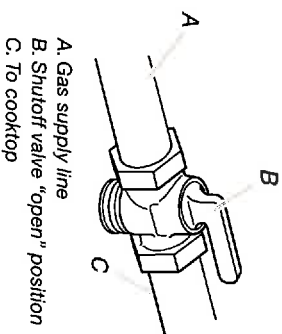

<sup>®</sup>TEFLON is a registered trademark of E.I. Du Pont De Nemours and Company.

ELECTRICAL REQUIREMENTS

- A 120 volt, 60 Hz, AC, only, 15-amp, fused electrical circuit is required. A time-delay fuse or circuit breaker is also recommended. It is recommended that a separate circuit serving only this cooktop be provided.
- Electronic ignition systems operate within wide voltage limits, but proper grounding and polarity are necessary. Check that the outlet provides 120-volt power and is correctly grounded.



PRODUCT DIMENSIONS

KCGS550ESS and KCGS950ESS Models

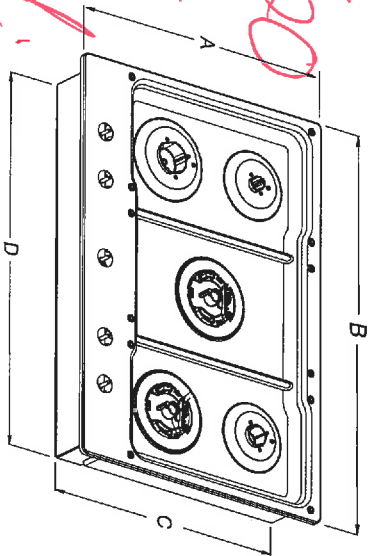

- A. 21" (53.3 cm)
- B. 30" (76.2 cm)
- C. 19 3/8" (49.2 cm)
- D. 28 3/8" (72.1 cm)
- E. 3 5/8" (9.2 cm)
- F. 4 9/16" (11.6 cm)
- G. 1 3/8" (3.4 cm)

KCGS556ESS and KCGS956ESS Models

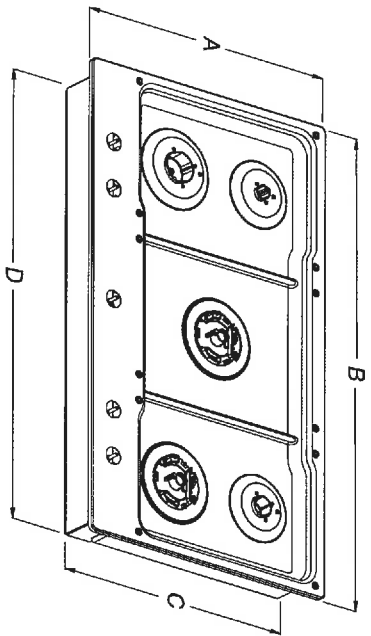

- A. 21" (53.3 cm)
- B. 36 1/4" (92.0 cm)
- C. 19 3/8" (49.2 cm)
- D. 34 3/8" (88.1 cm)
- E. 3 5/8" (9.2 cm)
- F. 4 5/16" (11.6 cm)
- G. 1 7/16" (3.6 cm)

All Other 30" (76.2 cm) Models

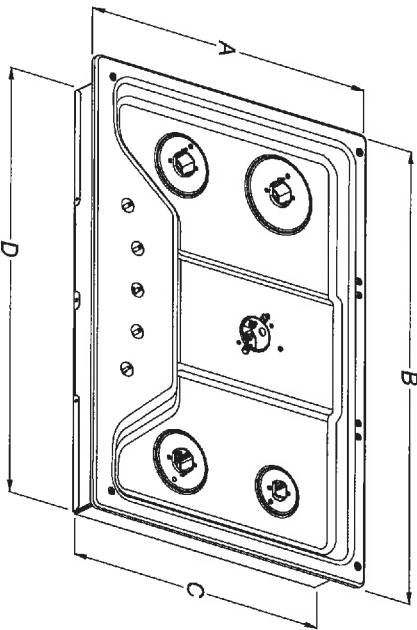

- A. 21" (53.3 cm)
- B. 30" (76.2 cm)
- C. 18 7/8" (48.0 cm)
- D. 28 3/8" (72.1 cm)
- E. 3 3/8" (8.6 cm)
- F. 4 1/8" (10.5 cm)
- G. 1 1/2" (3.8 cm)

All Other 36" (91.4 cm) Models

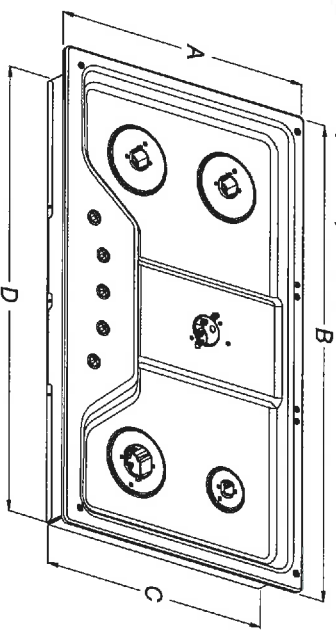

- A. 21" (53.3 cm)
- B. 36" (91.4 cm)
- C. 18 7/8" (48.0 cm)
- D. 33 3/4" (85.7 cm)
- E. 3 3/8" (8.6 cm)
- F. 4 1/8" (10.5 cm)
- G. 1 1/2" (3.8 cm)

CABINET DIMENSIONS

6/120  
Aug 15  
Socle

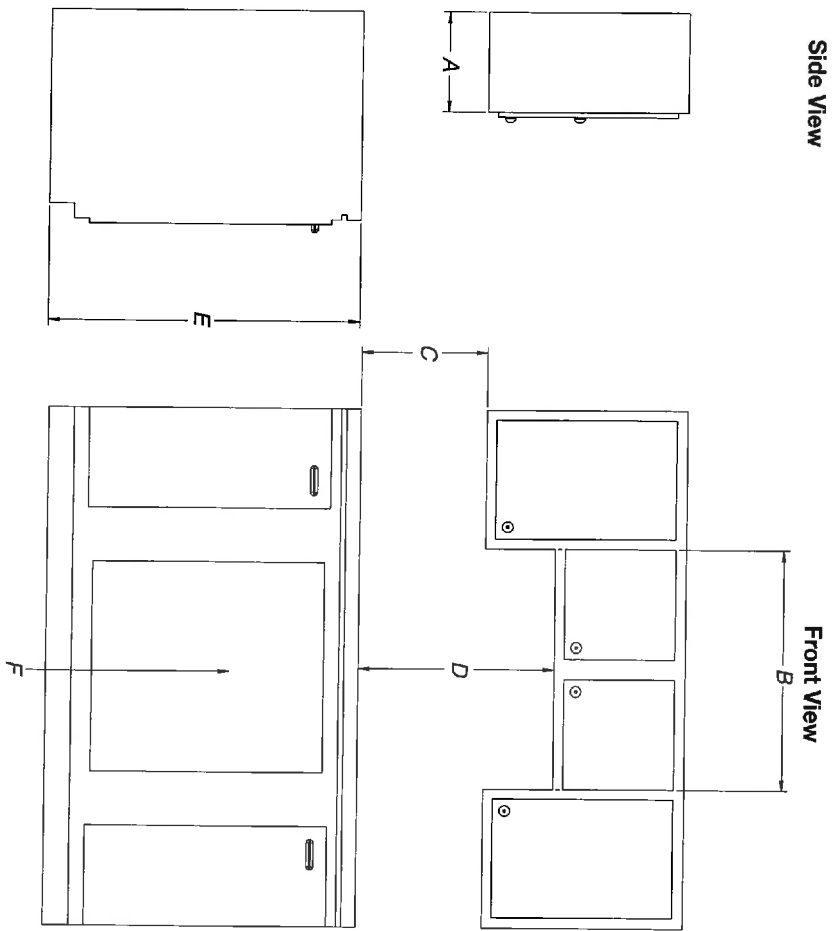

- A. 13" (33.0 cm) recommended upper cabinet depth.
- B. 30" (76.2 cm) for 30" models; 36" (91.4 cm) for 36" models.
- C. 18" (45.7 cm) minimum clearance from upper cabinet to countertop within minimum horizontal clearances to cooktop.
- D. 30" (76.2 cm) minimum clearance between top of cooktop platform and bottom of uncovered wood or metal cabinet. 24" [61 cm] minimum clearance if bottom of wood or metal cabinet is covered by not less than 1/4" [0.6 cm] flame retardant millboard covered with not less than No. 28 MSG sheet steel, 0.015" [0.04 cm] stainless steel, or 0.024" [0.06 cm] aluminum or 0.020" [0.05 cm] copper
- E. 36" (91.4 cm) top of countertop to floor.
- F. Gas line opening - Wall: anywhere 5" (12.7 cm) below underside of countertop. Cabinet floor: anywhere within 6" (15.2 cm) of rear wall is recommended.

CABINET DIMENSIONS (cont.)

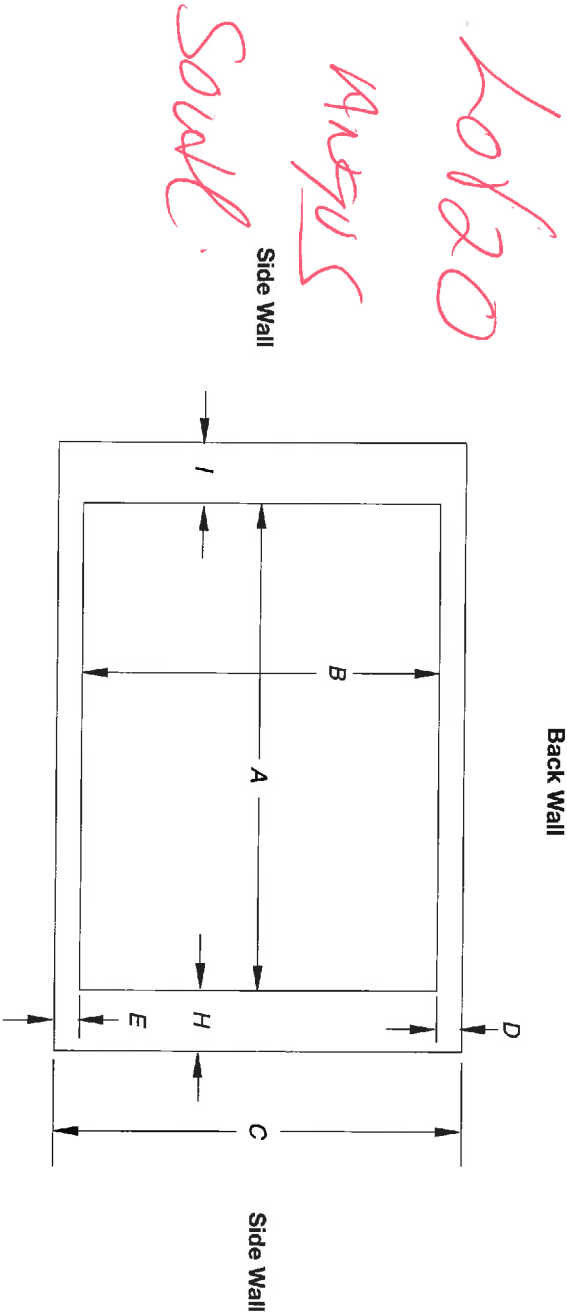

Cutout (Product Opening) Dimensions							
30" (76.2 cm) Models							
Models	A			B			
	Min	Recommended	Max	Min	Recommended	Max	
KCGS550 and KCGS950 All Other 30" (76.2 cm) Models	28 1/2" (72.4 cm) 28 1/2" (72.4 cm)	28 3/8" (73.4 cm) 28 1/2" (73.4 cm)	29 3/16" (74.3 cm) 29 9/16" (74.3 cm)	19 1/2" (49.5 cm) 19" (48.3 cm)	19 13/16" (50.2 cm) 19 1/2" (49.5 cm)	20" (50.8 cm) 20" (50.8 cm)	
36" (91.4 cm) Models							
KCGS556 and KCGS956 All Other 36" (91.4 cm) Models	34 1/2" (88.4 cm) 33 7/8" (86.0 cm)	35 3/8" (89.4 cm) 34 5/16" (87.0 cm)	35 9/16" (90.3 cm) 35 1/4" (89.5 cm)	19 1/2" (49.5 cm) 19" (48.3 cm)	19 13/16" (50.2 cm) 19 1/2" (49.5 cm)	20" (50.8 cm) 20" (50.8 cm)	

Side Walls (Combustible Surfaces)		
Models	H and I	
KCGS5 and KCGS9	H and I added together must be at least 48" (122.0 cm), with each side individually being at least 8" (20.3 cm).	
KCGS350, KCGS356, MGC9536, WCG97US0, WCG97US6	H and I added together must be at least 48" (122.0 cm), with each side individually being at least 12" (30.5 cm).	
All Other Models	Both have to be 8" (20.3 cm) or more.	

Back Wall and Countertop Front Dimensions				
Models	C	D		E
KCGS550 and KCGS950	25" (63.5 cm)	2 7/8" (7.3 cm)		2 3/4" (6.9 cm)
All Other Models				3 1/8" (7.9 cm)

**NOTES:** After making the countertop cutout, some installations may require notching down the base cabinet side walls to clear the cooktop base. To avoid this modification, use a base cabinet with sidewalls wider than the cutout.

If cabinet has a drawer, a 4" (10.2 cm) depth clearance from the countertop to the top of the drawer (or other obstruction) in base cabinet is required. The drawer depth may need to be shortened to avoid interfering with the regulator.

**IMPORTANT:** If a built-in wall oven is to be installed below this cooktop, the grounded outlet and gas supply piping must be located in an adjacent cabinet.

This cooktop and its gas and electrical supply sources must be installed before the undercounter built-in wall oven is installed.

# KitchenAid®

FOR THE WAY IT'S MADE.®

## Beverage Center

### PRODUCT MODEL NUMBERS

KUBL204E	KUBL304E
KUBR204E	KUBR304E

**Electrical:** A 115 volt, 60 Hz., AC only, 15- or 20-amp fused, grounded electrical supply is required. It is recommended that a separate circuit serving only your beverage center be provided. Use an outlet that cannot be turned off by a switch. Do not use an extension cord.

**NOTE:** Before performing any type of installation, cleaning, or removing a light bulb, unplug beverage center or disconnect power.

L0120  
Angeos  
Soak.

### OPENING DIMENSIONS

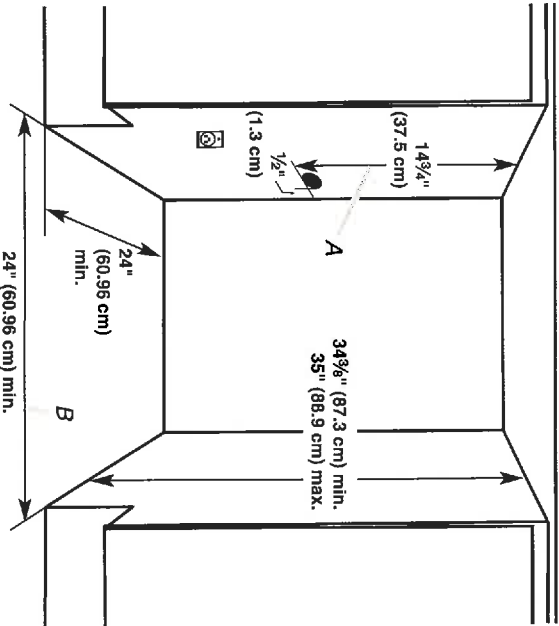

A. 1 1/2" (37.5 cm) utility opening  
B. 24" (60.96 cm) minimum opening width

- Height dimensions are shown with the leveling legs extended to the minimum height.
- NOTE:** When leveling legs are fully extended, add 5/8" (15 mm) to the height dimensions.
- If the floor of the opening is not level with the kitchen floor, shim the opening to make it level with the kitchen floor.

Model	Door Swing
KUBL204E	Left
KUBL304E	Left
KUBR204E	Right
KUBR304E	Right

### LOCATION REQUIREMENTS

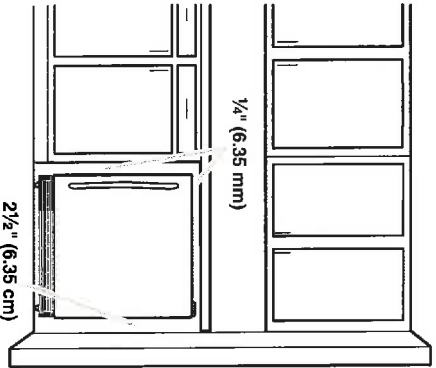

To ensure proper ventilation for your beverage center, allow for a 1/4" (6.35 mm) space on each side and at the top. When installing your beverage center next to a fixed wall, leave 2 1/2" (6.35 cm) minimum clearance on the hinge side to allow for the door to swing open.

**NOTE:** It is recommended that you do not install the beverage center near an oven, radiator, or other heat source. Do not install in a location where the temperature will fall below 55°F (13°C). For best performance, do not install the beverage center behind a cabinet door or block the base grille.

FOR THE WAY IT'S MADE.®

## Undercounter Dishwasher

## PRODUCT MODEL NUMBERS

KDFE204E, KDTE104E, KDTE204E, KDTE254E, KDTM354E,  
KDTM384E, KDTM404E, KDTM504E, KDTM704E, KDTM804E

**Electrical Requirements:** 120-volt, 60 Hz, AC-only, 15- or 20-amp, fused electrical supply. Copper wire only. A time delay fuse or circuit breaker and separate circuit is recommended.

**If direct wiring dishwasher:** Use flexible, armored or nonmetallic, sheathed copper wire with grounding wire that meets the wiring requirements for your home and local codes and ordinances.

Use a UL Listed or CSA Approved conduit connector.

Use power supply cord kit (Part Number 4317824) marked for use with dishwashers. Follow the kit



instructions for installing the power supply cord. Power supply cord must plug into a grounded three-prong outlet located in the cabinet next to the dishwasher opening. Outlet must meet all local codes and ordinances.

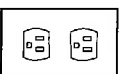

**Water Supply Requirements:** A hot water line with 20 to 120 psi (1.38 to 862 kPa) water pressure. Water temperature must be 120°F (49°C) water at dishwasher. Use  $\frac{3}{8}$ " O.D. copper tubing with compression fitting or flexible braided water supply line

**Note:** 1/2" minimum plastic tubing is not recommended.

Use a 90° elbow with  $\frac{3}{4}$ " hose connection with rubber washer (part number W10273460). Do not solder within 6" (15.2 cm) from water inlet valve.

**Drain Requirements:** A new drain hose is supplied with your dishwasher. If this is not long enough, use a new drain hose with a maximum length of 12' (3.7 m) (Part No. 3385556) that meets all current AHAM/AAPMO test standards, is resistant to heat and detergent, and fits the 1" (2.5 cm) drain connector of the dishwasher.

**Make sure to connect the drain hose to waste tee or disposer inlet above drain trap in house plumbing and 20" (50.8 cm) minimum above the floor. It is recommended**

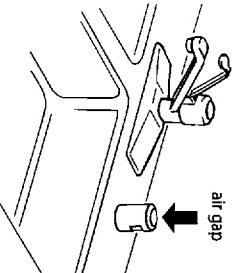

that the drain hose either be looped up and securely fastened to the underside of the counter, or be connected to an air gap.

**Make sure to use an air gap if the drain hose is connected to house plumbing lower than 20" (50.8 cm) above subfloor or**

(U.S. CIT) ABOVE SUBDUOI UI

Use  $\frac{1}{2}$ " (1.3 cm) minimum I.D. drain line fittings.

If required, the air gap should be installed in accordance with the air gap installation instructions. When connecting the air gap a rubber hose (not provided) will be needed to connect to the waste tee or disposer inlet.

## PRODUCT DIMENSIONS

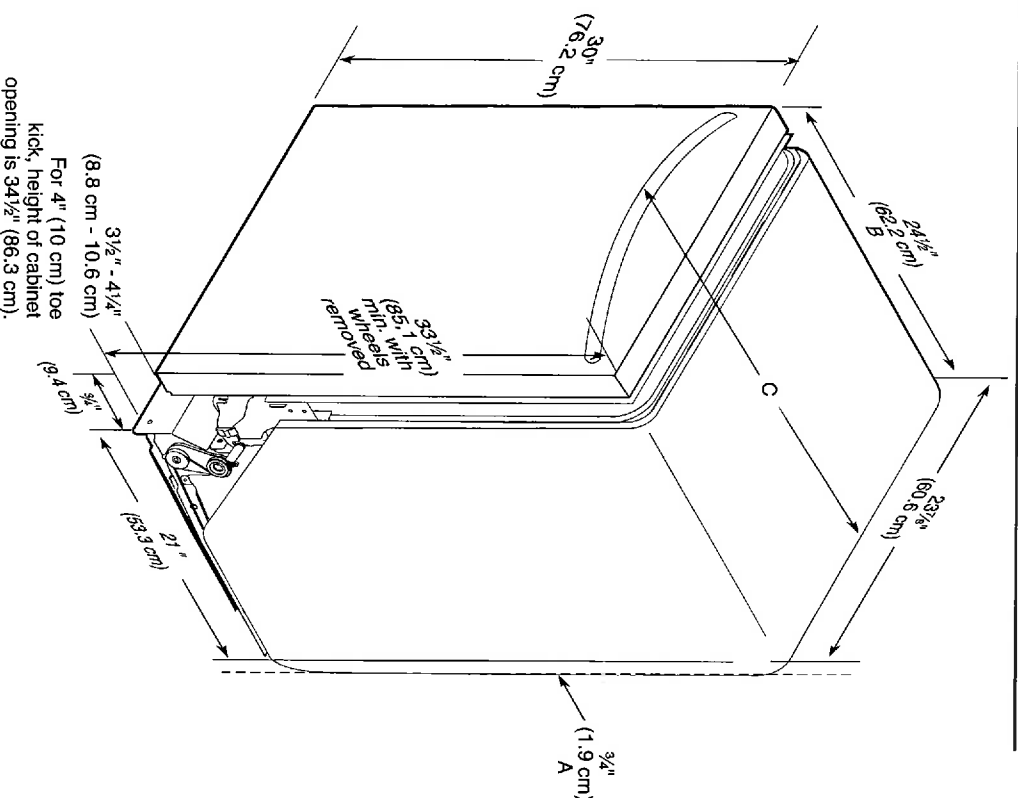

A. Insulation may be compressed (not used on all models).

**B.** For panel-ready models, dishwasher depth is 24" (60 cm) not including the  $\frac{3}{4}$ " (1.9 cm) custom door panel.

C. Door handles may protrude forward of the face of the dishwasher; varies by model.



## CABINET CUTOUT DIMENSIONS

**NOTE:** Shaded areas of cabinet walls show where utility connections may be installed.

\*Measure from the lowest point on the underside of the countertop. May be reduced to 33½" (85.1 cm) be removing the rear leveling legs from dishwasher.

**\*\*Minimum, measured from narrowest point of opening.**

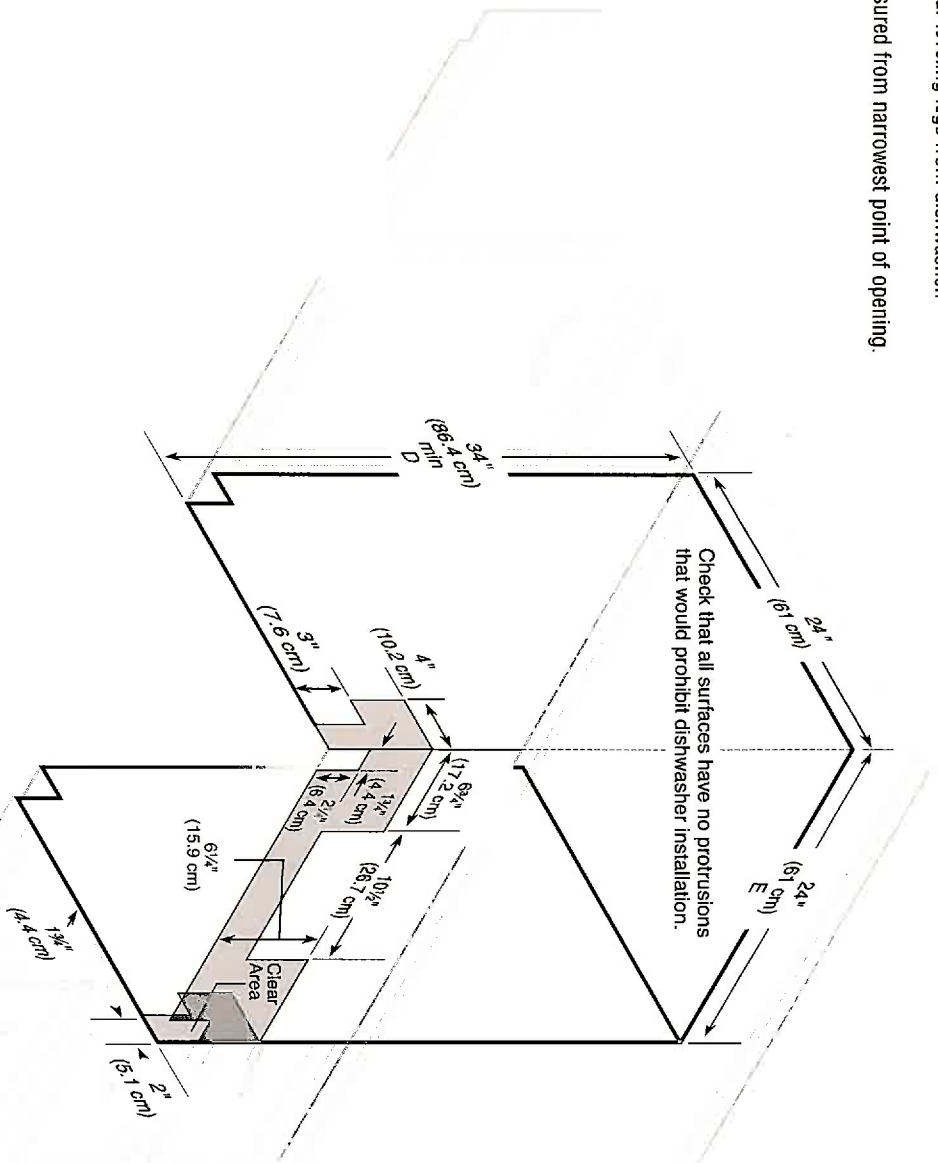

6020 Angus  
Sovall

ENGLISH CUSTOM HOOD LINER INSTALLATION SHEET  
PRELIMINARY INSTRUCTIONS

WARNING

When building a custom hood for an insert or power pack, always follow all applicable construction codes and standards. See the table and illustration below to locate your liner and use corresponding custom hood base dimensions. For the liner installation, only the bottom of the custom hood is needed. Do not finalize the entire custom hood yet, because an access is needed for the insert or power pack electrical connection.

NOTE: We recommend the base of the custom hood should be 3/4" inch thick plywood. We recommend the sides, front and backboard (if included) of the custom hood to be 3/4" thick, assuming standard cabinet widths. The INSIDE DEPTH shown in the table above assumes a minimum cabinet backboard thickness of 3/8".

Consider the shape and size of the power pack to determine the configuration of the custom hood. For more details, refer to the installation manual of the power pack.

For custom hood liner detailed installation instructions, see the reverse of this page.

FRANÇAIS INSTALLATION DU REVÊTEMENT D'ARMOIRE  
INSTRUCTIONS PRÉLIMINAIRES  
AVERTISSEMENT

Toujours suivre tous les codes en vigueur et standards de la construction lors de la construction d'une armoire de module de hotte encastrable.

An de déterminer à quelles dimensions la base de l'armoire correspond le revêtement, voir le tableau et l'illustration ci-dessous. Il n'y a que la base de l'armoire qui est nécessaire pour l'installation du revêtement. Ne pas finaliser l'armoire tout de suite; garder un accès pour le futur branchement électrique du module de hotte encastrable.

NOTE: Nous recommandons que la base de l'armoire soit faite en contreplaqué de 3/4" d'épaisseur. Nous recommandons que l'épaisseur de l'arrière (le cas échéant), de l'avant et des côtés de l'armoire soit de 3/4". La PROFONDEUR INTÉRIEURE indiquée dans le tableau ci-dessus sous-entend que l'épaisseur minimale de l'arrière de l'armoire est de 3/8".

Considérez la forme et la dimension du module de hotte encastrable an de déterminer la conguration de son armoire. Voir le guide d'installation du module de hotte encastrable pour plus de détails.

Voir le verso de cette page pour les instructions détaillées de l'installation du revêtement d'armoire.

ESPAÑOL INSTALACIÓN DEL LINER PARA CAMPANA  
INSTRUCCIONES PRELIMINARES  
ADVERTENCIA

Siempre que instale una cubierta para campanas empotrables, debe seguir los códigos y normas de la construcción. Consulte la tabla y la ilustración que se muestra a continuación para que localice la campana de su elección y utilice la base de dimensiones apropiadas a la campana. Para instalar la cubierta solo necesitará la parte inferior de la campana. No termine la instalación todavía, ya que necesitará dejar una entrada para la conexión eléctrica.

NOTA: Recomendamos que la base de la cubierta sea de triplay de 3/4" de grosor. Recomendamos que los lados, frente y respaldo (en caso de incluirse) de la cubierta sean de 3/4" de grosor, asumiendo estándares de gabinetes. La PROFUNDIDAD INTERIOR mostrada en la tabla asume un respaldo con un grosor mínimo de 3/8". Considere la forma y tamaño de la campana empotrable para determinar la configuración de la cubierta. Para mas detalles, haga referencia al manual de instalación de la campana.

Para detalles sobre la instalación del liner, vea el reverso de esta página.

Liner Models Modèles du Revêtement Modelos de liners	Power Pack models Modèles de module de hotte Modelos de campanas empotrables	Inside width - A Largeur int. - A Ancho int. - A	Inside Depth - B Profondeur intérieure - B	
			Without Backboard Sans panneau arrière Sin parte trasera	With Backboard Avec panneau arrière Con parte trasera
EXXHDL30	EAS428SS EPR628SS	29" (73.75cm)	18 1/4" (46.4cm) to 21 3/8" (53.9cm)	17 1/2" (44.5cm) to 20 1/2" (52cm)
EXXHDL36	EAS428SS EPR628SS	35" (89cm)	18 9/16" (46.8cm) to 21 3/4" (54.3cm)	17 9/16" (44.9cm) to 20 9/16" (52.4cm)

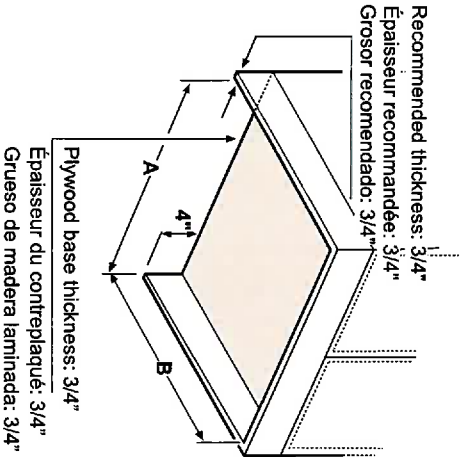

20620 Angus  
South

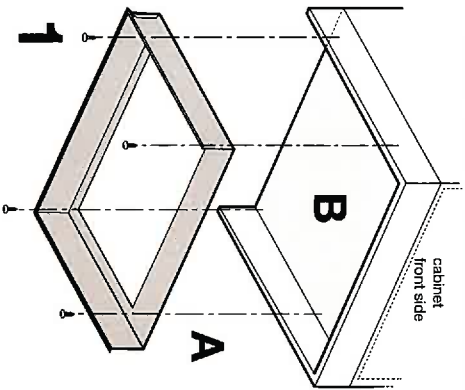

**ENGLISH CAUTION:** Before installing, remove the protective plastic film from all parts.

**NOTE:** The custom hood liner must be installed before the insert or power pack unit.

**CAUTION: FOR ELECTRIC RANGES INSTALLATION:** MOUNT THE HOOD SO THAT THE BOTTOM EDGE OF THE HOOD LINER IS NOT LESS THAN 24" (60.9 CM) ABOVE THE COOKING SURFACE (height measured from the cooktop to the lowest part of the Liner).

**FOR GAS RANGES INSTALLATION:** MOUNT THE HOOD SO THAT THE BOTTOM EDGE OF THE HOOD LINER IS NOT LESS THAN 30" (76.2 CM) ABOVE THE COOKING SURFACE (height measured from the cooktop to the lowest part of the Liner).

- Using the screws provided, temporarily install the main liner plate A to the external base of the cabinet B, Fig. 1.

**NOTE:** Main liner plate should be positioned in custom hood as far rearward as possible.

- Using a pencil, mark the outline of the future hole for the power pack, Fig. 2.

- Remove the main liner plate from the custom hood.

- Cut the hole in the bottom of the cabinet, Fig. 3.

- Reinstall the main liner plate to the base of the cabinet and secure it with 4 screws, Fig. 4.

- Slide the front panel section C forward into the nose of the cabinet base. Take care not to scratch main liner plate when installing front panel section of liner. Assemble it to the frontal side of the cabinet, using one screw per screw hole, Fig. 5.

- Install the two power pack's mounting brackets D. First, to the bottom face of the cabinet (a).

**NOTE:** Guided by the pilot holes in the liner kit. Then, with the help of two or more persons, get the power pack hood into the cabinet through the hole and then secure it to the mounting bracket with the provided screws (b), Fig. 6.

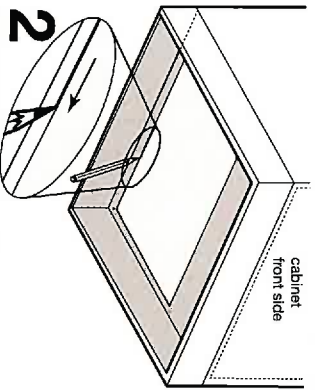

**FRANÇAIS ATTENTION:** Retirer le plastique protecteur de toutes les pièces avant l'installation.

**NOTE:** Ce revêtement d'armoire doit être installé avant le module de hotte encastrable.

**ATTENTION: POUR L'INSTALLATION AVEC CUISINIÈRES ÉLECTRIQUES:** MONTER LA HOTTE DE FAÇON À CE QUE LE FOND NE SOIT PAS À MOINS DE 24" (60.9 CM) AU-DESSUS DE LA SURFACE DE LA CUISINIÈRE (hauteur mesurée de la cuisinière à la partie la plus basse de la hotte). **POUR L'INSTALLATION AVEC CUISINIÈRES À GAZ:** MONTER LA HOTTE DE FAÇON À CE QUE LE FOND NE SOIT PAS À MOINS DE 30" (76.2 CM) AU-DESSUS DE LA SURFACE DE LA CUISINIÈRE (hauteur mesurée de la cuisinière à la partie la plus basse de la hotte).

- À l'aide des vis fournies, installer temporairement la plus grande plaque de revêtement A sur la base externe de l'armoire B, Fig. 1.

**NOTE:** La plus grande plaque de revêtement doit être installée le plus loin possible vers l'arrière de la base externe de l'armoire.

- À l'aide d'un crayon, tracer le contour du trou à découper pour l'insertion du module de hotte en castrable, Fig. 2.

- Retirer la plaque de revêtement de l'armoire.

- Découper le trou dans la base de l'armoire, Fig. 3.

- Installer la plus grande plaque de revêtement à la base externe de l'armoire et la fixer avec 4 vis, Fig. 4.

- Glisser la dernière pièce du revêtement C à l'avant de la base externe de l'armoire. Prendre soin de ne pas égratigner la plus grande plaque de revêtement lors de l'assemblage.

- L'assembler à l'avant de l'armoire en utilisant une vis pour chaque trou de vis, Fig. 5.

- Installez les supports d'installation de la hotte de la cuisinière D. Premièrement, à la face inférieure de l'armoire (a). **NOTE:** guidés par les trous dans le kit, puis, avec l'aide de deux personnes ou plus, déplacer la hotte dans l'armoire à travers le trou et la fixer sur le support d'installation avec les vis fournies (b), Fig. 6.

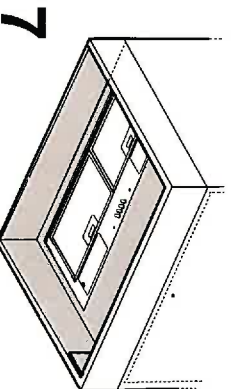
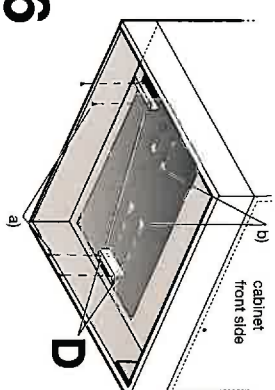
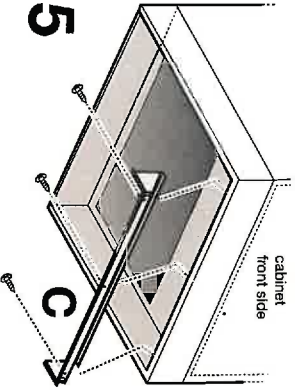
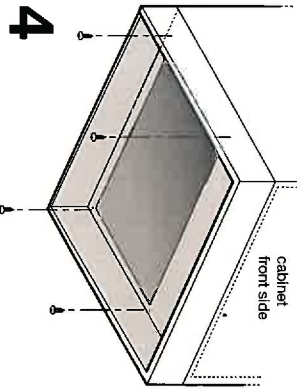
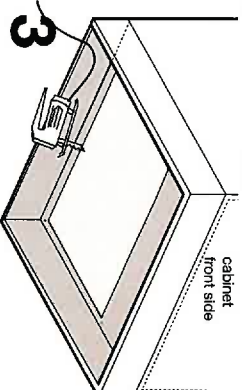

**ESPAÑOL PRECAUCIÓN:** Antes de instalar, retire el plástico protector de todas las partes.

**NOTA:** La cubierta de la campana debe instalarse antes de la campana empotrable.

**CUIDADO: PARA LA INSTALACIÓN SOBRE ESTUFAS ELÉCTRICAS:** MONTE LA CAMPANA DE MANERA QUE EL BORDE INFERIOR DEL LINER NO ESTE A MENOS DE 24" (60.9 cm) SOBRE LA SUPERFICIE DE COCCIÓN (altura medida de la superficie de cocción hasta la parte más baja del liner).

**PARA LA INSTALACIÓN SOBRE ESTUFAS DE GAS:** MONTE LA CAMPANA DE MANERA QUE EL BORDE INFERIOR DEL LINER NO ESTE A MENOS DE 30" (76.2 cm) SOBRE LA SUPERFICIE DE COCCIÓN (altura medida desde la superficie de cocción hasta la parte más baja del liner).

- Utilice los tornillos que se incluyen, instale provisionalmente la placa principal de la cubierta A a la base externa del gabinete B, Fig. 1.

**NOTA:** La placa principal de la cubierta debe ser instalada lo más lejos posible hacia atrás de la base externa del gabinete.

- Marque con un bolígrafo el contorno del orificio para la campana empotrable, Fig. 2.

- Retire la placa principal de la cubierta del gabinete.

- Haga el orificio en la parte inferior del gabinete, Fig. 3.

- Vuelva a instalar la placa principal de la cubierta a la base del gabinete y asegúrela con 4 tornillos

- Deslice la sección frontal del panel C dentro de la nariz de la base de la campana. Asegúrese de no rayar la placa principal de la cubierta. Ensámblala a la parte frontal del gabinete, sujetándola con un tornillo en cada orificio, Fig. 5.

- Instale las dos estatuas sujetoras de la campana D. Primero a la base inferior del gabinete (a).

**NOTA:** Guíese por los orificios en el liner. Posteriormente, con la ayuda de 2 o más personas, introduzca la campana empotrable en el gabinete a través del orificio y sujete a la estatu con los tornillos provistos (b), Fig. 6.

Loxdo  
RANGOS  
South



Lot 20 August 2014

# KitchenAid® 27" (68.6 cm) and 30" (76.2 cm) Electric Built-In Microwave/Oven Combination

## PRODUCT MODEL NUMBERS

KEMS309E KOCE500E KOCE507E

## ELECTRICAL CONNECTION

If codes permit and a separate ground wire is used, it is recommended that a qualified electrical installer determine that the ground path and the wire gauge are in accordance with local codes. Check with a qualified electrical installer if you are not sure the oven is properly grounded.

This oven must be connected to a grounded metal, permanent wiring system.

Be sure that the electrical connection and wire size are adequate and in conformance with the National Electrical Code, ANSI/NFPA 70-latest edition or CSA Standards C22.1-94, Canadian Electrical Code, Part 1 and C22.2 No. 0-M91-latest edition, and all local codes and ordinances.

To properly install your oven, you must determine the type of electrical connection you will be using and follow the instructions provided for it here.

- Oven must be connected to the proper electrical voltage and frequency as specified on the model/serial/rating plate. See the following illustration.

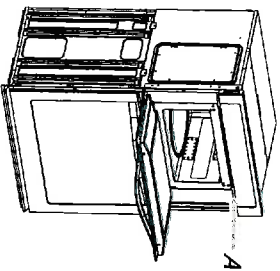

A. Model/serial/rating plate

- Models rated from 7.3 to 9.6 kW at 240 volts (5.4 to 7.4 kW at 208 volts) require a separate 40-amp circuit. Models rated at 4.8 kW and below at 240 volts (3.6 kW and below at 208 volts) require a separate 30-amp circuit.
- A circuit breaker is recommended.
- Connect directly to the fused disconnect (or circuit breaker box) through flexible, armored or nonmetallic sheathed, copper cable (with grounding wire). See "Make Electrical Connection" section.
- Flexible conduit from the oven should be connected directly to the junction box.
- Do not cut the conduit. The length of conduit provided is for serviceability of the oven.
- A UL listed or CSA approved conduit connector must be provided.
- If the house has aluminum wiring, follow the procedure below:
  1. Connect a section of solid copper wire to the pigtail leads.
  2. Connect the aluminum wiring to the added section of copper wire using special connectors and/or tools designed and UL listed for joining copper to aluminum.

Follow the electrical connector manufacturer's recommended procedure. Aluminum/copper connection must conform with local codes and industry accepted wiring practices.

For power requirements, refer to the following table.

Model	Voltage	Amperage (L1)*	Amperage (L2)*	Rating (W)
KOCE507E/KOCE500E	120/240	32	30	8000
KOCE507E/KOCE500E	120/208	30	28	6600

\*Amperage values noted above are for information purposes only: the units are rated in watts.

Because Whirlpool Corporation includes a continues commitment to improve our products, we reserve the right to change materials and specifications without notice.

## PRODUCT DIMENSIONS

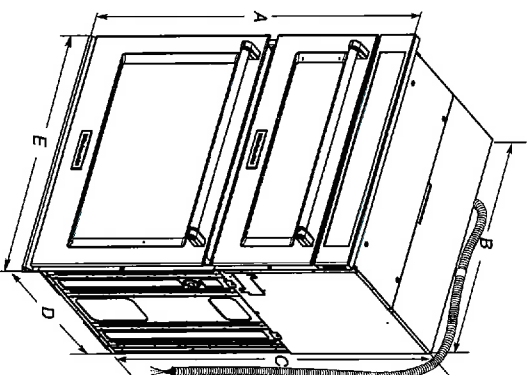

Cabinet Dimensions

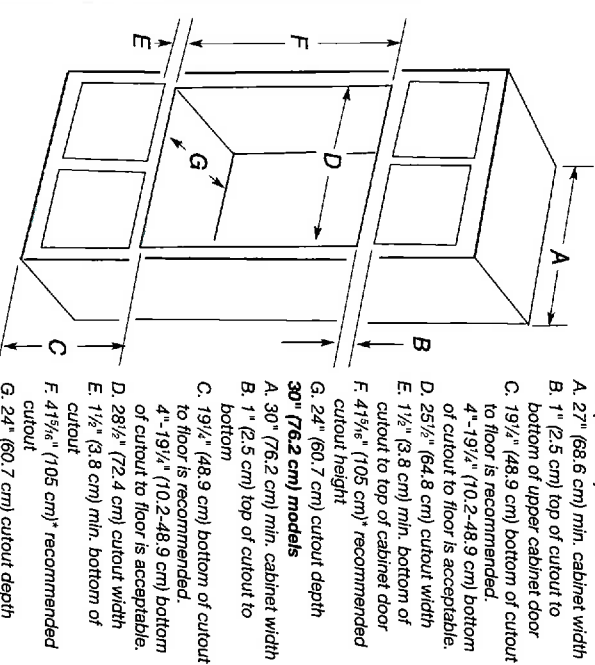

\*NOTE: The cabinet height can be between 41" (104.1 cm) and 41 1/2" (105.6 cm) for microwave/oven combination.

Dimensions are for planning purposes only. For complete details, see installation instructions packed with product. Specifications subject to change without notice.

Lo120



ASPIRE SERIES

Palermo provides professional grade performance, while its 28<sup>1/4</sup>" width and 10<sup>3/4</sup>" depth enables it to be discreetly installed within standard 12" deep cabinetry, making it ideal for smaller kitchens or where the range hood needs to be out of sight. Palermo has a powerful 600 CFM blower to support most cooking needs. Stylish stainless steel push button controls operate a 3-speed blower and halogen lighting.

Easy maintenance, higher efficiency and a cleaner kitchen are ensured by Elica's patented Baffle Slot Filters, which capture a higher percentage of grease and hold larger volumes of grease than traditional baffle filters. Palermo is designed for standard ducted or recirculating installation.



**MODELS**

EPR628SS

Palermo 28" Stainless

**DIMENSIONS**

(28 1/4"W x 10 3/4"D x 9 1/2"H)

Lo120  
Angus  
Souk



Halogen Lamps



Stainless Steel  
Push Button Controls



Stainless Steel  
Baffle Slot Filters



## FEATURES

Size (in) & Type Finish	28" Wide Insert Stainless Steel
Controls	Stainless Steel Push Button
Illumination	2, 40 Watt Halogen Lamps, 1 Light Intensity (bulbs included)
Installation Type	Ducted or Recirculating Installation Recirculating Kit Sold Separately
Blower Type	600 CFM, 3-Speed Internal
Blower Performance	Speed 1, 190 CFM, 2.1 Sones Speed 2, 350 CFM, 4.7 Sones Speed 3, 600 CFM, 8.1 Sones
Filter Type	2, Dishwasher-Safe, Stainless Steel Baffle Slot
Duct Transition	6" Round with Back Draft Damper (top)
Electrical	120V-60Hz 260 Watts at 4.6 Amps
Warranty	2 Year Parts & Labor, In-Home Service

## ACCESSORIES



Optional Recirculating Kit with 2 Carbon Filters  
CODE: KIT02770  
MODEL: KIT02770



Optional 30" Hood Liner  
29" W x 17 1/2" - 20 1/2" D

CODE: KIT02773  
MODEL: EXXHDL30



Optional 36" Hood Liner  
25" W x 17 1/2" - 20 1/2" D

CODE: KIT02774  
MODEL: EXXHDL36

## CONSUMABLE PARTS

Replacement Grease Filter (1)  
CODE: GR10018064

Replacement Carbon Filter (1)  
CODE: FB016A

Replacement Light Bulb (1)  
CODE: 2006EA

Consumable parts are sold in units of one (1). Order accordingly.

## LINE DRAWING

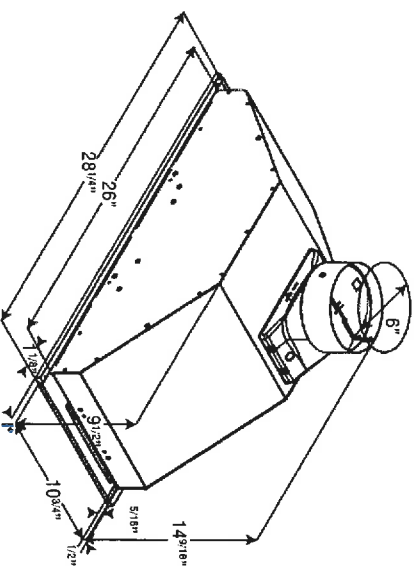

**PALERMO**  
INSERT  
ELICA DESIGN CENTER

**KitchenAid®**  
FOR THE WAY IT'S MADE:®

PRODUCT MODEL NUMBERS

KRFC302E

**Electrical:** A 115 volt, 60 Hz, AC, only 15- or 20-amp fused, grounded electrical supply is required. It is recommended that a separate circuit serving only your refrigerator and approved accessories be provided. Use an outlet that cannot be turned off by a switch. Do not use an extension cord.

**Water:** A cold water supply with water pressure of between 35 and 120 psi (241 and 827 kPa) is required to operate the water dispenser and ice maker. If you have questions about your water pressure, call a licensed, qualified plumber.

**Reverse Osmosis Water Supply:**  
**IMPORTANT:** The pressure of the water supply coming out of a reverse osmosis system going to the water inlet valve of the refrigerator needs to be between 35 and 120 psi (241 and 827 kPa).

Bottom Mount Refrigerator

PRODUCT DIMENSIONS

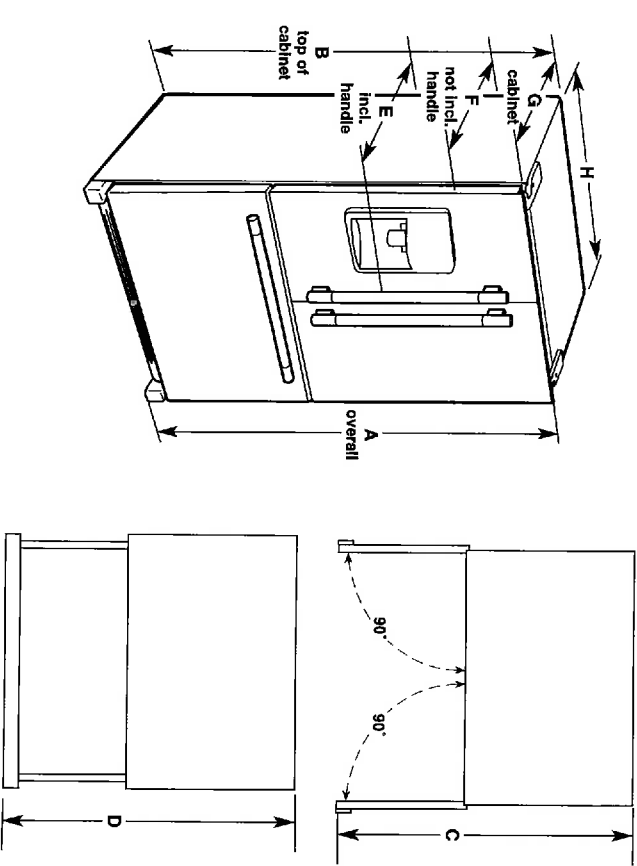

Model Size	Height - Overall "A"	Height - Top of Cabinet "B"	Depth - Doors Open 90° "C"	Depth - Drawer Open "D"	Depth - With Handles "E"	Depth - Without Handles "F"	Depth - Cabinet Only "G"	Width - Cabinet "H"
21.9	72" (182.9 cm)	71 3/8" (181.3 cm)	44 1/8" (112.1 cm)	45 1/4" (114.9 cm)	30 1/2" (76.8 cm)	27 3/4" (70.5 cm)	24 5/8" (62.5 cm)	35 3/4" (90.8 cm)

10/20/2025 Scott

LOCATION REQUIREMENTS

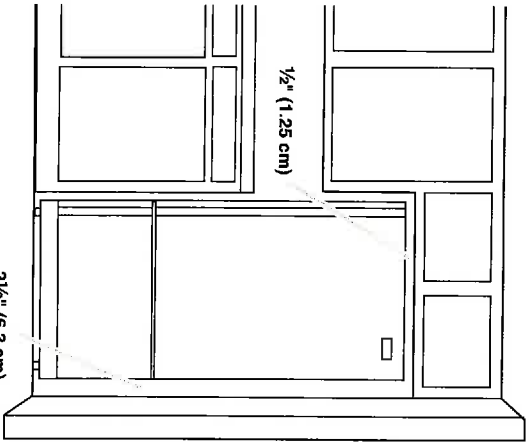

**IMPORTANT:** This refrigerator is designed for indoor, household use only.

To ensure proper ventilation for your refrigerator, allow for 1 1/2" (1.25 cm) of space on each side and at the top. Allow for 1" (2.54 cm) of space behind the refrigerator. If your refrigerator has an ice maker, allow extra space at the back for the water line connections. When installing your refrigerator next to a fixed wall, leave 2 1/2" (6.3 cm) minimum on the hinge side (some models require more) to allow for the door to swing open.

**NOTE:** This refrigerator is intended for use in a location where the temperature ranges from a minimum of 55°F (13°C) to a maximum of 110°F (43°C). The preferred room temperature range for optimum performance, which reduces electricity usage and provides superior cooling, is between 60°F (15°C) and 90°F (32°C). It is recommended that you do not install the refrigerator near a heat source, such as an oven or radiator.