



PURCHASER: ANTONIO MOGAN

CONSTRUCTION SUMMARY
Belle Aire Shores - Zancor Homes (Innisfil) Ltd.

TEL: RES.: 416-333-3357

LOT / PHASE	HOUSE TYPE	PRINT DATE
106 / 1	MARINA (42-02) ELEV A	3-May-17

Ref#	Quantity	Description	Approved	Notes
2159	BONUS:	Granite kitchen countertops with undermount sink 3 Piece stainless steel appliances with white top loading washer and dryer Stainless steel under cabinet hood fan Extended uppers in kitchen (39-1/2") BBQ Gas line	03May17	
2160	BONUS:	Air Conditioning (42ft and 50ft lots ONLY) 9ft main floor ceilings, 8ft ceilings on second floor 3-1/4 inch by ¾ inch natural prefinished engineered hardwood on main floor in non-tiled areas, excludes bedrooms Natural finished oak stairs	03May17	
2161	REMOVE WALL BETWEEN GREAT ROOM AND DINING ROOM CREATING A TRIMMED FLAT ARCH WITH 2 CAPPED HALF NIB WALLS APPROX 6FT OPENING.	03May17		
2162	ELECTRICAL - ADD (1) CAPPED LIGHT ABOVE KITCHEN ISLAND ON SEPARATE SWITCH	03May17		
2163	PLUMBING - MOVE LAUNDRY ROOM WASHER, DRYER AND LAUNDRY TUB FROM 2ND FLR TO BASEMENT (SEE SKETCH)	03May17		
2164	PLUMBING - CHANGE ORIGINAL LAUNDRY RM INTO BATHROOM WITH STD TUB, TOILET AND VANITY (SEE SKETCH)	03May17		
2165	TRIM - ADD OPTIONAL DOOR FROM BEDROOM 3 INTO MAIN BATH	03May17		
2166	HARDWOOD - UPGRADE 4 - DINING RM, GREAT RM, MAIN HALL	03May17		
2167	HARDWOOD - UPGRADE 4 - UPPER HALL IN LIEU OF CARPET	03May17		
2168	PAINT - STAIN OAK STAIRS (PURCHASER AWARE STAIRS ARE OAK AND HARDWOOD IS MAPLE, STAIN WILL BE AS CLOSE AS POSSIBLE)	03May17		
2169	RAILINGS - UPGRADE 5	03May17		
2170	TRIM - UPGRADE #1 INTERIOR DOOR HARDWARE	03May17		
2171	TILES - MASTER ENSUITE - UPGRADE #1 WALL TILE	03May17		
2172	TILES - MAIN BATH TUB - UPGRADE #1 WALL TILE	03May17		
2173	TILES - 3RD BATH TUB - UPGRADE #1 WALL TILES	03May17		
2174	TILES - DELETE ALL BATHROOM ACCESSORIES	03May17		
2175	CABINETS - KITCHEN UPGRADE #1	03May17		
2176	CABINETS - MASTER ENSUITE UPGRADE #1	03May17		
2177	CABINETS - MAIN BATH UPGRADE #1	03May17		
2178	CABINETS - 3RD BATH UPGRADE #1	03May17		
2179	CABINETS - KITCHEN - 24" DEEP UPPER OVER FRIDGE WITH PANELS	03May17		
2180	CABINETS - ALLOW FOR CHIMNEY HOOD ABOVE STOVE	03May17		
2181	CABINETS - ADD 2 CLEAR GLASS DOORS (1) DOOR ON THE LEFT (HINGED LEFT OF THE CHIMNEY) (1) DOOR ON THE RIGHT SIDE (HINGED RIGHT OF THE CHIMNEY)	03May17		
2182	CABINETS - ADD 2 CLEAR GLASS DOORS IN KITCHEN (SEE SKETCH)	03May17		



CONSTRUCTION SUMMARY

Belle Aire Shores - Zancor Homes (Innisfil) Ltd.

PURCHASER: ANTONIO MOGAN

TEL: RES.: 416-333-3357

LOT / PHASE	HOUSE TYPE	PRINT DATE
106 / 1	MARINA (42-02) ELEV A	3-May-17

Ref#	Quantity	Description	Approved	Notes
2183		CABINETS - 2 TONE KITCHEN/ISLAND	03May17	
2184		CABINETS - BUILT IN MICROWAVE/TRIM KIT ON KITCHEN ISLAND WITH DRAWER BELOW - INSTALL ON ISLAND	03May17	
2185		CABINETS - INCREASE LENGTH OF ISLAND BY APPROX 4-1/2" TO ACCOMMODATE MICROWAVE	03May17	
2186		CABINETS - SEE STOVE SPEC (MAKE SPACE AS TIGHT AS POSSIBLE)	03May17	
2187		ELECTRICAL - ADD 15 AMP ON SEPARATE CIRCUIT FOR MICROWAVE	03May17	

This Document is Extremely Time Sensitive - Printed 3 May 17 at 12:12

NCOR HOMES COLOUR CHART

CABINETRY / COUNTERTOPS						
	DOOR STYLE	HARDWARE	COUNTERTOP	EDGE		
Kitchen	SIERRA PVC WHITE (1)	K 1100 AC	UBA TUBA GRANITE STD	C		
Island	MOSAIC MAYFLOWER BROWN STAIN (1)	K 1100 AC	GIALLO ORNAMENTAL LT	C		
Servery	NA					
Master Ensuite	CAMBRIDGE MAPLE NEW GREY (1)	H 700 BC	CALCATTIA MARBLE 4925K-07			
Main	SIERRA PVC WHITE (1)	K 1100 A1	BASALT SLATE 3690-58			
3rd BATH	SIERRA PVC WHITE (1)	K1100 A1	BLACK ALCANTE 4926K-07			
Ensuite ###	NA					
Powder Room	NA					
Laundry	NA					
Basement Bath	NA					
TILES						
		INSERTS	THRESHOLDS			
Main Foyer	BELLINA GREY 13 X 13	✓				
Basement Foyer	NA					
Powder Room	SEAL GREY 13 X 13	✓				
Mud Room	SEAL GREY 13 X 13	✓				
Main Hall	NA					
Kitchen Floor	BELLINA GREY 13 X 13	✓				
Breakfast Floor	BELLINA GREY 13 X 13	✓				
Kitchen Bk.Splash	NA					
Laundry	NA					
Mstr Ensuite Floor	BELLINA GREY 13 X 13	✓				
Mstr Ensuite Shower	BRICK GLOSSY WHITE 8 X 12 UP # 1	NA				
Mstr Ens Tub Wall/Deck	NA					
Master Shower Floor	2 X 2 WHITE	✓		BIAN CARR		
Master Shower Jamb	BIANCA CARRERA	✓				
Main Bath Floor	GRECO IVORY 13 X 13	✓				
Main Bath Tub Wall	WEAVE WHITE 8 X 10 UP # 1	NA		BIAN CARR		
3RD Bath Floor	BELLINA GREY 13 X 13	✓				
3RD BATH Tub Wall	WEAVE TENDER GREY 8 X 10 UP # 1	NA		BIAN CARR		
Ensuite ### Bath Floor	NA					
Ensuite ### Bath Wall	NA					
Basement Ensuite Floor	NA					
Basement Ensuite Wall	NA					
HARDWOOD / CARPET						
	NA					
Living Room	NA					
Dining Room	VINTAGE SOLID SAWN MAPLE SELECT V PEARL NEBULA 4 3/8" UP # 4					
Family/Great Room	VINTAGE SOLID SAWN MAPLE SELECT V PEARL NEBULA 4 3/8" UP # 4					
Den/Study/parlour/Library	NA					
Kitchen *(Waiver)	NA					
Main Foyer *(Waiver)	NA					
Main Hall	VINTAGE SOLID SAWN MAPLE SELECT V PEARL NEBULA 4 3/8" UP # 4					
Upper Hall	VINTAGE SOLID SAWN MAPLE SELECT V PEARL NEBULA 4 3/8" UP # 4					
Master Bedroom	OPENING NIGHT T-20					
Bedroom 2	OPENING NIGHT T-20					
Bedroom 3	OPENING NIGHT T-20					
Bedroom 4	OPENING NIGHT T-20					
Carpet Underpad	STANDARD					
Basement Foyer	NA					
MIRRORS & ACCESSORIES						
LOCATION	NA	Opt. Surround	NA	MANTLE	NA	
Mirrors	STANDARD	Opt. Crown Moulding		PLASTER MOULDING	NA	
Bathroom Accessories	DELETE ALL	location		NA		
Purchaser has reviewed the colour chart				SITE & LOT		
FOR TRADE USE				INNISFIL		
				LOT 106		
<p>Any upgrades in the colour chart must be accompanied with a PES. It is the responsibility of all Trades to inform the builder of any discrepancies on sketches, PES and/or colour charts PRIOR to installation.</p>						
** PAGE 1 OF 2 **				Purchaser Initial	Vendor	

NCOR HOMES COLOUR CHART

STAIRS, RAILING & PICKETS & STAIR STAIN			
Stair Stain / Species:	STAIN OAK STAIRS TO MATCH NEBULA		
White Paint Regd	NA		
Main to 2nd Railing Details:	METAL BLACK STAMPED SINGLE /ALT DOUBLE 2 3/4" GROOVED OAK HANDRAIL 3 1/4" SQUARE OAK POST		
Main to top of Basement Door Railing	METAL BLACK STAMPED SINGLE /ALT DOUBLE 2 3/4" GROOVED OAK HANDRAIL 3 1/4" SQUARE OAK POST		
TRIM			
Casing/Baseboards	STANDARD		
Interior Doors	STANDARD		
Interior Door Hardware	WAVE IN PEWTER UP # 1		
Exterior Door Hardware	STANDARD		
PAINT			
Kitchen/Breakfast	WARM GREY	Master Beds	WARM GREY
Living Room	NA	Bedroom 2	WARM GREY
Dining Room	WARM GREY	Bedroom 3	WARM GREY
Family/Great room	WARM GREY	Bedroom 4	WARM GREY
Den/Study	NA	Master Ens.	WARM GREY
Main/Upper Hall	WARM GREY	3RD BATH	WARM GREY
Laundry	WARM GREY	Twin	NA
Powder Room	WARM GREY	Basement	NA
PLUMBING- UPGRADES TO BE DETAILED ON PES			
	FIXTURES	FAUCETS	NOTES
Kitchen	UPGRADE	STANDARD	STANDARD DOUBLE UNDERMOUNT
Powder Room	STANDARD	STANDARD	
Master Ensuite	STANDARD	STANDARD	
Main	STANDARD	STANDARD	
3rd Bath	STANDARD	STANDARD	
BASEMENT	NA		
Other			
ZANCOR APPLIANCE REQUIREMENTS-UPGRADES TO BE DETAILED ON PES			
Appliance Package received in 'Schedule E'		YES / NO Package Name:	
	UPG (SEE PES)	DECLINED	NOTES
GAS LINE BBQ	STANDARD		
WATERLINE to Fridge	NA		
Hood Fan Venting SIZE	6" STANDARD		
ELECTRICAL for Built-in Oven	NA		
ELECTRICAL for Built-in Micro	UPGRADE		
ELECTRICAL for Gas Stove	NA		
ELECTRICAL for Bar Fridge	NA		
DISCLAIMER		INITIALS	
Colours of all materials are as close as possible to Builders selection but not necessarily identical due to dye lot variances in manufacturing/manufacturers. Due to construction progress some items may have been pre-selected or installed. In this event the Vendor's selection must be accepted by the purchaser			
Any changes to the colour chart after signing are subject to a \$5000 administration fee plus costs		<div> <div></div> <div></div> </div>	
Purchaser has checked and acknowledged accuracy of colour and selections before signing.		<div> <div></div> <div></div> </div>	
SITE: INNISFIL	MARINA42-02-A	LOT: 106	
PURCHASER(S):	ANTONIO MOGAN		
HOME #/CELL #	416 333 3357		
EMAIL:			
DÉCOR NOTES	<div> <div>Purchaser Signature</div> <div>Date</div> </div>		
FOR TRADE USE			
Any upgrades in the colour chart must be accompanied with a PES.		<div> <div>Décor Consultant Signature</div> <div>Date</div> </div>	
It is the responsibility of all Trades to inform the builder of any discrepancies on sketches, PES and/or colour charts PRIOR to installation.		MAR 31 2018	
*** PAGE 2 OF 2 ***		Vendor Signature	

MARCN / 2017 42-02

March 22/17

The Marina

Lot 106

(Am)

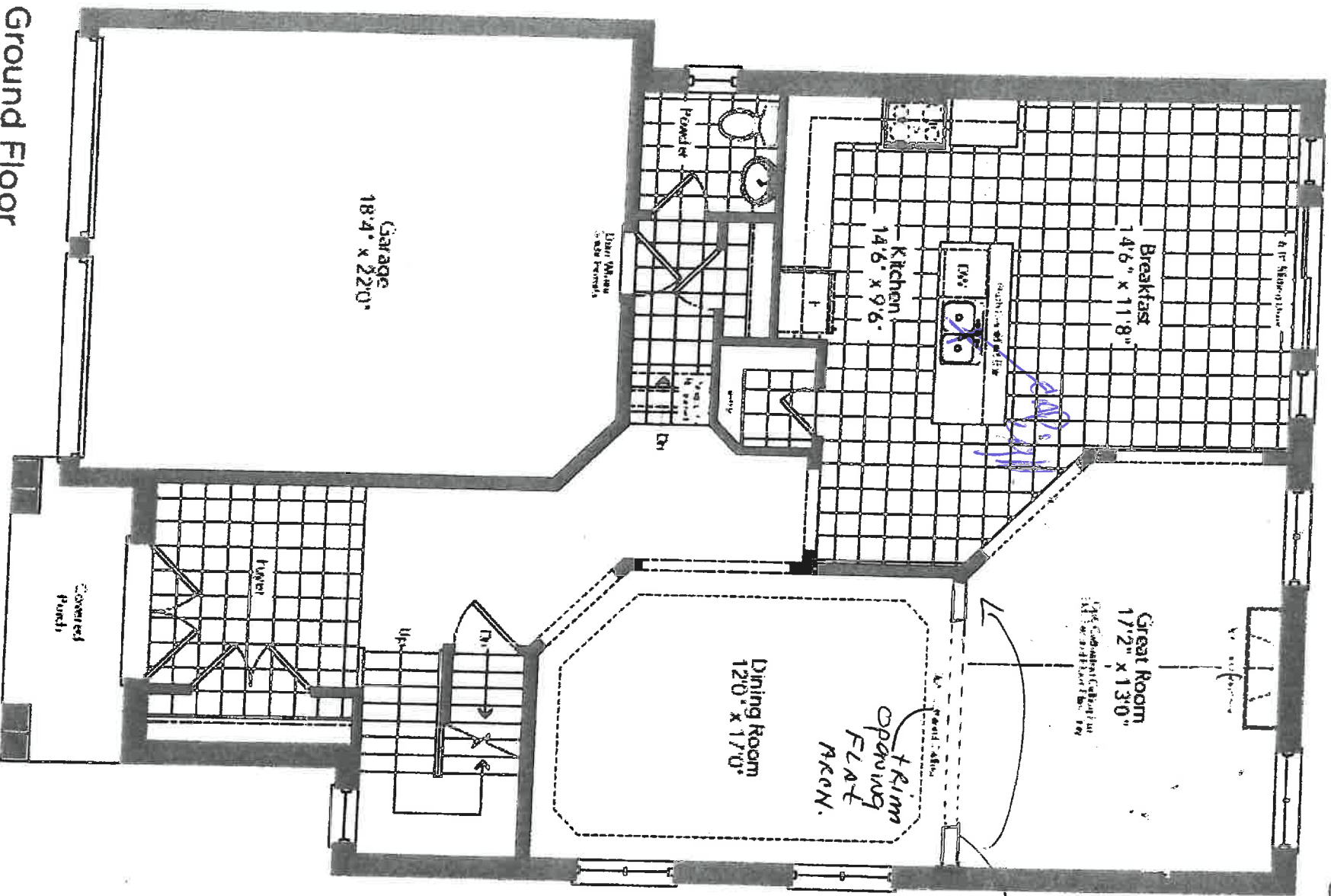

Ground Floor
Elevation A

3' N/A L F
N/A B
N/A L
N/A P P E N

Apr

MARCH 1, 2017 42-02

The Marina

A.

Lot 106

March 22/17

Am

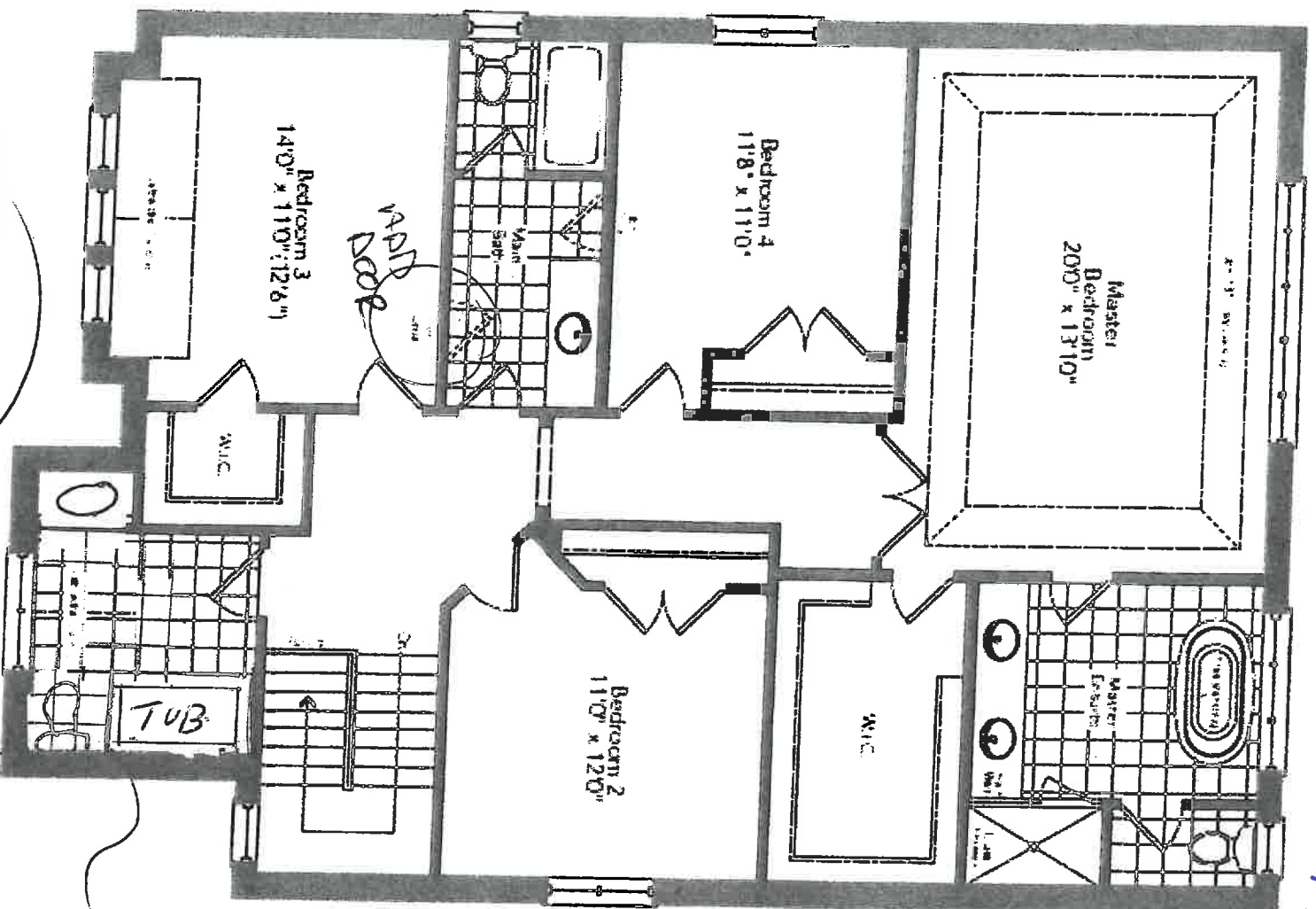

Optional Second
Floor Plan
Elevation A

HANDY MOVED
TO BARNARD.

Am

New Image Kitchens Inc.

Scale:
Date: 24/02/17

Approved by: MGER
Revised:

BELLE AIR SHORES, INNISFIL

Drawing number:

MODEL: 42-02

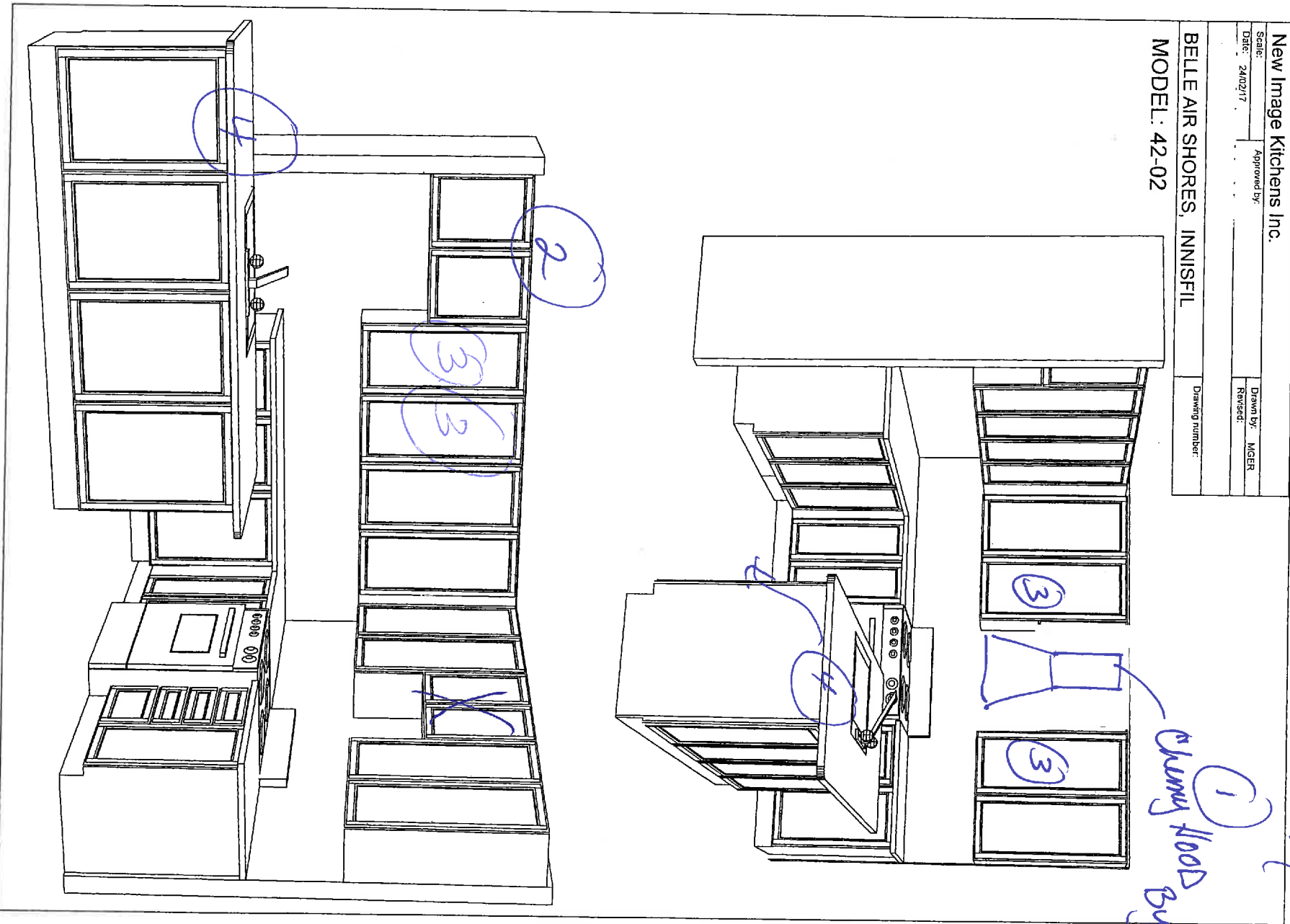

- 1 leave space for chimney hood
- 2 24" deep upper with side panels
- 3 2 clear glass doors
- 4 Built in microwave with De'Longhi
- 5 2-face kitchen

MAR 31 2018

Lot 106

Transil

ZANCOR HOMES
EDGE PROFILES (INTERSTONE / REDSTONE)

STANDARD

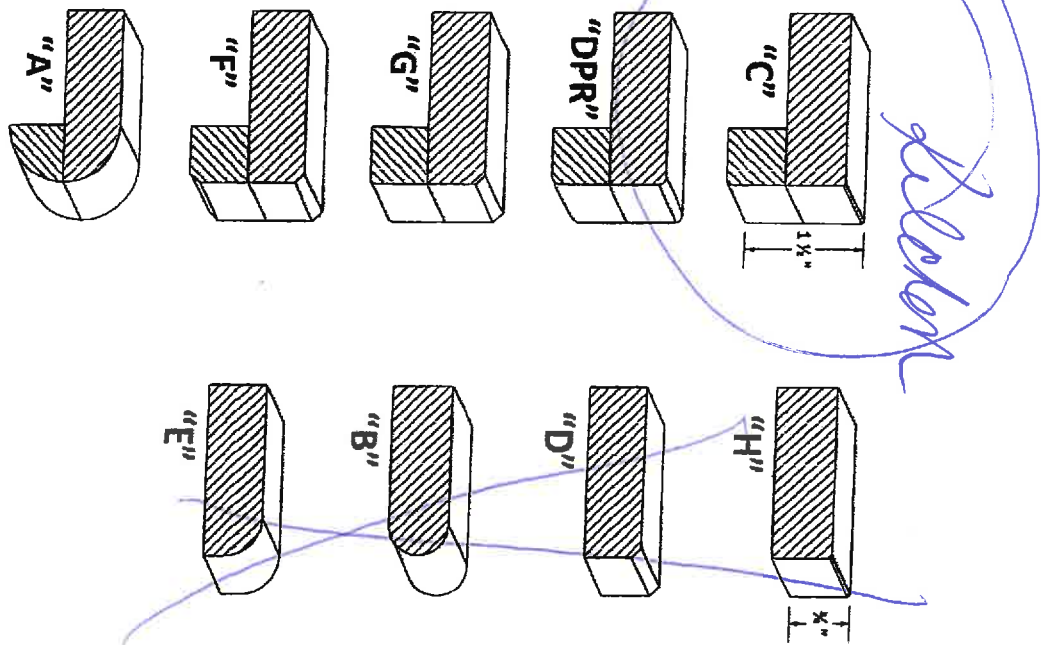

Om

UPGRADES

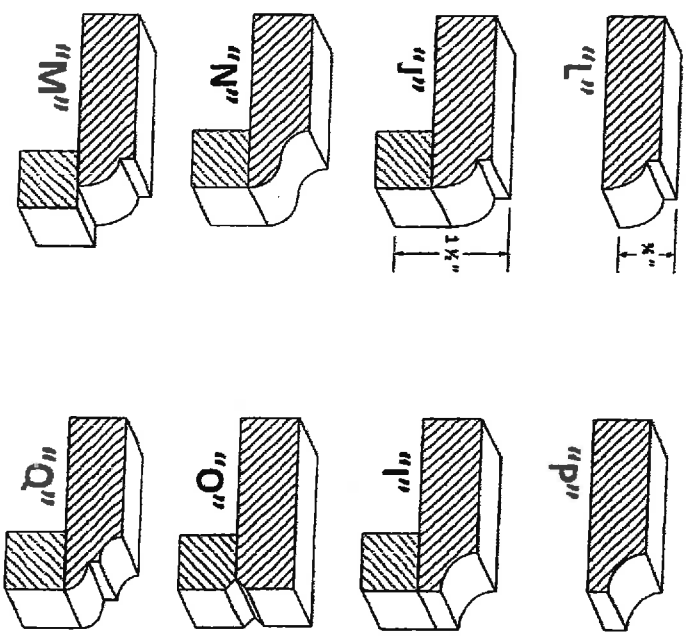

INTERIOR FINISHES ACKNOWLEDGEMENT / WAIVER

Purchaser accepts and acknowledges that the Builder reserves the right to substitute materials with those of equal or better quality where the manufacture, scheduling or delivery of materials may directly impact the Builder's ability to meet its' contractual obligations under the Agreement of Purchase and Sale.

PORCELAIN & NATURAL STONES: Due to the properties of natural stones including but not limited to **marble, granite, quartz**, no two pieces are exactly the same. Variations in colour, tone, granularity (pitting, fissures) and pattern are to be expected, including various lighting may affect the overall finished look. Stone should never be cleaned with lemon oil or vinegar. The purchaser acknowledges colour and product variations as well as natural imperfections that may exist with the selection of natural stone materials and shall not hold the Vendor liable for provision of same.

STONE COUNTERTOP JOINTS: Purchaser is aware that one joint will be at each corner and on either side of slide-in-range (if applicable). It will also be where the length of the counter top exceeds the length of a stone slab. Slabs are usually approximately 5'x 8'.

CERAMIC TILES: Due to manufacturing, shade (dye lots), product variations may exist that can affect the overall look of the finished product. Although every effort will be made to ensure the colours and materials selected are as close as possible to the samples, the purchaser acknowledges that the sample tiles supplied in the Design Centre may not be identical to the materials installed in the home.

STAIR STAINS: Due to the natural properties of wood, many variables can affect the overall look of the finished product. Factors including but not limited to wood type, knotting, graining, density, age, humidity, and air temperature can result in substantial variations in stain intensity. The purchaser accepts that although the Vendor will do their best to match stain the unfinished stairs as close as possible to the pre-finished floors, it is not possible to have an identical match and that there MAY be shade differences between the two products.

CABINETRY: Due to the natural properties of wood, slight variations apparent with cabinetry are to be expected. This includes but not limited to wood species, wood grain, colour, finish, product variations, and natural imperfections are all factors that may affect the overall look of the finished product. Such factors make exact colour matching impossible. The type and intensity of lighting in the areas of designated cabinetry placement may also highlight characteristics of cabinetry finish. All cabinets shall be finished with a white melamine interior box unless a finished interior is upgraded. Due to building specifications and/or on-site conditions, certain cabinetry upgrades may not be possible. The purchaser acknowledges that the Builder cannot guarantee the cabinetry finish or provision of certain upgrades and shall not hold the Builder liable for provision of same.

UPGRADES/EXTRAS: All upgrades and additional selections indicated on the colour chart must be accompanied by an upgrades/extras sheet (PES) and full payment otherwise the selection will be invalid. All colour charts and upgrades/extras will not proceed until verified and signed by an authorized signing officer at the Vendor's head office. **CHANGES WILL NOT BE PERMITTED UPON COMPLETION AND SUBMISSION OF THE COLOUR CHART.**

HARDWOOD / LAMINATE FLOORING: Due to the properties of wood and laminate, many variables can affect the overall look of the finished product. Variations include but not limited to wood type or laminate finish, colour/stain and wood grain are significant factors that make exact colour matching impossible. The purchaser acknowledges that the hardwood flooring is a pre-finished product in a controlled environment. Expansion, compression and cupping are characteristics of hardwood flooring once installed in the home. The purchaser acknowledges these may become apparent over time and despite the Builders' efforts to install the hardwood flooring materials in keeping with good workmanship, the Builder shall not be responsible nor held liable for minor variances of fluctuation in hardwood flooring materials.

UPGRADES/EXTRAS: All upgrades and additional selections indicated on the colour chart must be accompanied by an upgrades/extras sheet (PES) and full payment otherwise the selection will be invalid. All colour charts and upgrades/extras will not proceed until verified and signed by an authorized signing officer at the Vendor's head office. **CHANGES WILL NOT BE PERMITTED UPON COMPLETION AND SUBMISSION OF THE COLOUR CHART.**

HARDWOOD / LAMINATE WAIVER:

I/We understand hardwood flooring is classified as a porous material and as such not recommended by the Builder in certain areas. I/We understand there is a concern due to possible water and other substances being frequently splashed or spilled onto the floor and in contravention of Ontario Building Code Section 9.30.1.2(1).

"Finished flooring bathrooms, kitchens, public entrance halls, laundry & general storage areas shall consist of resilient flooring, felted-synthetic-fibre floor coverings, concrete, terrazzo, ceramic tile, mastic or other types of flooring providing similar degrees of water resistance."

I/We are prepared to assume full responsibility for any damage caused to the hardwood floor or subfloor due to moisture absorbency in the mentioned areas, and agree to waive any claims against the Township of residence, TARIION and/or the Builder in relation to the matter.

****SEE COLOUR CHART FOR LOCATIONS****

SITE

LOT

DATE

APPLIANCE SPEC INFORMATION SHEET

Lot 106

STE & LOT:

Unit 112

DATE:

22 Jan 22/17

SITING:

☐ Standard

☐ Reverse

RANGE

☒ 30" (STD)

See Spec

☐ 36"

☐ 48"

☐ GAS

☐ AMPS

☐ COOKTOP (APRON)

☐ AMPS

☐ COOKTOP (DROPIN)

☐ AMPS

REFRIGERATOR

☐ STANDARD OPENING 36" X 72"

See Spec

☐ BUILT IN FRIDGE

☐ WATERLINE REQUIRED

☐ PANELLED/INTEGRATED

☐ FLUSH INSET

WALL OVENS

☐ 30"

☐ SINGLE

☐ AMPS

☐ DOUBLE

☐ AMPS

☐ STEAM OVEN

☐ AMPS

☐ WARMING DRAWER

☐ AMPS

MICROWAVES

☐ BUILT IN MICRO

☐ AMPS

☒ MICRO TRIM KIT

☐ MODEL

☐ OVER THE RANGE

☐ AMPS

Spec to follow

HOOD FANS

☒ CHIMNEY (CENTRE VENT)

☐ UNDER CABINET

☐ FLUSH INSET

☒ 6 INCH (STD)

☐ 8 INCH

☐ 10 INCH

DISHWASHER

☐ 24" (STD SIZE)

☐ FRONT LOADING SIDE BY SIDE

LAUNDRY

☐ STACKABLE

Additional charges may apply for cabinetry, electrical and plumbing in order to accommodate the specs given by the homeowner.

NOTE: It is the Purchaser's responsibility to coordinate delivery, installation and hook up of appliances and to ensure they are installed as per Manufacturers specifications after closing.

Purchaser acknowledges responsibility for providing correct specification for such appliances. The purchaser agrees to deliver forthwith to the Builder the manufacturer's appliance specifications where the size exceeds the standard openings.

If specs not received, the standard openings as determined by Zancor Homes will be provided. If rework/repair is required due to late specs received, additional costs will be applied.

Appliance Specs are DUE (if not received during appointment):
2 WEEKS FROM SIGNED DATE ABOVE - Specs received after this date and changes are required to accommodate the appliances, an administration fee of minimum \$250 will apply.
*Changes must be approved by head office.

Purchaser Signature

Date

Purchaser Signature

Date

MAR 30 2018

2. Installation Diagram
2. Schéma d'installation
2. Diagrama de instalación

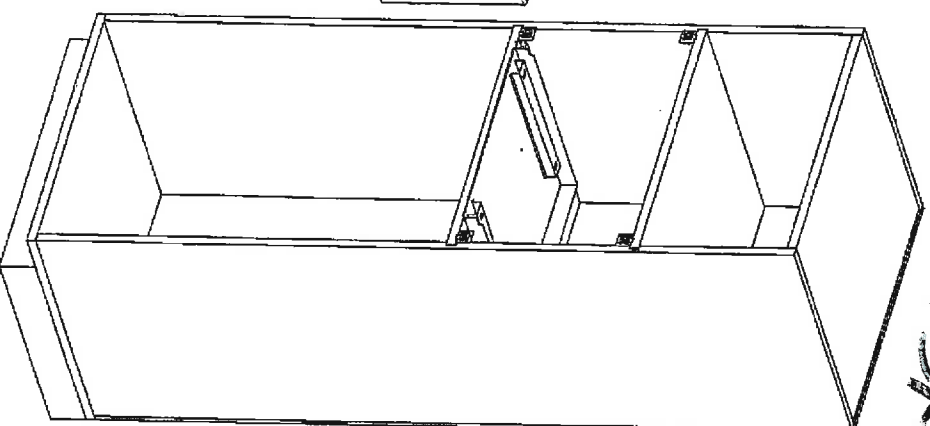
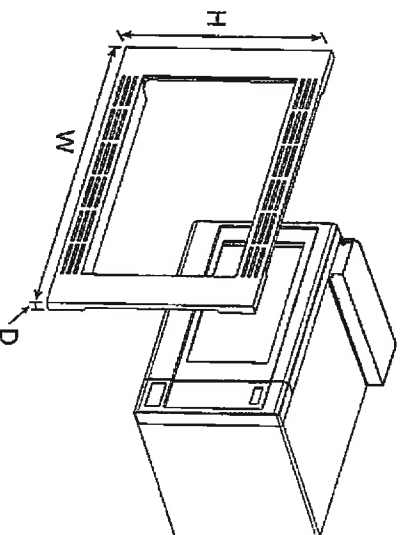

Trim Kit Dimensions				
	TK932S	TK922S	TK732S	TK722S
Width	30" (760 mm)	27" (684 mm)	30" (760 mm)	27" (684 mm)
Height	18 9/16" (472 mm)	18 9/16" (472 mm)	16 1/2" (419 mm)	16 1/2" (419 mm)
Depth (Thickness)	3/4" (20 mm)	3/4" (20 mm)	3/4" (20 mm)	3/4" (20 mm)

Dimensions du nécessaire d'encastrement				
	TK932S	TK922S	TK732S	TK722S
Largeur	760 mm (30 po)	684 mm (27 po)	760 mm (30 po)	684 mm (27 po)
Hauteur	472 mm (18 9/16 po)	472 mm (18 9/16 po)	419 mm (16 1/2 po)	419 mm (16 1/2 po)
Profondeur (épaisseur)	20 mm (3/4 po)	20 mm (3/4 po)	20 mm (3/4 po)	20 mm (3/4 po)

Dimensiones del juego de acabados				
	TK932S	TK922S	TK732S	TK722S
Ancho	30" (760 mm)	27" (684 mm)	30" (760 mm)	27" (684 mm)
Altura	18 9/16" (472 mm)	18 9/16" (472 mm)	16 1/2" (419 mm)	16 1/2" (419 mm)
Profundidad (grosor)	3/4" (20 mm)	3/4" (20 mm)	3/4" (20 mm)	3/4" (20 mm)

LOV106

Panasonic®

LAUNDRY

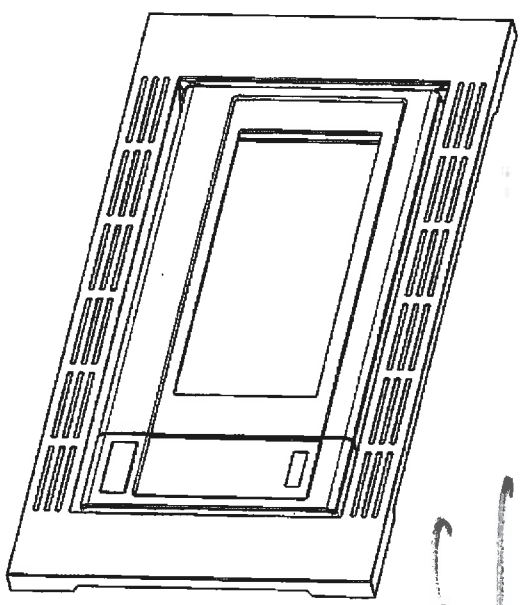

Installation Instructions

Notice d'installation

Instrucciones para la instalación

Cabinet Armoire Gabinete	Trim kit Nécessaire d'encastrement Juego de acabados
30" (762 mm) 30 po (762 mm) 30" (762 mm)	NN-TK932S NN-TK732S
27" (686 mm) 27 po (686 mm) 27" (686 mm)	NN-TK922S NN-TK722S

Read carefully and keep these installation instructions.
Lisez attentivement et conservez cette notice d'installation.
Lea cuidadosamente y guarde este instructivo de
instalación para su referencia.

DW80K7050US

Samsung Dishwasher

Installing Your Dishwasher

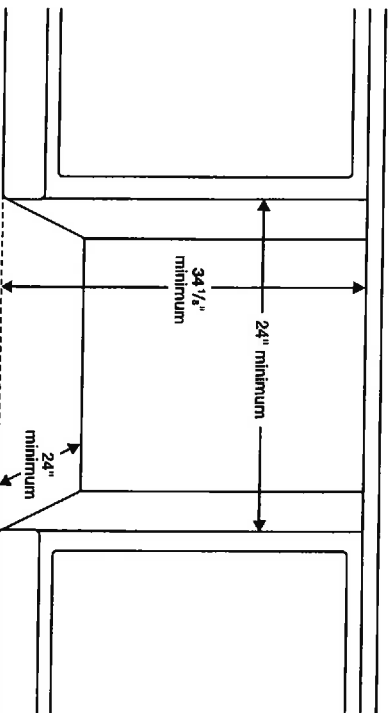

Dimensions

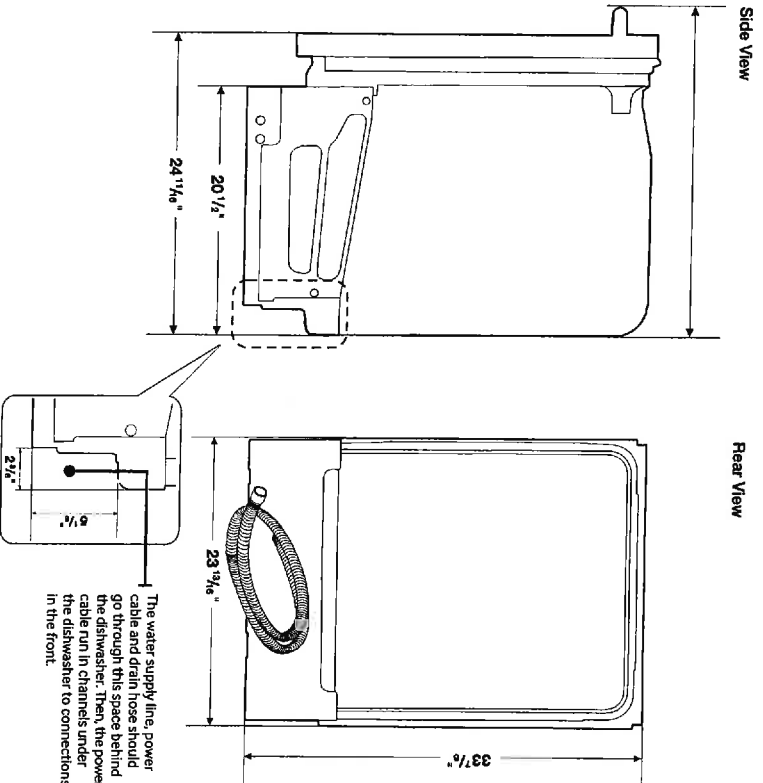

- ### Features
- 6 Wash Cycles: Auto, Heavy, Normal, Express 60, Delicate, Rinse Only
 - 6 Options: StormWash™, Lower Rack Wash, Sanitize (Anti-Bacterial-NSF), Hi-Temp Wash, Delay Start, Control Lock
 - Manual Filtration System
 - Hidden Heat Element
 - Stainless Steel Interior Tub

- ### Convenience
- Control Lock
 - Digital Water Leakage Sensor: Detects Water Leaks Before They Happen and Shuts Off the Dishwasher to Prevent Water Damage.
 - Nylon Racking
 - Upper Rack: 2 Cup Shelves, Adjustable Tines
 - Lower Rack: Adjustable Tines
 - 2 Silverware Baskets

Warranty

One (1) Year All Parts and Labor
Five (5) Year Limited on Printed Circuit Board and Interior Nylon Racks
Lifetime Limited Warranty on Stainless Steel Door Liner and Tub for Leakage

Product Dimensions & Weight (WxHxD)

Dimensions (height is adjustable):
23 7/8" x 33 7/8" – 35 7/8" x 24 3/4"
Weight: 97 lbs.

Shipping Dimensions & Weight (WxHxD)

Dimensions: 26" x 35" x 29 1/2"
Weight: 108 lbs.

Color	Model #	UPC Code
Stainless Steel	DW80K7050US	887276166452
Black Stainless Steel	DW80K7050UG	887276166438

DW80K7050US

Samsung Dishwasher

Features

- StormWash™ Heavy Duty Wash System
- AutoRelease™ Door
- Third Rack
- Light Indicator
- Five-Layer, Insulated Door
- Digital Leakage Sensor
- FlexLoad™ Racking System
- Touch Control
- ENERGY STAR® rated: 239 kWh/Year
- Half-Load Cycle
- One-Touch Adjustable Racking System
- Quiet Operation – 44 dBA
- Full Stainless Steel Interior
- Hidden Heating Element
- 15 Place Settings
- Filtration System
- Electronic Touch Sensor
- 3 Spray Wash Arms (Upper, Middle, Lower)
- 6 Wash Cycles and 6 Wash Options
- 2 Silverware Baskets

Convenience

- Control Lock
- Rinse Refill Indicator
- Cycle Progress Indicator
- Last Cycle Memory
- Five Sensors (Digital Water Leakage, Rinse Refill, Water Temperature, Turbidity, Water Fill)



open

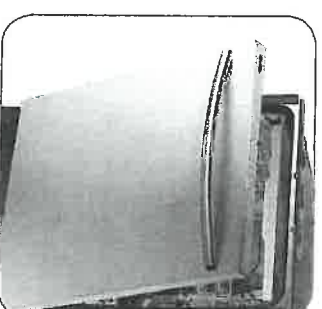

AutoRelease™ Door

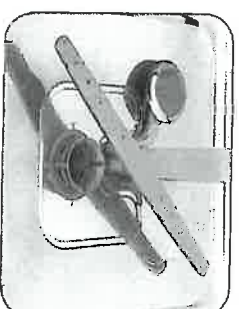

StormWash™

Available Colors



Stainless Steel
(shown)



Black Stainless Steel

Signature Features

STORMWASH™

- Heavy-duty wash system makes pre-rinsing unnecessary.
- Powerful rotating spray jets positioned to clean dishes at every angle.
- Simply place hard-to-clean items above the StormWash™ wheel on the bottom rack and it scrubs them for you.

Arm

AUTORELEASE™ DOOR

- Door opens automatically to dry dishes faster.*

*Improvements versus drying performance of the DW80600

THIRD RACK

- Dedicated space for cutlery and utensils adds 30% more usable space to your dishwasher.

SAMSUNG

NX58H9500WS

5.8 cu. ft. Slide-in Gas Range with Intuitive Controls

166106.

mpack 02/17

Installing Your Range

30" minimum clearance between the top of the cooking surface and the bottom of an unprotected wood or metal cabinet; or 24" minimum when the bottom of the wood or metal cabinet is protected by not less than 1/4" flame retardant millboard covered with not less than no.28 MSG sheet steel, 0.015" stainless steel, 0.024" aluminum or 0.020" copper.

** 18" minimum between the countertop and the adjacent cabinet bottom.

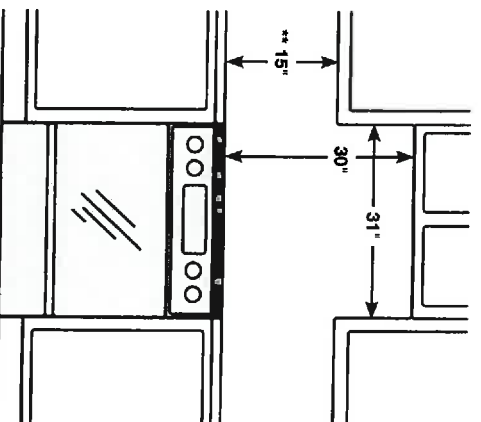

IMPORTANT: To eliminate the risk of burns or fire caused by reaching over heated surface units, cabinet storage space located above the surface units should be avoided. If cabinet storage is to be provided, the risk can be reduced by installing a range hood that projects horizontally a minimum of 5" beyond the bottom of the cabinets.

Dimensions

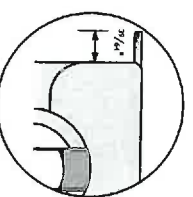
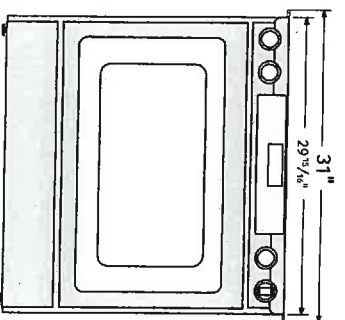

Glass cooktop overlaps and sits on top of your kitchen countertop to give a built-in look. Cut out space for the range is 29 13/16."

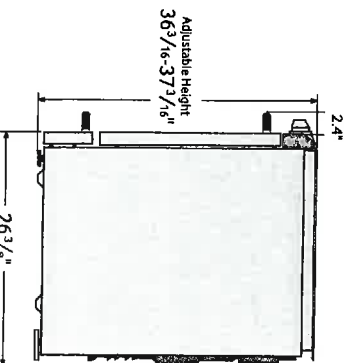

note the piece

at Back

of Stud

8.77

Total Power (BTU)

57,000 BTU

Power Source

120 V/60 Hz

Black Enamel 5 Burner Cooktop

- Right Front: 18000 BTU – Dual
- Left Front: 15000 BTU
- Right Rear: 5000 BTU
- Left Rear: 9500 BTU
- Centre Rear: 9500 BTU – Oval

Oven

- Bake: 175°F – 550°F (79°C – 288°C)
- Convection Bake: 150°F – 550°F (66°C – 288°C)
- Bake Burner: 18000 BTU
- Broil Burner: 16500 BTU
- Variable Broil: Low/High: 446°F – 587°F (230°C – 308°C)
- Convection Roast: 175°F – 550°F (79°C – 288°C)
- Sabbath Mode

Warming Drawer

- Capacity: 0.7 cu. ft.
- Heating Performance: 600 W
- Temperature Settings: 3 Level

Warranty

One (1) Year All Parts and Labour
Five (5) Years Gas Cooktop

Product Dimensions & Weight (WxHxD)

Actual Oven Dimensions:
25" x 21 1/8" x 19"

Outside Dimensions:

29 15/16" x 36 3/16" – 37 3/16" (Adjustable) x 26 3/8"

Weight: 202 lbs.

Shipping Dimensions & Weight (WxHxD)

Dimensions:

33 3/16" x 41 3/4" x 30 5/16"

Weight: 225 lbs.

Colour	Model #	UPC Code
Stainless Steel	NX58H9500WS	887276032054

SAMSUNG

* Samsung received the highest numerical score for ranges, cooktops and ovens in the proprietary I.D. Power 2014 Kitchen Appliance Study™. Study based on 15,380 total responses measuring 17 ranges, cooktops and oven brands and measures opinions of consumers about their new appliance purchased in the past 24 months. Proprietary study results are based on experiences and perceptions of consumers surveyed in January-March 2014. Your experiences may vary. Visit i.dpower.com.
Actual colour may vary. Design, specifications, and colour availability are subject to change without notice. Non-metric weights and measurements are approximate. Clearance requirements are the recommended minimum only. Check the regulations and codes in your area for any additional requirements.
© 2015 Samsung Electronics Canada Inc. All rights reserved. Samsung is a registered trademark of Samsung Electronics Co., Ltd. used with permission.

NX58H9500WS

5.8 cu. ft. Slide-in Gas Range with Intuitive Controls

Features

- Slide-in Design
- 5 Gas Burners
 - Right Front: Dual 18K BTU
 - Left Front: 15K BTU
 - Right Rear: 5K BTU
 - Left Rear: 9.5K BTU
 - Center: 9.5K BTU (Oval)
- Large Oven Capacity – 5.8 cu. ft.
- Guiding Light Controls
- Cast Iron 3 Piece Grates
- Reversible Cast Iron Griddle
- True Convection Oven
- Temperature Probe
- Warming Drawer (3 Levels)
- Healthy Cook Options

Convenience

- Auto Oven Light
- Sabbath Mode
- Delay Start
- Auto Shut-Off Option
- Child Safety Lock
- Self Clean
- 3 Favourite Cook Presets
- 4 Healthy Cook Presets
- 3 Chrome Oven Racks, including 1 Split Rack

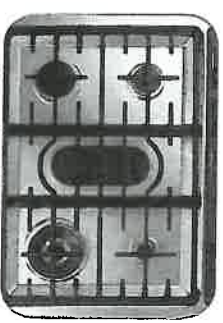
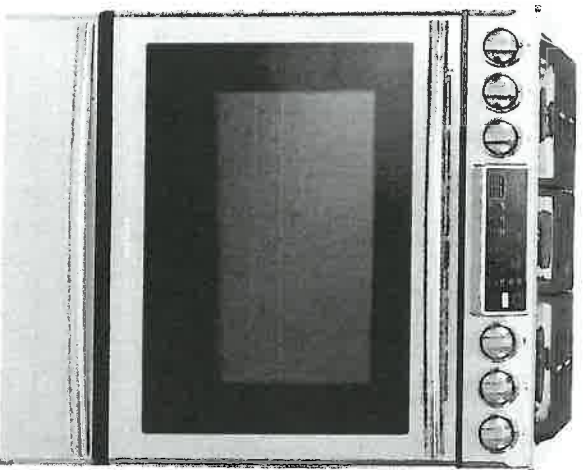

Power/Flexible Cooktop



Guiding Light Controls



Cast Iron Reversible Griddle

Available Colour:



Stainless Steel

Signature Features

POWERFUL/FLEXIBLE COOKTOP

- True dual-power burner allows for even heat distribution and reduced cooking time, plus the convenience of a large oval burner.

GUIDING-LIGHT CONTROLS

- Intuitive controls offer simple, step-by-step instructions for choosing cooking options.
- Only illuminates cooking options that are able to be selected and goes from left to right eliminating back and forth.
- Control temperature and time settings, select cooking functions and program your favourite recipes.

TRUE CONVECTION

- Heated fan system is great for baking and broiling because temperature is distributed thoroughly and food cooks evenly.

REVERSIBLE CAST IRON GRIDDLE

- Reversible griddle provides the flexibility of cooking on flat or grilled surface, while the Cast Iron provides even cooking.

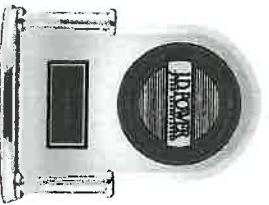

Ranked "Highest in Customer Satisfaction with Ranges, Cooktops and Ovens."*

—J.D. Power

SAMSUNG

RF23HCEDBSR

22.5 cu. ft. Counter-Depth French Door Refrigerator with Cool Select Pantry™

Installing Your Refrigerator

1. Measure the height, width and depth of the opening, making sure to include baseboards, molding, tile, countertop overhang, etc. Check to be sure there is enough room to open the door (consider walls, islands or other obstacles when measuring).
2. Refer to illustration below to determine dimensions.
3. Allow 2" of clearance on hinge side of refrigerator when installing next to a wall where handle may make contact.
4. Allow 1" minimum clearance at rear for proper air circulation and water/electrical connections. Allow a 3/8" minimum clearance at sides and top for ease of installation.
5. Ensure each door and entry way in the home is wide enough for the refrigerator to be moved through easily.

Please note: The following dimension and cutout information is for planning purposes only. For complete installation details consult manual packed with product, or download manual on-line at samsung.com.

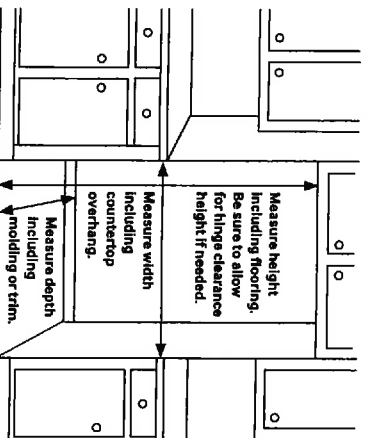

Dimensions

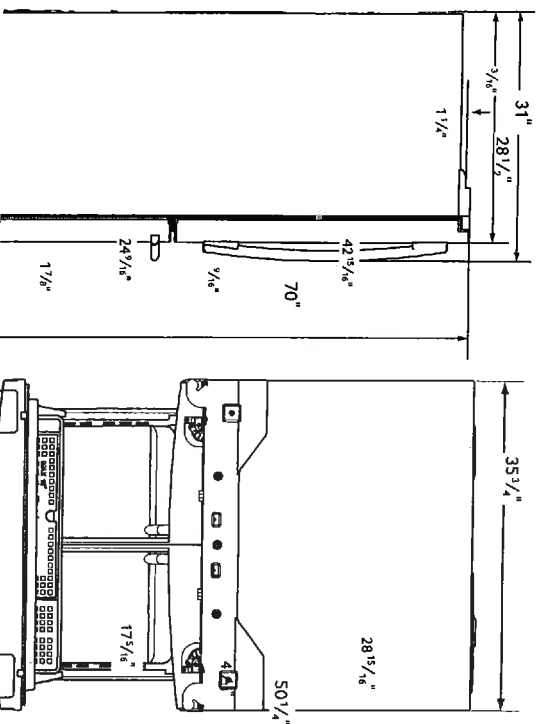

Total Capacity: 22.5 cu. ft.

Refrigerator: 15.7 cu. ft.

- Premium External Filtered Water and Ice Dispenser
- Ice Master Ice Maker
- CoolSelect Pantry™ with Temperature Control – Deli (41°C), Fresh (38°F) and Chilled (32°F) options
- 2 Humidity-Controlled Crispers
- 5 Tempered Glass Spill-Proof Shelves
- Adjustable Shelf for Tall oversized items
- 6 Door Bins
 - Right Door: 3 Gallon Bins
 - Left Door: 3 Regular Bins
- High-Efficiency Top and Side LED Lighting

Freezer: 6.8 cu. ft.

- EZ-Open Handle™
- 1 Drawer Divider
- High-Efficiency LED Lighting

Accessories

Water Filter: HAF-CIN

Warranty

One (1) Year All Parts and Labor
Five (5) Years Sealed System Parts and Labor
Ten (10) Years Compressor Parts Only

Product Dimensions & Weight

Dimensions (WxHxD) with hinges, handles and doors):
35 3/4" x 70" x 31"

Dimensions (WxHxD) without hinges and door):
35 3/4" x 68 7/8" x 24"

Dimensions (WxHxD) with hinge and door, no handle):
35 3/4" x 70" x 28 1/2"

Weight: 297.62 lbs.

Shipping Dimensions & Weight (WxHxD)

Dimensions: 38 1/4" x 76 5/8" x 31 1/4"

Weight: 321.87 lbs.

Color	Model #	UPC Code
Stainless Steel	RF23HCEDBSR	887276966106
White	RF23HCEDBWW	887276967646
Black	RF23HCEDBBC	887276967660

SAMSUNG

Samsung received the highest numerical score for refrigerators in the proprietary JD Power and Associates 2012 Kitchen Appliances Study™. Study based on 12,615 total responses measuring 17 brands and measures opinions of consumers about their refrigerator obtained new in the past 24 months. Proprietary study results are based on experiences and perceptions of consumers surveyed in January-February 2012. Your experiences may vary. Visit jdpower.com.

Actual color may vary. Design, specifications, and color availability are subject to change without notice. Non-metric weights and measurements are approximate.

©2013 Samsung Electronics America, Inc. 85 Challenger Road, Ridgefield Park, NJ 07660 Tel: 800-SAMSUNG samsung.com. Samsung is a registered trademark of Samsung Electronics Co. Ltd.

RF23HCEDBSR

22.5 cu. ft. Counter-Depth French Door Refrigerator with Cool Select Pantry™

Lot 106.

Junist.

1,885.00 plus tax

Features

- 3-Door Counter-Depth Design
- Large Capacity – 22.5 cu. ft.
- Twin Cooling Plus System™
- ENERGY STAR® Compliant
- Ice Master Ice Maker in the Refrigerator
- CoolSelect Pantry™ with Temperature Control
- Premium External Filtered Water and Ice Dispenser
- High-Efficiency Top and Side LED Lighting
- EZ-Open Handle™ on Freezer Door
- Adjustable Shelf for Tall Oversized Items
- Two Humidity-Controlled Crispers
- Tempered Glass Spill-Proof Shelves
- Auto Pull-Out Upper Freezer Drawer
- Easy-to-Access Water Filter

Convenience

- Cool Tight Door
- Door Alarm
- Water Filter Indicator

ENERGY STAR® rated:
699 kWh/yr *Am*

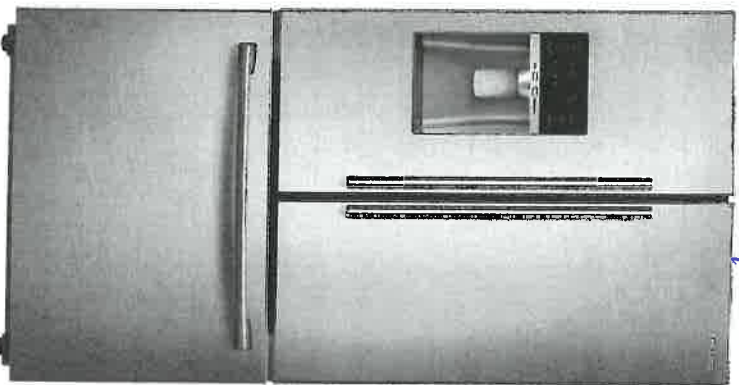

May 22/17

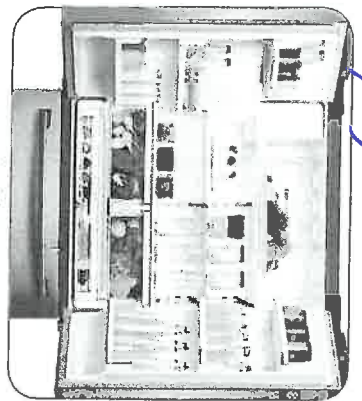

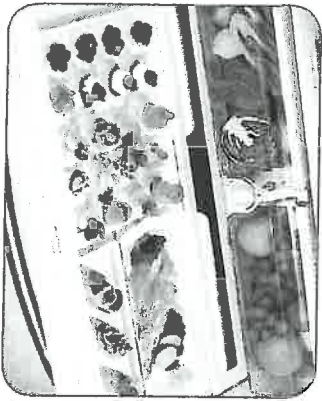

Ice Master



CoolSelect Pantry™ with Temperature Control

Available Colors

-  Stainless Steel (shown)
-  White
-  Black

Signature Features

SLEEK, BUILT-IN LOOK

- Stylish, counter-depth design allows for more work space in the kitchen.
- Sleek, built-in look enhances overall kitchen design.

TWIN COOLING PLUS®

- Keeps food fresher longer – Twin Cooling Plus humidity levels up to 3.6x higher than single cooling.
- Refrigerator air is kept at higher, near commercial grade humidity levels to keep perishable fruits and vegetables fresher longer.
- Drier freezer air means less freezer burn for better-tasting frozen foods.

ICE MASTER

- Our Ice Master makes 5.2 lbs. of ice per day with storage for nearly 2.7 lbs.
- Space-saving design leaves more room in the refrigerator.

COOL SELECT PANTRY™

- Provides additional temperature control for your food storage needs with Deli, Fresh and Chilled options.

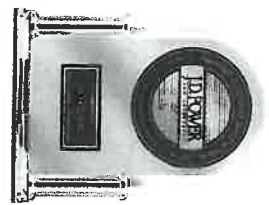

Ranked "Highest in Customer Satisfaction with Refrigerators" by J.D. Power and Associates.

part 2198