

## WASAGA - TRILLIUM FOREST

|        | <b>Lot 80</b><br><b>Model &amp; Elevation: VIOLET 50-06 ELEV. A - OPT. 3 BEDROOM</b><br><b>Purchasers Names : JOEMAR M &amp; JENNY ROSE RODRIGUZ</b> |  |                 |
|--------|--|---|-----------------|
| Item # |  | DATE  | NOTE            |
|        | 3 PIECE STAINLESS STEEL KITCHEN APPLIANCES WITH WHITE WASHER AND DRYER   |   | <b>INCLUDED</b> |
|        | 3 BEDROOM PLAN   |   | <b>INCLUDED</b> |
| 1/     | HARDWOOD - UPGRADE 1 IN FAMILY, HALL, LIVING, DINING IN LIEU OF CARPET   | 24-Jan-17   | STR & COLOURS   |
| 2/     | PAINT - STAIN OAK STAIRS TO MATCH HARDWOOD   | 24-Jan-17   | STR & COLOURS   |
| 3/     | CABINETS - KITCHEN - UPGRADE 1   | 24-Jan-17   | STR & COLOURS   |
| 4/     | CABINETS - KITCHEN - POTS & PAN DRAWERS (90 CM WIDE)   | 24-Jan-17   | STR & COLOURS   |
| 5/     | ELECTRICAL - KITCHEN - ADD PLUG ON ISLAND  | 24-Jan-17   | STR & COLOURS   |
| 6/     | ELECTRICAL - KITCHEN - STANDARD LIGHT FROM COOKING AREA TO BE INSTALLED ABOVE ISLAND   | 24-Jan-17   | STR & COLOURS   |
| 7/     | 3 PIECE ROUGHIN IN BASEMENT  | 24-Jan-17   | STR & COLOURS   |

ZANCOR HOMES COLOUR CHART

| CABINETRY / COUNTERTOPS   |   |                     |                           |                   |            |  |
|---|---|---------------------|---------------------------|-------------------|------------|--|
|   | DOOR STYLE  | HARDWARE            | COUNTERTOP                | EDGE              |            |  |
| Kitchen   | CAMBRIDGE MAPLE NEW GREY UP# 1 ✓                                      | H 800 BC            | CALCATTIA MARBLE 4925K-07 | ✓                 |            |  |
| Island  | CAMBRIDGE MAPLE NEW GREY UP# 1 ✓                                      | H 800 BC            | CALCATTIA MARBLE 4925K-07 | ✓                 |            |  |
| Servery   | NA  |                     |                           |                   |            |  |
| Master Ensuite  | 300 SERIES PVC TUXEDO ✓   | H 800 BC            | BRONZITE 4971K-52         | ✓                 |            |  |
| Main  | 300 SERIES PVC TUXEDO ✓   | H 800 BC            | CARRERRA BIANCO 6696-46   | ✓                 |            |  |
| Twin  | NA  |                     |                           |                   |            |  |
| Ensuite ###   | NA  |                     |                           |                   |            |  |
| Powder Room   | NA  |                     |                           |                   |            |  |
| Laundry   | NA  |                     |                           |                   |            |  |
| Basement Bath   | NA  |                     |                           |                   |            |  |
| TILES   |   |                     |                           | INSERTS           | THRESHOLDS |  |
| Main Foyer  | BELLINA GREY 13 X 13  | ✓                   |                           |                   |            |  |
| Basement Foyer  | BELLINA GREY 13 X 13  | ✓                   |                           |                   |            |  |
| Powder Room   | NA  |                     |                           |                   |            |  |
| Mud Room  | NA  |                     |                           |                   |            |  |
| Main Hall   | NA  |                     |                           |                   |            |  |
| Kitchen Floor   | BELLINA GREY 13 X 13  | ✓                   |                           |                   |            |  |
| Breakfast Floor   | BELLINA GREY 13 X 13  | ✓                   |                           |                   |            |  |
| Kitchen Bk.Splash   | NA  |                     |                           |                   |            |  |
| Laundry   | BELLINA GREY 13 X 13  | ✓                   |                           |                   |            |  |
| Mstr Ensuite Floor  | SEAL GREY 13 X 13   | ✓                   |                           |                   | PER ROY    |  |
| Mstr Ensuite Shower   | ALBION TAUPE 8 X 10   | ✓                   |                           | YES               |            |  |
| Mstr Ens Tub Wall/Deck  | SEAL GREY 13 X 13   | ✓                   |                           |                   |            |  |
| Master Shower Floor   | 2 X 2 WHITE   | ✓                   |                           |                   |            |  |
| Master Shower Jamb  | PERLATO ROYALE  | ✓                   |                           |                   |            |  |
| Main Bath Floor   | NEW ALBION GREY 13 X 13   | ✓                   |                           |                   | PER ROY    |  |
| Main Bath Tub Wall  | NEW ALBION GREY 8 X 10  | ✓                   |                           | YES               |            |  |
| Twin Bath Floor   | NA  |                     |                           |                   |            |  |
| Twin Ensuite Tub Wall   | NA  |                     |                           |                   |            |  |
| Ensuite ### Bath Floor  | NA  |                     |                           |                   |            |  |
| Ensuite ### Bath Wall   | NA  |                     |                           |                   |            |  |
| Basement Ensuite Floor  | NA  |                     |                           |                   |            |  |
| Basement Ensuite Wall   | NA  |                     |                           |                   |            |  |
| HARDWOOD / CARPET   |   |                     |                           |                   |            |  |
| Living Room   | VINTAGE U-LIOC COLLECTION SELECT V PEARL HICKORY MOOREA 4 1/4" UP # 1 |                     |                           |                   |            |  |
| Dining Room   | VINTAGE U-LIOC COLLECTION SELECT V PEARL HICKORY MOOREA 4 1/4" UP # 1 |                     |                           |                   |            |  |
| Family/Great Room   | VINTAGE U-LIOC COLLECTION SELECT V PEARL HICKORY MOOREA 4 1/4" UP # 1 |                     |                           |                   |            |  |
| Den/Study/parlour/Library   | NA  |                     |                           |                   |            |  |
| Kitchen *(Waiver)   | NA  |                     |                           |                   |            |  |
| Main Foyer *(Waiver)  | NA  |                     |                           |                   |            |  |
| Main Hall   | VINTAGE U-LIOC COLLECTION SELECT V PEARL HICKORY MOOREA 4 1/4" UP # 1 |                     |                           |                   |            |  |
| Upper Hall  | NA  |                     |                           |                   |            |  |
| Master Bedroom  | OPENING NIGHT T-18  |                     |                           |                   |            |  |
| Bedroom 2   | OPENING NIGHT T-18  |                     |                           |                   |            |  |
| Bedroom 3   | OPENING NIGHT T-18  |                     |                           |                   |            |  |
| Bedroom 4   | NA  |                     |                           |                   |            |  |
| Carpet Underpad   | STANDARD  |                     |                           |                   |            |  |
| Basement Foyer  | NA  |                     |                           |                   |            |  |
| FIREPLACES  |   |                     |                           |                   |            |  |
| LOCATION  | FAMILY ROOM   | Opt. Surround       | NA                        | MANTLE            | NF 8       |  |
| MIRRORS & ACCESSORIES   |   |                     |                           |                   |            |  |
| Mirrors   | STANDARD  | Opt. Crown Moulding |                           | NA                |            |  |
| Bathroom Accessories  | STANDARD  | location            |                           | NA                |            |  |
| Purchaser has reviewed the colour chart   |   |                     |                           | SITE & LOT        |            |  |
| ***FOR TRADE USE***   |   |                     |                           | WASAGA LOT 80     |            |  |
| Any upgrades in the colour chart must be accompanied with a PES. It is the responsibility of all Trades to inform the builder of any discrepancies on sketches, PES and/or colour charts PRIOR to installation. |   |                     |                           |                   |            |  |
| ** PAGE 1 OF 2 **   |   |                     |                           | Purchaser Initial | Vendor     |  |

# ZANCOR HOMES COLOUR CHART

| STAIRS, RAILING & PICKETS & STAIR STAIN  |                                       |                            |           |
|--|---------------------------------------|----------------------------|-----------|
| Stair Stain / Species:   | STAIN TO MATCH MOOREA                 |                            |           |
| White Paint Req'd  | NA                                    |                            |           |
| Main to down to Foyer Railing Details:   | STANDARD                              |                            |           |
| Main to Basement Railing Details:  | STANDARD                              |                            |           |
|  |                                       |                            |           |
| Casing/Baseboards  | STANDARD                              |                            |           |
| Interior Doors   | STANDARD                              |                            |           |
| Interior Door Hardware   | STANDARD                              |                            |           |
| Exterior Door Hardware   | STANDARD                              |                            |           |
| PAINT  |                                       |                            |           |
| Kitchen/Breakfast  | WARM GREY                             | Master Beds                | WARM GREY |
| Living Room  | WARM GREY                             | Bedroom 2                  | WARM GREY |
| Dining Room  | WARM GREY                             | Bedroom 3                  | WARM GREY |
| Family/Great room  | WARM GREY                             | Bedroom 4                  | NA        |
| Den/Study  | NA                                    | Master Ens.                | WARM GREY |
| Main Hall  | WARM GREY                             | Main                       | WARM GREY |
| Laundry  | WARM GREY                             | Twin                       | NA        |
| Powder Room  | NA                                    | Bsmt Foyer                 | WARM GREY |
| PLUMBING- UPGRADES TO BE DETAILED ON PES   |                                       |                            |           |
|  | FIXTURES                              | FAUCETS                    | NOTES     |
| Kitchen  | STANDARD                              | STANDARD                   |           |
| Powder Room  | NA                                    |                            |           |
| Master Ensuite   | STANDARD                              | STANDARD                   |           |
| Main   | STANDARD                              | STANDARD                   |           |
| 2nd Ensuite  | NA                                    |                            |           |
| BASEMENT   | NA                                    |                            |           |
| Other  |                                       |                            |           |
| ZANCOR APPLIANCE REQUIREMENTS-UPGRADES TO BE DETAILED ON PES   |                                       |                            |           |
| Appliance Package received in 'Schedule E'   |                                       | YES / NO Package Name:     |           |
|  | UPG (SEE PES)                         | DECLINED                   | NOTES     |
| GAS LINE BBQ   | STANDARD                              |                            |           |
| WATERLINE to Fridge  | NA                                    |                            |           |
| Hood Fan Venting SIZE  | 6"                                    |                            |           |
| ELECTRICAL for Built-in Oven   | NA                                    |                            |           |
| ELECTRICAL for Built-in Micro / OTR  | NA                                    |                            |           |
| ELECTRICAL for Gas Stove / Cooktop   | NA                                    |                            |           |
| ELECTRICAL for Bar Fridge  | NA                                    |                            |           |
| DISCLAIMER   |                                       | INITIALS                   |           |
| <small>Colours of all materials are as close as possible to Builders selection but not necessarily identical due to dye lot variances in manufacturing/manufacturers. Due to construction progress some items may have been pre-selected or installed. In this event the Vendor's selection must be accepted by the purchaser.</small> |                                       |                            |           |
| <small>Any changes to the colour chart after signing are subject to a \$5000 administration fee plus costs</small>   |                                       |                            |           |
| <small>Purchaser has checked and acknowledged accuracy of colour and selections before signing.</small>  |                                       |                            |           |
| SITE: WASAGA   | 50-06-A VIOLET                        | LOT: 80                    |           |
| PURCHASER(S):  | OPT 3 BEDROOM<br>Joemar M Rodriguez   | Purchaser Signature        | Date      |
| HOME #/CELL #  | Jenny Rose Rodriguez<br>416 836-0658' | Purchaser Signature        | Date      |
| DÉCOR NOTES  |                                       | Purchaser Signature        | Date      |
| ***FOR TRADE USE***  |                                       | Décor Consultant Signature | Date      |
| Any upgrades in the colour chart must be accompanied with a PES.<br><br>It is the responsibility of all Trades to inform the builder of any discrepancies on sketches, PES and/or colour charts PRIOR to installation.   |                                       |                            |           |
| *** PAGE 2 OF 2 ***  |                                       | Vendor Signature           | Date      |

24/17



# The Violet

includes 14 sq. ft. in lower level

Dr. Ground Floor & Bedroom (Pink) 1200 sq. ft.



**Basement Elev. 'C'**

১৫

Jan 24/17 Lot 80 W55A9A.

|                         |                 |
|-------------------------|-----------------|
| NEW IMAGE KITCHENS INC. |                 |
| Scale:                  | Approved by:    |
| Date: 23/4/12           | Drawn by: VINCE |
| ZANCOR HOMES            |                 |
| MODEL 6                 |                 |
| Drawing number:         |                 |

OPTIONAL EXTENDED BAR  
145 CT  
135 X 90 PANEL

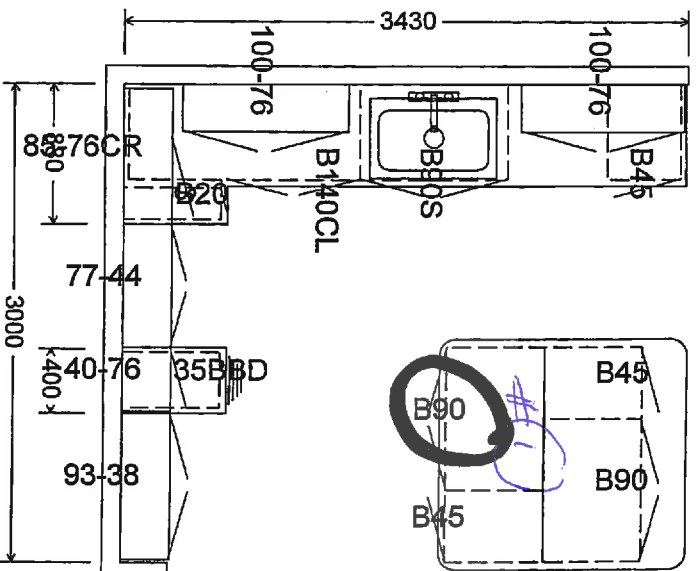

MAIN



ENSUITE

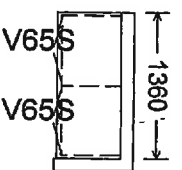

LAUNDRY

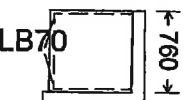

OPTIONAL  
BASEMENT  
BATH

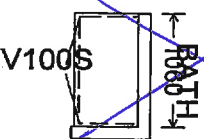

OPTIONAL  
LAUNDRY UPPEERS

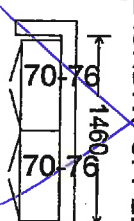

Appliance Specs are DUE:  
2 WEEKS FROM SIGNED DATE BELOW -- Specs received after this  
date, if accepted, an administration fee of minimum \$250 will apply

Appliance Specs  
RECEIVED

Purchaser Signature

Date

Jan 24/17

Purchaser Signature

Date

Jan 24/17

**INTERIOR FINISHES ACKNOWLEDGEMENT / WAIVER**

Purchaser accepts and acknowledges that the Builder reserves the right to substitute materials with those of equal or better quality where the manufacture, scheduling or delivery of materials may directly impact the Builder's ability to meet its' contractual obligations under the Agreement of Purchase and Sale.

**UPGRADES/EXTRAS:** All upgrades and additional selections indicated on the colour chart must be accompanied by an upgrades/extras sheet (PES) and full payment otherwise the selection will be invalid. All colour charts and upgrades/extras will not proceed until verified and signed by an authorized signing officer at the Vendor's head office. **CHANGES WILL NOT BE PERMITTED UPON COMPLETION AND SUBMISSION OF THE COLOUR CHART.**

**PORCELAIN & NATURAL STONES:** Due to the properties of natural stones including but not limited to **marble, granite, quartz**, no two pieces are exactly the same. Variations in colour, tone, granularity (pitting, fissures) and pattern are to be expected, including various lighting may affect the overall finished look. Stone tops are sealed at time of installation and should never be cleaned with lemon oil or vinegar. Stones are porous materials, therefore any spilled substance require immediate attention. Stone countertops require regular seal re-application as part of home maintenance. Purchaser acknowledges colour and product variations as well as natural imperfections may exist with the selection of natural stone materials and shall not hold the Vendor liable for provision of same.

**STONE COUNTERTOP JOINTS:** Purchaser is aware that one joint will be at each corner and on either side of slide-in-range (if applicable). It will also be where the length of the counter top exceeds the length of a stone slab. Slabs are usually approximately 5'x8'.

**CERAMIC TILES:** Due to manufacturing, shade (dye lots), product variations may exist that can affect the overall look of the finished product. Although every effort will be made to ensure the colours and materials selected are as close as possible to the samples, the purchaser acknowledges that the sample tiles supplied in the Design Centre may not be identical to the materials installed in the home.

**STAIR STAINS:** Due to the natural properties of wood, many variables can affect the overall look of the finished product. Factors including but not limited to wood type, knotting, graining, density, age, humidity, and air temperature can result in substantial variations in stain intensity. The purchaser accepts that although the Vendor will do their best to match stain the unfinished stairs as close as possible to the pre-finished floors, it is not possible to have an identical match and that there MAY be shade differences between the two products.

**CABINETRY:** Due to the natural properties of wood, slight variations apparent with cabinetry are to be expected. This includes but not limited to wood species, wood grain, colour, finish, product variations, and natural imperfections are all factors that may affect the overall look of the finished product. Such factors make exact colour matching impossible. The type and intensity of lighting in the areas of designated cabinetry placement may also highlight characteristics of cabinetry finish. All cabinets shall be finished with a white melamine interior box unless a finished interior is upgraded. Due to building specifications and/or on-site conditions, certain cabinetry upgrades may not be possible. The purchaser acknowledges that the Builder cannot guarantee the cabinetry finish or provision of certain upgrades and shall not hold the Builder liable for provision of same.

**UPGRADES/EXTRAS:** All upgrades and additional selections indicated on the colour chart must be accompanied by an upgrades/extras sheet (PES) and full payment otherwise the selection will be invalid. All colour charts and upgrades/extras will not proceed until verified and signed by an authorized signing officer at the Vendor's head office. **CHANGES WILL NOT BE PERMITTED UPON COMPLETION AND SUBMISSION OF THE COLOUR CHART.**

**HARDWOOD / LAMINATE FLOORING:** Due to the properties of wood and laminate, many variables can affect the overall look of the finished product. Variations include but not limited to wood type or laminate finish, colour/stain and wood grain are significant factors that make exact colour matching impossible. The purchaser acknowledges that the hardwood flooring is a pre-finished product in a controlled environment. Expansion, compression and cupping are characteristics of hardwood flooring once installed in the home. The purchaser acknowledges these may become apparent over time and despite the Builders' efforts to install the hardwood flooring materials in keeping with good workmanship, the Builder shall not be responsible nor held liable for minor variances of fluctuation in hardwood flooring materials.

**HARDWOOD / LAMINATE WAIVER:**

I/We understand hardwood flooring is classified as a porous material and as such not recommended by the Builder in certain areas. I/We understand there is a concern due to possible water and other substances being frequently splashed or spilled onto the floor and in contravention of Ontario Building Code Section 9.30.1.2(1).

*"Finished flooring bathrooms, kitchens, public entrance halls, laundry & general storage areas shall consist of resilient flooring, felted-synthetic-fibre floor coverings, concrete, terrazzo, ceramic tile, mastic or other types of flooring providing similar degrees of water resistance."*

I/We are prepared to assume full responsibility for any damage caused to the hardwood floor or subfloor due to moisture absorbency in the mentioned areas, and agree to waive any claims against the Township of residence, TARION and/or the Builder in relation to the matter. **\*\*SEE COLOUR CHART FOR LOCATIONS\*\***

SITE

LOT

DATE