

**STANDARD APPLIANCE OPENINGS**

The purchaser acknowledges the following standard spaces for kitchen appliances:

Range Conventional – 30" Width

Hood Fan – 30" Width (must be the same or larger as range opening as per Ontario Building & Fire Code)

Refrigerator – 36" W x 72" H (Approximate - height may change due to bulkheads)

Dishwasher – 24" Width

6" Exhaust Vent above stove

OTHER \_\_\_\_\_

**UPGRADED APPLIANCE OPENINGS**

**\*Check all that apply - NON-STANDARD APPLIANCE OPTIONS**

**NOTE:** When upgrading appliances, there may be an additional charge to modify cabinetry and/or electrical and plumbing to accommodate the appropriate size from the manufacturer specifications of each appliance.

**\*\*MANUFACTURERS SPECIFICATIONS MUST BE ATTACHED\*\***

36" / 42" Stove (Hood fan width will be the same as per Ontario Building Code)

Gas Stove

Slide-In Stove

Cooktop

\*(Gas/Electric – Cut-out Charge & Plug Required)

Built-In Wall Oven

Hood Fan (may require larger vent, charges will apply – 6" is standard)

8" Vent / 10" Vent

Chimney hoods \*\*CENTRE VENT ABOVE STOVE (clearance space will be left with this appliance will not butt up against cabinetry)

Built-In Microwave with Trim Kit

Built-In Microwave Drawer with Trim Kit

Warming Drawer

OTR – Over The Range Microwave \*Plug required

Built-in Refrigerator/Sub Zero – If purchasing a side by side or French Door, the wall beside the door may be an issue if it is deeper than 24"

\* Applicable charges may apply if required to due to space accommodations

\*Note: Refrigerator Door Swing

Wine / Bar Fridge (electrical required)

Steam Oven / Built-In Coffee makers

Cargo Waste Bin systems

Front Load Washer & Dryer \*(Specs required if installing counter above)

Stackable Washer & Dryer

~~NO~~ **NOTE:** It is the Purchaser's responsibility to coordinate delivery, installation and hook up of appliances and to ensure they are installed as per Manufacturers specifications after closing.

~~NO~~ Purchaser acknowledges responsibility for providing correct specification for such appliances. The purchaser agrees to deliver forthwith to the Builder the manufacturer's appliance specifications where the size exceeds the standard openings.

~~NO~~ If specs not received, the standard openings as determined by Zancor Homes will be provided. If rework/repair is required due to late specs received, additional costs will be applied.

**Appliance Specifications are to be sent to the Zancor Décor Centre no later than** \_\_\_\_\_

**Appliance Specifications received** \_\_\_\_\_

Purchaser Signature \_\_\_\_\_

Date \_\_\_\_\_

Purchaser Signature \_\_\_\_\_

Date \_\_\_\_\_

PROJECT \_\_\_\_\_

LOT \_\_\_\_\_

# Paris Kitchens Appliance Sign-off Form

245 West Beaver Creek Rd, Unit 2, Richmond Hill, On, L4B 1L7: 905.886.5751 f:905.886.8858

ZANCOR CASTLES  
LOT: 9

## BUILDER NOTIFICATION FOR APPLIANCE SPECIFICATIONS

Please find attached appliance specifications, as provided and signed off by the purchaser. It is the responsibility of the builder to ensure that any electrical, water supply, gas fittings, venting and any other appliance requirements are reviewed with the purchaser directly. It is also the responsibility of the builder to ensure that they have all relevant appliance spec's, as required to ensure installation of said appliances.

### Built-in appliance cut-out process:

- ☐ Once a date has been confirmed for the delivery of your appliances please contact our Customer Service Dept. at Paris Kitchens 905.886.5751
- ☐ We require at least **10 BUSINESS DAYS** notice to set up an appointment and all appliances (including trim kits) **MUST** be on site. We aim to schedule our Service Installers to complete the cut-out(s) the day after the appliances have been delivered. Please keep in mind that all appointments are scheduled between Monday to Friday from 8:00am to 3:00pm.  
(Not including holidays)

☐ After our Service have completed the cut-out(s), the installation and connection of the appliances can proceed (installation is NOT performed by Paris Kitchens). We do not install or connect appliances; this must be arranged by the homeowner with the appropriate trades.

- ☐ Please sign-off on the attached package of: APPLIANCE SPECIFICATIONS (PROVIDED BY PURCHASER)

### Appliance specs provided:

- ☐ ~~SEE SPECS~~
- ☐ ~~PLEASE SIGN~~
- ☐ ~~ON ALL~~
- ☐ ~~FOLLOWING~~
- ☐ ~~SPEC SHEETS~~

### Built-In Appliance Installation Application

- ☐ FLUSH INSTALLATION - Built-in Fridge
- ☒ STANDARD INSTALLATION - Built-in Fridge
- ☐ FLUSH INSTALLATION - Built-in Oven/Micro
- ☒ EURO FIT - Built-in Oven/Micro
- ☐ STANDARD INSTALLATION - Built-in Oven/micro
- ☐ RANGE TOP BUMPED OUT BY \_\_\_\_\_
- ☐ COOKTOP BUMPED OUT BY \_\_\_\_\_

Purchaser Name (please print)

Signature

Purchaser Name (please print)

Signature

Please sign

36" GAS RANGE - 6 BURNERS

WOLF



GR366

FEATURES

- 6 dual-stacked, sealed burners
- Dual-stacked, sealed burners for higher highs, lower lows
- Convection oven for faster, more consistent cooking
- Infrared broiler inside oven sears quickly and evenly
- Heavy-gauge stainless steel
- Enhanced views into oven
- Rigorously tested in our U.S. manufacturing facilities for decades of use
- Exceptional 24/7 support from our Customer Care team in Madison
- Signature red infinite control knobs
- Continuous cast-iron grates for easy movement of pots and pans
- Individual spark ignition system
- Adjustable legs for stability, plus rear casters

ACCESSORIES

- Bake stone kit (stone, rack and peel)
- Stainless steel, brass or chrome bezels
- High altitude conversion kit
- Full-extension easy glide oven rack
- Cast iron S-grates and wok grate
- Stainless steel kickplate
- Signature red, black or stainless steel control knobs
- Front leg covers
- 5" and 10" stainless steel risers, and 20" riser with shelf

Accessories available through an authorized Sub-Zero dealer.  
For local dealer information, visit [subzero-wolf.com/locator](http://subzero-wolf.com/locator).

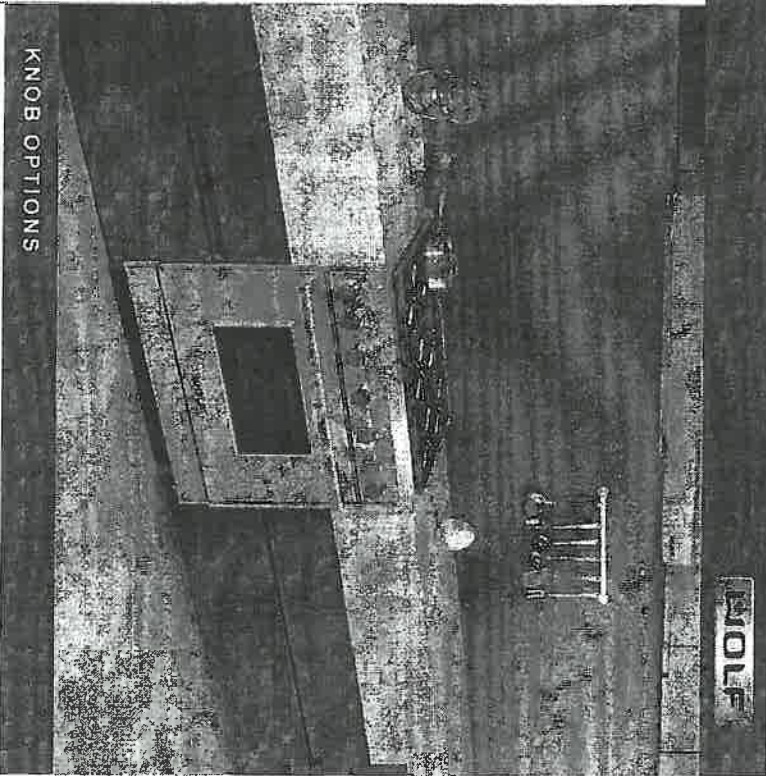

KNOB OPTIONS



TOP CONFIGURATION

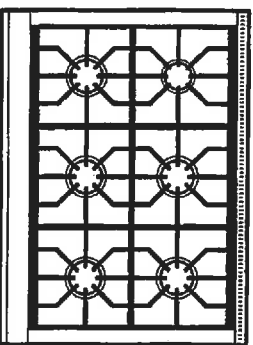

RANGETOP SPECIFICATIONS

- 1 - 9,200 Btu Burner
- 5 - 15,000 Btu Burners

I HAVE READ AND  
FULLY UNDERSTAND  
THIS LAYOUT/QUOTATION

CUSTOMER SIGNATURE

36" RANGE

lot 9  
RC

36" BUILT-IN OVER-AND-UNDER REFRIGERATOR/FREEZER

SUB-ZERO

PRODUCT SPECIFICATIONS

Model	BL36L/S		
Dimensions	36"W x 84"H x 24"D		
Door Clearance	37 1/4"		
Drawer Clearance	23 5/8"		
Weight	515 lb		
Refrigerator Capacity	16.4 cu ft		
Freezer Capacity	5.3 cu ft		
Electrical Supply	115 VAC, 60 Hz		
Electrical Service	15 amp dedicated circuit		
Plumbing Supply	1/4" OD copper, braided stainless steel or PEX tubing		
Plumbing Pressure	35-120 psi		

ELECTRICAL

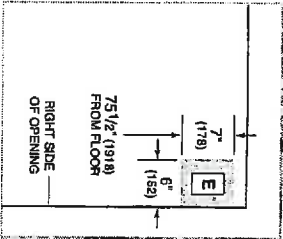

PLUMBING

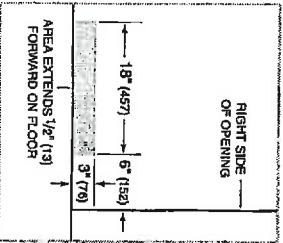

INTERIOR VIEW

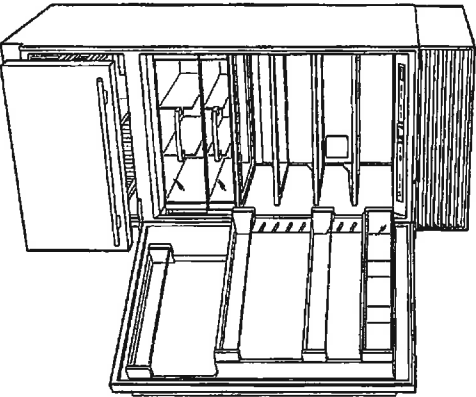

This illustration is intended for interior reference only and may not represent the exterior of the model being specified.

DIMENSIONS

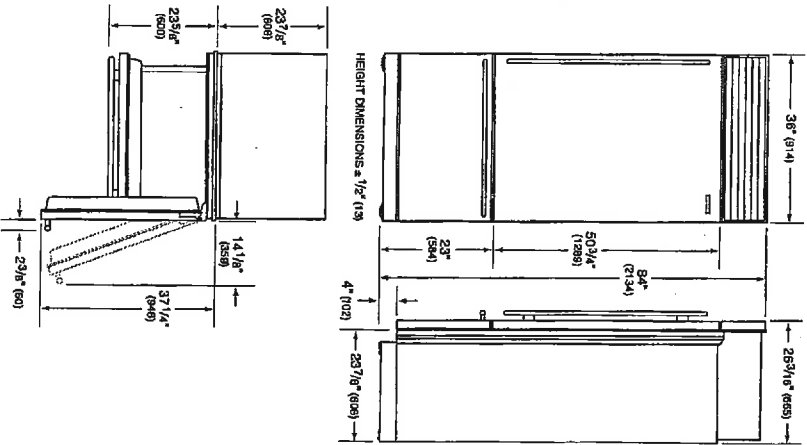

STANDARD INSTALLATION

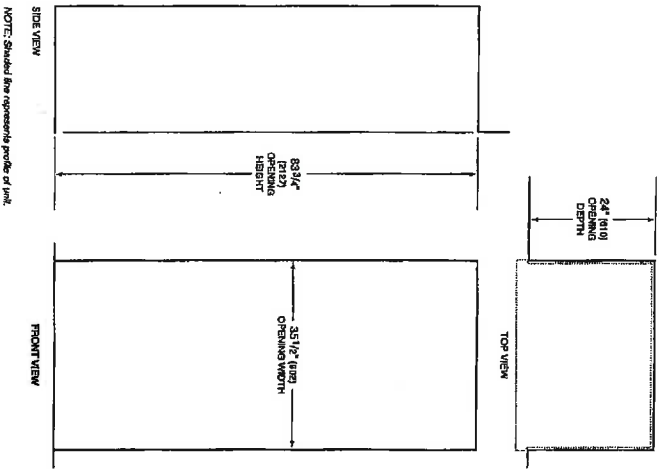

I HAVE READ AND  
FULLY UNDERSTAND  
THIS LAYOUT/QUOTATION

CUSTOMER SIGNATURE

FRIDGE

LOT. 9 RC



36" BUILT-IN OVER-AND-UNDER REFRIGERATOR/FREEZER

BI-36U/S



FEATURES

- Dual refrigeration keeps food fresher longer
- Air purification system fights spoilage, odors
- Chispers and deli drawers in low-temp, high-humidity zones for optimum freshness
- Microprocessor control assures peak performance
- Water-filtration system for ice reduces contaminants, chlorine taste and odor
- Freshness cards for maximum food preservation
- Clear-view, triple-pane and UV-resistant glass door
- Rigorously tested in our U.S. manufacturing facilities to ensure at least 20 years of heavy use
- Exceptional 24/7 support from our Customer Care team based in Madison, Wisconsin and just footsteps from our factory
- "Soft bright" interior lighting
- Over-and-under refrigerator/freezer storage
- Magnetic door seal system locks in cold air
- Automatic ice maker with "max ice" feature
- Adjustable shelves for maximum convenience

ACCESSORIES

- Stainless steel kickplate
  - Grilles for 83" or 88" finished height (94" is standard)
  - Side panel mounting kit
  - Dual installation kit with or without dual wide grille—84" finished height
- Accessories are available through an authorized Sub-Zero dealer. For local dealer information, visit [subzero-wolf.com/locator](http://subzero-wolf.com/locator).

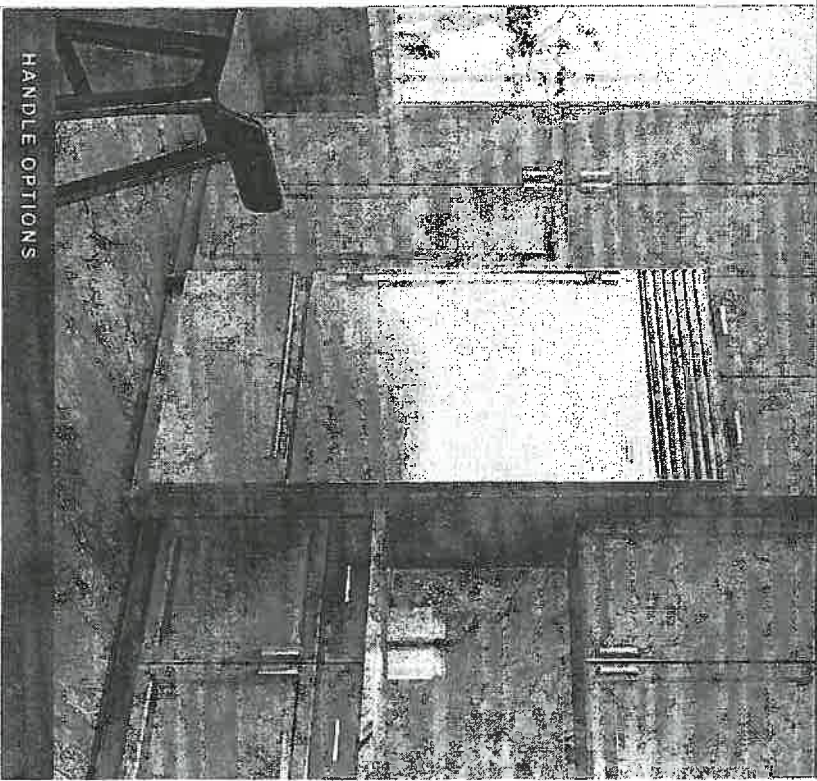

HANDLE OPTIONS

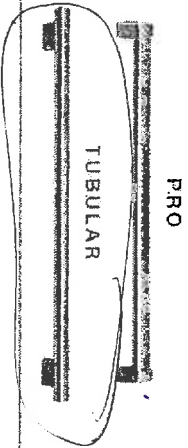

PRODUCT DETAILS

REFRIGERATOR

- 3 Adjustable glass shelves
- 1 Stationary glass shelf
- 1 High-humidity drawer with dividers
- 1 Storage drawer with dividers
- 2 Adjustable door shelves
- 1 Stationary door shelf
- Adjustable dairy compartment

FREEZER

- Full-extension roll-out freezer drawer
- Two-tier wire storage baskets
- Automatic ice maker

I HAVE READ AND  
FULLY UNDERSTAND  
THIS LAYOUT/QUOTATION

CUSTOMER SIGNATURE

FRIDGE

LOT 9 RC

FRIDGE

# SUTC-35

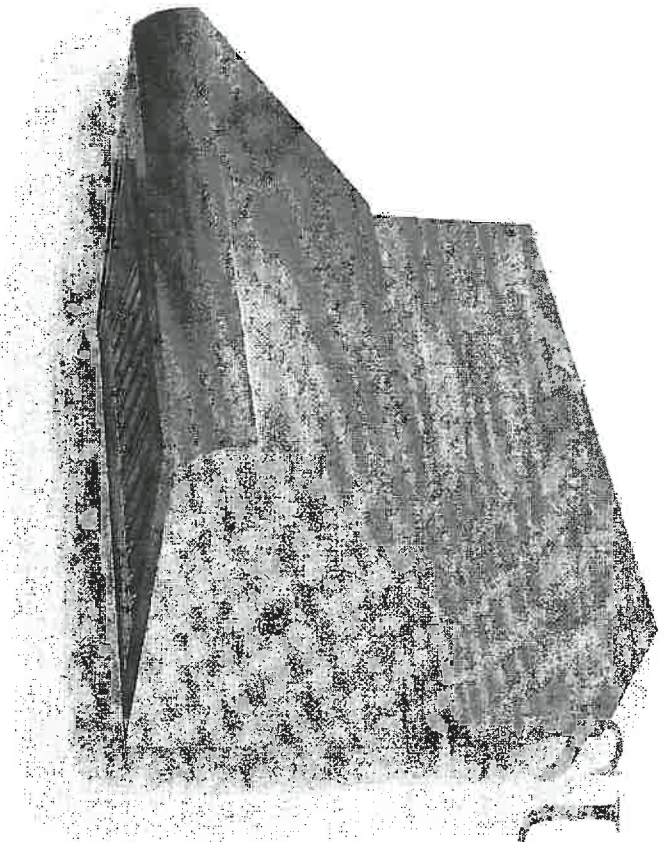

## SUTC 35

- SUTC35 36"-48" Dual Motor: EBM 1100 cfm (Duct size 8")
- SUTC35 30" One Motor: EBM 600cfm (Duct size 6")
- Pressure: 800 Pa
- Noise level: 66 dBA - 5.1 sones



- Lighting: 2x20W halogen lamps 30" version  
3x20W halogen lamps 36" version  
4x20W halogen lamps 48" version



- Red Control panel: 4 speed push-button + timer + light switch
- grease filter: commercial style baffle filters
- Stainless steel: AISI 430

**I HAVE READ AND  
FULLY UNDERSTAND  
THIS LAYOUT/QUOTATION**

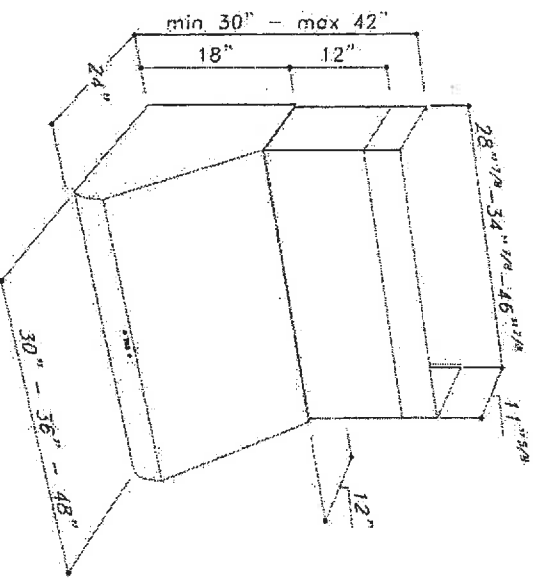

## CUSTOMER SIGNATURE

36" VENT HOOD

**Sirius**

LOT. 9RC

15

SU TC 35

2 Motors top vented version

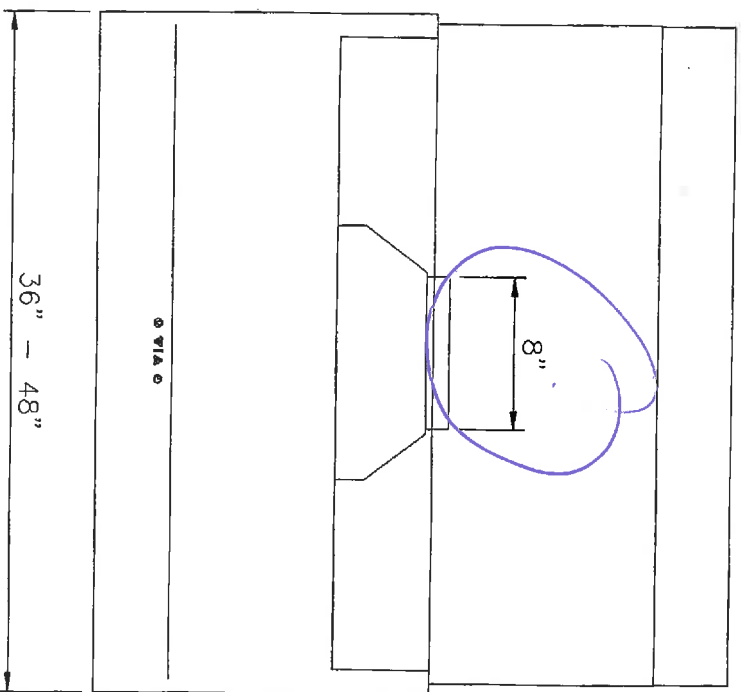
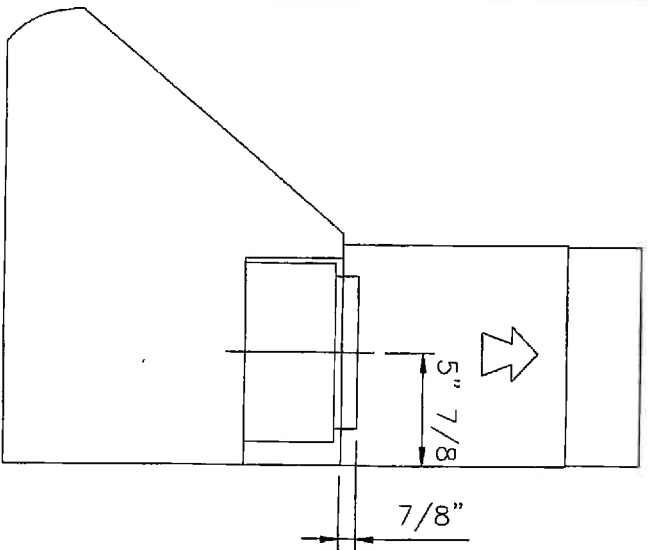

I HAVE READ AND  
FULLY UNDERSTAND  
THIS LAYOUT/QUOTATION

CUSTOMER SIGNATURE

36" Vent Heels

W

LOT 9 RC

NS

SU TC 35

2 Motors back vented version

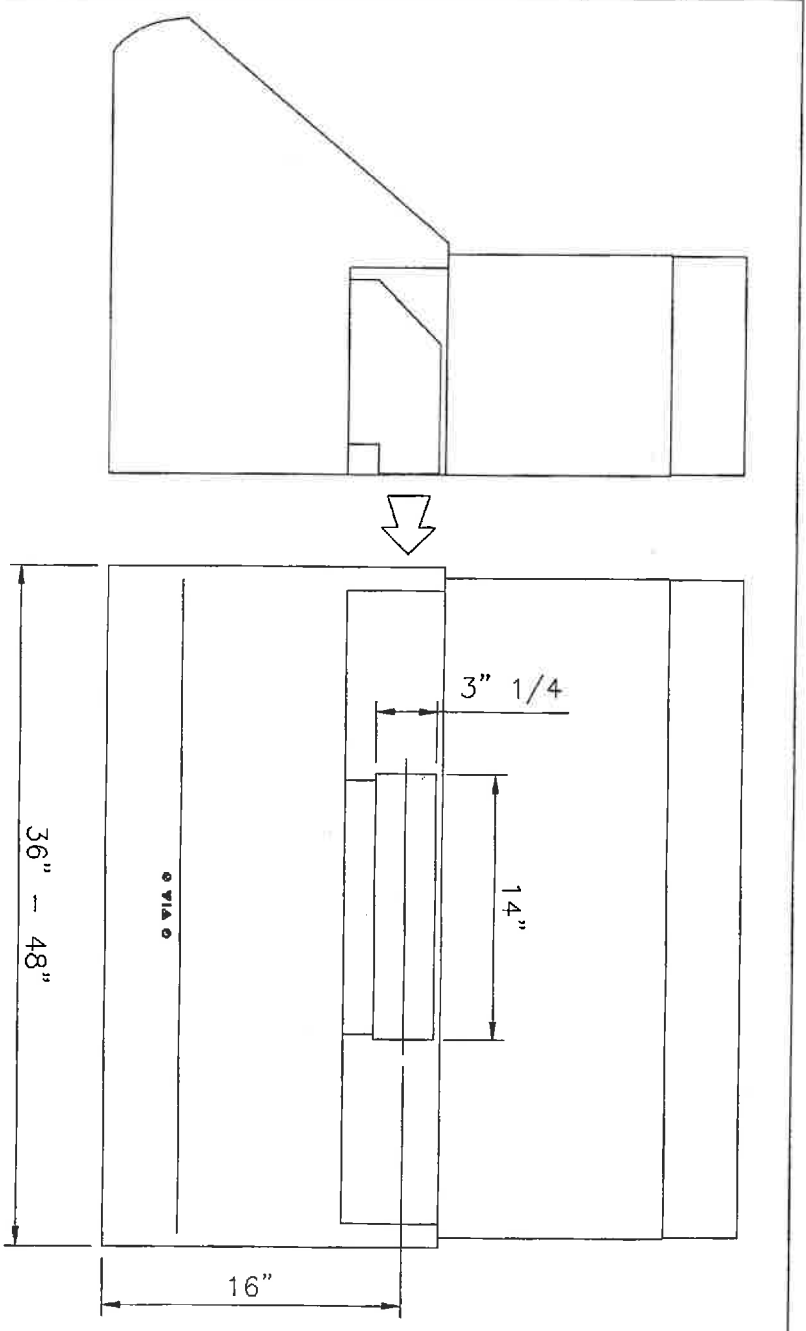

I HAVE READ AND  
FULLY UNDERSTAND  
THIS LAYOUT/QUOTATION

CUSTOMER SIGNATURE

36" Vent Hood

LOT 9 RC



30" M SERIES PROFESSIONAL BUILT-IN SINGLE OVEN



SO30PM/S/PH

FEATURES

- 10 cooking modes for predictably delicious results (Convection, Roast, Bake, Broil, Convection Roast, Stone, Gourmet, Warm, Proof and Dehydrate)
- Advanced Dual VentiCross convection system for faster preheats and consistent cooking across all racks
- Gourmet feature has menu of presets that automatically controls cooking of popular meals
- 5.1 cubic feet capacity to handle multiple dishes at once
- Interactive color touchscreen for advanced cooking control
- Enhanced interior views with triple-pane glass and three halogen lights
- Choose from signature red, black or stainless control knobs
- Quiet-close doors with spring-and-damper door hinge system
- Can be installed flush with surrounding cabinetry for integrated look
- Rigorously tested in our U.S. manufacturing facilities for decades of use
- Exceptional 24/7 support from our Customer Care team in Madison

ACCESSORIES

- Bake stone kit (stone, rack and peel)
- Dehydration kit (racks and door stop)
- Full-extension easy glide oven rack
- Temperature probe and broiler pan
- Set of three standard oven racks
- Signature red, black or stainless steel control knobs

Accessories available through an authorized Sub-Zero dealer. For local dealer information, visit [subzero-wolf.com/locator](http://subzero-wolf.com/locator).

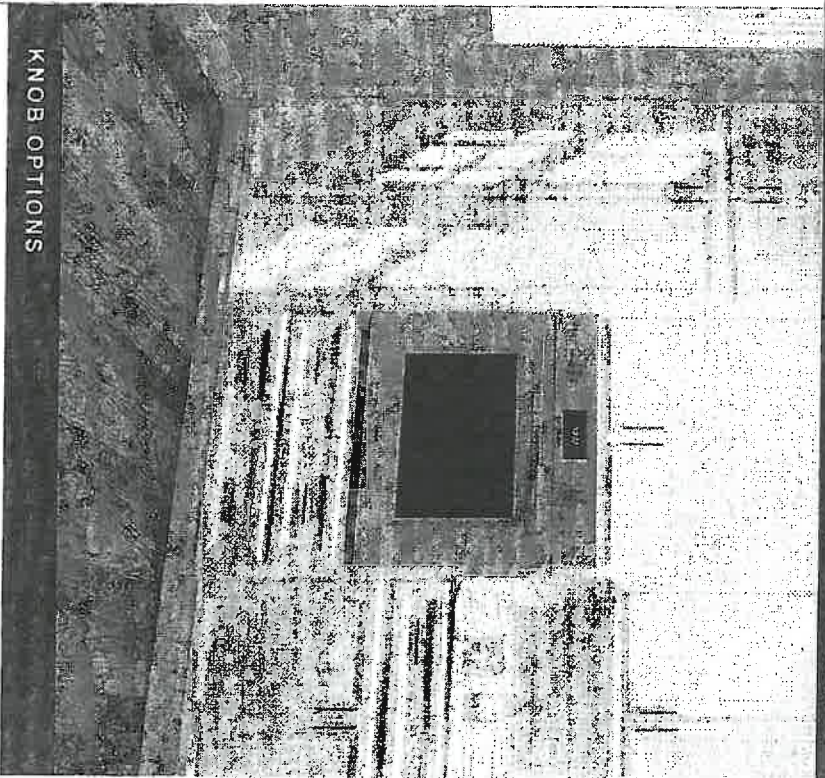

KNOB OPTIONS



EMROFIT

I HAVE READ AND  
FULLY UNDERSTAND  
THIS LAYOUT/QUOTATION

CUSTOMER SIGNATURE

30" OVEN  
LOT 9 RC

Handwritten signature in blue ink.

36" GAS RANGE - 6 BURNERS



PRODUCT SPECIFICATIONS

Model	GR386	
Dimensions	35 7/8"W x 37"H x 26 3/8"D	
Oven 1 Interior Dimensions	39"W x 18 5/8"H x 17"D	
Oven 1 Usable Capacity	3.7 cu ft	
Oven 1 Overall Capacity	5.5 cu ft	
Door Clearance	19 1/2"	
Weight	470 lb	
Electrical Supply	110/120 VAC, 50/60 Hz	
Electrical Service	15 amp dedicated circuit	
Gas Supply	3/4" rigid pipe	
Gas Inlet	1/2" NPT female	

DIMENSIONS

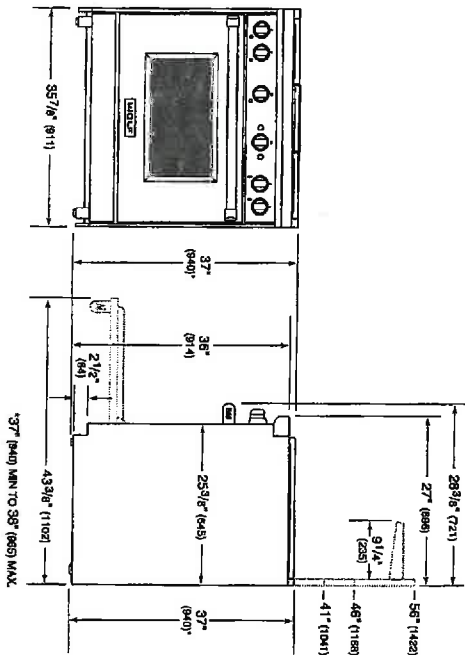

ELECTRICAL

GAS

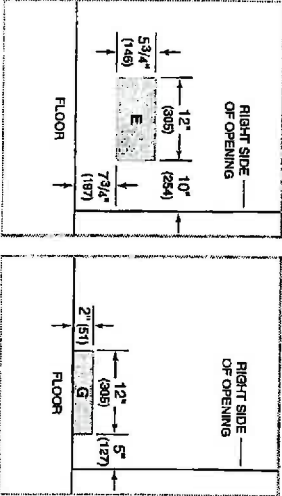

STANDARD INSTALLATION

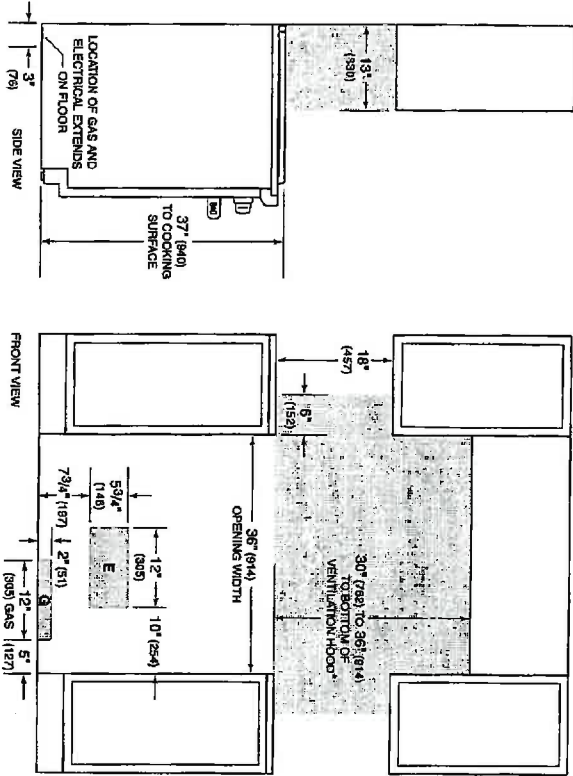

\*Without ventilation hood, 42" (1067) minimum clearance countertop to combustible materials, charcoal requires non-combustible materials.  
NOTE: Shaded area above countertop indicates minimum clearance to combustible surfaces, combustible materials cannot be located within this area.  
For Island Installation, 12" (305) minimum clearance back of range to combustible rear wall above countertop.

I HAVE READ AND  
FULLY UNDERSTAND  
THIS LAYOUT/QUOTATION

CUSTOMER SIGNATURE

6079  
RC  
36" RANGE

30" M-SERIES PROFESSIONAL DROP-DOWN DOOR MICROWAVE OVEN



PRODUCT SPECIFICATIONS

Model	MDD30PM/S/PH		
Dimensions	28 7/8"W x 17 7/8"H x 20"D		
Door Clearance	14 3/16"		
Weight	80 lb		
Electrical Supply	120 V/AC, 60 Hz		
Electrical Service	15 amp dedicated circuit		
Overall Capacity	1.6 cu ft		
Power Cord Length	4 feet		

ELECTRICAL

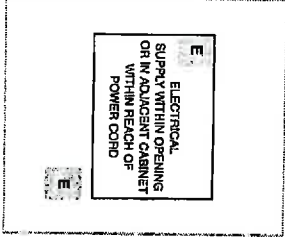

DIMENSIONS

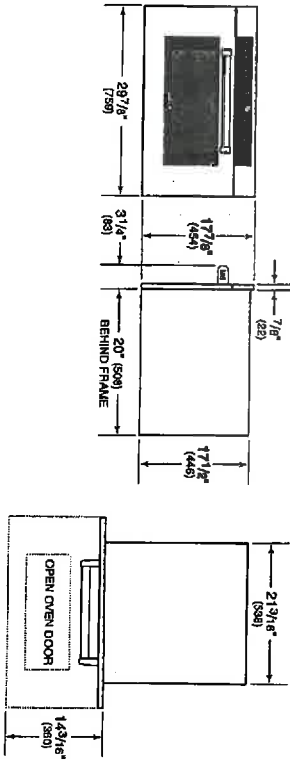

*BARO FIT*

STANDARD INSTALLATION

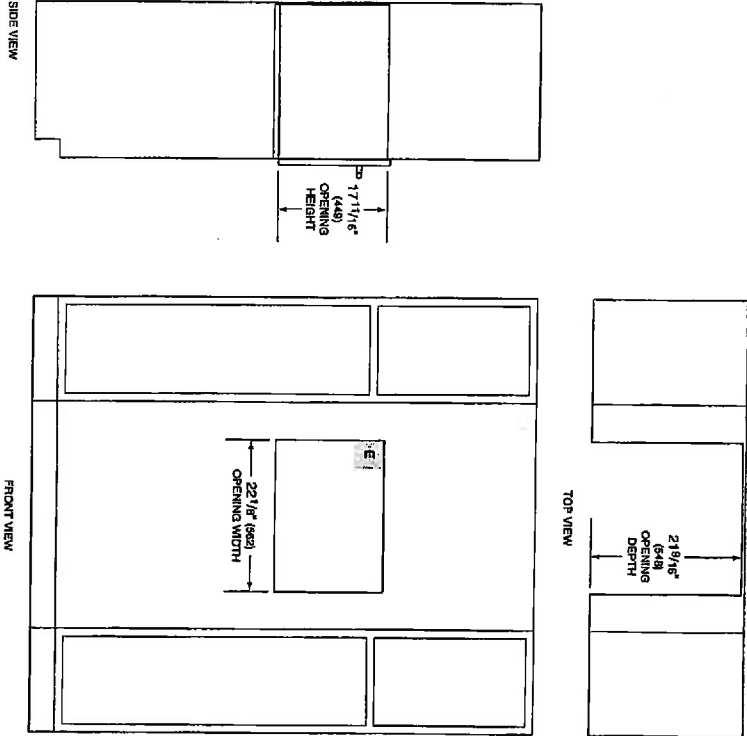

**I HAVE READ AND  
FULLY UNDERSTAND  
THIS LAYOUT/QUOTATION**

**CUSTOMER SIGNATURE**

*30" Micoe*

*LOT. 9RC*



30" M SERIES PROFESSIONAL DROP-DOWN DOOR MICROWAVE OVEN



MDD30PM/S/PH

FEATURES

Integrates into any kitchen

Matches M series ovens, coffee systems, convection steam oven

900 watts of power

Generous 1.6 cu. ft. capacity

Quick-start controls for popular items

Gourmet mode cooks automatically from preset recipes

"Keep Warm" mode

Rigorously tested in our U.S. manufacturing facilities for decades of use

Exceptional 24/7 support from our Customer Care team in Madison

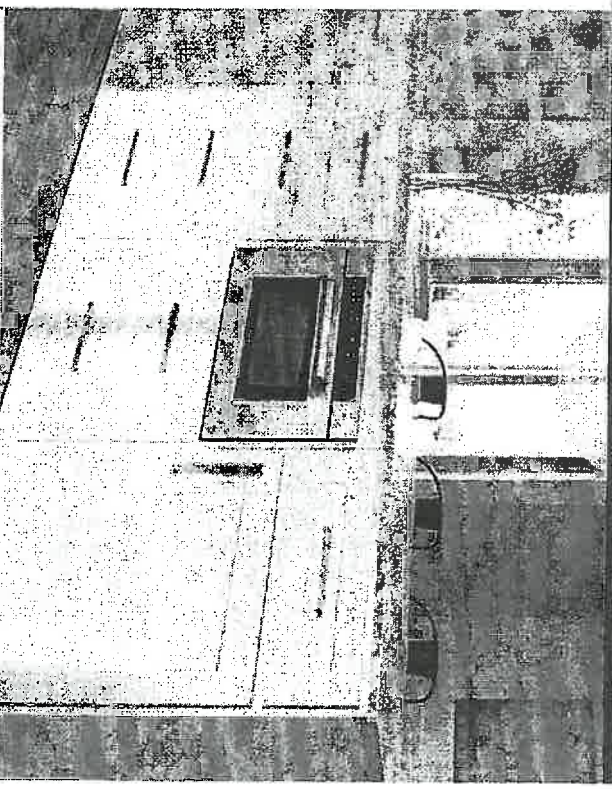

EURO FIT

I HAVE READ AND  
FULLY UNDERSTAND  
THIS LAYOUT/QUOTATION

CUSTOMER SIGNATURE

30" MICRO

LOT. 9 RC



30" M SERIES PROFESSIONAL BUILT-IN SINGLE OVEN



PRODUCT SPECIFICATIONS

Model	SO30PM/S/PH		
Dimensions	29 7/8"W x 28 1/2"H x 23"D		
Oven 1 Interior Dimensions	25 1/4"W x 17 1/2"H x 19 7/8"D		
Overall Capacity	5.1 cu ft		
Usable Capacity	3.3 cu ft		
Door Clearance	21 3/8"		
Weight	273 lb		
Electrical Supply	240/208 VAC, 60 Hz		
Electrical Service	30 amp dedicated circuit		
Conduit Length	4 feet		

ELECTRICAL

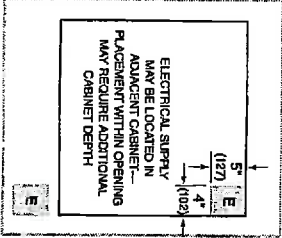

DIMENSIONS

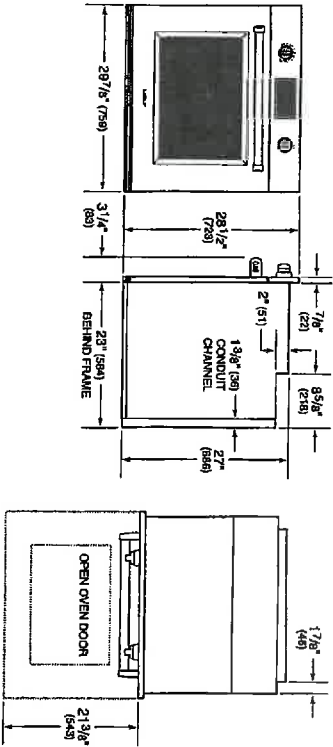

STANDARD INSTALLATION

EURO FIT

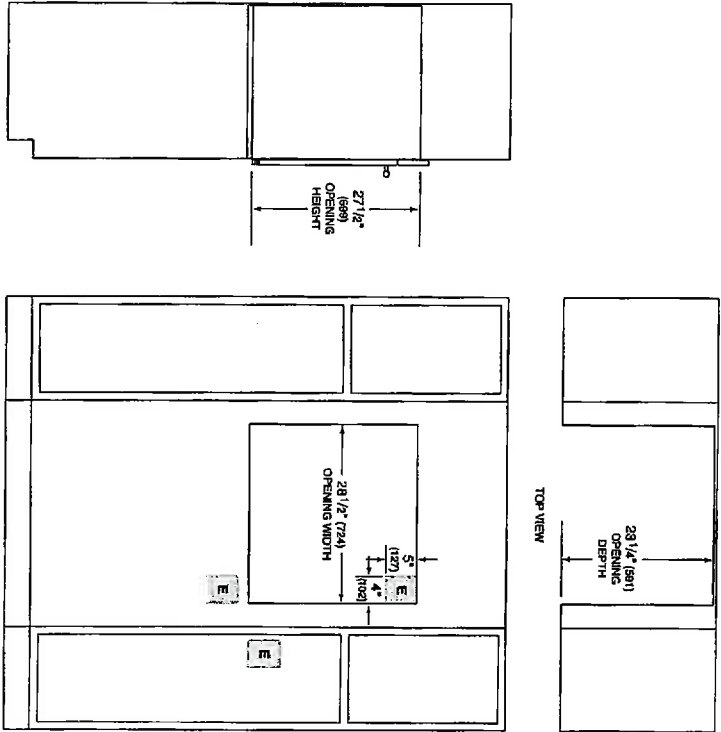

NOTE: Location of electrical supply within opening may require additional cabinet depth.

I HAVE READ AND  
FULLY UNDERSTAND  
THIS LAYOUT/QUOTATION

CUSTOMER SIGNATURE

30" OVEN

LOT. 9 RC

24" Marvel Beverage Center  
with Two 60/40 Split  
Convertible Shelves™  
Model # ML24BCG1\*\*



Certified to meet  
ENERGY STAR® requirements

- Dynamic Cooling Technology™ delivers rapid cooldown and the industry's best temperature stability
- 60/40 Split Convertible Shelf™—cantilevered glass shelving, wine rack with a Vibration Neutralization System™ or both configurations all in one
- Rollout wine storage
- Solid, black-stained maple shelf fronts (natural maple shelf accessories available)
- MARVEL Intui™ Integrated Controls ensure precise temperature management from 34°F to 42°F
- Thermal-efficient cabinet ensures optimum food preservation and energy efficiency while maximizing capacity
- Tinted, UV-resistant dual pane glass door protects wine from damaging ultra-violet light
- Two-stage, soft white theatre-style LED lighting and midnight black interior
- Cantilevered, fully adjustable shelving system
- Close Door Assist System™ gently and automatically closes door
- Audible and visual alarms signal when door is left ajar to protect food integrity and energy use
- Vacation/Sabbath mode conserves energy during times when the unit is not in use and complies with Star-K requirements
- Height adjustment up to 1" with leveling legs
- 4" black adjustable toe kick
- 1-year warranty

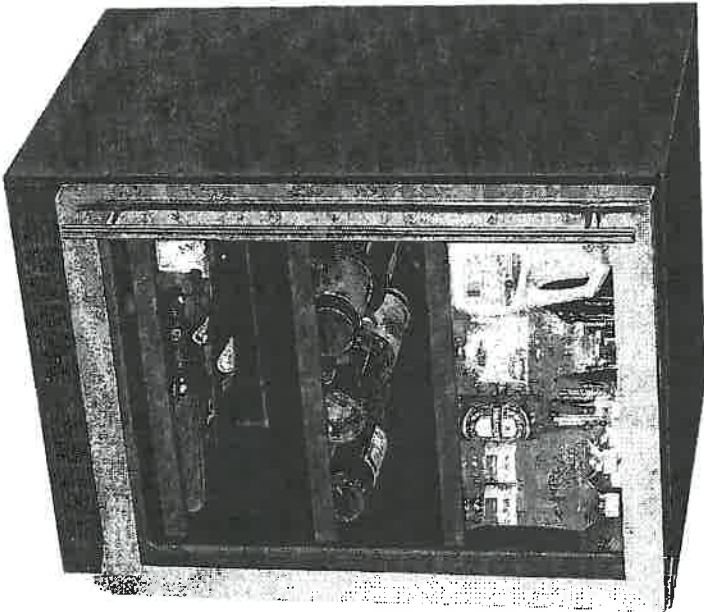

Ordering Details	
Stainless Frame Glass Door, Right Hinge	ML24BCG1RS
Stainless Frame Glass Door, Left Hinge	ML24BCG1LS
Panel Overlay Frame Glass Door Integrated Right Hinge	ML24BCF2RP
Panel Overlay Frame Glass Door Integrated Left Hinge	ML24BCF2LP
Panel Overlay Frame Glass Door Integrated Right Hinge	ML24BCP2RP
Panel Overlay Frame Glass Door Integrated Left Hinge	ML24BCP2LP

Storage Capacity

Up to (162) 12-oz cans or (18) wine bottles

Storage Configuration

- (2) cantilevered, full-width 60/40 Split Convertible Shelf™ black steel-framed glass shelf
- (1) roller-glide 4-bottle wine rack

Product Dimensions

23⅞" W x 33⅝" minimum H x 25⅝" D (including handle)

Finish/Door Options

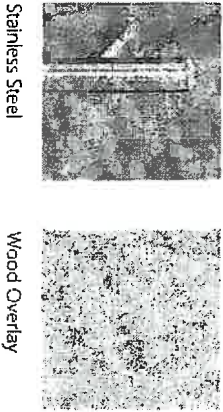

Stainless Steel

Wood Overlay  
(Panel Ready)

I HAVE READ AND  
FULLY UNDERSTAND  
THIS LAYOUT/QUOTATION

CUSTOMER SIGNATURE

BEV. RIDGE

LOT 9 RC

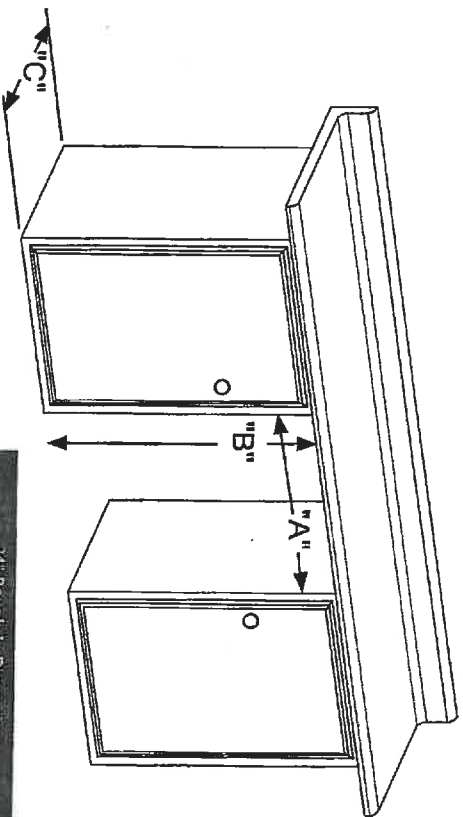

24" Rough-In Dimensions		
24" (61 cm)	33 3/4" to 35" (86.4 to 88.9 cm)	24" (61 cm)

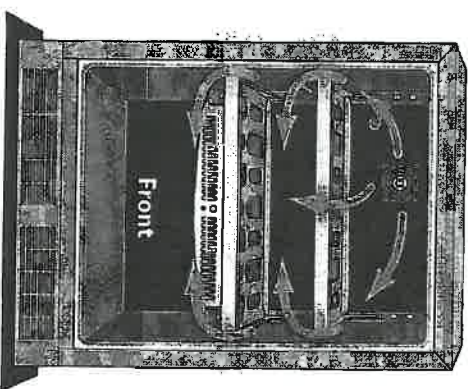

Cabinet Dimensions		
23 7/8" (60.7 cm)	33 3/4" to 34 3/4" (85.7 to 88.3 cm)	23 23/32" (60.2 cm)
25 21/32" (65.2 cm)	46 13/32" (117.9 cm)	25 11/16" (65.2 cm)

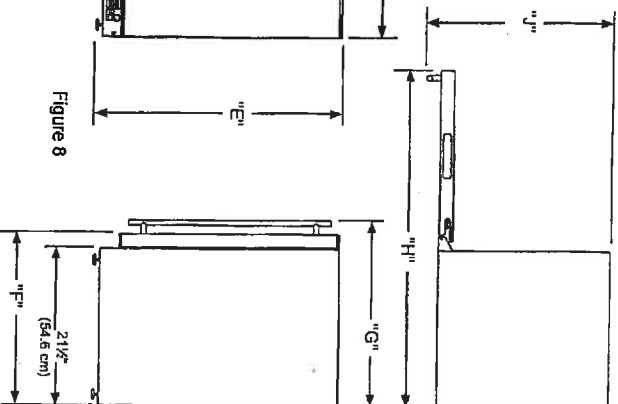
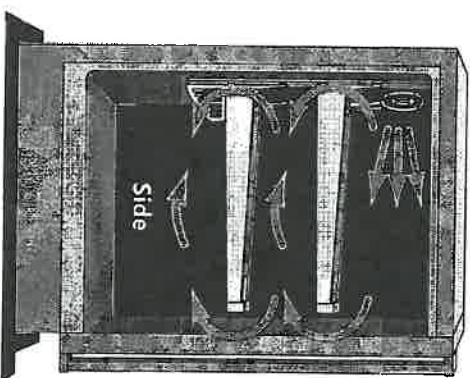

Figure 8

Width	23 7/8"
Interior Finish	Black
Capacity	Up to 18 wine bottles or up to 162 12-oz cans
Shelving System	Canilover
Shelf Fronts	Black painted maple
Other Storage	NA
Interior Lighting	2 White LED Pods
Toe Grill Finish	Black
Hinge	Classic Hinge
Handle	Designer

Control Type	Intuit™
Temperature Range	34° - 42° F
Lock	NA
Electrical Requirements	120V / 60Hz / 15A
Length of Power Cord	5'
Product Dimensions	23 7/8" W x 33 3/4" H x 23 1/2" D
Depth to Front of Door	23 29/32"
Depth to Handle	25 21/32"
Depth with door at 90°	46 3/16"
Shipping Weight	160 lbs



**Dynamic Cooling Technology™** delivers rapid cool down and the industry's best temperature stability

The distinctive Marvel design features a thermal-efficient cabinet and door combined with Dynamic Cooling Technology™ for superior temperature stability, faster cooling times, and speedy temperature recovery even with high frequency.

Finishes	SS, O
Vacation / Sabbath Mode	Yes
Agency Approvals	CSA
Energy Star Certified	

**Finishes Key**

- SS = Stainless Steel
- O = Overlay

**I HAVE READ AND FULLY UNDERSTAND THIS LAYOUT/QUOTATION**

**CUSTOMER SIGNATURE**

BEV. RIDGES

LOT 9 RC



## Electric Dryer

### PRODUCT MODEL NUMBERS

WED2HED, WED81HED, WED8740D, WED87HED, WED95HED, WED97HED

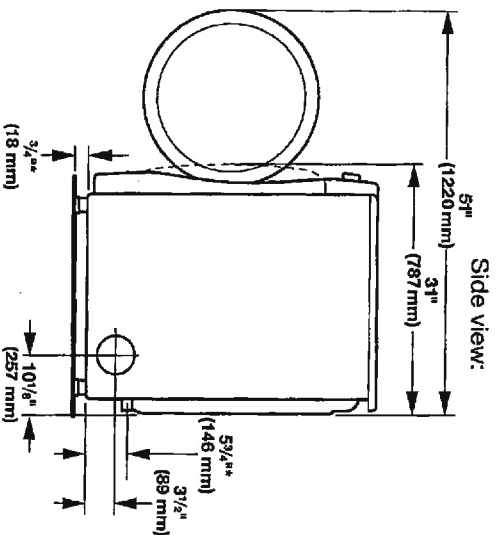
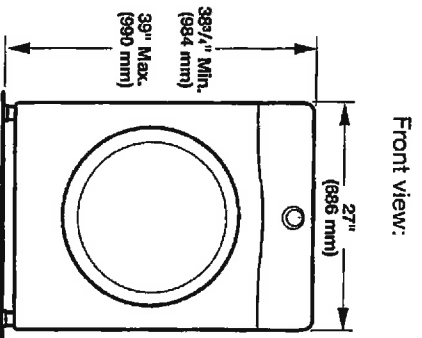

Back view:

Recommended Installation Spacing:

**NOTE:** Most installations require a minimum of 5" (127 mm) clearance behind dryer for exhaust vent with elbow. See "Venting Requirements."

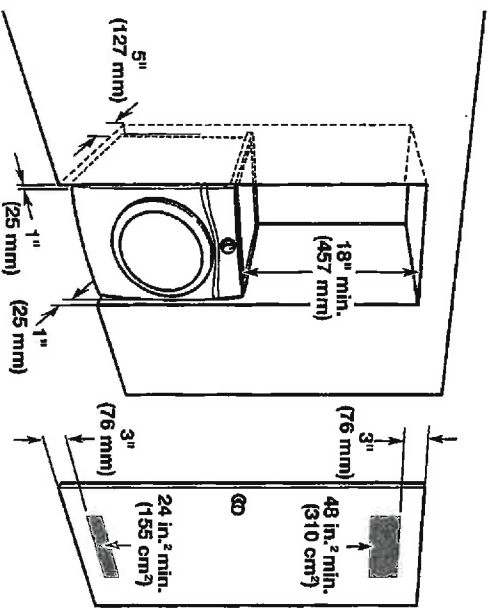
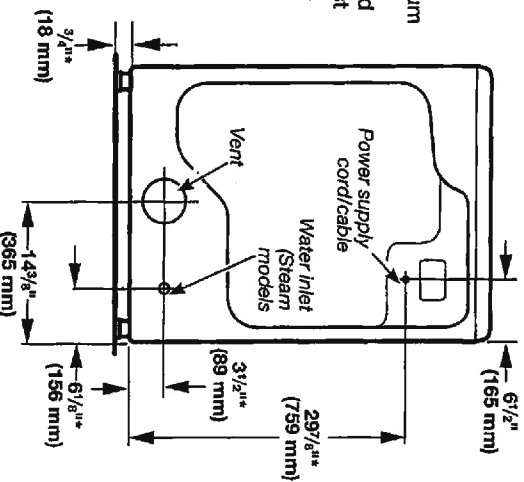

\* Approx. measurement.

### Installation spacing for recessed area or closet installation

The dimensions shown below are the recommended spacing for this dryer.

- Additional spacing should be considered for ease of installation and servicing.
- Additional clearances might be required for wall, door, floor moldings, and dryer venting.
- Additional spacing of 1" (25 mm) on all sides of the dryer is recommended to reduce noise transfer.
- For closet installation, with a door, minimum ventilation openings in the top and bottom of the door are required. Louvered doors with equivalent ventilation openings are acceptable. Companion appliance spacing should also be considered.

W10676165A  
04/2014

I HAVE READ AND  
FULLY UNDERSTAND  
THIS LAYOUT/QUOTATION

bot. QRC

CUSTOMER SIGNATURE

D Rye



ELECTRICAL REQUIREMENTS

To supply the required 3 or 4 wire, single phase, 120/240 volt, 60 Hz., AC only electrical supply (or 3 or 4 wire, 120/208 volt electrical supply, if specified on the serial/rating plate) on a separate 30-amp circuit, fused on both sides of the line. A time-delay fuse or circuit breaker is recommended. Connect to an individual branch circuit.

VENTING REQUIREMENTS

Exhaust venting: Exhaust your dryer to the outside. 4" (102 mm) diameter vent is required. Rigid or flexible metal exhaust vent must be used. Do not use plastic or metal foil vet. Exhaust hood must be at least 12" (305 mm) from the ground or any object that may be in the path of the exhaust.

The Vent System Chart provides venting requirements that will help achieve best drying performance.

Whirlpool Vent System Chart			
Number of 90° elbows	Type of vent	Box/louvered hoods	Angled hoods
0	Rigid metal	64 ft. (20 m)	58 ft. (17.7 m)
1	Rigid metal	54 ft. (16.5 m)	48 ft. (14.6 m)
2	Rigid metal	44 ft. (13.4 m)	38 ft. (11.6 m)
3	Rigid metal	35 ft. (10.7 m)	29 ft. (8.8 m)
4	Rigid metal	27 ft. (8.2 m)	21 ft. (6.4 m)

NOTE: Bottom exhaust installations have a 90° turn inside the dryer. To determine maximum exhaust length, add one 90° turn to the chart.

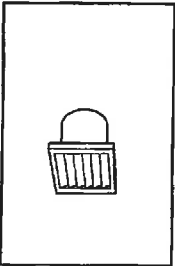

Louvered Hood

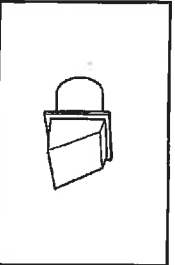

Box Hood

Acceptable Style:



Angled Hood

Determine vent path:

- Select route that will provide straightest and most direct path outdoors.
- Plan installation to use fewest number of elbows and turns.
- When using elbows or making turns, allow as much room as possible.
- Bend vent gradually to avoid kinking.
- Use as few 90° turns as possible.

Determine vent length and elbows needed for best drying performance:

- Use following Vent System Chart to determine type of vent material and hood combinations acceptable to use.

NOTE: Do not use vent runs longer than those specified in Vent System Chart. Exhaust systems longer than those specified will:

- Shorten life of dryer.
- Reduce performance, resulting in longer drying times and increased energy usage.

I HAVE READ AND FULLY UNDERSTAND THIS LAYOUT/QUOTATION

CUSTOMER SIGNATURE

lot 9Rc

DRYER

Because Whirlpool Corporation policy includes a continuous commitment to improve our products, we reserve the right to change materials and specifications without notice.

Dimensions are for planning purposes only. For complete details, see installation instructions packed with product. Specifications subject to change without notice.



## Front-Loading Washer

### PRODUCT MODEL NUMBERS

WFW88HEA, WFW94HEA, WFW96HEA,  
WFW95HED, WFW97HED

#### Washer Dimensions:

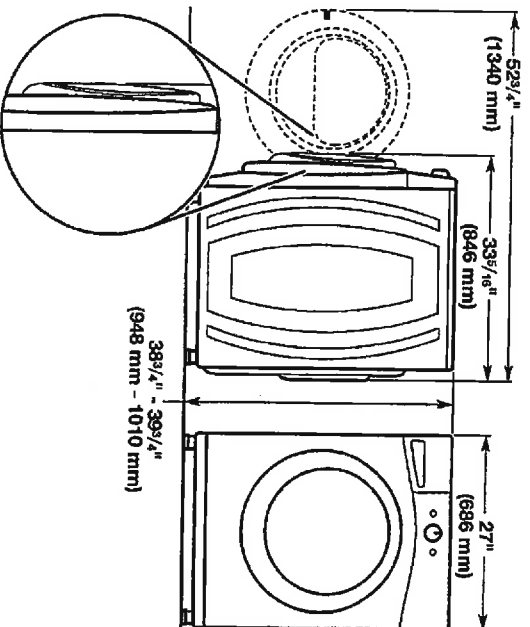

### PRODUCT MODEL NUMBERS

WFW61HEB, WFW70HEB, WFW80HEB,  
WFW8640B, WFW86HEB, WFW72HED,  
WFW81HED, WFW82HED, WFW8740D,  
WFW87HED

#### Washer Dimensions:

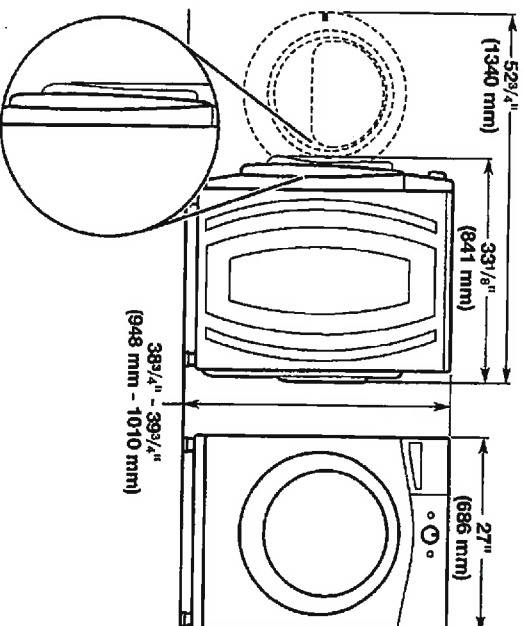

Recessed or closet installation -  
stacked washer and dryer

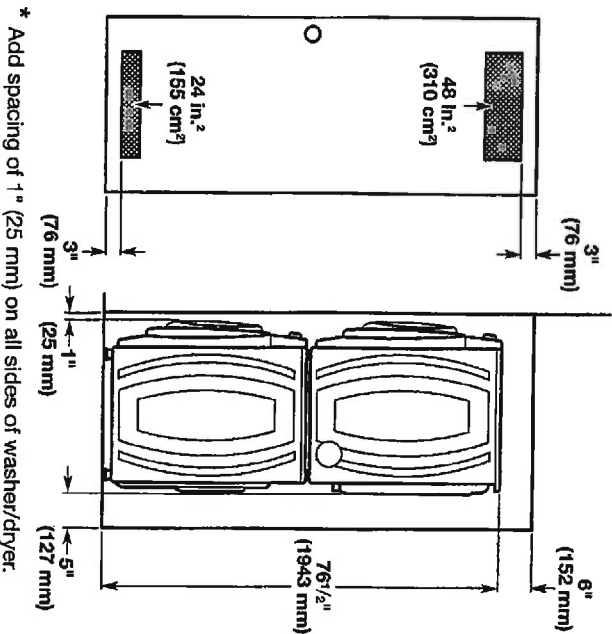

\* Add spacing of 1" (25 mm) on all sides of washer/dryer.

Recessed area or closet installation (washer only):

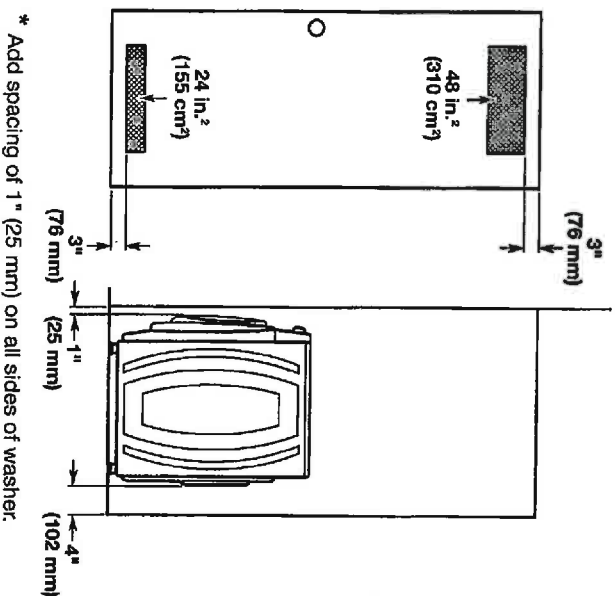

\* Add spacing of 1" (25 mm) on all sides of washer.

**I HAVE READ AND  
FULLY UNDERSTAND  
THIS LAYOUT/QUOTATION**

W10631156A  
04/2014

**CUSTOMER SIGNATURE**

LOT. 9  
RC

WASHER

**Custom cabinet installation (washer only):**

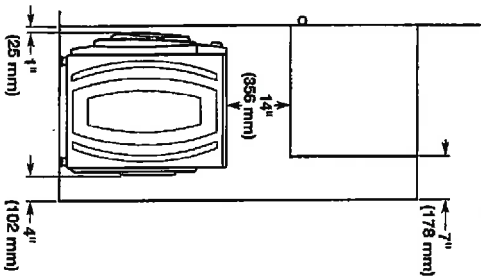

**Undercounter installation - washer only:**

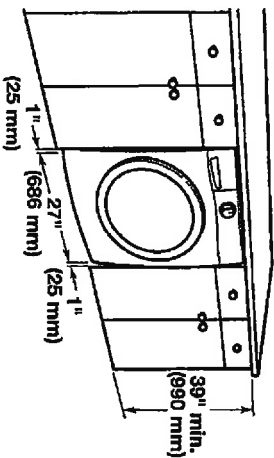

All dimensions show recommended spacing allowed, except for closet door ventilation openings which are the minimum required.

For each arrangement, consider allowing more space for ease of installation and servicing, and spacing for companion appliances and clearances for walls, doors, and floor moldings.

Space must be large enough to allow door to fully open. Add spacing of 1" (25 mm) on all sides of washer to reduce noise transfer; if a closet door or louvered door is installed, top and bottom air openings in door are required.

\*\* Recommended 4" (102 mm), minimum 1.5" (38 mm)

**ELECTRICAL REQUIREMENTS**

A 120 volt, 60 Hz., AC only, 15- or 20-amp, fused electrical supply is required. A time-delay fuse or circuit breaker is recommended. It is recommended that a separate circuit serving only this appliance be provided.

**DRAIN SYSTEM**

Drain system can be installed using a floor drain, wall standpipe, floor standpipe, or laundry tub. Select method you need.

**IMPORTANT:** To avoid siphoning, only 4.5" (114 mm) of drain hose should be inside standpipe. Always secure drain hose with cable tie.

**Floor standpipe drain system**

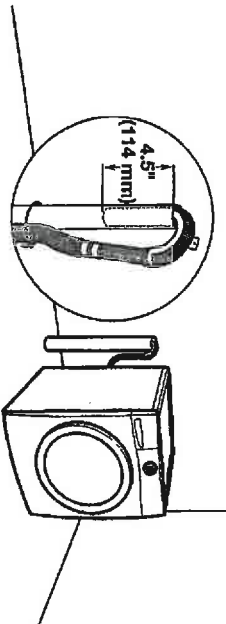

Minimum diameter for a standpipe drain: 2" (51 mm). Minimum carry-away capacity: 17 gal. (64 l) per minute. A 1/4" (6 mm) diameter to 1" (25 mm) diameter Standpipe Adapter Kit is available (Part Number 3363920). Top of standpipe must be at least 30" (762 mm) high; install no higher than 96" (2.44 m) from bottom of washer. If you have an overhead sewer and need to pump higher than 96" (2.44 m), a sump pump and associated hardware are needed. See "Alternate Parts".

**Wall standpipe drain system**

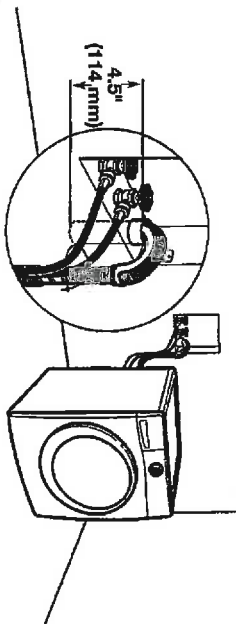

See requirements for floor standpipe drain system.

**Laundry tub drain system**

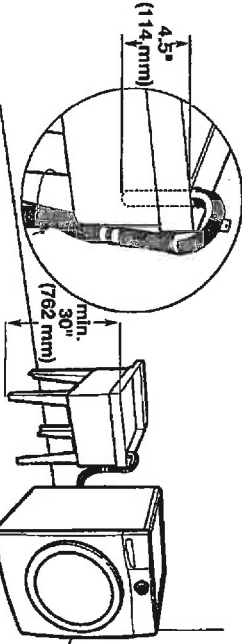

Minimum capacity: 20 gal. (76 l). Top of laundry tub must be at least 30" (762 mm) above floor; install no higher than 96" (2.44 m) from bottom of washer.

**Floor drain system**

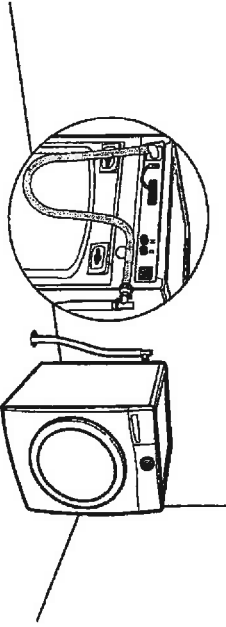

Floor drain system requires a Siphon Break Kit (Part Number 285834), 2 Connector Kits (Part Number 285835), and an Extension Drain Hose (Part Number 285863) that may be purchased separately. See "Alternate Parts". Minimum siphon break height: 28" (710 mm) from bottom of washer. (Additional hoses may be needed.)

Dimensions are for planning purposes only. For complete details, see installation instructions packed with product. Specifications subject to change without notice.

**I HAVE READ AND  
FULLY UNDERSTAND  
THIS LAYOUT/QUOTATION**

**CUSTOMER SIGNATURE**  
*WASHDL*

*LOT 9RC*

Because Whirlpool Corporation policy includes a continuous commitment to improve our products, we reserve the right to change materials and specifications without notice.