



## 36-INCH FRENCH DOOR BUILT-IN PANEL-READY

DRF365300AP



### PRODUCT FEATURES

- Full height door with true flush cabinet integration without exposed venting grille
- MetalCool™ Interior illuminated by 3DLighting™
- FreshZone™ Drawer with three customizable temperatures for Meat/Fish, chilled drinks and dairy
- Internal Water Dispenser for easy access to clean, filtered water

### DIMENSIONS & WEIGHT

APPLIANCE DIMENSIONS (H X W X D) (IN.)	83 3/8" X 35 3/4" X 23 13/16"
REQUIRED CUTOUT SIZE (HXWXD) (IN.)	84" X 36" X 25"
NET WEIGHT (LBS)	562 LBS.

### GENERAL PROPERTIES

PANEL READY	YES
INTERNAL WATER DISPENSER	YES
ICEMAKER	STANDARD ICE
DEODORIZING FILTER	YES
LIGHTING	3D LIGHTING™
INTERIOR MATERIAL	METALCOOL™ INTERIOR
FULL WIDTH SHELVES - REFRIGERATOR	2 EA
ADJUSTABLE SHELVES - REFRIGERATOR	2 EA
SHELF MATERIAL - REFRIGERATOR	TEMPERED GLASS SPILL-PROOF SHELVES
FULL EXTENSION DRAWERS AT 90° DOOR OPENING ANGLE	YES
FRESHZONE™ DRAWER	YES - CHEESE (37°F) / COLD DRINKS (33°F) / MEAT (29°F)
CRISPER DRAWERS	2 EA
DOOR BINS - REFRIGERATOR	6 EA
FREEZER DRAWERS	2 EA
DOOR OPEN ALARM	YES
SPECIAL MODES	SABBATH MODE

### CAPACITY

TOTAL UNIT GROSS CAPACITY (CU.FT.) - AHAM	21.3 CU. FT.
REFRIGERATOR GROSS CAPACITY (CU.FT.)	14.5 CU. FT.
FREEZER GROSS CAPACITY (CU.FT.)	6.8 CU. FT.

### PERFORMANCE

DOUBLE COOLING (2 EVAPORATORS, 1 COMPRESSOR)	YES
POWER COOL - REFRIGERATOR	YES
DEFROST PROCESS - FREEZER	YES
PRECISE COOLING	FROST-FREE
PRECISE COOLING	YES

### EFFICIENCY

ENERGY STAR® QUALIFIED	YES
ANNUAL ENERGY CONSUMPTION	549 KWH/YEAR

### TECHNICAL DETAILS

CURRENT (A)	6
VOLTS (V)	115
FREQUENCY (HZ)	60
POWER CORD LENGTH (IN.)	78 3/4"
PLUG TYPE	120 V, 3 PRONG

### TEMPERATURE RANGES

REFRIGERATOR	34°(1°) TO 44°(7°)
REFRIGERATOR - POWER COOL	34°(1°)
FRESHZONE™ DRAWER	37°(3°) / 33°(1°) / 29°(-1°)
FREEZER	5°(-15°) TO -8° (-23°)
FREEZER - POWER FREEZE	-8°(-23°)



## 36-INCH FRENCH DOOR BUILT-IN PANEL-READY

### APPLIANCE DIMENSIONS

A (WIDTH)	35 3/4" (908MM)
B (DEPTH)	25" (635MM)
C (HEIGHT)	83 3/8" (2118MM) - FRONT
D	35 5/8" (905MM)
E	44 7/8" (1140MM)
F	20 9/16" (496MM)
G	44" (1118MM)

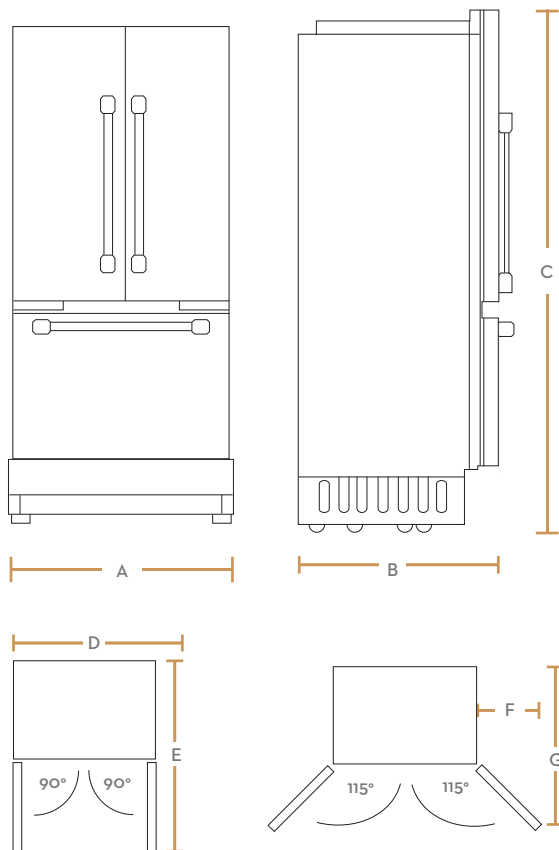

### INSTALLATION CUTOUT DIMENSIONS

A (WIDTH)	36" (914MM)
B (DEPTH)	25" (635MM)
C (HEIGHT)	84" (2134MM)
D	26" (660MM)
E	80" (2032MM)

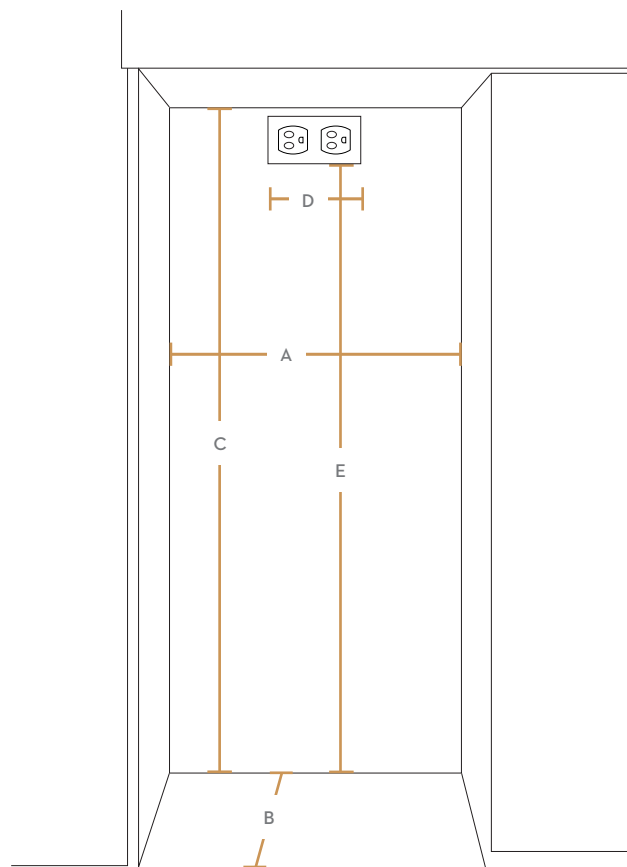

### ACCESSORIES

FRENCH-DOOR TRANSITIONAL REFRIGERATOR SILVER STAINLESS PANEL KIT: SILVER STAINLESS	RAF36ACAASR
FRENCH-DOOR REFRIGERATOR PRO PANEL KIT: SILVER STAINLESS	RAF36AHAASR
FRENCH-DOOR CONTEMPORARY REFRIGERATOR GRAPHITE PANEL KIT: GRAPHITE STAINLESS	RAF36AMAAMS
<b>FRENCH-DOOR CONTEMPORARY REFRIGERATOR SILVER STAINLESS PANEL KIT: SILVER STAINLESS</b>	<b>RAF36AMAASR</b>
FRENCH-DOOR REFRIGERATOR EPICURE PANEL KIT: SILVER STAINLESS	RAF36AEAASR
WATER FILTER	RAC00WFAAAA
DEODORIZING FILTER	RAC00DFAAAA

### WARRANTY

LIMITED, ENTIRE APPLIANCE, PARTS AND LABOR ON ANY PART OF THE REFRIGERATOR	2 YEAR
LIMITED WARRANTY FOR SEALED REFRIGERATION SYSTEM; PARTS AND LABOR	3RD TO 6TH YEAR
LIMITED WARRANTY FOR SEALED REFRIGERATION SYSTEM; PARTS ONLY	7TH TO 12TH YEAR
LIMITED WARRANTY FOR COMPRESSOR; PARTS ONLY	13TH TO 15TH YEAR



## 30-INCH PRO ALL-GAS RANGE

HGR30 | HERITAGE COLLECTION



### AVAILABLE MODELS

HGR30PS/NG/H	30" Heritage All Gas Pro Range - Stainless Steel Natural Gas High Altitude
HGR30PS/NG	30" Heritage All Gas Pro Range - Stainless Steel Natural Gas
HGR30PS/LP/H	30" Heritage All Gas Pro Range - Stainless Steel Liquid Propane High Altitude
HGR30PS/LP	30" Heritage All Gas Pro Range - Stainless Steel Liquid Propane

### FEATURES & BENEFITS

- > 18K BTU SimmerSear™ Aluminum Burner
- > 4 Dual-Stack Sealed Burners
- > Illumina™ Knobs - White LED
- > Smart Flame™
- > Large Oven Capacity - 5.2 cu. ft.
- > 3-Part Convection System - air baffle, fan and removable convection filter to precisely distribute heat for superior cooking results
- > Continuous Grates
- > Downdraft Compatible

### ADDITIONAL FEATURES

TYPE OF GRATE	CONTINUOUS CAST IRON
CAVITY	BLACK ENAMEL COATING
OVEN RACK POSITIONS	6
LIGHTING	LED & HALOGEN

### WARRANTY

LIMITED, PARTS AND LABOR	1 YEAR
--------------------------	--------

### ACCESSORIES (INCLUDED)

GLIDERACK™	1
STANDARD RACK	1
REMOVABLE CONVECTION FILTER	1
BLACK PORCELAIN BURNER CAPS	4/EA

### ACCESSORIES (OPTIONAL)

COOKIE SHEETS (SET OF 3)	ACSRO303
REMOVABLE NON-STICK GRIDDLE	ADRT14
BROIL/ROASTING PAN W/GRILL & V RACK	AORPVR
STAINLESS STEEL BACKGUARD 6"	AHB30G6
STAINLESS STEEL BACKGUARD 9"	AHB30G9
30" RANGE EPICURE HANDLE SET	AHHESR30

### GENERAL PROPERTIES

OVEN CAPACITY (CUBIC FEET)	5.2
COOKING MODES	CONVECTION BAKE; BAKE; CONVECTION BROIL; BROIL

### OVEN PERFORMANCE

HIDDEN STAINLESS STEEL BAKE BURNER	24,000 BTU
INFRARED CERAMIC BROIL GAS BURNER	18,000 BTU

### BURNER PERFORMANCE

TOTAL NUMBER OF COOKTOP BURNERS	4 DUAL STACK ALUMINUM BURNERS
LEFT FRONT (BTU)	18,000 DUAL (SIMMER/SEAR)
LEFT REAR (BTU)	9,500 STACK DUAL (SIMMER)
RIGHT FRONT (BTU)	15,000 STACK DUAL (SIMMER)
RIGHT REAR (BTU)	15,000 STACK DUAL (SIMMER)
SEALED BURNERS	YES
PERMA-FLAME™ (AUTO RE-IGNITION)	YES
SMART FLAME™	YES

### CONTROL FEATURES

LED (WHITE)	YES
NUMBER OF KNOBS	5 KNOBS
OVEN CONTROL METHOD	KNOBS
ILLUMINA™ BURNER KNOBS	YES
HIGHLIGHTING COLOR	WHITE
TEMPERATURE (F/C)	YES

### TECHNICAL DETAILS

CIRCUIT BREAKER (A)	15 AMPS
VOLTS (V)	120 VAC
FREQUENCY (HZ)	60 HZ
ENERGY SOURCE	GAS AND ELECTRICAL
PLUG TYPE	GROUNDING, DEDICATED, 3-PRONG ELECTRICAL OUTLET
GAS TYPES	NATURAL GAS NATURAL GAS (HIGH ALTITUDE) LIQUID PROPANE LIQUID PROPANE (HIGH ALTITUDE)

### DIMENSIONS & WEIGHT

APPLIANCE DIMENSIONS (H X W X D) (IN.)	35" - 37 1/8" X 29 7/8" X 26 7/8"
REQUIRED CUTOUT SIZE (W X D) (IN.)	30" X 24"

# dacor

## 30-INCH PRO ALL-GAS RANGE

### APPLIANCE DIMENSIONS

30"

A (WIDTH)	29 7/8" (75.9CM)
B (DEPTH)	26 7/8" (68.3CM)
C (HEIGHT)	35" TO 37 1/8" (88.9 - 94.3CM)

Product tolerances:  $\pm 1/16"$  ( $\pm 1.6$ MM)

### CABINET CUT-OUT DIMENSIONS

RANGE MODEL

F

G

HGR30

36" (91.4 CM)\*  
30" (76.2 CM)\*\*

30"  
(91.4 CM)\*\*

\* Recommended

\*\* Minimum

Cutout tolerances:  $\pm 1/16"$  ( $\pm 1.6$  mm), -0 unless otherwise stated

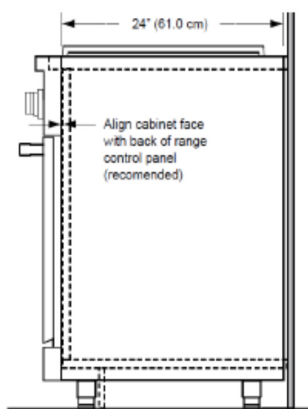
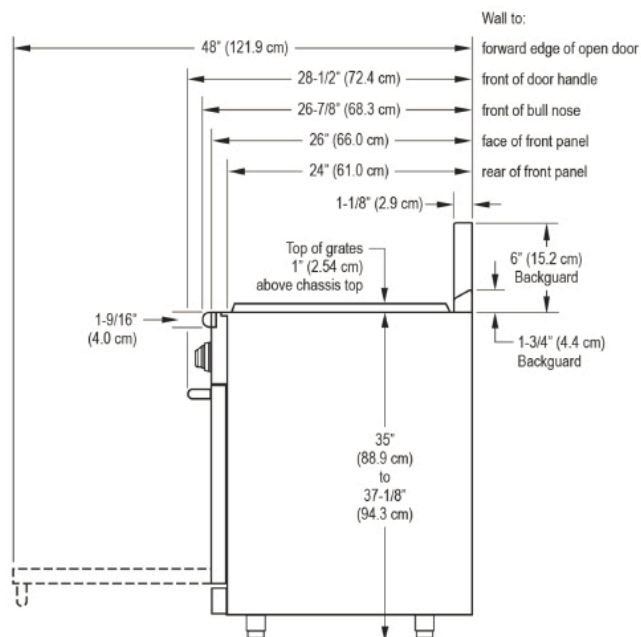

View of Range Installed  
(Side View)

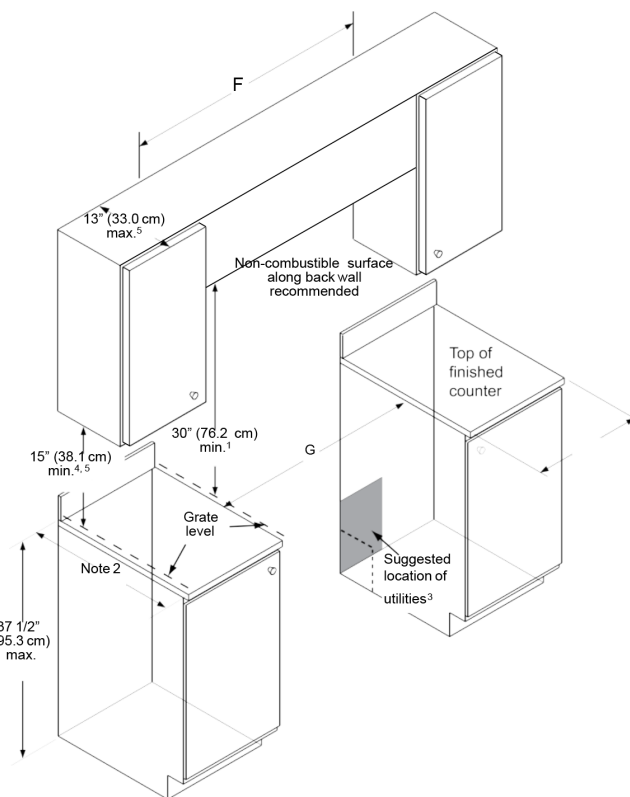

# 24" Pocket Handle Dishwasher

500 Series – Stainless Steel SHPM65W55N



**BOSCH**  
Invented for life



**SHPM65W55N**  
Stainless Steel

**The flexible 3rd rack allows you to accommodate deeper items, while adjustable tines let you customize the rack's loading space.**

## Features & Benefits

44 dBA: dishwasher runs quietly so your kitchen conversations aren't interrupted.

RackMatic® middle rack maximizes capacity by offering 3 height levels, for 9 possible rack positions.

The EasyGlide™ rack system provides a smooth glide for easier loading & unloading on the upper rack.

The AquaStop® leak protection system contains leaks through a precisely engineered system, giving you the ultimate peace of mind whether you are away or at home.

## General Properties

Number of wash cycles	5
Number of options	5
dBA	44
Drying system	PureDry®
Third rack	Flexible 3rd Rack
Rack adjustability	Rackmatic®
Tub material	Stainless Steel
Control type	Buttons
Concealed heating element	Yes
Leak protection system	24/7 AquaStop®
NSF®-certified* sanitize option	Yes
Water softener	No
Five-level wash	Yes
ChildLock	No
Special features	InfoLight®, Extra Dry Option

## Efficiency

Water usage per cycle	2.9
ENERGY STAR® certified	No
Total annual energy consumption (kWh)	269
Total annual water consumption (g)	623.5

## Capacity

Number of place settings	16
--------------------------	----

## Technical Details

Watts (W)	1440 W
Current (A)	12 Amps
Volts (V)	120 V
Frequency (Hz)	60 Hz
Power cord full length	67"
Power cord install length from edge of unit when facing the door (in)**	Left – 45" Right – 56"
Minimum water pressure (lb/sin)	14
Length outlet hose (in)	79"

## Dimensions & Weight

Overall appliance dimensions (HxWxD) (in)	33 7/8" x 23 9/16" x 23 3/4"
Required cutout size (HxWxD) (in)	33 7/8" x 23 5/8" x 24"
Adjustable feet	Yes
Net weight (lbs)	91 lbs

## Accessories—Optional

Junction Box	SMZPCJB1UC
Bosch Dishwasher Water Supply Hose	SMZSH002UC
Drain Hose Extension Kit	SGZ1010UC
Dishwasher Accessory Kit	SMZ5000
Anti-Tarnish Silverware Cassette	SMZ5002UC
Edge Protector + Power Cord Clip Install Kit	SMZEPCC1UC

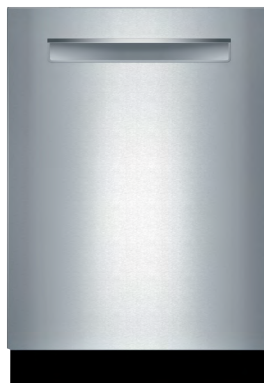

\*Certification to NSF/ANSI Standard 184 for residential dishwashers.

\*\*September 2020 running production change to remove adhesive routing clips for power cord. These clips and the edge protector are now included in the dishwasher accessory kit # SMZEPCC1UC.

**Accessories:** To purchase Bosch accessories, cleaners & parts please visit [www.bosch-home.com/us/store](http://www.bosch-home.com/us/store) or call 1-800-944-2904 (Mon to Fri 5 am to 6 pm PST, Sat 6 am to 3 pm PST).

**Notes:** All height, width and depth dimensions are shown in inches. BSH reserves the absolute and unrestricted right to change product materials and specifications, at any time, without notice. Consult the product's installation instructions for final dimensional data and other details prior to making cutout.

**Warranties:** Please see Use & Care manual or Bosch website for statement of limited warranty.

**For more information on our entire line of products, go to [www.bosch-home.ca](http://www.bosch-home.ca) or [www.bosch-home.com/us](http://www.bosch-home.com/us) or call 1-800-944-2904**

© BSH Home Appliances Corporation. All rights reserved. Bosch is a registered trademark of Robert Bosch GmbH.

7/23 CA & COSTCO

# 24" Pocket Handle Dishwasher

500 Series – Stainless Steel SHPM65W55N



**BOSCH**

Invented for life

## Installation Details

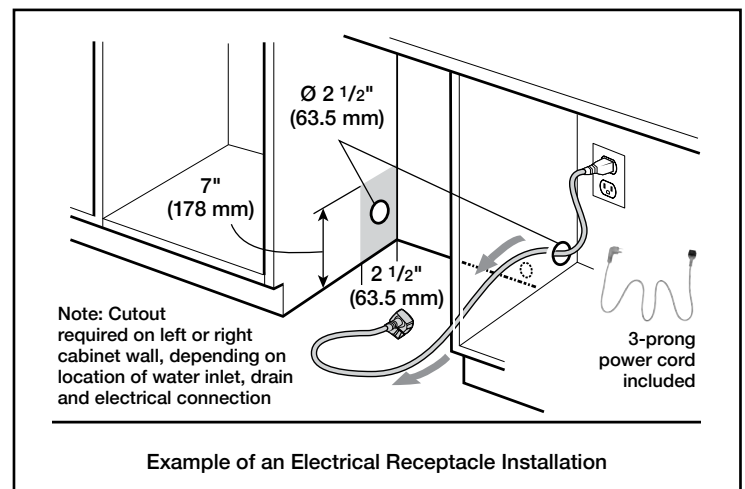
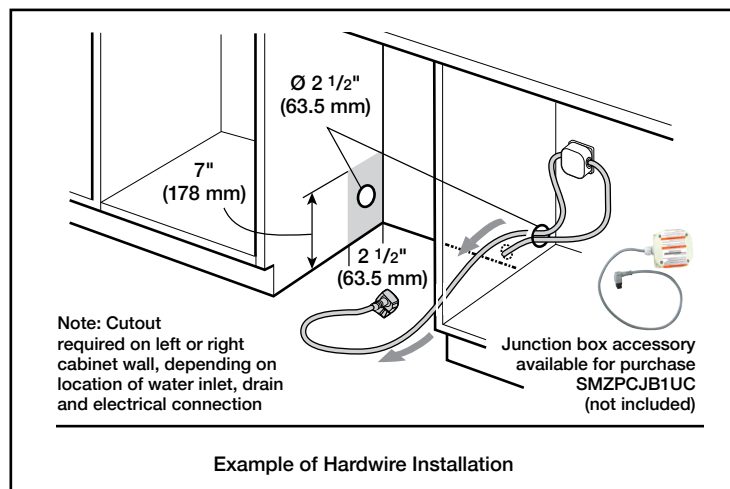
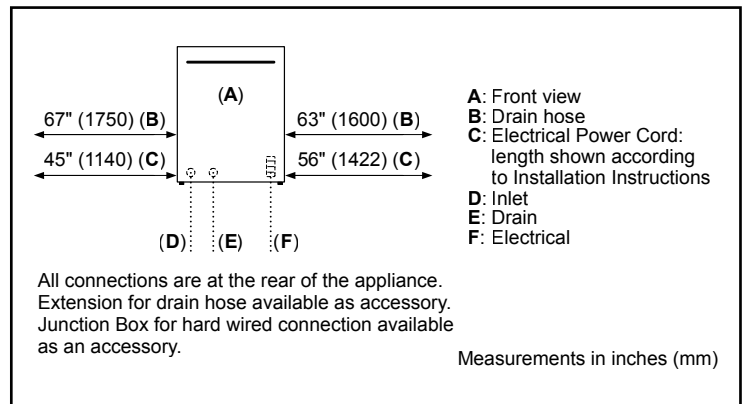
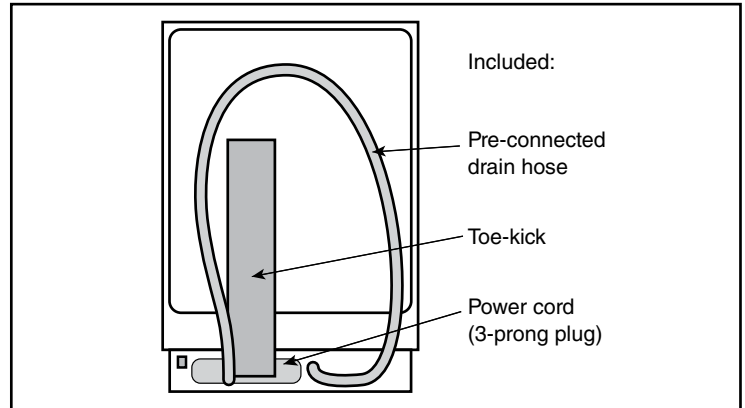
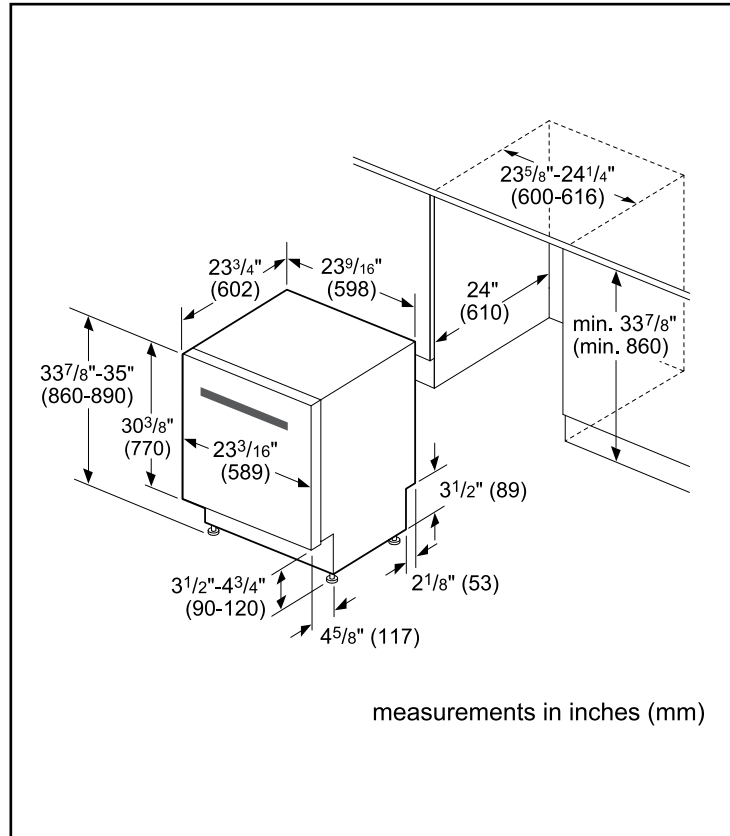

**Accessories:** To purchase Bosch accessories, cleaners & parts please visit [www.bosch-home.com/us/store](http://www.bosch-home.com/us/store) or call 1-800-944-2904 (Mon to Fri 5 am to 6 pm PST, Sat 6 am to 3 pm PST).

**Notes:** All height, width and depth dimensions are shown in inches. BSH reserves the absolute and unrestricted right to change product materials and specifications, at any time, without notice. Consult the product's installation instructions for final dimensional data and other details prior to making cutout.

**Warranties:** Please see Use & Care manual or Bosch website for statement of limited warranty.

**For more information on our entire line of products, go to [www.bosch-home.ca](http://www.bosch-home.ca) or [www.bosch-home.com/us](http://www.bosch-home.com/us) or call 1-800-944-2904**

© BSH Home Appliances Corporation. All rights reserved. Bosch is a registered trademark of Robert Bosch GmbH.

7/23 CA & COSTCO

# 24" Pocket Handle Dishwasher

500 Series – Stainless Steel SHPM65W55N



**BOSCH**  
Invented for life

## Installation Details

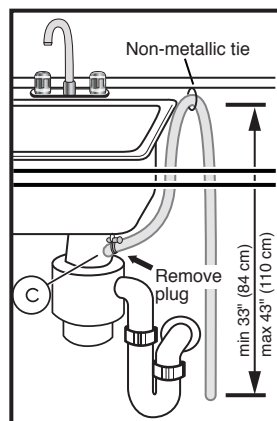
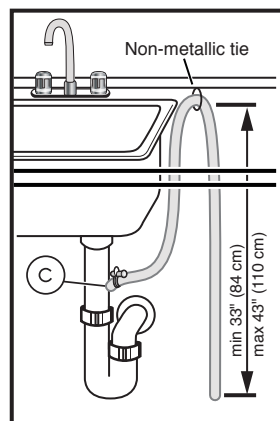

Note: Plumbing installations will vary - refer to local codes. Drain hose included is 79" (201 cm) and can be extended to a maximum of 155 3/4" (396 cm).

Always use the approved drain hose extension kit (SGZ1010UC).

Ensure a portion of the drain hose is raised between min. 33" (84 cm) and max. 43" (110 cm) above the cabinet floor.

**Accessories:** To purchase Bosch accessories, cleaners & parts please visit [www.bosch-home.com/us/store](http://www.bosch-home.com/us/store) or call 1-800-944-2904 (Mon to Fri 5 am to 6 pm PST, Sat 6 am to 3 pm PST).

**Notes:** All height, width and depth dimensions are shown in inches. BSH reserves the absolute and unrestricted right to change product materials and specifications, at any time, without notice. Consult the product's installation instructions for final dimensional data and other details prior to making cutout.

**Warranties:** Please see Use & Care manual or Bosch website for statement of limited warranty.

**For more information on our entire line of products, go to [www.bosch-home.ca](http://www.bosch-home.ca) or [www.bosch-home.com/us](http://www.bosch-home.com/us) or call 1-800-944-2904**

© BSH Home Appliances Corporation. All rights reserved. Bosch is a registered trademark of Robert Bosch GmbH.

7/23 CA & COSTCO

# Electrolux



## Front Load Washer

5.2 Cu. Ft. I.E.C Front Load Washer

ELFW7637AT, ELFW7637AW

Available Colors : Titanium, White

Version : 06/21

### Washer

Drum Light	Yes
Drum Material	Stainless Steel
Maximum Spin Speed	1,300 RPM
Water Heater	Yes
Water Level Adjustment	Yes

### Washer Cycles

Activewear	Yes
Clean Washer	Yes
Colors	Yes
Cycle Count	11
Delicates	Yes
Fast Wash	Yes
Hand Wash	Yes
Heavy Duty	Yes
Normal	Yes
Optic Whites	Yes
Rinse and Spin	Yes
Towels	Yes
Allergen	Yes

### Washer Options

Delay Start Time	1-12 Hours
Extended Refresh	Yes
Extra Rinse	Yes
Perfect Steam	Yes
Pure Rinse	Yes
Stain Soak	Yes
Steam	Yes

### Soil Levels

Extra Light	Yes
Light	Yes
Normal	Yes
Heavy	Yes

Solid Soil	Yes
------------	-----

### Temperature Settings

Eco Cold	Yes
Cool	Yes
Warm	Yes
Hot	Yes
Sanitize	Yes

### Washer Spin Speeds

Spin Speed Selections	5
Max	Yes
High	Yes
Medium	Yes
Low	Yes
No Spin	Yes

### Controls

Cancel	Yes
Cycle Status Lights	Yes
Delay Start	Yes
Control Lock	Yes
Pause Function	Yes
Power On/Off	Yes
Start	Yes

### Dispenser

Bleach Dispenser	Yes
Detergent Dispenser	Yes
Fabric Softener Dispenser	Yes
Prewash Detergent Dispenser	Yes
PODs Dispenser	Yes

### Exterior

Door Latch	Yes
Reversible Door	Yes

High standards of quality at Electrolux Home Products, Inc. mean we are constantly working to improve our products. We reserve the right to change specifications or discontinue models without notice.

Electrolux Major Appliances, N.A.

USA • 10200 David Taylor Drive • Charlotte, NC 28262 • Charlotte, NC 28262 • 1-877-4electrolux (1-877-435-3287) • [electroluxappliances.com](http://electroluxappliances.com)

CANADA • 5855 Terry Fox Way • Mississauga, ON L5V 3E4 • 1-800-265-8352 • [electroluxappliances.ca](http://electroluxappliances.ca)



5.2 Cu. Ft. I.E.C Front Load Washer

ELFW7637AT, ELFW7637AW

Version : 06/21

## Dimensions and Volume

Height	38"
Width	27"
Depth	32"
Washer Drum Capacity I.E.C.	5.2 Cu. Ft.

## Electrical Specifications

Minimum Circuit Required	15 Amps
Voltage Rating	120 V

## Energy Data

Integrated Water Factor	3.2
kWh/year	85 kWh
Modified Energy Factor	2.92
Water Usage/Year	4,248 Gallons

## Installation

Optional Pedestal	Yes
Stackable	Yes

## General Specifications

Chime On / Chime Off	Yes
Leveling Legs	Yes
Product Weight	217 lbs
Prop 65 Label	No
Warranty - Labor	1 Year
Warranty - Parts	1 Year

## Performance Certifications and Approvals

CEE Tier	Tier 2
ENERGY STAR Certified	Yes
ENERGY STAR Most Efficient	Yes
High Efficiency	Yes

## Safety Certifications and Approvals

UL Listed	Yes
NSF Certified	Yes
Sanitization and Allergy Reduction	Yes

High standards of quality at Electrolux Home Products, Inc. mean we are constantly working to improve our products. We reserve the right to change specifications or discontinue models without notice.

Electrolux Major Appliances, N.A.

USA • 10200 David Taylor Drive • Charlotte, NC 28262 • Charlotte, NC 28262 • 1-877-4electrolux (1-877-435-3287) • [electroluxappliances.com](http://electroluxappliances.com)

CANADA • 5855 Terry Fox Way • Mississauga, ON L5V 3E4 • 1-800-265-8352 • [electroluxappliances.ca](http://electroluxappliances.ca)

5.2 Cu. Ft. I.E.C Front Load Washer

ELFW7637AT, ELFW7637AW

Version : 06/21

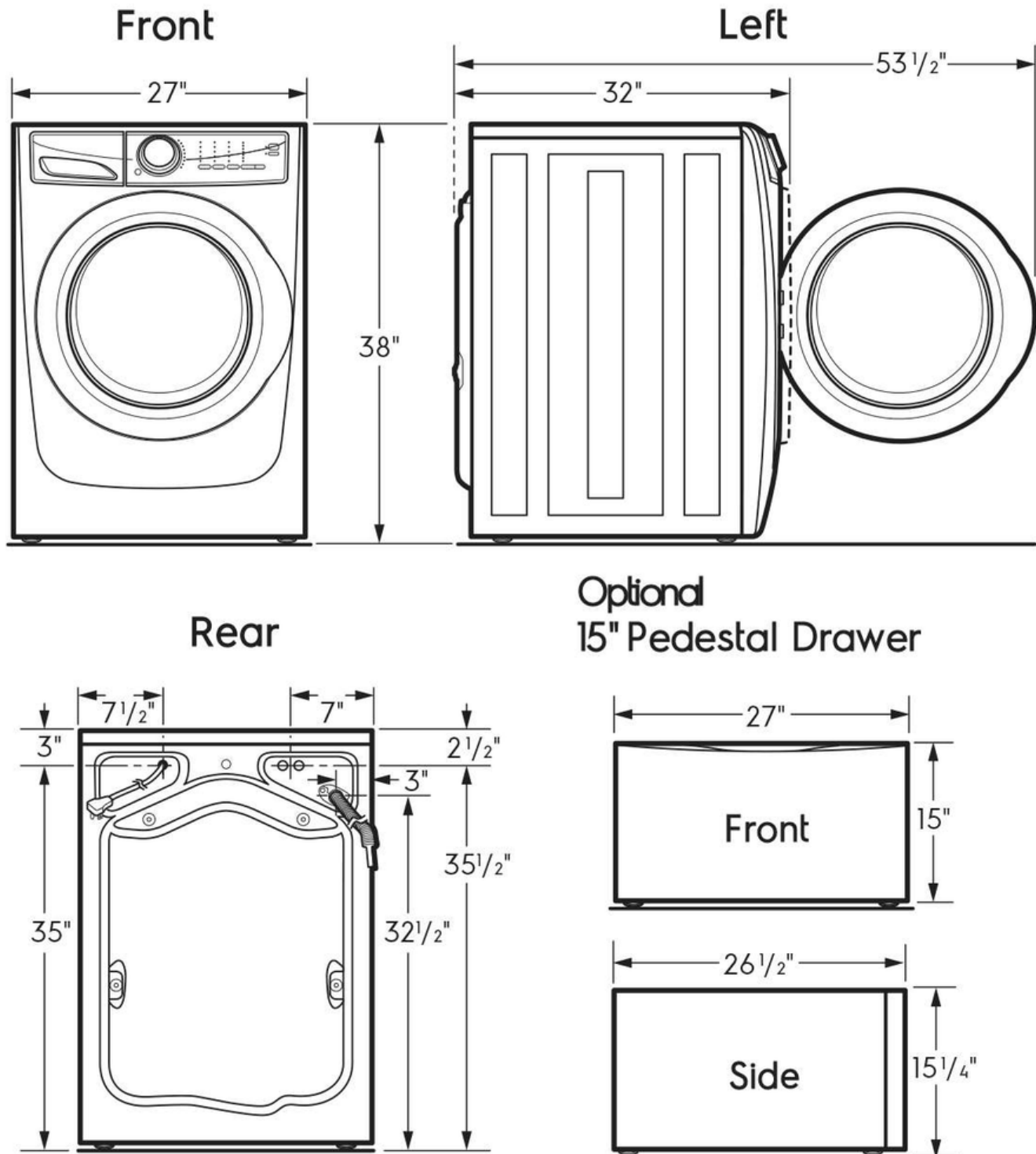

High standards of quality at Electrolux Home Products, Inc. mean we are constantly working to improve our products. We reserve the right to change specifications or discontinue models without notice.

Electrolux Major Appliances, N.A.

USA • 10200 David Taylor Drive • Charlotte, NC 28262 • Charlotte, NC 28262 • 1-877-4electrolux (1-877-435-3287) • [electroluxappliances.com](http://electroluxappliances.com)

CANADA • 5855 Terry Fox Way • Mississauga, ON L5V 3E4 • 1-800-265-8352 • [electroluxappliances.ca](http://electroluxappliances.ca)

# Electrolux



## Dryer

Electric 8.0 Cu. Ft. Front Load Dryer

ELFE763CAT, ELFE763CAW

Available Colors : Titanium, White

Version : 07/21

## Dryer

Air Flow	200 CFM
Balanced Dry	Yes
Drum Back Type	Painted Steel
Drum Material	Stainless Steel
Dryness Level Selections	Yes
Lint Filter	Yes
Predictive Dry	No

## Dryer Cycles

Cycle Count	11
Activewear	Yes
Air Dry	Yes
Allergen	Yes
Delicates	Yes
Fast Dry	Yes
Heavy Duty	Yes
Instant Refresh	Yes
Mixed Load	Yes
Normal	Yes
Timed Dry Time	Yes
Towels	Yes

## Dryer Options

Anti Static	Yes
Delay Start Time	1-12 Hours
Drum Light	Yes
Dry Boost	Yes
Extended Tumble	Yes
Perfect Steam	Yes
Wrinkle Release	Yes

## Drying Temperatures

Low	Yes
Normal	Yes
High	Yes

Sanitize	Yes
Eco Dry	Yes

## Dryness Level

Max	Yes
High	Yes
Normal	Yes
Low	Yes
Damp	Yes

## Controls

Cancel	Yes
Cycle Status Lights	Yes
Delay Start	Yes
Estimated Time Remaining	Yes
Control Lock	Yes
Pause Function	Yes
Power On/Off	Yes
Start	Yes

## Exterior

Door Latch	Yes
Reversible Door	Yes

## Dimensions and Volume

Height	38"
Width	27"
Depth	32"
Dryer Drum Capacity	8 Cu. Ft.

## Electrical Specifications

Minimum Circuit Required	30 Amps
Voltage Rating	208/240v

## Energy Data

kWh/cycle	2.5 kWh
-----------	---------

High standards of quality at Electrolux Home Products, Inc. mean we are constantly working to improve our products. We reserve the right to change specifications or discontinue models without notice.

Electrolux Major Appliances, N.A.

USA • 10200 David Taylor Drive • Charlotte, NC 28262 • Charlotte, NC 28262 • 1-877-4electrolux (1-877-435-3287) • [electroluxappliances.com](http://electroluxappliances.com)

CANADA • 5855 Terry Fox Way • Mississauga, ON L5V 3E4 • 1-800-265-8352 • [electroluxappliances.ca](http://electroluxappliances.ca)

Electric 8.0 Cu. Ft. Front Load Dryer

ELFE763CAT, ELFE763CAW

Version : 07/21

kWh/year	710 kWh
----------	---------

## Installation

Optional Pedestal	Yes
-------------------	-----

## General Specifications

Chime On / Chime Off	Yes
----------------------	-----

Leveling Legs	Yes
---------------	-----

Product Weight	126 lbs
----------------	---------

Prop 65 Label	No
---------------	----

Warranty - Labor	1 Year
------------------	--------

Warranty - Parts	1 Year
------------------	--------

## Performance Certifications and Approvals

ENERGY STAR Certified	Yes
-----------------------	-----

## Safety Certifications and Approvals

UL Listed	Yes
-----------	-----

High standards of quality at Electrolux Home Products, Inc. mean we are constantly working to improve our products. We reserve the right to change specifications or discontinue models without notice.

Electrolux Major Appliances, N.A.

USA • 10200 David Taylor Drive • Charlotte, NC 28262 • Charlotte, NC 28262 • 1-877-4electrolux (1-877-435-3287) • [electroluxappliances.com](http://electroluxappliances.com)

CANADA • 5855 Terry Fox Way • Mississauga, ON L5V 3E4 • 1-800-265-8352 • [electroluxappliances.ca](http://electroluxappliances.ca)

# Electrolux

Electric 8.0 Cu. Ft. Front Load Dryer

ELFE763CAT, ELFE763CAW

Version : 07/21

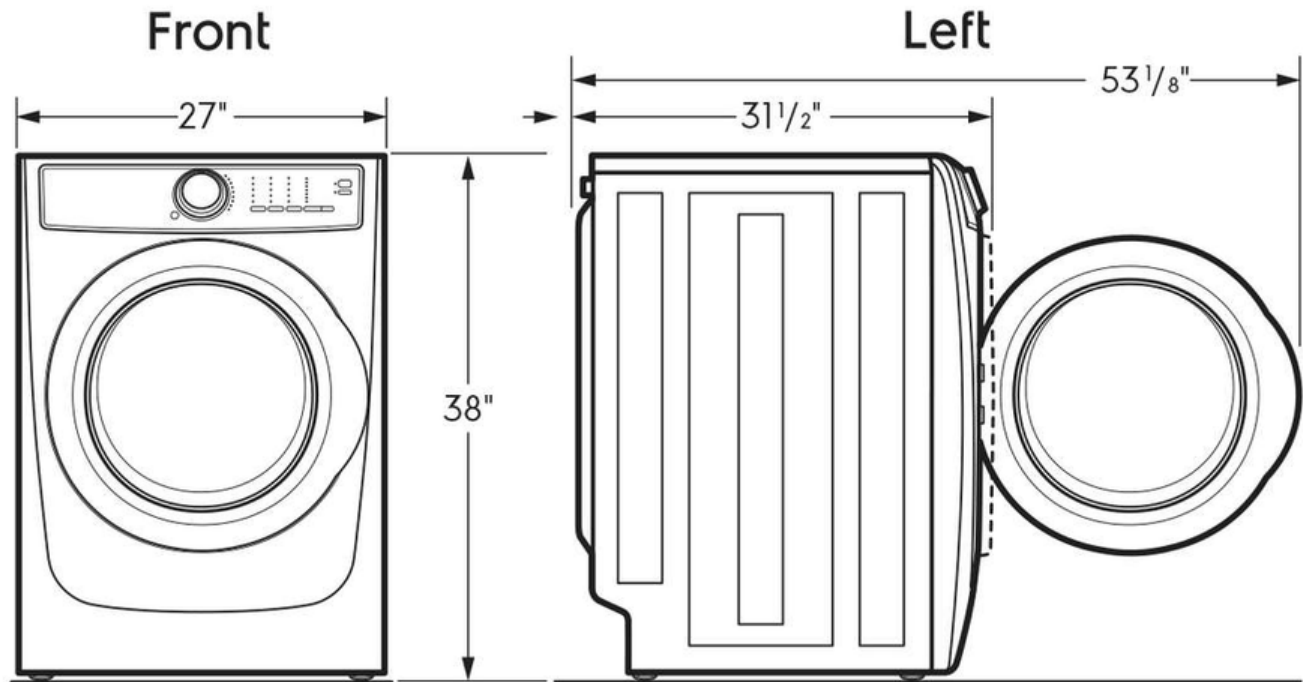

## Optional 15" Pedestal Drawer

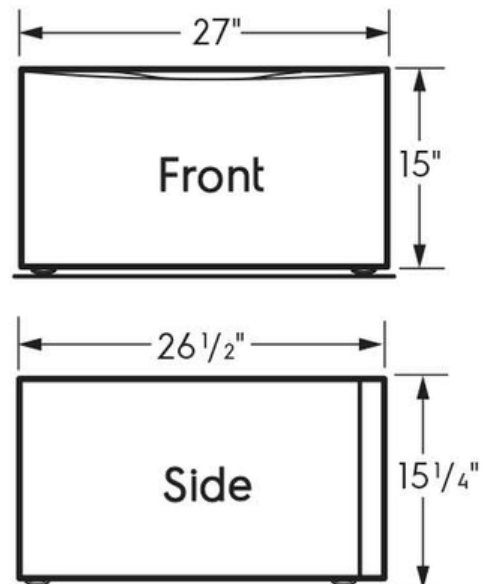
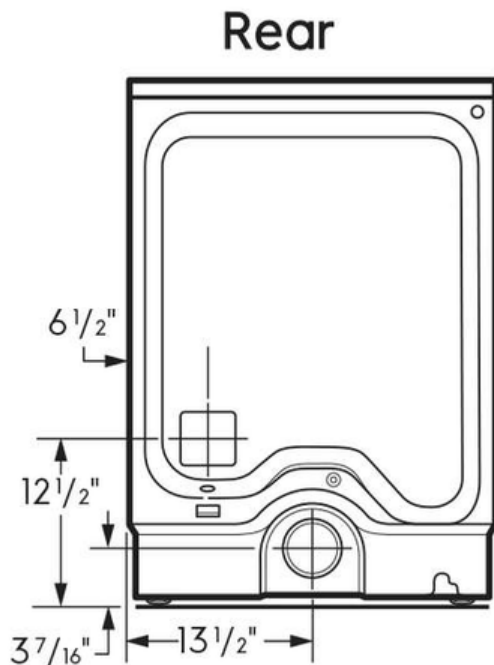

High standards of quality at Electrolux Home Products, Inc. mean we are constantly working to improve our products. We reserve the right to change specifications or discontinue models without notice.

Electrolux Major Appliances, N.A.

USA • 10200 David Taylor Drive • Charlotte, NC 28262 • Charlotte, NC 28262 • 1-877-4electrolux (1-877-435-3287) • [electroluxappliances.com](http://electroluxappliances.com)

CANADA • 5855 Terry Fox Way • Mississauga, ON L5V 3E4 • 1-800-265-8352 • [electroluxappliances.ca](http://electroluxappliances.ca)