



CONSTRUCTION SUMMARY

Joshua Creek - 68      BAYSHIRE (44-03) B

Registere Plan Number:    Municipal Address:    Closing: 20-Oct-23

BONUS

Inv.488 30 Line 9906  13Dec22 / 30Dec22	1 - BONUS PACKAGE: \$5,000.00 WORTH OF UPGRADES FROM VALERY HOMES DÉCOR CENTRE IS BEING APPLIED TOWARD THE STRUCTURAL APPOINTMENT  Note:
---	--

CABINETRY

Inv.573 132   Line 11586  28Feb24 / 1Mar24	1 - KITCHEN/ VANITY HARDWARE: UPGRADE 2 HARDWARE THROUGHOUT HOUSE. INCLUDES STACKED AND WET BAR AREAS  HARDWARE ON MAIN FLOOR- INCL. POWDER RM AND MUDROOM, KITCHEN, SERVERY AND WET BAR: 12817SB GOLD BASMNT BATH, MASTER, ENSUITE 2, 5 AND SHARED: 12817BN  Note: LAUNDRY ALSO IN BRUSHED NICKEL
Inv.618 143  Line 12305  7May24 / 13May24	4 - **CORRECTION TO PE #573, ITEM 108**  THE WINDOW IN THE KITCHEN WILL NOT ALLOW FOR STACKED CABINETS TO BE BUILT ABOVE. WE ARE RETURNING 4 GLASS DOORS  Note:
Inv.618 146 Line 12306  7May24 / 13May24	1 - KITCHEN: INSTALL AN ARCHED WINDOW VALANCE (J15)  Note:
Inv.618 147 Line 12307  7May24 / 13May24	1 - **DELETE** FROM PE #573, ITEM 111  KITCHEN: INSTALL FRIDGE ENCLOSURE (H04)  Note:
Inv.618 148 Line 12308  7May24 / 13May24	1 - **DELETE** FROM PE #573, ITEM 112  KITCHEN: INSTALL FRIDGE VALANCE  Note:
Inv.618 149 Line 12309  7May24 / 13May24	1 - KITCHEN: ACCOMODATE FOR BUILT IN FRIDGE, PROUD INSTALLATION (H06)  Note:



CONSTRUCTION SUMMARY

Joshua Creek - 68      BAYSHIRE (44-03) B

Register Plan Number:    Municipal Address:    Closing: 20-Oct-23

Inv.618 150  Line 12310  7May24 / 13May24	1 - **DELETE** FROM PE #573, ITEM 117  KITCHEN: TIP OUT TRAY AT SINK  THERE WILL NO BE ENOUGH SPACE TO FUNCTION WHEN QUARTZ IS INSTALLED  Note:
Inv.618 151  Line 12311  7May24 / 13May24	1 - KITCHEN: INSTALL DUMMY DRAWER AT KITCHEN SINK (B06)  Note:
Inv.618 152  Line 12312  7May24 / 13May24	1 - **NOTE** FROM PE #573, ITEM 116  THE LE MANS CORNER SYSTEM WILL NOT HAVE A FUNCTIONING DRAWER, BUT A DUMMY DRAWER  Note:
Inv.618 156  Line 12313  7May24 / 13May24	1 - NOTE THAT KITCHEN WINDOW WAS NARROWER THAN ANTICIPATED AND CABINETS AROUND WINDOW INCREASED IN WIDTH BY APPROX. 8". THERE IS NO ADDITIONAL CHARGE TO PURCHASER  Note:
Inv.618 157  Line 12314  7May24 / 13May24	1 - LAUNDRY ROOM: INSTALL OPTIONAL LAUNDRY ROOM UPPER CABINETS  Note:
Inv.618 158  Line 12315  7May24 / 13May24	1 - **DELETE** FROM PE #573, ITEM 121  MUD ROOM: DELETE BEADBOARD ABOVE BENCH  Note:
Inv.618 144  Line 12319  7May24 / 13May24	40 - **PRICE CORRECTION TO PE #573, ITEM 106**  DELETE ITEM 106 ON PE 573 : STACKED CABINETS (A03)  Note:
Inv.618 160  Line 12320  7May24 / 13May24	7 - KITCHEN: INSTALL 30CM CABINETS ON THE BACK OF THE KITCHEN ISLAND (B20)  Note:



CONSTRUCTION SUMMARY

Joshua Creek - 68      BAYSHIRE (44-03) B

Registere Plan Number:    Municipal Address:    Closing: 20-Oct-23

Inv.618 153 Line 12321 7May24 / 13May24	1 - **DELETE** FROM PE #573, ITEM 118  KITCHEN: REMOVE 1 TOP DRAWER  Note:
Inv.618 154 Line 12322 7May24 / 13May24	1 - **DELETE** FROM PE #597, ITEM 139  KITCHEN: REMOVE SOFT CLOSE FROM 1 TOP DRAWER IN KITCHEN  Note:
Inv.618 155 Line 12323 7May24 / 13May24	1 - KITCHEN: INSTALL ONE DUMMY DRAWER AT LA MANS CORNER  Note:
Inv.618 145 Line 12328 7May24 / 13May24	30 - KITCHEN: INSTALL EXTENDED STACKED UPPERS (A03) AMOUNT WAS REDUCED BECAUSE THE WINDOW IN THE KITCHEN WILL NOT ALLOW FOR STACKED CABINETS TO BE BUILT ABOVE. WE ARE RETURNING 4 FEET OF STACKED UPPERS  Note:
Inv.618 161 Line 12329 7May24 / 13May24	1 - DELETE: ITEM #68 ON PE 573  LAUNDRY ROOM: *IN NEW AREA*: INSTALL LEVEL 6 UPPER CABINETS THROUGHOUT LAUNDRY ROOM (A2)  Note:
Inv.618 162 Line 12330 7May24 / 13May24	1 - DELETE: ITEM #69 ON PE 573  LAUNDRY ROOM: *IN NEW AREA*: INSTALL LEVEL 6 BASE CABINETS THROUGHOUT LAUNDRY ROOM (A2)  Note:
Inv.573 106 Line 11558 28Feb24 / 1Mar24	40 - KITCHEN - SERVERY - WET BAR: INSTALL STACKED CABINETS THROUGHOUT. (A03)  Note:
Inv.573 107 Line 11559 28Feb24 / 1Mar24	1 - KITCHEN: INSTALL DEEP STACKED CABINETS (A04)  Note:



CONSTRUCTION SUMMARY

Joshua Creek - 68      BAYSHIRE (44-03) B

Registere Plan Number:    Municipal Address:    Closing: 20-Oct-23

Inv.573 108	37 - KITCHEN: INSTALL 37 CLEAR GLASS CABINETS THROUGHT STACKED CABINETS, INCLUDING 4 DOORS IN KITCHEN, 4 DOORS IN SERVERY, 4 DOORS IN WET BAR. SEE SKETCH
Line 11560	Note: **NOTE, THERE IS A CHANCE THAT WE WILL NOT BE ABLE TO GET THE STACKED CABINETS ABOVE THE WINDOW, DUE TO A BULKHEAD. WE WILL REFUND THE PURCHASER SHOULD THIS BE AN ISSUE. WE WILL KNOW BY MID APRIL
28Feb24 / 1Mar24	
Inv.573 109	4 - KITCHEN - MASTER ENSUITE: INSTALL CROWN THROUGHOUT KITCHEN, SERVERY AND WET BAR (J08)
	MASTER ENSUITE: INSTALL CROWN ON BOTH HUTCHES
Line 11561	Note:
28Feb24 / 1Mar24	
Inv.573 110	4 - KITCHEN: INSTALL LIGHT VALANCE (J11) TO GO IN KITCHEN SERVERY AND WET BAR
Line 11562	Note:
28Feb24 / 1Mar24	
Inv.573 111	1 - KITCHEN: INSTALL FRIDGE ENCLOSURE (H4) WITH ONE WALL
Line 11563	Note:
28Feb24 / 1Mar24	
Inv.573 112	1 - KITCHEN: INSTALL FRIDGE VALANCE
Line 11564	Note:
28Feb24 / 1Mar24	
Inv.573 113	1 - KITCHEN: INSTALL DECORATIVE FRIDGE DRAWERS (B41)
	NOTE: Fridge drawers will not be seamless. drawer sizes on either side of the fridge and fridge will be separated from the adjacent cabinets with small gables so the toe kick will not go straight across
Line 11565	Note:
28Feb24 / 1Mar24	
Inv.573 114	1 - KITCHEN: INSTALL HOOD FAN CABINET (H13)
Line 11566	Note:
28Feb24 / 1Mar24	
Inv.573 115	5 - KITCHEN: INSTALL FIVE (5) POT AND PAN DRAWERS (B10)
Line 11567	Note:
28Feb24 / 1Mar24	
Inv.573 116	1 - KITCHEN: INSTALL LE MANS CORNER SYSTEM (B30)
Line 11568	Note:
28Feb24 / 1Mar24	



CONSTRUCTION SUMMARY

Joshua Creek - 68    BAYSHIRE (44-03) B

Registere Plan Number:    Municipal Address:    Closing: 20-Oct-23

Inv.573 117  Line 11569  28Feb24 / 1Mar24	1 - KITCHEN: INSTALL TIP OUT TRAY AT SINK  NOTE: WE MAY NOT BE ABLE TO INSTALL ONCE THE QUARTZ COUNTER HAS BEEN INSTALLED DUE TO SPACING  Note:
Inv.573 118  Line 11570  28Feb24 / 1Mar24	2 - KITCHEN: INSTALL TWO TOP DRAWERS (B07)   Note:
Inv.573 119  Line 11571  28Feb24 / 1Mar24	1 - KITCHEN: INSTALL MICROWAVE CABINET IN ISLAND, WITH DRAWER BELOW, STANDARD APPLICATION (H36)  Note:
Inv.573 120  Line 11572  28Feb24 / 1Mar24	1 - POWDER ROOM: INSTALL TOWEL DRAWER CABINET (D17)   Note:
Inv.573 121  Line 11573  28Feb24 / 1Mar24	1 - MUDROOM: INSTALL BEADBOARD BACK ON BENCH (E12)   Note:
Inv.573 122  Line 11574  28Feb24 / 1Mar24	5 - WET BAR: INSTALL FOUR (4) POT AND PAN DRAWERS (B10)  INSTALL CABINET WITH U-SHAPED DRAWER UNDER BAR SINK  Note:
Inv.573 123  Line 11576  28Feb24 / 1Mar24	1 - WET BAR: INSTALL WINE RACK (A42)   Note:
Inv.573 124  Line 11578  28Feb24 / 1Mar24	1 - SERVERY: INSTALL APPLIANCE GARAGE WITH AVENTOS LIFT UP DOOR (A33 + A32)   Note:
Inv.573 125  Line 11579  28Feb24 / 1Mar24	3 - SERVERY: INSTALL THREE POT AND PAN DRAWERS (B10)   Note:



CONSTRUCTION SUMMARY

Joshua Creek - 68      BAYSHIRE (44-03) B

Registere Plan Number:    Municipal Address:    Closing: 20-Oct-23

Inv.573 126 Line 11580  28Feb24 / 1Mar24	3 - LAUNDRY ROOM: INSTALL THREE 2-DRAWER BASE CABINETS (B11)  Note:  
Inv.573 127 Line 11581  28Feb24 / 1Mar24	1 - SHARED BATH: INSTALL ONE BANK OF DRAWERS (B15)  Note:  
Inv.573 128  Line 11582  28Feb24 / 1Mar24	7 - MASTER ENSUITE (2)- ENSUITE 2 (1)- ENSUITE 5 (1)- BASEMENT BATH(1) - SHARED (2): (D12)  INSTALL DUMMY DRAWERS THROUGHOUT THE WASHROOM VANITIES (7)  Note:  
Inv.573 129 Line 11583  28Feb24 / 1Mar24	2 - MASTER ENSUITE: INSTALL TWO HUTCHES ON EITHER END OF THE VANITY, ADD CROWN (A31)  Note:  
Inv.573 65 Line 11515  28Feb24 / 1Mar24	1 - KITCHEN-SERVERY-WET BAR: INSTALL LEVEL 6 CABINETS THROUGHOUT KITCHEN, INCLUDING SERVERY AND WET BAR  Note:  
Inv.573 66 Line 11516  28Feb24 / 1Mar24	2 - KITCHEN: COLOUR CHANGE IN THE KITCHEN ISLAND AND WET BAR ISLAND  Note:  
Inv.573 67 Line 11517  28Feb24 / 1Mar24	1 - LAUNDRY ROOM: INSTALL LEVEL 6 CABINETS THROUGHOUT LAUNDRY ROOM  Note:  
Inv.573 68 Line 11518  28Feb24 / 1Mar24	7 - LAUNDRY ROOM: *IN NEW AREA*: INSTALL LEVEL 6 UPPER CABINETS THROUGHOUT LAUNDRY ROOM (A2)  Note:  
Inv.573 69 Line 11519  28Feb24 / 1Mar24	7 - LAUNDRY ROOM: *IN NEW AREA*: INSTALL LEVEL 6 BASE CABINETS THROUGHOUT LAUNDRY ROOM (B1)  Note:  



CONSTRUCTION SUMMARY

Joshua Creek - 68      BAYSHIRE (44-03) B

Registere Plan Number:    Municipal Address:    Closing: 20-Oct-23

Inv.573 70 Line 11520 28Feb24 / 1Mar24	1 - POWDER ROOM: INSTALL OPTIONAL CABINETS IN LEVEL 6 IN POWDER ROOM  Note:
Inv.573 71 Line 11521 28Feb24 / 1Mar24	1 - SHARED BATH: INSTALL LEVEL 6 CABINETS THROUGHOUT  Note:
Inv.573 72 Line 11522 28Feb24 / 1Mar24	1 - MASTER ENSUITE: INSTALL LEVEL 6 CABINETS THROUGHOUT  Note:
Inv.573 73 Line 11523 28Feb24 / 1Mar24	1 - ENSUITE 2: INSTALL LEVEL 6 CABINETS THROUGHOUT  Note:
Inv.573 74 Line 11524 28Feb24 / 1Mar24	1 - ENSUITE 5: INSTALL LEVEL 6 CABINETS THROUGHOUT  Note:
Inv.573 75 Line 11525 28Feb24 / 1Mar24	1 - MUDROOM BENCH: INSTALL LEVEL 6 CABINETS THROUGHOUT  Note:
Inv.573 76 Line 11526 28Feb24 / 1Mar24	1 - BASEMENT BATH: INSTALL LEVEL 6 CABINETS THROUGHOUT  Note:
Inv.597 138 Line 11999 11Apr24 / 12Apr24	1 - KITCHEN: CORRECTION:    ITEM 115 ON PE 573  THERE ARE ONLY 4 BANKS OF POT AND PAN DRAWERS IN THE KITCHEN, NOT 5  Note:
Inv.597 139 Line 12000 11Apr24 / 12Apr24	38 - KITCHEN: INSTALL SOFT-CLOSE DRAWERS THROUGHOUT KITCHEN (15 DRAWERS), SERVERY (9 DRAWERS), AND WET BAR AREA (14 DRAWERS)  THERE WILL BE A TOTAL OF 38 DRAWERS TO BE CHANGED TO SOFT CLOSE  Note:



CONSTRUCTION SUMMARY

Joshua Creek - 68      BAYSHIRE (44-03) B

Registere Plan Number:    Municipal Address:    Closing: 20-Oct-23

Inv.618 163	3 - DELETE: ITEM #126 ON PE 573
Line 12333	LAUNDRY ROOM: *IN NEW AREA*: INSTALL THREE 2-DRAWER BASE CABINETS IN LAUNDRY ROOM (B11)
	Note:
7May24 / 13May24	
Inv.618 166	1 - SHARED BATH: CLARIFICATION:
Line 12350	ITEM 127 ON PE 573: THE CODE FOR THE VANITY BANK OF DRAWERS SHOULD READ (D15)
	Note:
7May24 / 13May24	
Inv.618 167	1 - KITCHEN: CLARIFICATION:
Line 12351	ITEM 122 ON PE 573: THERE ARE 5 POT AND PAN DRAWERS IN THE WET BAR AREA, ALTHOUGH THE DESCRIPTION READS 4. PLEASE INSTALL 5, AS PURCHASED
	Note:
7May24 / 13May24	

CEILING

Inv.597 140	1 - CLARIFICATION: CROWN MOULDING LOCATIONS:
Line 12003	CROWN (A-120, 8x8), WILL BE INSTALLED THROUGHOUT ENTIRE MAIN FLOOR: FOYER, MAIN HALL, POWDER ROOM, DEN, DINING ROOM, SERVERY, KITCHEN AND WET BAR AREAS, MUDROOM AND FAMILY ROOM.
11Apr24 / 12Apr24	Note: ALSO TO BE ADDED TO THE INSIDE OF THE COFFERED IN MAIN HALL, DINING AND WAFFLES IN FAMILY ROOMS.
	2ND FLOOR: CROWN (A-120, 7X7), WILL BE ADDED TO STAIRCASE, MASTER BEDROOM (ALSO IN MASTER WAFFLE), MASTER ENSUITE- NOTE HUTCHES ON VANITY, UPPER HALLWAY.
	PLEASE ASK IF THERE ARE ANY QUESTIONS
Inv.573 133	1 - ***DELETE*** PE488, ITEM #4
Line 11587	MASTER BEDROOM: INSTALL TRAY CEILING
	Note:
28Feb24 / 1Mar24	

CEILING

Inv.573 134	1 - MASTER BEDROOM: INSTALL WAFFLE CEILING, 4 SQUARES
Line 11588	STANDARD LIGHT TO GO IN THE CENTRE OF THE 4 SQUARES
	Note:
28Feb24 / 1Mar24	





CONSTRUCTION SUMMARY

Joshua Creek - 68 - 1 - BAYSHIRE (44-03) B

Registere Plan Number:    Municipal Address:    Closing: 20-Oct-23



Inv.573 89 Line 11540 28Feb24 / 1Mar24	1 - BASEMENT BATH: INSTALL MSI 3, CALACATTA LAZA  Note:
Inv.618 164 Line 12331 7May24 / 13May24	1 - DELETE: ITEM #82 ON PE 573  LAUNDRY ROOM: *IN NEW AREA*: INSTALL MSI 3, CALACATTA LAZA IN NEW AREA ACROSS FROM WASHER/DRYER  Note:
Inv.573 99 Line 11550 28Feb24 / 1Mar24	1 - KITCHEN/ SERVERY: INSTALL MSI 3, CALACATTA LAZA ON BACKSPLASH  Note:
Inv.573 100 Line 11551 28Feb24 / 1Mar24	1 - WET BAR: INSTALL MSI 3, CALACATTA LAZA ON BACKSPLASH  Note:

ELECTRICAL

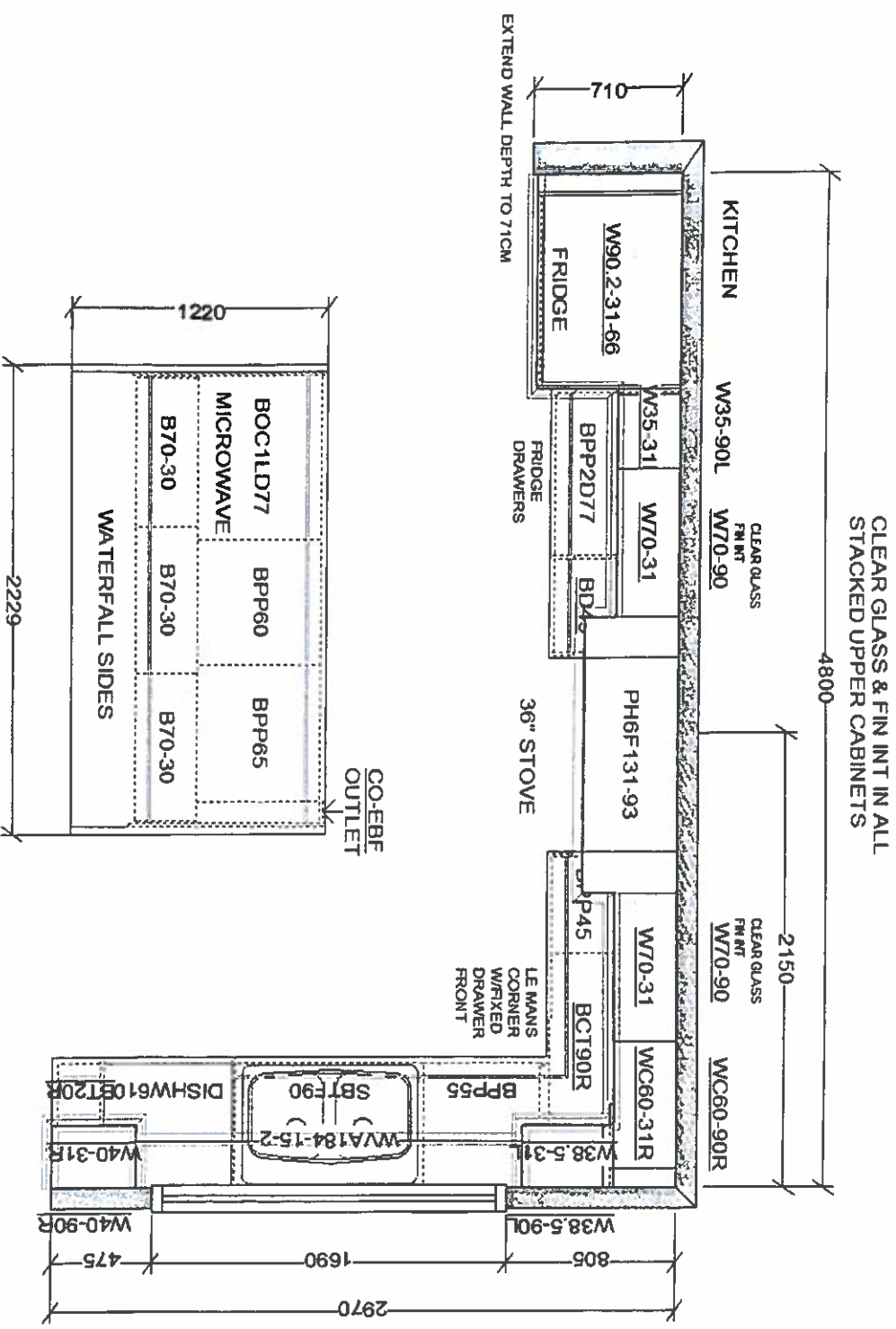
Inv.618 159 Line 12318 7May24 / 13May24	4 - **ADJUSTMENT** ON PE #573, ITEM 37 - KITCHEN: INSTALL CABINET LIGHTING  **ONLY 4 LIGHTS THAT WERE TO GO IN THE STACKED UPPERS ABOVE THE WINDOW NEED TO BE REMOVED. THERE IS A TOTAL OF 33 LIGHTS TO BE INSTALLED NOW  Note:
Inv.573 33 Line 11481 28Feb24 / 1Mar24	1 - MASTER BEDROOM:  CEILING FIXTURES- REINFORCE FOUR (4) FIXTURES FOR FUTURE CHANDELIERS (MAX WEIGHT OF 50 POUNDS)  Note:
Inv.573 45 Line 11495 28Feb24 / 1Mar24	1 - MASTER ENSUITE: INSTALL RECEPTACLES - DEDICATED 15 AMP 120 VOLT GFCI RECEPTACLE (INTERIOR)  FOR FUTURE ELECTRONIC BIDET SEAT, BEHIND TOILET  Note:



This sketch is for DESIGN PURPOSES ONLY – It is not meant to be an exact rendition.

 FRENDEL KITCHENS LIMITED 1500 Burnham Drive, Midvale, ON L4W 1C3	VALERY HOMES JOSHUA CREEK LOT 68	 B A May 9, 24
Drawn By: Date: May 8, 2024 Scale: Not To Scale		
Approved by Builder: Date:		

RECEIVED  
MAY 14 2024

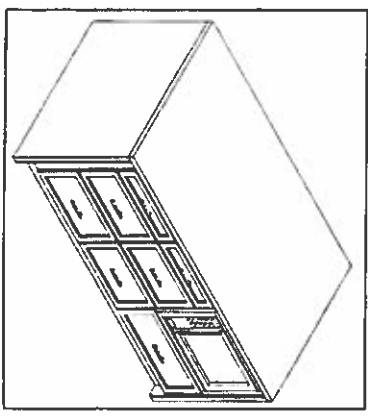
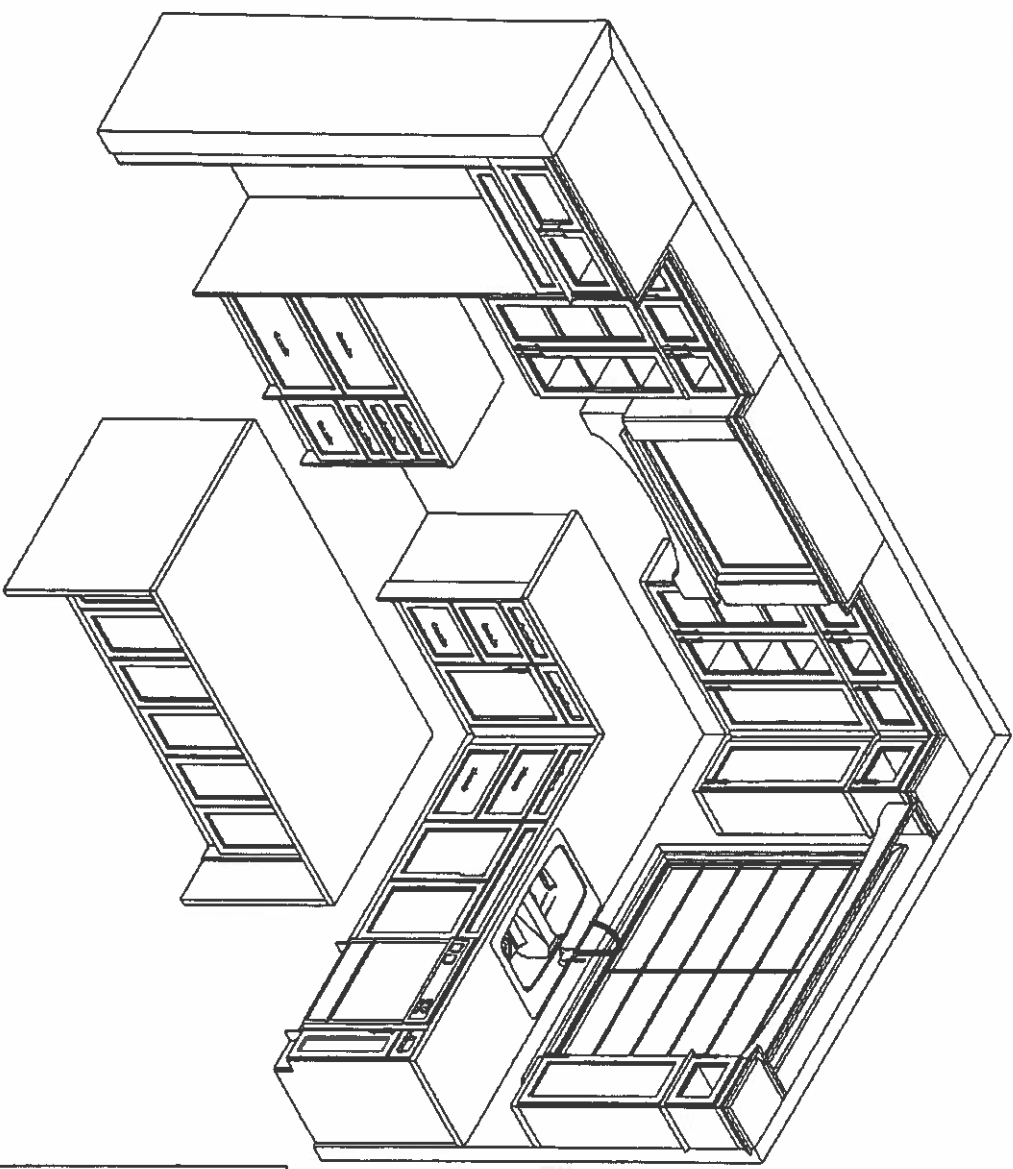

This sketch is for DESIGN PURPOSES ONLY – It is not meant to be an exact rendition.



VALERY HOMES  
JOSHUA CREEK  
LOT 68



*at pay 9, 24*

Drawn By:  
Date: May 8, 2024  
Scale: Not To Scale

Approved By Builder:

Date:

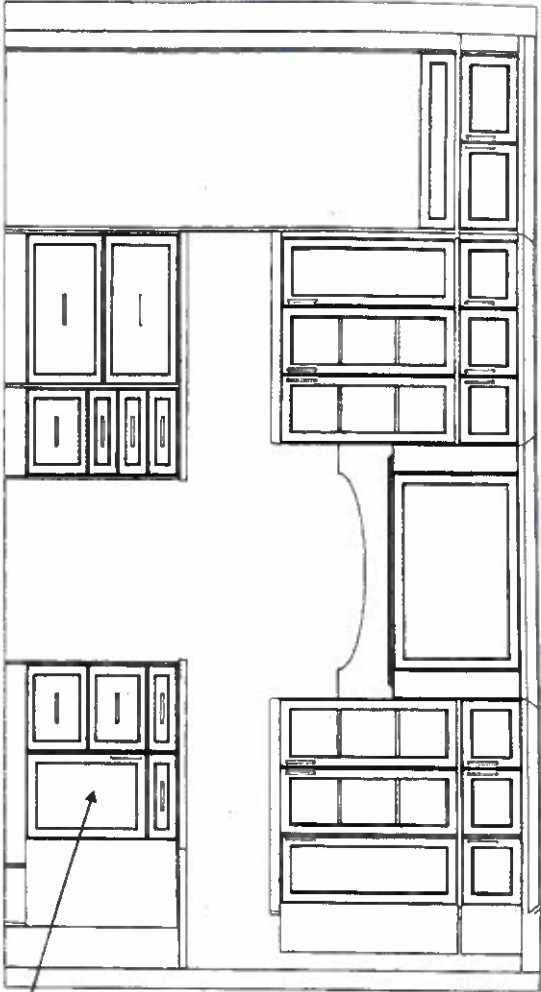

RECEIVED  
MAY 14 2024

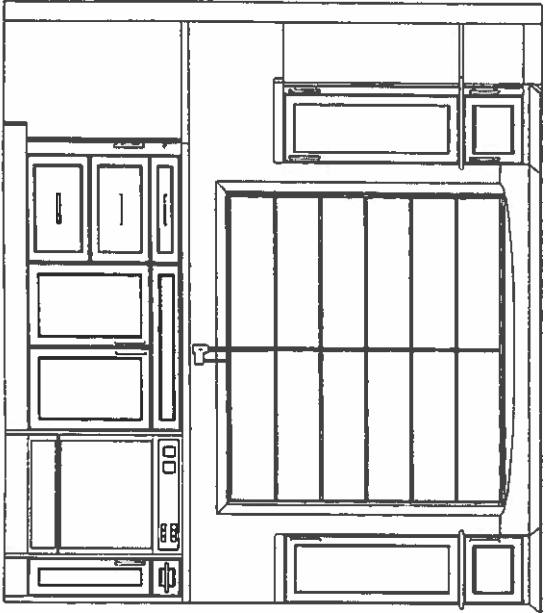

LE MANS CORNER  
W/FIXED DRAWER  
FRONT ABOVE



This sketch is for DESIGN PURPOSES ONLY – It is not meant to be an exact rendition.

 <b>F R E N D E L</b> KITCHENS LIMITED <small>(200) Preston Drive, Mississauga, ON L4W 1C3</small>	<b>VALERY HOMES</b> JOSHUA CREEK LOT 68	  <i>May 9, 2024</i>	
Drawn By: Date: May 8, 2024 Scale: Not To Scale			
Approved By Builder: _____ Date: _____			

RECEIVED  
MAY 14 2024

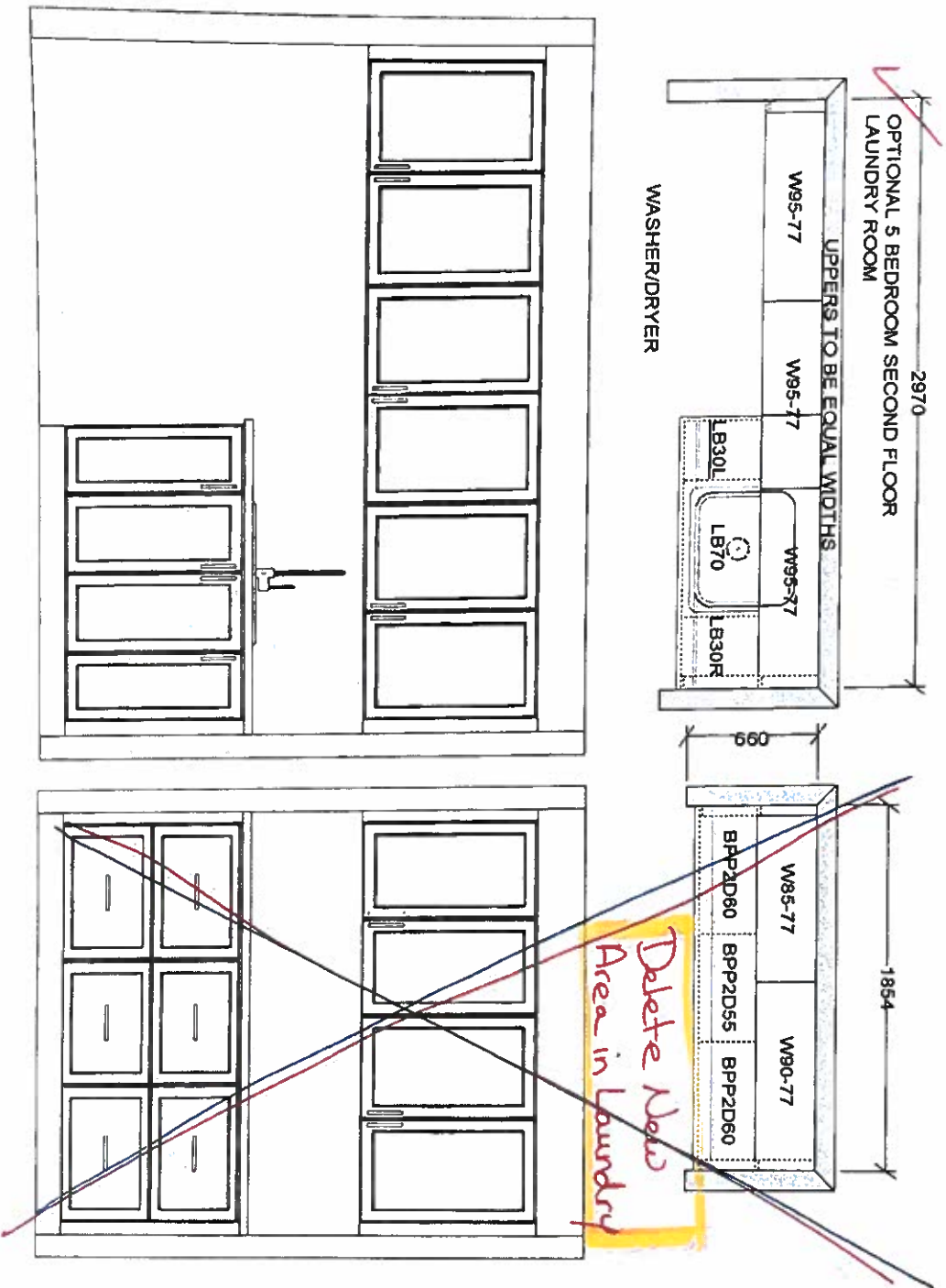

This sketch is for DESIGN PURPOSES ONLY – It is not meant to be an exact rendition.

 F R E N D E L S Y S T E M S L I M I T E D 1288 Burnham Drive, Markham, ON L3R 9C2	VALERY HOMES JOSHUA CREEK LOT 68	Feb. 29, 24 D.A. KN Copy 9, 24 D.A. KN	Drawn By: Date: February 29, 2024 Scale: Not To Scale	Approved By Builder: Date:
--	--	---	---	-------------------------------

RECEIVED  
MAY 14 2024