

## CONSTRUCTION SUMMARY

Joshua Creek - 56      CASTLEFIELD (42-04) A

Registere Plan Number:    Municipal Address:    Closing: 24-Oct-23

## BONUS

Inv.506 28 Line 10291  18Jan23 / 2Jan24	1 - BONUS PACKAGE: \$5,000.00 WORTH OF UPGRADES FROM VALERY HOMES DÉCOR CENTRE IS BEING APPLIED TOWARD THE STRUCTURAL APPOINTMENT.  Note:
---	---

## CEILING

Inv.506 3 Line 10268  18Jan23 / 2Jan24	1 - SECOND FLOOR: SMOOTH CEILING THROUGHOUT SECOND FLOOR  Note:
--	---

## CONSTRUCTION

Inv.506 6 Line 10271  18Jan23 / 2Jan24	1 - DINING ROOM / DEN: DELETE WALL BETWEEN THE DINING ROOM AND DEN. LEAVE ORIGINAL CEILING LINES AS IS  Note:
Inv.506 7 Line 10272  18Jan23 / 2Jan24	1 - KITCHEN: MOVE SINK AND DISHWASHER FROM THE KITCHEN ISLAND TO THE BACK & STOVE WALL. SEE SKETCH  ISLAND WILL BE REMOVED ENTIRELY AT THE COLOUR APPOINTMENT. <b>**DO NOT INSTALL STANDARD PLUGS</b>  Note:

## CONSTRUCTION

Inv.506 25 Line 10290  18Jan23 / 2Jan24	1 - GARAGE INSULATION - ALL WALLS AND CEILING  Note:
---	--

## ELECTRICAL

Inv.506 16 Line 10281  18Jan23 / 2Jan24	1 - FAMILY ROOM: ELECTRICAL - DEDICATED 15 AMP 120 V FOR ELECTRIC FIREPLACE  Note:
Inv.506 23 Line 10288  18Jan23 / 2Jan24	6 - FAMILY ROOM: INSTALL SIX (6) POT LIGHT - 4" LED NON-INSULATED CEILINGS, ON SEPARATE SWITCH. KEEP STANDARD LIGHT  Note: Location may vary slightly due to joist location
Inv.506 24 Line 10289  18Jan23 / 2Jan24	4 - DINING ROOM: INSTALL FOUR (4) POT LIGHT - 4" LED NON-INSULATED CEILINGS, ON SEPARATE SWITCH. KEEP STANDARD LIGHT  Note: Location may vary slightly due to joist location
Inv.506 8 Line 10273  18Jan23 / 2Jan24	1 - KITCHEN: MOVE SINK AND DISHWASHER FROM THE KITCHEN ISLAND TO THE BACK WALL. SEE SKETCH  ISLAND WILL BE REMOVED ENTIRELY AT THE COLOUR APPOINTMENT. <b>**DO NOT INSTALL STANDARD PLUGS</b>  Note:

## CONSTRUCTION SUMMARY

Joshua Creek - 56 CASTLEFIELD (42-04) A

Registere Plan Number:    Municipal Address:    Closing: 24-Oct-23

Inv.506 4	1 - FAMILY ROOM: ELECTRICAL - DEDICATED 15 AMP 120 V FOR FUTURE TV ABOVE FIREPLACE
Line 10269	Note: NOTE: STANDARD LOCATION OF FIREPLACE HAS MOVED
18Jan23 / 2Jan24	
Inv.506 10	1 - BASEMENT: ELECTRICAL - DEDICATED 15 AMP 120 V FOR FUTURE TV- TO BE PLACE 5' OFF FINISHED FLOOR
Line 10275	Note:
18Jan23 / 2Jan24	
Inv.506 12	1 - UPPER HALL ABOVE STAIRS: CEILING LIGHT ROUGH IN - FOR 1 CEILING LIGHT - ON SEPARATE SWITCH (DOES NOT INCLUDE FIXTURE)
Line 10277	Note: Location may vary slightly due to joist location
18Jan23 / 2Jan24	
Inv.506 13	1 - SECOND FLOOR ABOVE STAIRS: REINFORCE FIXTURE FOR CHANDELIER. MAX 50 POUNDS AT CEILING LIGHT ROUGH-IN ABOVE STAIRS
Line 10278	Note:
18Jan23 / 2Jan24	
Inv.506 18	1 - KITCHEN: INSTALL RECEPTACLES - ADDITIONAL 15 AMP 120 VOLT RECEPTACLE (NON-DEDICATED) FOR GAS STOVE
Line 10283	Note:
18Jan23 / 2Jan24	
Inv.506 19	1 - ELECTRICAL - ROUGH-IN FOR AC UNIT. INCLUDES BREAKER & LOW VOLTAGE WIRE
Line 10284	Note:
18Jan23 / 2Jan24	
Inv.506 20	1 - PRIMARY BEDROOM: ADDITIONAL ELECTRICAL - DEDICATED 15 AMP 120 V.
	ADDITIONAL PLUG HAS BEEN PURCHASED TO ENSURE THAT THERE ARE 2 PLUGS ALONG THE WALL WHERE THE BED/ NIGHT TABLES WOULD BE. LOCATIONS ARE NOT EXACT
Line 10285	Note: LOCATIONS MAY VARY DUE TO JOIST LOCATIONS
18Jan23 / 2Jan24	

## FIREPLACE

Inv.506 15	1 - FAMILY ROOM: FIREPLACE - ALLURAVISION 50 INCH SLIM ELECTRIC FIREPLACE - GLASS FRONT - BLACK - NEFL50CHS
	*NOTE LOCATION OF STANDARD FIREPLACE HAS BEEN MOVED
Line 10280	Note:
18Jan23 / 2Jan24	

## HVAC

Inv.506 17	1 - KITCHEN: INSTALL GAS PIPING AND OTHER - GAS LINE R/I FOR MAIN FLOOR - STOVE
Line 10282	Note:
18Jan23 / 2Jan24	
Inv.506 21	1 - KITCHEN: INSTALL GAS PIPING AND OTHER - UPGRADE STOVE VENT FROM STANDARD 6 INCH TO 8 INCH
Line 10286	Note:
18Jan23 / 2Jan24	

## MISCELLANEOUS





CONSTRUCTION SUMMARY

Joshua Creek - 56      CASTLEFIELD (42-04) A

Registere Plan Number:    Municipal Address:    Closing: 24-Oct-23

WINDOWS

Inv.506	3 - BASEMENT: BASEMENT WINDOW - ENLARGE THREE (3) STANDARD WINDOWS TO- 36 X
2	30
Line 10267	Note: MAY REQUIRE A WINDOW WELL
18Jan23 / 2Jan24	

## 42-4

Move  
Dishwasher  
here

817

3

↳ puts on separate switch. keep std. light

⑤ for fireplace

50" electric  
fireplace

⑤ for TV conduit

4 pots on  
separate  
sites: keep  
sta. light

Delete wall  
keep standard coffered  
ceilings as is

PARTIAL GROUND FLOOR ELEV. 3

PARTIAL GROUND FLOOR ELEV. C

GROUND FLOOR ELEVATION

# JOSHUA CREEK

## MONTAGE

# VALERY HOMES

20156 (1P)  
Jan 18, 23

CASTLEFIELD

42-4



OPTIONAL SECOND FLOOR ELEV. A  
5 BEDROOM



SECOND FLOOR ELEV. A



PARTIAL OPTIONAL SECOND FLOOR ELEV. B  
5 BEDROOM



PARTIAL OPTIONAL SECOND FLOOR ELEV. C  
5 BEDROOM



PARTIAL SECOND FLOOR ELEV. B



PARTIAL SECOND FLOOR ELEV. C

JOSHUA CREEK

MONTAGE

ALL OF NEWPORT'S ARE SUBJECT TO NEWPORT'S CONSTRUCTION STANDARDS. CONSTRUCTION MAY DIFFER FROM THE USABLE AREA AND SPECIFIED ROOMS. FLOOR PLANS AND ROOMS ARE SUBJECT TO CHANGE WITHOUT NOTICE. EXCEPT WHERE SHOWN OTHERWISE, NEWPORT'S ARE NOT TO BE INCLUDED IN THE BIDDING. PLEASE REFER TO THE REVISION HISTORY AND LOCAL REGULATIONS FOR MORE DETAILS. A. UNDER NO CIRCUMSTANCES SHALL NEWPORT'S BE USED IN ANY MANNER THAT WOULD BE IN VIOLATION OF ANY APPLICABLE LAWS OR REGULATIONS.

VALERY HOMES

Noted  
Jan 18th, 23



1075

Jan 18<sup>th</sup>, 23

36x30

30x30

constant 5' off finish floor & directly below upper conductive zone

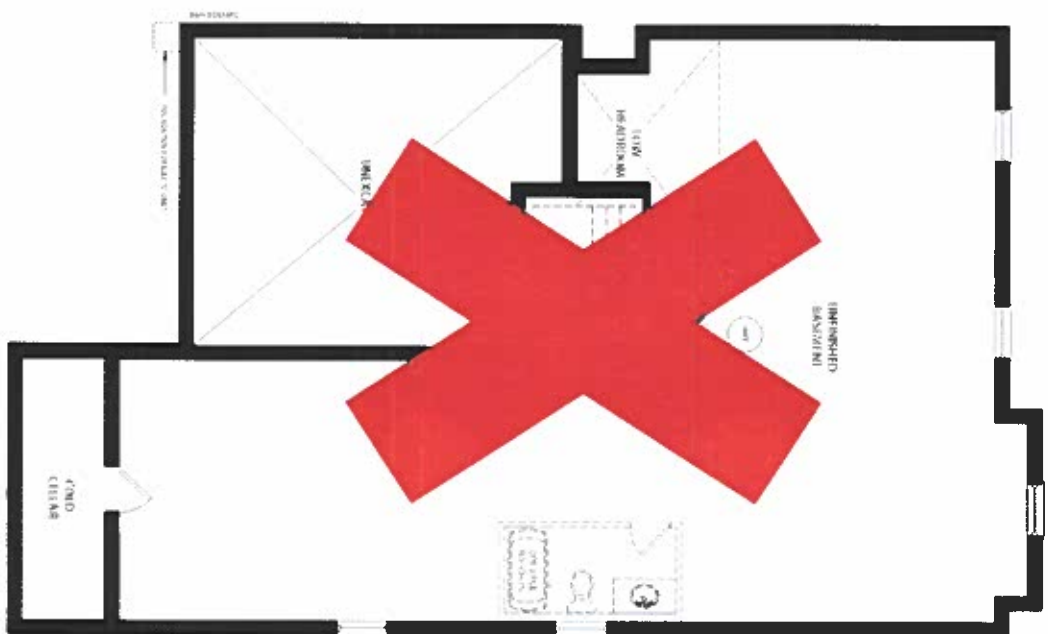

UNFINISHED BASEMENT FLEV. A, B &amp; C

[illegible]

The diagram illustrates the layout of a building with four floors. The ground floor includes an entrance hall, reception area, waiting area, examination room, treatment room, and storage room. The first floor features an office, meeting room, and conference room. The second floor houses a laboratory, library, and computer center. The third floor consists of a dormitory and cafeteria.

**VALERY**  
HOMES

POSI-TEMP®



•Primary Ens.

**Posi-Temp® Tub/Shower Faucet with 3 Function Transfer Valve/Trim and Slide Bar with Hand Shower\***

TL183EP / U361CI / UT2721 / 3669EP / A725 / 62320

Chrome \$1,293.00



**Posi-Temp® Shower Only with 3 Function Transfer Valve/Trim and Slide Bar with Hand Shower\***

TL182EP / U361CI / UT2721 / 3669EP / A725 / 62320

Chrome \$1,255.31



**Posi-Temp® Tub/Shower Faucet with 4 Function Hand Shower\***

TL2359EP / 62320

Chrome \$522.06



**Eco-Performance Posi-Temp® Tub/Shower Faucet\***

TL183EP / 62320

Chrome \$302.88



**Eco-Performance Posi-Temp® Shower Only\***

TL182EP / 62320

Chrome \$265.19

\* Note:

Shared Ensuite to have toe tap included in the new shower stall.

CHATEAU  
FINISH OPTION



Chrome

To order Chrome (CI) model, use model number only.

\* Refer to the Shower Design Guide for Installation Instructions