

Lot 42
Sept 7, 22

54

Full Spec Package

SHAKIR YASSIR



Contents	Page no.
G 7366 SCVi Miele Dishwasher G 7366 SCVi 24" Fully Integrated Dishwasher	4-5
G 7106 SCU Miele Dishwasher G 7106 SCU 24" Pre-Finished Dishwasher	6
KMR 1134-3 G Miele Rangetop 36" KMR 1134-3 G All Gas Rangetop	7-9
DAR1230 Miele Ventilation DAR 1230 36" Range Wall Hood SKU: 09753410	10-28
DA 2588 Miele Ventilation Hood 32" DA 2588 Built-In Ventilation Hood SKU: 10876770	29-35

Tasco Appliances
tascoappliance.ca

JAY NAKRA
9052751700

Search 20220730181407639SC
Version 1.1

Sat, Jul 30, 2022
2:14 PM EDT



enterprise.steelcod.com/sp/tasc/JWLB7UFL

Note about page numbers:
Because the original manufacturer's documents are not altered in any way, the page numbers displayed on the page may not correspond to the page number within this package.

All specifications are intended for initial planning purposes only.
Manufacturers reserve the right to change specifications at any time without notice. Always consult the installation instructions found on the manufacturer's website or included with the appliances before installation.

Lot 42

SM

Full Spec Package

Sept. 7, 22

F 2412 Vi	36-41
Miele Refrigeration	
18" F 2412 Vi Fully Integrated MasterCool	
SKU: 11503300	

K 2802 Vi	42-48
Miele Refrigeration	
30" K 2802 Vi Fully Integrated MasterCool	

H 7880 BP	49-51
Miele Wall Oven	
30" H 7880 BP PureLine Convection Oven	

H 7670 BM	52-54
Miele Wall Oven	
30" H 7670 BM PureLine Speed Oven	

CVA 7440	55-57
Miele Coffee Machine	
24" CVA 7440 PureLine Built-in Coffee System	

ESW 7670	58-60
Miele Warming Drawer	
30" ESW 7670 PureLine Handless Warming Drawer	

<p>Note about page numbers: Because the original manufacturer's documents are not altered in any way, the page numbers displayed on the page may not correspond to the page number within this package.</p>	<p>All specifications are intended for initial planning purposes only. Manufacturers reserve the right to change specifications at any time without notice. Always consult the installation instructions found on the manufacturer's website or included with the appliances before installation.</p>
--	--

Lot 42 S.Y.
Sept 7, 22

Full Spec Package

shakir yassir



Contents	Page no.
ELN136S2 Elica Ventilation LEONE Wall 36" SS (1200 CFM)	3-4
WM4500HBA LG Washer 5.8 cu.ft. Mega Capacity Front Load Washer with AI DD	5-9
DLEX4500B LG Dryer	10-15
WDP4V LG Laundry	16

Tasco Appliances
tascoappliance.ca

JAY NAKRA
9052751700

Search 20220813162609058SC
Version 1.1

Sat, Aug 13, 2022
12:26 PM EDT



enterprise.steelcod.com/sp/tasc/1KP56ZWI

Note about page numbers:
Because the original manufacturer's documents are not altered in any way, the page numbers displayed on the page may not correspond to the page number within this package.

All specifications are intended for initial planning purposes only.
Manufacturers reserve the right to change specifications at any time without notice. Always consult the installation instructions found on the manufacturer's website or included with the appliances before installation.



G 7366 SCVi
24" Fully Integrated Dishwasher

- Features:
- AutoDos - an integrated automatic detergent dispensing system
 - DirectSensor Controls - intuitive touch controls
 - QuickIntenseWash - a full wash and dry cycle in 58 minutes
 - 42 dB (40 dBa when using ExtraQuiet)
 - 3D MultiFlex Cutlery Tray
 - WifiConn@ct
 - Panel-Ready
 - Water Softener
 - EnergyStar

MATERIAL #
11388030

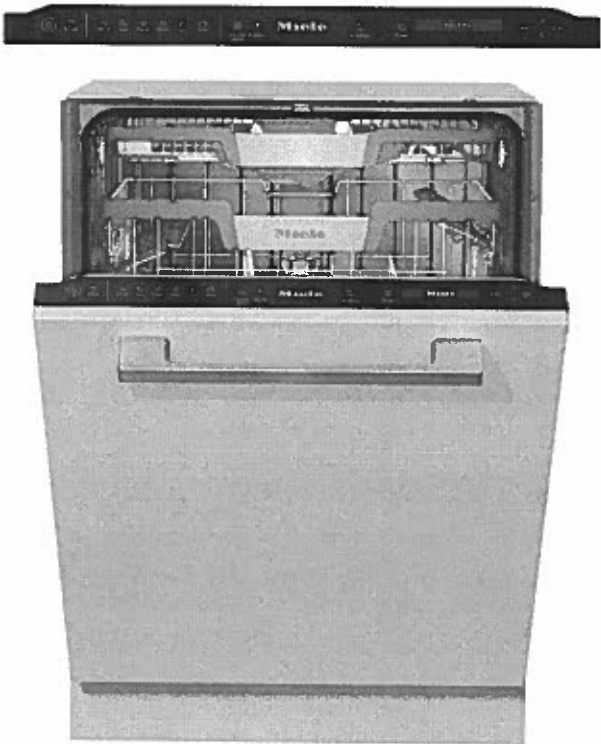

SPECIFICATIONS	
Overall Unit Dimensions	23 ⁹ / ₁₆ " (598 mm) W x 33 ¹¹ / ₁₆ " - 36 ¹ / ₄ " (855 - 920 mm) H x 22 ⁷ / ₁₆ " (570 mm) D [Depth does not include door panel]
Niche	
Minimum Cabinet Niche Opening	23 ⁵ / ₈ " (600 mm) W x 33 ³ / ₄ " (857 mm) H x 22 ⁷ / ₁₆ " (570 mm) D
Plumbing	
Water Supply Requirements	• Cold or Hot (max 150°F/65°C) water connection • Male 3/8" compression fitting • Water pressure range 7.25 psi (0.5 bar) and 145 psi (10 bar)
Water Connection Line (Supplied)	Length: 5 ft (1.5 m) Female 3/8" compression.
Drain Hose (Supplied)	Length: 5 ft (1.5 m) 7/8" (22 mm) internal diameter
Electrical	
Electrical Requirements	110V / 120V, 60Hz, 15 Amps
Power Cord (Convertible to hardwire)	NEMA 5-15 plug, 5 ft (1.52 m)
Shipping	
Shipping Weight	121 lbs (55 kg)
Shipping Dimensions	27 ¹ / ₈ " W x 38 ¹ / ₈ " H x 26 ³ / ₈ " D

PRODUCT DIMENSIONS

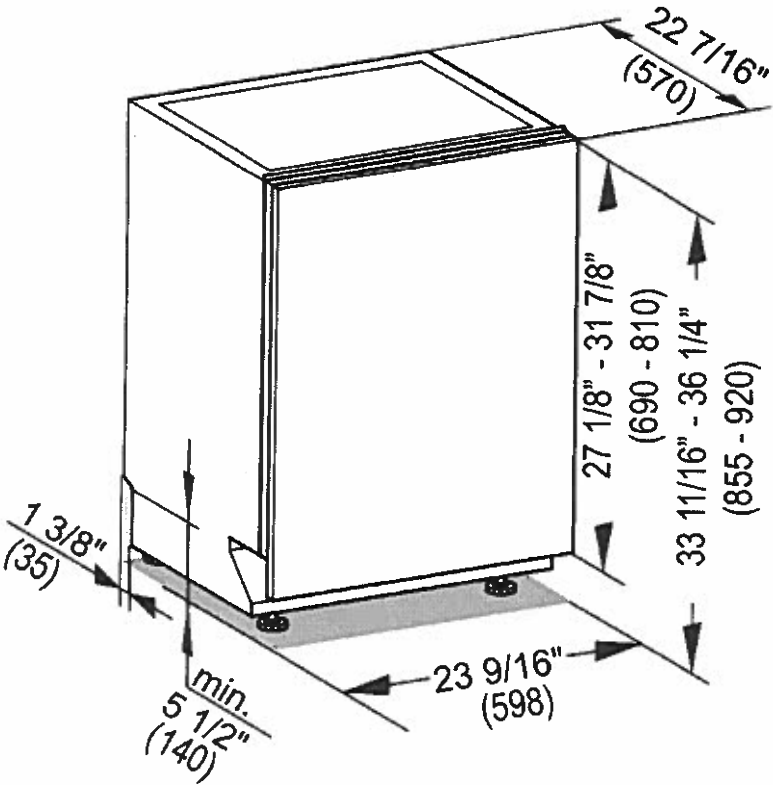



CUTOUT DIMENSIONS

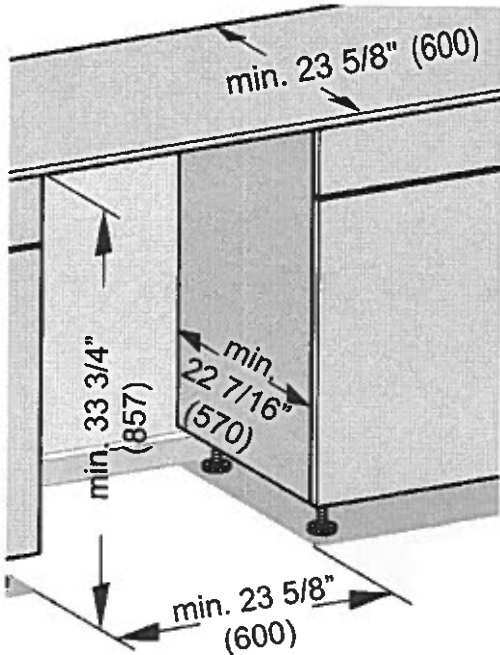

CUSTOM PANEL

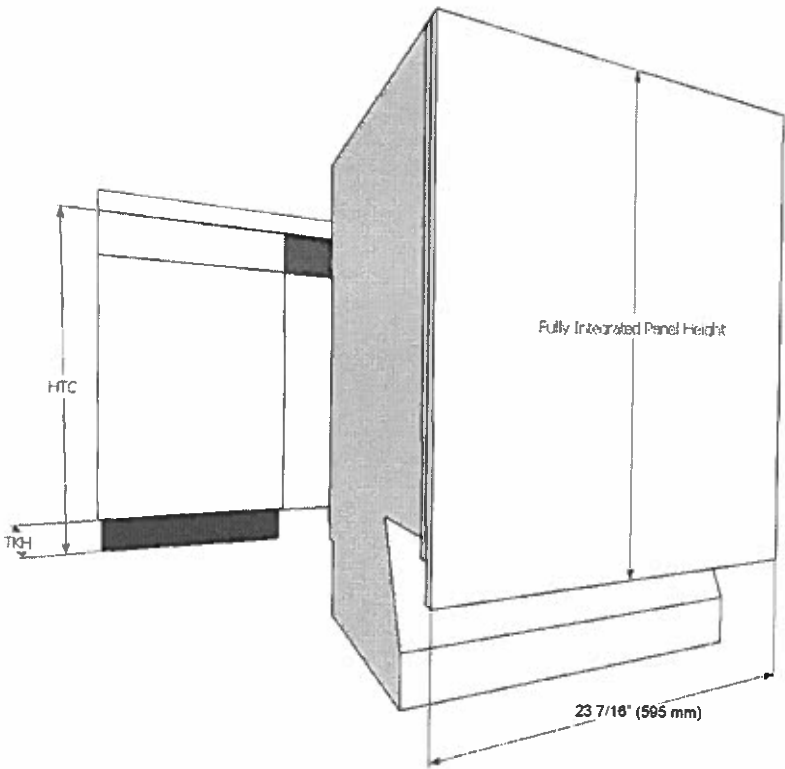

Width: 23 7/16" (595 mm) in all Cases
Thickness: 3/4" (19 mm) in all Cases
Height: Determined using the following calculation:

Panel Height = HTC – TKH

HTC = Height to the underside of countertop
TKH = Toe kick height

Note: Control panel is along the top edge of the unit. It is not visible when the unit is closed. A handle **MUST** be located on front of panel in order to open unit. (Except K2o models).

- Maximum panel height: 31 7/8" (810 mm)
- Minimum panel height: 27 1/8" (690 mm)
- Maximum panel weight: 26 lbs (12 kg)



G 7106 SCU
24" Pre-Finished Dishwasher

- Features:
- DirectSelect Controls
 - QuickIntenseWash - a full wash and dry cycle in 58 minutes
 - 43 dBa
 - 3D MultiFlex Cutlery Tray
 - CleanTouch Steel - easy to clean, fingerprint resistant stainless steel
 - Water Softener
 - EnergyStar

MATERIAL #
11387580

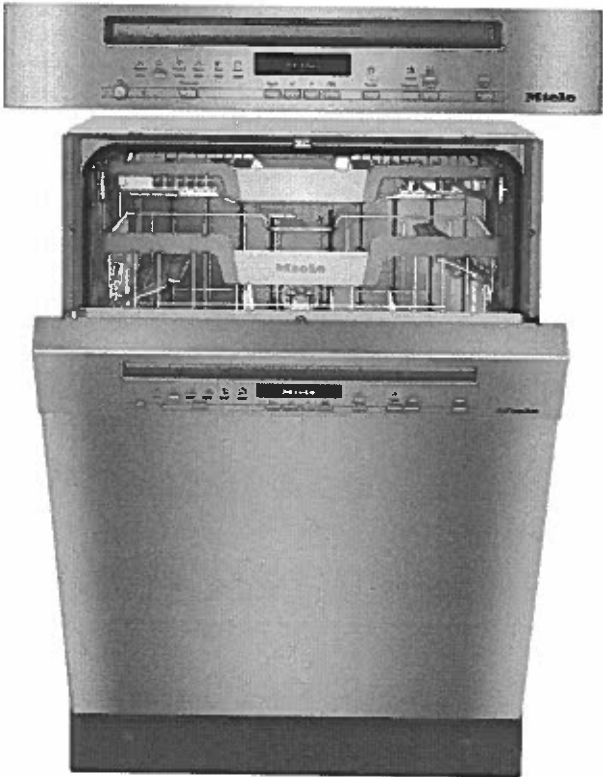

SPECIFICATIONS	
Overall Unit Dimensions	23 ⁹ / ₁₆ " (598 mm) W x 33 ¹¹ / ₁₆ " - 36 ¹ / ₄ " (855 - 920 mm) H x 22 ⁷ / ₁₆ " (570 mm) D [Depth does not include door panel]
Niche	
Minimum Cabinet Niche Opening	23 ⁹ / ₁₆ " (600 mm) W x 33 ³ / ₄ " (857 mm) H x 22 ⁷ / ₁₆ " (570 mm) D
Plumbing	
Water Supply Requirements	<ul style="list-style-type: none">• Cold or Hot (max 150°F/65°C) water connection• Male 3/8" compression fitting• Water pressure range 7.25 psi (0.5 bar) and 145 psi (10 bar)
Water Connection Line (Supplied)	Length: 5 ft (1.5 m) Female 3/8" compression.
Drain Hose (Supplied)	Length: 5 ft (1.5 m) 7/8" (22 mm) internal diameter
Electrical	
Electrical Requirements	110V / 120V, 60Hz, 15 Amps
Power Cord (Convertible to hardwire)	NEMA 5-15 plug, 5 ft (1.52 m)
Shipping	
Shipping Weight	121 lbs (55 kg)
Shipping Dimensions	27 ¹ / ₈ " W x 38 ¹ / ₈ " H x 26 ³ / ₈ " D

PRODUCT AND CUTOUT DIMENSIONS

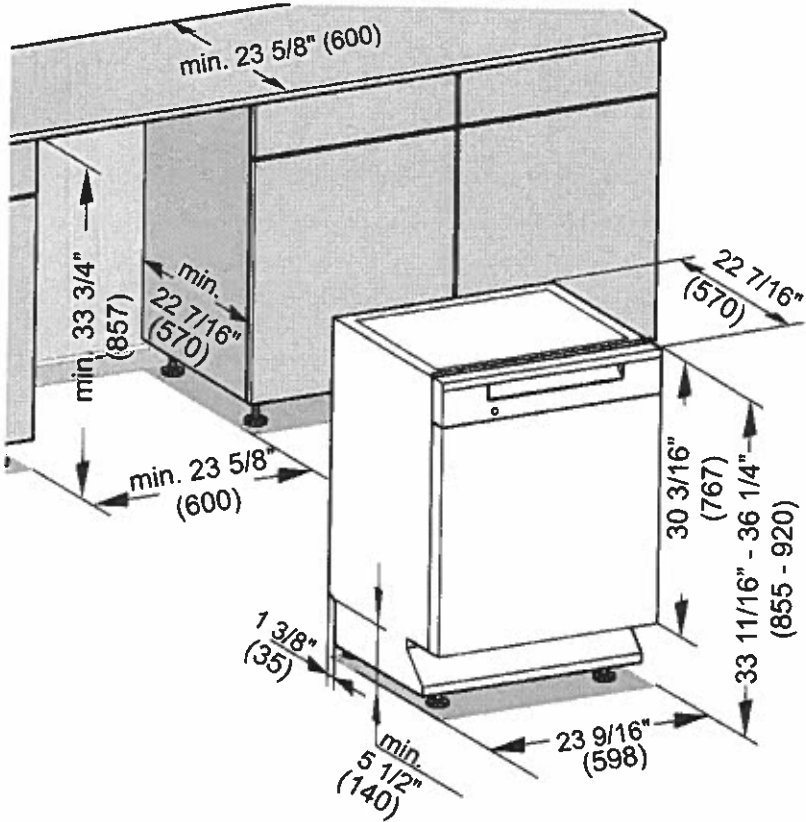



KMR 1134-3 G/LP
36" All Gas (6 Burner) Rangetop

Features:

- Direct Control - Knobs with light ring to instantly see if burner is on or off
- Comfort Clean gates - Easy to clean, dishwasher safe grates
- Clean Touch Steel™ finish - No fingerprints on stainless steel surfaces
- 6 Powerful Burners - Plenty of cooking space
- 1 Continuous Simmer Burner - The perfect temperature and even heat for delicate cooking



	MATERIAL #	UMRP	RETAIL
Gas	11588570	tbd.	tbd.
LP	11588020	tbd.	tbd.

SPECIFICATIONS	
Overall Unit Dimensions	35 15/16" (915 mm) W x 7 1/2" (191 mm) H x [Height does not including Grates] 26 1/2" (673 mm) D [Depth to control panel]
Niche	
Minimum Cabinet Niche Opening	36" (915 mm) W x 25 1/16" (636.6 mm) D [To back of control panel]
Operational Altitudes	
High Altitude	Miele Natural Gas and LP Rangetops will function up to 9,800 ft. If an installation exceeds these elevations, please contact rangejetkit@mieleusa.com.
Electrical	
Electrical Requirements	110V / 120V, 60Hz, 15 Amps
Power Cord (Convertible to hardwire)	NEMA 5-15 plug, 4 ft (1.2 m)
Shipping	
Shipping Weight	134.5 lbs (61 kg)
Shipping Dimensions	?? 1/2" W x ?? 1/2" H x ?? 1/2" D

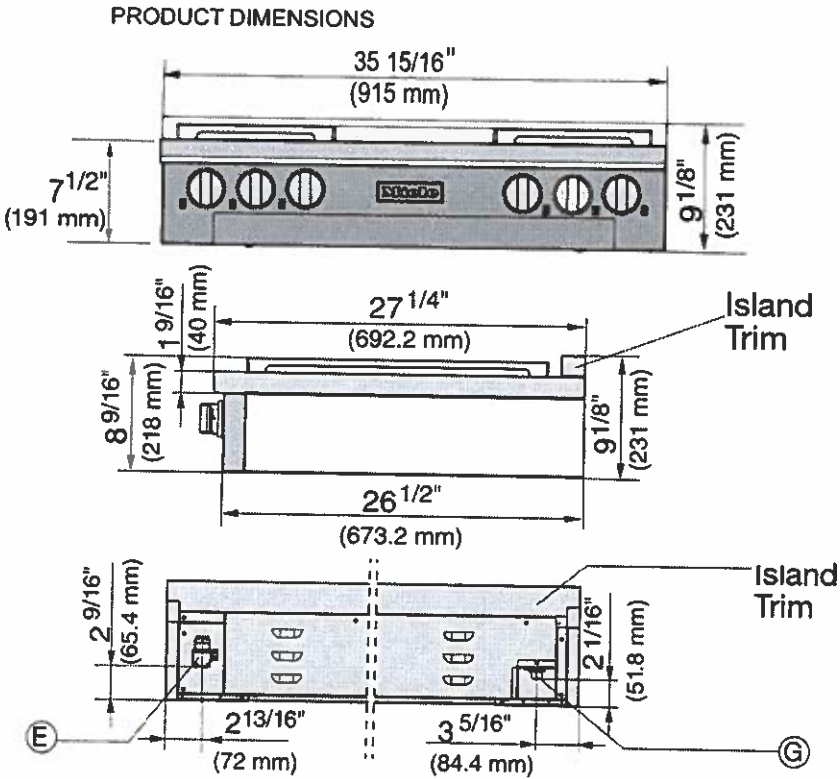

Length of power cord is 4 ft.

E = Electrical connection G = Gas connection

*Information subject to change

Miele

--	--

BTU Output	
Gas Burners:	(1) 12,500 BTU (G/LP);
	(2) 13,600 BTU (G)
	13,000 BTU (LP);
	(3) 19,500 BTU (G/LP)
Total BTU Output	98,200 BTU (G)
	97,000 BTU (LP)

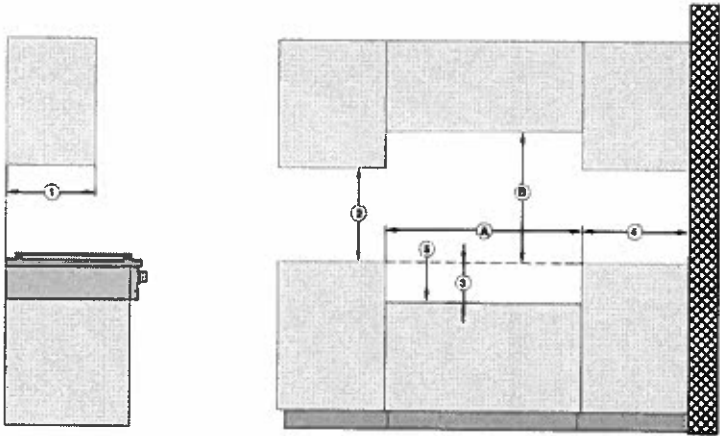

Position	Dimensions	Description
①	13" (330 mm)	Maximum depth of top cabinet
②	18" (457 mm)	Minimum distance to bottom edge of top cabinet
③	7 1/2" (190.5 mm)	Distance between the top edge of the countertop and the top edge of the support base
④	10" (254 mm)	Minimum distance to combustible surfaces
⑤		Support base ¹⁾
Ⓐ	min. 36" (915 mm)	Niche width
Ⓑ	37" (940 mm)	Minimum distance between the top of the cooking area and the bottom of an unprotected combustible surface.
	36" (915 mm)	Minimum distance between the top of the cooking area and the bottom of the Miele Range Hood (DAR model with DRxB XL blower).
	30" (762 mm)	Minimum distance between the top of the cooking area and the bottom of the Miele Range Hood (DAR model with DRxB XXL blower).
	Refer to the Installation instructions for the Miele ventilation hood, Appliance dimensions (Distance between cooktop and ventilation hood (S)). For all other hoods please consult the manufacturer's specifications for required distances.	

1) The support base must have a minimum thickness of 3/4" (19.05 mm).
At the rear right of the support base, a cut-out of 5 1/8" x 7 1/8" (130 mm x 80 mm) must be provided (gas connection) and, at the rear left, a cut-out of 4 6/8" x 1 9/16" (120 mm x 40 mm) (electrical connection).

External Range Hood Blower

DREB XL



SPECIFICATIONS	
DREB XL — Item	
Overall Width - Excluding mounting Tab Dimension	19 ³ / ₁₆ " (488mm)
Overall Height - Excluding mounting Tab Dimension	18 ¹⁵ / ₁₆ " (481mm)
Overall Depth - Excluding mounting Tab Dimension	15" (381mm)
Mounting Tab Length - Past Blower Housing	1/2" (13mm)
Airflow Rate	
CFM	700 Max
Exhaust Ducting	
Recomened Duct Diameter	8" (203mm)
Electrical	
Electrical Requirements	120V, 60Hz, 15 Amps, 615W
Power Cord	Yes - 6 Pole Plug Connector
Shipping	
Shipping Weight	41.7 lbs (18.9 kg)
Support	
Call	800.843.7231

External Blower
DREB XL



DREB XL Dimensions

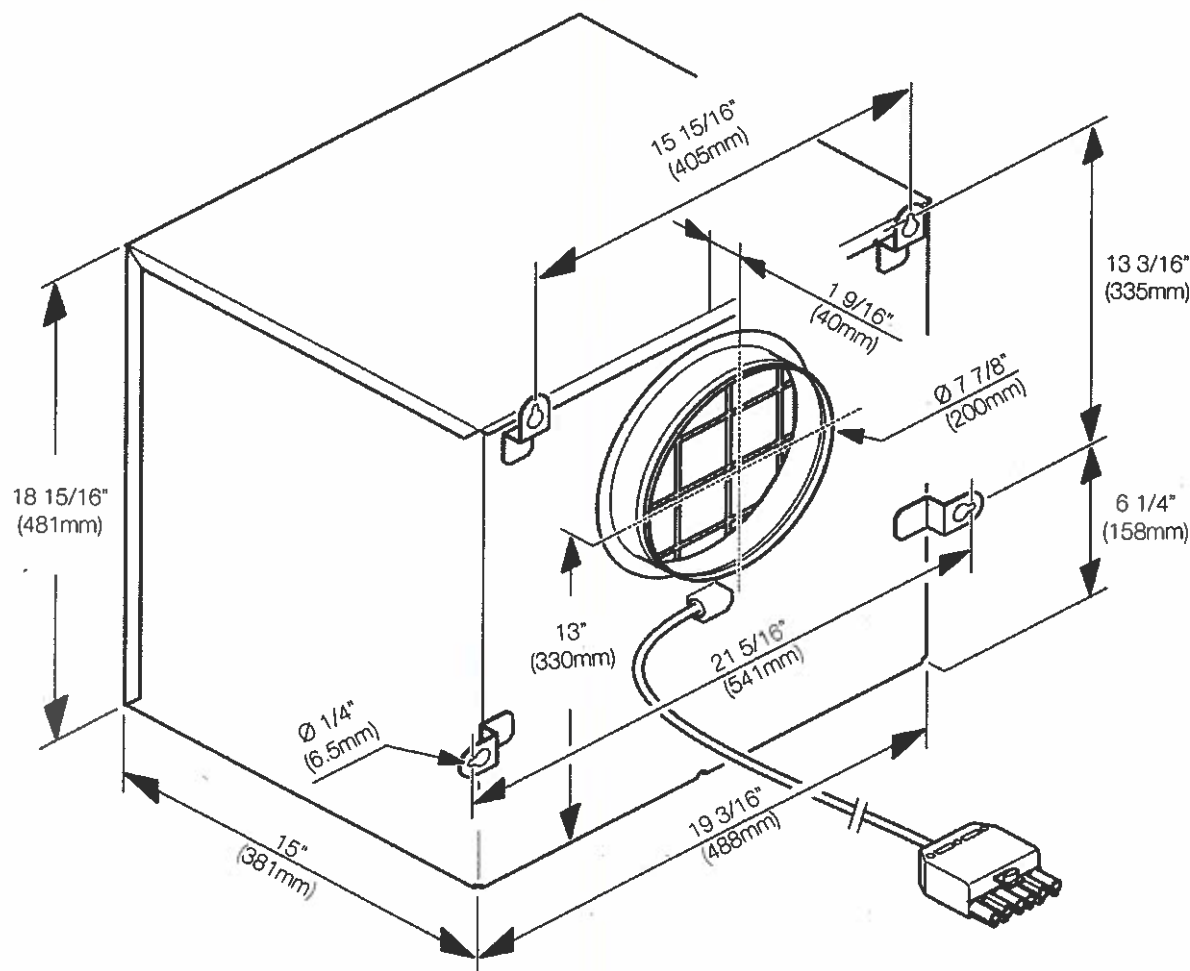

External Blower
DREB XL



Product Installation

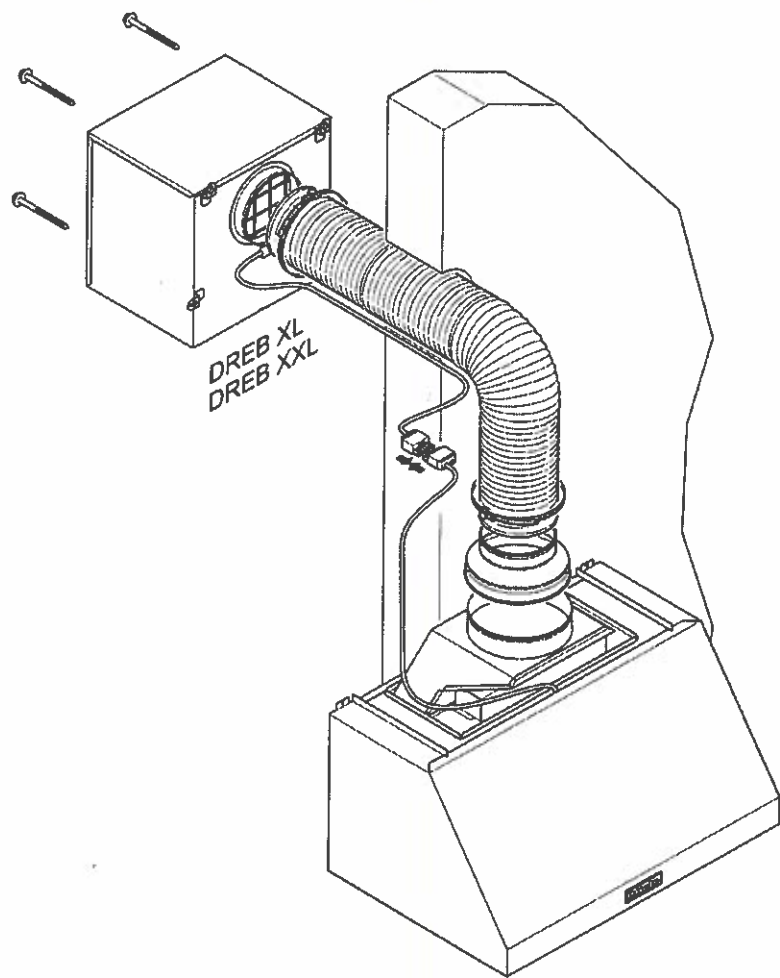

External Range Hood Blower

DREB XXL

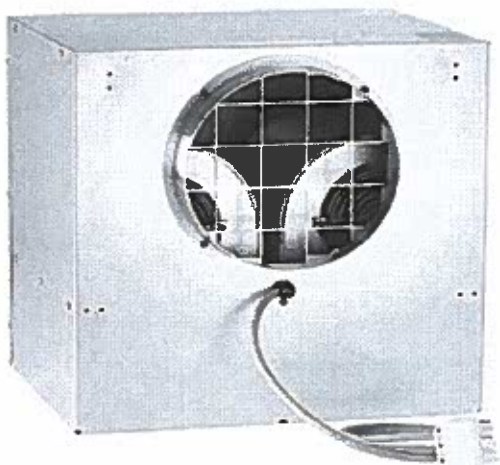

SPECIFICATIONS	
DREB XXL -- Item 28996348USA	
Overall Width - Excluding mounting Tab Dimension	19 ³ / ₁₆ " (488mm)
Overall Height - Excluding mounting Tab Dimension	18 ¹⁵ / ₁₆ " (481mm)
Overall Depth - Excluding mounting Tab Dimension	15" (381mm)
Mounting Tab Length - Past Blower Housing	1/2" (13mm)
Air Flow Rate	
CFM	1100 Max
Exhaust Ducting	
Recomened Duct Diameter	10" (254mm)
Electrical	
Electrical Requirements	120V, 60Hz, 15 Amps, 800W
Power Cord	Yes - 6 Pole Plug Connector
Shipping	
Shipping Weight	48.5 lbs (22 kg)
Support	
Call	800.843.7231

External Blower
DREB XXL



DREB XXL Dimensions

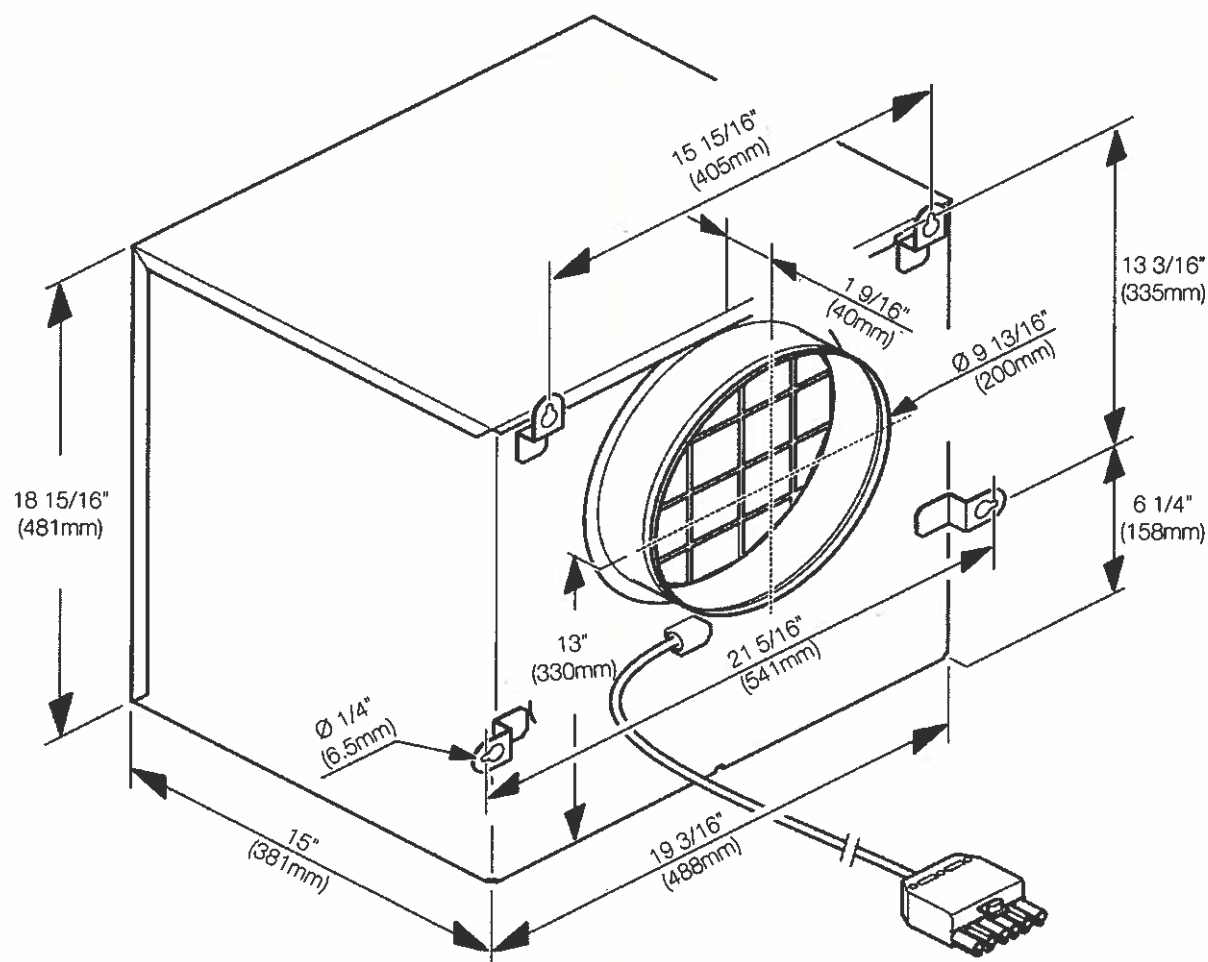

External Blower
DREB XXL



Product Installation

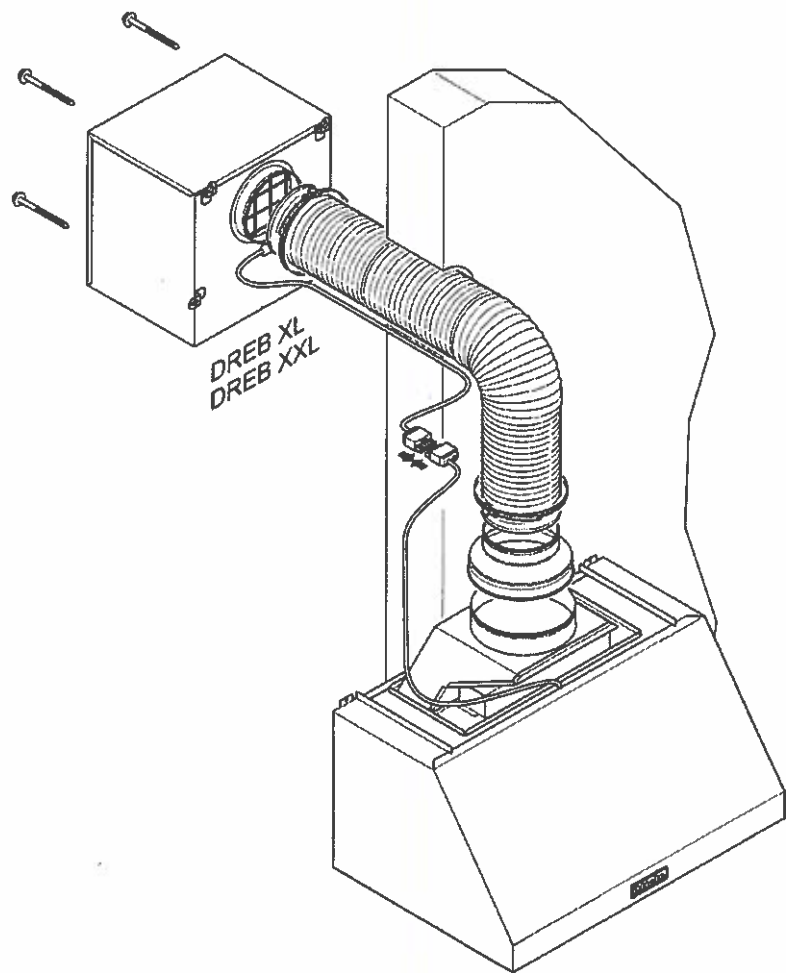

Internal Range Hood Blower

DRIB XL

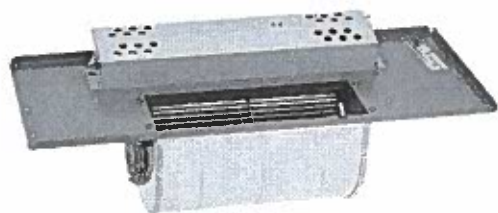

SPECIFICATIONS	
DRIB XL — Item 28996345USA	
Airflow Rate	
CFM	700
Exhaust Ducting	
Recomened Duct Diameter	8" (203mm)
Electrical	
Electrical Requirements	120V, 60Hz, 15 Amps, 615W
Power Cord	Yes - 6 Pole Plug Connector
Shipping	
Shipping Weight	34 lbs (15.4 kg)
Support	
Call	800.843.7231

INSTALLATION OPTIONS

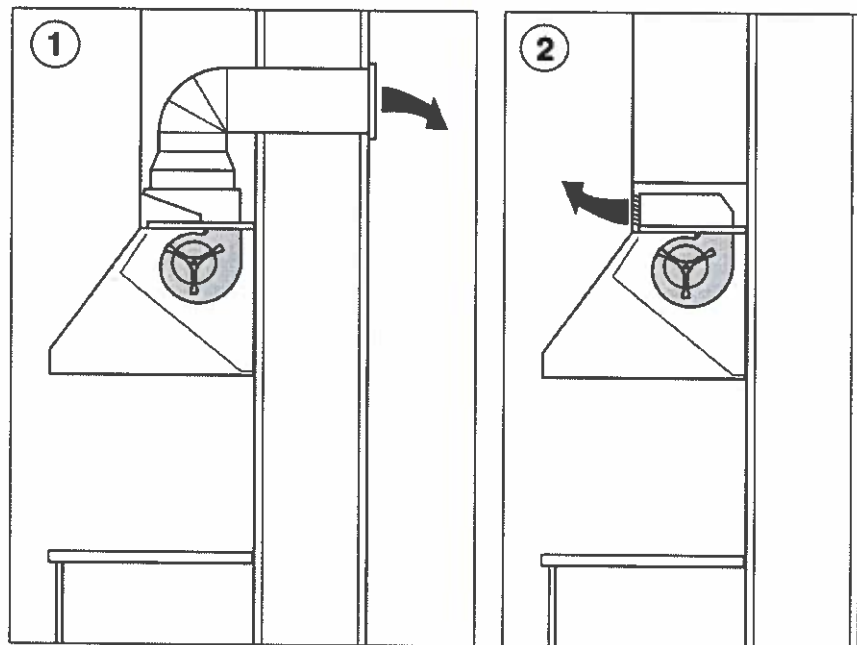

- ① Air extraction with internal blower DRIB XL or XXL.
- ② Recirculation with internal blower DRIB XL and conversion kit DRUU.

Internal Range Hood Blower

DRIB XXL



SPECIFICATIONS	
DRIB XXL — Item 28996346USA	
Air Flow Rate	
CFM	1100
Exhaust Ducting	
Recomened Duct Diameter	10" (254mm)
Electrical	
Electrical Requirements	120V, 60Hz, 15 Amps, 800W
Power Cord	Yes - 6 Pole Plug Connector
Shipping	
Shipping Weight	33.3 lbs (15.1 kg)
Support	
Call	800.843.7231

INSTALLATION OPTIONS

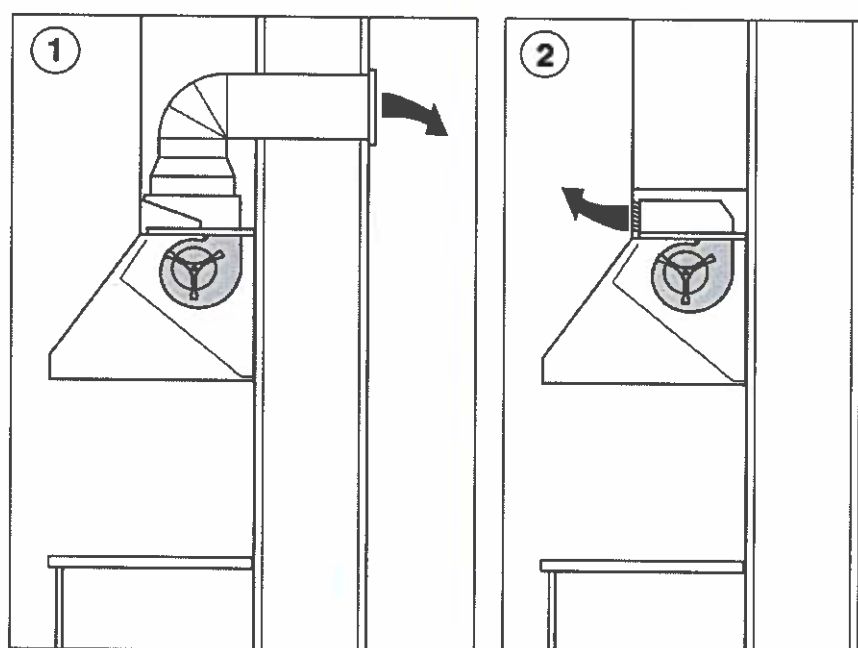

- ① Air extraction with internal blower DRIB XL or XXL.
- ② Recirculation with internal blower DRIB XL and conversion kit DRUU.

Miele

36" Range Hood

DAR 1230



36" Range Wall Hood
DAR 1230



DAR 1230

Features:

- Vented or Recirculating option
- Recessed knob controls
- M Pro Stainless Steel
- Dishwasher-safe stainless steel baffle filters
- 4 fan speeds including Intensive
- Hood interior with CleanCover
- LED ClearView lighting
- Auto-Vent safety sensor

SPECIFICATIONS	
DAR 1230 — Item 28123050USA	
Overall Unit Width	35 ¹³ / ₁₆ " (913mm)
Overall Height Without Duct Cover	18" (457mm)
Overall Unit Depth	24 ¹ / ₁₆ " (611mm)
Lighting	
Number of Lights and Wattage	3 LED lights @ 2 watts each
Fan	
Fan Speeds	4
Maximum CFM With DR*B XL	700 CFM
Maximum CFM With DR*B XXL	1100 CFM
Duct	
Recommended Duct Diameter With DR*B XL	8" (203 mm)
Recommended Duct Diameter With DR*B XXL	10" (254 mm)
Electrical	
Electrical Requirements	120V, 60Hz, 15 Amps
Power Cord	Yes - NEMA 5-15 plug, length 2' 6" (0.75 m)
Shipping	
Shipping Weight	103.6 lbs. (47kg)
Shipping Dimensions	41 ³ / ₁₆ " (1050mm) W x 28" (710mm) H x 29 ⁹ / ₁₆ " (740mm) D
Support	
Call Miele	800.843.7231
Miele Website	🌐www.mieleusa.com
20/20 Link	🌐2020technologies.com

INSTALLATION ACCESSORIES



DRIB XL

Internal Range Hood
Blower - 700 CFM



DRIB XXL

Internal Range Hood
Blower - 1100 CFM



DREB XL

External Range Hood
Blower - 700 CFM



DREB XXL

External Range Hood
Blower - 1100 CFM



DRRV 1200

Rear Venting Adapter

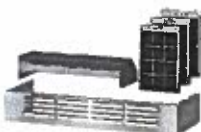

DRUU 36

Recirculation Kit - for use
with DRIB XL blower only

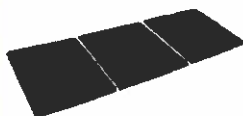

DKF 24-1

Replacement OdorFree
Charcoal filter for
Recirculation Kit



RBS36

40" tall by 36" wide flat stainless steel
Backsplash panel

36" Range Wall Hood
DAR 1230



PRODUCT SPECIFICATIONS

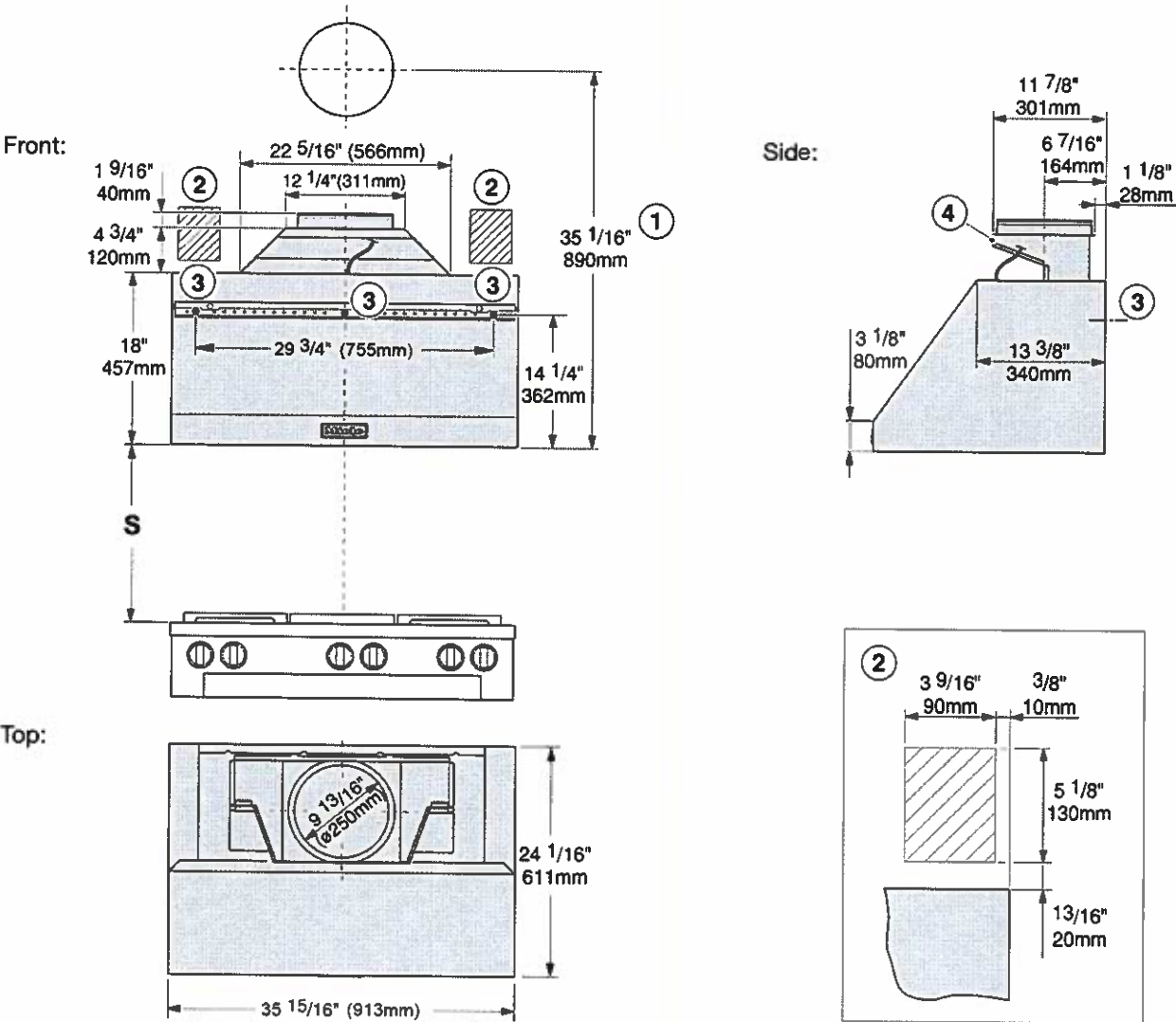

- ① Minimum height required for exhaust air penetration when using a vent duct.
- ② Recommended installation area for the electrical connection.
- ③ Attachment points: there must be a sub-construction capable of bearing the load in the area of the attachment point.
- ④ The vent collar is not used for recirculation mode.

36" Range Wall Hood
DAR 1230



DISTANCE BETWEEN COOKTOP
AND VENTILATION HOOD (S)

	Distance between cooktop and ventilation hood (S)			
Miele Range Wall / Insert Hood	DAR 1120, DAR 1220 (30")	DAR 1130, DAR 1230 (36")		DAR 1150, DAR 1250 (48")
Internal / External Miele blowers	DRIB/DREB XL (700 cfm)	DRIB/DREB XL (700 cfm)	DRIB/DREB XXL (1100 cfm)	DRIB/DREB XXL (1100 cfm)
Miele electric cooktops	24" (610 mm)			
Miele barbeque and fryer (electric)	26" (660 mm)			
Multi-burner Miele gas cooktop, ≤ 43,000 BTU/h (12.6 kW), none of the burners > 19,800 BTU/h (5.8 kW)	26" (660 mm)			
Multi-burner Miele gas cooktop, > 43,000 BTU/h (12.6 kW) and ≤ 92,200 BTU/h (27.0 kW), none of the burners > 19,800 BTU/h (5.8 kW)	30" (760 mm)			
Multi-burner Miele gas cooktop, > 92,200 BTU/h (27.0 kW) and ≤ 112,600 BTU (33.0 kW), none of the burners > 19,800 BTU/h (5.8 kW)	not possible	36" (910 mm)	30" (760 mm)	
Multi-burner Miele gas cooktop, > 112,200 BTU/h (33.0 kW) and ≤ 142,600 BTU (41.8 kW) none of the burners > 19,800 BTU/h (5.8 kW)	not possible		36" (910 mm)	
Multi-burner Miele gas cooktop, > 142,600 BTU/h (41.8 kW)	not possible			
Multi-burner Miele gas cooktop, one of the burners > 19,800 BTU/h (5.8 kW)	not possible			
Miele single-burner gas cooktop (wok) ≤ 20,500 BTU/h (6.0 kW)	26" (660 mm)			
Miele single-burner gas cooktop (wok) > 20,500 BTU/h, (6.0 kW), ≤ 27,600 BTU/h (8.1 kW)	30" (760 mm)			
Miele single-burner gas cooktop (wok) > 27,600 BTU/h (8.1 kW)	not possible			

36" Range Wall Hood
DAR 1230



Recirculation Kit
DRUU 36

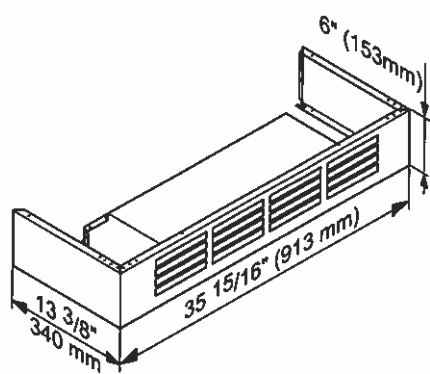

Note: Duct Covers can be stacked on top of Recirculation Kit

Duct Cover Options
DRDC 3624 - 24" height
DRDC 3618 - 18" height
DRDC 3612 - 12" height
DRDC 3606 - 6" height

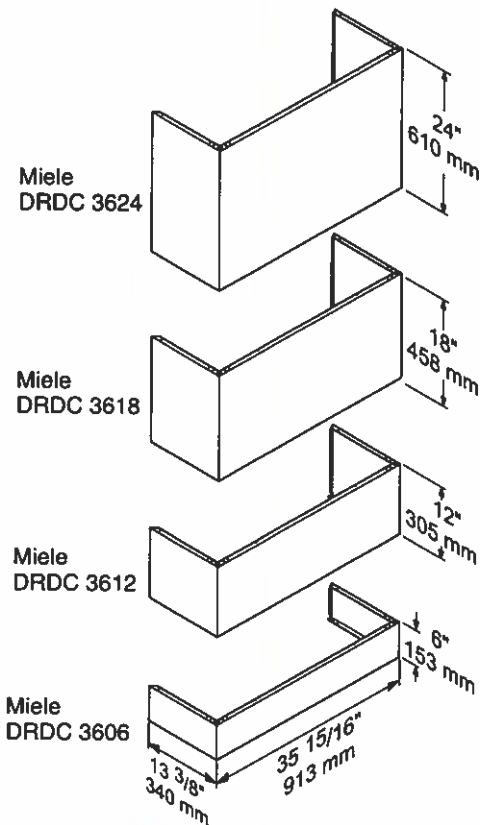

HOOD-BLOWER COMBINATION GUIDE

The following appliance combinations are possible:

	Extraction mode with internal blower	Vented mode with external blower	Recirculation mode	Ducting cover
Range Insert DAR 1120 (30")	Blower DRIB XL or DRIB XXL*	Blower DREB XL or DREB XXL*	-	-
Range Insert DAR 1130 (36")	Blower DRIB XL or DRIB XXL	blower DREB XL or DREB XXL	-	-
Range Insert DAR 1150 (36")	Blower DRIB XXL	Blower DREB XXL	-	-
Range Wall Hood DAR 1220 (30")	Blower DRIB XL or DRIB XXL*	Blower DREB XL or DREB XXL*	blower DRIB XL + recirculation kit DRUU 30**	DRDC 3006 (6") DRDC 3012 (12") DRDC 3018 (18") DRDC 3024 (24")
Range Wall Hood DAR 1230 (36")	Blower DRIB XL or DRIB XXL	blower DREB XL or DREB XXL	Blower DRIB XL + recirculation kit DRUU 36**	DRDC 3606 (6") DRDC 3612 (12") DRDC 3618 (18") DRDC 3624 (24")
Range Wall Hood DAR 1250 (48")	Blower DRIB XXL	Blower DREB XXL	-	DRDC 4806 (6") DRDC 4812 (12") DRDC 4818 (18") DRDC 4824 (24")
Range wall hood DAR 1260 (60")	Blower DRIB XXL	Blower DREB XXL	-	DRDC 6006 (6") DRDC 6012 (12") DRDC 6018 (18") DRDC 6024 (24")

*not recommended

**The DRDC duct cover can also be installed above the recirculation kit panel.

36" Range Wall Hood DAR 1230



DRIB XL
INTERNAL RANGE HOOD BLOWER
(Optional Accesory) 700 CFM



DRIB XXL
INTERNAL RANGE HOOD BLOWER
(Optional Accesory) 1100 CFM

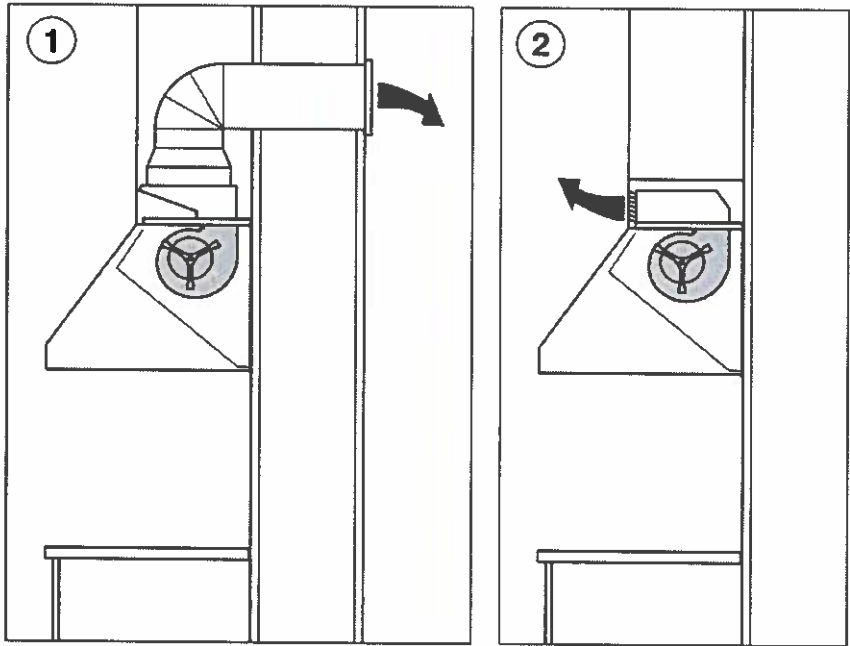

- ① Air extraction with internal blower DRIB XL or XXL.
- ② Recirculation with internal blower DRIB XL and conversion kit DRUU.

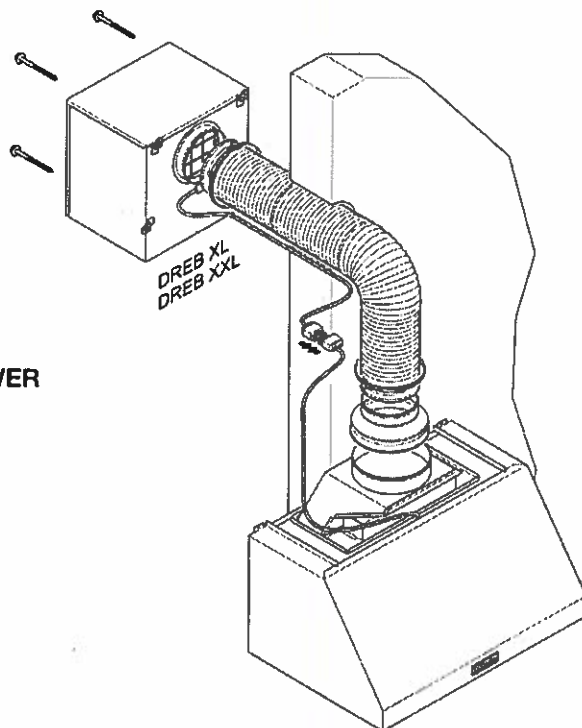
Miele[illegible]

ØA: DREB XL - Ø 7 7/8" (200mm)
ØB: DREB XXL - Ø 9 13/16" (254mm)

36" Range Wall Hood
DAR 1230



DRRV 1200 REAR VENTING ADAPTER
(Optional Accesory)



Side:

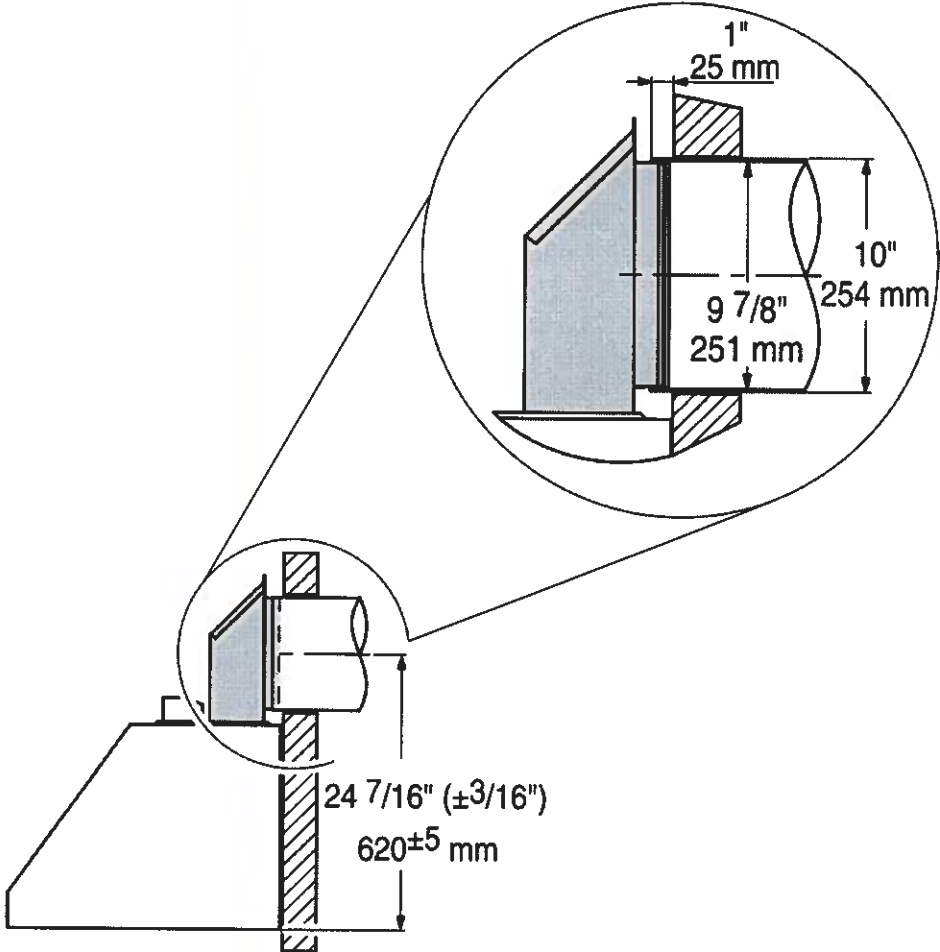

Front:

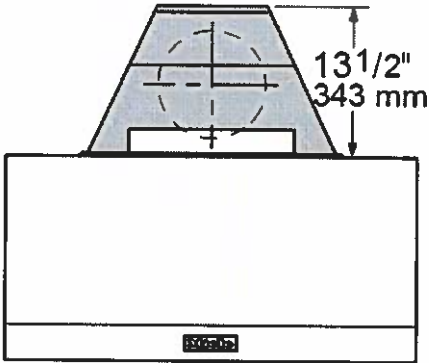

Miele

32" Built-In Ventilation Hood

DA 2588



Shown: DA 2588 over KM 3464
Please note: This information is subject to change

 mieleusa.com
Specification Sheets TRS 10082018



32" Built-In Ventilation Hood

SPECIFICATIONS	
Overall Unit Dimensions	31 ⁹ / ₁₆ " (802 mm) W x 12 ⁷ / ₈ " (326 mm) H x 15 ¹³ / ₁₆ " (402 mm) D
Built-In	
Minimum Opening Dimensions	30 ⁵ / ₁₆ " (770 mm) W x 14 ⁹ / ₁₆ " (370 mm) D
Minimum Opening Thickness	⁵ / ₈ " (16 mm)
Maximum Opening Thickness	1 ³ / ₈ " (35 mm)
Fan	
Fan Speeds	4
Maximum CFM	625 CFM, (Reducing Collar is available to reduce Air flow to less than 400 CFM)
Duct	
Recommended Duct Diameter	6" (150 mm)
Electrical	
Electrical Requirements	120V, 60Hz, 15A
Power Cord	Molded NEMA 5-15 plug, 2.5 ft (0.75 m)
Shipping	
Shipping Weight	40.4 lbs (18.3 kg)
Shipping Dimensions	46 ¹ / ₁₆ " W x 21 ⁷ / ₈ " H x 18 ¹ / ₂ " D
Optional Accessories	
Recirculation Kit (Round)	DUU 150
Recirculation Kit (Rectangle)	DUU 151
OdorFree Charcoal Filter	DKF 15-900
CFM Reducing Collar	R2000
Support	
Call Miele	(800) 999-1360
Miele Website	www.mieleusa.com
20/20 Link	2020technologies.com



DA 2588
Item 28258855USA

32" Built-In Ventilation Hood

INSTALLATION SPECIFICATIONS

Product Dimensions

Front View

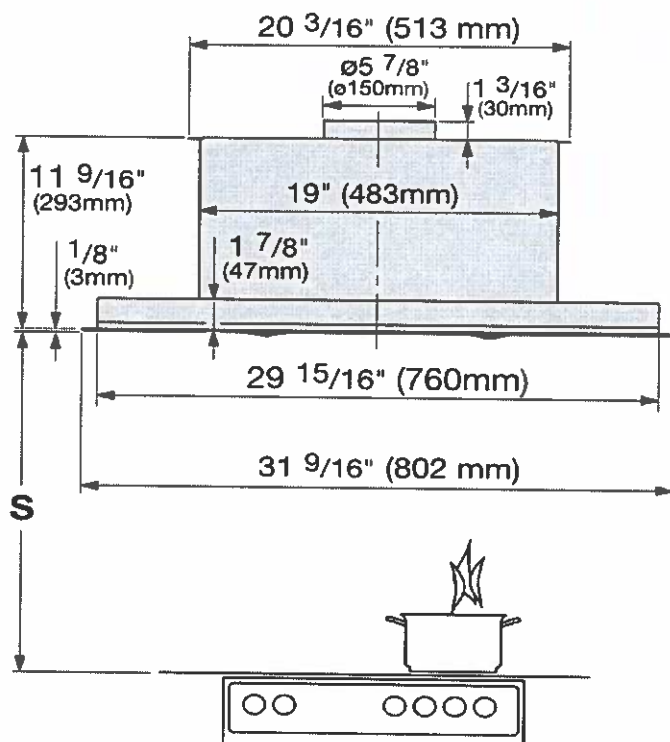

Side View

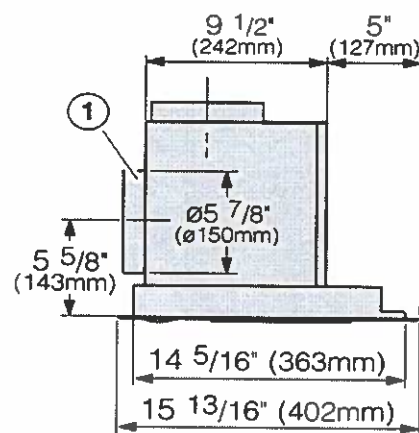

① The ducting can also be connected at the back.

Top View

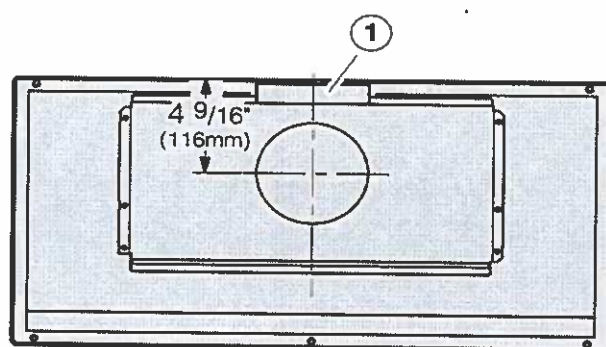

① The ducting can also be connected at the back.

Niche/Cutout Dimensions

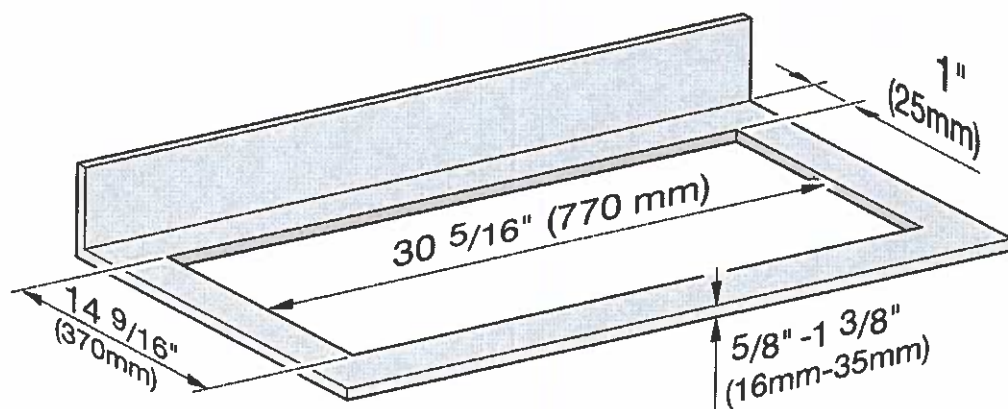

Drawings are not to scale



32" Built-In Ventilation Hood

INSTALLATION SPECIFICATIONS
Distance Between Cooktop and
Ventilation Hood (S)

Provided a larger distance is not given by the manufacturer of the cooktop, follow the minimum safety distances between a cooktop and the bottom of the hood.
Please also observe the information contained in the "IMPORTANT SAFETY INSTRUCTIONS" section of the manual.

Cooking appliance	Minimum distance S	
	Miele products	Non-Miele products
Electric Cooktops	24" (610 mm)	
Electric Barbeques and Fryers	26" (660 mm)	
Multiburner Gas Cooktops ≤ 43,000 BTU/hr (12.6 W), no burner > 15,000 BTU/hr (4.5 kW).	26" (660 mm)	30" (760 mm)
Multiburner Gas Cooktops ≤ 73,800 BTU/hr (21.6 W), no burner > 16,500 BTU/hr (4.8 kW)	30" (760 mm)	
Multiburner Gas Cooktops > 73,800 BTU/hr (21.6 W), or one of the burners > 16,500 BTU/hr (4.8 kW)	Not possible	
Single Burner Gas Cooktops ≤ 20,500 BTU/hr (6 kW)	26" (660 mm)	30" (760 mm)
Single Burner Gas Cooktops > 20,500 BTU/hr (6 kW) ≤ 27,600 BTU/hr (8.1 kW)	30" (760 mm)	
Single Burner Gas Cooktops > 27,600 BTU/hr (8.1 kW)	Not possible	

If you are installing a front panel made of wood or plastic to the hood, observe the safety distances given by the cooktop manufacturer regarding the use of easily flammable materials.

Recirculation Kit DUU 150
(Optional Accessory)

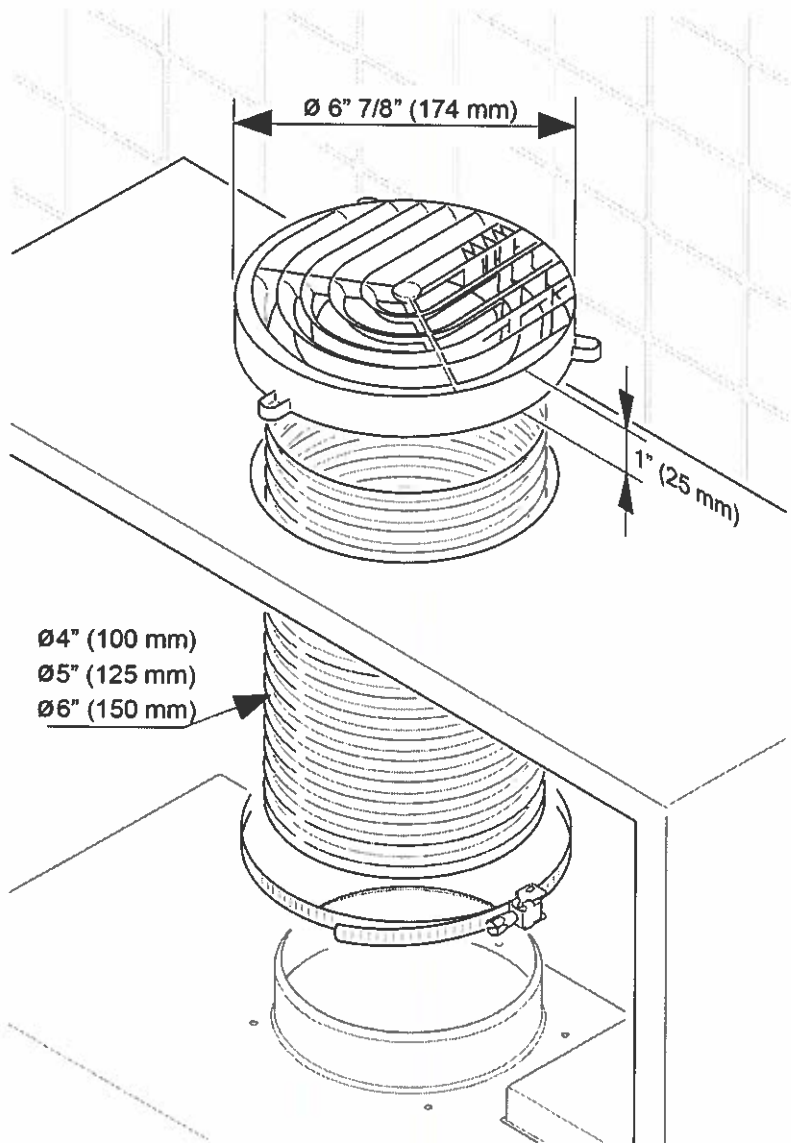

Recirculation Kit DUU 151
(Optional Accessory)

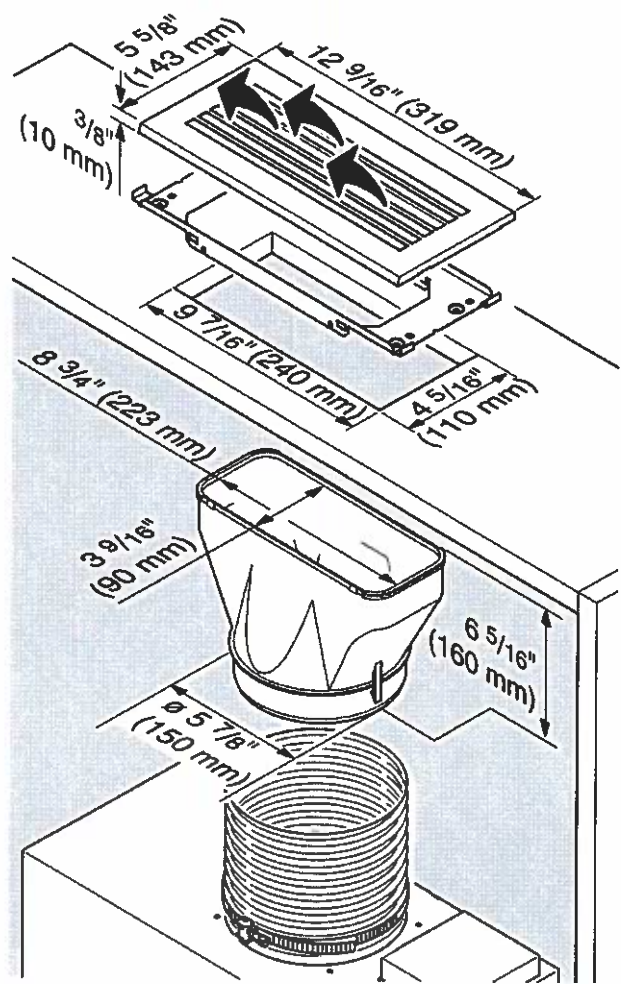

Reducing Collar
(Optional Accessory)

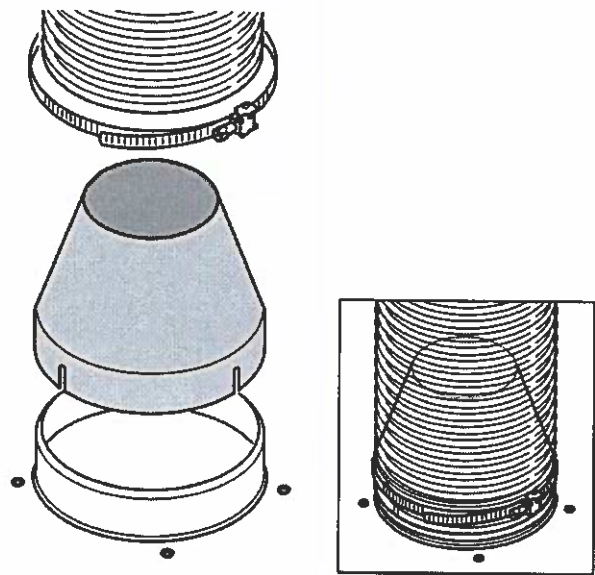

If you would like to reduce the enviromental impact of your ventilation system by limiting the CFM output the Reducing Collar can be installed. It reduces the air flow to less than 400 CFM. Check local building codes for maximum CFM requirements.

Miele

Fully Integrated
18" MasterCool

F 2412 Vi

F 2462 Vi / F 2472 Vi

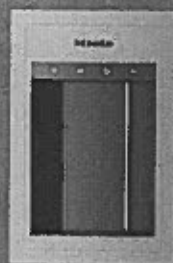

Shown: F 2472 Vi merged with K 2802 Vi

Info subject to change

mieleusa.com

Miele Help Desk (P): (800) 999-1360

Fully Integrated
18" MasterCool

SPECIFICATIONS		
Overall Unit Dimensions	17 ³ / ₄ " (451 mm) W x 83 ³ / ₄ " - 85 ³ / ₁₆ " (2127 - 2164 mm) H x 24" (610 mm) D [Depth does not include door panel]	
Niche		
Minimum Cabinet Niche Opening	18" (458 mm) W" x 84" - 85 ³ / ₁₆ " (2134 - 2164 mm) H x 24 ³ / ₄ " (629 mm) D	
Electrical	F 24x2 Vi	
Electrical Requirements	110V / 120V, 60Hz, 15 Amps In the case of side-by-side installations, a separate outlet must be used for each appliance.	
Power Cord	NEMA 5-15 plug, 5 ft (1.52 m)	
Plumbing	F 24x2 Vi	
Water Supply Requirements	Connect to a cold water supply only. Do not connect to a low-mineral or a reverse osmosis system. Must be connected to a shut-off valve. The water shut-off valve must be accessible after installation. The water pressure must be between 29 psi (2 bar) and 116 psi (8 bar). If the pressure is higher than 120 psi (8.3 bar), a pressure reducing valve must be installed.	
Water Connection Line	Standard 1/4" O.D flexible water line. The maximum outer diameter of the water pipe (without fittings): 3/8" (10 mm). Water line is not included.	
Shipping	F 2412 Vi	F 2462 Vi / F 2472 Vi
Shipping Weight	306 lbs (139 kg)	328 lbs (149 kg)
Shipping Dimensions	21 ¹ / ₁₆ " (535 mm) W x 84 ¹ / ₄ " (1,240 mm) H x 29 ⁷ / ₈ " (759 mm) D	

Please note the following:

- This specification sheet is for a single built-in unit.
- When combining multiple MasterCool units side-by-side, please refer to the Merging Kit specification sheet.

"If design calls for a partition less than 6 ⁵/₁₆" (160 mm) the left unit's cutout will require an additional ¹/₈" (3 mm) to the width to allow installation of the Heating Mat/Merge Kit.

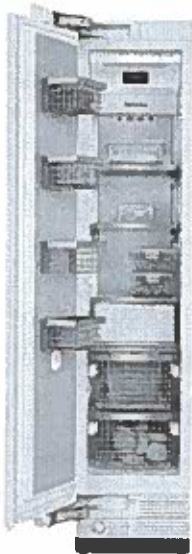

F 2412 Vi (Left Hinged)
Material# 11503300

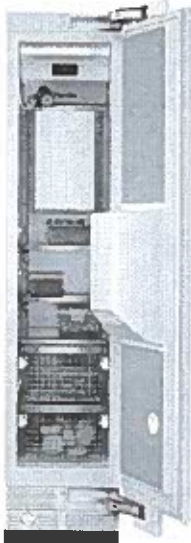

F 2462 Vi (Right Hinged)
Material# 11503420
F 2472 Vi (Left Hinged)
Material# 11503430

Fully Integrated 18" MasterCool

CUTOUT DIMENSIONS

- Niche depth assumes a 3/4" (19 mm) panel, please adjust according to custom panel thickness

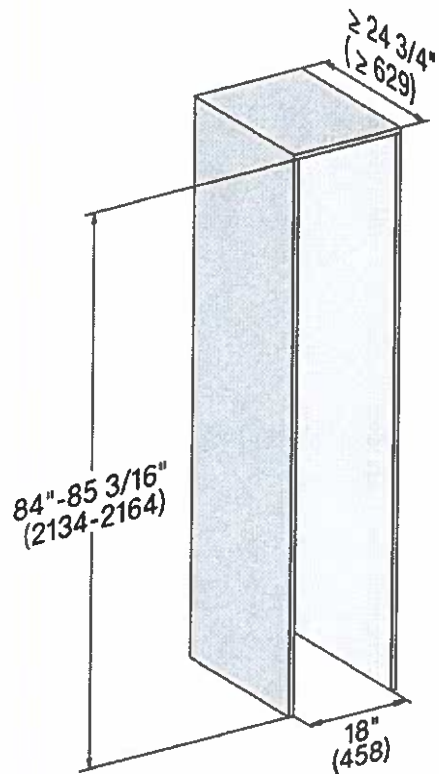

CUTOUT DETAILS

- The electrical connection must not be positioned higher than 9" (228.6 mm) above the floor.
- The 1/4" (6.4 mm) plumbed water connection should not be positioned higher than 2" (50.8 mm) above the floor.

Notes:

In case of an emergency the electrical outlet must be easily accessible and must not be concealed behind the appliance.

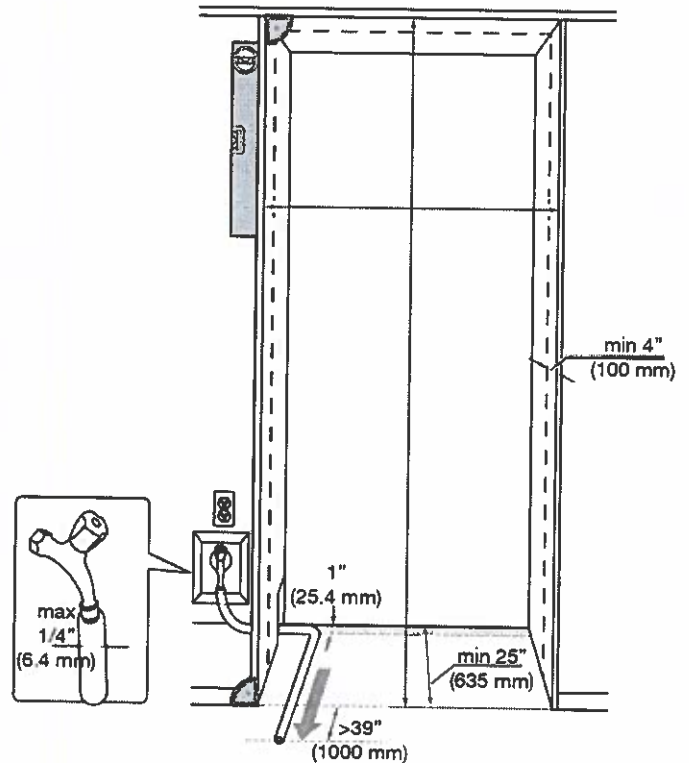

Fully Integrated 18" MasterCool

POWER SUPPLY AND WATER CONNECTION

Rear View

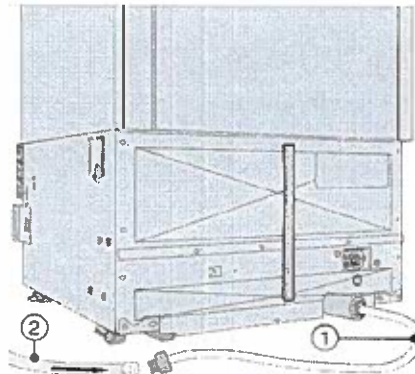

Water Connection:

- 1/4" water line is required
- Located at the rear of the appliance on a 4' 11" line.
- 1/4" compression fitting, ready to accept 1/4" line.

Side View

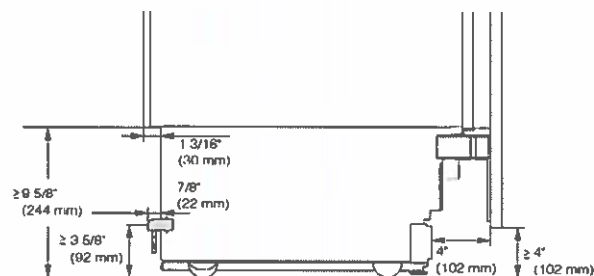

Notes:

- In case of an emergency the electrical outlet and water shutoff must be easily accessible and must not be concealed behind the appliance.
- In the event that connection points are located behind the unit the electrical outlet and water connection should be located no higher than 9 5/8" from the floor.

CUSTOM PANEL INSTALLATIONS

For Models:
• F 2412 Vi

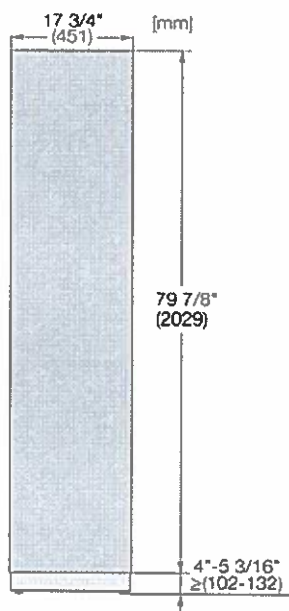

Max. Panel Weight:134 lbs

Optional Accessory:
Clean Touch Steel Panel:
• KFP1805
Material# 11499020

For Models:
• F 2462 Vi • F 2472 Vi

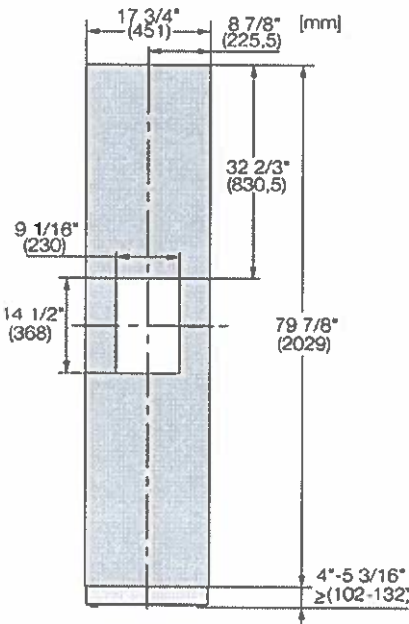

Max. Panel Weight:159 lbs

Optional Accessory:
Clean Touch Steel Panel:
• KFP1845
Material# 11499570

PANELS NOTES

If the adjoining cabinets are taller than the height of the machine the panel may be extended accordingly

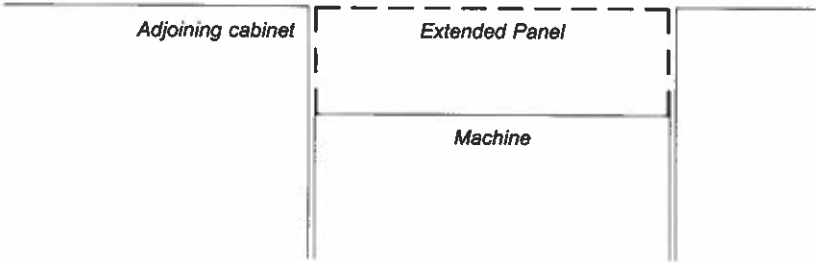



Fully Integrated
18" MasterCool

HINGING DETAILS 115° OPENING

Available for the following models:
• F 24x2 Vi

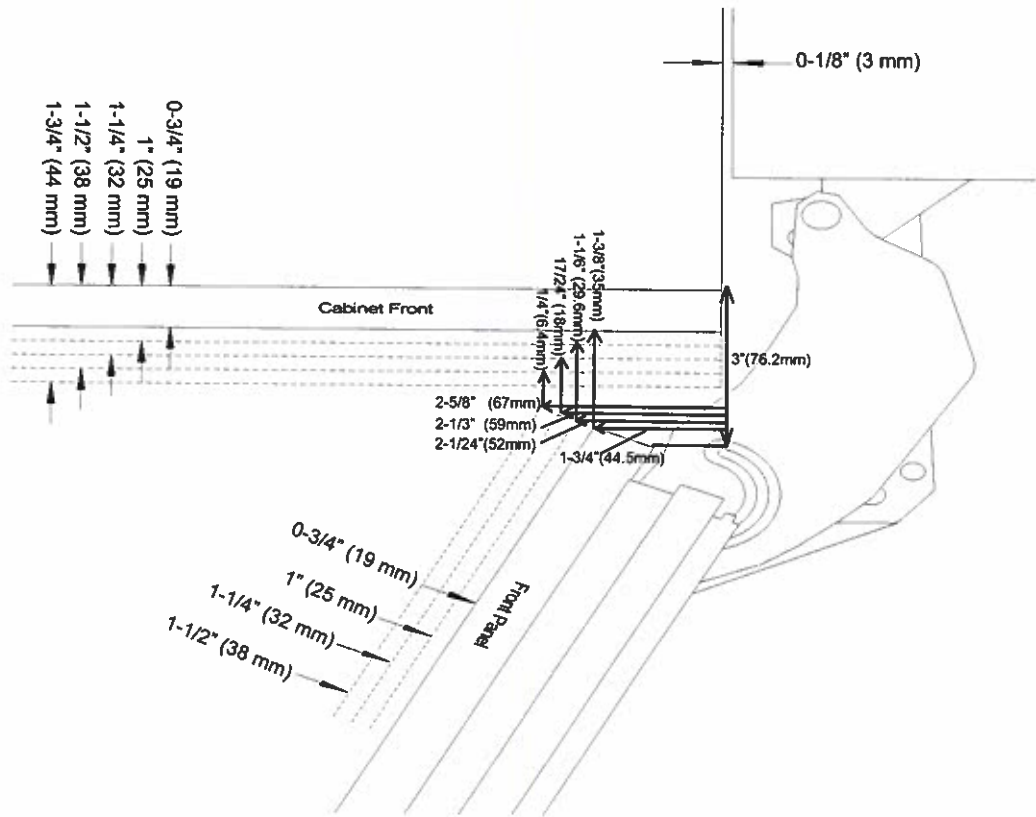

DOOR SWING AT 115° OPENING

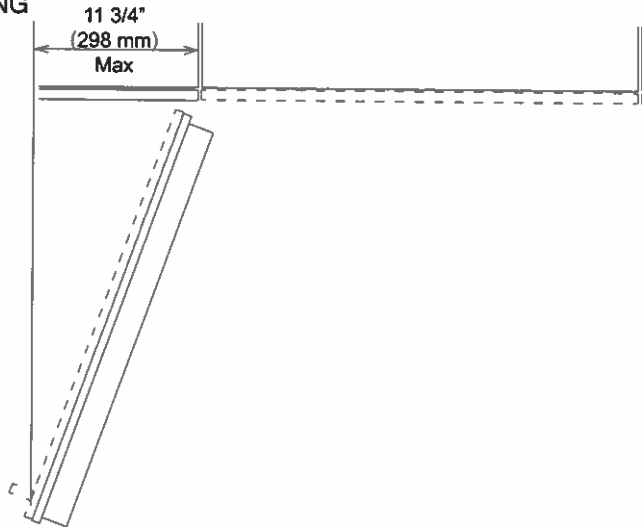

NOTE: Additional space needed depending on
thickness of front panels and handle used

Miele

Fully Integrated 30" MasterCool

All Refrigerator:

K 2802 Vi / K 2812 Vi

All Freezer:

F 2802 Vi / F 2812 Vi

Bottom Mount:

KF 2802 Vi / KF 2812 Vi

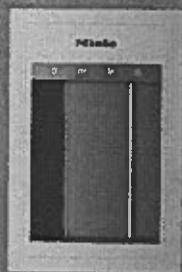

Shown: F 2472 Vi merged with K 2802 Vi

Info subject to change

mieleusa.com

Miele Help Desk (P): (800) 999-1360

Miele

Fully Integrated 30" MasterCool

SPECIFICATIONS			
Overall Unit Dimensions	29 ³ / ₄ " (756 mm) W x 83 ³ / ₄ " - 85 ³ / ₁₆ " (2127 - 2164 mm) H x 24" (610 mm) D [Depth does not include door panel]		
Niche			
Minimum Cabinet Niche Opening	30" (762 mm) W" x 84" - 85 ³ / ₁₆ " (2134 - 2164 mm) H x 24 ³ / ₄ " (629 mm) D		
Electrical	K 28x2 Vi	F 28x2 Vi	KF 28x2 Vi
Electrical Requirements	110V / 120V, 60Hz, 15 Amps In the case of side-by-side installations, a separate outlet must be used for each appliance.		
Power Cord	NEMA 5-15 plug, 5 ft (1.52 m)		
Plumbing	K 28x2 Vi	F 28x2 Vi	KF 28x2 Vi
Water Supply Requirements	-	Connect to a cold water supply only. Do not connect to a low-mineral or a reverse osmosis system. Must be connected to a shut-off valve. The water shut-off valve must be accessible after installation. The water pressure must be between 29 psi (2 bar) and 116 psi (8 bar). If the pressure is higher than 120 psi (8.3 bar), a pressure reducing valve must be installed.	
Water Connection Line	-	Standard 1/4" O.D flexible water line. The maximum outer diameter of the water pipe (without fittings): 3/8" (10 mm). Water line is not included.	
Shipping	K 28x2 Vi	F 28x2 Vi	KF 28x2 Vi
Shipping Weight	395 lbs (179 kg)	399 lbs (181 kg)	450 lbs (204 kg)
Shipping Dimensions	33 ⁵ / ₈ " (950 mm) W x 89 ¹³ / ₁₆ " (1,294 mm) H x 29 ¹ / ₄ " (800 mm) D		

Please note the following:

- This specification sheet is for a single built-in unit.
- When combining multiple MasterCool units side-by-side, please refer to the Merging Kit specification sheet.

*If design calls for a partition less than 6 ⁵/₁₆" (160 mm) the left unit's cutout will require an additional ¹/₈" (3 mm) to the width to allow installation of the Heating Mat/Merge Kit.



K 2802 Vi (Right Hinged)
Material# 11502590

K 2812 Vi (Left Hinged)
Material# 11502640

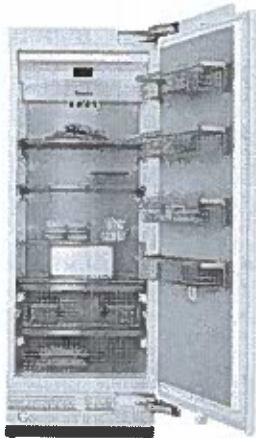

F 2802 Vi (Right Hinged)
Material# 11503330

F 2812 Vi (Left Hinged)
Material# 11503340

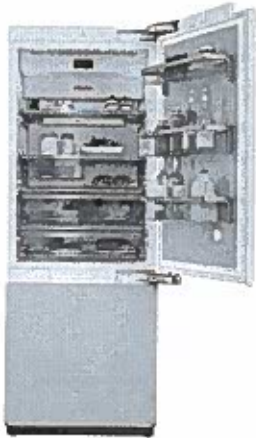

KF 2802 Vi (Right Hinged)
Material# 11502850

KF 2812 Vi (Left Hinged)
Material# 11502870

CUTOUT DIMENSIONS

- Niche depth assumes a 3/4" (19 mm) panel, please adjust according to custom panel thickness

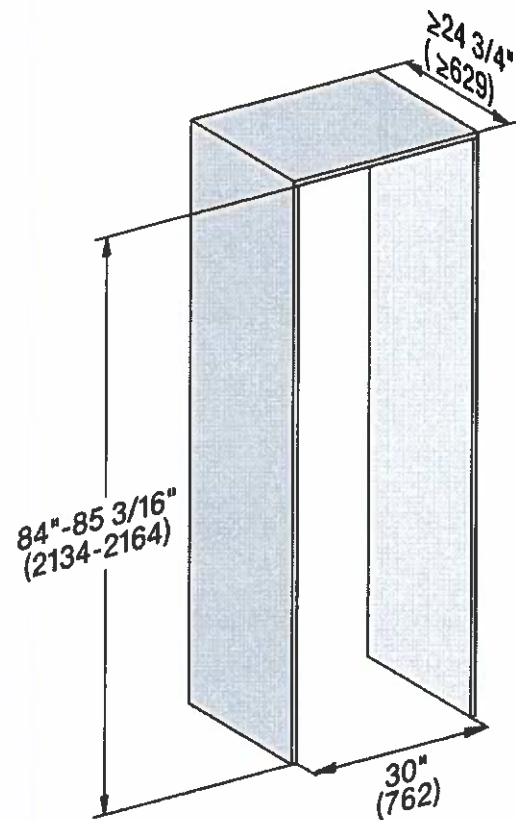

CUTOUT DETAILS

- The electrical connection must not be positioned higher than 9" (228.6 mm) above the floor.
- The 1/4" (6.4 mm) plumbed water connection should not be positioned higher than 2" (50.8 mm) above the floor.

Notes:

In case of an emergency the electrical outlet must be easily accessible and must not be concealed behind the appliance.

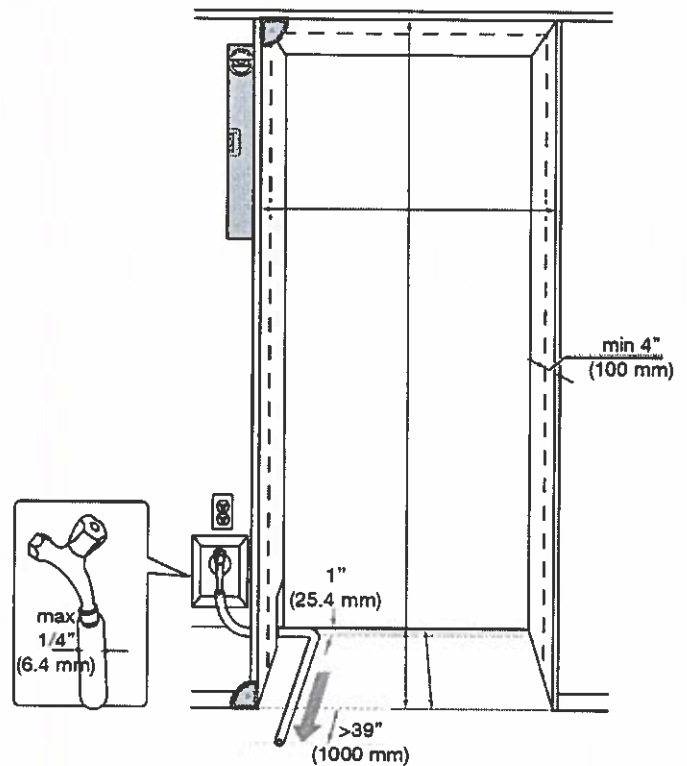

POWER SUPPLY AND WATER CONNECTION (Water Connection For F 28x2 Vi & KF 28x2 Vi Only)

Rear View

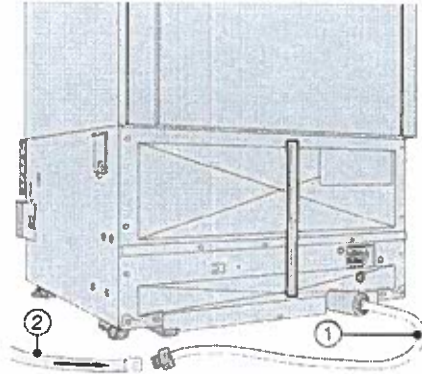

Water Connection:

- 1/4" water line is required
- Located at the rear of the appliance on a 4' 11" line.
- 1/4" compression fitting, ready to accept 1/4" line.

Side View

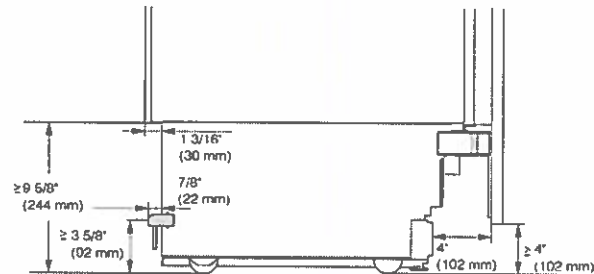

Notes:

- In case of an emergency the electrical outlet and water shutoff must be easily accessible and must not be concealed behind the appliance.
- In the event that connection points are located behind the unit the electrical outlet and water connection should be located no higher than 9 5/8" from the floor.



Fully Integrated
30" MasterCool

CUSTOM PANEL INSTALLATIONS

- For Models:
- F 2802 Vi • F 2812 Vi
 - K 2802 Vi • K 2812 Vi

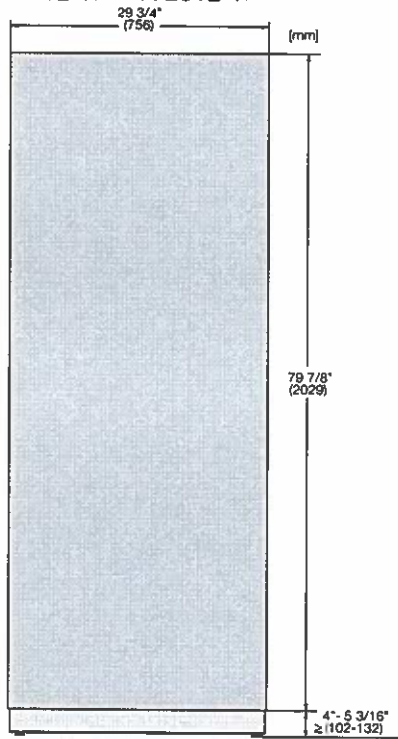

Max. Panel Weight:
F 28x2 Vi - 77 lbs
K 28x2 Vi - 106 lbs

Optional Accessory:
Clean Touch Steel Panel:
• KFP 3005
Material# 11499080

- For Models:
- KF 2802 Vi • KF 2812 Vi

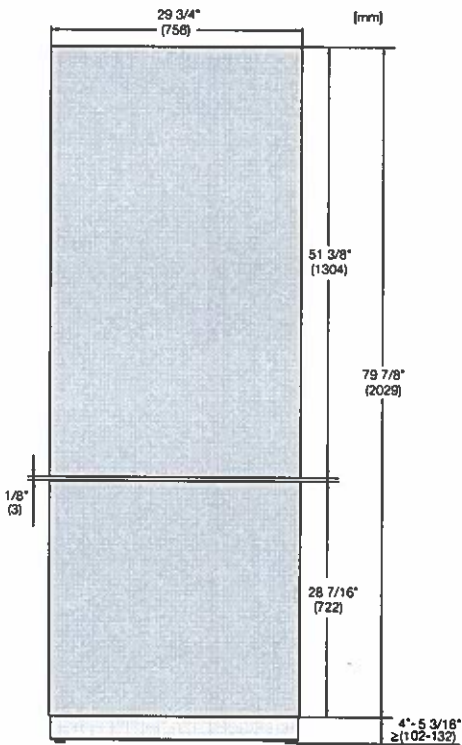

Max. Top Panel Weight: 99 lbs
Max. Bottom Panel Weight: 39 lbs

Optional Accessory:
Clean Touch Steel Panel:
• KFP 3015 - Top Panel
Material# 11499120
• KFP 3025 - Bottom Panel
Material# 11499130

Panel Notes

If the adjoining cabinets are taller than the height of machine (HOM) - the front panel may be extended accordingly. Simply maintain the toe kick height and extend the panel the needed distance.

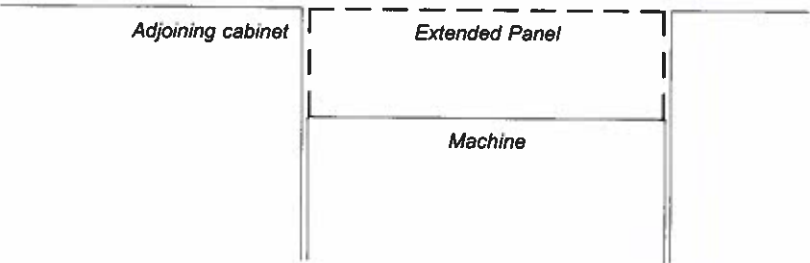

HINGING DETAILS 115° OPENING

Available for the following models:

- K 28x2 Vi
- F 28x2 Vi
- KF 28x2 Vi

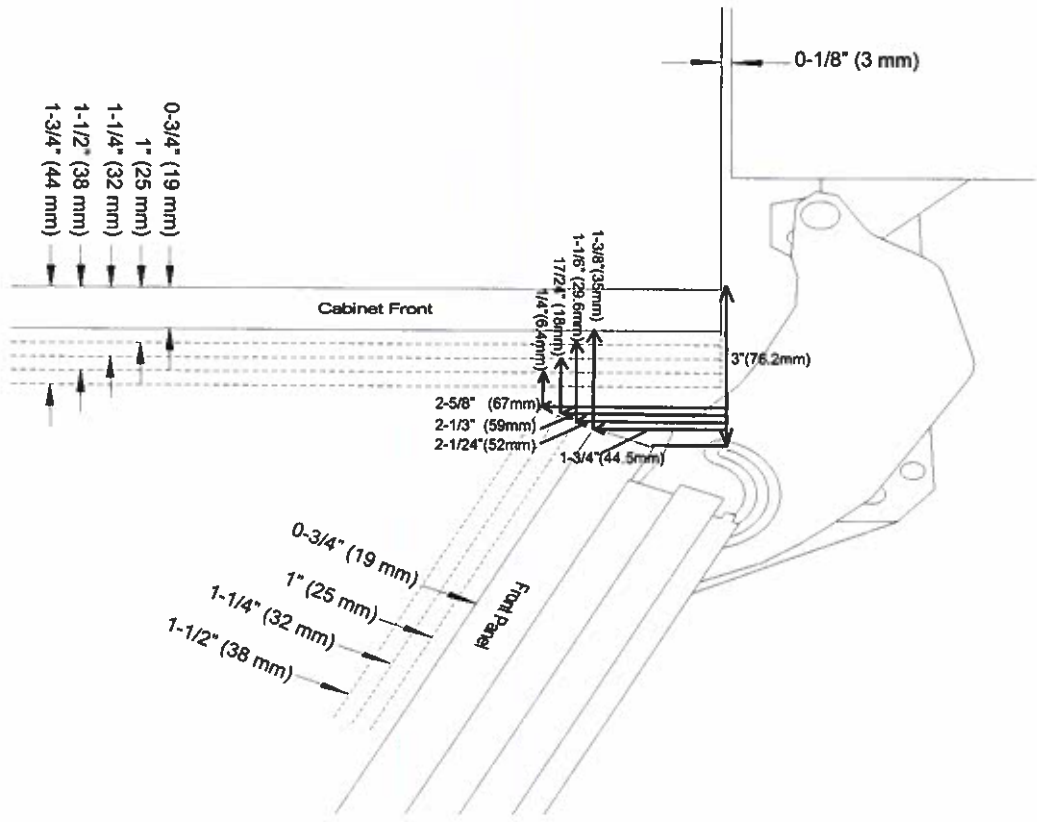

Top View)
(K29x2Vi, F29x2Vi, KF29x2Vi)

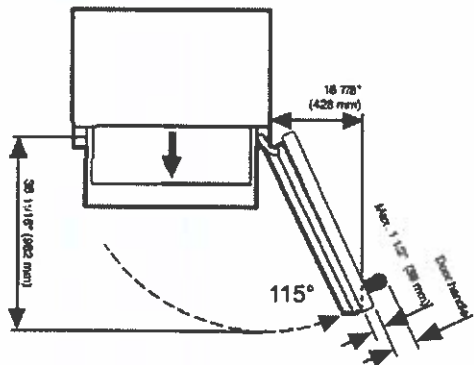

Fully Integrated
30" MasterCool



HINGING DETAILS 90° OPENING

Available for the following models:
• K 28x2 Vi
• KF 28x2 Vi

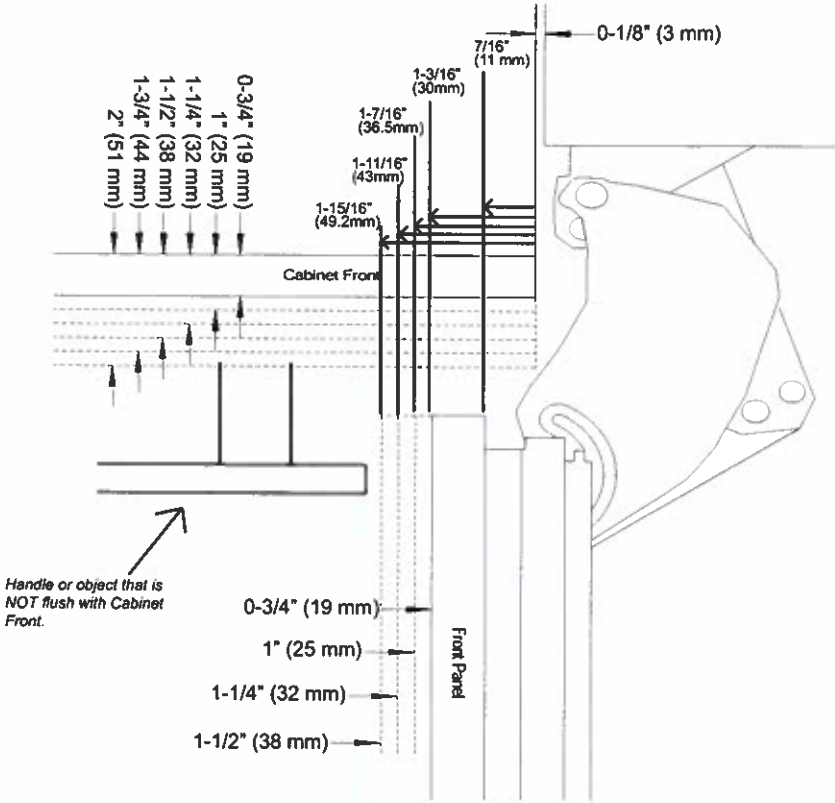

Top View)
(K29x2Vi, F29x2Vi, KF29x2Vi)

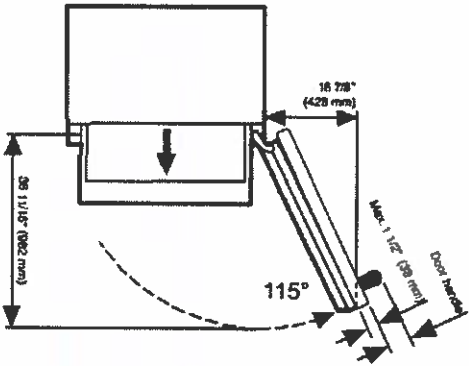



30" Convection Oven - PureLine

- M-Touch Display with Motion React - Simple to use touch controls
- FoodView and Miele@Home - see your food from anywhere with an in-oven camera
- Wireless precision probe - For simple and precise results
- Moisture Plus - a burst of steam for professional quality cooking results at home
- Direct Water - No need to fill any water tanks
- Taste Control - Prevents overcooked dishes



- 1 Perforated baking tray
- 1 Universal baking tray
- 2 Self Clean Ready Baking and Roasting Racks
- 1 Rack with rail system

11805590

SPECIFICATIONS	
Overall Unit Dimensions	29 ¹³ / ₁₆ " (757 mm) W x 28 ⁵ / ₁₆ " (727 mm) H x 23 ³ / ₄ " (603 mm) D
Niche	
Minimum Cabinet Niche Opening	28 ¹ / ₂ " (724 mm) W x 28 ¹ / ₄ " (718 mm) H x 24" (610 mm) D
Plumbing	
Water Supply Requirements	<ul style="list-style-type: none"> • Cold water connection • Male 3/8" compression fitting • Water pressure range 7.25 psi (0.5 bar) and 145 psi (10 bar)
Water Connection Line (Supplied)	Length: 5 ft (1.5 m) Female 3/8" compression.
Electrical	
Electrical Requirements	120/208-240V, 60Hz, 30 Amps
Power Cord	NEMA 14-30 plug, 5 ft (1.52 m)
Shipping	
Shipping Weight	215 lbs (98 kg)
Shipping Dimensions	30 ⁷ / ₁₆ " (776 mm) W x 35 ³ / ₄ " (907 mm) H x 32 ¹⁵ / ₁₆ " (836 mm) D

FLUSH CUTOUT DIMENSIONS

Front View

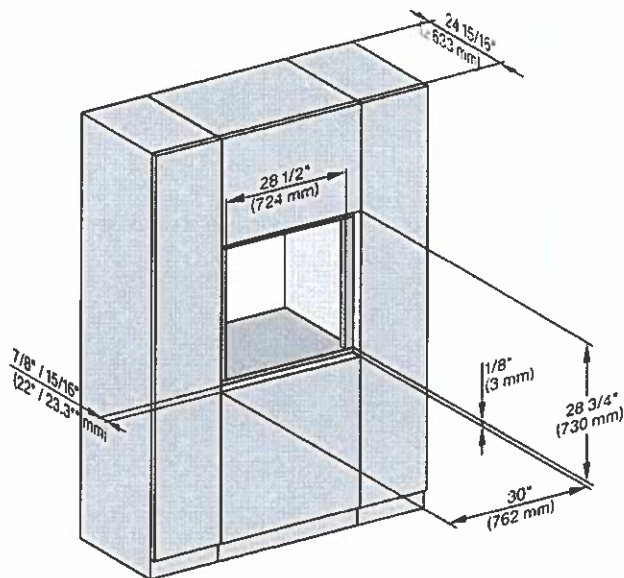

Side View

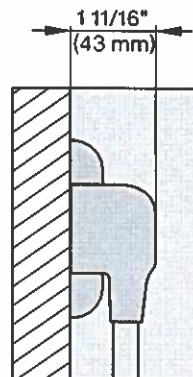
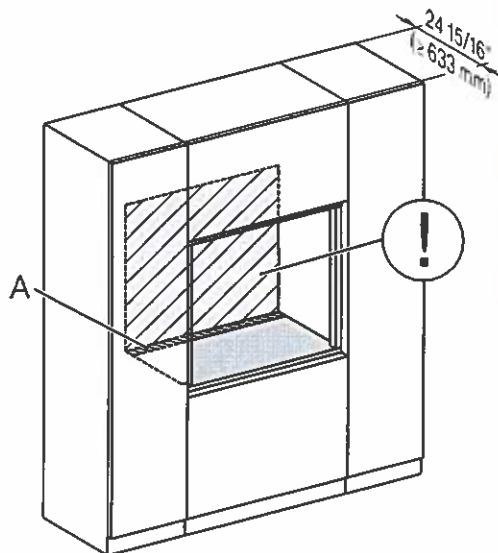
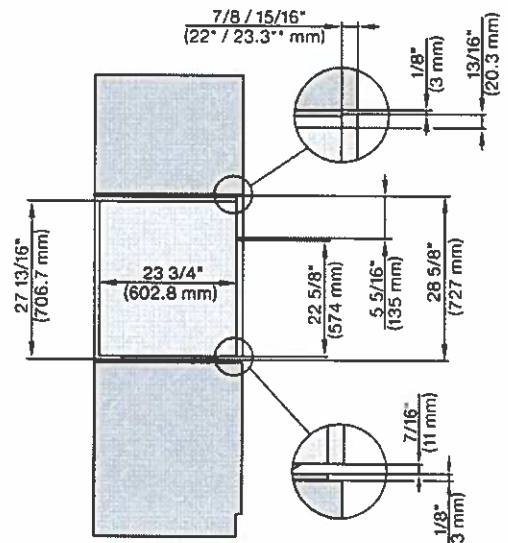

A - Cut-out (4" x 28" [100 mm x 720 mm]) in the bottom of the cabinet for the power cord and Ventilation

①- Electrical and water supplies are recommended to be placed in adjacent cabinetry.

Additional cabinet depth is required when placing the electrical and water supplies behind the appliance.

PROUD CUTOUT DIMENSIONS

Front View

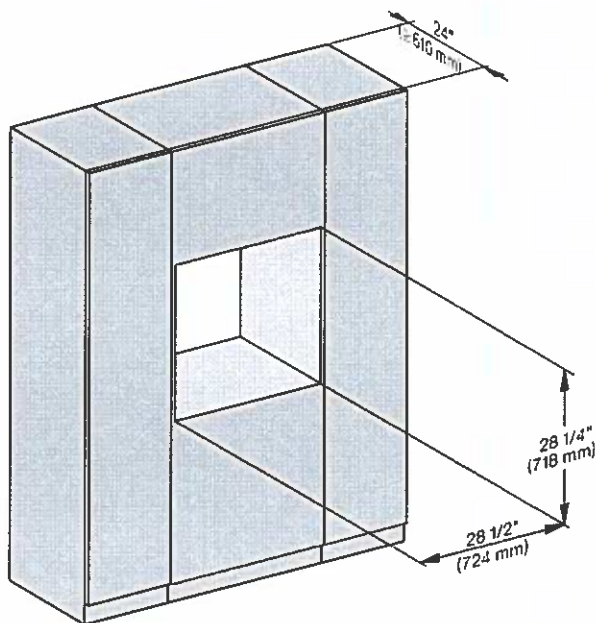

Side View

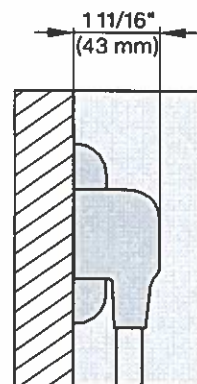
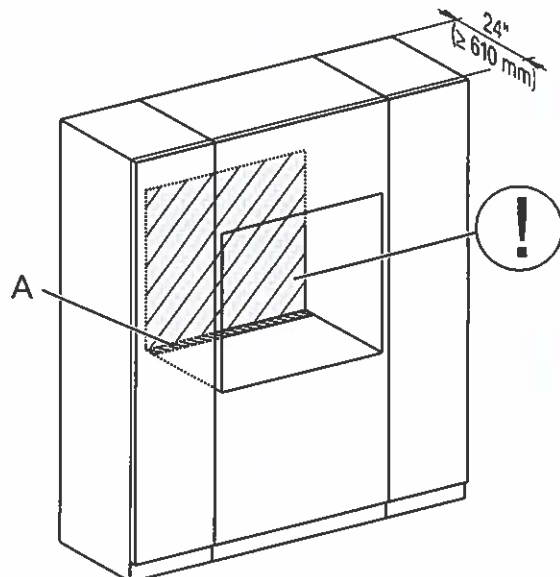
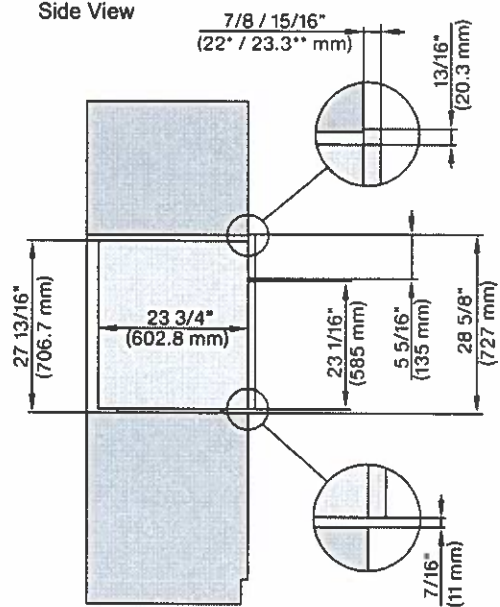

- A - Cut-out (4" x 28" [100 mm x 720 mm]) in the bottom of the cabinet for the power cord and Ventilation
- ①- Electrical and water supplies are recommended to be placed in adjacent cabinetry.
Additional cabinet depth is required when placing the electrical and water supplies behind the appliance.

H 7670 BM
30" Speed Oven - PureLine

Features:

- Speed ovens combine the functionality of a microwave and compact convection oven into one appliance
- M-Touch S Display - Simple to use touch controls
- WifiConn@ct - Monitor appliances from your mobile device
- Motion React - Appliance reacts to you when approached
- Roast Probe - Precise temperature control of food
- Automatic programs - easily master new recipes

Included:

- 1 Baking and Roasting Rack with Perfect Clean
- 1 Glass Dish



MATERIAL #

11804610

SPECIFICATIONS	
Overall Unit Dimensions	29 ¹³ / ₁₆ " (757 mm) W x 18 ⁷ / ₈ " (479 mm) H x 21 ¹¹ / ₁₆ " (551 mm) D
Niche	
Minimum Cabinet Niche Opening	18 ¹ / ₂ " (470 mm) W x 28 ¹ / ₂ " (724 mm) H x 24" (610 mm) D
Electrical	
Electrical Requirements	120/208-240V, 60Hz, 30 Amps
Power Cord	NEMA 14-30 plug, 5 ft (1.52 m)
Shipping	
Shipping Weight	128 lbs (58 kg)
Shipping Dimensions	30 ⁵ / ₈ " (777 mm) W x 29 ¹ / ₄ " (743 mm) H x 32 ⁷ / ₈ " (837 mm) D

PRODUCT DIMENSIONS

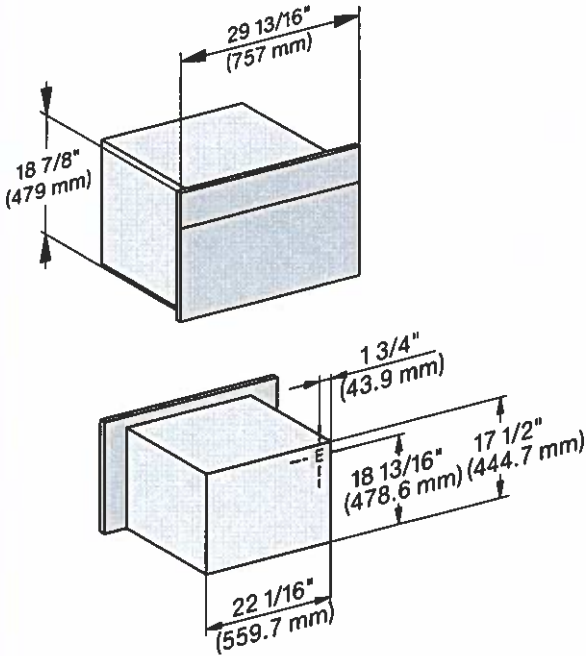

E = Electrical connection

FLUSH CUTOUT DIMENSIONS

Front View

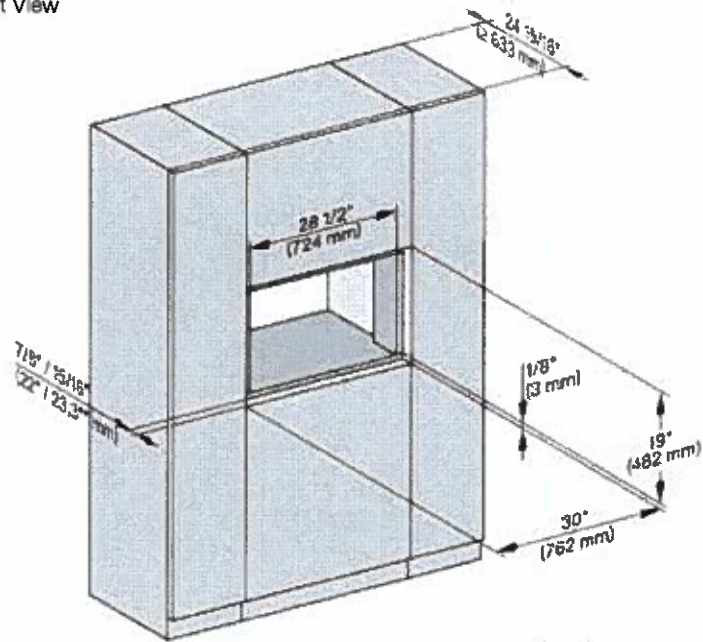

Side View

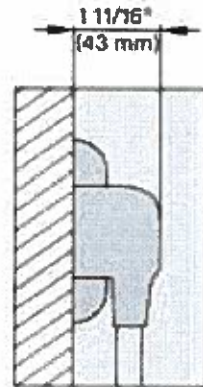
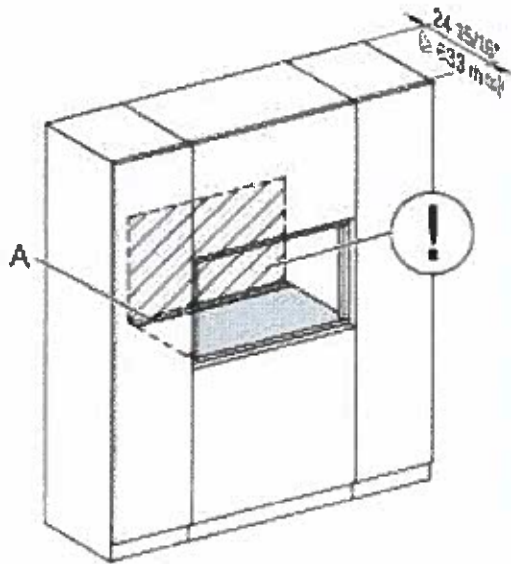
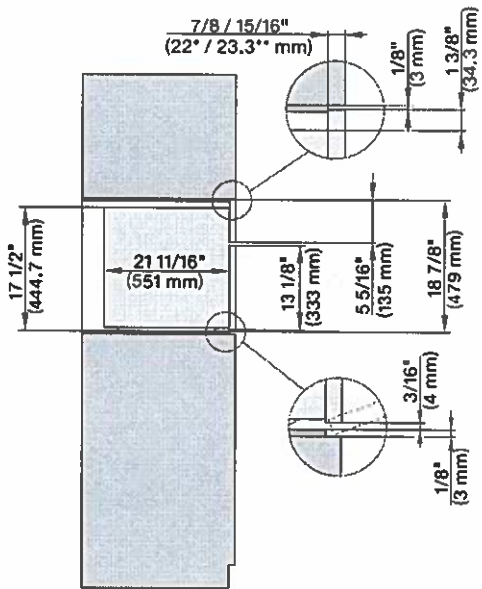

A - Cut-out (4" x 28" [100 mm x 720 mm]) in the bottom of the cabinet for the power cord and Ventilation

ⓘ - Electrical and water supplies are recommended to be placed in adjacent cabinetry.

Additional cabinet depth is required when placing the electrical and water supplies behind the appliance.

PROUD CUTOUT DIMENSIONS

Front View

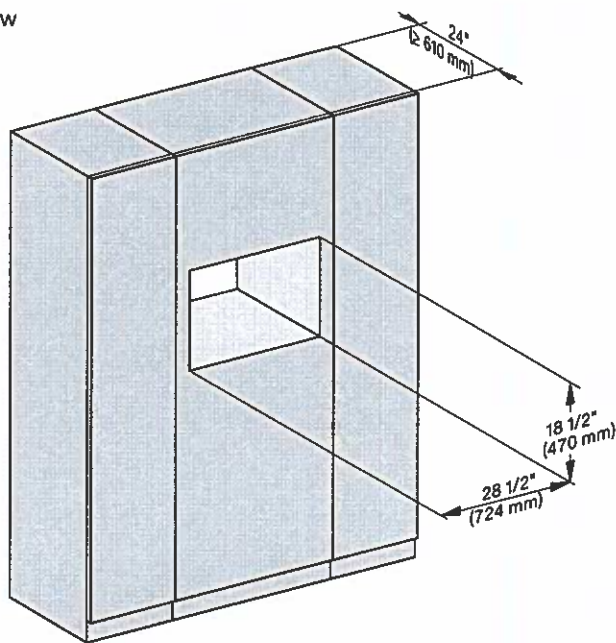

Side View

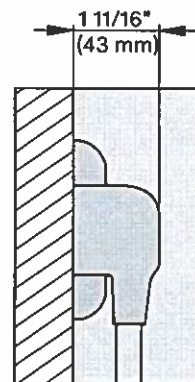
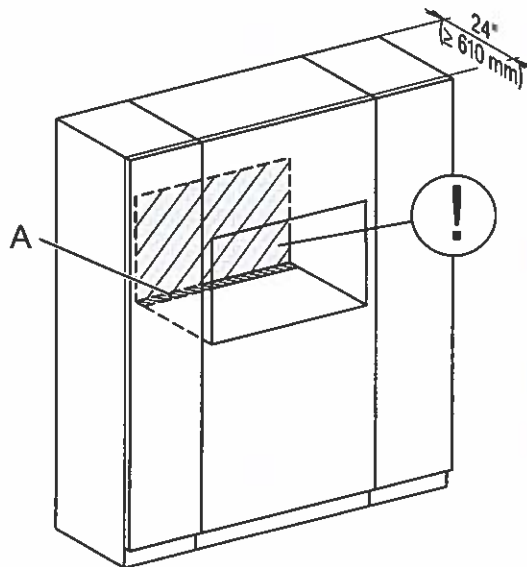
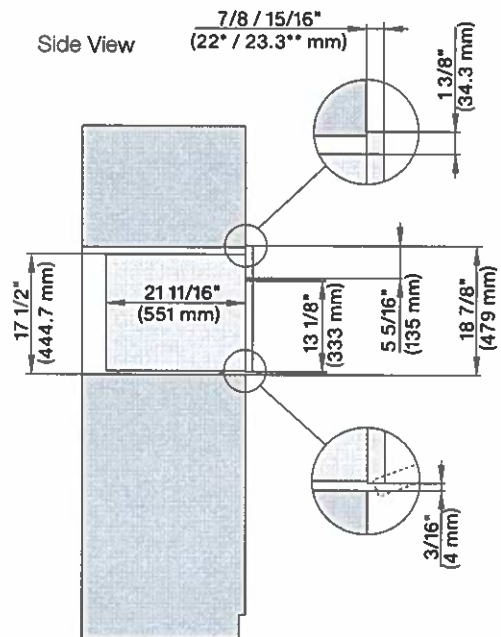

- A - Cut-out (4" x 28" [100 mm x 720 mm]) in the bottom of the cabinet for the power cord and Ventilation
- ① - Electrical and water supplies are recommended to be placed in adjacent cabinetry.
Additional cabinet depth is required when placing the electrical and water supplies behind the appliance.

ESW 7670
30" Handless Warming Drawer - PureLine

Features:

- Keep food or plates and cups warm
- Fits 12 place settings
- Non-Slip Liner
- Control Panel with sensor controls



MATERIAL #

11794810

SPECIFICATIONS	
Overall Unit Dimensions	29 ¹³ / ₁₆ " (757 mm) W x 9 ¹³ / ₁₆ " (250 mm) H x 21 ³ / ₄ " (542 mm) D
Niche	
Cabinet Niche Opening with Combination Appliance	21 ¹ / ₂ " (724 mm) W x Combination Appliance Opening Height + 9" (228 mm) H x 24" (610 mm) D
Electrical	
Electrical Requirements	120V, 60Hz, 15 Amps
Power Cord	NEMA 5-15 plug, 5 ft (1.52 m)
Shipping	
Shipping Weight	70.5 lbs (32 kg)
Shipping Dimensions	28 ³ / ₁₆ " (745 mm) W x 14 ⁹ / ₁₆ " (370 mm) H x 33 ⁵ / ₁₆ " (845 mm) D

PRODUCT DIMENSIONS

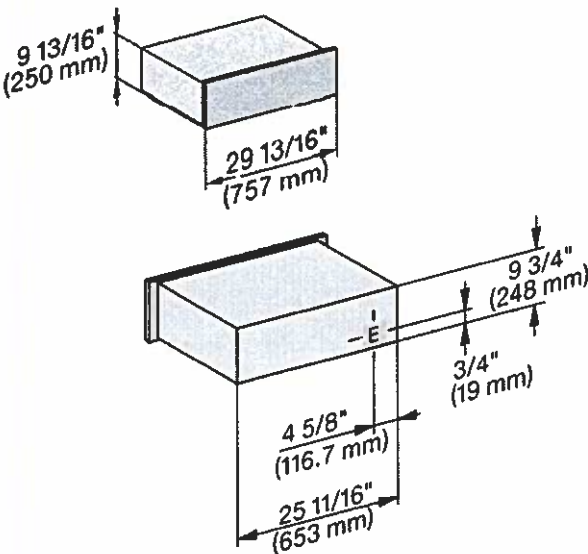

E = Electrical connection

FLUSH CUTOUT DIMENSIONS

Front View

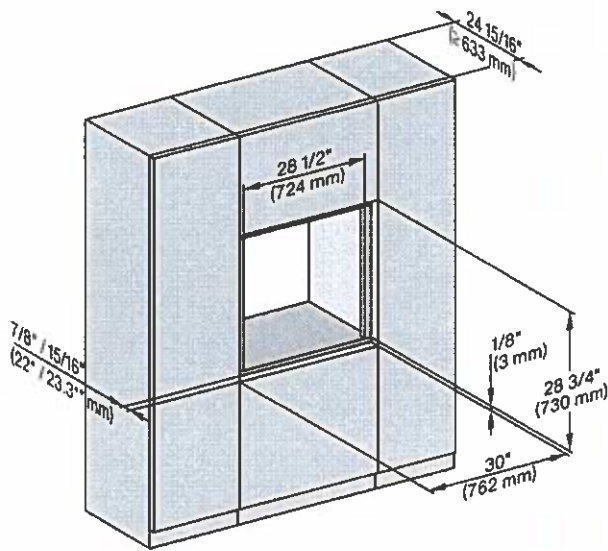

Side View

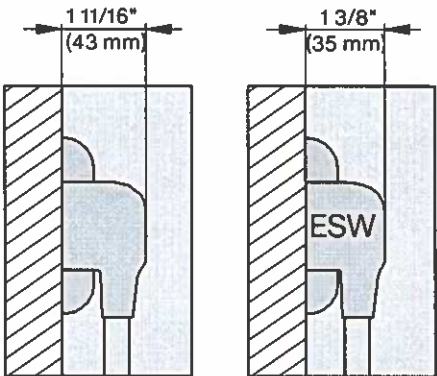
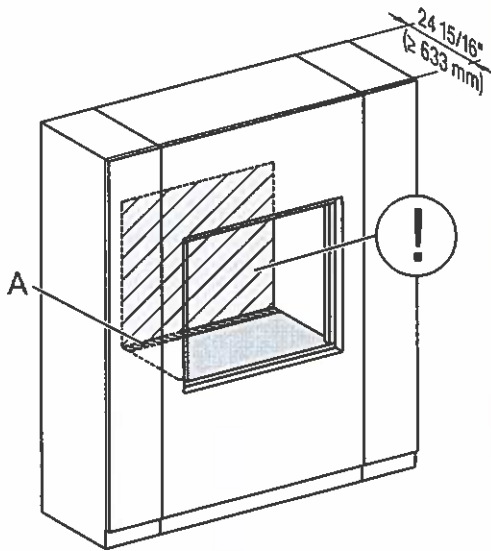
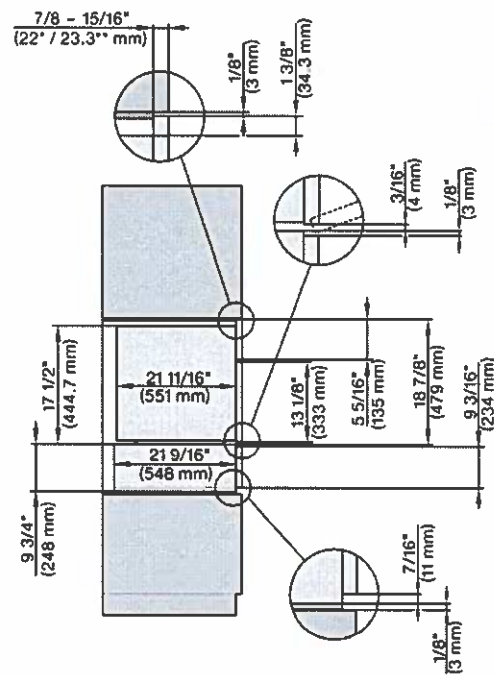

A - Cut-out (4" x 28" [100 mm x 720 mm]) in the bottom of the cabinet for the power cord and Ventilation
 Ⓢ- Electrical and water supplies are recommended to be placed in adjacent cabinetry.
 Additional cabinet depth is required when placing the electrical and water supplies behind the appliance.

PROUD CUTOUT DIMENSIONS

Front View

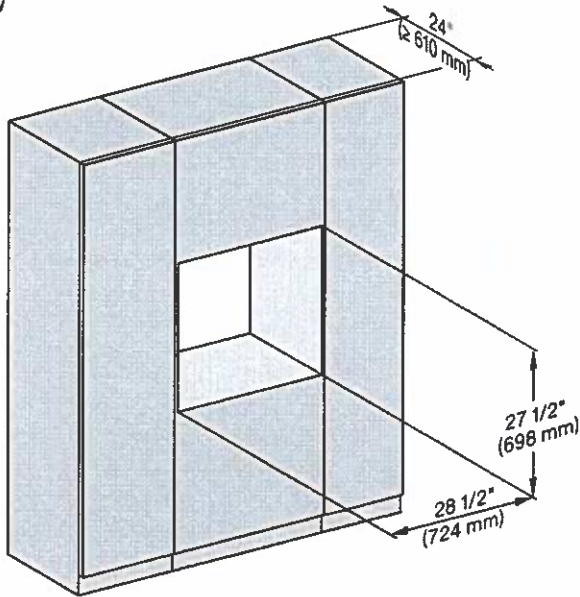

Side View

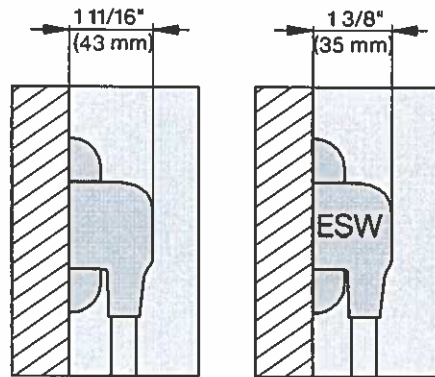
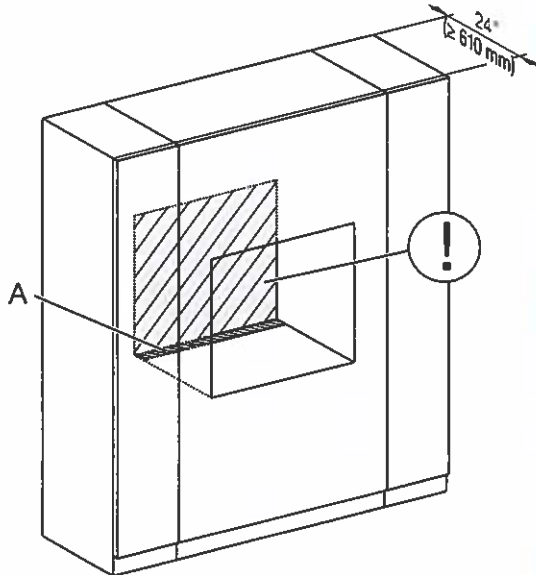
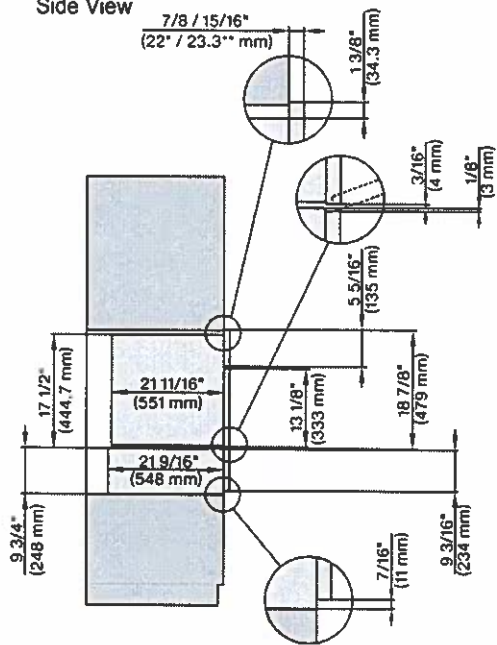

- A - Cut-out (4" x 28" [100 mm x 720 mm]) in the bottom of the cabinet for the power cord and Ventilation
- ① - Electrical and water supplies are recommended to be placed in adjacent cabinetry.
Additional cabinet depth is required when placing the electrical and water supplies behind the appliance.

ELICA PRO SERIES
LEONE



Give a splash of Italian design to your professional kitchen with Leone's crisp lines, seamless welded corner craftsmanship, beveled rim and gleaming stainless steel.

Leone has the extra depth (24") and power (1200 CFM on 36", 42" & 48" W) & 36" in 600 CFM needed to support professional ranges and cooktops. No ear plugs required with Leone's HUSH sound suppression system, which enables you to comfortably talk and entertain, even when cooking up a storm. Available in 30", 36" and 42" widths, Leone features backlit hidden knob controls, which operate the 4-speed blower and LED lighting. Designed for standard ducted ventilation only.

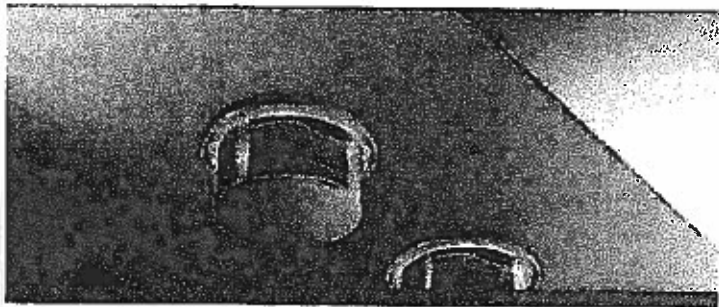
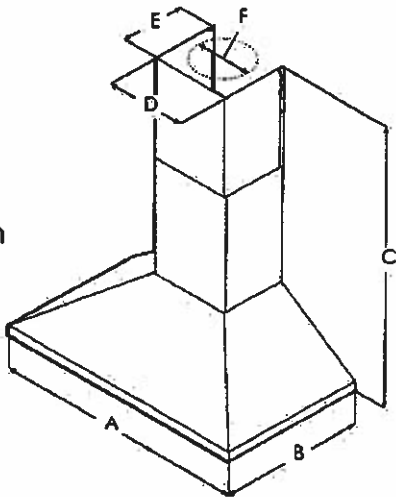

	ELN630S2	ELN636SS ELN136S2	ELN142S2	ELN148SS
A	30" (76.2 cm)	36" (91.4 cm)	42" (106.7 cm)	48" (121.9 cm)
B	24" (61 cm)			
C	Max: 47 5/8" (120.9 cm) Min: 30" (76.2 cm)			
D	13 2/16" (33.2 cm)			

ELICA PRO SERIES LEONE



SPECIFICATIONS

	30" Unit	36" Unit	42" Unit	48" Unit
Model:	ELN630S2	ELN636SS (600 CFM) ELN136S2 (1200 CFM)	ELN142S2	ELN148SS
Dimensions:	30"W x 24"D x 12 1/8"H	36"W x 24"D x 12 1/8"H	42"W x 24"D x 12 1/8"H	48"W x 24"D x 12 1/8"H
Blower Type(internal):	600 CFM(4-speed)	600 CFM & 1200 CFM (4-speed)	1200 CFM(4-speed)	1200 CFM(4-speed)
Blower Performance:				
Speed 1	205 CFM	205 CFM 375 CFM	375 CFM	375 CFM
Speed 2	350 CFM	350 CFM 640 CFM	640 CFM	640 CFM
Speed 3	510 CFM	510 CFM 940 CFM	940 CFM	940 CFM
Speed 4	600 CFM	600 CFM 1200 CFM	1200 CFM	1200 CFM
Noise (sones):				
Working Speed	Min:2.01, Max:6	Min: .8 , Max: 9.5	Min:3.21, Max:7.7	Min:3.21, Max:7.7
Finish:	Stainless Steel			
Controls:	Fully retractable rotating knobs with blue backlighting			
Illumination:	2 LED, 7.5 Watts	2 LED, 6.5 Watts (ELN636SS) 2 LED, 7.5 Watts (ELN136S2)	2 LED, 7.5 Watts	2 LED, 7.5 Watts
Filter Type:	Dishwasher-Safe, Professional Stainless Steel, Angles baffled filters			
Angled Baffle Filters:	1	2	2	3
Duct Transition:	8" Round with BackDraft Damper (top only)			
Installation Type:	Ducted Installation Only			
Electrical:	120V - 60 Hz			
KITS:				
Long Chimney Ext.	KIT02785 (13') & KIT01935 (11' 4")			
1200 CFM External Blower	KIT0153054			
1200 CFM In Line Blower	KIT0154387			
Replacement Grease Filter (1):	GF09EA			
Replacement Light Bulb (1):	LMP0131098	LMP0131098A (ELN636SS) LMP0131098 (ELN136S2)	LMP0131098	LMP0131098
*Consumable parts are sold in units of one (1). Order accordingly				
INSTALL HEIGHTS:				
Ranger Hood:	Min: 8', Max 10'			
Ranger Hood with extension duct covers:	Min: 9'9", Max 13'			
WARRANTY:	2 YEARS PARTS AND LABOR, EARN A 3RD YEAR OF FULL FACTORY WARRANTY. REGISTERING YOUR PRODUCT ON ELICA.COM			

PLUS FEATURES

** For valid warranty extension, register within 3 months from purchase. For USA & Canada Users only

*The product images shown are for illustration purposes only and may not be an exact representation of the product.



HUSH SYSTEM - An exclusive sound deadening technology that effectively reduces sound levels by over 35%



LED CONSUMER REPLACEABLE BULB - High quality LED lighting usually requires a skilled technician to replace lamps. Avoid this expense with Elica's new LED lamps that enable homeowners to replace in seconds



STAINLESS STEEL BAFFLE FILTERS WITH GREASE COLLECTORS - Designed for high airflow cooking, the "S" shape design traps high volumes of grease



PROFESSIONAL PERFORMANCE - Special features and high performances for models with aspiration capacity between 600 and 1200 CFM