



Valecraft

Homes (2019) Limited

Purchase Order PO0003526

210-1455 Youville Drive
Ottawa, On K1C 6Z7
Phone: 613-837-1104

Vendor:
S & S BOLTON ELECTRIC INC.
5411 CANOTEK ROAD
OTTAWA, ONTARIO K1J 9M3

tel: 613-748-0432
fax:
contact:

Ship To:
Site: PLACE ST. THOMAS PHASE7
Lot/Unit: LOT 21
Model: 804 STANDARD
Civic: 907 COLOGNE STREET

ORDER DATE	CHG. ORDER DT.	CANCEL DATE	RESPONSIBILITY	VENDOR #	TERMS
Jun 02, 2025			ARIEL	S02	NET 30 DAYS
Comments/Special Instructions:					REFERENCE

JOB/LOT/COST	REFERENCE	Description	QTY ORDERED	UNIT PRICE	EXTENSION
067-021-680	#01	REFER CONSTR. SUMMARY ITEM #1 ENSUITE CREDIT VANITY LIGHT -	1.0000	-91.000000	-91.00
067-021-680	#48	REFER CONSTR. SUMMARY ITEM #48 QUOTE SS6817 REV.05 APR 8-25 -	1.0000	2,475.000000	2,475.00

<div>Authorized Signature</div>	Subtotal	2,384.00
	HST	309.92
	Total Order Value	2,693.92

ORDER TERMS AND CONDITIONS

1. INVOICES must bear exact same prices and terms or authorization for changes must be received from our company in writing prior to shipping.
2. The right is reserved to cancel all or part of this order if not delivered within the time specified.
3. Packing slips must accompany all shipments.
4. In the event of interruption of our business in whole or in part by reason of fire, flood, windstorm, earthquake, war, strike, embargo, acts of God, governmental action, or any causes beyond our control, we shall have the option of cancelling undelivered orders in whole or in part.
5. Acceptance of this purchase order, or shipment of it will constitute an agreement to all of its specifications as to terms, delivery and prices.
6. No deliveries accepted after 4:00 pm or on weekends.

WHITE - ORIGINAL CANARY - ACCOUNTS PAYABLE PINK - DEPARTMENT



Tel: (613) 748-0432
Fax: (613) 748-0355

A Division of the S&S Bolton Group
www.ssbolton.com

Estimate No#: SS6817 Rev.05

Builder Copy

Customer:

Linda Gail McRoberts & Kenneth McRoberts
Home: 343-549-1934, 613-842-3680
Email: klmcroberts@icloud.com;
mcrobertskenny@icloud.com

Builder: VALECRAFT HOMES (2019) LTD.
Project: PST Singles Ph7
Lot: PST PH7 Lot 21
Closing Date: 11/27/2025
Salesperson: Kyle Takman
Date: 04/08/2025

Location	Qty	Product / Installation Details	Plan Code	Unit Price	Customer Total	Builder Total
Dinette	1.00	Misc. Product Relocate Standard Fixture and leave as keyless cenetered with future buffet ~31.5 inches from end of kitchen cabinet	A	\$	0.00 \$	0.00 \$
Front Out	1.00	15 Amp Separate Circuit Soffit Plug w/ Switch 15 Amp Separate Circuit Soffit Plug w/ Switch for Christmas lights	B	411.00 \$	411.00 \$	218.00 \$
Kitchen	1.00	Standard Light Outlet (Keyless) Relocate standard fixture and leave as keyless fixture and add 2nd keyless fixture (2 in total) for future pendant lighting on existing switch	C	160.00 \$	160.00 \$	85.00 \$
Kitchen	1.00	Misc. Product Credit for deleted fixture	C	-47.00 \$	-47.00 \$	-25.00 \$
Kitchen	2.00	4" LED slim Pot Light White (AFR4C-0930-WH) Add (2) 4" LED slim Pot Light White (AFR4-0930-WH) on added switch	D	245.00 \$	490.00 \$	260.00 \$
Kitchen	1.00	Single Pole Switch Added Switch for pot lights	D	136.00 \$	136.00 \$	72.00 \$
Living Room	1.00	4 * 4" LED slim Pot Light White (AFR4C-0930-WH) Add 4 * 4" LED slim Pot Light White (AFR4C-0930-WH) on existing switch	E	939.00 \$	939.00 \$	498.00 \$
Living Room	1.00	Misc. Product break connection to switched plugs and use switch for added pot lights	E	\$	0.00 \$	0.00 \$
Various Locations	2.00	Misc. Product USB Charger Receptacle in kitchen and owner's bedroom (standard items)	F	\$	0.00 \$	0.00 \$
Ensuite Bath	1.00	4" LED slim Pot Light White (AFR4C-0930-WH) Add 4" LED slim Pot Light White (AFR4-0930-WH) on added switch	G	245.00 \$	245.00 \$	130.00 \$

www.sandselectric.ca

Phone: (613) 748-0432 | Fax: (613) 748-0355 | Email: info@sandselectric.ca | Website: www.sandselectric.ca

5 4 1 1 Canotek Road, Ottawa, Ontario K1J 9M3

Printed By: Kyle Takman - Page: 2

RECEIVED
MAY 07 2025



Tel: (613) 748-0432
Fax: (613) 748-0355

A Division of the S&S Bolton Group
www.ssbolton.com

Location	Qty	Product / Installation Details	Plan Code	Unit Price	Customer Total	Builder Total
Ensuite Bath	1.00	Single Pole Switch Added Switch for pot light	G	136.00 \$	136.00 \$	72.00 \$
Basement	3.00	15 Amp Standard Plug Add (3) 15 Amp Standard Plug -Unfinished area at standard height	H	175.00 \$	525.00 \$	279.00 \$
Rec Room	1.00	15 Amp Standard Plug Add (1) 15 Amp Standard Plug -Above fireplace approximate 72 inches from floor	I	175.00 \$	175.00 \$	93.00 \$
Owners Suite	2.00	15 Amp Standard Plug Add (2) 15 Amp Standard Plug -one at standard height for bed side table -one raised 60 inches from floor	J	175.00 \$	350.00 \$	186.00 \$
Living Room	1.00	15 Amp Standard Plug Add (1) 15 Amp Standard Plug -Approximately 60 inches from floor	K	175.00 \$	175.00 \$	93.00 \$
Hall	1.00	4 * 4" LED slim Pot Light White (AFR4C-0930-WH) Delete standard fixtures, add 4 * 4" LED slim Pot Light White (AFR4C-0930-WH) on existing switches	L	939.00 \$	939.00 \$	498.00 \$
Hall	4.00	Misc. Product credit for deleted fixtures	L	-128.00 \$	-512.00 \$	-272.00 \$
Basement Stairwell	1.00	4" LED slim Pot Light White (AFR4C-0930-WH) Delete standard fixture, add 4" LED slim Pot Light White (AFR4-0930-WH) on existing switch	M	245.00 \$	245.00 \$	130.00 \$
Basement Stairwell	1.00	Misc. Product Credit for deleted fixture	M	-128.00 \$	-128.00 \$	-68.00 \$
Rec Room	1.00	4 * 4" LED slim Pot Light White (AFR4C-0930-WH) Add 4 * 4" LED slim Pot Light White (AFR4C-0930-WH) on existing switch	O	939.00 \$	939.00 \$	498.00 \$
Rec Room	4.00	Misc. Product Credit for deleted fixtures	O	-128.00 \$	-512.00 \$	-272.00 \$

*** Total price does not include any applicable taxes.

Customer Total:	4,666.00 \$
Builder Total:	2,475.00 \$

Notes:

"Purchaser has acknowledged that they have discussed any kitchen layout modifications with their electrical representative. If modifications are made after signing off on electrical, this will incur additional charges."

Phone: (613) 748-0432 | Fax: (613) 748-0355 | Email: info@sandselectric.ca | Website: www.sandselectric.ca

5 4 1 1 Canotek Road, Ottawa, Ontario K1J 9M3

Printed By: Kyle Takman - Page: 3

RECEIVED
MAY 07 2025



Tel: (613) 748-0432
Fax: (613) 748-0355

A Division of the S&S Bolton Group
www.ssbolton.com

Customer Signature

Date

RECEIVED
MAY 07 2025



Valecraft
Homes (2019) Limited

S&S / Orbital Sketch

Model Name: _____

Model #: _____

Site: _____

Purchaser: _____

Lot: _____

#804 "A"

Date: _____

Purchaser: _____

Place St. Thomas 7

PST PH7 Lot 21

April 8, 2025



ELEVATION A



Model Name: _____ Model #: _____

Site: _____ Purchaser: _____

Lot: Manning 2Bed #804 "A"

Date: Place St. Thomas 7 Purchaser: _____

PST PH7 Lot 21

April 8, 2025

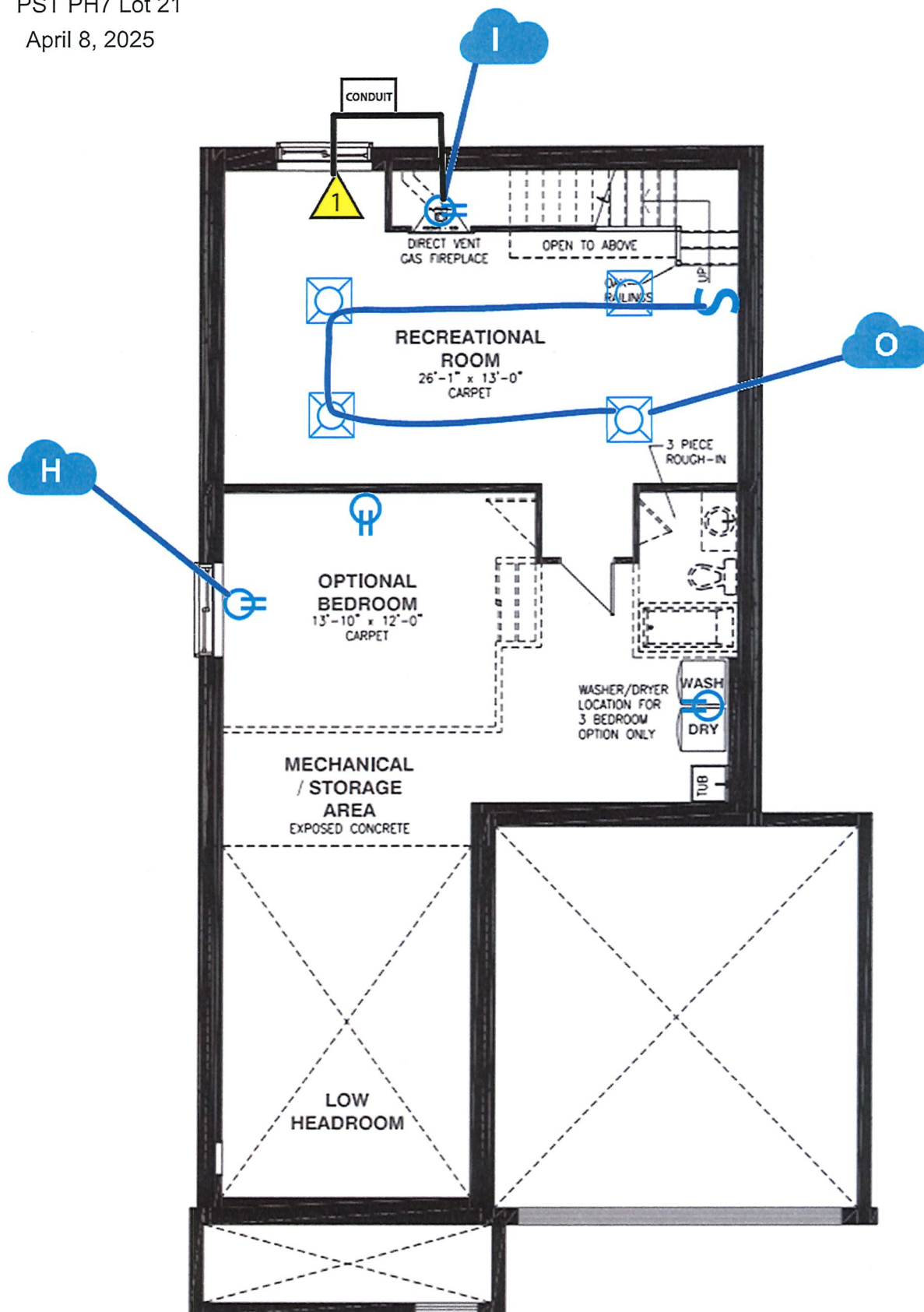

BASEMENT FLOOR



Valecraft
Homes (2019) Limited

S&S / Orbital Sketch

Model Name: _____ Model #: _____

Site: _____ Purchaser: _____

Lot: _____ Manning 2Bed #804 "A"

Date: _____ Place St. Thomas 7 Purchaser: _____

PST PH7 Lot 21

April 8, 2025

