



Valecraft

Homes (2019) Limited

Purchase Order

PO0003407

210-1455 Youville Drive
Ottawa, On K1C 6Z7
Phone: 613-837-1104

Vendor:
S & S BOLTON ELECTRIC INC.
5411 CANOTEK ROAD
OTTAWA, ONTARIO K1J 9M3

Ship To:
Site: SHEA VILLAGE
Lot/Unit: LOT 14
Model: 1086
Civic: 100 CRAIG DUNCAN DRIVE

tel: 613-748-0432
fax:
contact:

ORDER DATE	CHG. ORDER DT.	CANCEL DATE	RESPONSIBILITY	VENDOR #	TERMS
Apr 22, 2025			ARIEL	S02	NET 30 DAYS
Comments/Special Instructions: <i>REVISED PENDING PRICING</i>					REFERENCE

JOB/LOT/COST	REFERENCE	Description	QTY ORDERED	UNIT PRICE	EXTENSION
020-014-680	* #59 PENDING	- REFER CONSTR. SUMMARY ITEM #59 PENDANTS DINING RM & SND FLR. -	2.0000	1.000000	2.00

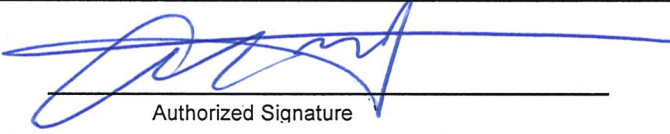
 Authorized Signature	Subtotal	3,415.00
	HST	443.95
	Total Order Value	3,858.95

ORDER TERMS AND CONDITIONS

1. INVOICES must bear exact same prices and terms or authorization for changes must be received from our company in writing prior to shipping.
2. The right is reserved to cancel all or part of this order if not delivered within the time specified.
3. Packing slips must accompany all shipments.
4. In the event of interruption of our business in whole or in part by reason of fire, flood, windstorm, earthquake, war, strike, embargo, acts of God, governmental action, or any causes beyond our control, we shall have the option of cancelling undelivered orders in whole or in part.
5. Acceptance of this purchase order, or shipment of it will constitute an agreement to all of its specifications as to terms, delivery and prices.
6. No deliveries accepted after 4:00 pm or on weekends.

WHITE - ORIGINAL

CANARY - ACCOUNTS PAYABLE

PINK - DEPARTMENT



Valecraft

Homes (2019) Limited

Purchase Order

PO0003407

210-1455 Youville Drive
Ottawa, On K1C 6Z7
Phone: 613-837-1104

Vendor:
S & S BOLTON ELECTRIC INC.
5411 CANOTEK ROAD
OTTAWA, ONTARIO K1J 9M3

Ship To:
Site: SHEA VILLAGE
Lot/Unit: LOT 14
Model: 1086
Civic: 100 CRAIG DUNCAN DRIVE

tel: 613-748-0432
fax:
contact:

ORDER DATE	CHG. ORDER DT.	CANCEL DATE	RESPONSIBILITY	VENDOR #	TERMS
Apr 22, 2025			ARIEL	S02	NET 30 DAYS
Comments/Special Instructions:					REFERENCE

JOB/LOT/COST	REFERENCE	Description	QTY ORDERED	UNIT PRICE	EXTENSION
020-014-680	#12	REFER CONSTR. SUMMARY ITEM #12 KITCHEN 120V OUTLET GAS STOVE	1.0000	85.000000	85.00
020-014-680	#14	REFER CONSTR. SUMMARY ITEM #14 OUTLET AT MICROWAVE OPENING	1.0000	258.000000	258.00
020-014-680	#31	REFER CONSTR. SUMMARY ITEM #31 ENSUITE 5 PC. BATHROOM'	1.0000	662.000000	662.00
020-014-680	* #34 PENDING	REFER CONSTR. SUMMARY ITEM #34 GARAGE WIRING CHARGING UNIT - EV 50 AMP BREAKER	1.0000	1.000000	1.00
020-014-680	#35	REFER CONSTR. SUMMARY ITEM #35 QUOTE #SS6784 REV06 MAR 28-25	1.0000	2,325.000000	2,325.00
020-014-680	#45	REFER CONSTR. SUMMARY ITEM #45 EXTENDED PANTRY DINETTE	1.0000	79.000000	79.00
020-014-680	* #57 PENDING	REFER CONSTR. SUMMARY ITEM #57 UPGRADE DINETTE PENDANT	1.0000	1.000000	1.00
020-014-680	* #58 PENDING	REFER CONSTR. SUMMARY ITEM #58 UPGRADE KITCHEN PENDANTS	2.0000	1.000000	2.00

Continued on next page...



Tel: (613) 748-0432
Fax: (613) 748-0355

A Division of the S&S Bolton Group
www.ssbolton.com

Estimate No#: SS6784 Rev.06

Builder Copy

Customer:

SV Lot 14 - Spec

Builder: VALECRAFT HOMES (2019) LTD.
Project: Shea Village
Lot: SV Lot 14
Closing Date: -

Salesperson: Kyle Takman
Date: 03/28/2025

Location	Qty	Product / Installation Details	Plan Code	Unit Price	Customer Total	Builder Total
Various Locations	2.00	Misc. Product USB Charger Receptacle in kitchen and master bedroom (standard items)	C	\$	0.00 \$	0.00 \$
Kitchen	1.00	Misc. Product Relocate MW plug from OTR to Island as per kitchen sketches	D	\$	0.00 \$	0.00 \$
Soffit	1.00	4 * 4" LED 2nd floor slim Soffit Pot Light White (AFR4C-0930-WH) Add 4 * 4" LED 2nd floor slim Soffit Pot Light White (AFR4C-0930-WH) on added switch	E	961.00 \$	961.00 \$	510.00 \$
Soffit	1.00	Single Pole Switch Single Pole Switch for added soffit pot lights	E	136.00 \$	136.00 \$	72.00 \$
Kitchen Island	1.00	Standard Light Outlet (Keyless) (1) Standard Light Outlet (Keyless)	F	160.00 \$	160.00 \$	85.00 \$
Kitchen Island	1.00	Misc. Product Relocate Standard Fixture and leave as keyless	F	\$	0.00 \$	0.00 \$
Kitchen	1.00	4 * 4" LED slim Pot Light White (AFR4C-0930-WH) Add 4 * 4" LED slim Pot Light White (AFR4C-0930-WH) on added switch **all in bulkhead 1 centered with the countertop of optional pantry one 1 on each side on stove 1 centered between fridge and corner pantry	G	939.00 \$	939.00 \$	498.00 \$
Kitchen	1.00	Single Pole Switch Single Pole Switch for added pot lights	G	136.00 \$	136.00 \$	72.00 \$
Ensuite Bath	1.00	4" LED slim Pot Light White (AFR4C-0930-WH) Add (1) 4" LED slim Pot Light White (AFR4-0930-WH) on added switch	H	245.00 \$	245.00 \$	130.00 \$
Ensuite Bath	1.00	Single Pole Switch Single Pole Switch for added pot light	H	136.00 \$	136.00 \$	72.00 \$

Phone: (613) 748-0432 | Fax: (613) 748-0355 | Email: info@sandselectric.ca | Website: www.sandselectric.ca

5 4 1 1 Canotek Road, Ottawa, Ontario K1J 9M3

Printed By: Kyle Takman - Page: 2

RECEIVED
APR 04 2025

www.sandselectric.ca



Tel: (613) 748-0432
Fax: (613) 748-0355

A Division of the S&S Bolton Group
www.ssbolton.com

Location	Qty	Product / Installation Details	Plan Code	Unit Price	Customer Total	Builder Total
Ensuite Bath	1.00	Upgrade Switch to Dimmer Upgrade Switch to Dimmer	H	121.00 \$	121.00 \$	64.00 \$
Basement Stair	1.00	4" LED slim Pot Light White (AFR4C-0930-WH) Delete standard fixture, Add (1) 4" LED slim Pot Light White (AFR4-0930-WH) on existing switch	K	245.00 \$	245.00 \$	130.00 \$
Basement Stair	1.00	Misc. Product Credit for Deleted fixture	K	-128.00 \$	-128.00 \$	-68.00 \$
Hall	1.00	4 * 4" LED slim Pot Light White (AFR4C-0930-WH) Deleted standard fixtures and add 4 * 4" LED slim Pot Light White (AFR4C-0930-WH) on existing switch	L	939.00 \$	939.00 \$	498.00 \$
Hall	4.00	Misc. Product Credit for deleted fixtures	L	-128.00 \$	-512.00 \$	-272.00 \$
Second Floor Hall	3.00	4" LED slim Pot Light White (AFR4C-0930-WH) Deleted standard fixtures and add (3) 4" LED slim Pot Light White (AFR4-0930-WH) on existing switch	M	245.00 \$	735.00 \$	390.00 \$
Second Floor Hall	3.00	Misc. Product Credit for deleted fixtures	M	-128.00 \$	-384.00 \$	-204.00 \$
Foyer	1.00	4" LED slim Pot Light White (AFR4C-0930-WH) Deleted standard fixture and add (1) 4" LED slim Pot Light White (AFR4-0930-WH) on existing switch	N	245.00 \$	245.00 \$	130.00 \$
Foyer	1.00	Misc. Product Credit for deleted fixture	N	-128.00 \$	-128.00 \$	-68.00 \$
Dinette	1.00	Misc. Product Relocate included fixture -Move dinette fixture approx. 18" toward the great room to account for added pantry	O	\$	0.00 \$	0.00 \$
Ensuite Bath	2.00	4" LED slim Pot Light White (AFR4C-0930-WH) Delete standard vanity fixtures, Add (2) 4" LED slim Pot Light White (AFR4-0930-WH) on existing switch -one over each sink	P	245.00 \$	490.00 \$	260.00 \$
Ensuite Bath	2.00	Misc. Product Credit for deleted vanity fixtures	P	-166.00 \$	-332.00 \$	-176.00 \$
Main Bath	1.00	4" LED slim Pot Light White (AFR4C-0930-WH) Add 4" LED slim Pot Light White (AFR4-0930-WH) on added switch	Q	245.00 \$	245.00 \$	130.00 \$

Phone: (613) 748-0432 | Fax: (613) 748-0355 | Email: info@sandselectric.ca | Website: www.sandselectric.ca

5 4 1 1 Canotek Road, Ottawa, Ontario K1J 9M3

Printed By: Kyle Takman - Page: 3

RECEIVED
APR 04 2025

www.sandselectric.ca



Tel: (613) 748-0432
Fax: (613) 748-0355

A Division of the S&S Bolton Group
www.ssbolton.com

Location	Qty	Product / Installation Details	Plan Code	Unit Price	Customer Total	Builder Total
Main Bath	1.00	Single Pole Switch Single Pole Switch for added pot light	Q	136.00 \$	136.00 \$	72.00 \$
*** Total price does not include any applicable taxes.					Customer Total:	4,385.00 \$
					Builder Total:	2,325.00 \$

Customer Signature

Date

Phone: (613) 748-0432 | Fax: (613) 748-0355 | Email: info@sandselectric.ca | Website: www.sandselectric.ca

5411 Canotek Road, Ottawa, Ontario K1J 9M3

Printed By: Kyle Takman - Page: 4

RECEIVED
APR 04 2025

www.sandselectric.ca



Valecraft
Homes (2019) Limited

S&S / Orbital Sketch

Model Name: The Steel B Model #: 1086

Site: SHEA VILLAGE Purchaser: _____

Lot: PH1 14

Date: March 28, 2025 Purchaser: _____



ELEVATION B

RECEIVED

APR 04 2025



Valecraft
Homes (2019) Limited

S&S / Orbital Sketch

Model Name: The Steel B Model #: 1086

Site: SHEA VILLAGE Purchaser: _____

Lot: PH1 14

Date: March 28, 2025 Purchaser: _____

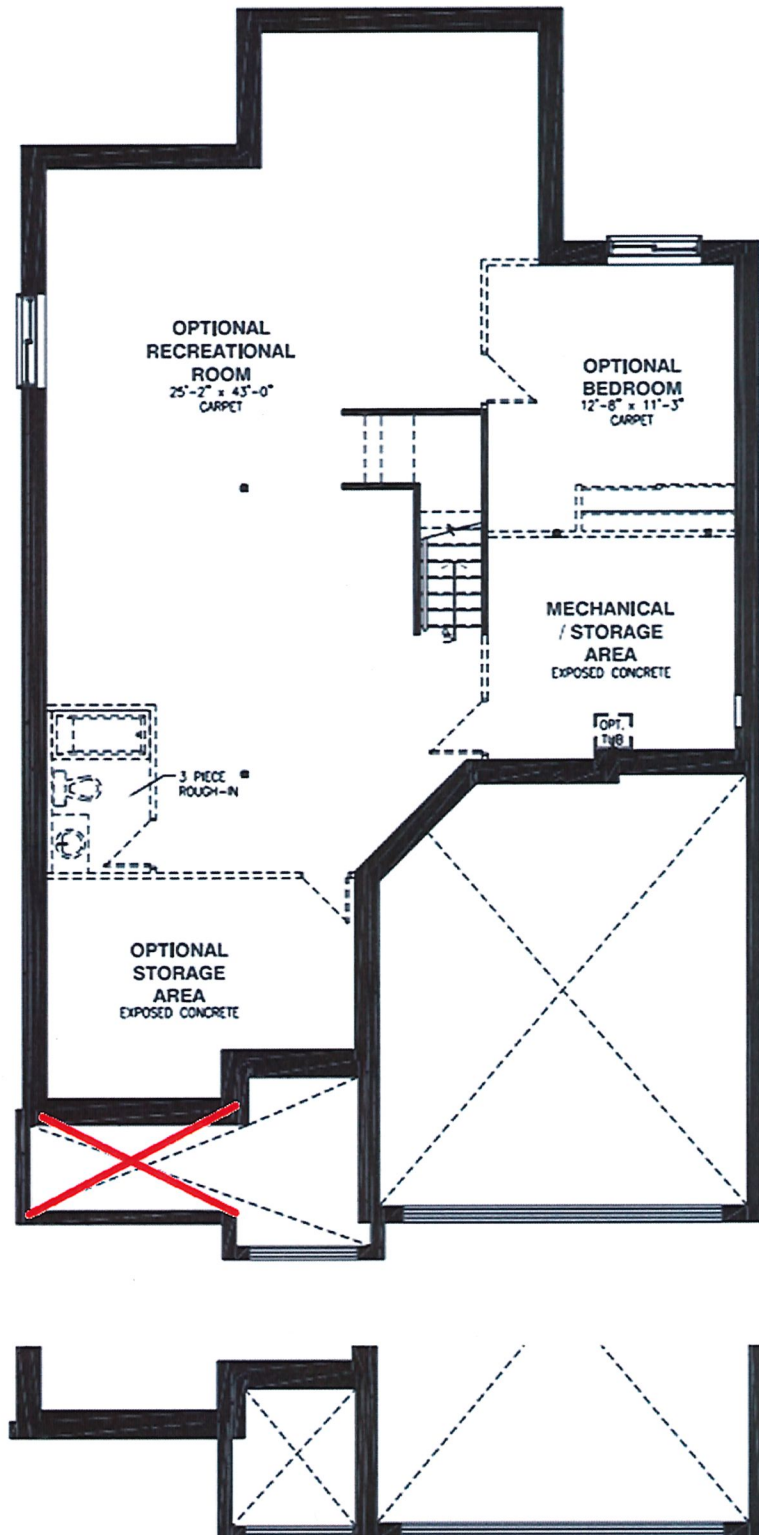

BASEMENT FLOOR - ELEVATION B

RECEIVED

APR 04 2025



1	
2	
3	
4	
5	
6	
7	

Date: March 28, 2025 Purchaser: _____

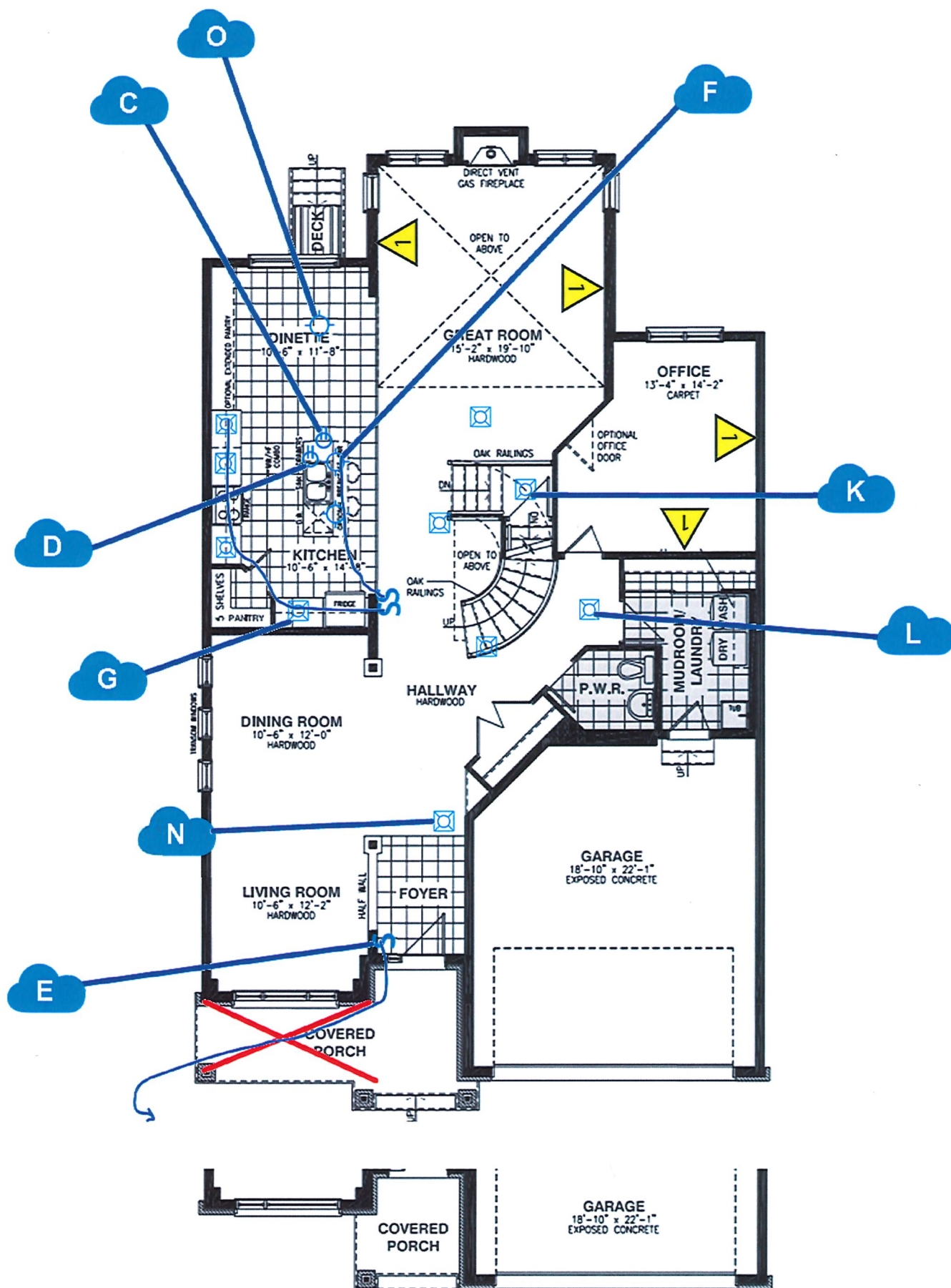

GROUND FLOOR - ELEVATION B

RECEIVED

APR 04 2025



Valecraft
Homes (2019) Limited

S&S / Orbital Sketch

Model Name: The Steel B Model #: 1086

Site: SHEA VILLAGE Purchaser: _____

Lot: PH1 14

Date: March 28, 2025 Purchaser: _____

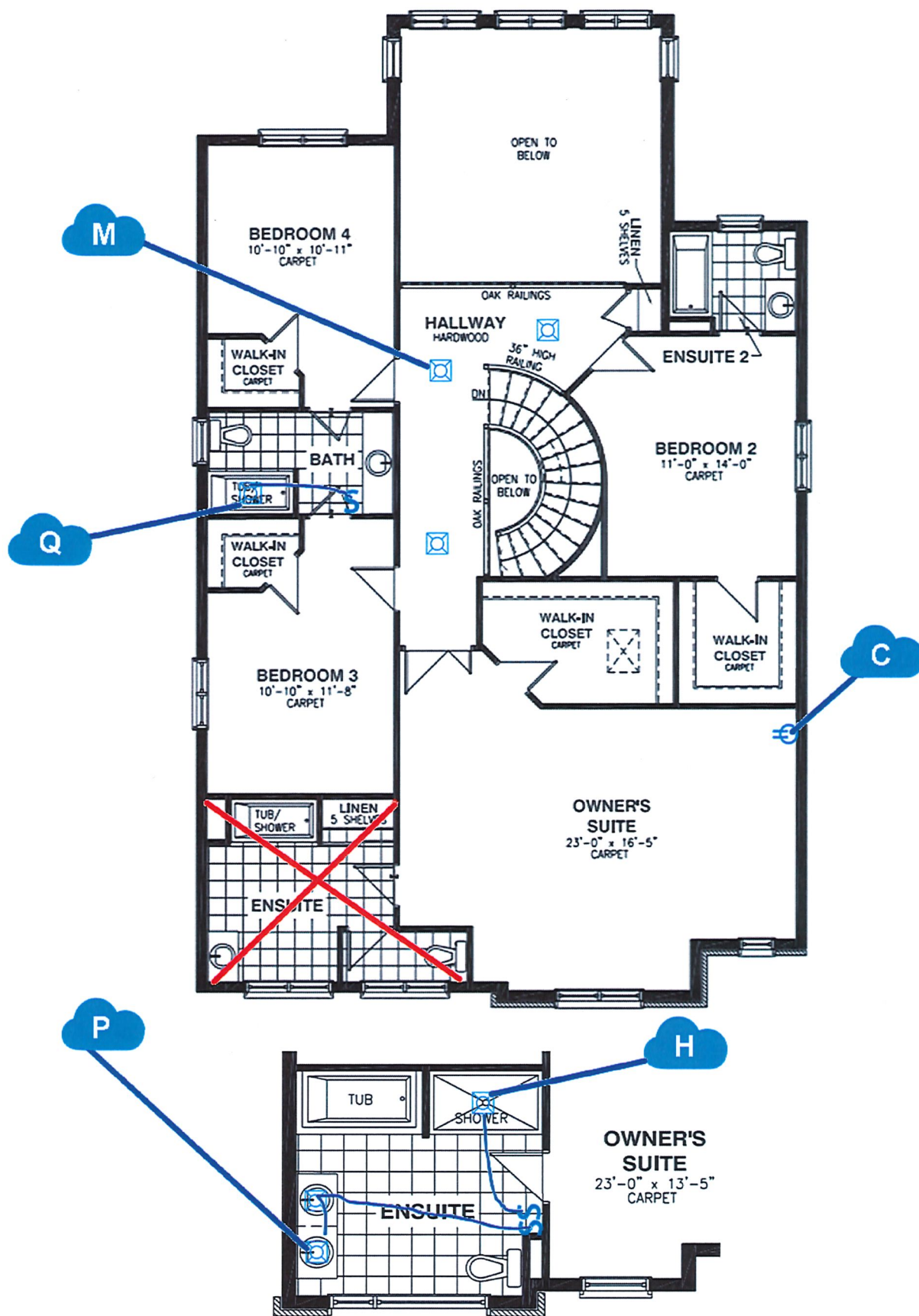

OPTIONAL 5PC ENSUITE
ELEVATION B

RECEIVED

APR 04 2025