



Valecraft

Homes (2019) Limited

210-1455 Youville Drive
Ottawa, On K1C 6Z7
Phone: 613-837-1104

Purchase Order PO0003196

Vendor:
S & S BOLTON ELECTRIC INC.
5411 CANOTEK ROAD
OTTAWA, ONTARIO K1J 9M3

Ship To:
Site: PLACE ST. THOMAS PHASE 7
Lot/Unit: LOT 5
Model: 1020 REVERSED
Civic: 894 COLOGNE STREET

tel: 613-748-0432
fax:
contact:

ORDER DATE	CHG. ORDER DT.	CANCEL DATE	RESPONSIBILITY	VENDOR #	TERMS
Dec 18, 2024			ARIEL	S02	NET 30 DAYS
Comments/Special Instructions:					REFERENCE

JOB/LOT/COST	REFERENCE	Description	QTY ORDERED	UNIT PRICE	EXTENSION
		- ITEM #63 WATERFALL ENDS TO BOTH SIDES OF KITCHEN ISLAND - ITEM #65 STACKABLE WASHER/DRYER CONNECTIONS IN MUDROOM -			

<div>Authorized Signature</div>	Subtotal	4,847.00
	HST	630.11
	Total Order Value	5,477.11

ORDER TERMS AND CONDITIONS

- 1. INVOICES must bear exact same prices and terms or authorization for changes must be received from our company in writing prior to shipping.
- 2. The right is reserved to cancel all or part of this order if not delivered within the time specified.
- 3. Packing slips must accompany all shipments.
- 4. In the event of interruption of our business in whole or in part by reason of fire, flood, windstorm, earthquake, war, strike, embargo, acts of God, governmental action, or any causes beyond our control, we shall have the option of cancelling undelivered orders in whole or in part.
- 5. Acceptance of this purchase order, or shipment of it will constitute an agreement to all of its specifications as to terms, delivery and prices.
- 6. No deliveries accepted after 4:00 pm or on weekends.

WHITE - ORIGINAL CANARY - ACCOUNTS PAYABLE PINK - DEPARTMENT



Valecraft

Homes (2019) Limited

210-1455 Youville Drive
Ottawa, On K1C 6Z7
Phone: 613-837-1104

Purchase Order PO0003196

Vendor:
S & S BOLTON ELECTRIC INC.
5411 CANOTEK ROAD
OTTAWA, ONTARIO K1J 9M3

Ship To:
Site: PLACE ST. THOMAS PHASE 7
Lot/Unit: LOT 5
Model: 1020 REVERSED
Civic: 894 COLOGNE STREET

tel: 613-748-0432
fax:
contact:

ORDER DATE	CHG. ORDER DT.	CANCEL DATE	RESPONSIBILITY	VENDOR #	TERMS
Dec 18, 2024			ARIEL	S02	NET 30 DAYS
Comments/Special Instructions:					REFERENCE

JOB/LOT/COST	REFERENCE	Description	QTY ORDERED	UNIT PRICE	EXTENSION
067-005-680	#01	REFER CONSTR. SUMMARY ITEM #1 FINISHED BASEMENT REC. ROOM -	1.0000	800.000000	800.00
067-005-680	#02	REFER CONSTR. SUMMARY ITEM #2 FINISHED BASEMENT BEDROOM -	1.0000	626.000000	626.00
067-005-680	#03	REFER CONSTR. SUMMARY ITEM #3 FINISHED BASEMENT BATHROOM -	1.0000	563.000000	563.00
067-005-680	#37	REFER CONSTR. SUMMARY ITEM #37 KITCHEN ADDITIONAL OUTLET -	1.0000	172.000000	172.00
067-005-680	#44	REFER CONSTR. SUMMARY ITEM #44 MICROWAVE SHELF OUTLET -	1.0000	172.000000	172.00
067-005-680	#45	REFER CONSTR. SUMMARY ITEM #45 REINFORCE OUTLET MASTER BEDRM -	1.0000	63.000000	63.00
067-005-680	#46	REFER CONSTR. SUMMARY ITEM #46 REINFORCE OUTLET BEDROOM #3 -	1.0000	63.000000	63.00
067-005-680	#84	REFER CONSTR. SUMMARY ITEM #84 QUOTE SS6730 REV.02 NOV 19-24	1.0000	2,388.000000	2,388.00

Continued on next page...



Tel: (613) 748-0432
Fax: (613) 748-0355

A Division of the S&S Bolton Group
www.ssbolton.com

Estimate No#: SS6730 Rev.02

Builder Copy

Customer:

Sylvie Yollande Rochon & Anthony Paul Latreille

Home: 613-513-7353, 613-762-0900
Email: larochon55@gmail.com;
nofireforyou@outlook.com

Builder: VALECRAFT HOMES (2019) LTD.
Project: PST Singles Ph7
Lot: PST PH 7 Lot 5
Closing Date: 07/03/2025

Salesperson: Kyle Takman
Date: 11/19/2024

Location	Qty	Product / Installation Details	Plan Code	Unit Price	Customer Total	Builder Total
Garage	1.00	15 Amp Separate Circuit Plug Add 15 Amp separate circuit plug for central vacuum	B	349.00 \$	349.00 \$	185.00 \$
Kitchen	1.00	Standard Light Outlet (Keyless) Relocate standard fixture and leave as keyless fixture and add 2nd keyless fixture (2 in total) for future pendant lighting - centered and evenly spaced over island	D	160.00 \$	160.00 \$	85.00 \$
Kitchen	1.00	Misc. Product Relocated Existing switch - switches to be ganged close to pantry (switches for items D,E,K)	D	\$	0.00 \$	0.00 \$
Kitchen	1.00	4 * 4" LED slim Pot Light White (AFR4C-0930-WH) Add 4 * 4" LED slim Pot Light White (AFR4C-0930-WH) on added switch	E	939.00 \$	939.00 \$	489.00 \$
Kitchen	1.00	Single Pole Switch Added Switch for potlights	E	136.00 \$	136.00 \$	72.00 \$
Kitchen	1.00	3-Way Switch Add 3-Way Switch for pot lights	E	164.00 \$	164.00 \$	87.00 \$
Various Locations	2.00	Misc. Product USB Charger Receptacle (standard items) -kitchen -owner's suite	G	\$	0.00 \$	0.00 \$
Ensuite Bath	1.00	4" LED slim Pot Light White (AFR4C-0930-WH) Add 1 LED Halo potlight (AFR4-0930-WH) on added switch	H	245.00 \$	245.00 \$	130.00 \$
Ensuite Bath	1.00	Single Pole Switch Added Switch for potlight	H	136.00 \$	136.00 \$	72.00 \$
Garage	1.00	15 Amp Separate Circuit Plug Add 15 Amp Separate Circuit Plug	J	349.00 \$	349.00 \$	185.00 \$
Dinette	1.00	Standard Light Outlet (Keyless) Relocate standard fixture and leave as keyless and add (1) keyless fixture on existing switch (total 2 keyless fixtures) - over cabinets and evenly spaced	K	160.00 \$	160.00 \$	85.00 \$

Phone: (613) 748-0432 | Fax: (613) 748-0355 | Email: info@sandselectric.ca | Website: www.sandselectric.ca

5 4 1 1 Canotek Road, Ottawa, Ontario K1J 9M3

Printed By: Kyle Takman - Page: 2

www.sandselectric.ca



Tel: (613) 748-0432
Fax: (613) 748-0355

A Division of the S&S Bolton Group
www.ssbolton.com

Location	Qty	Product / Installation Details	Plan Code	Unit Price	Customer Total	Builder Total
Dinette	1.00	Misc. Product credit for deleted fixture	K	-98.00 \$	-98.00 \$	-52.00 \$
Hall	3.00	4" LED slim Pot Light White (AFR4C-0930-WH) Delete standard fixtures, Add (3) 4" LED slim Pot Light White (AFR4-0930-WH) on existing switch -pot light in front of washroom to be centered with closet door	L	245.00 \$	735.00 \$	390.00 \$
Hall	3.00	Misc. Product credit for deleted fixtures	L	-128.00 \$	-384.00 \$	-204.00 \$
Rec Room	1.00	Misc. Product Relocate standard fixture	M	\$	0.00 \$	0.00 \$
Storage	3.00	15 Amp Standard Plug Add (3) 15 Amp Standard Plug	N	175.00 \$	525.00 \$	279.00 \$
Storage	2.00	Standard Light Outlet (Keyless) Add (2) Standard Light Outlet (Keyless) on existing switch	O	160.00 \$	320.00 \$	170.00 \$
Great Room	1.00	15 Amp Standard Plug Add (1) 15 Amp Standard Plug	P	175.00 \$	175.00 \$	93.00 \$
Hall	3.00	4" LED slim Pot Light White (AFR4C-0930-WH) Delete standard fixture, Add (3) 4" LED slim Pot Light White (AFR4-0930-WH) on existing switch	Q	245.00 \$	735.00 \$	390.00 \$
Hall	1.00	Misc. Product Credit deleted fixture	Q	-128.00 \$	-128.00 \$	-68.00 \$

*** Total price does not include any applicable taxes.

Customer Total:	4,518.00 \$
Builder Total:	2,388.00 \$

Notes:

"Purchaser has acknowledged that they have discussed any kitchen layout modifications with their electrical representative. If modifications are made after signing off on electrical, this will incur additional charges."

Customer Signature

Date

Phone: (613) 748-0432 | Fax: (613) 748-0355 | Email: info@sandselectric.ca | Website: www.sandselectric.ca

5 4 1 1 Canotek Road, Ottawa, Ontario K1J 9M3

Printed By: Kyle Takman - Page: 3

Model Name: Morgan "A" Rev. Model #: #1026 Plan #: 50M-361
Site: Place St. Thomas 7 Purchaser: Sylvie Yollande Rochon
Lot: PST PH7 Lot 5
Date: November 19, 2024 Purchaser: Anthony Paul Latreille



ELEVATION A



Model Name: Morgan "A" Rev.

Model #: #1026

Plan #: 50M-361

Site: Place St. Thomas 7

Purchaser: Sylvie Yollande Rochon

Lot: PST PH7 Lot 5

Date: November 19, 2024

Purchaser: Anthony Paul Latreille

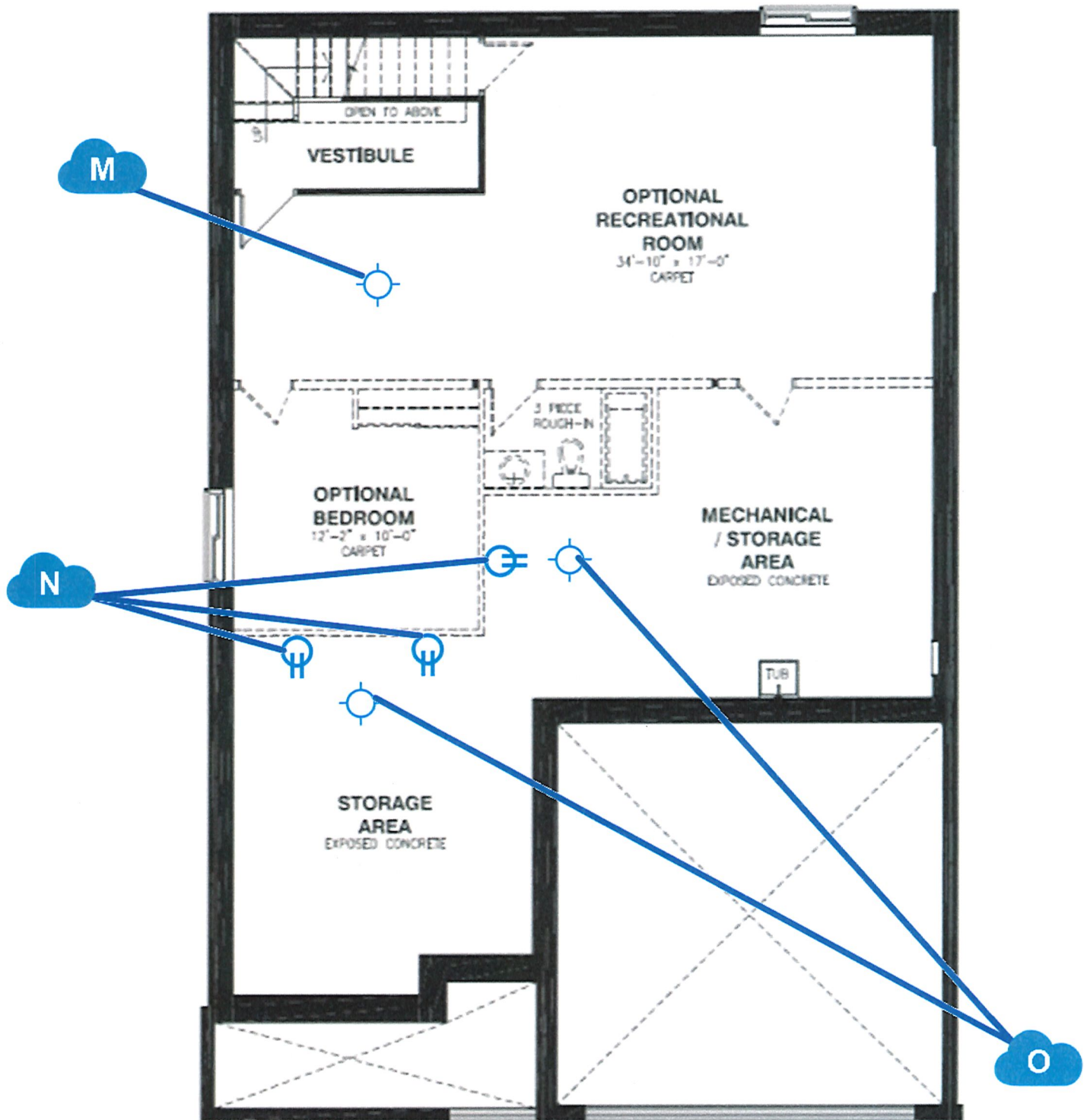

BASEMENT FLOOR - ELEVATION A



Model Name: Morgan "A" Rev.
Site: Place St. Thomas 7
Lot: PST PH7 Lot 5
Date: November 19, 2024

Model #: #1026 Plan #: 50M-361
Purchaser: Sylvie Yollande Rochon
Purchaser: Anthony Paul Latreille

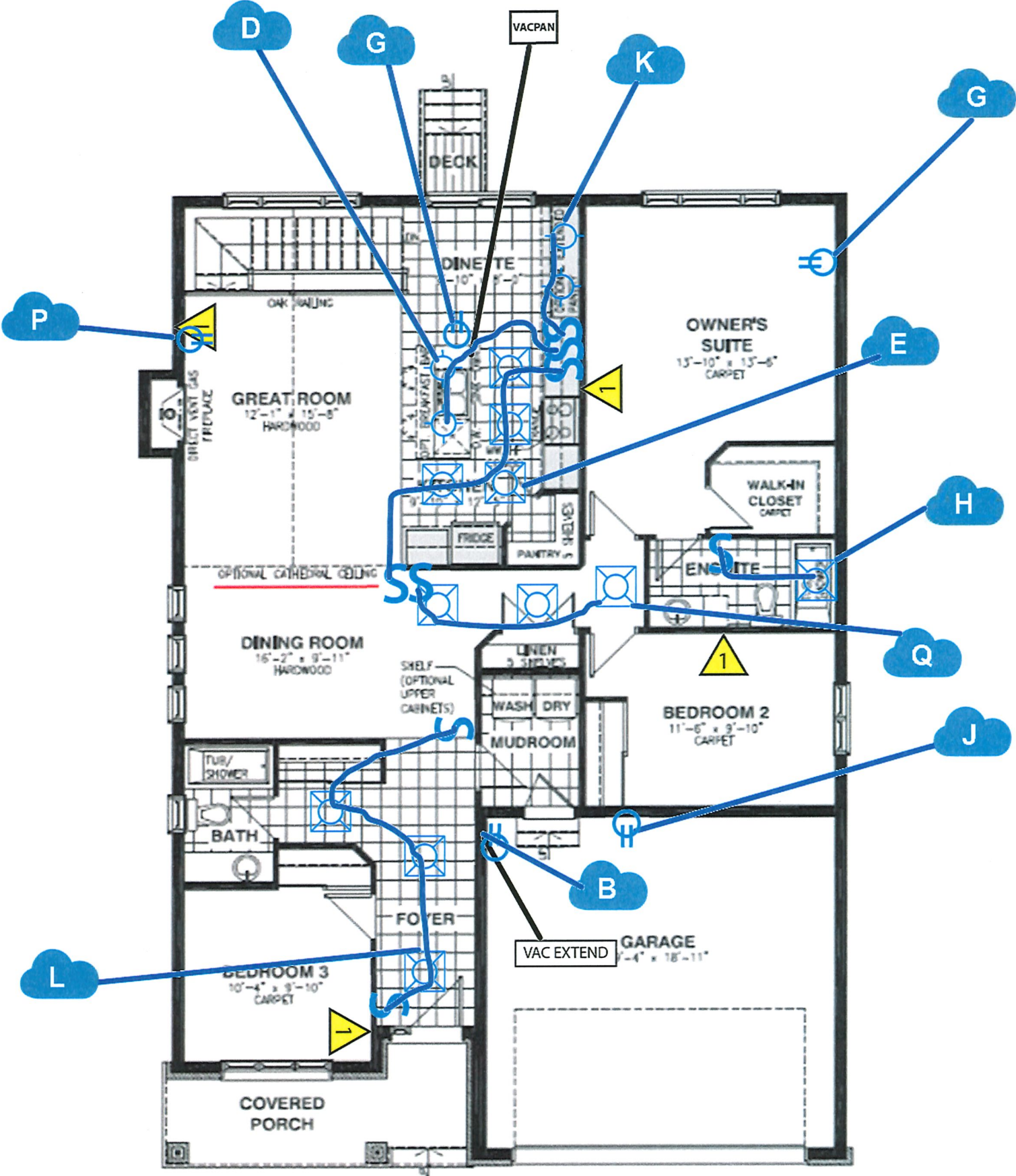

GROUND FLOOR - ELEVATION A