



# Valecraft

## Homes (2019) Limited

Purchase Order

PO0003029

210-1455 Youville Drive  
Ottawa, On K1C 6Z7  
Phone: 613-837-1104

**Vendor:**  
S & S BOLTON ELECTRIC INC.  
5411 CANOTEK ROAD  
OTTAWA, ONTARIO K1J 9M3

**Ship To:**  
Site: SHEA VILLAGE  
Lot/Unit: BLOCK B06  
Model: 130 STANDARD  
Civic: 1136 COPE DRIVE

tel: 613-748-0432  
fax:  
contact:

ORDER DATE Aug 20, 2024	CHG. ORDER DT.	CANCEL DATE	RESPONSIBILITY ARIEL	VENDOR # S02	TERMS NET 30 DAYS
Comments/Special Instructions:					REFERENCE

JOB/LOT/COST	REFERENCE	Description	QTY ORDERED	UNIT PRICE	EXTENSION
020-B06-680	#3	REFER CONSTR. SUMMARY ITEM #3 FINSHED BASEMENT FIREPLACE	1.0000	116.000000	116.00
020-B06-680	#5	REFER CONSTR. SUMMARY ITEM #5 ENSUITE 4PC. BATHROOM	1.0000	295.000000	295.00
020-B06-680	#10	REFER CONSTR. SUMMARY ITEM #10 QUOTE SS6678 REV.02 JUL 15-24	1.0000	2,016.000000	2,016.00

  
Authorized Signature

Subtotal	2,427.00
HST	315.51
<b>Total Order Value</b>	<b>2,742.51</b>

**ORDER TERMS AND CONDITIONS**

1. INVOICES must bear exact same prices and terms or authorization for changes must be received from our company in writing prior to shipping.
2. The right is reserved to cancel all or part of this order if not delivered within the time specified.
3. Packing slips must accompany all shipments.
4. In the event of interruption of our business in whole or in part by reason of fire, flood, windstorm, earthquake, war, strike, embargo, acts of God, governmental action, or any causes beyond our control, we shall have the option of cancelling undelivered orders in whole or in part.
5. Acceptance of this purchase order, or shipment of it will constitute an agreement to all of its specifications as to terms, delivery and prices.
6. No deliveries accepted after 4:00 pm or on weekends.

WHITE - ORIGINAL    CANARY - ACCOUNTS PAYABLE    PINK - DEPARTMENT



Tel: (613) 748-0432  
 Fax: (613) 748-0355

A Division of the S&S Bolton Group  
 www.ssbolton.com

**Estimate No#: SS6678 Rev.02**

Builder Copy

**Customer:**

SV PH1 Lot B06 - Spec

Builder: VALECRAFT HOMES (2019) LTD.  
 Project: Shea Village  
 Lot: SV PH1 Lot B06  
 Closing Date: -

Salesperson: Kyle Takman  
 Date: 07/15/2024

Location	Qty	Product / Installation Details	Plan Code	Unit Price	Customer Total	Builder Total
Family Room	1.00	<b>15 Amp Standard Plug</b> Add 15 AMP plug approx 60 inches from floor beside conduit	A	175.00 \$	175.00 \$	93.00 \$
Kitchen	4.00	<b>4" LED slim Pot Light White (AFR4C-0930-WH)</b> Add 4 LED Halo pot lights (AFR4-0930-WH) on added switch	D	245.00 \$	980.00 \$	520.00 \$
Kitchen	1.00	<b>Single Pole Switch</b> Switch for added pot lights	D	136.00 \$	136.00 \$	72.00 \$
Kitchen	1.00	<b>Standard Light Outlet (Keyless)</b> Add (1) Keyless fixture over island on existing switch	E	160.00 \$	160.00 \$	85.00 \$
Kitchen	1.00	<b>Misc. Product</b> relocate existing fixture over island and leave as keyless	E	\$	0.00 \$	0.00 \$
Various Locations	1.00	<b>15 Amp USB Charger Receptacle</b> USB Charger Receptacle in kitchen and master bedroom (standard items)	F	\$	0.00 \$	0.00 \$
Great Room	6.00	<b>4" LED slim Pot Light White (AFR4C-0930-WH)</b> Add 6 LED Halo pot lights (AFR4-0930-WH) - using control plug switch (sever control to plug)	G	245.00 \$	1,470.00 \$	780.00 \$
Ensuite Bath	1.00	<b>4" LED slim Pot Light White (AFR4C-0930-WH)</b> Add 1 LED Halo pot light (AFR4-0930-WH) on added switch	H	245.00 \$	245.00 \$	130.00 \$
Ensuite Bath	1.00	<b>Single Pole Switch</b> Switch for added pot light	H	136.00 \$	136.00 \$	72.00 \$
Main Bath	1.00	<b>4" LED slim Pot Light White (AFR4C-0930-WH)</b> Add 1 LED Halo pot light (AFR4-0930-WH) on added switch	I	245.00 \$	245.00 \$	130.00 \$
Main Bath	1.00	<b>Single Pole Switch</b> Switch for added pot light	I	136.00 \$	136.00 \$	72.00 \$
Hall	1.00	<b>4" LED slim Pot Light White (AFR4C-0930-WH)</b> Add 1 LED Halo pot light (AFR4-0930-WH) on existing switch	J	245.00 \$	245.00 \$	130.00 \$

www.sandselectric.ca

Phone: (613) 748-0432 | Fax: (613) 748-0355 | Email: info@sandselectric.ca | Website: www.sandselectric.ca

5411 Canotek Road, Ottawa, Ontario K1J 9M3

Printed By: Kyle Takman - Page: 2



Tel: (613) 748-0432  
Fax: (613) 748-0355

A Division of the S&S Bolton Group  
www.ssbolton.com

Location	Qty	Product / Installation Details	Plan Code	Unit Price	Customer Total	Builder Total
Hall	1.00	Misc. Product Delete Standard Fixture	J	-128.00 \$	-128.00 \$	-68.00 \$

\*\*\* Total price does not include any applicable taxes.

**Customer Total: 3,800.00 \$**

**Builder Total: 2,016.00 \$**

\_\_\_\_\_  
Customer Signature

\_\_\_\_\_  
Date



Tel: (613) 748-0432  
Fax: (613) 748-0355

A Division of the S&S Bolton Group  
www.ssbolton.com

**Estimate No#: SS6678 Rev.02**

Builder Copy

Builder: VALECRAFT HOMES (2019) LTD.  
Project: Shea Village  
Lot: SV PH1 Lot B06  
Closing Date: -  
  
Salesperson: Kyle Takman  
Date: 07/15/2024

**Attn: SV PH1 Lot B06 - Spec**

**Re: Upgrade Estimate for Shea Village, Lot: SV PH1 Lot B06**

We are pleased to submit our quotation for your review and consideration. Upon acceptance, please date and sign anywhere a "Customer Signature" and "Date" is requested, including the "Quotation Acceptance" form on the last page of this estimate, and send it back to Kyle Takman at

**Price ..... \$ 3,800.00 + Applicable Taxes**

**Terms and Conditions:**

- 1) Price are valid for 60 days from the date sent to the builder.
- 2) Locations on plan may vary due to mechanical and structural codes and are subject to change without notice. If specific outlet height and location is not specified, outlet will be installed as per installers' best judgement.
- 3) Any revisions related to this document after signing will be subject to a \$200 administration fee. There will also be additional costs to the purchaser for labour and materials required for the changes.
- 4) Any changes that you, the purchaser, may decide to make after the original signing of this document and/or after the 7 day waiting period, may delay the closing date of your home.

Should you have any questions, comments or concerns, please do not hesitate to contact us.

Yours truly,

Kyle Takman, **S&S Electric**

www.sandselectric.ca

Phone: (613) 748-0432 | Fax: (613) 748-0355 | Email: info@sandselectric.ca | Website: www.sandselectric.ca

5 4 1 1 Canotek Road, Ottawa, Ontario K1J 9M3

Printed By: Kyle Takman - Page: 1



Tel: (613) 748-0432  
Fax: (613) 748-0355

A Division of the S&S Bolton Group  
[www.ssbolton.com](http://www.ssbolton.com)

## QUOTATION ACCEPTANCE

(Quote No. SS6678 Rev.02)

I hereby have reviewed the attached quotation SS6678 Rev.02 dated 07/15/2024 for the amount of \$3,800.00, plus any applicable taxes, and understand that this quotation will not be finalized until I have accepted it with my builder, VALECRAFT HOMES (2019) LTD..

I further understand that S&S Electric is not responsible to proceed to supply any goods or services detailed in this quotation until a firm confirmation has been received from the builder, in the form of an VALECRAFT HOMES (2019) LTD. Addendum signed by the client.

I declare that I have read and understand the Terms and Conditions as stated on the attached quotation.

\_\_\_\_\_

Customer Signature

\_\_\_\_\_

Date

Model Name: Lewis Model #: 130 Plan #: \_\_\_\_\_  
 Site: Shea Village Purchaser: Spec  
 Lot: SV Ph1 B06  
 Date: July 15, 2024 Purchaser: \_\_\_\_\_

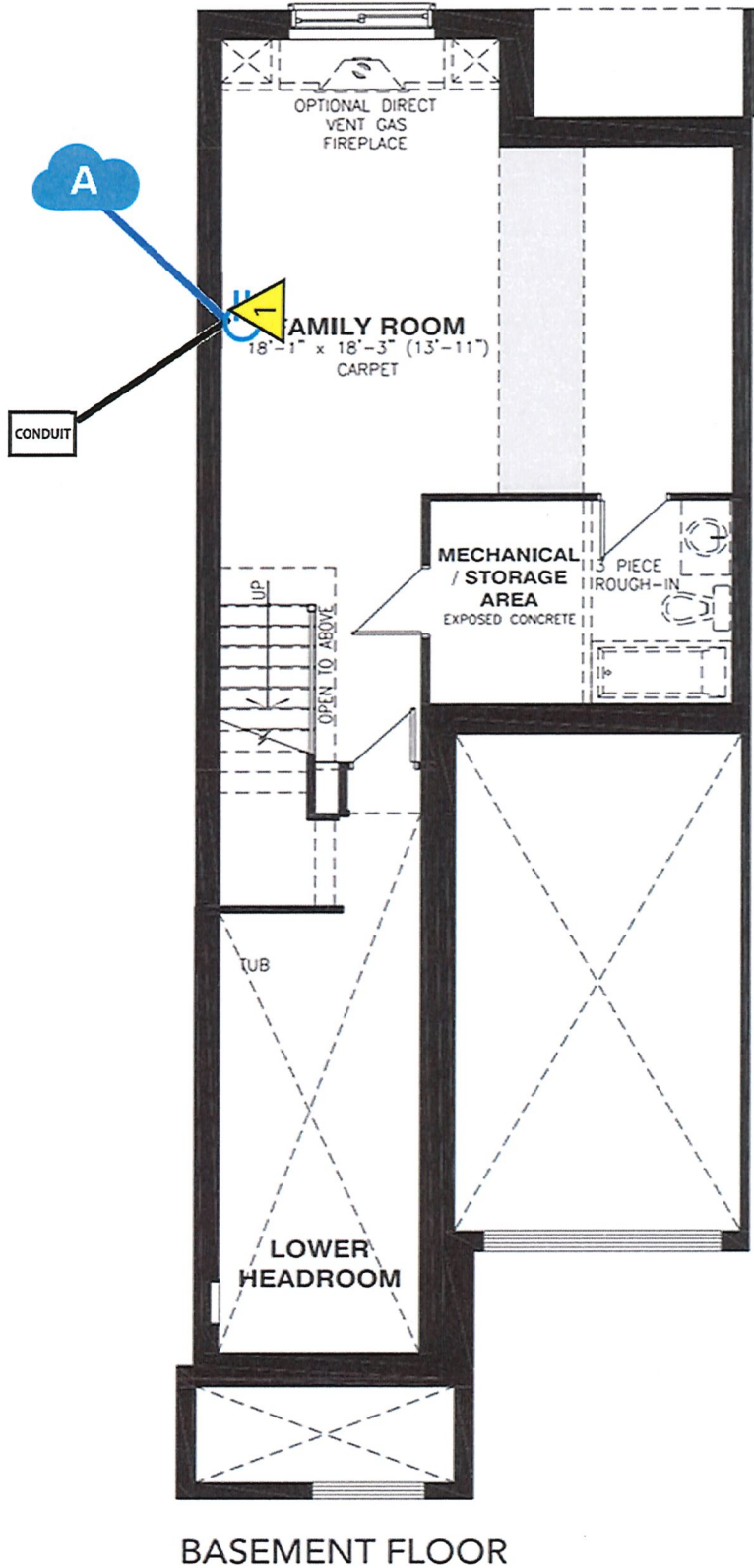

Model Name: Lewis Model #: 130 Plan #: \_\_\_\_\_  
 Site: Shea Village Purchaser: Spec  
 Lot: SV Ph1 B06  
 Date: July 15, 2024 Purchaser: \_\_\_\_\_

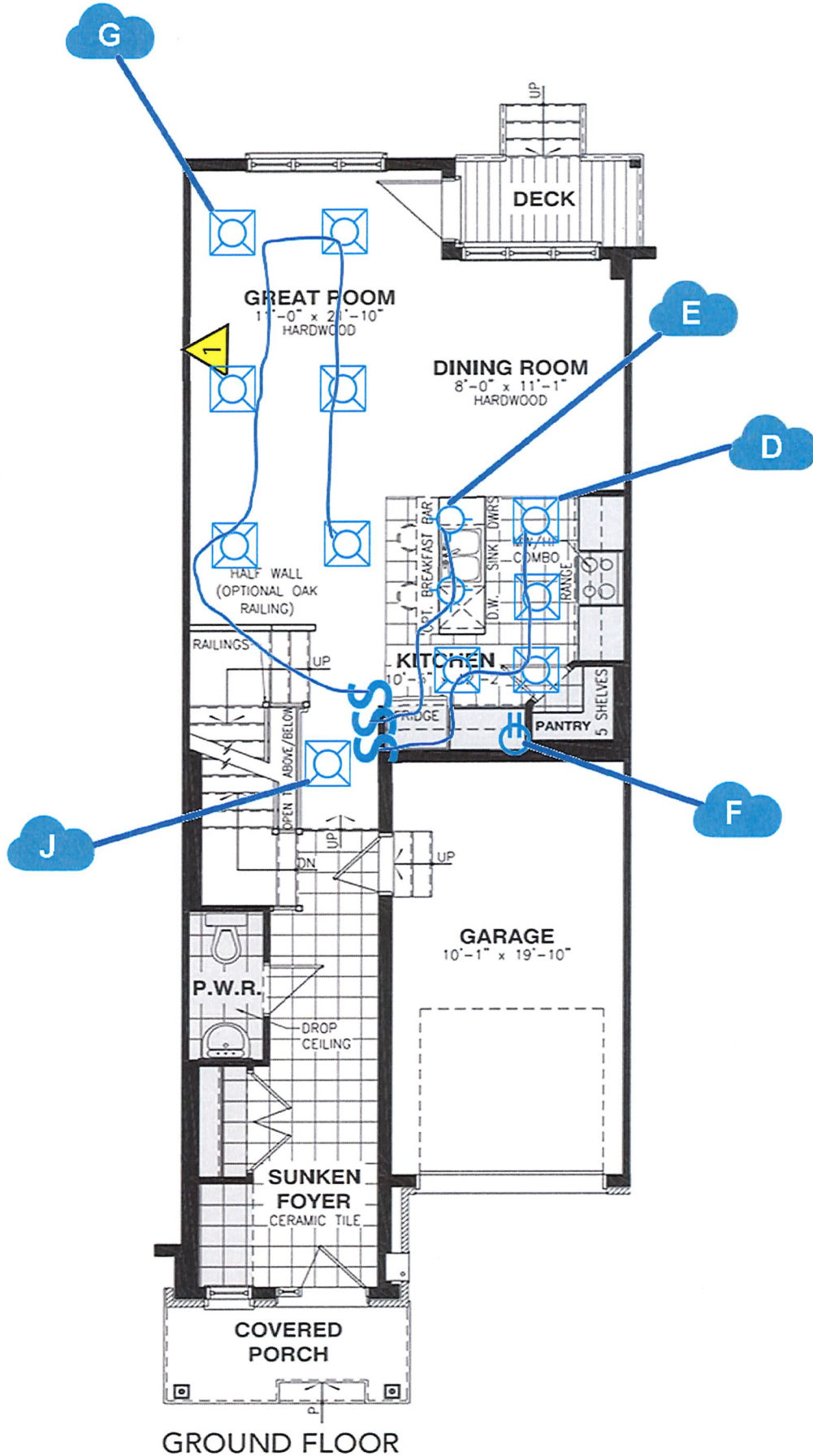



Model Name: Lewis Model #: 130 Plan #: \_\_\_\_\_  
 Site: Shea Village Purchaser: Spec  
 Lot: SV Ph1 B06  
 Date: July 15, 2024 Purchaser: \_\_\_\_\_

