

# KITCHEN SKETCH

## SV PH1 A03

PLEASE APPROVE

**IMPORTANT NOTE: RE: ITEM 23, 2 TONE/COLOUR FOR THE KITCHEN CABINETRY.**

**TF-180** TO BE ON ENLARGED STD PANTRY (#17) + UPPER AND LOWER CABINETS (EXCEPT KITCHEN ISLAND) + POTS AND PANS + UPC9-2B  
**TF-177** TO BE ON KITCHEN ISLAND CABINETRY.

**TF-180** COLOUR TO BE ON ENLARGED STD  
PANTRY, UPPER AND LOWER CABINETRY, POTS AND  
PANS + UPC9-2B (EXCEPT KITCHEN ISLAND)

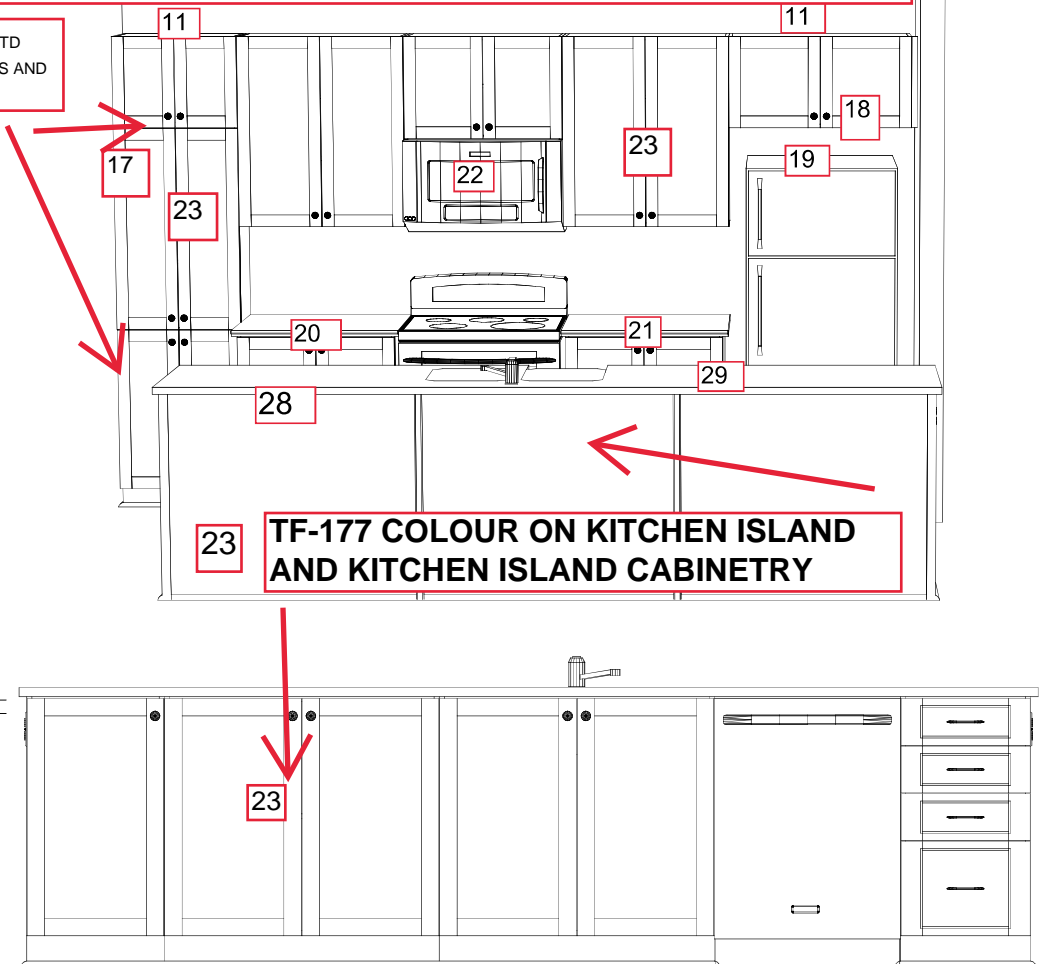
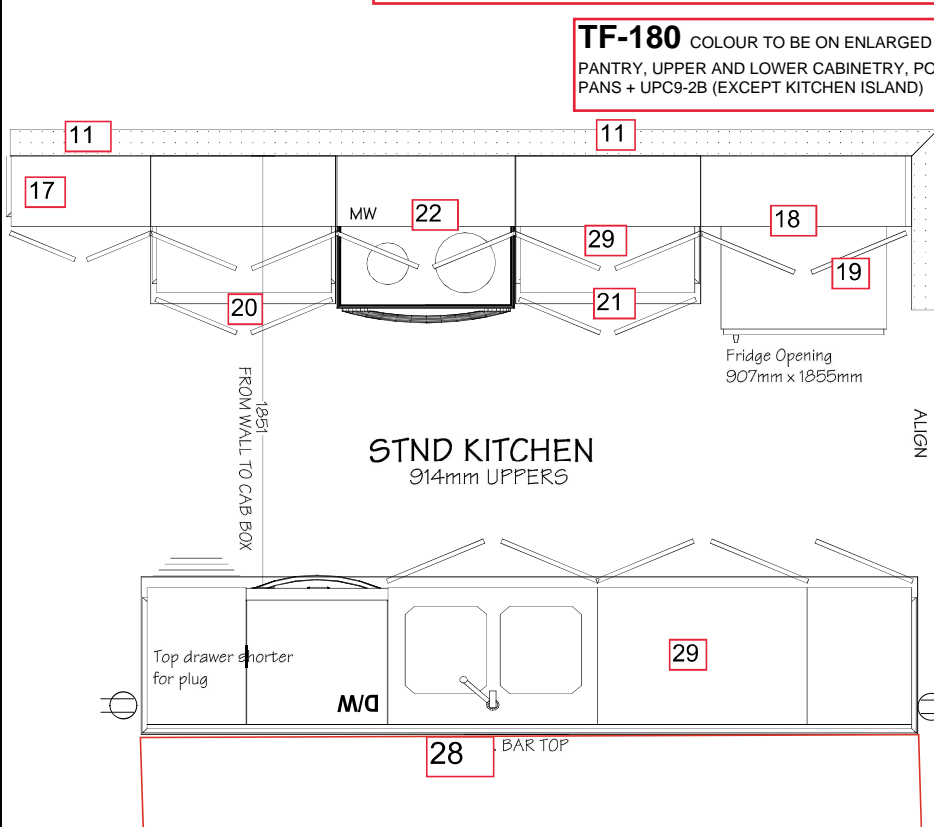

\*DIMENSIONS MAY VARY ON SITE MEASURES/CONDITIONS\*