



Valecraft

Homes (2019) Limited

210-1455 Youville Drive
Ottawa, On K1C 6Z7
Phone: 613-837-1104

Purchase Order PO0002942

Vendor:
S & S BOLTON ELECTRIC INC.
5411 CANOTEK ROAD
OTTAWA, ONTARIO K1J 9M3

tel: 613-748-0432
fax:
contact:

Ship To:
Site: SHEA VILLAGE
Lot/Unit: BLOCK B09
Model: 120 REVERSED
Civic: 1142 COPE DRIVE

ORDER DATE	CHG. ORDER DT.	CANCEL DATE	RESPONSIBILITY	VENDOR #	TERMS
Jul 19, 2024			ARIEL	S02	NET 30 DAYS
Comments/Special Instructions:					REFERENCE

JOB/LOT/COST	REFERENCE	Description	QTY ORDERED	UNIT PRICE	EXTENSION
020-B09-680	#2	REFER CONSTR. SUMMARY ITEM #2 OPTIONAL FIREPLACE IN BASEMENT	1.0000	116.000000	116.00
020-B09-680	#8	REFER CONSTR. SUMMARY ITEM #8 ENSUITE 4PC. BATHROOM	1.0000	100.000000	100.00
020-B09-680	#15	REFER CONSTR. SUMMARY ITEM #15 MASTER BEDROOM CEILING LIGHT	1.0000	63.000000	63.00
020-B09-680	#17	REFER CONSTR. SUMMARY ITEM #17 KITCHEN MICROWAVE OUTLET	1.0000	172.000000	172.00
020-B09-680	#65	REFER CONSTR. SUMMARY ITEM #65 QUOTE SS6672 REV.01 JUL 15-24	1.0000	4,523.000000	4,523.00

<div>Authorized Signature</div>	Subtotal	4,974.00
	HST	646.62
	Total Order Value	5,620.62

ORDER TERMS AND CONDITIONS

1. INVOICES must bear exact same prices and terms or authorization for changes must be received from our company in writing prior to shipping.

2. The right is reserved to cancel all or part of this order if not delivered within the time specified.

3. Packing slips must accompany all shipments.

4. In the event of interruption of our business in whole or in part by reason of fire, flood, windstorm, earthquake, war, strike, embargo, acts of God, governmental action, or any causes beyond our control, we shall have the option of cancelling undelivered orders in whole or in part.

5. Acceptance of this purchase order, or shipment of it will constitute an agreement to all of its specifications as to terms, delivery and prices.

6. No deliveries accepted after 4:00 pm or on weekends.

WHITE - ORIGINAL CANARY - ACCOUNTS PAYABLE PINK - DEPARTMENT



Tel: (613) 748-0432
Fax: (613) 748-0355

A Division of the S&S Bolton Group
www.ssbolton.com

Estimate No#: SS6672 Rev.01

Builder Copy

Customer:

Shawn Alexander Stewart
Home: 613-795-3025
Email: shawns_leafs16@hotmail.com

Builder: VALECRAFT HOMES (2019) LTD.
Project: Shea Village
Lot: SV PH1 Lot B09
Closing Date: 07/25/2025

Salesperson: Kyle Takman
Date: 07/15/2024

Location	Qty	Product / Installation Details	Plan Code	Unit Price	Customer Total	Builder Total
Kitchen	1.00	Upgrade existing receptacle to 15 or 20 Amp USB A Upgrade existing receptacle to 15 or 20 Amp USB A	A	87.00 \$	87.00 \$	46.00 \$
Kitchen	2.00	Misc. Product (2) Dorothy Pendants over island (total 2 pendants on dimmer)	B	428.00 \$	856.00 \$	454.00 \$
Kitchen	1.00	Standard Light Outlet (Keyless) Add (1) octagon box over island on existing switch	B	160.00 \$	160.00 \$	85.00 \$
Kitchen	1.00	Misc. Product Relocate existing fixture over island and delete fixture	B	-47.00 \$	-47.00 \$	-25.00 \$
Kitchen	1.00	Upgrade Switch to Dimmer Upgrade Switch to Dimmer	B	121.00 \$	121.00 \$	64.00 \$
Various Locations	2.00	Misc. Product USB Charger Receptacle in kitchen and master bedroom (standard items)	D	\$	0.00 \$	0.00 \$
Kitchen	3.00	4" LED slim Pot Light White (AFR4C-0930-WH) Add 3 LED Halo pot lights (AFR4-0930-WH) on added switch	C	245.00 \$	735.00 \$	390.00 \$
Kitchen	1.00	Single Pole Switch Added switch for pot lights	C	136.00 \$	136.00 \$	72.00 \$
Kitchen	1.00	Upgrade Switch to Dimmer Upgrade Switch to Dimmer	C	121.00 \$	121.00 \$	64.00 \$
Great Room	6.00	4" LED slim Pot Light White (AFR4C-0930-WH) Add 6 LED Halo pot lights (AFR4-0930-WH) on added switch	E	245.00 \$	1,470.00 \$	780.00 \$
Great Room	1.00	Single Pole Switch Added switch for pot lights	E	136.00 \$	136.00 \$	72.00 \$

Phone: (613) 748-0432 | Fax: (613) 748-0355 | Email: info@sandselectric.ca | Website: www.sandselectric.ca

5411 Canotek Road, Ottawa, Ontario K1J 9M3

Printed By: Kyle Takman - Page: 2

RECEIVED
JUL 18 2024



Tel: (613) 748-0432
Fax: (613) 748-0355

A Division of the S&S Bolton Group
www.ssbolton.com

Location	Qty	Product / Installation Details	Plan Code	Unit Price	Customer Total	Builder Total
Great Room	1.00	Upgrade Switch to Dimmer Upgrade Switch to Dimmer	E	121.00 \$	121.00 \$	64.00 \$
Ensuite Bath	1.00	4" LED slim Pot Light White (AFR4C-0930-WH) Add 1 LED Halo pot light (AFR4-0930-WH) on added switch	F	245.00 \$	245.00 \$	130.00 \$
Ensuite Bath	1.00	Single Pole Switch Switch for added pot light	F	136.00 \$	136.00 \$	72.00 \$
Ensuite Bath	1.00	Upgrade Switch to Dimmer Upgrade Switch to Dimmer	F	121.00 \$	121.00 \$	64.00 \$
Main Bath	1.00	4" LED slim Pot Light White (AFR4C-0930-WH) Add 1 LED Halo pot light (AFR4-0930-WH) on existing switch	G	245.00 \$	245.00 \$	130.00 \$
Owners Suite	1.00	15 Amp Standard Plug Offset standard plug and add (1) 15 Amp Standard Plug	H	175.00 \$	175.00 \$	93.00 \$
Owners Suite	4.00	4" LED slim Pot Light White (AFR4C-0930-WH) Add 4 LED Halo pot light (AFR4-0930-WH) on added switch pot lights not to be under fan blades, distance to be at least 27 inches away from centered ceiling fixture	I	245.00 \$	980.00 \$	520.00 \$
Owners Suite	1.00	Single Pole Switch Single Pole Switch	I	136.00 \$	136.00 \$	72.00 \$
Owners Suite	1.00	Upgrade Switch to Dimmer Upgrade Switch to Dimmer	I	121.00 \$	121.00 \$	64.00 \$
Hall	1.00	15 Amp Standard Plug Add (1) 15 Amp Standard Plug	J	175.00 \$	175.00 \$	93.00 \$
Soffit	2.00	2 * 4" LED 2nd floor slim Soffit Pot Light Black (AFR4-0930-BK) Add 2 LED Halo pot light (AFR4-0930-BK) on existing front out switch	K	251.00 \$	502.00 \$	266.00 \$
Main Bath	1.00	Misc. Product vanity fixture to have octagon box	L	\$	0.00 \$	0.00 \$
Ensuite Bath	1.00	Misc. Product vanity fixture to have octagon box	M	\$	0.00 \$	0.00 \$
Powder Room	1.00	Misc. Product vanity fixture to have octagon box	N	\$	0.00 \$	0.00 \$
Front Out	1.00	15 Amp Separate Circuit Soffit Plug w/ Switch 15 Amp Separate Circuit Soffit Plug w/ Switch	O	411.00 \$	411.00 \$	218.00 \$

Phone: (613) 748-0432 | Fax: (613) 748-0355 | Email: info@sandselectric.ca | Website: www.sandselectric.ca

5411 Canotek Road, Ottawa, Ontario K1J 9M3

Printed By: Kyle Takman - Page: 3

RECEIVED
JUL 18 2024

www.sandselectric.ca



Tel: (613) 748-0432
Fax: (613) 748-0355

A Division of the S&S Bolton Group
www.ssbolton.com

Location	Qty	Product / Installation Details	Plan Code	Unit Price	Customer Total	Builder Total
Mechanical Room	1.00	Supply and Install Whole House Surgebreaker Plus Protection (SDSB80111C) Complete with 2 Pole 20 amp breaker Supply and Install Whole House Surgebreaker Plus Protection (SDSB80111C) Complete with 2 Pole 20 amp breaker	P	980.00 \$	980.00 \$	520.00 \$
Family Room	1.00	15 Amp Standard Plug Add (1) 15 Amp Standard Plug	Q	175.00 \$	175.00 \$	93.00 \$
Owners Suite	1.00	Upgrade Standard Light Outlet for a Future Ceiling Fan c/w 3 Wires Upgrade Standard Light Outlet for a Future Ceiling Fan c/w 3 Wires	R	230.00 \$	230.00 \$	122.00 \$

*** Total price does not include any applicable taxes.

Customer Total: 8,528.00 \$

Builder Total: 4,523.00 \$

Customer Signature

Date

www.sandselectric.ca

Phone: (613) 748-0432 | Fax: (613) 748-0355 | Email: info@sandselectric.ca | Website: www.sandselectric.ca

5411 Canotek Road, Ottawa, Ontario K1J 9M3

Printed By: Kyle Takman - Page: 4

RECEIVED
JUL 18 2024



Valecraft
Homes (2019) Limited

S&S / Orbital Sketch

S&S ORBITAL SKETCH

Model Name: The huntley

Model #: 120

Plan #: 4M-1740

Site: Shea Village Ph1

Purchaser: _____

Lot: SV PH1 B09

Date: July 15, 2024

Purchaser: _____

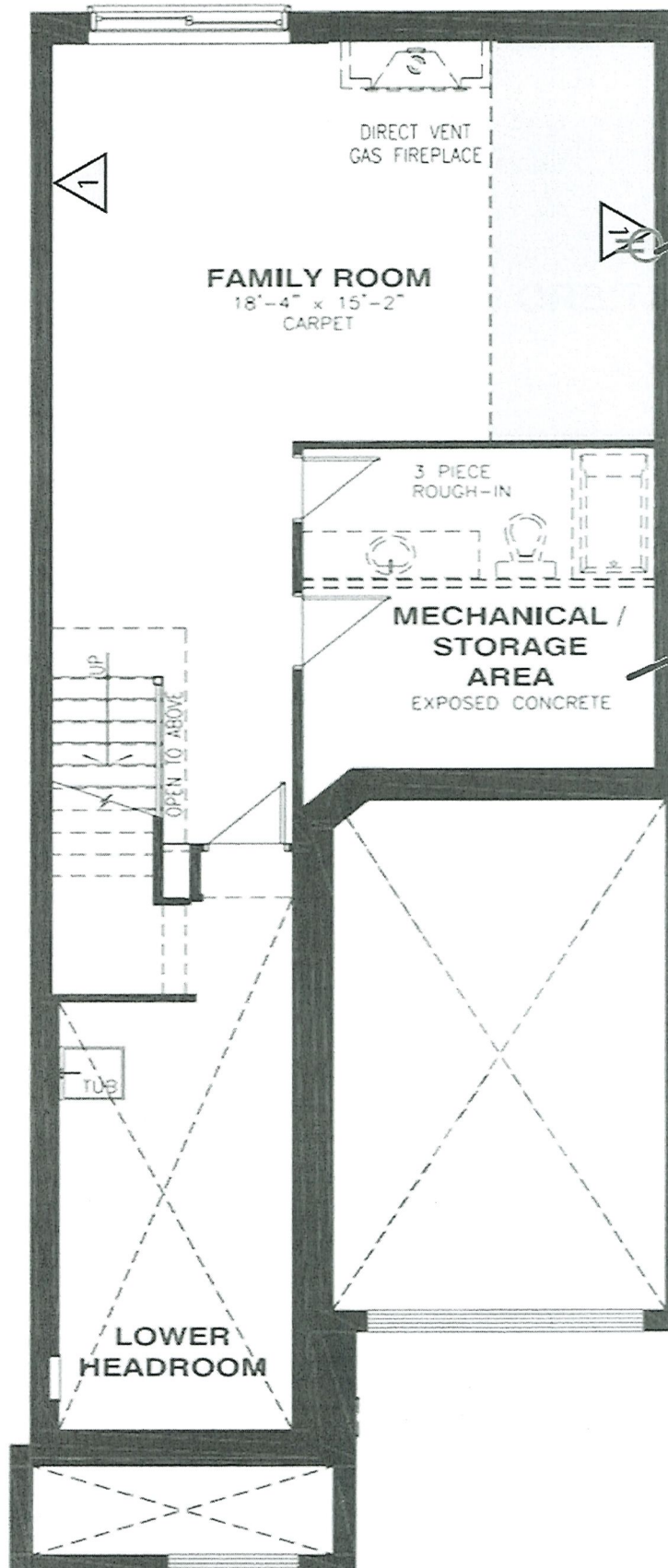

BASEMENT FLOOR

RECEIVED

JUL 18 2024

Model Name: The huntley

Model #: 120

Plan #: 4M-1740

Site: Shea Village Ph1

Purchaser: _____

Lot: SV PH1 B09

Date: July 15, 2024

Purchaser: _____

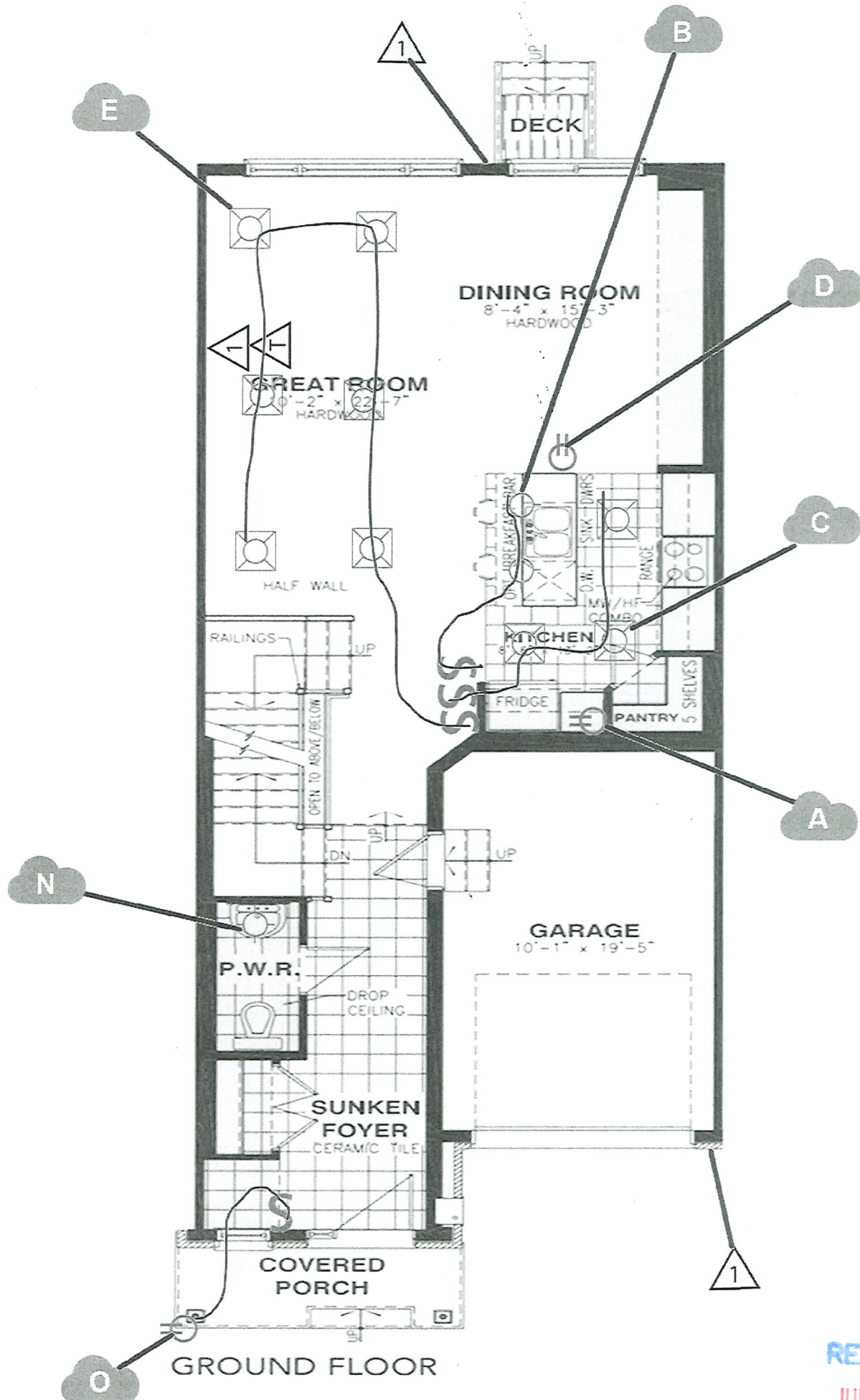

RECEIVED

JUL 18 2024



Valecraft
Homes (2019) Limited

S&S / Orbital Sketch

S&S ORBITAL SKETCH

Model Name: The huntley

Model #: 120

Plan #: 4M-1740

Site: Shea Village Ph1

Purchaser: _____

Lot: SV PH1 B09

Date: July 15, 2024

Purchaser: _____

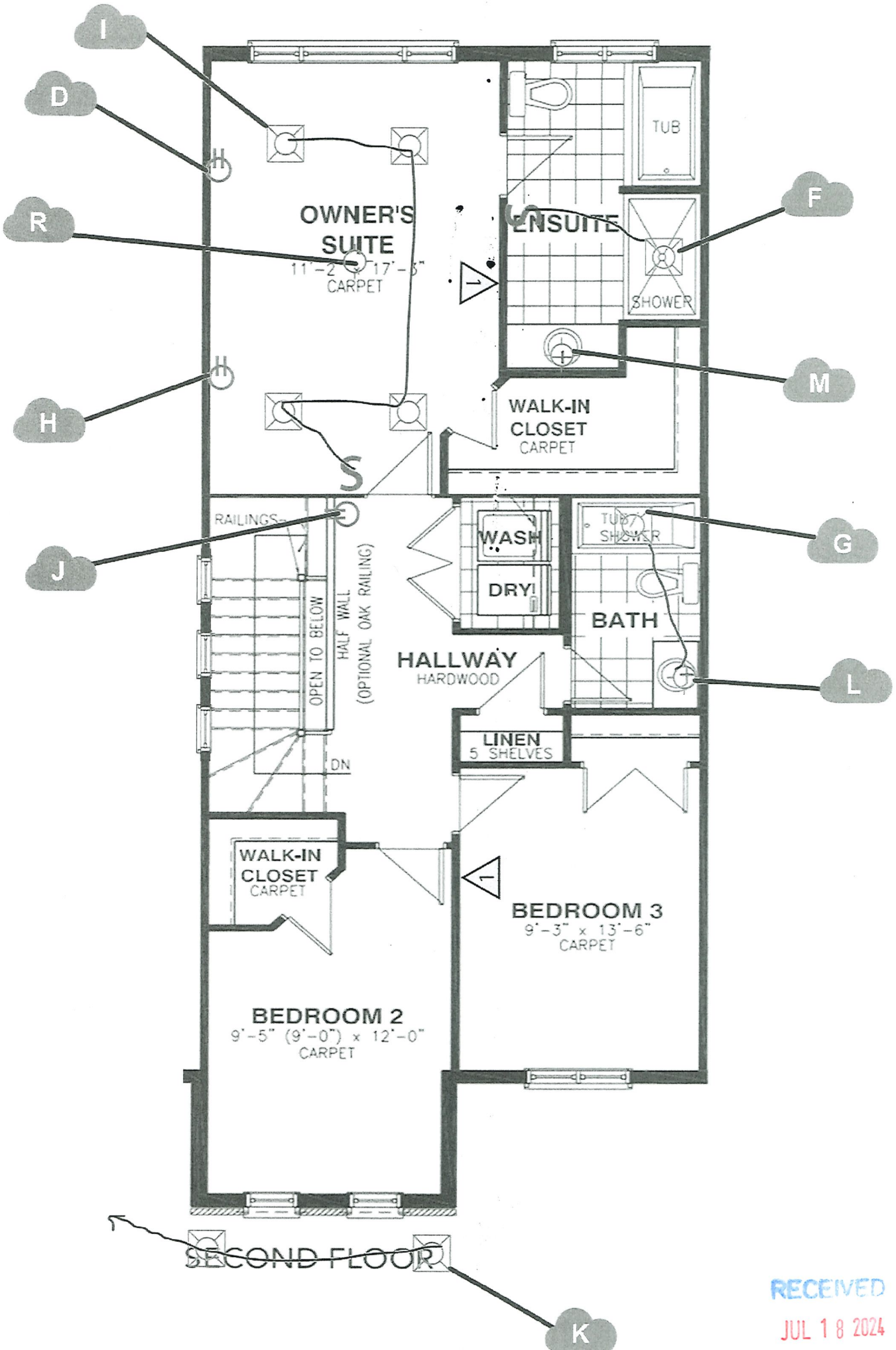

RECEIVED

JUL 18 2024