



NON STANDARD EXTRAS (680)

Shea Village - Phase 1

PURCHASERS: Derek David Jones and Courtney Anderson

Printed: 26-Mar-24 10:14 am

LOT NUMBER	PHASE	HOUSE TYPE	CLOSING DATE
15	1	1015 THE MURRY ELEV A	29-Oct-24

ITEM	QTY	EXTRA / CHANGE	PRICE	INTERNAL USE
76		1 - - DELETE ITEM # 57 (RE: S&S QUOTE UPGRADES AS PER ATTACHED QUOTE AND SKETH DATED 02/20/2024)	-\$8,000.40	Each
42826		Note: - As per Quote # SS6611 Rev.04 and Sketch dated February 20, 2024.		
*77 121356		1 - - S&S ELECTRIC UPGRADES AS PER ATTACHED QUOTE & SKETCH.	* \$8,000.40	Each
42828		Note: As per Quote# SS6611 Rev.05 dated March 21, 2024.		
78		1 - - DELETE ITEM #58 (RE: ORBITAL UPGRADES AS PER ATTACHED QUOTE AND SKETCH 02/20/2024)	\$0.00	Each
42829		Note: -As per Quote# OR8241 Rev.04 & Sketch dated February 20, 2024.		
*79 121357		1 - - ORBITAL UPGRADES AS PER ATTACHED QUOTE & SKETCH.	* \$0.00	Each
42830		Note: As per Quote #OR8241 Rev.05 dated March 21, 2024.		

Sub Total	\$0.00
HST	\$0.00
Total	\$0.00

Payment Summary	
<u>Paid By</u>	<u>Amount</u>
<u>Total Payment:</u>	

PURCHASER:

DocuSigned by:

Derek David Jones

FFEA4C2292624FF...

DocuSigned by:

Courtney Anderson

79A52B33367D491...

26-Mar-24

DATE

PURCHASER:

DocuSigned by:

Courtney Anderson

79A52B33367D491...

26-Mar-24

DATE

VENDOR:

DocuSigned by:

A04F827301214EE...

DocuSigned by:

A04F827301214EE...

March 26, 2024

DATE:

PREPARED BY: Lisa Ballard  
LOCKED BY: Lisa Ballard  
PE 2,071-1  
InvoiceSQL.rpt 01sept21

CONSTRUCTION SCHEDULING APPROVAL	
PER:	
DATE:	



Tel: (613) 748-0432  
Fax: (613) 748-0355

A Division of the S&S Bolton Group  
www.ssbolton.com

Estimate No#: OR8241 Rev.05  
Customer Copy

Customer:

Derek David Jones & Courtney Anderson  
Home: 705-440-9039, 705-796-2875  
Email: derek\_jones@live.ca;  
cd\_anderson@hotmail.com

Builder: VALECRAFT HOMES (2019) LTD.  
Project: Shea Village  
Lot: Shea Village Lot 15  
Closing Date: 10/29/2024  
  
Salesperson: Kyle Takman (OR)  
Date: 03/21/2024

Location	Qty	Product / Installation Details	Plan Code	Unit Price	Customer Total
N/A	2.00	Vacuum Rough-In Outlet Vacuum Rough-In Outlets		\$	\$0.00
Great Room	1.00	(1) Port Plate - (1) Data CAT6 Outlet (1) Port Plate - (1) Data CAT6 Outlet - Location as shown on floor plan		\$	\$0.00
Ensuite Bath	1.00	(1) Port Plate - (1) Data CAT6 Outlet (1) Port Plate - (1) Data CAT6 Outlet - Location as shown on floor plan - approximately 5.5ft from floor beside electrical outlet		\$	\$0.00
Flex Room	1.00	(1) Port Plate - (1) Data CAT6 Outlet (1) Port Plate - (1) Data CAT6 Outlet - Location as shown on floor plan		\$	\$0.00
Garage	1.00	(1) Port Plate - (1) Data CAT6 Outlet (1) Port Plate - (1) Data CAT6 Outlet - Location as shown on floor plan - approximately 7ft from floor beside electrical outlet		\$	\$0.00
Customer Subtotal:					\$0.00
HST:					\$0.00
Total:					\$0.00

\*\*\* Total price includes all applicable taxes

DocuSigned by:  
  
Customer Signature

March 26-2024  
Date

DocuSigned by:  
  
Customer Sign

March 26-2024  
Date



Tel: (613) 748-0432  
Fax: (613) 748-0355

A Division of the S&S Bolton Group  
www.ssbolton.com

DS

DDJ

DS

CA

DS

FN

Estimate No#: SS6611 Rev.05  
Customer Copy

Customer:

Derek David Jones & Courtney Anderson  
Home: 705-440-9039, 705-796-2875  
Email: derek\_jones@live.ca;  
cd\_anderson@hotmail.com

Builder: VALECRAFT HOMES (2019) LTD.  
Project: Shea Village  
Lot: Shea Village Lot 15  
Closing Date: 10/29/2024  
Salesperson: Kyle Takman  
Date: 03/20/2024

Location	Qty	Product / Installation Details	Plan Code	Unit Price	Customer Total
Family Room	1.00	<b>15 Amp Standard Plug</b> Add 15 AMP plug aprox 65 inches from floor over fireplace	A	\$175.00	\$175.00
Kitchen	1.00	<b>Misc. Product</b> Relocate (2) Standard fixtures (from kitchen and dinette) over island and leave as keyless on existing switch	B	\$	\$0.00
Kitchen	2.00	<b>Standard Light Outlet (Keyless)</b> Add (2) Keyless fixtures over island on on existing switch	B	\$160.00	\$320.00
Kitchen	1.00	<b>Misc. Product</b> Delete Standard Fixture (kitchen)	B	\$-47.00	\$-47.00
Dinette	1.00	<b>Misc. Product</b> Delete standard Fixture (dinette)	B	\$-98.00	\$-98.00
Kitchen	5.00	<b>4" LED slim Pot Light White (AFR4C-0930-WH)</b> Add 5 LED Halo pot lights (AFR4-0930-WH) on existing switch	C	\$277.00	\$1,385.00
Various Locations	1.00	<b>15 Amp USB Charger Receptacle</b> USB Charger Receptacle in kitchen and Great Room (standard items) See item N for Great Room Location	D	\$	\$0.00
Great Room	4.00	<b>4" LED slim Pot Light White (AFR4C-0930-WH)</b> Add 4 LED Halo pot lights (AFR4-0930-WH) on existing switch	E	\$277.00	\$1,108.00
Great Room	1.00	<b>Misc. Product</b> sever connection to switched outlets and use switch for added potlights	E	\$	\$0.00
Great Room	1.00	<b>3-Way Switch</b> Add 3-Way Switch to pot lights in great room	E	\$164.00	\$164.00

Phone: (613) 748-0432 | Fax: (613) 748-0355 | Email: info@sandselectric.ca | Website: www.sandselectric.ca  
5411 Canotek Road, Ottawa, Ontario K1J 9M3



Tel: (613) 748-0432  
Fax: (613) 748-0355

A Division of the S&S Bolton Group  
www.ssbolton.com



Location	Qty	Product / Installation Details	Plan Code	Unit Price	Customer Total
Ensuite Bath	1.00	<b>4" LED slim Pot Light White (AFR4C-0930-WH)</b> Add 1 LED Halo pot light (AFR4-0930-WH) on existing switch (from vanity lights)	F	\$277.00	\$277.00
Basement Bath	1.00	<b>4" LED slim Pot Light White (AFR4C-0930-WH)</b> Add 1 LED Halo pot light (AFR4-0930-WH) on added switch	I	\$277.00	\$277.00
Basement Bath	1.00	<b>Single Pole Switch</b> Added switch for pot light	I	\$136.00	\$136.00
Ensuite Bath	2.00	<b>15 Amp GFI Bathroom Plug</b> Add (2) receptacles centered with each sink, 24 inches above counter level	J	\$279.00	\$558.00
Ensuite Bath	2.00	<b>Misc. Product</b> Delete (2) standard vanity Fixtures	J	\$-166.00	\$-332.00
Ensuite Bath	1.00	<b>Standard Light Outlet (Keyless)</b> Add (1) Additional Light fixture near vanity (wiring and oct box) on existing switch	K	\$160.00	\$160.00
Ensuite Bath	1.00	<b>Misc. Product</b> Add (1) Bath Ceiling Fixture (SAN-A2012-11) (actual fixture) on existing switch	K	\$74.00	\$74.00
Dining	1.00	<b>Misc. Product</b> If possible Standard plug to be offset to be closer to corner of room, and not centered under window.	M	\$	\$0.00
Great Room	1.00	<b>15 Amp Standard Plug</b> Add (1) 15 Amp Standard Plug at approximately 48" from floor	N	\$175.00	\$175.00
Laundry Room	1.00	<b>15 Amp Standard Plug</b> Add (1) 15 Amp Standard Plug on side wall if possible	O	\$175.00	\$175.00
Ensuite Bath	1.00	<b>15 Amp GFI Bathroom Plug</b> 15 Amp GFI Bathroom Plug approximate 5.5ft from floor	P	\$279.00	\$279.00
Bedroom #2	1.00	<b>Misc. Product</b> Standard Plug and data to be approximately 4ft from laundry room wall	Q	\$	\$0.00
Front Out	3.00	<b>1 * 4" LED 2nd floor slim Soffit Pot Light White (AFR4C-0930-WH)</b> Add 3 LED Halo soffit pot lights (AFR4-0930-WH) on existing switch	R	\$288.00	\$864.00
Front Out	1.00	<b>Misc. Product</b> Delete Standard front out fixture to be replaced with soffit pot lights on existing switch	R	\$-180.00	\$-180.00
Laundry	1.00	<b>Misc. Product</b> Relocate washer and Dryer, flip orientation.	S	\$	\$0.00

Phone: (613) 748-0432 | Fax: (613) 748-0355 | Email: info@sandselectric.ca | Website: www.sandselectric.ca

5 4 1 1 C a n o t e k R o a d , O t t a w a , O n t a r i o K 1 J 9 M 3





Tel: (613) 748-0432  
Fax: (613) 748-0355

A Division of the S&S Bolton Group  
www.ssbolton.com



Location	Qty	Product / Installation Details	Plan Code	Unit Price	Customer Total
Garage	1.00	<b>15 Amp Separate Circuit Plug</b> Add(1) 15 Amp Separate Circuit Plug (to be on same circuit as plug with arrow connected **only 2 plugs on this circuit**) - plug to be approximately 48 inches from floor, and at least 52" from side wall	T	\$349.00	\$349.00
Garage	1.00	<b>15 Amp Separate Circuit Plug</b> Add(1) 15 Amp Separate Circuit Plug (to be on same circuit as plug with arrow connected **only 2 plugs on this circuit**) - plug to be approximately 48 inches from floor, and at least 52" from side wall	U	\$349.00	\$349.00
Garage	1.00	<b>15 Amp Separate Circuit Plug</b> Add (1) 15 Amp Separate Circuit Plug near ceiling for future heater on added switch	V	\$349.00	\$349.00
Garage	1.00	<b>Single Pole Switch</b> Add (1) switch for heater. **Not ganged with other switches**	V	\$110.00	\$110.00
Kitchen	1.00	<b>Misc. Product</b> relocate Microwave plug	W	\$	\$0.00
Great Room	1.00	<b>Misc. Product</b> Push second plug on back of master bedroom wall closer to corner of room if possible	X	\$	\$0.00
Garage	1.00	<b>15 Amp Standard Plug</b> Add (1) 15 Amp Standard Plug approximately 7ft from floor	Y	\$175.00	\$175.00
Front Out	2.00	<b>15 Amp Standard Plug</b> Add (2) 15 Amp Standard Plug in soffit for future security camera	Z	\$175.00	\$350.00
Back Out	1.00	<b>15 Amp Standard Plug</b> Add (1) 15 Amp Standard Plug in soffit for future security camera	ZA	\$175.00	\$175.00
Owners Suite	2.00	<b>Misc. Product</b> Relocate standard plugs - The two standard plugs on this wall are to be 8ft apart	ZB	\$	\$0.00
Owners Suite	1.00	<b>Misc. Product</b> Delete Standard Fixture and leave as keyless	ZC	\$-47.00	\$-47.00
Dining	1.00	<b>Misc. Product</b> Delete Standard Fixture and leave as keyless	ZD	\$-160.00	\$-160.00
Hall / Foyer	4.00	<b>Misc. Product</b> Delete Standard Fixture and leave as keyless (entry, hallway near dining room, hallway near powder room, stairs)	ZE	\$-47.00	\$-188.00
1st Garage Plug	1.00	<b>15 Amp Standard Plug</b> Add (1) 15 Amp Standard Plug	ZF	\$148.00	\$148.00

Phone: (613) 748-0432 | Fax: (613) 748-0355 | Email: info@sandselectric.ca | Website: www.sandselectric.ca

5 4 1 1 Canotek Road, Ottawa, Ontario K1J 9M3



Tel: (613) 748-0432  
Fax: (613) 748-0355

A Division of the S&S Bolton Group  
www.ssbolton.com

\*\*\* Total price includes all applicable taxes

Customer Subtotal:	\$7,080.00
HST:	\$920.40
<b>Total:</b>	<b>\$8,000.40</b>

DocuSigned by:  
*Derek David Jones*  
FPEA4C2292024FF...  
Customer Signature

March 26-2024  
Date

DS  
FN

DocuSigned by:  
*Courtney Anderson*  
79A52B33367D491...  
Customer Sign

March 26-2024  
Date

DS  
FN



S&S / Orbital Sketch

SS OR Sketches

Model Name: Murry  
Site: Shea Village  
Lot: Lot 15  
Date: March 21 2024

Model #: 1015 Plan #: A  
Purchaser: Derek David Jones  
Purchaser: Courtney Anderson

DocuSigned by: Derek David Jones DS FN  
FFEA4C2292624FF...  
DocuSigned by: Courtney Anderson DS FN  
79A52B33367D491...

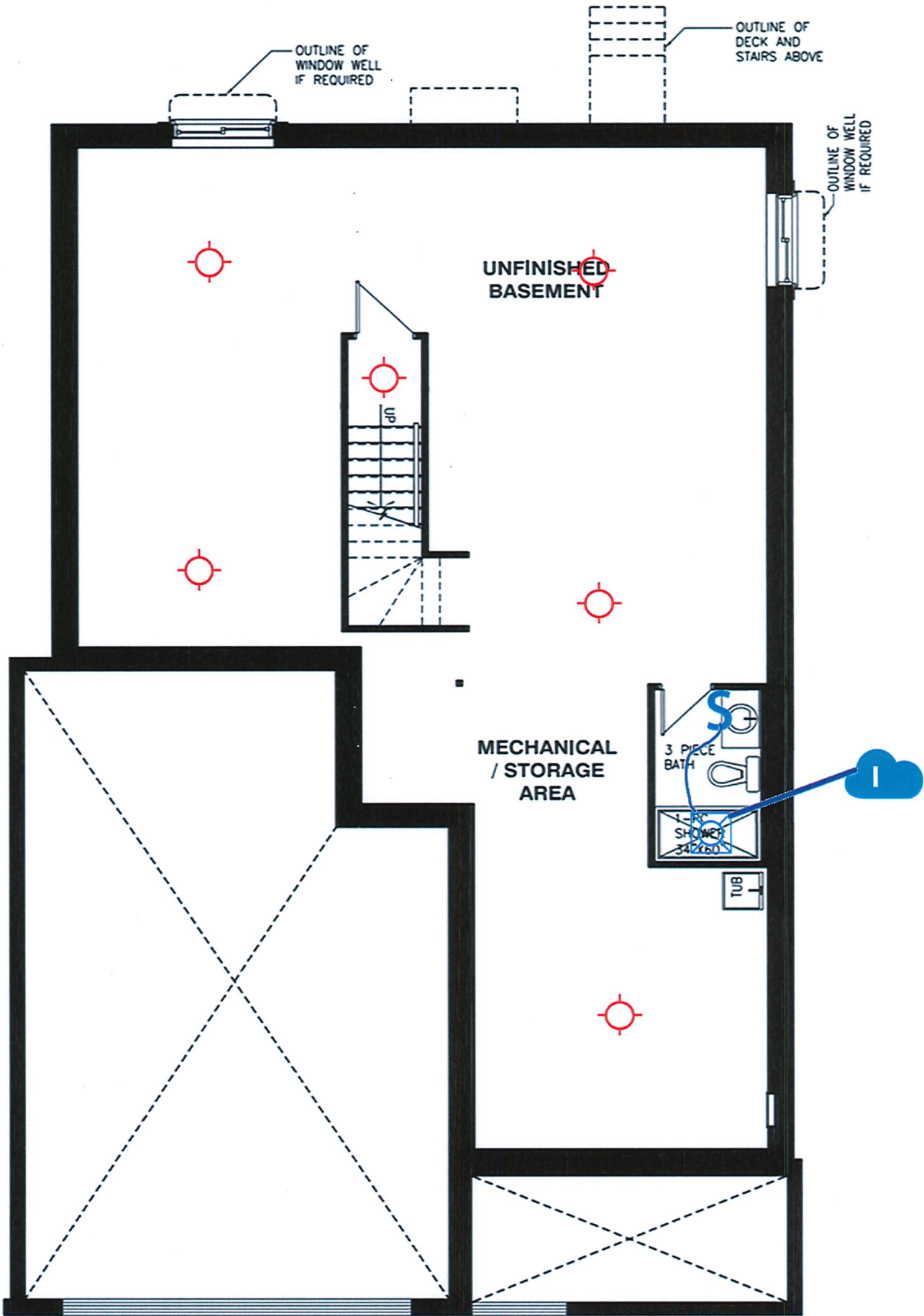

Basement Floor



Model Name: Custom Murry

Model #: #1015 A

Plan #:

Site: Shea Village

Purchaser:

DocuSigned by: Derek David Jones FNFEEA4C2292624FF...

Lot: PH1 Lot 15

Purchaser: Courtney Anderson

DocuSigned by: Courtney Anderson FNF79A52B33367D491...

Date: March 21-24

Purchaser:

