

AMENDMENT TO AGREEMENT OF PURCHASE AND SALE
BETWEEN THE UNDERSIGNED PARTIES HERETO SIGNED
ON THE 27 DAY OF June , 2023 .

REGARDING PROPERTY KNOWN AS: BUILDER'S LOT : 7
LOT: 7 BLOCK :
50M-361
CIVIC ADDRESS: 902 Cologne Street

PURCHASERS: Federika Alejandra Maingot & Marc-Antoine Castonguay

VENDORS: VALECRAFT HOMES LIMITED

DATE OF ACCEPTANCE: June 27, 2023

It is hereby understood and agreed between the undersigned parties hereto that the following changes shall be made to the above mentioned Agreement of Purchase and Sale and except for such changes noted below all other terms and conditions in the Agreement shall remain as stated therein and time shall remain of the essence.

DELETE: PURCHASE PRICE: \$887,920.74
BALANCE AT CLOSING: \$837,920.74
LESS H.S.T. AMOUNT: \$807,009.50
SCHEDULE "G" DATED: November 23, 2023
TARION SCHEDULE "B" DATED: November 23, 2023

INSERT: 680 dated: February 1, 2024 in the amount of: \$14,297.00
NEW PURCHASE PRICE: \$902,217.74
NEW BALANCE AT CLOSING: \$852,217.74
NEW LESS H.S.T. AMOUNT: \$819,661.72
SCHEDULE "G" DATED: February 1, 2024
TARION SCHEDULE "B" DATED: February 1, 2024

Dated at Embrun, ON this 1 day of February , 2024

In the presence of:

WITNESS

DocuSigned by:
PURCHASER

WITNESS

DocuSigned by:
PURCHASER

Dated at Ottawa, ON this 1 day of February , 2024

VALECRAFT HOMES LIMITED (VENDOR)

PER: DocuSigned by:
REV: September 3, 2020

SCHEDULE "G"

HARMONIZED SALES TAX AND NEW HOUSING REBATE

1. The parties acknowledge that as at the date of this Agreement, Harmonized Sales Tax ("HST") is applicable to this transaction pursuant to the Excise Tax Act (Canada) (the "**Legislation**") and that, the Purchaser may qualify for the GST/HST new housing rebate (as is authorized by the Legislation from time to time) (**the "New Housing Rebate"**) in respect of this transaction.
2. The Purchaser is hereby advised that the Purchase Price listed in "Purchase Price" Section of this Agreement includes all HST and the New Housing Rebate applicable to this transaction (refer to maximum rebate allowance in Clause 8) as at the date this Agreement is signed by the parties. All sales taxes applicable to the transaction (including any applicable New Housing Rebate) will be calculated as of the closing of the subject transaction and will be applied in accordance with the Legislation. In the event that there is a change to the Legislation after the execution of this Agreement but prior to the closing of this transaction, the Vendor shall make all applicable adjustments to the sales taxes payable in this transaction in accordance with all applicable Legislation.
3. The Purchaser hereby irrevocably assigns to the Vendor the benefit of the New Housing Rebate, if applicable to this transaction.
4. The Purchaser hereby warrants and agrees that:

(a) The Real Property is being purchased as the Purchaser's primary place of residence and that the Purchaser will take possession and occupy the Dwelling forthwith upon closing and will not allow occupancy of the Dwelling by any other individual (other than the Purchaser's immediate family) as a place of residence prior to occupancy by the Purchaser;

(b) Purchaser will execute and deliver on closing such documents as the Vendor may require to confirm the warranties and agreements contained in this Schedule; and

(c) Purchaser will submit to the Vendor on closing, prior to or after closing at the Vendor's request, an application or applications in the manner and in the form prescribed containing prescribed information required by the Legislation for the New Housing Rebate
5. The Purchaser acknowledges that the Vendor has calculated the Purchase Price on the assumption that the New Housing Rebate will be applicable to this transaction. If for any reason the Purchaser does not qualify for the New Housing Rebate, then the Purchaser shall be fully responsible for paying to the Vendor the amount of such New Housing Rebate plus interest at the Bank of Montreal prime rate from the date the statement of adjustments is calculated plus any fees, penalties or damages imposed on the Vendor under the Legislation. For greater certainty, the Purchaser acknowledges that the New Housing Rebate described above is for individuals buying a new house or residential condominium as a primary place of residence for themselves or a relation. It does not include the rebate for HST which may be available to investors buying a new house or residential condominium as a rental property (the **GST/HST "New Residential Rental Property Rebate"**). If the Property is being purchased for investment purposes, the Purchaser will not qualify for the New Housing Rebate and the Purchaser shall be responsible for paying to the Vendor an amount equal to the New Housing Rebate which has been included in the Purchase Price hereunder. All Purchasers buying a new house or residential condominium as a rental property are responsible for applying for the New Residential Rental Property Rebate after the closing of the subject transaction.

DS



Purchaser

DS



Purchaser

DS



Vendor

6. The Purchaser acknowledges and agrees that the Purchase Price set forth in this Agreement has been arrived at on the basis that the Purchase Price includes all Extras, premiums and bonuses and excludes any Extras ordered pursuant to a Change Order following the date of execution of this Agreement. The Purchaser acknowledges that the purchase of additional Extras following the date of execution of this Agreement may push the Purchase Price of the Real Property into a different sales tax category for the purposes of determining the amount of the New Housing Rebate, and that this may lower the amount of said New Housing Rebate applicable to the transaction. If a reduced New Housing Rebate is applicable under the Legislation due to the purchase of Extras following the date of execution of this Agreement, the Purchaser agrees to compensate the Vendor for the, amount by which the New Housing Rebate used to calculate the Purchase Price listed in the "Purchase Price" section herein exceeds the actual applicable New Housing Rebate, such amount to be credited to the Vendor as an adjustment on closing.
7. The Parties acknowledge that for purposes of Land Transfer Tax, the total consideration to be inserted in the Transfer/Deed of Land for this transaction shall be the total Purchase Price including Extras excluding HST and the New Housing Rebate, namely the amount of \$819,661.72 . The Purchaser is responsible for payment in full of the Land Transfer Tax and the cost of registration of the transfer. The consideration value is subject to change, pursuant to any and all extras that are ordered pursuant to a Change Order following the date of the execution of this Agreement.
8. The Purchaser agrees to execute all further documents required by the Vendor after closing to give effect to this Schedule.

Signed at Embrun, ON this 1 day of February , 2024

DocuSigned by:



CF107600F-830455

PURCHASER

VALECRAFT HOMES LIMITED

DocuSigned by:



809B8447C1041144E

PURCHASER

DocuSigned by:



A04F827301214EE

PER:

February 1, 2024

DATE:

PROJECT: PLACE ST. THOMAS

LOT: 7



NON STANDARD EXTRAS (680)			
Place St. Thomas - Phase 7			
PURCHASERS: Federika Alejandra Maingot and Marc-Antoine Castonguay			Printed: 5-Feb-24 2:14 pm
LOT NUMBER	PHASE	HOUSE TYPE	CLOSING DATE
7	7	826 THE BRADLEY 3 BED ELEV B	9-Jul-24
ITEM	QTY	EXTRA / CHANGE	PRICE
75		1 - KITCHEN - KITCHEN REDESIGN - RE-CENTER STOVE & HOODFAN + POTS & PANS DRAWERS - AS PER SKETCH	\$6,464.00
42567		Note: See Kitchen Sketch dated February 1, 2024.	Each
*76	11	*1 - ENSUITE BATH - TILE - FLOOR - UPGRADE - SILVER - - ENSUITE BATHROOM OPTIONAL - SILVER	* \$1,187.00
42568		Note: - Standard side to side installation as per Floor tile sketch dated February 1, 2024. -As per Floor plan sketch dated February 1, 2024. -See Colour Sheets Rev. 02 dated February 1, 2024	Each
77	135	1 - ENSUITE BATH - TILE - WALL - UPGRADE - FLOOR TILE IN LIEU OF WALL - SILVER - - APPROXIMATELY 5 FOOT x 3 FOOT CERAMIC SHOWER - SILVER	\$1,046.00
42571		Note: - Standard vertical stacked installation as per Wall tile sketch dated February 1, 2024. -See Colour Sheets Rev. 02 dated February 1, 2024	Each
*78	872	1 - ENSUITE BATH - VANITY BANK OF DRAWERS (3 DRAWERS) 6-10-10	* \$791.00
42572		Note: - Approximately centered in double vanity -See Item #79 (Level 2 cabinetry) -As per Floor plan sketch dated February 1, 2024.	Each
79		1 - ENSUITE BATH - UPGRADE TO LEVEL 2 CABINETRY - DOUBLE VANITY	\$1,046.00
42573		Note: -See Item 78 (Vanity bank of drawers) -See Item #26 (5 pc Ensuite) -See Colour Sheets Rev. 02 dated February 1, 2024 -As per Floor plan sketch dated February 1, 2024.	Each
80		7 - ENSUITE BATH - LEVEL 2 HANDLES IN ENSUITE DOUBLE VANITY - INCLUDES BANK OF DRAWERS	\$154.00
42574		Note: -See Colour Sheets Rev. 02 dated February 1, 2024 -As per Floor plan sketch dated February 1, 2024.	
*81	523	2 - ENSUITE BATH - BATH - DELTA TRINSIC LAVATORY FAUCET SINGLE HANDLE HIGH - ARC 559HA -BL- DST MATTE BLACK	* \$1,142.00
42575		Note: - Includes matching drain trim -See Item 26 (5 pc Ensuite) -See Colour Sheets Rev. 02 dated February 1, 2024	
82	28061	1 - ENSUITE BATH - BATH - DELTA TRINSIC ROMAN TUB FAUCET T2759-BL MATTE BLACK - MATCHING OVERFLOW AND DRAIN	\$778.00
42576		Note: - See Item #28 (Freestanding Tub) -See Item #26 (5pc Ensuite) -See Colour Sheets Rev. 02 dated February 1, 2024	Each
*83	104407	1 - ENSUITE BATH - BATH - DELTA TRINSIC SHOWER FAUCET T14259-BL WITH H2O KINETIC RAINCAN SHOWER HEAD MATTE BLACK	* \$335.00
42577		Note: Includes matching drain trim -See Item #26 (5 pc Ensuite) -See Colour Sheets Rev. 02 dated February 1, 2024	Each
84		1 - FOYER - FOYER - TILE - FLOOR - INSTALLATION - 45 DEGREE - FOYER -	\$452.00
42581		Note: - See Floor Tile installaion chart dated February 1, 2024 -See Colour Sheets Rev. 02 dated February 1, 2024	Each

PREPARED BY: Adam Bowman
LOCKED BY: Lisa Ballard
PE 2,063-1

Vendor Initials:

DS
FN

 Purchaser Initials:

DS
FAM

DS
MLC

CONSTRUCTION SCHEDULING APPROVAL	
PER:	_____
DATE:	_____



NON STANDARD EXTRAS (680)

Place St. Thomas - Phase 7

PURCHASERS: Federika Alejandra Maingot and Marc-Antoine Castonguay

Printed: 5-Feb-24 2:14 pm

LOT NUMBER	PHASE	HOUSE TYPE	CLOSING DATE
7	7	826 THE BRADLEY 3 BED ELEV B	9-Jul-24

ITEM	QTY	EXTRA / CHANGE	PRICE	INTERNAL USE
85		41 - KITCHEN/DINETTE - UPGRADED HARDWARE ON KITCHEN CABINETRY DOORS - KNOB 63030-1BRB	\$902.00	
42580	Note:	- Purchaser acknowledges this item has been discontinued and is in limited supply. Replacement hardware will not be available for repair or warranty. -See Colour Sheets Rev. 02 dated February 1, 2024		
86		1 - - REVISION #2 TO INTERIOR COLOUR CHART DATED FEBRUARY 1, 2024	\$0.00	Each
42585	Note:			

Sub Total	\$14,297.00
HST	\$0.00
Total	\$14,297.00

Payment Summary
<div><div>Paid By</div><div>Amount</div></div>
<div>Total Payment:</div>

PURCHASER:

DocuSigned by:

CF1W78DCP683D951...

Federika Alejandra Maingot

1-Feb-24

DATE

PURCHASER:

DocuSigned by:

8DB06444CD4144B...

Marc-Antoine Castonguay

1-Feb-24

DATE

VENDOR:

DocuSigned by:

A04F827301214EE...

PER: Valecraft Homes (2019) Limited

DATE: February 1, 2024

PREPARED BY: Adam Bowman

LOCKED BY: Lisa Ballard

PE 2,063-2

InvoiceSQL.rpt 01sept21

CONSTRUCTION SCHEDULING APPROVAL
PER: _____
DATE: _____

Valecraft Homes (2019) Ltd.

Site: Place St. Thomas 7

Plan: 50M-361

Lot: 7 - Phase 7

Model: #826 "B" Rev Bradley 3Bed

Date: February 1, 2024

Purchaser: Federika Alejandra Maingot

Purchaser: Marc-Antoine Castonguay

ALL DIMENSIONS ARE APPROXIMATE

PG#
1 of 4

Sheet 1



4TH COPY :

ROOM NAME	
OPT KITCHEN 1 W/ OPT PANTRY 1	
COUNTERTOPS	
(A) QUARTZ 30mm BY OTHER	
FINISH	
TF-176 & TF-177	
HANDLES	
Doors:63030-1BRB drawers as noted	
DOOR STYLE	
basedoor:TF-3620	TF-176
UpperDoor:TF-3620	TF-176
Drawer:TF-3620 DRAWER	TF-176
DRAWER GUIDE	
(A) AXIAL DRAWER	
DOOR HINGE STYLE	
(A) SOFT CLOSE	
CONSTRUCTION	
(A) POTVIN 32mm	
CEILING	
(A) Crown Filler 76 mm Board Stock - TF-176	
CROWN MLDG	
(A) No Crown Board Stock - TF-176	
LIGHT VALANCE	
(A) No Light Valance Board Stock - TF-176	

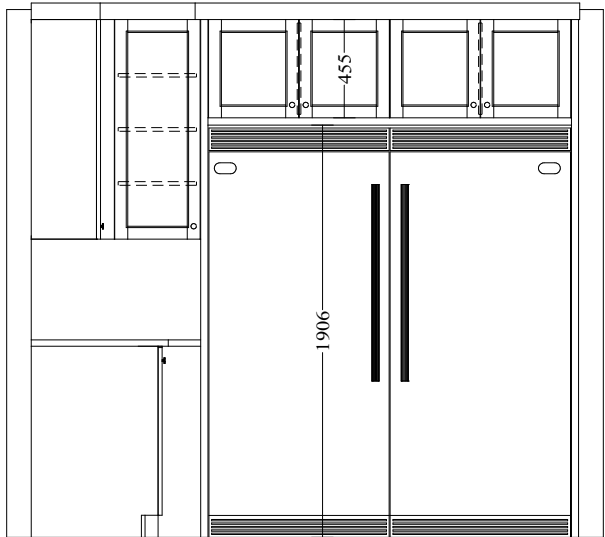
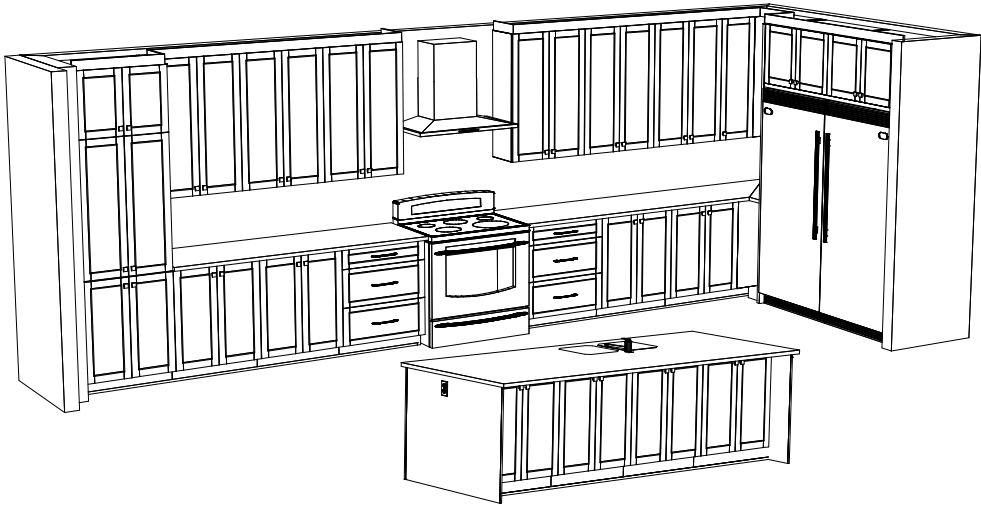
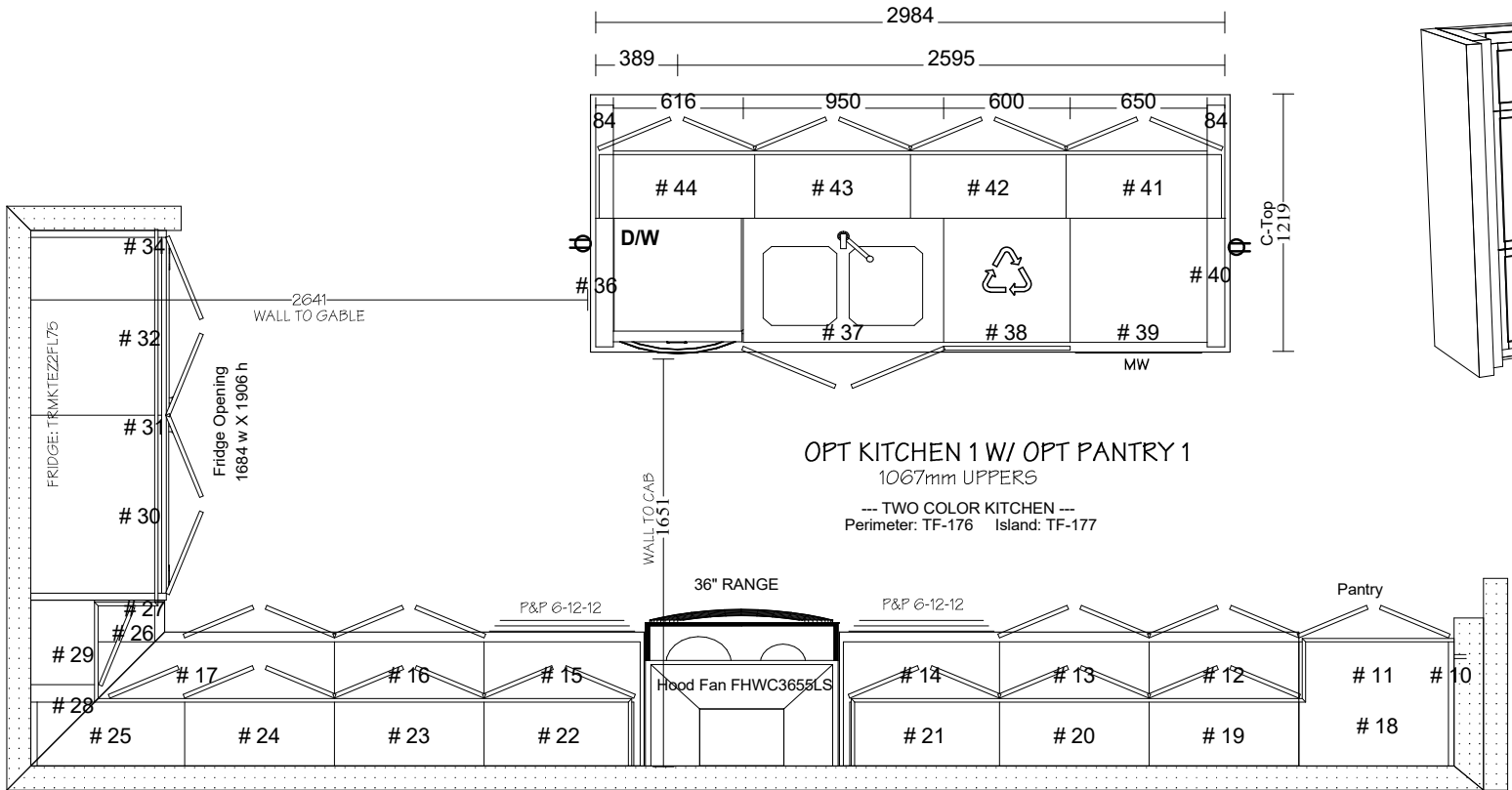
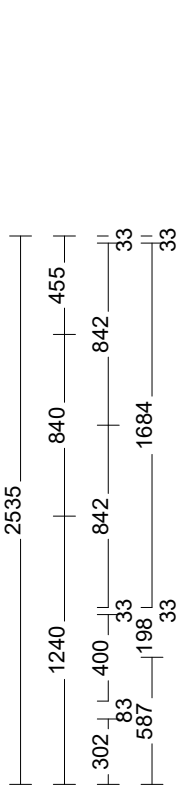

All Cabinets				
No	Name	Width	Height	Depth
0	WH-2	914	700	499.5
0	Electric range	914	1118	716
0	Single Door Right	835	1892.5	635
0	Single Door Left	835	1892.5	635
10	P Filler	26.5	2444	587
11	LC 710	710	883	587
12	LC 710	710	883	587
13	LC 710	710	883	587
14	LC 740 PP 6-12-12	740	883	587
15	LC 740 PP 6-12-12	740	883	587
16	LC 710	710	883	587
17	LC1300 BC Right	1300	883	587
18	P710/1561/587	710	1561	587
19	UC710/1067	710	1067	302
20	UC710/1067	710	1067	302
21	UC710/1067	710	1067	302
22	UC710/1067	710	1067	302
23	UC710/1067	710	1067	302
24	UC710/1067	710	1067	302
25	UC700/1067 BC	700	1067	302
26	LC FILLER	198	883	587
27	33mm TALL GABLE MLW	33	2444	642
28	UC FILLER	83	1067	302
29	UC400/1067	400	1067	302
30	UC842/505/620 Fridge	842	505	620
31	33mm SHELF MLW	1684	33	642
32	UC842/505/620 Fridge	842	505	620
34	33mm TALL GABLE MLW	33	2444	642

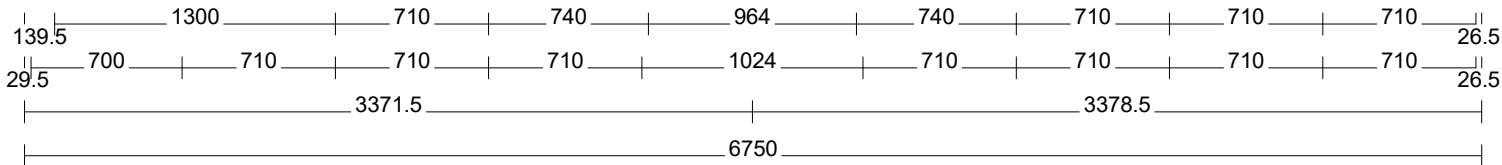

All Cabinets				
No	Name	Width	Height	Depth
0	Double W/Faucet/gray	762	101.5	457
0	DISHWASHER	610	883	587
35	W STRETCHER T1S (NEV	711	102	19
36	DW Left with Plug	84	883	1144
37	LC 950 SK USB	950	883	587
38	LC 600 recycle	600	883	587
39	LC 650 MW/Drw	650	883	587
40	DW Right with Plug	84	883	1144
41	LC 737/302D	737	883	302
42	LC 738/302D	738	883	302
43	LC 738/302D	738	883	302
44	LC 738/302D	738	883	302

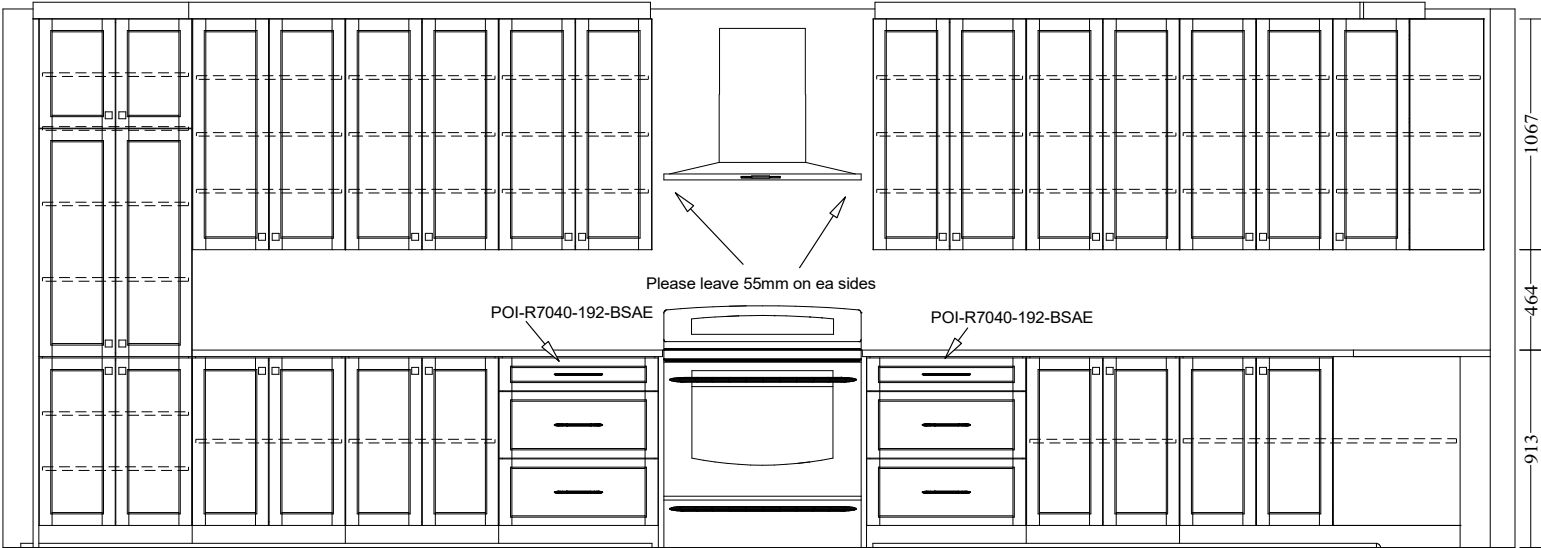
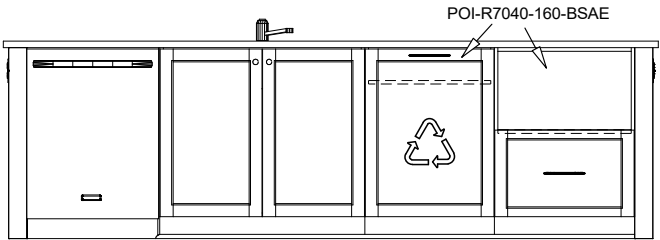
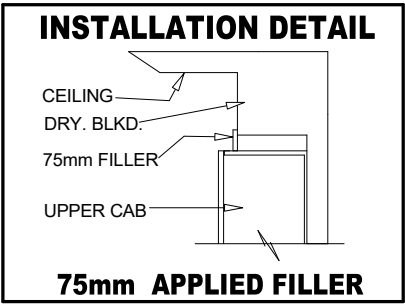

DS
FAM

DS
MAC

DS
FN

Valecraft Homes (2019) Ltd.

Site: Place St. Thomas 7

Plan: 50M-361

Lot: 7 - Phase 7

Model: #826 "B" Rev Bradley 3Bed

Date: February 1, 2024

Purchaser: Federika Alejandra Maingot

Purchaser: Marc-Antoine Castonguay

ALL DIMENSIONS ARE APPROXIMATE

PG#
2 of 4

Sheet 2



4TH COPY :

ROOM NAME	
MAIN 2ND FLOOR	
COUNTERTOPS	
(A) QUARTZ 20mm BY OTHER	
FINISH	
TA-M2007	
HANDLES	
81092-142	
DOOR STYLE	
basedoor:LASTRA	19mm TA-M2007
UpperDoor:LASTRA	19mm TA-M2007
Drawer:LASTRA DRAWER	19mm TA-M2007
DRAWER GUIDE	
(A) AXIAL DRAWER	
DOOR HINGE STYLE	
(A) SOFT CLOSE	
CONSTRUCTION	
(A) POTVIN 32mm	

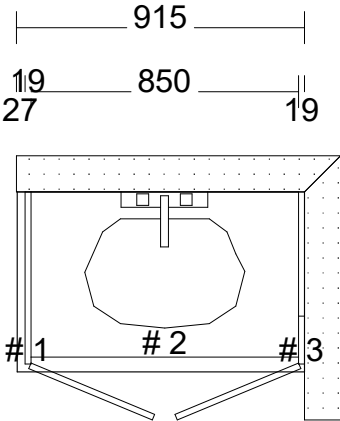

MAIN 2ND FLOOR

No shoe; scribe

All Cabinets				
No	Name	Width	Height	Depth
0	Single W/Faucet	508	51	432
1	Vanity Lastra Gable	19	819	546
2	V 850 SK	850	819	524
3	Vanity Lastra Gable	19	819	152

ROOM NAME	
OPT BASEMENT	
COUNTERTOPS	
(A) QUARTZ 20mm BY OTHER	
FINISH	
PM-V392WT	
HANDLES	
81092-195	
DOOR STYLE	
basedoor:PM-100I	PM-V392WT
UpperDoor:PM-100I	PM-V392WT
Drawer:PM-100I DRAWER	PM-V392WT
DRAWER GUIDE	
(A) AXIAL DRAWER	
DOOR HINGE STYLE	
(A) SOFT CLOSE	
CONSTRUCTION	
(A) POTVIN 32mm	

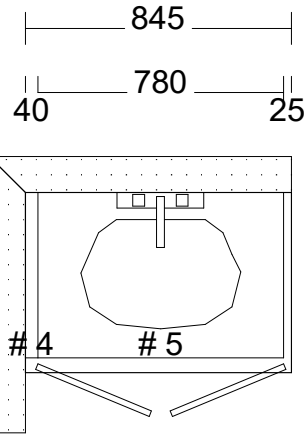

OPT BASEMENT

All Cabinets				
No	Name	Width	Height	Depth
0	Single W/Faucet	508	51	432
4	V Filler	40	819	524
5	V 780 SK	780	819	524

ROOM NAME	
OPT ENSUITE 2ND FLOOR	
COUNTERTOPS	
(A) QUARTZ 20mm BY OTHER	
FINISH	
PM-V392WT	
HANDLES	
81092-195	
DOOR STYLE	
basedoor:PM-100I	PM-V392WT
UpperDoor:PM-100I	PM-V392WT
Drawer:PM-100I DRAWER	PM-V392WT
DRAWER GUIDE	
(A) AXIAL DRAWER	
DOOR HINGE STYLE	
(A) SOFT CLOSE	
CONSTRUCTION	
(A) POTVIN 32mm	
CEILING	
(A) No Filler	Board Stock - PM-V392WT
CROWN MLDG	
(A) No Crown	Board Stock - PM-V392WT
LIGHT VALANCE	
(A) No Light Valance	Board Stock - PM-V392WT

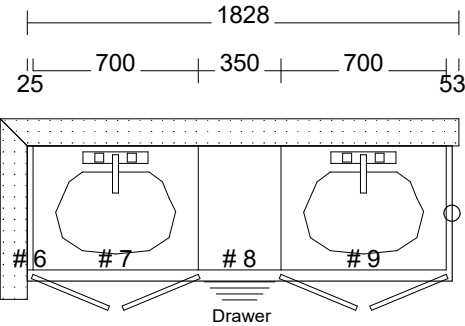

OPT ENSUITE 2ND FLOOR

All Cabinets				
No	Name	Width	Height	Depth
0	Single W/Faucet	508	51	432
0	Single W/Faucet	508	51	432
6	V Filler	25	819	524
7	V 700 SK	700	819	524
8	V350 4D	350	819	524
9	V 700 SK	700	819	524

DS
FAM

DS
MAC

DS
FN

	SINGLES AND TOWNS COLOUR CHART - REVISION #2					
	Community:	Place St. Thomas 7	Reg'd Plan #:	50M-361	Sales Rep:	A. Bowman
	Lot No:	7 - Phase 7	Civic Address:	902 Cologne Street, Embrun ON K0A 1W0		
	Purchaser(s):	Federika Alejandra Maingot			Model Name/#:	Bradley 3Bed "B"
	Purchaser(s):	Marc-Antoine Castonguay			Closing Date:	July 9th, 2024
CABINETRY						
ROOM	SELECTION				LEVEL	STD/UPG #
KITCHEN	STYLE AND COLOUR					
	HARDWARE CODE	POI-R7040-192-BSAE for pots & pans drawers, POI-R7040-160-BSAE for recycle and microwave drawers, 63030-1BRB for all cabinet doors	TYPE	Handle & Knob	Level 2, and UPG Knobs	51, 85
	COUNTERTOP		COUNTERTOP EDGE PROFILE			
MAIN BATHROOM	STYLE AND COLOUR					
	HARDWARE CODE		TYPE			
	COUNTERTOP		COUNTERTOP EDGE PROFILE			
5PC ENSUITE BATHROOM	STYLE AND COLOUR	Edelweiss MDF (MDF Seainless) - Black			Level 2	26, 78, 79
	HARDWARE CODE	POI-R20004-256-NM (Black)	TYPE	Handle	Level 2	26, 80
	COUNTERTOP		COUNTERTOP EDGE PROFILE			
POWDER ROOM	STYLE AND COLOUR					
	HARDWARE CODE		TYPE			
	COUNTERTOP		COUNTERTOP EDGE PROFILE			
BASEMENT/OTHER BATHROOM	STYLE AND COLOUR					
	HARDWARE CODE		TYPE			
	COUNTERTOP		COUNTERTOP EDGE PROFILE			
LAUNDRY ROOM	STYLE AND COLOUR					
	HARDWARE CODE		TYPE			
	COUNTERTOP		COUNTERTOP EDGE PROFILE			

Purchaser's Signature(s) :

DocuSigned by:

CF1075DCF83D451...

Date: February 1, 2024

Purchaser's Signature(s) :

DocuSigned by:

6DB06444CD4144B...

Date: February 1, 2024

Approved By :

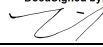
DocuSigned by:

A04F827301214EE...

Date: February 1, 2024

	SINGLES AND TOWNS COLOUR CHART - REVISION #2					
	Community:	Place St. Thomas 7	Reg'd Plan #:	50M-361	Sales Rep:	A. Bowman
	Lot No:	7 - Phase 7	Civic Address:	902 Cologne Street, Embrun ON K0A 1W0		
	Purchaser(s):	Federika Alejandra Maingot			Model Name/#:	Bradley 3Bed "B"
	Purchaser(s):	Marc-Antoine Castonguay			Closing Date:	July 9th, 2024
CERAMIC & GROUT SELECTIONS (1)						
ROOM	AREA	MANUFACTURER/SERIES/SIZE/ COLOUR/CODE		GROUT SELECTION	LEVEL	STD/UPG #
FOYER	FLOOR	Euro Pasha Bellina - GREY 13" x 13" #pas bel gre (45 degree installation)		25 Polar Grey	STD Tile, STD grout, UPG Install	STD, STD, 84
POWDER ROOM	FLOOR	Euro Pasha Bellina - GREY 13" x 13" #pas bel gre (45 degree installation)		25 Polar Grey	STD Tile, STD grout, UPG Install	STD, STD, 84
	WALL					
	INSERT OR BORDER					
MUDROOM	FLOOR					
	WALL					
	INSERT OR BORDER					
LAUNDRY ROOM	FLOOR					
	WALL					
	INSERT OR BORDER					
KITCHEN	FLOOR					
	BACKSPLASH					
	INSERT OR BORDER					
BREAKFAST AREA/DINETTE	FLOOR					
FIREPLACE	HEARTH					
	SURROUND					
ADDITIONAL FIREPLACE	HEARTH					
	SURROUND					

Purchaser's Signature(s) :

DocuSigned by:



CF1075DCF83D451...

Purchaser's Signature(s) :

DocuSigned by:

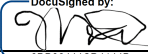

8DB08444CD4144B...

Approved By :

DocuSigned by:

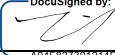

A04F827301214EE...

Date:

February 1, 2024

Date:

February 1, 2024

Date:

February 1, 2024

Subject to change by Valecraft Homes in the event of unavailability of materials.
Prices, terms and specifications are subject to change without notice E/O.E
K:\Sales\Sales Legal Docs\Site - Place-St Thomas\PST PH7 - Singles\PST PH7 Lot 07 - Alejandra Ma

	SINGLES AND TOWNS COLOUR CHART - REVISION #2					
	Community:	Place St. Thomas 7	Reg'd Plan #:	50M-361	Sales Rep:	A. Bowman
	Lot No:	7 - Phase 7	Civic Address:	902 Cologne Street, Embrun ON K0A 1W0		
	Purchaser(s):	Federika Alejandra Maingot			Model Name/#:	Bradley 3Bed "B"
	Purchaser(s):	Marc-Antoine Castonguay			Closing Date:	July 9th, 2024
CERAMIC & GROUT SELECTIONS (2)						
ROOM	AREA	MANUFACTURER/SERIES/SIZE/ COLOUR/CODE		GROUT SELECTION	LEVEL	STD/UPG #
MAIN BATHROOM	FLOOR					
	WALL					
	INSERT OR BORDER					
3PC ENSUITE BATHROOM	FLOOR					
	WALL					
	INSERT OR BORDER					
5PC ENSUITE BATHROOM	FLOOR	Centura Canadiana Alsacia 12" x 24" Blanco ALSACIA - Matte Glazed Porcelain (Standard Side to Side Installation)		25 Polar Grey	Silver Floor Tile, STD grout	76, STD, 26
	TUB DECK	N/A (freestanding tub)		N/A	N/A	28, 26
	TUB BACKSPLASH	N/A (freestanding tub)		N/A	N/A	28, 26
	INSERT OR BORDER	N/A				
	WALK-IN SHOWER	Centura Canadiana Alsacia 12" x 24" Blanco ALSACIA - Matte Glazed Porcelain (Vertical Stacked Installation)		25 Polar Grey	Silver Floor Tile, STD grout	77, 26, 27
2PC BASEMENT BATHROOM	FLOOR					
	WALL					
	INSERT OR BORDER					

Purchaser's Signature(s) :

DocuSigned by:



CF1075DCF83D451...

Date: February 1, 2024

Purchaser's Signature(s) :

DocuSigned by:



8DB06444CD4144B...

Date: February 1, 2024

Approved By :

DocuSigned by:



A04F827301214EE...

Date: February 1, 2024

	SINGLES AND TOWNS COLOUR CHART - REVISION #2					
	Community:	Place St. Thomas 7	Reg'd Plan #:	50M-361	Sales Rep:	A. Bowman
	Lot No:	7 - Phase 7	Civic Address:	902 Cologne Street, Embrun ON K0A 1W0		
	Purchaser(s):	Federika Alejandra Maingot			Model Name/#:	Bradley 3Bed "B"
	Purchaser(s):	Marc-Antoine Castonguay			Closing Date:	July 9th, 2024
PLUMBING FIXTURES						
ROOM	FIXTURE	STYLE		FINISH	STD/UPG#	
KITCHEN	SINK					
	FAUCET					
MAIN BATHROOM	SINK					
	VANITY FAUCET					
	WATER CLOSET					
	TUB/SHOWER					
	TUB/SHOWER FAUCET					
5PC ENSUITE BATHROOM	SINK(S)					
	VANITY FAUCET(S) X2	Delta Trinsic Lavatory Faucet - Single Handle High - # ARC 559HA-BL-DST		Matte Black	81, 26	
	WATER CLOSET					
	SHOWER					
	SHOWER FAUCET	Delta Trinsic Shower Faucet #T14259-BL - 14 Series with H20 Kinetic 6" Raincan Shower Head		Matte Black	83, 26	
	BATHTUB					
	BATHTUB FAUCET	Delta Trinsic Roman Tub Faucet #T2759-BL incl. matching overflow and drain		Matte Black	82, 26	
POWDER ROOM	PEDESTAL					
	SINK FAUCET					
	WATER CLOSET					
2PC BASEMENT BATHROOM	SINK					
	VANITY FAUCET					
	WATER CLOSET					
	TUB/SHOWER					
	TUB/SHOWER FAUCET					
NOTE: All fixtures are white as standard						

Purchaser's Signature(s) :

DocuSigned by:



CF1075DCF83D451...

Purchaser's Signature(s) :

DocuSigned by:

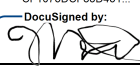

6DB06444CD4144B...

Approved By :

DocuSigned by:

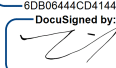

A04F827301214EE...

Date:

February 1, 2024

Date:

February 1, 2024

Date:

February 1, 2024



COLOUR REV. 02

Tile Installation Options

FLOOR TILE

Standard square

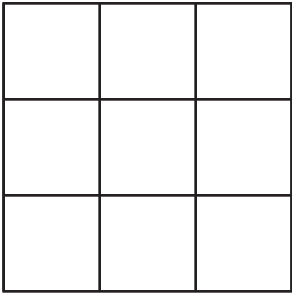

Square brick

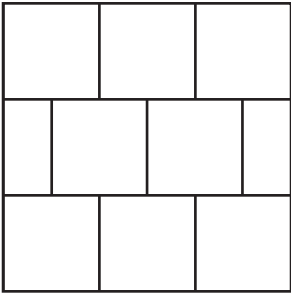

Rectangular
front to back of the house

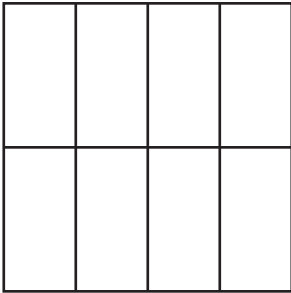

Rectangular
side to side of the house

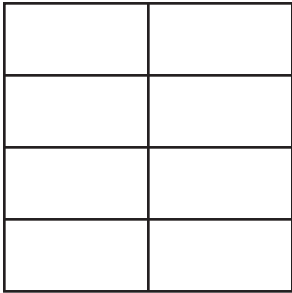

5PC Ensuite Bathroom

Rectangular 1/3 staggered
front to back of the house

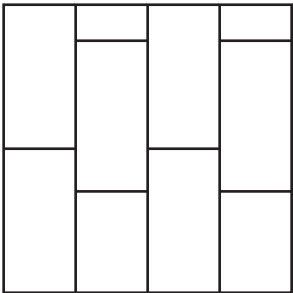

Rectangular 1/3 staggered
side to side of the house

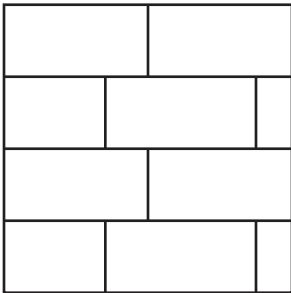

45 degree

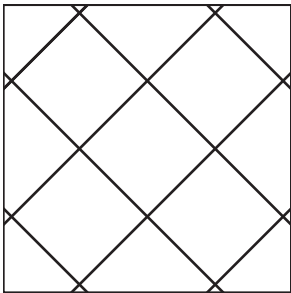

Foyer

Project: Place St. Thomas 7

Plan #: 50M-361

Lot: 7 - Phase 7

Model: #826 Bradley 3Bed, "B", Rev

Purchaser: Federika Alejandra Maingot

Purchaser: Marc-Antoine Castonguay

Date: February 1, 2024

Upgrade #: 76, 84



COLOUR REV .02

Tile Installation Options

WALL TILE

Vertical stacked

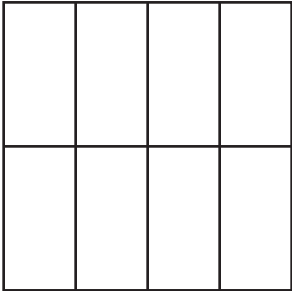

5PC Ensuite
Walk-In Shower

Horizontal stacked

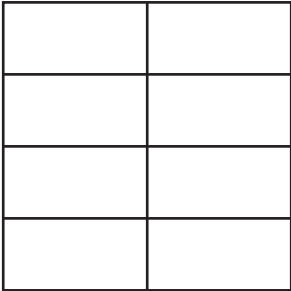

Vertical 1/3 offset staggered

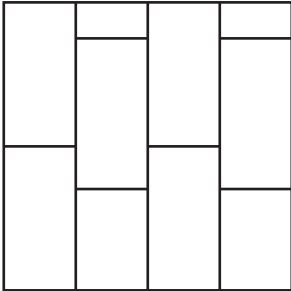

Horizontal 1/3 offset staggered

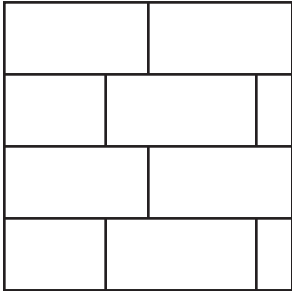

Vertical brick

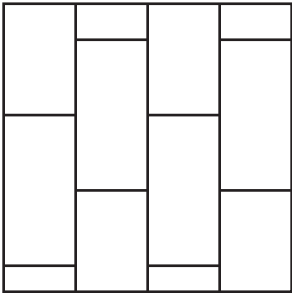

Horizontal brick

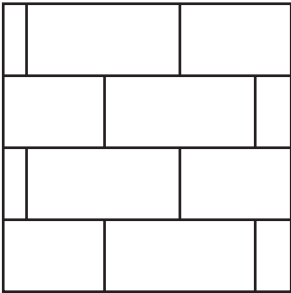

45 degree

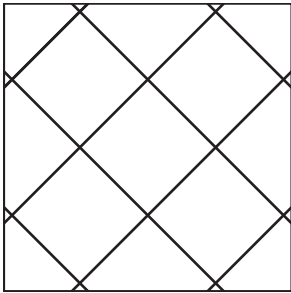

Standard square

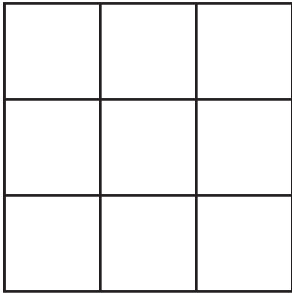

Project: Place St. Thomas 7

Plan #: 50M-361

Lot: 7 - Phase 7

Model: #826 Bradely 3Bed, "B", Rev

Purchaser: Federika Alejandra Maingot

Purchaser: Marc-Antoine Castonguay

Date: February 1, 2024

Upgrade #: 77