



Valecraft

Homes (2019) Limited

210-1455 Youville Drive
Ottawa, On K1C 6Z7
Phone: 613-837-1104

Purchase Order

PO0002649

Vendor:
S & S BOLTON ELECTRIC INC.
5411 CANOTEK ROAD
OTTAWA, ONTARIO K1J 9M3

Ship To:
Site: SHEA VILLAGE PHASE 2
Lot/Unit: BLOCK A02
Model: 120 REVERSED
Civic: 1128 COPE DRIVE

tel: 613-748-0432
fax:
contact:

ORDER DATE	CHG. ORDER DT.	CANCEL DATE	RESPONSIBILITY	VENDOR #	TERMS
Oct 30, 2023			ARIEL	S02	NET 30 DAYS
Comments/Special Instructions:					REFERENCE

JOB/LOT/COST	REFERENCE	Description	QTY ORDERED	UNIT PRICE	EXTENSION
020-A02-680	#1	REFER COSNTR. SUMMARY ITEM #1 ENSUITE 4 PC. BATHROOM	1.0000	100.000000	100.00
020-A02-680	#2	REFER CONSTR. SUMMARY ITEM #2 OPTIONAL BASEMENT FIREPLACE	1.0000	116.000000	116.00
020-A02-680	#9	REFER CONSTR. SUMMARY ITEM #9 QUOTE #SS6549 REV.01 OCT 17-23	1.0000	2,412.000000	2,412.00

Authorized Signature

Subtotal	2,628.00
HST	341.64
Total Order Value	2,969.64

ORDER TERMS AND CONDITIONS

1. INVOICES must bear exact same prices and terms or authorization for changes must be received from our company in writing prior to shipping.
2. The right is reserved to cancel all or part of this order if not delivered within the time specified.
3. Packing slips must accompany all shipments.
4. In the event of interruption of our business in whole or in part by reason of fire, flood, windstorm, earthquake, war, strike, embargo, acts of God, governmental action, or any causes beyond our control, we shall have the option of cancelling undelivered orders in whole or in part.
5. Acceptance of this purchase order, or shipment of it will constitute an agreement to all of its specifications as to terms, delivery and prices.
6. No deliveries accepted after 4:00 pm or on weekends.

WHITE - ORIGINAL

CANARY - ACCOUNTS PAYABLE

PINK - DEPARTMENT



Tel: (613) 748-0432
Fax: (613) 748-0355

A Division of the S&S Bolton Group
www.ssbolton.com

Estimate No#: SS6549 Rev.01

Builder Copy

Customer:

Shea Village A02

Builder: VALECRAFT HOMES (2019) LTD.
Project: Shea Village
Lot: SV A02
Closing Date: -

Salesperson: Kyle Takman
Date: 10/17/2023

Location	Qty	Product / Installation Details	Plan Code	Unit Price	Customer Total	Builder Total
Family Room	1.00	15 Amp Standard Plug Add 15 AMP plug approx 65 inches from floor beside conduit	A	175.00 \$	175.00 \$	93.00 \$
Kitchen	4.00	4" LED slim Pot Light White (AFR4C-0930-WH) Add 4 LED Halo potlights (AFR4-0930-WH) on existing switch	B	277.00 \$	1,108.00 \$	588.00 \$
Various Locations	1.00	15 Amp USB Charger Receptacle USB Charger Receptacle in kitchen and master bedroom (standard items)	C	\$	0.00 \$	0.00 \$
Great Room	6.00	4" LED slim Pot Light White (AFR4C-0930-WH) Add 6 LED Halo potlights (AFR4-0930-WH) - using control plug switch (sever control to plug)	D	277.00 \$	1,662.00 \$	882.00 \$
Ensuite Bath	1.00	4" LED slim Pot Light White (AFR4C-0930-WH) Add 1 LED Halo potlight (AFR4-0930-WH) on added switch	E	277.00 \$	277.00 \$	147.00 \$
Ensuite Bath	1.00	Single Pole Switch Switch for added potlight	E	136.00 \$	136.00 \$	72.00 \$
Main Bath	1.00	4" LED slim Pot Light White (AFR4C-0930-WH) Add 1 LED Halo potlight (AFR4-0930-WH) on added switch	F	277.00 \$	277.00 \$	147.00 \$
Main Bath	1.00	Single Pole Switch Switch for added potlight	F	136.00 \$	136.00 \$	72.00 \$
Hall	1.00	4" LED slim Pot Light White (AFR4C-0930-WH) Add 1 LED Halo potlight (AFR4-0930-WH) on existing switch	G	277.00 \$	277.00 \$	147.00 \$
Kitchen	1.00	Misc. Product Delete Standard Fixture	B	-128.00 \$	-128.00 \$	-68.00 \$
Hall	1.00	Misc. Product Delete Standard Fixture	G	-128.00 \$	-128.00 \$	-68.00 \$

Phone: (613) 748-0432 | Fax: (613) 748-0355 | Email: info@sandselectric.ca | Website: www.sandselectric.ca

5411 Canotek Road, Ottawa, Ontario K1J 9M3

Printed By: Kyle Takman - Page: 2

RECEIVED
OCT 23 2023



Tel: (613) 748-0432
Fax: (613) 748-0355

A Division of the S&S Bolton Group
www.ssbolton.com

Location	Qty	Product / Installation Details	Plan Code	Unit Price	Customer Total	Builder Total
Kitchen	2.00	Standard Light Outlet (Keyless) Add 2 Keyless Fixtures on added switch	H	160.00 \$	320.00 \$	170.00 \$
Kitchen	1.00	Single Pole Switch Switch for added keyless fixtures	H	136.00 \$	136.00 \$	72.00 \$
Hall	2.00	Misc. Product Delete Standard Fixtures	I	-128.00 \$	-256.00 \$	-136.00 \$
Hall	2.00	4" LED slim Pot Light White (AFR4C-0930-WH) Add 2 LED Halo potlight (AFR4-0930-WH) on existing switch	I	277.00 \$	554.00 \$	294.00 \$
*** Total price does not include any applicable taxes.					Customer Total:	4,546.00 \$
					Builder Total:	2,412.00 \$

Customer Signature

Date

Phone: (613) 748-0432 | Fax: (613) 748-0355 | Email: info@sandselectric.ca | Website: www.sandselectric.ca

5411 Canotek Road, Ottawa, Ontario K1J 9M3

Printed By: Kyle Takman - Page: 3

RECEIVED
OCT 23 2023



Valecraft
Homes (2019) Limited

S&S / Orbital Sketch

Model Name: The Huntley

Model #: 120

Plan #: _____

Site: Shea Village

Purchaser: INVENTORY HOME

Lot: A02

Date: October 17, 2023

Purchaser: _____

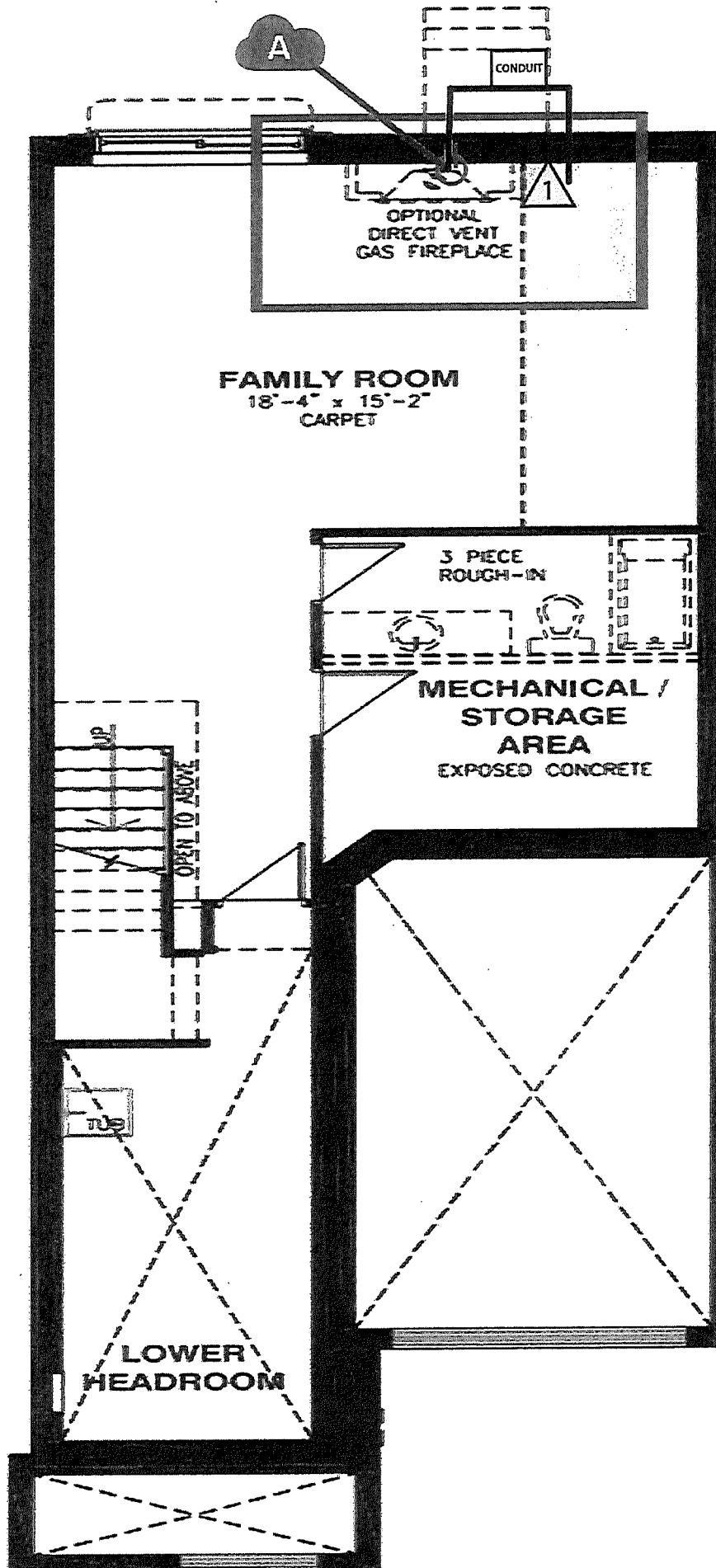

BASEMENT FLOOR

OCT 23 2023

[illegible]

Plan #: _____

Purchaser: INVENTORY HOME

Purchaser:

Purchaser:

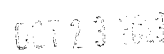



Valecraft
Homes (2019) Limited

S&S / Orbital Sketch

Model Name: The Huntley

Model #: 120

Plan #: _____

Site: Shea Village

Purchaser: INVENTORY HOME

Lot: A02

Date: October 17, 2023

Purchaser: _____

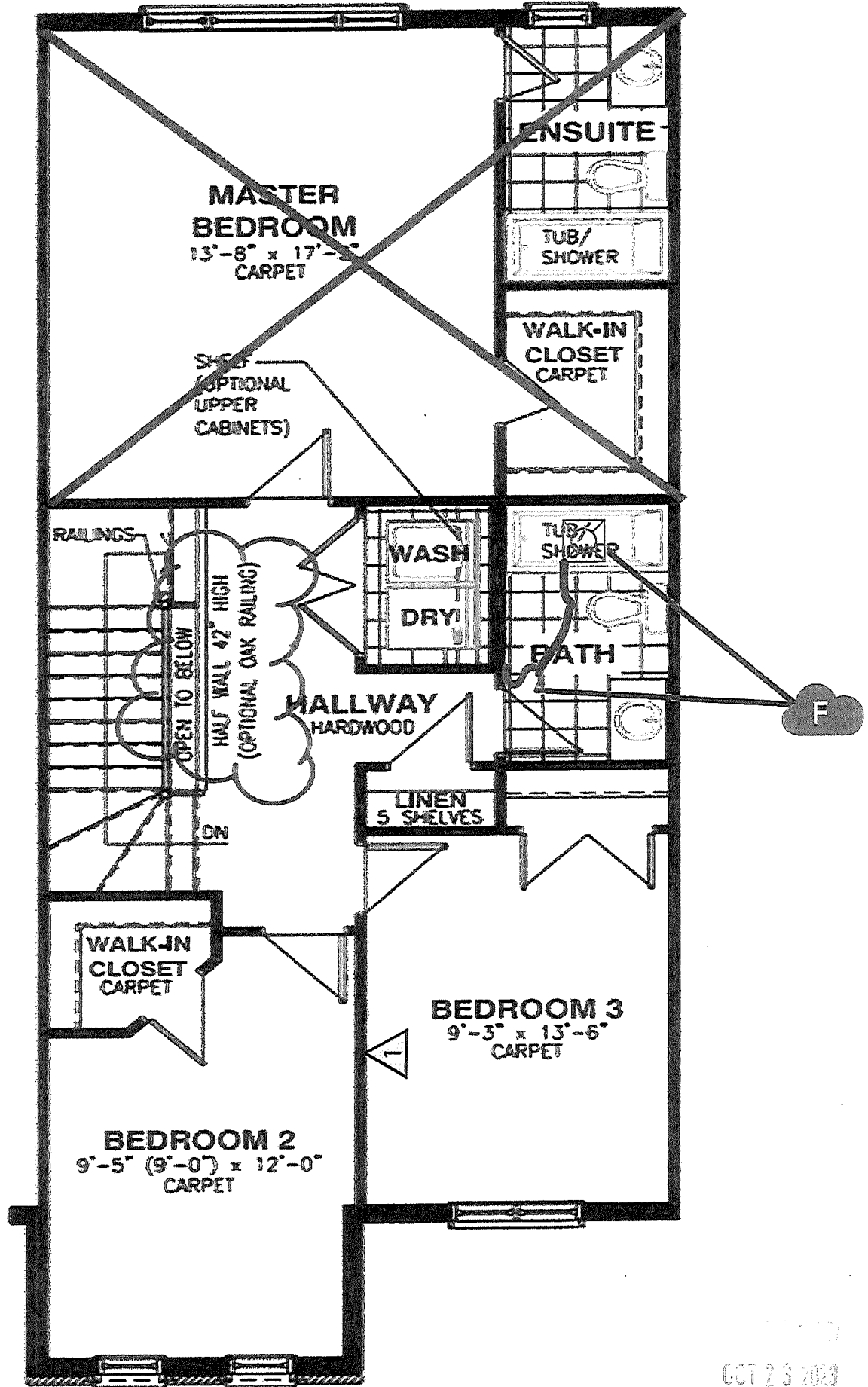

SECOND FLOOR



Valecraft
Homes (2019) Limited

S&S / Orbital Sketch

Model Name: The Huntley

Model #: 120

Plan #: _____

Site: Shea Village

Purchaser: INVENTORY HOME

Lot: A02

Date: October 17, 2023

Purchaser: _____

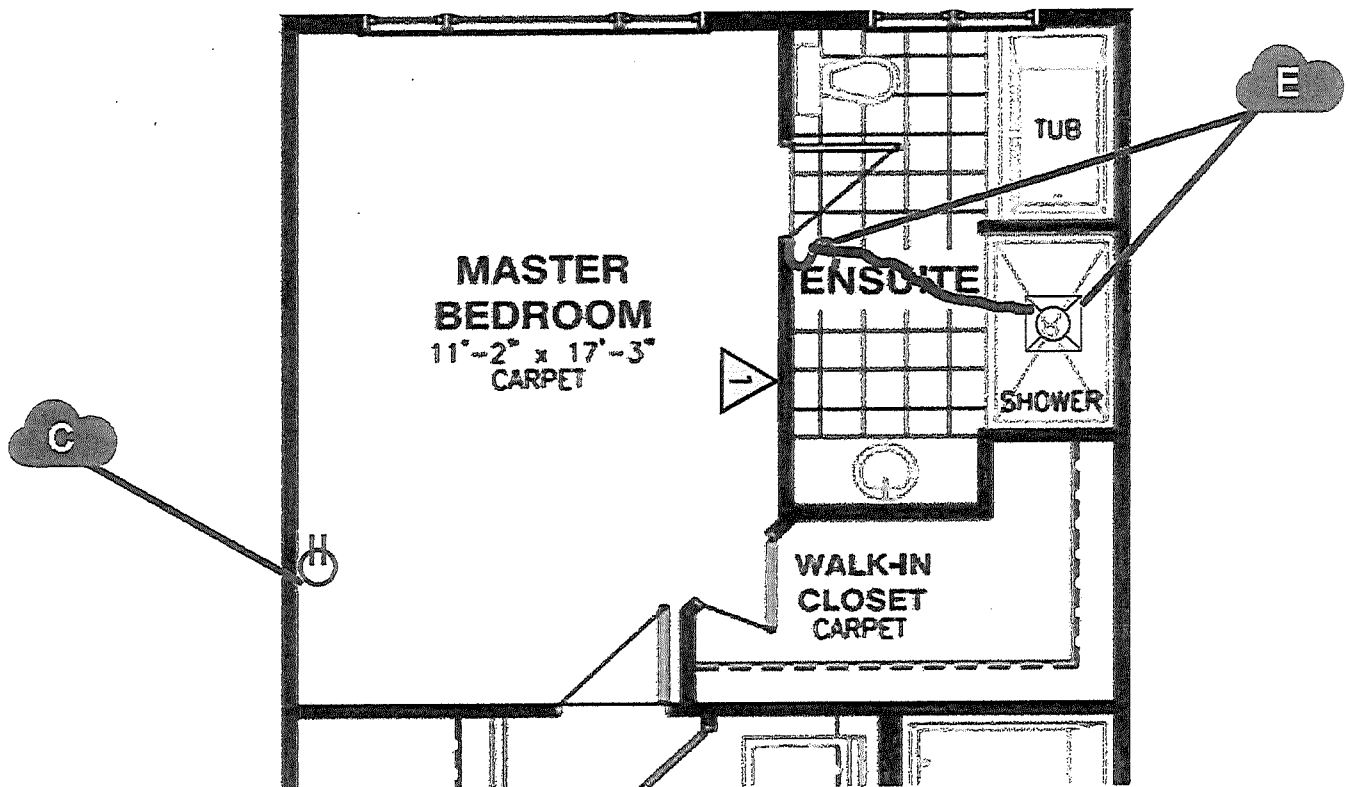

OPTIONAL 4PC ENSUITE

OCT 23 2023