



# Valecraft

## Homes (2019) Limited

210-1455 Youville Drive  
Ottawa, On K1C 6Z7  
Phone: 613-837-1104

Purchase Order

PO0002308

Vendor:  
S & S BOLTON ELECTRIC INC.  
5411 CANOTEK ROAD  
OTTAWA, ONTARIO K1J 9M3

Ship To:  
Site: PLACE ST. THOMAS PHASE 7  
Lot/Unit: LOT 3  
Model: 1015 REVERSED  
Civic: 886 COLOGNE STREET

tel: 613-748-0432  
fax:  
contact:

ORDER DATE	CHG. ORDER DT.	CANCEL DATE	RESPONSIBILITY	VENDOR #	TERMS
Jun 19, 2023			ARIEL	S02	NET 30 DAYS
Comments/Special Instructions:					REFERENCE

JOB/LOT/COST	REFERENCE	Description	QTY ORDERED	UNIT PRICE	EXTENSION
067-003-680	#1	REFER CONSTR. SUMMARY ITEM #1 OPT. BSMT. FINISHED REC. ROOM	1.0000	927.000000	927.00
067-003-680	#26	REFER CONSTR. SUMMARY ITEM #26 OPT. KITCHEN PANTRY #1	1.0000	79.000000	79.00
067-003-680	#63	REFER CONSTR. SUMMARY ITEM #63 MASTER BEDROOM	1.0000	63.000000	63.00
067-003-680	#64	REFER CONSTR. SUMMARY ITEM #64 KITCHENDINETTE	1.0000	258.000000	258.00
067-003-680	#77	REFER CONSTR. SUMMARY ITEM #77 #SS6460 REV.02 DATE MAY 8-23	1.0000	2,286.000000	2,286.00

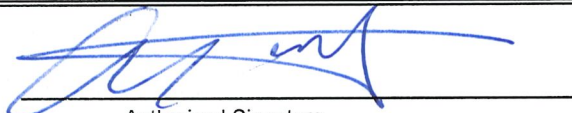
 Authorized Signature	Subtotal	3,613.00
	HST	469.69
	Total Order Value	4,082.69

### ORDER TERMS AND CONDITIONS

1. INVOICES must bear exact same prices and terms or authorization for changes must be received from our company in writing prior to shipping.
2. The right is reserved to cancel all or part of this order if not delivered within the time specified.
3. Packing slips must accompany all shipments.
4. In the event of interruption of our business in whole or in part by reason of fire, flood, windstorm, earthquake, war, strike, embargo, acts of God, governmental action, or any causes beyond our control, we shall have the option of cancelling undelivered orders in whole or in part.
5. Acceptance of this purchase order, or shipment of it will constitute an agreement to all of its specifications as to terms, delivery and prices.
6. No deliveries accepted after 4:00 pm or on weekends.

WHITE - ORIGINAL

CANARY - ACCOUNTS PAYABLE

PINK - DEPARTMENT



Tel: (613) 748-0432  
Fax: (613) 748-0355

A Division of the S&S Bolton Group  
www.ssbolton.com

Estimate No#: SS6460 Rev.02

Builder Copy

Customer:

Peggy Perrault  
Home: 613-913-8189  
Cell: 613-835-7536  
Email: pandj.perrault@xplornet.com

Builder: VALECRAFT HOMES (2019) LTD.  
Project: PST Singles Ph7  
Lot: PST PH 7 Lot 3  
Closing Date: December 14, 2023

Salesperson: Kyle Takman  
Date: 05/08/2023

Location	Qty	Product / Installation Details	Plan Code	Unit Price	Customer Total	Builder Total
Great Room	1.00	<b>15 Amp Standard Plug</b> Add 15 AMP plug approx 72 inches from floor above fireplace beside conduit	A	148.00 \$	148.00 \$	74.00 \$
Mechanical Room	1.00	<b>15 Amp Separate Circuit Plug</b> Add 15 Amp separate circuit plug for central vacuum	C	294.00 \$	294.00 \$	147.00 \$
Front Out	1.00	<b>15 Amp Separate Circuit Soffit Plug w/ Switch</b> 15 Amp Separate Circuit Soffit Plug w/ Switch for Christmas lights	D	348.00 \$	348.00 \$	174.00 \$
Kitchen	2.00	<b>Standard Light Outlet (Keyless)</b> Relocate standard fixtures, leave as (2) keyless for future pendent lighting	E	\$	0.00 \$	0.00 \$
Kitchen	3.00	<b>Misc. Product</b> delete standard fixture in Dinette	F	-166.00 \$	-498.00 \$	-249.00 \$
Kitchen	1.00	<b>6 * 4" LED slim Pot Light White (AFR4C-0930-WH)</b> Add 6 LED Halo potlights (AFR4-0930-WH) on included switch	F	1,488.00 \$	1,488.00 \$	744.00 \$
Kitchen	1.00	<b>Upgrade Switch to Dimmer</b> Upgrade Switch to Dimmer	F	108.00 \$	108.00 \$	54.00 \$
Great Room	1.00	<b>6 * 4" LED slim Pot Light White (AFR4C-0930-WH)</b> Add 6 LED Halo potlights (AFR4-0930-WH) on included switch	G	1,488.00 \$	1,488.00 \$	744.00 \$
Great Room	1.00	<b>Misc. Product</b> Switch for switched outlets to be used for potlights	G	\$	0.00 \$	0.00 \$
Great Room	1.00	<b>Upgrade Switch to Dimmer</b> Upgrade Switch to Dimmer	G	108.00 \$	108.00 \$	54.00 \$
Various Locations	2.00	<b>15 Amp USB Charger Receptacle</b> USB Charger Receptacle in kitchen and master bedroom (standard items)	H	\$	0.00 \$	0.00 \$

www.sandselectric.ca

Phone: (613) 748-0432 | Fax: (613) 748-0355 | Email: info@sandselectric.ca | Website: www.sandselectric.ca

5 4 1 1 Canotek Road, Ottawa, Ontario K1J 9M3

Printed By: Kyle Takman - Page: 2



Tel: (613) 748-0432  
Fax: (613) 748-0355

A Division of the S&S Bolton Group  
www.ssbolton.com

Location	Qty	Product / Installation Details	Plan Code	Unit Price	Customer Total	Builder Total
Island Plug	1.00	<b>Misc. Product</b> Upgrade White Plug to Black (island only)	H	\$	0.00 \$	0.00 \$
Ensuite Bath	1.00	<b>4" LED slim Pot Light White (AFR4C-0930-WH)</b> Add 1 LED Halo potlight (AFR4-0930-WH) on added dimmer	I	250.00 \$	250.00 \$	125.00 \$
Ensuite Bath	1.00	<b>Add Dimmer</b> Added dimmer switch for potlight	I	218.00 \$	218.00 \$	109.00 \$
Main Bath	1.00	<b>4" LED slim Pot Light White (AFR4C-0930-WH)</b> Add 1 LED Halo potlight (AFR4-0930-WH) on added switch	J	250.00 \$	250.00 \$	125.00 \$
Main Bath	1.00	<b>Single Pole Switch</b> Added switch for potlight	J	110.00 \$	110.00 \$	55.00 \$
Master Bedroom	1.00	<b>Upgrade Standard Light Outlet for a Future Ceiling Fan c/w 3 Wires</b> Upgrade Standard Light Outlet for a Future Ceiling Fan c/w 3 Wires	L	260.00 \$	260.00 \$	130.00 \$

\*\*\* Total price does not include any applicable taxes.

<b>Customer Total:</b>	<b>4,572.00 \$</b>
<b>Builder Total:</b>	<b>2,286.00 \$</b>

Notes:

"Purchaser has acknowledged that they have discussed any kitchen layout modifications with their electrical representative. If modifications are made after signing off on electrical, this will incur additional charges."

Customer Signature

Date



THE MURRY

MODEL 1015  
1517 SQ. FT.

S&S / ORBITAL SKETCH

Site: Place St. Thomas 7 Purchaser: \_\_\_\_\_  
Plan No.: 50M-361  
Lot: 3 - Phase 7 Purchaser: \_\_\_\_\_  
Date May 8, 2023



ELEVATION A

Valecraft.com

\*Rendering is an artist concept only. Not to scale and may vary from finished community. Dimensions, specifications and landscaping are approximate and are subject to change without notice. E & O.E 01/20/2021



Model Name: The Murry 1015      Model #: 50M-361

Site: Place St. Thomas 7      Purchaser: \_\_\_\_\_

Lot: 3 - Phase 7

Date: May 8, 2023      Purchaser: \_\_\_\_\_

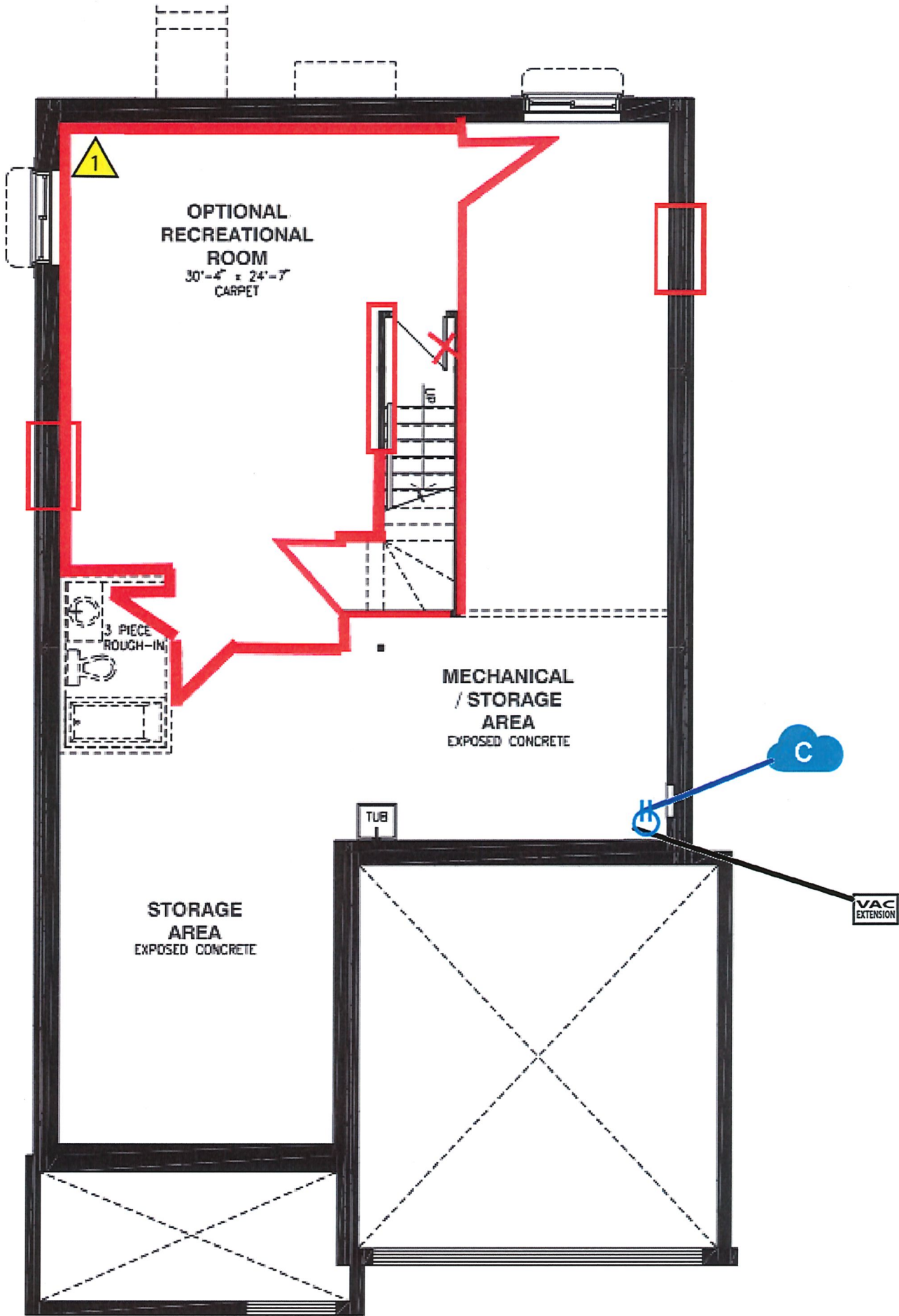

**BASEMENT FLOOR - ELEVATION A**



Valecraft  
Homes (2019) Limited

## S&S / Orbital Sketch

PST 7 Lot 3

Model Name: The Murry 1015

Model #: 50M-361

Site: Place St. Thomas 7

Purchaser: \_\_\_\_\_

Lot: 3 - Phase 7

Date: May 8, 2023

Purchaser: \_\_\_\_\_

