



# Valecraft

Homes Ltd.

Purchase Order PO0051121

210-1455 Youville Drive  
Orleans, On K1C 6Z7  
Phone: 613-837-1104

Vendor:  
S & S BOLTON ELECTRIC INC.  
5411 CANOTEK ROAD  
GLOUCESTER, ONTARIO K1J 9M3

tel: 6137480432  
fax: 613-748-0355  
contact: CAROL

Ship To:  
Site: DEERFIELD VILLAGE PHASE 2  
Lot/Unit: BLOCK U47  
Model: 5206 LEVEL 2  
Civic: 535-C FAWN VALLEY PRIVATE

ORDER DATE	CHG. ORDER DT.	CANCEL DATE	RESPONSIBILITY	VENDOR #	TERMS
Jan 19, 2022			ARIEL	S02	NET 30 DAYS
Comments/Special Instructions:					REFERENCE

JOB/LOT/COST	REFERENCE	Description	QTY ORDERED	UNIT PRICE	EXTENSION
042-U47-680	#4	S/I ELECTRICAL QUOTE #SS4967 REV.03	1.0000	952.000000	952.00
		-			

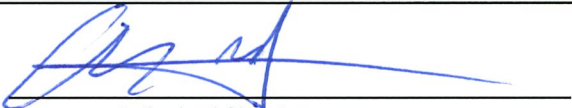
 Authorized Signature	Subtotal	952.00
	HST	123.76
	Total Order Value	1,075.76

ORDER TERMS AND CONDITIONS

- 1. INVOICES must bear exact same prices and terms or authorization for changes must be received from our company in writing prior to shipping.
- 2. The right is reserved to cancel all or part of this order if not delivered within the time specified.
- 3. Packing slips must accompany all shipments.
- 4. In the event of interruption of our business in whole or in part by reason of fire, flood, windstorm, earthquake, war, strike, embargo, acts of God, governmental action, or any causes beyond our control, we shall have the option of cancelling undelivered orders in whole or in part.
- 5. Acceptance of this purchase order, or shipment of it will constitute an agreement to all of its specifications as to terms, delivery and prices.
- 6. No deliveries accepted after 4:00 pm or on weekends.

WHITE - ORIGINAL      CANARY - ACCOUNTS PAYABLE      PINK - DEPARTMENT



Tel: (613) 748-0432  
Fax: (613) 748-0355

A Division of the S&S Bolton Group  
www.ssbolton.com

Estimate No#: SS4967 Rev.03

Builder Copy

Customer:

Inventory Unit - Valecraft

Builder: VALECRAFT HOMES LTD.  
Project: Deerfield Village Condos  
Lot: DV2 U47  
Closing Date: 05/10/2022

Salesperson: Jason Thompson  
Date: 07/07/2021

Location	Qty	Product / Installation Details	Plan Code	Unit Price	Customer Total	Builder Total
Living Room	1.00	<b>15 Amp Standard Plug</b> Add 15 Amp Plug - Approx 60 inches from floor beside conduit	A	141.00 \$	141.00 \$	74.00 \$
Master Bedroom	1.00	<b>15 Amp Standard Plug</b> Add 15 Amp Plug - Approx 60 inches from floor beside conduit	B	141.00 \$	141.00 \$	74.00 \$
Bedroom #2	1.00	<b>15 Amp Standard Plug</b> Add 15 Amp Plug - Approx 60 inches from floor beside conduit	C	141.00 \$	141.00 \$	74.00 \$
Kitchen	4.00	<b>4" LED slim Pot Light White (AFR4C-0930-WH)</b> Delete standard fixture and add 4 LED Halo potlight (AFR4-0930-WH) on upgraded dimmer switch	D	236.00 \$	944.00 \$	496.00 \$
Kitchen	1.00	<b>Upgrade Switch to Dimmer</b> Upgrade Switch to Dimmer	D	103.00 \$	103.00 \$	54.00 \$
Kitchen	1.00	<b>20 Amp USB Charger Receptacle</b> 20 Amp USB Charger Receptacle (standard)	F	\$	0.00 \$	0.00 \$
Ensuite Bath	1.00	<b>4" LED slim Pot Light White (AFR4C-0930-WH)</b> Add 1 LED Halo potlight (AFR4-0930-WH) on added switch	K	238.00 \$	238.00 \$	125.00 \$
Ensuite Bath	1.00	<b>Single Pole Switch</b> Switch for added potlight	K	105.00 \$	105.00 \$	55.00 \$

\*\*\* Total price does not include any applicable taxes.

Customer Total: 1,813.00 \$

Builder Total: 952.00 \$

Notes:

"Purchaser has acknowledged that they have discussed any kitchen layout modifications with their electrical representative. If modifications are made after signing off on electrical, this will incur additional charges."

Customer Signature

Date

Phone: (613) 748-0432 | Fax: (613) 748-0355 | Email: info@sandselectric.ca | Website: www.sandselectric.ca

5411 Canotek Road, Ottawa, Ontario K1J 9M3

Printed By: Jason Thompson - Page: 2

RECEIVED  
JUL 26 2021



SECOND FLOOR | **MODEL 5206** | 1145 SQ.FT

Site: Deerfield Village 2

Plan No.: 4M-1290

Unit: U-47

Date: July 7, 2021

Purchaser:

Purchaser:

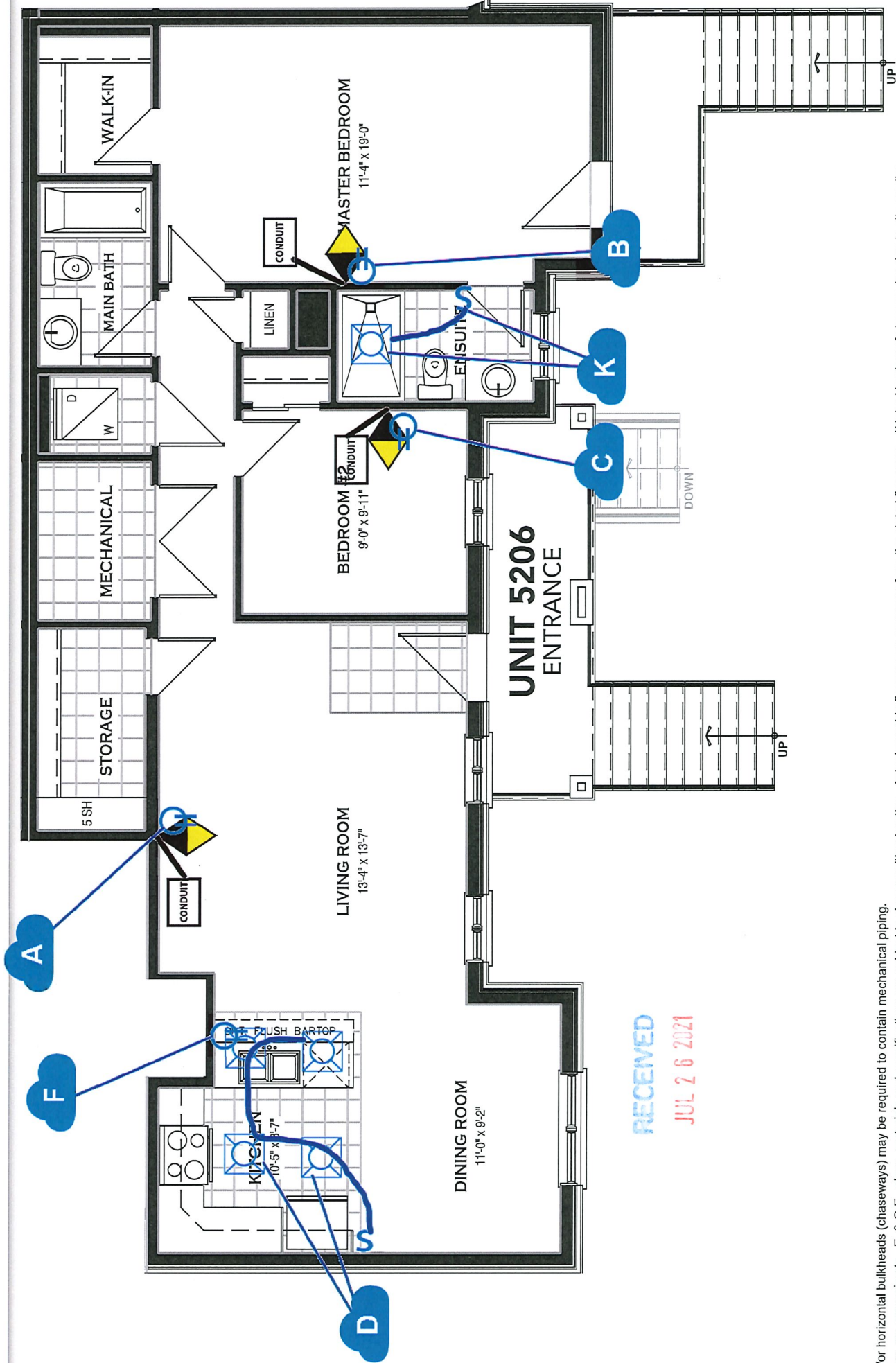

RECEIVED  
JUL 26 2021

SS-Orbital Sketch

Vertical and/or horizontal bulkheads (chaseways) may be required to contain mechanical piping. All dimensions are approximate. E. & O.E., plans, materials and specifications are subject to change without notice. Actual useable floor space may vary from the stated floor area. \*Note: Number of steps varies due to site grading.