



NON STANDARD EXTRAS (680)
Place St. Thomas - Phase 6

PURCHASER: Paulette Flore Dongmo Kahou

Printed: 9-May-22 5:49 pm

| | | | |
|------------------|------------|--|---------------------------|
| LOT NUMBER 10 | PHASE 6 | HOUSE TYPE 826 THE BRADLEY 3 BED ELEV A | CLOSING DATE 30-Mar-23 |
|------------------|------------|--|---------------------------|

| ITEM | QTY | EXTRA / CHANGE | PRICE | INTERNAL USE |
|-------|-------|---|---------|--------------|
| 33 | 1 | ENSUITE BATH - PURCHASER ACKNOWLEDGES AND ACCEPTS THE CUSTOM 4PC ENSUITE BATHROOM SKETCH DATED MAY 10, 2022 | \$ 0.00 | Each |
| 39513 | Note: | - As per Custom 4 Pc Ensuite sketch dated May 10, 2022 - See item #22 (4pc ensuite) - See item #23 (freestanding tub) | | |

| | |
|-----------|--------|
| Sub Total | \$0.00 |
| HST | \$0.00 |
| Total | \$0.00 |

Payment Summary

| <u>Paid By</u> | <u>Amount</u> |
|----------------|---------------|
| Total Payment: | |

PURCHASER:

DocuSigned by:

FA3AD7E1A7E14BA...
Paulette Flore Dongmo Kahou
10-May-22
DATE

VENDOR:

DocuSigned by:

A04F6273C61214EE
PER: Valecraft Homes (2019) Limited

DATE: May 10, 2022

PREPARED BY: Adam Bowman

LOCKED BY:

PE 1,875-1

InvoiceSQL.rpt 01sept21

CONSTRUCTION SCHEDULING APPROVAL

PER: _____

DATE: _____

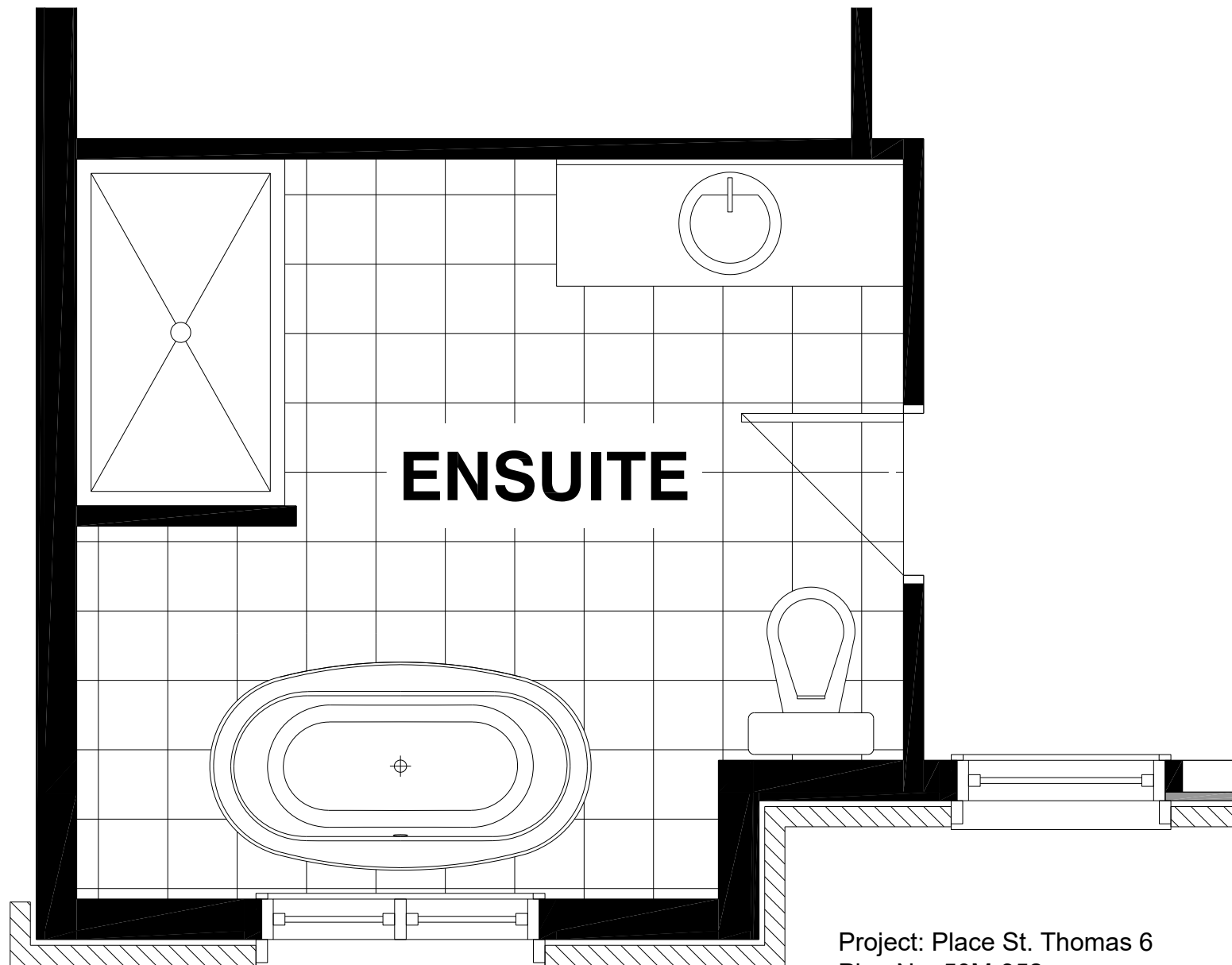

Project: Place St. Thomas 6
Plan No: 50M-352
Lot No: 10 - Phase 6
Model: #826 "A" Std Bradley 3Bed
Date: May 10, 2022

Custom 4 Pc Ensuite

Purchaser: Paulette Flore Dongmo Kahou

DS
PFD
DS
FN