

Internal B1A Deerfield 2 - Phase Condo				
PURCHASER: Portobello Partnership			Printed: 6-Oct-21 1:31 pm	
LOT NUMBER T29 Level: 2		PHASE Condo	HOUSE TYPE 5206	CLOSING DATE 31-May-22
ITEM	QTY	EXTRA / CHANGE	PRICE	INTERNAL USE
7 119594	1	KITCHEN - COUNTERTOP - GRANITE - LEVEL 1 - KITCHEN C/W FLUSH BREAKFAST BAR	\$ 5,332.00	Each
37214	Note:	Countertop edge to be eased edge, as per countertop edge profile sketch, Kitchen Sketch and Schedule H dated October 8, 2021. See items #18 & #19 for sink and faucet.		
8 90835	1	KITCHEN - CABINETRY - EXTEND FRIDGE UPPER TO APPROX. 2FT DEEP (ALL SERIES)	\$ 187.00	Each
37127	Note:	In standard series cabinetry, as per Kitchen Sketch and Schedule H dated October 8, 2021.		
9 87999	1	KITCHEN - LOWER CABINETS - LC POTS & PANS C/W 3 DRAWER FRONTS 6/12/12	\$ 704.00	Each
37128	Note:	In standard series cabinetry. To be located beside refrigerator, as per Kitchen Sketch and Schedule H dated October 8, 2021		
10	1	KITCHEN - SUPPLY AND INSTALL KITCHEN CABINETRY HARDWARE POI-R7040-128-BNL. INCLUDING POTS AND PANS 3 DRAWERS.	\$ 462.00	Each
37129	Note:	To be installed in Kitchen. See item #9 for pots and pans.		
11	1	ENSUITE BATH - SUPPLY AND INSTALL CABINETRY HARDWARE POI-R7040-128-BNL.	\$ 42.00	Each
37130	Note:	To be installed in Ensuite Bathroom.		
12	1	MAIN BATHROOM - SUPPLY AND INSTALL CABINETRY HARDWARE POI-R7040-128-BNL.	\$ 42.00	Each
37131	Note:	To be installed in Main Bathroom.		
13	1	- DELETE ALL BUILDERS STANDARD FLOORING IN ALL ROOMS (CERAMIC FLOORS, HARDWOOD FLOORS, CARPET AND UNDERPAD) AND SUPPLY AND INSTALL TORLYS FLOORING.	\$ 2,653.00	Each
37133	Note:	To be installed (side to side) in Dining Room, Living Room, Entry/Foyer, Kitchen, Mechanical Room, Laundry closet, Storage Room, Bedroom Hallway, Master Bedroom & WIC and Bedroom #2. To be installed (1/2 brick front to back) in Main Bathroom and Ensuite Bathroom, as per Floor tile installation sketch and Schedule H dated October 8, 2021		
14 128	1	KITCHEN - TILE - WALL - BACKSPLASH - UPGRADE - GOLD - - KITCHEN - GOLD	\$ 285.00	Each
37134	Note:	As per wall tile installation sketch dated October 8, 2021		
15 140	1	ENSUITE BATH - TILE - WALL - UPGRADE - FLOOR TILE IN LIEU OF WALL - SILVER - - ENSUITE BATHROOM - SILVER	\$ 1,129.00	Each
37135	Note:	To be installed in Ensuite shower walls, as per wall tile installation sketch dated October 8, 2021		
16 140	1	MAIN BATHROOM - TILE - WALL - UPGRADE - FLOOR TILE IN LIEU OF WALL - SILVER - - MAIN BATHROOM - SILVER	\$ 983.00	Each
37136	Note:	To be installed in Main Bathroom tub/shower, as per wall tile installation sketch dated October 8, 2021		
17 88508	2	- CERAMIC TILE - GROUT COLOR PER COLOUR	\$ 150.00	
37137	Note:			
18 88428	1	KITCHEN - KITCHEN FAUCET - DELTA MARLEY 986LF - AR ARCTIC STAINLESS	\$ 358.00	Each
37138	Note:	See item #7 for solid surface countertop. See item #19 for sink.		

Vendor Initials: \_\_\_\_\_ Purchaser Initials: \_\_\_\_\_

PREPARED BY: Nicole Trudel  
LOCKED BY: Lisa Ballard  
PE 1,725-1  
InvoiceSQL.rpt 05may21

CONSTRUCTION SCHEDULING APPROVAL

PER: \_\_\_\_\_

DATE: \_\_\_\_\_

Internal B1A

Deerfield 2 - Phase Condo

PURCHASER: Portobello Partnership

Printed: 6-Oct-21 1:31 pm

LOT NUMBER	PHASE	HOUSE TYPE	CLOSING DATE
T29 Level: 2	Condo	5206	31-May-22

ITEM	QTY	EXTRA / CHANGE	PRICE	INTERNAL USE
19	1	KITCHEN - KITCHEN SINK - REGINOX ND1831UA/9 DOUBLE BOWL UNDERMOUNT SINK	\$ 143.00	Each
88544				
37139		Note: See item #7 for solid surface countertop. See item #18 for faucet.		

Sub Total

\$12,470.00

HST

\$0.00

Total

\$12,470.00

Payment Summary

<u>Paid By</u>	<u>Amount</u>
Total Payment: _____	

PURCHASER:

\_\_\_\_\_

06-Oct-21

Portobello Partnership

DATE

VENDOR:

\_\_\_\_\_

PER: Valecraft Homes Limited

DATE: \_\_\_\_\_

CONSTRUCTION SCHEDULING APPROVAL

PER: \_\_\_\_\_

DATE: \_\_\_\_\_



BUILDER: VALECRAFT	PROJECT: DV2
BUILDER SCHEDULE:	LOT: T29
MEASURED BY:	DATE MEASURED: October 8, 2021

LOT: DV2 T29
Portobello Partnership

Kitchen Sketch

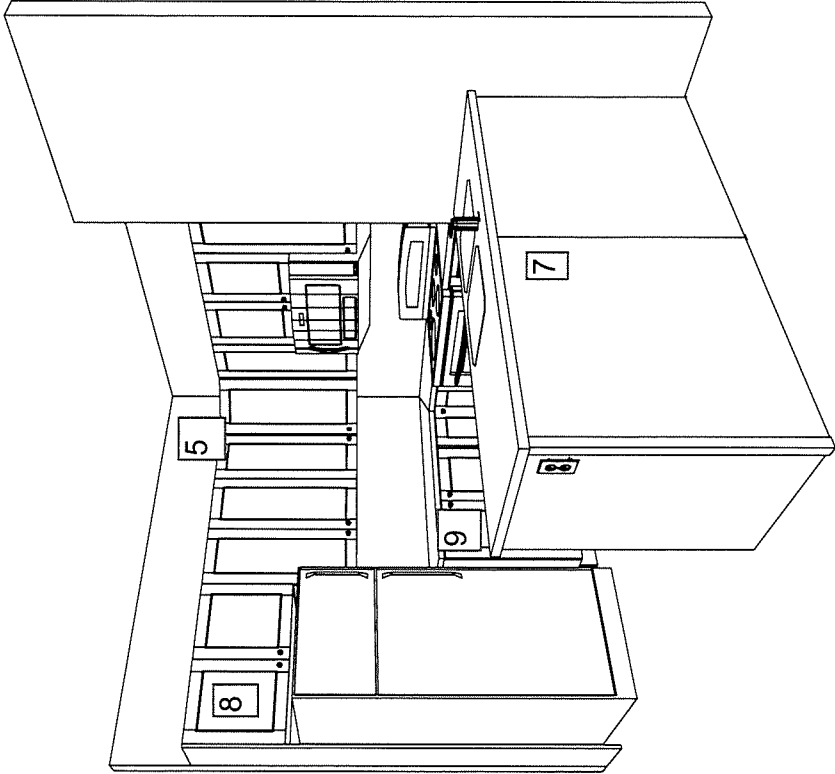
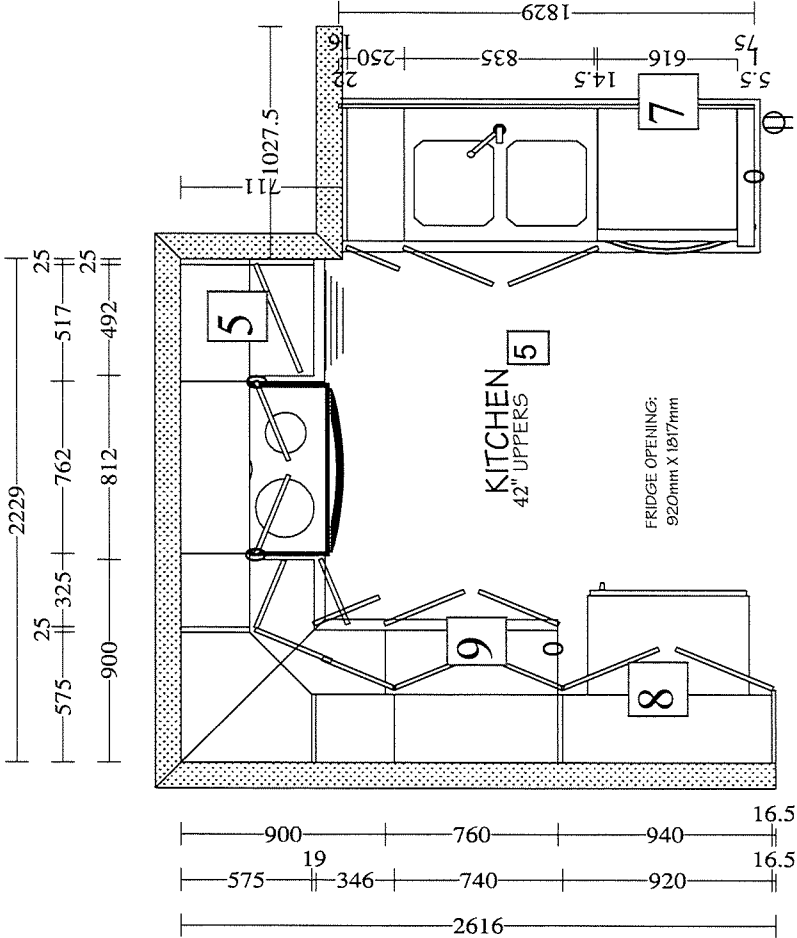



## Standard Edge Profiles for Granite & Quartz

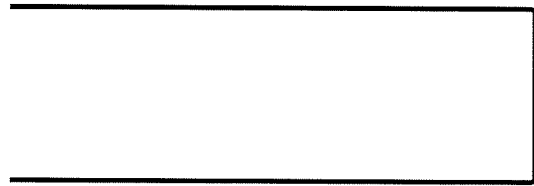

Eased Edge

#7 Kitchen

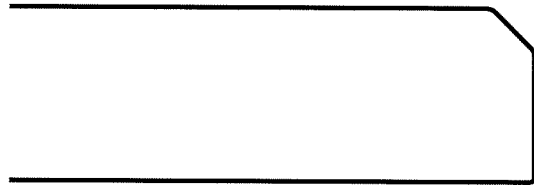

1/4 Bevel

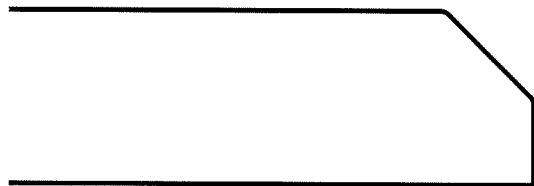

1/2 Bevel

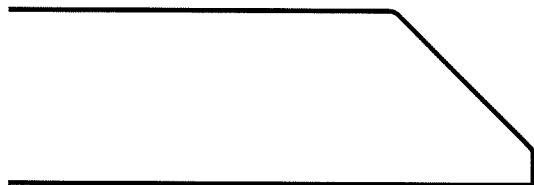

3/4 Bevel

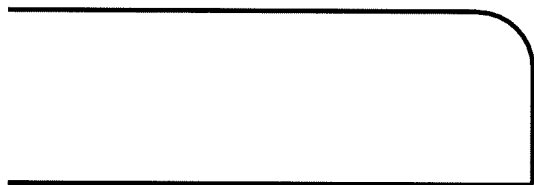

Pencil Top Only  
with Square Bottom

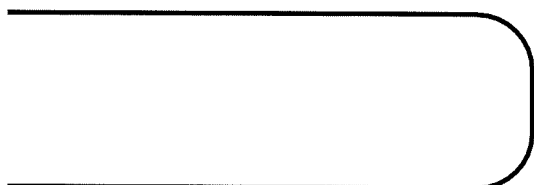

Pencil Top and Bottom

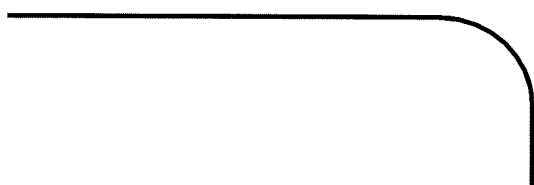

1/2 Bullnose

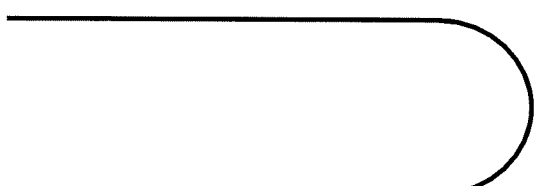

Full Bullnose

Project: DV2

Purchaser: Portobello Partnership

Plan #: 4M-1290

Purchaser: \_\_\_\_\_

Lot: T29

Date: October 8, 2021

Model: 5206

Upgrade #: 7



Valecraft  
Homes Ltd.

## Tile Installation Options

### FLOOR TILE

Standard square

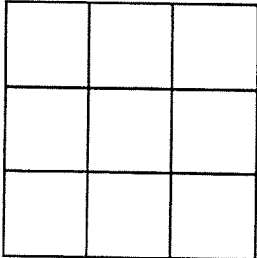

Square brick

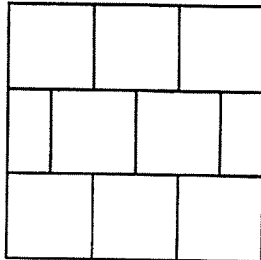

Rectangular  
front to back of the house

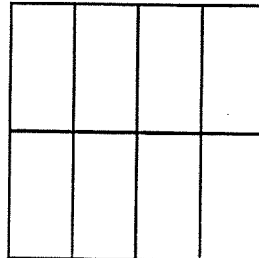

Rectangular  
side to side of the house

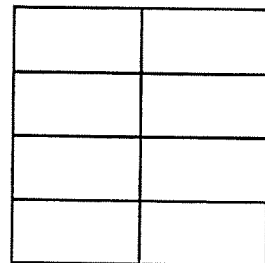

1/2 brick front to back  
of the house

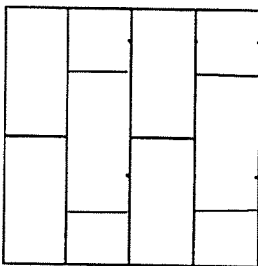

Main Bathroom  
Ensuite Bathroom

1/2 brick side to side of  
house

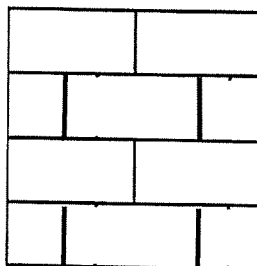

45 degree

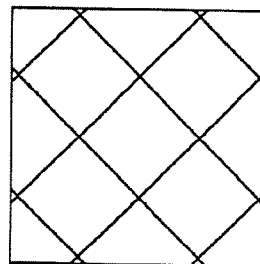

Project: DV2

Plan #: 4M-1290

Lot: T29

Model: 5206

Purchaser: Portobello Partnership

Purchaser: \_\_\_\_\_

Date: October 8, 2021

Upgrade #: 13



## Tile Installation Options

### WALL TILE

Vertical stacked

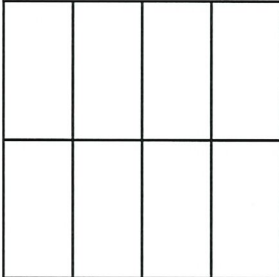

\_\_\_\_\_

\_\_\_\_\_

\_\_\_\_\_

Horizontal stacked

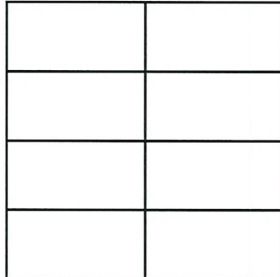

Kitchen Backsplash

Ensuite Bathroom

Main Bathroom

\_\_\_\_\_

Vertical 1/3 staggered

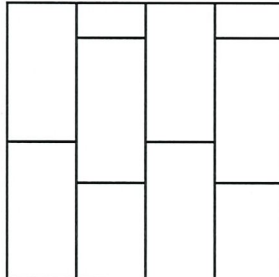

\_\_\_\_\_

\_\_\_\_\_

\_\_\_\_\_

Horizontal 1/3 staggered

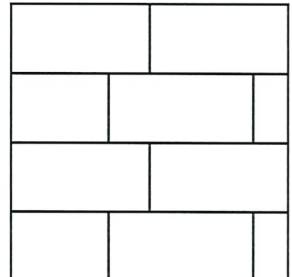

\_\_\_\_\_

\_\_\_\_\_

\_\_\_\_\_

Vertical brick

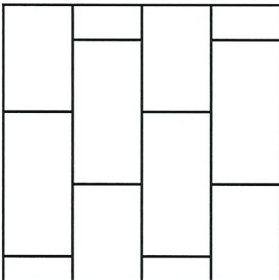

\_\_\_\_\_

\_\_\_\_\_

\_\_\_\_\_

Horizontal brick

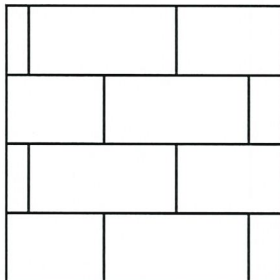

\_\_\_\_\_

\_\_\_\_\_

\_\_\_\_\_

45 degree

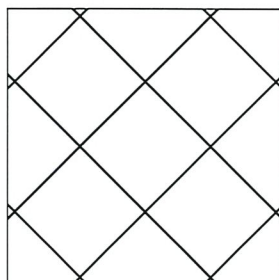

\_\_\_\_\_

\_\_\_\_\_

\_\_\_\_\_

Standard square

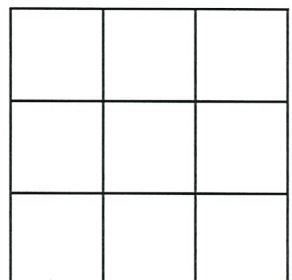

\_\_\_\_\_

\_\_\_\_\_

\_\_\_\_\_

Project: DV2

Plan #: 4M-1290

Lot: T29

Model: 5206

Purchaser: Portobello Partnership

Purchaser: \_\_\_\_\_

Date: October 8, 2021

Upgrade #: 14, 15, 16

Schedule "W4"  
Granite & Variegated Quartz Colour Variation

Purchaser's name:	<u>Portobello Partnership</u>	Lot no:	<u>T29</u>
Purchaser's name:	<u>Contact: Smar Merhi</u>	Project:	<u>DEERFIELD VILLAGE 2</u>
Home Phone:	<u></u>	Model:	<u>5206</u>
Work Phone:	<u>613-837-2754</u>	Closing Date:	<u>May 31st, 2022</u>
E-Mail (1):	<u><a href="mailto:design@valecraft.com">design@valecraft.com</a></u>	E-Mail (2):	<u></u>

Valecraft Homes Ltd. continues to provide the best in class sales and service. We recognize the importance of your home to you, our valued customer.

Granite & Variegated Quartz countertops are an elegant addition to your home. However, there are some things of which you should be aware.

Due to the natural composition of **Granite**, inherent variations in texture, colour and consistency are to be expected and considered as normal.

During the process of manufacturing **Variegated Quartz** to achieve a more natural stone look, variations in the appearance between the sample & the slab are to be expected.

Valecraft Homes Limited strongly suggests that you attend an appointment with our granite/quartz supplier two to three months prior to closing to view the granite/variegated quartz slabs available in the colour you have already chosen. A representative from our supplier will contact you to set up a mutual date & time for the appointment.

I/we, Portobello Partnership

have read and fully understand the aforementioned recommendation set forth by the builder and as such hereby release VALECRAFT HOMES LIMITED from future responsibility with respect to a variation in colour of granite countertops.

<input checked="" type="checkbox"/>	We <u>accept</u> this opportunity
<input type="checkbox"/>	We <u>decline</u> this opportunity

Project: DEERFIELD VILLAGE 2 LOT NO: T29

<u>Purchaser</u>	<u>Date:</u>
------------------	--------------

<u>Purchaser</u>	<u>Date:</u>
------------------	--------------

<u>T. OLIVER</u>	<u>October 8, 2021</u>
Valecraft Homes Limited	Date:

Appointment date given:	<u></u>	Spoke with/left message:	<u></u>
Time scheduled:	<u></u>	Date & Time:	<u></u>



 **Valecraft**  
Homes Ltd.

**SECOND FLOOR**

---

**MODEL 5206**

**BLOCKS T - U - V**

**1145 SQ.FT**

Purchaser: Portobello Partnership

Plan No.: 4M-1290

Purchaser:

Date: October 8, 2021

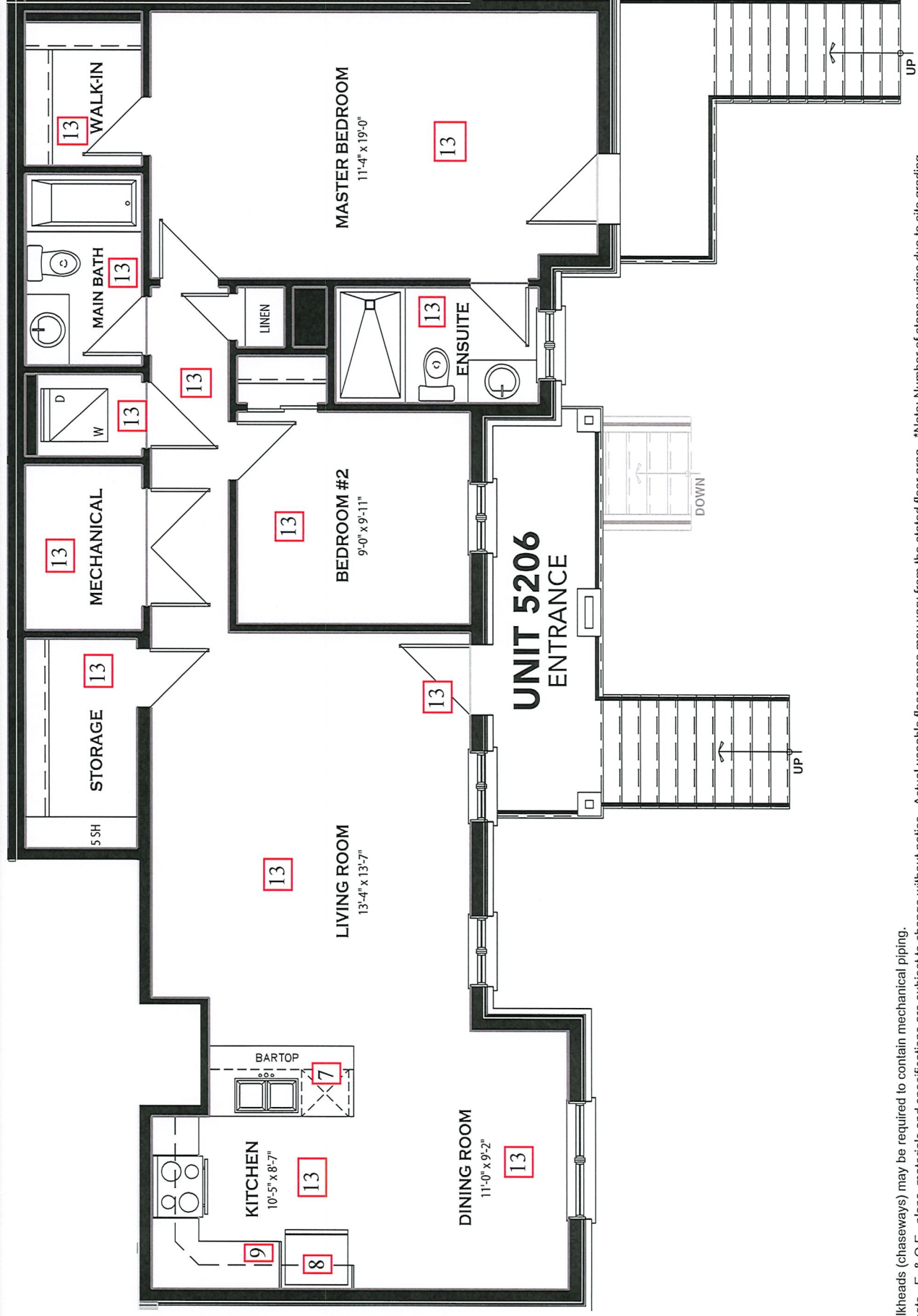

Vertical and/or horizontal bulkheads (chaseways) may be required to contain mechanical piping. All dimensions are approximate. E. & O.E., plans, materials and specifications are subject to change.

07/14/2021

## Schedule H



 <b>Valecraft</b> Homes Ltd.	<b>CONDOMINIUM HOME COLOUR CHART</b>					
	Community:	Deerfield Village II	Reg'd Plan #:	4M-1290	Sales Rep:	Nicole Trudel
	Lot No:	T29	Civic Address:	715-I Dearborn Private		
	Purchaser(s):	Portobello Partnership			Model Name/#:	5206
	Purchaser(s):				Closing Date:	May 31-2022

INTERIOR FINISHES		
DESCRIPTION		STD/UPG #
TRIM STYLE	Standard Nivaga Baseboards and Casings	STD
DOOR STYLE	Standard Cambridge Style Passage Doors	STD
INTERIOR HARDWARE	Standard Satin Chrome	STD
INTERIOR LIGHTING PACKAGE	Roma Lighting Package	4
BATHROOM ACCESSORIES	Standard Infinity Series in Chrome	STD

PAINT COLOUR(S)				
ROOM	MAIN COLOUR	STD/UPG #	ACCENT WALL	STD/UPG #
TRIM	Semi Gloss OC-117 simply white	STD	N/A	N/A
ENTRANCE	N/A	N/A	N/A	N/A
STORAGE ROOM	Low Lustre OC-30 Gray Mist	STD	N/A	N/A
LAUNDRY CLOSET	Low Lustre OC-30 Gray Mist	STD	N/A	N/A
MAIN FLOOR HALLWAY	N/A	N/A	N/A	N/A
LIVING ROOM / DINING ROOM	Low Lustre OC-30 Gray Mist	STD	N/A	N/A
KITCHEN	Semi Gloss OC-30 Gray Mist	STD	N/A	N/A
MECHANICAL ROOM	Low Lustre OC-30 Gray Mist	STD	N/A	N/A
BEDROOM HALLWAY	Low Lustre OC-30 Gray Mist	STD	N/A	N/A
MASTER BEDROOM & WIC	Low Lustre OC-30 Gray Mist	STD	N/A	N/A
BEDROOM #2	Low Lustre OC-30 Gray Mist	STD	N/A	N/A
ENSUITE BATHROOM	Semi Gloss OC-30 Gray Mist	STD	N/A	N/A
MAIN BATHROOM	Semi Gloss OC-30 Gray Mist	STD	N/A	N/A
NOTES:				

Purchaser's Signature(s) : \_\_\_\_\_
Date: \_\_\_\_\_

Purchaser's Signature(s) : \_\_\_\_\_
Date: \_\_\_\_\_

Approved By :

T. OLIVER

Date: **October 8, 2021**

Subject to change by Valecraft Homes in the event of unavailability of materials.  
Prices, terms and specifications are subject to change without notice E/O.E  
K:\Sales\Sales Legal Docs\Site - Deerfield\Block T\T29\DC\DV2 T29 Interior Colours (Simon) Sept

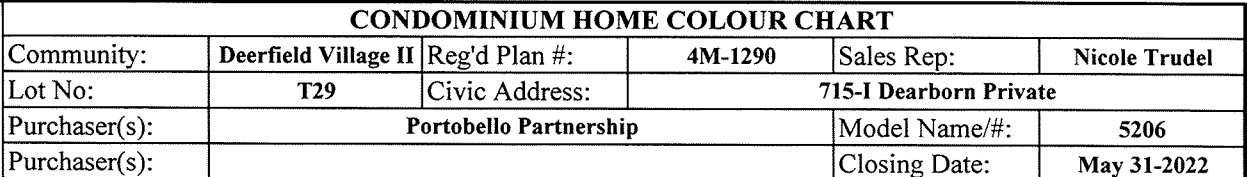

CABINETRY						
ROOM	SELECTION				LEVEL	STD/UPG #
KITCHEN	STYLE AND COLOUR	B10R 2164			STD	5, 7, 8, 9
	HARDWARE CODE	POI-R7040-128-BNL	TYPE	Pulls	UPG	9, 10
	COUNTERTOP	Black Pearl (Slab Viewing Required)	COUNTERTOP EDGE PROFILE	Eased Edge	Granite Level 1	7
MAIN BATHROOM	STYLE AND COLOUR	V202S 2164			STD	STD
	HARDWARE CODE	POI-R7040-128-BNL	TYPE	Pulls	UPG	12
	COUNTERTOP	RK7002-T	COUNTERTOP EDGE PROFILE	Standard	STD Laminate	STD
ENSUITE BATHROOM	STYLE AND COLOUR	V202S 2164			STD	STD
	HARDWARE CODE	POI-R7040-128-BNL	TYPE	Pulls	UPG	11
	COUNTERTOP	RK7002-T	COUNTERTOP EDGE PROFILE	Standard	STD Laminate	STD
POWDER ROOM	STYLE AND COLOUR	N/A			N/A	N/A
	HARDWARE CODE	N/A	TYPE	N/A	N/A	N/A
	COUNTERTOP	N/A	COUNTERTOP EDGE PROFILE	N/A	N/A	N/A

APPLIANCES				
TYPE	SIZE	STD/UPG #	APPLIANCE UPG LEVEL	STD/UPG #
<b>FRIDGE</b> <i>(Standard Minimum Opening is 33" x 70.75")</i>	Standard Opening	STD	Basic Stainless Steel	2
<b>RANGE</b>	Standard Opening	STD	Basic Stainless Steel	2
<b>DISHWASHER</b>	Standard Opening	STD	Basic Stainless Steel	2
<b>MICROWAVE / HOODFAN</b>	Standard Opening	STD	OTR - Basic Stainless Steel	2
<b>WASHING MACHINE/DRYER</b>	Standard Opening	STD	Basic White Stackable Washer/ Dryer with Stacking Kit	2

**Purchaser's Signature(s) :** \_\_\_\_\_ **Date:** \_\_\_\_\_

Subject to change by Valecraft Homes in the event of unavailability of materials.  
Prices, terms and specifications are subject to change without notice E/O.E  
K:\Sales\Sales Legal Docs\Site - Deerfield\Block T1T29\DC\DV2 T29 Interior Colours (Simon) Sept

	CONDOMINIUM HOME COLOUR CHART				
	Community:	Deerfield Village II	Reg'd Plan #:	4M-1290	Sales Rep: Nicole Trudel
	Lot No:	T29	Civic Address:	715-I Dearborn Private	
	Purchaser(s):	Portobello Partnership			Model Name/ #: 5206
	Purchaser(s):				Closing Date: May 31-2022

CERAMIC / VINYL TILE & GROUT SELECTIONS					
ROOM	AREA	MANUFACTURER/SERIES/ SIZE/COLOUR/CODE	GROUT SELECTION	LEVEL	STD/UPG #
ENTRY	FLOOR	See Vinyl EverWood Flooring Selection	N/A	N/A	13
STORAGE ROOM	FLOOR	See Vinyl EverWood Flooring Selection	N/A	N/A	13
	WALL	N/A	N/A	N/A	N/A
	INSERT OR BORDER	N/A			
MECHANICAL ROOM	FLOOR	See Vinyl EverWood Flooring Selection	N/A	N/A	13
LAUNDRY CLOSET	FLOOR	See Vinyl EverWood Flooring Selection	N/A	N/A	13
	WALL	N/A	N/A	N/A	N/A
	INSERT OR BORDER	N/A			
KITCHEN	FLOOR	See Vinyl EverWood Flooring Selection	N/A	N/A	13
	BACKSPLASH	Euro Pasha Soho 4"x16" Matte White (Horizontal stacked install)	910 Bright White	Gold Wall Tile + UPG Grout	14, 17
	INSERT OR BORDER	N/A			
DINETTE	FLOOR	N/A	N/A	N/A	N/A
MAIN BATHROOM	FLOOR	Torlys Evertile Premier ET-24013 Calcata 11-1/2" Wide x 23-5/8" Long (Front to Back 1/2 Brick Install)	N/A	Quote	13
	WALL	Ceratec Visuals Gaia 11.6"x23.4" Taupe (Horizontal Stacked Install)	908 Dove Gray	Silver Floor Tile on Wall + UPG Grout	16, 17
	INSERT OR BORDER	N/A			
ENSUITE BATHROOM	FLOOR	Torlys Evertile Premier ET-24013 Calcata 11-1/2" Wide x 23-5/8" Long (Front to Back 1/2 Brick Install)	N/A	Quote	13
	WALL	Ceratec Visuals Gaia 11.6"x23.4" Taupe (Horizontal Stacked Install)	908 Dove Gray	Silver Floor Tile on Wall + UPG Grout	15, 17
	INSERT OR BORDER	N/A			

Purchaser's Signature(s) : \_\_\_\_\_
Date: \_\_\_\_\_

Purchaser's Signature(s) : \_\_\_\_\_
Date: \_\_\_\_\_

Approved By : T. OLIVER \_\_\_\_\_
Date: October 8, 2021 \_\_\_\_\_

Subject to change by Valecraft Homes in the event of unavailability of materials.  
Prices, terms and specifications are subject to change without notice E/O.E  
K:\Sales\Sales Legal Docs\Site - Deerfield\Block T\T29\DC\DV2 T29 Interior Colours (Simon) Sept

 <b>Valecraft</b> <small>Homes Ltd.</small>	<b>CONDOMINIUM HOME COLOUR CHART</b>					
	Community:	<b>Deerfield Village II</b>	Reg'd Plan #:	<b>4M-1290</b>	Sales Rep:	<b>Nicole Trudel</b>
	Lot No:	<b>T29</b>	Civic Address:	<b>715-I Dearborn Private</b>		
	Purchaser(s):	<b>Portobello Partnership</b>			Model Name/#:	<b>5206</b>
	Purchaser(s):				Closing Date:	<b>May 31-2022</b>

FLOORING SELECTIONS			
ROOM	CARPET/UNDERPAD / HARDWOOD / VINYL EVERWOOD	LEVEL	STD/UPG #
ENTRY/FOYER	Torlys Everwood Premier EW23001 Beach House 4-7/8" Wide x 48-3/8" Long Plank (Side to Side Install)	Quote	13
KITCHEN	Torlys Everwood Premier EW23001 Beach House 4-7/8" Wide x 48-3/8" Long Plank (Side to Side Install)	Quote	13
DINING ROOM	Torlys Everwood Premier EW23001 Beach House 4-7/8" Wide x 48-3/8" Long Plank (Side to Side Install)	Quote	13
PANTRY/ STORAGE	Torlys Everwood Premier EW23001 Beach House 4-7/8" Wide x 48-3/8" Long Plank (Side to Side Install)	Quote	13
MECHANICAL ROOM	Torlys Everwood Premier EW23001 Beach House 4-7/8" Wide x 48-3/8" Long Plank (Side to Side Install)	Quote	13
LAUNDRY CLOSET	Torlys Everwood Premier EW23001 Beach House 4-7/8" Wide x 48-3/8" Long Plank (Side to Side Install)	Quote	13
LIVING ROOM	Torlys Everwood Premier EW23001 Beach House 4-7/8" Wide x 48-3/8" Long Plank (Side to Side Install)	Quote	13
MAIN STAIRS	N/A	N/A	N/A
BEDROOM HALLWAY	Torlys Everwood Premier EW23001 Beach House 4-7/8" Wide x 48-3/8" Long Plank (Side to Side Install)	Quote	13
MASTER BEDROOM & WIC	Torlys Everwood Premier EW23001 Beach House 4-7/8" Wide x 48-3/8" Long Plank (Side to Side Install)	Quote	13
BEDROOM # 2	Torlys Everwood Premier EW23001 Beach House 4-7/8" Wide x 48-3/8" Long Plank (Side to Side Install)	Quote	13
STAIRS FROM FOYER	N/A	N/A	N/A

Purchaser's Signature(s) :

Date:

Purchaser's Signature(s) :

Date:

Approved By :

T. OLIVER

Date:

October 8, 2021



CONDOMINIUM HOME COLOUR CHART					
Community:	Deerfield Village II	Reg'd Plan #:	4M-1290	Sales Rep:	Nicole Trudel
Lot No:	T29	Civic Address:	715-I Dearborn Private		
Purchaser(s):	Portobello Partnership			Model Name/#:	5206
Purchaser(s):				Closing Date:	May 31-2022

PLUMBING FIXTURES

ROOM	FIXTURE	STYLE	FINISH	STD/UPG#
KITCHEN	SINK	Reginox Kitchen Sink Undermount Double Bowl ND1831UA/9	Stainless Steel	19
	FAUCET	Delta Kitchen Faucet Single Handle Pull-Down Marley 986LF-AR	Arctic Stainless	18
ENSUITE BATHROOM	SINK	Standard	White	STD
	VANITY FAUCET	Standard	Chrome	STD
	WATER CLOSET	Standard	White	STD
	SHOWER	Standard with Zitta Niche 12 x 12 (Installed on short wall opposing of shower head, approx. centered and the top of niche approx. 5ft from shower base)	White/Chrome/ Clear Glass/ Stainless Steel	6
	SHOWER FAUCET	Standard	Chrome	STD
MAIN BATHROOM	SINK	Standard	White	STD
	VANITY FAUCET	Standard	Chrome	STD
	WATER CLOSET	Standard	White	STD
	TUB/SHOWER	Standard	White	STD
	TUB/SHOWER FAUCET	Standard	Chrome	STD
POWDER ROOM	PEDESTAL	N/A	N/A	N/A
	SINK FAUCET	N/A	N/A	N/A
	WATER CLOSET	N/A	N/A	N/A

NOTE: All fixtures are white as standard

Purchaser's Signature(s) : \_\_\_\_\_

Purchaser's Signature(s) : \_\_\_\_\_

Approved By : \_\_\_\_\_

Date: \_\_\_\_\_

Date: \_\_\_\_\_

Date: October 8, 2021

**Schedule "W4"**  
**Granite & Variegated Quartz Colour Variation**

Purchaser's name:	<u>Portobello Partnership</u>	Lot no:	<u>T29</u>
Purchaser's name:	<u>Contact: Smar Merhi</u>	Project:	<u>DEERFIELD VILLAGE 2</u>
Home Phone:	<u></u>	Model:	<u>5206</u>
Work Phone:	<u>613-837-2754</u>	Closing Date:	<u>May 31st, 2022</u>
E-Mail (1):	<u>design@valecraft.com</u>	E-Mail (2):	<u></u>

Valecraft Homes Ltd. continues to provide the best in class sales and service. We recognize the importance of your home to you, our valued customer.

Granite & Variegated Quartz countertops are an elegant addition to your home. However, there are some things of which you should be aware.

Due to the natural composition of **Granite**, inherent variations in texture, colour and consistency are to be expected and considered as normal.

During the process of manufacturing **Variegated Quartz** to achieve a more natural stone look, variations in the appearance between the sample & the slab are to be expected.

Valecraft Homes Limited strongly suggests that you attend an appointment with our granite/quartz supplier two to three months prior to closing to view the granite/variegated quartz slabs available in the colour you have already chosen. A representative from our supplier will contact you to set up a mutual date & time for the appointment.

I/we, Portobello Partnership  
have read and fully understand the aforementioned recommendation set forth by the builder and as such hereby release VALECRAFT HOMES LIMITED from future responsibility with respect to a variation in colour of granite countertops.

☒ We accept this opportunity  
☐ We decline this opportunity

**Project:** DEERFIELD VILLAGE 2      **LOT NO:** T29

**Purchaser** \_\_\_\_\_ **Date:** \_\_\_\_\_

**Purchaser** \_\_\_\_\_ **Date:** \_\_\_\_\_

T. Oliver      October 8, 2021  
**Valecraft Homes Limited**      **Date:**

Appointment date given: \_\_\_\_\_ Spoke with/left message: \_\_\_\_\_

Time scheduled: \_\_\_\_\_ Date & Time: \_\_\_\_\_