

Internal B1A Deerfield 2 - Phase 2				
PURCHASER: Portobello Partnership			Printed: 2-Sep-21 1:09 pm	
LOT NUMBER B11		PHASE 2	HOUSE TYPE 105 THE MANN 3 BED	CLOSING DATE 14-Dec-21
ITEM	QTY	EXTRA / CHANGE	PRICE	INTERNAL USE
*16 90563	1	- BONUS - APPLIANCES - 3 BASIC STAINLESS STEEL KITCHEN APPLIANCES INCLUDING MICROWAVE COMBO HOODFAN, AND BASIC TOP LOAD WHITE WASHER AND DRYER.	\$ 0.00	Each
36236	Note:			
17 88290	1	- FLAT CEILING IN WHOLE HOUSE	\$ 2,245.00	Each
36237	Note: Includes Family Room in Basement			
18	1	- KITCHEN - DELETE ITEM 5 (RE: UPGRADE KITCHEN CABINETRY TO LEVEL 1).	-\$2,205.00	Each
36238	Note:			
19	1	- BASEMENT - DELETE ITEM 7 (RE: OPTIONAL DIRECT VENT FIREPLACE IN BASEMENT WITH SURROUND FROM BUILDER'S STANDARDS, AND MDF MODERN TYPE 1 MANTLE PAINTED WHITE WHITE).	-\$3,944.00	Each
36239	Note:			
20	1	- BASEMENT - DELETE ITEM 8 (RE: FIREPLACE FAN KIT).	-\$389.00	Each
36240	Note:			
21	1	- KITCHEN - DELETE ITEM 9 (RE: UPC9-2A LEVEL 1 CABINETRY STANDARD LAYOUT. INCLUDES UPGARDE TO 42IN UPPERS WITH FILLER DETAIL ON UPPER KITCHEN CABINETRY TO STANDARD BULKHEAD).	-\$626.00	Each
36241	Note:			
*22 103630	1	- KITCHEN - CABINETRY - UPC9-2A - BUILDERS STANDARD CABINETRY - STANDARD LAYOUT. INCLUDES UPGRADE TO 42IN UPPERS WITH FILLER DETAIL ON UPPER KITCHEN CABINETRY TO STANDARD BULKHEAD	*\$ 471.00	Each
36242	Note: As per UPC Sketch and kitchen sketch dated August 31, 2021. Purchaser Acknowledges and accepts that Upper Kitchen cabinetry upgraded wood doors will have center style.			
23 90835	1	- KITCHEN - CABINETRY - EXTEND FRIDGE UPPER TO APPROX. 2FT DEEP (ALL SERIES)	\$ 187.00	Each
36243	Note: In standard series cabinets, in standard kitchen layout, as per kitchen sketch and Schedule H dated August 31, 2021.			
24 128	1	- KITCHEN - TILE - WALL - BACKSPLASH - UPGRADE - GOLD - - KITCHEN - GOLD	\$ 297.00	Each
36244	Note: To be installed in standard kitchen layout, horizontal 1/3 staggered install as per wall tile installation sketch dated August 31, 2021.			
25 88508	1	- - CERAMIC TILE - GROUT COLOR PER COLOUR	\$ 75.00	Each
36245	Note:			
26	1	- KITCHEN - SUPPLY AND INSTALL CABINETRY HARDWARE POI-V53-096-ZM2, IN KITCHEN, STANDARD LAYOUT.	\$ 420.00	Each
36246	Note:			
27	1	- KITCHEN - DELETE ITEM 12 (RE: KITCHEN FAUCET - DELTA ESSA 9113-AR-DST ARCTIC STAINLESS SINGLE HANDLE PULL- DOWN).	-\$456.00	Each
36247	Note:			

Internal B1A Deerfield 2 - Phase 2				
PURCHASER: Portobello Partnership			Printed: 2-Sep-21 1:09 pm	
LOT NUMBER B11		PHASE 2	HOUSE TYPE 105 THE MANN 3 BED	CLOSING DATE 14-Dec-21
ITEM	QTY	EXTRA / CHANGE	PRICE	INTERNAL USE
*28 88428	1	KITCHEN - KITCHEN FAUCET - DELTA MARLEY 986LF - AR ARCTIC STAINLESS	*\$ 357.00	Each
36248	Note: See item # 6 for solid surface countertops. See item # 30 for sink.			
29	1	KITCHEN - DELETE ITEM 13 (RE: FRANKE CUBE CUX110-30-CA SINGLE BOWL STAINLESS STEEL 9" DEEP UNDERMOUNT SINK.	-\$855.00	Each
36250	Note:			
30 88544	1	KITCHEN - KITCHEN SINK - REGINOX ND1831UA/9 DOUBLE BOWL UNDERMOUNT SINK	\$ 143.00	Each
36249	Note: See item # 6 for solid surface countertops. See item # 28 for faucet.			
31	1	- DELETE ITEM 10 (RE: OAK MODERN 3 1/2" BEVELLED POSTS, CONTEMPORARY HANDRAILS & GUNN METAL SQUARE SPINDLES, IN STANDARD AREAS/STAIRCASE TO BASEMENT).	-\$1,600.00	Each
36251	Note:			
32	1	- SUPPLY AND INSTALL OAK MODERN 3 1/2" WIDE POSTS WITH CAP, COLONIAL HANDRAILS & WRINKLED BLACK SQUARE SPINDLES, C/W METAL BRACKETS.(IN ALL STANDARD AREAS).	\$ 1,638.00	Each
36252	Note: In standard areas/staircase to basement, as per Schedule H dated August 31, 2021.			
33	1	MAIN BATHROOM - SUPPLY AND INSTALL UPGRADED LAMINATE COUNTERTOP, IN LIEU OF STANDARD.	\$ 105.00	Each
36253	Note: To be installed in main bathroom, as per Schedule H dated August 31, 2021.			
34	1	ENSUITE BATH - SUPPLY AND INSTALL UPGRADED LAMINATE COUNTERTOP, IN LIEU OF STANDARD.	\$ 84.00	Each
36254	Note: To be installed in 4 Pce ensuite c/w 2 sinks, as per Schedule H dated August 31, 2021. -See Item 4 (4 PC Ensuite Bathroom Layout)			
35 140	1	MAIN BATHROOM - TILE - WALL - UPGRADE - FLOOR TILE IN LIEU OF WALL - SILVER - MAIN BATHROOM - SILVER	\$ 983.00	Each
36255	Note: To be installed in Main bathroom, as per wall tile installation sketch dated August 31, 2021.			
36 140	1	ENSUITE BATH - TILE - WALL - UPGRADE - FLOOR TILE IN LIEU OF WALL - SILVER - - APPROXIMATELY 5 FOOT x 3 FOOT CERAMIC SHOWER - SILVER	\$ 1,024.00	Each
36256	Note: To be installed in 4 Pce ensuite c/w 2 sinks, as per wall tile installation sketch dated August 31, 2021. -See Item 4 (4 PC Ensuite Bathroom Layout)			
37	1	- DELETE ITEM 11 (RE: SUPPLY AND INSTALL OAK STAIRCASE WITH VENEERED RISERS & STRINGERS AND SOLID THREADS, PER STAIRCASE, IN LIEU OF STANDARD STAIRCASE FROM MAIN FLOOR TO BASEMENT).	-\$4,206.00	Each
36257	Note:			
38	1	FOYER - SUPPLY AND INSTALL TORLYS EVERWOOD PREMIER EW23001 BEACH HOUSE 4-7/8" WIDE x 48-3/8" LONG, FRONT TO BACK INSTALLATION (INCLUDES MAIN BATHROOM)	\$ 200.00	Each
36258	Note: To be installed in Foyer, as per Schedule H dated August 31, 2021.			
39	1	MAIN BATHROOM - SUPPLY AND INSTALL TORLYS EVERWOOD PREMIER EW23001 BEACH HOUSE 4-7/8" WIDE x 48-3/8" LONG, FRONT TO BACK INSTALLATION.	\$ 0.00	Each
36259	Note: To installed in Main bathroom, as per Schedule H dated August 31, 2021. INCLUDED IN ITEM #38			

Internal B1A Deerfield 2 - Phase 2			
PURCHASER: Portobello Partnership		Printed: 2-Sep-21 1:09 pm	
LOT NUMBER B11		PHASE 2	HOUSE TYPE 105 THE MANN 3 BED
CLOSING DATE 14-Dec-21			
ITEM	QTY	EXTRA / CHANGE	PRICE
		INTERNAL USE	
40	1	ENSUITE BATH - SUPPLY AND INSTALL TORLYS EVERWOOD PREMIER EW23001 BEACH HOUSE 4-7/8" WIDE x 48-3/8" LONG, FRONT TO BACK INSTALLATION.	\$ 0.00
36260	Note:	To be installed in 4 Pce ensuite c/w 2 sinks, as per Schedule H dated August 31, 2021. -See Item 4 (4 PC Ensuite Bathroom Layout)	Each
41	1	GREAT ROOM - SUPPLY AND INSTALL TORLYS EVERWOOD PREMIER EW23001 BEACH HOUSE 4-7/8" WIDE x 48-3/8" LONG, FRONT TO BACK INSTALLATION.(IN ALL STANDARD AREAS).	\$ 0.00
36261	Note:	To be installed in Great Room/ Dining Room and Main floor hallway (all standard areas), as per Schedule H dated August 31, 2021.	Each
42	1	KITCHEN - SUPPLY AND INSTALL TORLYS EVERWOOD PREMIER EW23001 BEACH HOUSE 4-7/8" WIDE x 48-3/8" LONG, FRONT TO BACK INSTALLATION.	\$ 86.00
36262	Note:	To be installed in standard Kitchen layout, as per Schedule H dated August 31, 2021.	Each
43	1	BEDROOM 2 - SUPPLY AND INSTALL TORLYS EVERWOOD PREMIER EW23001 BEACH HOUSE 4-7/8" WIDE x 48-3/8" LONG, FRONT TO BACK INSTALLATION.	\$ 1,321.00
36263	Note:	To be installed in Bedroom # 2, as per Schedule H dated August 31, 2021.	Each
44	1	BEDROOM 3 - SUPPLY AND INSTALL TORLYS EVERWOOD PREMIER EW23001 BEACH HOUSE 4-7/8" WIDE x 48-3/8" LONG, FRONT TO BACK INSTALLATION.	\$ 1,328.00
36264	Note:	To be installed in Bedroom # 3, as per Schedule H dated August 31, 2021.	Each
45	1	MASTER BEDROOM - SUPPLY AND INSTALL TORLYS EVERWOOD PREMIER EW23001 BEACH HOUSE 4-7/8" WIDE x 48-3/8" LONG, FRONT TO BACK INSTALLATION.	\$ 2,195.00
36265	Note:	To be installed in Master Bedroom and WIC, as per Schedule H dated August 31, 2021.	Each
46	1	BASEMENT - SUPPLY AND INSTALL TORLYS EVERWOOD PREMIER EW23001 BEACH HOUSE 4-7/8" WIDE x 48-3/8" LONG, FRONT TO BACK INSTALLATION.	\$ 4,161.00
36266	Note:	To be installed in Family Room, as per Schedule H dated August 31, 2021.	Each
47	1	- SUPPLY AND INSTALL QUOTE LEVEL CARPET BEAULIEU SILEX II BROADLOOM CARPET PAMPA BEIGE 16320, on stairs to basement including the steps and landing at the rear door	\$ 1,500.00
36268	Note:	As per Schedule H dated August 31, 2021.	Each
*48 107	*1	- UNDERPAD - UPGRADE - LEVEL 1 - - BASEMENT STAIRCASE - LEVEL 1	*\$ 94.00
36339	Note:	Including the steps and landing at the rear door, as per Schedule H dated August 31, 2021	Each
49	1	KITCHEN - CLARIFICATION TO ITEM 6: GRANITE LEVEL 1 IN KITCHEN AND FLUSH BREAKFAST BAR TO BE EASED EDGE COUNTERTOP DETAIL.	\$ 0.00
36270	Note:	As per countertop edge profile sketch dated August 31, 2021.	Each
50 88441	1	ENSUITE BATH - BATHROOMS - ZITTA NICHE 12X12 STAINLESS STEEL	\$ 447.00
36271	Note:	To be installed in 4 Pce ensuite bathroom shower, approximately centered on middle longest shower wall and approximately 5'-0" from floor, as per Schedule H dated August 31, 2021.	Each
		Sub Total	\$5,080.00
		HST	\$0.00
		Total	\$5,080.00

Internal B1A				
Deerfield 2 - Phase 2				
PURCHASER: Portobello Partnership			Printed: 2-Sep-21 1:09 pm	
LOT NUMBER		PHASE	HOUSE TYPE	CLOSING DATE
B11		2	105 THE MANN 3 BED	14-Dec-21
ITEM	QTY	EXTRA / CHANGE		PRICE
				INTERNAL USE

Payment Summary	
<u>Paid By</u>	<u>Amount</u>
APS	\$5,080.00
<u>Total Payment:</u>	<u>\$5,080.00</u>

PURCHASER:	_____	2-Sep-21	VENDOR:	_____
	Portobello Partnership	DATE		PER: Valecraft Homes Limited
			DATE:	_____

CONSTRUCTION SCHEDULING APPROVAL	
PER:	_____
DATE:	_____

Schedule "W4"
Granite & Variegated Quartz Colour Variation

Purchaser's name:	Portobello Partnership	Lot no:	B11	Plan #:	4M-1290
Purchaser's name:	Contact: Samar Merhi	Project:	DEERFIELD VILLAGE 2		
Home Phone:		Model:	105 Mann Std. W/O End		
Work Phone:	613-837-2754	Closing Date:	December 14th, 2021		
E-Mail (1):	design@valecraft.com	E-Mail (2):			

Valecraft Homes Ltd. continues to provide the best in class sales and service. We recognize the importance of your home to you, our valued customer.

Granite & Variegated Quartz countertops are an elegant addition to your home. However, there are some things of which you should be aware.

Due to the natural composition of **Granite**, inherent variations in texture, colour and consistency are to be expected and considered as normal.

During the process of manufacturing **Variegated Quartz** to achieve a more natural stone look, variations in the appearance between the sample & the slab are to be expected.

Valecraft Homes Limited strongly suggests that you attend an appointment with our granite/quartz supplier two to three months prior to closing to view the granite/variegated quartz slabs available in the colour you have already chosen. A representative from our supplier will contact you to set up a mutual date & time for the appointment.

I/we, Portobello Partnership
have read and fully understand the aforementioned recommendation set forth by the builder and as such hereby release VALECRAFT HOMES LIMITED from future responsibility with respect to a variation in colour of granite/ variegated quartz countertops.

<input checked="" type="checkbox"/>	We <u>accept</u> this opportunity
<input type="checkbox"/>	We <u>decline</u> this opportunity

Project:	DEERFIELD VILLAGE 2	LOT NO:	B11
<hr/>		<hr/>	
Purchaser		Date:	
<hr/>		<hr/>	
Purchaser		Date:	
<hr/>		<hr/>	
T. OLIVER		September 2, 2021	
Valecraft Homes Limited		Date:	
<hr/>		<hr/>	

Appointment date given:		Spoke with/left message:	
<hr/>		<hr/>	
Time scheduled:		Date & Time:	
<hr/>		<hr/>	

OPTIONAL KITCHEN CABINET CROWN MOULDING,
FILLER & **STANDARD** BULKHEAD DETAILS

UPC9-1B

Upgrade #: N/A

- Includes upgrade to 40" uppers with filler detail & valence on upper kitchen cabinetry. Raised approx. 2" to standard bulkhead.

26" D x 10" H

40" CABINETS

STANDARD BULKHEAD

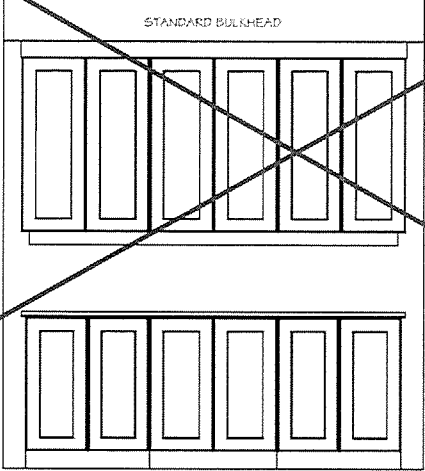

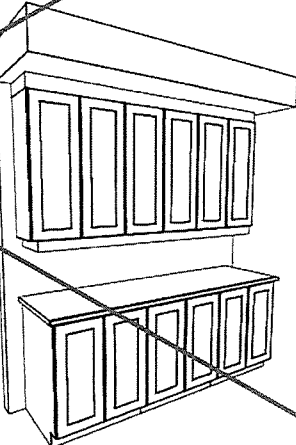

UPC9-2A

Upgrade #: 22

- Includes upgrade to 42" uppers with filler detail on upper kitchen cabinetry to standard bulkhead.

26" D x 10" H

42" CABINETS

STANDARD BULKHEAD

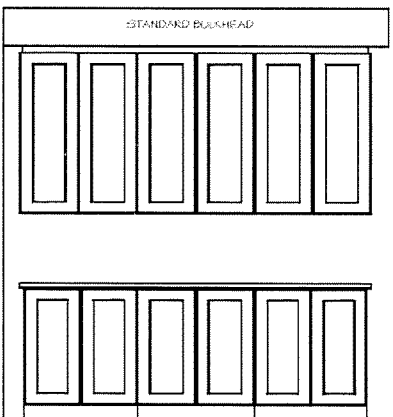

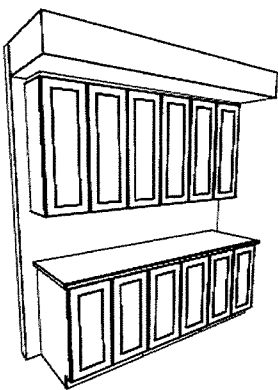

UPC9-3B

Upgrade #: N/A

- Includes upgrade to 40" uppers with crown moulding & filler detail on upper kitchen cabinetry to standard bulkhead.

26" D x 10" H

40" CABINETS

STANDARD BULKHEAD

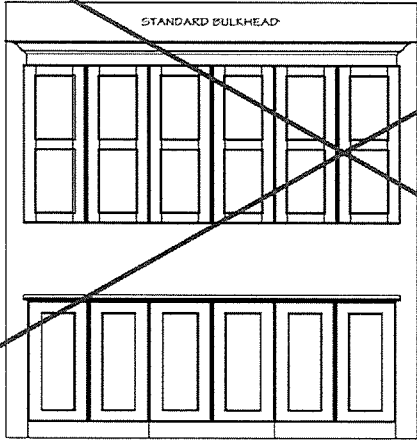

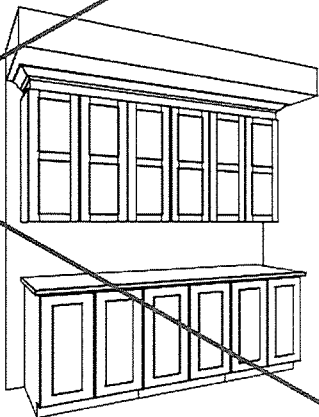

Site: DV2

Purchaser: Portobello Partnership

Plan No: 4M-1290

Lot: B11

Purchaser:

Date: August 31, 2021



Valecraft
Homes Ltd.

Standard Edge Profiles for Granite & Quartz

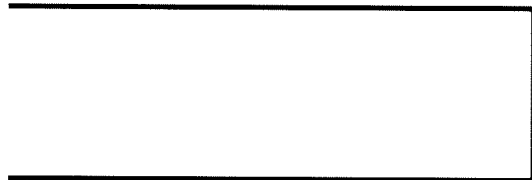

Eased Edge

#6, 49 Kitchen

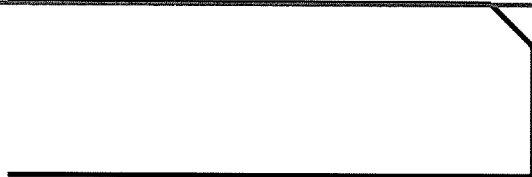

1/4 Bevel

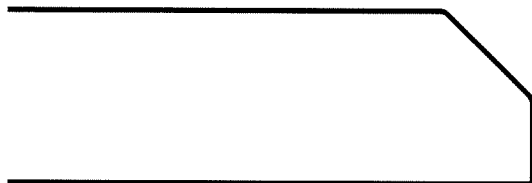

1/2 Bevel

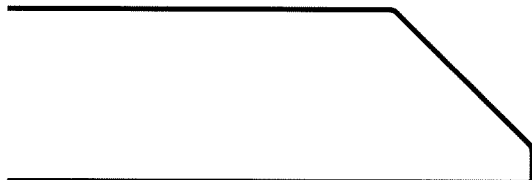

3/4 Bevel

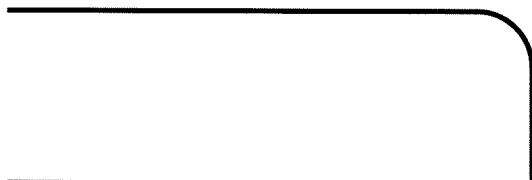

Pencil Top Only
with Square Bottom



Pencil Top and Bottom



1/2 Bullnose



Full Bullnose

Project: DV2

Purchaser: Portobello Partnership

Plan #: 4M-1290

Purchaser: _____

Lot: B11

Date: August 31, 2021

Model: 105 the Mann Std. W/O

Upgrade #: 6, 49

<div>  <div> <div>KITCHENS & CABINETS</div> <div>potvin</div> </div> </div>	BUILDER: VALECRAFT	PROJECT: DV2	<div> <div>LOT: DV2 B11</div> <div>Portobello Partnership</div> </div>
	REDESIGN NUMBER:	MODEL: 105 The Mann Std. W/O	
	DONE BY:	DATE: August 31, 2021	

****DIMENSIONS MAY VARY DEPENDING ON SITE MEASURES/CONDITIONS****

Kitchen Sketch

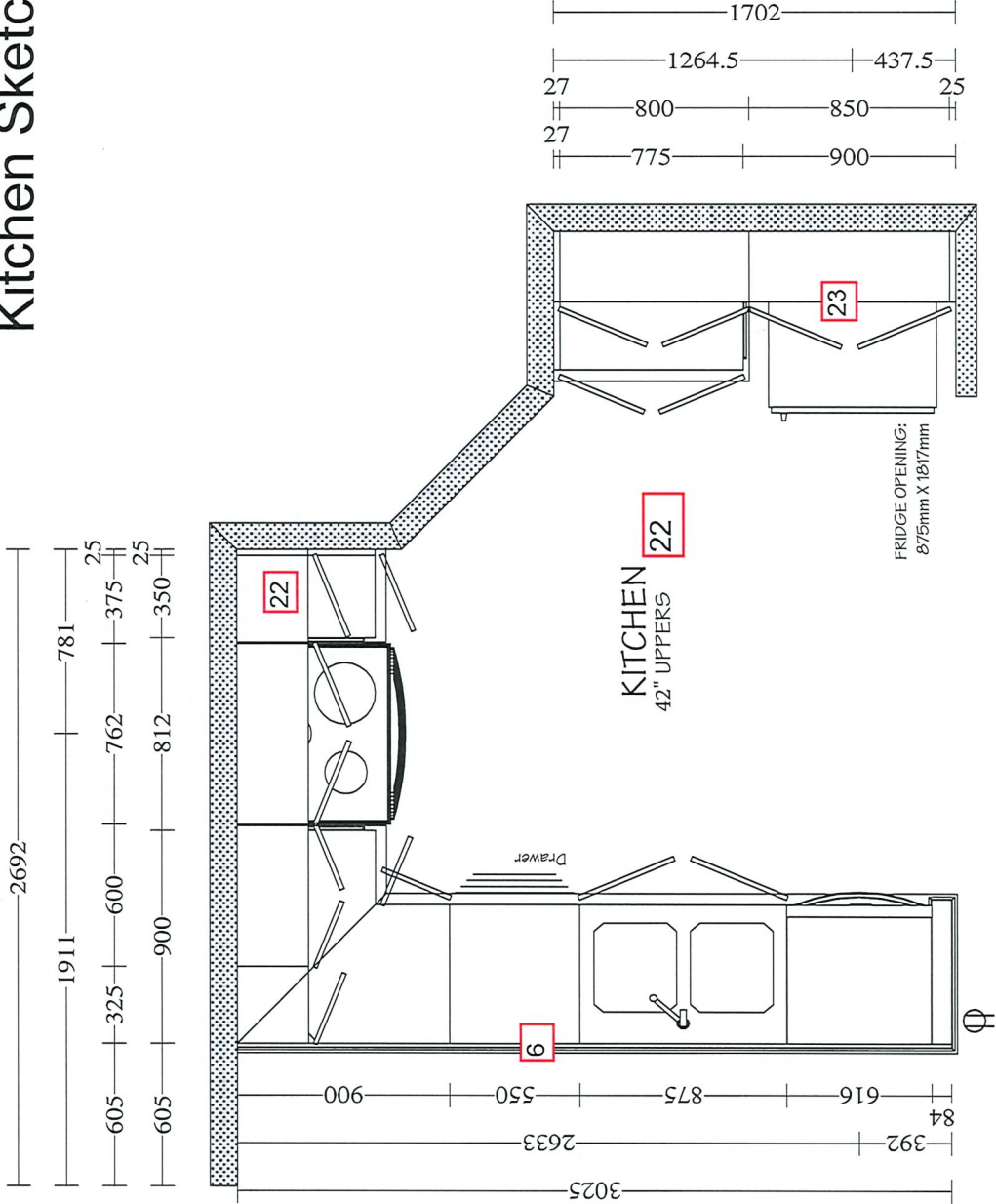



Tile Installation Options

WALL TILE

Vertical stacked

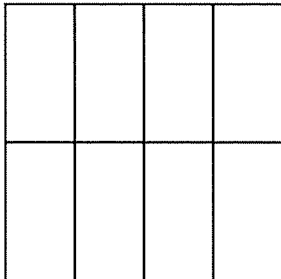

Horizontal stacked

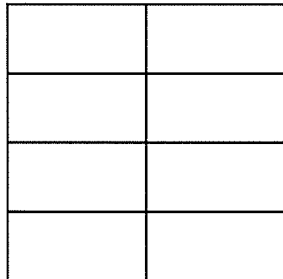

Main Bathroom
Wall/Tub Surround

Ensuite Bathroom
Shower Walls

Vertical 1/3 staggered

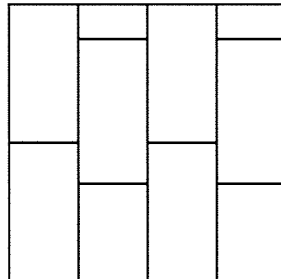

Horizontal 1/3 staggered

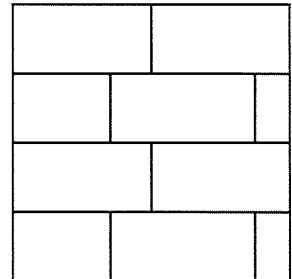

Kitchen Backsplash

Vertical brick

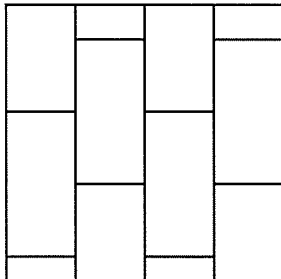

Horizontal brick

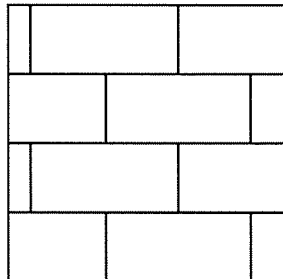

45 degree

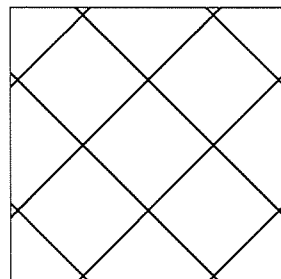

Standard square

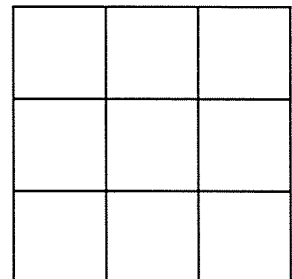

Project: DV2

Plan #: 4M-1290

Lot: B11

Model: 105 the Mann Std. W/O

Purchaser: Portobello Partnership

Purchaser: _____

Date: August 31, 2021

Upgrade #: 4, 24, 35, 36



THE MANN

MODEL 105

END UNIT

1599 sq.ft. (443 sq.ft. Basement)

Site: DV2

Plan No.: 4M-1290

Lot: B11

Date: August 31, 2021

Purchaser: Portobello Partnership

Purchaser:

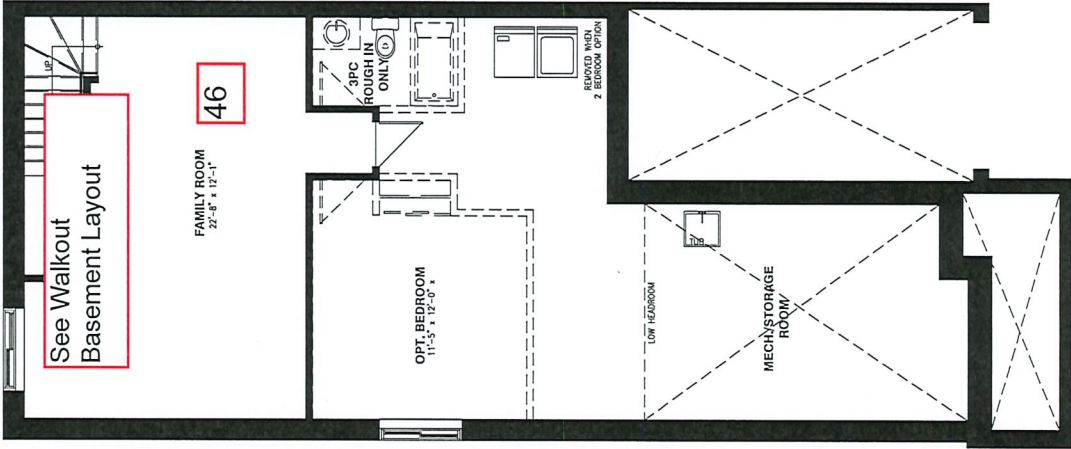

BASEMENT FLOOR

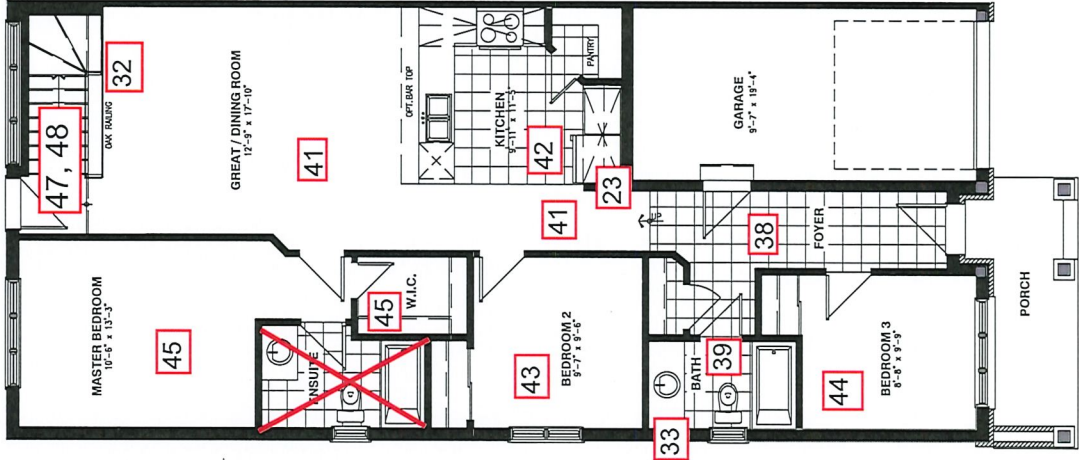

GROUND FLOOR
STANDARD 3 BEDROOM PLAN

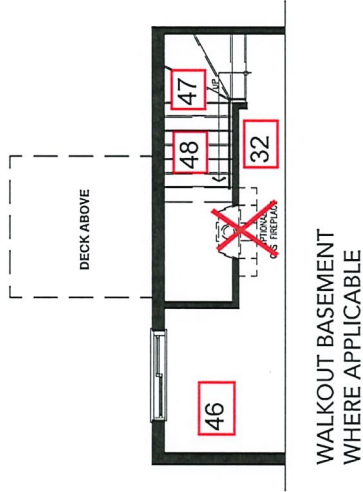

Schedule H

Vertical and/or horizontal bulkheads (chaseways) may be required to contain mechanical piping.
All dimensions are approximate. E. & O.E., plans, materials and specifications are subject to change without notice. Actual useable floor space may vary from the stated floor area. *Note: Number of steps varies due to site grading.



SINGLES AND TOWNS COLOUR CHART					
Community:	Deerfield Village 2	Reg'd Plan #:	4M-1290	Sales Rep:	N. Trudel
Lot No:	B11	Civic Address:	522 Fawn Valley Private		
Purchaser(s):	Portobello Partnership			Model Name/#:	105 Mann Std. W/O
Purchaser(s):				Closing Date:	14-Dec-21

INTERIOR FINISHES		
DESCRIPTION		STD/UPG #
TRIM STYLE	Standard Nivaga Baseboards and Casings	STD
DOOR STYLE	Standard Cambridge Style Passage Doors	STD
INTERIOR HARDWARE	Standard Satin Chrome	STD
INTERIOR LIGHTING PACKAGE	Roma Lighting Package	4, 14
BATHROOM ACCESSORIES	Infinity Series in Chrome	4
FIREPLACE MANTLE	N/A	N/A

INTERIOR HANDRAILS AND SPINDLES				
	WOOD	STYLE	STAIN/COLOUR	STD/UPG #
HANDRAIL	Red Oak	Colonial	SB 200	32, 41
BRACKET (if applicable)	Metal	Metal	Wrinkled Black	32
SPINDLES	Metal	Square	Wrinkled Black	32
POSTS	Red Oak	3-1/2" wide Modern with Cap	SB 200	32, 41
CASINGS	Red Oak	N/A	SB 200	32, 41
HARDWOOD STAIRCASE (WHERE APPLICABLE)	N/A	N/A	N/A	N/A

APPLIANCES				
TYPE	SIZE	STD/UPG #	APPLIANCE UPG LEVEL	STD/UPG #
RIDGE <i>Standard Minimum Opening is 33" (70.75")</i>	Standard Opening	STD	Basic Stainless Steel	16
RANGE	Standard Opening	STD	Basic Stainless Steel	16
DISHWASHER	Standard Opening	STD	Basic Stainless Steel	16
MICROWAVE/HOODFAN	Standard Opening	STD	OTR - Basic Stainless Steel	16
WASHING MACHINE/DRYER	Standard Opening	STD	Basic White with Top Load Washer	16

Purchaser's Signature(s) : _____

Date: _____

Purchaser's Signature(s) : _____

Date: _____

Approved By : _____

T. OLIVER

Date: August 31, 2021



SINGLES AND TOWNS COLOUR CHART					
Community:	Deerfield Village 2	Reg'd Plan #:	4M-1290	Sales Rep:	N. Trudel
Lot No:	B11	Civic Address:	522 Fawn Valley Private		
Purchaser(s):	Portobello Partnership			Model Name/#:	105 Mann Std. W/O
Purchaser(s):				Closing Date:	14-Dec-21

CABINETRY					
ROOM	SELECTION			LEVEL	STD/UPG #
KITCHEN	STYLE AND COLOUR	V202S 2164		STD	6, 22, 23
	HARDWARE CODE	POI-V53-096-ZM2	TYPE Pulls	UPG	26
	COUNTERTOP	Black pearl (Slab Viewing Required)	COUNTERTOP EDGE PROFILE Eased Edge	Granite Level 1	6, 49
MAIN BATHROOM	STYLE AND COLOUR	V202S 2164		STD	STD
	HARDWARE CODE	5923-900	TYPE Knobs	STD	STD
	COUNTERTOP	P353-BC	COUNTERTOP EDGE PROFILE Standard	UPG Laminate	33
1PCE ENSUITE BATHROOM C/W 2 SINKS	STYLE AND COLOUR	V202S 2164		STD	4
	HARDWARE CODE	5923-900	TYPE Knobs	STD	4
	COUNTERTOP	P353-BC	COUNTERTOP EDGE PROFILE Standard	UPG Laminate	4, 34
POWDER ROOM	STYLE AND COLOUR	N/A		N/A	N/A
	HARDWARE CODE	N/A	TYPE N/A	N/A	N/A
	COUNTERTOP	N/A	COUNTERTOP EDGE PROFILE N/A	N/A	N/A
BASEMENT BATHROOM	STYLE AND COLOUR	N/A		N/A	N/A
	HARDWARE CODE	N/A	TYPE N/A	N/A	N/A
	COUNTERTOP	N/A	COUNTERTOP EDGE PROFILE N/A	N/A	N/A
LAUNDRY ROOM	STYLE AND COLOUR	N/A		N/A	N/A
	HARDWARE CODE	N/A	TYPE N/A	N/A	N/A
	COUNTERTOP	N/A	COUNTERTOP EDGE PROFILE N/A	N/A	N/A

Purchaser's Signature(s) : _____

Date: _____

Purchaser's Signature(s) : _____

Date: _____

Approved By : _____

T. OLIVER

Date: August 31, 2021



SINGLES AND TOWNS COLOUR CHART					
Community:	Deerfield Village 2	Reg'd Plan #:	4M-1290	Sales Rep:	N. Trudel
Lot No:	B11	Civic Address:	522 Fawn Valley Private		
Purchaser(s):	Portobello Partnership			Model Name/#:	105 Mann Std. W/O
Purchaser(s):				Closing Date:	14-Dec-21

PAINT COLOUR(S)				
ROOM	MAIN COLOUR	STD/UPG #	ACCENT WALL	STD/UPG #
KITCHEN	Semi Gloss OC-117 simply white	STD	N/A	N/A
HALLWAY	Low Luster OC-30 Gray Mist	STD	N/A	N/A
POWDER ROOM	N/A	N/A	N/A	N/A
MAIN FLOOR HALLWAY	Low Luster OC-30 Gray Mist	STD	N/A	N/A
FAMILY ROOM	Low Luster OC-30 Gray Mist	STD	N/A	N/A
STUDY	N/A	N/A	N/A	N/A
GREAT ROOM	Low Luster OC-30 Gray Mist	STD	N/A	N/A
DINING ROOM	Low Luster OC-30 Gray Mist	STD	N/A	N/A
PORCH	N/A	N/A	N/A	N/A
KITCHEN/DINETTE/BREAKFAST	Semi Gloss OC-30 Gray Mist	STD	N/A	N/A
LAUNDRY/MUDROOM	N/A	N/A	N/A	N/A
SECOND FLOOR HALLWAY	N/A	N/A	N/A	N/A
MAIN BATH	Semi Gloss OC-30 Gray Mist	STD	N/A	N/A
BEDROOM #2	Low Luster OC-30 Gray Mist	STD	N/A	N/A
BEDROOM #3	Low Luster OC-30 Gray Mist	STD	N/A	N/A
BEDROOM #4	N/A	N/A	N/A	N/A
MASTER BEDROOM	Low Luster OC-30 Gray Mist	STD	N/A	N/A
MASTER BEDROOM WALK-IN CLOSET	Low Luster OC-30 Gray Mist	STD	N/A	N/A
MASTER BEDROOM ENSUITE	Semi Gloss OC-30 Gray Mist	STD	N/A	N/A
FINISHED BASEMENT RECREATION ROOM	N/A	N/A	N/A	N/A
BASEMENT BATHROOM	N/A	N/A	N/A	N/A

Purchaser's Signature(s) : _____

Date: _____

Purchaser's Signature(s) : _____

Date: _____

Approved By : _____

T. OLIVER

Date: August 31, 2021

Subject to change by Valecraft Homes in the event of unavailability of materials.
Prices, terms and specifications are subject to change without notice E/O.E
\\SALES\Sales Legal Docs\Site - Deerfield\Block B\B11\DV2 B11 Interior Colour Charts Aug 26-21.



SINGLES AND TOWNS COLOUR CHART					
Community:	Deerfield Village 2	Reg'd Plan #:	4M-1290	Sales Rep:	N. Trudel
Lot No:	B11	Civic Address:	522 Fawn Valley Private		
Purchaser(s):	Portobello Partnership			Model Name/#:	105 Mann Std. W/O
Purchaser(s):				Closing Date:	14-Dec-21

CERAMIC & GROUT SELECTIONS (1)					
ROOM	AREA	MANUFACTURER/SERIES/SIZE/ COLOUR/CODE	GROUT SELECTION	LEVEL	STD/UPG #
LOVER	FLOOR	See Flooring Selection Sheet	N/A	N/A	38
POWDER ROOM	FLOOR	N/A	N/A	N/A	N/A
	WALL	N/A	N/A	N/A	N/A
	INSERT OR BORDER	N/A			
LAUNDRY ROOM	FLOOR	N/A	N/A	N/A	N/A
	WALL	N/A	N/A	N/A	N/A
	INSERT OR BORDER	N/A			
BATH	FLOOR	N/A	N/A	N/A	N/A
	WALL	N/A	N/A	N/A	N/A
	INSERT OR BORDER	N/A			
KITCHEN	FLOOR	See Flooring Selection Sheet	N/A	N/A	42
	BACKSPLASH	Euro Pasha Soho 4"x16" Glossy Warm Grey (Horizontal 1/3 Staggered install)	949 Silverado	Gold Wall Tile + UPG Install + UPG Grout	24, 25
	INSERT OR BORDER	N/A			
BREAKFAST AREA/DINETTE	FLOOR	N/A	N/A	N/A	N/A
FIREPLACE	HEARTH	N/A	N/A	N/A	N/A
	SURROUND	N/A	N/A	N/A	N/A
ADDITIONAL FIREPLACE	HEARTH	N/A	N/A	N/A	N/A
	SURROUND	N/A	N/A	N/A	N/A

Purchaser's Signature(s) : _____ Date: _____

Purchaser's Signature(s) : _____ Date: _____

Approved By : _____ T. OLIVER Date: August 31, 2021



SINGLES AND TOWNS COLOUR CHART					
Community:	Deerfield Village 2	Reg'd Plan #:	4M-1290	Sales Rep:	N. Trudel
Lot No:	B11	Civic Address:	522 Fawn Valley Private		
Purchaser(s):	Portobello Partnership			Model Name/#:	105 Mann Std. W/O
Purchaser(s):				Closing Date:	14-Dec-21

CERAMIC & GROUT SELECTIONS (2)					
ROOM	AREA	MANUFACTURER/SERIES/SIZE/ COLOUR/CODE	GROUT SELECTION	LEVEL	STD/UPG #
MAIN BATHROOM	FLOOR	See Flooring Selection Sheet	N/A	N/A	39
	WALL	Ceratec Visuals Gaia 11.6" x 23.4" White (Horizontal stacked Install)	949 Silverado	Silver Floor Tile on Wall + UPG Grout	25, 35
	INSERT OR BORDER	N/A			
OTHER BATHROOM	FLOOR	N/A	N/A	N/A	N/A
	WALL	N/A	N/A	N/A	N/A
	INSERT OR BORDER	N/A			
PC ENSUITE BATHROOM C/W 2 SINKS	FLOOR	See Flooring Selection Sheet	N/A	N/A	40
	TUB DECK	N/A	N/A	N/A	N/A
	TUB BACKSPLASH	N/A	N/A	N/A	N/A
	SHOWER INSERT	N/A	N/A	N/A	N/A
	SHOWER WALL	Ceratec Visuals Gaia 11.6" x 23.4" White (Horizontal Stacked Install)	949 Silverado	Silver Floor Tile on Wall + UPG Grout	4, 25, 36
BASEMENT/OTHER BATHROOM	FLOOR	N/A	N/A	N/A	N/A
	WALL	N/A	N/A	N/A	N/A
	INSERT OR BORDER	N/A	N/A	N/A	N/A

Purchaser's Signature(s) : _____

Purchaser's Signature(s) : _____

Approved By : _____

Date: _____

Date: _____

Date: August 31, 2021



SINGLES AND TOWNS COLOUR CHART					
Community:	Deerfield Village 2	Reg'd Plan #:	4M-1290	Sales Rep:	N. Trudel
Lot No:	B11	Civic Address:	522 Fawn Valley Private		
Purchaser(s):	Portobello Partnership			Model Name/#:	105 Mann Std. W/O
Purchaser(s):				Closing Date:	14-Dec-21

FLOORING SELECTIONS			
ROOM	CARPET/UNDERPAD OR HARDWOOD	LEVEL	STD/UPG #
MAIN FLOOR HALLWAY	Torlys Everwood Premier EW23001 Beach House 4-7/8" Wide x 48-3/8" Long Plank (Front to back install)	Quote	41
FOYER	Torlys Everwood Premier EW23001 Beach House 4-7/8" Wide x 48-3/8" Long Plank (Front to back install)	Quote	38
STUDY	N/A	N/A	N/A
DINING ROOM	Torlys Everwood Premier EW23001 Beach House 4-7/8" Wide x 48-3/8" Long Plank (Front to back install)	Quote	41
GREAT ROOM	Torlys Everwood Premier EW23001 Beach House 4-7/8" Wide x 48-3/8" Long Plank (Front to back install)	Quote	41
FAMILY ROOM	Torlys Everwood Premier EW23001 Beach House 4-7/8" Wide x 48-3/8" Long Plank (Front to back install)	Quote	46
REAR HALLWAY	N/A	N/A	N/A
KITCHEN	Torlys Everwood Premier EW23001 Beach House 4-7/8" Wide x 48-3/8" Long Plank (Front to back install)	Quote	42
BREAKFAST AREA/DINETTE	N/A	N/A	N/A
MAIN STAIRS TO BASEMENT INCLUDING LANDING	Beaulieu Silex II Broadloom Carpet Pampa Beige 16320 + Upgraded Underpad	Quote Carpet + L1 Underpad	47, 48
UPPER HALLWAY	N/A	N/A	N/A
BEDROOM # 2	Torlys Everwood Premier EW23001 Beach House 4-7/8" Wide x 48-3/8" Long Plank (Front to back install)	Quote	43
BEDROOM # 3	Torlys Everwood Premier EW23001 Beach House 4-7/8" Wide x 48-3/8" Long Plank (Front to back install)	Quote	44
MAIN BATHROOM	Torlys Everwood Premier EW23001 Beach House 4-7/8" Wide x 48-3/8" Long Plank (Front to back install)	Quote	39
MASTER BEDROOM	Torlys Everwood Premier EW23001 Beach House 4-7/8" Wide x 48-3/8" Long Plank (Front to back install)	Quote	45
MASTER BEDROOM WALK-IN CLOSET	Torlys Everwood Premier EW23001 Beach House 4-7/8" Wide x 48-3/8" Long Plank (Front to back install)	Quote	45
WIPC ENSUITE BATHROOM C/W 2 SINKS	Torlys Everwood Premier EW23001 Beach House 4-7/8" Wide x 48-3/8" Long Plank (Front to back install)	Quote	4, 40
FINISHED BASEMENT RECREATION ROOM	N/A	N/A	

Purchaser's Signature(s) : _____

Date: _____

Purchaser's Signature(s) : _____

Date: _____

Approved By : _____

T. OLIVER

Date: August 31, 2021



SINGLES AND TOWNS COLOUR CHART					
Community:	Deerfield Village 2	Reg'd Plan #:	4M-1290	Sales Rep:	N. Trudel
Lot No:	B11	Civic Address:	522 Fawn Valley Private		
Purchaser(s):	Portobello Partnership			Model Name/#:	105 Mann Std. W/O
Purchaser(s):				Closing Date:	14-Dec-21

PLUMBING FIXTURES				
ROOM	FIXTURE	STYLE	FINISH	STD/UPG#
KITCHEN	SINK	Reginox Undermount Double Bowl ND1831UA/9	Stainless Steel	30
	FAUCET	Delta Single Handle Pull-Down Kitchen Faucet Marley 986LF-AR	Arctic Stainless	28
MAIN BATHROOM	SINK	Standard	White	STD
	VANITY FAUCET	Standard	Chrome	STD
	WATER CLOSET	Standard	White	STD
	TUB/SHOWER	Standard	White	STD
	TUB/SHOWER FAUCET	Standard	Chrome	STD
POWDER ENSUITE BATHROOM C/W 2 SINKS	SINKS	Standard	White	4
	VANITY FAUCETS	Standard	Chrome	4
	WATER CLOSET	Standard	White	4
	SHOWER	Standard w/ Zitta Niche 12 x 12 (Installed approx. centered on middle of longest shower wall with top at approx. 5ft from floor)	White/Chrome/Clear Glass/ Stainless Steel	4, 50
	SHOWER FAUCET	Standard	Chrome	4
	BATHTUB	N/A	N/A	N/A
	BATHTUB FAUCET	N/A	N/A	N/A
POWDER ROOM	PEDESTAL	N/A	N/A	N/A
	SINK FAUCET	N/A	N/A	N/A
	WATER CLOSET	N/A	N/A	N/A
BASEMENT BATHROOM	SINK	N/A	N/A	N/A
	VANITY FAUCET	N/A	N/A	N/A
	WATER CLOSET	N/A	N/A	N/A
	TUB/SHOWER	N/A	N/A	N/A
	TUB/SHOWER FAUCET	N/A	N/A	N/A

NOTE: All fixtures are white as standard

Purchaser's Signature(s) : _____Date: _____

Purchaser's Signature(s) : _____Date: _____

Approved By : T. OLIVER _____Date: August 31, 2021 _____