

Internal B1A

Deerfield 2 - Phase 2

PURCHASER: Portobello Partnership

Printed: 2-Sep-21 1:01 pm

LOT NUMBER	PHASE	HOUSE TYPE	CLOSING DATE
B10	2	110 THE THOMAS	9-Dec-21

ITEM	QTY	EXTRA / CHANGE	PRICE	INTERNAL USE
*16 90564  36164	1 -	- BONUS - APPLIANCES - 3 BASIC STAINLESS STEEL KITCHEN APPLIANCES INCLUDING MICROWAVE COMBO HOODFAN, AND BASIC TOP LOAD WHITE WASHER AND DRYER.  Note:	\$ 0.00	Each
17 88290  36165	1 -	- FLAT CEILING IN WHOLE HOUSE  Note: Includes Family Room in Basement	\$ 2,245.00	Each
18  36166	1 -	KITCHEN - DELETE ITEM # 5 IN B1A'S (RE: SUPPLY AND INSTALL GRANITE LEVEL 1 IN STANDARD KITCHEN C/W FLUSH BREAKFAST BAR).  Note:	-\$5,933.00	Each
19  36179	1 -	KITCHEN - SUPPLY AND INSTALL GRANITE LEVEL 2, IN STANDARD KITCHEN, C/W FLUSH BREAKFAST BAR, EASED EDGE DETAIL.  Note: As per countertop edge profile sketch and as per kitchen sketch and Schedule H dated August 31, 2021. See items # 33 and # 35 for sink and faucet.	\$ 6,840.00	Each
*20 88406  36520	3 -	KITCHEN - PANTRY - UPGRADE STANDARD 12IN DEEP PANTRY TO APPROX 2FT DEEP, BUILDER STANDARD CABINETRY, PER LINEAR FOOT  Note: As per kitchen sketch and Schedule H dated August 31, 2021.	*\$ 650.00	
21 87999  36188	1 -	KITCHEN - LOWER CABINETS - LC POTS & PANS C/W 3 DRAWER FRONTS 6/12/12  Note: In standard series cabinets, in standard kitchen, to be installed between refrigerator and range, as per kitchen sketch and Schedule H dated August 31, 2021.	\$ 704.00	Each
22  36167	1 -	KITCHEN - DELETE ITEM # 6 IN B1A'S (RE: UPGRADE KITCHEN CABINETRY TO LEVEL 1).  Note:	-\$2,587.00	Each
23  36168	1 -	GREAT ROOM - DELETE ITEM # 7 IN B1A'S (RE: OAK MODERN 3 1/2" BEVELED POSTS, CONTEMPORARY HANDRAILS & GUNN METAL SQUARE METAL SPINDLES IN LIEU OF THE HALF WALL ON THE STAIRS ADJACENT TO GREAT ROOM C/W OPEN STRINGERS).  Note:	-\$2,554.00	Each
24  36230	1 -	GREAT ROOM - SUPPLY AND INSTALL OAK MODERN 3 1/2" WIDE POSTS WITH CAP, CONTEMPORARY HANDRAILS & GUNN METAL GREY SQUARE SPINDLES, IN LIEU OF THE HALF WALL ON THE STAIRS ADJACENT TO GREAT ROOM C/W OPEN STRINGERS).  Note: As per Schedule H dated August 31, 2021.	\$ 2,491.00	Each
25  36169	1 -	- DELETE ITEM # 8 IN B1A'S (RE: OAK MODERN 3 1/2" BEVELED POSTS, CONTEMPORARY HANDRAILS & GUNN METAL SQUARE METAL SPINDLES IN STANDARD AREAS).  Note:	-\$1,670.00	Each
26  36231	1 -	- SUPPLY AND INSTALL OAK MODERN 3 1/2" WIDE POSTS WITH CAP, CONTEMPORARY HANDRAILS & GUNN METAL GREY SQUARE SPINDLES, C/W METAL BRACKETS, IN ALL STANDARD AREAS.  Note: To be installed in all Standard areas in lieu of standard railings, as per Schedule H dated August 31, 2021.	\$ 3,309.00	Each
27  36170	1 -	UPPER HALL - DELETE ITEM # 9 IN B1A'S (RE: OAK MODERN 3 1/2" BEVELED POSTS, CONTEMPORARY HANDRAILS & GUNN METAL SQUARE METAL SPINDLES IN LIEU OF THE HALF WALL IN THE SECOND FLOOR HALLWAY).  Note:	-\$3,744.00	Each

Internal B1A

Deerfield 2 - Phase 2

PURCHASER: Portobello Partnership

Printed: 2-Sep-21 1:01 pm

LOT NUMBER		PHASE	HOUSE TYPE	CLOSING DATE
B10		2	110 THE THOMAS	9-Dec-21
ITEM	QTY	EXTRA / CHANGE	PRICE	INTERNAL USE
28		1 - UPPER HALL - SUPPLY AND INSTALL OAK MODERN 3 1/2" WIDE POSTS WITH CAP, CONTEMPORARY HANDRAILS & GUNN METAL GREY SQUARE SPINDLES, IN LIEU OF THE HALF WALL IN THE SECOND FLOOR HALLWAY.	\$ 3,416.00	Each
36232		Note: As per Schedule H dated August 31, 2021.		
29		1 - - DELETE ITEM # 10 IN B1A'S (RE: SUPPLY AND INSTALL OAK STAIRCASE WITH VENEERED RISERS & STRINGERS AND SOLID THREADS, PER STAIRCASE, IN LIEU OF STANDARD STAIRCASE FROM MAIN FLOOR TO SECOND LEVEL).	-\$6,078.00	Each
36171		Note:		
30		1 - KITCHEN - DELETE ITEM # 11 IN B1A'S (RE: UPC9-2A LEVEL 1 CABINETY STANDARD LAYOUT. INCLUDES UPGRADE TO 42"IN UPPERS WITH FILLER DETAIL ON UPPER KITCHEN CABINETY TO STANDARD BULKHEAD).	-\$626.00	Each
36172		Note:		
*31		1 - KITCHEN - CABINETY - UPC9-2A - BUILDERS STANDARD CABINETY - STANDARD LAYOUT. INCLUDES UPGRADE TO 42IN UPPERS WITH FILLER DETAIL ON UPPER KITCHEN CABINETY TO STANDARD BULKHEAD	*\$ 471.00	Each
103633		Note: As per UPC Sketch and kitchen sketch dated August 31, 2021. Purchaser Acknowledges and accepts that Upper Kitchen cabinetry upgraded wood doors will have center style.		
36180				
32		1 - KITCHEN - DELETE ITEM #12 IN B1A'S (RE: FRANKE CUBE CUX110-30-CA SINGLE BOWL STAINLESS STEEL 9" DEEP UNDERMOUNT SINK).	-\$855.00	Each
36175		Note:		
33		1 - KITCHEN - KITCHEN SINK - REGINOX ND1831UA/9 DOUBLE BOWL UNDERMOUNT SINK	\$ 143.00	Each
88544		Note: See item # 19 for solid surface countertops and see item # 35 for faucet.		
36202				
34		1 - KITCHEN - DELETE ITEM #13 IN B1A'S (RE: DELTA ESSA 9113-AR-DST ARCTIC STAINLESS SINGLE HANDLE PULL DOWN KITCHEN FAUCET).	-\$456.00	Each
36176		Note:		
*35		1 - KITCHEN - KITCHEN FAUCET - DELTA MARLEY 986LF - AR ARCTIC STAINLESS	*\$ 357.00	Each
88428		Note: See item # 19 for solid surface countertops and see item # 33 for sink.		
36203				
36		1 - KITCHEN - SUPPLY AND INSTALL CABINETY HARDWARE POI-R20004-160-PC-BSN IN STANDARD KITCHEN CABINETS, INCLUDING 3 POTS & PANS DRAWERS.	\$ 588.00	Each
36189		Note: - See Item 21 (Pot and Pans Drawers). -Standard Kitchen Layout		
37		1 - MAIN BATHROOM - SUPPLY AND INSTALL CABINETY HARDWARE POI-R20004-160-PC-BSN IN MAIN BATHROOM.	\$ 42.00	Each
36190		Note:		
38		1 - ENSUITE BATH - SUPPLY AND INSTALL CABINETY HARDWARE POI-R20004-160-PC-BSN IN 4 PCE ENSUITE BATHROOM CABINETS.	\$ 84.00	Each
36199		Note: - See Item 4 (4PC Ensuite Bathroom Layout)		
39		2 - - CERAMIC TILE - GROUT COLOR PER COLOUR	\$ 150.00	
88508		Note:		
36206				

Vendor Initials: \_\_\_\_\_ Purchaser Initials: \_\_\_\_\_

PREPARED BY: Nicole Trudel

CHECKED BY: Tricia Oliver

FILE # 1.680-2

Source: SQL.rpt 01sept21

CONSTRUCTION SCHEDULING APPROVAL

PER: \_\_\_\_\_

DATE: \_\_\_\_\_

Internal B1A

Deerfield 2 - Phase 2

PURCHASER: Portobello Partnership

Printed: 2-Sep-21 1:01 pm

LOT NUMBER B10		PHASE 2	HOUSE TYPE 110 THE THOMAS	CLOSING DATE 9-Dec-21	
ITEM	QTY	EXTRA / CHANGE		PRICE	INTERNAL USE
40		1 - <i>KITCHEN</i> - SUPPLY AND INSTALL GOLD LEVEL BACKSPLASH, HORIZONTAL 1/3 STAGGERED INSTALL, IN STANDARD KITCHEN LAYOUT.		\$ 223.00	Each
36207		Note: As per wall tile installation sketch dated August 31, 2021.			
41		1 - <i>ENSUITE BATH</i> - TILE - WALL - UPGRADE - FLOOR TILE IN LIEU OF WALL - SILVER - - APPROXIMATELY 5 FOOT x 3 FOOT CERAMIC SHOWER - SILVER		\$ 1,024.00	Each
140					
36208		Note: In 4 Pce Ensuite bathroom shower, as per wall tile installation sketch dated August 31, 2021. --See Item 4 (4PC Ensuite Bathroom Layout)			
42		1 - <i>ENSUITE BATH</i> - TILE - WALL - UPGRADE - FLOOR TILE IN LIEU OF WALL - SILVER - - TUB SURROUND - ENSUITE BATHROOM - OPTIONAL (20) - SILVER		\$ 377.00	Each
140					
36209		Note: Includes tub deck and tub backsplash in 4 Pce Ensuite bathroom, As per wall tile installation sketch dated August 31, 2021. --See Item 4 (4PC Ensuite Bathroom Layout)			
43		1 - <i>MAIN BATHROOM</i> - TILE - WALL - UPGRADE - FLOOR TILE IN LIEU OF WALL - SILVER - MAIN BATHROOM - SILVER		\$ 857.00	Each
140					
36210		Note: To be installed in Main bathroom, as per wall tile installation sketch dated August 31, 2021.			
44		1 - - SUPPLY AND INSTALL QUOTE LEVEL CARPET BEAULIEU SILEX II BROADLOOM CARPET PAMPA BEIGE 16320, IN STAIRS TO SECOND LEVEL.		\$ 1,500.00	Each
36214		Note: As per Schedule H dated August 31, 2021.			
45		1 - - SUPPLY AND INSTALL QUOTE LEVEL CARPET BEAULIEU SILEX II BROADLOOM CARPET PAMPA BEIGE 16320, IN STAIRS TO BASEMENT.		\$ 1,500.00	Each
36215		Note: As per Schedule H dated August 31, 2021.			
*46		*1 - - UNDERPAD - UPGRADE - LEVEL 1 - - UPPER STAIRCASE - LEVEL 1		*\$ 107.00	Each
107					
36338		Note: As per Schedule H dated August 31, 2021			
*47		*1 - - UNDERPAD - UPGRADE - LEVEL 1 - - BASEMENT STAIRCASE - LEVEL 1		*\$ 93.00	Each
107					
36337		Note: As per Schedule H dated August 31, 2021			
48		1 - <i>FOYER</i> - SUPPLY AND INSTALL TORLYS EVERTILE PREMIER ET24001 CLIFF ISLAND 11-1/2" WIDE x 23-5/8" LONG, FRONT TO BACK 1/2 BRICK INSTALL.		\$ 190.00	Each
36218		Note: To be installed in Foyer and Powder Room, as per floor tile installation sketch and as per Schedule H dated August 31, 2021.			
49		1 - <i>LAUNDRY ROOM</i> - SUPPLY AND INSTALL TORLYS EVERWOOD PREMIER EW23024 SIERRA 4-7/8" WIDE x 48-3/8" LONG PLANK, FRONT TO BACK INSTALL.		\$ 0.00	Each
36219		Note: To be installed in Laundry closet, as per Schedule H dated August 31, 2021.			
50		1 - <i>KITCHEN/DINETTE</i> - SUPPLY AND INSTALL TORLYS EVERWOOD PREMIER EW23024 SIERRA 4-7/8" WIDE x 48-3/8" LONG PLANK, FRONT TO BACK INSTALL.		\$ 278.00	Each
36220		Note: To be installed in Kitchen and Dinette, as per Schedule H dated August 31, 2021.			
51		1 - <i>GREAT ROOM</i> - SUPPLY AND INSTALL TORLYS EVERWOOD PREMIER EW23024 SIERRA 4-7/8" WIDE x 48-3/8" LONG PLANK, FRONT TO BACK INSTALL.		\$ 0.00	Each
36221		Note: To be installed in Great Room, Dining Room, Lower hallway and Upper hallway (all standard areas), as per Schedule H dated August 31, 2021.			

Vendor Initials: \_\_\_\_\_

Purchaser Initials: \_\_\_\_\_

PREPARED BY: Nicole Trudel

CHECKED BY: Tricia Oliver

E 1,680-3

voiceSQL.rpt 01sept21

CONSTRUCTION SCHEDULING APPROVAL

PER: \_\_\_\_\_

DATE: \_\_\_\_\_

Internal B1A

Deerfield 2 - Phase 2

PURCHASER: Portobello Partnership

Printed: 2-Sep-21 1:01 pm

LOT NUMBER		PHASE	HOUSE TYPE	CLOSING DATE	
B10		2	110 THE THOMAS	9-Dec-21	
ITEM	QTY	EXTRA / CHANGE		PRICE	INTERNAL USE
52		1 - BASEMENT - SUPPLY AND INSTALL TORLYS EVERWOOD PREMIER EW23024 SIERRA 4-7/8" WIDE x 48-3/8" LONG PLANK, FRONT TO BACK INSTALL.		\$ 3,458.00	Each
36222		Note: To be installed in Family Room, as per Schedule H dated August 31, 2021.			
53		1 - BEDROOM 2 - SUPPLY AND INSTALL TORLYS EVERWOOD PREMIER EW23024 SIERRA 4-7/8" WIDE x 48-3/8" LONG PLANK, FRONT TO BACK INSTALL.		\$ 2,157.00	Each
36223		Note: To be installed in Bedroom #2, as per Schedule H dated August 31, 2021.			
54		1 - BEDROOM 3 - SUPPLY AND INSTALL TORLYS EVERWOOD PREMIER EW23024 SIERRA 4-7/8" WIDE x 48-3/8" LONG PLANK, FRONT TO BACK INSTALL.		\$ 1,658.00	Each
36224		Note: To be installed in Bedroom #3, as per Schedule H dated August 31, 2021.			
55		1 - MASTER BEDROOM - SUPPLY AND INSTALL TORLYS EVERWOOD PREMIER EW23024 SIERRA 4-7/8" WIDE x 48-3/8" LONG PLANK, FRONT TO BACK INSTALL.		\$ 3,086.00	Each
36225		Note: To be installed in Master Bedroom and WIC, as per Schedule H dated August 31, 2021.			
56		1 - MAIN BATHROOM - SUPPLY AND INSTALL TORLYS EVERTILE PREMIER ET24013 CALCATTA 11-1/2" WIDE x 23-5/8" LONG, SIDE TO SIDE 1/2 BRICK INSTALL.		\$ 0.00	Each
36227		Note: Top be installed in Main bathroom, as per floor tile Sketch and Schedule H dated August 31, 2021.			
57		1 - ENSUITE BATH - SUPPLY AND INSTALL TORLYS EVERTILE PREMIER ET24013 CALCATTA 11-1/2" WIDE x 23-5/8" LONG, SIDE TO SIDE 1/2 BRICK INSTALL.		\$ 47.00	Each
36228		Note: To be installed in 4 Pce Ensuite bathroom, as per Floor tile Sketch and Schedule H dated August 31, 2021.			
58 88441		1 - ENSUITE BATH - BATHROOMS - ZITTA NICHE 12X12 STAINLESS STEEL		\$ 447.00	Each
36229		Note: To be installed on small shower wall opposite to shower head approximately centered, 5 ft from shower base in 4 Pce ensuite bathroom shower, as per Schedule H dated August 31, 2021. -See Item 4 (4 PC Ensuite Bathroom Layout)			
59 90835		1 - KITCHEN - CABINETRY - EXTEND FRIDGE UPPER TO APPROX. 2FT DEEP (ALL SERIES)		\$ 187.00	Each
36272		Note: In standard series cabinets, in standard kitchen layout, as per kitchen sketch and Schedule H dated August 31, 2021.			

Sub Total	\$14,176.00
HST	\$0.00
Total	\$14,176.00

Vendor Initials: \_\_\_\_\_ Purchaser Initials: \_\_\_\_\_

PREPARED BY: Nicole Trudel

CHECKED BY: Tricia Oliver

1.680-4

01SQL.rpt 01sept21

CONSTRUCTION SCHEDULING APPROVAL

PER: \_\_\_\_\_

DATE: \_\_\_\_\_

Internal B1A

Deerfield 2 - Phase 2

PURCHASER: Portobello Partnership

Printed: 2-Sep-21 1:01 pm

LOT NUMBER	PHASE	HOUSE TYPE	CLOSING DATE
B10	2	110 THE THOMAS	9-Dec-21

ITEM	QTY	EXTRA / CHANGE	PRICE	INTERNAL USE
------	-----	----------------	-------	--------------

Payment Summary	
<u>Paid By</u>	<u>Amount</u>
APS	\$14,176.00
<u>Total Payment:</u>	<u>\$14,176.00</u>

PURCHASER: 

Portobello Partnership

2-Sep-21  
DATE

VENDOR: 

PER: Valecraft Homes Limited

DATE:

PREPARED BY: Nicole Trudel

CHECKED BY: Tricia Oliver

CONSTRUCTION SCHEDULING APPROVAL

PER: \_\_\_\_\_

DATE: \_\_\_\_\_

Schedule "W4"  
Granite & Variegated Quartz Colour Variation

Purchaser's name:	<u>Portobello Partnership</u>	Lot no:	<u>B10</u>	Plan #:	<u>4M-1290</u>
Purchaser's name:	<u>Contact: Samar Mehri</u>	Project:	<u>DEERFIELD VILLAGE 2</u>		
Home Phone:	<u></u>	Model:	<u>110 Thomas Rev. W/O</u>		
Work Phone:	<u>613-837-2754</u>	Closing Date:	<u></u>		
E-Mail (1):	<u>design@valecraft.com</u>	E-Mail (2):	<u></u>		

Valecraft Homes Ltd. continues to provide the best in class sales and service. We recognize the importance of your home to you, our valued customer.

Granite & Variegated Quartz countertops are an elegant addition to your home. However, there are some things of which you should be aware.

Due to the natural composition of **Granite**, inherent variations in texture, colour and consistency are to be expected and considered as normal.

During the process of manufacturing **Variegated Quartz** to achieve a more natural stone look, variations in the appearance between the sample & the slab are to be expected.

Valecraft Homes Limited strongly suggests that you attend an appointment with our granite/quartz supplier two to three months prior to closing to view the granite/variegated quartz slabs available in the colour you have already chosen. A representative from our supplier will contact you to set up a mutual date & time for the appointment.

I/we, Portobello Partnership  
have read and fully understand the aforementioned recommendation set forth by the builder and as such hereby release VALECRAFT HOMES LIMITED from future responsibility with respect to a variation in colour of granite/ variegated quartz countertops.

<input checked="" type="checkbox"/>	We <u>accept</u> this opportunity
<input type="checkbox"/>	We <u>decline</u> this opportunity

<b>Project:</b>	<u>DEERFIELD VILLAGE 2</u>	<b>LOT NO:</b>	<u>B10</u>
<b>Purchaser</b>	<u></u>	<b>Date:</b>	<u></u>
<b>Purchaser</b>	<u></u>	<b>Date:</b>	<u></u>
<u>T. Oliver</u>	<u></u>	<u>August 31, 2021</u>	<u></u>
<b>Valecraft Homes Limited</b>	<u></u>	<b>Date:</b>	<u></u>

Appointment date given:	<u></u>	Spoke with/left message:	<u></u>
Time scheduled:	<u></u>	Date & Time:	<u></u>



Valecraft  
Homes Ltd.

## Standard Edge Profiles for Granite & Quartz

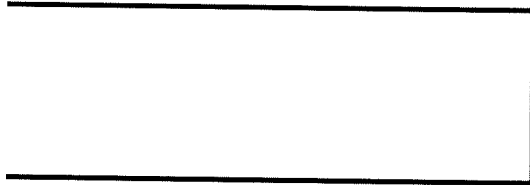

Eased Edge

#19 Kitchen

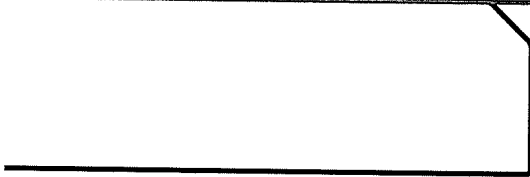

1/4 Bevel

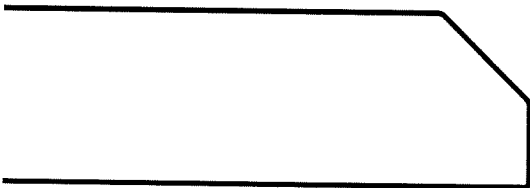

1/2 Bevel

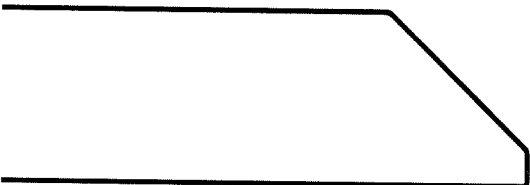

3/4 Bevel

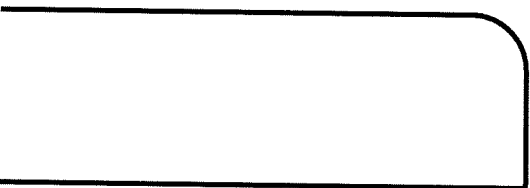

Pencil Top Only  
with Square Bottom

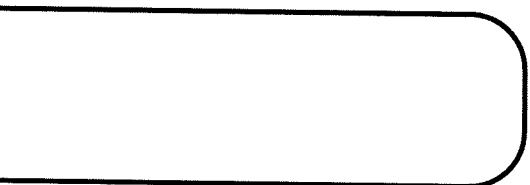

Pencil Top and Bottom

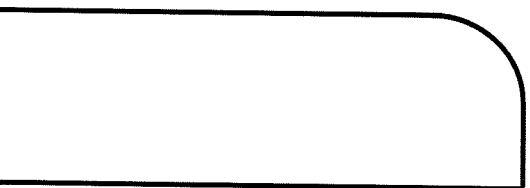

1/2 Bullnose

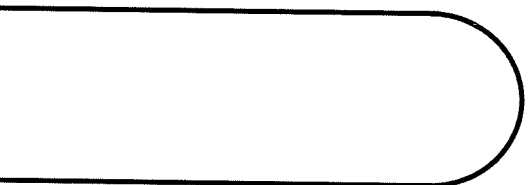

Full Bullnose

Project: DV2

Purchaser: Portobello Partnership

Plan #: 4M-1290

Purchaser: \_\_\_\_\_

Lot: B10

Date: August 31, 2021

Model: 110 the Thomas Rev. W/O

Upgrade #: 19

# OPTIONAL KITCHEN CABINET CROWN MOULDING, FILLER & **STANDARD** BULKHEAD DETAILS

## ~~UPC9-1B Upgrade #: N/A~~

- Includes upgrade to 40" uppers with filler detail & valence on upper kitchen cabinetry. Raised approx. 2" to standard bulkhead.

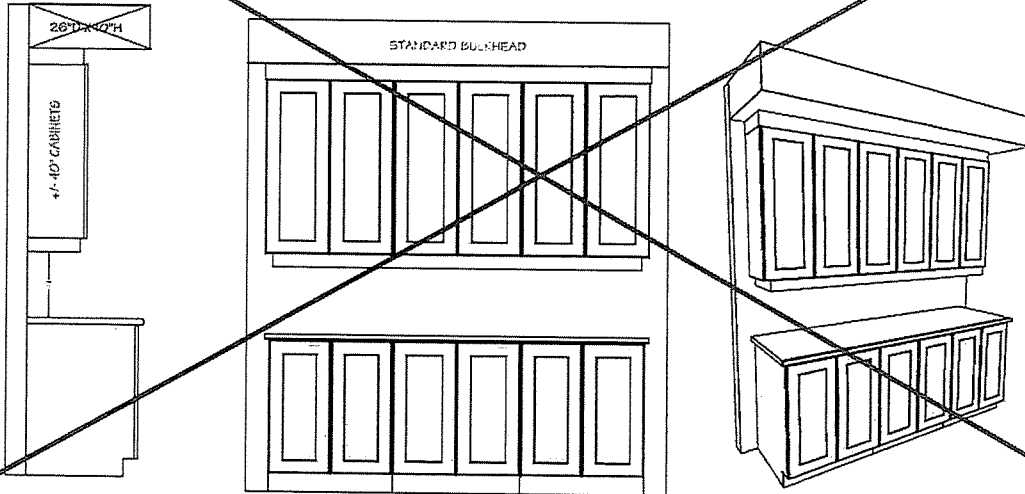

## UPC9-2A Upgrade #: 31

- Includes upgrade to 42" uppers with filler detail on upper kitchen cabinetry to standard bulkhead.

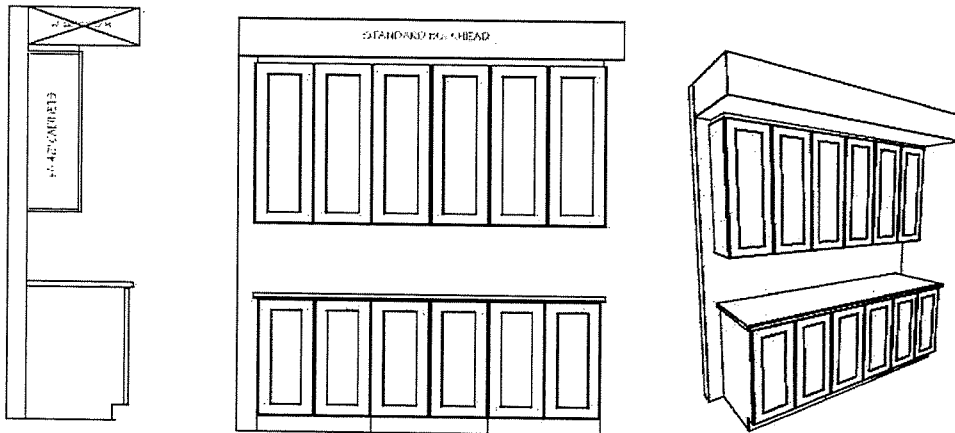

## ~~UPC9-3B Upgrade #: N/A~~

- Includes upgrade to 40" uppers with crown moulding & filler detail on upper kitchen cabinetry to standard bulkhead.

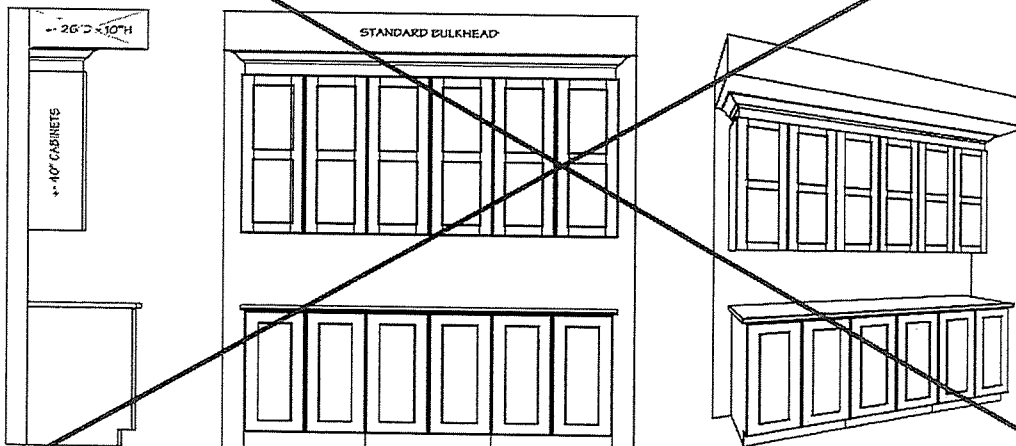

Site: DV2

Purchaser: Portobello Partnership

Plan No: 4M-1290

Lot: B10

Purchaser:

Date: August 31, 2021





## Tile Installation Options

### WALL TILE

Vertical stacked

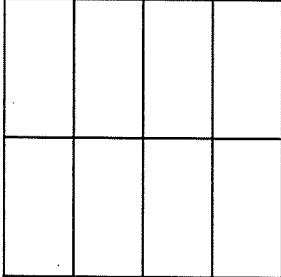

\_\_\_\_\_

\_\_\_\_\_

\_\_\_\_\_

Horizontal stacked

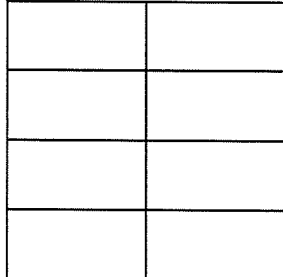

Main Bathroom  
Wall/Tub Surround  
~~Ensuite Bathroom Tub~~  
Deck & Tub  
Backsplash, Ensuite  
Shower Walls

Horizontal 1/3 staggered

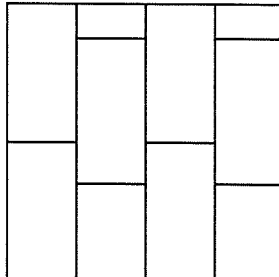

\_\_\_\_\_

\_\_\_\_\_

\_\_\_\_\_

Horizontal 1/3 staggered

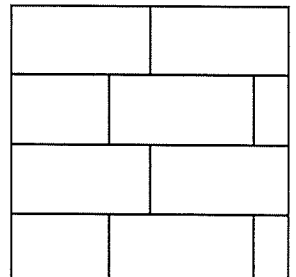

Kitchen Backsplash

\_\_\_\_\_

\_\_\_\_\_

Vertical brick

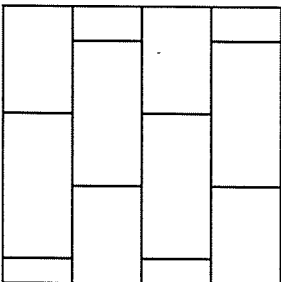

\_\_\_\_\_

\_\_\_\_\_

\_\_\_\_\_

Horizontal brick

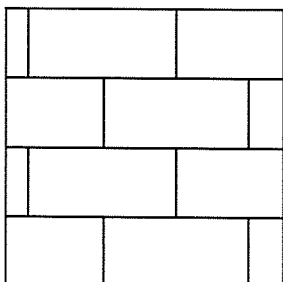

\_\_\_\_\_

\_\_\_\_\_

\_\_\_\_\_

45 degree

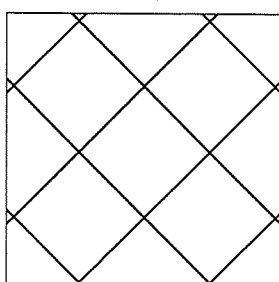

\_\_\_\_\_

\_\_\_\_\_

\_\_\_\_\_

Standard square

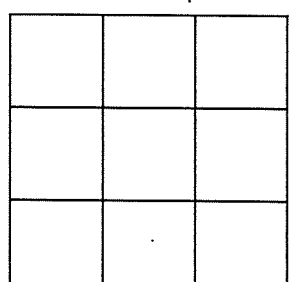

\_\_\_\_\_

\_\_\_\_\_

\_\_\_\_\_

Project: DV2

Plan #: 4M-1290

Lot: B10

Model: 110 The Thomas Rev. W/O

Purchaser: Portobello Partnership

Purchaser: \_\_\_\_\_

Date: August 31, 2021

Upgrade #: 4, 40, 41, 42, 43



Valecraft  
Homes Ltd.

## Tile Installation Options

### FLOOR TILE

Standard square

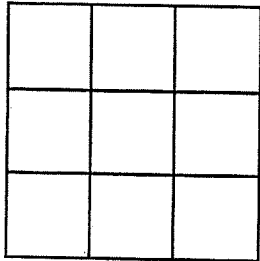

Square brick

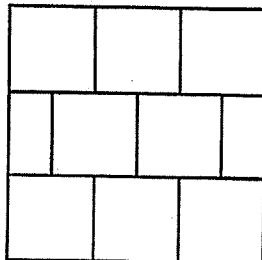

Rectangular  
front to back of the house

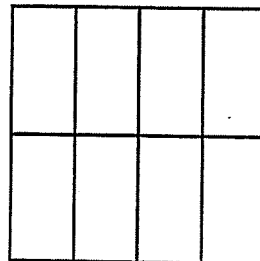

Rectangular  
side to side of the house

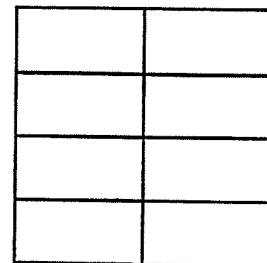

1/2 brick front to back  
of the house

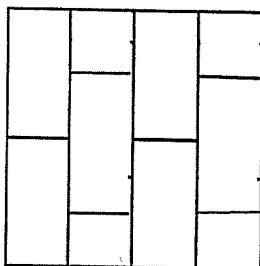

Foyer & Powder Room

Rectangular 1/3 staggered  
side to side of the house

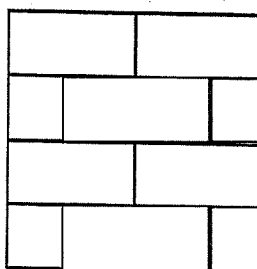

Main Bathroom  
4Pce Ensuite Bathroom

45 degree

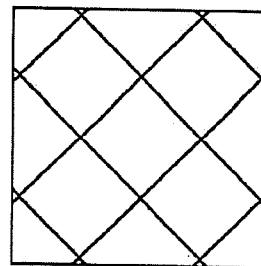

Project: DV2

Plan #: 4M-1290

Lot: B10

Model: 110 The Thomas Rev. W/O

Purchaser: Portobello Partnership

Purchaser: \_\_\_\_\_

Date: August 31, 2021

Upgrade #: 4, 48, 56, 57

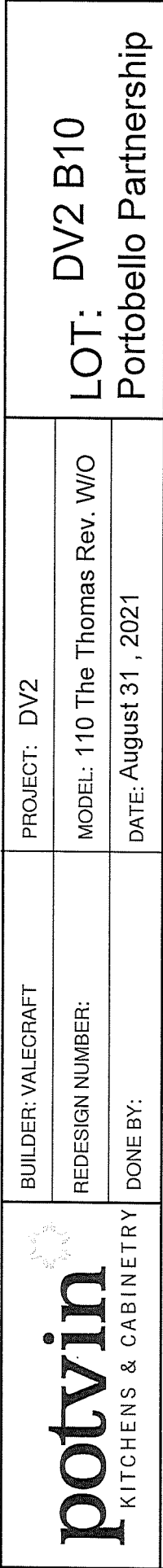

**\*\*DIMENSIONS MAY VARY DEPENDING ON SITE MEASURES/CONDITIONS\*\***

### Kitchen Sketch

The sketch illustrates a kitchen layout with the following dimensions and components:

- Overall Dimensions:**
  - Total width: 3887
  - Total depth: 3291
- Component Labels and Dimensions:**
  - 20:** Cabinet section on the left, width 650.
  - 31:** Kitchen 42" Uppers, width 1220.
  - 21:** Cabinet section in the middle, width 800.
  - 59:** Cabinet section on the right, width 850.
  - 19:** Cabinet section on the far right, width 900.
- Appliances and Features:**
  - FRIDGE OPENING:** 875mm X 1817mm
  - Drawer:** Located under the 20 cabinet section.
  - ALIGN:** Indicated by a dashed line across the top of the layout.
- Additional Measurements:**
  - 1831 (width of the leftmost section)
  - 762 (width of the middle section)
  - 812 (width of the rightmost section)
  - 437.5 (depth of the upper cabinets)
  - 25 (depth of the lower cabinets)
  - 750 (width of the section between 20 and 21)
  - 750 (width of the section between 21 and 59)
  - 425 (width of the section between 20 and 31)
  - 616 (width of the section between 31 and 21)
  - 900 (width of the section between 21 and 19)
  - 450 (width of the section between 19 and the right edge)
  - 733 (width of the section between 20 and 19)
  - 2558 (width of the section between 31 and 19)

# Kitchen Sketch

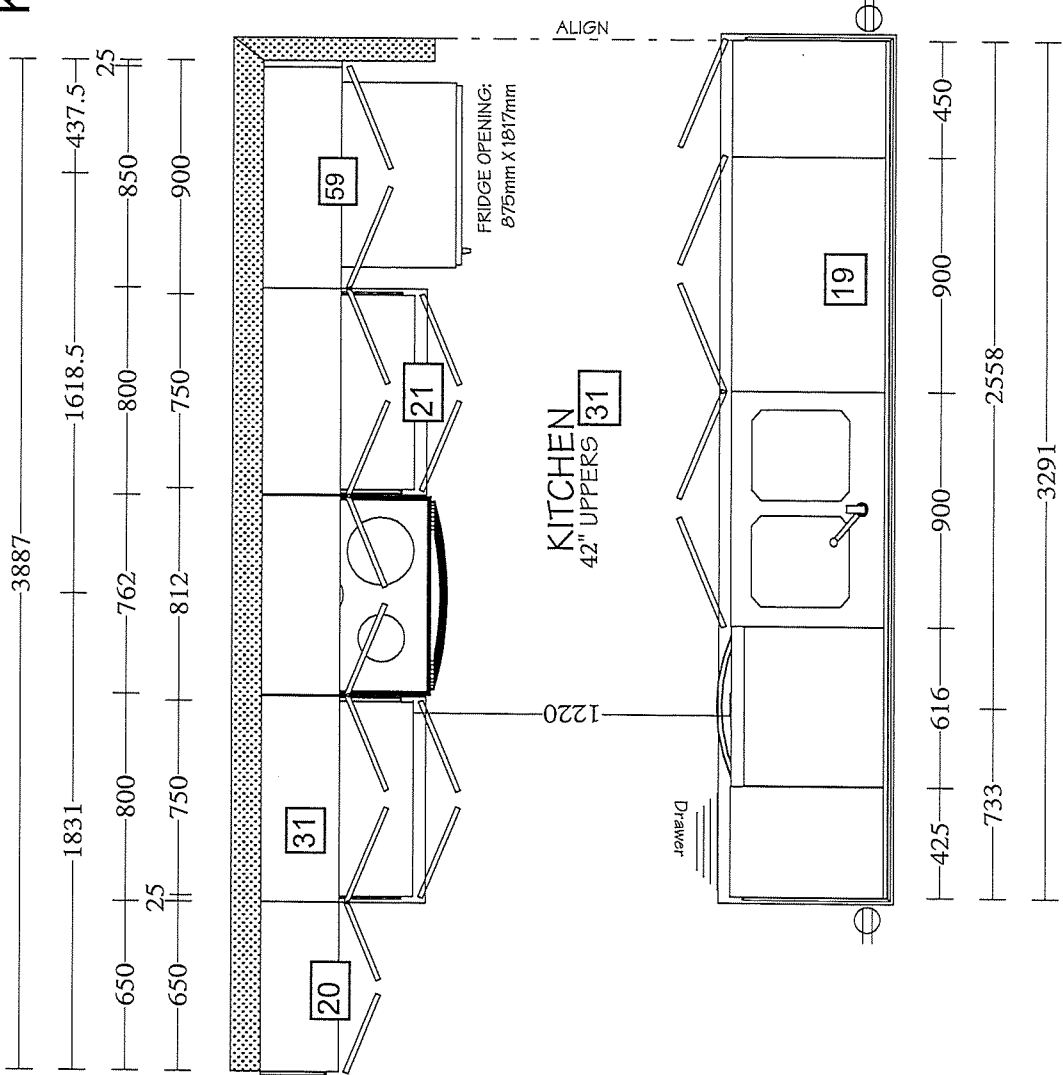



THE THOMAS

MODEL 110

2098 sq.ft  
(365 sq.ft. Basement)

Site: DV2

Plan No.: 4M-1290

Lot: B10

Date: August 31, 2021

Purchaser: Portobello Partnership

Purchaser:

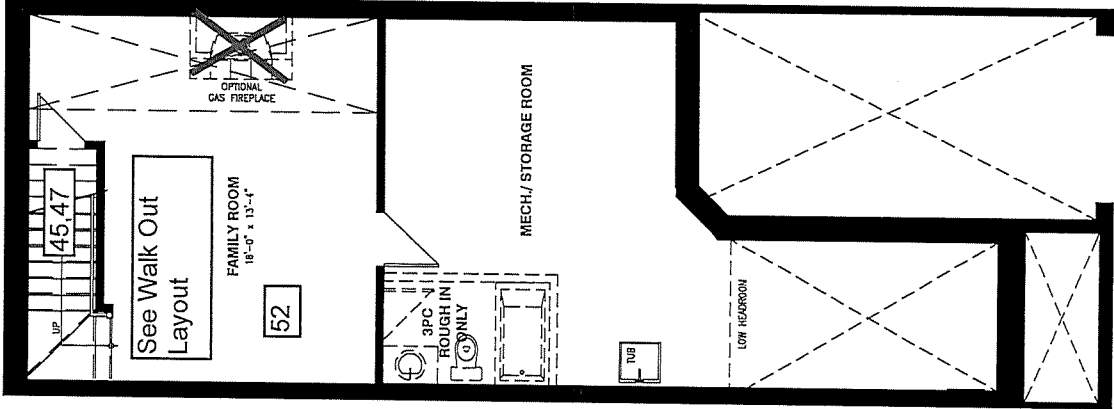

BASEMENT FLOOR

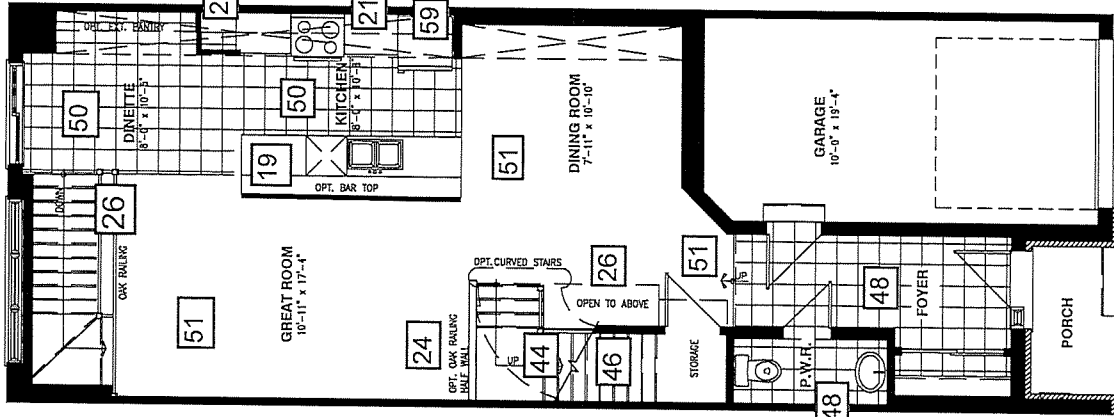

GROUND FLOOR

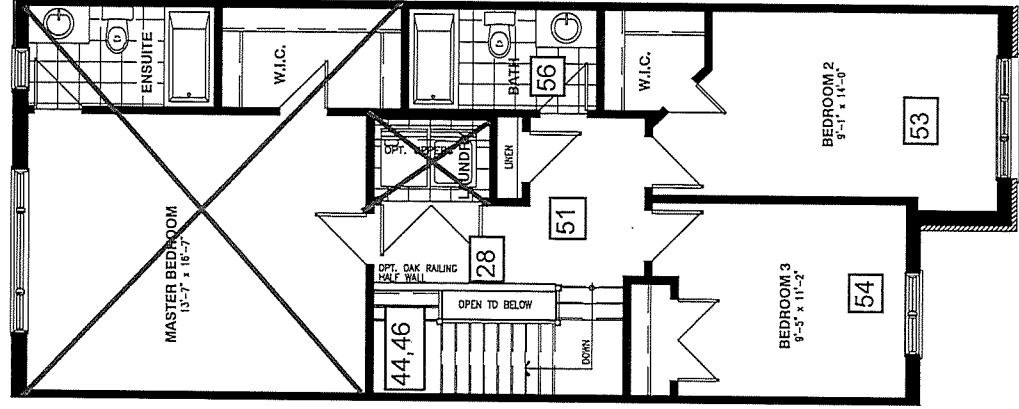

SECOND FLOOR

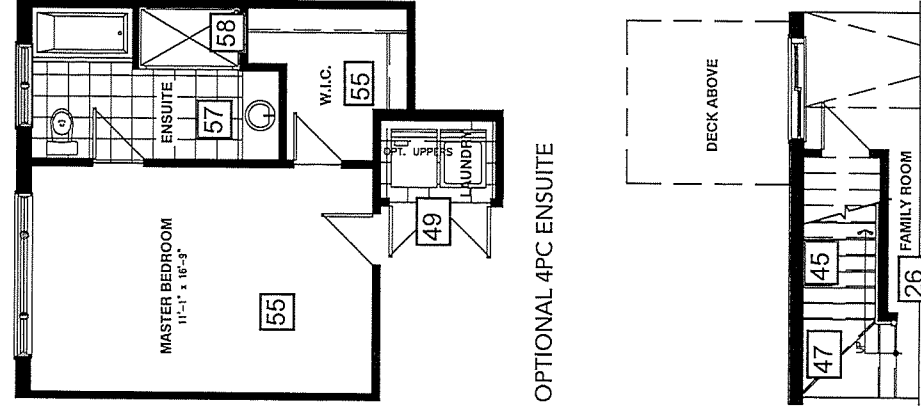

OPTIONAL 4PC ENSUITE

WALKOUT BASEMENT  
WHERE APPLICABLE

Schedule H



Vertical and/or horizontal bulkheads (chaseways) may be required to contain mechanical piping. All dimensions are approximate. E. & O.E., plans, materials and specifications are subject to change without notice. Actual useable floor space may vary from the stated floor area. \*Note: Number of steps varies due to site grading.

 <b>Valecraft</b> Homes Ltd.	<b>SINGLES AND TOWNS COLOUR CHART</b>				
	Community:	Deerfield Village 2	Reg'd Plan #:	4M-1290	Sales Rep: N. Trudel
	Lot No:	B10	Civic Address:	520 Fawn Valley Private	
	Purchaser(s):	Portobello Partnership			Model Name/#: 110 Thomas Rev. W/O
	Purchaser(s):				Closing Date: December 9-2021

INTERIOR FINISHES		
	DESCRIPTION	STD/UPG #
TRIM STYLE	Standard Nivaga Baseboards and Casings	STD
DOOR STYLE	Standard Cambridge Style Passage Doors	STD
INTERIOR HARDWARE	Standard / Satin Chrome	STD
INTERIOR LIGHTING PACKAGE	Roma Lighting Package	4, 14
BATHROOM ACCESSORIES	Infinity Series in Chrome	4
FIREPLACE MANTLE	N/A	N/A

INTERIOR HANDRAILS AND SPINDLES				
	WOOD	STYLE	STAIN/COLOUR	STD/UPG #
HANDRAIL	Red Oak	Contemporary	SB 208	24, 26, 28, 51
RACKET (if applicable)	Metal	Metal	Gunn Metal Grey	24, 26, 28
SPINDLES	Metal	Square / Metal	Gunn Metal Grey	24, 26, 28
POSTS	Red Oak	3-1/2" wide Modern with Cap	SB 208	24, 26, 28, 51
CASINGS	Red Oak	N/A	SB 208	24, 28, 51
HARDWOOD STAIRCASE (WHERE APPLICABLE)	N/A	N/A	N/A	N/A

APPLIANCES				
TYPE	SIZE	STD/UPG #	APPLIANCE UPG LEVEL	STD/UPG #
RIDGE CAP (Standard Minimum Opening is 33" x 70.75")	Standard	STD	Basic Stainless Steel	16
RANGE	Standard	STD	Basic Stainless Steel	16
DISHWASHER	Standard	STD	Basic Stainless Steel	16
MICROWAVE / WOODFAN	Standard	STD	OTR - Basic Stainless Steel	16
WASHING MACHINE/DRYER	Standard	STD	Basic White with Top Load Washer	16

Purchaser's Signature(s) : \_\_\_\_\_
Date: \_\_\_\_\_

Purchaser's Signature(s) : \_\_\_\_\_
Date: \_\_\_\_\_

Approved By : T. Oliver
Date: August 31, 2021



SINGLES AND TOWNS COLOUR CHART

Community:	Deerfield Village 2	Reg'd Plan #:	4M-1290	Sales Rep:	N. Trudel
Lot No:	B10	Civic Address:	520 Fawn Valley Private		
Purchaser(s):	Portobello Partnership			Model Name/#:	110 Thomas Rev. W/O
Purchaser(s):				Closing Date:	December 9-2021

CABINETRY					
ROOM	SELECTION			LEVEL	STD/UPG #
KITCHEN	STYLE AND COLOUR	B10R 2164		STD	19, 20, 21, 31, 59
	HARDWARE CODE	POI-R20004-160-PC-BSN	TYPE Pulls	UPG	21, 36
	COUNTERTOP	Kashmere Cream (Slab Viewing Required)	COUNTERTOP EDGE PROFILE Eased Edge	Granite Level 2	19
MAIN BATHROOM	STYLE AND COLOUR	B10R 2164		STD	STD
	HARDWARE CODE	POI-R20004-160-PC-BSN	TYPE Pulls	UPG	37
	COUNTERTOP	RK7002-T	COUNTERTOP EDGE PROFILE Standard	STD Laminate	STD
PCE ENSUITE BATHROOM	STYLE AND COLOUR	B10R 2164		STD	4
	HARDWARE CODE	POI-R20004-160-PC-BSN	TYPE Pulls	UPG	4, 38
	COUNTERTOP	RK7002-T	COUNTERTOP EDGE PROFILE Standard	STD Laminate	4,
POWDER ROOM	STYLE AND COLOUR	Pedestal		STD	STD
	HARDWARE CODE	N/A	TYPE N/A	N/A	N/A
	COUNTERTOP	N/A	COUNTERTOP EDGE PROFILE N/A	N/A	N/A
BASEMENT BATHROOM	STYLE AND COLOUR	N/A		N/A	N/A
	HARDWARE CODE	N/A	TYPE N/A	N/A	N/A
	COUNTERTOP	N/A	COUNTERTOP EDGE PROFILE N/A	N/A	N/A
LAUNDRY ROOM	STYLE AND COLOUR	N/A		N/A	N/A
	HARDWARE CODE	N/A	TYPE N/A	N/A	N/A
	COUNTERTOP	N/A	COUNTERTOP EDGE PROFILE N/A	N/A	N/A

Purchaser's Signature(s) : \_\_\_\_\_

Date: \_\_\_\_\_

Purchaser's Signature(s) : \_\_\_\_\_

Date: \_\_\_\_\_

Approved By : \_\_\_\_\_

T. Oliver

Date: August 31, 2021

 <b>Valecraft</b> Homes Ltd.	<b>SINGLES AND TOWNS COLOUR CHART</b>					
	Community:	Deerfield Village 2	Reg'd Plan #:	4M-1290	Sales Rep:	N. Trudel
	Lot No:	B10	Civic Address:	520 Fawn Valley Private		
	Purchaser(s):	Portobello Partnership			Model Name/#:	110 Thomas Rev. W/O
	Purchaser(s):				Closing Date:	December 9-2021
<b>PAINT COLOUR(S)</b>						
ROOM	MAIN COLOUR		STD/UPG #	ACCENT WALL		STD/UPG #
RIM	Semi Gloss OC-117 simply white		STD	N/A		N/A
BOYER	Low Luster OC-30 Gray Mist		STD	N/A		N/A
POWDER ROOM	Semi Gloss OC-30 Gray Mist		STD	N/A		N/A
MAIN FLOOR HALLWAY	Low Luster OC-30 Gray Mist		STD	N/A		N/A
ENTRY	N/A		N/A	N/A		N/A
FAMILY ROOM	Low Luster OC-30 Gray Mist		STD	N/A		N/A
REAR ROOM	Low Luster OC-30 Gray Mist		STD	N/A		N/A
DINING ROOM	Low Luster OC-30 Gray Mist		STD	N/A		N/A
KITCHEN ROOM	N/A		N/A	N/A		N/A
KITCHEN/DINETTE/ BREAKFAST	Semi Gloss OC-30 Gray Mist		STD	N/A		N/A
LAUNDRY CLOSET	Low Luster OC-30 Gray Mist		STD	N/A		N/A
2ND FLOOR HALLWAY	Low Luster OC-30 Gray Mist		STD	N/A		N/A
MAIN BATH	Semi Gloss OC-30 Gray Mist		STD	N/A		N/A
BEDROOM #2	Low Luster OC-30 Gray Mist		STD	N/A		N/A
BEDROOM #3	Low Luster OC-30 Gray Mist		STD	N/A		N/A
BEDROOM #4	N/A		N/A	N/A		N/A
MASTER BEDROOM	Low Luster OC-30 Gray Mist		STD	N/A		N/A
MASTER BEDROOM WALK-IN CLOSET	Low Luster OC-30 Gray Mist		STD	N/A		N/A
MASTER BEDROOM DRESSING SUITE	Semi Gloss OC-30 Gray Mist		STD	N/A		N/A
FINISHED BASEMENT RECREATION ROOM	N/A		N/A	N/A		N/A
BASEMENT BATHROOM	N/A		N/A	N/A		N/A

Purchaser's Signature(s) : \_\_\_\_\_
Date: \_\_\_\_\_

Purchaser's Signature(s) : \_\_\_\_\_
Date: \_\_\_\_\_

Approved By : August 31, 2021
Date: August 31, 2021

Subject to change by Valecraft Homes in the event of unavailability of materials.  
 Prices, terms and specifications are subject to change without notice E/O.E  
 SALES\Sales Legal Docs\Site - Deerfield\Block B\B10\DV2 B10 Interior Colours Aug 31-21 HO COP

 <b>Valecraft</b> Homes Ltd.	SINGLES AND TOWNS COLOUR CHART					
	Community:	Deerfield Village 2	Reg'd Plan #:	4M-1290	Sales Rep:	N. Trudel
	Lot No:	B10	Civic Address:	520 Fawn Valley Private		
	Purchaser(s):	Portobello Partnership			Model Name/#:	110 Thomas Rev. W/O
	Purchaser(s):				Closing Date:	December 9-2021

CERAMIC & GROUT SELECTIONS (1)					
ROOM	AREA	MANUFACTURER/SERIES/SIZE/ COLOUR/CODE	GROUT SELECTION	LEVEL	STD/UPG #
oyer	FLOOR	Torlys Evertile Premier ET24001 Cliff Island 11-1/2" Wide x 23-5/8" Long (Front to Back 1/2 Brick Install)	N/A	Quote	48
owder room	FLOOR	Torlys Evertile Premier ET24001 Cliff Island 11-1/2" Wide x 23-5/8" Long (Front to Back 1/2 Brick Install)	N/A	Quote	48
	WALL	N/A	N/A	N/A	N/A
	INSERT OR BORDER	N/A			
AUNDRY CLOSET	FLOOR	See Flooring Selection Sheet	N/A	N/A	49
	WALL	N/A	N/A	N/A	N/A
	INSERT OR BORDER	N/A			
UDROOM	FLOOR	N/A	N/A	N/A	N/A
	WALL	N/A	N/A	N/A	N/A
	INSERT OR BORDER	N/A			
ITCHEN	FLOOR	See Flooring Selection Sheet	N/A	N/A	50
	BACKSPLASH	Ceratec Ragno Brick 3.9"x11.8" Beige R4GK (Horizontal 1/3 Staggered Install)	988 Pearl	Gold Wall Tile + UPG Install + UPG Grout	39, 40
	INSERT OR BORDER	N/A			
INETTE	FLOOR	See Flooring Selection Sheet	N/A	N/A	50
REPLACE	HEARTH	N/A	N/A	N/A	N/A
	SURROUND	N/A	N/A	N/A	N/A
DDITIONAL REPLACE	HEARTH	N/A	N/A	N/A	N/A
	SURROUND	N/A	N/A	N/A	N/A

Purchaser's Signature(s) :
Date:

Purchaser's Signature(s) :
Date:

Approved By :
T. Oliver
Date: August 31, 2021

Subject to change by Valecraft Homes in the event of unavailability of materials.  
 Prices, terms and specifications are subject to change without notice E/O.E  
 SALES\Sales Legal Docs\Site - Deerfield\Block B\B10\DV2 B10 Interior Colours Aug 31-21 HO COP



 <b>Valecraft</b> Homes Ltd.	SINGLES AND TOWNS COLOUR CHART					
	Community:	Deerfield Village 2	Reg'd Plan #:	4M-1290	Sales Rep:	N. Trudel
	Lot No:	B10	Civic Address:	520 Fawn Valley Private		
	Purchaser(s):	Portobello Partnership			Model Name/#:	110 Thomas Rev. W/O
	Purchaser(s):				Closing Date:	December 9-2021

CERAMIC & GROUT SELECTIONS (2)					
ROOM	AREA	MANUFACTURER/SERIES/SIZE/ COLOUR/CODE	GROUT SELECTION	LEVEL	STD/UPG #
MAIN BATHROOM	FLOOR	Torlys Evertile Premier ET-24013 Calcatta 11-1/2" Wide x 23-5/8" Long (Side to Side 1/2" Brick Install)	N/A	Quote	56
	WALL	Ceratec Visuals Gaia 11.6" x 23.4" Taupe (Horizontal Stacked Install)	908 Dove Gray	Silver Floor Tile on wall + UPG Grout	39, 43
	INSERT OR BORDER	N/A			
OTHER BATHROOM	FLOOR	N/A	N/A	N/A	N/A
	WALL	N/A	N/A	N/A	N/A
	INSERT OR BORDER	N/A			
POC ENSUITE BATHROOM	FLOOR	Torlys Evertile Premier ET-24013 Calcatta 11-1/2" Wide x 23-5/8" Long (Side to Side 1/2" Brick Install)	N/A	Quote	4, 57
	TUB DECK	Ceratec Visuals Gaia 11.6" x 23.4" Taupe (Horizontal Stacked Install)	908 Dove Gray	Silver Floor Tile on wall + UPG Grout	4, 39, 42
	TUB BACKSPLASH	Ceratec Visuals Gaia 11.6" x 23.4" Taupe (Horizontal Stacked Install)	908 Dove Gray	Silver Floor Tile on wall + UPG Grout	4, 39, 42
	SHOWER WALL	Ceratec Visuals Gaia 11.6" x 23.4" Taupe (Horizontal Stacked Install)	908 Dove Gray	Silver Floor Tile on wall + UPG Grout	4, 39, 41
	SHOWER WALL INSERT	N/A	N/A	N/A	N/A
BASEMENT/OTHER BATHROOM	FLOOR	N/A	N/A	N/A	N/A
	WALL	N/A	N/A	N/A	N/A
	INSERT OR BORDER	N/A	N/A	N/A	N/A

Purchaser's Signature(s) : \_\_\_\_\_

Purchaser's Signature(s) : \_\_\_\_\_

Approved By : \_\_\_\_\_

Date: \_\_\_\_\_

Date: \_\_\_\_\_

Date: August 31, 2021

	SINGLES AND TOWNS COLOUR CHART					
	Community:	Deerfield Village 2	Reg'd Plan #:	4M-1290	Sales Rep:	N. Trudel
	Lot No:	B10	Civic Address:	520 Fawn Valley Private		
	Purchaser(s):	Portobello Partnership			Model Name/#:	110 Thomas Rev. W/O
	Purchaser(s):				Closing Date:	December 9-2021
FLOORING SELECTIONS						
ROOM	CARPET/UNDERPAD OR HARDWOOD			LEVEL	STD/UPG #	
MAIN FLOOR HALLWAY	Torlys Everwood Premier EW23024 Sierra 4-7/8" Wide x 48-3/8" Long Plank (Front to back Install)			Quote	51	
LIVING ROOM	N/A			N/A	N/A	
LAUNDRY CLOSET	Torlys Everwood Premier EW23024 Sierra 4-7/8" Wide x 48-3/8" Long Plank (Front to back Install)			Quote	49	
DINING ROOM	Torlys Everwood Premier EW23024 Sierra 4-7/8" Wide x 48-3/8" Long Plank (Front to back Install)			Quote	51	
REAR ROOM	Torlys Everwood Premier EW23024 Sierra 4-7/8" Wide x 48-3/8" Long Plank (Front to back Install)			Quote	51	
FAMILY ROOM	Torlys Everwood Premier EW23024 Sierra 4-7/8" Wide x 48-3/8" Long Plank (Front to back Install)			Quote	52	
REAR HALLWAY	N/A			N/A	N/A	
KITCHEN	Torlys Everwood Premier EW23024 Sierra 4-7/8" Wide x 48-3/8" Long Plank (Front to back Install)			Quote	50	
BREAKFAST REAR DINETTE	Torlys Everwood Premier EW23024 Sierra 4-7/8" Wide x 48-3/8" Long Plank (Front to back Install)			Quote	50	
MAIN STAIRS TO BEDROOMS (Including Landings)	Beaulieu Silex II Broadloom Carpet Pampa Beige 16320 + Upgraded Underpad			Quote Carpet + L1 Underpad	44, 46	
UPPER HALLWAY	Torlys Everwood Premier EW23024 Sierra 4-7/8" Wide x 48-3/8" Long Plank (Front to back Install)			Quote	51	
BEDROOM # 2	Torlys Everwood Premier EW23024 Sierra 4-7/8" Wide x 48-3/8" Long Plank (Front to back Install)			Quote	53	
BEDROOM # 3	Torlys Everwood Premier EW23024 Sierra 4-7/8" Wide x 48-3/8" Long Plank (Front to back Install)			Quote	54	
BEDROOM # 4	N/A			N/A	N/A	
MASTER BEDROOM	Torlys Everwood Premier EW23024 Sierra 4-7/8" Wide x 48-3/8" Long Plank (Front to back Install)			Quote	55	
MASTER BEDROOM WALK-IN CLOSET	Torlys Everwood Premier EW23024 Sierra 4-7/8" Wide x 48-3/8" Long Plank (Front to back Install)			Quote	55	
STAIRS TO BASEMENT	Beaulieu Silex II Broadloom Carpet Pampa Beige 16320 + Upgraded Underpad			Quote Carpet + L1 Underpad	45, 47	
OTHER	N/A			N/A	N/A	

Purchaser's Signature(s) :
Date:

Purchaser's Signature(s) :
Date:

Approved By :
T. Oliver
Date: August 31, 2021



Valecraft

Homes Ltd.

SINGLES AND TOWNS COLOUR CHART

Community:	Deerfield Village 2	Reg'd Plan #:	4M-1290	Sales Rep:	N. Trudel
Lot No:	B10	Civic Address:	520 Fawn Valley Private		
Purchaser(s):	Portobello Partnership			Model Name/#:	110 Thomas Rev. W/O
Purchaser(s):				Closing Date:	December 9-2021

PLUMBING FIXTURES				
ROOM	FIXTURE	STYLE	FINISH	STD/UPG#
KITCHEN	SINK	Reginox Kitchen Sink Undermount Double Bowl ND1831UA/9	Stainless Steel	33
	FAUCET	Delta Kitchen Faucet Single Handle Pull-Down Marley 986LF-AR	Arctic Stainless	35
MAIN BATHROOM	SINK	Standard	White	STD
	VANITY FAUCET	Standard	Chrome	STD
	WATER CLOSET	Standard	White	STD
	TUB/SHOWER	Standard	White	STD
	TUB/SHOWER FAUCET	Standard	Chrome	STD
POWDER ENSUITE BATHROOM	SINK	Standard	White	4
	VANITY FAUCET	Standard	Chrome	4
	WATER CLOSET	Standard	White	4
	SHOWER	Standard w/ Zitta Niche 12 x 12 (Installed on small wall of shower opposite shower head approx. centered. With top to be approx. 5 ft. from floor)	White/Chrome/Clear Glass/ Stainless Steel	4, 58
	SHOWER FAUCET	Standard	Chrome	4
	BATHTUB	Standard	White	4
	BATHTUB FAUCET	Standard	Chrome	4
POWDER ROOM	PEDESTAL	Standard	White	STD
	SINK FAUCET	Standard	Chrome	STD
	WATER CLOSET	Standard	White	STD
BASEMENT BATHROOM	SINK	N/A	N/A	N/A
	VANITY FAUCET	N/A	N/A	N/A
	WATER CLOSET	N/A	N/A	N/A
	TUB/SHOWER	N/A	N/A	N/A
	TUB/SHOWER FAUCET	N/A	N/A	N/A

NOTE: All fixtures are white as standard

Purchaser's Signature(s) : \_\_\_\_\_

Date: \_\_\_\_\_

Purchaser's Signature(s) : \_\_\_\_\_

Date: \_\_\_\_\_

Approved By : T. Oliver \_\_\_\_\_

Date: August 31, 2021 \_\_\_\_\_

Subject to change by Valecraft Homes in the event of unavailability of materials.  
Prices, terms and specifications are subject to change without notice E/O.E  
C:\Sales\Legal Docs\Site - Deerfield\Block B\B10\DV2 B10 Interior Colours Aug 31-21 HO COP